



US 20200022710A1

(19) **United States**(12) **Patent Application Publication**
Bohl et al.(10) **Pub. No.: US 2020/0022710 A1**(43) **Pub. Date: Jan. 23, 2020**(54) **APPARATUS FOR INCISION AND REMOVAL
OF OSSEOUS TISSUE AND METHODS
THEREOF****Publication Classification**(51) **Int. Cl.***A61B 17/17* (2006.01)*A61B 17/16* (2006.01)*A61B 17/15* (2006.01)(52) **U.S. Cl.**CPC *A61B 17/1757* (2013.01); *A61B 17/1604*
(2013.01); *A61B 17/15* (2013.01); *A61B*
17/1671 (2013.01)(71) Applicant: **DIGNITY HEALTH**, San Francisco,
CA (US)(72) Inventors: **Michael Bohl**, Phoenix, AZ (US);
Michael Mooney, Phoenix, AZ (US);
Iridian Vaca, Madera, CA (US); **Ryan**
Samuel Schulte, Spokane, WA (US);
Andrew Robert Bruce, Bellingham,
WA (US); **Leah Elizabeth Fletcher**,
Shoreline, WA (US); **Aron**
Lopez-Jimenez, Phoenix, AZ (US);
Framarz Alam, Phoenix, AZ (US);
Ethan Marshall, Queen Creek, AZ
(US); **Ivanna Revel**, Scottsdale, AZ
(US)(21) Appl. No.: **16/481,535**(22) PCT Filed: **Jan. 31, 2018**(86) PCT No.: **PCT/US2018/016256**

§ 371 (c)(1),

(2) Date: **Jul. 29, 2019****Related U.S. Application Data**(60) Provisional application No. 62/452,413, filed on Jan.
31, 2017.(57) **ABSTRACT**

An apparatus for extraction of osseous tissue is disclosed. The apparatus includes a fixed portion and a clamp oriented along a generally central area of the fixed portion. The apparatus includes a first bone cutting device and a second bone cutting device coupled to the fixed portion and oriented around the clamp. The first bone cutting device and the second bone cutting device are coupled to the fixed portion using respective joints that accommodate orientations of the first bone cutting device and the second bone cutting device relative to the fixed portion along different horizontal and vertical axes. The clamp is configured to engage a first bone portion during a surgical procedure. The first bone cutting device and the second bone cutting device are configured to remove a second bone portion

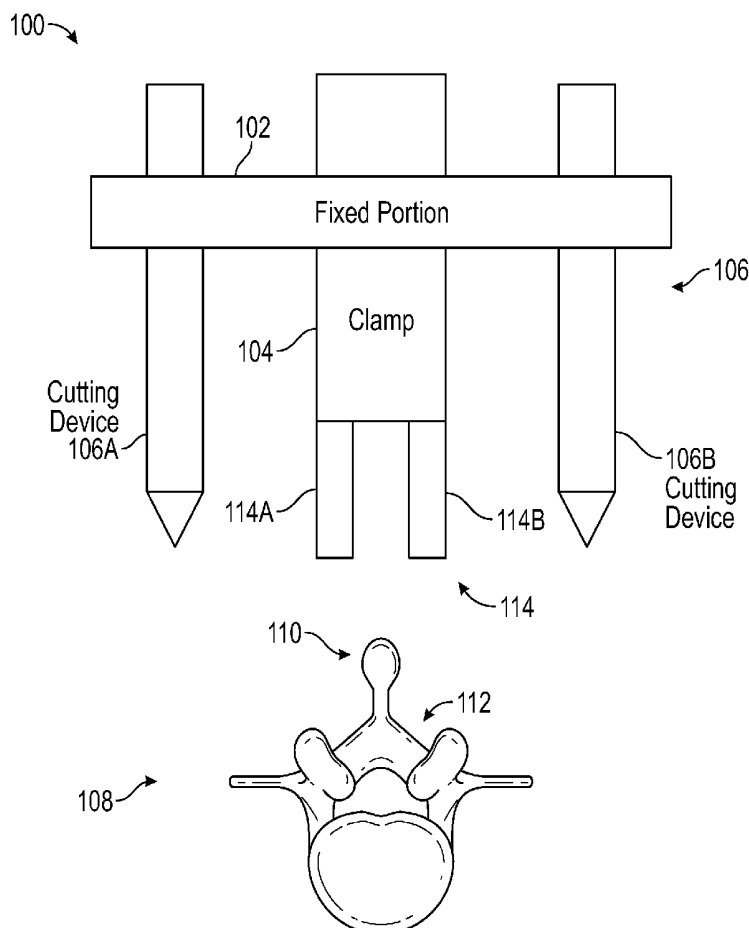

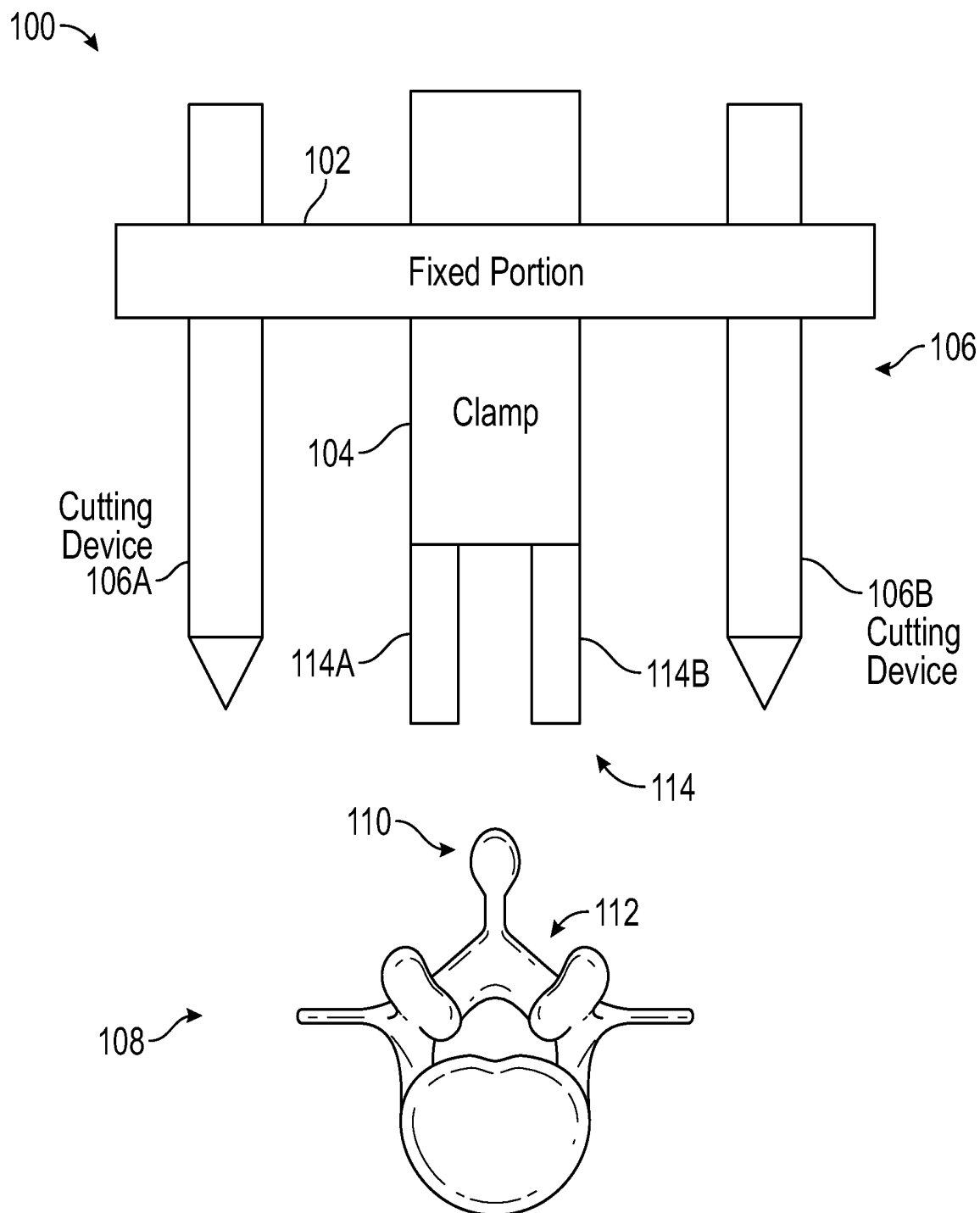
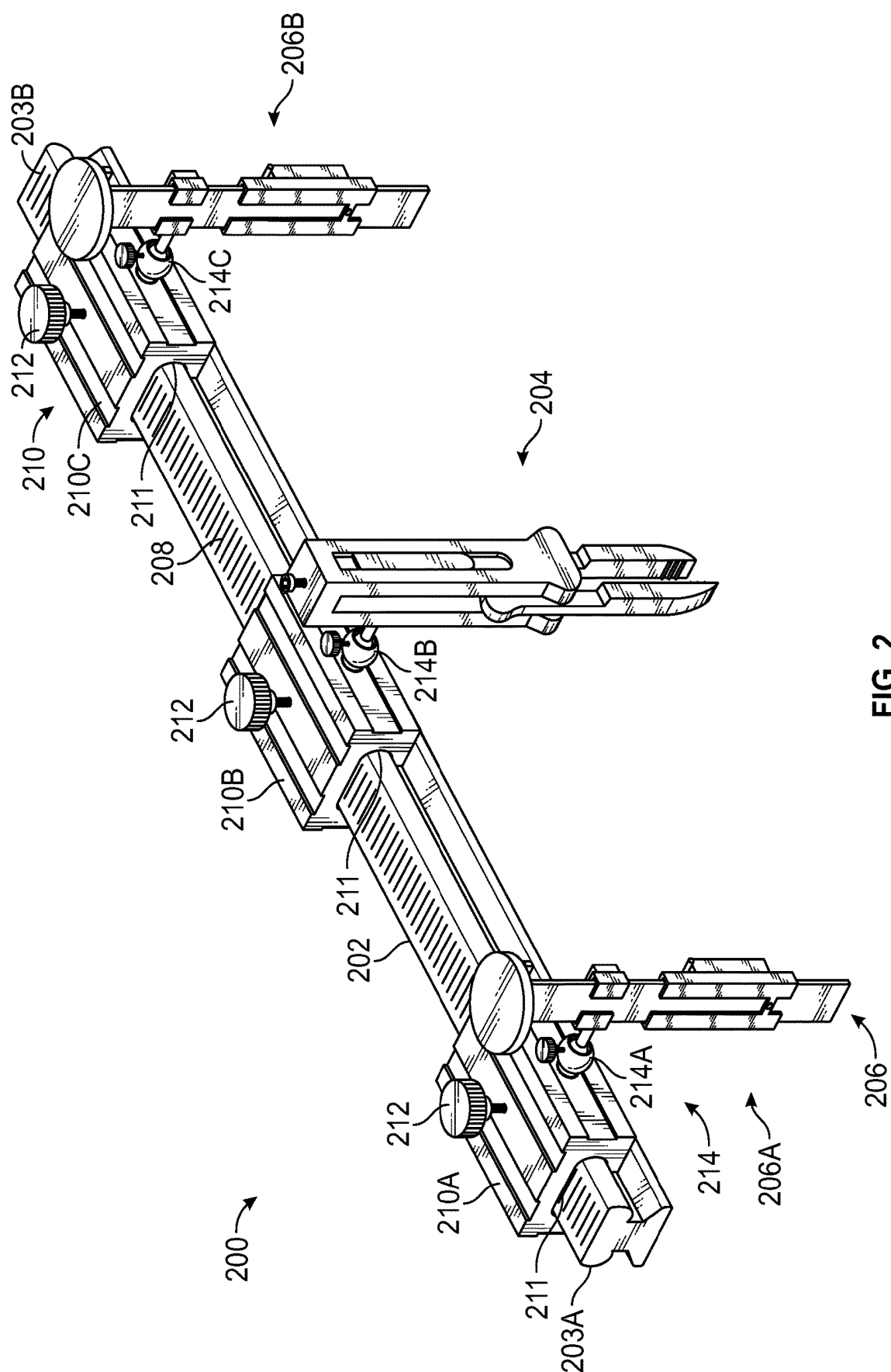

FIG. 1



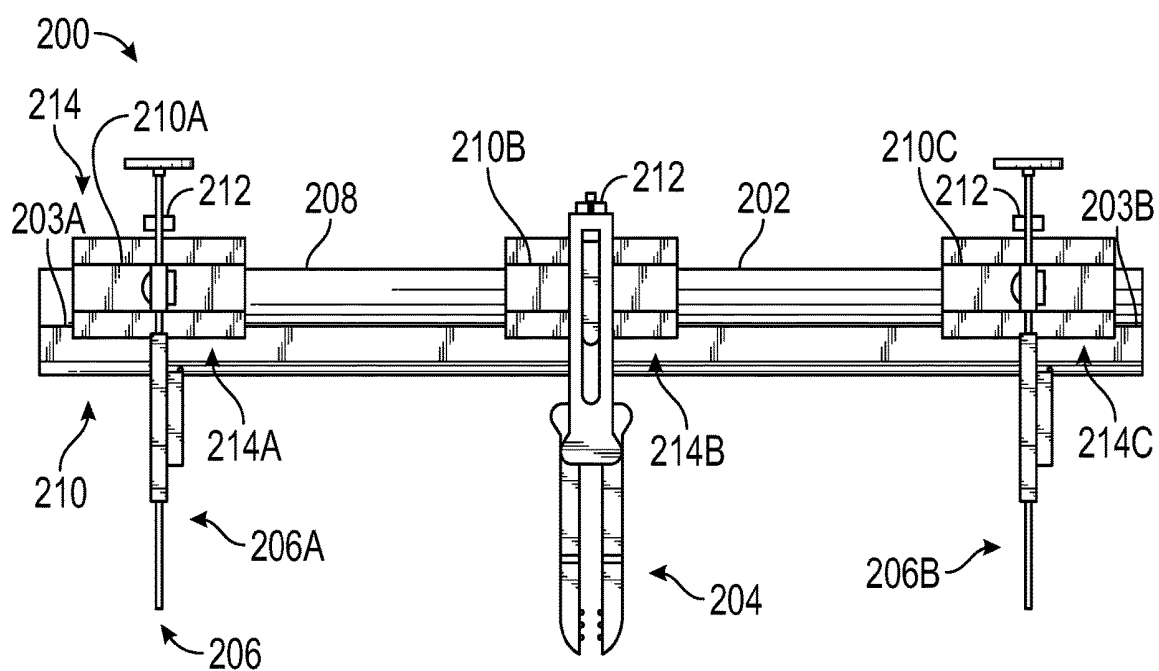

FIG. 3

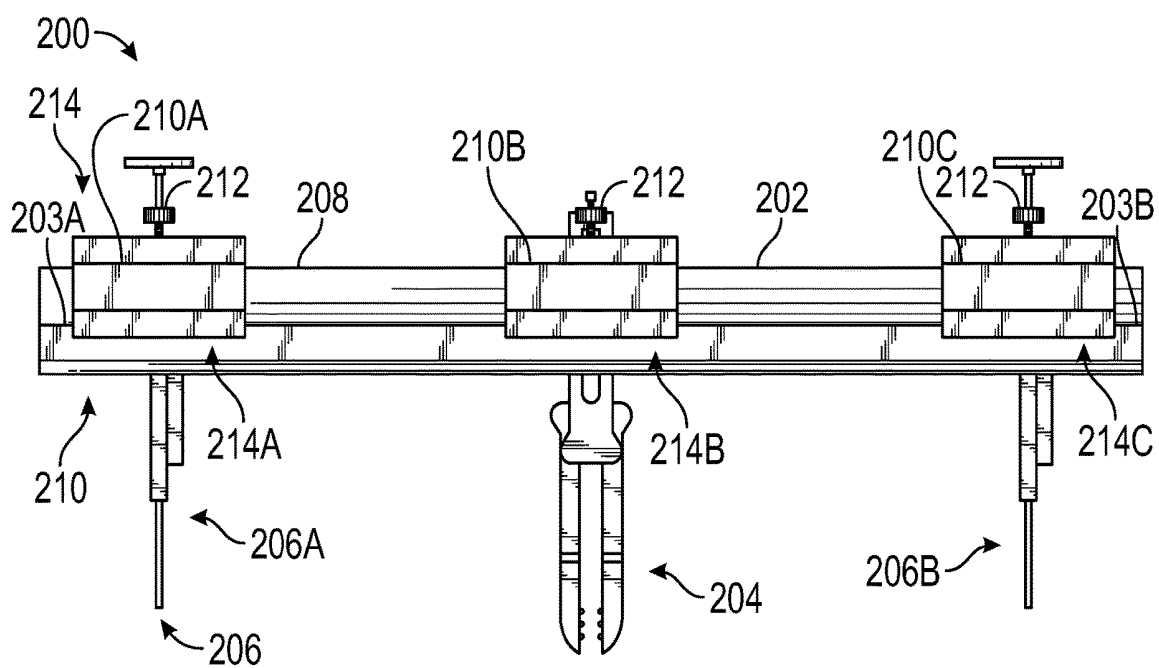

FIG. 4

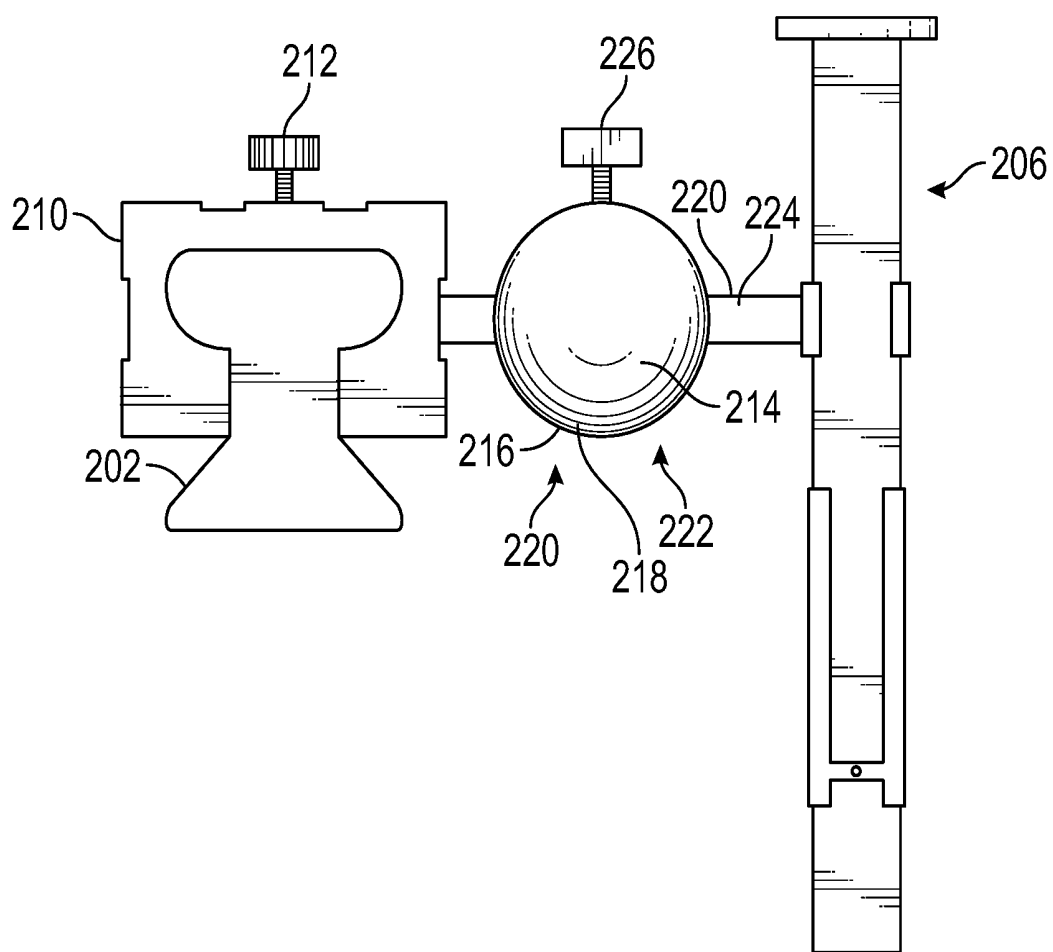

FIG. 5

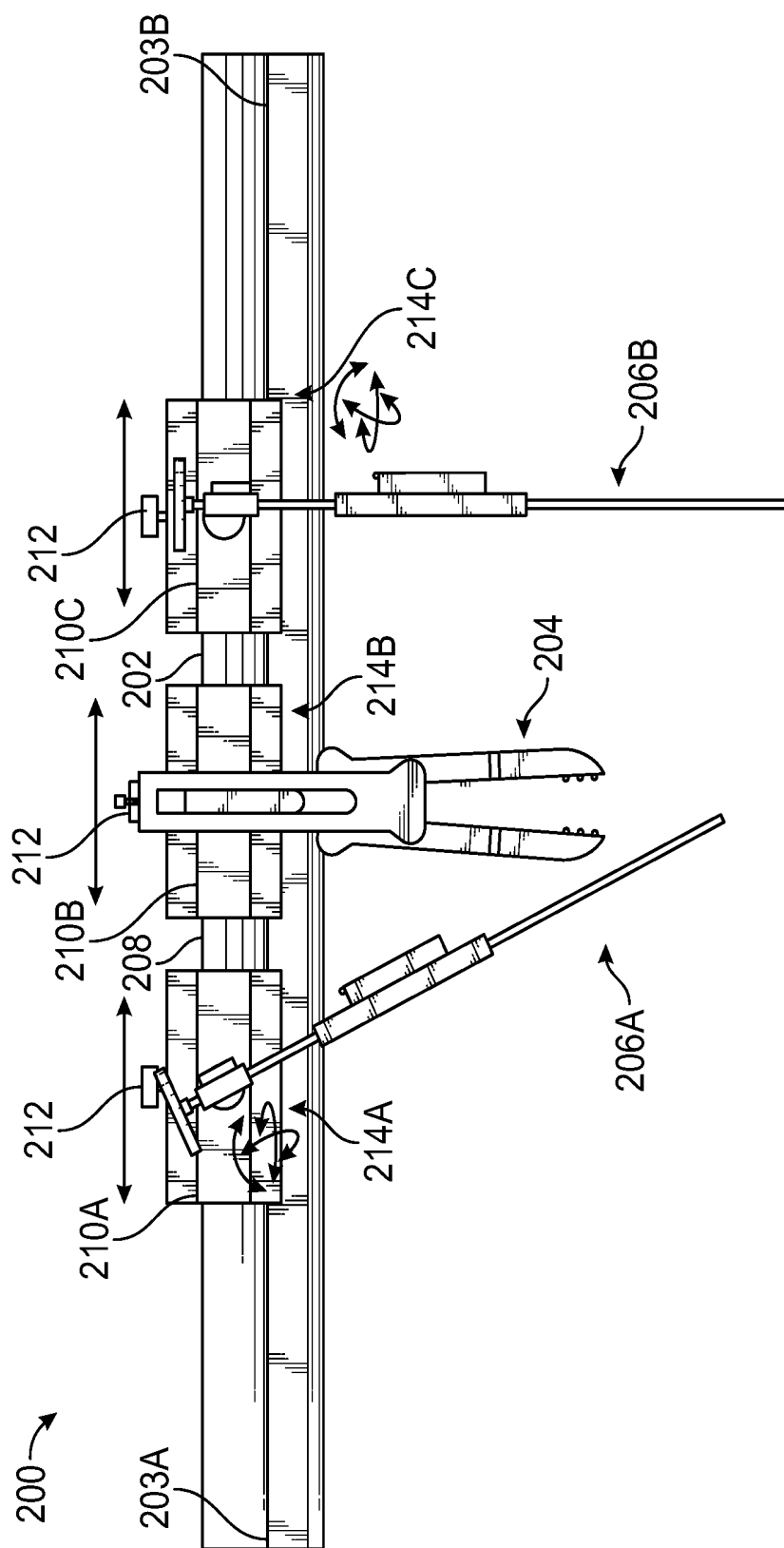

FIG. 6

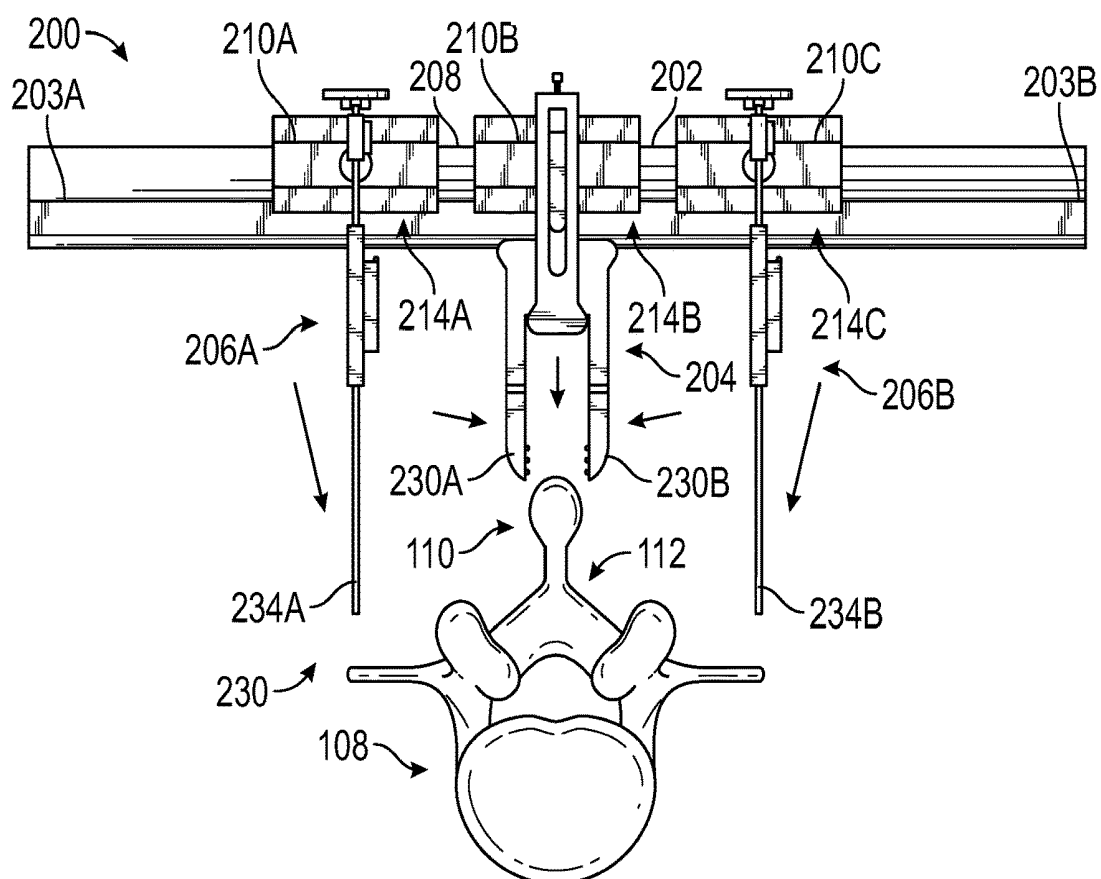

FIG. 7A

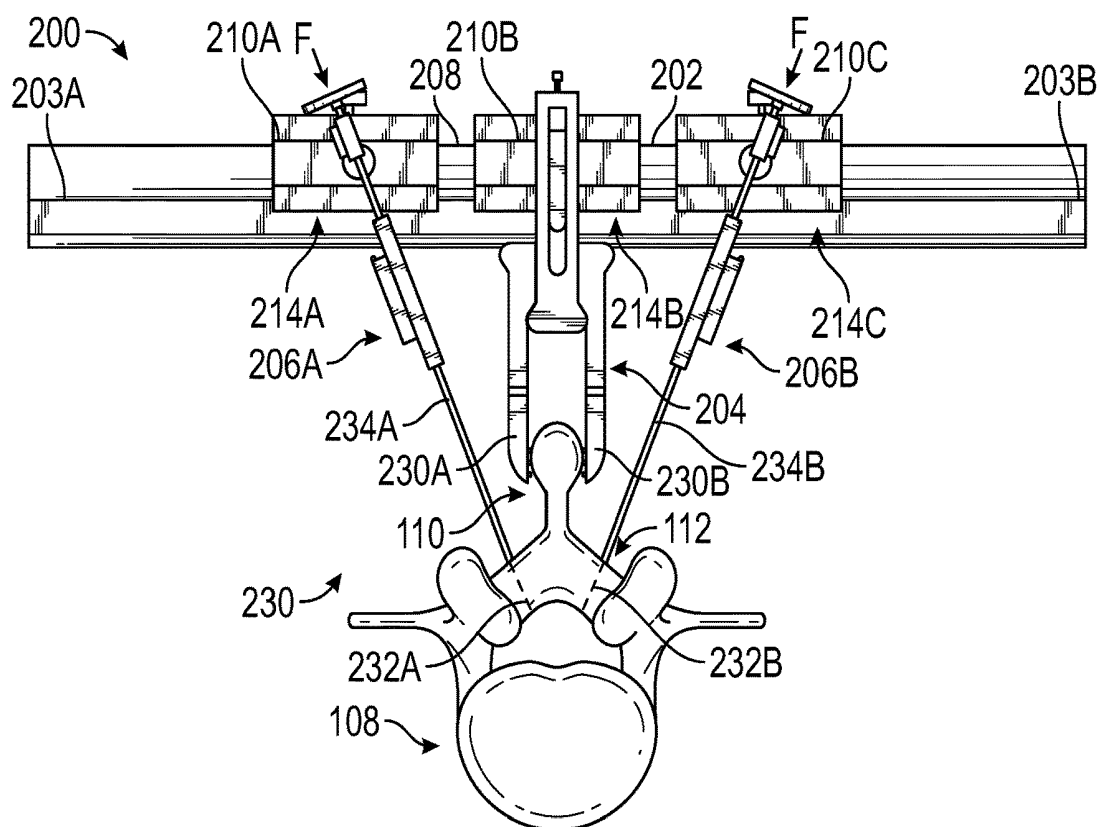

FIG. 7B

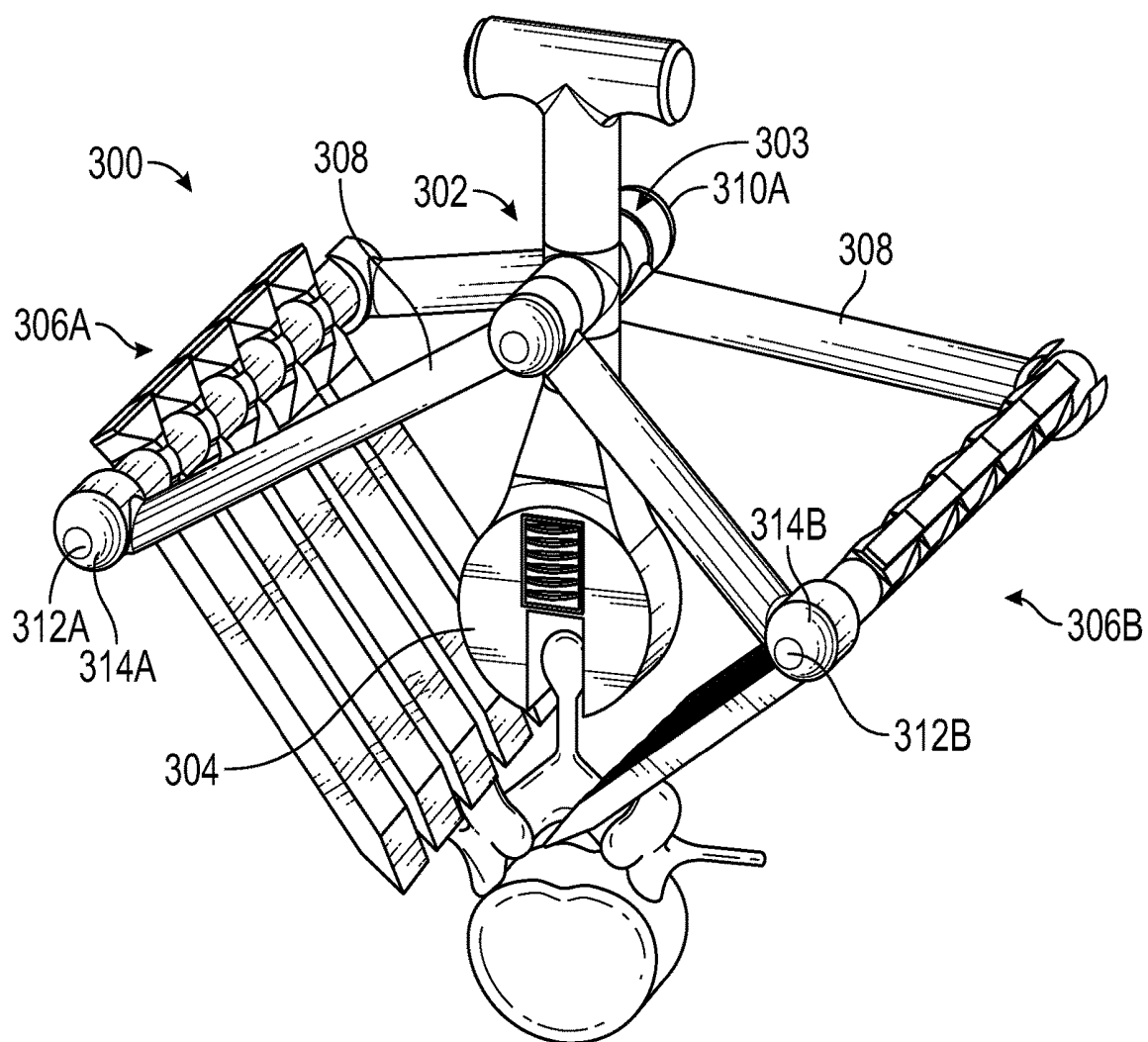

FIG. 8

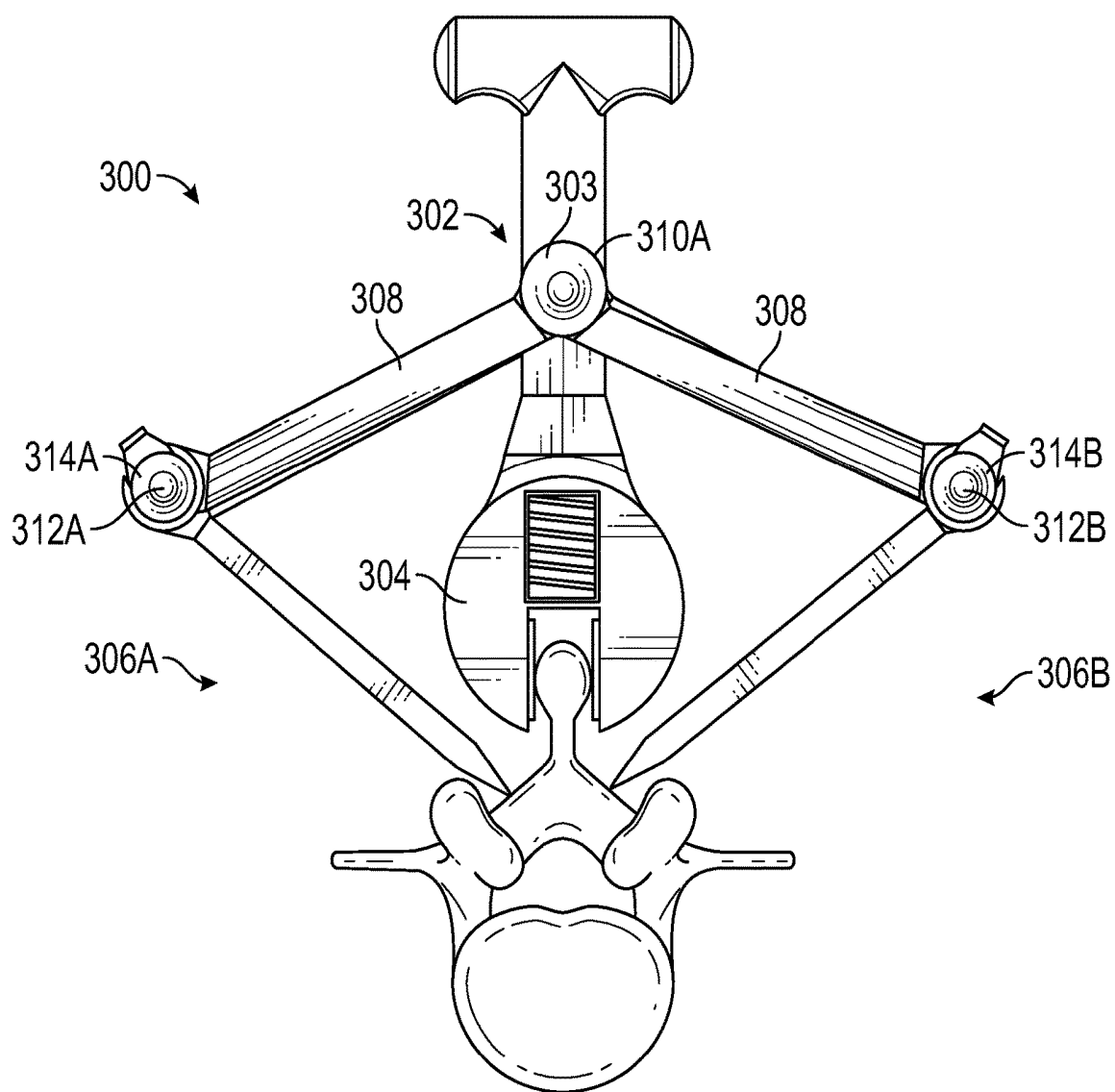

FIG. 9

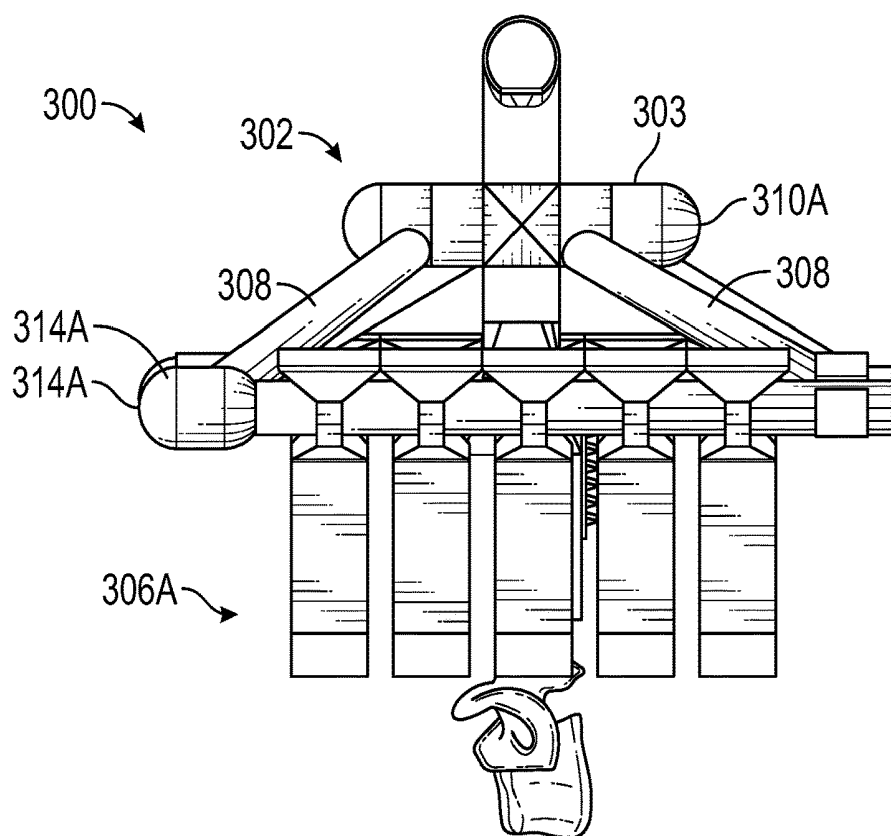

FIG. 10

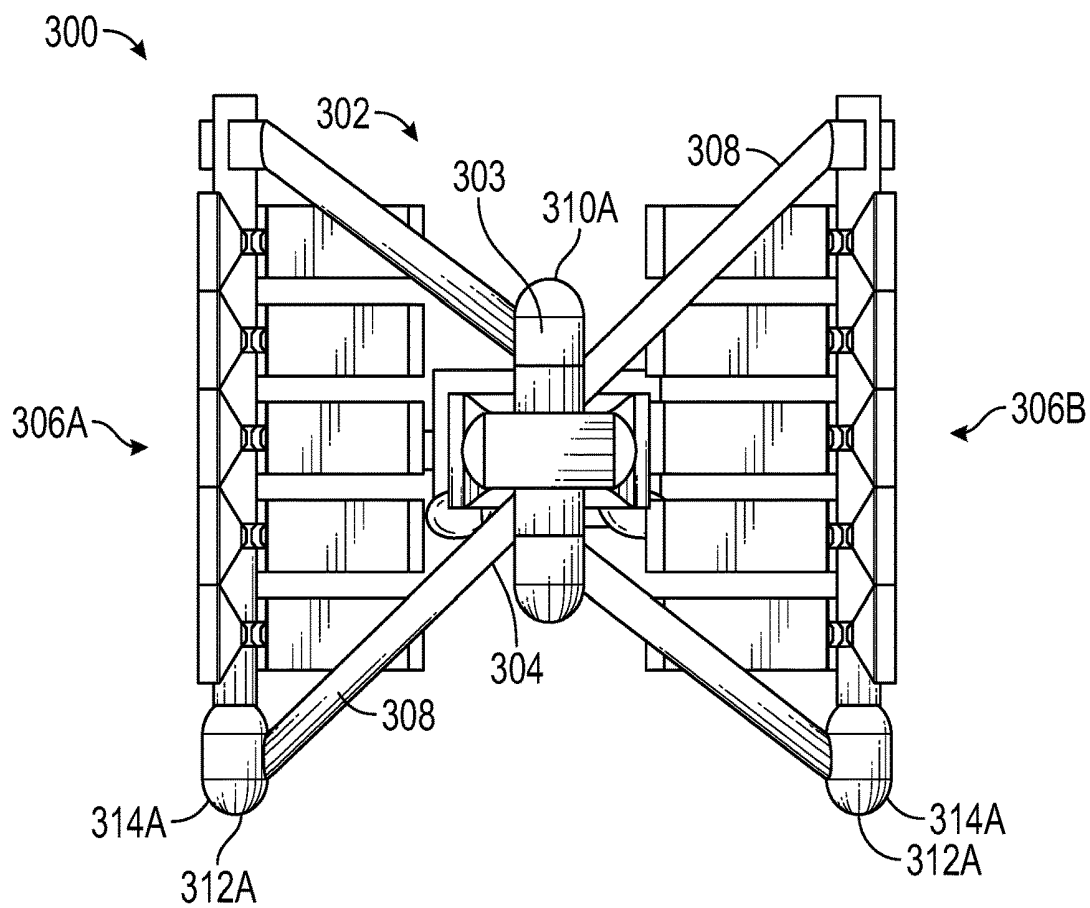

FIG. 11

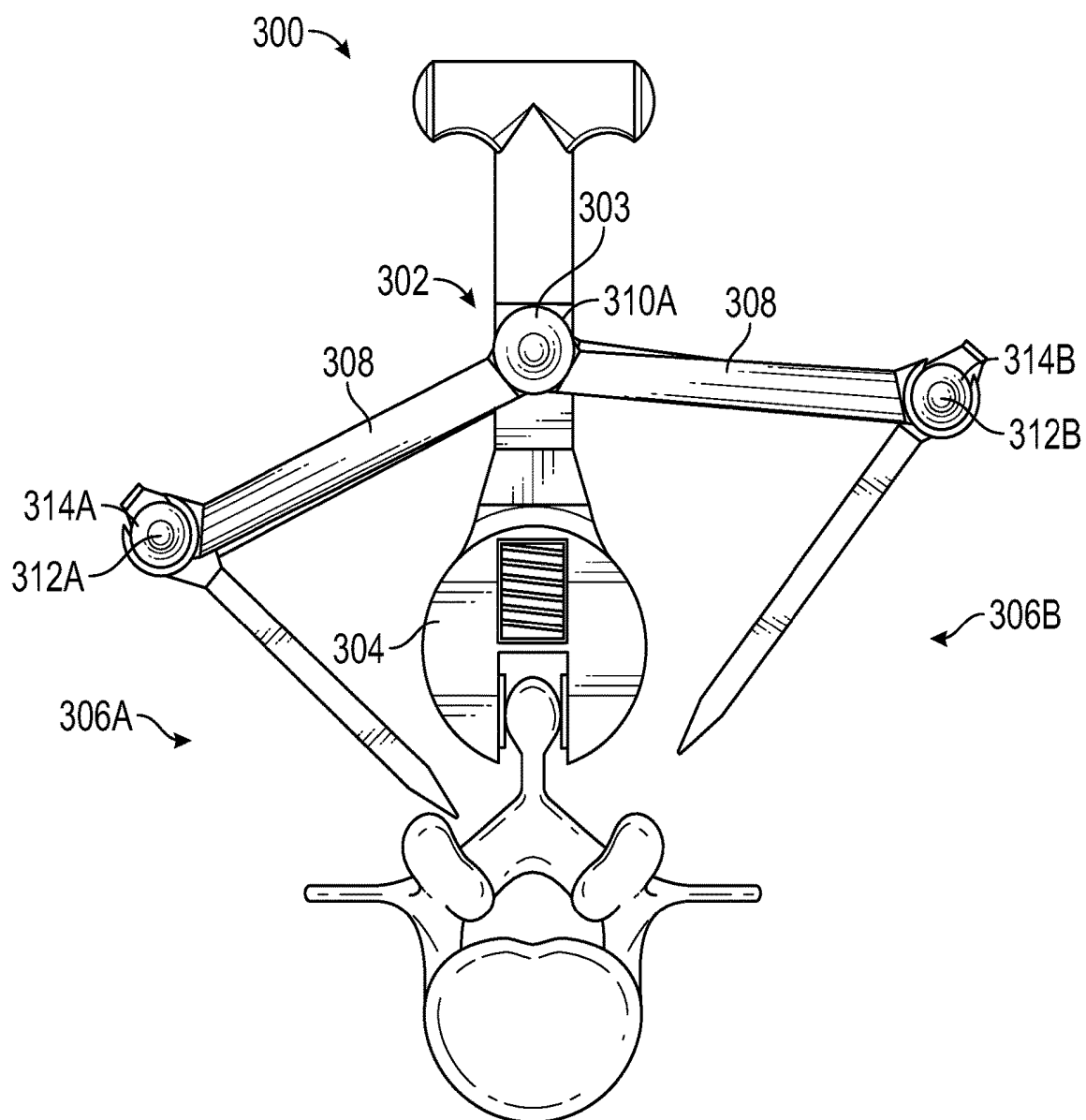

FIG. 12

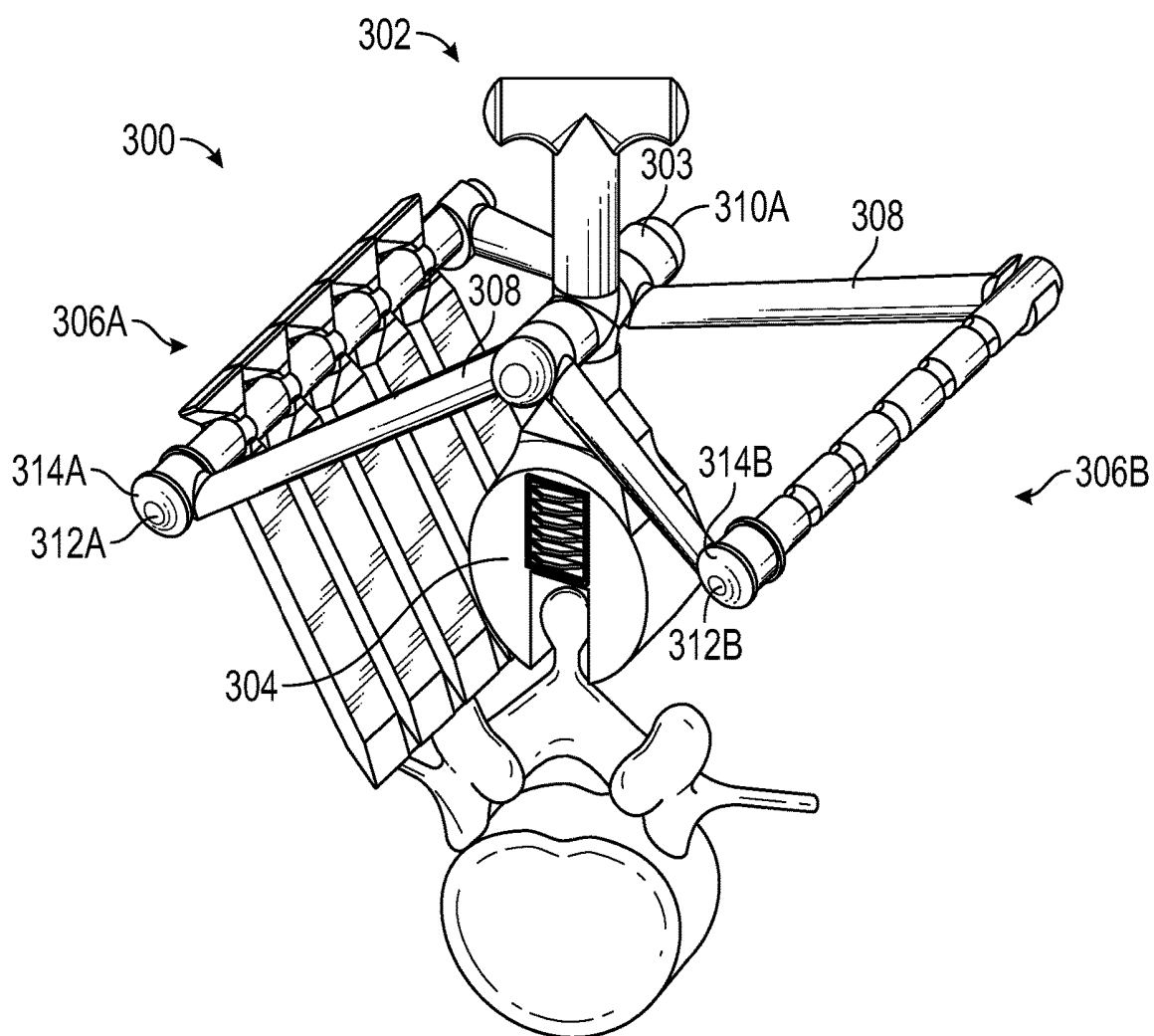

FIG. 13

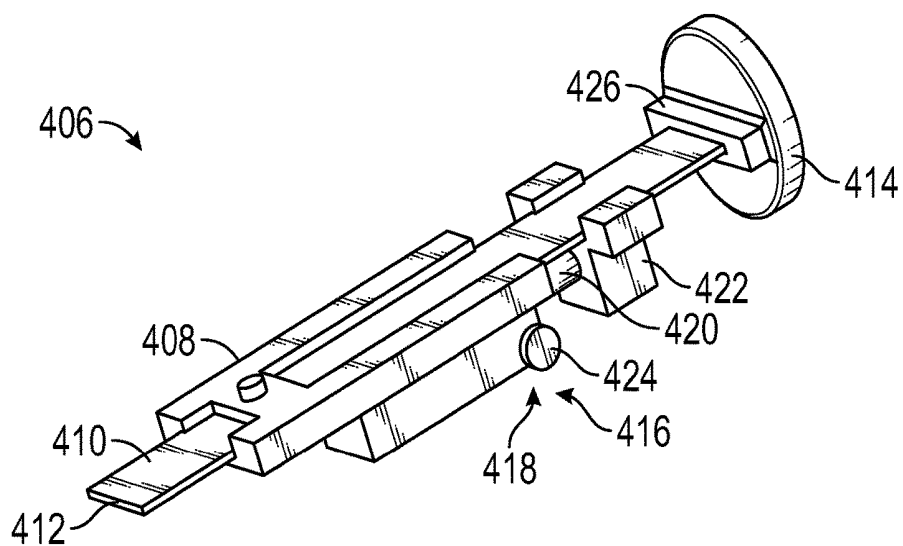

FIG. 14

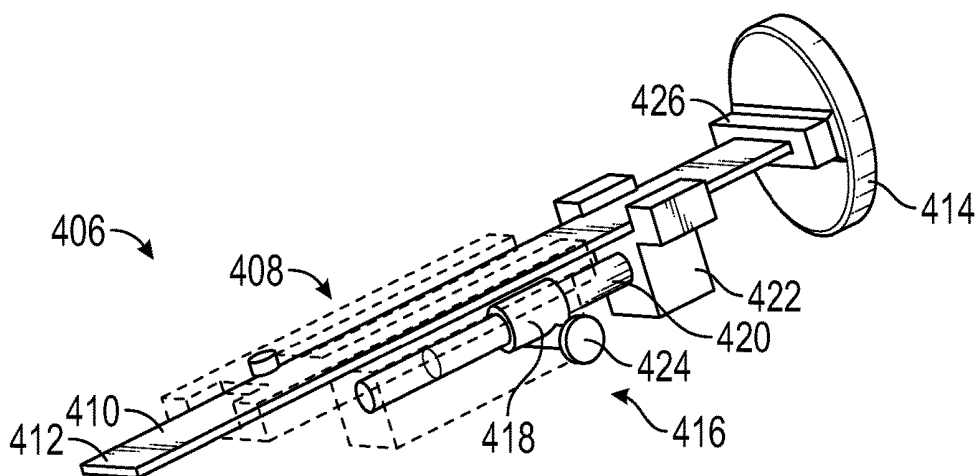

FIG. 15

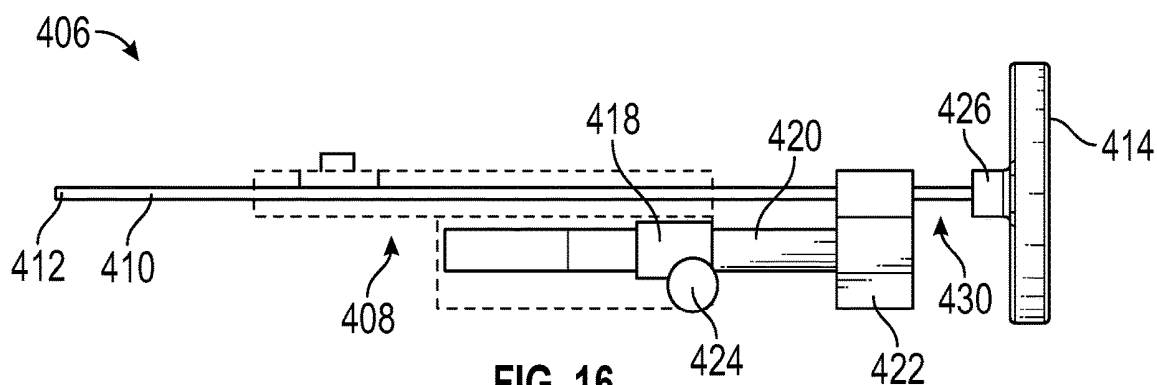

FIG. 16

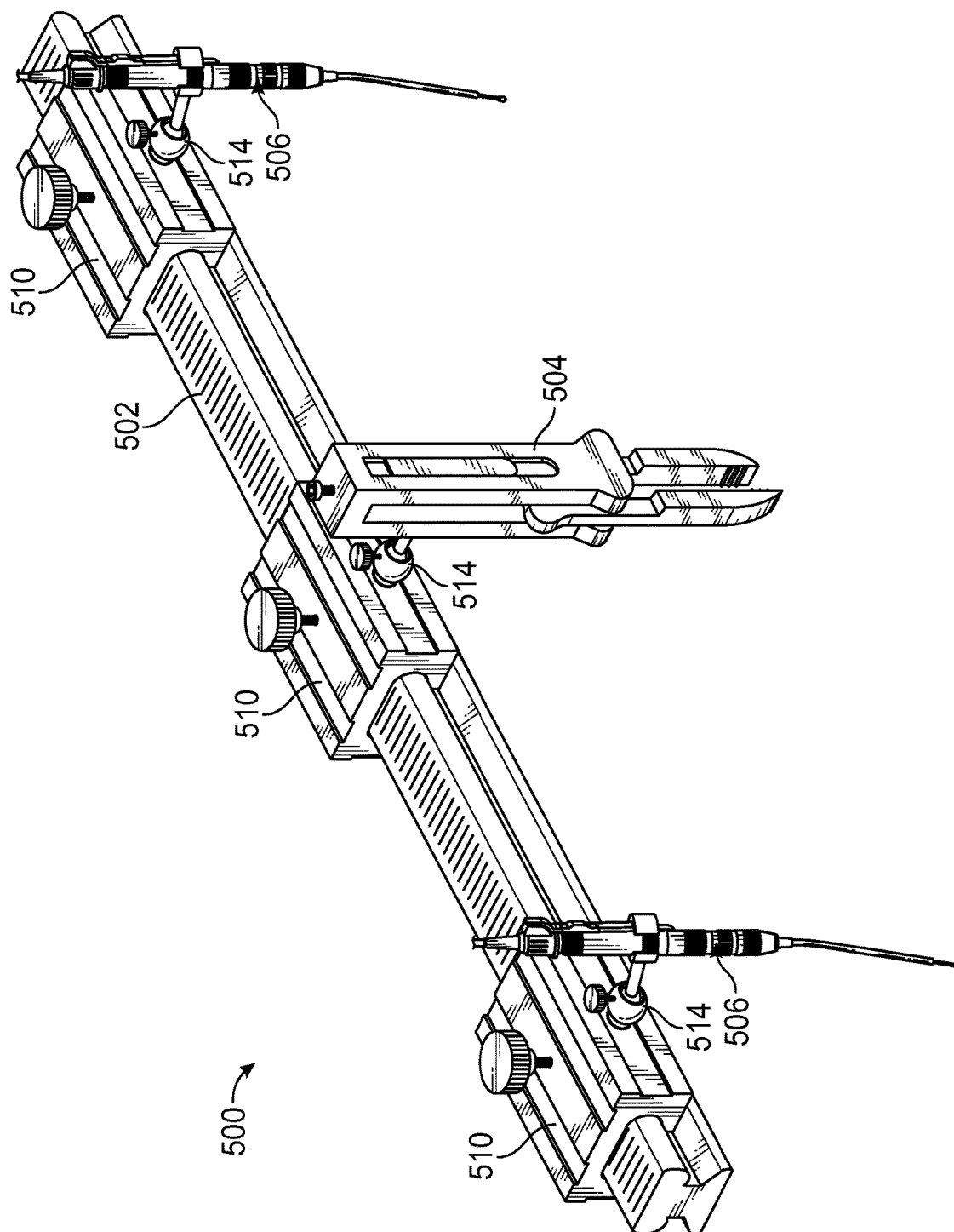

FIG. 17A

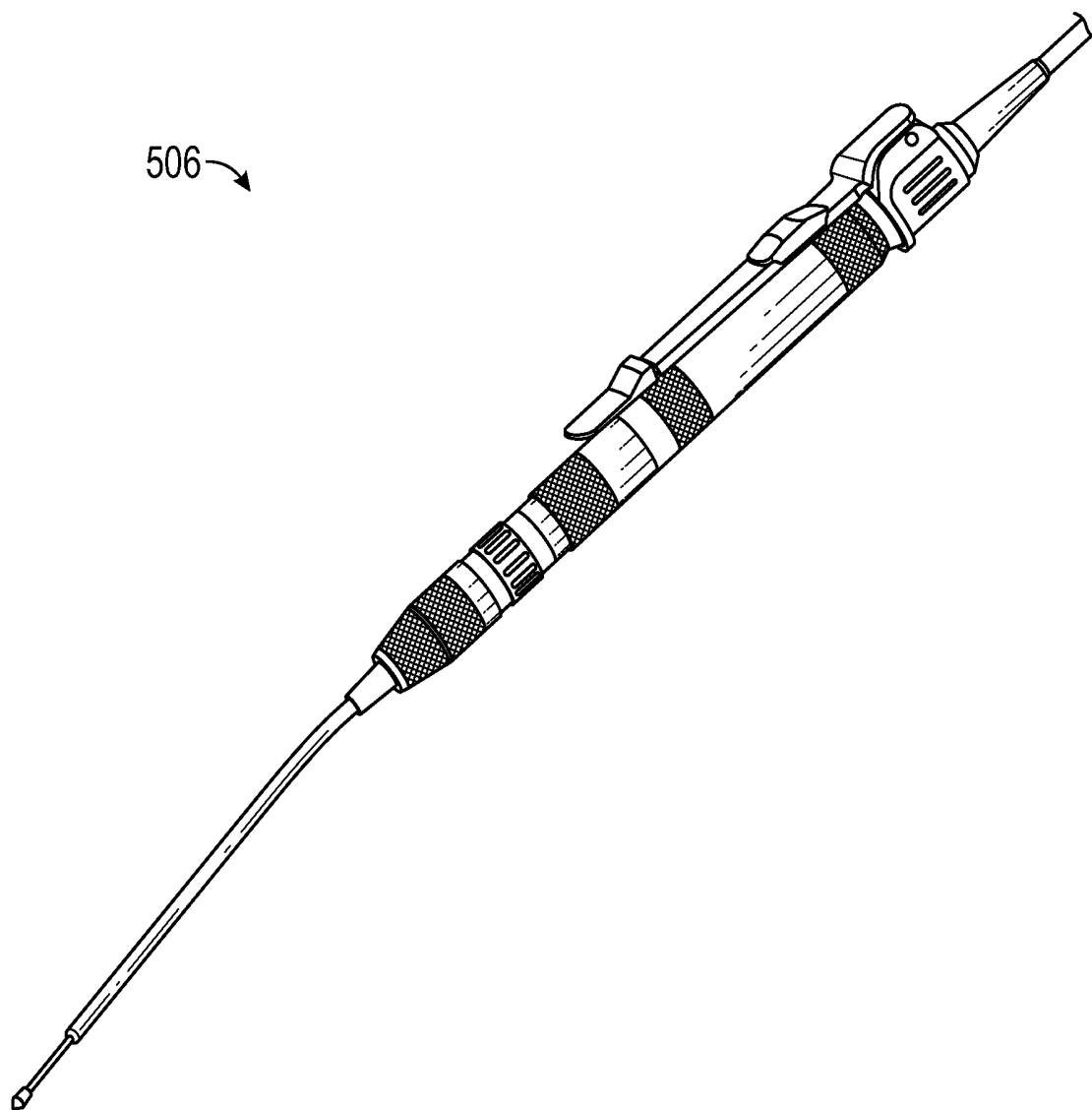

FIG. 17B

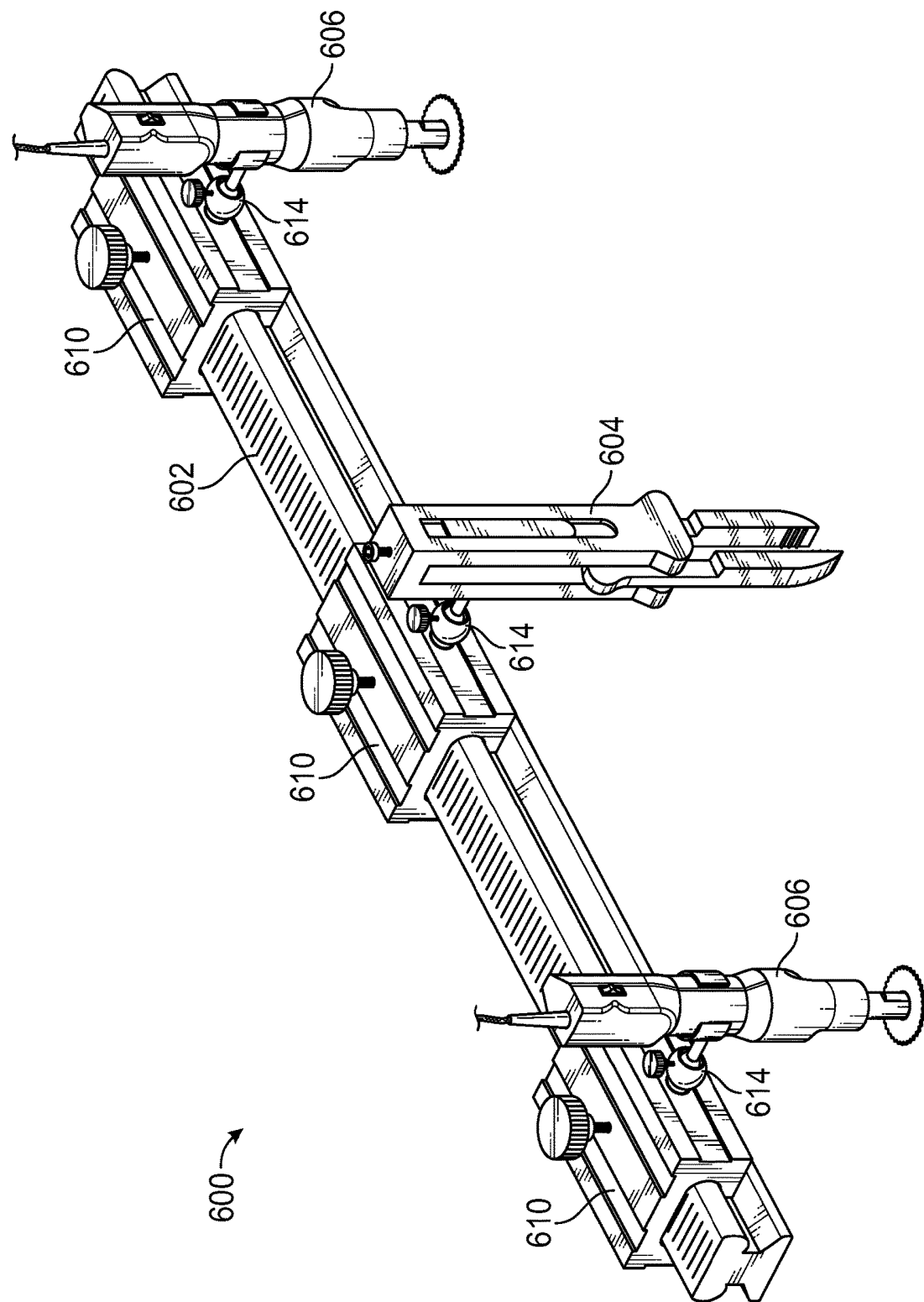

FIG. 18A

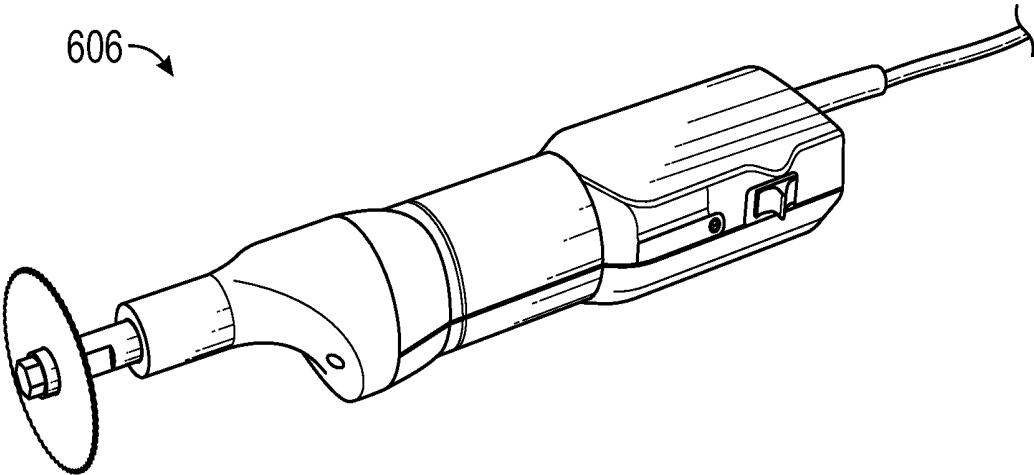

FIG. 18B

APPARATUS FOR INCISION AND REMOVAL OF OSSEOUS TISSUE AND METHODS THEREOF

FIELD

[0001] The present disclosure generally relates to medical apparatuses and devices, and in particular to surgical apparatuses configured for incision and extraction of osseous tissue that includes a clamp and bone cutting devices arranged along a fixed portion of the apparatus.

BACKGROUND

[0002] Various surgical procedures may involve the removal of osseous tissue, or bone. Such procedures may include, e.g., incisions along portions of the rib cage to gain access to the thoracic cavity, removal of bone tissue during knee surgery, or removal of portions of the skull or cutting of the skull during brain surgery. In most cases, precise and measurable cuts are required for each procedure. However, conventional devices typically employed for these procedures may lack precision and sufficient stabilization features, or have other drawbacks which may increase the likelihood of complications or concerns during surgery.

[0003] As one specific example, a laminectomy is a surgical procedure for removal of the vertebral arch, located in the cervical, thoracic, lumbar, and sacral regions of the spine. This procedure may be performed on patients with back pain due to compression along the spinal cord or nerves, which may be caused from various spine diseases, including (but not limited to) degenerative, infectious, neoplastic, traumatic, and congenital pathologies. Removal of the vertebral arch allows for decompression of the spinal canal, and gives the surgeon access to the contents of the spinal canal as needed. It is important when performing a laminectomy not to harm or tear the dura mater, which is a layer of tissue that surrounds and protects the spinal cord and nerve roots. A tear of the dura mater (fibrous sac containing the spinal cord, nerve roots, and spinal fluid) can result in cerebrospinal fluid leakage, which can potentially inhibit the body's healing process while also increasing the probability of an infection. With conventional surgical instruments used in this space, removal of the vertebral arch without causing a dural tear remains difficult. Further, such conventional instruments require an applied force to break through the vertebrae. This force is also generally unrestricted, thereby forfeiting the ability to control precision.

[0004] It is with these observations in mind, among others, that various aspects of the present disclosure were conceived and developed.

BRIEF DESCRIPTION OF THE DRAWINGS

[0005] Corresponding reference characters indicate corresponding elements among the view of the drawings. The headings used in the figures do not limit the scope of the claims.

[0006] FIG. 1 is a simplified block diagram of an apparatus for incision and extraction of osseous tissue, according to aspects of the present disclosure.

[0007] FIG. 2 is a perspective view of a first embodiment of an apparatus for incision and extraction of osseous tissue related to FIG. 1, according to aspects of the present disclosure.

[0008] FIG. 3 is a front view of the apparatus of FIG. 2, according to aspects of the present disclosure.

[0009] FIG. 4 is a rear view of apparatus of FIG. 2, according to aspects of the present disclosure.

[0010] FIG. 5 is a side view of the apparatus of FIG. 2, according to aspects of the present disclosure.

[0011] FIG. 6 illustrates possible movement of a plurality of bone cutting devices and a clamp of the apparatus of FIG. 2 relative to a fixed portion, according to aspects of the present disclosure.

[0012] FIGS. 7A-7D illustrate different sequences of a laminectomy procedure which relate to one possible non-limiting use of the apparatus of FIG. 2, according to aspects of the present disclosure.

[0013] FIG. 8 is a perspective view of a second embodiment of an apparatus for incision and extraction of osseous tissue related to FIG. 1, according to aspects of the present disclosure.

[0014] FIG. 9 is a front view of the apparatus of FIG. 8, according to aspects of the present disclosure.

[0015] FIG. 10 is a side view of the apparatus of FIG. 8, according to aspects of the present disclosure.

[0016] FIG. 11 is a top view of the apparatus of FIG. 8, according to aspects of the present disclosure.

[0017] FIG. 12 illustrates possible movement of a plurality of bone cutting devices and a clamp of the apparatus of FIG. 8 relative to a fixed portion, according to aspects of the present disclosure.

[0018] FIG. 13 is a perspective view of the apparatus of FIG. 8 with some of the bone cutting devices removed for illustrative purposes, according to aspects of the present disclosure.

[0019] FIG. 14 is a perspective view of a first embodiment of a bone cutting device, specifically, an osteotome for use with the apparatus of FIG. 2 or FIG. 8, according to aspects of the present disclosure.

[0020] FIG. 15 is another perspective view of the osteotome of FIG. 14 with some portions revealed to illustrate a cutting adjustment mechanism, according to aspects of the present disclosure.

[0021] FIG. 16 is a side view of the osteotome of FIG. 14 illustrating adjustment of cutting depth, according to aspects of the present disclosure.

[0022] FIG. 17A is a perspective view of a third embodiment of an apparatus for incision and extraction of osseous tissue including a second embodiment of a bone cutting device, according to aspects of the present disclosure.

[0023] FIG. 17B is a perspective view of the second embodiment of a bone cutting device of FIG. 17A, according to aspects of the present disclosure.

[0024] FIG. 18A is a perspective view of a fourth embodiment of an apparatus for incision and extraction of osseous tissue including a third embodiment of a bone cutting device, according to aspects of the present disclosure.

[0025] FIG. 18B is a perspective view of the third embodiment of a bone cutting device of FIG. 18A, according to aspects of the present disclosure.

DETAILED DESCRIPTION

[0026] Aspects of the present disclosure relate to an apparatus and related methods for incision and extraction of osseous tissue, which may also be referred to interchangeably herein as bone tissue. More specifically, an apparatus as described herein may include a fixed portion, a clamp

mechanically coupled to the fixed portion for gripping bone tissue during a surgical procedure, and one or more (e.g., a plurality of) bone cutting devices arranged around the clamp along the fixed portion for cutting osseous tissue.

[0027] In some embodiments, the clamp, and the plurality of bone cutting devices may be engaged to the fixed portion using linear and spherical joints so that the clamp and bone cutting devices may be oriented along different horizontal and vertical axes relative to the fixed portion. Referring to the drawings, embodiments of an apparatus for incision and extraction of osseous tissue are illustrated and generally indicated as 100, 200, and 300 in FIGS. 1-18.

[0028] Referring to FIG. 1, a first embodiment of an apparatus, designated 100, includes a fixed portion 102, a clamp 104 coupled to the fixed portion 102, and a plurality of bone cutting devices 106, illustrated as cutting device 106A and cutting device 106B, that are coupled to the fixed portion 102 and oriented around the clamp 104, such that the clamp 104 is positioned between the cutting device 106A and the cutting device 106B. It should be understood that a pair of bone cutting devices 106 is shown solely for demonstration purposes, and some embodiments may include one bone cutting device or more than two bone cutting devices as needed for specific applications.

[0029] In some embodiments, the fixed portion 102 may comprise an elongated member, a rod, a linear guide rail, or a frame. The fixed portion 102 may be generally oriented to extend horizontally over a bone such as a vertebra 108 of a patient, including a spinous process 110 and lamina 112, as shown. During use, the fixed portion 102 generally rests in a fixed, stationary position relative to the other components of the apparatus 100 and the target bone, as described herein.

[0030] As shown, the clamp 104 may be coupled in a generally central position along the fixed portion 102. The clamp 104 may include any form of clamping device or vise-like apparatus capable of engaging and gripping a target area of bone tissue, such as the spinous process 110. In some embodiments, the clamp 104 may be coupled to the fixed portion 102 using a spherical joint or hinge joint (not shown) so that clamp 104 may be oriented along different horizontal and vertical axes relative to the fixed portion 102 or be configured with multiple degrees of freedom. In some embodiments, the clamp 104 may also be in linear sliding engagement along the fixed portion 102 (not shown). In other embodiments, the clamp 104 may be coupled to the fixed portion 102 using a vertically aligned support member (not shown). Yet in other embodiments, the clamp 104 may be fixed in a stationary position relative to the fixed portion 102.

[0031] In some embodiments, the clamp 104 includes at least a pair of clamp legs 114 illustrated as a first clamp leg 114A and a second clamp leg 114B. The first clamp leg 114A and the second clamp leg 114B may be driven or moved together to bind or grip the spinous process 110 or other bone matter. Movement of the clamp legs 114 may be achieved by tightening a screw (not shown) in mechanical engagement with the clamp legs 114, or the clamp legs 114 may be spring loaded such that the clamp legs 114 are biased to a closed configuration, and may be driven to an open configuration by releasing the spring (not shown). Other suitable methods of moving the clamp legs 114 are contemplated and described herein. In other embodiments, a C-clamp may be implemented which is devoid of multiple legs and generally involves drawing a movable closing

member against a stationary member to hold an object in place. Other such clamps are contemplated by the present inventive disclosure.

[0032] The bone cutting devices 106 are configured and operable to cut bone tissue and may include at least one of a drill, an osteotome, a rongeur, a scalpel, a laser, an ultrasonic device, a chisel, a saw, or the like, capable of creating an incision through osseous tissue to accomplish this function. In some embodiments, the bone cutting devices 106 may be coupled to the fixed portion 102 using spherical joints or hinge joints (not shown), so that the bone cutting devices 106 may be oriented and maintained along different axes or be mechanically configured with multiple degrees of freedom. In some embodiments, the bone cutting devices 106 may also be in linear sliding engagement along the fixed portion 102 (not shown). In some embodiments, the bone cutting devices 106 are configured so that cutting depths can be controlled; i.e., the surgeon may carefully control the depth of any incision into the bone tissue. Dimensions of the bone cutting devices 106 may also vary with respect to length and width as needed.

[0033] The apparatus 100 may enable surgeons to remove bone tissue safely and more efficiently. As one example, a neurosurgeon may employ the apparatus 100 to quickly and safely perform a laminectomy. Specifically, once a target vertebra has been exposed and is available for access, the clamp 104 of the apparatus 100 may be engaged to the spinous process 110 by driving the clamp legs 114 together and gripping the spinous process 110.

[0034] The surgeon may also align the bone cutting devices 106 along portions of the vertebra, and accurately position the bone cutting devices 106 over the lamina 112 in the position and angle desired. The bone cutting devices 106 may then be employed to form bilateral, controlled longitudinal incisions or cuts in order to remove the lamina 112 and/or the spinous process 110 from the vertebra 108. In the case where the bone cutting devices 106 include osteotomes, any force on the lamina 112 generated by application of the osteotomes is transmitted to the clamp 104, thereby canceling the force generated on the lamina 112 from the operation of the osteotomes so that the apparatus 100 remains in a stationary position relative to the vertebra 108 during the procedure.

[0035] Once incisions formed by the bone cutting devices 106 are advanced to a predefined appropriate depth, the lamina 112 may naturally release from the vertebra 108 and can be removed as a single piece with the spinous process 110 still attached to the clamp 104. Using the apparatus 100 as described, the dura mater surrounding the vertebra 108 underneath the lamina 112 is unlikely to be cut and the laminectomy procedure is efficient and precise in its application. In this example, the laminectomy procedure may be completed within a time span of one to three minutes or less. The apparatus 100 may involve primarily inexpensive mechanical components as opposed to software or electro-mechanical components. Aspects of the apparatus 100 may be formed using surgical steel, although the present disclosure is not limited in this regard.

[0036] Referring to FIGS. 2-4, one embodiment of an apparatus, designated 200, includes a fixed portion 202, a clamp 204 coupled to a generally central position along the fixed portion 202, and a plurality of osteotomes 206, illustrated as osteotome 206A and osteotome 206B, that are coupled to the fixed portion 202 and oriented generally

adjacent to the clamp **204**, such that the clamp **204** is positioned between the osteotome **206A** and the osteotome **206B**. It should be understood that a pair of osteotomes **206** and a sole clamp **204** are shown solely for illustrating possible aspects of the present disclosure, and some embodiments may include a plurality of clamps, a sole osteotome, or more than two osteotomes as may be suitable for specific applications. The osteotomes **206** and clamp **204** are described in greater detail below, but the osteotomes **206** illustrate one possible implementation of bone cutting devices previously described in FIG. 1 that may be configured to form incisions within bone in order to accommodate removal of bone tissue, and the clamp **204** may be generally configured to grip other bone tissue during surgery.

[0037] In some embodiments, the fixed portion **202** comprises a substantially linear rail, and may be generally cuboidal in shape, i.e. define an elongated three-dimensional rectangle shape as shown (although cylindrical/rod shapes and other such shapes are contemplated in related embodiments). The fixed portion **202** may be generally configured to extend horizontally over a bone such as the vertebra **108** of a patient during a laminectomy, similar to the orientation of the fixed portion **102** of the apparatus **100** relative to the vertebra **108** shown in FIG. 1. The fixed portion **202** defines a first end **203A**, and a second end **203B** opposite the first end **203A**. In some embodiments, the fixed portion **202** defines a plurality of markers **208** arranged along the length of the fixed portion **202**. The plurality of markers **208** may define etchings, labels, indentations, or the like and may be associated with units of measurement to assist a surgeon with arranging the clamp **204** and the osteotomes **206** over predetermined positions along the fixed portion **202**, as further described herein.

[0038] In some embodiments, a plurality of carriages **210** may be mechanically coupled to the fixed portion **202** of the apparatus **200**. In the present embodiment shown, the plurality of carriages **210** may be illustrated as carriage **210A**, carriage **210B**, and carriage **210C**. In some embodiments, the carriage **210A** is positioned generally along the first end **203A**, the carriage **210C** is positioned generally along the second end **203B**, and the carriage **210B** is positioned between the carriage **210A** and the carriage **210C**. Each of the carriages **210** may be oriented in linear sliding engagement along the fixed portion **202**. Specifically, each of the carriages **210** may define a respective channel **211** extending through each of the carriages **210**, and the carriages **210** may be slidably mounted along the fixed portion **202** by inserting either the first end **203A** or the second end **203B** of the fixed portion **202** through the channels **211** of the carriages **210**. The plurality of carriages **210** may define linear bearings, slide casings, or linear/prismatic joints that are capable of linear sliding movement along the fixed portion **202**, as further described herein. In some embodiments, as shown, the fixed portion **202** may be formed with linear guides or rails, and the channels **211** may be formed of a shape that is suitable for receiving the linear guides in order to movably mount and maintain the carriages **210** along the guide rails of the fixed portion **202**, although the present disclosure is not limited in this regard.

[0039] In some embodiments, each of the carriages **210** may include a respective tightening knob **212** or other such locking mechanism for restricting linear movement of the carriages **210** along the fixed portion **202**. In other words, when the tightening knob **212** of the carriage **210A** is

engaged, the tightening knob **212** maintains the carriage **210A** in a locked or stationary position relative to the fixed portion **202**. Maintaining the carriages **210** in a locked or stationary position relative to the fixed portion **202** may be advantageous during surgery when various forces may be exerted upon the apparatus **200**, as further described herein.

[0040] As further shown, a plurality of spherical joints **214** may be mounted to or otherwise defined along the carriages **210**. In particular, as illustrated, a spherical joint **214A** may be included along the carriage **210A**, a spherical joint **214B** may be included along the carriage **210B**, and a spherical joint **214C** may be included along the carriage **210C**. The spherical joints **214** may define ball joints, ball bearings, spherical bearings, ball and socket joints, or the like.

[0041] Referring to FIG. 5, in some embodiments, each of the spherical joints **214** may include at least a housing body **216** defining a cavity **218**, with the housing body **216** mounted or otherwise defined along the carriage **210** of the apparatus **200**. The spherical joints **214** may further include a ball stud **220** defining a ball portion **222** in communication with a stem portion **224**. The ball portion **222** of the ball stud **220** may be rotatably engaged within the cavity **218** of the housing body **216** to accommodate angular rotation of the stem portion **224** relative to the housing body **216** and enable multiple degrees of freedom. Further, as shown, the stem portion **224** may be coupled to or mounted along an osteotome **206** (or the clamp **204** (not shown)). In this manner, the osteotome **206** may be oriented along different horizontal and vertical axes, and may be rotated relative to the fixed portion **202** by nature of the osteotome **206** being coupled to the spherical joint **214**.

[0042] In some embodiments as shown, the spherical joints **214** may include a tightening knob **226** or other like locking mechanism similar to the tightening knobs **212** for restricting movement of the ball stud **220** relative to the housing body **216**. In other words, when the tightening knob **226** of a spherical joint **214** is engaged, the tightening knob **226** maintains the ball stud **220** in a substantially locked or stationary position relative to the housing body **216** and restricts angular and rotational movement thereof. Maintaining the ball stud **220** in a locked or stationary position relative to the housing body **216** may be advantageous during surgery when various forces may be exerted upon the apparatus **200** and it is desired to maintain the osteotomes **206** (and/or the clamp **204**) in a stationary position.

[0043] Referring to FIG. 6, each of the clamp **204**, the osteotome **206A**, and the osteotome **206B**, when coupled to any one of the spherical joints **214**, may be configured with multiple degrees of freedom, i.e., may be oriented along different horizontal and vertical axes relative to the fixed portion **202**. In addition, by virtue of the spherical joints **214** being coupled to the carriages **210**, the linear positioning of each of the clamp **204**, the osteotome **206A**, and the osteotome **206B** along the fixed portion **202** may be adjusted by sliding the carriages **210** to different predetermined positions along the fixed portion **202** as desired. For example, as indicated by the horizontal arrows of FIG. 6, the carriage **210A** (and the osteotome **206A**) may be advanced along the fixed portion **202** towards the first end **203A** or the second end **203B** to a predetermined position (not shown) as desired, and the tightening knob **212** defined along the carriage **210A** may be actuated, tightened or otherwise engaged to lock the carriage **210A** or otherwise maintain the carriage **210A** in a substantially stationary configuration

along the predetermined position. In addition, with the spherical joint 214A defined along the carriage 210 as described, and the osteotome 206A being coupled to the spherical joint 214A, the osteotome 206A may be oriented along different horizontal and vertical axes relative to the fixed portion 202 (as illustrated by the curved arrows), independently of the osteotome 206B and the clamp 204. The clamp 204, when coupled to the spherical joint 214B and the carriage 210B, and the osteotome 206B, when coupled to the spherical joint 214C and the carriage 210C, are capable of the same or similar movement. Once the components of the apparatus 200 (the clamp 204, the osteotome 206A, and the osteotome 206B) are oriented as desired, the surgeon may engage the tightening knobs 212 and the tightening knobs 226 (not shown in FIG. 6) to temporarily maintain these orientations during a surgical procedure. This enhanced flexibility, maneuverability, and stability of the apparatus 200 components may allow a surgeon to more accurately align the apparatus 200 along a vertebra or other bone tissue and safely complete a cutting procedure.

[0044] As one non-limiting example, referring to FIGS. 7A-7D, a neurosurgeon may employ the apparatus 200 to efficiently and safely perform a laminectomy. As shown, the apparatus 200 as described above includes the fixed portion 202 (defining the plurality of markers 208) with a plurality of carriages 210, designated 210A, 210B, and 210C, in movable engagement along the fixed portion 202 between the first end 203A and the second end 203B. In addition, the plurality of spherical joints 214, designated spherical joint 214A, spherical joint 214B, and spherical joint 214C are defined along the carriages 210A, 210B, and 210C respectively. The osteotome 206A is coupled to the spherical joint 214A and the carriage 210A, the osteotome 206B is coupled to the spherical joint 214C and the carriage 210C, and the clamp 204 is coupled to the spherical joint 214B and the carriage 210B. As further shown, the clamp 204 may define a pair of clamp legs 230, designated clamp leg 230A, and 230B. Cutting lines 232A-232B are exclusively shown in FIGS. 7B and 7C and further described below. In addition, FIGS. 7A-7D indicate that the osteotome 206A may define a blade 234A, and the osteotome 206B may define a blade 234B. The apparatus 200 may be oriented over the vertebra 108, which defines a spinous process 110 and lamina 112.

[0045] Referring specifically to FIG. 7A, once a target vertebra 108 has been exposed and is available for access, the apparatus 200 may be oriented over the spinous process 110 of the vertebra 108 as shown. The clamp 204 of the apparatus 200 may be engaged to the spinous process 110 by driving the clamp leg 230A and the clamp leg 230B together to grip the spinous process 110, and temporarily couple the apparatus 200 to the vertebra 108.

[0046] Referring to FIG. 7B, using the carriages 210, the surgeon may align the osteotomes 206 as desired between the first end 203A and the second end 203B of the fixed portion 202. Using the spherical joints 214, the osteotomes 206 may also be aligned along predetermined portions of the vertebra 108, or cutting lines designated 232A and 232B. Specifically, the blade 234A of the osteotome 206A may be aligned along the cutting line 232A, and the blade 234B of the osteotome 206B may be aligned along the cutting line 232B. Referring to FIGS. 7B-7C, a force, designated F may be applied to the upper portions of the osteotomes 206 to drive the blade 234A of the osteotome 206A in a downwards direction, and to also drive the blade 234B of the osteotome

206B in a downwards direction as indicated to form bilateral, controlled longitudinal incisions or cuts in order to remove at least a portion of the lamina 112 and/or the spinous process 110 from the vertebra 108, as defined by the cutting lines 232A and 232B. Forces exerted upon the lamina 112 during cutting by the osteotomes 206 is transmitted to the clamp 204, thereby canceling forces on the lamina 112 so that the apparatus 200 safely remains in a stationary position relative to the vertebra 108 during the procedure.

[0047] Referring to FIGS. 7C-7D, once incisions formed by the osteotomes 206 are advanced to a predefined appropriate depth, at least a portion of the lamina 112 (defined by the cutting lines 232A and 232B shown in FIG. 7B) may naturally release from the vertebra 108 and can be removed as a single piece with the spinous process 110 still attached to the clamp 204 as shown. Using the apparatus 200 as described, the dura mater surrounding the vertebra 108 underneath the lamina 112 is unlikely to be cut and the laminectomy procedure is efficient and precise in its application. In this example, the laminectomy procedure may be completed within a time span of one to three minutes or less. The apparatus 200 may involve primarily inexpensive mechanical components as opposed to software or electro-mechanical components. Aspects of the apparatus 200 may be formed using surgical steel, or biocompatible polymers, although the present disclosure is not limited in this regard.

[0048] Referring to FIGS. 8-13, another embodiment of an apparatus, designated 300, for incision and extraction of osseous tissue generally includes a fixed portion 302, a clamp 304 in communication with the fixed portion 302, a plurality of bone cutting devices 306A defined along one side of the apparatus 300, and a plurality of bone cutting devices 306B defined along an opposite side of the apparatus 300 as shown, such that the clamp 304 is positioned between the plurality of bone cutting devices 306A and 306B. While a plurality of bone cutting devices 306A and 306B is illustrated, other embodiments may include a pair of bone cutting devices, i.e., a sole bone cutting device arranged along opposite sides of the apparatus 300.

[0049] As shown, the fixed portion 302 defines a generally central area of the apparatus 300, and is in direct communication with the clamp 304. In some embodiments, the fixed portion 302 includes a central rod 303 extending horizontally over the clamp 304. A plurality of arms 308 may be rotatably coupled to the central rod 303 of the fixed portion 302 by way of joints 310A. Joints 310A may be hinge joints, or revolute joints that provide single axis rotation of the arms 308 relative to the rod 303 of the fixed portion 302. In some embodiments, the fixed portion 302 may define a handle along the central rod 303 that may assist a surgeon to remove the apparatus 300 from a surgical area.

[0050] In addition, in some embodiments, the bone cutting devices 306A may be arranged along a lateral rod 312A, and the bone cutting devices 306B may be arranged along a lateral rod 312B. Specifically, the bone cutting devices 306A may be coupled to the lateral rod 312A by way of joints 314A, and the bone cutting devices 306B may be coupled to the lateral rod 312B by way of joints 314B. The joints 314, like the joints 310, may be hinge joints, or revolute joints that provide single axis rotation of the bone cutting devices 306 relative to the lateral rods 312A and 312B. As further shown, the arms 308 may connect the central rod 303 with the lateral rod 312A and the lateral rod 312B.

[0051] The bone cutting devices 306 of the apparatus 300 may include chisel tools as shown, which may be driven into bone tissue during e.g. a laminectomy or similar procedure; however the bone cutting devices 306 may also include osteotomes, scalpels, or other cutting tools. In some embodiments, the clamp 304 is spring-loaded such that arms (not shown) defined along the clamp 304 are biased to a closed position and may be temporarily engaged to an open position to grip bone tissue during procedures.

[0052] Referring to FIGS. 14-15, one embodiment of an osteotome 406, which may be identical to or similar to the osteotome 206, and may be used with the apparatus 200 or apparatus 300, is illustrated. The osteotome 406 is generally configured for driving a blade into bone tissue and making predetermined controlled cuts, and includes a mechanism for adjusting the depth of cuts formed by the blade using a stopper, as described herein. Specifically, the osteotome 406 includes a housing 408, and a blade 410 extending through opposite ends of the housing 408 such that the blade 410 is integrated into the housing 408. A cutting edge 412 may be defined along one end of the blade 410 and configured for making incisions into bone tissue, and a mallet end 414 may be defined along another end of the blade 410 opposite the cutting edge 412, and configured for receiving a blunt force of a mallet or other blunt object (not shown) for driving the blade 410 partially through the housing 408 and to within bone tissue.

[0053] In some embodiments, the osteotome 406 includes an adjustment mechanism 416 defined along the housing 408 for controlling the depth of cuts made using the blade 410. The adjustment mechanism 416 may include a self-locking worm gear 418 encapsulated within the housing 408 in which the gear 418 has been modified to have an internally threaded hole (not shown). The adjustment mechanism 416 may further include an externally threaded rod 420 passed through and configured to engage with the internally threaded hole of the self-locking worm gear 418. The externally threaded rod 420 may further be in communication with a stopper 422 as shown.

[0054] In addition, the adjustment mechanism 416 may include an adjustment knob 424. The adjustment knob 424 may be utilized to shift the externally threaded rod 420 back and forth through the self-locking worm gear 418 to predetermined positions in order to adjust the distance between the mallet end 414 and the stopper 422. Specifically, in some embodiments, rotation of the adjustment knob 424 may cause rotation of the self-locking worm gear 418 which may shift the externally threaded rod 420 (and the stopper 422) back and forth along the housing 408 relative to the self-locking worm gear 418. In some embodiments, a stopper surface 426 is defined along the mallet end 414 and configured to make contact with the stopper 422. Referring to FIG. 16, a cutting depth 430 associated with the osteotome 406, and defined by the distance between the stopper surface 426 and the stopper 422, may be modified by actuating the adjustment knob 424 to increase or decrease the distance between the stopper 422 and the stopper surface 426.

[0055] Referring to FIGS. 17A and 17B, a third embodiment of an apparatus, designated 500, may generally include a fixed portion 502 similar to the fixed portion 202, and a clamp 504 similar to the clamp 204 arranged along a generally central position associated with the fixed portion 502. A plurality of surgical drills 506 may be arranged around the clamp 504 along the fixed portion 202. As shown,

the clamp 504 and the surgical drills 506 may be coupled to the fixed portion 502 using spherical joints 514 and carriages 510 similar to the apparatus 200, so that the surgical drills 506 and the clamp 504 may be positioned along different vertical and horizontal axes relative to the fixed portion 502.

[0056] Referring to FIGS. 18A and 18B, a fourth embodiment of an apparatus, designated 600, may generally include a fixed portion 602 similar to the fixed portion 202, and a clamp 604 similar to the clamp 204 arranged along a generally central position associated with the fixed portion 602. A plurality of surgical saws 606 may be arranged around the clamp 604 along the fixed portion 602. As shown, the clamp 604 and the surgical saws 606 may be coupled to the fixed portion 602 using spherical joints 614 and carriages 610 similar to the apparatus 200, so that the surgical saws 606 and the clamp 604 may be positioned along different vertical and horizontal axes relative to the fixed portion 602.

[0057] Other embodiments and features not shown are contemplated by the present disclosure. For example, in some embodiments, the clamp 204 of apparatus 200 may be replaced with a spring-clamp which applies inward pressure to the spinous process 110 using a spring. Alternatively, the fixed portion 202 may be coupled to bone tissue by drilling one or more holes into the spinous process, and passing rods through the holes. In other embodiments, a crank, motor, or other precise advancing tool may be implemented to gradually and in a controlled fashion drive osteotome blades or other cutting tools into bone tissue.

[0058] It should be understood from the foregoing that, while particular embodiments have been illustrated and described, various modifications can be made thereto without departing from the spirit and scope of the invention as will be apparent to those skilled in the art. Such changes and modifications are within the scope and teachings of this invention as defined in the claims appended hereto.

What is claimed is:

1. An apparatus, comprising:

- a fixed portion;
- a plurality of carriages in linear sliding engagement along the fixed portion;
- a plurality of spherical joints, each of the plurality of spherical joints defined along a respective one of the plurality of carriages;
- a first bone cutting device coupled to a first spherical joint of the plurality of spherical joints;
- a second bone cutting device coupled to a second spherical joint of the plurality of spherical joints; and
- a clamp oriented along the fixed portion between the first bone cutting device and the second bone cutting device.

2. The apparatus of claim 1, further comprising:

- a first carriage of the plurality of carriages positioned along a first end of the fixed portion with the first spherical joint defined along the first carriage;
- a second carriage of the plurality of carriages positioned along a second end of the fixed portion with the second spherical joint defined along the second carriage; and
- a third carriage of the plurality of carriages positioned along the fixed portion between the first carriage and the second carriage, with a third spherical joint of the plurality of spherical joints defined along the third carriage.

3. The apparatus of claim 1, wherein the clamp, the first bone cutting device, and the second bone cutting device are each adjustable relative to the fixed portion along at least three degrees of freedom.

4. The apparatus of claim 1, wherein the first bone cutting device and the second bone cutting device each comprise at least one of a drill, an osteotome, a rongeur, a scalpel, an ultrasonic device, a chisel, or a saw.

5. The apparatus of claim 1, wherein the clamp comprises a spinous process clamp and defines a first clamp arm and a second clamp arm configured to grip a projection or lamina defined along a posterior portion of a vertebra.

6. The apparatus of claim 1, wherein the first bone cutting device comprises an osteotome, the osteotome including a blade defining a cutting edge and a mallet end defined along a housing.

7. The apparatus of claim 6, wherein the osteotome includes an adjustment mechanism for controlling a depth of cuts formed by the blade of the osteotome, comprising:

a worm gear defining an opening;

a rod oriented through the opening and in communication with a stopper; and

a knob in mechanical engagement with the worm gear, wherein the knob is configured to move the rod through the opening of the worm gear, thereby modifying a distance between the stopper and the mallet end.

8. The apparatus of claim 7, wherein modifying a distance between the stopper and the mallet end also modifies the depth of the cuts formed by the blade.

9. The apparatus of claim 7, wherein the mallet end defines a stopping surface oriented towards the stopper, and the stopper is configured to impact the stopping surface during use of the osteotome to control the depth of the cuts formed by the blade.

10. A method, comprising:

providing an apparatus defining a fixed portion, a first bone cutting device coupled to the fixed portion, a second bone cutting device coupled to the fixed portion, and a clamp coupled to the fixed portion between the first bone cutting device and the second bone cutting device,

wherein the clamp is configured to grip a first bone portion to maintain the fixed portion in a stationary position over the first bone portion, and

wherein the first bone cutting device and the second bone cutting device are configured to form cuts through a second bone portion.

11. The method of claim 10, further comprising:

engaging a lamina portion of a vertebra using the clamp; aligning the first bone cutting device and the second bone cutting device along predetermined locations of the vertebra around the lamina portion;

forming a plurality of incisions along the predetermined locations of the vertebra using the first bone cutting device and the second bone cutting device to release at least part of the lamina portion; and

removing the lamina portion from the vertebra by shifting the clamp engaged to the lamina portion away from the vertebra.

12. The method of claim 10, further comprising:

providing a carriage in slideable engagement along the fixed portion; and

coupling the first bone cutting device to the carriage, such that a position of the bone cutting device relative to the fixed portion may be adjusted by moving the carriage to a predetermined position along the fixed portion.

13. The method of claim 12, further comprising:

providing a spherical joint defined between the carriage and the first bone cutting device; and

coupling the first bone cutting device to the spherical joint, such that the first bone cutting device is configured for orientation along different vertical and horizontal axes relative to the fixed portion.

14. The method of claim 12, further comprising:

providing a locking knob defined along the carriage; and engaging the locking knob to maintain the carriage at the predetermined position along the fixed portion.

15. An apparatus, comprising

a fixed portion;

a first bone cutting device coupled to a first side of the fixed portion;

a second bone cutting device coupled to a second side of the fixed portion opposite the first side of the fixed portion; and

a clamp coupled to the fixed portion between the first bone cutting device and the second bone cutting device.

16. The apparatus of claim 15, further comprising:

a central rod defined along the fixed portion; and

a plurality of arms coupled to the central rod along revolute joints.

17. The apparatus of claim 16, further comprising:

wherein the first bone cutting device and the second bone cutting device are coupled to respective ones of the plurality of arms.

18. The apparatus of claim 16, further comprising:

an external rod coupled to the central rod by a first one of the plurality of arms; and

a plurality of cutting devices defined by the first bone cutting device, the plurality of cutting devices defined along the external rod.

19. The apparatus of claim 15, further comprising:

a carriage in linear sliding engagement along the fixed portion; and

a spherical joint defined along the carriage,

wherein the first bone cutting device is coupled to the spherical joint.

20. The apparatus of claim 15, further comprising:

wherein the first bone cutting device includes an osteotome with an adjustment mechanism configured to restrict cutting depths formed into bone.

* * * * *

专利名称(译)	用于切开和去除骨组织的设备及其方法		
公开(公告)号	US20200022710A1	公开(公告)日	2020-01-23
申请号	US16/481535	申请日	2018-01-31
申请(专利权)人(译)	卫生尊严		
当前申请(专利权)人(译)	卫生尊严		
[标]发明人	BOHL MICHAEL MOONEY MICHAEL VACA IRIDIAN SCHULTE RYAN SAMUEL BRUCE ANDREW ROBERT FLETCHER LEAH ELIZABETH LOPEZ JIMENEZ ARON ALAM FRAMARZ MARSHALL ETHAN REVEL IVANNA		
发明人	BOHL, MICHAEL MOONEY, MICHAEL VACA, IRIDIAN SCHULTE, RYAN SAMUEL BRUCE, ANDREW ROBERT FLETCHER, LEAH ELIZABETH LOPEZ-JIMENEZ, ARON ALAM, FRAMARZ MARSHALL, ETHAN REVEL, IVANNA		
IPC分类号	A61B17/17 A61B17/16 A61B17/15		
CPC分类号	A61B17/1604 A61B17/1757 A61B17/15 A61B17/1671 A61B17/1657 A61B17/58 A61B17/60 A61B17/66		
优先权	62/452413 2017-01-31 US		
外部链接	Espacenet USPTO		

摘要(译)

公开了一种用于提取骨组织的设备。该设备包括固定部分和沿着固定部分的大致中央区域定向的夹具。该设备包括第一骨切割装置和第二骨切割装置，该第一骨切割装置和第二骨切割装置联接至固定部分并围绕夹具定向。第一骨头切割装置和第二骨头切割装置使用各自的接头连接到固定部分，所述接头容纳第一骨头切割装置和第二骨头切割装置相对于固定部分沿着不同的水平和垂直轴的取向。夹具构造成在外科手术过程中接合第一骨部分。第一骨切割装置和第二骨切割装置构造成去除第二骨部分

