



US008348967B2

(12) **United States Patent**
Stulen

(10) **Patent No.:** **US 8,348,967 B2**
(45) **Date of Patent:** **Jan. 8, 2013**

(54) **ULTRASONIC SURGICAL INSTRUMENTS**

(75) Inventor: **Foster B. Stulen**, Mason, OH (US)

(73) Assignee: **Ethicon Endo-Surgery, Inc.**, Cincinnati, OH (US)

(*) Notice: Subject to any disclaimer, the term of this patent is extended or adjusted under 35 U.S.C. 154(b) by 654 days.

3,862,630 A	1/1975	Balamuth
3,900,823 A	8/1975	Sokal et al.
3,918,442 A	11/1975	Nikolaev et al.
3,946,738 A	3/1976	Newton et al.
3,955,859 A	5/1976	Stella et al.
3,956,826 A	5/1976	Perdreau, Jr.
4,156,187 A	5/1979	Murry et al.
4,188,927 A	2/1980	Harris
4,200,106 A	4/1980	Douvas et al.
4,306,570 A	12/1981	Matthews
4,445,063 A	4/1984	Smith

(Continued)

(21) Appl. No.: **11/881,636**

(22) Filed: **Jul. 27, 2007**

(65) **Prior Publication Data**

US 2009/0030438 A1 Jan. 29, 2009

(51) **Int. Cl.**
A61B 17/32 (2006.01)

(52) **U.S. Cl.** **606/169**

(58) **Field of Classification Search** 433/86,
433/119, 118, 120, 121, 165, 224; 604/22;
606/32, 39, 45, 159, 167, 169; 601/2-4
See application file for complete search history.

(56) **References Cited**

U.S. PATENT DOCUMENTS

2,704,333 A *	3/1955	Calosi et al.	310/26
2,736,960 A	3/1956	Armstrong	
2,849,788 A	9/1958	Creek	
RE25,033 E *	8/1961	Balamuth et al.	451/36
3,015,961 A	1/1962	Roney	
3,513,848 A	5/1970	Winston et al.	
3,526,219 A	9/1970	Balamuth	
3,614,484 A	10/1971	Shoh	
3,636,943 A	1/1972	Balamuth	
3,776,238 A	12/1973	Peyman et al.	
3,805,787 A	4/1974	Banko	
3,830,098 A	8/1974	Antonevich	
3,854,737 A	12/1974	Gilliam, Sr.	

FOREIGN PATENT DOCUMENTS

CN 1634601 A 7/2005
(Continued)

OTHER PUBLICATIONS

International Search Report for PCT/US2008/070983, Nov. 7, 2008
(5 pages).

(Continued)

Primary Examiner — Ryan Severson
Assistant Examiner — Ashley Cronin

(57) **ABSTRACT**

A surgical instrument includes a transducer configured to produce vibrations at a predetermined frequency. The transducer is configured to produce vibrations along a longitudinal axis at a predetermined frequency. An ultrasonic blade extends along the longitudinal axis and is coupled to the transducer. The ultrasonic blade includes a body having a proximal end and a distal end. The distal end is movable relative to the longitudinal axis by the vibrations produced by the transducer. The body includes a treatment region that extends from the proximal end to the distal end. The body includes a tapered concave surface which extends inwardly into the body defining a variety of shapes including a conical shape, a frusto-conical shape, or a partial spheroid.

31 Claims, 21 Drawing Sheets

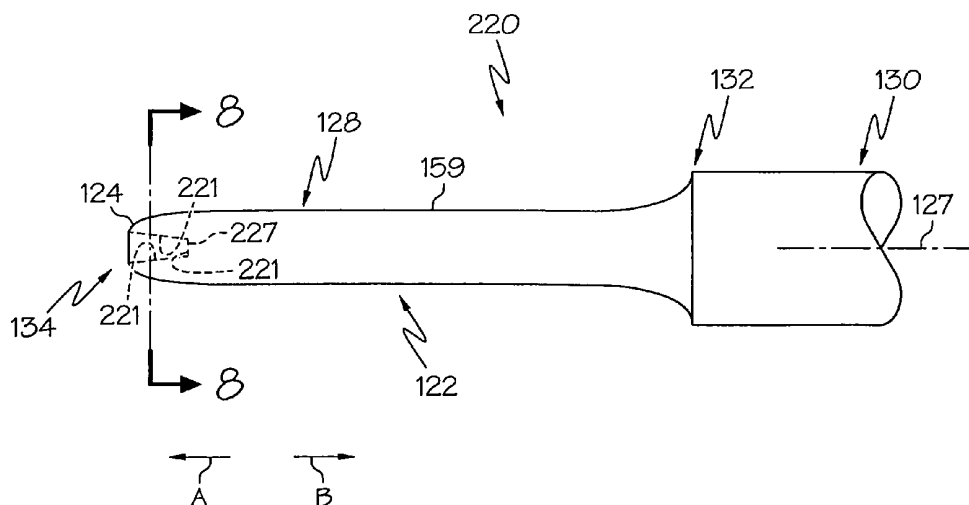

U.S. PATENT DOCUMENTS

4,491,132 A	1/1985	Aikins	5,730,752 A	3/1998	Alden et al.
4,574,615 A	3/1986	Bower et al.	5,733,074 A	3/1998	Stöck et al.
4,617,927 A	10/1986	Manes	5,741,226 A	4/1998	Strukel et al.
4,633,119 A	12/1986	Thompson	5,792,135 A	8/1998	Madhani et al.
4,634,420 A	1/1987	Spinosa et al.	5,810,859 A	9/1998	DiMatteo et al.
4,640,279 A	2/1987	Beard	5,817,084 A	10/1998	Jensen
4,649,919 A	3/1987	Thimsen et al.	5,827,323 A	10/1998	Klieman et al.
4,708,127 A	11/1987	Abdelghani	5,828,160 A	10/1998	Sugishita
4,712,722 A	12/1987	Hood et al.	5,836,897 A	11/1998	Sakurai et al.
4,827,911 A	5/1989	Broadwin et al.	5,843,109 A	12/1998	Mehta et al.
4,832,683 A	5/1989	Idemoto et al.	5,878,193 A	3/1999	Wang et al.
4,838,853 A	6/1989	Parisi	5,879,364 A	3/1999	Bromfield et al.
4,850,354 A	7/1989	McGurk-Burleson et al.	5,893,835 A	4/1999	Witt et al.
4,865,159 A	9/1989	Jamison	5,897,569 A	4/1999	Kellogg et al.
4,896,009 A	1/1990	Pawlowski	5,906,628 A	5/1999	Miyawaki et al.
4,903,696 A	2/1990	Stasz et al.	5,935,143 A	8/1999	Hood
4,922,902 A	5/1990	Wuchinich et al.	5,935,144 A	8/1999	Estabrook
4,965,532 A	10/1990	Sakurai	5,938,633 A	8/1999	Beaupre
4,979,952 A	12/1990	Kubota et al.	5,944,718 A	8/1999	Austin et al.
4,981,756 A	1/1991	Rhandhawa	5,944,737 A	8/1999	Tsonton et al.
5,026,387 A	6/1991	Thomas	5,954,736 A	9/1999	Bishop et al.
5,112,300 A	5/1992	Ureche	5,954,746 A	9/1999	Holthaus et al.
5,123,903 A	6/1992	Quaid et al.	5,957,882 A	9/1999	Nita et al.
5,126,618 A	6/1992	Takahashi et al.	5,957,943 A	9/1999	Vaitekunas
5,162,044 A	11/1992	Gahn et al.	5,968,007 A	10/1999	Simon et al.
5,167,725 A	12/1992	Clark et al.	5,968,060 A	10/1999	Kellogg
D332,660 S	1/1993	Rawson et al.	D416,089 S	11/1999	Barton et al.
5,176,695 A	1/1993	Dulebohn	5,980,510 A	11/1999	Tsonton et al.
5,184,605 A	2/1993	Grezeszykowski	5,989,274 A	11/1999	Davison et al.
5,213,569 A	5/1993	Davis	5,989,275 A	11/1999	Estabrook et al.
5,221,282 A	6/1993	Wuchinich	5,993,972 A	11/1999	Reich et al.
5,226,909 A	7/1993	Evans et al.	6,024,741 A	2/2000	Williamson, IV et al.
5,226,910 A	7/1993	Kajiyama et al.	6,033,375 A	3/2000	Brumbach
5,241,236 A	8/1993	Sasaki et al.	6,051,010 A	4/2000	DiMatteo et al.
5,257,988 A	11/1993	L'Esperance, Jr.	6,056,735 A	5/2000	Okada et al.
5,261,922 A	11/1993	Hood	6,063,098 A	5/2000	Houser et al.
5,263,957 A	11/1993	Davison	6,066,132 A	5/2000	Chen et al.
5,275,609 A	1/1994	Pingleton et al.	6,068,647 A	5/2000	Witt et al.
5,282,800 A	2/1994	Foshee et al.	6,077,285 A	6/2000	Boukhny
5,304,115 A	4/1994	Pflueger et al.	6,083,191 A	7/2000	Rose
D347,474 S	5/1994	Olson	6,086,584 A	7/2000	Miller
5,322,055 A	6/1994	Davison et al.	6,090,120 A	7/2000	Wright et al.
5,324,299 A	6/1994	Davison et al.	6,109,500 A	8/2000	Alli et al.
5,344,420 A	9/1994	Hilal et al.	6,110,127 A	8/2000	Suzuki
5,346,502 A	9/1994	Estabrook et al.	6,113,594 A	9/2000	Savage
5,357,423 A	10/1994	Weaver et al.	6,129,735 A	10/2000	Okada et al.
5,366,466 A	11/1994	Christian et al.	6,132,368 A	10/2000	Cooper
D354,564 S	1/1995	Medema	6,139,320 A	10/2000	Hahn
5,381,067 A	1/1995	Greenstein et al.	6,142,615 A	11/2000	Qiu et al.
5,403,312 A	4/1995	Yates et al.	6,152,902 A	11/2000	Christian et al.
5,411,481 A	5/1995	Allen et al.	6,159,160 A	12/2000	Hsei et al.
5,419,761 A	5/1995	Narayanan et al.	6,159,175 A	12/2000	Strukel et al.
5,421,829 A	6/1995	Olichney et al.	6,204,592 B1	3/2001	Hur
5,438,997 A	8/1995	Sieben et al.	6,206,844 B1	3/2001	Reichel et al.
5,449,370 A	9/1995	Vaitekunas	6,210,403 B1	4/2001	Klicek
5,471,988 A	12/1995	Fujio et al.	6,214,023 B1	4/2001	Whipple et al.
5,483,501 A	1/1996	Park et al.	6,231,565 B1	5/2001	Tovey et al.
5,486,162 A	1/1996	Brumbach	6,233,476 B1	5/2001	Strommer et al.
5,500,216 A	3/1996	Julian et al.	6,238,366 B1	5/2001	Savage et al.
5,501,654 A	3/1996	Failla et al.	6,252,110 B1	6/2001	Uemura et al.
5,505,693 A	4/1996	Mackool	D444,365 S	7/2001	Bass et al.
5,527,331 A	6/1996	Kresch et al.	6,254,623 B1	7/2001	Haibel, Jr. et al.
5,562,609 A	10/1996	Brumbach	6,258,034 B1	7/2001	Hanafy
5,562,610 A	10/1996	Brumbach	6,267,761 B1	7/2001	Ryan
5,601,601 A	2/1997	Tal et al.	6,270,831 B2	8/2001	Kumar et al.
5,603,773 A	2/1997	Campbell	6,273,852 B1	8/2001	Lehe et al.
5,607,436 A	3/1997	Pratt et al.	6,274,963 B1	8/2001	Estabrook et al.
5,618,492 A	4/1997	Auten et al.	6,277,115 B1	8/2001	Saadat
5,628,760 A	5/1997	Knoepfler	6,278,218 B1	8/2001	Madan et al.
5,630,420 A	5/1997	Vaitekunas	6,283,981 B1	9/2001	Beaupre
D381,077 S	7/1997	Hunt	6,309,400 B2	10/2001	Beaupre
5,651,780 A	7/1997	Jackson et al.	6,319,221 B1	11/2001	Savage et al.
5,653,713 A	8/1997	Michelson	6,325,811 B1	12/2001	Messery
5,669,922 A	9/1997	Hood	6,328,751 B1	12/2001	Beaupre
5,674,235 A	10/1997	Parisi	6,340,352 B1	1/2002	Okada et al.
5,690,269 A	11/1997	Bolanos et al.	6,352,532 B1	3/2002	Kramer et al.
5,694,936 A	12/1997	Fujimoto et al.	6,364,888 B1	4/2002	Niemeyer et al.
5,713,896 A	2/1998	Nardella	6,379,320 B1	4/2002	Lafon et al.
			D457,958 S	5/2002	Dycus et al.

6,383,194	B1	5/2002	Pothula	7,041,088	B2	5/2006	Nawrocki et al.
6,387,109	B1	5/2002	Davison et al.	7,041,102	B2	5/2006	Truckai et al.
6,388,657	B1	5/2002	Natoli	7,070,597	B2	7/2006	Truckai et al.
6,391,042	B1 *	5/2002	Cimino 606/169	7,074,219	B2	7/2006	Levine et al.
6,405,733	B1	6/2002	Fogarty et al.	7,077,039	B2	7/2006	Gass et al.
6,416,486	B1	7/2002	Wampler	7,077,853	B2	7/2006	Kramer et al.
6,423,073	B2	7/2002	Bowman	7,083,619	B2	8/2006	Truckai et al.
6,423,082	B1	7/2002	Houser et al.	7,087,054	B2	8/2006	Truckai et al.
6,428,539	B1	8/2002	Baxter et al.	7,101,378	B2	9/2006	Salameh et al.
6,432,118	B1	8/2002	Messerly	7,108,695	B2	9/2006	Witt et al.
6,436,114	B1	8/2002	Novak et al.	7,112,201	B2	9/2006	Truckai et al.
6,436,115	B1	8/2002	Beaupre	7,118,564	B2	10/2006	Ritchie et al.
6,443,969	B1	9/2002	Novak et al.	7,124,932	B2	10/2006	Isaacson et al.
6,454,781	B1	9/2002	Witt et al.	7,125,409	B2	10/2006	Truckai et al.
6,454,782	B1	9/2002	Schwemberger	7,135,018	B2	11/2006	Ryan et al.
6,458,142	B1	10/2002	Faller et al.	7,135,030	B2	11/2006	Schwemberger et al.
6,480,796	B2	11/2002	Wiener	7,153,315	B2	12/2006	Miller
6,485,490	B2	11/2002	Wampler et al.	D536,093	S	1/2007	Nakajima et al.
6,491,708	B2	12/2002	Madan et al.	7,156,189	B1	1/2007	Bar-Cohen et al.
6,497,715	B2	12/2002	Satou	7,156,853	B2	1/2007	Muratsu
6,500,176	B1	12/2002	Truckai et al.	7,157,058	B2	1/2007	Marhasin et al.
6,500,188	B2	12/2002	Harper et al.	7,159,750	B2	1/2007	Racenet et al.
6,524,316	B1	2/2003	Nicholson et al.	7,163,548	B2	1/2007	Stulen et al.
6,527,736	B1	3/2003	Attinger et al.	7,169,146	B2	1/2007	Truckai et al.
6,533,784	B2	3/2003	Truckai et al.	7,179,271	B2	2/2007	Friedman et al.
6,537,291	B2	3/2003	Friedman et al.	7,186,253	B2	3/2007	Truckai et al.
6,543,452	B1	4/2003	Lavigne	7,189,233	B2	3/2007	Truckai et al.
6,543,456	B1	4/2003	Freeman	7,204,820	B2 *	4/2007	Akahoshi 604/22
6,544,260	B1	4/2003	Markel et al.	7,220,951	B2	5/2007	Truckai et al.
6,561,983	B2	5/2003	Cronin et al.	7,223,229	B2	5/2007	Inman et al.
6,572,632	B2	6/2003	Zisterer et al.	7,229,455	B2	6/2007	Sakurai et al.
6,575,969	B1	6/2003	Rittman, III et al.	7,273,483	B2	9/2007	Wiener et al.
6,582,451	B1	6/2003	Marucci et al.	7,309,849	B2	12/2007	Truckai et al.
6,589,200	B1	7/2003	Schwemberger et al.	7,311,709	B2	12/2007	Truckai et al.
6,589,239	B2	7/2003	Khandkar et al.	7,317,955	B2	1/2008	McGreevy
6,616,450	B2	9/2003	Mossle et al.	7,326,236	B2	2/2008	Andreas et al.
6,623,501	B2	9/2003	Heller et al.	7,331,410	B2	2/2008	Yong et al.
6,626,926	B2	9/2003	Friedman et al.	7,353,068	B2	4/2008	Tanaka et al.
6,633,234	B2	10/2003	Wiener et al.	7,354,440	B2	4/2008	Truckai et al.
6,656,177	B2	12/2003	Truckai et al.	7,380,695	B2	6/2008	Doll et al.
6,662,127	B2	12/2003	Wiener et al.	7,380,696	B2	6/2008	Shelton, IV et al.
6,663,941	B2	12/2003	Brown et al.	7,381,209	B2	6/2008	Truckai et al.
6,669,690	B1	12/2003	Okada et al.	7,390,317	B2	6/2008	Taylor et al.
6,676,660	B2	1/2004	Wampler et al.	7,404,508	B2	7/2008	Smith et al.
6,678,621	B2	1/2004	Wiener et al.	7,408,288	B2	8/2008	Hara
6,679,899	B2	1/2004	Wiener et al.	D576,725	S	9/2008	Shumer et al.
6,682,544	B2	1/2004	Mastri et al.	D578,643	S	10/2008	Shumer et al.
6,689,146	B1	2/2004	Himes	D578,644	S	10/2008	Shumer et al.
6,716,215	B1	4/2004	David et al.	D578,645	S	10/2008	Shumer et al.
6,731,047	B2	5/2004	Kauf et al.	7,431,704	B2	10/2008	Babaev
6,733,506	B1	5/2004	McDevitt et al.	7,455,208	B2	11/2008	Wales et al.
6,762,535	B2	7/2004	Take et al.	7,472,815	B2	1/2009	Shelton, IV et al.
6,770,072	B1	8/2004	Truckai et al.	7,479,148	B2	1/2009	Beaupre
6,773,444	B2	8/2004	Messerly	7,479,160	B2	1/2009	Branch et al.
6,783,524	B2	8/2004	Anderson et al.	7,494,468	B2	2/2009	Rabiner et al.
6,786,382	B1	9/2004	Hoffman	7,503,893	B2	3/2009	Kucklick
6,786,383	B2	9/2004	Stegelmann	7,506,790	B2	3/2009	Shelton, IV
6,790,216	B1	9/2004	Ishikawa	7,524,320	B2	4/2009	Tierney et al.
6,802,843	B2	10/2004	Truckai et al.	7,534,243	B1	5/2009	Chin et al.
6,828,712	B2	12/2004	Battaglin et al.	D594,983	S	6/2009	Price et al.
6,869,439	B2	3/2005	White et al.	7,549,564	B2	6/2009	Boudreaux
6,875,220	B2	4/2005	Du et al.	7,559,450	B2	7/2009	Wales et al.
6,905,497	B2	6/2005	Truckai et al.	7,567,012	B2	7/2009	Namikawa
6,908,472	B2	6/2005	Wiener et al.	7,654,431	B2	2/2010	Hueil et al.
6,913,579	B2	7/2005	Truckai et al.	7,674,263	B2	3/2010	Ryan
6,926,716	B2	8/2005	Baker et al.	7,691,098	B2	4/2010	Wallace et al.
6,929,632	B2	8/2005	Nita et al.	7,713,202	B2	5/2010	Boukhny et al.
6,929,644	B2	8/2005	Truckai et al.	7,714,481	B2	5/2010	Sakai
D509,589	S	9/2005	Wells	D618,797	S	6/2010	Price et al.
6,942,677	B2	9/2005	Nita et al.	7,751,115	B2	7/2010	Song
6,945,981	B2	9/2005	Donofrio et al.	7,770,774	B2	8/2010	Mastri et al.
D511,145	S	11/2005	Donofrio et al.	7,780,054	B2	8/2010	Wales
6,976,844	B2 *	12/2005	Hickok et al. 433/224	7,780,659	B2	8/2010	Okada et al.
6,976,969	B2	12/2005	Messerly	7,784,662	B2	8/2010	Wales et al.
6,977,495	B2	12/2005	Donofrio	7,798,386	B2	9/2010	Schall et al.
6,984,220	B2	1/2006	Wuchinich	7,806,891	B2	10/2010	Nowlin et al.
7,011,657	B2	3/2006	Truckai et al.	7,824,401	B2	11/2010	Manzo et al.
7,033,357	B2	4/2006	Baxter et al.	7,854,735	B2	12/2010	Houser et al.
7,041,083	B2	5/2006	Chu et al.	D631,155	S	1/2011	Peine et al.

7,876,030 B2	1/2011	Taki et al.	2008/0058845 A1	3/2008	Shimizu et al.
D631,965 S	2/2011	Price et al.	2008/0082039 A1	4/2008	Babaev
7,892,606 B2	2/2011	Thies et al.	2008/0082098 A1	4/2008	Tanaka et al.
7,905,881 B2	3/2011	Masuda et al.	2008/0172051 A1	7/2008	Masuda et al.
7,959,050 B2	6/2011	Smith et al.	2008/0177268 A1	7/2008	Daum et al.
7,959,626 B2	6/2011	Hong et al.	2008/0188878 A1	8/2008	Young
7,976,544 B2	7/2011	McClurken et al.	2008/0200940 A1	8/2008	Eichmann et al.
8,038,693 B2	10/2011	Allen	2008/0208231 A1	8/2008	Ota et al.
8,061,014 B2	11/2011	Smith et al.	2008/0234708 A1	9/2008	Houser et al.
8,089,197 B2	1/2012	Rinner et al.	2008/0234709 A1	9/2008	Houser
8,177,800 B2	5/2012	Spitz et al.	2008/0234710 A1	9/2008	Neurohr et al.
D661,801 S	6/2012	Price et al.	2008/0234711 A1	9/2008	Houser et al.
D661,802 S	6/2012	Price et al.	2008/0243106 A1	10/2008	Coe et al.
D661,803 S	6/2012	Price et al.	2008/0245371 A1	10/2008	Gruber
D661,804 S	6/2012	Price et al.	2008/0249553 A1	10/2008	Gruber et al.
2001/0025184 A1	9/2001	Messerly	2008/0262490 A1	10/2008	Williams
2001/0031950 A1	10/2001	Ryan	2008/0281200 A1	11/2008	Voic et al.
2001/0039419 A1	11/2001	Francischelli et al.	2008/0287948 A1	11/2008	Newton et al.
2002/0002377 A1	1/2002	Cimino	2009/0030311 A1	1/2009	Stulen et al.
2002/0019649 A1	2/2002	Sikora et al.	2009/0030351 A1	1/2009	Wiener et al.
2002/0022836 A1	2/2002	Goble et al.	2009/0030437 A1	1/2009	Houser et al.
2002/0077550 A1	6/2002	Rabiner et al.	2009/0030439 A1	1/2009	Stulen
2002/0156493 A1	10/2002	Houser et al.	2009/0036911 A1	2/2009	Stulen
2003/0055443 A1	3/2003	Spotnitz	2009/0036912 A1	2/2009	Wiener et al.
2003/0204199 A1	10/2003	Novak et al.	2009/0036913 A1	2/2009	Wiener et al.
2003/0212332 A1	11/2003	Fenton et al.	2009/0036914 A1	2/2009	Houser
2003/0212422 A1	11/2003	Fenton et al.	2009/0054886 A1	2/2009	Yachi et al.
2004/0030254 A1	2/2004	Babaev	2009/0054894 A1	2/2009	Yachi
2004/0047485 A1	3/2004	Sherrit et al.	2009/0076506 A1	3/2009	Baker
2004/0092921 A1	5/2004	Kadziauskas et al.	2009/0082716 A1	3/2009	Akahoshi
2004/0097919 A1	5/2004	Wellman et al.	2009/0105750 A1	4/2009	Price et al.
2004/0097996 A1 *	5/2004	Rabiner et al. 606/159	2009/0118802 A1	5/2009	Mioduski et al.
2004/0199193 A1	10/2004	Hayashi et al.	2009/0138006 A1	5/2009	Bales et al.
2004/0204728 A1	10/2004	Haefner	2009/0143795 A1	6/2009	Robertson
2004/0243157 A1	12/2004	Connor et al.	2009/0143796 A1	6/2009	Stulen et al.
2004/0260300 A1	12/2004	Gorensek et al.	2009/0143797 A1	6/2009	Smith et al.
2005/0033337 A1	2/2005	Muir et al.	2009/0143798 A1	6/2009	Smith et al.
2005/0049546 A1	3/2005	Messerly et al.	2009/0143799 A1	6/2009	Smith et al.
2005/0143769 A1	6/2005	White et al.	2009/0143800 A1	6/2009	Deville et al.
2005/0149108 A1	7/2005	Cox	2009/0143801 A1	6/2009	Deville et al.
2005/0165345 A1	7/2005	Laufer et al.	2009/0143802 A1	6/2009	Deville et al.
2005/0177184 A1	8/2005	Easley	2009/0143803 A1	6/2009	Palmer et al.
2005/0192610 A1	9/2005	Houser et al.	2009/0143804 A1	6/2009	Palmer et al.
2005/0209620 A1	9/2005	Du et al.	2009/0143805 A1	6/2009	Palmer et al.
2005/0261581 A1	11/2005	Hughes et al.	2009/0143806 A1	6/2009	Witt et al.
2005/0261588 A1	11/2005	Makin et al.	2009/0270853 A1	10/2009	Yachi et al.
2005/0288659 A1	12/2005	Kimura et al.	2009/0318945 A1	12/2009	Yoshimine et al.
2006/0030797 A1	2/2006	Zhou et al.	2009/0327715 A1	12/2009	Smith et al.
2006/0063130 A1	3/2006	Hayman et al.	2010/0004668 A1	1/2010	Smith et al.
2006/0079878 A1	4/2006	Houser	2010/0004669 A1	1/2010	Smith et al.
2006/0084963 A1	4/2006	Messerly	2010/0016785 A1	1/2010	Takuma
2006/0190034 A1	8/2006	Nishizawa et al.	2010/0030248 A1	2/2010	Palmer et al.
2006/0211943 A1 *	9/2006	Beaupre 600/471	2010/0036370 A1	2/2010	Mirel et al.
2006/0235306 A1	10/2006	Cotter et al.	2010/0036405 A1	2/2010	Giordano et al.
2006/0253050 A1	11/2006	Yoshimine et al.	2010/0069940 A1	3/2010	Miller et al.
2007/0016235 A1	1/2007	Tanaka et al.	2010/0158307 A1	6/2010	Kubota et al.
2007/0016236 A1	1/2007	Beaupre	2010/0179577 A1	7/2010	Houser
2007/0055228 A1	3/2007	Berg et al.	2010/0187283 A1	7/2010	Crainich et al.
2007/0060915 A1	3/2007	Kucklick	2010/0298743 A1	11/2010	Nield et al.
2007/0060935 A1	3/2007	Schwardt et al.	2010/0298851 A1	11/2010	Nield
2007/0063618 A1	3/2007	Bromfield	2010/0331869 A1	12/2010	Voegele et al.
2007/0129716 A1	6/2007	Daw et al.	2010/0331870 A1	12/2010	Wan et al.
2007/0130771 A1	6/2007	Ehlert et al.	2010/0331871 A1	12/2010	Nield et al.
2007/0131034 A1	6/2007	Ehlert et al.	2010/0331872 A1	12/2010	Houser et al.
2007/0149881 A1	6/2007	Rabin	2011/0009850 A1	1/2011	Main et al.
2007/0162050 A1	7/2007	Sartor	2011/0015627 A1	1/2011	DiNardo et al.
2007/0173872 A1	7/2007	Neuenfeldt	2011/0015631 A1	1/2011	Wiener et al.
2007/0185380 A1	8/2007	Kucklick	2011/0015660 A1	1/2011	Wiener et al.
2007/0219481 A1 *	9/2007	Babaev 604/22	2011/0082486 A1	4/2011	Messerly et al.
2007/0239028 A1	10/2007	Houser et al.	2011/0087212 A1	4/2011	Aldridge et al.
2007/0249941 A1	10/2007	Salehi et al.	2011/0087213 A1	4/2011	Messerly et al.
2007/0260234 A1	11/2007	McCullagh et al.	2011/0087214 A1	4/2011	Giordano et al.
2007/0265560 A1	11/2007	Soltani et al.	2011/0087215 A1	4/2011	Aldridge et al.
2007/0275348 A1	11/2007	Lemon	2011/0087216 A1	4/2011	Aldridge et al.
2007/0282335 A1	12/2007	Young et al.	2011/0087217 A1	4/2011	Yates et al.
2007/0287933 A1	12/2007	Phan et al.	2011/0087218 A1	4/2011	Boudreaux et al.
2008/0009848 A1	1/2008	Paraschiv et al.	2011/0087256 A1	4/2011	Wiener et al.
2008/0058585 A1	3/2008	Novak et al.	2011/0125175 A1	5/2011	Stulen et al.
2008/0058775 A1	3/2008	Darian et al.	2011/0196286 A1	8/2011	Robertson et al.

2011/0196287	A1	8/2011	Robertson et al.
2011/0196398	A1	8/2011	Robertson et al.
2011/0196399	A1	8/2011	Robertson et al.
2011/0196400	A1	8/2011	Robertson et al.
2011/0196401	A1	8/2011	Robertson et al.
2011/0196402	A1	8/2011	Robertson et al.
2011/0196403	A1	8/2011	Robertson et al.
2011/0196404	A1	8/2011	Dietz et al.
2011/0196405	A1	8/2011	Dietz
2011/0288452	A1	11/2011	Houser et al.
2012/0029546	A1	2/2012	Robertson
2012/0059289	A1	3/2012	Nield et al.
2012/0078139	A1	3/2012	Aldridge et al.
2012/0078247	A1	3/2012	Worrell et al.
2012/0083783	A1	4/2012	Davison et al.
2012/0083784	A1	4/2012	Davison et al.
2012/0123458	A1	5/2012	Giordano et al.
2012/0184946	A1	7/2012	Price et al.

FOREIGN PATENT DOCUMENTS

CN	1640365	A	7/2005
CN	1694649	A	11/2005
CN	1922563	A	2/2007
CN	101040799	A	9/2007
EP	0171967	A2	2/1986
EP	0443256	A1	8/1991
EP	0456470	A1	11/1991
EP	0482195	B1	4/1992
EP	0482195	B1	1/1996
EP	0612570	B1	6/1997
EP	0908148	B1	1/2002
EP	0908155	B1	6/2003
EP	1199044	B1	12/2005
EP	1844720	A1	10/2007
EP	1862133	A1	12/2007
EP	1974771	A1	10/2008
EP	1832259	B1	6/2009
EP	2074959	A1	7/2009
GB	2032221	A	4/1980
GB	2447767	B	8/2011
JP	6-104503	A	4/1994
JP	2005027026	A	1/2005
JP	2006217716	A	8/2006
WO	WO 92/22259	A2	12/1992
WO	WO 93/14708	A1	8/1993
WO	WO 98/37815	A1	9/1998
WO	WO 01/54590	A1	8/2001
WO	WO 2005/122917		12/2005
WO	WO 2006/042210	A2	4/2006
WO	WO 2006/058223	A2	6/2006
WO	WO 2006/129465	A1	12/2006
WO	WO 2007/008710	A2	1/2007
WO	WO 2007/047531	A2	4/2007
WO	WO 2007/143665	A2	12/2007
WO	WO 2008/016886	A2	2/2008
WO	WO 2008/130793	A1	10/2008
WO	WO 2009/018406	A2	2/2009
WO	WO 2009/027065	A1	3/2009
WO	WO 2011/144911	A1	11/2011

OTHER PUBLICATIONS

Gooch et al., "Recommended. Infection-Control Practices for Dentistry, 1993," Published: May 28, 1993; [retrieved on Aug. 23, 2008]. Retrieved from the internet: URL: <http://wonder.cdc.gov/wonder/prevguid/p0000191/p0000191.asp> (15 pages).
 U.S. Appl. No. 12/181,816, filed Jul. 29, 2008.
 U.S. Appl. No. 11/881,602, filed Jul. 27, 2007.
 U.S. Appl. No. 11/888,081, filed Jul. 31, 2007.
 U.S. Appl. No. 11/881,654, filed Jul. 27, 2007.
 U.S. Appl. No. 11/888,171, filed Jul. 31, 2007.
 U.S. Appl. No. 11/998,758, filed Nov. 30, 2007.
 U.S. Appl. No. 11/881,662, filed Jul. 27, 2007.
 U.S. Appl. No. 11/888,222, filed Jul. 31, 2007.
 U.S. Appl. No. 12/245,158, filed Oct. 3, 2008.
 U.S. Appl. No. 29/292,295, filed Oct. 5, 2007.
 U.S. Appl. No. 11/998,543, filed Nov. 30, 2007.

U.S. Appl. No. 29/327,737, filed Nov. 12, 2008.
 U.S. Appl. No. 12/274,884, filed Nov. 20, 2008.
 Technology Overview, printed from www.harmonicscalpel.com, Internet site, website accessed on Jun. 13, 2007, (3 pages).
 Sherrit et al., "Novel Horn Designs for Ultrasonic/Sonic Cleaning Welding, Soldering, Cutting and Drilling," Proc. SPIE Smart Structures Conference, vol. 4701, Paper No. 34, San Diego, CA, pp. 353-360, Mar. 2002.
 Lim et al., "A Review of Mechanism Used in Laparoscopic Surgical Instruments," Mechanism and Machine Theory, vol. 38, pp. 1133-1147, (2003).
 AST Products, Inc., "Principles of Video Contact Angle Analysis," 20 pages, (date unknown).
 U.S. Appl. No. 11/881,645, filed Jul. 27, 2007.
 U.S. Appl. No. 12/469,293, filed May 20, 2009.
 U.S. Appl. No. 12/469,308, filed May 20, 2009.
 U.S. Appl. No. 12/503,769, filed Jul. 15, 2009.
 U.S. Appl. No. 12/503,770, filed Jul. 15, 2009.
 U.S. Appl. No. 12/503,766, filed Jul. 15, 2009.
 U.S. Appl. No. 12/490,906, filed Jun. 24, 2009.
 U.S. Appl. No. 12/490,922, filed Jun. 24, 2009.
 U.S. Appl. No. 12/490,933, filed Jun. 24, 2009.
 U.S. Appl. No. 12/490,948, filed Jun. 24, 2009.
 U.S. Appl. No. 12/703,860, filed Feb. 11, 2010.
 U.S. Appl. No. 12/703,864, filed Feb. 11, 2010.
 U.S. Appl. No. 12/703,866, filed Feb. 11, 2010.
 U.S. Appl. No. 12/703,870, filed Feb. 11, 2010.
 U.S. Appl. No. 12/703,875, filed Feb. 11, 2010.
 U.S. Appl. No. 12/703,877, filed Feb. 11, 2010.
 U.S. Appl. No. 12/703,879, filed Feb. 11, 2010.
 U.S. Appl. No. 12/703,885, filed Feb. 11, 2010.
 U.S. Appl. No. 12/703,893, filed Feb. 11, 2010.
 U.S. Appl. No. 12/703,899, filed Feb. 11, 2010.
 AST Products, Inc., "Principles of Video Contact Angle Analysis," 20 pages, (2006).
 Huston et al., "Magnetic and Magnetostrictive Properties of Cube Textured Nickel for Magnetostrictive Transducer Applications," IEEE Transactions on Magnetics, vol. 9(4), pp. 636-640 (Dec. 1973).
 Incropera et al., Fundamentals of Heat and Mass Transfer, Wiley, New York (1990). (Book-not attached).
 F. A. Duck, "Optical Properties of Tissue Including Ultraviolet and Infrared Radiation," pp. 43-71 in *Physical Properties of Tissue* (1990).
 Orr et al., "Overview of Bioheat Transfer," pp. 367-384 in *Optical-Thermal Response of Laser-Irradiated Tissue*, A. J. Welch and M. J. C. van Gemert, eds., Plenum, New York (1995).
 Campbell et al., "Thermal Imaging in Surgery," p. 19-3, in *Medical Infrared Imaging*, N. A. Diakides and J. D. Bronzino, Eds. (2008).
 U.S. Appl. No. 12/896,351, filed Oct. 1, 2010.
 U.S. Appl. No. 12/896,411, filed Oct. 1, 2010.
 U.S. Appl. No. 12/896,420, filed Oct. 1, 2010.
 U.S. Appl. No. 29/402,697, filed Sep. 26, 2011.
 U.S. Appl. No. 29/402,699, filed Sep. 26, 2011.
 U.S. Appl. No. 29/402,700, filed Sep. 26, 2011.
 U.S. Appl. No. 29/402,701, filed Sep. 26, 2011.
 U.S. Appl. No. 13/251,766, filed Oct. 3, 2011.
 U.S. Appl. No. 29/404,676, filed Oct. 24, 2011.
 U.S. Appl. No. 13/452,386, filed Apr. 20, 2012.
 U.S. Appl. No. 13/448,175, filed Apr. 16, 2012.
 U.S. Appl. No. 13/151,181, filed Jun. 2, 2011.
 U.S. Appl. No. 13/369,561, filed Feb. 9, 2012.
 U.S. Appl. No. 13/369,569, filed Feb. 9, 2012.
 U.S. Appl. No. 13/369,578, filed Feb. 9, 2012.
 U.S. Appl. No. 13/369,584, filed Feb. 9, 2012.
 U.S. Appl. No. 13/369,588, filed Feb. 9, 2012.
 U.S. Appl. No. 13/369,594, filed Feb. 9, 2012.
 U.S. Appl. No. 13/369,601, filed Feb. 9, 2012.
 U.S. Appl. No. 13/369,609, filed Feb. 9, 2012.
 U.S. Appl. No. 13/369,629, filed Feb. 9, 2012.
 U.S. Appl. No. 13/369,666, filed Feb. 9, 2012.

* cited by examiner

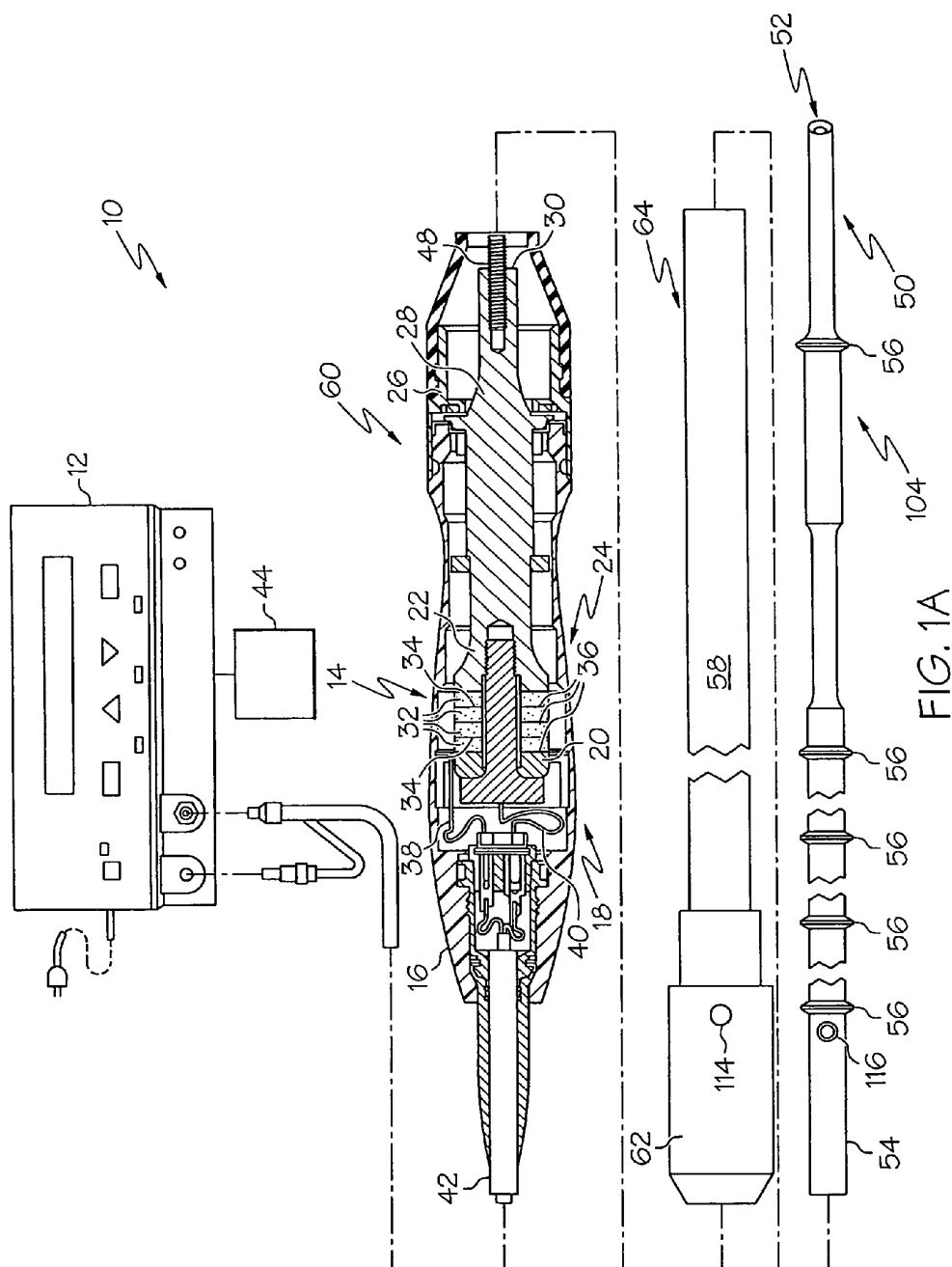

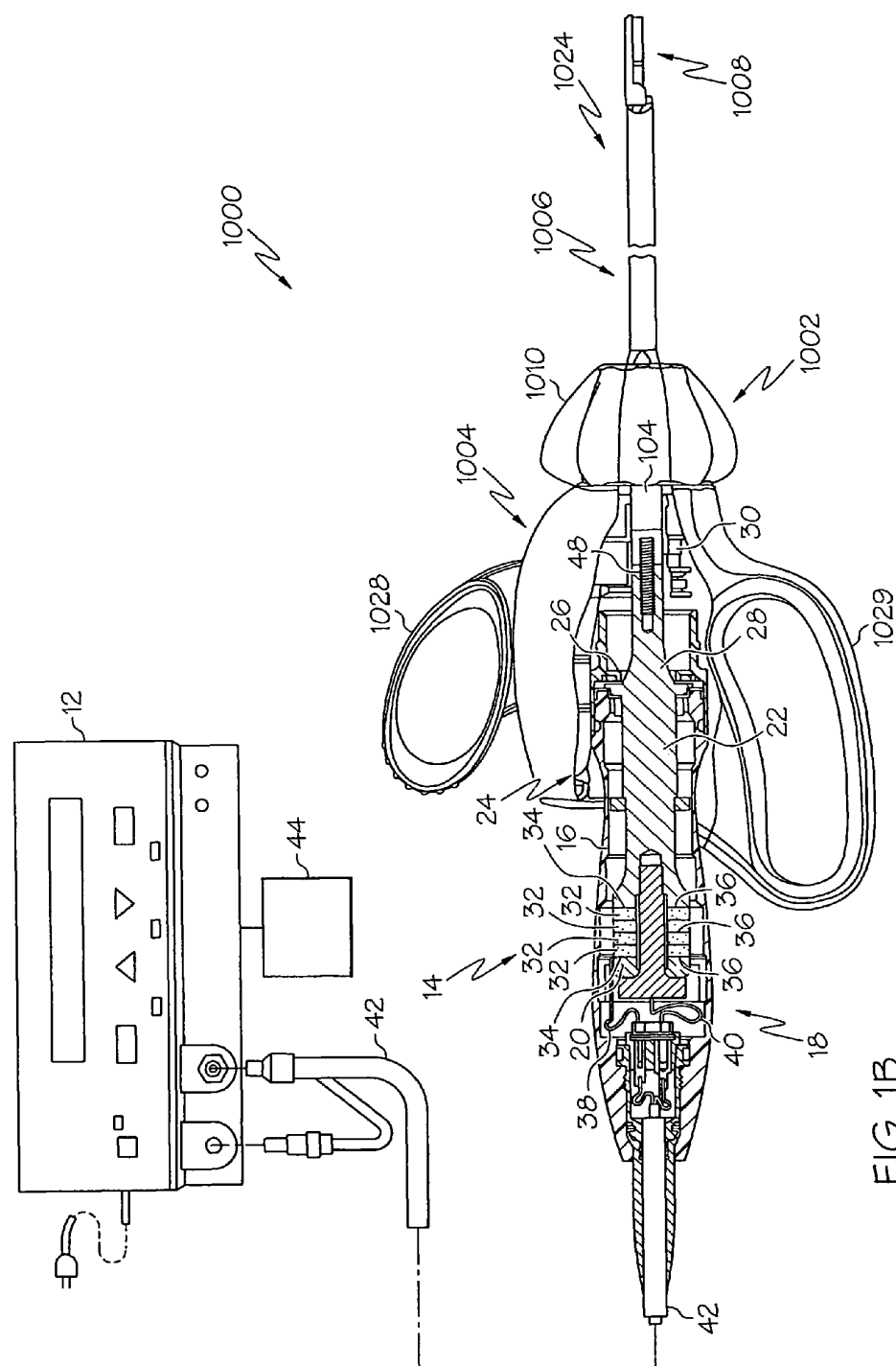

FIG. 1B

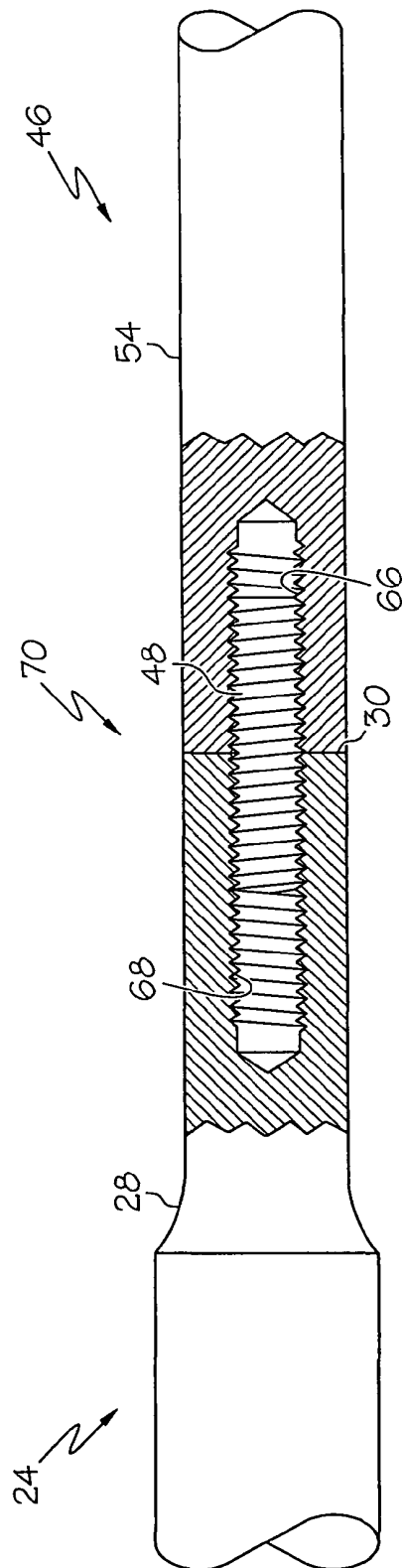

FIG. 2

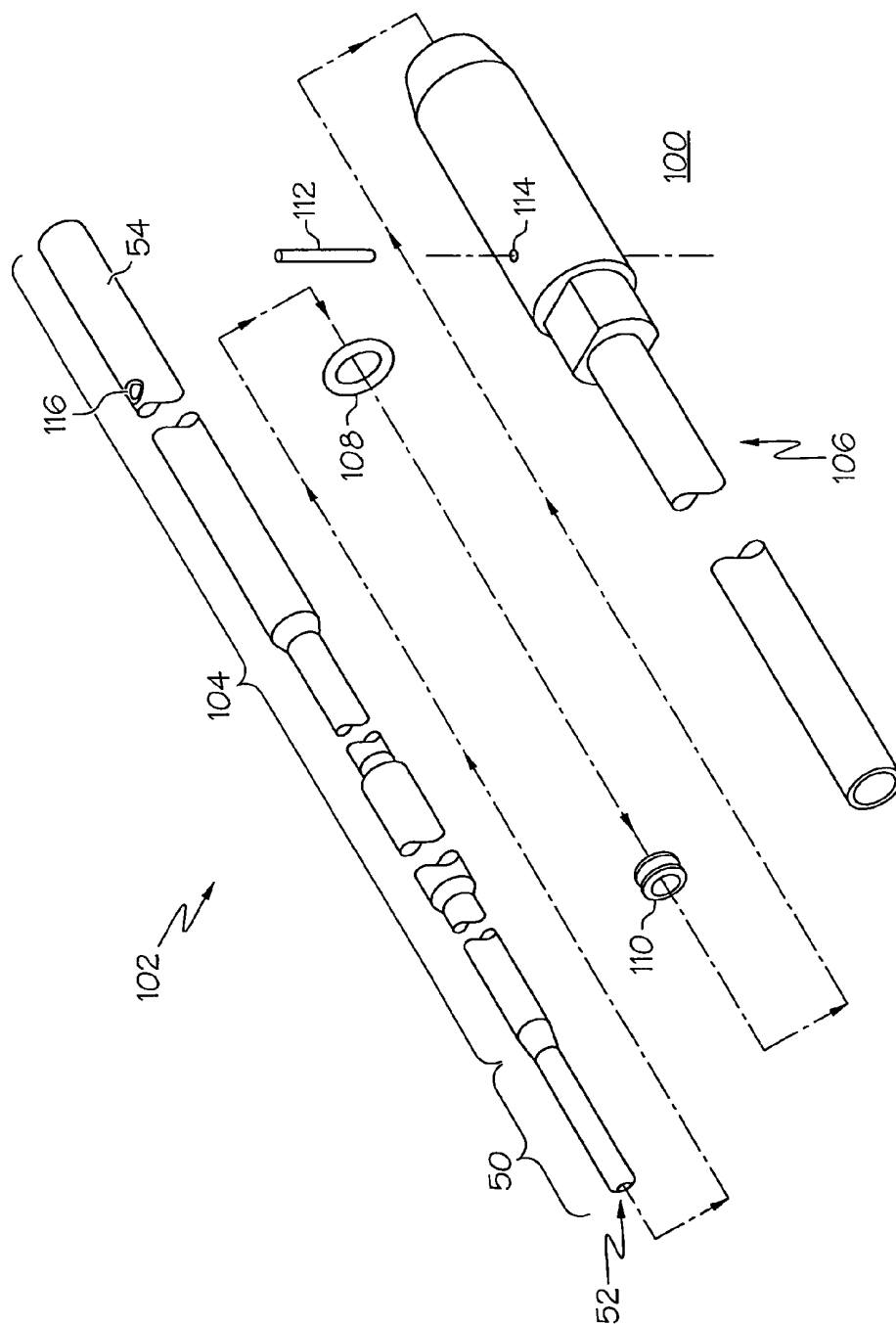

FIG. 3A

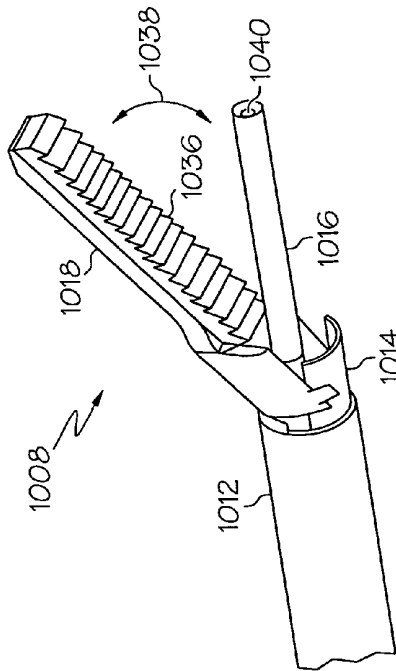

FIG. 3C

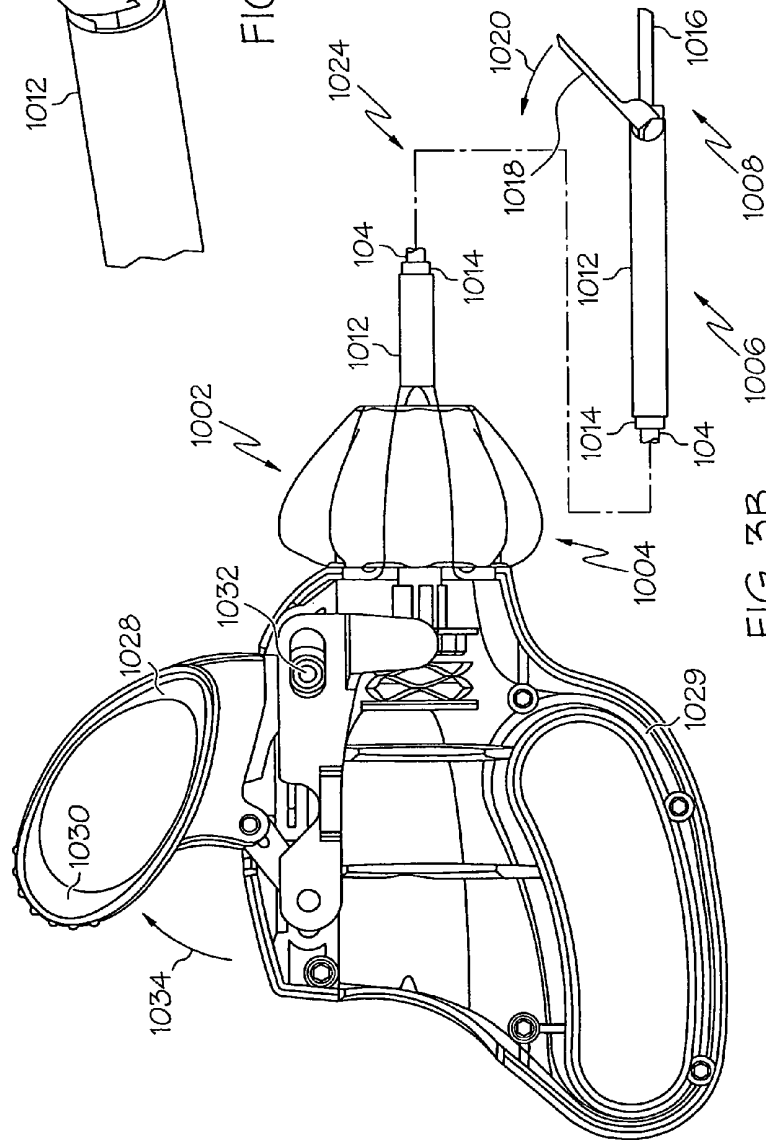

FIG. 3B

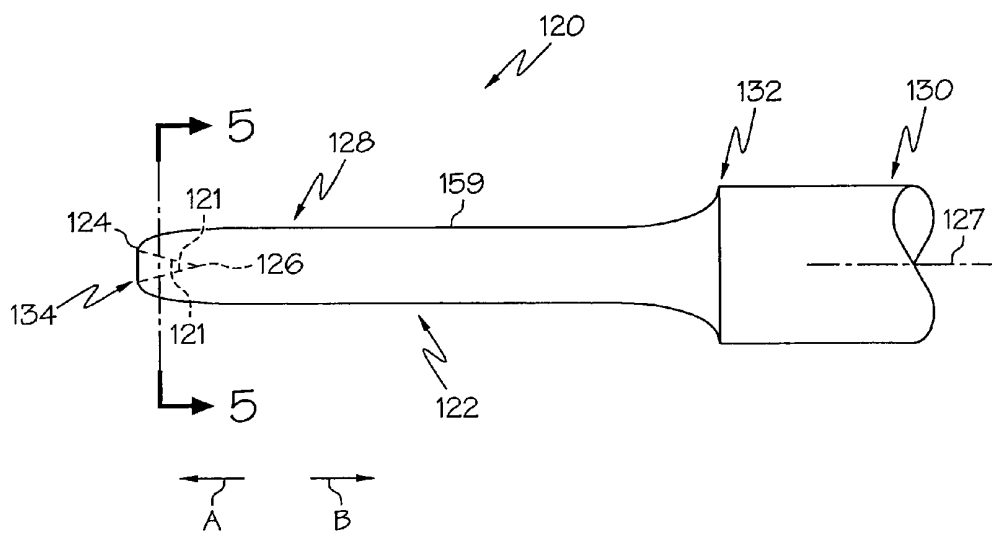

FIG. 4

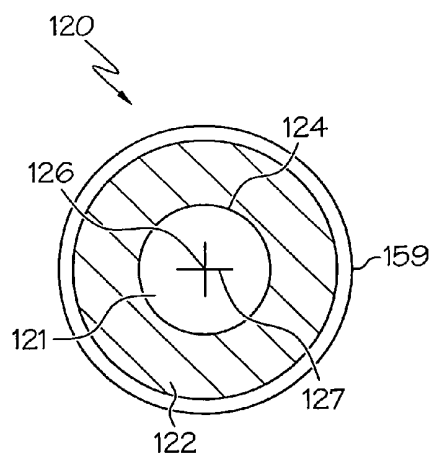

FIG. 5

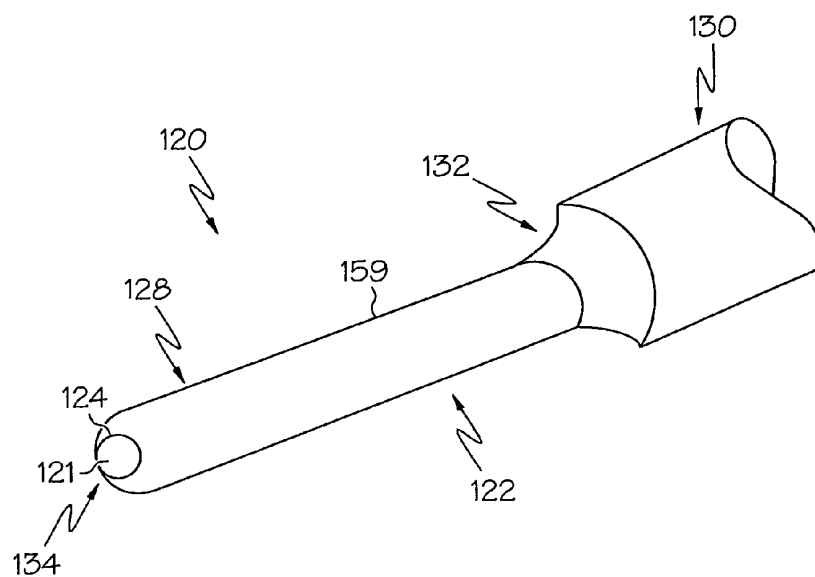

FIG. 6

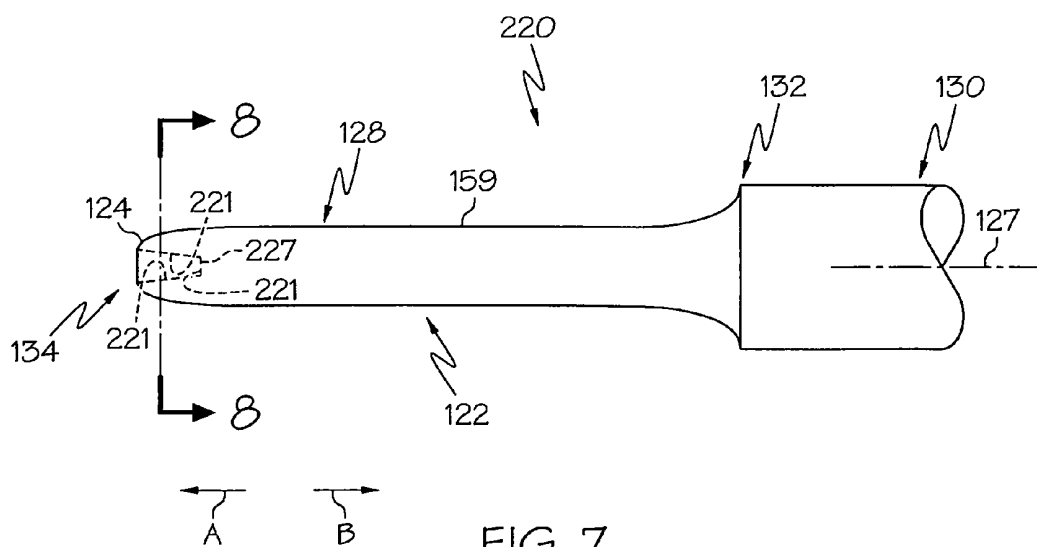

FIG. 7

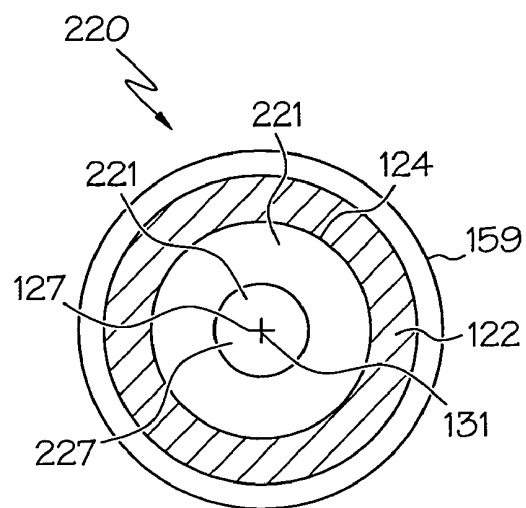

FIG. 8

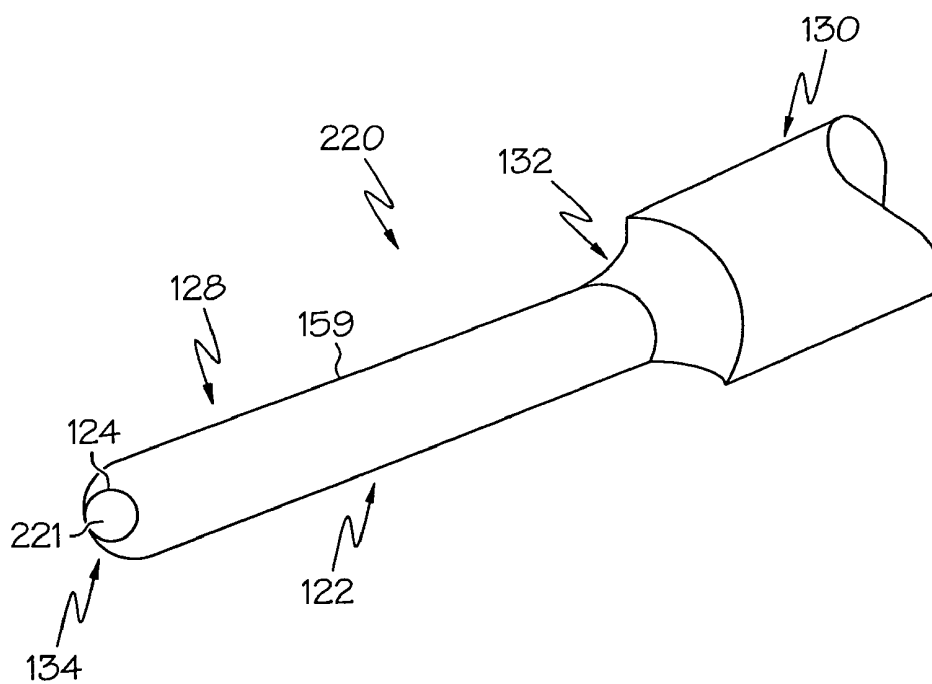
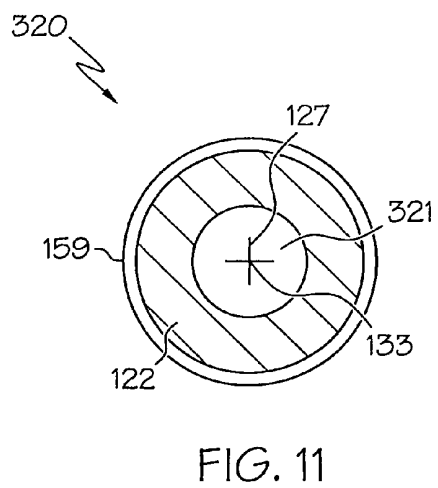
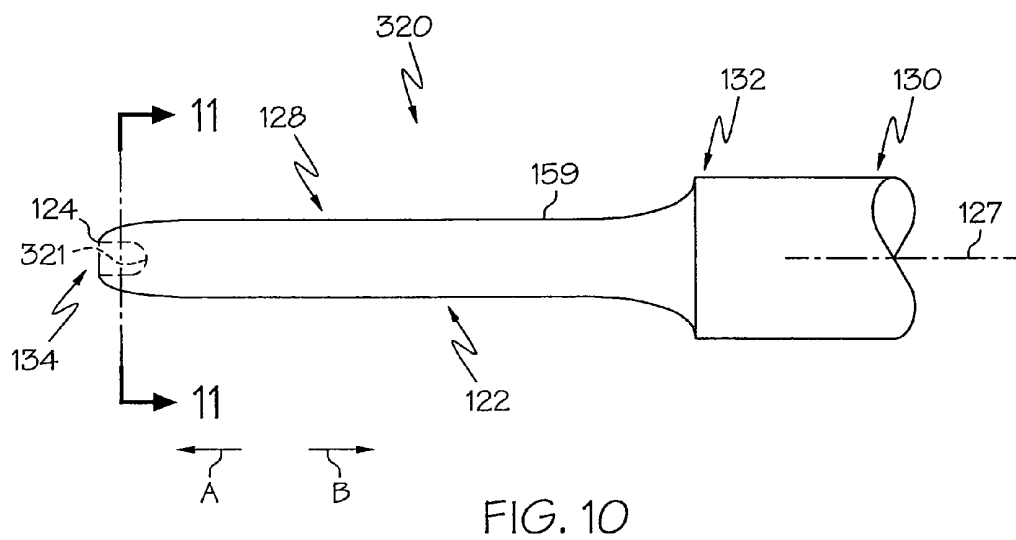

FIG. 9



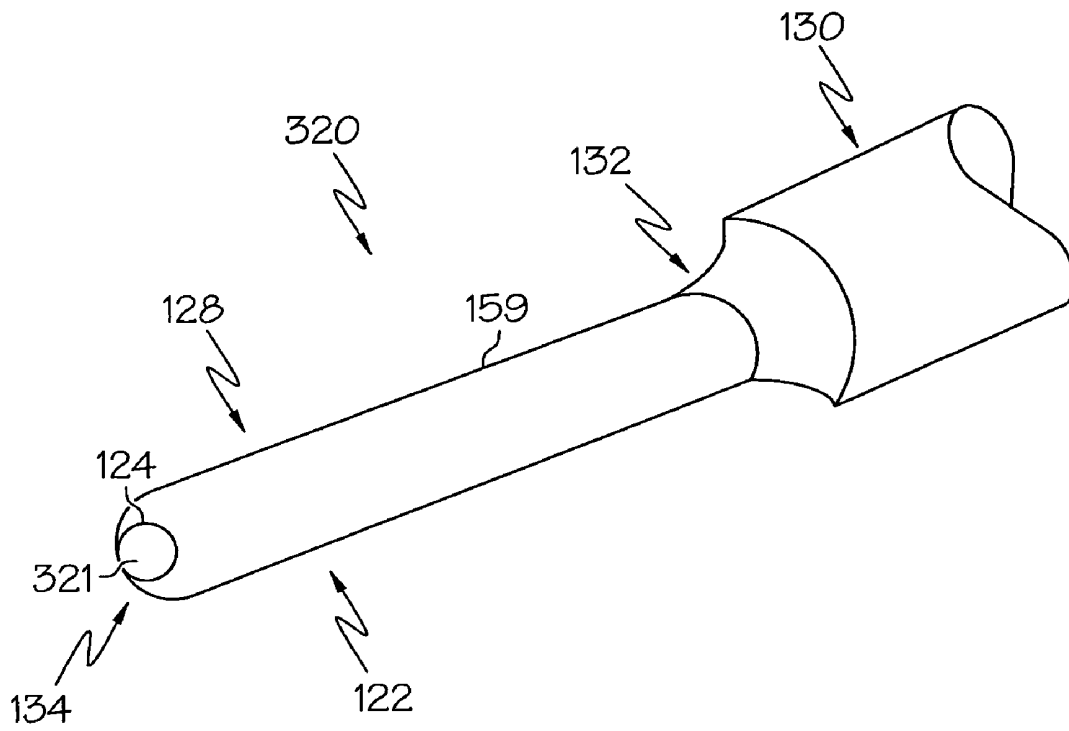

FIG. 12

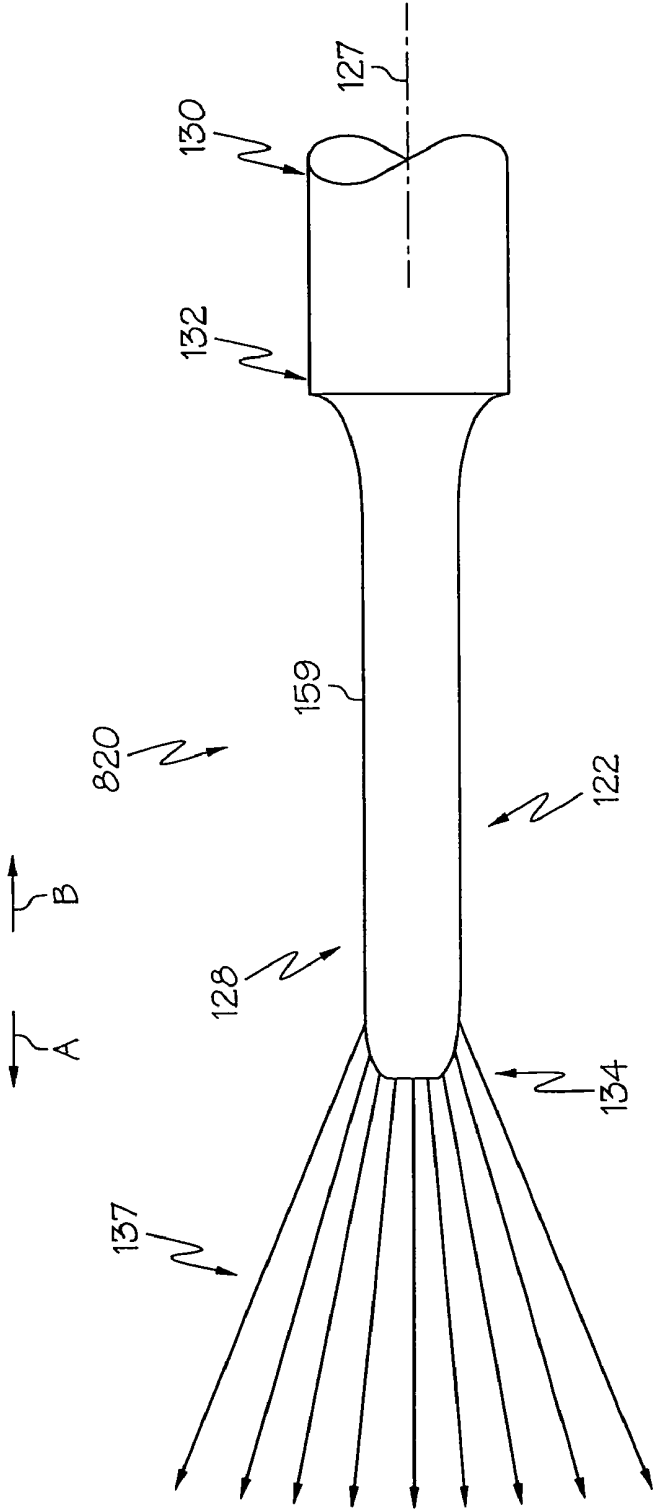

FIG. 13A

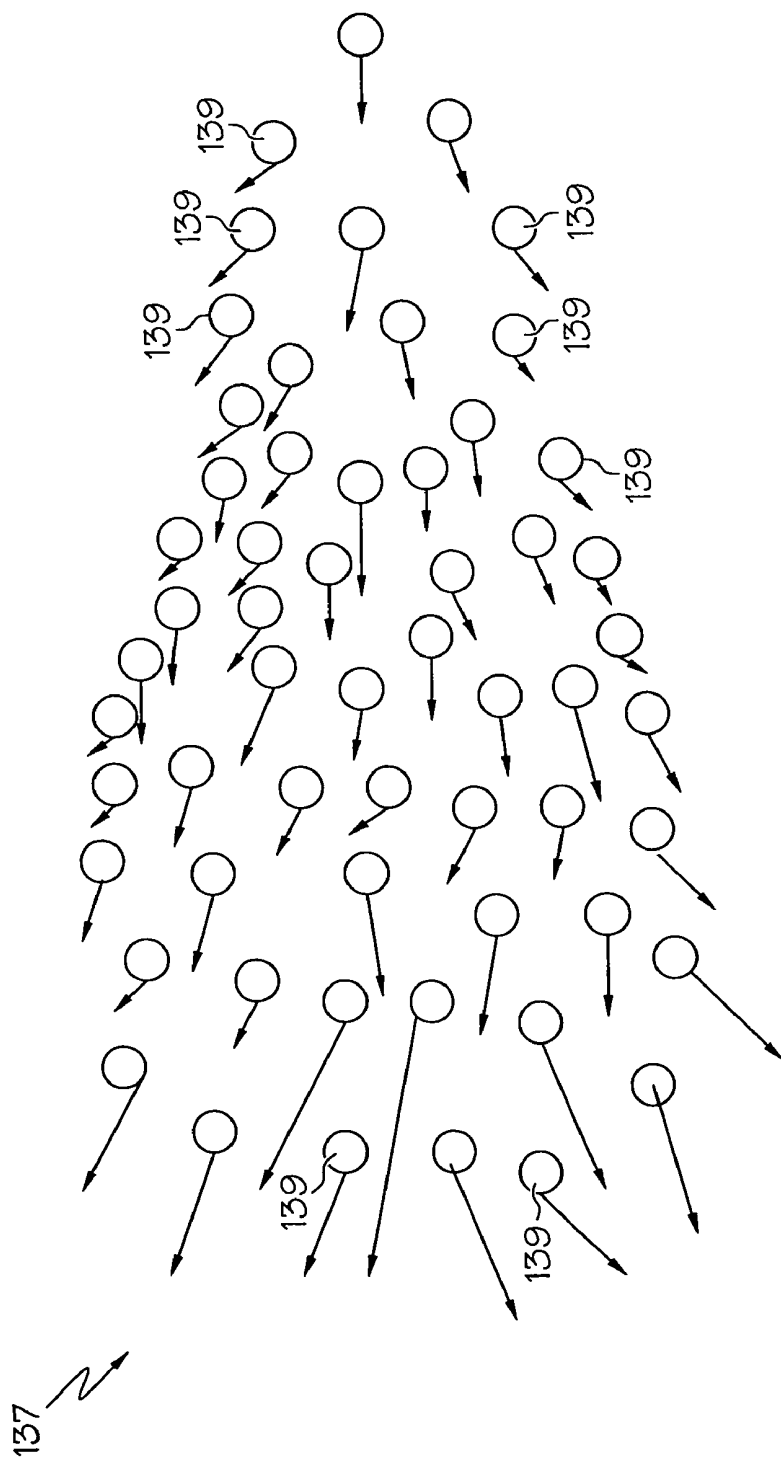
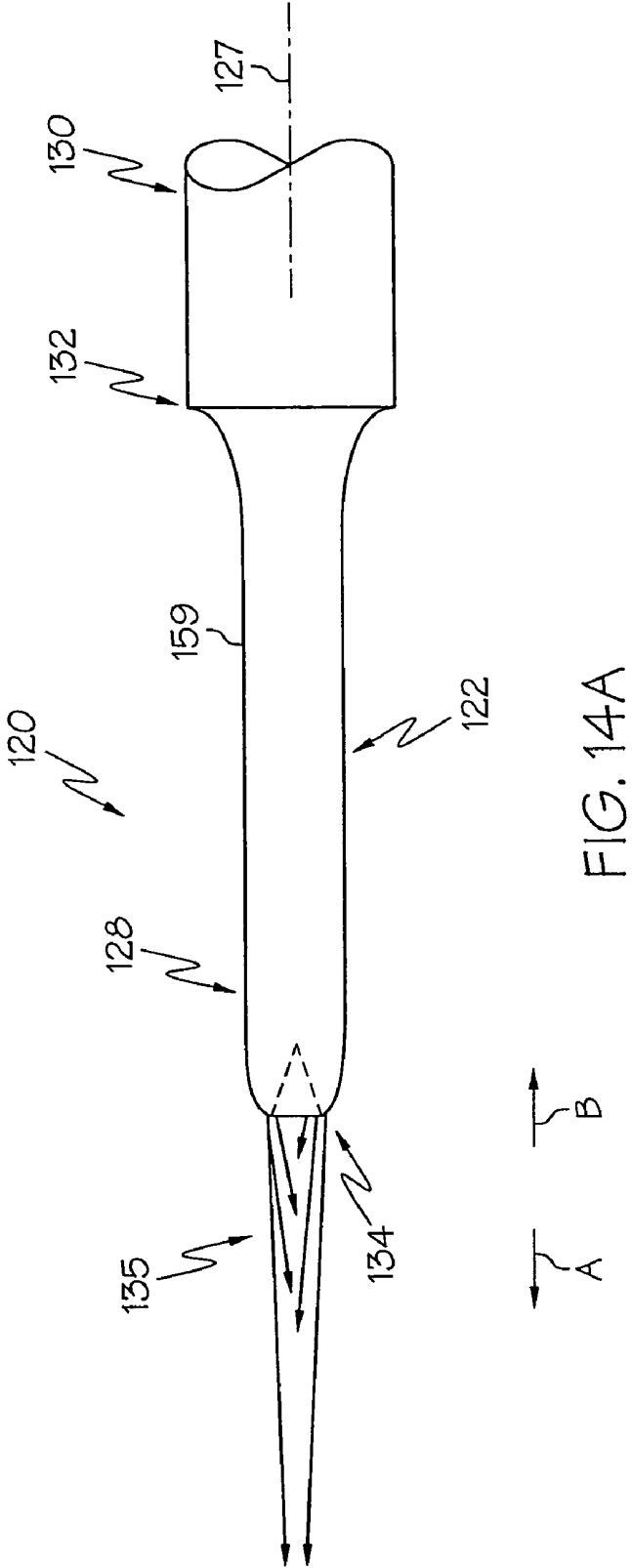

FIG. 13B



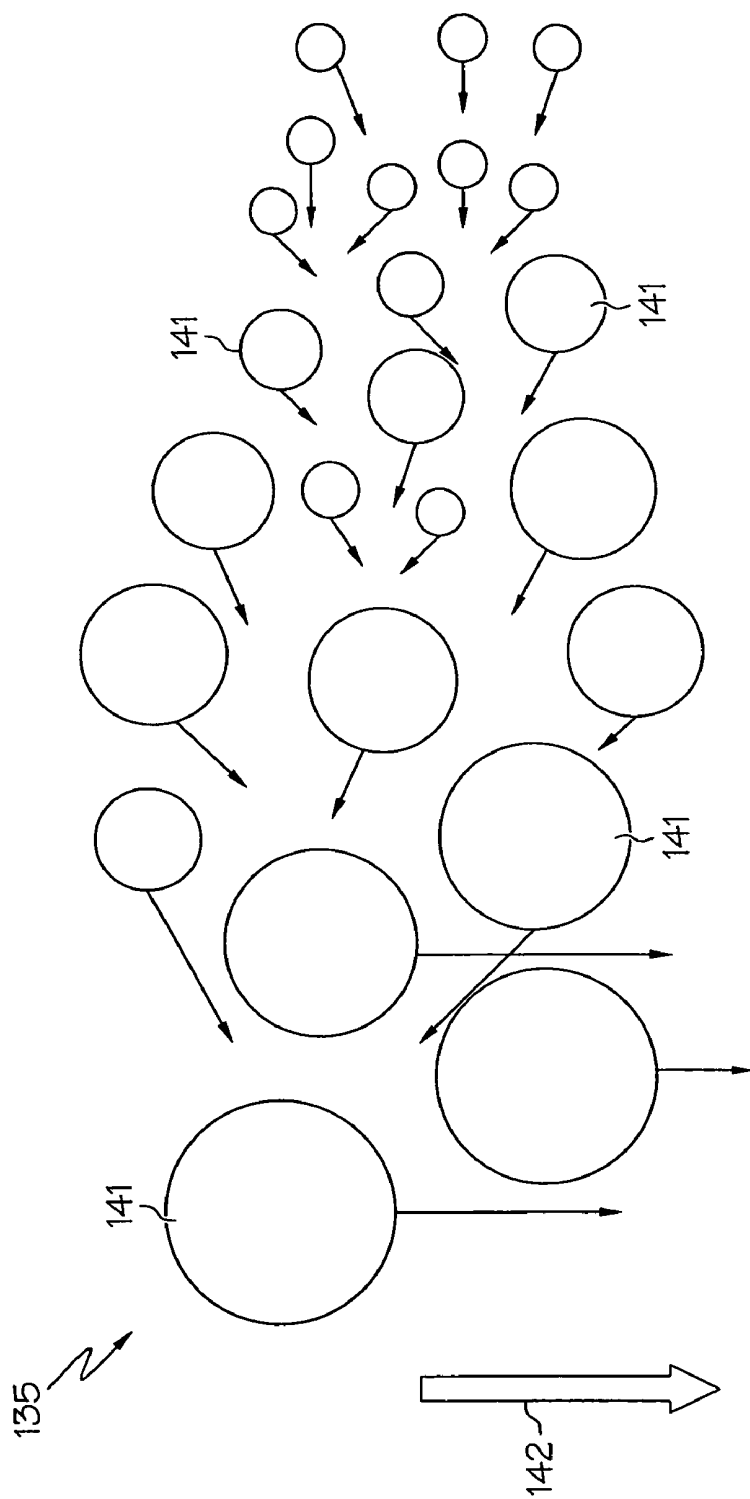

FIG. 14B

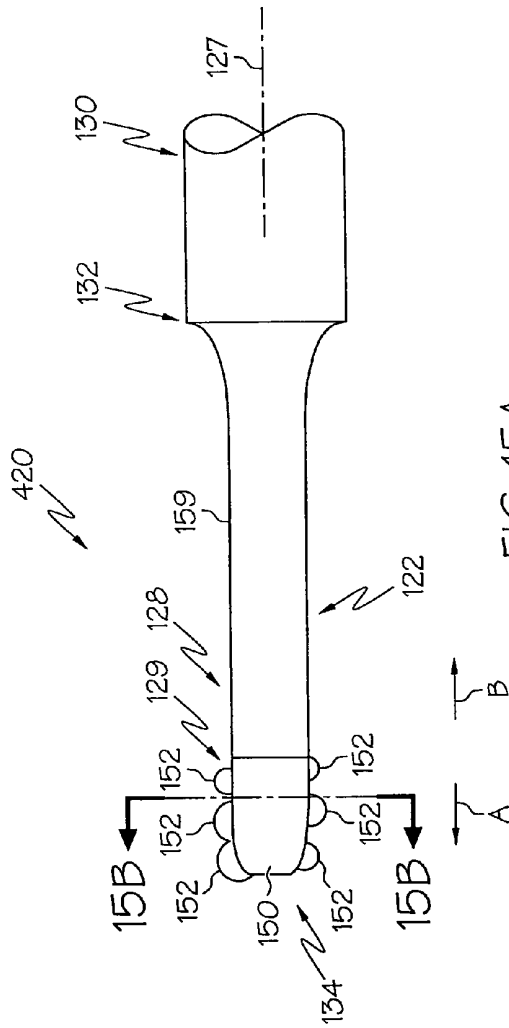

FIG. 15A

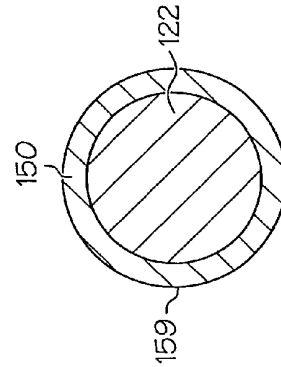

FIG. 15B

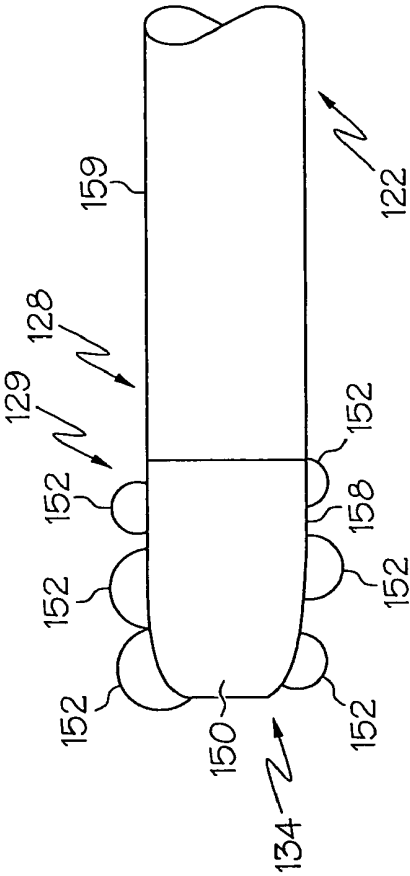

FIG. 15C

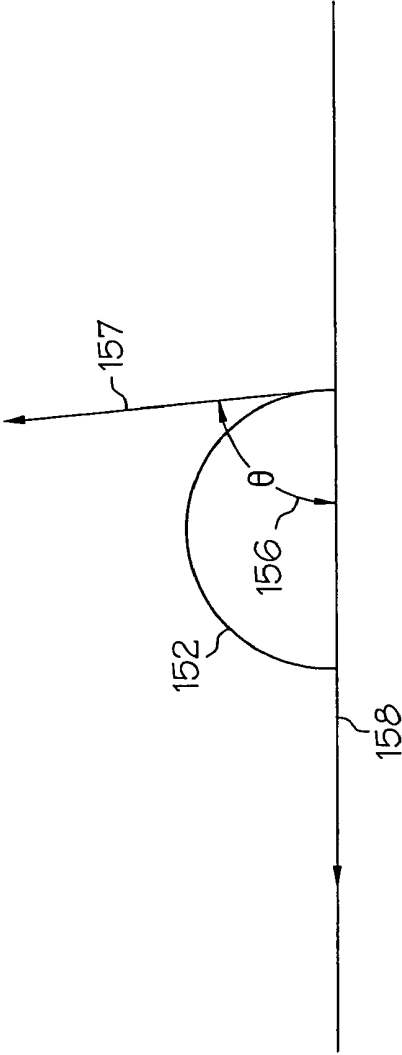

FIG. 15D

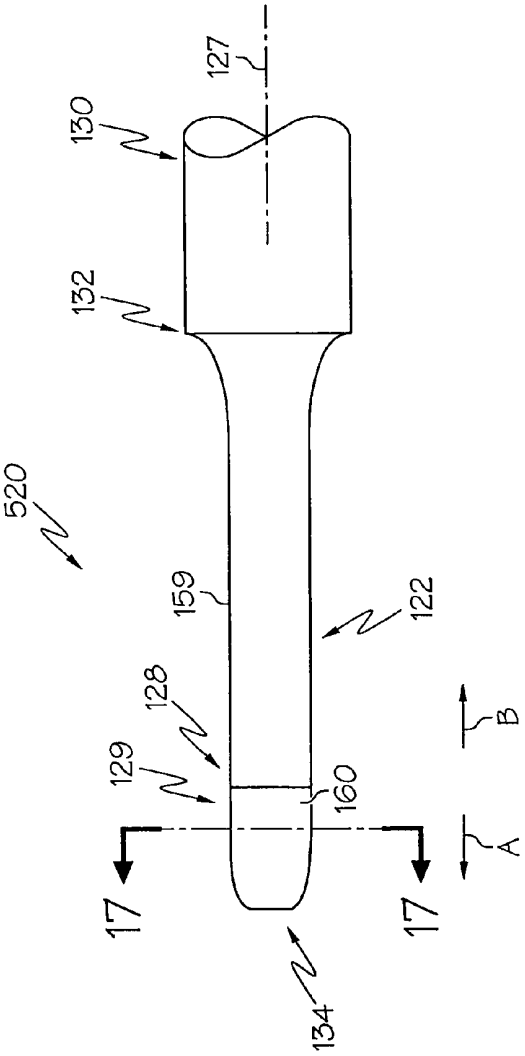

FIG. 16

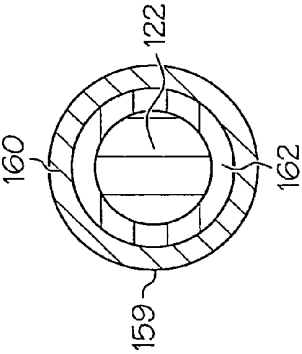
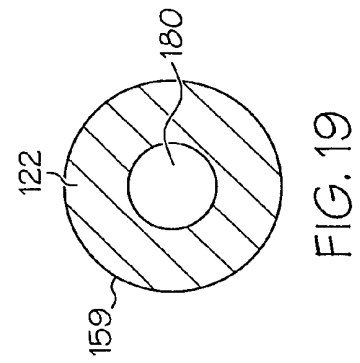
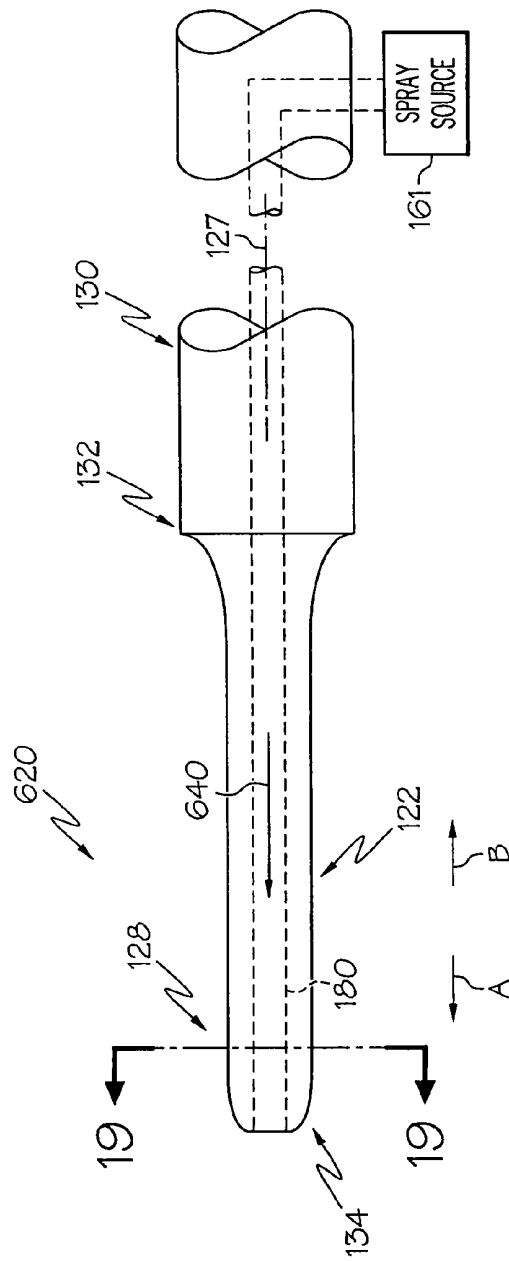
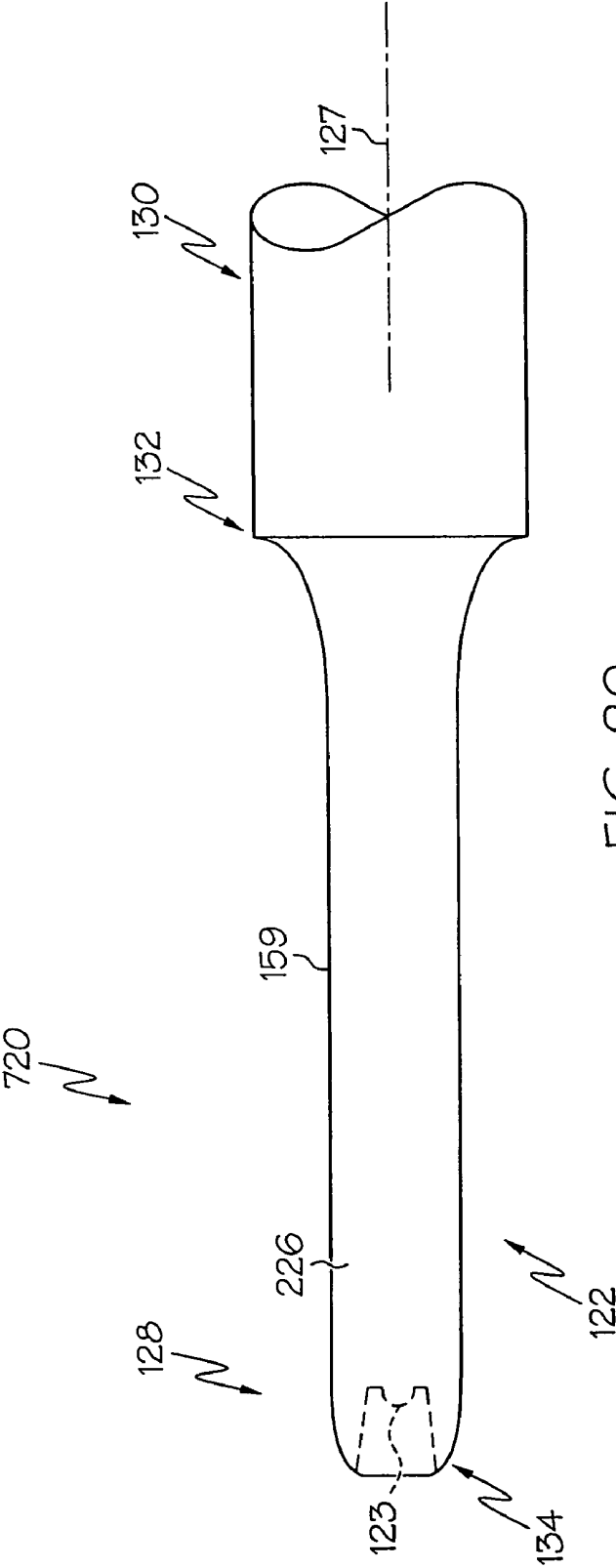

FIG. 17





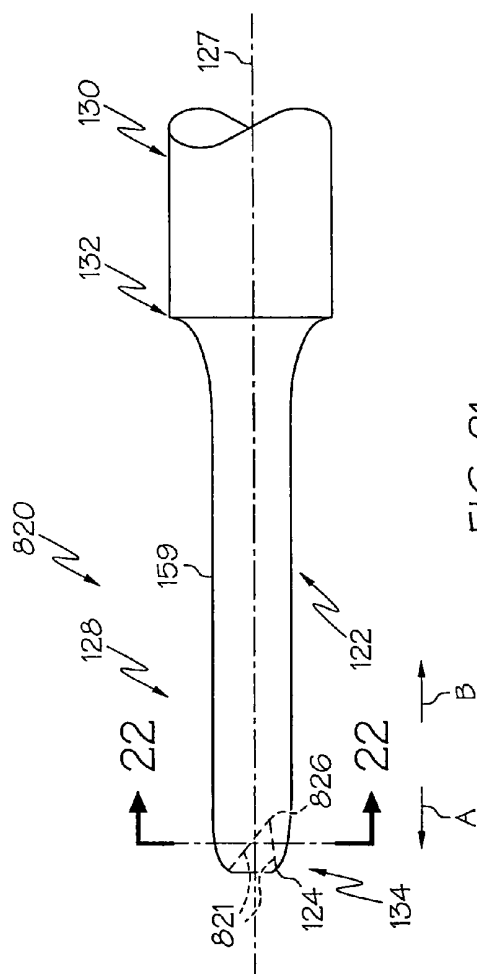

FIG. 21

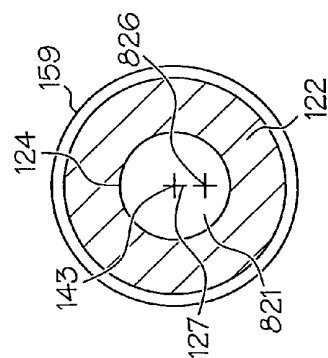

FIG. 22

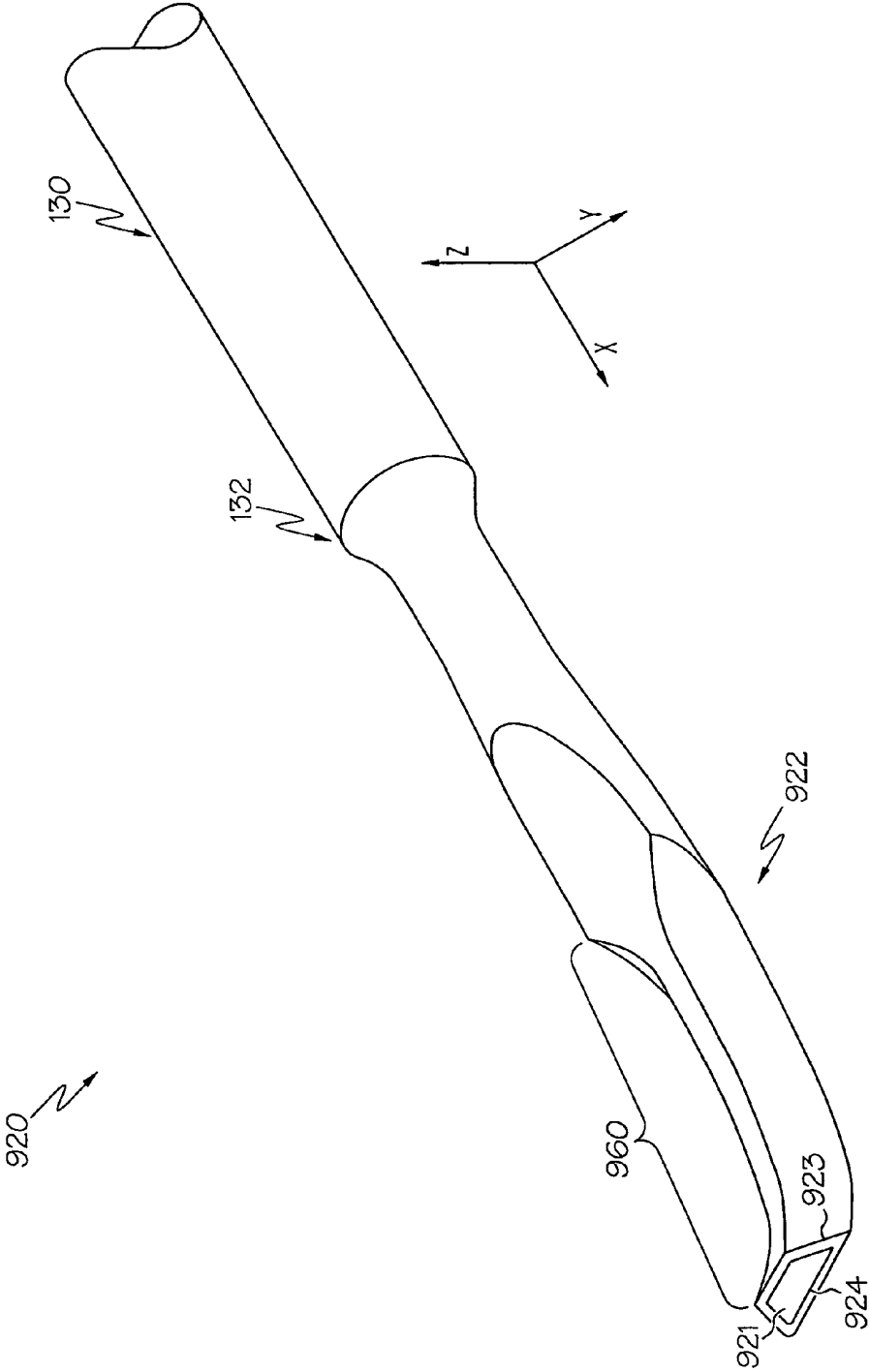

FIG. 23

ULTRASONIC SURGICAL INSTRUMENTS

BACKGROUND

The subject application is related a co-pending and commonly-owned application U.S. patent application Ser. No. 11/881,645, now U.S. Patent Publication No. 2009/0030439, filed on even date herewith, the disclosure of which is hereby incorporated by reference in its entirety, the application being respectively entitled Ultrasonic Surgical Instruments to Foster B. Stulen.

Ultrasonic instruments, including both hollow core and solid core instruments, are used for the safe and effective treatment of many medical conditions. Ultrasonic instruments, and particularly solid core ultrasonic instruments, are advantageous because they may be used to cut and/or coagulate tissue using energy in the form of mechanical vibrations transmitted to a surgical end effector at ultrasonic frequencies. Ultrasonic vibrations, when transmitted to organic tissue at suitable energy levels and using a suitable end effector, may be used to cut, dissect, or coagulate tissue or elevate or separate muscle tissue off bone. Ultrasonic instruments utilizing solid core technology are particularly advantageous because of the amount of ultrasonic energy that may be transmitted from the ultrasonic transducer, through an ultrasonic transmission waveguide, to the surgical end effector. Such instruments may be used for open procedures or minimally invasive procedures, such as endoscopic or laparoscopic procedures, wherein the end effector is passed through a trocar to reach the surgical site.

Activating or exciting the single or multiple element end effector (e.g., cutting blade, ball coagulator) of such instruments at ultrasonic frequencies induces longitudinal, transverse, or torsional vibratory movement that generates localized heat within adjacent tissue, facilitating both cutting and coagulating. Because of the nature of ultrasonic instruments, a particular ultrasonically actuated end effector may be designed to perform numerous functions, including, for example, cutting and coagulating.

Ultrasonic vibration is induced in the surgical end effector by electrically exciting a transducer, for example. The transducer may be constructed of one or more piezoelectric or magnetostrictive elements in the instrument hand piece. Vibrations generated by the transducer section are transmitted to the surgical end effector via an ultrasonic waveguide extending from the transducer section to the surgical end effector. The waveguides and end effectors are most preferably designed to resonate at the same frequency as the transducer. When an end effector is attached to a transducer the overall system frequency may be the same frequency as the transducer itself.

The transducer and the end effector may be designed to resonate at two different frequencies and when joined or coupled may resonate at a third frequency. The zero-to-peak amplitude of the longitudinal ultrasonic vibration at the tip, d, of the end effector behaves as a simple sinusoid at the resonant frequency as given by:

$$d=A \sin(\omega t)$$

where:

ω =the radian frequency which equals 2π times the cyclic frequency, f; and

A=the zero-to-peak amplitude.

The longitudinal excursion is defined as the peak-to-peak (p-t-p) amplitude, which is just twice the amplitude of the sine wave or $2A$.

Solid core ultrasonic surgical instruments may be divided into two types, single element end effector devices and multiple-element end effectors. Single element end effector devices include instruments such as scalpels (e.g., blades, sharp hook blades, dissecting hook blades, curved blades) and ball coagulators. Single-element end effector instruments have limited ability to apply blade-to-tissue pressure when the tissue is soft and loosely supported. Substantial pressure may be necessary to effectively couple ultrasonic energy to the tissue. The inability of a single-element end effector to grasp the tissue results in a further inability to fully coat tissue surfaces while applying ultrasonic energy, leading to less-than-desired hemostasis and tissue joining. The use of multiple-element end effectors such as clamping coagulators includes a mechanism to press tissue against an ultrasonic blade that can overcome these deficiencies.

Ultrasonic clamp coagulators or clamped coagulating shears provide an improved ultrasonic surgical instrument for cutting/coagulating tissue, particularly loose and unsupported tissue, wherein the ultrasonic blade is employed in conjunction with a clamp for applying a compressive or biasing force to the tissue, whereby faster coagulation and cutting of the tissue.

As the distal end of the end effector, or more particularly, the blade, cuts through or coagulates tissue it comes into contact with fluid (e.g., blood, tissue particles). When the distal end of the blade contacts this fluid, a fine mist in the form of a diverging plume of fluid particles may emanate from the distal end of the blade. This plume of mist may limit visibility at the surgical site. It would be desirable to provide an ultrasonic instrument which reduces the plume of mist emanating from the distal end of the end effector.

SUMMARY

In one general aspect, the various embodiments are directed to a surgical instrument with mist reducing features. The surgical instrument may comprise a transducer configured to produce vibrations at a predetermined frequency. An ultrasonic blade extends along a longitudinal axis and is coupled to the transducer. The ultrasonic blade comprises a substantially solid, substantially cylindrical blade body without a channel and having a first length. The substantially solid, substantially cylindrical blade body has a proximal end and a distal end. The distal end is movable relative to a longitudinal axis by the vibrations produced by the transducer. The body comprises a treatment region that extends from the proximal end to the distal end.

The body may comprise elements which may lead to the reduction of mist emanating from a distal end of the blade. The body may comprise a tapered inner concave surface at the distal end which may extend inwardly into the substantially solid, substantially cylindrical blade body substantially along the longitudinal axis. The conical shape may comprise an apex within the substantially solid, substantially cylindrical blade body and the tapered inner concave surface may terminate at or before the apex of the conical shape. The tapered inner concave surface may comprise a second length between the distal end and the apex. The first length may be at least three times the second length such that vibrations produced along the substantially solid, substantially cylindrical blade body are substantially uniform to provide substantially even distribution of energy to the tissue. The tapered inner concave surface may reduce a mist plume produced by fluids contacting a surface of the energized ultrasonic blade during ultrasonic surgical procedures by causing fluid particles to converge along the longitudinal axis when the fluid droplets

collide with the tapered inner concave surface to enhance visibility of a surgical site. The tapered concave surface may define a variety of symmetrical and asymmetrical shapes including conical, frusto-conical and a partial spheroid. The tapered concave surface may be formed on the distal end of symmetrical as well as asymmetrical ultrasonically actuable blades.

FIGURES

The novel features of the various embodiments are set forth with particularity in the appended claims. The various embodiments, however, both as to organization and methods of operation, may best be understood by reference to the following description, taken in conjunction with the accompanying drawings as follows.

FIG. 1A illustrates one embodiment of an ultrasonic system comprising a single element end effector.

FIG. 1B illustrates one embodiment of an ultrasonic system comprising a multi-element end effector.

FIG. 2 illustrates one embodiment of a connection union/joint for an ultrasonic instrument.

FIG. 3A illustrates an exploded perspective view of one embodiment of a single element end effector ultrasonic surgical instrument that may be coupled to the ultrasonic system illustrated in FIG. 1A.

FIG. 3B illustrates one embodiment of a clamp coagulator comprising a multi-element end effector as shown in FIG. 1B.

FIG. 3C illustrates a perspective view of the multi-element end effector as shown in FIGS. 1B and 3B.

FIGS. 4-6 illustrate one embodiment of an ultrasonic blade, where:

FIG. 4 is a side view of one embodiment of an ultrasonic blade;

FIG. 5 is a cross-sectional view of the ultrasonic blade taken along line 5-5 in FIG. 4; and

FIG. 6 is a perspective view of the ultrasonic blade shown in FIG. 4.

FIGS. 7-9 illustrate various embodiments of the ultrasonic blade, where:

FIG. 7 is a side view of one embodiment of an ultrasonic blade;

FIG. 8 is a cross-sectional view of the ultrasonic blade taken along line 8-8 in FIG. 7; and

FIG. 9 is a perspective view of the ultrasonic blade shown in FIG. 7.

FIGS. 10-12 illustrate one embodiment of the ultrasonic blade, where:

FIG. 10 is a side view of one embodiment of an ultrasonic blade;

FIG. 11 is a cross-sectional view of the ultrasonic blade taken along line 11-11 in FIG. 10; and

FIG. 12 is a perspective view of the ultrasonic blade shown in FIG. 10.

FIGS. 13A-B illustrate various embodiments of an ultrasonic blade, where:

FIG. 13A is a side view of an ultrasonic blade with a convex blade tip depicting a divergent plume mist; and

FIG. 13B is a detail view of the divergent jet of fluid mist.

FIGS. 14A-B illustrate various embodiments of an ultrasonic blade, where:

FIG. 14A is a side view of an ultrasonic blade with a tapered concave surface formed at a distal end of the blade depicting a convergence of the fluid leaving the blade tip; and

FIG. 14B is a detail view of the convergent jet of fluid mist.

FIGS. 15A-D illustrate various embodiments of an ultrasonic blade, where:

FIG. 15A is a side view of an ultrasonic blade with at least a portion of the ultrasonic blade coated with at least one layer of a material which may allow the fluid to form globules on the surface of the material; and

FIG. 15B is cross-sectional view of the ultrasonic blade taken along line B-B in FIG. 15A.

FIG. 15C is a detailed view of the ultrasonic blade of FIG. 15A.

FIG. 15D illustrates a contact angle between a droplet and the surface of the ultrasonic blade of FIG. 15A.

FIGS. 16-17 illustrate various embodiments of an ultrasonic blade, where:

FIG. 16 is a side view of an ultrasonic blade with portions of the blade coated with more than one material to provide an electric charge to the blade tip; and

FIG. 17 is cross-sectional view of the ultrasonic blade taken along line 17-17 in FIG. 16.

FIGS. 18-19 illustrate various embodiments of an ultrasonic blade, where:

FIG. 18 is a side view of an ultrasonic blade with a longitudinally extending bore; and

FIG. 19 is cross-sectional view of the ultrasonic blade taken along line 19-19 in FIG. 18.

FIG. 20 is a side view of an ultrasonic blade with a convex portion within a tapered concave surface thereof.

FIG. 21-22 illustrate various embodiments of an ultrasonic blade, where:

FIG. 21 is a side view of an ultrasonic blade with a tapered concave surface extending into the blade body asymmetrically.

FIG. 22 is a cross-sectional view of the ultrasonic blade taken along line 22-22 in FIG. 21.

FIG. 23 is a perspective view of an asymmetric ultrasonic blade comprising a tapered concave surface extending inwardly into the blade body.

DESCRIPTION

Before explaining the various embodiments in detail, it should be noted that the embodiments are not limited in its application or use to the details of construction and arrangement of parts illustrated in the accompanying drawings and description. The illustrative embodiments may be implemented or incorporated in other embodiments, variations and modifications, and may be practiced or carried out in various ways. For example, the surgical instruments and blade configurations disclosed below are illustrative only and not meant to limit the scope or application thereof. Furthermore, unless otherwise indicated, the terms and expressions employed herein have been chosen for the purpose of describing the illustrative embodiments for the convenience of the reader and are not to limit the scope thereof.

The various embodiments relate, in general, to ultrasonic blades for use in surgical instruments and, more particularly, to ultrasonic blades comprising mist reducing features as described herein. The various embodiments relate, in general, to ultrasonic blades and instruments to improve visibility of the surgical site during surgery by reducing the mist plume created by fluid particles colliding with a distal end of an activated ultrasonic blade. Visibility of the surgical site may be improved through the mist reducing features of the ultrasonic blades which may comprise a tapered concave surface formed at the distal end of the blade, a tip coating, a lumen fluidically coupled to a spraying mechanism, a material to hold an electric charge, or any combination thereof. The term "tapered concave surface" is defined as a concave surface formed at a distal end of the blade that is tapered inwardly

from its distal end to its proximal end in the direction indicated by arrow B, various embodiments of which are shown in FIGS. 4-23. A variety of different blade configurations are disclosed which may be useful for both open and laparoscopic applications.

Examples of ultrasonic surgical instruments are disclosed in U.S. Pat. Nos. 5,322,055 and 5,954,736 and in combination with ultrasonic blades and surgical instruments disclosed in U.S. Pat. Nos. 6,309,400 B2, 6,278,218 B1, 6,283,981 B1, and 6,325,811 B1, for example, are incorporated herein by reference in their entirety. These references disclose ultrasonic surgical instruments and blade configurations where a longitudinal mode of the blade is excited. Because of asymmetry or asymmetries, ultrasonic blades also may exhibit transverse and/or torsional motion where the characteristic "wavelength" of this non-longitudinal motion is generally less than that of the general longitudinal motion of the blade and its extender portion. Therefore, the wave shape of the non-longitudinal motion will present nodal positions of transverse/torsional motion along the tissue effector while the net motion of the active blade along its tissue effector is non-zero (i.e., will have at least longitudinal motion along the length extending from its distal end, an antinode of longitudinal motion, to the first nodal position of longitudinal motion that is proximal to the tissue effector portion).

Certain embodiments will now be described to provide an overall understanding of the principles of the structure, function, manufacture, and use of the devices and methods disclosed herein. One or more examples of these embodiments are illustrated in the accompanying drawings. Those of ordinary skill in the art will understand that the devices and methods specifically described herein and illustrated in the accompanying drawings are non-limiting embodiments and that the scope of the various embodiments is defined solely by the claims. The features illustrated or described in connection with one embodiment may be combined with the features of other embodiments. Such modifications and variations are intended to be included within the scope of the claims.

FIG. 1A illustrates one embodiment of an ultrasonic system 10 comprising a single element end effector. One embodiment of the ultrasonic system 10 comprises an ultrasonic signal generator 12 coupled to an ultrasonic transducer 14, a hand piece assembly 60 comprising a hand piece housing 16, and an ultrasonically actuatable single element end effector or ultrasonically actuatable blade 50. The ultrasonic transducer 14, which is known as a "Langevin stack", generally includes a transduction portion 18, a first resonator portion or end-bell 20, and a second resonator portion or fore-bell 22, and ancillary components. The total construction of these components is a resonator. The ultrasonic transducer 14 is preferably an integral number of one-half system wavelengths ($n\lambda/2$; where "n" is any positive integer; e.g., $n=1, 2, 3, \dots$) in length as will be described in more detail later. An acoustic assembly 24 includes the ultrasonic transducer 14, a nose cone 26, a velocity transformer 28, and a surface 30.

It will be appreciated that the terms "proximal" and "distal" are used herein with reference to a clinician gripping the hand piece assembly 60. Thus, the blade 50 is distal with respect to the more proximal hand piece assembly 60. It will be further appreciated that, for convenience and clarity, spatial terms such as "top" and "bottom" also are used herein with respect to the clinician gripping the hand piece assembly 60. However, surgical instruments are used in many orientations and positions, and these terms are not intended to be limiting and absolute.

The distal end of the end-bell 20 is connected to the proximal end of the transduction portion 18, and the proximal end

of the fore-bell 22 is connected to the distal end of the transduction portion 18. The fore-bell 22 and the end-bell 20 have a length determined by a number of variables, including the thickness of the transduction portion 18, the density and modulus of elasticity of the material used to manufacture the end-bell 20 and the fore-bell 22, and the resonant frequency of the ultrasonic transducer 14. The fore-bell 22 may be tapered inwardly from its proximal end to its distal end to amplify the ultrasonic vibration amplitude as the velocity transformer 28, or alternately may have no amplification. A suitable vibrational frequency range may be about 20 Hz to 120 kHz and a well-suited vibrational frequency range may be about 30-100 kHz. A suitable operational vibrational frequency may be approximately 55.5 kHz, for example.

Piezoelectric elements 32 may be fabricated from any suitable material, such as, for example, lead zirconate-titanate, lead meta-niobate, lead titanate, barium titanate, or other piezoelectric ceramic material. Each of positive electrodes 34, negative electrodes 36, and the piezoelectric elements 32 has a bore extending through the center. The positive and negative electrodes 34 and 36 are electrically coupled to wires 38 and 40, respectively. The wires 38 and 40 are encased within a cable 42 and electrically connectable to the ultrasonic signal generator 12 of the ultrasonic system 10.

The ultrasonic transducer 14 of the acoustic assembly 24 converts the electrical signal from the ultrasonic signal generator 12 into mechanical energy that results in primarily a standing acoustic wave of longitudinal vibratory motion of the ultrasonic transducer 14 and the end effector 50 at ultrasonic frequencies. In another embodiment, the vibratory motion of the ultrasonic transducer may act in a different direction. For example, the vibratory motion may comprise a local longitudinal component of a more complicated motion of the tip of the ultrasonic system 10. A suitable generator is available as model number GEN04, from Ethicon Endo-Surgery, Inc., Cincinnati, Ohio. When the acoustic assembly 24 is energized, a vibratory motion standing wave is generated through the acoustic assembly 24. The ultrasonic system 10 is designed to operate at a resonance such that an acoustic standing wave pattern of predetermined amplitude is produced. The amplitude of the vibratory motion at any point along the acoustic assembly 24 depends upon the location along the acoustic assembly 24 at which the vibratory motion is measured. A minimum or zero crossing in the vibratory motion standing wave is generally referred to as a node (i.e., where motion is minimal), and a local absolute value maximum or peak in the standing wave is generally referred to as an anti-node (i.e., where local motion is maximal). The distance between an anti-node and its nearest node is one-quarter wavelength ($\lambda/4$).

The wires 38 and 40 transmit an electrical signal from the ultrasonic signal generator 12 to the positive electrodes 34 and the negative electrodes 36. The piezoelectric elements 32 are energized by the electrical signal supplied from the ultrasonic signal generator 12 in response to an actuator 44, such as a foot switch, for example, to produce an acoustic standing wave in the acoustic assembly 24. The electrical signal causes disturbances in the piezoelectric elements 32 in the form of repeated small displacements resulting in large alternating compression and tension forces within the material. The repeated small displacements cause the piezoelectric elements 32 to expand and contract in a continuous manner along the axis of the voltage gradient, producing longitudinal waves of ultrasonic energy. The ultrasonic energy is transmitted through the acoustic assembly 24 to the single element end effector such as the blade 50 via a transmission component or an ultrasonic transmission waveguide 104.

In order for the acoustic assembly 24 to deliver energy to the single element end effector 50, all components of the acoustic assembly 24 must be acoustically coupled to the blade 50. The distal end of the ultrasonic transducer 14 may be acoustically coupled at the surface 30 to the proximal end of the ultrasonic transmission waveguide 104 by a threaded connection such as a stud 48.

The components of the acoustic assembly 24 are preferably acoustically tuned such that the length of any assembly is an integral number of one-half wavelengths ($n\lambda/2$), where the wavelength λ is the wavelength of a pre-selected or operating longitudinal vibration drive frequency f_d of the acoustic assembly 24. It is also contemplated that the acoustic assembly 24 may incorporate any suitable arrangement of acoustic elements.

The blade 50 may have a length substantially equal to an integral multiple of one-half system wavelengths ($n\lambda/2$). A distal end 52 of the blade 50 may be disposed near an antinode in order to provide the maximum longitudinal excursion of the distal end. When the transducer assembly is energized, the distal end 52 of the blade 50 may be configured to move in the range of, for example, approximately 10 to 500 microns peak-to-peak, and preferably in the range of about 30 to 150 microns at a predetermined vibrational frequency of 55 kHz, for example.

The blade 50 may comprise features to reduce misting. For example, the blade 50 may comprise a tapered concave surface at the distal end 52, a coating formed at the distal end 52, a lumen fluidically coupled to a spraying mechanism, a material to hold an electric charge, or any combination thereof.

The blade 50 may be coupled to the ultrasonic transmission waveguide 104. The blade 50 and the ultrasonic transmission waveguide 104 as illustrated are formed as a single unit construction from a material suitable for transmission of ultrasonic energy. Examples of such materials include Ti6Al4V (an alloy of Titanium including Aluminum and Vanadium), Aluminum, Stainless Steel, or other suitable materials. Alternatively, the blade 50 may be separable (and of differing composition) from the ultrasonic transmission waveguide 104, and coupled by, for example, a stud, weld, glue, quick connect, or other suitable known methods. The length of the ultrasonic transmission waveguide 104 may be substantially equal to an integral number of one-half wavelengths ($n\lambda/2$), for example. The ultrasonic transmission waveguide 104 may be preferably fabricated from a solid core shaft constructed out of material suitable to propagate ultrasonic energy efficiently, such as the titanium alloy discussed above (i.e., Ti6Al4V) or any suitable aluminum alloy, or other alloys, for example.

The ultrasonic transmission waveguide 104 comprises a longitudinally projecting attachment post 54 at a proximal end to couple to the surface 30 of the ultrasonic transmission waveguide 104 by a threaded connection such as the stud 48. In the embodiment illustrated in FIG. 1, the ultrasonic transmission waveguide 104 includes a plurality of stabilizing silicone rings or compliant supports 56 positioned at a plurality of nodes. The silicone rings 56 dampen undesirable vibration and isolate the ultrasonic energy from an outer sheath 58 assuring the flow of ultrasonic energy in a longitudinal direction to the distal end 52 of the blade 50 with maximum efficiency.

As shown in FIG. 1, the outer sheath 58 protects a user of the ultrasonic surgical instrument 10, 100 and a patient from the ultrasonic vibrations of the ultrasonic transmission waveguide 104. The sheath 58 generally includes a hub 62 and an elongated tubular member 64. The tubular member 64 is attached to the hub 62 and has an opening extending lon-

gitudinally therethrough. The sheath 58 is threaded onto the distal end of the housing 16. The ultrasonic transmission waveguide 104 extends through the opening of the tubular member 64 and the silicone rings 56 isolate the ultrasonic transmission waveguide 104 from the outer sheath 58. The outer sheath 58 may be attached to the waveguide 104 with an isolator pin 112. The hole in the waveguide 104 may occur nominally at a displacement. The waveguide 104 may screw or snap onto the hand piece assembly 60 by the stud 48. The flat portions on the hub 62 may allow the assembly to be torqued to a required level.

The hub 62 of the sheath 58 is preferably constructed from plastic and the tubular member 64 is fabricated from stainless steel. Alternatively, the ultrasonic transmission waveguide 104 may comprise polymeric material surrounding it to isolate it from outside contact.

The distal end of the ultrasonic transmission waveguide 104 may be coupled to the proximal end of the blade 50 by an internal threaded connection, preferably at or near an antinode. It is contemplated that the blade 50 may be attached to the ultrasonic transmission waveguide 104 by any suitable means, such as a welded joint or the like. Although the blade 50 may be detachable from the ultrasonic transmission waveguide 104, it is also contemplated that the single element end effector (e.g., the blade 50) and the ultrasonic transmission waveguide 104 may be formed as a single unitary piece.

FIG. 1B illustrates one embodiment of an ultrasonic system 1000 comprising a multi-element end effector. One embodiment of the ultrasonic system 1000 comprises the ultrasonic generator 12 coupled to the ultrasonic transducer 14 described with reference to FIG. 1A. The ultrasonic transducer 14 is coupled to clamped coagulating shears 1002 comprising an instrument housing 1004. The acoustic assembly 18 delivers energy to the end effector 1016 (FIG. 3B) of the multi-element end assembly 1008 of the multi-element instrument. In order for the acoustic assembly 18 to deliver energy to the multi-element end effector or multi-element end assembly 1008, all components of the acoustic assembly 18 must be acoustically coupled to the ultrasonically active portions of the clamped coagulating shears 1002. Accordingly, the distal end of the ultrasonic transducer 14 may be acoustically coupled at the surface 30 to the proximal end of the ultrasonic transmission waveguide 104 by the threaded connection stud 48.

As previously discussed with reference to the ultrasonic system 10 shown in FIG. 1A, the components of the acoustic assembly 18 are preferably acoustically tuned such that the length of any assembly is an integral number of one-half wavelengths ($n\lambda/2$), where the wavelength λ is the wavelength of a pre-selected or operating longitudinal vibration drive frequency f_d of the acoustic assembly 18. The acoustic assembly 18 may incorporate any suitable arrangement of acoustic elements.

FIG. 2 illustrates one embodiment of a connection union/joint 70 for an ultrasonic instrument. The connection union/joint 70 may be formed between the attachment post 54 of the ultrasonic transmission waveguide 104 and the surface 30 of the velocity transformer 28 at the distal end of the acoustic assembly 24. The proximal end of the attachment post 54 comprises a female threaded substantially cylindrical recess 66 to receive a portion of the threaded stud 48 therein. The distal end of the velocity transformer 28 also may comprise a female threaded substantially cylindrical recess 68 to receive a portion of the threaded stud 48. The recesses 66, 68 are substantially circumferentially and longitudinally aligned. In another embodiment (not shown), the stud is an integral component of the end of the ultrasonic transducer. For example,

the treaded stud and the velocity transformer may be of a single unit construction with the stud projecting from a distal surface of the velocity transformer at the distal end of the acoustic assembly. In this embodiment, the stud is not a separate component and does not require a recess in the end of the transducer.

FIG. 3A illustrates an exploded perspective view of one embodiment of a single element end effector ultrasonic surgical instrument **100**. The ultrasonic surgical instrument **100** may be employed with the ultrasonic system **10** illustrated in FIG. 1A. However, as described herein, those of ordinary skill in the art will understand that the various embodiments of the ultrasonic surgical instruments disclosed herein as well as any equivalent structures thereof could conceivably be effectively used in connection with other known ultrasonic surgical instruments without departing from the scope thereof. Thus, the protection afforded to the various ultrasonic surgical blade embodiments disclosed herein should not be limited to use only in connection with the exemplary ultrasonic surgical instrument described above.

In the embodiment illustrated in FIG. 3A, the elongated transmission component is shown as the ultrasonic waveguide **104** and the end effector is shown as a single element end effector or blade **50** suitable to cut and/or coagulate tissue. The blade **50** may be symmetrical or asymmetrical.

The length of the blade **50** may be substantially equal to an integral multiple of one-half system wavelengths ($n\lambda/2$). The distal end **52** of the blade **50** may be disposed near an antinode in order to provide the maximum longitudinal excursion of the distal end **52**. When the transducer assembly is energized, the distal end **52** of the blade **50** may be configured to move in the range of, for example, approximately 10 to 500 microns peak-to-peak, and preferably in the range of about 30 to 150 microns at a predetermined vibrational frequency.

The blade **50** may be coupled to the ultrasonic transmission waveguide **104**. The blade **50** and the ultrasonic transmission waveguide **104** as illustrated are formed as a single unit of construction from a material suitable for transmission of ultrasonic energy such as, for example, Ti6Al4V (an alloy of titanium including aluminum and vanadium), aluminum, stainless steel, other known materials, or combinations thereof. Alternately, the blade **50** may be separable (and of differing composition) from the ultrasonic transmission waveguide **104**, and coupled by, for example, a stud, weld, glue, quick connect, or other suitable known methods. The length of the ultrasonic transmission waveguide **104** may be substantially equal to an integral number of one-half system wavelengths ($n\lambda/2$), for example. The ultrasonic transmission waveguide **104** also may be preferably fabricated from a solid core shaft constructed out of material that propagates ultrasonic energy efficiently, such as titanium alloy (e.g., Ti6Al4V) or an aluminum alloy, for example. The ultrasonic transmission waveguide **104** also may be fabricated from a hollow core shaft constructed out of similar materials. The ultrasonic transmission waveguide **104** also may be fabricated with a combination solid/hollow core shaft, for example, a solid core shaft with hollow cavities positioned at various locations along the length of the shaft.

In the embodiment illustrated in FIG. 3A, the ultrasonic transmission waveguide **104** is positioned within the outer sheath **58** by a mounting O-ring **108** and a sealing ring **110**. In other embodiments, one or more additional dampers or support members (not shown) also may be included along the ultrasonic transmission waveguide **104**. The ultrasonic transmission waveguide **104** is affixed to the outer sheath **58** by the mounting pin **112** that passes through mounting holes **114** in

the outer sheath **58** and a mounting hole **116** formed in the ultrasonic transmission waveguide **104**.

FIG. 3B illustrates one embodiment of the clamped coagulating shears **1002** comprising a multi-element end effector as shown in FIG. 1B. FIG. 3C illustrates a perspective view of the multi-element end effector as shown in FIGS. 1B and 3B. With reference to FIGS. 1B, 3B and 3C, the clamped coagulating shears **1002** may be preferably attached to and removed from the acoustic assembly **18** as a unit. The proximal end of the clamped coagulating shears **1002** preferably acoustically couples to the distal surface **30** of the acoustic assembly **18**. The clamped coagulating shears **1002** may be coupled to the acoustic assembly **18** by any suitable means.

The clamped coagulating shears **1002** preferably includes an instrument housing **1004** and an elongated member **1006**. The elongated member **1006** may be selectively rotated with respect to the instrument housing **1004**. The instrument housing **1004** includes a pivoting handle portion **1028** and a fixed handle portion **1029**.

An indexing mechanism (not shown) is disposed within a cavity of the instrument housing **1004**. The indexing mechanism is preferably coupled or attached on an inner tube **1014** to translate movement of the pivoting handle portion **1028** to linear motion of the inner tube **1014** to open and close the multi-element end assembly **1008**. When the pivoting handle portion **1028** is moved toward the fixed handle portion **1029**, the indexing mechanism slide the inner tube **1014** rearward to pivot the multi-element end assembly **1008** into a closed position. The movement of the pivoting handle portion **1028** in the opposite direction slides the indexing mechanism to displace the inner tube **1014** in the opposite direction, i.e., forwardly, and hence pivot the multi-element end assembly **1008** into its open position in the direction indicated by arrow **1020** as shown in FIG. 3B.

The pivoting handle portion **1028** includes a thumb loop **1030**. A pivot pin **1032** is disposed through a first hole of the pivoting handle portion **1028** to allow pivoting as shown by arrow **1034** in FIG. 3B. As the thumb loop **1030** of the pivoting handle portion **1028** is moved in the direction of arrow **1034**, away from the instrument housing **1004**, the inner tube **1014** slides rearward to pivot the multi-element end assembly **1008** into a closed position.

The elongated member **1006** of the clamped coagulating shears **1002** extends from the instrument housing **1004**. The elongated member **1006** preferably includes an outer member or outer tube **1012**, an inner member or inner tube **1014**, and a transmission component or ultrasonic transmission waveguide **104**.

The multi-element end effector or multi-element end assembly **1008** includes a clamp arm assembly **1018**, a tissue pad **1036**, and an ultrasonic blade **1016**. The clamp arm assembly **1018** is pivotally mounted about a pivot pin (not shown) to rotate in the direction indicated by arrow **1038**. The ultrasonic blade **1016** comprises a tapered concave surface **1040** extending inwardly into the blade body.

The ultrasonic surgical instrument **100** and the clamped coagulating shears **1002** may be sterilized by methods known in the art such as, for example, gamma radiation sterilization, Ethylene Oxide processes, autoclaving, soaking in sterilization liquid, or other known processes. In the embodiment illustrated in FIGS. 1A and 3A, an ultrasonic transmission assembly **102** of the surgical instrument **100** includes the single element ultrasonically actuated end effector or blade **50** coupled to the ultrasonic transmission waveguide **104**. The blade **50** and the ultrasonic transmission waveguide **104** are illustrated as a single unit construction from a material suitable for transmission of ultrasonic energy as previously dis-

cussed (e.g., Ti6Al4V, Aluminum, Stainless Steel, or other known materials). Alternately, the blade 50 may be separable (and of differing composition) from the ultrasonic transmission waveguide 104, and coupled by, for example, a stud, weld, glue, quick connect, or other known methods. In the embodiment illustrated in FIGS. 1B and 3B, the ultrasonic transmission assembly 1024 of the clamped coagulating shears 1002 includes the multi-element end assembly 1008 coupled to the ultrasonic transmission waveguide 104. The length of the ultrasonic transmission waveguide 104 may be substantially equal to an integral number of one-half system wavelengths ($n\lambda/2$), for example. The ultrasonic transmission waveguide 104 may be preferably fabricated from a solid core shaft constructed out of material that propagates ultrasonic energy efficiently, such as titanium alloy (i.e., Ti6Al4V) or an aluminum alloy, for example.

FIGS. 4-22 illustrate various embodiments of ultrasonic blades, which may be considered different embodiments of the single element end effector or the blade 50 or the ultrasonic blade 1016 of the multi-element end assembly 1008 and are generally well-suited for cutting, coagulating, and reshaping tissue. In addition, these blades comprise mist reducing features. The ultrasonic blades may be employed in the above-described ultrasonic systems 10, 1000. Those skilled in the art will appreciate that although the various embodiments of the ultrasonic blades 50, 1016 are well-suited for cutting, coagulating, reshaping tissue, and reducing the mist associated with the previously discussed functions, these ultrasonic blades are multifunctional and may be employed in multiple numerous applications.

FIGS. 4-6 illustrate one embodiment of an ultrasonic blade 120. The ultrasonic blade 120 is generally well-suited for cutting, coagulating, and reshaping tissue. The ultrasonic blade 120 may be employed in various other therapeutic procedures. The ultrasonic blade 120 comprises mist reducing features as described herein. FIG. 4 is a side view of one embodiment of the ultrasonic blade 120. FIG. 5 is a cross-sectional view of one embodiment of the ultrasonic blade 120 taken along line 5-5 in FIG. 4. FIG. 6 is a perspective view of one embodiment of the ultrasonic blade in FIG. 4.

In the embodiment illustrated in FIGS. 4-6, the ultrasonic blade 120 comprises a blade body 122 having a proximal end 132 and a distal end 134. As shown in the cross-sectional view of FIG. 5, the body 122 may have a substantially circular cross section. The blade body 122 may extend along a longitudinal central axis 127. The blade body 122 may comprise a tapered concave surface 121 at the distal end 134 of the blade body 122 which may extend inwardly into the blade body 122. This inward extension may occur such that the blade body has an inwardly tapered concave shaped tip as opposed to a conventional convex shaped tip that extends outwardly or a flat faced tip. The blade body 122 may comprise a substantially elongated treatment region 128 and a neck or transition portion 130 that protrudes from the proximal end 132 of the treatment region 128. The neck portion 130 may be configured to attach to the ultrasonic transmission waveguide 104 by a stud, weld, glue, quick connect, or other suitable attachment methods, for example. In various other embodiments, the ultrasonic blade 120 and the ultrasonic transmission waveguide 104 may be formed as a single unitary body. In either configuration, the ultrasonic transmission waveguide 104 may have gain steps to amplify the mechanical vibrations transmitted to the ultrasonic blade 120 as is well known in the art. The ultrasonic blade 120 is adapted to couple to the ultrasonic transmission waveguide 104, which may be employed with the above-described ultrasonic surgical system 10.

In various embodiments, the tapered concave surface 121 may extend inwardly into the blade body 122 from a first edge 124 which may be located at the distal end 134 of the blade body 122. As previously discussed, the surface 121 may be substantially concave and may be tapered inwardly into the blade body 122. In one embodiment, as illustrated in FIG. 20, the concave surface 121 may comprise a convex portion 123 or "bump" within the concave surface 121. FIG. 20 is a side view of an ultrasonic blade 720 with the convex portion 123 formed within the concave surface 121. For example, the substantially concave surface may have a convex portion 123 or "bump" extending in a direction different from the inward direction of the extension of the surface 121 (see FIG. 20, for example).

The tapered concave surface 121 may be configured to produce a substantially convergent jet 135 of fluid mist, as shown in FIGS. 14A, B, for example. FIG. 14A is a side view of an ultrasonic blade comprising a tapered concave blade tip depicting the convergent jet 135 of fluid mist emanating from the distal end of the blade 120 in direction A. FIG. 14B is a detail view of the convergent jet 135 of fluid mist. The convergent jet 135 may be produced by the tapered concave shape of distal end 134 of the blade body 122. Fluid droplets 139 that collide with the tapered concave shape of the distal end 134 of the blade body 122 will tend to converge rather than diverge as the fluid droplets 139 travel away from the distal end 134 of the blade body 122 in the direction of arrow A. Generally, when the fluid droplets 139 collide with a convex shaped blade tip, the fluid particles 139 tend to produce a substantially divergent jet of fluid mist 137, as shown in FIG. 13A, B, for example. FIG. 13A is a side view of an ultrasonic blade 820 with a convex blade tip depicting a typical divergent jet 137 of fluid mist. FIG. 13B is a detail view of the divergent jet 137 of fluid mist. For example, when fluid particles associated with the surgical site collide with a convex shaped distal end of a blade body, the fluid mist that emanates from the distal end 134 of the blade body in direction A, tends to produce the divergent jet 137 of fluid mist, as shown in FIG. 13A. This fluid mist may limit the visibility at the surgical site. As shown in FIG. 14B, the tapered concave surface 121 may cause the fluid droplets moving in direction A to be directed towards the longitudinal axis 127 where the fluid droplets 141 may collide and coalesce, thus increasing droplet size such that the fluid droplets 141 may drop out under the influence of gravity 142.

With reference now back to FIGS. 4-6, in various embodiments, the distal end 134 may comprise a first edge 124. The first edge 124 may form the base from which the tapered surface 121 extends inwardly into the blade body 122 in the direction B. The first edge 124 may be formed in a variety of shapes including a circle, an ellipse, a square, a rectangle, a pentagon, a hexagon or any suitable polygon. In one embodiment, as shown in FIGS. 4-6, the tapered concave surface 121 defines a conical shape extending inwardly in direction B into the blade body 122. The conical shape may comprise a cone with an apex 126 and a circular base. In other embodiments, the base may be an ellipse, or a polygon (e.g., a pyramid) and may also comprise a right cone (e.g., where a line joining the apex to the center of the base is at a right angle to the base plane) or an oblique cone (e.g., where a line joining the apex to the center of the base is not at a right angle to the base plane). The surface may terminate at the apex 126 within the blade body 122. The conical shape of the tapered concave surface 121 may be symmetrical or asymmetrical. In the embodiment illustrated in FIGS. 4-6, the conical shape is symmetric with the apex located substantially along the longitudinal axis 127. In other embodiments, the conical shape

of the tapered concave surface **121** may be asymmetric with the apex **126** located between an outer edge **159** of the blade body **122** and the longitudinal axis **127**. The tapered concave surface **121** may have a second length between the first edge **124** and the apex **126**. The blade body **122** may have a first length between the proximal end **132** and the distal end **134**. The first length may be at least three times the second length. Vibrations produced along the blade body **122** may be substantially uniform to provide substantially even distribution of energy to the tissue.

In various other embodiments, the tapered concave surface **221** of the blade body **122** may define various other symmetrical or asymmetrical shapes. In one embodiment, as shown in FIGS. 7-9, the tapered concave surface **221** may define a frusto-conical shape. FIG. 7 is a side view of another embodiment of the ultrasonic blade **220**. FIG. 8 is a cross-sectional view of the ultrasonic blade **220** taken along line 8-8 in FIG. 7. FIG. 9 is a perspective view of the ultrasonic blade **220** in FIG. 7. The frusto-conical shape may extend inwardly into the blade body **122** in direction B from the first edge **124**. The frusto-conical shape may comprise all of the characteristics of a cone, as defined above, but may terminate short of a hypothetical apex of the cone, in other words, the frusto-conical shape may be a shape similar to a cone but terminating in a plane **227** substantially orthogonal to the longitudinal axis **127** as opposed to a point along or near the longitudinal axis **127** found in a cone. The tapered concave surface **221** may terminate prior to reaching the hypothetical apex within the blade body **122**. For example, the frusto-conical shape may be a cone with a substantially flat top as opposed to a point. In various other embodiments, the frusto-conical shape may have a rounded top or any other suitable shape for the top portion. In the embodiments illustrated in FIGS. 7-9, the frusto-conical shape of the tapered concave surface **221** is symmetric with the center **131** of the plane **227** located substantially along the longitudinal axis **127**. In other embodiments, the frusto-conical shape of the tapered concave surface **221** may be asymmetric with the center **131** of the plane **227** located between an outer edge **129** of the blade body **122** and the longitudinal axis **127**.

In another embodiment, as shown in FIGS. 10-12, the ultrasonic blade **320** comprises a tapered concave surface **321** defining a partial spheroid extending inwardly into the blade body **122** in the direction B. FIG. 10 is a side view of the ultrasonic blade **320**. FIG. 11 is a cross-sectional view of the ultrasonic blade **320** taken along line 11-11 in FIG. 10. FIG. 12 is a perspective view of the ultrasonic blade **320** in FIG. 10. The partial spheroid may extend inwardly from the first edge **124**, or base, into the blade body **122** in the direction of B. A spheroid may be formed when an ellipse or circle is rotated about an axis. For example, when a circle is rotated about its axis, a spheroid, commonly referred to in this case as a sphere, is formed. When the ellipse is rotated about its major axis a prolate spheroid is formed, and when the ellipse is rotated about its minor axis an oblate spheroid is formed. The tapered concave surface **321** may define at least one of a partial sphere, a partial prolate spheroid, or a partial oblate spheroid. The partial spheroid may be more than half of a spheroid, less than half of a spheroid, or exactly half of a spheroid (e.g., a hemispheroid). The first edge **124** may form a circle or an ellipse which has a center **133** that may be substantially aligned with the longitudinal axis **127**.

In at least one embodiment, the blade may comprise a variety of shapes. For example, the blade may be curved. The blade may be curved in any direction. In addition, the blade may comprise various cross-sections. For example, the blade may comprise a square cross-section. All of these blade

shapes may comprise an axis defined between the proximal end **132** and the distal end **134** of the blade.

FIG. 23 is a perspective view of an asymmetric ultrasonic blade comprising a tapered concave surface extending inwardly into the blade body. More details regarding curved or asymmetric blades are described in U.S. Pat. No. 6,283,981, which is incorporated herein by reference. As shown in FIG. 23, the ultrasonic surgical instrument **10** may comprise an ultrasonic blade **920** and a treatment region **960** that includes a curved blade designed to cut and coagulate tissue. The treatment region **960** may be curved to provide the surgeon with better access and visibility. The treatment region **960** may also comprise a tapered concave surface **921** which may provide a mist reducing feature. As illustrated in FIG. 23, the curved treatment region may be symmetrical about x,z plane, but asymmetrical about x,y plane. The tapered concave surface **921** may extend inwardly into the blade body **922** from a first edge **924** which may extend substantially parallel to the perimeter of the blade tip **923**. In other embodiments, the first edge may be a different shape from the perimeter of the blade tip. For example, the first edge may form a circle when the perimeter of the blade tip forms a trapezoid. The embodiments are not limited in this context.

As previously discussed, in various embodiments, the tapered concave surface may extend inwardly into the blade body **122** in direction B from a first edge **124** either symmetrically or asymmetrically. This extension may occur at or near the longitudinal central axis **127** of the blade body **122**. For example, with respect to the embodiment illustrated in FIGS. 4-6, the surface may extend symmetrically to form or define a right cone or asymmetrically to form or define an oblique cone. FIG. 21 is a side view of an ultrasonic blade **820** with a tapered concave surface **821** extending inwardly into the blade body **122** asymmetrically along direction B. FIG. 22 is a cross-sectional view of the ultrasonic blade **820** taken along line 22-22 in FIG. 21. As shown in FIG. 21, the tapered concave surface **821** extends inwardly from the distal end **134** of the blade **820** to the proximal end **132** of the blade **820** to form a substantially oblique cone. The oblique cone may be formed asymmetrically about the longitudinal axis **127**. For example, the apex **826** of the oblique cone may be offset from the center of the longitudinal axis **127** or the center **143** of the geometric shape formed by the first edge **124**. The surface may form any geometrical shape, which may be formed asymmetrically within the blade body.

In various embodiments, as shown in FIGS. 15A-D, at least a portion **129** of the blade body **122** may comprise a layer of material **150** to minimize the divergent jet **137** of fluid mist (FIGS. 13A, B) associated with the ultrasonic blade **420**. FIG. 15A is a side view of an ultrasonic blade **420** with at least a portion **129** of the ultrasonic blade **420** comprising at least one layer of the material **150** formed thereon. FIG. 15B is cross-sectional view of the ultrasonic blade **420** taken along line 15B-15B in FIG. 15A. FIG. 15C is a detailed view of the ultrasonic blade **420** of FIG. 15A. The coated portion **129** of the blade body **122** may be located at the distal end **134** of the ultrasonic blade **420**. The coated portion **129** of the blade body **122** may comprise at least one layer of a material **150** which acts to globulize fluid particles **152** when they contact the coated portion **129** of the blade body **122**. To globulize refers to creating globules or forming droplets of fluid. The material **150** may have properties which cause the material **150** to repel fluid. For example, the material **150** may be hydrophobic and thus repel fluid which may include irrigation saline, interstitial fluid, blood plasma and a cell.

The globulization of the fluid may be caused by differences between the surface tension of the material **150** and the sur-

face tension of the fluid in contact with the material **150**. The material **150** may have a surface tension which is less than the surface tension of the fluid which may cause the fluid to globulize on the surface of the material **150**. A fluid may form globules or "beads" on surfaces coated with a material where the surface tension of the material **150** on the surface **156** is less than the surface tension of the fluid. The formation of globules may prevent the "wetting" or formation of a layer of fluid spreading over the surface of the coated portion **129** of the blade body **122**. The globules **152** may be pushed off of the blade body **122** through the vibrating motion of the end effector **50** unlike a layer of fluid which may have to be atomized from the surface thus causing a mist to form. The effects of the differences between the surface tension of the material **150** and the surface tension of the fluid may be illustrated in terms of a contact angle formed between a fluid interface and a surface.

FIG. **15D** illustrates a contact angle **156** formed between a fluid interface **157** and a surface **158** of the ultrasonic blade **122** of FIG. **15A**. As shown in FIG. **15D**, the contact angle **156** is the angle at which the fluid interface **157** meets the surface **158** of the material **150**. The contact angle **156** is specific for any given system and is determined by the interactions across the three interfaces. For clarity, the concept is illustrated with a small liquid droplet resting on a flat horizontal solid surface. On extremely hydrophilic surfaces, a water droplet will completely spread (an effective contact angle of 0°). This occurs for surfaces that have a large affinity for water (including materials that absorb water). On many hydrophilic surfaces, water droplets will exhibit contact angles of 10° to 30° , for example. On highly hydrophobic surfaces, which are incompatible with water, one may observe a large contact angle (70° to 90°). Some surfaces have water contact angles as high as 150° or even nearly 180° . On these surfaces, water droplets simply rest on the surface, without actually wetting the surface to any significant extent, for example. These surfaces are termed superhydrophobic and can be obtained on fluorinated surfaces (TEFLON®-like coatings) that have been appropriately micropatterned. The contact angle **156** thus directly provides information on the interaction energy between the surface **156** of the material **150** and the fluid.

In various embodiments, the surface **158** of the material **150** may be hydrophobic or superhydrophobic. The first material **150** may comprise any one of polytetrafluoroethylene (TEFLON®), polypropylene, polyethylene, waxes, polycaprolactone, any combination thereof, or any other suitable hydrophobic or superhydrophobic material. For example, the first material **150** may comprise at least one of a polypropylene wax hydrocarbon mixture or TEFLON®. The first material **150** may be applied to the surface through a variety of coating techniques including dipping, spraying, brushing, drying, melting, sintering, fused curing, and any other suitable method for applying hydrophobic materials. Other methods for applying hydrophobic materials may include material deposition techniques that are well known in the art. More details regarding hydrophobic and superhydrophobic materials and methods for applying those materials to a surface are described by U.S. Pat. Nos. 7,041,088 and 6,663,941, which are incorporated herein by reference.

In various other embodiments, as shown in FIGS. **16-17**, at least a portion of the blade body **122** may be coated with at least two materials which may allow an electric charge to be carried by at least one of the materials. FIG. **16** is a side view of an ultrasonic blade **520** with portions of the blade body **122** coated with more than one material to provide an electric charge to the distal end **134** of the blade body **122**. FIG. **17** is cross-sectional view of the ultrasonic blade **520** taken along

line **17-17** in FIG. **16**. At least a first portion **129** of the blade body **122** may comprise at least one layer of a first material **160**. This first material **160** may contact at least a portion of a second material **162**. The first material **160** may comprise a material suitable to carry an electric charge. The electric charge carried by the first material **160** may be the same as the nominal electric charge carried by the fluid. The similar electric charges may cause the portion **129** of the blade body **122** covered with the first material to repel the fluid. For example, if the first material **160** has a positive charge and the fluid has a positive charge, the fluid will be repelled by the first material **160**. Accordingly, the first material **160** acts as a hydrophobic surface. The first material **160** may receive its electrical charge carried by wires from an electrical source located at or near the proximal end **132** of the blade body **122**. For example, the electrical source may comprise a direct current ("DC") electrical source (e.g., a battery). In another embodiment, the electrical source may be located in a different location. The wires may be provided within a bore formed in the ultrasonic blade **520** or maybe provided along the outside of the ultrasonic blade **520** within a channel or conduit. The misting effect may be reduced because the fluid is repelled from the surface of the first material **160**. Accordingly, there is minimal fluid on the surface of the blade body **122** to be atomized by the ultrasonically activated blade **520**.

At least a second portion of the blade body **122** comprises at least one layer of a second material **162**. The second material **162** may comprise an electrically insulative material. The second material **162** may be located between the first material **160** and the blade body **122**. The second material **162** may insulate the blade **520**, and the blade body **122**, from electrical charges. The second material **162** may be an electret material which may be made from silicon dioxide, fluoropolymer, polypropylene or any other suitable material. These materials may hold a constant or slow decaying charge. The first material **160** may be a metallic layer or a vapor deposited layer acting as a floating conductor wherein wires may not be required to convey a charge to the second material **162** from an electrical source.

In another embodiment, the electric charge carried by the first material **160** may be the opposite polarity as the nominal electric charge carried by the fluid. The opposite electric charges may cause the portion **129** of the blade body **122** covered with the first material to attract the fluid. For example, if the first material **160** has a negative charge and the fluid has a positive charge, the fluid will be attracted by the first material **160**. Accordingly, the first material **160** acts as a hydrophilic surface. Accordingly, electric charge on the coating materials may be selected such that they exhibit opposite charges to that of the fluid to create attraction rather than repulsion between the blade body **122** and the fluid. This may enable surgical "smoke" or mist to globulize as it collects on the surface of the blade body **122**. In addition, this technique may be employed to attract other materials or constituents, such as, drug molecules, fibrin, and natural adhesives to the treatment site. These other materials or constituents may be introduced in a liquid suspension. The difference in charges between the blade body **122** and the fluid would act to concentrate these other materials or constituents in the vicinity of the distal end of the blade body **122**.

In various embodiments, as shown in FIGS. **18-19**, a blade **620** may comprise a bore **180** (e.g., a lumen). FIG. **18** is a side view of the ultrasonic blade **620** with a longitudinally extending bore **180**. FIG. **19** is cross-sectional view of the ultrasonic blade **620** taken along line **19-19** in FIG. **18**. The bore **180** may extend longitudinally along the longitudinal axis **127**, or, in certain embodiments, the bore may extend in a different

direction. The bore **180** may be formed within the blade **620**. The ultrasonic blade **620** may be configured to emit a spray via the bore **180** in a direction indicated by arrow **640** at the distal end **134** of the blade **620**. The spray may emanate from a spray source **161** located at or near the proximal end **132** of the blade **620** and travel in the flow direction **640**. The flow direction **640** may be from the proximal end **132** to the distal end of the blade **620**. In another embodiment, the spray source **161** may be found in other locations. The spray emanating from the distal end **134** of the blade **620** may substantially prevent fluid from contacting the distal end **134** of the blade **620**. This prevention of contact may reduce the mist as a layer of fluid may not be present on the blade **620** for atomization. The spray may comprise a gas. For example, the gas may be carbon dioxide, air or some other suitable gas.

The ultrasonic blade **120** comprises a treatment region **128** that is suitable to effect tissue, such as, for example, cut, coagulate, reshape, scrape, and remove tissue. A distal end **134** of the treatment region **128** may also comprise a tip with a cutting edge. Additional cutting edges may be positioned laterally along both sides of the treatment region **128**. In one embodiment, the cutting edges extend from the proximal end **132** to the distal end **134** of the treatment region **128**.

The ultrasonic blades as discussed herein may be fabricated from a material suitable for transmission of ultrasonic energy such as, for example, Ti6Al4V, Aluminum, Stainless Steel, or other known materials. The ultrasonic blade may be used in a single-element end effector (e.g., a scalpel, hook, or ball coagulator) as discussed with reference to ultrasonic system **10** and FIGS. **1A**, **2** and **3A**, or a multiple-element end effector (e.g., clamping coagulating shears) as discussed with reference to ultrasonic system **1000** and FIGS. **1B**, **3B**, and **3C**, for example.

The devices disclosed herein can be designed to be disposed of after a single use, or they can be designed to be used multiple times. In either case, however, the device can be reconditioned for reuse after at least one use. Reconditioning can include any combination of the steps of disassembly of the device, followed by cleaning or replacement of particular pieces, and subsequent reassembly. In particular, the device can be disassembled, and any number of the particular pieces or parts of the device can be selectively replaced or removed in any combination. Upon cleaning and/or replacement of particular parts, the device can be reassembled for subsequent use either at a reconditioning facility, or by a surgical team immediately prior to a surgical procedure. Those skilled in the art will appreciate that reconditioning of a device can utilize a variety of techniques for disassembly, cleaning/replacement, and reassembly. Use of such techniques, and the resulting reconditioned device, are all within the scope of the present application.

Preferably, the various embodiments described herein will be processed before surgery. First, a new or used instrument is obtained and if necessary cleaned. The instrument can then be sterilized. In one sterilization technique, the instrument is placed in a closed and sealed container, such as a plastic or TYVEK® bag. The container and instrument are then placed in a field of radiation that can penetrate the container, such as gamma radiation, x-rays, or high-energy electrons. The radiation kills bacteria on the instrument and in the container. The sterilized instrument can then be stored in the sterile container. The sealed container keeps the instrument sterile until it is opened in the medical facility.

It is preferred that the device is sterilized. This can be done by any number of ways known to those skilled in the art including beta or gamma radiation, ethylene oxide, steam.

Although various embodiments have been described herein, many modifications and variations to those embodiments may be implemented. For example, different types of end effectors may be employed. In addition, combinations of the described embodiments may be used. For example, a concave blade tip may be coated with a hydrophobic material. Also, where materials are disclosed for certain components, other materials may be used. The foregoing description and following claims are intended to cover all such modification and variations.

Any patent, publication, or other disclosure material, in whole or in part, that is said to be incorporated by reference herein is incorporated herein only to the extent that the incorporated materials does not conflict with existing definitions, statements, or other disclosure material set forth in this disclosure. As such, and to the extent necessary, the disclosure as explicitly set forth herein supersedes any conflicting material incorporated herein by reference. Any material, or portion thereof, that is said to be incorporated by reference herein, but which conflicts with existing definitions, statements, or other disclosure material set forth herein will only be incorporated to the extent that no conflict arises between that incorporated material and the existing disclosure material.

What is claimed is:

1. A surgical instrument for the treatment of tissue, comprising:

a transducer configured to produce vibrations at a predetermined frequency;

an ultrasonic blade extending along a longitudinal axis coupled to the transducer, wherein the ultrasonic blade comprises:

a substantially solid, substantially cylindrical blade body without a channel and having a first length, wherein the substantially solid, substantially cylindrical blade body comprises a proximal end and a distal end, wherein the distal end is movable relative to the longitudinal axis by the vibrations produced by the transducer;

a treatment region extending from the proximal end to the distal end; and

a tapered inner concave surface forming a conical shape formed at the distal end extending inwardly into the substantially solid, substantially cylindrical blade body substantially along the longitudinal axis, wherein the conical shape comprises an apex within the substantially solid, substantially cylindrical blade body, wherein the tapered inner concave surface terminates at or before the apex of the conical shape, wherein the tapered inner concave surface comprises a second length between the distal end and the apex, wherein the first length is at least three times the second length such that vibrations produced along the substantially solid, substantially cylindrical blade body are substantially uniform to provide substantially even distribution of energy to the tissue, and wherein the tapered inner concave surface is configured to cause fluid droplets to converge along the longitudinal axis when the fluid droplets collide with the tapered inner concave surface to enhance visibility of a surgical site by reducing a mist plume produced by fluids contacting a surface of the energized ultrasonic blade during ultrasonic surgical procedures.

2. The surgical instrument of claim 1, wherein the ultrasonic blade further comprises:
 - a first edge; and
 - a substantially circular cross-section.
3. The surgical instrument of claim 2, wherein the first edge forms a base of the tapered inner concave surface.
4. The surgical instrument of claim 2, wherein the treatment region comprises at least one coagulating edge.
5. The surgical instrument of claim 1, wherein the tapered inner concave surface is asymmetric.
6. The surgical instrument of claim 1, wherein the tapered inner concave surface is substantially concave and comprises a convex portion.
7. The surgical instrument of claim 1, wherein the tapered inner concave surface terminates at the apex within the substantially solid, substantially cylindrical blade body.
8. The surgical instrument of claim 1, wherein the tapered inner concave surface terminates prior to reaching the apex within the substantially solid, substantially cylindrical blade body.
9. The surgical instrument of claim 1, wherein the treatment region comprises at least one cutting edge.
10. An ultrasonic surgical blade for the treatment of tissue, comprising:
 - a substantially solid, substantially cylindrical blade body defining a longitudinal axis, the substantially solid, substantially cylindrical blade body without a channel and having a first length, wherein the substantially solid, substantially cylindrical blade body comprises a proximal end and a distal end, wherein the distal end is movable relative to the longitudinal axis by the vibrations produced by a transducer;
 - a treatment region extending from the proximal end to the distal end; and
 - a tapered inner concave surface forming a conical shape formed at the distal end extending inwardly into the substantially solid, substantially cylindrical blade body substantially along the longitudinal axis, wherein the conical shape comprises an apex within the substantially solid, substantially cylindrical blade body, wherein the tapered inner concave surface terminates at or before the apex of the conical shape, wherein the tapered inner concave surface comprises a second length between the distal end and the apex, wherein the first length is at least three times the second length such that vibrations produced along the substantially solid, substantially cylindrical blade body are substantially uniform to provide substantially even distribution of energy to the tissue, and wherein the tapered inner concave surface is configured to cause fluid droplets to converge along the longitudinal axis when the fluid droplets collide with the tapered inner concave surface to enhance visibility of a surgical site by reducing a mist plume produced by fluids contacting a surface of the energized ultrasonic blade during ultrasonic surgical procedures.
11. The ultrasonic surgical blade of claim 10, wherein the ultrasonic blade further comprises:
 - a first edge; and
 - a substantially circular cross-section.
12. The ultrasonic surgical blade of claim 11, wherein the first edge forms a base of the tapered inner concave surface.
13. The ultrasonic surgical blade of claim 11, wherein the treatment region comprises at least one coagulating edge.
14. The ultrasonic surgical blade of claim 10, wherein the tapered inner concave surface is asymmetric.

15. The ultrasonic surgical blade of claim 10, wherein the tapered inner concave surface is substantially concave and comprises a convex portion.
16. The ultrasonic surgical blade of claim 10, wherein the tapered inner concave surface terminates at the apex within the substantially solid, substantially cylindrical blade body.
17. The ultrasonic surgical blade of claim 10, wherein the tapered inner concave surface terminates prior to reaching the apex within the substantially solid, substantially cylindrical blade body.
18. The ultrasonic surgical blade of claim 17, wherein the tapered inner concave surface terminates at a plane substantially orthogonal to the longitudinal axis.
19. The ultrasonic surgical blade of claim 10, wherein the treatment region comprises at least one cutting edge.
20. The ultrasonic surgical blade of claim 10, wherein the tapered inner concave surface terminates at a partial ellipsoid surface.
21. The ultrasonic surgical blade of claim 10, wherein the treatment region comprises a curved blade.
22. An ultrasonic surgical blade for the treatment of tissue, comprising:
 - an elongated, substantially solid blade body having a first length and comprising a proximal end and a distal end, wherein the elongated, substantially solid blade body is configured to acoustically couple to an acoustic assembly configured to produce vibratory motion in the elongated, substantially solid blade body;
 - a treatment region; and
 - a first edge at the distal end of the elongated, substantially solid blade body;
 - a tapered inner concave surface defining a cavity that extends along an axis into the elongated, substantially solid blade body from the first edge, wherein the cavity terminates at a proximal end of the tapered inner concave surface and has a second length between the first edge and the proximal end, wherein the first length is at least three times the second length such that vibrations produced along the elongated, substantially solid blade body are substantially uniform to provide substantially even distribution of energy to the tissue, and wherein the tapered inner concave surface is configured to cause fluid droplets to converge along the axis when the fluid droplets collide with the tapered inner concave surface when the elongated, substantially solid blade body is in vibratory motion to enhance visibility of a surgical site.
23. The ultrasonic surgical blade of claim 22, wherein the cavity is substantially concave and comprises a convex portion, and wherein the convex portion comprises a partial ellipsoid surface.
24. The ultrasonic surgical blade of claim 22, wherein the tapered inner concave surface is configured to cause fluid droplets to converge along the axis at a point beyond the distal end of the elongated, substantially solid blade body.
25. The ultrasonic surgical blade of claim 22, wherein the cavity terminates at a plane substantially orthogonal to the longitudinal axis.
26. The ultrasonic surgical blade of claim 22, wherein the treatment region comprises a curved blade.
27. An ultrasonic surgical blade for the treatment of tissue, comprising:
 - an elongated, substantially solid blade body having a first length and comprising a proximal end and a distal end, wherein the proximal end is configured to acoustically couple to an acoustic assembly configured to produce vibratory motion in the elongated, substantially solid blade body;

21

a treatment region;
a first edge at the distal end of the elongated, substantially
solid blade body; and
a cavity comprising a taper, wherein the cavity extends
along an axis into the elongated, substantially solid
blade body from the first edge, wherein the cavity ter-
minates at a proximal end of the taper and has a second
length between the first edge and the proximal end,
wherein the first length is at least three times the second
length such that vibrations produced along the elon-
gated, substantially solid blade body are substantially
uniform to provide even distribution of energy to the
tissue, and wherein the cavity is configured to cause fluid
droplets to converge along the axis when the fluid drop-
lets collide with the cavity when the elongated, substan-
tially solid blade body is in vibratory motion to enhance
visibility of a surgical site.

22

28. The ultrasonic surgical blade of claim **27**, wherein the
cavity is substantially concave and comprises a convex por-
tion, and wherein the convex portion comprises a partial
ellipsoid surface.

29. The ultrasonic surgical blade of claim **27**, wherein the
cavity is configured to cause fluid droplets to converge along
the axis at a point beyond the distal end.

30. The ultrasonic surgical blade of claim **27**, wherein the
cavity terminates at a plane substantially orthogonal to the
longitudinal axis.

31. The ultrasonic surgical blade of claim **27**, wherein the
treatment region comprises a curved blade designed to cut
and coagulate tissue.

* * * * *