



US009764164B2

(12) **United States Patent**
Wiener et al.

(10) **Patent No.:** **US 9,764,164 B2**
(45) **Date of Patent:** **Sep. 19, 2017**

(54) **ULTRASONIC SURGICAL INSTRUMENTS**

(56) **References Cited**

(71) Applicant: **Ethicon Endo-Surgery, Inc.**,
Cincinnati, OH (US)

U.S. PATENT DOCUMENTS

(72) Inventors: **Eitan T. Wiener**, Cincinnati, OH (US);
Shan Wan, Mason, OH (US); **Daniel W. Price**,
Loveland, OH (US); **David K. Norvell**, Monroe,
OH (US); **James R. Giordano**, Milford, OH (US)

969,528 A 9/1910 Disbrow
1,570,025 A 1/1926 Young
(Continued)

FOREIGN PATENT DOCUMENTS

AU 2003241752 A1 9/2003
CA 2535467 A1 4/1993
(Continued)

(73) Assignee: **Ethicon LLC**, Guaynabo, PR (US)

(*) Notice: Subject to any disclaimer, the term of this
patent is extended or adjusted under 35
U.S.C. 154(b) by 598 days.

OTHER PUBLICATIONS

AST Products, Inc., "Principles of Video Contact Angle Analysis,"
20 pages, (2006).

(Continued)

(21) Appl. No.: **14/136,836**

(22) Filed: **Dec. 20, 2013**

Primary Examiner — Michael Peffley
Assistant Examiner — Khadijeh Vahdat

(65) **Prior Publication Data**

US 2014/0107538 A1 Apr. 17, 2014

(57) **ABSTRACT**

Related U.S. Application Data

(62) Division of application No. 12/503,769, filed on Jul.
15, 2009, now Pat. No. 8,663,220.

(51) **Int. Cl.**
A61B 18/14 (2006.01)
A61N 7/00 (2006.01)
(Continued)

(52) **U.S. Cl.**
CPC **A61N 7/00** (2013.01); **A61B 17/320092**
(2013.01); **A61B 18/1445** (2013.01);
(Continued)

(58) **Field of Classification Search**
CPC .. A61B 17/320092; A61B 2017/00367; A61B
2017/00393; A61B 18/14;
(Continued)

A surgical instrument comprising a housing, an acoustic assembly configured to produce vibrations, and a waveguide coupled to the acoustic assembly is disclosed. The surgical instrument further comprises an ultrasonic blade extending from the waveguide and a clamp movable between an open position and a closed position relative to the waveguide. The clamp comprises an electrically non-conductive pad, a first electrode embedded in the electrically non-conductive pad, and a second electrode embedded in the electrically non-conductive pad, wherein the first electrode and the second electrode longitudinally overlap a tissue treatment area of the ultrasonic blade when the clamp is in the closed position. The surgical instrument further comprises a first conductor and a second conductor, wherein the first conductor and the second conductor are configured to be placed in electrical communication with a power source such that current can flow from the first electrode to the second electrode.

10 Claims, 15 Drawing Sheets

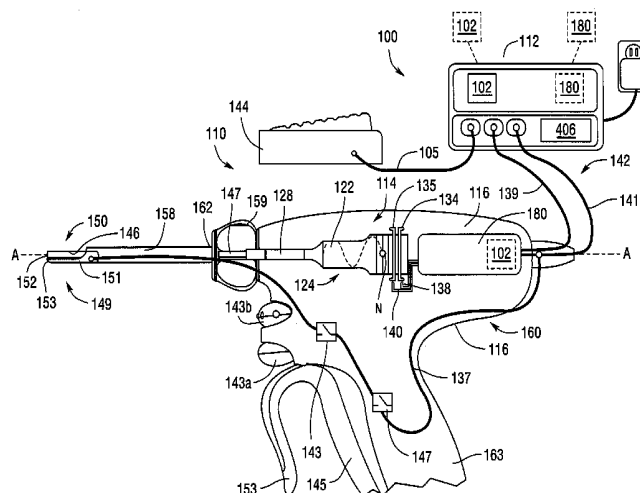

(51)	Int. Cl.		4,445,063 A	4/1984	Smith
	<i>A61B 17/32</i>	(2006.01)	4,491,132 A	1/1985	Aikins
	<i>A61B 17/00</i>	(2006.01)	4,494,759 A	1/1985	Kieffer
	<i>A61B 18/00</i>	(2006.01)	4,504,264 A	3/1985	Kelman
(52)	U.S. Cl.		4,512,344 A	4/1985	Barber
	CPC	<i>A61B 2017/00367</i> (2013.01); <i>A61B 2017/00393</i> (2013.01); <i>A61B 2018/00702</i> (2013.01); <i>A61B 2018/00875</i> (2013.01); <i>A61B 2018/00916</i> (2013.01)	4,526,571 A	7/1985	Wuchinich
			4,545,374 A	10/1985	Jacobson
			4,574,615 A	3/1986	Bower et al.
			4,617,927 A	10/1986	Manes
			4,633,119 A	12/1986	Thompson
			4,634,420 A	1/1987	Spinosa et al.
			4,640,279 A	2/1987	Beard
(58)	Field of Classification Search		4,641,053 A	2/1987	Takeda
	CPC	<i>A61B 18/1445</i> ; <i>A61B 2018/00702</i> ; <i>A61B 2018/00875</i> ; <i>A61B 2018/00916</i> ; <i>A61N 7/00</i>	4,646,738 A	3/1987	Trott
			4,646,756 A	3/1987	Watmough et al.
			4,649,919 A	3/1987	Thimsen et al.
	USPC	606/33-42	4,662,068 A	5/1987	Polonsky
	See application file for complete search history.		4,674,502 A	6/1987	Imonti
			4,708,127 A	11/1987	Abdelghani
			4,712,722 A	12/1987	Hood et al.
(56)	References Cited		4,808,154 A	2/1989	Freeman
	U.S. PATENT DOCUMENTS		4,819,635 A	4/1989	Shapiro
			4,827,911 A	5/1989	Broadwin et al.
			4,832,683 A	5/1989	Idemoto et al.
			4,836,186 A	6/1989	Scholz
			4,838,853 A	6/1989	Parisi
			4,844,064 A	7/1989	Thimsen et al.
			4,850,354 A	7/1989	McGurk-Burleson et al.
			4,852,578 A	8/1989	Companion et al.
			4,865,159 A	9/1989	Jamison
			4,867,157 A	9/1989	McGurk-Burleson et al.
			4,878,493 A	11/1989	Pasternak et al.
			4,881,550 A	11/1989	Kothe
			4,896,009 A	1/1990	Pawlowski
			4,903,696 A	2/1990	Stasz et al.
			4,915,643 A	4/1990	Samejima et al.
			4,922,902 A	5/1990	Wuchinich et al.
			4,965,532 A	10/1990	Sakurai
			4,979,952 A	12/1990	Kubota et al.
			4,981,756 A	1/1991	Rhandhawa
			5,013,956 A	5/1991	Kurozumi et al.
			5,015,227 A	5/1991	Broadwin et al.
			5,026,370 A	6/1991	Lottick
			5,026,387 A	6/1991	Thomas
			5,042,707 A	8/1991	Taheri
			5,084,052 A	1/1992	Jacobs
			5,105,117 A	4/1992	Yamaguchi
			5,109,819 A	5/1992	Custer et al.
			5,112,300 A	5/1992	Ureche
			5,123,903 A	6/1992	Quaid et al.
			5,126,618 A	6/1992	Takahashi et al.
			D327,872 S	7/1992	McMills et al.
			5,152,762 A	10/1992	McElhenney
			5,162,044 A	11/1992	Gahn et al.
			5,163,421 A	11/1992	Bernstein et al.
			5,163,537 A	11/1992	Radev
			5,167,619 A *	12/1992	Wuchinich <i>A61B 17/164</i> 604/22
			5,167,725 A	12/1992	Clark et al.
			5,172,344 A	12/1992	Ehrlich
			5,174,276 A	12/1992	Crockard
			D332,660 S	1/1993	Rawson et al.
			5,176,677 A	1/1993	Wuchinich
			5,176,695 A	1/1993	Dulebohn
			5,184,605 A	2/1993	Grzeszykowski
			5,188,102 A	2/1993	Idemoto et al.
			D334,173 S	3/1993	Liu et al.
			5,209,719 A	5/1993	Baruch et al.
			5,213,569 A	5/1993	Davis
			5,214,339 A	5/1993	Naito
			5,218,529 A	6/1993	Meyer et al.
			5,221,282 A	6/1993	Wuchinich
			5,222,937 A	6/1993	Kagawa
			5,226,909 A	7/1993	Evans et al.
			5,226,910 A	7/1993	Kajiyama et al.
			5,241,236 A	8/1993	Sasaki et al.
			5,241,968 A	9/1993	Slater
			5,242,460 A	9/1993	Klein et al.
			5,254,129 A	10/1993	Alexander

(56)

References Cited

U.S. PATENT DOCUMENTS

5,257,988 A	11/1993	L'Esperance, Jr.	5,618,304 A	4/1997	Hart et al.
5,261,922 A	11/1993	Hood	5,618,492 A	4/1997	Auten et al.
5,263,957 A	11/1993	Davison	5,620,447 A	4/1997	Smith et al.
5,264,925 A	11/1993	Shipp et al.	5,626,587 A	5/1997	Bishop et al.
5,275,166 A	1/1994	Vaitekunas et al.	5,626,595 A	5/1997	Sklar et al.
5,275,607 A	1/1994	Lo et al.	5,628,760 A	5/1997	Knoepfler
5,275,609 A	1/1994	Pingleton et al.	5,630,420 A	5/1997	Vaitekunas
5,282,800 A	2/1994	Foshee et al.	5,632,717 A	5/1997	Yoon
5,282,817 A	2/1994	Hoogetboom et al.	5,640,741 A	6/1997	Yano
5,285,795 A	2/1994	Ryan et al.	D381,077 S	7/1997	Hunt
5,300,068 A	4/1994	Rosar et al.	5,649,937 A	7/1997	Bitto
5,304,115 A	4/1994	Pflueger et al.	5,651,780 A	7/1997	Jackson et al.
D347,474 S	5/1994	Olson	5,653,713 A	8/1997	Michelson
5,307,976 A	5/1994	Olson et al.	5,662,662 A	9/1997	Bishop et al.
5,312,023 A	5/1994	Green et al.	5,669,922 A	9/1997	Hood
5,312,425 A	5/1994	Evans et al.	5,674,235 A	10/1997	Parisi
5,322,055 A	6/1994	Davison et al.	5,678,568 A	10/1997	Uchikubo et al.
5,324,299 A	6/1994	Davison et al.	5,690,269 A	11/1997	Bolanos et al.
5,326,013 A	7/1994	Green et al.	5,694,936 A	12/1997	Fujimoto et al.
5,326,342 A	7/1994	Pflueger et al.	5,700,261 A	12/1997	Brinkerhoff
5,344,420 A	9/1994	Hilal et al.	5,704,534 A	1/1998	Huitema et al.
5,345,937 A	9/1994	Middleman et al.	5,709,680 A	1/1998	Yates et al.
5,346,502 A	9/1994	Estabrook et al.	5,711,472 A	1/1998	Bryan
5,353,474 A	10/1994	Good et al.	5,713,896 A	2/1998	Nardella
5,357,164 A	10/1994	Imabayashi et al.	5,715,817 A	2/1998	Stevens-Wright et al.
5,357,423 A	10/1994	Weaver et al.	5,717,306 A	2/1998	Shipp
5,359,994 A	11/1994	Krauter et al.	5,728,130 A	3/1998	Ishikawa et al.
5,366,466 A	11/1994	Christian et al.	5,730,752 A	3/1998	Alden et al.
5,368,557 A	11/1994	Nita et al.	5,733,074 A	3/1998	Stöck et al.
5,370,645 A	12/1994	Klicek et al.	5,741,226 A	4/1998	Strukel et al.
5,371,429 A	12/1994	Manna	5,766,164 A	6/1998	Mueller et al.
5,374,813 A	12/1994	Shipp	5,772,659 A	6/1998	Becker et al.
D354,564 S	1/1995	Medema	5,792,135 A	8/1998	Madhani et al.
5,381,067 A	1/1995	Greenstein et al.	5,792,138 A	8/1998	Shipp
5,387,215 A	2/1995	Fisher	5,792,165 A	8/1998	Klieman et al.
5,389,098 A	2/1995	Tsuruta et al.	5,797,959 A	8/1998	Castro et al.
5,394,187 A	2/1995	Shipp	5,805,140 A	9/1998	Rosenberg et al.
5,396,266 A	3/1995	Brimhall	5,808,396 A	9/1998	Boukhny
5,403,312 A	4/1995	Yates et al.	5,810,859 A	9/1998	DiMatteo et al.
5,403,334 A	4/1995	Evans et al.	5,817,084 A	10/1998	Jensen
5,408,268 A	4/1995	Shipp	5,817,119 A	10/1998	Klieman et al.
D358,887 S	5/1995	Feinberg	5,823,197 A	10/1998	Edwards
5,411,481 A	5/1995	Allen et al.	5,827,323 A	10/1998	Klieman et al.
5,419,761 A	5/1995	Narayanan et al.	5,828,160 A	10/1998	Sugishita
5,421,829 A	6/1995	Olichney et al.	5,833,696 A	11/1998	Whitfield et al.
5,423,844 A	6/1995	Miller	5,836,897 A	11/1998	Sakurai et al.
5,438,997 A	8/1995	Sieben et al.	5,836,957 A	11/1998	Schulz et al.
5,445,639 A	8/1995	Kuslich et al.	5,843,109 A	12/1998	Mehta et al.
5,449,370 A	9/1995	Vaitekunas	5,851,212 A	12/1998	Zirps et al.
5,451,220 A	9/1995	Ciervo	5,858,018 A	1/1999	Shipp et al.
5,456,684 A	10/1995	Schmidt et al.	5,873,873 A	2/1999	Smith et al.
5,471,988 A	12/1995	Fujio et al.	5,873,882 A	2/1999	Straub et al.
5,472,443 A	12/1995	Cordis et al.	5,878,193 A	3/1999	Wang et al.
5,478,003 A	12/1995	Green et al.	5,879,364 A	3/1999	Bromfield et al.
5,483,501 A	1/1996	Park et al.	5,883,615 A	3/1999	Fago et al.
5,486,162 A	1/1996	Brumbach	5,893,835 A	4/1999	Witt et al.
5,490,860 A	2/1996	Middle et al.	5,897,523 A	4/1999	Wright et al.
5,500,216 A	3/1996	Julian et al.	5,897,569 A	4/1999	Kellogg et al.
5,501,654 A	3/1996	Failla et al.	5,903,607 A	5/1999	Tailliet
5,505,693 A	4/1996	Mackool	5,904,681 A	5/1999	West, Jr.
5,507,738 A	4/1996	Ciervo	5,906,627 A	5/1999	Spaulding
5,527,331 A	6/1996	Kresch et al.	5,906,628 A	5/1999	Miyawaki et al.
5,540,693 A	7/1996	Fisher	5,911,699 A	6/1999	Anis et al.
5,553,675 A	9/1996	Pitzen et al.	5,916,229 A	6/1999	Evans
5,558,671 A	9/1996	Yates	5,929,846 A	7/1999	Rosenberg et al.
5,562,609 A	10/1996	Brumbach	5,935,143 A	8/1999	Hood
5,562,610 A	10/1996	Brumbach	5,935,144 A	8/1999	Estabrook
5,562,659 A	10/1996	Morris	5,938,633 A	8/1999	Beaupre
5,573,424 A	11/1996	Poppe	5,944,718 A	8/1999	Austin et al.
5,577,654 A	11/1996	Bishop	5,944,737 A	8/1999	Tsonton et al.
5,591,187 A	1/1997	Dekel	5,947,984 A	9/1999	Whipple
5,593,414 A	1/1997	Shipp et al.	5,954,736 A	9/1999	Bishop et al.
5,601,601 A	2/1997	Tal et al.	5,954,746 A	9/1999	Holthaus et al.
5,603,773 A	2/1997	Campbell	5,957,882 A	9/1999	Nita et al.
5,607,436 A	3/1997	Pratt et al.	5,957,943 A	9/1999	Vaitekunas
			5,968,007 A	10/1999	Simon et al.
			5,968,060 A	10/1999	Kellogg
			5,974,342 A	10/1999	Petrofsky
			D416,089 S	11/1999	Barton et al.

(56)

References Cited

U.S. PATENT DOCUMENTS

5,980,510 A	11/1999	Tsonton et al.	6,270,831 B2	8/2001	Kumar et al.
5,980,546 A	11/1999	Hood	6,273,852 B1	8/2001	Lehe et al.
5,989,274 A	11/1999	Davison et al.	6,274,963 B1	8/2001	Estabrook et al.
5,989,275 A	11/1999	Estabrook et al.	6,277,115 B1	8/2001	Saadat
5,993,465 A	11/1999	Shipp et al.	6,278,218 B1	8/2001	Madan et al.
5,993,972 A	11/1999	Reich et al.	6,280,407 B1	8/2001	Manna et al.
5,994,855 A	11/1999	Lundell et al.	6,283,981 B1	9/2001	Beaupre
6,024,741 A	2/2000	Williamson, IV et al.	6,287,344 B1	9/2001	Wampler et al.
6,024,750 A	2/2000	Mastri et al.	6,290,575 B1	9/2001	Shipp
6,027,515 A	2/2000	Cimino	6,299,591 B1	10/2001	Banko
6,031,526 A	2/2000	Shipp	6,306,131 B1	10/2001	Hareyama
6,033,375 A	3/2000	Brumbach	6,306,157 B1	10/2001	Shchervinsky
6,033,399 A	3/2000	Gines	6,309,400 B2	10/2001	Beaupre
6,036,667 A	3/2000	Manna et al.	6,311,783 B1	11/2001	Harpell
6,036,707 A	3/2000	Spaulding	6,319,221 B1	11/2001	Savage et al.
6,048,224 A	4/2000	Kay	6,325,795 B1	12/2001	Lindemann et al.
6,050,943 A	4/2000	Slayton et al.	6,325,799 B1	12/2001	Goble
6,051,010 A	4/2000	DiMatteo et al.	6,325,811 B1	12/2001	Messerly
6,056,735 A	5/2000	Okada et al.	6,328,751 B1	12/2001	Beaupre
6,063,098 A	5/2000	Houser et al.	6,332,891 B1	12/2001	Himes
6,066,132 A	5/2000	Chen et al.	6,338,657 B1	1/2002	Harper et al.
6,066,151 A	5/2000	Miyawaki et al.	6,340,352 B1	1/2002	Okada et al.
6,068,627 A	5/2000	Orszulak et al.	6,350,269 B1	2/2002	Shipp et al.
6,068,647 A	5/2000	Witt et al.	6,352,532 B1	3/2002	Kramer et al.
6,077,285 A	6/2000	Boukhny	6,358,264 B2	3/2002	Banko
6,083,191 A	7/2000	Rose	6,364,888 B1	4/2002	Niemeyer et al.
6,086,584 A	7/2000	Miller	6,379,320 B1	4/2002	Lafon et al.
6,090,120 A	7/2000	Wright et al.	D457,958 S	5/2002	Dycus et al.
6,096,033 A	8/2000	Tu et al.	6,383,194 B1	5/2002	Pothula
6,099,542 A	8/2000	Cohn et al.	6,384,690 B1	5/2002	Wilhelmsson et al.
6,109,500 A	8/2000	Alli et al.	6,387,109 B1	5/2002	Davison et al.
6,110,127 A	8/2000	Suzuki	6,388,657 B1	5/2002	Natoli
6,113,594 A	9/2000	Savage	6,391,042 B1	5/2002	Cimino
6,117,152 A	9/2000	Huitema	6,398,779 B1	6/2002	Buyse et al.
6,126,629 A	10/2000	Perkins	6,402,743 B1	6/2002	Orszulak et al.
6,129,735 A	10/2000	Okada et al.	6,402,748 B1	6/2002	Schoenman et al.
6,129,740 A	10/2000	Michelson	6,405,733 B1	6/2002	Fogarty et al.
6,132,368 A	10/2000	Cooper	6,416,486 B1	7/2002	Wampler
6,132,427 A	10/2000	Jones et al.	6,423,073 B2	7/2002	Bowman
6,132,448 A	10/2000	Perez et al.	6,423,082 B1	7/2002	Houser et al.
6,139,320 A	10/2000	Hahn	6,428,538 B1	8/2002	Blewett et al.
6,139,561 A	10/2000	Shibata et al.	6,428,539 B1	8/2002	Baxter et al.
6,142,615 A	11/2000	Qiu et al.	6,432,118 B1	8/2002	Messerly
6,142,994 A	11/2000	Swanson et al.	6,436,114 B1	8/2002	Novak et al.
6,147,560 A	11/2000	Erhage et al.	6,436,115 B1	8/2002	Beaupre
6,152,902 A	11/2000	Christian et al.	6,440,062 B1	8/2002	Ouchi
6,154,198 A	11/2000	Rosenberg	6,443,968 B1	9/2002	Holthaus et al.
6,159,160 A	12/2000	Hsei et al.	6,443,969 B1	9/2002	Novak et al.
6,159,175 A	12/2000	Strukel et al.	6,449,006 B1	9/2002	Shipp
6,162,194 A	12/2000	Shipp	6,454,781 B1	9/2002	Witt et al.
6,165,150 A	12/2000	Banko	6,454,782 B1	9/2002	Schwemberger
6,174,310 B1	1/2001	Kirwan, Jr.	6,458,142 B1	10/2002	Faller et al.
6,179,853 B1	1/2001	Sachse et al.	6,475,215 B1	11/2002	Tanrisever
6,183,426 B1	2/2001	Akisada et al.	6,480,796 B2	11/2002	Wiener
6,193,709 B1	2/2001	Miyawaki et al.	6,485,490 B2	11/2002	Wampler et al.
6,204,592 B1	3/2001	Hur	6,491,708 B2	12/2002	Madan et al.
6,205,855 B1	3/2001	Pfeiffer	6,497,715 B2	12/2002	Satou
6,206,844 B1	3/2001	Reichel et al.	6,500,176 B1	12/2002	Truckai et al.
6,210,337 B1	4/2001	Dunham et al.	6,500,188 B2	12/2002	Harper et al.
6,210,402 B1	4/2001	Olsen et al.	6,500,312 B2	12/2002	Wedekamp
6,210,403 B1	4/2001	Klicek	6,506,208 B2	1/2003	Hunt et al.
6,214,023 B1	4/2001	Whipple et al.	6,511,478 B1	1/2003	Burnside et al.
6,228,080 B1	5/2001	Gines	6,511,493 B1	1/2003	Moutafis et al.
6,231,565 B1	5/2001	Tovey et al.	6,514,267 B2	2/2003	Jewett
6,233,476 B1	5/2001	Strommer et al.	6,524,251 B2	2/2003	Rabiner et al.
6,238,366 B1	5/2001	Savage et al.	6,524,316 B1	2/2003	Nicholson et al.
6,245,065 B1	6/2001	Panescu et al.	6,527,736 B1	3/2003	Attinger et al.
6,252,110 B1	6/2001	Uemura et al.	6,533,784 B2	3/2003	Truckai et al.
D444,365 S	7/2001	Bass et al.	6,537,272 B2	3/2003	Christopherson et al.
D445,092 S	7/2001	Lee	6,537,291 B2	3/2003	Friedman et al.
D445,764 S	7/2001	Lee	6,543,452 B1	4/2003	Lavigne
6,254,623 B1	7/2001	Haibel, Jr. et al.	6,543,456 B1	4/2003	Freeman
6,257,241 B1	7/2001	Wampler	6,544,260 B1	4/2003	Markel et al.
6,258,034 B1	7/2001	Hanafy	6,558,376 B2	5/2003	Bishop
6,267,761 B1	7/2001	Ryan	6,561,983 B2	5/2003	Cronin et al.
			6,565,558 B1	5/2003	Lindenmeier et al.
			6,572,563 B2	6/2003	Ouchi
			6,572,632 B2	6/2003	Zisterer et al.
			6,575,969 B1	6/2003	Rittman, III et al.

(56)

References Cited

U.S. PATENT DOCUMENTS

6,582,427	B1	6/2003	Goble et al.	6,849,073	B2	2/2005	Hoey et al.
6,582,451	B1	6/2003	Marucci et al.	6,860,878	B2	3/2005	Brock
D477,408	S	7/2003	Bromley	6,863,676	B2	3/2005	Lee et al.
6,588,277	B2	7/2003	Giordano et al.	6,869,439	B2	3/2005	White et al.
6,589,200	B1	7/2003	Schwemberger et al.	6,875,220	B2	4/2005	Du et al.
6,589,239	B2	7/2003	Khandkar et al.	6,877,647	B2	4/2005	Green et al.
6,607,540	B1	8/2003	Shipp	6,882,439	B2	4/2005	Ishijima
6,610,059	B1	8/2003	West, Jr.	6,887,209	B2	5/2005	Kadziauskas et al.
6,616,450	B2	9/2003	Mossle et al.	6,887,252	B1	5/2005	Okada et al.
6,619,529	B2	9/2003	Green et al.	6,899,685	B2	5/2005	Kermode et al.
6,623,500	B1	9/2003	Cook et al.	6,905,497	B2	6/2005	Truckai et al.
6,623,501	B2	9/2003	Heller et al.	6,908,472	B2	6/2005	Wiener et al.
6,626,848	B2	9/2003	Neuenfeldt	6,913,579	B2	7/2005	Truckai et al.
6,626,926	B2	9/2003	Friedman et al.	6,915,623	B2	7/2005	Dey et al.
6,629,974	B2	10/2003	Penny et al.	6,923,804	B2	8/2005	Eggers et al.
6,633,234	B2	10/2003	Wiener et al.	6,926,712	B2	8/2005	Phan
6,644,532	B2	11/2003	Green et al.	6,926,716	B2	8/2005	Baker et al.
6,651,669	B1	11/2003	Burnside	6,929,602	B2	8/2005	Hirakui et al.
6,652,513	B2	11/2003	Panescu et al.	6,929,632	B2	8/2005	Nita et al.
6,652,539	B2	11/2003	Shipp et al.	6,929,644	B2	8/2005	Truckai et al.
6,652,545	B2	11/2003	Shipp et al.	6,933,656	B2	8/2005	Matsushita et al.
6,656,132	B1	12/2003	Ouchi	D509,589	S	9/2005	Wells
6,656,177	B2	12/2003	Truckai et al.	6,942,660	B2	9/2005	Pantera et al.
6,660,017	B2	12/2003	Beaupre	6,942,677	B2	9/2005	Nita et al.
6,662,127	B2	12/2003	Wiener et al.	6,945,981	B2	9/2005	Donofrio et al.
6,663,941	B2	12/2003	Brown et al.	6,946,779	B2	9/2005	Birgel
6,666,860	B1	12/2003	Takahashi	6,948,503	B2	9/2005	Refior et al.
6,666,875	B1	12/2003	Sakurai et al.	D511,145	S	11/2005	Donofrio et al.
6,669,690	B1	12/2003	Okada et al.	6,974,450	B2	12/2005	Weber et al.
6,669,710	B2	12/2003	Moutafis et al.	6,976,844	B2	12/2005	Hickok et al.
6,676,660	B2	1/2004	Wampler et al.	6,976,969	B2	12/2005	Messerly
6,678,621	B2	1/2004	Wiener et al.	6,977,495	B2	12/2005	Donofrio
6,679,875	B2	1/2004	Honda et al.	6,979,332	B2	12/2005	Adams
6,679,899	B2	1/2004	Wiener et al.	6,981,628	B2	1/2006	Wales
6,682,544	B2	1/2004	Mastri et al.	6,984,220	B2	1/2006	Wuchinich
6,685,701	B2	2/2004	Orszulak et al.	6,988,295	B2	1/2006	Tillim
6,685,703	B2	2/2004	Pearson et al.	6,994,708	B2	2/2006	Manzo
6,689,145	B2	2/2004	Lee et al.	7,001,335	B2	2/2006	Adachi et al.
6,689,146	B1	2/2004	Himes	7,011,657	B2	3/2006	Truckai et al.
6,716,215	B1	4/2004	David et al.	7,014,638	B2	3/2006	Michelson
6,719,692	B2	4/2004	Kleffner et al.	7,033,357	B2	4/2006	Baxter et al.
6,719,776	B2	4/2004	Baxter	7,037,306	B2	5/2006	Podany
6,723,091	B2	4/2004	Goble et al.	7,041,083	B2	5/2006	Chu et al.
D490,059	S	5/2004	Conway et al.	7,041,088	B2	5/2006	Nawrocki et al.
6,731,047	B2	5/2004	Kauf et al.	7,041,102	B2	5/2006	Truckai et al.
6,733,506	B1	5/2004	McDevitt et al.	7,044,949	B2	5/2006	Orszulak et al.
6,739,872	B1	5/2004	Turri	7,066,893	B2	6/2006	Hibner et al.
6,740,079	B1	5/2004	Eggers et al.	7,066,895	B2	6/2006	Podany
D491,666	S	6/2004	Kimmell et al.	7,070,597	B2	7/2006	Truckai et al.
6,743,245	B2	6/2004	Lobdell	7,074,218	B2	7/2006	Washington et al.
6,746,284	B1	6/2004	Spink, Jr.	7,074,219	B2	7/2006	Levine et al.
6,746,443	B1	6/2004	Morley et al.	7,077,039	B2	7/2006	Gass et al.
6,752,815	B2	6/2004	Beaupre	7,077,845	B2	7/2006	Hacker et al.
6,755,825	B2	6/2004	Shoenman et al.	7,077,853	B2	7/2006	Kramer et al.
6,761,698	B2	7/2004	Shibata et al.	7,083,618	B2	8/2006	Couture
6,762,535	B2	7/2004	Take et al.	7,083,619	B2	8/2006	Truckai et al.
6,770,072	B1	8/2004	Truckai et al.	7,087,054	B2	8/2006	Truckai et al.
6,773,409	B2	8/2004	Truckai et al.	7,090,672	B2	8/2006	Underwood et al.
6,773,443	B2	8/2004	Truwit et al.	7,101,371	B2	9/2006	Dycus et al.
6,773,444	B2	8/2004	Messerly	7,101,378	B2	9/2006	Salameh et al.
6,778,023	B2	8/2004	Christensen	7,104,834	B2	9/2006	Robinson et al.
6,783,524	B2	8/2004	Anderson et al.	7,108,695	B2	9/2006	Witt et al.
6,786,382	B1	9/2004	Hoffman	7,111,769	B2	9/2006	Wales et al.
6,786,383	B2	9/2004	Stegelmann	7,112,201	B2	9/2006	Truckai et al.
6,790,173	B2	9/2004	Saadat et al.	D531,311	S	10/2006	Guerra et al.
6,790,216	B1	9/2004	Ishikawa	7,117,034	B2	10/2006	Kronberg
6,796,981	B2	9/2004	Wham et al.	7,118,564	B2	10/2006	Ritchie et al.
D496,997	S	10/2004	Dycus et al.	7,124,932	B2	10/2006	Isaacson et al.
6,802,843	B2	10/2004	Truckai et al.	7,125,409	B2	10/2006	Truckai et al.
6,808,525	B2	10/2004	Latterell et al.	7,128,720	B2	10/2006	Podany
6,809,508	B2	10/2004	Donofrio	7,131,860	B2	11/2006	Sartor et al.
6,810,281	B2	10/2004	Brock et al.	7,135,018	B2	11/2006	Ryan et al.
6,827,712	B2	12/2004	Tovey et al.	7,135,030	B2	11/2006	Schwemberger et al.
6,828,712	B2	12/2004	Battaglin et al.	7,137,980	B2	11/2006	Buyse et al.
6,835,082	B2	12/2004	Gonnering	7,144,403	B2	12/2006	Booth
				7,153,315	B2	12/2006	Miller
				D536,093	S	1/2007	Nakajima et al.
				7,156,189	B1	1/2007	Bar-Cohen et al.
				7,156,853	B2	1/2007	Muratsu

(56)

References Cited

U.S. PATENT DOCUMENTS

7,157,058 B2	1/2007	Marhasin et al.	7,494,468 B2	2/2009	Rabiner et al.
7,159,750 B2	1/2007	Racenet et al.	7,502,234 B2	3/2009	Goliszek et al.
7,160,296 B2	1/2007	Pearson et al.	7,503,893 B2	3/2009	Kucklick
7,160,299 B2	1/2007	Baily	7,503,895 B2	3/2009	Rabiner et al.
7,163,548 B2	1/2007	Stulen et al.	7,506,790 B2	3/2009	Shelton, IV
7,169,144 B2	1/2007	Hoey et al.	7,506,791 B2	3/2009	Omaits et al.
7,169,146 B2	1/2007	Truckai et al.	7,524,320 B2	4/2009	Tierney et al.
7,179,254 B2	2/2007	Pendekanti et al.	7,530,986 B2	5/2009	Beaupre et al.
7,179,271 B2	2/2007	Friedman et al.	7,534,243 B1	5/2009	Chin et al.
7,186,253 B2	3/2007	Truckai et al.	D594,983 S	6/2009	Price et al.
7,189,233 B2	3/2007	Truckai et al.	7,540,871 B2	6/2009	Gonnering
D541,418 S	4/2007	Schechter et al.	7,544,200 B2	6/2009	Houser
7,204,820 B2	4/2007	Akahoshi	7,549,564 B2	6/2009	Boudreaux
7,207,997 B2	4/2007	Shipp et al.	7,559,450 B2	7/2009	Wales et al.
7,210,881 B2	5/2007	Greenberg	7,567,012 B2	7/2009	Namikawa
7,211,079 B2	5/2007	Treat	7,568,603 B2	8/2009	Shelton, IV et al.
7,217,128 B2	5/2007	Atkin et al.	7,569,057 B2	8/2009	Liu et al.
7,217,269 B2	5/2007	El-Galley et al.	7,572,266 B2	8/2009	Young et al.
7,220,951 B2	5/2007	Truckai et al.	7,572,268 B2	8/2009	Babaev
7,223,229 B2	5/2007	Inman et al.	7,578,820 B2	8/2009	Moore et al.
7,229,455 B2	6/2007	Sakurai et al.	7,582,084 B2	9/2009	Swanson et al.
7,235,071 B2	6/2007	Gonnering	7,582,095 B2	9/2009	Shipp et al.
7,244,262 B2	7/2007	Wiener et al.	7,585,181 B2	9/2009	Olsen
7,258,688 B1	8/2007	Shah et al.	7,588,176 B2	9/2009	Timm et al.
7,269,873 B2	9/2007	Brewer et al.	7,601,119 B2	10/2009	Shahinian
7,273,483 B2	9/2007	Wiener et al.	7,607,557 B2	10/2009	Shelton, IV et al.
D552,241 S	10/2007	Bromley et al.	7,621,930 B2	11/2009	Houser
7,282,048 B2	10/2007	Goble et al.	7,641,653 B2	1/2010	Dalla Betta et al.
7,285,895 B2	10/2007	Beaupré	7,645,278 B2	1/2010	Ichihashi et al.
7,300,431 B2	11/2007	Dubrovsky	7,654,431 B2	2/2010	Hueil et al.
7,300,435 B2	11/2007	Wham et al.	7,659,833 B2	2/2010	Warner et al.
7,300,446 B2	11/2007	Beaupre	7,665,647 B2	2/2010	Shelton, IV et al.
7,303,531 B2	12/2007	Lee et al.	7,670,334 B2	3/2010	Hueil et al.
7,303,557 B2	12/2007	Wham et al.	7,670,338 B2	3/2010	Albrecht et al.
7,306,597 B2	12/2007	Manzo	7,674,263 B2	3/2010	Ryan
7,309,849 B2	12/2007	Truckai et al.	7,678,069 B1	3/2010	Baker et al.
7,311,706 B2	12/2007	Schoenman et al.	7,678,125 B2	3/2010	Shipp
7,311,709 B2	12/2007	Truckai et al.	7,682,366 B2	3/2010	Sakurai et al.
7,317,955 B2	1/2008	McGreevy	7,686,770 B2	3/2010	Cohen
7,318,831 B2	1/2008	Alvarez et al.	7,686,826 B2	3/2010	Lee et al.
7,326,236 B2	2/2008	Andreas et al.	7,688,028 B2	3/2010	Phillips et al.
7,331,410 B2	2/2008	Yong et al.	7,691,098 B2	4/2010	Wallace et al.
7,335,165 B2	2/2008	Truwit et al.	7,699,846 B2	4/2010	Ryan
7,335,997 B2	2/2008	Wiener	7,713,202 B2	5/2010	Boukhny et al.
7,337,010 B2	2/2008	Howard et al.	7,714,481 B2	5/2010	Sakai
7,353,068 B2	4/2008	Tanaka et al.	7,717,312 B2	5/2010	Beetel
7,354,440 B2	4/2008	Truckal et al.	7,717,915 B2	5/2010	Miyazawa
7,364,577 B2	4/2008	Wham et al.	7,721,935 B2	5/2010	Racenet et al.
RE40,388 E	6/2008	Gines	D618,797 S	6/2010	Price et al.
7,380,695 B2	6/2008	Doll et al.	7,726,537 B2	6/2010	Olson et al.
7,380,696 B2	6/2008	Shelton, IV et al.	7,727,177 B2	6/2010	Bayat
7,381,209 B2	6/2008	Truckai et al.	7,738,969 B2	6/2010	Bleich
7,390,317 B2	6/2008	Taylor et al.	7,740,594 B2	6/2010	Hibner
7,404,508 B2	7/2008	Smith et al.	7,751,115 B2	7/2010	Song
7,408,288 B2	8/2008	Hara	D621,503 S	8/2010	Otten et al.
7,416,101 B2	8/2008	Shelton, IV et al.	7,766,210 B2	8/2010	Shelton, IV et al.
7,416,437 B2	8/2008	Sartor et al.	7,766,693 B2	8/2010	Sartor et al.
D576,725 S	9/2008	Shumer et al.	7,770,774 B2	8/2010	Mastri et al.
7,419,490 B2	9/2008	Falkenstein et al.	7,770,775 B2	8/2010	Shelton, IV et al.
7,422,139 B2	9/2008	Shelton, IV et al.	7,771,425 B2	8/2010	Dycus et al.
7,422,463 B2	9/2008	Kuo	7,771,444 B2	8/2010	Patel et al.
D578,643 S	10/2008	Shumer et al.	7,775,972 B2	8/2010	Brock et al.
D578,644 S	10/2008	Shumer et al.	7,776,036 B2	8/2010	Schechter et al.
D578,645 S	10/2008	Shumer et al.	7,778,733 B2	8/2010	Nowlin et al.
7,431,704 B2	10/2008	Babaev	7,780,054 B2	8/2010	Wales
7,441,684 B2	10/2008	Shelton, IV et al.	7,780,593 B2	8/2010	Ueno et al.
7,455,208 B2	11/2008	Wales et al.	7,780,651 B2	8/2010	Madhani et al.
7,462,181 B2	12/2008	Kraft et al.	7,780,659 B2	8/2010	Okada et al.
7,464,846 B2	12/2008	Shelton, IV et al.	7,784,662 B2	8/2010	Wales et al.
7,472,815 B2	1/2009	Shelton, IV et al.	7,796,969 B2	9/2010	Kelly et al.
7,473,263 B2	1/2009	Johnston et al.	7,798,386 B2	9/2010	Schall et al.
7,479,148 B2	1/2009	Beaupre	7,799,020 B2	9/2010	Shores et al.
7,479,160 B2	1/2009	Branch et al.	7,799,045 B2	9/2010	Masuda
7,481,775 B2	1/2009	Weikel, Jr. et al.	7,803,152 B2	9/2010	Honda et al.
7,488,285 B2	2/2009	Honda et al.	7,806,891 B2	10/2010	Nowlin et al.
			7,810,693 B2	10/2010	Broehl et al.
			7,811,283 B2	10/2010	Moses et al.
			7,819,819 B2	10/2010	Quick et al.
			7,821,143 B2	10/2010	Wiener

(56)

References Cited

U.S. PATENT DOCUMENTS

D627,066	S	11/2010	Romero	D669,992	S	10/2012	Schafer et al.
7,824,401	B2	11/2010	Manzo et al.	D669,993	S	10/2012	Merchant et al.
7,832,611	B2	11/2010	Boyden et al.	8,286,846	B2	10/2012	Smith et al.
7,834,484	B2	11/2010	Sartor	8,287,485	B2	10/2012	Kimura et al.
7,837,699	B2	11/2010	Yamada et al.	8,287,528	B2	10/2012	Wham et al.
7,845,537	B2	12/2010	Shelton, IV et al.	8,287,532	B2	10/2012	Carroll et al.
7,846,155	B2	12/2010	Houser et al.	8,292,888	B2	10/2012	Whitman
7,846,161	B2	12/2010	Dumbauld et al.	8,298,223	B2	10/2012	Wham et al.
7,854,735	B2	12/2010	Houser et al.	8,298,225	B2	10/2012	Gilbert
D631,155	S	1/2011	Peine et al.	8,303,576	B2	11/2012	Brock
7,861,906	B2	1/2011	Doll et al.	8,303,580	B2	11/2012	Wham et al.
7,862,560	B2	1/2011	Marion	8,303,583	B2	11/2012	Hosier et al.
7,876,030	B2	1/2011	Taki et al.	8,319,400	B2	11/2012	Houser et al.
D631,965	S	2/2011	Price et al.	8,323,302	B2	12/2012	Robertson et al.
7,878,991	B2	2/2011	Babaev	8,333,778	B2	12/2012	Smith et al.
7,879,033	B2	2/2011	Sartor et al.	8,333,779	B2	12/2012	Smith et al.
7,892,606	B2	2/2011	Thies et al.	8,334,468	B2	12/2012	Palmer et al.
7,901,400	B2	3/2011	Wham et al.	8,334,635	B2	12/2012	Voegele et al.
7,901,423	B2	3/2011	Stulen et al.	8,337,407	B2	12/2012	Quistgaard et al.
7,905,881	B2	3/2011	Masuda et al.	8,338,726	B2	12/2012	Palmer et al.
7,909,824	B2	3/2011	Masuda et al.	8,344,596	B2	1/2013	Nield et al.
7,922,061	B2	4/2011	Shelton, IV et al.	8,348,967	B2	1/2013	Stulen
7,922,651	B2	4/2011	Yamada et al.	8,357,103	B2	1/2013	Mark et al.
D637,288	S	5/2011	Houghton	8,366,727	B2	2/2013	Witt et al.
D638,540	S	5/2011	Ijiri et al.	8,372,099	B2	2/2013	Deville et al.
7,936,203	B2	5/2011	Zimlich	8,372,101	B2	2/2013	Smith et al.
7,951,095	B2	5/2011	Makin et al.	8,372,102	B2	2/2013	Stulen et al.
7,951,165	B2	5/2011	Golden et al.	8,374,670	B2	2/2013	Selkee
7,959,050	B2	6/2011	Smith et al.	8,377,059	B2	2/2013	Deville et al.
7,959,626	B2	6/2011	Hong et al.	8,377,085	B2	2/2013	Smith et al.
7,972,329	B2	7/2011	Refior et al.	8,382,748	B2	2/2013	Geisel
7,976,544	B2	7/2011	McClurken et al.	8,382,775	B1	2/2013	Bender et al.
7,981,050	B2	7/2011	Ritchart et al.	8,382,782	B2	2/2013	Robertson et al.
7,998,157	B2	8/2011	Culp et al.	8,403,948	B2	3/2013	Deville et al.
8,038,693	B2	10/2011	Allen	8,403,949	B2	3/2013	Palmer et al.
8,057,498	B2	11/2011	Robertson	8,403,950	B2	3/2013	Palmer et al.
8,058,771	B2	11/2011	Giordano et al.	8,418,073	B2	4/2013	Mohr et al.
8,061,014	B2	11/2011	Smith et al.	8,418,349	B2	4/2013	Smith et al.
8,070,711	B2	12/2011	Bassinger et al.	8,419,758	B2	4/2013	Smith et al.
8,070,762	B2	12/2011	Escudero et al.	8,419,759	B2	4/2013	Dietz
8,075,558	B2	12/2011	Truckai et al.	8,425,545	B2	4/2013	Smith et al.
8,089,197	B2	1/2012	Rinner et al.	8,430,898	B2	4/2013	Wiener et al.
8,097,012	B2	1/2012	Kagarise	8,435,257	B2	5/2013	Smith et al.
8,105,323	B2	1/2012	Buyse et al.	8,439,912	B2	5/2013	Cunningham et al.
8,142,461	B2	3/2012	Houser et al.	8,439,939	B2	5/2013	Deville et al.
8,152,801	B2	4/2012	Goldberg et al.	8,444,637	B2	5/2013	Podmore et al.
8,152,825	B2	4/2012	Madan et al.	8,444,662	B2	5/2013	Palmer et al.
8,157,145	B2	4/2012	Shelton, IV et al.	8,444,664	B2	5/2013	Balaney et al.
8,161,977	B2	4/2012	Shelton, IV et al.	8,460,288	B2	6/2013	Tamai et al.
8,162,966	B2	4/2012	Connor et al.	8,461,744	B2	6/2013	Wiener et al.
8,172,846	B2	5/2012	Brunnett et al.	8,469,981	B2	6/2013	Robertson et al.
8,172,870	B2	5/2012	Shipp	8,479,969	B2	7/2013	Shelton, IV
8,177,800	B2	5/2012	Spitz et al.	8,480,703	B2	7/2013	Nicholas et al.
8,182,502	B2	5/2012	Stulen et al.	8,485,413	B2	7/2013	Scheib et al.
8,186,877	B2	5/2012	Klimovitch et al.	8,486,057	B2	7/2013	Behnke, II
D661,801	S	6/2012	Price et al.	8,486,096	B2	7/2013	Robertson et al.
D661,802	S	6/2012	Price et al.	8,491,578	B2	7/2013	Manwaring et al.
D661,803	S	6/2012	Price et al.	D687,549	S	8/2013	Johnson et al.
D661,804	S	6/2012	Price et al.	8,506,555	B2	8/2013	Ruiz Morales
8,197,472	B2	6/2012	Lau et al.	8,509,318	B2	8/2013	Tailliet
8,197,502	B2	6/2012	Smith et al.	8,512,359	B2	8/2013	Whitman et al.
8,207,651	B2	6/2012	Gilbert	8,512,365	B2	8/2013	Wiener et al.
8,210,411	B2	7/2012	Yates et al.	8,523,889	B2	9/2013	Stulen et al.
8,226,675	B2	7/2012	Houser et al.	8,531,064	B2	9/2013	Robertson et al.
8,235,917	B2	8/2012	Joseph et al.	8,535,340	B2	9/2013	Allen
8,236,019	B2	8/2012	Houser	8,535,341	B2	9/2013	Allen
8,236,020	B2	8/2012	Smith et al.	8,546,996	B2	10/2013	Messery et al.
8,241,271	B2	8/2012	Millman et al.	8,546,999	B2	10/2013	Houser et al.
8,246,575	B2	8/2012	Viola	8,568,400	B2	10/2013	Gilbert
8,246,615	B2	8/2012	Behnke	8,573,461	B2	11/2013	Shelton, IV et al.
8,252,012	B2	8/2012	Stulen	8,573,465	B2	11/2013	Shelton, IV
8,253,303	B2	8/2012	Giordano et al.	8,579,928	B2	11/2013	Robertson et al.
8,257,377	B2	9/2012	Wiener et al.	8,591,459	B2	11/2013	Clymer et al.
8,257,387	B2	9/2012	Cunningham	8,591,506	B2	11/2013	Wham et al.
8,273,087	B2	9/2012	Kimura et al.	8,591,536	B2	11/2013	Robertson
				D695,407	S	12/2013	Price et al.
				D696,631	S	12/2013	Price et al.
				8,602,031	B2	12/2013	Reis et al.
				8,602,288	B2	12/2013	Shelton, IV et al.

(56)

References Cited

U.S. PATENT DOCUMENTS

8,608,745 B2	12/2013	Guzman et al.	2002/0156493 A1	10/2002	Houser et al.
8,616,431 B2	12/2013	Timm et al.	2003/0014087 A1	1/2003	Fang et al.
8,623,027 B2	1/2014	Price et al.	2003/0036705 A1	2/2003	Hare et al.
8,650,728 B2	2/2014	Wan et al.	2003/0050572 A1	3/2003	Brautigam et al.
8,652,155 B2	2/2014	Houser et al.	2003/0055443 A1	3/2003	Spotnitz
8,659,208 B1	2/2014	Rose et al.	2003/0114851 A1	6/2003	Truckai et al.
8,663,220 B2	3/2014	Wiener et al.	2003/0144680 A1	7/2003	Kellogg et al.
8,690,582 B2	4/2014	Rohrbach et al.	2003/0199794 A1	10/2003	Sakurai et al.
8,696,366 B2	4/2014	Chen et al.	2003/0204199 A1	10/2003	Novak et al.
8,704,425 B2	4/2014	Giordano et al.	2003/0212332 A1	11/2003	Fenton et al.
8,709,031 B2	4/2014	Stulen	2003/0212363 A1	11/2003	Shipp
8,747,351 B2	6/2014	Schultz	2003/0212392 A1	11/2003	Fenton et al.
8,752,749 B2	6/2014	Moore et al.	2003/0212422 A1	11/2003	Fenton et al.
8,753,338 B2	6/2014	Widenhouse et al.	2003/0229344 A1	12/2003	Dycus et al.
8,754,570 B2	6/2014	Voegele et al.	2004/0030254 A1	2/2004	Babaev
8,764,735 B2	7/2014	Coe et al.	2004/0030330 A1	2/2004	Brassell et al.
8,771,270 B2	7/2014	Burbank	2004/0047485 A1	3/2004	Sherrit et al.
8,784,418 B2	7/2014	Romero	2004/0054364 A1	3/2004	Aranyi et al.
8,808,319 B2	8/2014	Houser et al.	2004/0064151 A1	4/2004	Mollenauer
8,827,992 B2	9/2014	Koss et al.	2004/0092921 A1	5/2004	Kadziauskas et al.
8,845,537 B2	9/2014	Tanaka et al.	2004/0092992 A1	5/2004	Adams et al.
8,882,791 B2	11/2014	Stulen	2004/0097911 A1	5/2004	Murakami et al.
8,888,776 B2	11/2014	Dietz et al.	2004/0097912 A1	5/2004	Gonnering
8,888,809 B2	11/2014	Davison et al.	2004/0097919 A1	5/2004	Wellman et al.
8,899,462 B2	12/2014	Kostrzewski et al.	2004/0097996 A1	5/2004	Rabiner et al.
8,900,259 B2	12/2014	Houser et al.	2004/0116952 A1	6/2004	Sakurai et al.
8,951,248 B2	2/2015	Messerly et al.	2004/0132383 A1	7/2004	Langford et al.
8,951,272 B2	2/2015	Robertson et al.	2004/0147934 A1	7/2004	Kiester
8,956,349 B2	2/2015	Aldridge et al.	2004/0167508 A1	8/2004	Wham et al.
8,961,547 B2	2/2015	Dietz et al.	2004/0176686 A1	9/2004	Hare et al.
8,968,283 B2	3/2015	Kharin	2004/0176751 A1	9/2004	Weitzner et al.
8,968,355 B2	3/2015	Malkowski et al.	2004/0199193 A1	10/2004	Hayashi et al.
8,974,477 B2	3/2015	Yamada	2004/0204728 A1	10/2004	Haefner
8,979,890 B2	3/2015	Boudreaux	2004/0243147 A1	12/2004	Lipow
8,986,287 B2	3/2015	Park et al.	2004/0260300 A1	12/2004	Gorensek et al.
8,986,302 B2	3/2015	Aldridge et al.	2005/0020967 A1	1/2005	Ono
8,989,903 B2	3/2015	Weir et al.	2005/0021018 A1	1/2005	Anderson et al.
9,039,695 B2	5/2015	Giordano et al.	2005/0021065 A1	1/2005	Yamada et al.
9,044,261 B2	6/2015	Houser	2005/0033337 A1	2/2005	Muir et al.
9,050,093 B2	6/2015	Aldridge et al.	2005/0049546 A1	3/2005	Messerly et al.
9,050,124 B2	6/2015	Houser	2005/0070800 A1	3/2005	Takahashi
9,060,775 B2	6/2015	Wiener et al.	2005/0096683 A1	5/2005	Ellins et al.
9,060,776 B2	6/2015	Yates et al.	2005/0099824 A1	5/2005	Dowling et al.
9,066,747 B2	6/2015	Robertson	2005/0103819 A1	5/2005	Racenet et al.
9,095,367 B2	8/2015	Olson et al.	2005/0143769 A1	6/2005	White et al.
9,107,689 B2	8/2015	Robertson et al.	2005/0149108 A1	7/2005	Cox
9,113,940 B2	8/2015	Twomey	2005/0165345 A1	7/2005	Laufer et al.
9,198,714 B2	12/2015	Worrell et al.	2005/0177184 A1	8/2005	Easley
9,220,527 B2	12/2015	Houser et al.	2005/0182339 A1	8/2005	Lee et al.
9,226,766 B2	1/2016	Aldridge et al.	2005/0188743 A1	9/2005	Land
9,226,767 B2	1/2016	Stulen et al.	2005/0192610 A1	9/2005	Houser et al.
9,232,979 B2	1/2016	Parihar et al.	2005/0209620 A1	9/2005	Du et al.
9,237,921 B2	1/2016	Messerly et al.	2005/0222598 A1	10/2005	Ho et al.
9,241,728 B2	1/2016	Price et al.	2005/0234484 A1	10/2005	Houser et al.
9,241,731 B2	1/2016	Boudreaux et al.	2005/0249667 A1	11/2005	Tuszynski et al.
9,259,234 B2	2/2016	Robertson et al.	2005/0256405 A1	11/2005	Makin et al.
9,283,045 B2	3/2016	Rhee et al.	2005/0261581 A1	11/2005	Hughes et al.
9,326,788 B2	5/2016	Batross et al.	2005/0261588 A1	11/2005	Makin et al.
9,339,289 B2	5/2016	Robertson	2005/0273090 A1	12/2005	Nieman et al.
9,351,754 B2	5/2016	Vakharia et al.	2005/0288659 A1	12/2005	Kimura et al.
9,393,037 B2	7/2016	Olson et al.	2006/0030797 A1	2/2006	Zhou et al.
9,408,622 B2	8/2016	Stulen et al.	2006/0058825 A1	3/2006	Ogura et al.
2001/0025173 A1	9/2001	Ritchie et al.	2006/0063130 A1	3/2006	Hayman et al.
2001/0025183 A1	9/2001	Shahidi et al.	2006/0066181 A1	3/2006	Bromfield et al.
2001/0025184 A1	9/2001	Messerly	2006/0074442 A1	4/2006	Noriega et al.
2001/0031950 A1	10/2001	Ryan	2006/0079874 A1	4/2006	Faller et al.
2001/0039419 A1	11/2001	Francischelli et al.	2006/0079879 A1	4/2006	Faller et al.
2002/0002377 A1	1/2002	Cimino	2006/0084963 A1	4/2006	Messerly
2002/0019649 A1	2/2002	Sikora et al.	2006/0095046 A1	5/2006	Trieu et al.
2002/0022836 A1	2/2002	Goble et al.	2006/0190034 A1	8/2006	Nishizawa et al.
2002/0029055 A1	3/2002	Bonutti	2006/0206100 A1	9/2006	Eskridge et al.
2002/0049551 A1	4/2002	Friedman et al.	2006/0206115 A1	9/2006	Schomer et al.
2002/0052617 A1	5/2002	Anis et al.	2006/0211943 A1	9/2006	Beaupre
2002/0077550 A1	6/2002	Rabiner et al.	2006/0217729 A1	9/2006	Eskridge et al.
2002/0156466 A1	10/2002	Sakurai et al.	2006/0224160 A1	10/2006	Cotter et al.
			2006/0235306 A1	10/2006	Yamada
			2006/0247558 A1	11/2006	Yoshimine et al.
			2006/0253050 A1	11/2006	Hansmann et al.
			2006/0264809 A1	11/2006	

(56)

References Cited

U.S. PATENT DOCUMENTS

2006/0271030 A1	11/2006	Francis et al.	2009/0118802 A1	5/2009	Mioduski et al.
2007/0016235 A1	1/2007	Tanaka et al.	2009/0138006 A1	5/2009	Bales et al.
2007/0016236 A1	1/2007	Beaupre	2009/0143797 A1	6/2009	Smith et al.
2007/0055228 A1	3/2007	Berg et al.	2009/0143799 A1	6/2009	Smith et al.
2007/0056596 A1	3/2007	Fanney et al.	2009/0143800 A1	6/2009	Deville et al.
2007/0060915 A1	3/2007	Kucklick	2009/0143806 A1	6/2009	Witt et al.
2007/0060935 A1	3/2007	Schwardt et al.	2009/0149801 A1	6/2009	Crandall et al.
2007/0063618 A1	3/2007	Bromfield	2009/0163807 A1	6/2009	Sliwa
2007/0074584 A1	4/2007	Talarico et al.	2009/0207923 A1	8/2009	Dress
2007/0106317 A1	5/2007	Shelton, IV et al.	2009/0216157 A1	8/2009	Yamada
2007/0129716 A1	6/2007	Daw et al.	2009/0223033 A1	9/2009	Houser
2007/0130771 A1	6/2007	Ehlert et al.	2009/0254077 A1	10/2009	Craig
2007/0131034 A1	6/2007	Ehlert et al.	2009/0254080 A1	10/2009	Honda
2007/0149881 A1	6/2007	Rabin	2009/0264909 A1	10/2009	Beaupre
2007/0162050 A1	7/2007	Sartor	2009/0270771 A1	10/2009	Takahashi
2007/0166663 A1	7/2007	Telles et al.	2009/0270812 A1	10/2009	Litscher et al.
2007/0173803 A1	7/2007	Wham et al.	2009/0270853 A1	10/2009	Yachi et al.
2007/0173813 A1	7/2007	Odom	2009/0270899 A1	10/2009	Carusillo et al.
2007/0173872 A1	7/2007	Neuenfeldt	2009/0275940 A1	11/2009	Malackowski et al.
2007/0175949 A1	8/2007	Shelton, IV et al.	2009/0318945 A1	12/2009	Yoshimine et al.
2007/0185380 A1	8/2007	Kucklick	2009/0327715 A1	12/2009	Smith et al.
2007/0191712 A1	8/2007	Messerly et al.	2010/0004508 A1	1/2010	Naito et al.
2007/0219481 A1	9/2007	Babaev	2010/0016785 A1	1/2010	Takuma
2007/0239028 A1	10/2007	Houser et al.	2010/0016852 A1	1/2010	Manzo et al.
2007/0239101 A1	10/2007	Kellogg	2010/0022825 A1	1/2010	Yoshie
2007/0249941 A1	10/2007	Salehi et al.	2010/0030233 A1	2/2010	Whitman et al.
2007/0260234 A1	11/2007	McCullagh et al.	2010/0030248 A1	2/2010	Palmer et al.
2007/0265560 A1	11/2007	Soltani et al.	2010/0036370 A1	2/2010	Mirel et al.
2007/0275348 A1	11/2007	Lemon	2010/0042077 A1	2/2010	Okada
2007/0282335 A1	12/2007	Young et al.	2010/0049180 A1	2/2010	Wells et al.
2007/0287933 A1	12/2007	Phan et al.	2010/0057118 A1	3/2010	Dietz et al.
2007/0288055 A1	12/2007	Lee	2010/0063525 A1	3/2010	Beaupre et al.
2008/0009848 A1	1/2008	Paraschiv et al.	2010/0063528 A1	3/2010	Beaupre
2008/0013809 A1	1/2008	Zhu et al.	2010/0069940 A1	3/2010	Miller et al.
2008/0051812 A1	2/2008	Schmitz et al.	2010/0158307 A1	6/2010	Kubota et al.
2008/0058585 A1	3/2008	Novak et al.	2010/0187283 A1	7/2010	Crainich et al.
2008/0058775 A1	3/2008	Darian et al.	2010/0222714 A1	9/2010	Muir et al.
2008/0058845 A1	3/2008	Shimizu et al.	2010/0228264 A1	9/2010	Robinson et al.
2008/0077145 A1	3/2008	Boyden et al.	2010/0234906 A1	9/2010	Koh
2008/0082039 A1	4/2008	Babaev	2010/0262134 A1	10/2010	Jensen et al.
2008/0082098 A1	4/2008	Tanaka et al.	2010/0274160 A1	10/2010	Yachi et al.
2008/0097501 A1	4/2008	Blier	2010/0280407 A1	11/2010	Polster
2008/0114364 A1	5/2008	Goldin et al.	2010/0292691 A1	11/2010	Brogna
2008/0125768 A1	5/2008	Tahara et al.	2010/0298743 A1	11/2010	Nield et al.
2008/0140158 A1	6/2008	Hamel et al.	2010/0298851 A1	11/2010	Nield
2008/0147092 A1	6/2008	Rogge et al.	2010/0331742 A1	12/2010	Masuda
2008/0171938 A1	7/2008	Masuda et al.	2011/0004233 A1	1/2011	Muir et al.
2008/0172051 A1	7/2008	Masuda et al.	2011/0009850 A1	1/2011	Main et al.
2008/0177268 A1	7/2008	Daum et al.	2011/0015627 A1	1/2011	DiNardo et al.
2008/0188878 A1	8/2008	Young	2011/0077648 A1	3/2011	Lee et al.
2008/0200940 A1	8/2008	Eichmann et al.	2011/0082486 A1	4/2011	Messerly et al.
2008/0208108 A1	8/2008	Kimura	2011/0087218 A1	4/2011	Boudreaux et al.
2008/0208231 A1	8/2008	Ota et al.	2011/0112526 A1	5/2011	Fritz et al.
2008/0214967 A1	9/2008	Aranyi et al.	2011/0125151 A1	5/2011	Strauss et al.
2008/0234709 A1	9/2008	Houser	2011/0125174 A1	5/2011	Babaev
2008/0234710 A1	9/2008	Neurohr et al.	2011/0144806 A1	6/2011	Sandhu et al.
2008/0243106 A1	10/2008	Coe et al.	2011/0224689 A1	9/2011	Larkin et al.
2008/0243162 A1	10/2008	Shibata et al.	2011/0238065 A1	9/2011	Hunt et al.
2008/0245371 A1	10/2008	Gruber	2011/0257650 A1	10/2011	Deville et al.
2008/0249553 A1	10/2008	Gruber et al.	2011/0270126 A1	11/2011	Gunday et al.
2008/0255423 A1	10/2008	Kondo et al.	2011/0290853 A1	12/2011	Shelton, IV et al.
2008/0262490 A1	10/2008	Williams	2011/0290856 A1	12/2011	Shelton, IV et al.
2008/0281200 A1	11/2008	Voic et al.	2012/0004655 A1	1/2012	Kim et al.
2008/0281315 A1	11/2008	Gines	2012/0022525 A1	1/2012	Dietz et al.
2008/0281322 A1	11/2008	Sherman et al.	2012/0022530 A1	1/2012	Woodruff et al.
2008/0287948 A1	11/2008	Newton et al.	2012/0022583 A1	1/2012	Sugalski et al.
2009/0023985 A1	1/2009	Ewers	2012/0059289 A1	3/2012	Nield et al.
2009/0048537 A1	2/2009	Lydon et al.	2012/0065628 A1	3/2012	Naito
2009/0054886 A1	2/2009	Yachi et al.	2012/0071863 A1	3/2012	Lee et al.
2009/0054894 A1	2/2009	Yachi	2012/0078139 A1	3/2012	Aldridge et al.
2009/0076506 A1	3/2009	Baker	2012/0078243 A1	3/2012	Worrell et al.
2009/0082716 A1	3/2009	Akahoshi	2012/0078244 A1	3/2012	Worrell et al.
2009/0088785 A1	4/2009	Masuda	2012/0078247 A1	3/2012	Worrell et al.
2009/0112229 A1	4/2009	Omori et al.	2012/0078278 A1	3/2012	Bales, Jr. et al.
2009/0118751 A1	5/2009	Wiener et al.	2012/0080332 A1	4/2012	Shelton, IV et al.
			2012/0101495 A1	4/2012	Young et al.
			2012/0101501 A1	4/2012	Nishimura et al.
			2012/0109159 A1	5/2012	Jordan et al.
			2012/0116379 A1	5/2012	Yates et al.

(56)

References Cited

U.S. PATENT DOCUMENTS

2012/0116391 A1 5/2012 Houser et al.
 2012/0116394 A1 5/2012 Timm et al.
 2012/0116395 A1 5/2012 Madan et al.
 2012/0130256 A1 5/2012 Buysse et al.
 2012/0130365 A1 5/2012 McLawhorn
 2012/0136354 A1 5/2012 Rupp
 2012/0138660 A1 6/2012 Shelton, IV
 2012/0143211 A1 6/2012 Kishi
 2012/0150170 A1 6/2012 Buysse et al.
 2012/0165816 A1 6/2012 Kersten et al.
 2012/0172873 A1 7/2012 Artale et al.
 2012/0172904 A1 7/2012 Muir et al.
 2012/0177005 A1 7/2012 Liang et al.
 2012/0184946 A1 7/2012 Price et al.
 2012/0199630 A1 8/2012 Shelton, IV
 2012/0199632 A1 8/2012 Spivey et al.
 2012/0203143 A1 8/2012 Sanai et al.
 2012/0203247 A1 8/2012 Shelton, IV et al.
 2012/0209289 A1 8/2012 Duque et al.
 2012/0209303 A1 8/2012 Frankhouser et al.
 2012/0210223 A1 8/2012 Eppolito
 2012/0215220 A1 8/2012 Manzo et al.
 2012/0245582 A1 9/2012 Kimball et al.
 2012/0253370 A1 10/2012 Ross et al.
 2012/0265196 A1 10/2012 Turner et al.
 2012/0269676 A1 10/2012 Houser et al.
 2012/0310262 A1 12/2012 Messerly et al.
 2012/0310264 A1 12/2012 Messerly et al.
 2012/0330307 A1 12/2012 Ladtkow et al.
 2013/0012957 A1 1/2013 Shelton, IV et al.
 2013/0030433 A1 1/2013 Heard
 2013/0035680 A1 2/2013 Ben-Haim et al.
 2013/0035706 A1 2/2013 Giordano et al.
 2013/0053840 A1 2/2013 Krapohl et al.
 2013/0072856 A1 3/2013 Frankhouser et al.
 2013/0072857 A1 3/2013 Frankhouser et al.
 2013/0079762 A1 3/2013 Twomey et al.
 2013/0103023 A1 4/2013 Monson et al.
 2013/0103024 A1 4/2013 Monson et al.
 2013/0110145 A1 5/2013 Weitzman
 2013/0123776 A1 5/2013 Monson et al.
 2013/0123777 A1 5/2013 Monson et al.
 2013/0123782 A1 5/2013 Trees et al.
 2013/0123822 A1 5/2013 Wellman et al.
 2013/0131660 A1 5/2013 Monson et al.
 2013/0165929 A1 6/2013 Muir et al.
 2013/0217967 A1 8/2013 Mohr et al.
 2013/0226207 A1 8/2013 Stulen et al.
 2013/0226208 A1 8/2013 Wiener et al.
 2013/0245659 A1 9/2013 Robertson et al.
 2013/0253498 A1 9/2013 Germain et al.
 2013/0267975 A1 10/2013 Timm et al.
 2013/0274732 A1 10/2013 Wiener et al.
 2013/0274734 A1 10/2013 Maass et al.
 2013/0282038 A1 10/2013 Dannaher et al.
 2013/0282039 A1 10/2013 Wiener et al.
 2013/0296908 A1 11/2013 Schulte et al.
 2013/0338661 A1 12/2013 Behnke, II
 2013/0345689 A1 12/2013 Ruddenklau et al.
 2014/0005640 A1 1/2014 Shelton, IV et al.
 2014/0005653 A1 1/2014 Shelton, IV et al.
 2014/0005656 A1 1/2014 Mucilli et al.
 2014/0005661 A1 1/2014 Shelton, IV et al.
 2014/0005662 A1 1/2014 Shelton, IV et al.
 2014/0005676 A1 1/2014 Shelton, IV et al.
 2014/0005680 A1 1/2014 Shelton, IV et al.
 2014/0005681 A1 1/2014 Gee et al.
 2014/0005702 A1 1/2014 Timm et al.
 2014/0005705 A1 1/2014 Weir et al.
 2014/0005708 A1 1/2014 Shelton, IV et al.
 2014/0005718 A1 1/2014 Shelton, IV et al.
 2014/0012299 A1 1/2014 Stoddard et al.
 2014/0066962 A1 3/2014 Robertson et al.
 2014/0087569 A1 3/2014 Lee
 2014/0114327 A1 4/2014 Boudreaux et al.

2014/0135804 A1 5/2014 Weisenburgh, II et al.
 2014/0155921 A1 6/2014 Price et al.
 2014/0180280 A1 6/2014 Sigmon, Jr.
 2014/0243864 A1 8/2014 Voegelé et al.
 2014/0276970 A1 9/2014 Messerly et al.
 2015/0045819 A1 2/2015 Houser et al.
 2015/0066067 A1 3/2015 Stulen
 2015/0073460 A1 3/2015 Stulen
 2015/0112335 A1 4/2015 Boudreaux et al.
 2015/0119914 A1 4/2015 Neurohr et al.
 2015/0119915 A1 4/2015 Neurohr et al.
 2015/0119916 A1 4/2015 Dietz et al.
 2015/0123348 A1 5/2015 Robertson et al.
 2015/0157355 A1 6/2015 Price et al.
 2015/0157356 A1 6/2015 Gee
 2015/0164533 A1 6/2015 Felder et al.
 2015/0164534 A1 6/2015 Felder et al.
 2015/0164535 A1 6/2015 Felder et al.
 2015/0164536 A1 6/2015 Czarnecki et al.
 2015/0164537 A1 6/2015 Cagle et al.
 2015/0164538 A1 6/2015 Aldridge et al.
 2015/0182251 A1 7/2015 Messerly et al.
 2015/0182276 A1 7/2015 Wiener et al.
 2015/0182277 A1 7/2015 Wiener et al.
 2015/0196318 A1 7/2015 Messerly et al.
 2015/0250495 A1 9/2015 Robertson et al.
 2015/0257780 A1 9/2015 Houser
 2015/0257781 A1 9/2015 Houser et al.
 2015/0265308 A1 9/2015 Houser et al.
 2015/0327883 A1 11/2015 Messerly et al.
 2015/0328484 A1 11/2015 Messerly et al.
 2015/0340586 A1 11/2015 Wiener et al.
 2015/0351789 A1 12/2015 Robertson et al.
 2016/0030076 A1 2/2016 Faller et al.
 2016/0089209 A1 3/2016 Parihar et al.
 2016/0089533 A1 3/2016 Turner et al.
 2016/0095617 A1 4/2016 Price et al.
 2016/0106509 A1 4/2016 Worrell et al.
 2016/0120563 A1 5/2016 Messerly et al.
 2016/0192999 A1 7/2016 Stulen et al.
 2016/0206342 A1 7/2016 Robertson et al.

FOREIGN PATENT DOCUMENTS

CN 1233944 A 11/1999
 CN 1253485 A 5/2000
 CN 1634601 A 7/2005
 CN 1640365 A 7/2005
 CN 1694649 A 11/2005
 CN 1922563 A 2/2007
 CN 1951333 A 4/2007
 CN 101040799 A 9/2007
 CN 101467917 A 1/2009
 DE 3904558 A1 8/1990
 DE 9210327 U1 11/1992
 DE 4323585 A1 1/1995
 DE 19608716 C1 4/1997
 DE 20021619 U1 3/2001
 DE 10042606 A1 8/2001
 EP 0136855 B1 9/1984
 EP 0171967 A2 2/1986
 EP 1839599 A1 10/1987
 EP 0336742 A2 4/1989
 EP 0342448 A1 11/1989
 EP 0424685 B1 5/1991
 EP 0443256 A1 8/1991
 EP 0456470 A1 11/1991
 EP 0598976 A2 1/1994
 EP 0677275 A2 3/1995
 EP 0482195 B1 1/1996
 EP 0695535 A1 2/1996
 EP 0741996 A2 11/1996
 EP 0612570 B1 6/1997
 EP 1108394 A2 6/2001
 EP 1138264 A1 10/2001
 EP 0908148 B1 1/2002
 EP 1229515 A2 8/2002
 EP 1285634 A1 2/2003
 EP 0908155 B1 6/2003

(56)

References Cited

FOREIGN PATENT DOCUMENTS

EP	0705570	B1	4/2004	JP	H 04-150847	A	5/1992
EP	0765637	B1	7/2004	JP	H 04-152942	A	5/1992
EP	0870473	B1	9/2005	JP	05-095955	A	4/1993
EP	0624346	B1	11/2005	JP	H 05-115490	A	5/1993
EP	1594209	A1	11/2005	JP	H 06-070938	A	3/1994
EP	1199044	B1	12/2005	JP	6-104503	A	4/1994
EP	1609428	A1	12/2005	JP	6-507081	A	8/1994
EP	1199043	B1	3/2006	JP	H 06-217988	A	8/1994
EP	1433425	B1	6/2006	JP	H 7-508910	A	10/1995
EP	1256323	B1	9/2006	JP	7-308323	A	11/1995
EP	1698289	A2	9/2006	JP	8-24266	A	1/1996
EP	1704824	A1	9/2006	JP	8-275951	A	10/1996
EP	1749479	A1	2/2007	JP	H 08-299351	A	11/1996
EP	1815950	A1	8/2007	JP	H 08-336545	A	12/1996
EP	1844720	A1	10/2007	JP	H 09-503146	A	3/1997
EP	1862133	A1	12/2007	JP	H 09-135553	A	5/1997
EP	1875875	A1	1/2008	JP	H 09-140722	A	6/1997
EP	1199045	B1	6/2008	JP	H 10-005237	A	1/1998
EP	1964530	A1	9/2008	JP	10-295700	A	11/1998
EP	1972264	A1	9/2008	JP	H 11-501543	A	2/1999
EP	1974771	A1	10/2008	JP	H 11-128238	A	5/1999
EP	1435852	B1	12/2008	JP	H 11-192235	A	7/1999
EP	1498082	B1	12/2008	JP	11-253451	A	9/1999
EP	1707131	B1	12/2008	JP	H 11-318918	A	11/1999
EP	1997438	A2	12/2008	JP	2000-041991	A	2/2000
EP	1477104	B1	1/2009	JP	2000-070279	A	3/2000
EP	2014218	A2	1/2009	JP	2000-210299	A	8/2000
EP	2042112	A2	4/2009	JP	2000-287987	A	10/2000
EP	1832259	B1	6/2009	JP	2001-029353	A	2/2001
EP	2074959	A1	7/2009	JP	2001-502216	A	2/2001
EP	2106758	A1	10/2009	JP	2003612	A	6/2001
EP	2111813	A1	10/2009	JP	2001-309925	A	11/2001
EP	2200145	A1	6/2010	JP	2002-186901	A	7/2002
EP	1214913	B1	7/2010	JP	2002-204808	A	7/2002
EP	2238938	A1	10/2010	JP	2002-263579	A	9/2002
EP	2298154	A2	3/2011	JP	2002-301086	A	10/2002
EP	1510178	B1	6/2011	JP	2002-330977	A	11/2002
EP	1946708	B1	6/2011	JP	2002-542690	A	12/2002
EP	2305144	A1	6/2011	JP	2003-000612	A	1/2003
EP	2335630	A1	6/2011	JP	2003-010201	A	1/2003
EP	1502551	B1	7/2011	JP	2003-510158	A	3/2003
EP	2361562	A1	8/2011	JP	2003-116870	A	4/2003
EP	2365608	A2	9/2011	JP	2003-126104	A	5/2003
EP	2420197	A2	2/2012	JP	2003-126110	A	5/2003
EP	2422721	A2	2/2012	JP	2003-310627	A	5/2003
EP	1927321	B1	4/2012	JP	2003-530921	A	10/2003
EP	2510891	A1	10/2012	JP	2003-339730	A	12/2003
EP	2316359	B1	3/2013	JP	2004-129871	A	4/2004
EP	1586275	B1	5/2013	JP	2004-147701	A	5/2004
EP	1616529	B1	9/2013	JP	2005027026	A	1/2005
EP	2583633	B1	10/2014	JP	2005-040222	A	2/2005
EP	2113210	B1	3/2016	JP	2005-066316	A	3/2005
GB	1482943	A	8/1977	JP	2005-074088	A	3/2005
GB	2032221	A	4/1980	JP	2005-534451	A	11/2005
GB	2317566	A	4/1998	JP	2006-6410	A	1/2006
GB	2379878	B	11/2004	JP	2006-512149	A	4/2006
GB	2447767	B	8/2011	JP	2006-116194	A	5/2006
JP	S 50-100891	A	8/1975	JP	2006-158525	A	6/2006
JP	S 59-68513	U	5/1984	JP	2006-218296	A	8/2006
JP	S 59141938	A	8/1984	JP	2006217716	A	8/2006
JP	62-221343	A	9/1987	JP	2006-288431	A	10/2006
JP	S 62-227343	A	10/1987	JP	2007-050181	A	3/2007
JP	62-292153	A	12/1987	JP	2007-229454	A	9/2007
JP	S 62-292154	A	12/1987	JP	2007-527747	A	10/2007
JP	63-109386	A	5/1988	JP	2008-508065	A	3/2008
JP	63-315049	A	12/1988	JP	2008-119250	A	5/2008
JP	H 01-151452	A	6/1989	JP	2008-521503	A	6/2008
JP	H 01-198540	A	8/1989	JP	D1339835	S	8/2008
JP	02-71510	U	5/1990	JP	2008-212679	A	9/2008
JP	2-286149	A	11/1990	JP	2008-536562	A	9/2008
JP	H 02-292193	A	12/1990	JP	2008-284374	A	11/2008
JP	H 03-37061	A	2/1991	JP	2009-511206	A	3/2009
JP	04-25707	U	2/1992	JP	2009-517181	A	4/2009
JP	H 04-64351	A	2/1992	JP	4262923	B2	5/2009
JP	4-30508	U	3/1992	JP	2009-523567	A	6/2009
				JP	2009-236177	A	10/2009
				JP	2009-254819	A	11/2009
				JP	2010-000336	A	1/2010
				JP	2010-514923	A	5/2010

(56) References Cited

FOREIGN PATENT DOCUMENTS

JP	2010-534522	A	11/2010
JP	2010-540186	A	12/2010
JP	2011-505198	A	2/2011
JP	2012-235658	A	11/2012
JP	5208761	B2	6/2013
JP	5714508	B2	5/2015
RU	2154437	C1	8/2000
RU	22035	U1	3/2002
WO	WO 92/22259	A2	12/1992
WO	WO 93/08757	A1	5/1993
WO	WO 93/14708	A1	8/1993
WO	WO 93/16646	A1	9/1993
WO	WO 93/20877	A1	10/1993
WO	WO 94/21183	A1	9/1994
WO	WO 94/24949	A1	11/1994
WO	WO 95/09572	A1	4/1995
WO	WO 95/34259	A1	12/1995
WO	WO 96/30885	A1	10/1996
WO	WO 96/39086	A1	12/1996
WO	WO 98/16156	A1	4/1998
WO	WO 98/26739	A1	6/1998
WO	WO 98/35621	A1	8/1998
WO	WO 98/37815	A1	9/1998
WO	WO 98/47436	A1	10/1998
WO	WO 99/20213	A1	4/1999
WO	WO 99/52489	A1	10/1999
WO	WO 00/64358	A2	11/2000
WO	WO 00/74585	A2	12/2000
WO	WO 01/24713	A1	4/2001
WO	WO 01/54590	A1	8/2001
WO	WO 01/67970	A1	9/2001
WO	WO 01/95810	A2	12/2001
WO	WO 02/24080	A2	3/2002
WO	WO 02/38057	A1	5/2002
WO	WO 02/062241	A1	8/2002
WO	WO 03/082133	A1	10/2003
WO	WO 2004/012615	A1	2/2004
WO	WO 2004/026104	A2	4/2004
WO	WO 2004/032754	A2	4/2004
WO	WO 2004/032762	A1	4/2004
WO	WO 2004/032763	A2	4/2004
WO	WO 2004/037095	A2	5/2004
WO	WO 2004/060141	A2	7/2004
WO	WO 2004/098426	A1	11/2004
WO	WO 2004/112618	A2	12/2004
WO	WO 2005/117735	A1	12/2005
WO	WO 2005/122917	A1	2/2006
WO	WO 2006/012797	A1	2/2006
WO	WO 2006/042210	A2	4/2006
WO	WO 2006/058223	A2	6/2006
WO	WO 2006/063199	A2	6/2006
WO	WO 2006/083988	A1	8/2006
WO	WO 2006/101661	A2	9/2006
WO	WO 2006/119139	A2	11/2006
WO	WO 2006/119376	A2	11/2006
WO	WO 2006/129465	A1	12/2006
WO	WO 2007/008703	A2	1/2007
WO	WO 2007/008710	A2	1/2007
WO	WO 2007/038538	A1	4/2007
WO	WO 2007/040818	A1	4/2007
WO	WO 2007/047380	A2	4/2007
WO	WO 2007/047531	A2	4/2007
WO	WO 2007/056590	A1	5/2007
WO	WO 2007/087272	A2	8/2007
WO	WO 2007/143665	A2	12/2007
WO	WO 2008/016886	A2	2/2008
WO	WO 2008/042021	A1	4/2008
WO	WO 2008/049084	A2	4/2008
WO	WO 2008/051764	A2	5/2008
WO	WO 2008/089174	A2	7/2008
WO	WO 2008/118709	A1	10/2008
WO	WO 2008/130793	A1	10/2008
WO	WO 2009/010565	A1	1/2009
WO	WO 2009/018067	A1	2/2009
WO	WO 2009/018406	A2	2/2009

WO	WO 2009/027065	A1	3/2009
WO	WO 2009/046234	A2	4/2009
WO	WO 2009/073402	A2	6/2009
WO	WO 2009/120992	A2	10/2009
WO	WO 2010/017149	A1	2/2010
WO	WO 2010/068783	A1	6/2010
WO	WO 2011/008672	A2	1/2011
WO	WO 2011/052939	A2	5/2011
WO	WO 2011/100321	A2	8/2011
WO	WO 2011/144911	A1	11/2011
WO	WO 2012/061722	A2	5/2012
WO	WO 2012/128362	A1	9/2012
WO	WO 2012/135705	A1	10/2012
WO	WO 2012/135721	A1	10/2012
WO	WO 2013/018934	A1	2/2013
WO	WO 2013/062978	A2	5/2013
WO	WO 2014/092108	A1	6/2014

OTHER PUBLICATIONS

International Preliminary Report on Patentability for PCT/US2010/041663, Jan. 17, 2012 (8 pages).

Partial International Search Report for PCT/US2010/041663, Oct. 28, 2010 (2 pages).

International Search Report for PCT/US2010/041663, Feb. 17, 2011 (8 pages).

Technology Overview, printed from www.harmonicscalpel.com, internet site, website accessed on Jun. 13, 2007, (3 pages).

Sherrit et al., "Novel Horn Designs for Ultrasonic/Sonic Cleaning Welding, Soldering, Cutting and Drilling," Proc. SPIE Smart Structures Conference, vol. 4701, Paper No. 34, San Diego, CA, pp. 353-360, Mar. 2002.

Lim et al., "A Review of Mechanism Used in Laparoscopic Surgical Instruments," Mechanism and Machine Theory, vol. 38, pp. 1133-1147, (2003).

Gooch et al., "Recommended Infection-Control Practices for Dentistry, 1993," Published: May 28, 1993; [retrieved on Aug. 23, 2008]. Retrieved from the internet: URL: <http://wonder.cdc.gov/wonder/prevguid/p0000191/p0000191.asp> (15 pages).

Huston et al., "Magnetic and Magnetostrictive Properties of Cube Textured Nickel for Magnetostrictive Transducer Applications," IEEE Transactions on Magnetics, vol. 9(4), pp. 636-640 (Dec. 1973).

Incropera et al., "Fundamentals of Heat and Mass Transfer", Wiley, New York (1990). (Book—not attached).

F. A. Duck, "Optical Properties of Tissue Including Ultraviolet and Infrared Radiation," pp. 43-71 in *Physical Properties of Tissue* (1990).

Orr et al., "Overview of Bioheat Transfer," pp. 367-384 in *Optical-Thermal Response of Laser-Irradiated Tissue*, A. J. Welch and M. J. C. van Gemert, eds., Plenum, New York (1995).

Campbell et al., "Thermal Imaging in Surgery," p. 19-3, in *Medical Infrared Imaging*, N. A. Diakides and J. D. Bronzino, Eds. (2008).

Sullivan, "Cost-Constrained Selection of Strand Diameter and Number in a Litz-Wire Transformer Winding," IEEE Transactions on Power Electronics, vol. 16, No. 2, Mar. 2001, pp. 281-288.

Sullivan, "Optimal Choice for Number of Strands in a Litz-Wire Transformer Winding," IEEE Transactions on Power Electronics, vol. 14, No. 2, Mar. 1999, pp. 283-291.

Graff, K.F., "Elastic Wave Propagation in a Curved Sonic Transmission Line," IEEE Transactions on Sonics and Ultrasonics, SU-17(1), 1-6 (1970).

Makarov, S. N., Ochmann, M., Desinger, K., "The longitudinal vibration response of a curved fiber used for laser ultrasound surgical therapy," Journal of the Acoustical Society of America 102, 1191-1199 (1997).

Morley, L. S. D., "Elastic Waves in a Naturally Curved Rod," Quarterly Journal of Mechanics and Applied Mathematics, 14: 155-172 (1961).

Walsh, S. J., White, R. G., "Vibrational Power Transmission in Curved Beams," Journal of Sound and Vibration, 233(3), 455-488 (2000).

(56)

References Cited

OTHER PUBLICATIONS

Covidien 501(k) Summary Sonication, dated Feb. 24, 2011 (7 pages).

Gerhard, Glen C., "Surgical Electrotechnology: Quo Vadis?," IEEE Transactions on Biomedical Engineering, vol. BME-31, No. 12, pp. 787-792, Dec. 1984.

Fowler, K.R., "A Programmable, Arbitrary Waveform Electrosurgical Device," IEEE Engineering in Medicine and Biology Society 10th Annual International Conference, pp. 1324, 1325 (1988).

LaCourse, J.R.; Vogt, M.C.; Miller, W.T., III; Selikowitz, S.M., "Spectral Analysis Interpretation of Electrosurgical Generator Nerve and Muscle Stimulation," IEEE Transactions on Biomedical Engineering, vol. 35, No. 7, pp. 505-509, Jul. 1988.

U.S. Appl. No. 13/751,680, filed Jan. 28, 2013.

* cited by examiner

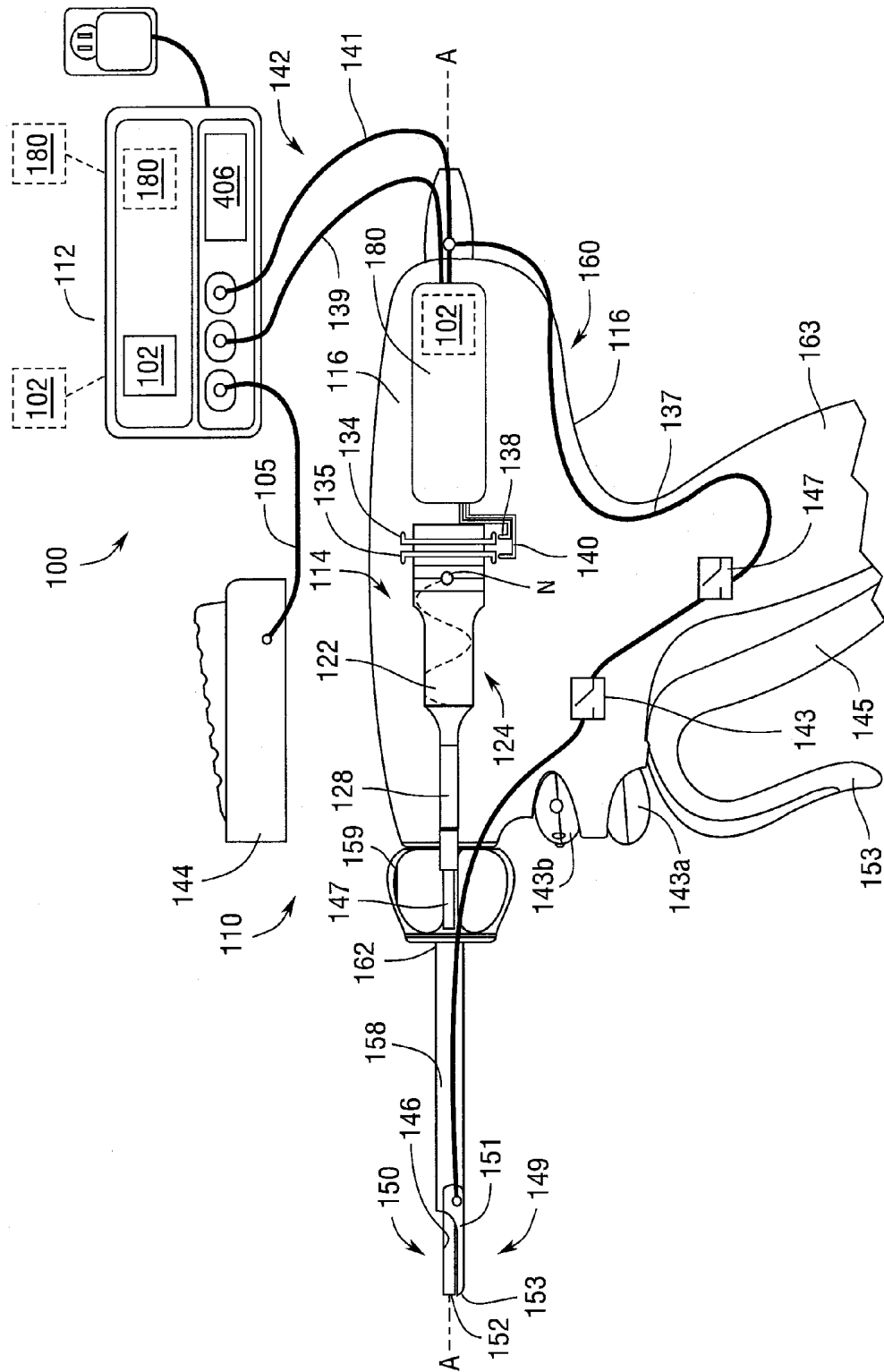

Fig. 1

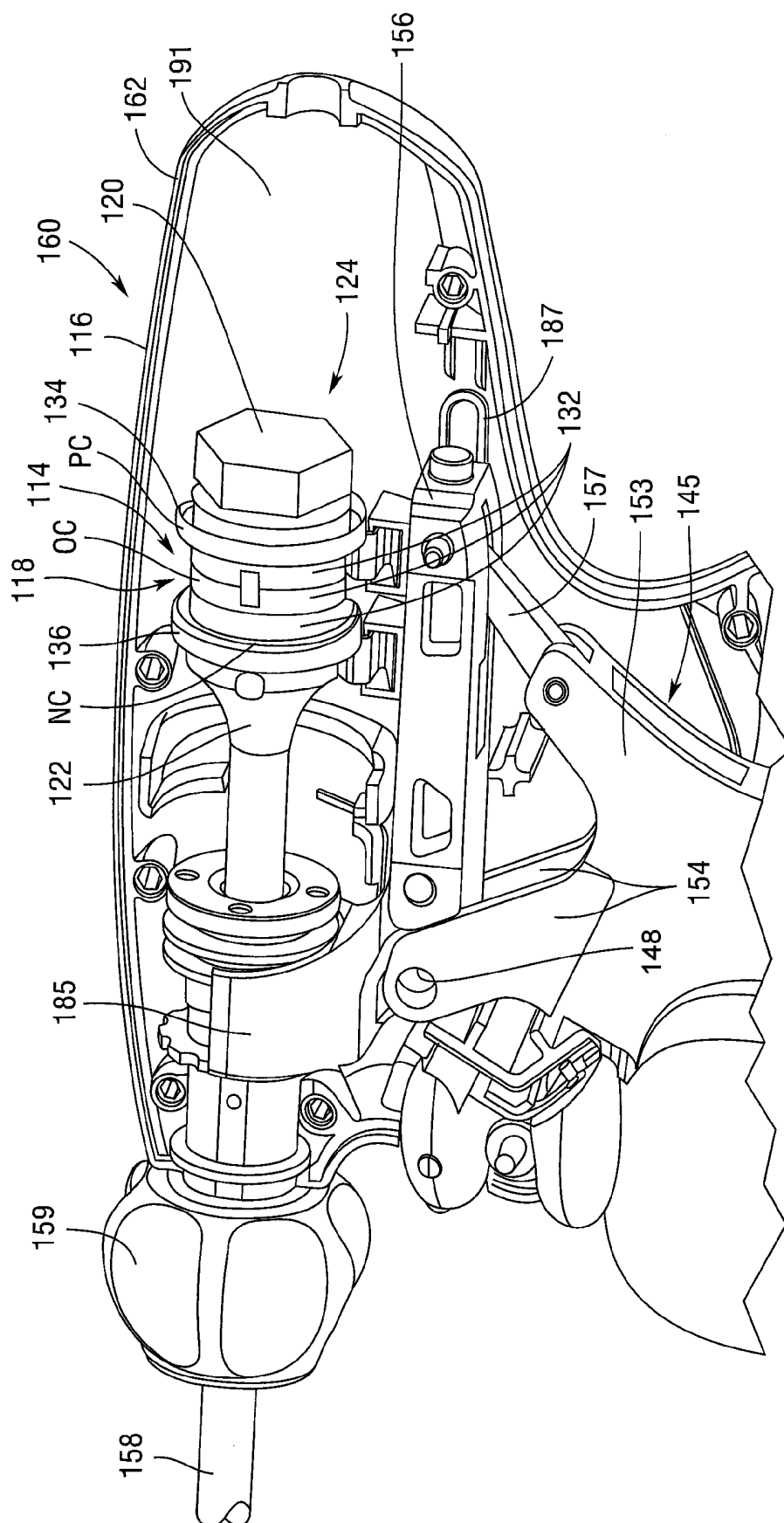

Fig. 2

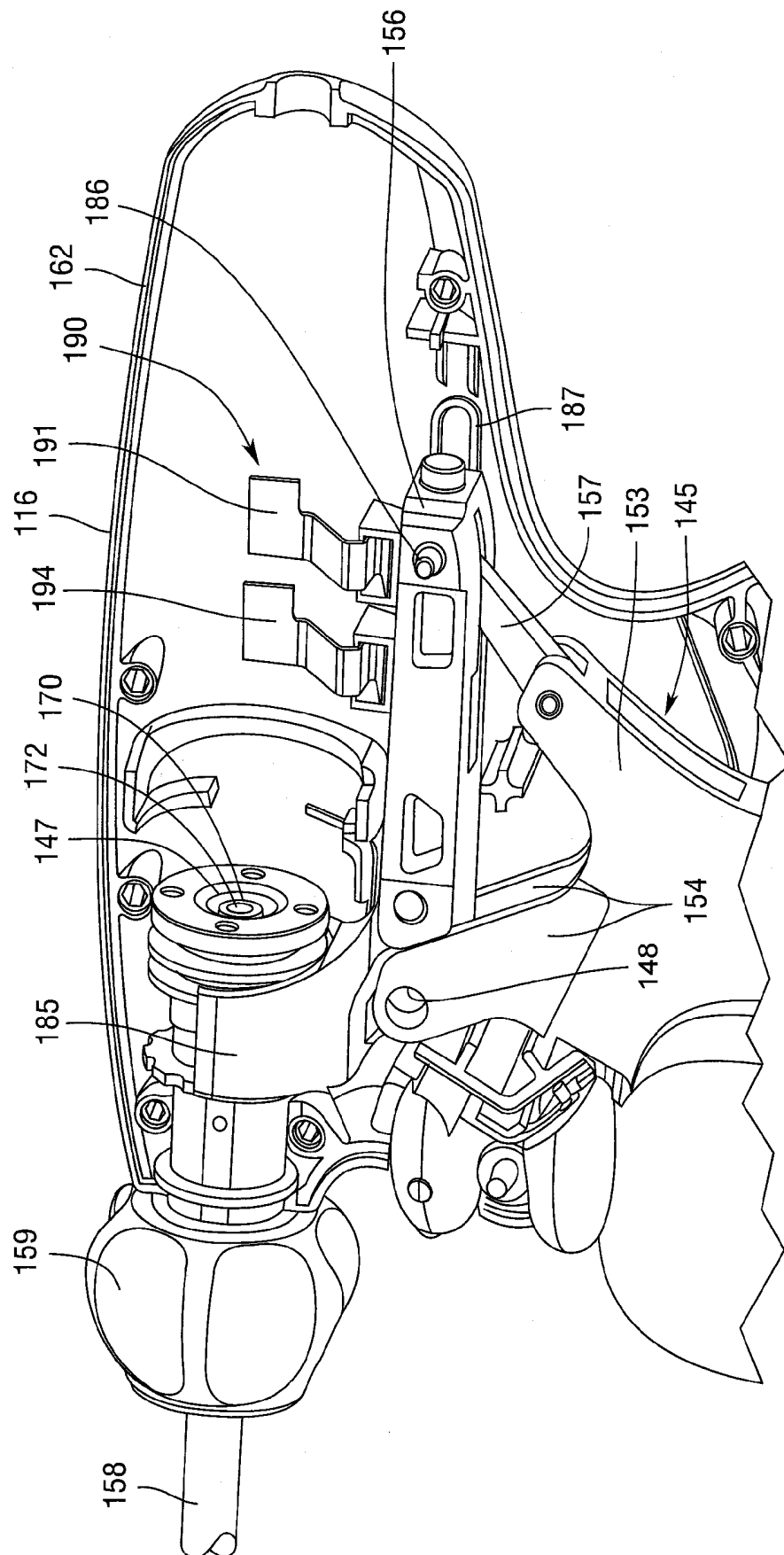

Fig. 3

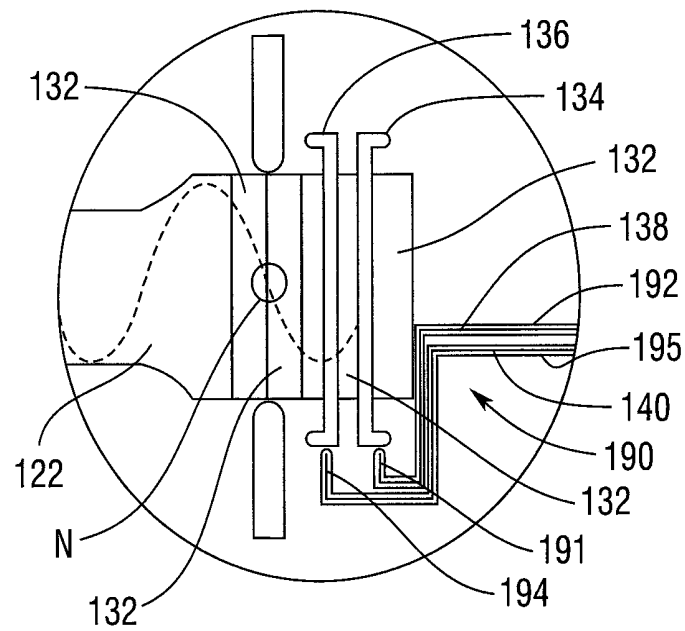

Fig.4

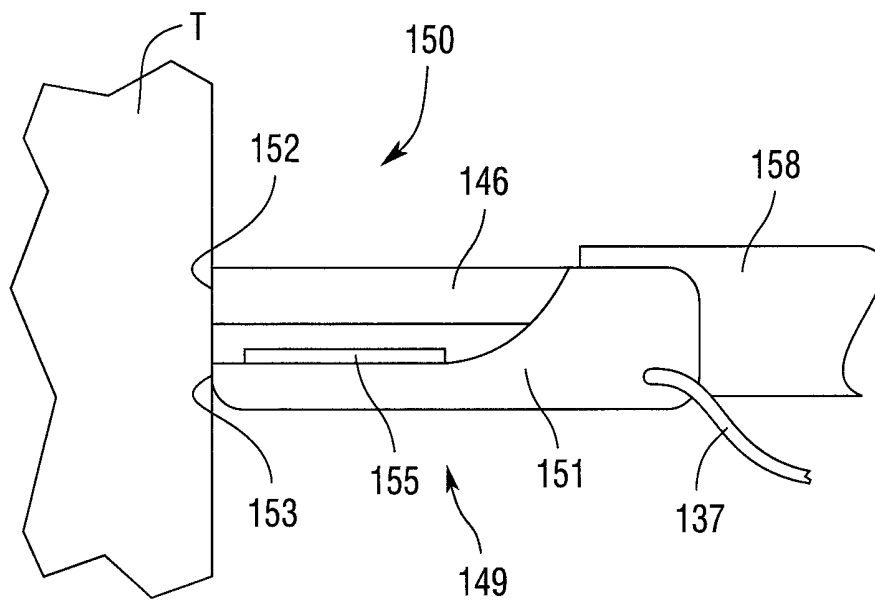

Fig.5

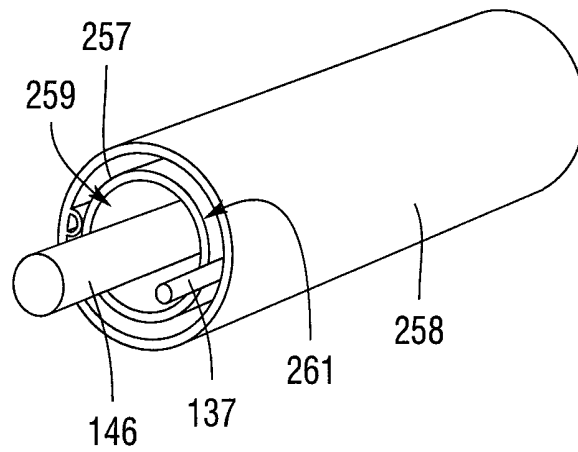

Fig. 6

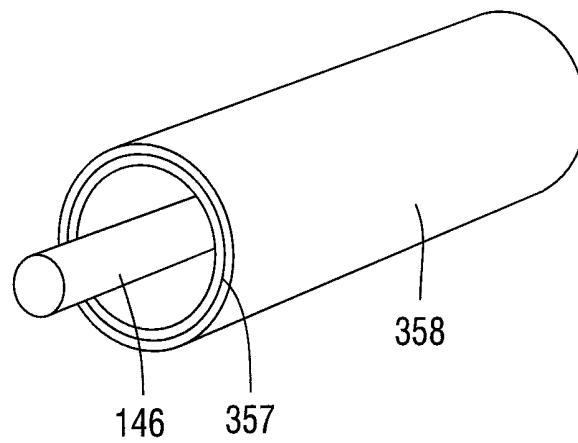

Fig. 7

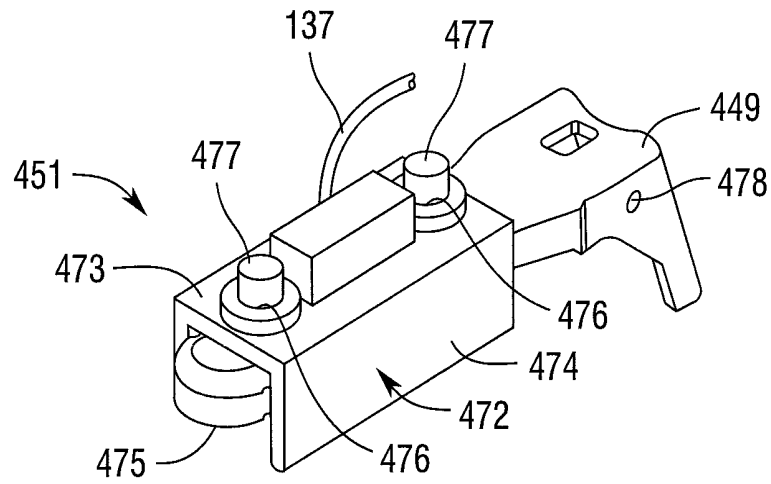

Fig. 8

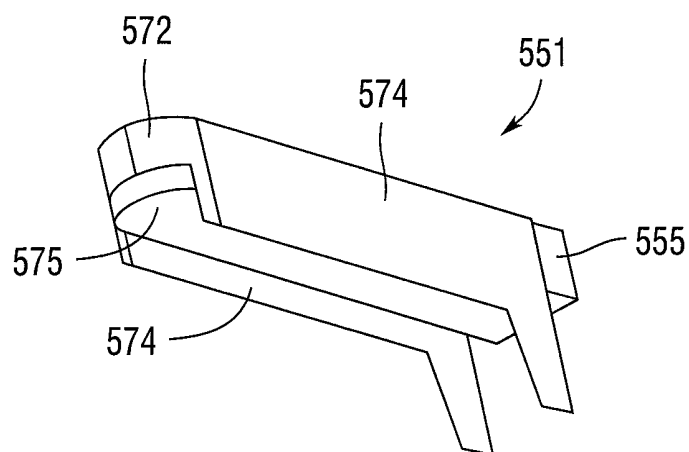
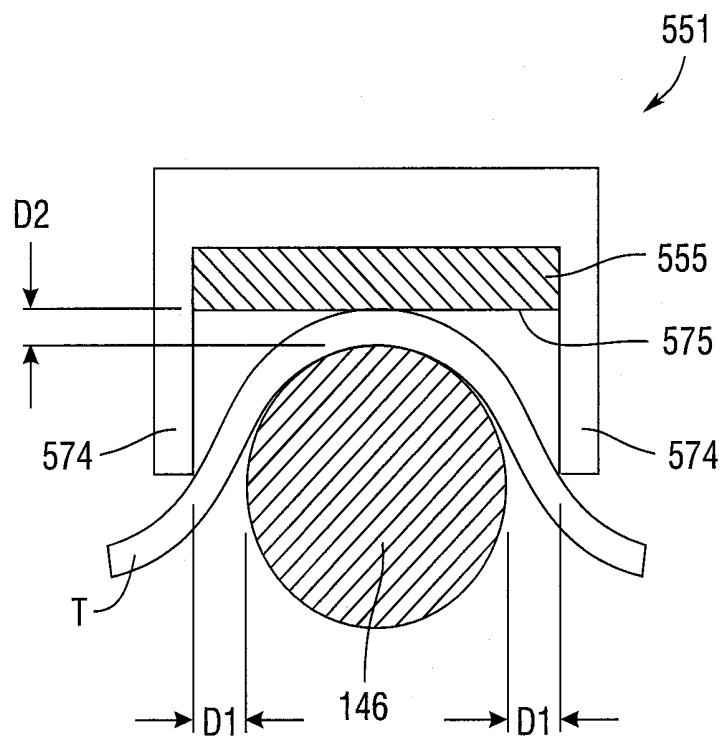

Fig. 9

**Fig.10**

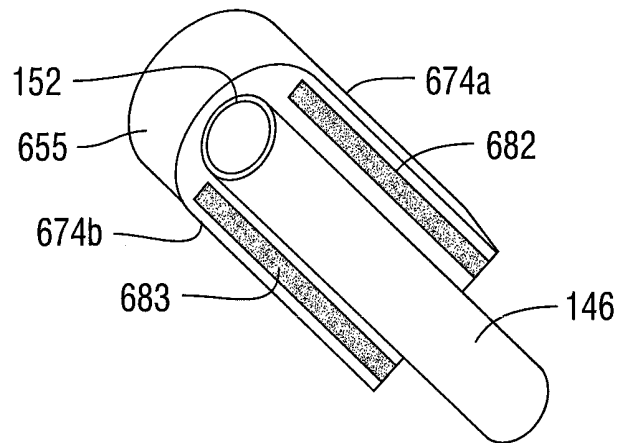

Fig. 11

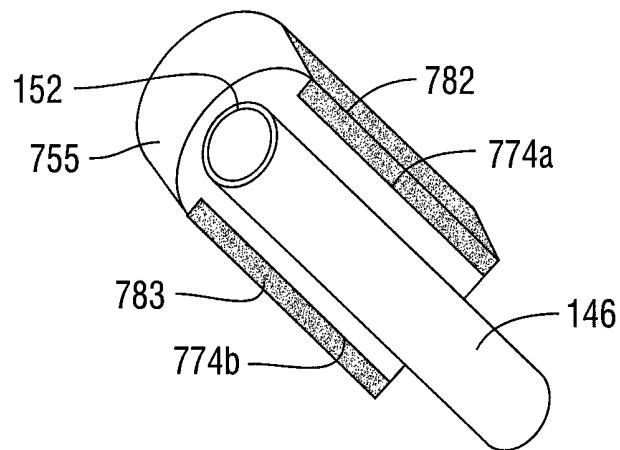

Fig. 12

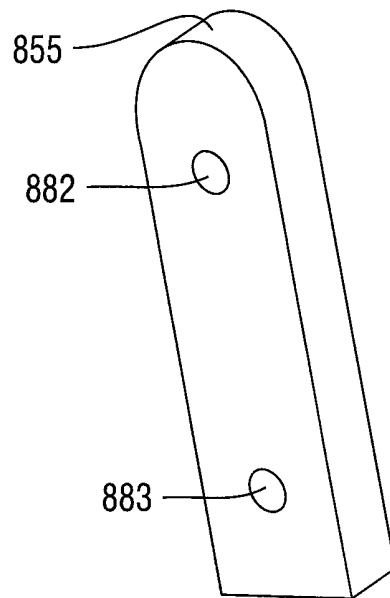

Fig.13

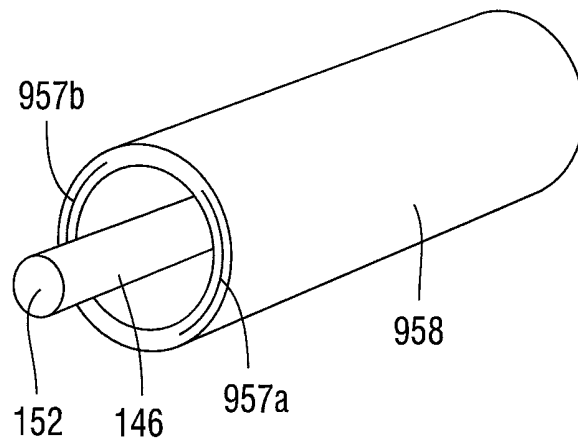

Fig.14

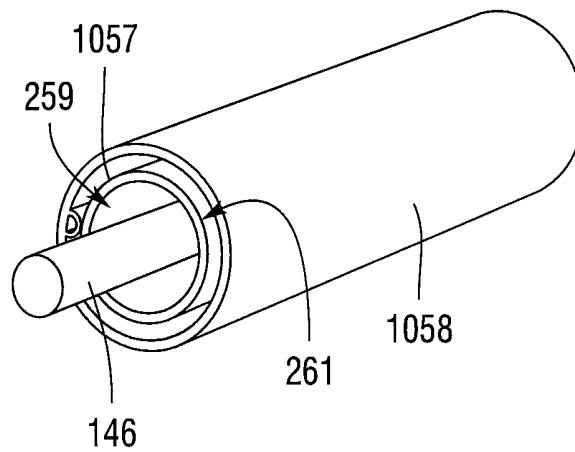

Fig.15

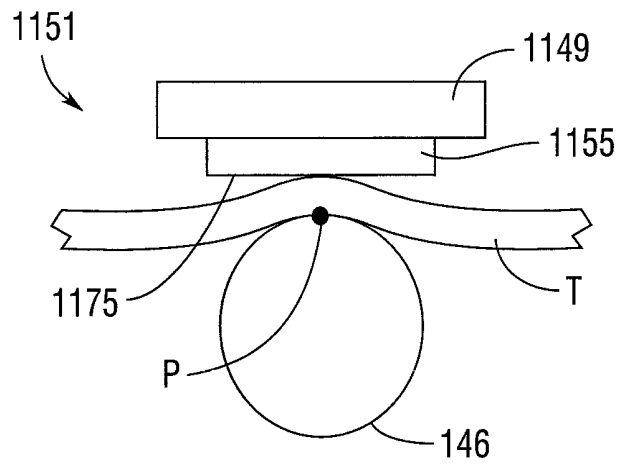

Fig. 16

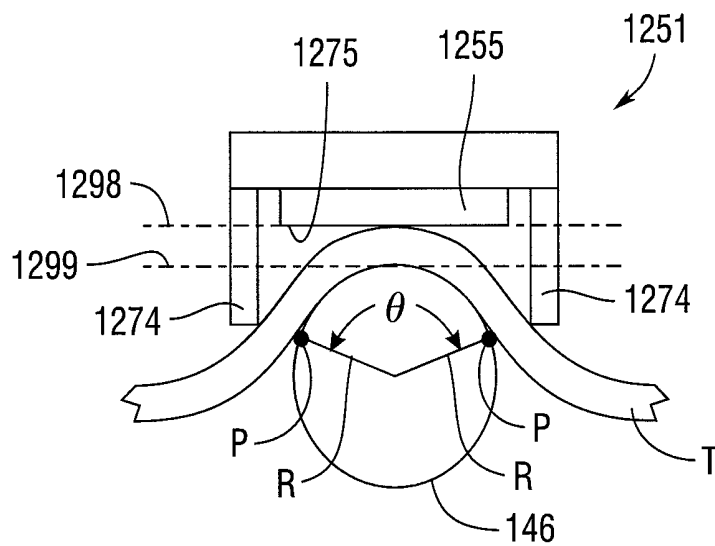

Fig. 17

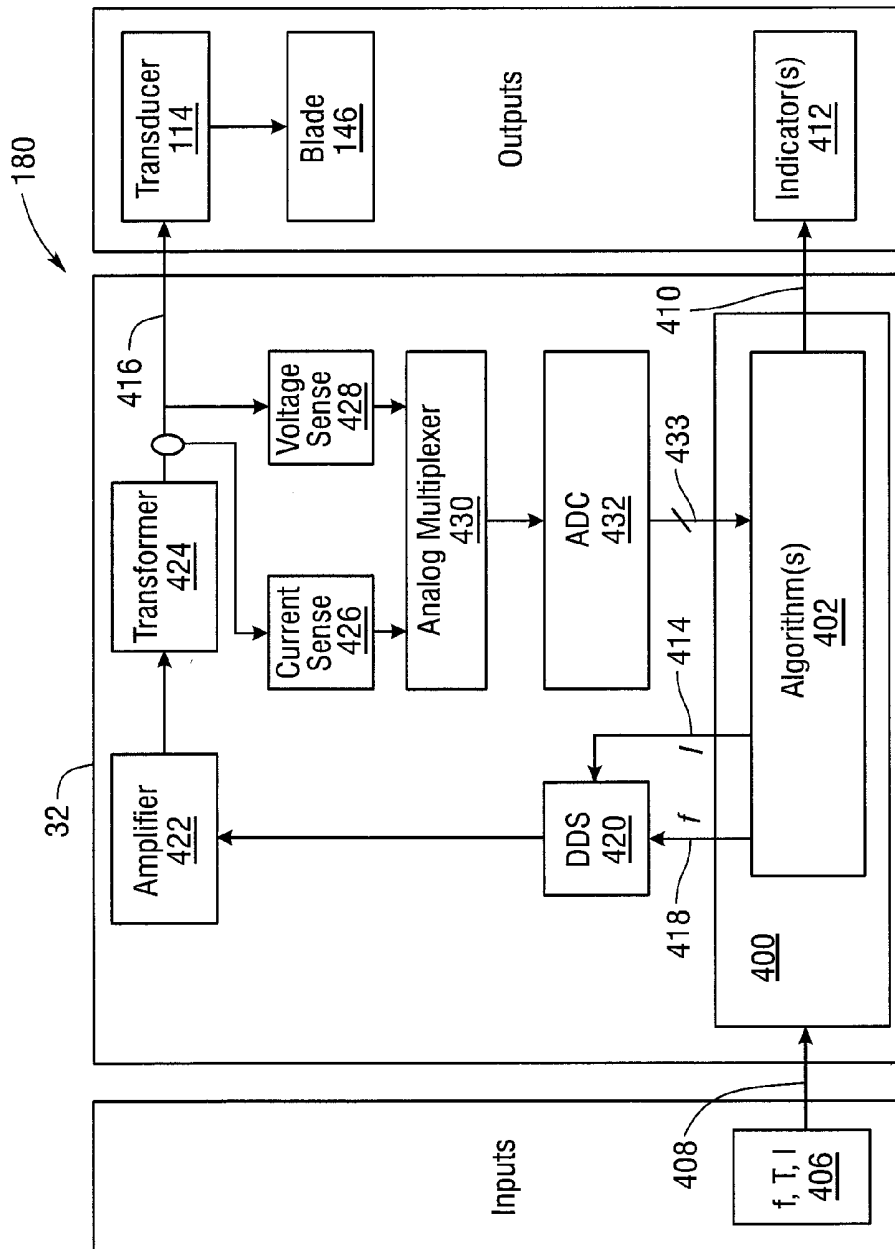

Fig.18

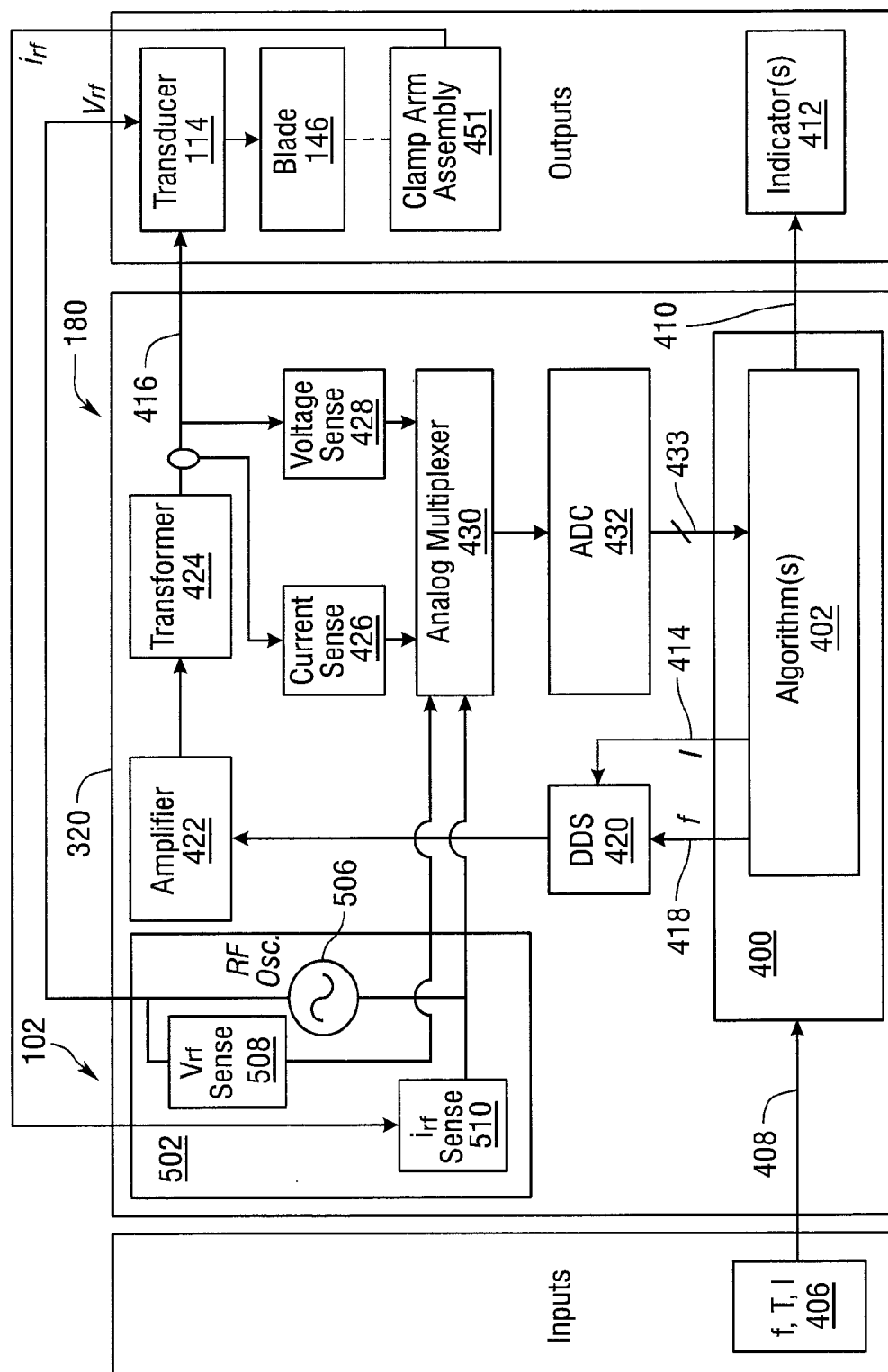
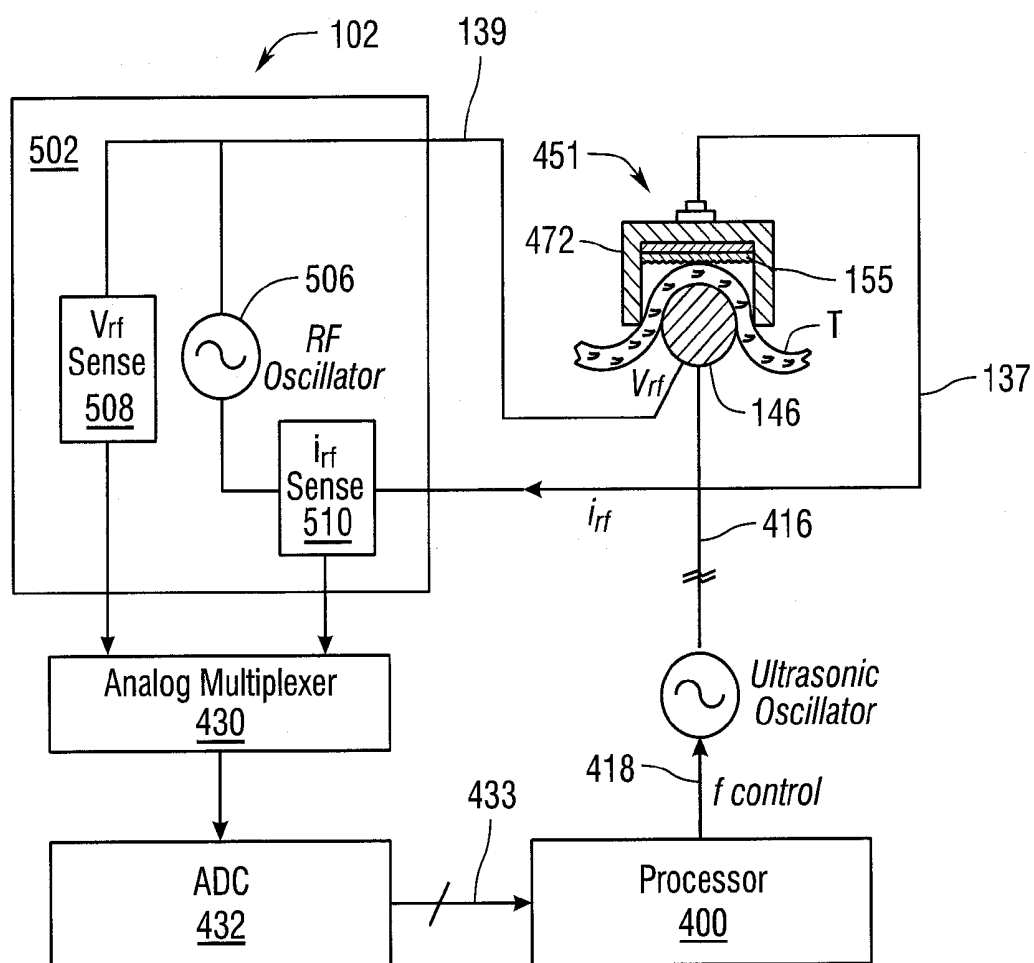

Fig. 19

*Fig.20*

ULTRASONIC SURGICAL INSTRUMENTS

CROSS-REFERENCE TO RELATED APPLICATION

This application is a divisional application under 35 U.S.C. §121 of co-pending U.S. patent application Ser. No. 12/503,769, filed on Jul. 15, 2009, entitled ULTRASONIC SURGICAL INSTRUMENTS, now U.S. Pat. No. 8,663,220, which is hereby incorporated by reference herein in its entirety.

BACKGROUND

The present disclosure generally relates to ultrasonic surgical systems and, more particularly, to ultrasonic systems that allow surgeons to perform cutting and coagulation.

Ultrasonic surgical instruments are finding increasingly widespread applications in surgical procedures by virtue of the unique performance characteristics of such instruments. Depending upon specific instrument configurations and operational parameters, ultrasonic surgical instruments can provide substantially simultaneous cutting of tissue and homeostasis by coagulation, desirably minimizing patient trauma. The cutting action is typically realized by an end effector, or blade tip, at the distal end of the instrument, which transmits ultrasonic energy to tissue brought into contact with the end effector. Ultrasonic instruments of this nature can be configured for open surgical use, laparoscopic, or endoscopic surgical procedures including robotic-assisted procedures.

Some surgical instruments utilize ultrasonic energy for both precise cutting and controlled coagulation. Ultrasonic energy cuts and coagulates by using lower temperatures than those used by electrosurgery. Vibrating at high frequencies (e.g., 55,500 times per second), the ultrasonic blade denatures protein in the tissue to form a sticky coagulum. Pressure exerted on tissue with the blade surface collapses blood vessels and allows the coagulum to form a hemostatic seal. The precision of cutting and coagulation is controlled by the surgeon's technique and adjusting the power level, blade edge, tissue traction, and blade pressure.

A primary challenge of ultrasonic technology for medical devices, however, continues to be sealing of blood vessels. Work done by the applicant and others has shown that optimum vessel sealing occurs when the inner muscle layer of a vessel is separated and moved away from the adventitia layer prior to the application of standard ultrasonic energy. Current efforts to achieve this separation have involved increasing the clamp force applied to the vessel.

Furthermore, the user does not always have visual feedback of the tissue being cut. Accordingly, it would be desirable to provide some form of feedback to indicate to the user that the cut is complete when visual feedback is unavailable. Moreover, without some form of feedback indicator to indicate that the cut is complete, the user may continue to activate the harmonic instrument even though the cut is complete, which cause possible damage to the harmonic instrument and surrounding tissue by the heat that is generated exponentially when activating a harmonic instrument with nothing between the jaws.

It would be desirable to provide an ultrasonic surgical instrument that overcomes some of the deficiencies of current instruments. The ultrasonic surgical instrument described herein overcomes those deficiencies.

SUMMARY

In various embodiments, a surgical instrument comprising a handpiece housing, an acoustic assembly supported within

the handpiece housing, wherein the acoustic assembly is configured to produce vibrations, and a waveguide comprising a proximal end and a distal end, wherein the proximal end is mounted to the acoustic assembly such that vibrations produced by the acoustic assembly are transmitted to the waveguide is disclosed. The surgical instrument further comprises an ultrasonic blade coupled to the distal end of the waveguide, wherein the ultrasonic blade comprises a tissue treatment portion configured to cut and coagulate tissue, a clamp movable between an open position and a closed position relative to the waveguide, wherein the clamp comprises a first electrode and a second electrode, and wherein the first electrode and the second electrode longitudinally overlap the tissue treatment portion of the ultrasonic blade when the clamp is in the closed position, a first conductor in electrical communication with the first electrode, and a second conductor in electrical communication with the second electrode, wherein the first conductor and the second conductor are configured to be placed in electrical communication with a power source such that current can flow from the first electrode to the second electrode through tissue positioned intermediate the first electrode and the second electrode.

In various embodiments, a surgical instrument comprising a housing, an acoustic assembly supported within the housing, wherein the acoustic assembly is configured to produce vibrations, and a waveguide coupled to the acoustic assembly is disclosed. The surgical instrument further comprises an ultrasonic blade extending from the waveguide, wherein the ultrasonic blade comprises a tissue treatment area configured to cut and coagulate tissue, and a clamp movable between an open position and a closed position relative to the waveguide. The clamp comprises an electrically non-conductive pad, a first electrode embedded in the electrically non-conductive pad, and a second electrode embedded in the electrically non-conductive pad, wherein the first electrode and the second electrode longitudinally overlap the tissue treatment area of the ultrasonic blade when the clamp is in the closed position. The surgical instrument further comprises a first conductor in electrical communication with the first electrode and a second conductor in electrical communication with the second electrode, wherein the first conductor and the second conductor are configured to be placed in electrical communication with a power source such that current can flow from the first electrode to the second electrode through tissue positioned intermediate the first electrode and the second electrode.

FIGURES

The features of various embodiments are set forth with particularity in the appended claims. The various embodiments, however, both as to organization and methods of operation, together with further objects and advantages thereof, may best be understood by reference to the following description, taken in conjunction with the accompanying drawings as follows.

FIG. 1 illustrates a surgical instrument comprising an ultrasonic surgical instrument system and an electrosurgery surgical instrument system.

FIG. 2 illustrates a portion of a handpiece assembly of the surgical instrument of FIG. 1 with a portion of the handpiece housing removed and an acoustic assembly operably engaged with a waveguide of the surgical instrument.

FIG. 3 illustrates the handpiece assembly of FIG. 2 with the acoustic assembly removed to illustrate positive and negative electrode contacts configured to supply the acoustic assembly with power.

FIG. 4 is a detail view of a portion of the acoustic assembly of FIG. 2.

FIG. 5 is a detail view of the end effector of the ultrasonic surgical instrument of FIG. 1.

FIG. 6 is a perspective view of an embodiment of a sheath assembly comprising an inner sheath and an outer sheath which can define a first passageway for a waveguide of an ultrasonic instrument and a second passageway for a return conductor.

FIG. 7 is a perspective view of an embodiment of a sheath configured to surround at least a portion of a waveguide of an ultrasonic surgical instrument, wherein a conductor can be embedded in at least a portion of a sheath.

FIG. 8 is a perspective view of an embodiment of a clamp arm assembly configured to hold tissue against a waveguide of an ultrasonic surgical instrument.

FIG. 9 is a perspective view of another embodiment of a clamp arm assembly having downwardly-extending walls which extend below a tissue-contacting surface.

FIG. 10 is a cross-sectional end view of the clamp arm assembly of FIG. 9 positioned in a closed position relative to a waveguide of an ultrasonic surgical instrument.

FIG. 11 is a perspective view of a tissue-contacting pad of a clamp arm assembly, wherein the pad includes first and second electrodes embedded therein and positioned relative to a waveguide of an ultrasonic surgical instrument.

FIG. 12 is a perspective view of another embodiment of a tissue-contacting pad of a clamp arm assembly, wherein the pad includes first and second electrodes mounted thereto and positioned relative to a waveguide of an ultrasonic surgical instrument.

FIG. 13 is a perspective view of another embodiment of a tissue-contacting pad of a clamp arm assembly, wherein the pad includes first and second point electrodes embedded therein.

FIG. 14 is a perspective view of an embodiment of a sheath configured to surround at least a portion of a waveguide of an ultrasonic surgical instrument, wherein first and second conductors can be embedded in at least a portion of a sheath.

FIG. 15 is a perspective view of an embodiment of a sheath assembly comprising an inner sheath and an outer sheath, wherein the inner sheath and the outer sheath may comprise first and second conductors.

FIG. 16 is an end view of a clamp arm assembly holding tissue against a waveguide.

FIG. 17 is an end view of an alternative embodiment of a clamp arm assembly holding tissue against a waveguide.

FIG. 18 illustrates one embodiment of a drive system of an ultrasonic generator module, which creates the ultrasonic electrical signal for driving an ultrasonic transducer.

FIG. 19 illustrates one embodiment of a drive system of a generator comprising a tissue impedance module.

FIG. 20 is a schematic diagram of a tissue impedance module coupled to a blade and a clamp arm assembly with tissue located therebetween.

DESCRIPTION

Before explaining various embodiments of ultrasonic surgical instruments in detail, it should be noted that the illustrative embodiments are not limited in application or use to the details of construction and arrangement of parts

illustrated in the accompanying drawings and description. The illustrative embodiments may be implemented or incorporated in other embodiments, variations and modifications, and may be practiced or carried out in various ways. Further, unless otherwise indicated, the terms and expressions employed herein have been chosen for the purpose of describing the illustrative embodiments for the convenience of the reader and are not for the purpose of limitation thereof.

Further, it is understood that any one or more of the following-described embodiments, expressions of embodiments, examples, can be combined with any one or more of the other following-described embodiments, expressions of embodiments, and examples.

Various embodiments are directed to improved ultrasonic surgical instruments configured for effecting tissue dissecting, cutting, and/or coagulation during surgical procedures. In one embodiment, an ultrasonic surgical instrument apparatus is configured for use in open surgical procedures, but has applications in other types of surgery, such as laparoscopic, endoscopic, and robotic-assisted procedures. Versatile use is facilitated by selective use of ultrasonic energy.

It will be appreciated that the terms “proximal” and “distal” are used herein with reference to a clinician gripping a handpiece assembly. Thus, an end effector is distal with respect to the more proximal handpiece assembly. It will be further appreciated that, for convenience and clarity, spatial terms such as “top” and “bottom” also are used herein with respect to the clinician gripping the handpiece assembly. However, surgical instruments are used in many orientations and positions, and these terms are not intended to be limiting and absolute.

The various embodiments will be described in combination with an ultrasonic instrument as described herein. Such description is provided by way of example, and not limitation, and is not intended to limit the scope and applications thereof. For example, any one of the described embodiments is useful in combination with a multitude of ultrasonic instruments including those described in, for example, U.S. Pat. Nos. 5,322,055; 5,449,370; 5,630,420; 5,935,144; 5,938,633; 5,944,737; 5,954,736; 6,278,218; 6,283,981; 6,309,400; 6,325,811; and 6,436,115, wherein the disclosure of each of the patents is herein incorporated by reference. Also incorporated by reference in its entirety is commonly-owned, co-pending U.S. patent application Ser. No. 11/726,625, entitled ULTRASONIC SURGICAL INSTRUMENTS, filed on Mar. 22, 2007, now U.S. Patent Application Publication No. 2008/0234710. The disclosure of each the following commonly-owned U.S. Patent Applications is incorporated herein by reference in its entirety:

(1) U.S. patent application Ser. No. 12/503,770, entitled “ROTATING TRANSDUCER MOUNT FOR ULTRASONIC SURGICAL INSTRUMENTS”, now U.S. Pat. No. 8,461,744; and

(2) U.S. patent application Ser. No. 12/503,766, entitled “IMPEDENCE MONITORING APPARATUS, SYSTEM, AND METHOD FOR ULTRASONIC SURGICAL INSTRUMENTS”, now U.S. Patent Application Publication No. 2011/0015627;

(3) U.S. patent application Ser. No. 12/503,775, entitled “ULTRASONIC DEVICE FOR CUTTING AND COAGULATING WITH STEPPED OUTPUT”, now U.S. Pat. No. 8,058,771.

As will become apparent from the following description, it is contemplated that embodiments of the surgical instrument described herein may be used in association with an oscillator module of a surgical system, whereby ultrasonic

energy from the oscillator module provides the desired ultrasonic actuation for the present surgical instrument. It is also contemplated that embodiments of the surgical instrument described herein may be used in association with a signal generator module of a surgical system, whereby electrical energy in the form of radio frequencies (RF), for example, is used to provide feedback to the user regarding the surgical instrument. The ultrasonic oscillator and/or the signal generator modules may be non-detachably integrated with the surgical instrument or may be provided as separate components, which can be electrically attachable to the surgical instrument.

One embodiment of the present surgical apparatus is particularly configured for disposable use by virtue of its straightforward construction. However, it is also contemplated that other embodiments of the present surgical instrument can be configured for non-disposable or multiple uses. Detachable connection of the present surgical instrument with an associated oscillator and signal generator unit is presently disclosed for single-patient use for illustrative purposes only. However, non-detachable integrated connection of the present surgical instrument with an associated oscillator and/or signal generator unit is also contemplated. Accordingly, various embodiments of the presently described surgical instruments may be configured for single use and/or multiple uses and with either detachable and/or non-detachable integral oscillator and/or signal generator modules, without limitation. All combinations of such configurations are contemplated to be within the scope of the present disclosure.

FIG. 1 illustrates one embodiment of a surgical system 100. The surgical system 100 includes a generator 112 and an ultrasonic surgical instrument 110. The generator 112 is connected to an ultrasonic transducer 114 portion of the ultrasonic surgical instrument 110 via a suitable transmission medium such as a cable 142. In one embodiment, the generator 112 is coupled to an ultrasonic generator module 180 and a signal generator module 102. In various embodiments, the ultrasonic generator module 180 and/or the signal generator module 102 each may be formed integrally with the generator 112 or may be provided as a separate circuit modules electrically coupled to the generator 112 (shown in phantom to illustrate this option). In one embodiment, the signal generator module 102 may be formed integrally with the ultrasonic generator module 180. Although in the presently disclosed embodiment, the generator 112 is shown separate from the surgical instrument 110, in one embodiment, the generator 112 may be formed integrally with the surgical instrument 110 to form a unitary surgical system 100. The generator 112 comprises an input device 406 located on a front panel of the generator 112 console. The input device 406 may comprise any suitable device that generates signals suitable for programming the operation of the generator 112 as subsequently described with reference to FIG. 18. Still with reference to FIG. 1, the cable 142 may comprise multiple electrical conductors 139, 141 for the application of electrical energy to positive (+) and negative (−) electrodes of the ultrasonic transducer 114. It will be noted that, in some applications, the ultrasonic transducer 114 may be referred to as a “handle assembly” because the surgical instrument 110 of the surgical system 100 may be configured such that a surgeon may grasp and manipulate the ultrasonic transducer 114 during various procedures and operations.

In one embodiment, the generator 112 may be implemented as an electrosurgery unit (ESU) capable of supplying power sufficient to perform bipolar electrosurgery using

radio frequency (RF) energy. In one embodiment, the ESU can be a bipolar ERBE ICC 350 sold by ERBE USA, Inc. of Marietta, Ga. In bipolar electrosurgery applications, as previously discussed, a surgical instrument having an active electrode and a return electrode can be utilized, wherein the active electrode and the return electrode can be positioned against, or adjacent to, the tissue to be treated such that current can flow from the active electrode to the return electrode through the tissue. Accordingly, the generator 112 may be configured for therapeutic purposes by applying electrical energy to the tissue T sufficient for treating the tissue (e.g., cauterization).

In one embodiment, the signal generator module 102 may be configured to deliver a subtherapeutic RF signal to implement a tissue impedance measurement module. In one embodiment, the signal generator module 102 comprises a bipolar radio frequency generator as described in more detail below. In one embodiment, signal generator module 102 may be configured to monitor the electrical impedance Z_t of tissue T (FIG. 5) and to control the characteristics of time and power level based on the tissue impedance Z_t . The tissue impedance Z_t may be determined by applying the subtherapeutic RF signal to the tissue T and measuring the current through the tissue T (FIGS. 5, 10, 16, 17) by way of a return electrode on provided on a clamp member 151, as discussed in more detail below. Accordingly, the signal generator module 102 may be configured for subtherapeutic purposes for measuring the impedance or other electrical characteristics of the tissue T. Techniques and circuit configurations for measuring the impedance or other electrical characteristics of the tissue T are discussed in more detail below with reference to FIGS. 18-20 below.

A suitable ultrasonic generator module 180 may be configured to functionally operate in a manner similar to the GEN 300 sold by Ethicon Endo-Surgery, Inc. of Cincinnati, Ohio as is disclosed in one or more of the following U.S. Patents, all of which are incorporated by reference herein: U.S. Pat. No. 6,480,796 (Method for Improving the Start Up of an Ultrasonic System Under Zero Load Conditions); U.S. Pat. No. 6,537,291 (Method for Detecting a Loose Blade in a Handle Connected to an Ultrasonic Surgical System); U.S. Pat. No. 6,626,926 (Method for Driving an Ultrasonic System to Improve Acquisition of Blade Resonance Frequency at Startup); U.S. Pat. No. 6,633,234 (Method for Detecting Blade Breakage Using Rate and/or Impedance Information); U.S. Pat. No. 6,662,127 (Method for Detecting Presence of a Blade in an Ultrasonic System); U.S. Pat. No. 6,678,621 (Output Displacement Control Using Phase Margin in an Ultrasonic Surgical Handle); U.S. Pat. No. 6,679,899 (Method for Detecting Transverse Vibrations in an Ultrasonic Handle); U.S. Pat. No. 6,908,472 (Apparatus and Method for Altering Generator Functions in an Ultrasonic Surgical System); U.S. Pat. No. 6,977,495 (Detection Circuitry for Surgical Handpiece System); U.S. Pat. No. 7,077,853 (Method for Calculating Transducer Capacitance to Determine Transducer Temperature); U.S. Pat. No. 7,179,271 (Method for Driving an Ultrasonic System to Improve Acquisition of Blade Resonance Frequency at Startup); and U.S. Pat. No. 7,273,483 (Apparatus and Method for Alerting Generator Function in an Ultrasonic Surgical System).

In accordance with the described embodiments, the ultrasonic generator module 180 produces electrical signals of a particular voltage, current, and frequency, e.g. 55,500 cycles per second (Hz). The generator is 112 connected by the cable 142 to the ultrasonic generator module 180 in the handpiece assembly 160, which contains piezoceramic elements forming the ultrasonic transducer 114. In response to a switch 143

on the handpiece assembly **160** or a foot switch **144** connected to the generator **112** by another cable **105** the generator signal is applied to the transducer **114**, which causes a longitudinal vibration of its elements. A structure connects the transducer **114** to a surgical blade **146**, which is thus vibrated at ultrasonic frequencies when the generator signal is applied to the transducer **114**. The structure is designed to resonate at the selected frequency, thus amplifying the motion initiated by the transducer **114**. In one embodiment, the generator **112** is configured to produce a particular voltage, current, and/or frequency output signal that can be stepped with high resolution, accuracy, and repeatability.

Referring now to FIGS. 1-4, the handpiece assembly **160** of the surgical instrument system **110** may include a handpiece housing **116** that operably supports the end effector **150**. The handpiece housing **116** rotatably supports an acoustic assembly **124** therein. The acoustic assembly **124** includes the ultrasonic transducer **114** that generally includes a transduction portion **118**, a first resonator or end-bell **120**, a second resonator or fore-bell **122**, and ancillary components as shown in FIG. 2. In various embodiments, the ultrasonic energy produced by the transducer **114** can be transmitted through the acoustic assembly **124** to the end effector **150** via the ultrasonic transmission waveguide **147** as shown in FIGS. 1 and 3. In order for the acoustic assembly **124** to deliver energy to the waveguide **147**, and ultimately to the end effector **150**, the components of the acoustic assembly **124** are acoustically coupled to the blade **146**. For example, the distal end of the ultrasonic transducer **114** may be acoustically coupled to the proximal end **170** of the waveguide **147** by a coupling assembly that enables the acoustic assembly **124** to freely rotate relative to the waveguide **147** while transmitting ultrasonic energy thereto.

As shown in FIG. 3, the proximal end **170** of the waveguide **147** may be provided with an aperture **172** therein that is sized to receive a stem (not shown) that protrudes distally from the fore-bell **122**. In various embodiments, piezoelectric elements **132**, for example, can be compressed between the end-bell **120** and the fore-bell **122** to form a stack of piezoelectric elements when the end-bell **120** and the fore-bell **122** are assembled together as illustrated in FIGS. 2-4. The piezoelectric elements **132** may be fabricated from any suitable material, such as, for example, lead zirconate-titanate, lead meta-niobate, lead titanate, and/or any suitable piezoelectric crystal material, for example. As shown in FIGS. 2 and 4, the transducer **114** may comprise electrodes, such as at least one positive electrode **134** and at least one negative electrode **136**, for example, which can be configured to create a voltage potential across the one or more piezoelectric elements **132**. As shown in FIG. 2, the positive electrode **134** and the negative electrode **136**, and the piezoelectric elements **132** can each be configured with a bore (not shown) that cooperates to form a passageway that can receive a threaded portion of the end-bell **120**. In one embodiment, the positive electrode **134** is provided in the form of an annular ring that has a first circumference "PC" and the negative electrode **136** is also provided in the form of an annular ring that has a second circumference "NC." As shown in FIG. 2, in various embodiments, the stack of piezoelectric elements **132** may have an outer circumference "OC" that is less than the first and second circumferences "PC" and "NC."

In various embodiments, the handpiece housing **116** may support the ultrasonic generator module **180** and/or the signal generator module **102**. In one embodiment, the ultra-

sonic generator module **180** may be electrically coupled to an electrical contact assembly **190** that may comprise a positive slip ring contact **191** that is mounted within handpiece housing **116** for rotatable contact with the positive electrode **134**. The positive slip ring contact **191** is electrically coupled to the ultrasonic generator module **180** by a positive ultrasonic supply cable/conductor **192**. The electrical contact assembly **190** may further comprise a negative slip ring contact **194** that is mounted within handpiece housing **116** for rotatable contact with the negative electrode **136**. The negative slip ring contact **194** is electrically coupled to the ultrasonic generator module **180** by a negative ultrasonic supply cable **195**. It will be appreciated that such arrangement enables the acoustic assembly **124** to freely rotate relative to the ultrasonic generator module **180** while remaining in full electrical contact therewith.

In various embodiments, the ultrasonic transmission waveguide **147** may comprise a plurality of stabilizing silicone rings or compliant supports (not shown) positioned at, or at least near, a plurality of nodes. As was discussed above, the silicone rings can dampen undesirable vibration and isolate the ultrasonic energy from the sheath **158** that at least partially surrounds the waveguide **147**, thereby assuring the flow of ultrasonic energy in a longitudinal direction to the distal end **152** of the end effector **150** with maximum efficiency.

As shown in FIGS. 2 and 3, the sheath **158** can be coupled to a rotation wheel **159** that is rotatably attached to the distal end of the handpiece assembly **160**. The rotation wheel **159** facilitates selective rotation of the sheath **158** and the waveguide **147** relative to the handpiece assembly **160**. The sheath **158** may have an adapter portion **162** that may be threaded or snapped onto the rotation wheel **159**. The rotation wheel **159** may include a flanged portion (not shown) that is snapped into an annular groove in the handpiece assembly **160** to facilitate rotation of the sheath **158** and waveguide **147** relative to the handpiece assembly **160** about axis A-A. In one embodiment, the sheath **158** also includes a hollow tubular portion **164** through which the waveguide **147** extends in the manner described in further detail above. In various embodiments, the adapter **162** of the sheath **158** may be constructed from ULTEM®, for example, and the tubular portion **164** may be fabricated from stainless steel, for example. In at least one embodiment, the ultrasonic transmission waveguide **147** may have polymeric material, for example, surrounding it in order to isolate it from outside contact.

In the embodiment, as shown in FIG. 1, the ultrasonic generator module **180** is electrically coupled to the electronic signal/radio frequency generator **112** by the cables **139**, **141** which may be housed in a sheath to form the cable **142**. Because the acoustic assembly **124** can freely rotate relative to the ultrasonic generator module **180**, the waveguide **147** and the end effector **150** may be freely rotated about axis A-A relative to the handpiece assembly **160** without causing the cable **142** to undesirably twist and tangle.

As illustrated in FIGS. 2 and 3, the handpiece assembly **160** may have a pistol grip configuration and operably support a movable trigger assembly **145** that is pivotally supported within the handpiece assembly **160**. To facilitate easy assembly, the handpiece assembly **160** may comprise two housing segments **162** that are coupled together by threaded fasteners, snap features, adhesive. The movable trigger assembly **145** includes a trigger portion **153** that has a pair of spaced attachment arms **154** that each has a hole **155** therethrough. Holes **155** are each sized to receive a

corresponding pivot pin (not shown) that protrudes from each of the housing segments 162. Such arrangement permits the trigger portion 153 to pivot relative to the handpiece assembly 160 about an axis that is substantially transverse to axis A-A.

As shown in FIGS. 2 and 3, the trigger assembly 145 may comprise an actuation arm 156 that is attached to the trigger portion 153 via an intermediate link 157. The actuation arm 156 is pivotally coupled (pinned) to the trigger yoke 185. The arm 156 has a mounting pin 186 extending transversely therethrough that is sized to be slidably received in corresponding elongated cavities 187 formed in the housing segments 162. See FIGS. 2 and 3. Such arrangement facilitates the axial movement of the actuation arm 156 within the handpiece assembly 160 in response to pivoting the trigger portion 153.

In the embodiment illustrated in FIG. 1, the end effector 150 portion of the surgical system 100 comprises a clamp arm assembly 149 connected at a distal end of the surgical instrument 110. The blade 146 forms a first (e.g., energizing) electrode and the clamp arm assembly 149 comprises an electrically conductive portion that forms a second (e.g., return) electrode. The signal generator module 102 is coupled to the blade 146 and the clamp arm assembly 149 through a suitable transmission medium such as a cable 137. The cable 137 comprises multiple electrical conductors for applying a voltage to the tissue and providing a return path for current flowing through the tissue back to the signal generator module 102. In various embodiments, the signal generator module 102 may be formed integrally with the generator 112 or may be provided as a separate circuit coupled to the generator 112 and, in one embodiment, may be formed integrally with the ultrasonic generator module 180 (shown in phantom to illustrate these options).

In one embodiment, the surgical system 100 illustrated in FIG. 1 may comprise components for selectively energizing an end effector 150 and transmitting mechanical energy thereto and, in addition, selectively energizing the end effector 150 with therapeutic and/or subtherapeutic electrical energy. The surgical instrument 110 may be switchable between a first operating mode in which mechanical energy, or vibrations at ultrasonic frequencies (e.g., 55.5 kHz), are transmitted to the end effector 150 and a second operating mode in which electrical energy (e.g., therapeutic and/or subtherapeutic), or current, is permitted to flow through the end effector 150. In certain embodiments, referring to FIG. 1, in a first operating mode of the surgical instrument 110, for example, the transducer 114 converts electrical energy supplied thereto by the ultrasonic generator module 180 (e.g., an ultrasonic oscillator) of the generator 112 into mechanical vibrations and transmit the vibrations into a waveguide 147 to the blade 146 portion of the end effector 150, for example. Such mechanical vibrations can be generated at ultrasonic frequencies, although any suitable frequency, or frequencies, can be used. In the second operating mode of the surgical instrument 110, an electrical current may be supplied by the generator 112 that can flow through the transducer 114, the waveguide 147, and the end effector 150. The current flowing through the waveguide 147 and end effector 150 can be an alternating current (AC current), wherein, in various embodiments, the wave form of the AC current can be sinusoidal and/or may comprise a series of step intervals, for example.

In one embodiment, the current supplied by the signal generator module 102 is an RF current. In any event, the surgical instrument 110 may comprise a supply path and a return path, wherein the tissue T (FIG. 5) being treated

completes, or closes, an electrical circuit, or loop, comprising a supply path through the transducer 114, the waveguide 147, and the blade 146 and a return path through conductor cable 137. In one embodiment, the patient can be positioned on a conductive pad wherein the current can flow from a supply path of the surgical instrument, through the patient, and into the conductive pad in order to complete the electrical circuit.

Still referring to FIG. 1, as previously discussed, in one embodiment the surgical instrument system 110 may be energized by the generator 112 by way of the foot switch 144 in order to energize the end effector 150. When actuated, the foot switch 144 triggers the generator 112 to deliver electrical energy to the handpiece assembly 160, for example. Although the foot switch 144 may be suitable in many circumstances, other suitable switches can be used. In various embodiments, the surgical instrument system 110 may comprise at least one supply conductor 139 and at least one return conductor 141, wherein current can be supplied to handpiece assembly 160 via the supply conductor 139 and wherein the current can flow back to the generator 112 via return conductor 141. In various embodiments, the supply conductor 139 and the return conductor 141 may comprise insulated wires and/or any other suitable type of conductor. In certain embodiments, as described below, the supply conductor 139 and the return conductor 141 may be contained within and/or may comprise a cable extending between, or at least partially between, the generator 112 and the transducer 114 portion of the handpiece assembly 160. In any event, the generator 112 can be configured to apply a sufficient voltage differential between the supply conductor 139 and the return conductor 141 such that sufficient current can be supplied to the transducer 114.

In various embodiments, still referring to FIG. 1, the supply conductor 139 and the return conductor 141 may be operably connected to a transducer drive unit 135, wherein the drive unit 135 can be configured to receive current from the generator 112 via the supply conductor 139. In certain embodiments, the handpiece assembly 160 may comprise a switch, such as a toggle switch 143, for example, which can be manipulated to place the surgical instrument 110 in one of a first operating mode and a second operating mode. In one embodiment, as described below, the toggle switch 143 may comprise a first toggle button 143a which can be depressed to place the surgical instrument 110 in the first operating mode and, in addition, a second toggle button 143b which can be depressed to place the surgical instrument in the second operating mode. Although a toggle switch is illustrated and described herein, any suitable switch, or switches, can be used. When the first toggle button 143a is depressed, the transducer drive unit 135 can operate a transducer, such as the transducer 114, for example, such that the transducer 114 produces vibrations. The transducer 114 may comprise one or more piezoelectric elements 132, wherein the drive unit 135 can be configured to apply a voltage differential, and/or a series of voltage differentials, across the piezoelectric elements 132 such that they mechanically vibrate in a desired manner. Also, the transducer 114 may comprise one or more electrodes, such as a positive electrode 134 and a negative electrode 136, for example, positioned intermediate and/or adjacent to the piezoelectric elements 132. In one embodiment, the surgical instrument 110 may comprise a positive polarizing conductor 192 operably connected to the drive unit 135 and a positive electrode 134 and, in addition, a negative polarizing conductor 195 operably connected to the drive unit 135 and the negative electrode 136, wherein the drive unit 135 can be

configured to polarize the electrodes **134**, **136** via the polarizing conductors **192**, **195**, respectively.

In various embodiments, the transducer **114** may comprise a fore-bell **122** and a velocity transformer **128** which can be configured to conduct the vibrations produced by the piezoelectric elements **132** into the transmission waveguide **147**. In certain embodiments, referring still to FIG. 1, the transmission waveguide **147** may comprise an elongate shaft portion surrounded, or at least partially surrounded, by a sheath **158**, for example, wherein the waveguide **147** may comprise a distal end **152**. The distal end **152** of the waveguide **147** may comprise part of the end effector **150**, wherein the end effector **150** may comprise the clamp member **151** having a rotatable clamp arm, or jaw, which can be pivoted between an open position in which tissue can be positioned intermediate the blade **146** and the clamp member **151** and a closed position in which clamp member **151** can position and/or compress the tissue T (FIG. 5) against the blade **146**. In various embodiments, a surgical instrument may comprise a lever or actuator, such as a jaw closure trigger **145**, for example, which can be actuated by a surgeon in order to pivot the clamp member **151** between its open and closed positions. In at least one embodiment, the jaw closure trigger **145** can be operably engaged with a push/pull rod operably engaged with the clamp member **151** wherein, when the jaw closure trigger **145** is closed or moved toward the handpiece assembly **160**, the closure trigger **145** can push the push/pull rod distally and pivot the clamp member **151** toward the blade **146** into its closed position. Correspondingly, the jaw closure trigger **145** can be pivoted into its open position in order to pull the rod proximally and pivot the clamp member **151** away from the blade **146** into its open position.

In any event, once the tissue T (FIG. 5) has been suitably positioned within the jaws of the end effector **150**, the transducer **114** can be operated by the drive unit **135** in order to transmit mechanical energy, or vibrations, into the targeted tissue T. In some embodiments, the actuation of the foot switch **144** may be sufficient to actuate the transducer **114**. In certain other embodiments, the actuation of a different switch may be required in addition to or in lieu of the actuation of the foot switch **144**. In one embodiment, the actuation of the foot switch **144** can supply power to the drive unit **135**, although the actuation of the jaw closure trigger **145**, and the trigger closure switch **147**, may be required before the drive unit **135** can drive the transducer **114**. In various embodiments, the jaw closure trigger **145** can be moved between a first, or open, position in which the trigger closure switch **147** is in an open state, or condition, and a second, or closed, position in which the trigger closure switch **147** is in a closed state, or condition. When the trigger closure switch **147** is in its closed condition, in various embodiments, a circuit within the drive unit **135**, for example, can be closed such that the drive unit **135** can drive the transducer **114**.

Referring still to FIG. 1, In various applications, a surgeon may desire to treat tissue using mechanical energy, or vibrations, transmitted through the blade **146**, for example. In various other applications, the surgeon may desire to treat the tissue using therapeutic electrical energy transmitted through the blade **146**. In various other applications, the surgeon may desire to obtain feedback in regards to a state of the tissue T (FIG. 5) by measuring the electrical properties of the tissue T (e.g., impedance) using subtherapeutic electrical energy transmitted through the blade **146**. In various embodiments, the toggle switch **143** can be manipulated to place the surgical instrument **110** in the second operating

mode. In at least one such embodiment, the second toggle button **143b** of the toggle switch **143** can be depressed in order to switch the surgical instrument **110** from the first operating mode into the second operating mode. As described below, the depression of the second toggle button **143b** can configure the handpiece assembly **160** such that the drive unit **135** does not drive the transducer **114** but rather, the power supplied to the handpiece assembly **160** from generator **112** can flow into the blade **146** without being converted into mechanical energy, or vibrations. In one embodiment, referring now to FIG. 5, the distal end **152** of the blade **146** can be positioned against the targeted tissue “T” and, in addition, the distal end **153** of the clamp member **151** can also be positioned against the tissue T such that current can flow from the supply conductor **139** into the blade **136**, through the tissue T, and return back to the generator **112** via the clamp member **151**, the return conductors **137**, **141**. As shown in FIG. 5, the clamp member **151** can be configured such that it is not in contact with the blade **146** when the clamp member **151** is in the closed position.

With reference now back to FIG. 1, in various embodiments, the return conductor **137** may comprise an insulated wire having a first end operably coupled with the clamp member **151** and a second end operably coupled with the return conductor **141**, wherein current can flow through the return conductor **137** when the toggle switch **143** is in the second configuration and the trigger closure switch **147** has been closed by the trigger **145**. In one embodiment, current will not flow through the return conductor **137** when the trigger closure switch **147** is in an open condition and/or when the toggle switch **143** is in the first configuration, i.e., when the first toggle button **143a** is depressed, as described above. In any event, in various circumstances, the current flowing through the tissue T (FIG. 5) from the distal end **152** of the blade **146** to the distal end **153** of the clamp member **151** can treat the tissue positioned intermediate, and/or surrounding, the distal ends **152**, **153**. In another embodiment, the current may be subtherapeutic for measuring the electrical state of the tissue T (FIG. 5).

The distal end **152** of the blade **146** may comprise a supply electrode while the distal end **153** of the clamp member **151** may comprise a return electrode. In various other embodiments, current can be supplied to the conductor **137** such that the distal end **153** of the clamp member **151** may comprise the supply electrode and the distal end **152** of the blade **146** may comprise the return electrode. In one embodiment, the current can return to the generator **112** via the blade **146**, the waveguide **147**, and the conductor **139**. In either event, referring again to FIG. 1, at least a portion of the return conductor **137** can extend along the outside of the sheath **158**, wherein at least another portion of the return conductor **137** can extend through the handpiece assembly **160**. In certain embodiments, although not illustrated, at least a portion of the return conductor **137** can be positioned within the sheath **158** and can extend alongside the blade **146**.

As shown in FIG. 6, in some embodiments, the surgical instrument **110** may comprise an inner sheath **257** and an outer sheath **258**, wherein the inner sheath **257** can define a first, or inner, passageway **259**, and wherein the inner sheath **257** and the outer sheath **258** can define a second, or outer, passageway **261** therebetween. In one embodiment, the blade **146** can extend through the inner passageway **259** and the return conductor **137**, and/or any other suitable conductor, can extend through the outer passageway **261**. In various

other embodiments, a conductor can be embedded in at least a portion of the inner sheath 257 or the outer sheath 258.

As shown in FIG. 7, in one embodiment, a sheath may comprise a non-electrically conductive or insulative material 358, such as plastic and/or rubber, for example, overmolded onto a conductive insert 357, which can be comprised of copper, for example, wherein the conductive insert 357 can allow current flowing through the blade 146 to return to the generator 112 after it has passed through the targeted tissue T (FIG. 5) as described above. In various embodiments, the insulative material 358 can entirely, or at least substantially, surround the conductive insert 357 such that current flowing through the conductive insert 357 does not unintentionally short to non-targeted tissue, for example. In at least one embodiment, the insulative material 358 can cover the inside surface and the outside surface of the conductive insert 357. In certain embodiments, although not illustrated, an insulative material of a sheath may cover only the outer surface of a conductive insert, for example.

In various embodiments, as described above, a first end of the return conductor 137 can be operably coupled to the clamp member 151 such that current can flow therethrough. In certain embodiments, the first end of the return conductor 137 can be soldered and/or welded to the clamp member 151. In one embodiment, although not illustrated, the clamp member 151 may comprise an aperture configured to receive the first end of the return conductor 137 wherein a fastener can be inserted into the aperture in order to secure the first end therein. In at least one such embodiment, the sidewalls of the aperture can be at least partially threaded and the fastener can be threadably received in the threaded aperture.

As shown in FIG. 8, in one embodiment, a clamp arm assembly 451 may comprise a conductive jacket 472 mounted to a base 449. In one embodiment, the first end of the return conductor 137 may be mounted to the conductive jacket 472 such that current can flow from the blade 146, through tissue positioned intermediate the jacket 472 and the blade 146, and then into the jacket 472 and to the return conductor 137. In various embodiments, the conductive jacket 472 may comprise a center portion 473 and at least one downwardly-extending sidewall 474 which can extend below bottom the surface 475 of the base 449. In the illustrated embodiment, the conductive jacket 472 has two sidewalls 474 extending downwardly on opposite sides of the base 449. In certain embodiments, the center portion 473 may comprise at least one aperture 476 which can be configured to receive a projection 477 extending from the base 449. In one embodiment, the projections 477 can be press-fit within the apertures 476 in order to secure the conductive jacket 472 to the base 449 although, in some embodiments, the projections 477 can be deformed after they have been inserted into the apertures 476. In various embodiments, fasteners can be used to secure the conductive jacket 472 to the base 449.

In various embodiments, the clamp arm assembly 451 may comprise a non-electrically conductive or insulative material, such as plastic and/or rubber, for example, positioned intermediate the conductive jacket 472 and the base 449. The insulative material can prevent current from flowing, or shorting, between the conductive jacket 472 and the base 449. In various embodiments, referring again to FIG. 8, the base 449 may comprise at least one aperture 478, for example, which can be configured to receive a pivot pin (not illustrated), wherein the pivot pin can be configured to pivotably mount the base 449 to the sheath 158, for example, such that the clamp arm assembly 451 can be rotated between open and closed positions relative to the sheath 158.

In the embodiment illustrated in FIG. 8, the base 449 includes two apertures 478 positioned on opposite sides of the base 449. In one embodiment, the pivot pin can be comprised of a non-electrically conductive or insulative material, such as plastic and/or rubber, for example, which can be configured to prevent current from flowing into the sheath 158 even if the base 449 is in electrical contact with the conductive jacket 472, for example.

In various embodiments, as described above, the surgical instrument system 110 can be configured such that current can flow from the distal tip of the blade 146, through the tissue T (FIG. 5), and then to the distal tip of the clamp member 151. In one embodiment, as shown in FIG. 5, the clamp member 151 may comprise a tissue engaging pad or clamp pad 155, for example, mounted thereto, wherein the pad 155 can be configured to contact tissue positioned intermediate the clamp member 151 and the waveguide 147. In one expression of the embodiment, the pad 155 may be formed of a non-electrically conductive or insulative material, such as polytetrafluoroethylene (PTFE), such as for example TEFLON® a trademark name of E. I. Du Pont de Nemours and Company, a low coefficient of friction polymer material, or any other suitable low-friction material. The non-electrically conductive or insulative material can also serve to prevent current from flowing between the clamp member 151 and the blade 146 without first passing through the distal end 152 of the blade 146, the targeted tissue T, and the distal end 153 of the clamp member 151. In various embodiments, the pad 155 can be attached to the clamp member 151 utilizing an adhesive, for example. The clamp pad 155 mounts on the clamp member 151 for cooperation with the blade 146, with pivotal movement of the clamp member 151 positioning the clamp pad 155 in substantially parallel relationship to, and in contact with, the blade 146, thereby defining a tissue treatment region. By this construction, tissue is grasped between the clamp pad 155 and the blade 146. The clamp pad 155 may be provided with a non-smooth surface, such as a saw tooth-like configuration to enhance the gripping of tissue in cooperation with the blade 146. The saw tooth-like configuration, or teeth, provide traction against the movement of the blade 146. The teeth also provide counter traction to the blade 146 and clamping movement. It will be appreciated that the saw tooth-like configuration is just one example of many tissue engaging surfaces to prevent movement of the tissue relative to the movement of the blade 146. Other illustrative examples include bumps, criss-cross patterns, tread patterns, a bead, or sand blasted surface.

In various other embodiments, the surgical instrument 110 can be configured such that current can flow through tissue clamped between the blade 146, for example, and the clamp member 151 without having to first pass through the distal ends thereof. In at least one embodiment, referring now to FIG. 9, a clamp arm assembly 551 may comprise an electrically-conductive member 572 and a pad 555 attached thereto, wherein the electrically-conductive member 572 may comprise at least one sidewall 574 extending downwardly therefrom. In one embodiment, current can flow between the blade 146, for example, through tissue positioned between the blade 146 and the sidewalls 574 of the clamp arm assembly 551, and into the sidewalls 574. In various embodiments, gaps can be defined between each sidewall 574 and the blade 146 and, in addition, a gap can be defined between the tissue-contacting surface 575 of the pad 555 and the blade 146.

In one embodiment, referring now to FIG. 10, the gaps between each sidewall 574 and the waveguide 147 can be

defined by a distance "D1," wherein the distance D1 can be selected such that, when the clamp arm assembly 551 is positioned in a closed position, the tissue positioned intermediate each of the sidewalls 574 and the blade 146 can be compressed. Although these gaps are illustrated as having the same distance D1, other embodiments are envisioned in which the gaps have different distances. A gap between the tissue-contacting surface 575 and the blade 146 can be defined by a distance "D2," wherein the distance D2 also may be selected such that, when the clamp arm assembly 551 is positioned in a closed position, the tissue-contacting surface 575 can be contact and/or compress the tissue against blade 146.

In various embodiments, a clamp arm assembly may comprise an electrically-conductive pad mounted thereto. In at least one such embodiment, such a pad can be configured to contact and/or compress tissue positioned intermediate the clamp arm assembly and a waveguide, such as the blade 146, for example, such that current can flow from the blade 146 into the pad. In certain embodiments, the electrically conductive pad can be comprised of a typically conductive material, such as copper, for example. In at least one embodiment, the pad can be comprised of a typically non-conductive material, such as PTFE, for example, which can be impregnated with electrically conductive particles, such as medical grade stainless steel, for example, such that the pad is sufficiently conductive to permit current to flow between the blade 146 and the clamp arm.

In one embodiment, as previously discussed, the surgical instrument 110 comprises the blade 146, for example, which may comprise a first electrode and, in addition, a clamp arm, such as the clamp member 151, for example, which may comprise a second electrode. In various embodiments, as also discussed above, the blade 146 may comprise a supply electrode whereas the clamp member 151 may comprise a return electrode. Alternatively, the clamp member 151 may comprise the supply electrode while the blade 146 may comprise the return electrode. In various other embodiments, a clamp arm may comprise both the supply electrode and the return electrode. In certain embodiments, referring now to FIG. 11, a clamp arm may comprise a pad 655 and two or more electrodes, such as a first electrode 682 and a second electrode 683, for example. In one embodiment, the pad 655 can be comprised of a non-electrically conductive or insulative material, such as PTFE, for example, as previously discussed with reference to the clamp pad 155 (FIG. 5), whereas the electrodes 682, 683 can be comprised of an electrically conductive material, such as copper and/or a PTFE material having electrically conductive particles mixed therein, for example. In various embodiments, the first electrode 682 and/or the second electrode 683 can be embedded within the pad 655. In at least one such embodiment, the pad 655 can be molded onto the electrodes 682, 683 whereas, in certain embodiments, the electrodes 682, 683 can be inserted and/or press-fit into openings formed in the pad 655.

In various embodiments, the first electrode 682 can be positioned adjacent to a first side 674a of the pad 655 while the second electrode 683 can be positioned adjacent to a second side 674b of the pad 655. In use, the first electrode 682 may comprise a supply electrode and the second electrode 683 may comprise a return electrode, wherein current can flow from the supply electrode 682, through tissue clamped or positioned between the pad 655 and the blade 146, for example, and into the return electrode 683. In one embodiment, a supply wire can be operably coupled with the first electrode 682 and a return wire can be operably coupled

with the second electrode 683 such that current can be supplied thereto from a power source, such as the generator 112, for example. In various embodiments, referring still to FIG. 11, the electrodes 682, 683 can be positioned within the pad 655 such that the electrodes 682, 683 do not contact the blade 146 when the clamp member 151 (FIG. 5) is in a closed position and short to the blade 146. Although the illustrated embodiment comprises one supply electrode and one return electrode positioned within a pad, embodiments are envisioned in which a pad includes more than one supply electrode and/or more than one return electrode.

As discussed above, electrodes can be embedded within the pad of a clamp arm assembly. In various embodiments, first and second electrodes can be mounted to the sides of a clamp arm pad. Referring now to FIG. 12, a clamp arm may comprise a pad 755, for example, which can be configured to hold tissue against the blade 146, for example, wherein a first electrode 782 can be mounted to a first side 774a of the pad 755 and wherein a second electrode 783 can be mounted to a second side 774b of the pad 755. In various embodiments, the electrodes 782, 783 can be positioned within cut-outs in the sides of the pad 755 wherein, in certain embodiments, the electrodes 782, 783 can be adhered and/or fastened, for example, to the pad 755. The first electrode 782 may comprise a supply electrode and the second electrode 783 may comprise a return electrode, wherein current can flow from the supply electrode 782, through tissue clamped or positioned between the pad 755 and the blade 146, for example, and into the return electrode 783. In one embodiment, a supply wire can be operably coupled with the first electrode 782 and a return wire can be operably coupled with the second electrode 783 such that current can be supplied thereto from a power source, such as the generator 112, for example. Furthermore, the electrodes 782, 783 can be mounted to the pad 755 such that the electrodes 782, 783 do not contact the blade 146 and create an electrical short thereto. Although the illustrated embodiment comprises one supply electrode and one return electrode mounted to a pad, embodiments are envisioned in which a pad includes more than one supply electrode and/or more than one return electrode.

Still referring to FIG. 12, various electrodes can be configured such that they extend in a longitudinal direction which is parallel, or at least substantially parallel, to the longitudinal axis of the blade 146, for example. In various embodiments, the electrodes can extend along an end effector such that the entire length of the tissue positioned within the end effector can be treated. In various embodiments, referring now to FIG. 13, a clamp arm may comprise a pad 885 having two point electrodes. More particularly, in one embodiment, the pad 885 may comprise a first point electrode 882 and a second point electrode 883 positioned therein, wherein current can flow through tissue positioned intermediate the first point electrode 882 and the second point electrode 883. In at least one such embodiment, the pad 885 can be comprised of a non-electrically conductive material, the first point electrode 882 may comprise a supply electrode, and the second point electrode 883 may comprise a return electrode. In various embodiments, the electrodes 882, 883 can be embedded within the pad 885 and, in one embodiment the pad 885 can be molded around the electrodes 882, 883. In certain embodiments, the electrodes 882, 883 can be inserted into apertures within the pad 885. A supply wire can be operably coupled with the first electrode 882 and a return wire can be operably coupled with the second electrode 883 such that current can be supplied thereto from a power source, such as the generator 112, for

example. Furthermore, the electrodes **882**, **883** can be positioned within the pad **855** such that the electrodes **882**, **883** do not contact the blade **146** and create an electrical short thereto. In one embodiment, the clamp arm supporting pad **885**, and/or a sheath rotatably supporting the clamp arm, may further comprise a stop which can be configured to prevent the pad **855** from rotating into a position in which the electrodes **882**, **883** contact the blade **146**. Although the illustrated embodiment comprises one supply point electrode and one return point electrode positioned within a pad, other embodiments are envisioned in which a pad includes more than one supply point electrode and/or more than one return point electrode. Various embodiments are envisioned in which a pad includes an array of supply point electrodes and/or an array of return point electrodes.

In various embodiments, as described above, a surgical instrument may comprise a clamp arm including both a supply electrode and a return electrode. In one embodiment, the surgical instrument may comprise a waveguide which does not comprise an electrode. In certain embodiments, a supply electrode and a return electrode can be configured such that current can flow therebetween along a predetermined path. In various embodiments, such a path can be one-dimensional. Embodiments having two point electrodes, for example, can permit such a path. In other embodiments, such a path can be two-dimensional. Embodiments having an array of point electrodes, for example, can permit such a path. A two-dimensional path can be referred to as a field. In certain embodiments, a path can be three-dimensional. In at least one such embodiment, a clamp arm assembly can have a supply electrode and a return electrode while the waveguide may comprise one of a supply electrode or a return electrode. In embodiments where the waveguide comprises a return electrode, current can flow from the supply electrode of the clamp arm assembly to the return electrode of the clamp arm assembly and the return electrode of the waveguide. In one such embodiment, the return electrodes may comprise a common ground. In embodiments where the waveguide comprises a supply electrode, current can flow from the waveguide and the supply electrode of the clamp arm assembly to the return electrode of the clamp arm assembly. Such arrangements can permit the current to flow in a three-dimensional path, or field.

In various embodiments, referring now to FIG. **14**, the surgical instrument **110** may comprise a sheath encompassing, or at least partially encompassing, a portion of the blade **146** wherein a sheath may comprise both at least one supply conductor and at least one return conductor. In one embodiment, a sheath may comprise a plurality of conductive inserts, such as a first conductive insert **957a** and a second conductive insert **957b**, for example, wherein the first conductive insert **957a** may comprise a supply conductor and wherein the second conductive insert **957b** may comprise a return conductor. In various embodiments, a non-electrically conductive or insulative material **958**, such as plastic and/or rubber, for example, can be overmolded onto the first and second conductive inserts **957a**, **957b** in order to comprise the sheath. In various other embodiments, the surgical instrument **110** may comprise, referring now to FIG. **15**, a sheath assembly encompassing, or at least partially encompassing, a portion of a waveguide wherein the sheath assembly may comprise an inner sheath, such as an inner sheath **1057**, for example, and an outer sheath, such as an outer sheath **1058**, for example. In one embodiment, the inner sheath **1057** may comprise a supply conductor operably coupled with a supply electrode in a clamp arm

assembly, wherein the outer sheath **1058** may comprise a return conductor operably coupled with a return electrode in the clamp arm assembly. In certain embodiments, the inner sheath **1057** and/or the outer sheath **1058** may be comprised of an electrically conductive material, such as medical grade stainless steel, for example, wherein, in one embodiment, one or more surfaces of the inner sheath **1057** and/or the outer sheath **1058** can be coated, or at least partially coated, in a non-conductive material, such as a material comprising poly(p-xylylene) polymers, for example. Materials comprised of poly(p-xylylene) polymers are often sold under the tradename of Parylene™.

In various embodiments, a clamp arm can be moved between open and closed positions in order position and/or compress tissue T against a blade. In one embodiment, referring to FIG. **16**, a clamp arm **1151** may comprise a base **1149** and a pad **1155** mounted to the base **1149**, wherein the pad **1155** can be configured to contact and compress tissue T against the blade **146**, for example. As illustrated in FIG. **16**, the pad **1155** may comprise a tissue-contacting surface **1175** which, although it may include various serrations, ridges, and/or surface texturing, is planar, or at least substantially planar. In such embodiments, especially when the blade **146** has a round or arcuate cross-section, only a small portion of the tissue T positioned intermediate the blade **146** and the pad **1155** may contact the surface area, or perimeter, of the blade **146**. As illustrated in FIG. **16**, the tissue T may contact the blade **146** at a contact point P. Various alternative embodiments are envisioned in which the clamp arm **1251**, for example, may comprise downwardly-extending sidewalls **1274** which extend below a tissue-contacting surface **1275** of the pad **1255**, for example, although a clamp arm may comprise a tissue-contacting surface with or without a pad. In one embodiment, referring to FIG. **17**, the sidewalls **1274** can be configured to contact the tissue T positioned laterally with respect to the blade **146** and push the tissue T downwardly. As illustrated in FIG. **17**, the sidewalls **1274** can push the tissue T downwardly such that the tissue T positioned intermediate the sidewalls **1274** contacts a larger surface area, or perimeter, on the blade **146** as compared to the embodiment illustrated in FIG. **16**. Owing to the larger contact area, the blade **146** may be more efficient in cutting, coagulating, and/or otherwise treating the tissue. In embodiments where the blade **146** may comprise a circular or arcuate cross-section, the perimeter contact distance, i.e., the distance in which the tissue is in contact with the perimeter of the blade **146**, may comprise an arclength (s) which can equal the product of the radius of curvature of the arc R and the sweep angle θ defined between the two contact points P. As illustrated in FIG. **17**, the contact points P can represent the endpoints of the perimeter in which the tissue T contacts the blade **146**. Although the illustrated blade **146** is depicted as having a curved or arcuate cross-section, any other suitable cross-section may be used.

In various embodiments, the tissue-contacting surface **1275** of the clamp arm **1251** can define a plane **1298** which can represent the portions of the pad **1255** which contact the tissue T positioned within the end effector when the clamp arm **1251** is rotated between its open and closed positions. As illustrated in FIG. **17**, the sidewalls **1274** of the clamp arm **1251** can extend through the plane **1298**, wherein, when the clamp arm **1251** is rotated from an open position into a closed position, the sidewalls **1274** can be positioned laterally along the opposite sides of the blade **146** and, in addition, the tissue-contacting surface **1275** can be positioned against, or adjacent to, the top surface of the blade **146** such that the plane **1298** is aligned with, or respect to,

a plane 1299 extending through the top surface of the blade 146. In one embodiment, the plane 1299 can be defined as a tangential plane which is tangential to the perimeter of the blade 146. In one embodiment, the plane 1299 can be tangential to the top tissue-contacting surface of the blade 146, for example, wherein the top tissue-contacting surface of the 146 may comprise the surface closest to the clamp tissue-contacting surface 1275 when the clamp arm 1271 is in its closed position. In the illustrated embodiment, still referring to FIG. 17, the planes 1298, 1299 can be parallel, or at least substantially parallel, to one another when the tissue-contacting surface 1275 is positioned adjacent to the blade 146, while the planes 1298, 1299 can be co-planar, or at least substantially co-planar, with one another when the tissue-contacting surface 1275 is in contact with the blade 146. The sidewalls 1274 can be sized and configured such that they extend through the blade plane 1299 when the clamp arm 1271 is in the closed position. In various embodiments, the sidewalls 1274 may not extend through the plane 1299 when the clamp arm 1251 is in the open position. In one embodiment, the sidewalls 1274 may "break" the plane 1299 as the clamp arm 1251 is being closed, but before it is completely closed. In one embodiment, the sidewalls 1274 may break the plane 1299 just before the clamp arm 1251 reaches its completely closed position.

FIG. 18 illustrates one embodiment of a drive system 32 of the ultrasonic generator module 180 shown in FIG. 1, which creates an ultrasonic electrical signal for driving an ultrasonic transducer. With reference now to FIGS. 1 and 18, the drive system 32 is flexible and can create an ultrasonic electrical drive signal 416 at a desired frequency and power level setting for driving the ultrasonic transducer 114. In various embodiments, the generator 112 may comprise several separate functional elements, such as modules and/or blocks. Although certain modules and/or blocks may be described by way of example, it can be appreciated that a greater or lesser number of modules and/or blocks may be used and still fall within the scope of the embodiments. Further, although various embodiments may be described in terms of modules and/or blocks to facilitate description, such modules and/or blocks may be implemented by one or more hardware components, e.g., processors, Digital Signal Processors (DSPs), Programmable Logic Devices (PLDs), Application Specific Integrated Circuits (ASICs), circuits, registers and/or software components, e.g., programs, sub-routines, logic and/or combinations of hardware and software components.

In one embodiment, the ultrasonic generator module 180 drive system 32 may comprise one or more embedded applications implemented as firmware, software, hardware, or any combination thereof. The ultrasonic generator module 180 drive system 32 may comprise various executable modules such as software, programs, data, drivers, application program interfaces (APIs), and so forth. The firmware may be stored in nonvolatile memory (NVM), such as in bit-masked read-only memory (ROM) or flash memory. In various implementations, storing the firmware in ROM may preserve flash memory. The NVM may comprise other types of memory including, for example, programmable ROM (PROM), erasable programmable ROM (EPROM), electrically erasable programmable ROM (EEPROM), or battery backed random-access memory (RAM) such as dynamic RAM (DRAM), Double-Data-Rate DRAM (DDR), and/or synchronous DRAM (SDRAM).

In one embodiment, the ultrasonic generator module 180 drive system 32 comprises a hardware component implemented as a processor 400 for executing program instruc-

tions for monitoring various measurable characteristics of the ultrasonic surgical instrument 110 and generating a corresponding output control signal for operating the surgical instrument 110. In various embodiments, the output control signal is for driving the ultrasonic transducer 114 in cutting and/or coagulation operating modes, measuring electrical characteristics of the surgical instrument 110 and/or the tissue T, and providing feedback to use. It will be appreciated by those skilled in the art that the ultrasonic generator module 180 and the drive system 32 may comprise additional or fewer components and only a simplified version of the ultrasonic generator module 180 and the drive system 32 are described herein for conciseness and clarity. In various embodiments, as previously discussed, the hardware component may be implemented as a DSP, PLD, ASIC, circuits, and/or registers. In one embodiment, the processor 400 may be configured to store and execute computer software program instructions to generate the step function output signals for driving various components of the ultrasonic surgical instrument 110, such as the transducer 114, the end effector 150, and/or the blade 146.

In one embodiment, under control of one or more software program routines, the processor 400 executes the methods in accordance with the described embodiments to perform a variety of functions, such as, for example, generating a step function formed by a stepwise waveform of drive signals comprising current (I), voltage (V), and/or frequency (f) for various time intervals or periods (T), driving the ultrasonic transducer 114, driving the end effector 150 using therapeutic and/or subtherapeutic electrical signals (e.g., RF signal), measuring the impedance (Z) of the transducer 114, measuring the impedance (Z_t) of the tissue T, and/or providing feedback to the user. In one embodiment, stepwise waveforms of the drive signals may be generated by forming a piecewise linear combination of constant functions over a plurality of time intervals created by stepping the ultrasonic generator module 180 drive signals, e.g., output drive current (I), voltage (V), and/or frequency (f). The time intervals or periods (T) may be predetermined (e.g., fixed and/or programmed by the user) or may be variable. Variable time intervals may be defined by setting the drive signal to a first value and maintaining the drive signal at that value until a change is detected in a monitored characteristic. Examples of monitored characteristics may comprise, for example, transducer impedance, tissue impedance, tissue heating, tissue transection, tissue coagulation, and the like. The ultrasonic drive signals generated by the ultrasonic generator module 180 include, without limitation, ultrasonic drive signals that excite various vibratory modes of the ultrasonic transducer 114 such as the primary longitudinal mode and harmonics thereof as well flexural and torsional vibratory modes.

In one embodiment, the executable modules comprise one or more algorithm(s) 402 stored in memory that when executed causes the processor 400 to perform a variety of functions, such as, for example, generating a step function formed by a stepwise waveform of drive signals comprising current (I), voltage (V), and/or frequency (f) for various time intervals or periods (T), driving the ultrasonic transducer 114, driving the end effector 150 using a therapeutic and/or subtherapeutic electrical signal (e.g., RF signal), measuring the impedance (Z) of the transducer 114, measuring the impedance (Z_t) of the tissue T, and/or providing feedback in accordance with a state of the tissue T. In one embodiment, an algorithm 402 is executed by the processor 400 to generate a step function formed by a stepwise waveform of drive signals comprising current (I), voltage (V), and/or

frequency (f) for various time intervals or periods (T). The stepwise waveforms of the drive signals may be generated by forming a piecewise linear combination of constant functions over two or more time intervals created by stepping the generator's 30 output drive current (I), voltage (V), and/or frequency (f). The drive signals may be generated either for predetermined fixed time intervals or periods (T) of time or variable time intervals or periods of time in accordance with the one or more stepped output algorithm(s) 402. Under control of the processor 400, the ultrasonic generator module 180 steps (e.g., increment or decrement) the current (I), voltage (V), and/or frequency (f) up or down at a particular resolution for a predetermined period (T) or until a predetermined condition is detected, such as a change in a monitored characteristic (e.g., transducer impedance, tissue impedance). The steps can change in programmed increments or decrements. If other steps are desired, the ultrasonic generator module 180 can increase or decrease the step adaptively based on measured system characteristics. In other embodiments, algorithms 402 may be executed by the processor 400 to drive the ultrasonic transducer 114, drive the end effector 150 using a therapeutic and/or subtherapeutic electrical signal (e.g., RF signal), measure the impedance (Z) of the transducer 114, measure the impedance (Z_t) of the tissue T, and/or to provide feedback in accordance with a state of the tissue T.

In operation, the user can program the operation of the ultrasonic generator module 180 using the input device 406 located on the front panel of the ultrasonic generator module 180 console. The input device 406 may comprise any suitable device that generates signals 408 that can be applied to the processor 400 to control the operation of the ultrasonic generator module 180. In various embodiments, the input device 406 includes buttons, switches, thumbwheels, keyboard, keypad, touch screen monitor, pointing device, remote connection to a general purpose or dedicated computer. In other embodiments, the input device 406 may comprise a suitable user interface. Accordingly, by way of the input device 406, the user can set or program the current (I), voltage (V), frequency (f), and/or period (T) for programming the step function output of the ultrasonic generator module 180. The processor 400 then displays the selected power level by sending a signal on line 410 to an output indicator 412.

In various embodiments, the output indicator 412 may provide visual, audible, and/or tactile feedback to the surgeon to indicate the status of a surgical procedure, such as, for example, when tissue cutting and coagulating is complete based on a measured characteristic of the ultrasonic surgical instrument 110, e.g., transducer impedance, tissue impedance, or other measurements as subsequently described. By way of example, and not limitation, visual feedback comprises any type of visual indication device including incandescent lamps or light emitting diodes (LEDs), graphical user interface, display, analog indicator, digital indicator, bar graph display, digital alphanumeric display. By way of example, and not limitation, audible feedback comprises any type of buzzer, computer generated tone, computerized speech, voice user interface (VUI) to interact with computers through a voice/speech platform. By way of example, and not limitation, tactile feedback comprises any type of vibratory feedback provided through the instrument handpiece assembly 160 or simply housing handle assembly.

In one embodiment, the processor 400 may be configured or programmed to generate a digital current signal 414 and a digital frequency signal 418. These signals 414, 418 are

applied to a direct digital synthesizer (DDS) circuit 420 to adjust the amplitude and the frequency (f) of the current output signal 416 to the transducer 114. The output of the DDS circuit 420 is applied to an amplifier 422 whose output is applied to a transformer 424. The output of the transformer 424 is the signal 416 applied to the ultrasonic transducer 114, which is coupled to the blade 146 by way of the waveguide 147.

In one embodiment, the ultrasonic generator module 180 comprises one or more measurement modules or components that may be configured to monitor measurable characteristics of the ultrasonic instrument 110. In embodiment illustrated in FIG. 18, the processor 400 may be employed to monitor and calculate system characteristics. As shown, the processor 400 measures the impedance Z of the transducer 114 by monitoring the current supplied to the transducer 114 and the voltage applied to the transducer 114. In one embodiment, a current sense circuit 426 is employed to sense the current flowing through the transducer 114 and a voltage sense circuit 428 is employed to sense the output voltage applied to the transducer 114. These signals may be applied to the analog-to-digital converter 432 (ADC) via an analog multiplexer 430 circuit or switching circuit arrangement. The analog multiplexer 430 routes the appropriate analog signal to the ADC 432 for conversion. In other embodiments, multiple ADCs 432 may be employed for each measured characteristic instead of the multiplexer 430 circuit. The processor 400 receives the digital output 433 of the ADC 432 and calculates the transducer impedance Z based on the measured values of current and voltage. In response to the transducer impedance (Z), the processor 400 controls the operation of the surgical instrument 110. For example, the processor 400 can adjust the power delivered to the transducer 114, can shut off the power to the transducer 114, and/or provide feedback to the user. In one embodiment, the processor 400 adjusts the output drive signal 416 such that it can generate a desired power versus load curve. In one embodiment, in accordance with a programmed step function algorithms 402, the processor 400 can step the drive signal 416, e.g., the current or frequency, in any suitable increment or decrement in response to the transducer impedance Z.

With reference back now to FIGS. 1 and 18, to actually cause the surgical blade 146 to vibrate, e.g., actuate the blade 146, the user activates the foot switch 144 or the switch 143 on the handpiece assembly 160, as discussed above. This activation outputs the drive signal 416 to the transducer 114 based on programmed values of current (I), frequency (f), and corresponding time periods (T). After a predetermined fixed time period (T), or variable time period based on a measurable system characteristic such as changes in the impedance Z of the transducer 114, the processor 400 changes the output current step or frequency step in accordance with the programmed values. The output indicator 412 communicates the particular state of the process to the user.

The operation of the ultrasonic generator module 180 may be programmed to provide a variety of output drive signals to measure electrical properties of current, voltage, power, impedance, and frequency associated with the transducer 114 in an unloaded state, a lightly loaded state, and a heavily loaded state, for example. When the ultrasonic transducer 114 is in an unloaded state, the ultrasonic generator module 180 output may be stepped in a first sequence, for example. In one embodiment, the ultrasonic generator module 180 is initially activated at about time 0 resulting in a drive current rising to a first set point I_1 of about 100 mA. The current is maintained at the first set point I_1 , for a first period T_1 . At the

end of the first period T_1 , e.g., about 1 second, the current set point is changed, e.g., stepped, by the ultrasonic generator module **180** in accordance with the software, e.g., the step function algorithm(s) **402**, to a second set point I_2 of about 175 mA for a second period T_2 , e.g., about 2 seconds. At the end of the second period T_2 , e.g., at about 3 seconds, the ultrasonic generator module **180** software changes the current to a third set point I_3 of about 350 mA. The voltage, current, power, and frequency respond only slightly because there is no load on the system.

When the ultrasonic transducer **114** is in a lightly loaded state, the ultrasonic generator module **180** is activated at about time 0 resulting in the current rising to the first current set point I_1 of about 100 mA. At about 1 second the current set point is changed within the ultrasonic generator module **180** by the software to I_2 of about 175 mA, and then again at about 3 seconds the ultrasonic generator module **180** changes the current **300** set point to I_3 of about 350 mA. The voltage, current, power, and frequency respond to the light load.

When the ultrasonic transducer **114** is in a heavily loaded state, the ultrasonic generator module **180** is activated at about time 0 resulting in the current rising to the first set point I_1 of about 100 mA. At about 1 second the current set point is changed within the ultrasonic generator module **180** by the software to I_2 of about 175 mA, and then again at about 3 seconds the ultrasonic generator module **180** changes the current **300** set point to I_3 of about 350 mA. The voltage, current, power, and frequency respond to the heavy load.

It will be appreciated by those skilled in the art that the current step function set points (e.g., I_1 , I_2 , I_3) and the time intervals or periods (e.g., T_1 , T_2) of duration for each of the step function set points described above are not limited to the values described herein and may be adjusted to any suitable value as may be desired for a given set of surgical procedures. Additional or fewer current set points and periods of duration may be selected as may be desired for a given set of design characteristics or performance constraints. As previously discussed, the periods may be predetermined by programming or may be variable based on measurable system characteristics. The embodiments are not limited in this context.

Having described operational details of various embodiments of the surgical system **100**, operations for the above surgical system **100** may be further described in terms of a process for cutting and coagulating a blood vessel employing a surgical instrument comprising the input device **406** and the transducer impedance measurement capabilities described with reference to FIG. **18**. Although a particular process is described in connection with the operational details, it can be appreciated that the process merely provides an example of how the general functionality described herein can be implemented by the surgical system **100**. Further, the given process does not necessarily have to be executed in the order presented herein unless otherwise indicated. As previously discussed, the input device **406** may be employed to program the stepped output (e.g., current, voltage, frequency) to the ultrasonic transducer **114**/blade **146** assembly.

Accordingly, one technique for sealing a vessel includes separating and moving the inner muscle layer of the vessel away from the adventitia layer prior to the application of standard ultrasonic energy to transect and seal the vessel. Although conventional methods have achieved this separation by increasing the force applied to the clamp member **151**, disclosed is an alternative apparatus and method for

cutting and coagulating tissue without relying on clamp force alone. In order to more effectively separate the tissue layers of a vessel, for example, the ultrasonic generator module **180** may be programmed to apply a frequency step function to the ultrasonic transducer **114** to mechanically displace the blade **146** in multiple modes in accordance with the step function. In one embodiment, the frequency step function may be programmed by way of the user interface **406**, wherein the user can select a stepped-frequency program, the frequency (f) for each step, and the corresponding time period (T) of duration for each step for which the ultrasonic transducer **114** will be excited. The user may program a complete operational cycle by setting multiple frequencies for multiple periods to perform various surgical procedures.

In one embodiment, a first ultrasonic frequency may be set initially to mechanically separate the muscle tissue layer of a vessel prior to applying a second ultrasonic frequency to cut and seal the vessel. By way of example, and not limitation, in accordance with one implementation of the program, initially, the ultrasonic generator module **180** is programmed to output a first drive frequency f_1 for a first period T_1 of time (for example less than approximately 1 second), wherein the first frequency f_1 is significantly off resonance, for example, $f_0/2$, $2f_0$ or other structural resonant frequencies, where f_0 is the resonant frequency (e.g., 55.5 kHz). The first frequency f_1 provides a low level of mechanical vibration action to the blade **146** that, in conjunction with the clamp force, mechanically separates the muscle tissue layer (subtherapeutic) of the vessel without causing significant heating that generally occurs at resonance. After the first period T_1 , the ultrasonic generator module **180** is programmed to automatically switch the drive frequency to the resonant frequency f_0 for a second period T_2 to transect and seal the vessel. The duration of the second period T_2 may be programmed or may be determined by the length of time it actually takes to cut and seal the vessel as determined by the user or may be based on measured system characteristics such as the transducer impedance Z as described in more detail below.

In one embodiment, the tissue/vessel transection process (e.g., separating the muscle layer of the vessel from the adventitia layer and transecting/sealing the vessel) may be automated by sensing the impedance Z characteristics of the transducer **114** to detect when the transection of the tissue/vessel occurs. The impedance Z can be correlated to the transection of the muscle layer and to the transection/sealing of the vessel to provide a trigger for the processor **400** to generate the frequency and/or current step function output. As previously discussed with reference to FIG. **18**, the impedance Z of the transducer **114** may be calculated by the processor **400** based on the current flowing through transducer **114** and the voltage applied to the transducer **114** while the blade **146** is under various loads. Because the impedance Z of the transducer **114** is proportional to the load applied to the blade **146**, as the load on the blade **146** increases the impedance Z of the transducer **114** increases and as the load on the blade **146** decreases the impedance Z of the transducer **114** decreases. Accordingly, the impedance Z of the transducer **114** can be monitored to detect the transection of the inner muscle tissue layer of the vessel from the adventitia layer and can also be monitored to detect when the vessel has been transected and sealed.

In one embodiment, the ultrasonic surgical instrument **110** may be operated in accordance with a programmed step function algorithm responsive to the transducer impedance Z . In one embodiment, a frequency step function output may

be initiated based on a comparison of the transducer impedance Z and one or more predetermined thresholds that have been correlated with tissue loads against the blade **146**. When the transducer impedance Z transitions above or below (e.g., crosses) a threshold, the processor **400** applies a digital frequency signal **418** to the DDS circuit **420** to change the frequency of the drive signal **416** by a predetermined step in accordance with the step function algorithm(s) **402** responsive to the transducer impedance Z . In operation, the blade **146** is first located at the tissue treatment site. The processor **400** applies a first digital frequency signal **418** to set a first drive frequency f_1 that is off resonance (e.g., $f_0/2$, $2f_0$ or other structural resonant frequencies, where f_0 is the resonant frequency). The drive signal **416** is applied to the transducer **114** in response to activation of the switch **312a** on the handpiece assembly **160** or the foot switch **434**. During this period the ultrasonic transducer **114** mechanically activates the blade **146** at the first drive frequency f_1 . A force or load may be applied to the clamp member **151** and the blade **146** to facilitate this process. During this period, the processor **400** monitors the transducer impedance Z until the load on the blade **146** changes and the transducer impedance Z crosses a predetermined threshold to indicate that the tissue layer has been transected. The processor **400** then applies a second digital frequency signal **418** to set a second drive frequency f_2 , e.g., the resonant frequency f_0 or other suitable frequency for transecting, coagulating, and sealing tissue. Another portion of the tissue (e.g., the vessel) is then grasped between the clamp member **151** and the blade **146**. The transducer **114** is now energized by the drive signal **416** at the second drive frequency f_2 by actuating either the foot switch **434** or the switch **312a** on the handpiece assembly **160**. It will be appreciated by those skilled in the art that the drive current (I) output also may be stepped as described with reference to FIGS. 6-8 based on the transducer impedance Z .

According to one embodiment of a step function algorithm **402**, the processor **400** initially sets a first drive frequency f_1 that is significantly off resonance to separate the inner muscle layer of the vessel from the adventitia layer. During this period of operation the processor **400** monitors the transducer impedance Z to determine when the inner muscle layer is transected or separated from the adventitia layer. Because the transducer impedance Z is correlated to the load applied to the blade **146**, for example, cutting more tissue decrease the load on the blade **146** and the transducer impedance Z . The transection of the inner muscle layer is detected when the transducer impedance Z drops below a predetermined threshold. When the change in transducer impedance Z indicates that the vessel has been separated from the inner muscle layer, the processor **400** sets the drive frequency to the resonant frequency f_0 . The vessel is then grasped between the blade **146** and the clamp member **151** and the transducer **114** is activated by actuating either the foot switch or the switch on the handpiece assembly **160** to transect and seal the vessel. In one embodiment, the impedance Z change may range between about 1.5 to about 4 times a base impedance measurements from an initial point of contact with the tissue to a point just before the muscle layer is transected and sealed.

With reference now to FIGS. 1, 8, and 19, as previously discussed, in one embodiment, the surgical system **100**, and the ultrasonic surgical instrument **110**, comprises the signal generator module **102**. In one embodiment, the signal generator module **102** may be implemented as a tissue impedance module **502**. Although in the presently disclosed embodiment, the signal generator module **102** is shown

separate from the surgical instrument **110**, in one embodiment, the signal generator module **102** may be formed integrally with the surgical instrument **110**, as shown in phantom in FIG. 1, such that the surgical instrument **110** forms a unitary surgical system. In one embodiment, surgical instrument the signal generator module **102** may be configured to monitor the electrical impedance Z_t of the tissue T (FIGS. 5, 10, 16, 17) to control the characteristics of time and power level based on the impedance Z_t of the tissue T. In one embodiment, the tissue impedance Z_t may be determined by applying a subtherapeutic radio frequency (RF) signal to the tissue T and measuring the current through the tissue T by way of a return electrode on the clamp member **151**, as previously discussed. In the schematic diagram shown in FIG. 19, an end effector portion of the surgical system **100** comprises the clamp arm assembly **451** (FIG. 8) connected to the distal end of the outer sheath **158**. The blade **146** forms a first (e.g., energizing) electrode and the clamp arm assembly **451** comprises an electrically conductive portion that forms a second (e.g., return) electrode. The tissue impedance module **502** is coupled to the blade **146** and the clamp arm assembly **451** through a suitable transmission medium such as a cable **137**. The cable **137** comprises multiple electrical conductors for applying a voltage to the tissue T and providing a return path for current flowing through the tissue T back to the impedance module **502**. In various embodiments, the tissue impedance module **502** may be formed integrally with the generator **112** or may be provided as a separate circuit coupled to the generator **112** (shown in phantom to illustrate this option).

Still with reference to FIGS. 1, 8, and 19 illustrates one embodiment of an integrated generator module **320** comprising the ultrasonic generator module **180** and the signal generator module **102**. As shown, the signal generator module **102** is configured as a tissue impedance module **502**. The integrated generator module **320** generates the ultrasonic electrical drive signal **416** to drive the ultrasonic transducer **114**. In one embodiment, the tissue impedance module **502** may be configured to measure the impedance Z_t of the tissue T (FIGS. 5, 10, 16, 17) grasped between the blade **146** and the clamp arm assembly **451**. The tissue impedance module **502** comprises an RF oscillator **506**, a voltage sensing circuit **508**, and a current sensing circuit **510**. The voltage and current sensing circuits **508**, **510** respond to the RF voltage v_{rf} applied to the blade **146** electrode and the RF current i_{rf} flowing through the blade **146** electrode, the tissue, and the conductive portion of the clamp arm assembly **451**. The sensed voltage v_{rf} and current i_{rf} are converted to digital form by the ADC **432** via the analog multiplexer **430**. The processor **400** receives the digitized output **433** of the ADC **432** and determines the tissue impedance Z_t by calculating the ratio of the RF voltage v_{rf} to current i_{rf} measured by the voltage sense circuit **508** and the current sense circuit **510**. In one embodiment, the transection of the inner muscle layer and the tissue may be detected by sensing the tissue impedance Z_t . Accordingly, detection of the tissue impedance Z_t may be integrated with an automated process for separating the inner muscle layer from the outer adventitia layer prior to transecting the tissue without causing a significant amount of heating, which normally occurs at resonance. Additional clamp arm and sheath assemblies comprising an electrode as shown in FIGS. 9-17 may be employed without limitation.

FIG. 20 is a schematic diagram of the signal generator module **102** configured as the tissue impedance module **502** coupled to the blade **146** and the clamp arm assembly **415** with tissue T located therebetween. With reference now to

FIGS. 1, 8, and 18-20, the generator 112 comprises the signal generator module 102 configured as the tissue impedance module 502 configured for monitoring the impedance Z_t of the tissue T located between the blade 146 and the clamp arm assembly 451 during the tissue transection process. The tissue impedance module 502 may be coupled to the ultrasonic surgical instrument 110 by way of the cables 137, 139. The cable includes a first "energizing" conductor 139 connected to the blade 146 (e.g., positive [+] electrode) and a second "return" conductor 137 connected to the conductive jacket 472 (e.g., negative [-] electrode) of the clamp arm assembly 451. In one embodiment, RF voltage v_{rf} is applied to the blade 146 to cause RF current i_{rf} to flow through the tissue T. The second conductor 137 provides the return path for the current i_{rf} back to the tissue impedance module 502. The distal end of the return conductor 137 is connected to the conductive jacket 472 such that the current i_{rf} can flow from the blade 146, through the tissue T positioned intermediate the conductive jacket 472 and the blade 146, and the conductive jacket 472 to the return conductor 137. The impedance module 502 connects in circuit, by way of the first and second conductors 137, 139. In one embodiment, the RF energy may be applied to the blade 146 through the ultrasonic transducer 114 and the waveguide 147. It is worthwhile noting that the RF energy applied to the tissue T for purposes of measuring the tissue impedance Z_t is a low level subtherapeutic signal that does not contribute in a significant manner, or at all, to the treatment of the tissue T.

Having described operational details of various embodiments of the surgical system 100, operations for the above surgical system 100 may be further described with reference to FIGS. 1, 8, and 18-20 in terms of a process for cutting and coagulating a blood vessel employing a surgical instrument comprising the input device 406 and the tissue impedance module 502. Although a particular process is described in connection with the operational details, it can be appreciated that the process merely provides an example of how the general functionality described herein can be implemented by the surgical system 100. Further, the given process does not necessarily have to be executed in the order presented herein unless otherwise indicated. As previously discussed, the input device 406 may be employed to program the step function output (e.g., current, voltage, frequency) to the ultrasonic transducer 114/blade 146 assembly.

In one embodiment, the ultrasonic surgical instrument 110 may be operated in accordance with a programmed step function algorithm 402 responsive to the tissue impedance Z_t . In one embodiment, a frequency step function output may be initiated based on a comparison of the tissue impedance Z_t and predetermined thresholds that have been correlated with various tissue states (e.g., desiccation, transection, sealing). When the tissue impedance Z_t transitions above or below (e.g., crosses) a threshold, the processor 400 applies a digital frequency signal 418 to the DDS circuit 420 to change the frequency of an ultrasonic oscillator by a predetermined step in accordance with the step function algorithm 402 responsive to the tissue impedance Z_t .

In operation, the blade 146 is located at the tissue treatment site. The tissue T is grasped between the blade 146 and the clamp arm assembly 451 such that the blade 146 and the conductive jacket 472 make electrical contact with the tissue T. The processor 400 applies a first digital frequency signal 418 to set a first drive frequency f_1 that is off resonance (e.g., $f_0/2$, $2f_0$ or other structural resonant frequencies, where f_0 is the resonant frequency). The blade 146 is electrically ener-

gized by the low level subtherapeutic RF voltage v_{rf} supplied by the tissue impedance module 502. The drive signal 416 is applied to the transducer 114/blade 146 in response to actuation of the switch 143 on the handpiece assembly 160 or the foot switch 144 until the tissue impedance Z_t of the tissue T changes by a predetermined amount. A force or load is then applied to the clamp arm assembly 451 and the blade 146. During this period the ultrasonic transducer 114 mechanically activates the blade 146 at the first drive frequency f_1 and as a result, the tissue T begins to desiccate from the ultrasonic action applied between the blade 146 and the one or more clamp pads 155 of the clamp arm assembly 451 causing the impedance Z_t of the tissue T to increase. Eventually, as the tissue T is transected by the ultrasonic action and applied clamp force, the impedance Z_t of the tissue T becomes very high or infinite. It will be appreciated by those skilled in the art that the drive current (I) output also may be stepped as described above based on measured impedance Z_t of the tissue T.

In one embodiment, the impedance Z_t of tissue T may be monitored by the impedance module 502 in accordance with the following process. A measurable RF current i_1 is conveyed through the first energizing conductor 139 to the blade 146, through the tissue T, and back to the impedance module 502 through the conductive jacket 472 and the second conductor 137. As the tissue T is desiccated and cut by the ultrasonic action of the blade 146 acting against the one or more clamp pads 155, the impedance of the tissue 514 increases and thus the current i_1 in the return path, i.e., the second conductor 137, decreases. The impedance module 502 measures the tissue impedance Z_t and conveys a representative signal to the ADC 432 whose digital output 433 is provided to the processor 400. The processor 400 calculates the tissue impedance Z_t based on these measured values of v_{rf} and i_{rf} . In response to the transducer impedance (Z_t), the processor 400 controls the operation of the surgical instrument 110. For example, the processor 400 can adjust the power delivered to the transducer 114, can shut off the power to the transducer 114, and/or provide feedback to the user. In one embodiment, the processor 400 steps the frequency by any suitable increment or decrement in response to changes in the impedance Z_t of the tissue T. In other embodiments, the processor 400 controls the drive signals 416 and can make any necessary adjustments in amplitude and frequency in response to the tissue impedance Z_t . In one embodiment, the processor 400 can cut off the drive signal 416 when the tissue impedance Z_t reaches a predetermined threshold value.

Accordingly, by way of example, and not limitation, in one embodiment, the ultrasonic surgical instrument 110 may be operated in accordance with a programmed stepped output algorithm to separate the inner muscle layer of a vessel from the adventitia layer prior to transecting and sealing the vessel. As previously discussed, according to one step function algorithm, the processor 400 initially sets a first drive frequency f_1 that is significantly off resonance. The transducer 114 is activated to separate the inner muscle layer of the vessel from the adventitia layer and the tissue impedance module 502 applies a subtherapeutic RF voltage v_{rf} signal to the blade 146. During this period T_1 of operation the processor 400 monitors the tissue impedance Z_t to determine when the inner muscle layer is transected or separated from the adventitia layer. The tissue impedance Z_t is correlated to the load applied to the blade 146, for example, when the tissue becomes desiccated or when the tissue is transected the tissue impedance Z_t becomes extremely high or infinite. The change in tissue impedance

Z_t indicates that the vessel has been separated or transected from the inner muscle layer and the generator **112** is deactivated for a second period of time T_2 . The processor **400** then sets the drive frequency to the resonant frequency f_0 . The vessel is then grasped between the blade **146** and the clamp arm assembly **451** and the transducer **114** is reactivated to transect and seal the vessel. Continuous monitoring of the tissue impedance Z_t provides an indication of when the vessel is transected and sealed. Also, the tissue impedance Z_t may be monitored to provide an indication of the completeness of the tissue cutting and/or coagulating process or to stop the activation of the generator **112** and/or the ultrasonic generator module **180** when the impedance Z_t of the tissue T reaches a predetermined threshold value. The threshold for the tissue impedance Z_t may be selected, for example, to indicate that the vessel has been transected. In one embodiment, the tissue impedance Z_t may range between about 10 Ohms to about 1000 Ohms from an initial point to a point just before the muscle layer is transected and sealed.

The applicants have discovered that experiments that run varying current set points (both increasing and decreasing) and dwell times indicate that the described embodiments can be used to separate the inner muscle layer from the outer adventitia layer prior to completing the transection resulting in improved hemostasis and potentially lower total energy (heat) at the transection site. Furthermore, although the surgical instrument **110** has been described in regards to impedance threshold detection schemes to determine when the muscle layer is separated from the adventitia, other embodiments that do not employ any detection scheme are within the scope of the present disclosure. For example, embodiments of the surgical instrument **110** may be employed in simplified surgical systems wherein non-resonant power is applied to separate the layers for a predetermined time of approximately 1 second or less, prior to applying a resonant power to cut the tissue. The embodiments are not limited in this context.

In various embodiments, the surgical instrument **110** may be programmed for detecting a change of state of tissue being manipulated by an ultrasonic surgical instrument and providing feedback to the user to indicate that the tissue has undergone such change of state or that there is a high likelihood that the tissue has undergone such change of state. As used herein, the tissue may undergo a change of state when the tissue is separated from other layers of tissue or bone, when the tissue is cut or transected, when the tissue is coagulated, and so forth while being manipulated with an end effector of an ultrasonic surgical instrument, such as, for example, the end effector **150** of the ultrasonic surgical instrument **110**. A change in tissue state may be determined based on the likelihood of an occurrence of a tissue separation event.

With reference to FIGS. 1, 5, and 18-20, in various embodiments, the impedance Z and the tissue Z_t , as well as any other suitable electrical measurements, that can be made with the surgical system **100**, may be used to provide feedback by the output indicator **412** shown in FIGS. 18 and 19. The output indicator **412** is particularly useful in applications where the tissue being manipulated by the end effector **151** is out of the user's field of view and the user cannot see when a change of state occurs in the tissue T . The output indicator **412** communicates to the user that a change in tissue state has occurred as determined in accordance with the operations described with respect to various logic flows. As previously discussed, the output indicator **412** may be configured to provide various types of feedback to the user

including, without limitation, visual, audible, and/or tactile feedback to indicate to the user (e.g., surgeon, clinician) that the tissue has undergone a change of state of the tissue. By way of example, and not limitation, as previously discussed, visual feedback comprises any type of visual indication device including incandescent lamps or LEDs, graphical user interface, display, analog indicator, digital indicator, bar graph display, digital alphanumeric display. By way of example, and not limitation, audible feedback comprises any type of buzzer, computer generated tone, computerized speech, VUI to interact with computers through a voice/speech platform. By way of example, and not limitation, tactile feedback comprises any type of vibratory feedback provided through the instrument housing handpiece assembly **160**.

The processor **400** determines a change in tissue state in accordance with the operations described above and provides feedback to the user by way of the output indicator **412**. The processor **400** monitors and evaluates the voltage, current, and/or frequency signal samples available from the generator **32**, **320** and according to the evaluation of such signal samples determines whether a change in tissue state has occurred. A change in tissue state may be determined based on the type of ultrasonic instrument and the power level that the instrument is energized at. In response to the feedback, the operational mode of the ultrasonic surgical instrument **110** may be controlled by the user or may be automatically or semi-automatically controlled.

In one embodiment, the processor **400** portion of the drive system **32**, **320** samples the voltage (v), current (i), and frequency (f) signals of the ultrasonic generator module **180** and/or the signal generator module **102**. As previously discussed, the output indicator **412** may provide visual, audible, and/or tactile feedback to alert the user of the ultrasonic surgical instrument **110** that a change in tissue state has occurred. In various embodiments, in response to the feedback from the output indicator **412**, the operational modes of the generator **112**, the ultrasonic generator module **180**, the signal generator module **102**, and/or the ultrasonic instrument **110** may be controlled manually, automatically, or semi-automatically. The operational modes include, without limitation, disconnecting or shutting down the output power, reducing the output power, cycling the output power, pulsing the output power, and/or outputting momentary surge of high-power. In one embodiment, the operational modes include, operating the surgical instrument **110** in a first operating mode in which the transducer **14** produces mechanical energy, or vibrations, that are transmitted to the end effector **151** and a second operating mode in which electrical energy, or current, can flow through the end effector **151** to perform electrosurgery. The operational modes of the ultrasonic instrument **110** in response to the change in tissue state can be selected, for example, to minimize heating effects of the end effector **151**, e.g., of the clamp pad **155**, to prevent or minimize possible damage to the surgical instrument **110**, and/or surrounding tissue. This is advantageous because heat is generated exponentially when the transducer **114** is activated with nothing between the jaws of the end effector **151** as is the case when a change in tissue state occurs.

In various embodiments, the change of state of the tissue may be determined based on transducer and tissue impedance measurements as previously described, or based on voltage, current, and frequency measurements in accordance with the operations described in the disclosure of the following commonly-owned U.S. Patent Application, which is incorporated herein by reference in its entirety: U.S. patent

application Ser. No. 12/503,775, entitled "ULTRASONIC DEVICE FOR CUTTING AND COAGULATING WITH STEPPED OUTPUT," now U.S. Pat. No. 8,058,771.

The devices disclosed herein can be designed to be disposed of after a single use, or they can be designed to be used multiple times. In either case, however, the device can be reconditioned for reuse after at least one use. Reconditioning can include any combination of the steps of disassembly of the device, followed by cleaning or replacement of particular pieces, and subsequent reassembly. In particular, the device can be disassembled, and any number of the particular pieces or parts of the device can be selectively replaced or removed in any combination. Upon cleaning and/or replacement of particular parts, the device can be reassembled for subsequent use either at a reconditioning facility, or by a surgical team immediately prior to a surgical procedure. Those skilled in the art will appreciate that reconditioning of a device can utilize a variety of techniques for disassembly, cleaning/replacement, and reassembly. Use of such techniques, and the resulting reconditioned device, are all within the scope of the present application.

Preferably, the various embodiments described herein will be processed before surgery. First, a new or used instrument is obtained and if necessary cleaned. The instrument can then be sterilized. In one sterilization technique, the instrument is placed in a closed and sealed container, such as a plastic or TYVEK bag. The container and instrument are then placed in a field of radiation that can penetrate the container, such as gamma radiation, x-rays, or high-energy electrons. The radiation kills bacteria on the instrument and in the container. The sterilized instrument can then be stored in the sterile container. The sealed container keeps the instrument sterile until it is opened in the medical facility. Sterilization can also be done by any number of ways known to those skilled in the art including beta or gamma radiation, ethylene oxide, and/or steam.

In various embodiments, an ultrasonic surgical instrument can be supplied to a surgeon with a waveguide and/or end effector already operably coupled with a transducer of the surgical instrument. In at least one such embodiment, the surgeon, or other clinician, can remove the ultrasonic surgical instrument from a sterilized package, plug the ultrasonic instrument into a generator, as outlined above, and use the ultrasonic instrument during a surgical procedure. Such a system can obviate the need for a surgeon, or other clinician, to assemble a waveguide and/or end effector to the ultrasonic surgical instrument. After the ultrasonic surgical instrument has been used, the surgeon, or other clinician, can place the ultrasonic instrument into a sealable package, wherein the package can be transported to a sterilization facility. At the sterilization facility, the ultrasonic instrument can be disinfected, wherein any expended parts can be discarded and replaced while any reusable parts can be sterilized and used once again. Thereafter, the ultrasonic instrument can be reassembled, tested, placed into a sterile package, and/or sterilized after being placed into a package. Once sterilized, the reprocessed ultrasonic surgical instrument can be used once again.

Although various embodiments have been described herein, many modifications and variations to those embodiments may be implemented. For example, different types of end effectors may be employed. Also, where materials are disclosed for certain components, other materials may be used. The foregoing description and following claims are intended to cover all such modification and variations.

Any patent, publication, or other disclosure material, in whole or in part, that is said to be incorporated by reference

herein is incorporated herein only to the extent that the incorporated materials does not conflict with existing definitions, statements, or other disclosure material set forth in this disclosure. As such, and to the extent necessary, the disclosure as explicitly set forth herein supersedes any conflicting material incorporated herein by reference. Any material, or portion thereof, that is said to be incorporated by reference herein, but which conflicts with existing definitions, statements, or other disclosure material set forth herein will only be incorporated to the extent that no conflict arises between that incorporated material and the existing disclosure material.

What is claimed is:

1. A surgical instrument, comprising:

a handpiece housing;

an acoustic assembly supported within said handpiece housing, wherein said acoustic assembly is configured to produce vibrations;

a waveguide comprising a proximal end and a distal end, wherein said proximal end is mounted to said acoustic assembly such that vibrations produced by said acoustic assembly are transmitted to said waveguide;

an ultrasonic blade coupled to said distal end of said waveguide, wherein said ultrasonic blade comprises a tissue treatment portion configured to cut and coagulate tissue;

a clamp movable between an open position and a closed position relative to said waveguide, wherein said clamp comprises a first electrode and a second electrode, and wherein said first electrode and said second electrode longitudinally overlap said tissue treatment portion of said ultrasonic blade when said clamp is in said closed position;

a first conductor in electrical communication with said first electrode; and

a second conductor in electrical communication with said second electrode, wherein said first conductor and said second conductor are configured to be placed in electrical communication with a power source such that current can flow from said first electrode to said second electrode through tissue positioned intermediate said first electrode and said second electrode.

2. The surgical instrument of claim 1, wherein said clamp comprises a tissue-contacting pad, and wherein said first electrode and said second electrode are embedded in said tissue-contacting pad.

3. The surgical instrument of claim 2, wherein said first electrode comprises a first point electrode, wherein said second electrode comprises a second point electrode, and wherein said first point electrode is positioned closer to said distal end of said waveguide than said second point electrode.

4. The surgical instrument of claim 1, wherein said clamp comprises a tissue-contacting pad, wherein said tissue-contacting pad comprises a first side and a second side, wherein said first electrode is mounted to said first side, and wherein said second electrode is mounted to said second side.

5. A surgical instrument, comprising:

a housing;

an acoustic assembly supported within said housing, wherein said acoustic assembly is configured to produce vibrations;

a waveguide coupled to said acoustic assembly;

an ultrasonic blade extending from said waveguide, wherein said ultrasonic blade comprises a tissue treatment area configured to cut and coagulate tissue;

33

a clamp movable between an open position and a closed position relative to said waveguide, wherein said clamp comprises:

an electrically non-conductive pad;

a first electrode embedded in said electrically non-conductive pad; and

a second electrode embedded in said electrically non-conductive pad, wherein said first electrode and said second electrode longitudinally overlap said tissue treatment area of said ultrasonic blade when said clamp is in said closed position;

a first conductor in electrical communication with said first electrode; and

a second conductor in electrical communication with said second electrode, wherein said first conductor and said second conductor are configured to be placed in electrical communication with a power source such that current can flow from said first electrode to said second

34

electrode through tissue positioned intermediate said first electrode and said second electrode.

6. The surgical instrument of claim 5, wherein said first electrode and said second electrode are laterally offset.

7. The surgical instrument of claim 5, wherein said first electrode comprises a first longitudinal electrode, and wherein said second electrode comprises a second longitudinal electrode.

8. The surgical instrument of claim 7, wherein said second electrode extends parallel to said first electrode.

9. The surgical instrument of claim 7, wherein said electrically non-conductive pad comprises a first lateral side and a second lateral side, wherein said first electrode is mounted to said first lateral side, and wherein said second electrode is mounted to said second lateral side.

10. The surgical instrument of claim 5, wherein said first electrode comprises a first point electrode, and wherein said second electrode comprises a second point electrode.

* * * * *

专利名称(译)	超声波手术器械		
公开(公告)号	US9764164	公开(公告)日	2017-09-19
申请号	US14/136836	申请日	2013-12-20
[标]申请(专利权)人(译)	伊西康内外科公司		
申请(专利权)人(译)	爱惜康内镜手术，INC.		
当前申请(专利权)人(译)	ETHICON LLC		
[标]发明人	WIENER EITAN T WAN SHAN PRICE DANIEL W NORVELL DAVID K GIORDANO JAMES R		
发明人	WIENER, EITAN T. WAN, SHAN PRICE, DANIEL W. NORVELL, DAVID K. GIORDANO, JAMES R.		
IPC分类号	A61B18/14 A61N7/00 A61B17/32 A61B17/00 A61B18/00		
CPC分类号	A61N7/00 A61B17/320092 A61B18/1445 A61B2017/00367 A61B2017/00393 A61B2018/00702 A61B2018/00875 A61B2018/00916 A61B2017/320093 A61B2017/320094 A61B2017/320095		
其他公开文献	US20140107538A1		
外部链接	Espacenet USPTO		

摘要(译)

本发明公开了一种手术器械，包括壳体，配置成产生振动的声学组件，以及连接到声学组件的波导。手术器械还包括从波导延伸的超声刀和可相对于波导在打开位置和闭合位置之间移动的夹具。夹具包括非导电垫，嵌入非导电垫中的第一电极，以及嵌入非导电垫中的第二电极，其中第一电极和第二电极纵向重叠组织处理区域。当夹具处于关闭位置时，超声波刀片。手术器械还包括第一导体和第二导体，其中第一导体和第二导体被配置为与电源电连通，使得电流可以从第一电极流到第二电极。

