

(19) World Intellectual Property Organization
International Bureau



(43) International Publication Date
12 April 2001 (12.04.2001)

(10) International Publication Number
WO 01/24714 A1

PCT

- | | | |
|---|--|--|
| (51) International Patent Classification⁷: | A61B 17/32 | (72) Inventor: MESSERLY, Jeffrey, D.; 3940 Marburg Avenue, Cincinnati, OH 45209 (US). |
| (21) International Application Number: | PCT/US00/24656 | (74) Agents: CIAMPORCERO, Audley, A., Jr. et al.; Johnson & Johnson, 1 Johnson & Johnson Plaza, New Brunswick, NJ 08933 (US). |
| (22) International Filing Date: | 8 September 2000 (08.09.2000) | |
| (25) Filing Language: | English | (81) Designated States (<i>national</i>): AU, CA, JP. |
| (26) Publication Language: | English | (84) Designated States (<i>regional</i>): European patent (DE, ES, FR, GB, IT, NL). |
| (30) Priority Data: | 09/413,225 5 October 1999 (05.10.1999) US | Published:
— <i>With international search report.</i> |
| (71) Applicant: ETHICON ENDO-SURGERY, INC.
[US/US]; 4545 Creed Road, Cincinnati, OH 45242-2839 (US). | | <i>For two-letter codes and other abbreviations, refer to the "Guidance Notes on Codes and Abbreviations" appearing at the beginning of each regular issue of the PCT Gazette.</i> |

(54) Title: MULTIFUNCTIONAL CURVED BLADE FOR USE WITH AN ULTRASONIC SURGICAL INSTRUMENT

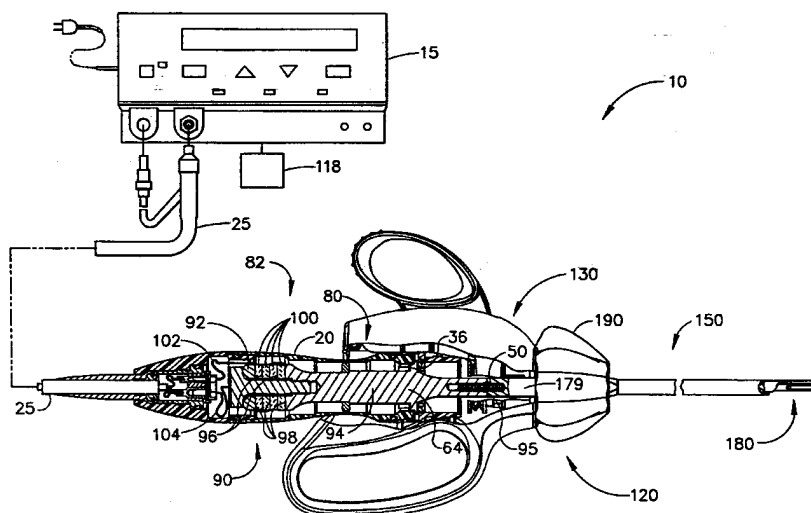

(57) Abstract: The present invention relates, in general, to ultrasonic surgical clamping instruments and, more particularly, to a multi-functional curved shears blade for an ultrasonic surgical clamping instrument (120). Disclosed is an ultrasonic surgical instrument that combines end effector geometry to best affect the multiple functions of a shears type configuration. The shape of the blade is characterized by a radius cut to form a curved, and potentially tapered geometry. This cut creates a curved surface including a concave surface (53), and a convex surface (57). The convex surface transitions into a short, straight, flat surface. The length of this straight portion affects, in part, the acoustic balancing of the transverse motion induced by the curved shape. Relative to straight blade tips, the tip curvature of the present design provides improved visibility of the transection site and improved access to targeted tissues.

WO 01/24714 A1

MULTIFUNCTIONAL CURVED BLADE FOR USE WITH AN ULTRASONIC SURGICAL INSTRUMENT

Field of the Invention

5

The present invention relates, in general, to ultrasonic surgical clamping instruments and, more particularly, to a multifunctional curved shears blade for an ultrasonic surgical clamping instrument.

10 Background of the Invention

This application is related to the following copending patent applications: Application Serial No. 08/948,625 filed October 10, 1997; Application Serial No. 08/949,133 filed October 10, 1997; Application Serial No. 09/106,686 filed June 15 29, 1998; Application Serial No. 09/337,077 filed June 21, 1999; Application Serial No. 09/412,557; application Serial No. 09/412,996; and application Serial No. 09/412,257 which are hereby incorporated herein by reference.

20 Ultrasonic instruments, including both hollow core and solid core instruments, are used for the safe and effective treatment of many medical conditions. Ultrasonic instruments, and particularly solid core ultrasonic instruments, are advantageous because they may be used to cut and/or coagulate organic tissue using energy in the form of mechanical vibrations transmitted to a surgical end-effector at ultrasonic frequencies. Ultrasonic vibrations, when 25 transmitted to organic tissue at suitable energy levels and using a suitable end-effector, may be used to cut, dissect, or cauterize tissue. Ultrasonic instruments utilizing solid core technology are particularly advantageous because of the amount of ultrasonic energy that may be transmitted from the ultrasonic transducer through the waveguide to the surgical end-effector. Such instruments are particularly

laparoscopic procedures, wherein the end-effector is passed through a trocar to reach the surgical site.

Ultrasonic vibration is induced in the surgical end-effector by, for example,
5 electrically exciting a transducer which may be constructed of one or more piezoelectric or magnetostrictive elements in the instrument hand piece. Vibrations generated by the transducer section are transmitted to the surgical end-effector via an ultrasonic waveguide extending from the transducer section to the surgical end-effector.

10

Solid core ultrasonic surgical instruments may be divided into two types, single element end-effector devices and multiple-element end-effector. Single element end-effector devices include instruments such as scalpels, and ball coagulators, see, for example, U.S. Patent No. 5,263,957. While such
15 instruments as disclosed in U.S. Patent No. 5,263,957 have been found eminently satisfactory, there are limitations with respect to their use, as well as the use of other ultrasonic surgical instruments. For example, single-element end-effector instruments have limited ability to apply blade-to-tissue pressure when the tissue is soft and loosely supported. Substantial pressure is necessary to effectively couple
20 ultrasonic energy to the tissue. This inability to grasp the tissue results in a further inability to fully coapt tissue surfaces while applying ultrasonic energy, leading to less-than-desired hemostasis and tissue joining.

The use of multiple-element end-effectors such as clamping coagulators
25 include a mechanism to press tissue against an ultrasonic blade, that can overcome these deficiencies. A clamp mechanism disclosed as useful in an ultrasonic surgical device has been described in U.S. Patent Nos. 3,636,943 and 3,862,630 to Balamuth. Generally, however, the Balamuth device, as disclosed in those patents, does not coagulate and cut sufficiently fast, and lacks versatility in that it
30 cannot be used to cut/coagulate without the clamp because access to the blade is blocked by the clamp.

Ultrasonic clamp coagulators such as, for example, those disclosed in U.S. Patent Nos. 5,322,055 and 5,893,835 provide an improved ultrasonic surgical instrument for cutting/coagulating tissue, particularly loose and unsupported tissue, wherein the ultrasonic blade is employed in conjunction with a clamp for
5 applying a compressive or biasing force to the tissue, whereby faster coagulation and cutting of the tissue, with less attenuation of blade motion, are achieved.

Improvements in technology of curved ultrasonic instruments such as described in U.S. Patent Application Serial No. 09/106,686 previously
10 incorporated herein by reference, have created needs for improvements in other aspects of curved clamp coagulators. For example, U.S Patent No. 5,873,873 describes an ultrasonic clamp coagulating instrument having an end-effector including a clamp arm comprising a tissue pad. In the configuration shown in U.S Patent No. 5,873,873 the clamp arm and tissue pad are straight.

15

The shape of an ultrasonic surgical blade or end-effector used in a clamp coagulator device defines at least four important aspects of the instrument. These are: (1) the visibility of the end-effector and its relative position in the surgical field, (2) the ability of the end-effector to access or approach targeted tissue, (3) the
20 manner in which ultrasonic energy is coupled to tissue for cutting and coagulation, and (4) the manner in which tissue can be manipulated with the ultrasonically inactive end-effector. It would be advantageous to provide an improved ultrasonic clamp coagulator optimizing these four aspects of the instrument.

25 Idemoto, et al. discloses a surgical ultrasonic horn used in a surgical operation comprising a horn body and an end plate portion. Cutting portions are provided on an edge and an end of the end portion. A passage for irrigation solution extends in the horn body and the end plate portion. At least one bore opens at the cutting portions by a jet angle of 5.degree. to 90.degree. in respect of a plane of the end
30 plate portion. The irrigation solution passage communicates with the bore, thereby the irrigation solution is sprayed therethrough.

It would be advantageous to deliver ultrasonic power more uniformly to clamped tissue than predicate devices. It would also be advantageous to provide for improved visibility of the end-effector so that a surgeon can verify that the blade extends across the structure being cut / coagulated. It would also be advantageous to provide for improved tissue access with the end-effector more closely replicating the curvature of biological structures. It would also be advantageous to provide a multitude of edges and surfaces, designed to provide a multitude of tissue effects: clamped coagulation, clamped cutting, grasping, back-cutting, dissection, spot coagulation, tip penetration and tip scoring. It would also be advantageous to provide an ultrasonic clamp coagulator that self-tensions tissue during back-cutting, utilizing a slight hook-like or wedge-like action. It would further be advantageous to provide a multifunctional ultrasonic surgical blade using unique geometric features to include: compatibility with a clamping member, sharp features for cutting, curvature for access and visibility, and a more uniform delivery of ultrasonic power than predicate devices. The present invention provides these features and improvements as described below.

Summary of the Invention

Disclosed is an ultrasonic surgical instrument that combines end-effector geometry to best affect the multiple functions of a shears-type configuration. The shape of the blade is characterized by a radiused cut to form a curved and potentially tapered geometry. This cut creates a curved surface including, in one embodiment, a concave surface and a convex surface. The convex surface transitions into a short, straight, flat surface. The length of this straight portion affects, in part, the acoustic balancing of the transverse motion induced by the curved shape. Relative to straight blade tips, the tip curvature of the present design provides improved visibility of the transection site and improved access to targeted tissues. In one embodiment, an ultrasonic blade is described comprising a broad edge and a narrow edge. The broad edge opposes the narrow edge along a vertical plane, wherein the narrow edge is defined by the intersection of a first surface and a second surface, wherein the first surface is concave.

Brief Description of the Drawings

5 The novel features of the invention are set forth with particularity in the appended claims. The invention itself, however, both as to organization and methods of operation, together with further objects and advantages thereof, may best be understood by reference to the following description, taken in conjunction with the accompanying drawings in which:

10 Figure 1 illustrates an ultrasonic surgical system including a plan view of an ultrasonic generator, a sectioned plan view of an ultrasonic transducer, and a partially sectioned plan view of a clamp coagulator in accordance with the present invention;

15 Figure 2A is an exploded perspective view of a portion of a clamp coagulator in accordance with the present invention;

Figure 2B is an exploded perspective view of a portion of a clamp coagulator in accordance with the present invention;

20

Figure 3 is a partially sectioned plan view of a clamp coagulator in accordance with the present invention with the clamp arm assembly shown in an open position;

25 Figure 4 is a partially sectioned plan view of a clamp coagulator in accordance with the present invention with the clamp arm assembly shown in a closed position;

Figure 5 is a side view of a collar cap of the clamp coagulator;

30

Figure 6 is a front view of a collar cap of the clamp coagulator;

Figure 7 is a side view of a force limiting spring of the clamp coagulator;
Figure 8 is a front view of a force limiting spring of the clamp coagulator;

Figure 9 is a side view of a washer of the clamp coagulator;

5

Figure 10 is a front view of a washer of the clamp coagulator;

Figure 11 is a side view of a tubular collar of the clamp coagulator;

10

Figure 12 is a rear view of a tubular collar of the clamp coagulator;

Figure 13 is a front view of a tubular collar of the clamp coagulator;

Figure 14 is a side view of an inner knob of the clamp coagulator;

15

Figure 15 is a front view of an inner knob of the clamp coagulator;

Figure 16 is a bottom view of an inner knob of the clamp coagulator;

20

Figure 17 is a rear view of an outer knob of the clamp coagulator;

Figure 18 is a top view of an outer knob of the clamp coagulator;

Figure 19 is a top view of a yoke of the clamp coagulator;

25

Figure 20 is a side view of a yoke of the clamp coagulator;

Figure 21 is a front view of a yoke of the clamp coagulator;

30

Figure 22 is a perspective view of a yoke of the clamp coagulator;

Figure 23 is a perspective view of an end-effector of the clamp coagulator;

Figure 24 is a top perspective view of a clamp arm of the camp coagulator;

Figure 25 is a top view of an end-effector of the clamp coagulator;

5

Figure 26 is a side view of an end-effector of the clamp coagulator with the clamp arm open;

Figure 27 is a top view of a tissue pad of the clamp coagulator;

10

Figure 28 is a side view of a tissue pad of the clamp coagulator;

Figure 29 is a front view of a tissue pad of the clamp coagulator;

15

Figure 30 is a perspective view of a tissue pad of the clamp coagulator;

Figure 31 is a bottom perspective view of a clamp arm of the clamp coagulator;

20

Figure 32 is a first cross-sectional view of the clamp arm illustrated in Figure 31;

Figure 33 is a second cross-sectional view of the clamp arm illustrated in Figure 31;

25

Figure 34 is a bottom plan view of a blade of the clamp coagulator;

Figure 35 is a cross-sectional view of a blade of the clamp coagulator;

30

Figure 35A is a cross-sectional view of an alternate embodiment of a blade of the clamp coagulator; and

Figure 36 is a perspective view of an end-effector of the clamp coagulator.

Detailed Description of the Invention

The present invention will be described in combination with ultrasonic instruments as described herein. Such description is exemplary only, and is not intended to limit the scope and applications of the invention. For example, the invention is useful in combination with a multitude of ultrasonic instruments including those described in, for example, U.S. Patents Nos. 5,938,633; 5,935,144; 5,944,737; 5,322,055, 5,630,420; and 5,449,370.

10

Figure 1 illustrates ultrasonic system 10 comprising an ultrasonic signal generator 15 with a sandwich type ultrasonic transducer 82, hand piece housing 20, and clamp coagulator 120 in accordance with the present invention. Clamp coagulator 120 may be used for open or laparoscopic surgery. The ultrasonic transducer 82, which is known as a "Langevin stack", generally includes a transduction portion 90, a first resonator or end-bell 92, and a second resonator or fore-bell 94, and ancillary components. The ultrasonic transducer 82 is preferably an integral number of one-half system wavelengths ($n\lambda/2$) in length as will be described in more detail later. An acoustic assembly 80 includes the ultrasonic transducer 82, mount 36, velocity transformer 64 and surface 95.

20

The distal end of end-bell 92 is connected to the proximal end of transduction portion 90, and the proximal end of fore-bell 94 is connected to the distal end of transduction portion 90. Fore-bell 94 and end-bell 92 have a length determined by a number of variables, including the thickness of the transduction portion 90, the density and modulus of elasticity of the material used to manufacture end-bell 92 and fore-bell 94, and the resonant frequency of the ultrasonic transducer 82. The fore-bell 94 may be tapered inwardly from its proximal end to its distal end to amplify the ultrasonic vibration amplitude as velocity transformer 64, or alternately may have no amplification.

30

The piezoelectric elements 100 may be fabricated from any suitable material, such as, for example, lead zirconate-titanate, lead meta-niobate, lead titanate, or other piezoelectric crystal material. Each of the positive electrodes 96, negative electrodes 98, and piezoelectric elements 100 has a bore extending
5 through the center. The positive and negative electrodes 96 and 98 are electrically coupled to wires 102 and 104, respectively. Wires 102 and 104 are encased within cable 25 and electrically connectable to ultrasonic signal generator 15 of ultrasonic system 10.

10 Ultrasonic transducer 82 of the acoustic assembly 80 converts the electrical signal from ultrasonic signal generator 15 into mechanical energy that results in primarily longitudinal vibratory motion of the ultrasonic transducer 82 and an end-effector 180 at ultrasonic frequencies. When the acoustic assembly 80 is energized, a vibratory motion standing wave is generated through the acoustic
15 assembly 80. The amplitude of the vibratory motion at any point along the acoustic assembly 80 depends on the location along the acoustic assembly 80 at which the vibratory motion is measured. A minimum or zero crossing in the vibratory motion standing wave is generally referred to as a node (i.e., where motion is usually minimal), and an absolute value maximum or peak in the
20 standing wave is generally referred to as an anti-node. The distance between an anti-node and its nearest node is one-quarter wavelength ($\lambda / 4$).

Wires 102 and 104 transmit the electrical signal from the ultrasonic signal generator 15 to positive electrodes 96 and negative electrodes 98. A suitable
25 generator is available as model number GEN01, from ETHICON ENDO-SURGERY Inc., Cincinnati, Ohio. The piezoelectric elements 100 are energized by an electrical signal supplied from the ultrasonic signal generator 15 in response to a foot switch 118 to produce an acoustic standing wave in the acoustic assembly 80. The electrical signal causes disturbances in the piezoelectric elements 100 in
30 the form of repeated small displacements resulting in large compression forces within the material. The repeated small displacements cause the piezoelectric elements 100 to expand and contract in a continuous manner along the axis of the

voltage gradient, producing longitudinal waves of ultrasonic energy. The ultrasonic energy is transmitted through the acoustic assembly 80 to the end-effector 180.

5 In order for the acoustic assembly 80 to deliver energy to end-effector 180, all components of acoustic assembly 80 must be acoustically coupled to the ultrasonically active portions of clamp coagulator 120. The distal end of the ultrasonic transducer 82 may be acoustically coupled at surface 95 to the proximal end of an ultrasonic waveguide 179 by a threaded connection such as stud 50.

10

 The components of the acoustic assembly 80 are preferably acoustically tuned such that the length of any assembly is an integral number of one-half wavelengths ($n\lambda/2$), where the wavelength λ is the wavelength of a pre-selected or operating longitudinal vibration drive frequency f_d of the acoustic assembly 80, and
15 where n is any positive integer. It is also contemplated that the acoustic assembly 80 may incorporate any suitable arrangement of acoustic elements.

 Referring now to Figures 2A and 2B, an exploded perspective view of the clamp coagulator 120 of the surgical system 10 in accordance with the present
20 invention is illustrated. The clamp coagulator 120 is preferably attached to and removed from the acoustic assembly 80 as a unit. The proximal end of the clamp coagulator 120 preferably acoustically couples to the distal surface 95 of the acoustic assembly 80 as shown in Figure 1. It will be recognized that the clamp coagulator 120 may be coupled to the acoustic assembly 80 by any suitable means.

25

 The clamp coagulator 120 preferably includes an instrument housing 130, and an elongated member 150. The elongated member 150 can be selectively rotated with respect to the instrument housing 130 as further described below. The instrument housing 130 includes a pivoting handle portion 136, and a fixed handle
30 132A and 132B coupled to a left shroud 134 and a right shroud 138 respectively.

The right shroud 138 is adapted to snap fit on the left shroud 134. The right shroud 138 is preferably coupled to the left shroud 134 by a plurality of inwardly facing prongs 70 formed on the right shroud 138. The plurality of prongs 70 are arranged for engagement in corresponding holes or apertures 140, which are formed in the left shroud 134. When the left shroud 134 is attached to the right shroud 138, a cavity is formed therebetween to accommodate various components, such as an indexing mechanism 255 as further described below.

The left shroud 134, and the right shroud 138 of the clamp coagulator 120 are preferably fabricated from polycarbonate. It is contemplated that these components may be made from any suitable material without departing from the spirit and scope of the invention.

Indexing mechanism 255 is disposed in the cavity of the instrument housing 130. The indexing mechanism 255 is preferably coupled or attached on inner tube 170 to translate movement of the handle portion 136 to linear motion of the inner tube 170 to open and close the clamp arm assembly 300. When the pivoting handle portion 136 is moved toward the fixed handle portion 130, the indexing mechanism 255 slides the inner tube 170 rearwardly to pivot the clamp arm assembly 300 into a closed position. The movement of the pivoting handle portion 136 in the opposite direction slides the indexing mechanism 255 to displace the inner tube 170 in the opposite direction, i.e., forwardly, and hence pivot the clamp arm assembly 300 into its open position.

The indexing mechanism 255 also provides a ratcheting mechanism to allow the elongated member 150 to rotate about its longitudinal axis relative to instrument housing 130. The rotation of the elongated member 150 enables the clamp arm assembly 300 to be turned to a selected or desired angular position. The indexing mechanism 255 preferably includes a tubular collar 260 and yoke 280.

The tubular collar 260 of the indexing mechanism 255 is preferably snapped onto the proximal end of the inner tube 170 and keyed into opposing openings 168. The tubular collar 260 is preferably fabricated from polyetherimide. It is contemplated that the tubular collar 260 may be constructed
5 from any suitable material.

Tubular collar 260 is shown in greater detail in Figures 11 through 13. The tubular collar 260 preferably includes an enlarged section 262, and a bore 266 extending therethrough. The enlarged section 262 preferably includes a ring 272
10 formed around the periphery of the tubular collar 260 to form groove 268. The groove 268 has a plurality of detents or teeth 269 for retaining the elongated member 150 in different rotational positions as the elongated member 150 is rotated about its longitudinal axis. Preferably, the groove 268 has twelve ratchet teeth to allow the elongated portion to be rotated in twelve equal angular
15 increments of approximately 30 degrees. It is contemplated that the tubular collar 260 may have any number of teeth-like members. It will be recognized that the teeth-like members may be disposed on any suitable part of the tubular collar 260 without departing from the scope and spirit of the present invention.

Referring back now to Figures 2A through 4, the pivoting handle portion
20 136 includes a thumb loop 142, a first hole 124, and a second hole 126. A pivot pin 153 is disposed through first hole 124 of handle portion 136 to allow pivoting as shown by arrow 121 in Figure 3. As thumb loop 142 of pivoting handle portion 136 is moved in the direction of arrow 121, away from instrument housing
25 130, a link 128 applies a forward force to yoke 280, causing yoke 280 to move forward. Link 128 is connected to pivoting handle portion 136 by a pin 129, and link 128 is connected to base 284 by a pin 127.

Referring back now to Figure 2A, yoke 280 generally includes a holding or
30 supporting member 282 and a base 284. The supporting member 282 is preferably semi-circular and has a pair of opposing pawls 286 that extend inwardly to engage with the teeth 269 of the tubular collar 260. It is contemplated that the pawls 286

may be disposed on any suitable part of the yoke 280 for engagement with the teeth 269 of the tubular collar 260 without departing from the spirit and scope of the invention. It will also be recognized that the yoke 280 may have any number of ratchet arms.

5

Yoke 280 is shown in greater detail in Figures 19 through 22. The pivoting handle portion 136 preferably is partially disposed in a slot 147 of the base 284 of the yoke 280. The base 284 also includes a base opening 287, an actuator travel stop 290, and a base pin-hole 288. The pivot pin 153 is disposed
10 through the base opening 287. Yoke 280 pawls 286 transfer opening force to inner tube 170 through tubular collar 260, resulting in the opening of clamp arm assembly 300.

The yoke 280 of the clamp coagulator 120 is preferably fabricated from
15 polycarbonate. The yoke 280 may also be made from a variety of materials including other plastics, such as ABS, NYLON, or polyetherimide. It is contemplated that the yoke 280 may be constructed from any suitable material without departing from the spirit and scope of the invention.

20 As illustrated in Figures 3 and 4, yoke 280 also transfers a closing force to clamp arm assembly 300 as pivoting handle portion 136 is moved toward instrument housing 130. Actuator travel stop 290 contacts pivot pin 153 at the bottom of the stroke of pivoting handle portion 136, stopping any further movement, or overtravel, of pivoting handle portion 136. Pawls 286 of yoke 280
25 transfer force to tubular collar 260 through a washer 151, a force limiting spring 155, and collar cap 152. Collar cap 152 is rigidly attached to tubular collar 260 after washer 151 and force limiting spring 155 have been assembled onto tubular collar 260 proximal to enlarged section 262. Collar cap 152 is illustrated in greater detail in Figures 5 and 6. Force limiting spring 155 is illustrated in greater
30 detail in Figures 7 and 8, and washer 151 is illustrated in greater detail in Figures 9 and 10. Thickness of washer 151 may be adjusted during design or manufacturing of clamp coagulator 120 to alter the pre-load of force limiting

spring 155. Collar cap 152 is attached to tubular collar 260 by ultrasonic welding, but may alternately be press fit, snap fit or attached with an adhesive.

Referring to Figures 5 through 10, tubular collar 260, washer 151, force limiting spring 155, and collar cap 152 provide a force limiting feature to clamp arm assembly 300. As pivoting handle portion 136 is moved toward instrument housing 130, clamp arm assembly 300 is rotated toward ultrasonic blade 88. In order to provide both ultrasonic cutting, and hemostasis, it is desirable to limit the maximum force of clamp arm assembly 300 to 0.5 to 3.0 Lbs.

10

Figures 5 and 6 illustrate collar cap 152 including a spring surface 158. Figures 7 and 8 illustrate force limiting spring 155 including a cap surface 156, a washer surface 157, and a plurality of spring elements 159. Force limiting spring 155 is described in the art as a wave spring, due to the shape of spring elements 159. It is advantageous to use a wave spring for force limiting spring 155 because it provides a high spring rate in a small physical size well suited to an ultrasonic surgical instrument application where a central area is open for ultrasonic waveguide 179. Force limiting spring 155 is biased between spring surface 158 of collar cap 152 and spring face 165 of washer 151. Washer 151 includes a pawl face 167 (Figures 9 and 10) that contacts pawls 286 of yoke 280 after assembly of clamp coagulator 120 (see Figures 2 through 4).

20

Referring now to Figure 2 and Figures 14 through 18, a rotational knob 190 is mounted on the elongated member 150 to turn the elongated member 150 so that the tubular collar 260 rotates with respect to the yoke 280. The rotational knob 190 may be fabricated from polycarbonate. The rotational knob 190 may also be made from a variety of materials including other plastics, such as a polyetherimide, nylon, or any other suitable material.

25

The rotational knob 190 preferably has an enlarged section or outer knob 192, an inner knob 194, and an axial bore 196 extending therethrough. Inner knob 194 includes keys 191 that attach cooperatively to keyways 189 of outer knob 192.

30

The outer knob 192 includes alternating longitudinal ridges 197 and grooves 198 that facilitate the orientation of the rotational knob 190 and the elongated member 150 by a surgeon. The axial bore 196 of the rotational knob 190 is configured to snugly fit over the proximal end of the elongated member 150.

5

The inner knob 194 extends through an opening 139 in the distal end of the instrument housing 130. Inner knob 194 includes a channel 193 to rotatably attach inner knob 194 into opening 139. The inner knob 194 of the rotational knob 190 has a pair of opposing holes 199. The opposing holes 199 are aligned as part of a
10 passageway 195 that extends through the elongated member 150, as will be described later.

A coupling member, such as, for example, pin 163, may be positioned through opposing holes 199 of the passageway 195. The pin 163 may be held in
15 the passageway 195 of the elongated member 150 by any suitable means, such as, for example, trapped between ribs in housing 130, or a silicone or cyanoacrylate adhesive. The pin 163 allows rotational torque to be applied to the elongated member 150 from the rotational knob 190 in order to rotate the elongated member 150.

20

When the rotational knob 190 is rotated, the teeth 269 of the tubular collar 260 engage and ride up slightly on the corresponding pawls 286 of the yoke 280. As the pawls 286 ride up on the teeth 269, the supporting member 282 of the yoke 280 deflects outwardly to allow pawls 286 to slip or pass over the teeth 269 of the
25 tubular collar 260.

In one embodiment, the teeth 269 of the tubular collar 260 are configured as ramps or wedges, and the pawls 286 of the yoke 280 are configured as posts. The teeth 269 of the tubular collar 260 and the pawls 286 of the yoke 280 may be
30 reversed so that the teeth 269 of the tubular collar 260 are posts, and the pawls 286 of the yoke 280 are ramps or wedges. It is contemplated that the teeth 269 may be integrally formed or coupled directly to the periphery of the elongated member

150. It will also be recognized that the teeth 269 and the pawls 286 may be cooperating projections, wedges, cam surfaces, ratchet-like teeth, serrations, wedges, flanges, or the like which cooperate to allow the elongated member 150 to be indexed at selective angular positions, without departing from the spirit and scope of the invention.

As illustrated in Figure 2, the elongated member 150 of the clamp coagulator 120 extends from the instrument housing 130. As shown in Figures 2B through 4, the elongated member 150 preferably includes an outer member or outer tube 160, an inner member or inner tube 170, and a transmission component or ultrasonic waveguide 179.

The outer tube 160 of the elongated member 150 preferably includes a hub 162, a tubular member 164, and a longitudinal opening or aperture 166 extending therethrough. The outer tube 160 preferably has a substantially circular cross-section and may be fabricated from stainless steel. It will be recognized that the outer tube 160 may be constructed from any suitable material and may have any suitable cross-sectional shape.

The hub 162 of the outer tube 160 preferably has a larger diameter than the tubular member 164 does. The hub 162 has a pair of outer tube holes 161 to receive pin 163 to allow the hub 162 to be coupled to rotational knob 190. As a result, the outer tube 160 will rotate when the rotational knob 190 is turned or rotated.

The hub 162 of the outer tube 160 also includes wrench flats 169 on opposite sides of the hub 162. The wrench flats 169 are preferably formed near the distal end of the hub 162. The wrench flats 169 allow torque to be applied by a torque wrench to the hub 162 to tighten the ultrasonic waveguide 179 to the stud 50 of the acoustic assembly 80. For example, U.S. Patent Nos. 5,059,210 and 5,057,119, which are hereby incorporated herein by reference, disclose torque

wrenches for attaching and detaching a transmission component to a mounting device of a hand piece assembly.

Located at the distal end of the tubular member 164 of the outer tube 160 is
5 an end-effector 180 for performing various tasks, such as, for example, grasping tissue, cutting tissue and the like. It is contemplated that the end-effector 180 may be formed in any suitable configuration.

End-effector 180 and its components are shown in greater detail in Figures
10 23 through 33. The end-effector 180 generally includes a non-vibrating clamp arm assembly 300 to, for example, grip tissue or compress tissue against the ultrasonic blade 88. The end-effector 180 is illustrated in Figures 23 and 26 in a clamp open position, and clamp arm assembly 300 is preferably pivotally attached to the distal end of the outer tube 160.

15 Looking first to Figures 23 through 26, the clamp arm assembly 300 preferably includes a clamp arm 202, a jaw aperture 204, a first post 206A and a second post 206B, and a tissue pad 208. The clamp arm 202 is pivotally mounted about pivot pins 207A and 207B to rotate in the direction of arrow 122 in Figure 3
20 when thumb loop 142 is moved in the direction indicated by arrow 121 in Figure 3. By advancing the pivoting handle portion 136 toward the instrument housing 130, the clamp arm 202 is pivoted about the pivot pin 207 into a closed position. Retracting the pivoting handle portion 136 away from the instrument housing 130 pivots the clamp arm 202 into an open position.

25 The clamp arm 202 has tissue pad 208 attached thereto for squeezing tissue between the ultrasonic blade 88 and clamp arm assembly 300. The tissue pad 208 is preferably formed of a polymeric or other compliant material and engages the ultrasonic blade 88 when the clamp arm 202 is in its closed position. Preferably,
30 the tissue pad 208 is formed of a material having a low coefficient of friction but which has substantial rigidity to provide tissue-grasping capability, such as, for example, TEFLON, a trademark name of E. I. Du Pont de Nemours and Company

for the polymer polytetrafluoroethylene (PTFE). The tissue pad 208 may be mounted to the clamp arm 202 by an adhesive, or preferably by a mechanical fastening arrangement as will be described below.

5 As illustrated in Figures 23, 26 and 28, serrations 210 are formed in the clamping surfaces of the tissue pad 208 and extend perpendicular to the axis of the ultrasonic blade 88 to allow tissue to be grasped, manipulated, coagulated and cut without slipping between the clamp arm 202 and the ultrasonic blade 88.

10 Tissue pad 208 is illustrated in greater detail in Figures 27 through 29. Tissue pad 208 includes a T-shaped protrusion 212, a left protrusion surface 214, a right protrusion surface 216, a top surface 218, and a bottom surface 219. Bottom surface 219 includes the serrations 210 previously described. Tissue pad 208 also includes a beveled front end 209 to ease insertion during assembly as will be
15 described below.

Referring now to Figure 26, the distal end of the tubular member 174 of the inner tube 170 preferably includes a finger or flange 171 that extends therefrom. The flange 171 has openings 173A and 173B (173B not shown) to
20 receive the posts 206A and 206B of the clamp arm 202. When the inner tube 170 of the elongated member 150 is moved axially, the flange 171 moves forwardly or rearwardly while engaging the post 206 of the clamp arm assembly 300 to open and close the clamp arm 202.

25 Referring now to Figures 24, 25, and 31 through 33, the clamp arm 202 of end-effector 180 is shown in greater detail. Clamp arm 202 includes an arm top 228 and an arm bottom 230, as well as a straight portion 235 and a curved portion 236. Straight portion 235 includes a straight T-slot 226. Curved portion 236 includes a first top hole 231, a second top hole 232, a third top hole 233, a fourth
30 top hole 234, a first bottom cut-out 241, a second bottom cut-out 242, a third bottom cut-out 243, a fourth bottom cut-out 244, a first ledge 221, a second ledge 222, a third ledge 223, a fourth ledge 224, and a fifth ledge 225.

Top hole 231 extends from arm top 228 through clamp arm 202 to second ledge 222. Top hole 232 extends from arm top 228 through clamp arm 202 to third ledge 223. Top hole 233 extends from arm top 228 through clamp arm 202 to fourth ledge 224. Top hole 234 extends from arm top 228 through clamp arm 202 to fifth ledge 225. The arrangement of holes 231 through 234 and ledges 211 through 225 enables clamp arm 202 to include both the straight portion 235 and the curved portion 236, while being moldable from a process such as, for example, metal injection molding (MIM). Clamp arm 202 may be made out of stainless steel or other suitable metal utilizing the MIM process.

10

Referring to Figures 30 and 31, tissue pad 208 T-shaped protrusion 212 is insertable into clamp arm 202 straight T-slot 226. Clamp arm 202 is designed such that tissue pad 208 may be manufactured as a straight component by, for example, injection molding, machining, or extrusion. As clamp arm 202 is inserted into straight T-slot 226 and moved progressively through curved portion 236, beveled front edge 209 facilitates bending of tissue pad 208 to conform to the curvature of clamp arm 202. The arrangement of holes 231 through 234 and ledges 211 through 225 enables clamp arm 202 to bend and hold tissue pad 208.

Figures 32 and 33 illustrate how clamp arm 202 holds tissue pad 208 in place while maintaining a bend in tissue pad 208 that conforms to curved portion 236 of clamp arm 202. As illustrated in Figure 32, third ledge 223 contacts right protrusion surface 216 providing a contact edge 238, while left protrusion surface 214 is unsupported at this position. At a distal location, illustrated in Figure 33, fourth ledge 224 contacts left protrusion surface 214 providing a contact edge 239, while right protrusion surface 216 is unsupported at this location.

Referring back now to Figure 2 again, the inner tube 170 of the elongated member 150 fits snugly within the opening 166 of the outer tube 160. The inner tube 170 preferably includes an inner hub 172, a tubular member 174, a circumferential groove 176, a pair of opposing openings 178, a pair of opposing openings 178, and a longitudinal opening or aperture 175 extending therethrough.

30

The inner tube 170 preferably has a substantially circular cross-section, and may be fabricated from stainless steel. It will be recognized that the inner tube 170 may be constructed from any suitable material and may be any suitable shape.

5 The inner hub 172 of the inner tube 170 preferably has a larger diameter than the tubular member 174 does. The pair of opposing openings 178 of the inner hub 172 allow the inner hub 172 to receive the pin 163 to allow the inner tube 170 and the ultrasonic waveguide 179 to transfer torque for attaching ultrasonic waveguide 179 to stud 50 as previously described. An O-ring 220 is preferably
10 disposed in the circumferential groove 176 of the inner hub 172.

 The ultrasonic waveguide 179 of the elongated member 150 extends through aperture 175 of the inner tube 170. The ultrasonic waveguide 179 is preferably substantially semi-flexible. It will be recognized that the ultrasonic
15 waveguide 179 may be substantially rigid or may be a flexible wire. Ultrasonic vibrations are transmitted along the ultrasonic waveguide 179 in a longitudinal direction to vibrate the ultrasonic blade 88.

 The ultrasonic waveguide 179 may, for example, have a length
20 substantially equal to an integral number of one-half system wavelengths ($n\lambda/2$). The ultrasonic waveguide 179 may be preferably fabricated from a solid core shaft constructed out of material which propagates ultrasonic energy efficiently, such as titanium alloy (i.e., Ti-6Al-4V) or an aluminum alloy. It is contemplated that the ultrasonic waveguide 179 may be fabricated from any other suitable material. The
25 ultrasonic waveguide 179 may also amplify the mechanical vibrations transmitted to the ultrasonic blade 88 as is well known in the art.

 As illustrated in Figure 2, the ultrasonic waveguide 179 may include one or more stabilizing silicone rings or damping sheaths 110 (one being shown)
30 positioned at various locations around the periphery of the ultrasonic waveguide 179. The damping sheaths 110 dampen undesirable vibration and isolate the ultrasonic energy from the inner tube 170 assuring the flow of ultrasonic energy in

a longitudinal direction to the distal end of the ultrasonic blade 88 with maximum efficiency. The damping sheaths 110 may be secured to the ultrasonic waveguide 179 by an interference fit such as, for example, a damping sheath described in U.S. Patent Application No. 08/808,652 hereby incorporated herein by reference.

5

Referring again to Figure 2, the ultrasonic waveguide 179 generally has a first section 182, a second section 184, and a third section 186. The first section 182 of the ultrasonic waveguide 179 extends distally from the proximal end of the ultrasonic waveguide 179. The first section 182 has a substantially continuous cross-section dimension.

10

The first section 182 preferably has at least one radial waveguide hole 188 extending therethrough. The waveguide hole 188 extends substantially perpendicular to the axis of the ultrasonic waveguide 179. The waveguide hole 188 is preferably positioned at a node but may be positioned at any other suitable point along the ultrasonic waveguide 179. It will be recognized that the waveguide hole 188 may have any suitable depth and may be any suitable shape.

15

The waveguide hole 188 of the first section 182 is aligned with the opposing openings 178 of the hub 172 and outer tube holes 161 of hub 162 to receive the pin 163. The pin 163 allows rotational torque to be applied to the ultrasonic waveguide 179 from the rotational knob 190 in order to rotate the elongated member 150. Passageway 195 of elongated member 150 includes opposing openings 178, outer tube holes 161, waveguide hole 188, and opposing holes 199.

20

25

The second section 184 of the ultrasonic waveguide 179 extends distally from the first section 182. The second section 184 has a substantially continuous cross-section dimension. The diameter of the second section 184 is smaller than the diameter of the first section 182. As ultrasonic energy passes from the first section 182 of the ultrasonic waveguide 179 into the second section 184, the

30

narrowing of the second section 184 will result in an increased amplitude of the ultrasonic energy passing therethrough.

5 The third section 186 extends distally from the distal end of the second section 184. The third section 186 has a substantially continuous cross-section dimension. The third section 186 may also include small diameter changes along its length. The third section preferably includes a seal 187 formed around the outer periphery of the third section 186. As ultrasonic energy passes from the second section 184 of the ultrasonic waveguide 179 into the third section 186, the
10 narrowing of the third section 186 will result in an increased amplitude of the ultrasonic energy passing therethrough.

The third section 186 may have a plurality of grooves or notches (not shown) formed in its outer circumference. The grooves may be located at nodes of
15 the ultrasonic waveguide 179 or any other suitable point along the ultrasonic waveguide 179 to act as alignment indicators for the installation of a damping sheath 110 during manufacturing.

Still referring to Figure 2, damping sheath 110 of the surgical instrument
20 150 surrounds at least a portion of the ultrasonic waveguide 179. The damping sheath 110 may be positioned around the ultrasonic waveguide 179 to dampen or limit transverse side-to-side vibration of the ultrasonic waveguide 179 during operation. The damping sheath 110 preferably surrounds part of the second section 184 of the ultrasonic waveguide 179. It is contemplated that the damping
25 sheath 110 may be positioned around any suitable portion of the ultrasonic waveguide 179. The damping sheath 110 preferably extends over at least one antinode of transverse vibration, and more preferably, a plurality of antinodes of transverse vibration. The damping sheath 110 preferably has a substantially circular cross-section. It will be recognized that the damping sheath 110 may have
30 any suitable shape to fit over the ultrasonic waveguide 179 and may be any suitable length.

The damping sheath 110 is preferably in light contact with the ultrasonic waveguide 179 to absorb unwanted ultrasonic energy from the ultrasonic waveguide 179. The damping sheath 110 reduces the amplitude of non-axial vibrations of the ultrasonic waveguide 179, such as, unwanted transverse
5 vibrations associated with the longitudinal frequency of 55,500 Hz as well as other higher and lower frequencies.

The damping sheath 110 is constructed of a polymeric material, preferably with a low coefficient of friction to minimize dissipation of energy from the axial
10 motion or longitudinal vibration of the ultrasonic waveguide 179. The polymeric material is preferably floura-ethylene propene (FEP) which resists degradation when sterilized using gamma radiation. It will be recognized that the damping sheath 110 may be fabricated from any suitable material, such as, for example, PTFE.

15

The damping sheath 110 preferably has an opening extending therethrough, and a longitudinal slit 111. The slit 111 of the damping sheath 110 allows the damping sheath 110 to be assembled over the ultrasonic waveguide 179 from either end. It will be recognized that the damping sheath 110 may have any suitable
20 configuration to allow the damping sheath 110 to fit over the ultrasonic waveguide 179. For example, the damping sheath 110 may be formed as a coil or spiral or may have patterns of longitudinal and/or circumferential slits or slots. It is also contemplated that the damping sheath 110 may be fabricated without a slit 111 and the ultrasonic waveguide 179 may be fabricated from two or more parts to fit
25 within the damping sheath 110.

It will be recognized that the ultrasonic waveguide 179 may have any suitable cross-sectional dimension. For example, the ultrasonic waveguide 179 may have a substantially uniform cross-section or the ultrasonic waveguide 179
30 may be tapered at various sections or may be tapered along its entire length.

The ultrasonic waveguide 179 may also amplify the mechanical vibrations transmitted through the ultrasonic waveguide 179 to the ultrasonic blade 88 as is well known in the art. The ultrasonic waveguide 179 may further have features to control the gain of the longitudinal vibration along the ultrasonic waveguide 179 and features to tune the ultrasonic waveguide 179 to the resonant frequency of the system.

The proximal end of the third section 186 of ultrasonic waveguide 179 may be coupled to the distal end of the second section 184 by an internal threaded connection, preferably near an antinode. It is contemplated that the third section 186 may be attached to the second section 184 by any suitable means, such as a welded joint or the like. Third section 186 includes ultrasonic blade 88. Although the ultrasonic blade 88 may be detachable from the ultrasonic waveguide 179, the ultrasonic blade 88 and ultrasonic waveguide 179 are preferably formed as a single unit.

The ultrasonic blade 88 may have a length substantially equal to an integral multiple of one-half system wavelengths ($n\lambda/2$). The distal end of ultrasonic blade 88 may be disposed near an antinode in order to provide the maximum longitudinal excursion of the distal end. When the transducer assembly is energized, the distal end of the ultrasonic blade 88 is configured to move in the range of, for example, approximately 10 to 500 microns peak-to-peak, and preferably in the range of about 30 to 150 microns at a predetermined vibrational frequency.

The ultrasonic blade 88 is preferably made from a solid core shaft constructed of material which propagates ultrasonic energy, such as a titanium alloy (i.e., Ti-6Al-4V) or an aluminum alloy. It will be recognized that the ultrasonic blade 88 may be fabricated from any other suitable material. It is also contemplated that the ultrasonic blade 88 may have a surface treatment to improve the delivery of energy and desired tissue effect. For example, the ultrasonic blade 88 may be micro-finished, coated, plated, etched, grit-blasted, roughened or scored to enhance coagulation and cutting of tissue and/or reduce adherence of

tissue and blood to the end-effector. Additionally, the ultrasonic blade 88 may be sharpened or shaped to enhance its characteristics. For example, the ultrasonic blade 88 may be blade shaped, hook shaped, or ball shaped.

5 As illustrated in Figures 34, 35 and 36, the geometry of the ultrasonic blade 88 in accordance with the present invention delivers ultrasonic power more uniformly to clamped tissue than predicate devices. The end-effector 180 provides for improved visibility of the blade tip so that a surgeon can verify that the blade 88 extends across the structure being cut or coagulated. This is especially
10 important in verifying margins for large blood vessels. The geometry also provides for improved tissue access by more closely replicating the curvature of biological structures. Blade 88 provides a multitude of edges and surfaces, designed to provide a multitude of tissue effects: clamped coagulation, clamped cutting, grasping, back-cutting, dissection, spot coagulation, tip penetration and tip
15 scoring.

The distal most tip of blade 88 has a surface 54 perpendicular to a tangent 63, a line tangent to the curvature at the distal tip. Two fillet-like features 61A and 61B are used to blend surfaces 51, 52 and 54, thus giving a blunt tip that can be utilized
20 for spot coagulation. The top of the blade 88 is radiused and blunt, providing a broad edge, or surface 56, for clamping tissues between it and clamp arm assembly 300. Surface 56 is used for clamped cutting and coagulation as well as manipulating tissues while the blade is inactive.

25 The bottom surface has a spherical cut 53 that provides a narrow edge, or sharp edge 55, along the bottom of blade 88. The material cut is accomplished by, for example, sweeping a spherical end mill through an arc of radius R1 and then finishing the cut using a second, tighter radius R2 that blends the cut with a bottom surface 58 of the blade 88. Radius R1 is preferably within the range of 0.5 inches
30 to 2 inches, more preferably within the range of 0.9 inches to 1.1 inches, and most preferably about 1.068 inches. Radius R2 is preferably within the range of 0.125

inches to 0.5 inches, and most preferably about 0.25 inches. The second radius R2 and the corresponding blend with the bottom surface 58 of blade 88 diminishes the stress concentrated at the end of the spherical cut relative to stopping the cut without this blend. The sharp edge 55 facilitates dissection and unclamped cutting
5 (back-cutting) through less vascular tissues.

The curved shape of blade 88 also results in a more uniformly distributed energy delivery to tissue as it is clamped against the blade 88. Uniform energy delivery is desired so that a consistent tissue effect (thermal and transection effect)
10 along the length of end-effector 180 is achieved. The distal most 15 millimeters of blade 88 is the working portion, used to achieve a tissue effect. The displacement vectors for locations along the curved shears blade 88 have directions that, by virtue of the improvements of the present invention over predicate instruments, lie largely in the x-y plane illustrated in Figure 34. The motion, therefore, of blade 88 lies
15 within a plane (the x-y plane) that is perpendicular to the direction of the clamping force from clamp arm assembly 300.

Spherical cut 53 on bottom surface 58 of blade 88 creates sharp edge 55 while removing a minimal amount of material from blade 88. Spherical cut 53 on
20 the bottom of blade 88 creates a sharp edge 55 with an angle of α as described below. This angle α may be similar to predicate shears devices such as, for example, the LCS-K5 manufactured by Ethicon Endo-Surgery Inc., Cincinnati, Ohio. However the blade 88 of the present invention cuts faster than predicate devices by virtue of the orientation of the angle α with respect to the typical
25 application force. For the predicate shears devices, the edges are symmetric, spanning the application force equally. The edges for the present invention are asymmetric, with the asymmetry of the edges dictating how quickly tissue is separated or cut. The asymmetry is important in that it provides for an effectively sharper edge when ultrasonically activated, without removing a significant volume
30 of material, while maintaining blunt geometry. This asymmetric angle as well as

the curvature of the blade act to self tension tissue during back-cutting utilizing a slight hook-like or wedge-like action.

Sharp edge 55 of ultrasonic blade 88 is defined by the intersection of surface 53 and a second surface 57 left after bottom surface 58 has received spherical cut 53. Clamp arm assembly 300 is pivotally mounted on said distal end of outer tube 160 for pivotal movement with respect to ultrasonic blade 88, for clamping tissue between clamp arm assembly 300 and ultrasonic blade 88. Reciprocal movement of inner tube 170 pivots clamp arm assembly 300 through an arc of movement, defining a vertical plane 181. A tangent 60 of spherical cut 53 at sharp edge 55 defines an angle α with a tangent 62 of second surface 57, as illustrated in Figure 35. The bisection 59 of angle α preferably does not lie in vertical plane 181, but is offset by an angle β . Preferably the tangent 60 of spherical cut 53 lies within about 5 to 50 degrees of vertical plane 181, and most preferably the tangent of spherical cut 53 lies about 38.8 degrees from vertical plane 181. Preferably angle α is within the range of about 90 to 150 degrees, and most preferably angle α is about 121.6 degrees.

Looking to Figure 35A, an alternate embodiment of the present invention is illustrated with an asymmetric narrow edge. A tangent 60A of a spherical cut 53A at a sharp edge 55A defines an angle α_A with a tangent 62A of a second surface 57A, as illustrated in Figure 35A. A bisection 59A of angle α_A preferably does not lie in a vertical plane 181A, but is offset by an angle β_A .

Referring now to Figures 1-4, the procedure to attach and detach the clamp coagulator 120 from the acoustic assembly 80 will be described below. When the physician is ready to use the clamp coagulator 120, the physician simply attaches the clamp coagulator 120 onto the acoustic assembly 80. To attach the clamp coagulator 120 to acoustic assembly 80, the distal end of stud 50 is threadedly connected to the proximal end of the transmission component or ultrasonic waveguide 179. The clamp coagulator 120 is then manually rotated in a

conventional screw-threading direction to interlock the threaded connection between the stud 50 and the ultrasonic waveguide 179.

Once the ultrasonic waveguide 179 is threaded onto the stud 50, a tool, such as, for example, a torque wrench, may be placed over the elongated member 150 of the clamp coagulator 120 to tighten the ultrasonic waveguide 179 to the stud 50. The tool may be configured to engage the wrench flats 169 of the hub 162 of the outer tube 160 in order to tighten the ultrasonic waveguide 179 onto the stud 50. As a result, the rotation of the hub 162 will rotate the elongated member 150 until the ultrasonic waveguide 179 is tightened against the stud 50 at a desired and predetermined torque. It is contemplated that the torque wrench may alternately be manufactured as part of the clamp coagulator 120, or as part of the hand piece housing 20, such as the torque wrench described in U.S. Patent No. 5,776,155 hereby incorporated herein by reference.

15

Once the clamp coagulator 120 is attached to the acoustic assembly 80, the surgeon can rotate the rotational knob 190 to adjust the elongated member 150 at a desired angular position. As the rotational knob 190 is rotated, the teeth 269 of the tubular collar 260 slip over the pawls 286 of the yoke 280 into the adjacent notch or valley. As a result, the surgeon can position the end-effector 180 at a desired orientation. Rotational knob 190 may incorporate an indicator to indicate the rotational relationship between instrument housing 130 and clamp arm 202. As illustrated in Figures 17 and 18, one of the ridges 197 of rotational knob 190 may be used to indicate the rotational position of clamp arm 202 with respect to instrument housing 130 by utilizing, for example, an enlarged ridge 200. It is also contemplated that alternate indications such as the use of coloring, symbols, textures, or the like may also be used on rotational knob 190 to indicate position similarly to the use of enlarged ridge 200.

30

To detach the clamp coagulator 120 from the stud 50 of the acoustic assembly 80, the tool may be slipped over the elongated member 150 of the surgical tool 120 and rotated in the opposite direction, i.e., in a direction to

- 29 -

unthread the ultrasonic waveguide 179 from the stud 50. When the tool is rotated, the hub 162 of the outer tube 160 allows torque to be applied to the ultrasonic waveguide 179 through the pin 163 to allow a relatively high disengaging torque to be applied to rotate the ultrasonic waveguide 179 in the unthreading direction. As
5 a result, the ultrasonic waveguide 179 loosens from the stud 50. Once the ultrasonic waveguide 179 is removed from the stud 50, the entire clamp coagulator 120 may be thrown away.

While preferred embodiments of the present invention have been shown
10 and described herein, it will be obvious to those skilled in the art that such embodiments are provided by way of example only. Numerous variations, changes, and substitutions will now occur to those skilled in the art without departing from the invention. Accordingly, it is intended that the invention be limited only by the spirit and scope of the appended claims.

WHAT IS CLAIMED IS:

1. An ultrasonic clamp coagulator apparatus comprising:
a housing, said housing comprising an actuator;
5 an ultrasonic waveguide positioned within said housing, said ultrasonic
waveguide comprising an end-effector extending distally from said housing,
said end-effector comprising an edge, wherein said edge is defined
by the intersection of a first surface and a second surface, wherein
said first surface is concave and wherein said second surface is not
10 concave;
a clamp arm pivotally mounted on said housing, said clamp arm pivotable with
respect to said end-effector for clamping tissue between said clamp arm and
said end-effector; and
an actuation mechanism within said housing, said actuation mechanism connected
15 between said clamp arm and said actuator, said actuation mechanism adapted to
actuate said clamp arm pivotably with respect to said end-effector.
2. An ultrasonic clamp coagulator apparatus according to claim 1, wherein
said second surface defining said edge is convex.
20
3. An ultrasonic clamp coagulator apparatus according to claim 2, wherein
said end-effector further comprises a third surface opposite said edge, said third
surface adapted to contact said clamp arm.
- 25 4. An ultrasonic clamp coagulator apparatus according to claim 3, wherein
said third surface is convex.

5. An ultrasonic clamp coagulator apparatus comprising:
a housing, said housing comprising an actuator;
an outer tube having a proximal end joined to said housing, and
a distal end, said outer tube defining a longitudinal axis;
5 an actuating element reciprocally positioned within said outer tube, said actuating
element operatively connected to said actuator;
an ultrasonic waveguide positioned within said outer tube, said ultrasonic
waveguide having an end-effector extending distally from said distal end of
said outer tube,
10 said end-effector comprising an edge, wherein said edge is defined
by the intersection of a first surface and a second surface, wherein
said first surface is concave and wherein said second surface is not
concave;
a clamp arm pivotally mounted on said distal end of said outer tube for pivotal
15 movement with respect to said end-effector for clamping tissue between
said clamp arm and said end-effector, said clamp arm operatively connected
to said actuating element so that reciprocal movement of said actuating
element pivots said clamp arm; and
an actuation mechanism within said housing, said actuation mechanism connected
20 between said clamp arm and said actuator, said actuation mechanism
adapted to actuate said clamp arm pivotably with respect to said end-
effector.
6. An ultrasonic clamp coagulator apparatus according to claim 5, wherein
25 said second surface defining said edge is convex.
7. An ultrasonic clamp coagulator apparatus according to claim 6, wherein
said end-effector further comprises a third surface opposite said edge, said third
surface adapted to contact said clamp arm.
30
8. An ultrasonic clamp coagulator apparatus according to claim 7, wherein
said third surface is convex.

9. An ultrasonic clamp coagulator apparatus comprising:
a housing;
an ultrasonic waveguide positioned within said housing, said ultrasonic
5 waveguide having an end-effector extending distally from said housing;
a blade means for cutting tissue and clamping tissue between said blade means and
a clamp arm, wherein said blade means comprises an edge defined by the
intersection of a first surface and a second surface, wherein said first surface is
concave and wherein said second surface is not concave; and
10 an actuator connected to said clamp arm, said actuator adapted to move said clamp
arm with respect to said blade means.

10. An ultrasonic clamp coagulator apparatus comprising:
a housing, said housing comprising an actuator;
15 an outer tube having a proximal end joined to said housing, and
a distal end, said outer tube defining a longitudinal axis;
an actuating element reciprocally positioned within said outer tube, said actuating
element operatively connected to said actuator;
an ultrasonic waveguide positioned within said outer tube, said ultrasonic
20 waveguide having an end-effector extending distally from said distal end of
said outer tube,
wherein said end-effector comprises a broad edge and a narrow
edge, wherein said narrow edge is defined by the intersection of a
first surface and a second surface, wherein said first surface is
25 concave and wherein said second surface is not concave; and
a clamp arm pivotally mounted on said distal end of said outer tube for pivotal
movement with respect to said end-effector for clamping tissue between
said clamp arm and said end-effector, the arc of said pivotal movement of
said clamp arm defining a vertical plane, said clamp arm operatively
30 connected to said actuating element so that reciprocal movement of said
actuating element pivots said clamp arm along said vertical plane.

11. An ultrasonic clamp coagulator apparatus according to claim 10, wherein the tangent of said first concave surface at said narrow edge defines an angle α with said second surface, wherein the bisection of said angle α does not lie in said vertical plane.

5

12. An ultrasonic clamp coagulator apparatus according to claim 11, wherein the tangent of said first concave surface at said narrow edge lies within about 5 to 50 degrees of said vertical plane.

10 13. An ultrasonic clamp coagulator apparatus according to claim 12, wherein the tangent of said first concave surface at said narrow edge lies about 38.8 degrees from said vertical plane.

14. An ultrasonic clamp coagulator apparatus according to claim 12, wherein
15 said second surface defining said narrow edge is convex.

15. An ultrasonic clamp coagulator apparatus according to claim 14, wherein said angle α is within the range of about 90 to about 150 degrees.

20 16. An ultrasonic clamp coagulator apparatus according to claim 15, wherein said angle α is about 121.6 degrees.

17. An ultrasonic clamp coagulator apparatus according to claim 16, wherein the tangent of said first concave surface at said narrow edge lies about 38.8
25 degrees from said vertical plane.

18. An ultrasonic blade comprising:
a broad edge and a narrow edge, said broad edge opposing said narrow edge along a vertical plane, wherein said narrow edge is defined by the intersection of a first
30 surface and a second surface, wherein said first surface is concave and wherein said second surface is not concave.

19. An ultrasonic blade according to claim 18, wherein the tangent of said first concave surface at said narrow edge defines an angle α with the tangent of said second surface, wherein the bisection of said angle α intersects said vertical plane.
- 5 20. An ultrasonic blade according to claim 19, wherein the tangent of said first concave surface at said narrow edge lies within about 5 to 50 degrees of said vertical plane.
21. An ultrasonic blade according to claim 20, wherein the tangent of said first
10 concave surface at said narrow edge lies about 38.8 degrees from said vertical plane.
22. An ultrasonic blade according to claim 20, wherein said second surface defining said narrow edge is convex.
- 15 23. An ultrasonic blade according to claim 22, wherein said angle α is within the range of about 90 to 150 degrees.
24. An ultrasonic blade according to claim 23, wherein said angle α is about
20 121.6 degrees.
25. An ultrasonic blade comprising:
a broad edge and a narrow edge, said broad edge opposing said narrow edge along a vertical plane, wherein said narrow edge is defined by the intersection of a first
25 surface and a second surface, wherein said first surface is concave and wherein said second surface is concave and wherein the tangent of said first concave surface at said narrow edge defines an angle α with the tangent of said second concave surface, wherein the bisection of said angle α intersects said vertical plane.

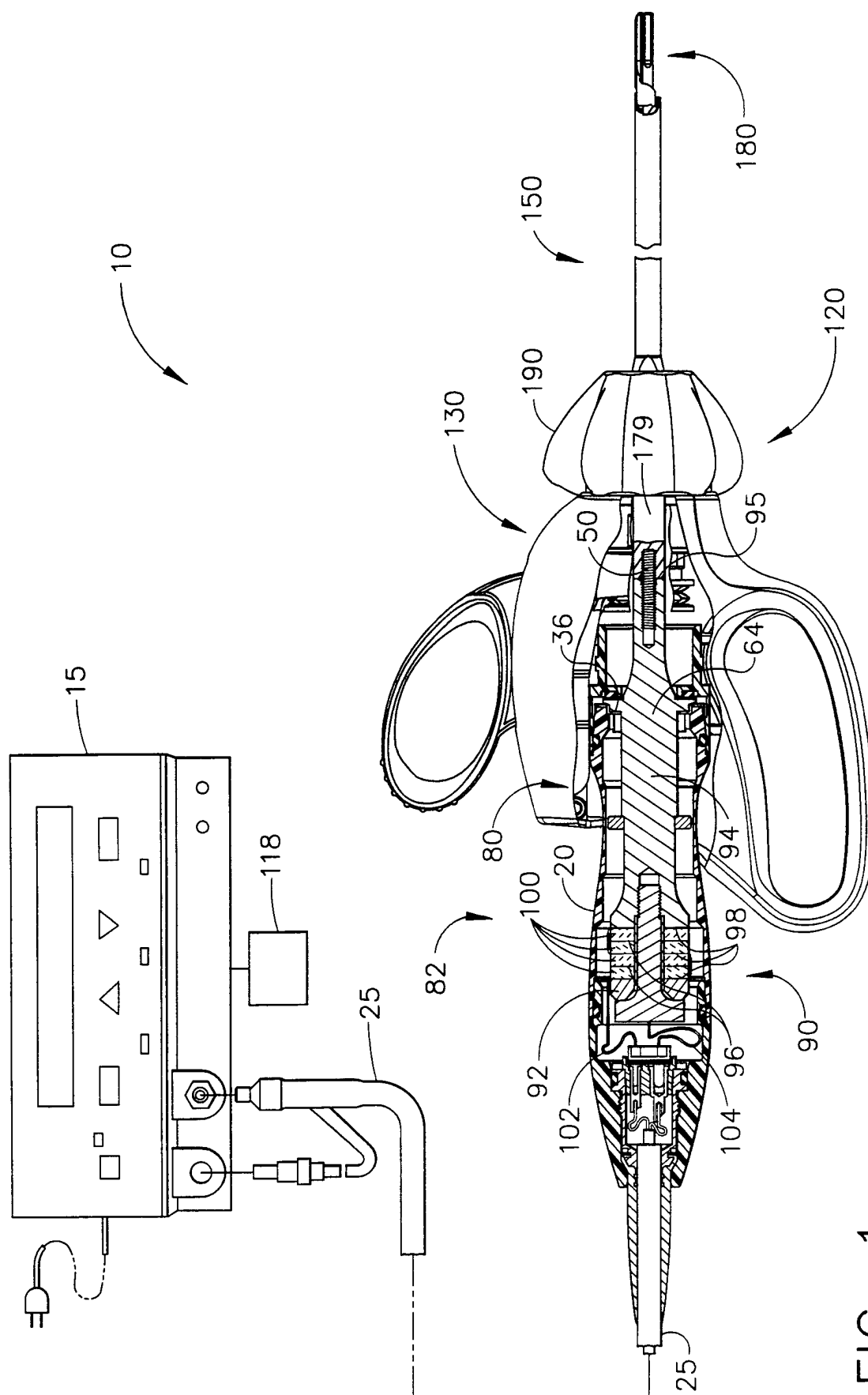
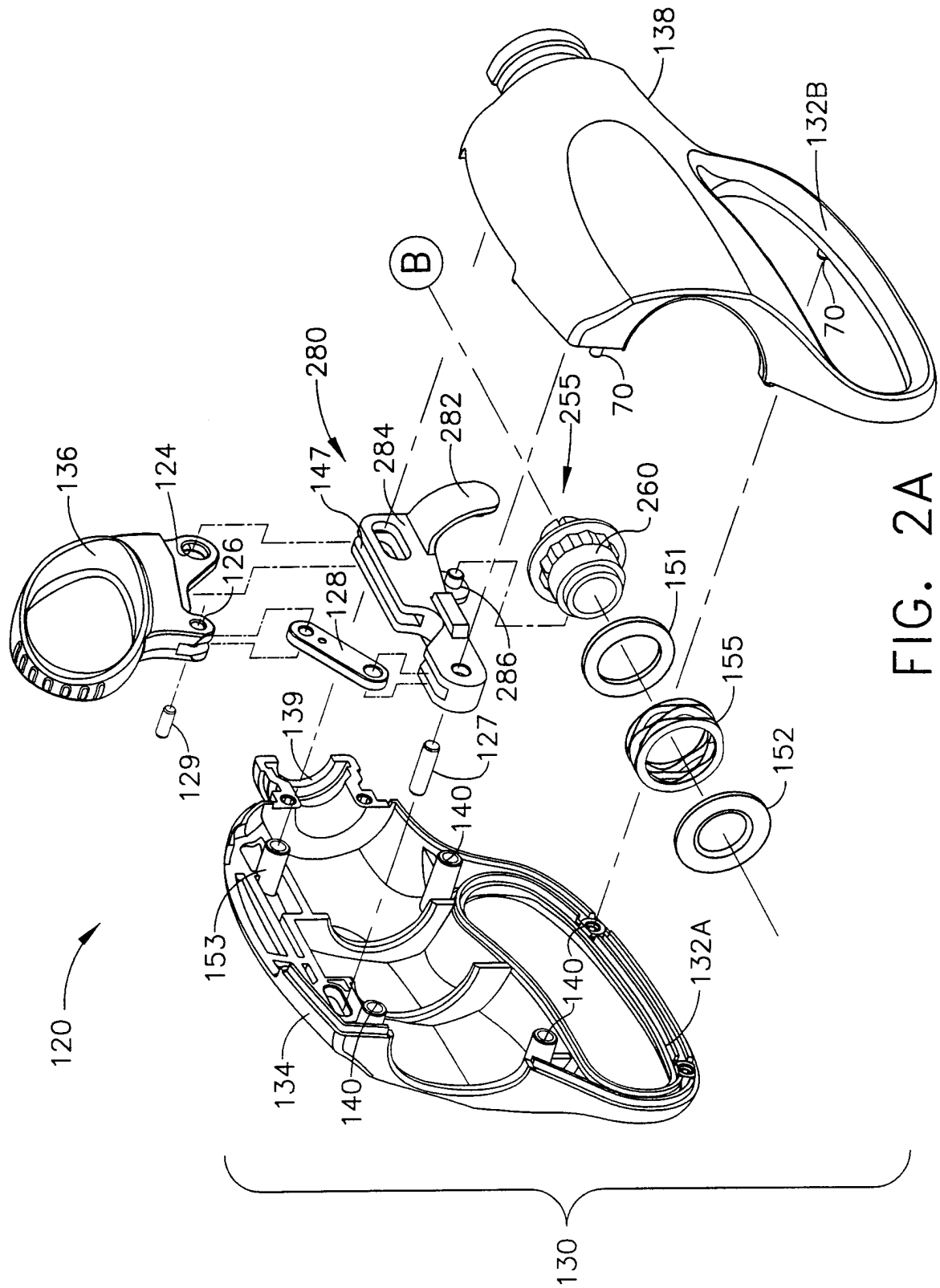

FIG. 1



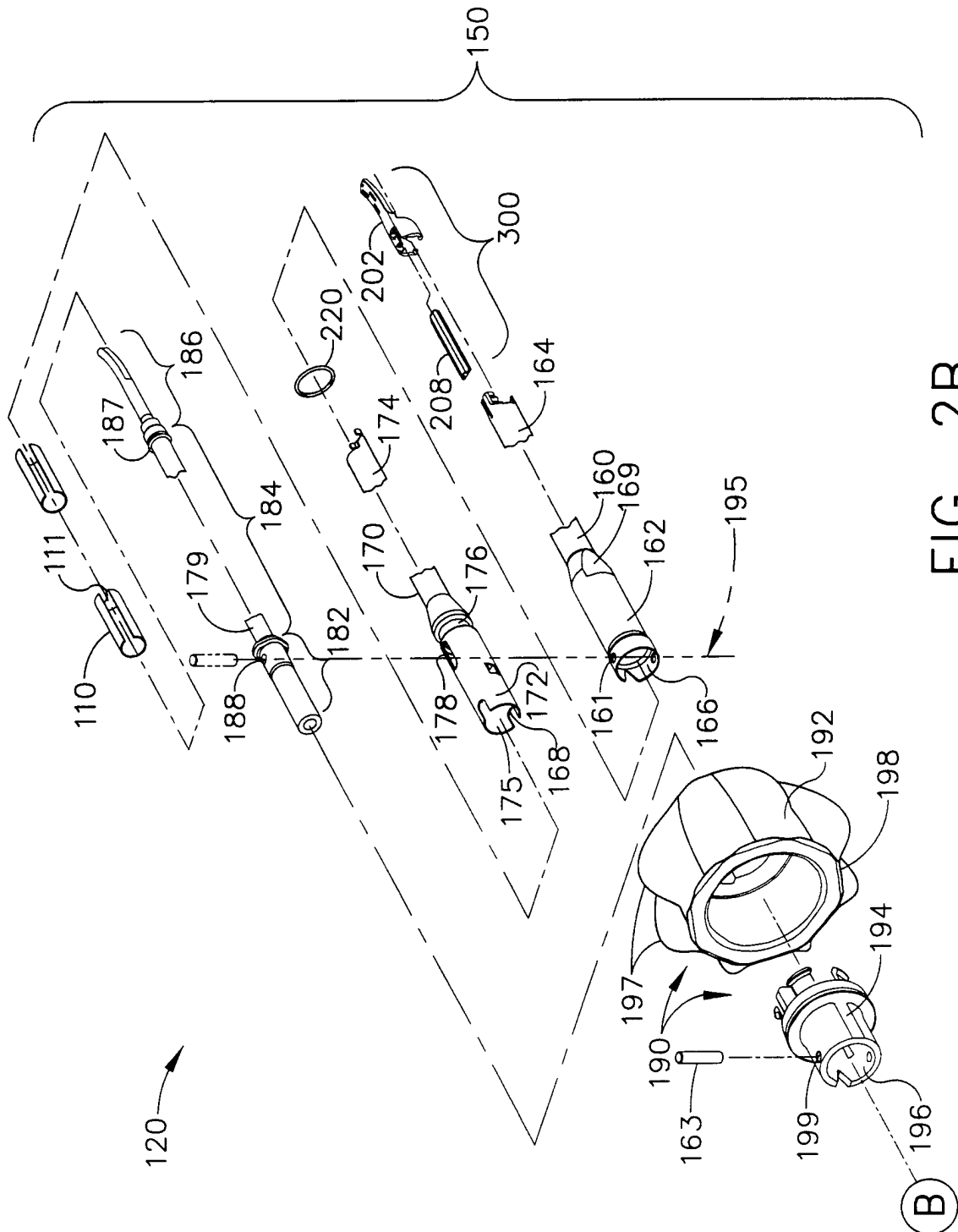
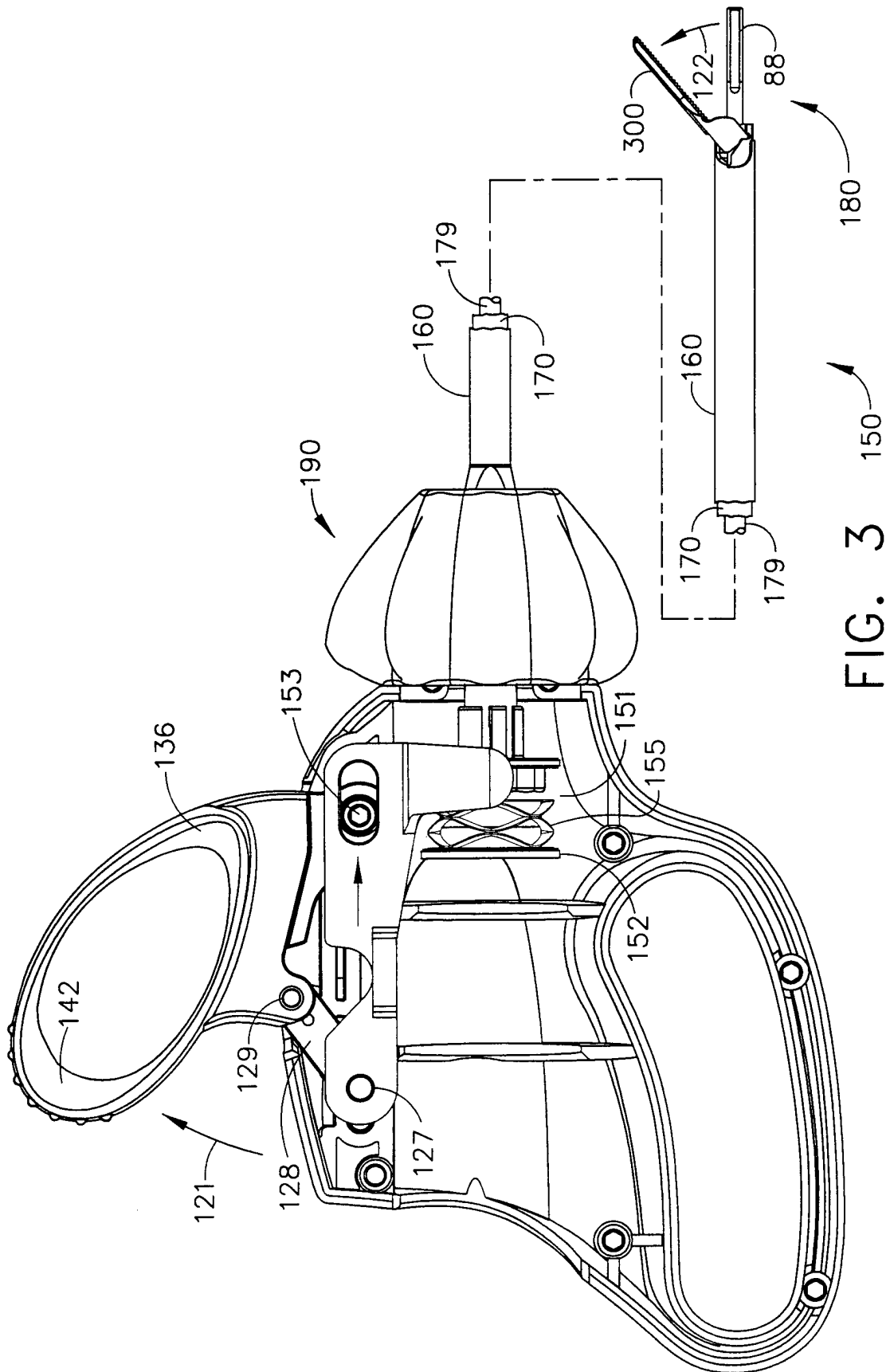
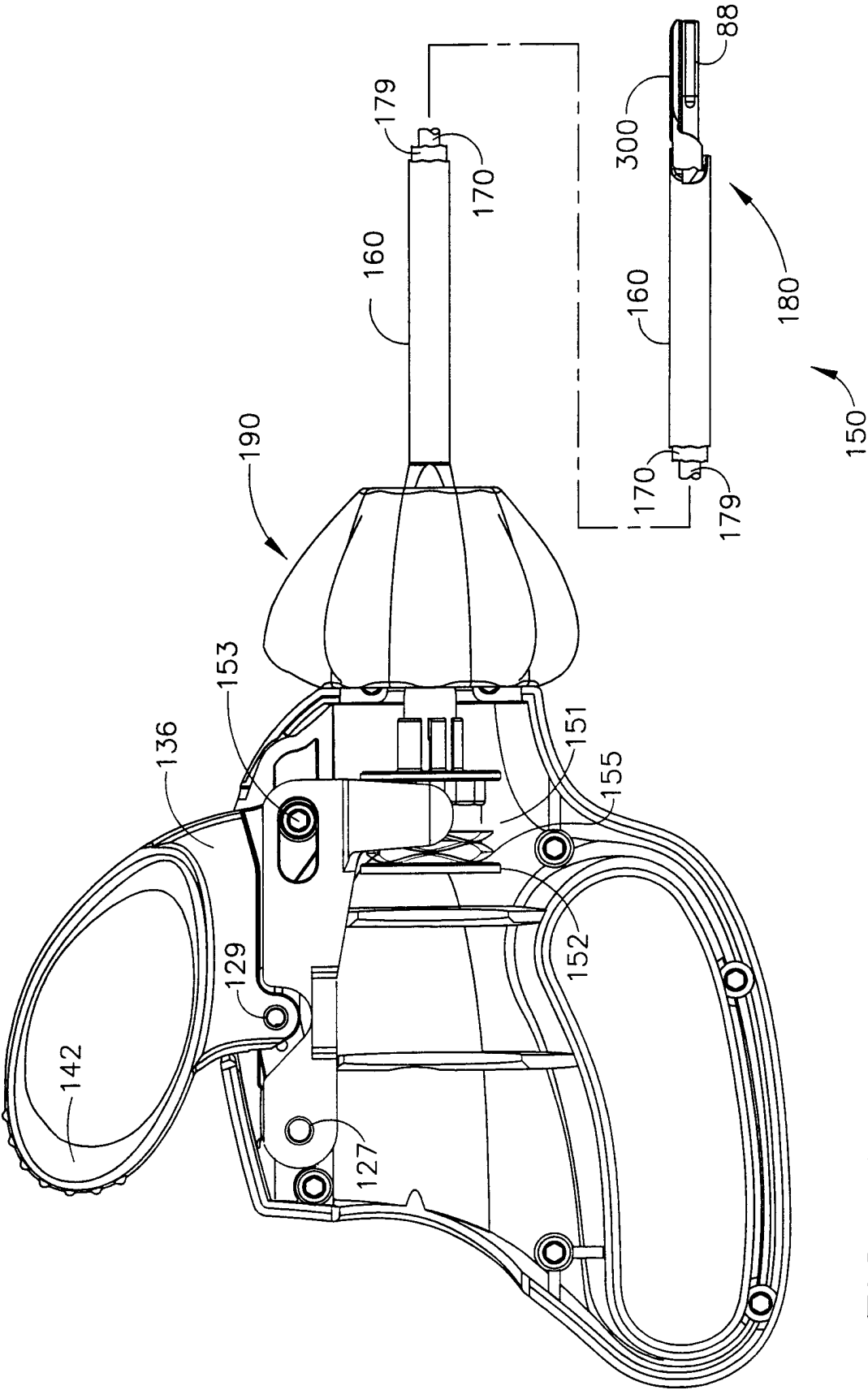

FIG. 2B





6/17

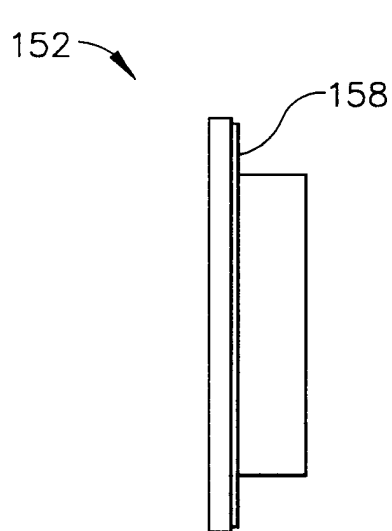

FIG. 5

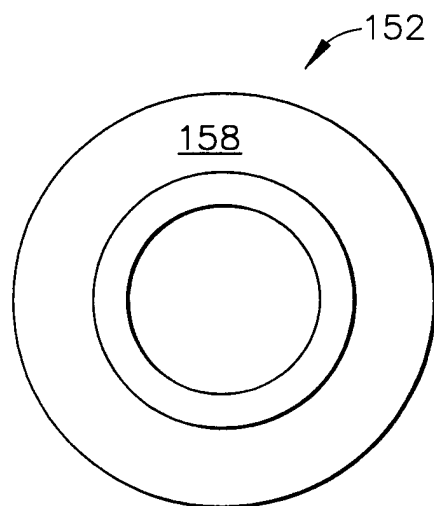

FIG. 6

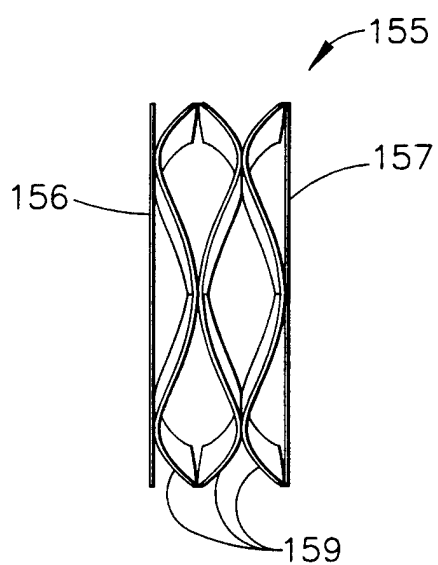

FIG. 7

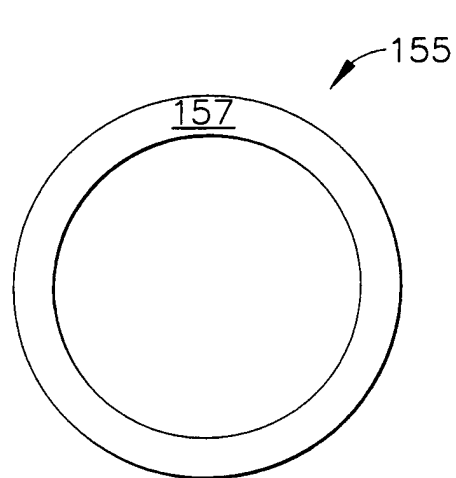

FIG. 8

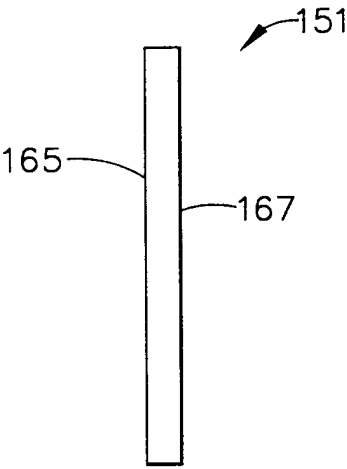

FIG. 9

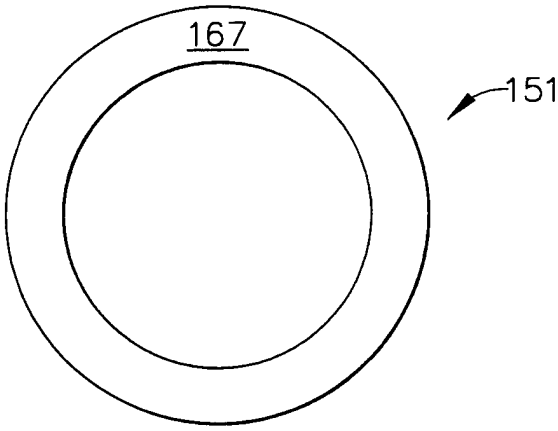

FIG. 10

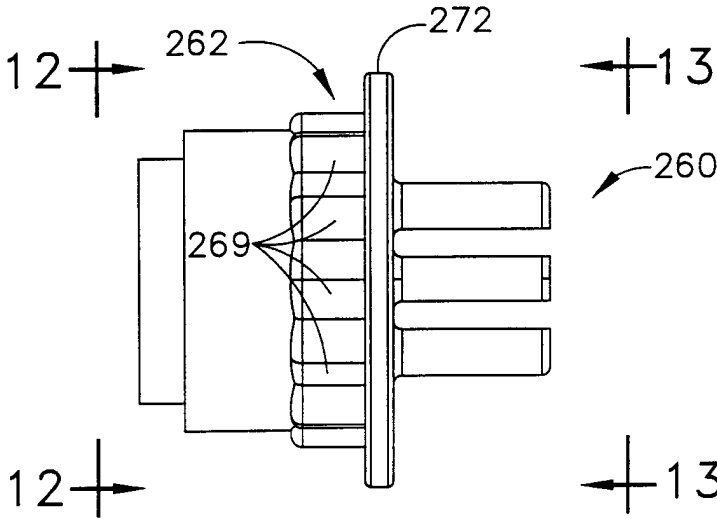

FIG. 11

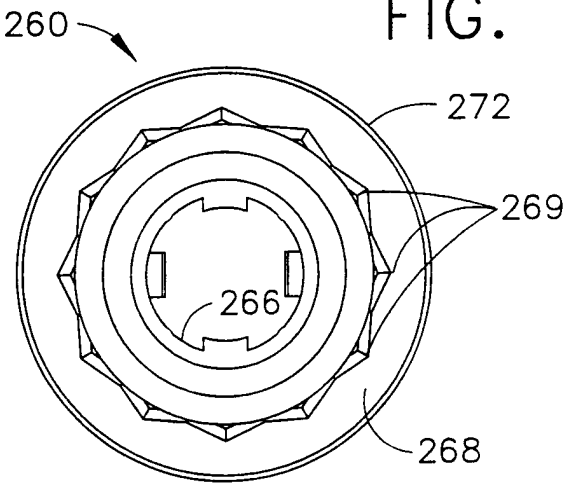

FIG. 12

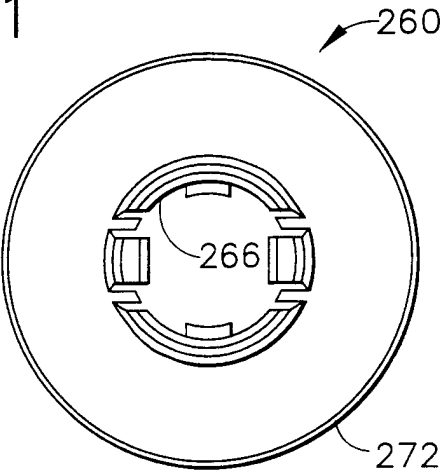

FIG. 13

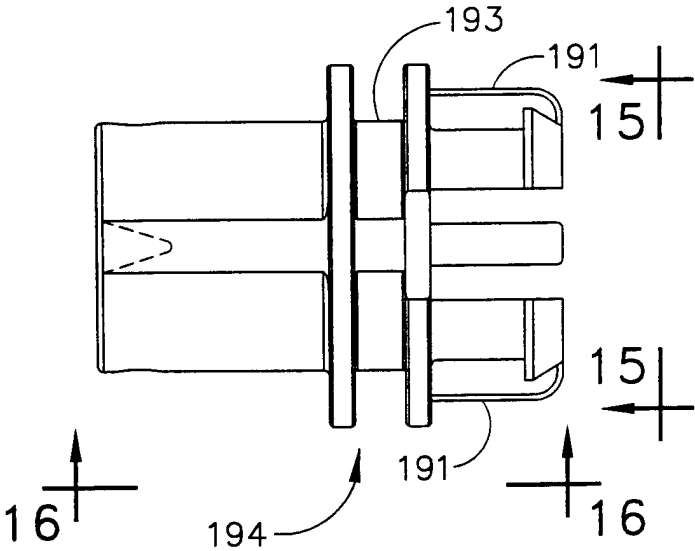

FIG. 14

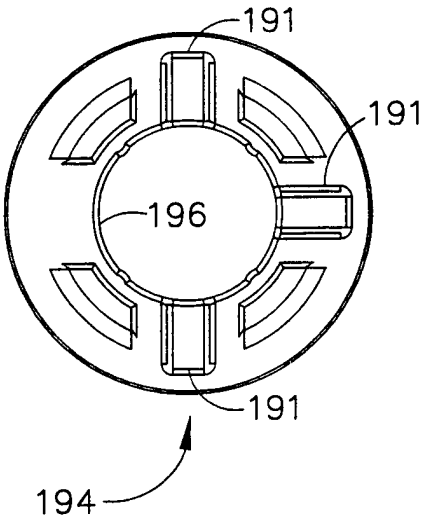

FIG. 15

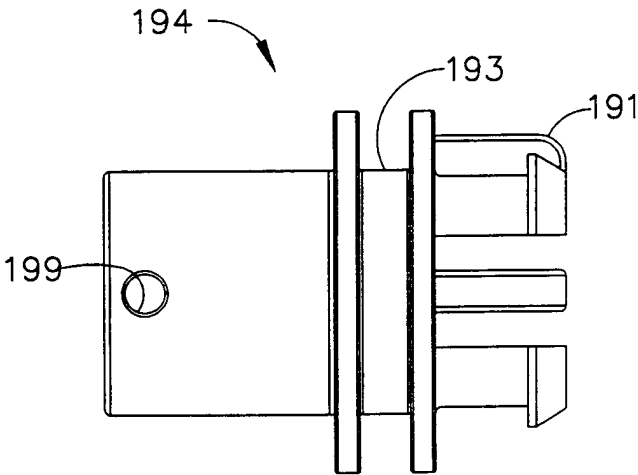

FIG. 16

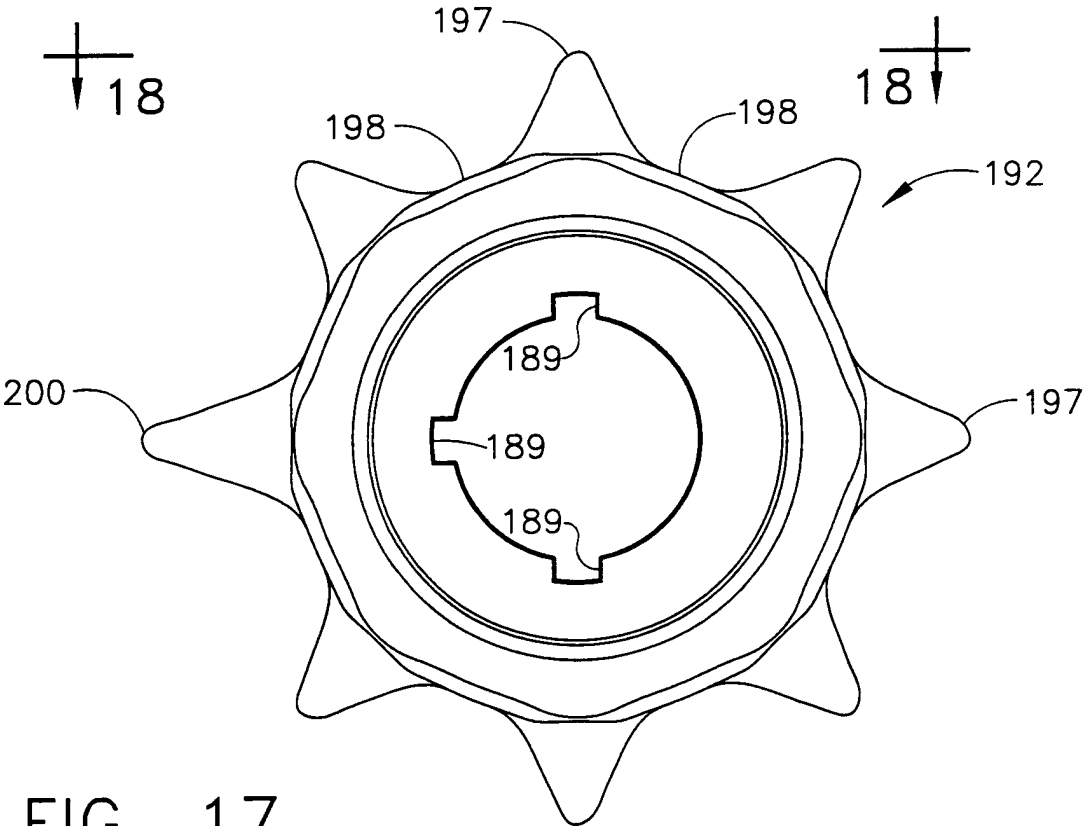

FIG. 17

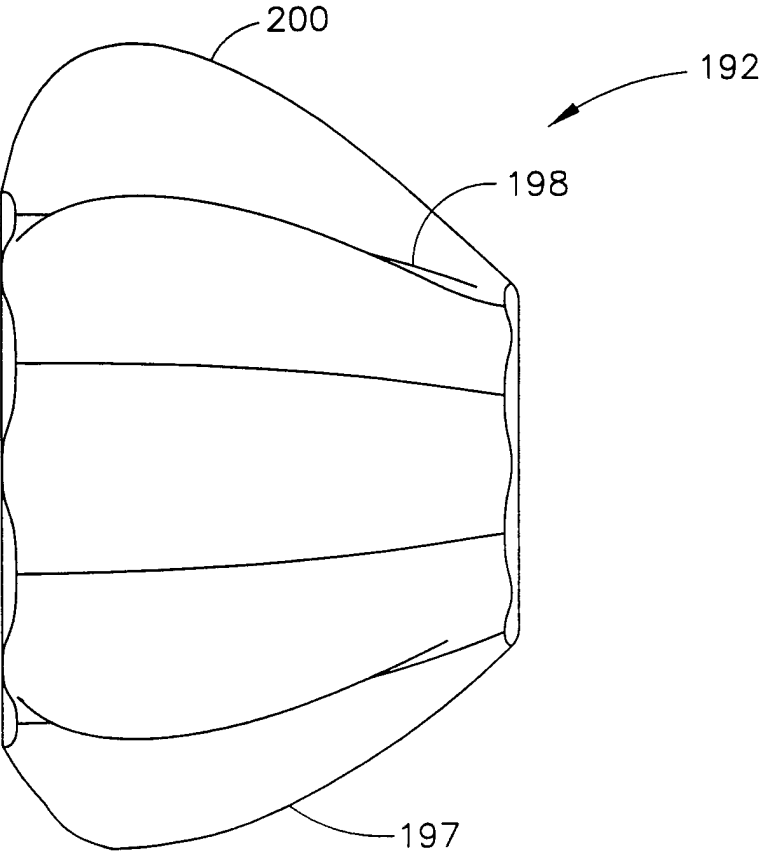

FIG. 18

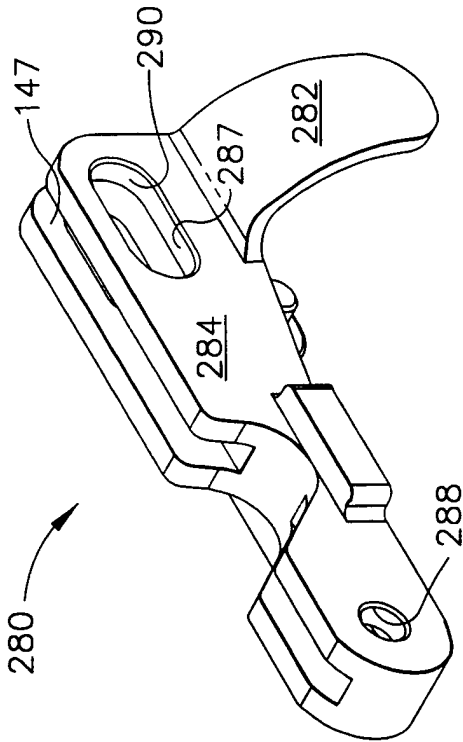

FIG. 19

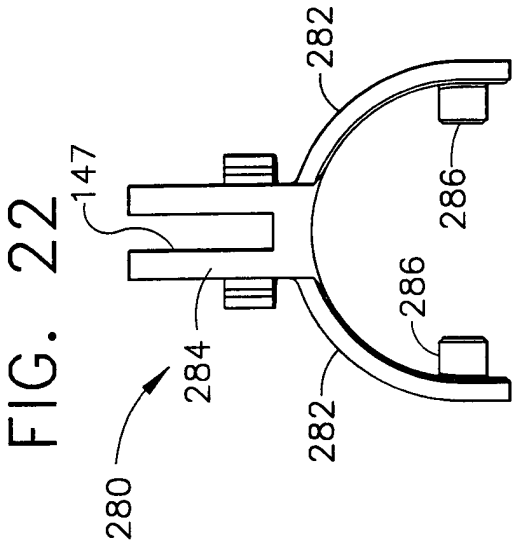

FIG. 20

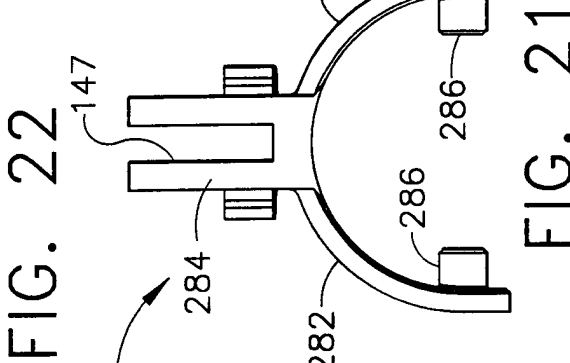

FIG. 21

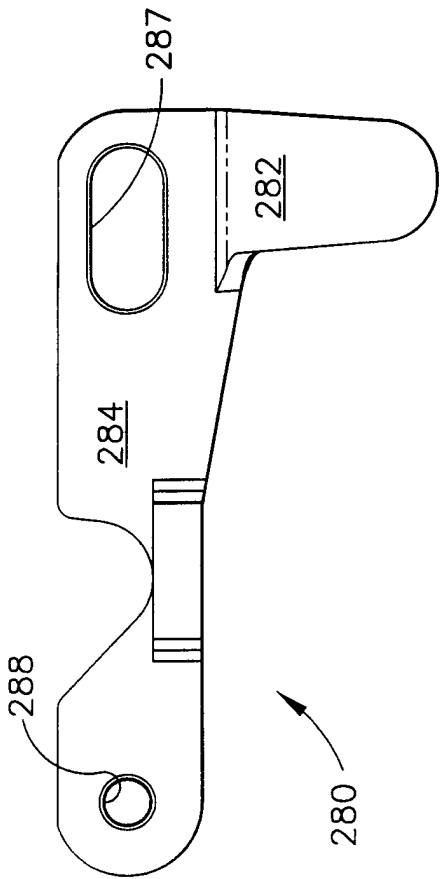

FIG. 22

11/17

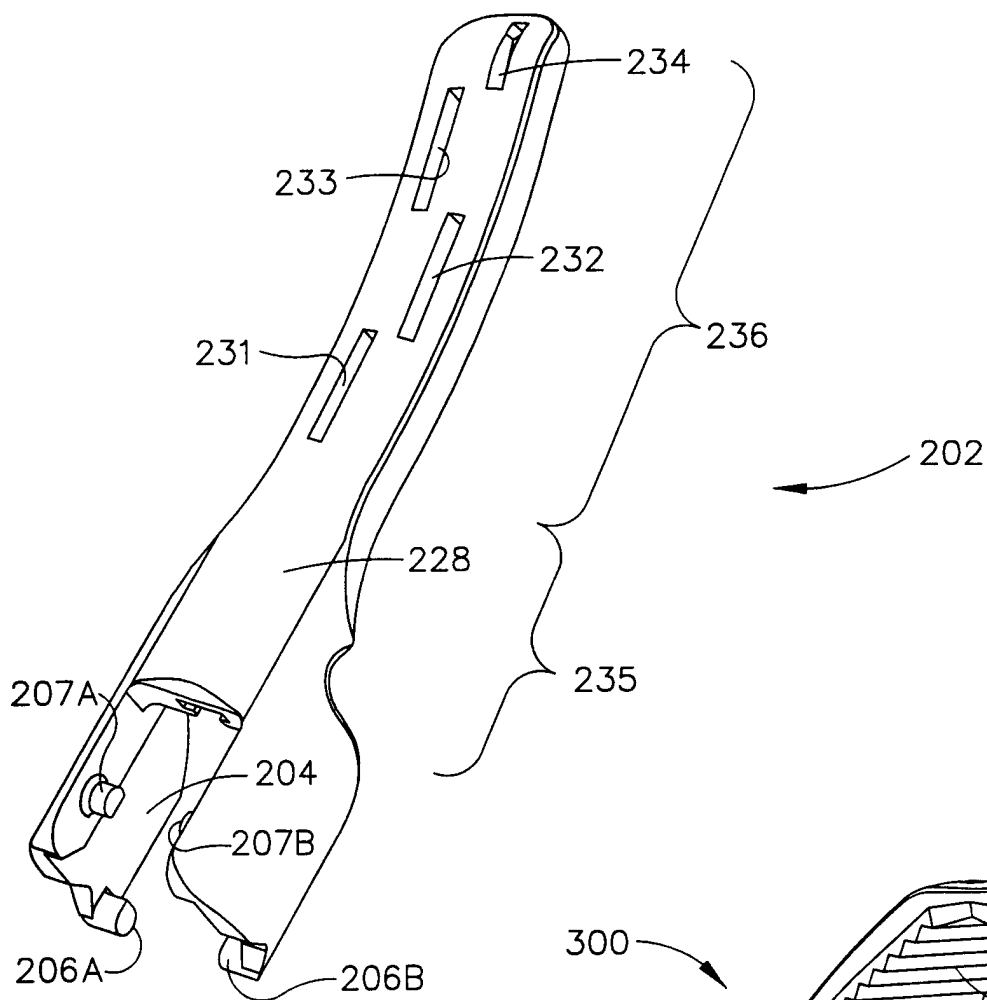

FIG. 24

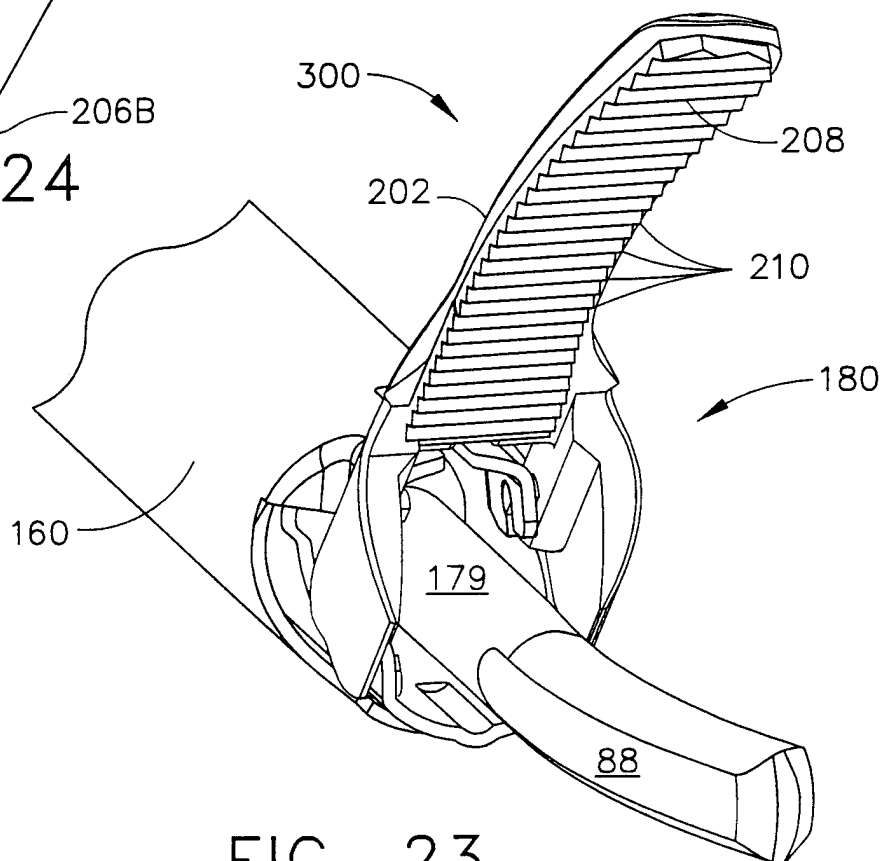

FIG. 23

12/17

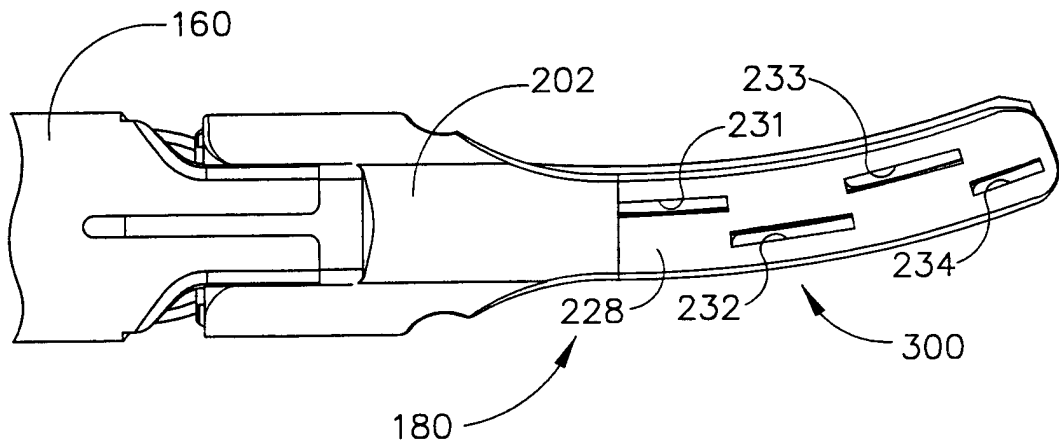

FIG. 25

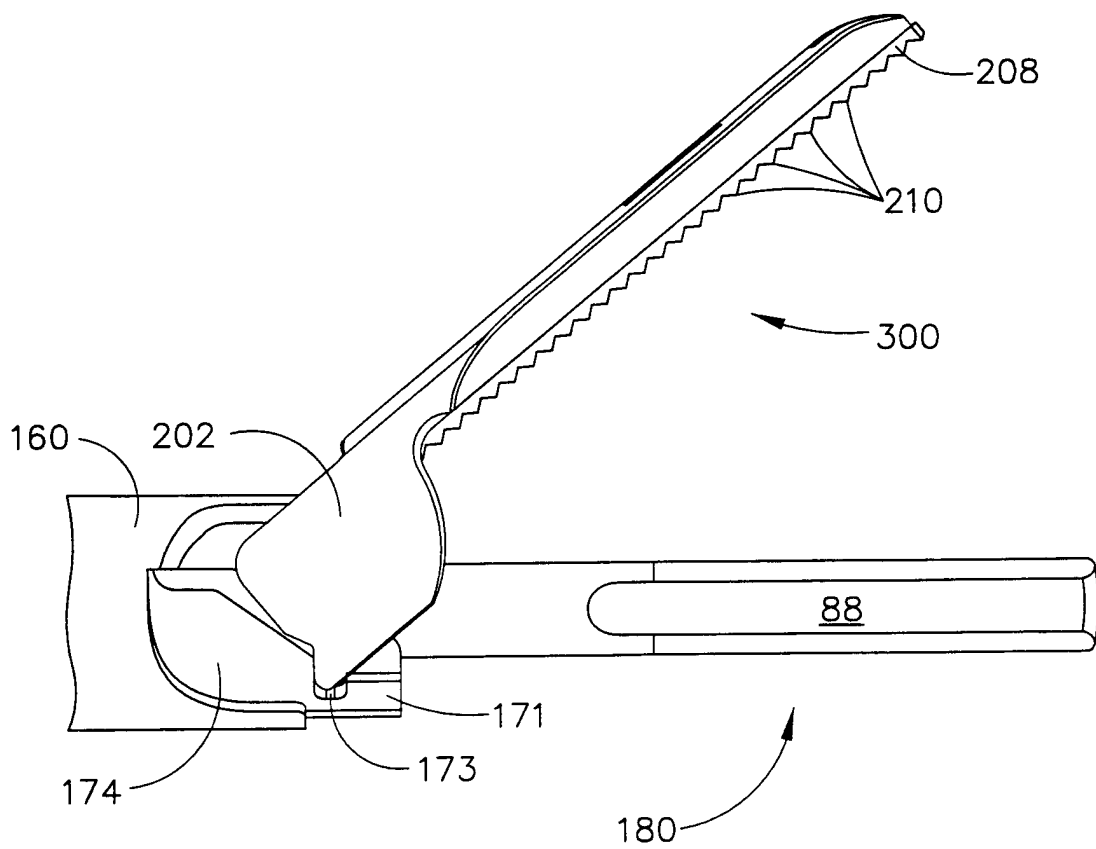

FIG. 26

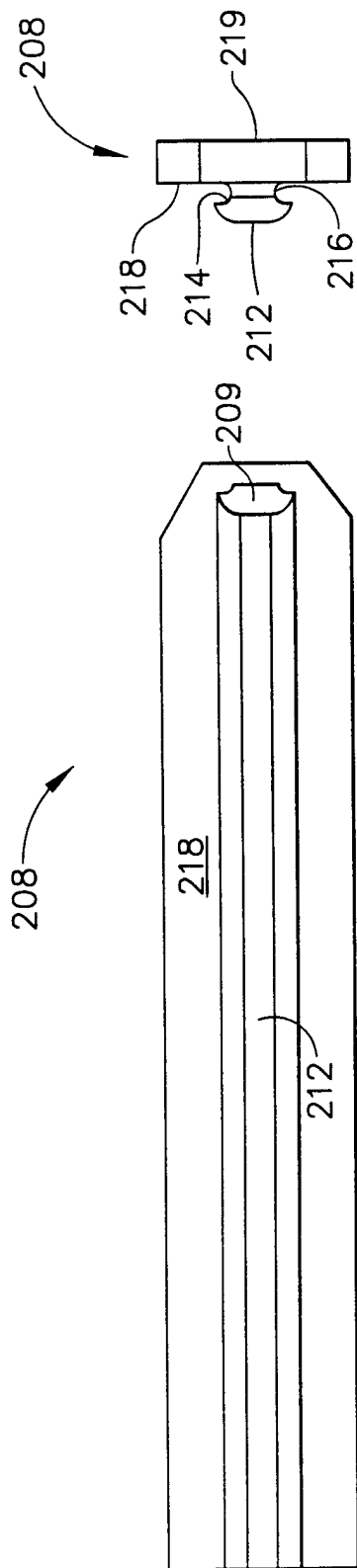

FIG. 29

FIG. 27

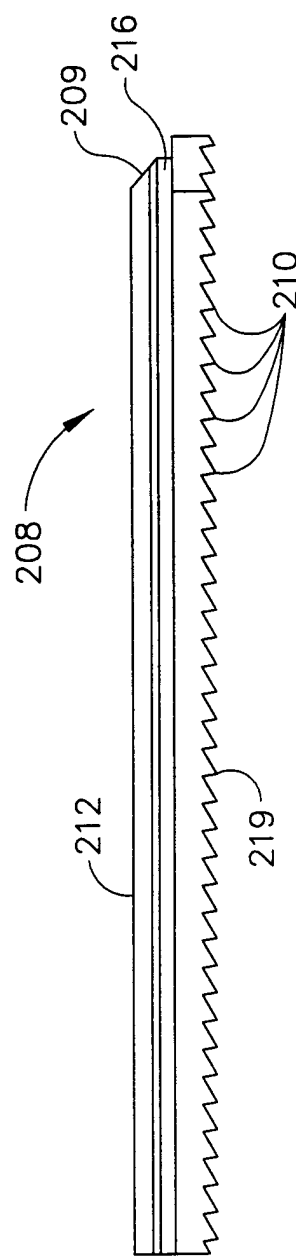

FIG. 28

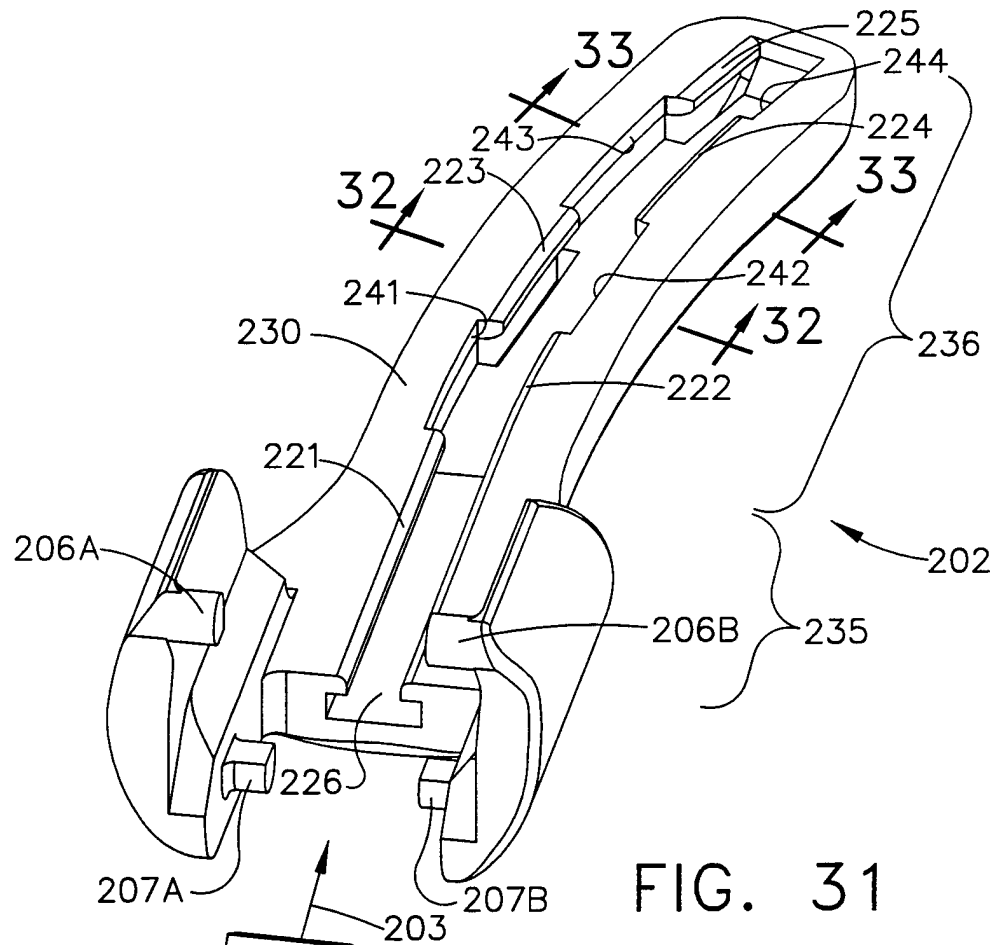

FIG. 31

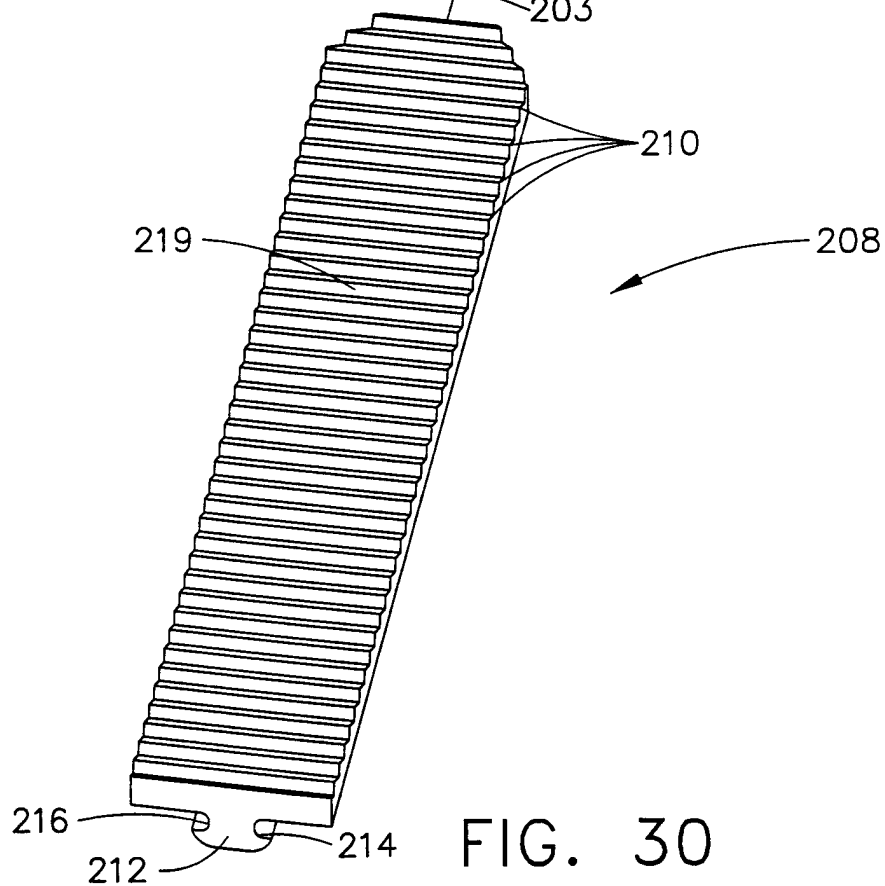

FIG. 30

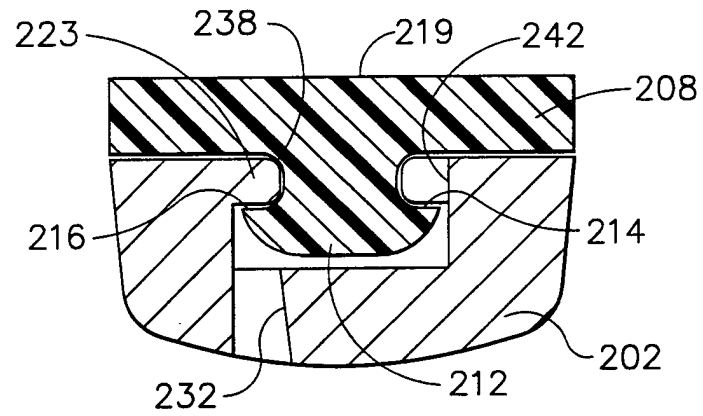

FIG. 32

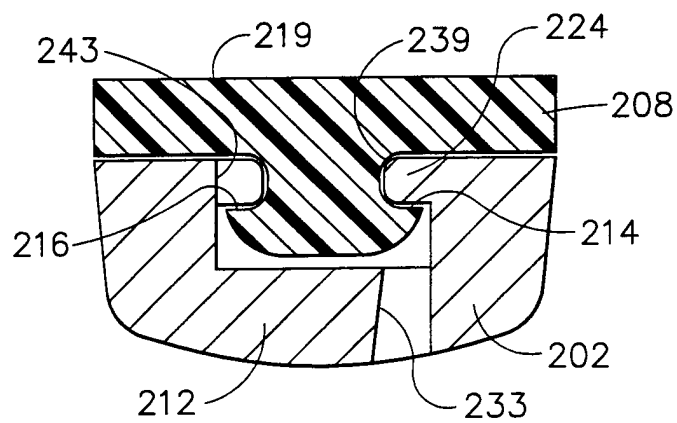

FIG. 33

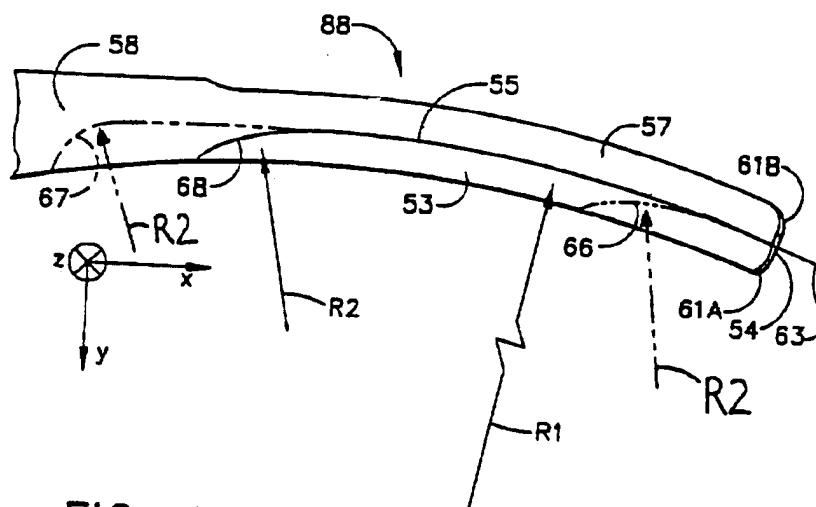

FIG. 34

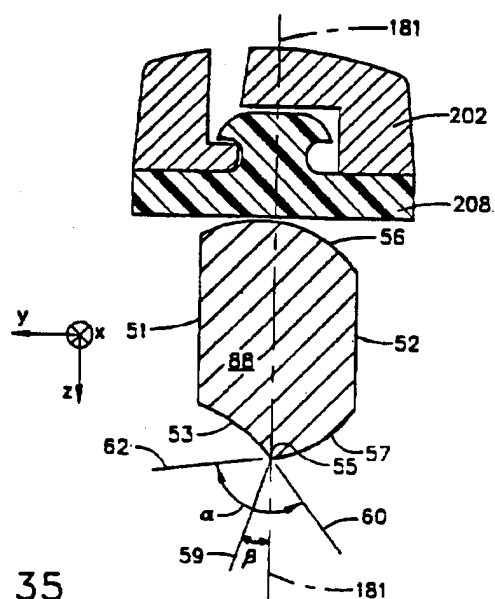

FIG. 35

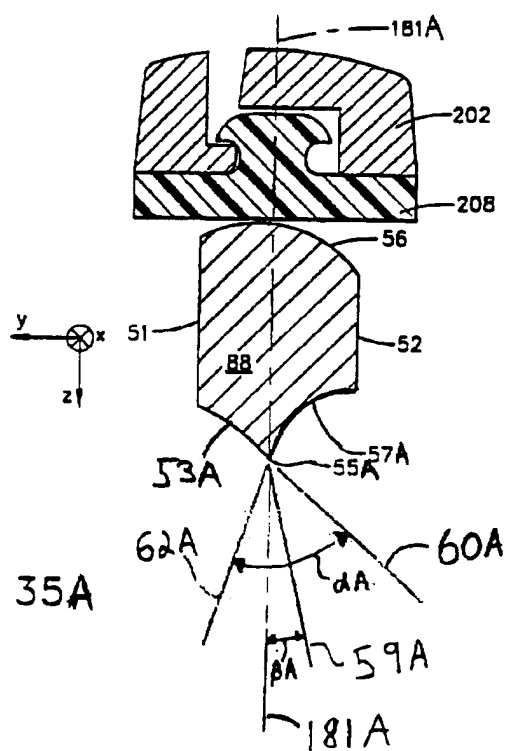

FIG. 35A

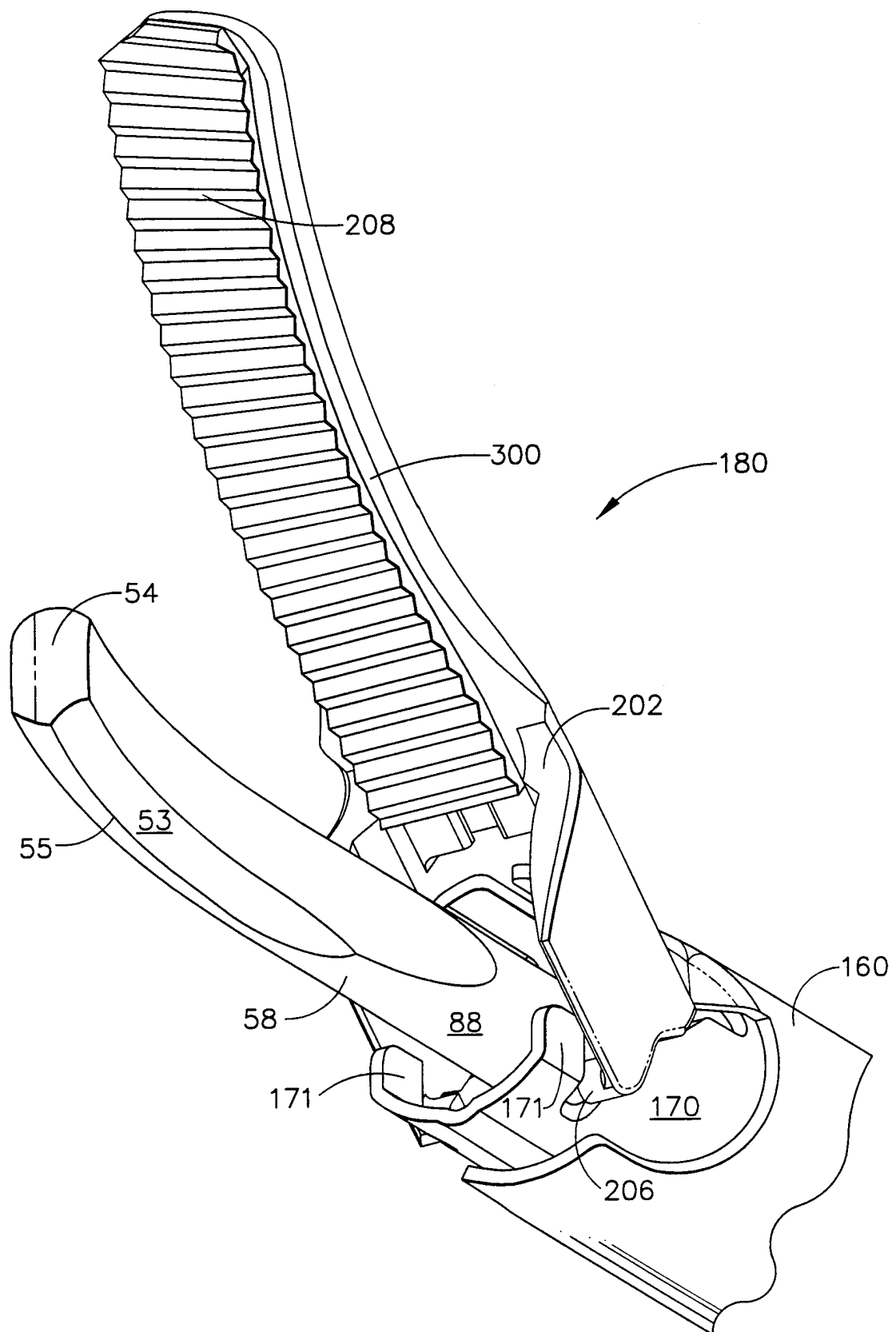

FIG. 36

INTERNATIONAL SEARCH REPORT

International application No.
PCT/US00/24656

A. CLASSIFICATION OF SUBJECT MATTER

IPC(7) :A61B 17/32

US CL :606/169

According to International Patent Classification (IPC) or to both national classification and IPC

B. FIELDS SEARCHED

Minimum documentation searched (classification system followed by classification symbols)

U.S. : 30/346.55, 357; 606/166, 167, 169

Documentation searched other than minimum documentation to the extent that such documents are included in the fields searched

Electronic data base consulted during the international search (name of data base and, where practicable, search terms used)

C. DOCUMENTS CONSIDERED TO BE RELEVANT

Category*	Citation of document, with indication, where appropriate, of the relevant passages	Relevant to claim No.
Y	US 5,322,055 A (DAVISON et al.) 21 June 1994, Fig. 8g'.	1-14
X	US 3,433,226 A (BOYD) 18 March 1969, Fig. 2.	18-22
Y	US 5,188,102 A (IDEMOTO et al.) 23 February 1993, Figs. 17A and 17B.	25



Further documents are listed in the continuation of Box C.



See patent family annex.

* Special categories of cited documents:	"T" later document published after the international filing date or priority date and not in conflict with the application but cited to understand the principle or theory underlying the invention
"A" document defining the general state of the art which is not considered to be of particular relevance	"X" document of particular relevance; the claimed invention cannot be considered novel or cannot be considered to involve an inventive step when the document is taken alone
"E" earlier document published on or after the international filing date	"Y" document of particular relevance; the claimed invention cannot be considered to involve an inventive step when the document is combined with one or more other such documents, such combination being obvious to a person skilled in the art
"L" document which may throw doubts on priority claim(s) or which is cited to establish the publication date of another citation or other special reason (as specified)	"&" document member of the same patent family
"O" document referring to an oral disclosure, use, exhibition or other means	
"P" document published prior to the international filing date but later than the priority date claimed	

Date of the actual completion of the international search

12 OCTOBER 2000

Date of mailing of the international search report

28 NOV 2000

Name and mailing address of the ISA/US
Commissioner of Patents and Trademarks
Box PCT
Washington, D.C. 20231

Facsimile No. (703) 305-3230

Authorized officer

MICHAEL THALER

Telephone No. (703) 308-2981

专利名称(译)	多功能弯曲刀片，用于超声波手术器械		
公开(公告)号	EP1223869A1	公开(公告)日	2002-07-24
申请号	EP2000960037	申请日	2000-09-08
[标]申请(专利权)人(译)	伊西康内外科公司		
申请(专利权)人(译)	爱惜康内镜手术，INC.		
当前申请(专利权)人(译)	爱惜康内镜手术，INC.		
[标]发明人	MESSERLY JEFFREY D		
发明人	MESSERLY, JEFFREY, D.		
IPC分类号	A61B17/3211 A61B17/32 A61B18/00		
CPC分类号	A61B17/320092 A61B2017/320093 A61B2017/320094 A61B2017/320095		
代理机构(译)	FISHER，ADRIAN JOHN		
优先权	09/413225 1999-10-05 US		
其他公开文献	EP1223869B1 EP1223869A4		
外部链接	Espacenet		

摘要(译)

本发明一般涉及超声外科夹持器械，更具体地说，涉及一种用于超声外科夹持器械（120）的多功能弯曲剪刀片。公开了一种超声外科手术器械，其结合了末端执行器几何形状以最好地影响剪切型构造的多种功能。刀片的形状的特征在于半径切割以形成弯曲的且可能锥形的几何形状。该切口形成包括凹表面（53）和凸表面（57）的弯曲表面。凸面过渡成短而直的平台表面。该直线部分的长度部分地影响由弯曲形状引起的横向运动的声学平衡。相对于直刀片尖端，本设计的尖端曲率提供了横切部位的改善的可见性并改善了对目标组织的接近。