



(12) **EUROPEAN PATENT APPLICATION**

(43) Date of publication:
18.05.2011 Bulletin 2011/20

(51) Int Cl.:
A61B 17/32 (2006.01)

(21) Application number: **10178865.1**

(22) Date of filing: **08.09.2000**

(84) Designated Contracting States:
DE ES FR GB IT

(72) Inventor: **Messerly, Jeffrey D.**
Cincinnati, OH 45209 (US)

(30) Priority: **05.10.1999 US 412257**

(74) Representative: **Fisher, Adrian John**
Carpmaels & Ransford
One Southampton Row
London
WC1B 5HA (GB)

(62) Document number(s) of the earlier application(s) in accordance with Art. 76 EPC:
07075628.3 / 1 839 598
00961666.5 / 1 223 870

(71) Applicant: **ETHICON ENDO-SURGERY, INC.**
Cincinnati, OH 45242-2839 (US)

Remarks:

This application was filed on 23-09-2010 as a divisional application to the application mentioned under INID code 62.

(54) **Blades with functional balance asymmetries for use with ultrasonic surgical instruments**

(57) Disclosed is an ultrasonic surgical instrument that combines end-effector geometry to best effect the multiple functions of a shears-type configuration. The shape of the blade is characterized by a radiused cut offset by some distance to form a curved geometry. The cut creates a curved surface with multiple asymmetries causing multiple imbalances within the blade. Imbalance due to the curve of the instrument is corrected by a non-functional asymmetry proximal to the functional asymmetry. Imbalance due to the asymmetric cross-section

of the blade is corrected by the appropriate selection of the volume and location of material removed from a functional asymmetry. The shape of the blade in one embodiment of the present invention is characterized by two radiused cuts offset by some distance to form a curved and potentially tapered geometry. These two cuts create curved surfaces including a concave surface and a convex surface. The length of the radiused cuts affects, in part, the acoustic balancing of the transverse motion induced by the curved shape.

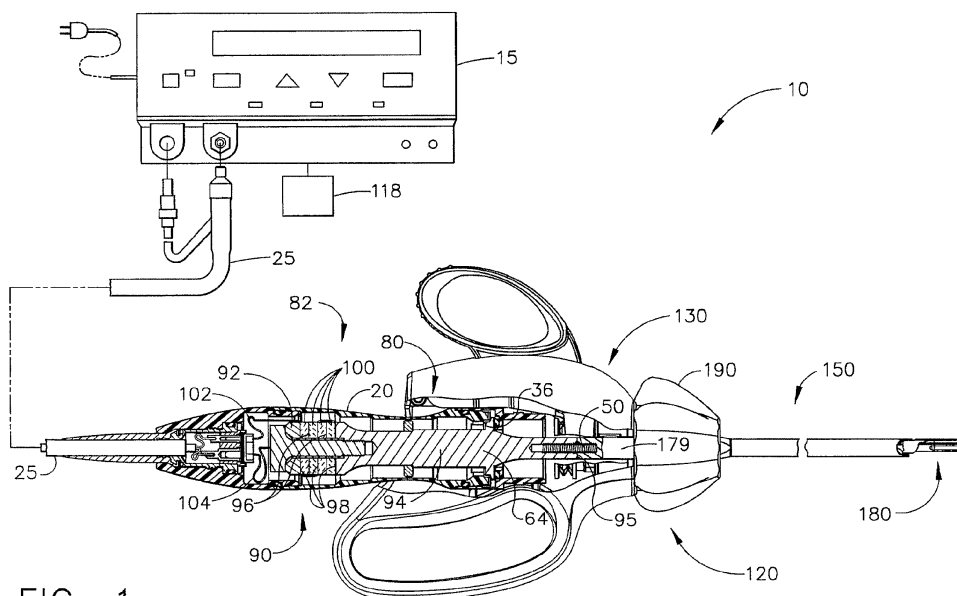

FIG. 1

DescriptionField of the Invention

[0001] The present invention relates, in general, to ultrasonic surgical instruments and, more particularly, to multifunctional curved blades with functional asymmetries for use with ultrasonic surgical instruments to minimize undesirable motion.

Background of the Invention

[0002] This application is related to the following copending patent applications: Application Serial No. 08/948,625 filed October 10, 1997; Application Serial No. 08/949,133 filed October 10, 1997; Application Serial No. 09/106,686 filed June 29, 1998; Application Serial No. 09/337,077 filed June 21, 1999; Application Serial No. 09/412,557; Application Serial No. 09/412,996; and Application Serial No. 09/-413-225 which are hereby incorporated herein by reference.

[0003] Ultrasonic instruments, including both hollow core and solid core instruments, are used for the safe and effective treatment of many medical conditions. Ultrasonic instruments, and particularly solid core ultrasonic instruments, are advantageous because they may be used to cut and/or coagulate organic tissue using energy in the form of mechanical vibrations transmitted to a surgical end-effector at ultrasonic frequencies. Ultrasonic vibrations, when transmitted to organic tissue at suitable energy levels and using a suitable end-effector, may be used to cut, dissect, or cauterize tissue. Ultrasonic instruments utilizing solid core technology are particularly advantageous because of the amount of ultrasonic energy that may be transmitted from the ultrasonic transducer through the waveguide to the surgical end-effector. Such instruments are particularly suited for use in minimally invasive procedures, such as endoscopic or laparoscopic procedures, wherein the end-effector is passed through a trocar to reach the surgical site.

[0004] Ultrasonic vibration is induced in the surgical end-effector by, for example, electrically exciting a transducer which may be constructed of one or more piezoelectric or magnetostrictive elements in the instrument hand piece. Vibrations generated by the transducer section are transmitted to the surgical end-effector via an ultrasonic waveguide extending from the transducer section to the surgical end-effector. The waveguides and end-effectors are designed to resonate at the same frequency as the transducer. Therefore, when an end-effector is attached to a transducer the overall system frequency is still the same frequency as the transducer itself.

[0005] The amplitude of the longitudinal ultrasonic vibration at the tip, d , behaves as a simple sinusoid at the resonant frequency as given by:

$$d = A \sin(\omega t) \text{ (equation 1)}$$

where:

ω = the radian frequency which equals 2π times the cyclic frequency, f ; and

A = the zero-to-peak amplitude.

The longitudinal excursion is defined as the peak-to-peak (p-t-p) amplitude, which is just twice the amplitude of the sine wave or $2A$.

[0006] Solid core ultrasonic surgical instruments may be divided into two types, single element end-effector devices and multiple-element end-effector. Single element end-effector devices include instruments such as scalpels, and ball coagulators, see, for example, U.S. Patent No. 5,263,957. While such instruments as disclosed in U.S. Patent No. 5,263,957 have been found eminently satisfactory, there are limitations with respect to their use, as well as the use of other ultrasonic surgical instruments. For example, single-element end-effector instruments have limited ability to apply blade-to-tissue pressure when the tissue is soft and loosely supported. Substantial pressure is necessary to effectively couple ultrasonic energy to the tissue. This inability to grasp the tissue results in a further inability to fully coapt tissue surfaces while applying ultrasonic energy, leading to less-than-desired hemostasis and tissue joining.

[0007] The use of multiple-element end-effectors such as clamping coagulators include a mechanism to press tissue against an ultrasonic blade, that can overcome these deficiencies. A clamp mechanism disclosed as useful in an ultrasonic surgical device has been described in U.S. Pat. Nos. 3,636,943 and 3,862,630 to Balamuth. Generally, however, the Balamuth device, as disclosed in those patents, does not coagulate and cut sufficiently fast, and lacks versatility in that it cannot be used to cut/coagulate without the clamp because access to the blade is blocked by the clamp.

[0008] Ultrasonic clamp coagulators such as, for example, those disclosed in U.S. Patents No. 5,322,055 and 5,893,835 provide an improved ultrasonic surgical instrument for cutting/coagulating tissue, particularly loose and unsupported

tissue, wherein the ultrasonic blade is employed in conjunction with a clamp for applying a compressive or biasing force to the tissue, whereby faster coagulation and cutting of the tissue, with less attenuation of blade motion, are achieved.

[0009] Improvements in technology of curved ultrasonic instruments such as described in U.S. Patent Application Serial No. 09/106,686 previously incorporated herein by reference, have created needs for improvements in other aspects of curved clamp coagulators. For example, U.S. Patent No. 5,873,873 describes an ultrasonic clamp coagulating instrument having an end-effector including a clamp arm comprising a tissue pad. In the configuration shown in U.S. Patent No. 5,873,873 the clamp arm and tissue pad are straight.

[0010] The shape of an ultrasonic surgical blade or end-effector used in a clamp coagulator device defines at least four important aspects of the instrument. These are: (1) the visibility of the end-effector and its relative position in the surgical field, (2) the ability of the end-effector to access or approach targeted tissue, (3) the manner in which ultrasonic energy is coupled to tissue for cutting and coagulation, and (4) the manner in which tissue can be manipulated with the ultrasonically inactive end-effector. It would be advantageous to provide an improved ultrasonic clamp coagulator optimizing these four aspects of the instrument.

[0011] However, as features are added to ultrasonic surgical instrument blades, the altered shape and asymmetries cause the blade to become unbalanced, meaning that the blade has the tendency to vibrate in directions other than the longitudinal direction along the length of the instrument. U.S. Patent Application Serial No. 09/106,686 previously incorporated herein by reference, addressed balancing blades proximal to functional asymmetries using balance asymmetries. While U.S. Patent Application Serial No. 09/106,686 has proven eminently successful at balancing blades and waveguides proximal to the balance asymmetry, there are some applications where some balancing may be desirable within the functional portion of an asymmetric blade.

[0012] It would be desirable to provide a balanced ultrasonic surgical instrument blade within the functional area of the blade to optimize instrument performance. The blade described herein has been developed to address this desire.

Summary of the Invention

[0013] Disclosed is an ultrasonic surgical instrument that combines end-effector geometry to best affect the multiple functions of a shears-type configuration. The shape of the blade is characterized by a radiused cut offset by some distance to form a curved geometry. The cut creates a curved surface with multiple asymmetries causing multiple imbalances within the blade. Imbalance due to the curve of the instrument is corrected by a non-functional asymmetry proximal to the functional asymmetry. Imbalance due to the asymmetric cross-section of the blade is corrected by the appropriate selection of the volume and location of material removed from a functional asymmetry. The shape of the blade in one embodiment of the present invention is characterized by two radiused cuts offset by some distance to form a curved and potentially tapered geometry. These two cuts create curved surfaces including a concave surface and a convex surface. The length of the radiused cuts affects, in part, the acoustic balancing of the transverse motion induced by the curved shape.

Brief Description of the Drawings

[0014] The novel features of the invention are set forth with particularity in the appended claims. The invention itself, however, both as to organization and methods of operation, together with further objects and advantages thereof, may best be understood by reference to the following description, taken in conjunction with the accompanying drawings in which:

Figure 1 illustrates an ultrasonic surgical system including an elevational view of an ultrasonic generator, a sectioned plan view of an ultrasonic transducer, and a partially sectioned plan view of a clamp coagulator in accordance with the present invention;

Figure 2A is an exploded perspective view of a portion of a clamp coagulator in accordance with the present invention;

Figure 2B is an exploded perspective view of a portion of a clamp coagulator in accordance with the present invention;

Figure 3 is a partially sectioned plan view of a clamp coagulator in accordance with the present invention with the clamp arm assembly shown in an open position;

Figure 4 is a partially sectioned plan view of a clamp coagulator in accordance with the present invention with the clamp arm assembly shown in a closed position;

Figure 5 is a side view of a collar cap of the clamp coagulator;

EP 2 322 106 A2

Figure 6 is a front view of a collar cap of the clamp coagulator;

Figure 7 is a side view of a force limiting spring of the clamp coagulator;

5 Figure 8 is a front view of a force limiting spring of the clamp coagulator;

Figure 9 is a side view of a washer of the clamp coagulator;

10 Figure 10 is a front view of a washer of the clamp coagulator;

Figure 11 is a side view of a tubular collar of the clamp coagulator;

Figure 12 is a rear view of a tubular collar of the clamp coagulator;

15 Figure 13 is a front view of a tubular collar of the clamp coagulator;

Figure 14 is a side view of an inner knob of the clamp coagulator;

20 Figure 15 is a front view of an inner knob of the clamp coagulator;

Figure 16 is a bottom view of an inner knob of the clamp coagulator;

Figure 17 is a rear view of an outer knob of the clamp coagulator;

25 Figure 18 is a top view of an outer knob of the clamp coagulator;

Figure 19 is a top view of a yoke of the clamp coagulator;

30 Figure 20 is a side view of a yoke of the clamp coagulator;

Figure 21 is a front view of a yoke of the clamp coagulator;

Figure 22 is a perspective view of a yoke of the clamp coagulator;

35 Figure 23 is a perspective view of an end-effector of the clamp coagulator;

Figure 24 is a top perspective view of a clamp arm of the camp coagulator;

40 Figure 25 is a top view of an end-effector of the clamp coagulator;

Figure 26 is a side view of an end-effector of the clamp coagulator with the clamp arm open;

Figure 27 is a top view of a tissue pad of the clamp coagulator;

45 Figure 28 is a side view of a tissue pad of the clamp coagulator;

Figure 29 is a front view of a tissue pad of the clamp coagulator;

50 Figure 30 is a perspective view of a tissue pad of the clamp coagulator;

Figure 31 is a bottom perspective view of a clamp arm of the clamp coagulator;

Figure 32 is a first cross-sectional view of the clamp arm illustrated in Figure 31;

55 Figure 33 is a second cross-sectional view of the clamp arm illustrated in Figure 31;

Figure 34 is a bottom plan view of a blade of the clamp coagulator;

Figure 35 is a cross-sectional view of a blade of the clamp coagulator;

Figure 35A is a cross-sectional view of an alternate embodiment of a blade of the clamp coagulator; and

Figure 36 is a perspective view of an end-effector of the clamp coagulator.

Detailed Description of the Invention

[0015] The present invention will be described in combination with ultrasonic instruments as described herein. Such description is exemplary only, and is not intended to limit the scope and applications of the invention. For example, the invention is useful in combination with a multitude of ultrasonic instruments including those described in, for example, U.S. Patents Nos. 5,938,633; 5,935,144; 5,944,737; 5,322,055, 5,630,420; and 5,449,370.

[0016] Figure 1 illustrates ultrasonic system 10 comprising an ultrasonic signal generator 15 with ultrasonic transducer 82, hand piece housing 20, and clamp coagulator 120 in accordance with the present invention. Clamp coagulator 120 may be used for open or laparoscopic surgery. The ultrasonic transducer 82, which is known as a "Langevin stack", generally includes a transduction portion 90, a first resonator or end-bell 92, and a second resonator or fore-bell 94, and ancillary components. The ultrasonic transducer 82 is preferably an integral number of one-half system wavelengths ($n\lambda/2$) in length as will be described in more detail later. An acoustic assembly 80 includes the ultrasonic transducer 82, mount 36, velocity transformer 64 and surface 95.

[0017] The distal end of end-bell 92 is connected to the proximal end of transduction portion 90, and the proximal end of fore-bell 94 is connected to the distal end of transduction portion 90. Fore-bell 94 and end-bell 92 have a length determined by a number of variables, including the thickness of the transduction portion 90, the density and modulus of elasticity of the material used to manufacture end-bell 92 and fore-bell 94, and the resonant frequency of the ultrasonic transducer 82. The fore-bell 94 may be tapered inwardly from its proximal end to its distal end to amplify the ultrasonic vibration amplitude as velocity transformer 64, or alternately may have no amplification.

[0018] The piezoelectric elements 100 may be fabricated from any suitable material, such as, for example, lead zirconate-titanate, lead meta-niobate, lead titanate, or other piezoelectric crystal material. Each of the positive electrodes 96, negative electrodes 98, and piezoelectric elements 100 has a bore extending through the center. The positive and negative electrodes 96 and 98 are electrically coupled to wires 102 and 104, respectively. Wires 102 and 104 are encased within cable 25 and electrically connectable to ultrasonic signal generator 15 of ultrasonic system 10.

[0019] Ultrasonic transducer 82 of the acoustic assembly 80 converts the electrical signal from ultrasonic signal generator 15 into mechanical energy that results in primarily longitudinal vibratory motion of the ultrasonic transducer 82 and an end-effector 180 at ultrasonic frequencies. A suitable generator is available as model number GEN01, from Ethicon Endo-Surgery, Inc., Cincinnati, Ohio. When the acoustic assembly 80 is energized, a vibratory motion standing wave is generated through the acoustic assembly 80. The amplitude of the vibratory motion at any point along the acoustic assembly 80 depends on the location along the acoustic assembly 80 at which the vibratory motion is measured. A minimum or zero crossing in the vibratory motion standing wave is generally referred to as a node (i.e., where motion is usually minimal), and an absolute value maximum or peak in the standing wave is generally referred to as an anti-node. The distance between an anti-node and its nearest node is one-quarter wavelength ($\lambda/4$).

[0020] Wires 102 and 104 transmit the electrical signal from the ultrasonic signal generator 15 to positive electrodes 96 and negative electrodes 98. The piezoelectric elements 100 are energized by an electrical signal supplied from the ultrasonic signal generator 15 in response to a foot switch 118 to produce an acoustic standing wave in the acoustic assembly 80. The electrical signal causes disturbances in the piezoelectric elements 100 in the form of repeated small displacements resulting in large compression forces within the material. The repeated small displacements cause the piezoelectric elements 100 to expand and contract in a continuous manner along the axis of the voltage gradient, producing longitudinal waves of ultrasonic energy. The ultrasonic energy is transmitted through the acoustic assembly 80 to the end-effector 180.

[0021] In order for the acoustic assembly 80 to deliver energy to end-effector 180, all components of acoustic assembly 80 must be acoustically coupled to the ultrasonically active portions of clamp coagulator 120. The distal end of the ultrasonic transducer 82 may be acoustically coupled at surface 95 to the proximal end of an ultrasonic waveguide 179 by a threaded connection such as stud 50.

[0022] The components of the acoustic assembly 80 are preferably acoustically tuned such that the length of any assembly is an integral number of one-half wavelengths ($n\lambda/2$), where the wavelength λ is the wavelength of a pre-selected or operating longitudinal vibration drive frequency f_d of the acoustic assembly 80, and where n is any positive integer. It is also contemplated that the acoustic assembly 80 may incorporate any suitable arrangement of acoustic elements.

[0023] Referring now to Figures 2A and 2B, a clamp coagulator 120 of the surgical system 10 in accordance with the present invention is illustrated. The clamp coagulator 120 is preferably attached to and removed from the acoustic

assembly 80 as a unit. The proximal end of the clamp coagulator 120 preferably acoustically couples to the distal surface 95 of the acoustic assembly 80 as shown in Figure 1. It will be recognized that the clamp coagulator 120 may be coupled to the acoustic assembly 80 by any suitable means.

[0024] The clamp coagulator 120 preferably includes an instrument housing 130, and an elongated member 150. The elongated member 150 can be selectively rotated with respect to the instrument housing 130 as further described below. The instrument housing 130 includes a pivoting handle portion 136, and a fixed handle 132A and 132B, coupled to a left shroud 134 and a right shroud 138 respectively.

[0025] The right shroud 138 is adapted to snap fit on the left shroud 134. The right shroud 138 is preferably coupled to the left shroud 134 by a plurality of inwardly facing prongs 70 formed on the right shroud 138. The plurality of prongs 70 are arranged for engagement in corresponding holes or apertures 140, which are formed in the left shroud 134. When the left shroud 134 is attached to the right shroud 138, a cavity is formed therebetween to accommodate various components, such as an indexing mechanism 255 as further described below.

[0026] The left shroud 134, and the right shroud 138 of the clamp coagulator 120 are preferably fabricated from polycarbonate. It is contemplated that these components may be made from any suitable material without departing from the spirit and scope of the invention.

[0027] Indexing mechanism 255 is disposed in the cavity of the instrument housing 130. The indexing mechanism 255 is preferably coupled or attached on inner tube 170 to translate movement of the handle portion 136 to linear motion of the inner tube 170 to open and close the clamp arm assembly 300. When the pivoting handle portion 136 is moved toward the fixed handle portion 130, the indexing mechanism 255 slides the inner tube 170 rearwardly to pivot the clamp arm assembly 300 into a closed position. The movement of the pivoting handle portion 136 in the opposite direction slides the indexing mechanism 255 to displace the inner tube 170 in the opposite direction, i.e., forwardly, and hence pivot the clamp arm assembly 300 into its open position.

[0028] The indexing mechanism 255 also provides a ratcheting mechanism to allow the elongated member 150 to rotate about its longitudinal axis relative to instrument housing 130. The rotation of the elongated member 150 enables the clamp arm assembly 300 to be turned to a selected or desired angular position. The indexing mechanism 255 preferably includes a tubular collar 260 and yoke 280.

[0029] The tubular collar 260 of the indexing mechanism 255 is preferably snapped onto the proximal end of the inner tube 170 and keyed into opposing openings 168. The tubular collar 260 is preferably fabricated from polyetherimide. It is contemplated that the tubular collar 260 may be constructed from any suitable material.

[0030] Tubular collar 260 is shown in greater detail in Figures 11 through 13. The tubular collar 260 preferably includes an enlarged section 262, and a bore 266 extending therethrough. The enlarged section 262 preferably includes a ring 272 formed around the periphery of the tubular collar 260 to form groove 268. The groove 268 has a plurality of detents or teeth 269 for retaining the elongated member 150 in different rotational positions as the elongated member 150 is rotated about its longitudinal axis. Preferably, the groove 268 has twelve ratchet teeth to allow the elongated portion to be rotated in twelve equal angular increments of approximately 30 degrees. It is contemplated that the tubular collar 260 may have any number of teeth-like members. It will be recognized that the teeth-like members may be disposed on any suitable part of the tubular collar 260 without departing from the scope and spirit of the present invention.

[0031] Referring back now to Figures 2A through 4, the pivoting handle portion 136 includes a thumb loop 142, a first hole 124, and a second hole 126. A pivot pin 153 is disposed through first hole 124 of handle portion 136 to allow pivoting as shown by arrow 121 in Figure 3. As thumb loop 142 of pivoting handle portion 136 is moved in the direction of arrow 121, away from instrument housing 130, a link 128 applies a forward force to yoke 280, causing yoke 280 to move forward. Link 128 is connected to pivoting handle portion 136 by a pin 129, and link 128 is connected to base 284 by a pin 127.

[0032] Referring back now to Figure 2A, yoke 280 generally includes a holding or supporting member 282 and a base 284. The supporting member 282 is preferably semi-circular and has a pair of opposing pawls 286 that extend inwardly to engage with the teeth 269 of the tubular collar 260. It is contemplated that the pawls 286 may be disposed on any suitable part of the yoke 280 for engagement with the teeth 269 of the tubular collar 260 without departing from the spirit and scope of the invention. It will also be recognized that the yoke 280 may have any number of ratchet arms.

[0033] Yoke 280 is shown in greater detail in Figures 19 through 22. The pivoting handle portion 136 preferably is partially disposed in a slot 147 of the base 284 of the yoke 280. The base 284 also includes a base opening 287, an actuator travel stop 290, and a base pin-hole 288. The pivot pin 153 is disposed through the base opening 287. Yoke 280 pawls 286 transfer opening force to inner tube 170 through tubular collar 260, resulting in the opening of clamp arm assembly 300.

[0034] The yoke 280 of the clamp coagulator 120 is preferably fabricated from polycarbonate. The yoke 280 may also be made from a variety of materials including other plastics, such as ABS, NYLON, or polyetherimide. It is contemplated that the yoke 280 may be constructed from any suitable material without departing from the spirit and scope of the invention.

[0035] As illustrated in Figures 3 and 4, yoke 280 also transfers a closing force to clamp arm assembly 300 as pivoting

handle portion 136 is moved toward instrument housing 130. Actuator travel stop 290 contacts pivot pin 153 at the bottom of the stroke of pivoting handle portion 136, stopping any further movement, or overtravel, of pivoting handle portion 136. Pawls 286 of yoke 280 transfer force to tubular collar 260 through a washer 151, a force limiting spring 155, and collar cap 152. Collar cap 152 is rigidly attached to tubular collar 260 after washer 151 and force limiting spring 155 have been assembled onto tubular collar 260 proximal to enlarged section 262. Collar cap 152 is illustrated in greater detail in Figures 5 and 6. Force limiting spring 155 is illustrated in greater detail in Figures 7 and 8, and washer 151 is illustrated in greater detail in Figures 9 and 10. Thickness of washer 151 may be adjusted during design or manufacturing of clamp coagulator 120 to alter the pre-load of force limiting spring 155. Collar cap 152 is attached to tubular collar 260 by ultrasonic welding, but may alternately be press fit, snap fit or attached with an adhesive.

[0036] Referring to Figures 5 through 10, tubular collar 260, washer 151, force limiting spring 155, and collar cap 152 provide a force limiting feature to clamp arm assembly 300. As pivoting handle portion 136 is moved toward instrument housing 130, clamp arm assembly 300 is rotated toward ultrasonic blade 88. In order to provide both ultrasonic cutting, and hemostasis, it is desirable to limit the maximum force of clamp arm assembly 300 to 0.5 to 3.0 Lbs.

[0037] Figures 5 and 6 illustrate collar cap 152 including a spring surface 158. Figures 7 and 8 illustrate force limiting spring 155 including a cap surface 156, a washer surface 157, and a plurality of spring elements 159. Force limiting spring 155 is described in the art as a wave spring, due to the shape of spring elements 159. It is advantageous to use a wave spring for force limiting spring 155 because it provides a high spring rate in a small physical size well suited to an ultrasonic surgical instrument application where a central area is open for ultrasonic waveguide 179. Force limiting spring 155 is biased between spring surface 158 of collar cap 152 and spring face 165 of washer 151. Washer 151 includes a pawl face 167 (Figures 9 and 10) that contacts pawls 286 of yoke 280 after assembly of clamp coagulator 120 (see Figures 2 through 4).

[0038] Referring now to Figures 2A, 2B, and Figures 14 through 18, a rotational knob 190 is mounted on the elongated member 150 to turn the elongated member 150 so that the tubular collar 260 rotates with respect to the yoke 280. The rotational knob 190 may be fabricated from polycarbonate. The rotational knob 190 may also be made from a variety of materials including other plastics, such as a polyetherimide, nylon, or any other suitable material.

The rotational knob 190 preferably has an enlarged section or outer knob 192, an inner knob 194, and an axial bore 196 extending therethrough. Inner knob 194 includes keys 191 that attach cooperatively to keyways 189 of outer knob 192. The outer knob 192 includes alternating longitudinal ridges 197 and grooves 198 that facilitate the orientation of the rotational knob 190 and the elongated member 150 by a surgeon. The axial bore 196 of the rotational knob 190 is configured to snugly fit over the proximal end of the elongated member 150.

[0039] The inner knob 194 extends through an opening 139 in the distal end of the instrument housing 130. Inner knob 194 includes a channel 193 to rotatably attach inner knob 194 into opening 139. The inner knob 194 of the rotational knob 190 has a pair of opposing holes 199. The opposing holes 199 are aligned as part of a passageway 195 that extends through the elongated member 150, as will be described later.

[0040] A coupling member, such as, for example, pin 163, may be positioned through opposing holes 199 of the passageway 195. The pin 163 may be held in the passageway 195 of the elongated member 150 by any suitable means, such as, for example, trapped between ribs in housing 130, or a silicone or cyanoacrylate adhesive. The pin 163 allows rotational torque to be applied to the elongated member 150 from the rotational knob 190 in order to rotate the elongated member 150.

[0041] When the rotational knob 190 is rotated, the teeth 269 of the tubular collar 260 engage and ride up slightly on the corresponding pawls 286 of the yoke 280. As the pawls 286 ride up on the teeth 269, the supporting member 282 of the yoke 280 deflects outwardly to allow pawls 286 to slip or pass over the teeth 269 of the tubular collar 260.

[0042] In one embodiment, the teeth 269 of the tubular collar 260 are configured as ramps or wedges, and the pawls 286 of the yoke 280 are configured as posts. The teeth 269 of the tubular collar 260 and the pawls 286 of the yoke 280 may be reversed so that the teeth 269 of the tubular collar 260 are posts, and the pawls 286 of the yoke 280 are ramps or wedges. It is contemplated that the teeth 269 may be integrally formed or coupled directly to the periphery of the elongated member 150. It will also be recognized that the teeth 269 and the pawls 286 may be cooperating projections, wedges, cam surfaces, ratchet-like teeth, serrations, wedges, flanges, or the like which cooperate to allow the elongated member 150 to be indexed at selective angular positions, without departing from the spirit and scope of the invention.

[0043] As illustrated in Figure 2B, the elongated member 150 of the clamp coagulator 120 extends from the instrument housing 130. As shown in Figures 2B through 4, the elongated member 150 preferably includes an outer member or outer tube 160, an inner member or inner tube 170, and a transmission component or ultrasonic waveguide 179.

[0044] The outer tube 160 of the elongated member 150 preferably includes a hub 162, a tubular member 164, and a longitudinal opening or aperture 166 extending therethrough. The outer tube 160 preferably has a substantially circular cross-section and may be fabricated from stainless steel. It will be recognized that the outer tube 160 may be constructed from any suitable material and may have any suitable cross-sectional shape.

[0045] The hub 162 of the outer tube 160 preferably has a larger diameter than the tubular member 164 does. The hub 162 has a pair of outer tube holes 161 to receive pin 163 to allow the hub 162 to be coupled to rotational knob 190.

As a result, the outer tube 160 will rotate when the rotational knob 190 is turned or rotated.

[0046] The hub 162 of the outer tube 160 also includes wrench flats 169 on opposite sides of the hub 162. The wrench flats 169 are preferably formed near the distal end of the hub 162. The wrench flats 169 allow torque to be applied by a torque wrench to the hub 162 to tighten the ultrasonic waveguide 179 to the stud 50 of the acoustic assembly 80. For example, U.S. Patent Nos. 5,059,210 and 5,057,119, which are hereby incorporated herein by reference, disclose torque wrenches for attaching and detaching a transmission component to a mounting device of a hand piece assembly.

[0047] Located at the distal end of the tubular member 164 of the outer tube 160 is an end-effector 180 for performing various tasks, such as, for example, grasping tissue, cutting tissue and the like. It is contemplated that the end-effector 180 may be formed in any suitable configuration.

[0048] End-effector 180 and its components are shown in greater detail in Figures 23 through 33. The end-effector 180 generally includes a non-vibrating clamp arm assembly 300 to, for example, grip tissue or compress tissue against the ultrasonic blade 88. The end-effector 180 is illustrated in Figures 23 and 26 in a clamp open position, and clamp arm assembly 300 is preferably pivotally attached to the distal end of the outer tube 160.

[0049] Looking first to Figures 23 through 26, the clamp arm assembly 300 preferably includes a clamp arm 202, a jaw aperture 204, a first post 206A, a second post 206B, and a tissue pad 208. The clamp arm 202 is pivotally mounted about a pivot pin 207A and pivot pin 207B to rotate in the direction of arrow 122 in Figure 3 when thumb loop 142 is moved in the direction indicated by arrow 121 in Figure 3. By advancing the pivoting handle portion 136 toward the instrument housing 130, the clamp arm 202 is pivoted about the pivot pin 207A and pivot pin 207B into a closed position. Retracting the pivoting handle portion 136 away from the instrument housing 130 pivots the clamp arm 202 into an open position.

[0050] The clamp arm 202 has tissue pad 208 attached thereto for squeezing tissue between the ultrasonic blade 88 and clamp arm assembly 300. The tissue pad 208 is preferably formed of a polymeric or other compliant material and engages the ultrasonic blade 88 when the clamp arm 202 is in its closed position. Preferably, the tissue pad 208 is formed of a material having a low coefficient of friction but which has substantial rigidity to provide tissue-grasping capability, such as, for example, TEFLON, a trademark name of E. I. Du Pont de Nemours and Company for the polymer polytetrafluoroethylene (PTFE). The tissue pad 208 may be mounted to the clamp arm 202 by an adhesive, or preferably by a mechanical fastening arrangement as will be described below.

[0051] As illustrated in Figures 23, 26 and 28, serrations 210 are formed in the clamping surfaces of the tissue pad 208 and extend perpendicular to the axis of the ultrasonic blade 88 to allow tissue to be grasped, manipulated, coagulated and cut without slipping between the clamp arm 202 and the ultrasonic blade 88.

[0052] Tissue pad 208 is illustrated in greater detail in Figures 27 through 29. Tissue pad 208 includes a T-shaped protrusion 212, a left protrusion surface 214, a right protrusion surface 216, a top surface 218, and a bottom surface 219. Bottom surface 219 includes the serrations 210 previously described. Tissue pad 208 also includes a beveled front end 209 to ease insertion during assembly as will be described below.

[0053] Referring now to Figure 26, the distal end of the tubular member 174 of the inner tube 170 preferably includes a finger or flange 171 that extends therefrom. The flange 171 has an opening 173A and an opening 173B (not shown) to receive the first post 206A and second post 206B of the clamp arm 202. When the inner tube 170 of the elongated member 150 is moved axially, the flange 171 moves forwardly or rearwardly while engaging the first post 206A and second post 206B of the clamp arm assembly 300 to open and close the clamp arm 202.

[0054] Referring now to Figures 24, 25, and 31 through 33, the clamp arm 202 of end-effector 180 is shown in greater detail. Clamp arm 202 includes an arm top 228 and an arm bottom 230, as well as a straight portion 235 and a curved portion 236. Straight portion 235 includes a straight T-slot 226. Curved portion 236 includes a first top hole 231, a second top hole 232, a third top hole 233, a fourth top hole 234, a first bottom cut-out 241, a second bottom cut-out 242, a third bottom cut-out 243, a fourth bottom cut-out 244, a first ledge 221, a second ledge 222, a third ledge 223, a fourth ledge 224, and a fifth ledge 225.

[0055] Top hole 231 extends from arm top 228 through clamp arm 202 to second ledge 222. Top hole 232 extends from arm top 228 through clamp arm 202 to third ledge 223. Top hole 233 extends from arm top 228 through clamp arm 202 to fourth ledge 224. Top hole 234 extends from arm top 228 through clamp arm 202 to fifth ledge 225. The arrangement of holes 231 through 234 and ledges 221 through 225 enables clamp arm 202 to include both the straight portion 235 and the curved portion 236, while being moldable from a process such as, for example, metal injection molding (MIM). Clamp arm 202 may be made out of stainless steel or other suitable metal utilizing the MIM process.

[0056] Referring to Figures 30 and 31, tissue pad 208 T-shaped protrusion 212 is insertable into clamp arm 202 straight T-slot 226. Clamp arm 202 is designed such that tissue pad 208 may be manufactured as a straight component by, for example, injection molding, machining, or extrusion. As clamp arm 202 is inserted into straight T-slot 226 and moved progressively through curved portion 236, beveled front edge 209 facilitates bending of tissue pad 208 to conform to the curvature of clamp arm 202. The arrangement of holes 231 through 234 and ledges 221 through 225 enables clamp arm 202 to bend and hold tissue pad 208.

[0057] Figures 32 and 33 illustrate how clamp arm 202 holds tissue pad 208 in place while maintaining a bend in

tissue pad 208 that conforms to curved portion 236 of clamp arm 202. As illustrated in Figure 32, third ledge 223 contacts right protrusion surface 216 providing a contact edge 238, while left protrusion surface 214 is unsupported at this position. At a distal location, illustrated in Figure 33, fourth ledge 224 contacts left protrusion surface 214 providing a contact edge 239, while right protrusion surface 216 is unsupported at this location.

5 **[0058]** Referring back now to Figure 2 again, the inner tube 170 of the elongated member 150 fits snugly within the opening 166 of the outer tube 160. The inner tube 170 preferably includes an inner hub 172, a tubular member 174, a circumferential groove 176, a pair of opposing openings 178, a pair of opposing openings 178, and a longitudinal opening or aperture 175 extending therethrough. The inner tube 170 preferably has a substantially circular cross-section, and may be fabricated from stainless steel. It will be recognized that the inner tube 170 may be constructed from any suitable material and may be any suitable shape.

10 **[0059]** The inner hub 172 of the inner tube 170 preferably has a larger diameter than the tubular member 174 does. The pair of opposing openings 178 of the inner hub 172 allow the inner hub 172 to receive the pin 163 to allow the inner tube 170 and the ultrasonic waveguide 179 to transfer torque for attaching ultrasonic waveguide 179 to stud 50 as previously described. An O-ring 220 is preferably disposed in the circumferential groove 176 of the inner hub 172.

15 **[0060]** The ultrasonic waveguide 179 of the elongated member 150 extends through aperture 175 of the inner tube 170. The ultrasonic waveguide 179 is preferably substantially semi-flexible. It will be recognized that the ultrasonic waveguide 179 may be substantially rigid or may be a flexible wire. Ultrasonic vibrations are transmitted along the ultrasonic waveguide 179 in a longitudinal direction to vibrate the ultrasonic blade 88.

20 **[0061]** The ultrasonic waveguide 179 may, for example, have a length substantially equal to an integral number of one-half system wavelengths ($n\lambda/2$). The ultrasonic waveguide 179 may be preferably fabricated from a solid core shaft constructed out of material which propagates ultrasonic energy efficiently, such as titanium alloy (i.e., Ti-6Al-4V) or an aluminum alloy. It is contemplated that the ultrasonic waveguide 179 may be fabricated from any other suitable material. The ultrasonic waveguide 179 may also amplify the mechanical vibrations transmitted to the ultrasonic blade 88 as is well known in the art.

25 **[0062]** As illustrated in Figure 2, the ultrasonic waveguide 179 may include one or more stabilizing silicone rings or damping sheaths 110 (one being shown) positioned at various locations around the periphery of the ultrasonic waveguide 179. The damping sheaths 110 dampen undesirable vibration and isolate the ultrasonic energy from the inner tube 170 assuring the flow of ultrasonic energy in a longitudinal direction to the distal end of the ultrasonic blade 88 with maximum efficiency. The damping sheaths 110 may be secured to the ultrasonic waveguide 179 by an interference fit such as, for example, a damping sheath described in U.S. Patent Application No. 08/808,652 hereby incorporated herein by reference.

30 **[0063]** Referring again to Figure 2, the ultrasonic waveguide 179 generally has a first section 182, a second section 184, and a third section 186. The first section 182 of the ultrasonic waveguide 179 extends distally from the proximal end of the ultrasonic waveguide 179. The first section 182 has a substantially continuous cross-section dimension.

35 **[0064]** The first section 182 preferably has at least one radial waveguide hole 188 extending therethrough. The waveguide hole 188 extends substantially perpendicular to the axis of the ultrasonic waveguide 179. The waveguide hole 188 is preferably positioned at a node but may be positioned at any other suitable point along the ultrasonic waveguide 179. It will be recognized that the waveguide hole 188 may have any suitable depth and may be any suitable shape.

40 **[0065]** The waveguide hole 188 of the first section 182 is aligned with the opposing openings 178 of the hub 172 and outer tube holes 161 of hub 162 to receive the pin 163. The pin 163 allows rotational torque to be applied to the ultrasonic waveguide 179 from the rotational knob 190 in order to rotate the elongated member 150. Passageway 195 of elongated member 150 includes opposing openings 178, outer tube holes 161, waveguide hole 188, and opposing holes 199.

45 **[0066]** The second section 184 of the ultrasonic waveguide 179 extends distally from the first section 182. The second section 184 has a substantially continuous cross-section dimension. The diameter of the second section 184 is smaller than the diameter of the first section 182. As ultrasonic energy passes from the first section 182 of the ultrasonic waveguide 179 into the second section 184, the narrowing of the second section 184 will result in an increased amplitude of the ultrasonic energy passing therethrough.

50 **[0067]** The third section 186 extends distally from the distal end of the second section 184. The third section 186 has a substantially continuous cross-section dimension. The third section 186 may also include small diameter changes along its length. The third section preferably includes a seal 187 formed around the outer periphery of the third section 186. As ultrasonic energy passes from the second section 184 of the ultrasonic waveguide 179 into the third section 186, the narrowing of the third section 186 will result in an increased amplitude of the ultrasonic energy passing there-through.

55 **[0068]** The third section 186 may have a plurality of grooves or notches (not shown) formed in its outer circumference. The grooves may be located at nodes of the ultrasonic waveguide 179 or any other suitable point along the ultrasonic waveguide 179 to act as alignment indicators for the installation of a damping sheath 110 during manufacturing.

[0069] Still referring to Figure 2, damping sheath 110 of the surgical instrument 150 surrounds at least a portion of

the ultrasonic waveguide 179. The damping sheath 110 may be positioned around the ultrasonic waveguide 179 to dampen or limit transverse side-to-side vibration of the ultrasonic waveguide 179 during operation. The damping sheath 110 preferably surrounds part of the second section 184 of the ultrasonic waveguide 179. It is contemplated that the damping sheath 110 may be positioned around any suitable portion of the ultrasonic waveguide 179. The damping sheath 110 preferably extends over at least one antinode of transverse vibration, and more preferably, a plurality of antinodes of transverse vibration. The damping sheath 110 preferably has a substantially circular cross-section. It will be recognized that the damping sheath 110 may have any suitable shape to fit over the ultrasonic waveguide 179 and may be any suitable length.

[0070] The damping sheath 110 is preferably in light contact with the ultrasonic waveguide 179 to absorb unwanted ultrasonic energy from the ultrasonic waveguide 179. The damping sheath 110 reduces the amplitude of non-axial vibrations of the ultrasonic waveguide 179, such as, unwanted transverse vibrations associated with the longitudinal frequency of 55,500 Hz as well as other higher and lower frequencies.

[0071] The damping sheath 110 is constructed of a polymeric material, preferably with a low coefficient of friction to minimize dissipation of energy from the axial motion or longitudinal vibration of the ultrasonic waveguide 179. The polymeric material is preferably floura-ethylene propene (FEP) which resists degradation when sterilized using gamma radiation. It will be recognized that the damping sheath 110 may be fabricated from any suitable material, such as, for example, PTFE.

[0072] The damping sheath 110 preferably has an opening extending therethrough, and a longitudinal slit 111. The slit 111 of the damping sheath 110 allows the damping sheath 110 to be assembled over the ultrasonic waveguide 179 from either end. It will be recognized that the damping sheath 110 may have any suitable configuration to allow the damping sheath 110 to fit over the ultrasonic waveguide 179. For example, the damping sheath 110 may be formed as a coil or spiral or may have patterns of longitudinal and/or circumferential slits or slots. It is also contemplated that the damping sheath 110 may be fabricated without a slit 111 and the ultrasonic waveguide 179 may be fabricated from two or more parts to fit within the damping sheath 110.

[0073] It will be recognized that the ultrasonic waveguide 179 may have any suitable cross-sectional dimension. For example, the ultrasonic waveguide 179 may have a substantially uniform cross-section or the ultrasonic waveguide 179 may be tapered at various sections or may be tapered along its entire length.

[0074] The ultrasonic waveguide 179 may also amplify the mechanical vibrations transmitted through the ultrasonic waveguide 179 to the ultrasonic blade 88 as is well known in the art. The ultrasonic waveguide 179 may further have features to control the gain of the longitudinal vibration along the ultrasonic waveguide 179 and features to tune the ultrasonic waveguide 179 to the resonant frequency of the system.

[0075] The proximal end of the third section 186 of ultrasonic waveguide 179 may be coupled to the distal end of the second section 184 by an internal threaded connection, preferably near an antinode. It is contemplated that the third section 186 may be attached to the second section 184 by any suitable means, such as a welded joint or the like. Third section 186 includes ultrasonic blade 88. Although the ultrasonic blade 88 may be detachable from the ultrasonic waveguide 179, the ultrasonic blade 88 and ultrasonic waveguide 179 are preferably formed as a single unit.

[0076] The ultrasonic blade 88 may have a length substantially equal to an integral multiple of one-half system wavelengths ($n\lambda/2$). The distal end of ultrasonic blade 88 may be disposed near an antinode in order to provide the maximum longitudinal excursion of the distal end. When the transducer assembly is energized, the distal end of the ultrasonic blade 88 is configured to move in the range of, for example, approximately 10 to 500 microns peak-to-peak, and preferably in the range of about 30 to 150 microns at a predetermined vibrational frequency.

[0077] The ultrasonic blade 88 is preferably made from a solid core shaft constructed of material which propagates ultrasonic energy, such as a titanium alloy (i.e., Ti-6Al-4V) or an aluminum alloy. It will be recognized that the ultrasonic blade 88 may be fabricated from any other suitable material. It is also contemplated that the ultrasonic blade 88 may have a surface treatment to improve the delivery of energy and desired tissue effect. For example, the ultrasonic blade 88 may be micro-finished, coated, plated, etched, grit-blasted, roughened or scored to enhance coagulation and cutting of tissue and/or reduce adherence of tissue and blood to the end-effector. Additionally, the ultrasonic blade 88 may be sharpened or shaped to enhance its characteristics. For example, the ultrasonic blade 88 may be blade shaped, hook shaped, or ball shaped.

[0078] As illustrated in Figures 34, 35 and 36, the geometry of the ultrasonic blade 88 in accordance with the present invention delivers ultrasonic power more uniformly to clamped tissue than predicate devices. The end-effector 180 provides for improved visibility of the blade tip so that a surgeon can verify that the blade 88 extends across the structure being cut or coagulated. This is especially important in verifying margins for large blood vessels. The geometry also provides for improved tissue access by more closely replicating the curvature of biological structures. Blade 88 provides a multitude of edges and surfaces, designed to provide a multitude of tissue effects: clamped coagulation, clamped cutting, grasping, back-cutting, dissection, spot coagulation, tip penetration and tip scoring.

[0079] The distal most tip of blade 88 has a surface 54 perpendicular to tangent 63, a line tangent to the curvature at the distal tip. Two fillet-like features 61A and 61B are used to blend surfaces 51, 52 and 54, thus giving a blunt tip that

can be utilized for spot coagulation. The top of the blade 88 is radiused and blunt, providing a broad edge, or surface 56, for clamping tissues between it and clamp arm assembly 300. Surface 56 is used for clamped cutting and coagulation as well as manipulating tissues while the blade is inactive.

[0080] The bottom surface has a spherical cut 53 that provides a narrow edge, or sharp edge 55, along the bottom of blade 88. The material cut is accomplished by, for example, sweeping a spherical end mill through an arc of radius R1 and then finishing the cut using a second, tighter radius R2 that blends the cut with a bottom surface 58 of the blade 88. Radius R1 is preferably within the range of 0.5 inches to 2 inches, more preferably within the range of 0.9 inches to 1.1 inches, and most preferably about 1.068 inches. Radius R2 is preferably within the range of 0.125 inches to 0.5 inches, and most preferably about 0.25 inches. The second radius R2 and the corresponding blend with the bottom surface 58 of blade 88 diminishes the stress concentrated at the end of the spherical cut relative to stopping the cut without this blend. The sharp edge 55 facilitates dissection and undamped cutting (back-cutting) through less vascular tissues.

[0081] Spherical cut 53 on bottom surface 58 of blade 88 creates sharp edge 55 while removing a minimal amount of material from blade 88. Spherical cut 53 on the bottom of blade 88 creates a sharp edge 55 with an angle of α as described below. This angle α may be similar to predicate shears devices such as, for example, the LCS-K5 manufactured by Ethicon Endo-Surgery, Inc., Cincinnati, Ohio. However the blade 88 of the present invention cuts faster than predicate devices by virtue of the orientation of the angle α with respect to the typical application force. For the predicate shears devices, the edges are symmetric, spanning the application force equally. The edges for the present invention are asymmetric, with the asymmetry of the edges dictating how quickly tissue is separated or cut. The asymmetry is important in that it provides for an effectively sharper edge when ultrasonically activated, without removing a significant volume of material, while maintaining blunt geometry. This asymmetric angle as well as the curvature of the blade act to self tension tissue during back-cutting utilizing a slight hook-like or wedge-like action.

[0082] Sharp edge 55 of ultrasonic blade 88 is defined by the intersection of surface 53 and a second surface 57 left after bottom surface 58 has received spherical cut 53. Clamp arm assembly 300 is pivotally mounted on said distal end of outer tube 160 for pivotal movement with respect to ultrasonic blade 88, for clamping tissue between clamp arm assembly 300 and ultrasonic blade 88. Reciprocal movement of inner tube 170 pivots clamp arm assembly 300 through an arc of movement, defining a vertical plane 181. A tangent 60 of spherical cut 53 at sharp edge 55 defines an angle α with a tangent 62 of second surface 57, as illustrated in Figure 35. The bisection 59 of angle α preferably does not lie in vertical plane 181, but is offset by an angle β . Preferably the tangent 60 of spherical cut 53 lies within about 5 to 50 degrees of vertical plane 181, and most preferably the tangent of spherical cut 53 lies about 38.8 degrees from vertical plane 181. Preferably angle α is within the range of about 90 to 150 degrees, and most preferably angle α is about 121.6 degrees.

[0083] Looking to Figure 35A, an alternate embodiment of the present invention is illustrated with an asymmetric narrow edge. A tangent 60A of a spherical cut 53A at a sharp edge 55A defines an angle α_A with a tangent 62A of a second surface 57A, as illustrated in Figure 35A. A bisection 59A of angle α_A preferably does not lie in a vertical plane 181A, but is offset by an angle β_A .

[0084] The curved shape of the design of ultrasonic blade 88 also results in a more uniformly distributed energy delivery to tissue as it is clamped against the blade 88. Uniform energy delivery is desired so that a consistent tissue effect (thermal and transection effect) along the length of end-effector 180 is achieved. The distal most 15 millimeters of blade 88 is the working portion, used to achieve a tissue effect. As will be further described below, the displacement vectors for locations along the curved shears blade 88 have directions that, by virtue of the improvements of the present invention over predicate instruments, lie largely in the x-y plane illustrated in Figures 34 and 35. The motion, therefore, of blade 88 lies within a plane (the x-y plane) that is perpendicular to the direction of the clamping force from clamp arm assembly 300.

[0085] Straight symmetric ultrasonic blades in general have tip excursions that lie along the longitudinal axis, designated the x-axis in Figures 34 and 35. Transverse motion is usually undesirable because it results in undesirable heat generation in inner tube 170. When a functional asymmetry is added to an ultrasonic blade, such as a curved end-effector as described in U.S. Patent Application Serial No. 09/106,686 previously incorporated herein by reference, the functional asymmetry creates an imbalance in the ultrasonic waveguide. If the imbalance is not corrected, then undesirable heat, noise, and compromised tissue effect occur. Although U.S. Patent Application Serial No. 09/106,686 teaches how to provide ultrasonic blades that are balanced proximal to the balance asymmetry, the distal portion of the end-effector has an excursion in at least two axes. If the end-effector has a single plane of functional asymmetry, such as a curved end-effector, but the blade is otherwise symmetric, then the excursion will lie in a plane at the distal most end.

[0086] It is often desirable to minimize any ultrasonic blade 88 excursion in the z-axis direction. Excursion of ultrasonic blade 88 in the z-axis direction causes system inefficiencies, resulting in undesirable heating, power loss, and possibly noise. Excursion of ultrasonic blade 88 in the z-axis direction at end-effector 180 causes the ultrasonic blade 88 to impact tissue lying between ultrasonic blade 88 and clamp arm assembly 300. It is desirable to limit ultrasonic blade 88 excursion to the x-y plane shown in Figures 34 and 35. This allows ultrasonic blade 88 to rub tissue lying between ultrasonic blade 88 and clamp arm assembly 300 without impact, which optimizes heating of the tissue, and thus provides optimal

coagulation. Minimizing z-axis excursion both proximal to the end-effector 180, and in ultrasonic blade 88, may be accomplished by proper selection of a spherical cut 53.

[0087] However, an ultrasonic end-effector 180 with an ultrasonic blade 88 that has multiple functional asymmetries, such as ultrasonic blade 88 as illustrated in Figures 34 through 36, will naturally have a tendency to include tip excursion in all three axes, x, y, and z if not balanced properly. For example, ultrasonic blade 88 as illustrated in Figure 34 is curved in the y direction at its distal end. This curvature, although balanced proximal to end-effector 180, will cause ultrasonic blade 88 to have excursions in both the x and y directions when activated. Adding spherical cut 53 subsequently adds another level of asymmetry to ultrasonic blade 88, causing tip excursion in all three axes if not corrected, and also causing z-axis imbalances in ultrasonic waveguide 179 which decreases efficiency.

[0088] It is possible to minimize z-axis tip excursion proximal to the functional asymmetry, and therefore maximize efficiency with improved tissue effect, by providing a functional asymmetry optimized to minimize z-axis excursion in ultrasonic waveguide 179. As illustrated in Figure 34, spherical cut 53 may extend proximally into ultrasonic blade 88, from the most distal end, to any position. For example, Figure 34 illustrates a first position 66, a second position 67, and a third position 68, for spherical cut 53 to extend into ultrasonic blade 88.

[0089] Table 1 below describes three possible lengths of spherical cuts 53 for ultrasonic blade 88 illustrated in Figure 34 as first position 66, second position 67, and third position 68. The rows of Table 1 correspond to the length of cut into the ultrasonic blade 88, and the columns of Table 1 correspond to the balance condition and excursions along each axis for each cut length. It can be appreciated from Table 1 that providing spherical cut 53 to a length corresponding to first position 68 minimizes the z axis excursion proximal to the functional asymmetry. It is preferable to balance ultrasonic blade 88 below 15 % z axis excursion proximal to the functional asymmetry and it is most preferable to balance ultrasonic blade 88 below 5 % z axis excursion proximal to the functional asymmetry. Preferably clamp coagulator 120 is designed to be balanced when activated in air (loaded only by air), and then balance is verified under other load conditions.

[0090] In Table 1, a normalized excursion percentage (% z) in a clamping instrument at the end-effector 88 is calculated by taking the magnitude of the excursion in the direction normal to the clamp arm when the clamp arm is in its fully closed position, and dividing that magnitude by the magnitude of the maximum tip vibration excursion (also called the primary tip vibration excursion), and then multiplying the dividend by one hundred. Primary tip vibration excursion is the magnitude of the major axis of the ellipse or ellipsoid created by a point on the distal most end of ultrasonic blade 88 when the ultrasonic blade 88 is activated. The measurement of excursions is more fully explained in IEC international standard 61847, titled Measurement and Declaration of the Basic Output Characteristics of ultrasonic surgical systems, hereby incorporated herein by reference. A normalized excursion percentage (%x, %y, %z) in ultrasonic blade 88 or ultrasonic waveguide 179 is calculated by taking the magnitude of a secondary vibration excursion, and dividing that magnitude by the magnitude of the primary tip vibration excursion, and then multiplying the dividend by one hundred. Secondary tip vibration excursion is the magnitude of a minor axis, or other arbitrary axis, of the ellipse or ellipsoid created by a point on the distal most end of ultrasonic blade 88 when the ultrasonic blade 88 is activated.

Table 1. Three possible lengths to provide a range of balances for a 0.946 inch long blade with a radius of R1 manufactured from Ti6Al4V with the blade including a functional asymmetry.

	% x at distal end of blade 88	% y at distal end of blade 88	% z at distal end of blade 88	% z proximal to blade 88
Cut Length = 12.8 mm, Location at first position 68	71.83	69.47	4.15	0.40
Cut Length= 14.8 mm, Location at second position 67	72.49	68.87	1.60	12.43
Cut Length= 8.2 mm, Location at third position 66	74.54	66.03	9.21	8.25

[0091] Referring now to Figures 1-4, the procedure to attach and detach the clamp coagulator 120 from the acoustic assembly 80 will be described below. When the physician is ready to use the clamp coagulator 120, the physician simply attaches the clamp coagulator 120 onto the acoustic assembly 80. To attach the clamp coagulator 120 to acoustic assembly 80, the distal end of stud 50 is threadedly connected to the proximal end of the transmission component or ultrasonic waveguide 179. The clamp coagulator 120 is then manually rotated in a conventional screw-threading direction to interlock the threaded connection between the stud 50 and the ultrasonic waveguide 179.

[0092] Once the ultrasonic waveguide 179 is threaded onto the stud 50, a tool, such as, for example, a torque wrench,

may be placed over the elongated member 150 of the clamp coagulator 120 to tighten the ultrasonic waveguide 179 to the stud 50. The tool may be configured to engage the wrench flats 169 of the hub 162 of the outer tube 160 in order to tighten the ultrasonic waveguide 179 onto the stud 50. As a result, the rotation of the hub 162 will rotate the elongated member 150 until the ultrasonic waveguide 179 is tightened against the stud 50 at a desired and predetermined torque. It is contemplated that the torque wrench may alternately be manufactured as part of the clamp coagulator 120, or as part of the hand piece housing 20, such as the torque wrench described in U.S. Patent No. 5,776,155 hereby incorporated herein by reference.

[0093] Once the clamp coagulator 120 is attached to the acoustic assembly 80, the surgeon can rotate the rotational knob 190 to adjust the elongated member 150 at a desired angular position. As the rotational knob 190 is rotated, the teeth 269 of the tubular collar 260 slip over the pawls 286 of the yoke 280 into the adjacent notch or valley. As a result, the surgeon can position the end-effector 180 at a desired orientation. Rotational knob 190 may incorporate an indicator to indicate the rotational relationship between instrument housing 130 and clamp arm 202. As illustrated in Figures 17 and 18, one of the ridges 197 of rotational knob 190 may be used to indicate the rotational position of clamp arm 202 with respect to instrument housing 130 by utilizing, for example, an enlarged ridge 200. It is also contemplated that alternate indications such as the use of coloring, symbols, textures, or the like may also be used on rotational knob 190 to indicate position similarly to the use of enlarged ridge 200.

[0094] To detach the clamp coagulator 120 from the stud 50 of the acoustic assembly 80, the tool may be slipped over the elongated member 150 of the surgical tool 120 and rotated in the opposite direction, i.e., in a direction to unthread the ultrasonic waveguide 179 from the stud 50. When the tool is rotated, the hub 162 of the outer tube 160 allows torque to be applied to the ultrasonic waveguide 179 through the pin 163 to allow a relatively high disengaging torque to be applied to rotate the ultrasonic waveguide 179 in the unthreading direction. As a result, the ultrasonic waveguide 179 loosens from the stud 50. Once the ultrasonic waveguide 179 is removed from the stud 50, the entire clamp coagulator 120 may be thrown away.

[0095] While preferred embodiments of the present invention have been shown and described herein, it will be obvious to those skilled in the art that such embodiments are provided by way of example only. Numerous variations, changes, and substitutions will now occur to those skilled in the art without departing from the invention. Accordingly, it is intended that the invention be limited only by the spirit and scope of the appended claims.

Claims

1. An ultrasonic clamp coagulator apparatus comprising:

a housing;
an outer tube having a proximal end joined to said housing, and a distal end;
an ultrasonic waveguide positioned within said outer tube, said ultrasonic waveguide having an end-effector extending distally from said distal end of said outer tube; and
said end-effector having an ultrasonically actuated motion in substantially a single actuation plane and comprising a curved treatment portion defining plane of asymmetry and a balance portion including at least one balance asymmetry, wherein the balance asymmetry is positioned to counter motion of the end effector in a plane orthogonal to the single actuation plane.

2. An ultrasonic clamp coagulator apparatus according to claim 1, wherein excursion of said end-effector along said plane orthogonal to the single actuation plane is limited to less than 15 %.

3. An ultrasonic clamp coagulator apparatus according to claim 1, wherein excursion of said end-effector along said plane orthogonal to the single actuation plane is limited to less than 10 %.

4. An ultrasonic clamp coagulator apparatus according to claim 1, wherein excursion of said end-effector along said plane orthogonal to the single actuation plane is limited to less than 5 %.

5. The ultrasonic clamp coagulator apparatus according to claim 1, further comprising a clamp member having an open position in which at least a portion of the clamp member is spaced from the end effector and a closed position in which the clamp member is adjacent to the end effector and that the motion from the closed position to the open position occurs in a plane substantially perpendicular to the plane of motion of the end effector.

6. The ultrasonic surgical instrument of claim 1, wherein the balance asymmetry extends from the distal end of the end effector to a point within the treatment portion.

7. The ultrasonic surgical instrument of claim 1, wherein the balance asymmetry extends from the distal end of the end effector to a point proximal to the treatment portion.
8. The ultrasonic surgical instrument of claim 1, further comprising a damping member enclosing at least a portion of the waveguide.
9. The ultrasonic surgical instrument of claim 5, wherein the clamp member is supported adjacent to the end effector and the motion of the clamp member from the closed position to the open position is configured to subscribe an arc larger than the diameter of the outer tube.
10. The ultrasonic surgical instrument of claim 5 further comprising a rotatable member operatively associated with the clamp member and the end effector, the rotatable member being rotatable to cause corresponding rotation of the clamp member and the end effector about a longitudinal axis of the instrument.

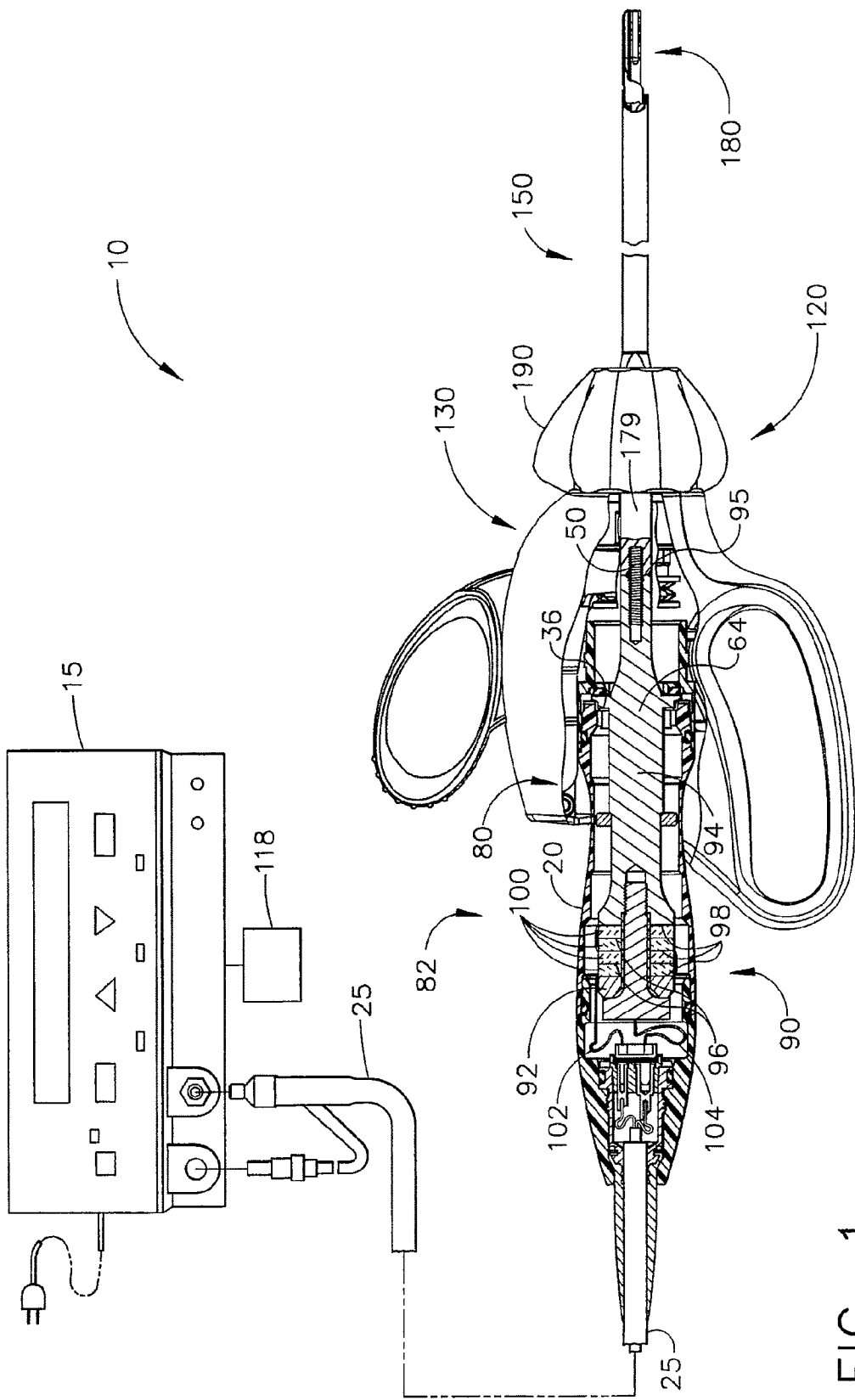
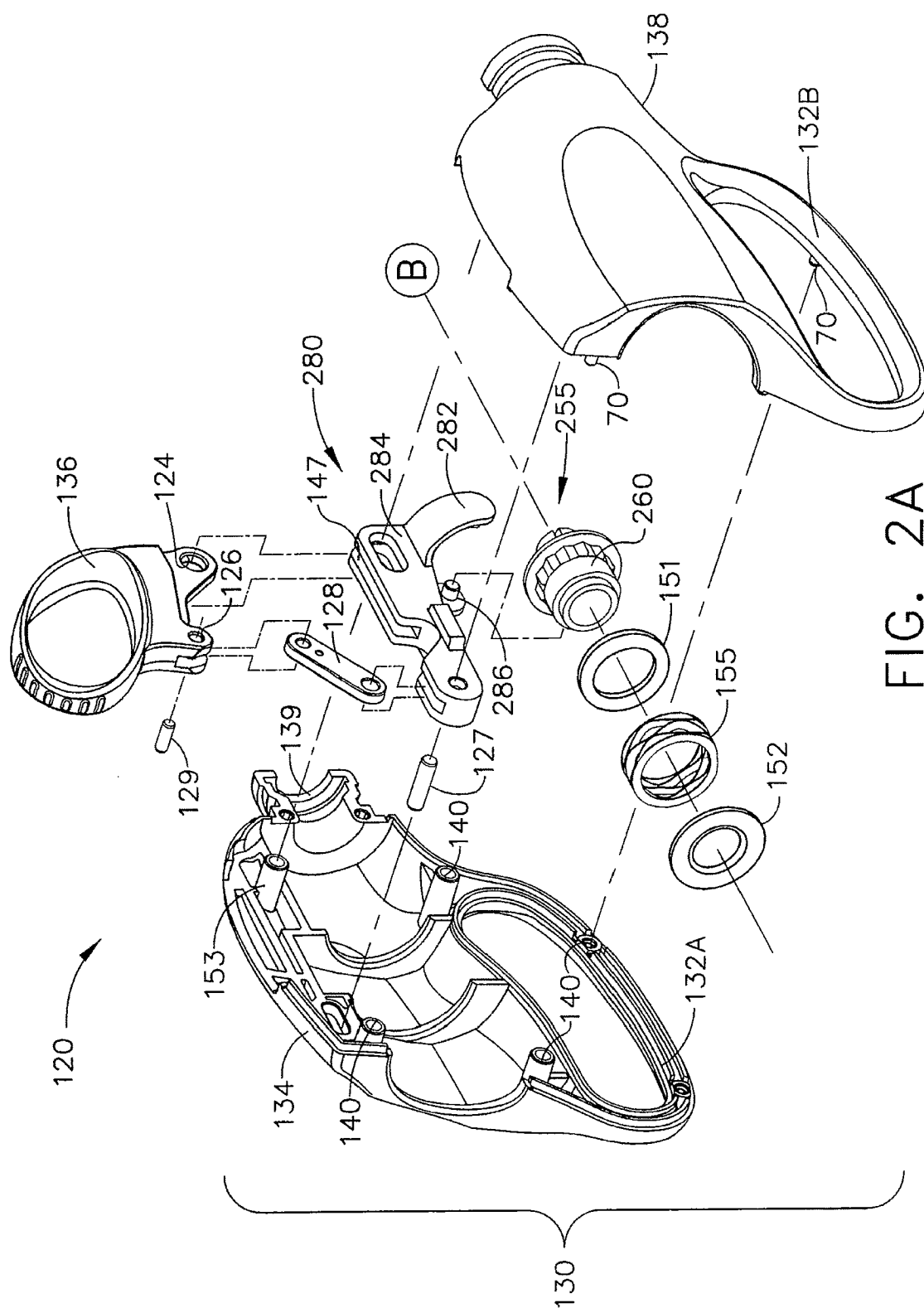
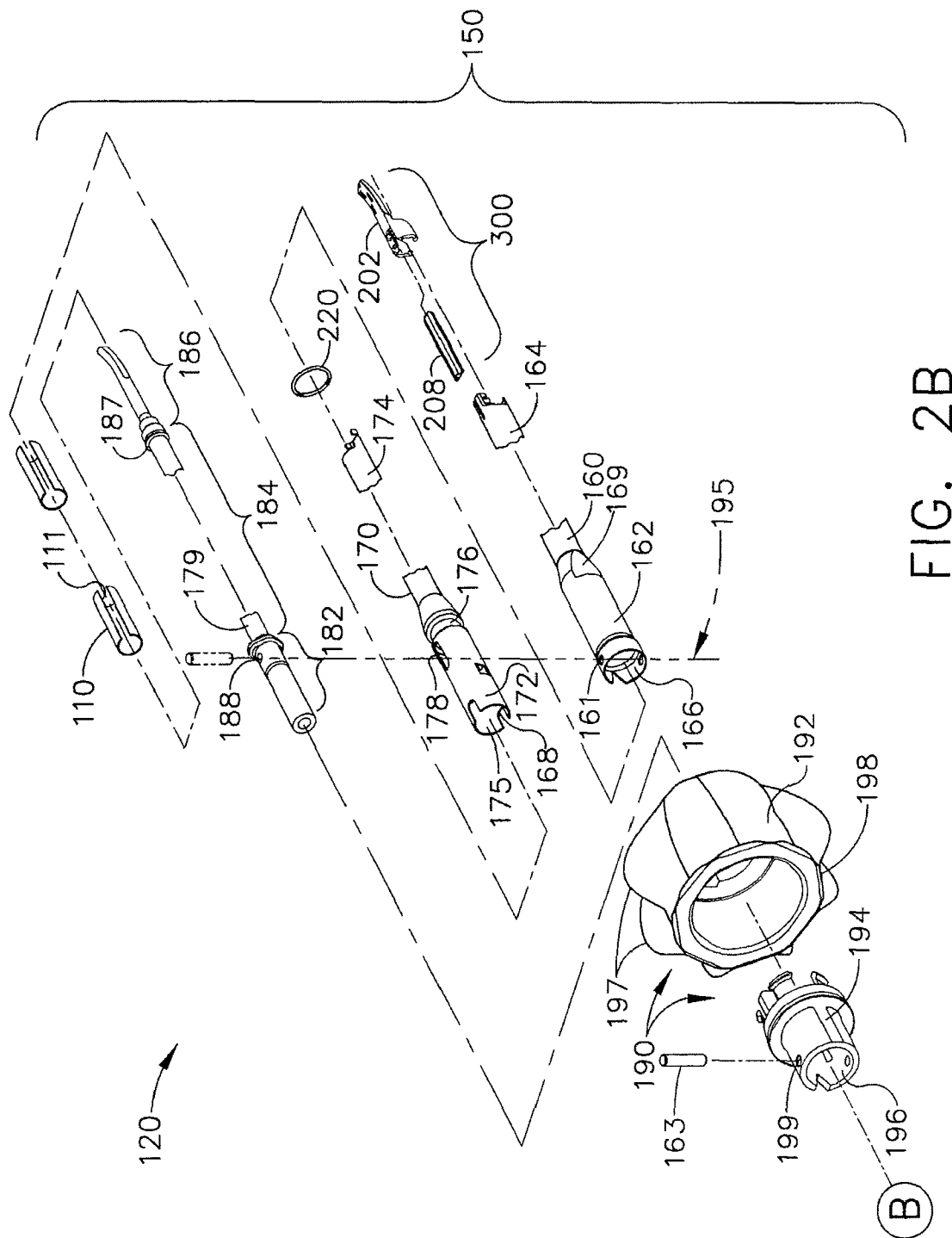

FIG. 1





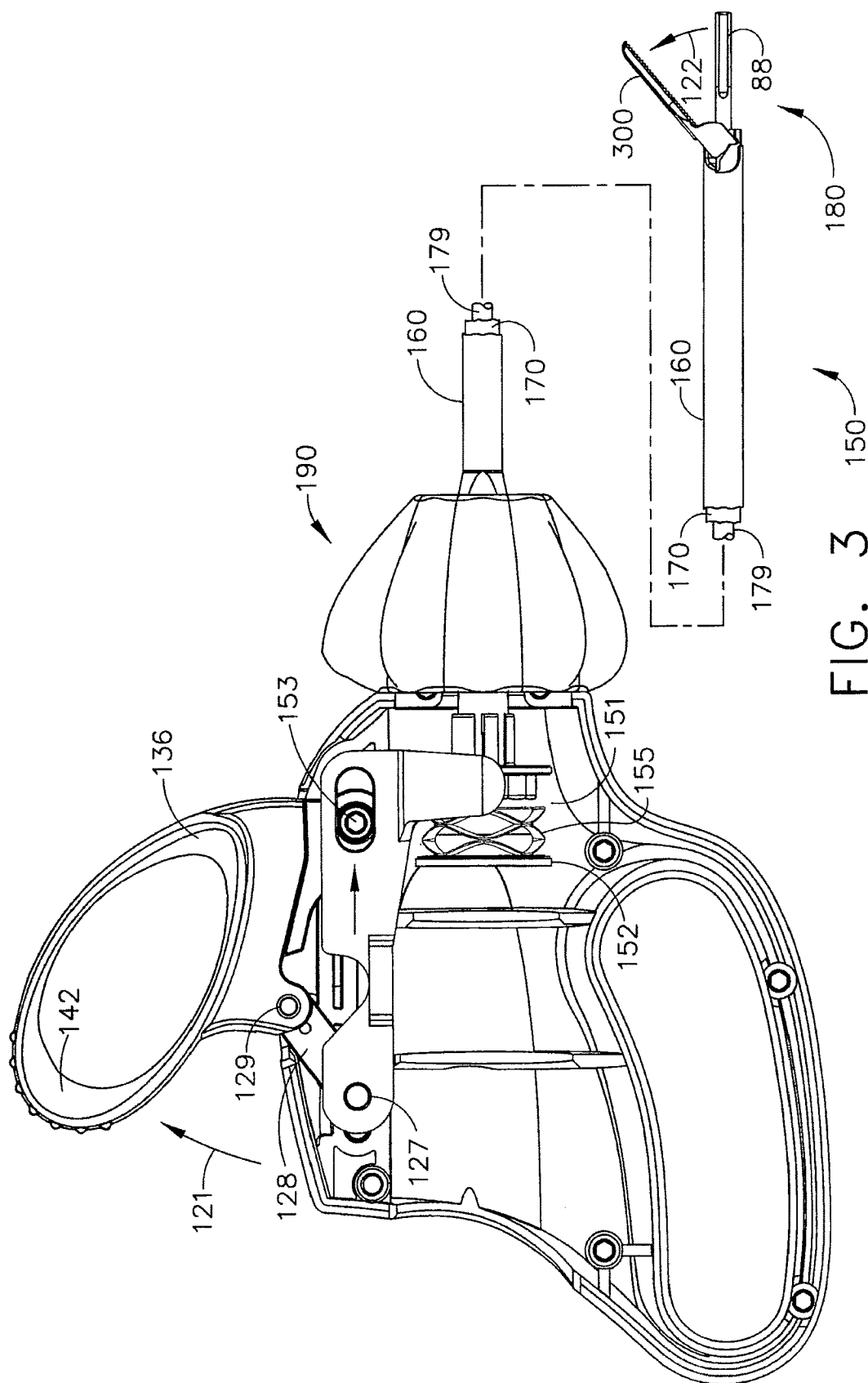

FIG. 3 150

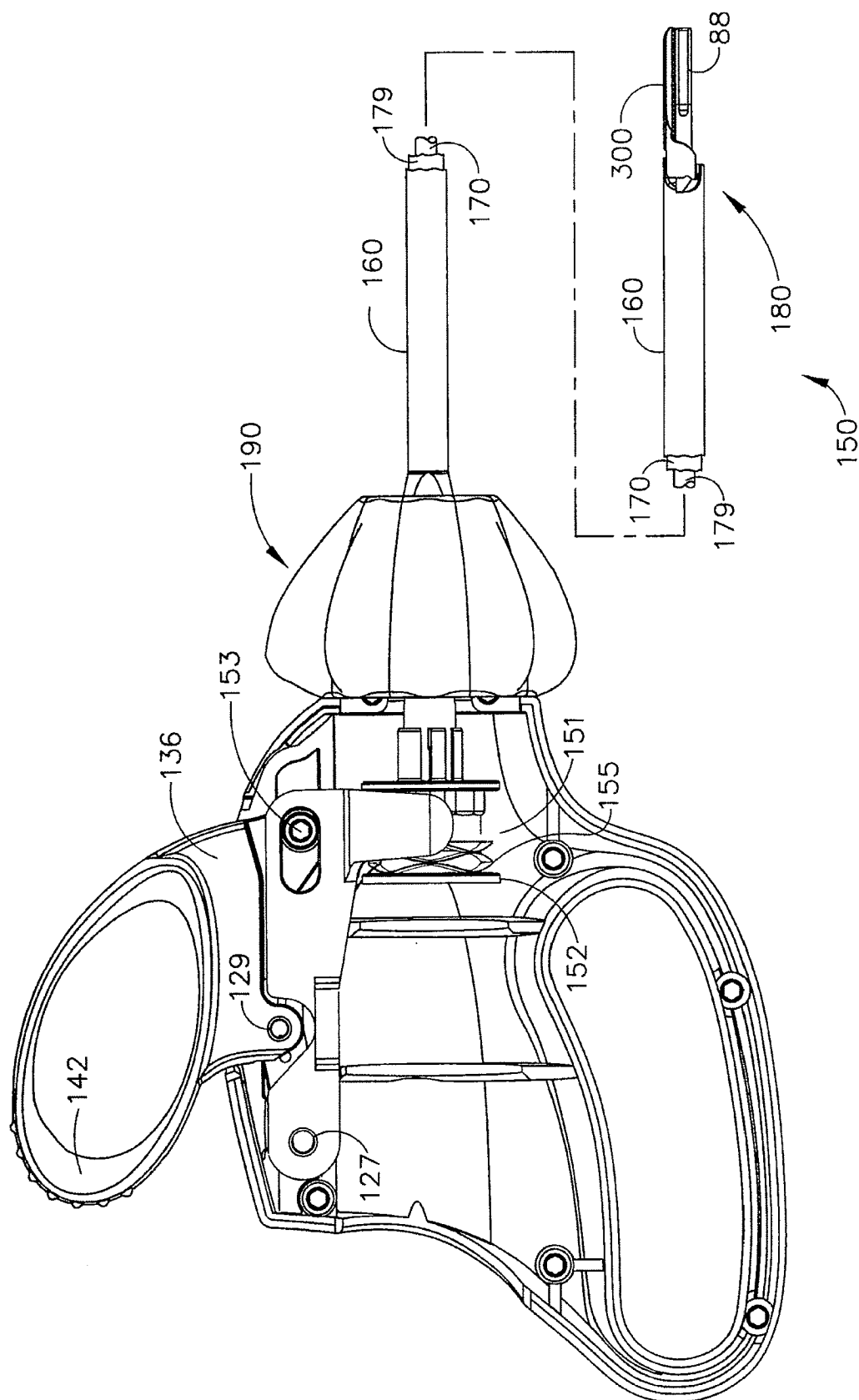

FIG. 4

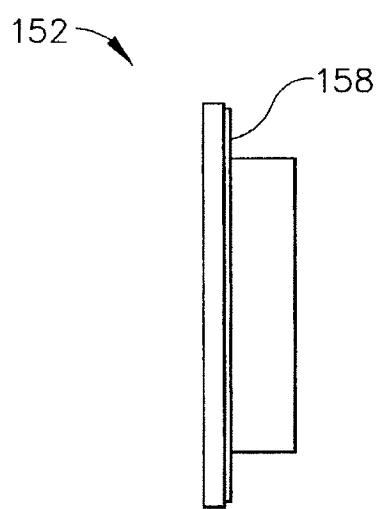

FIG. 5

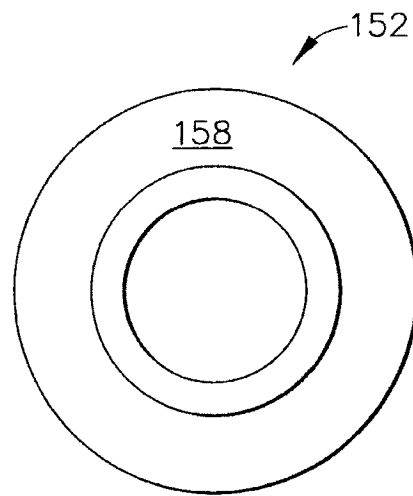

FIG. 6

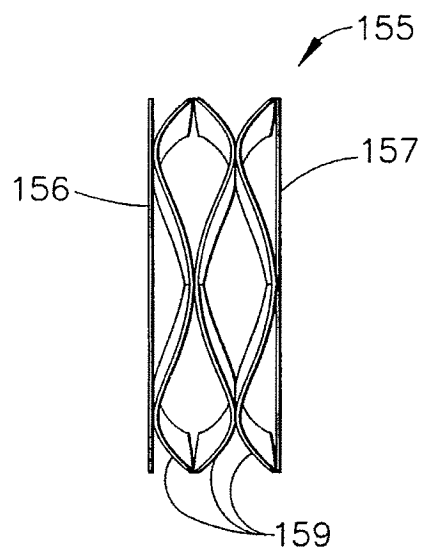

FIG. 7

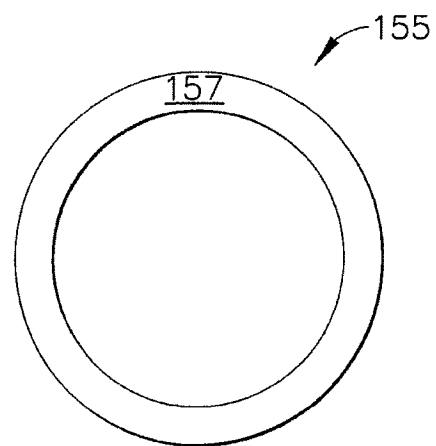

FIG. 8

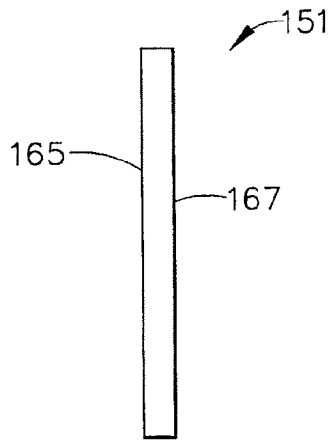

FIG. 9

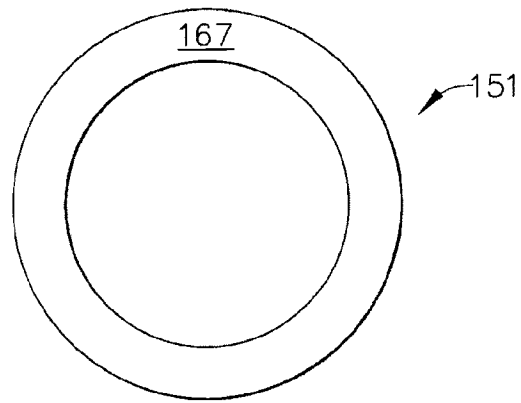

FIG. 10

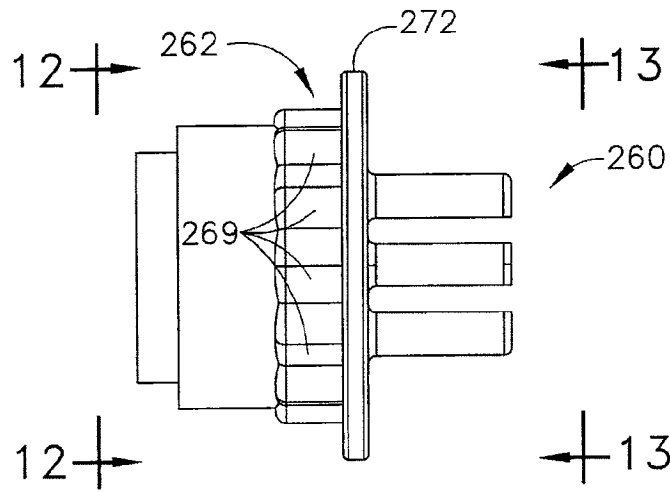

FIG. 11

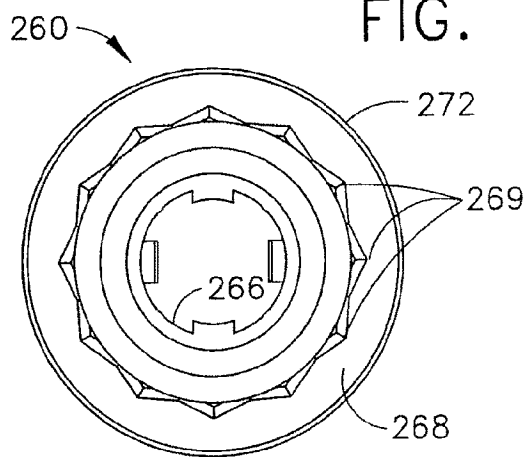

FIG. 12

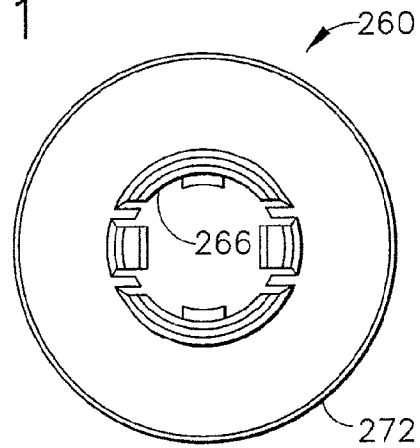

FIG. 13

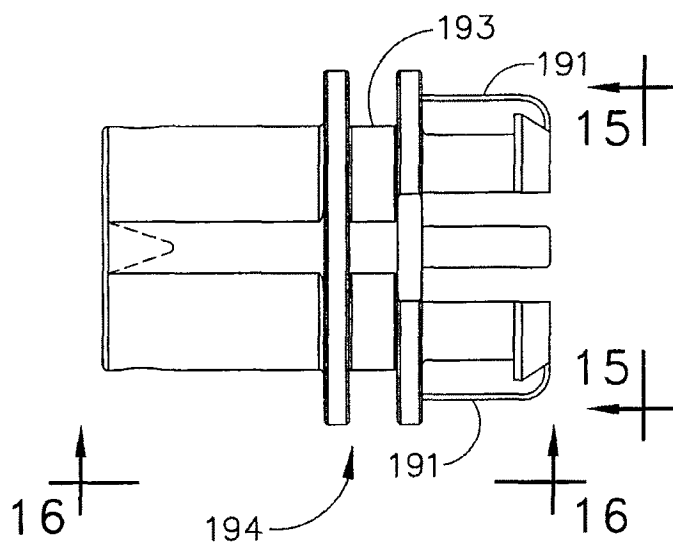

FIG. 14

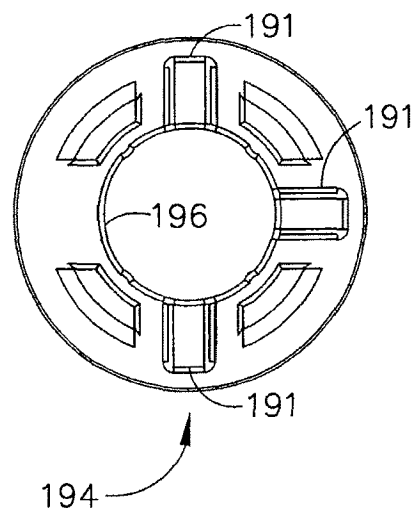

FIG. 15

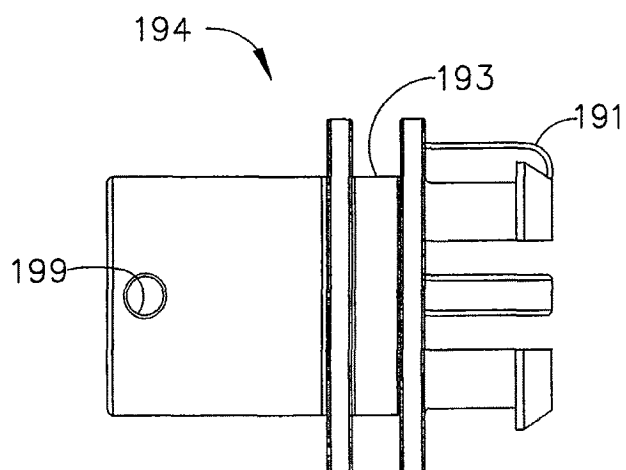

FIG. 16

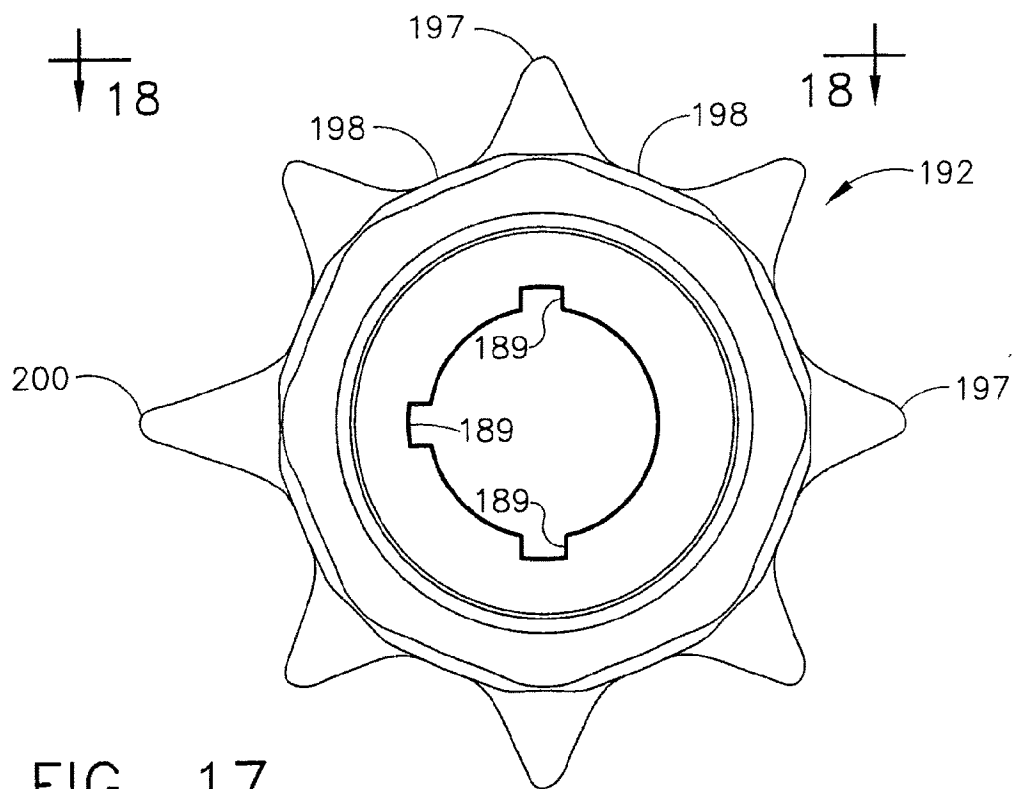

FIG. 17

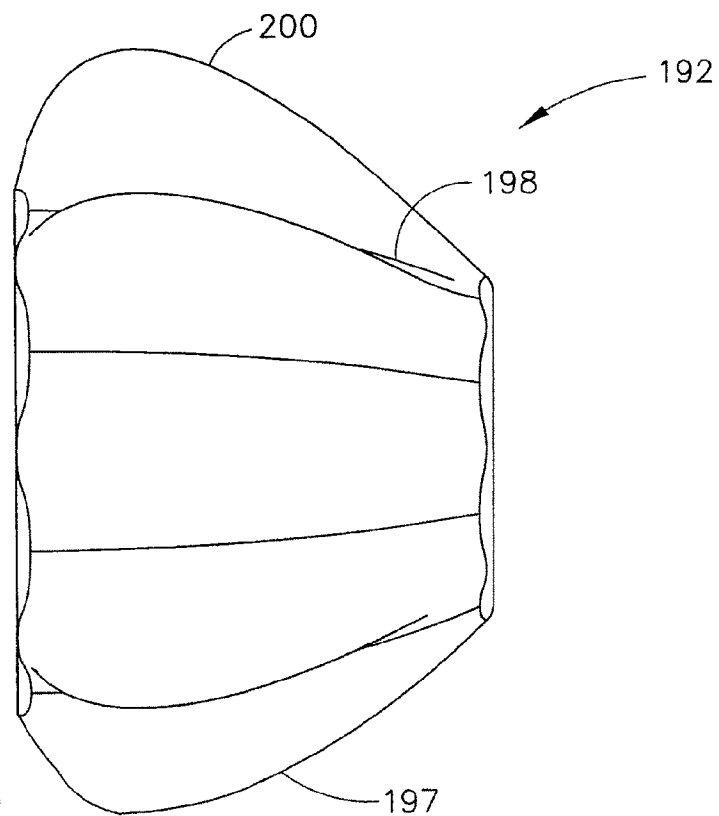

FIG. 18

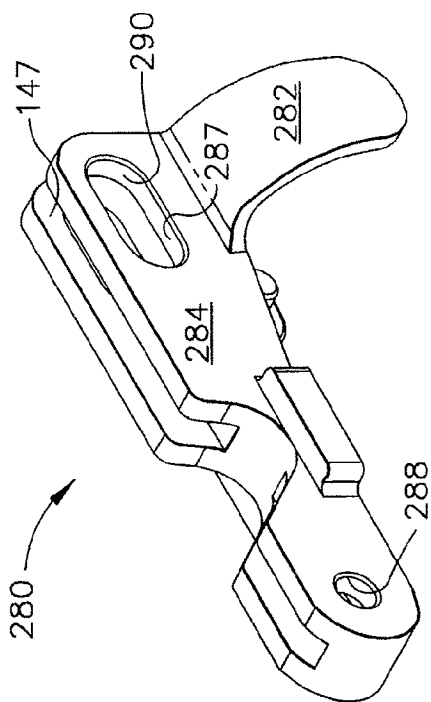

FIG. 19

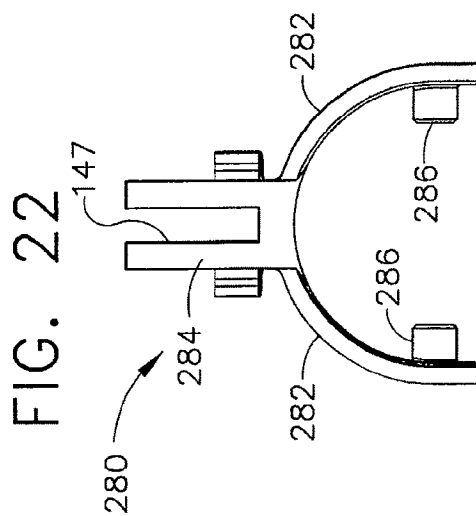

FIG. 20

FIG. 21

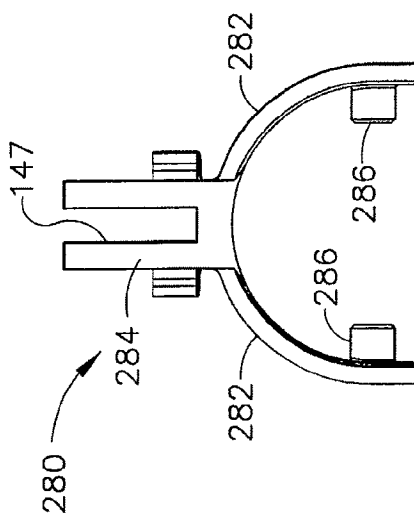

FIG. 22

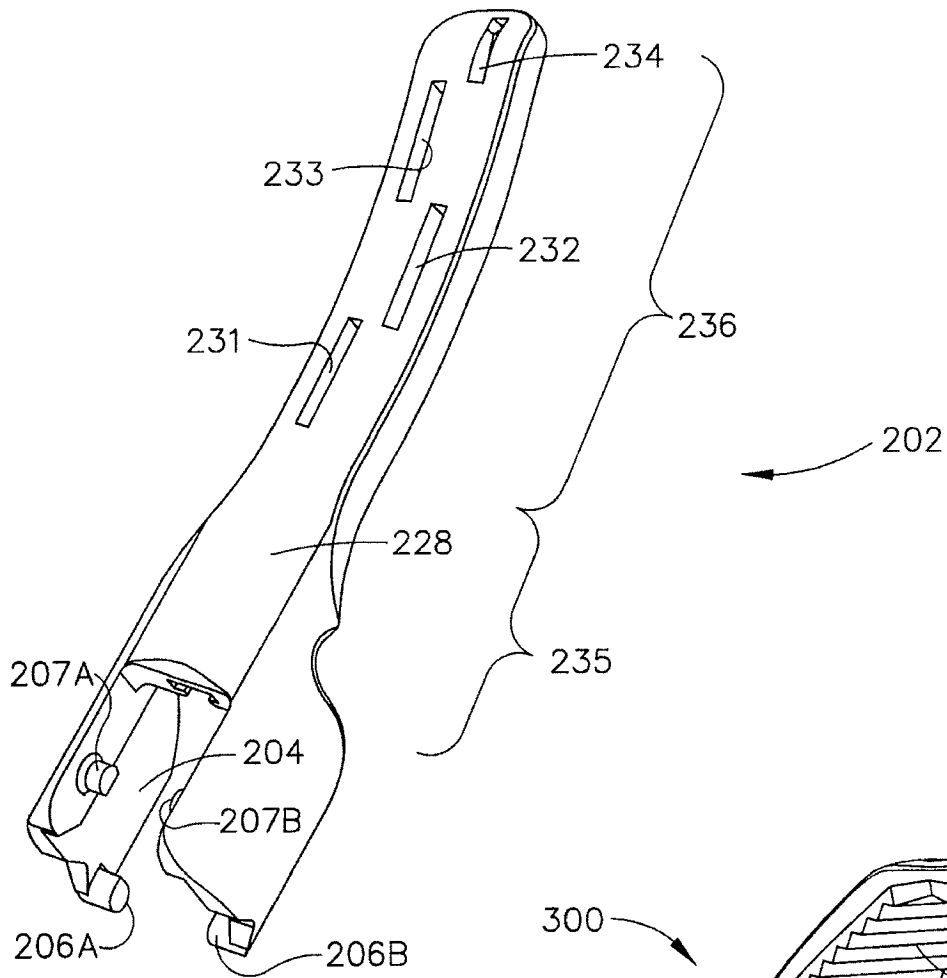

FIG. 24

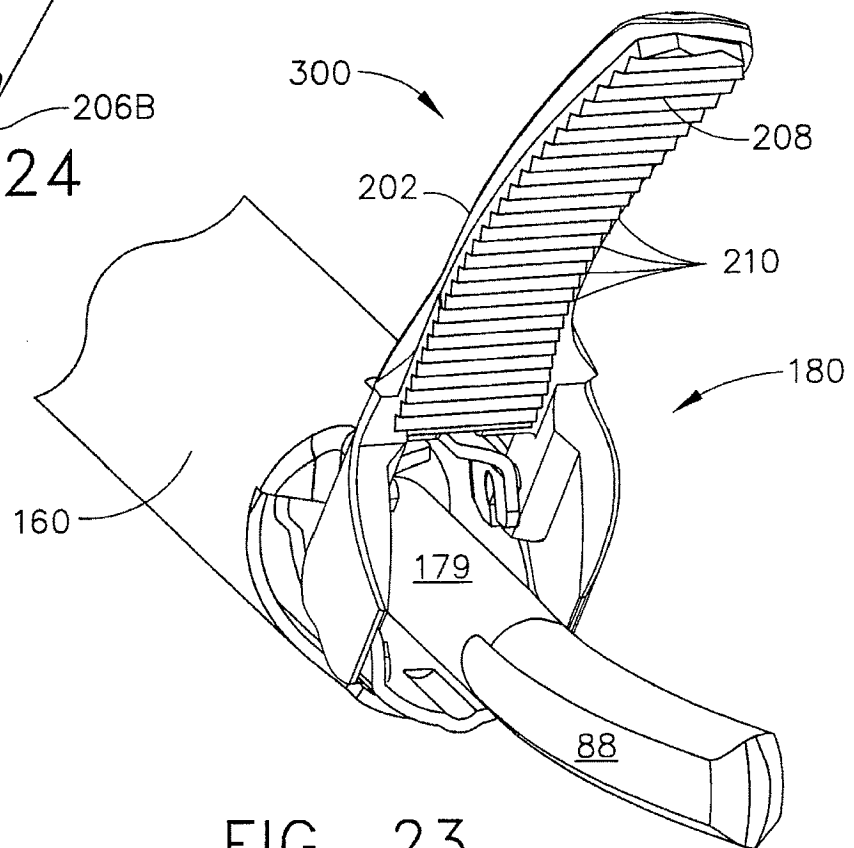

FIG. 23

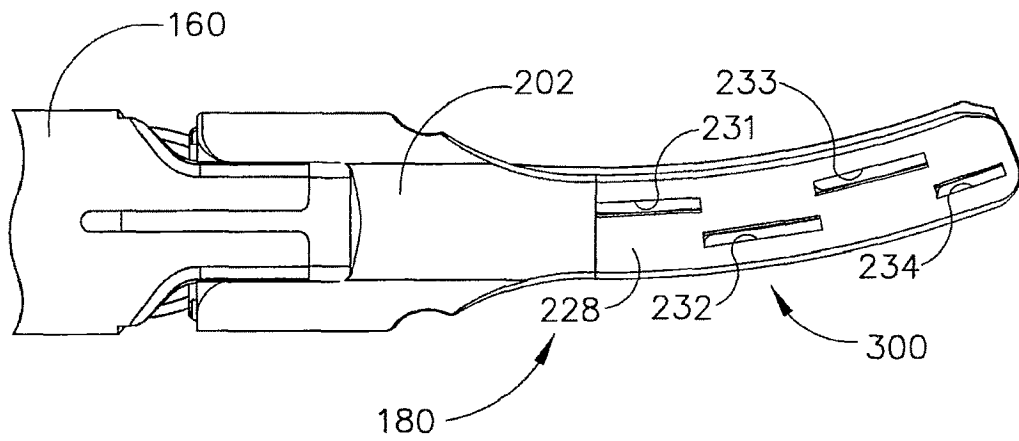

FIG. 25

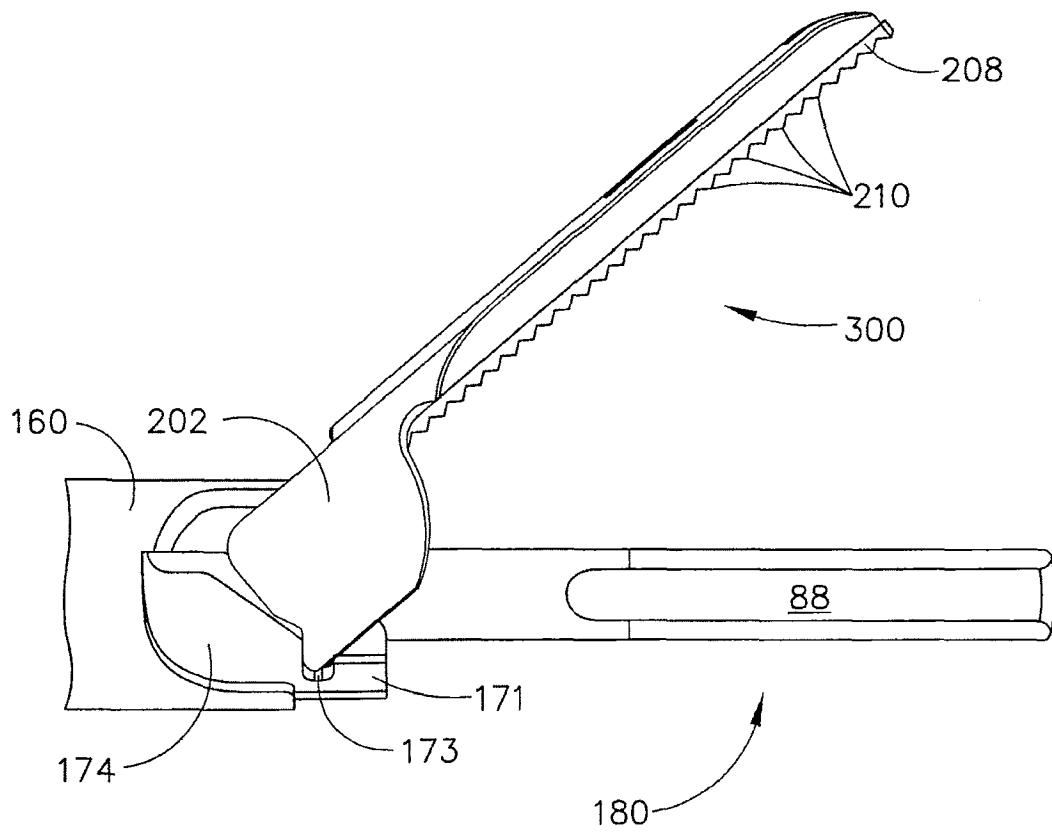

FIG. 26

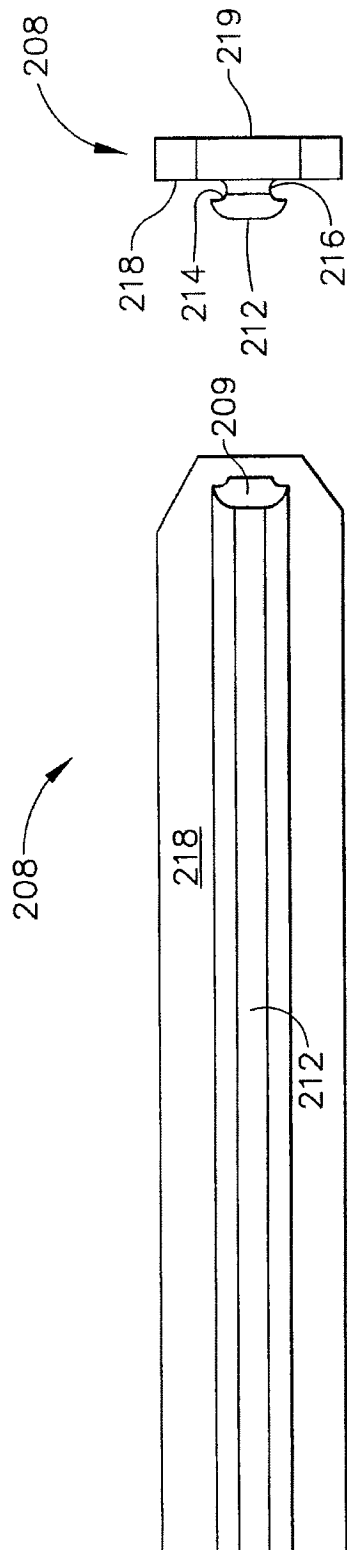

FIG. 27

FIG. 29

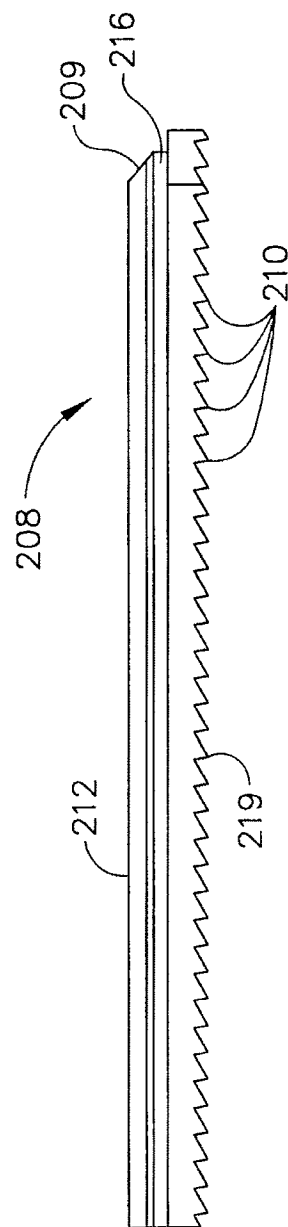
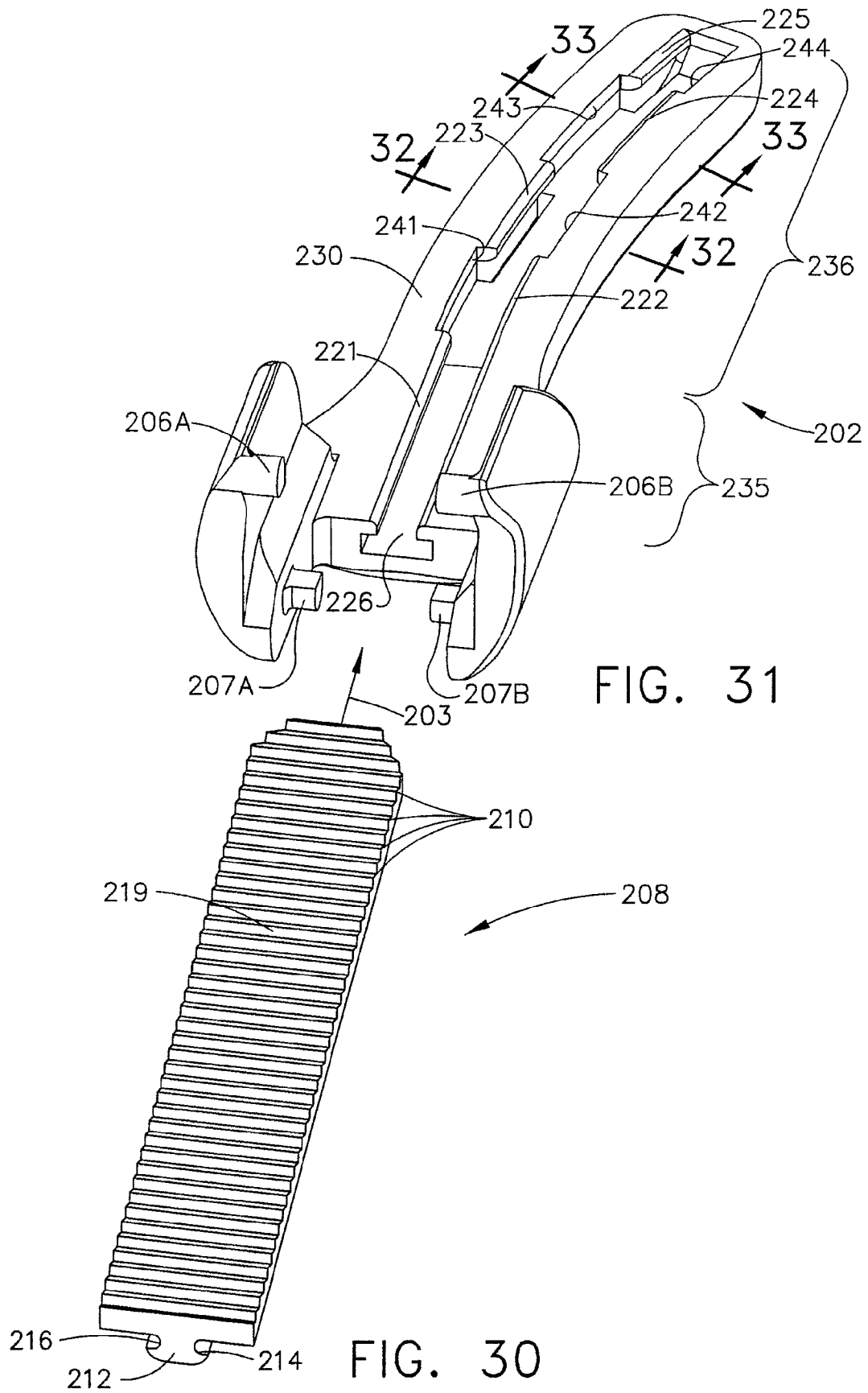

FIG. 28



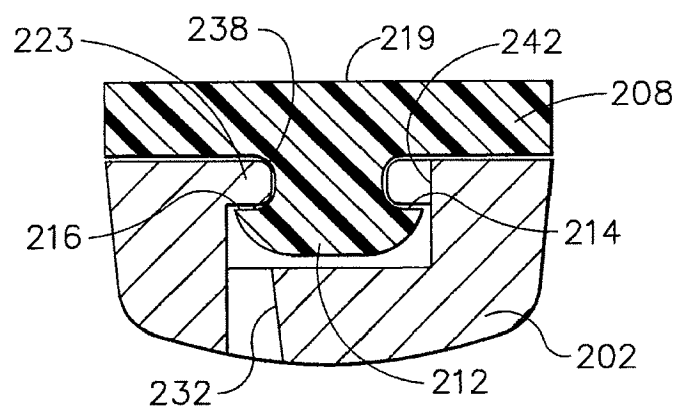

FIG. 32

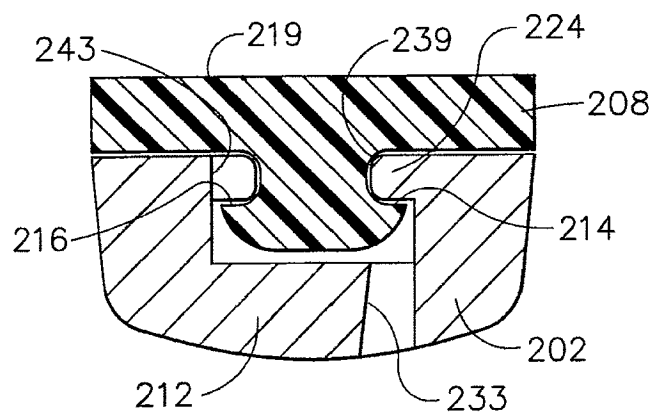

FIG. 33

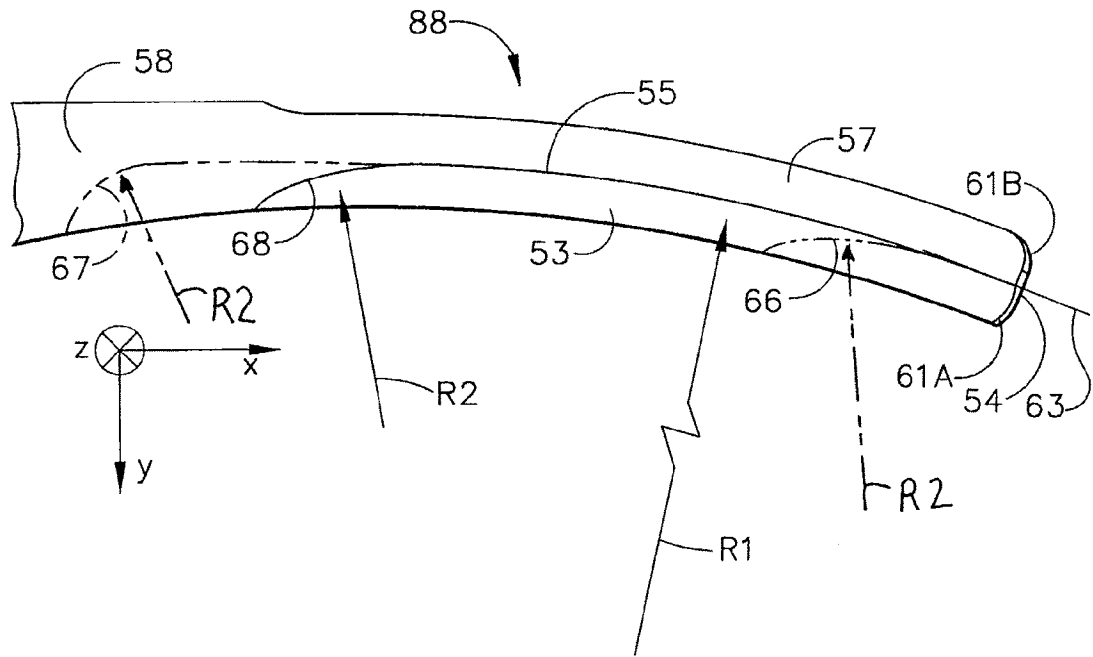

FIG. 34

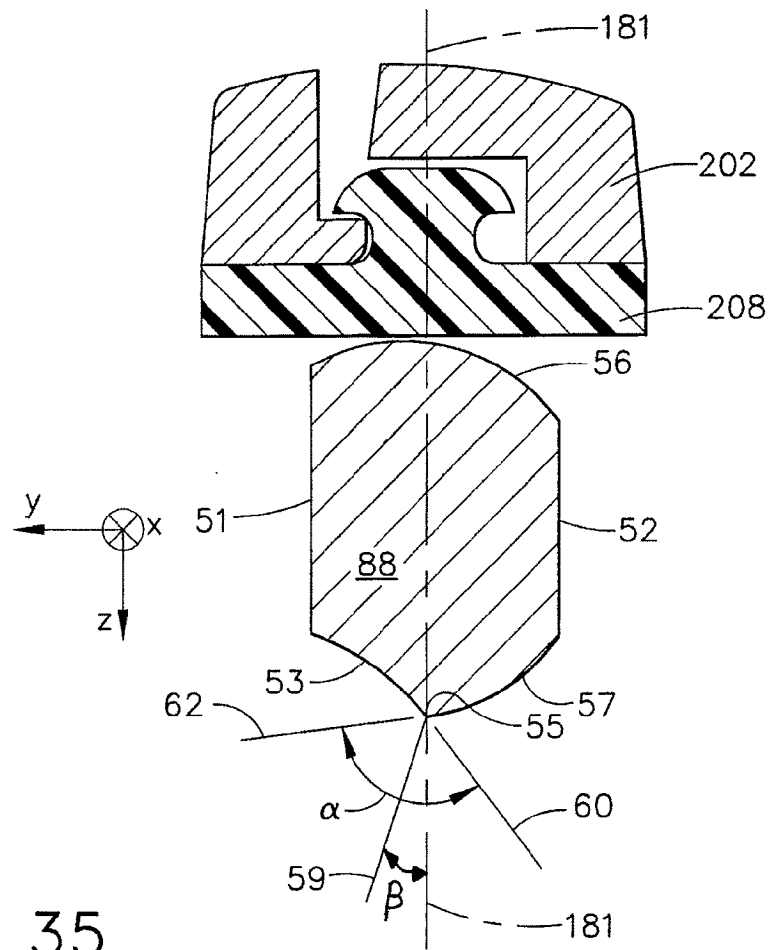

FIG. 35

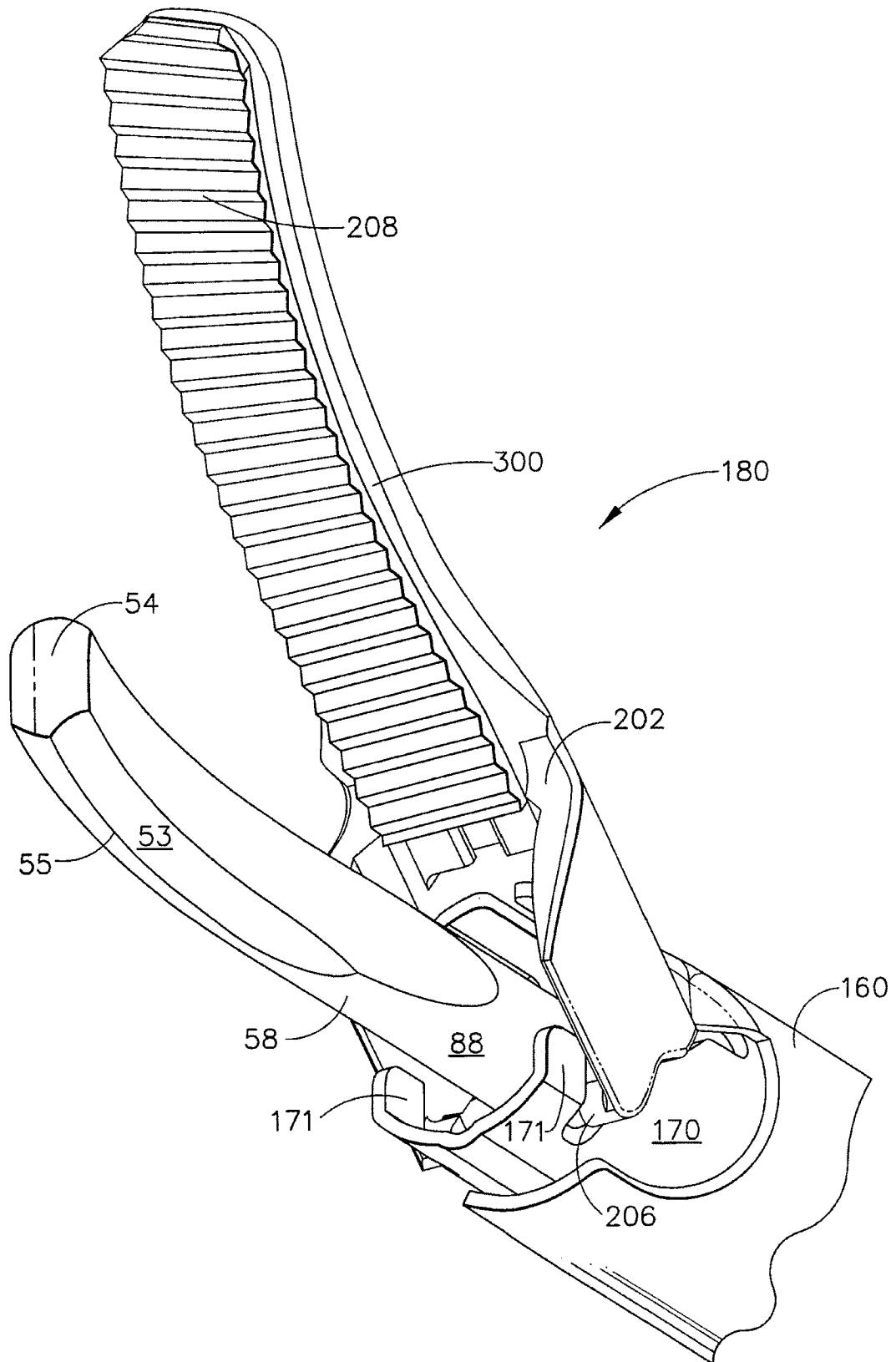

FIG. 36

REFERENCES CITED IN THE DESCRIPTION

This list of references cited by the applicant is for the reader's convenience only. It does not form part of the European patent document. Even though great care has been taken in compiling the references, errors or omissions cannot be excluded and the EPO disclaims all liability in this regard.

Patent documents cited in the description

- US 08948625 B [0002]
- WO 08949133 A [0002]
- US 09106686 B [0002]
- US 09337077 B [0002]
- US 09412557 B [0002]
- US 09412996 B [0002]
- WO 09413225 A [0002]
- US 5263957 A [0006]
- US 3636943 A [0007]
- US 3862630 A, Balamuth [0007]
- US 5322055 A [0008] [0015]
- US 5893835 A [0008]
- US 106686 A [0009] [0011] [0085]
- US 5938633 A [0015]
- US 5935144 A [0015]
- US 5944737 A [0015]
- US 5630420 A [0015]
- US 5449370 A [0015]
- US 5059210 A [0046]
- US 5057119 A [0046]
- US 808652 A [0062]
- US 5776155 A [0092]

专利名称(译)	具有功能平衡不对称的刀片用于超声外科手术器械		
公开(公告)号	EP2322106A2	公开(公告)日	2011-05-18
申请号	EP2010178865	申请日	2000-09-08
[标]申请(专利权)人(译)	伊西康内外科公司		
申请(专利权)人(译)	爱惜康内镜手术，INC.		
当前申请(专利权)人(译)	爱惜康内镜手术，INC.		
[标]发明人	MESSERLY JEFFREY D		
发明人	MESSERLY, JEFFREY D.		
IPC分类号	A61B17/32 A61B17/3201 A61B17/28 A61B18/00		
CPC分类号	A61B17/2816 A61B17/320092 A61B2017/2825 A61B2017/2929 A61B2017/320075 A61B2017/320093 A61B2017/320094 A61B2017/320095		
代理机构(译)	FISHER, ADRIAN JOHN		
优先权	09/412257 1999-10-05 US		
其他公开文献	EP2322106A3		
外部链接	Espacenet		

摘要(译)

公开了一种超声外科手术器械，其结合了末端执行器几何形状以最佳地实现剪切型构造的多种功能。刀片的形状的特征在于偏角切割偏移一定距离以形成弯曲几何形状。切口形成具有多个不对称的弯曲表面，导致刀片内的多个不平衡。由于仪器曲线引起的不平衡通过功能不对称附近的非功能性不对称来校正。通过适当选择从功能不对称中移除的材料体积和位置来校正由于叶片的不对称横截面引起的不平衡。在本发明的一个实施例中，叶片的形状的特征在于两个圆角切口偏移一定距离以形成弯曲且可能锥形的几何形状。这两个切口形成曲面，包括凹面和凸面。圆角切口的长度部分地影响由弯曲形状引起的横向运动的声学平衡。

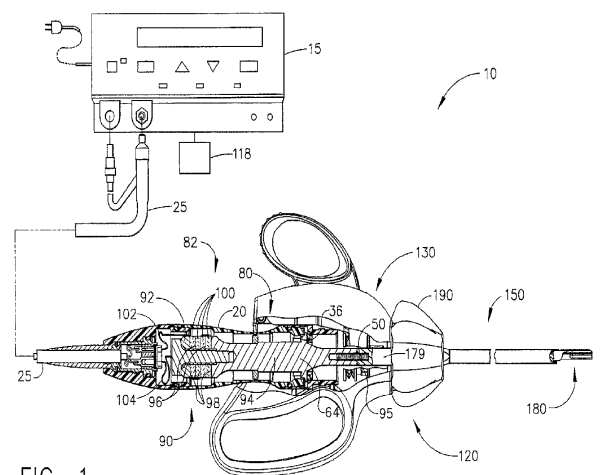

FIG. 1