



(12) **Patent Application Publication**
Holsten et al.

(43) **Pub. Date:** **Feb. 15, 2007**

Related U.S. Application Data

(63) Continuation of application No. 11/204,060, filed on Aug. 15, 2005.

(75) Inventors: **Henry E. Holsten**, Southington, CT (US); **Frank J. Viola**, Sandy Hook, CT (US); **Clifford L. Emmons**, Oakville, CT (US)

Publication Classification

(51) **Int. Cl.**
A61B 17/04 (2006.01)

(52) **U.S. Cl.** 227/179.1

Correspondence Address:
UNITED STATES SURGICAL,
A DIVISION OF TYCO HEALTHCARE
GROUP LP
195 MCDERMOTT ROAD
NORTH HAVEN, CT 06473 (US)

(73) Assignee: **Tyco Healthcare Group LP**

(21) Appl. No.: 11/512,943

(22) Filed: **Aug. 29, 2006**

(57) **ABSTRACT**

A surgical stapling apparatus includes a staple cartridge and an anvil member. The staple cartridge includes a plurality of surgical fasteners disposed in rows of retention slots. The staple cartridge may have an annular or linear configuration of retention slots. The tissue contacting surface of the staple cartridge may be tapered or stepped. The anvil member has a tissue contacting surface that includes a number of pockets arranged for substantially aligning with the retention slots. In addition, the tissue contacting surface of the anvil member may complement the tissue contacting surface of the staple cartridge.

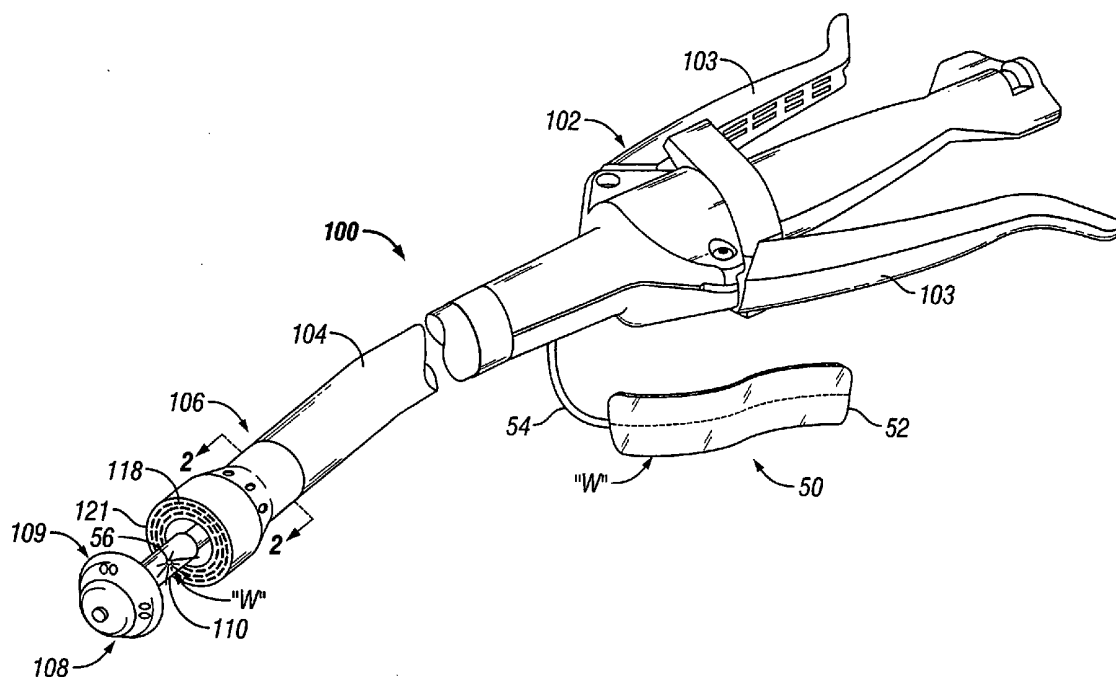

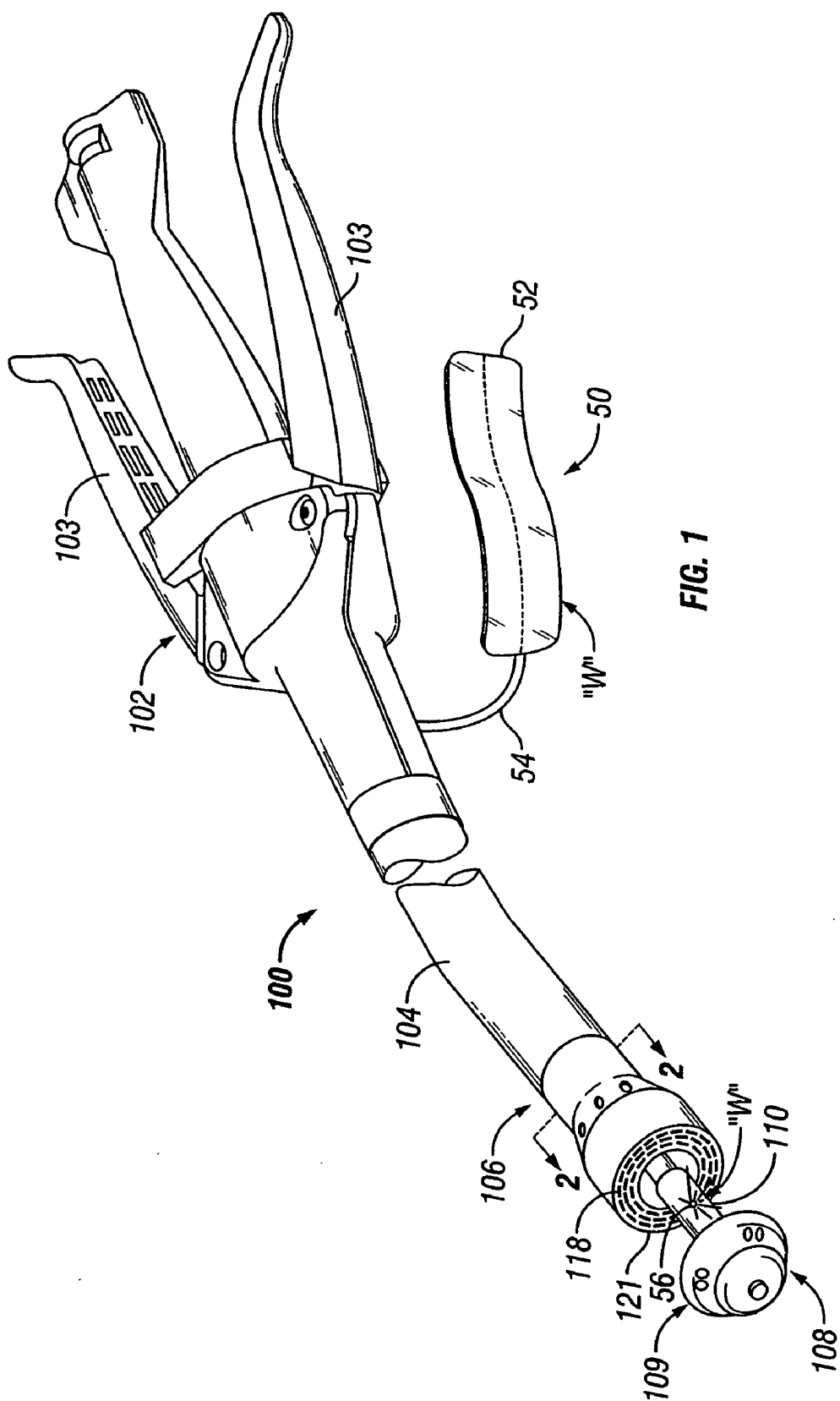

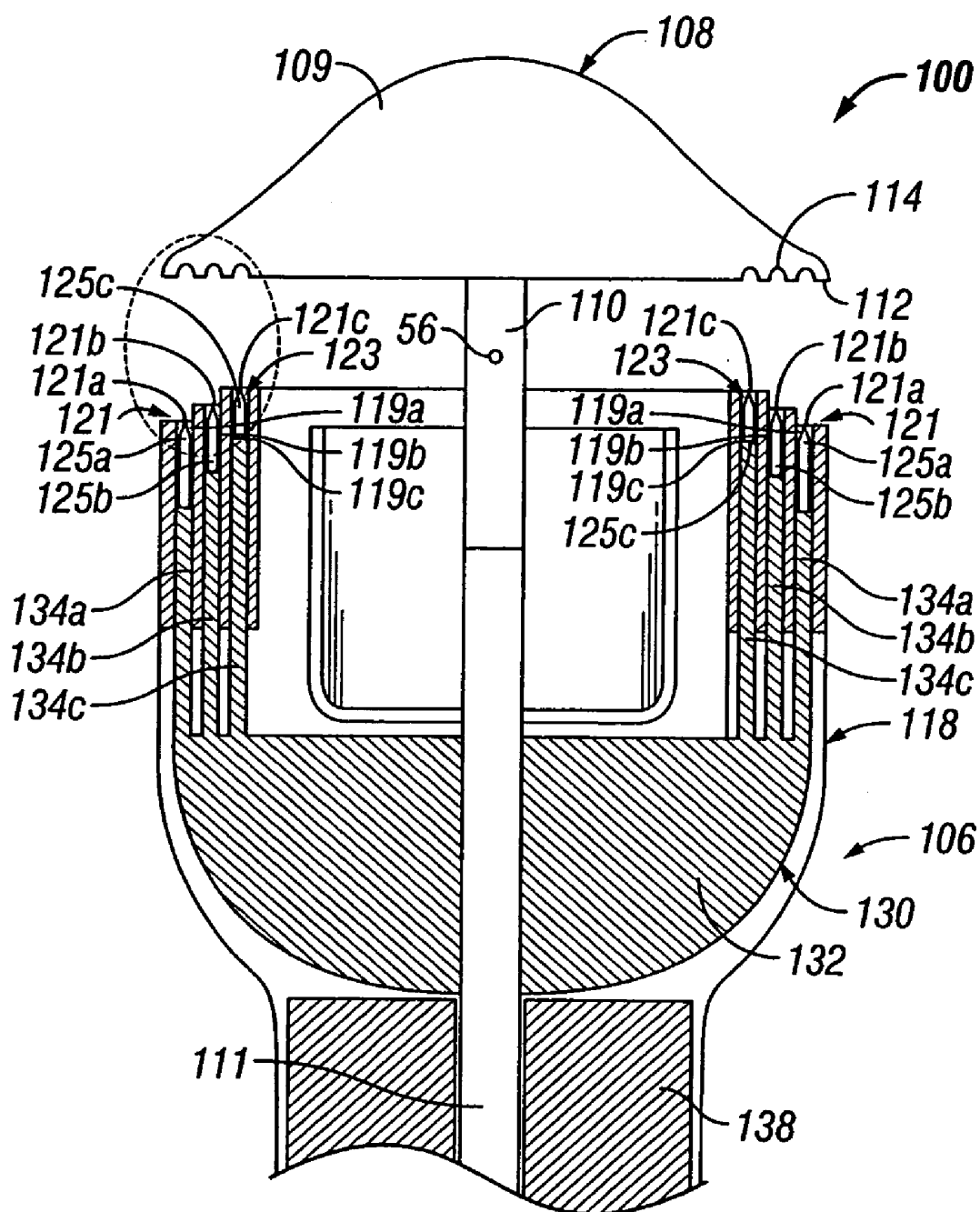

FIG. 2

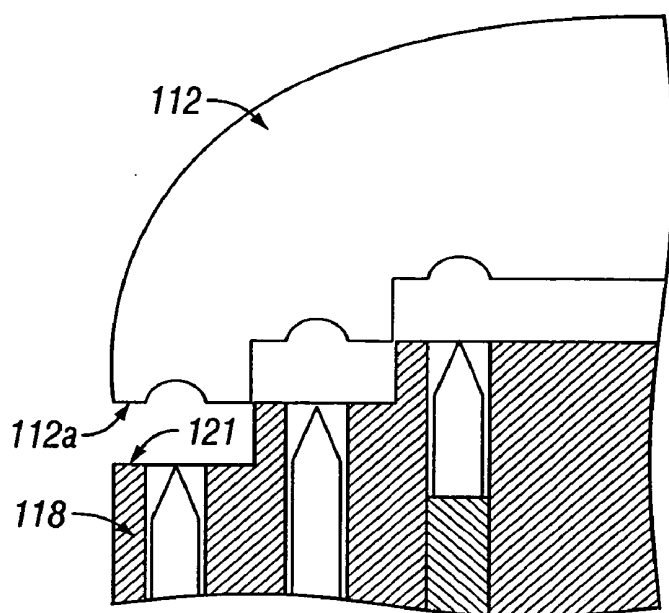

FIG. 3A

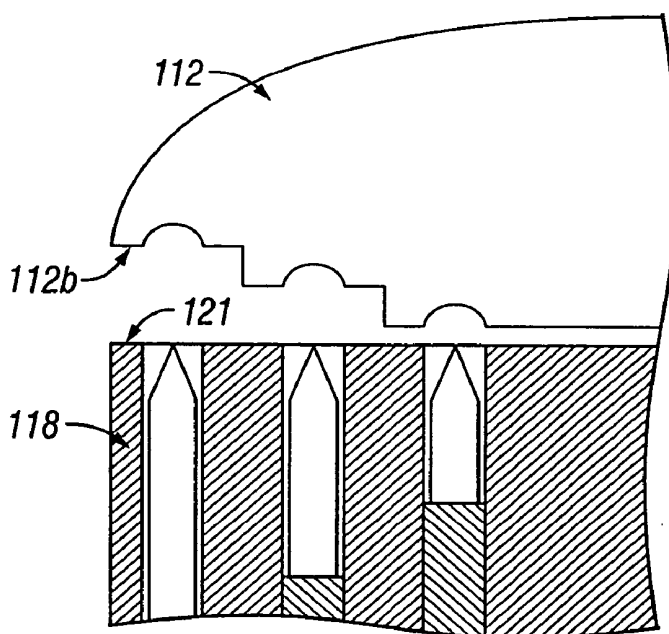

FIG. 3B

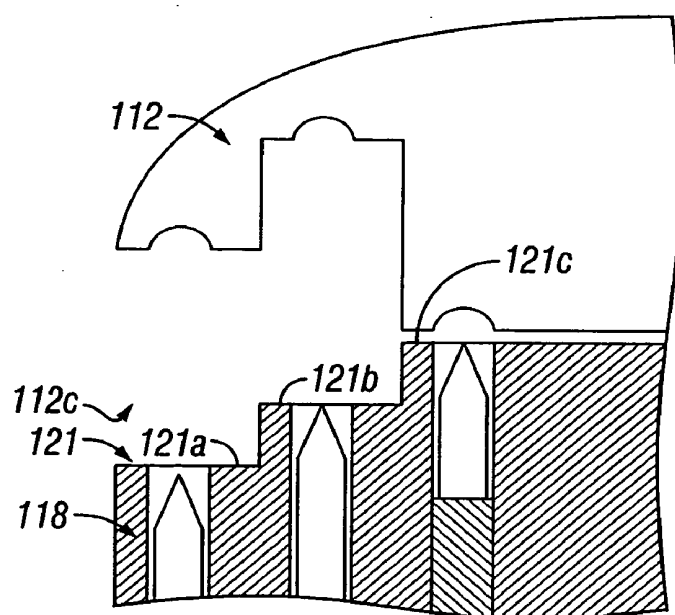

FIG. 3C

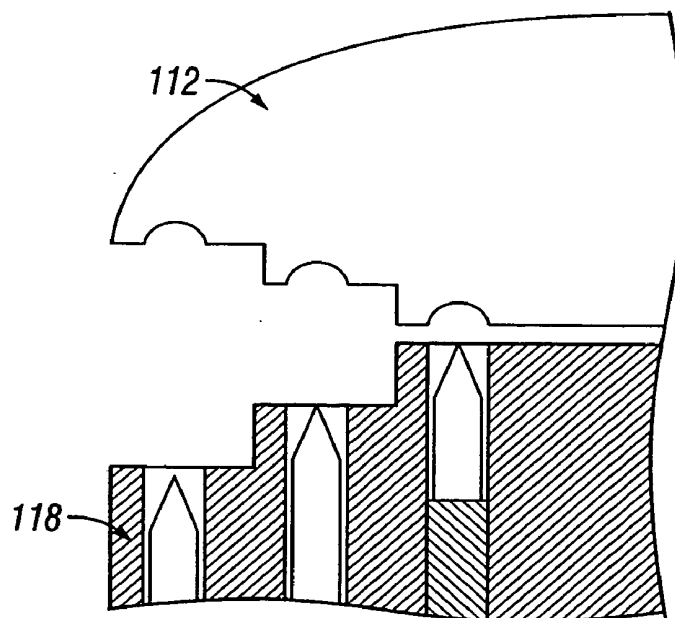
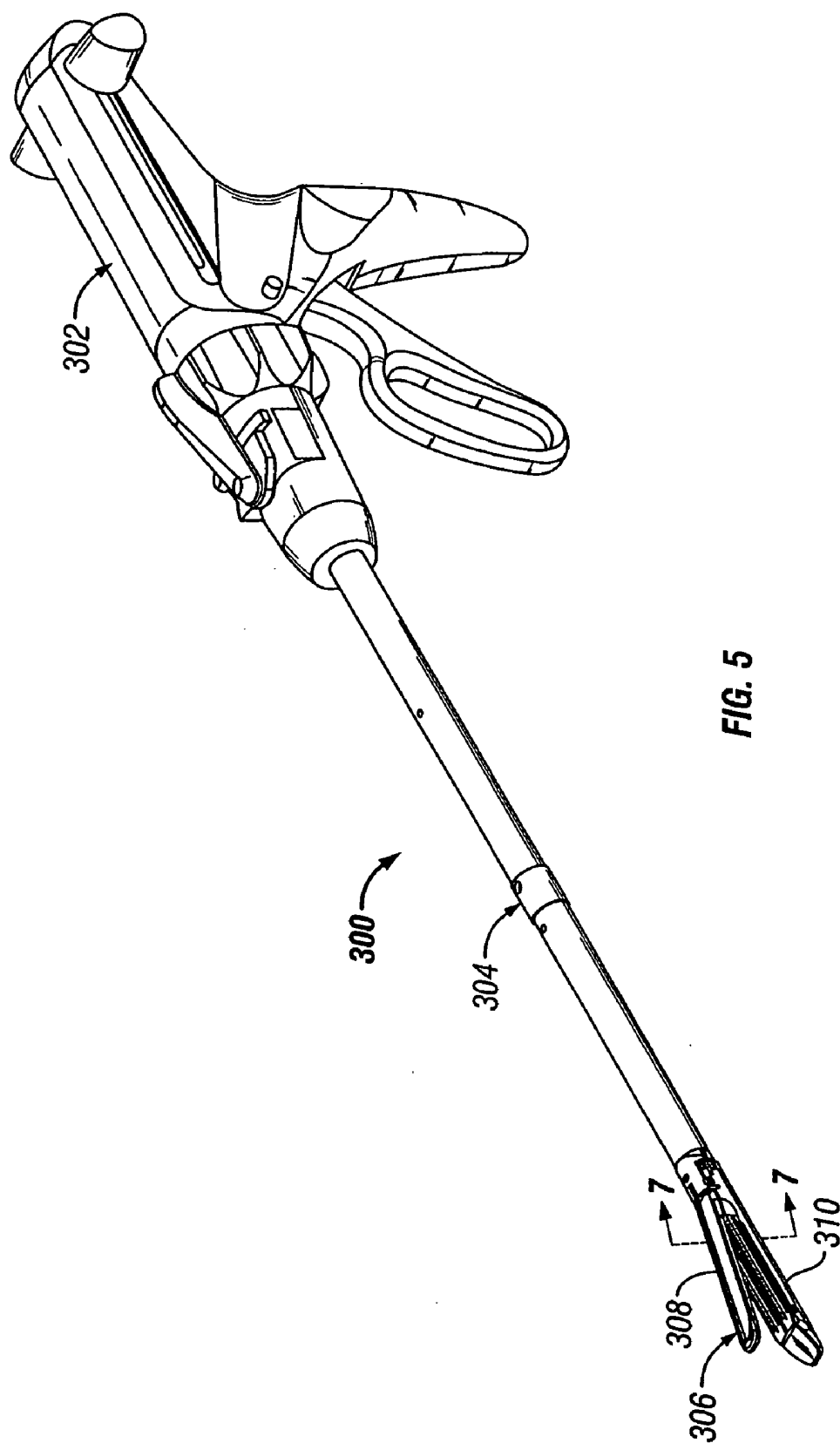

FIG. 3D



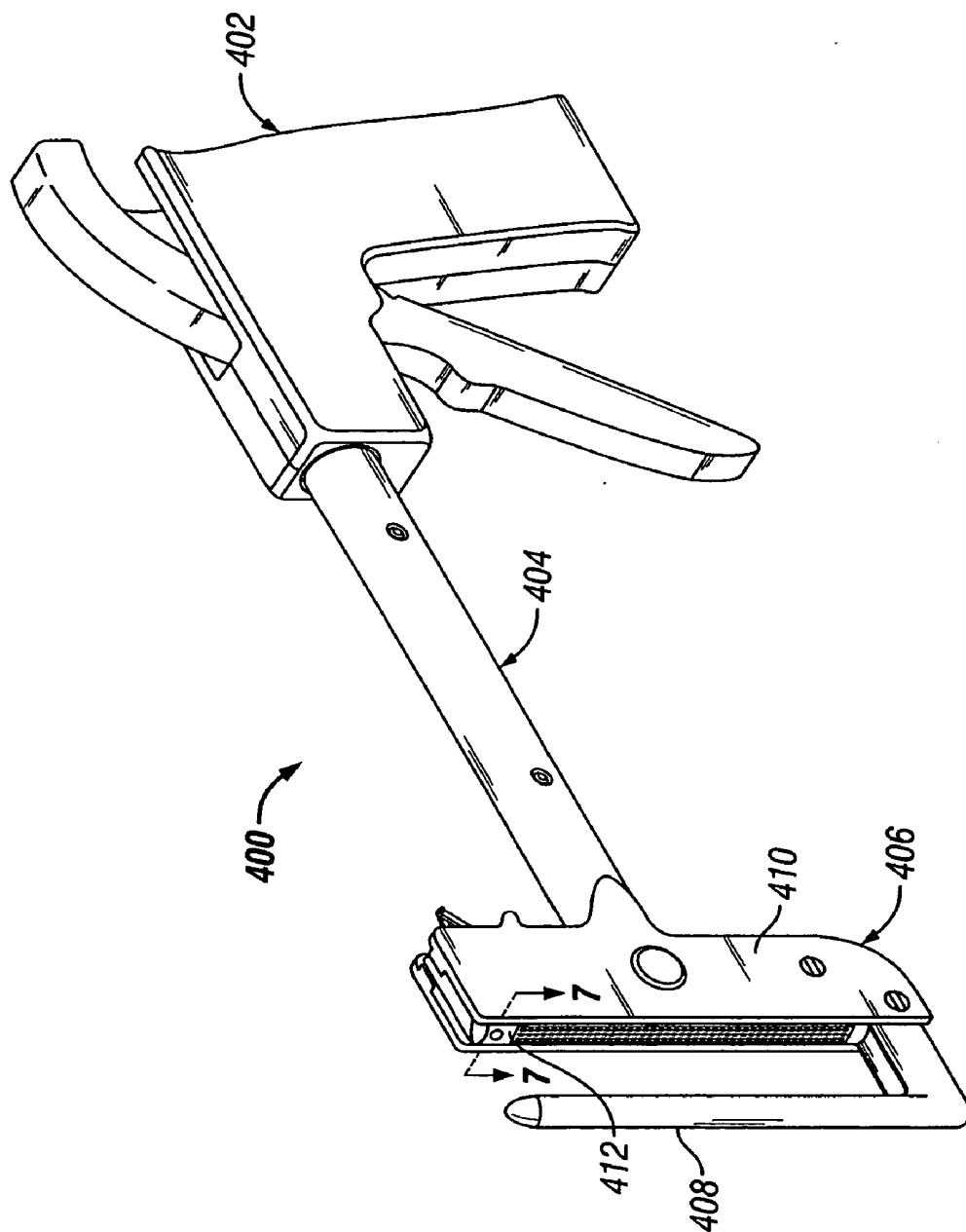

FIG. 6

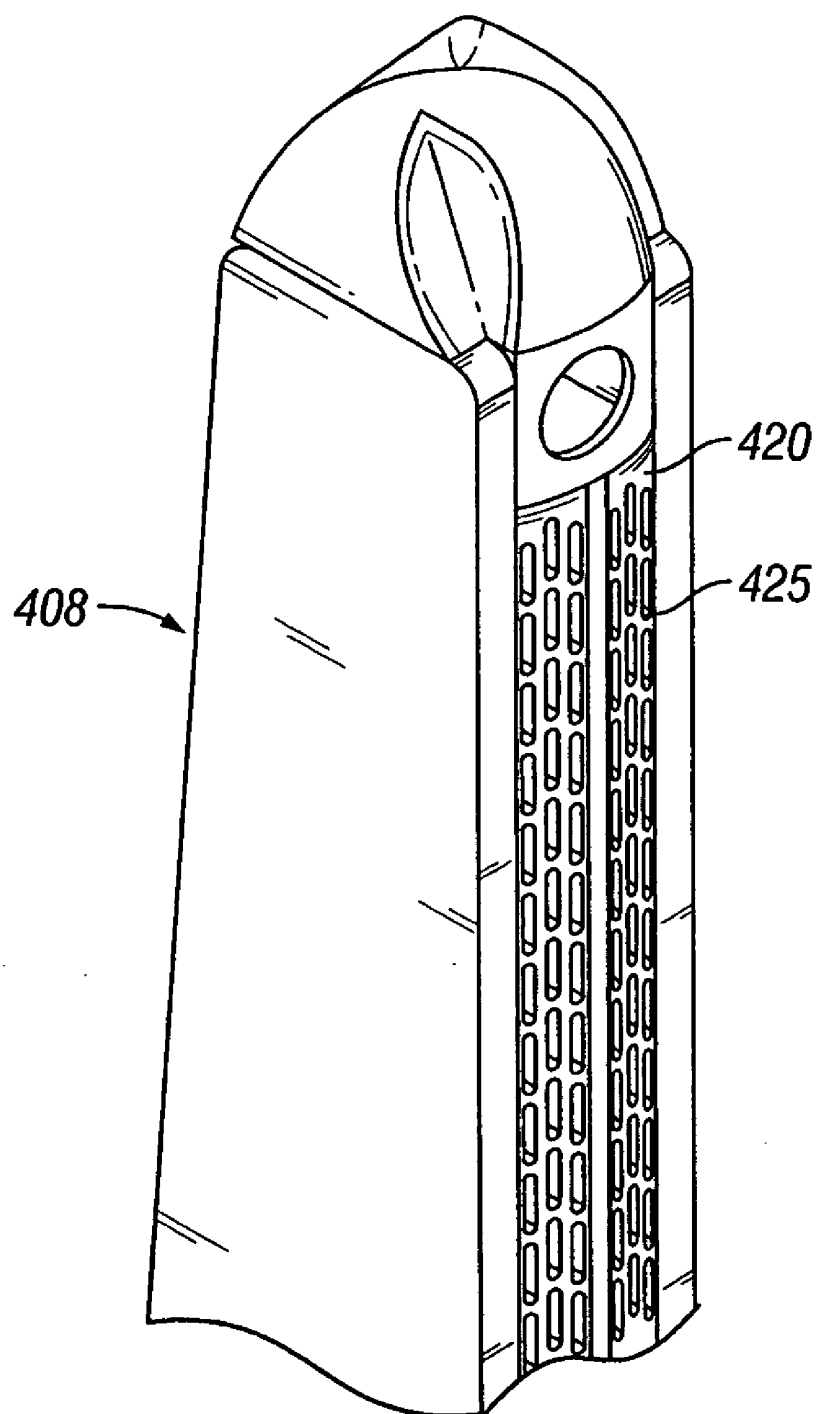

FIG. 6A

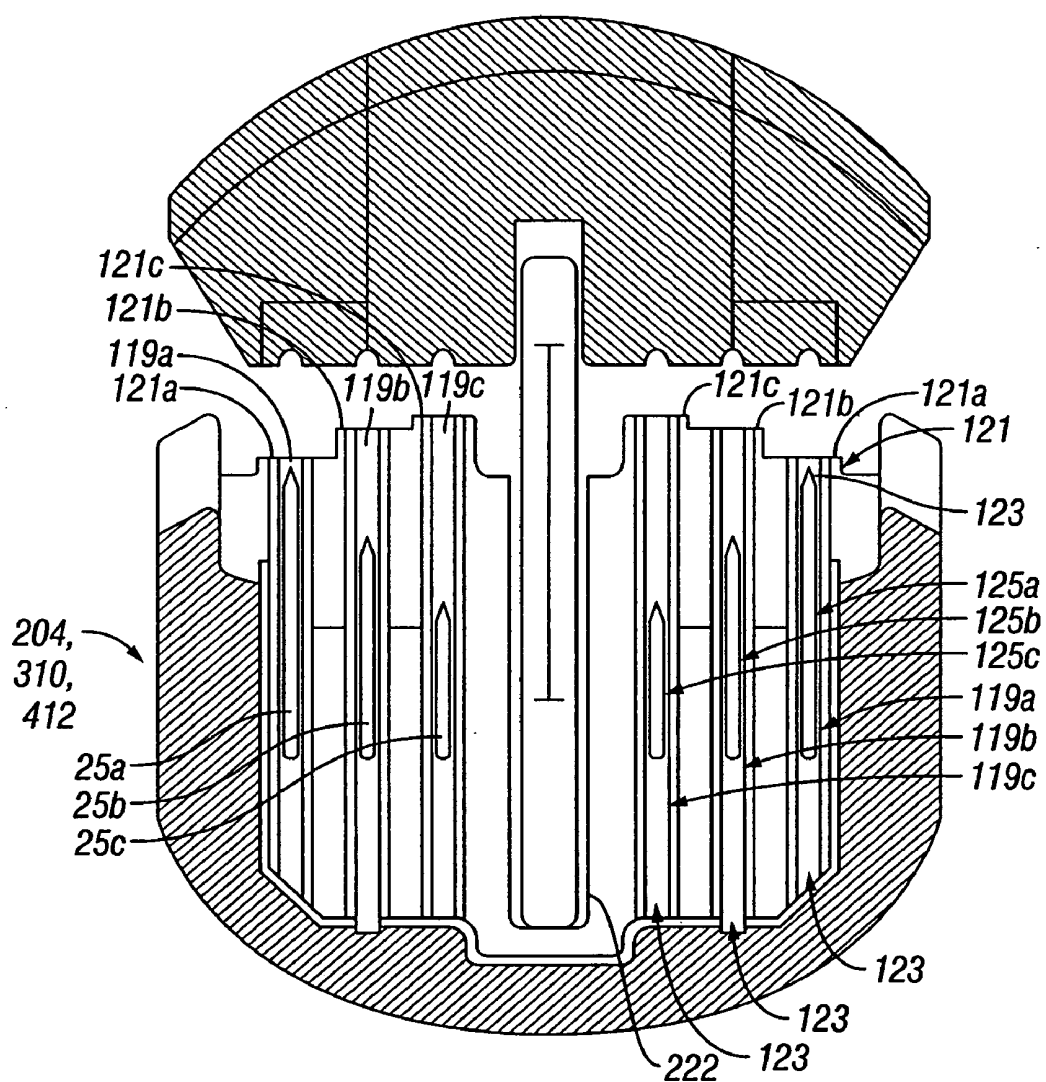

FIG. 7

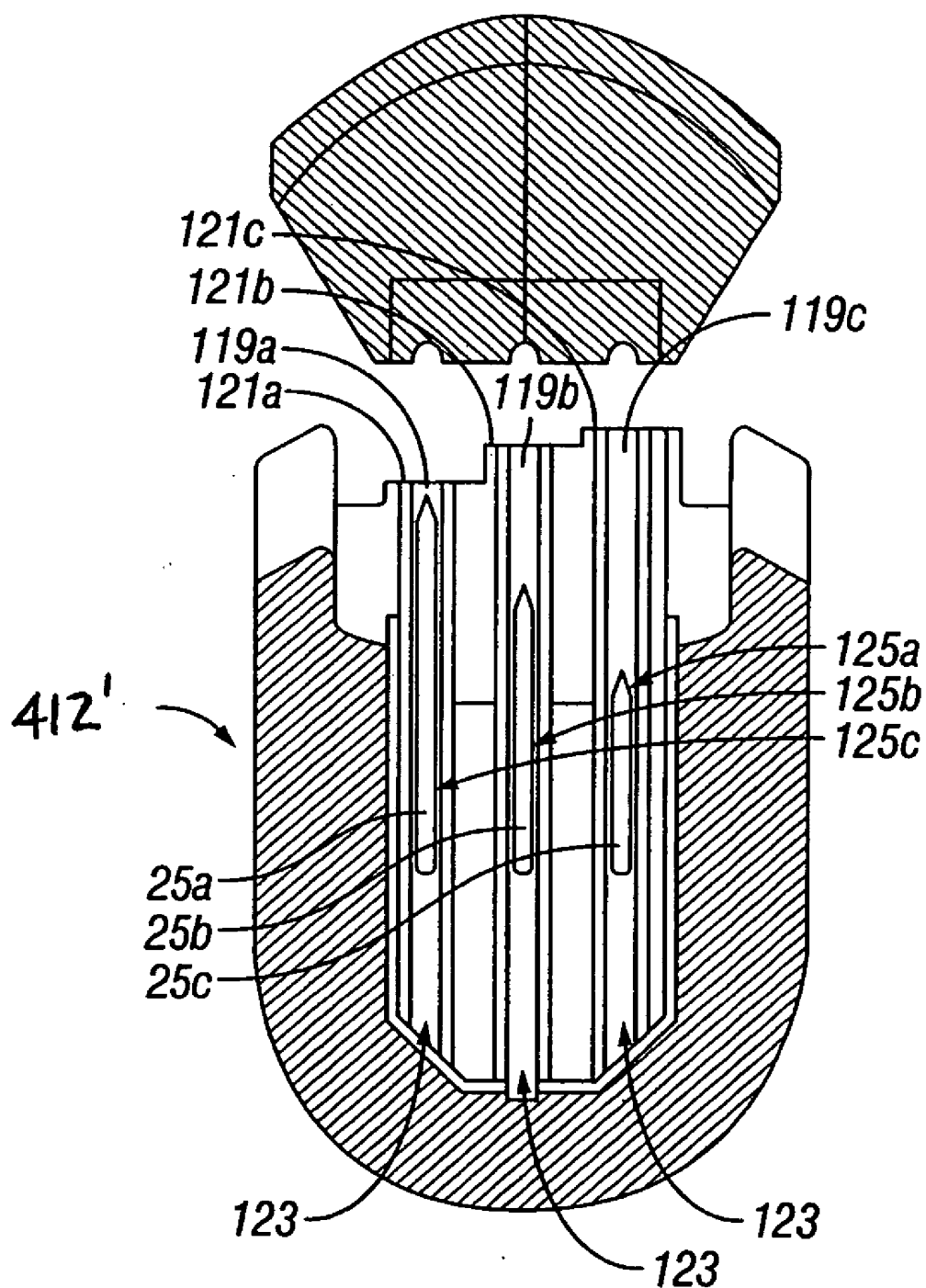

FIG. 7A

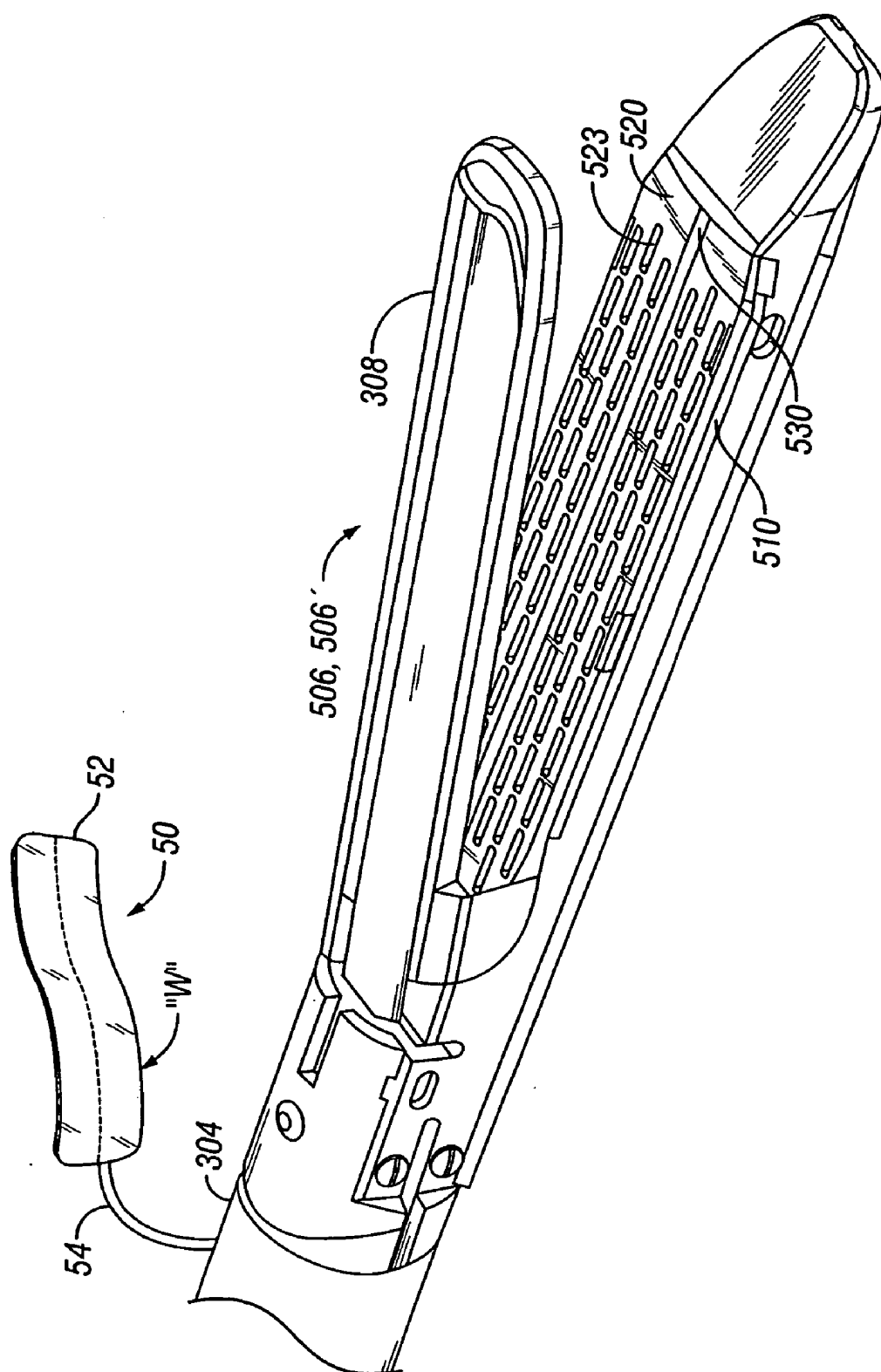

FIG. 8

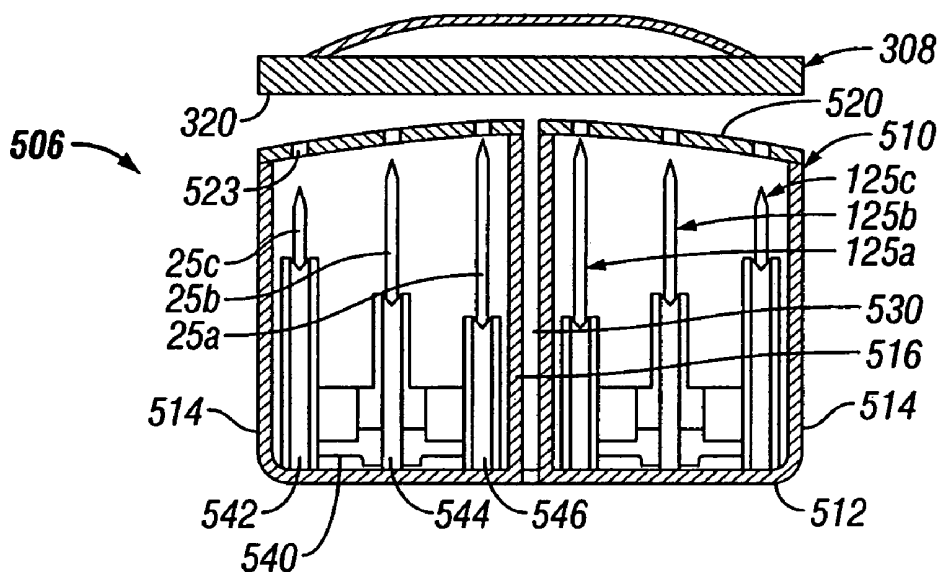

FIG. 9

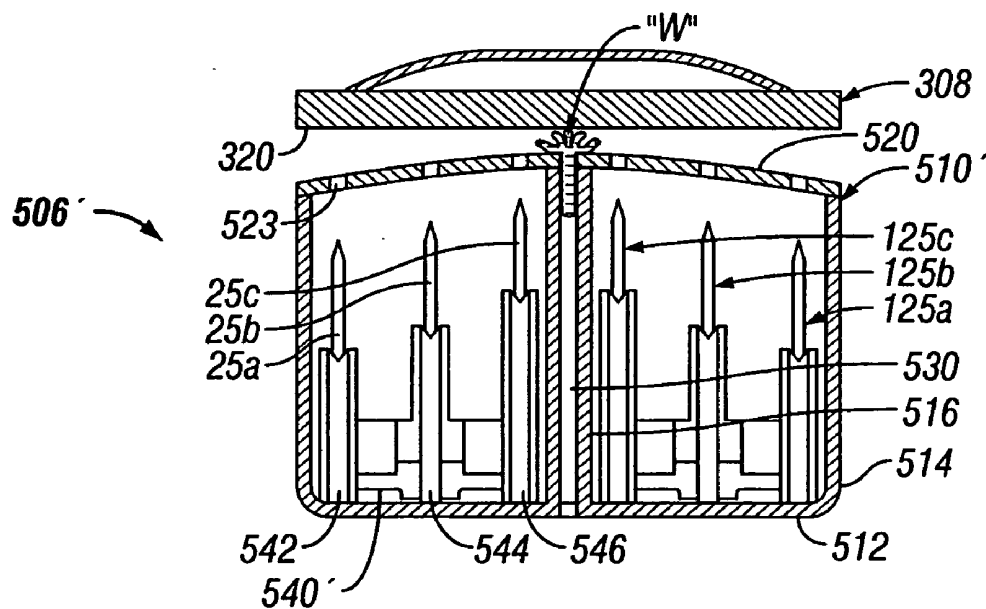

FIG. 10

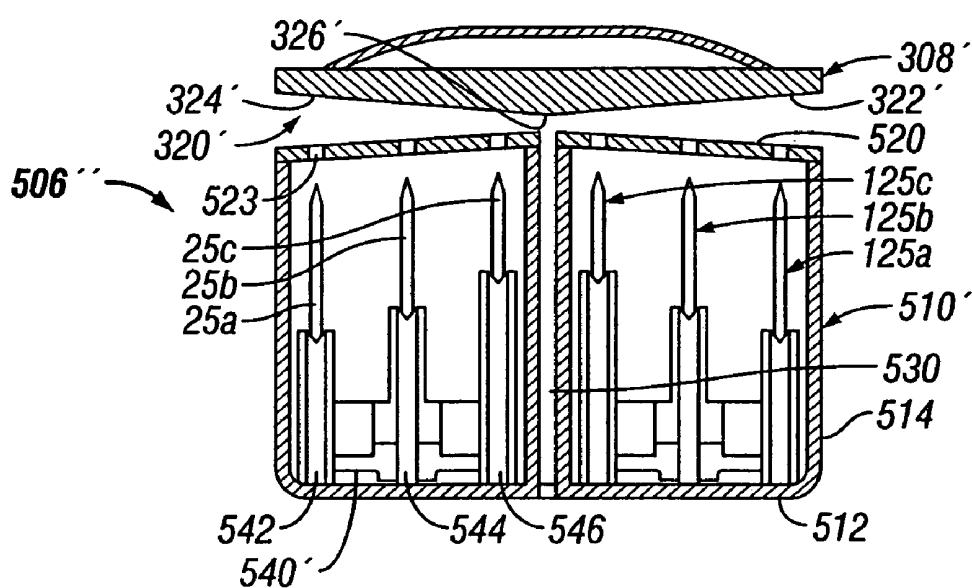

FIG. 11

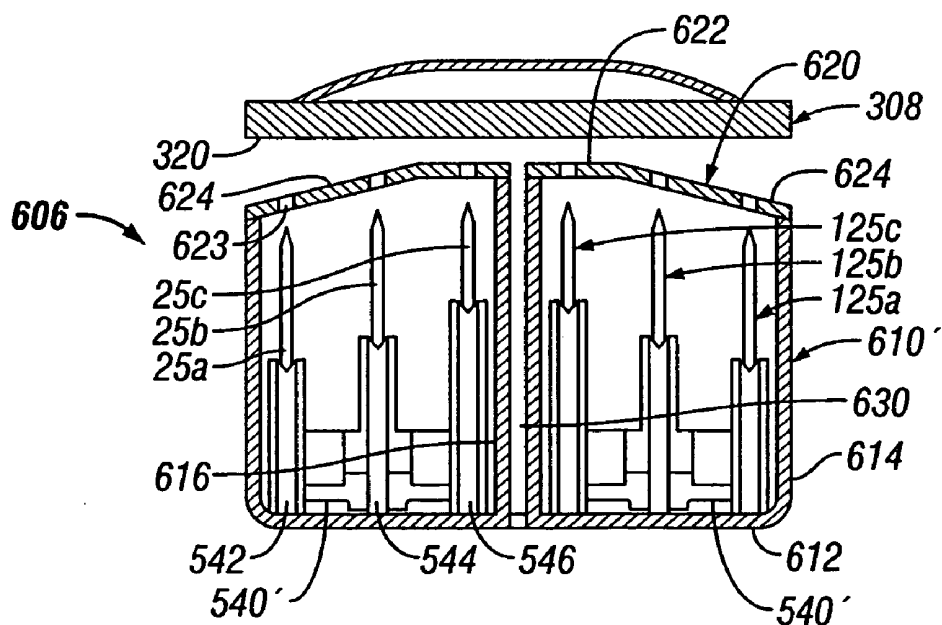

FIG. 12

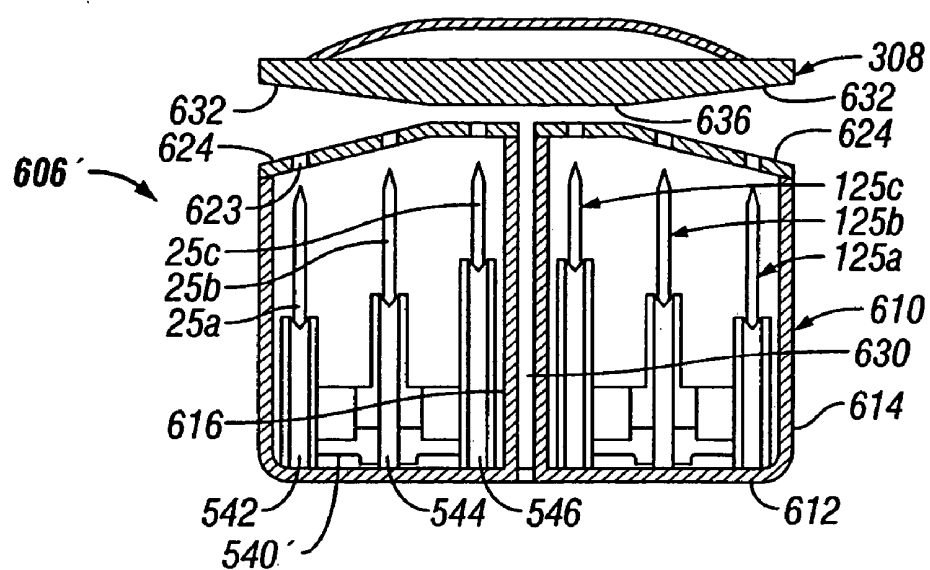

FIG. 13

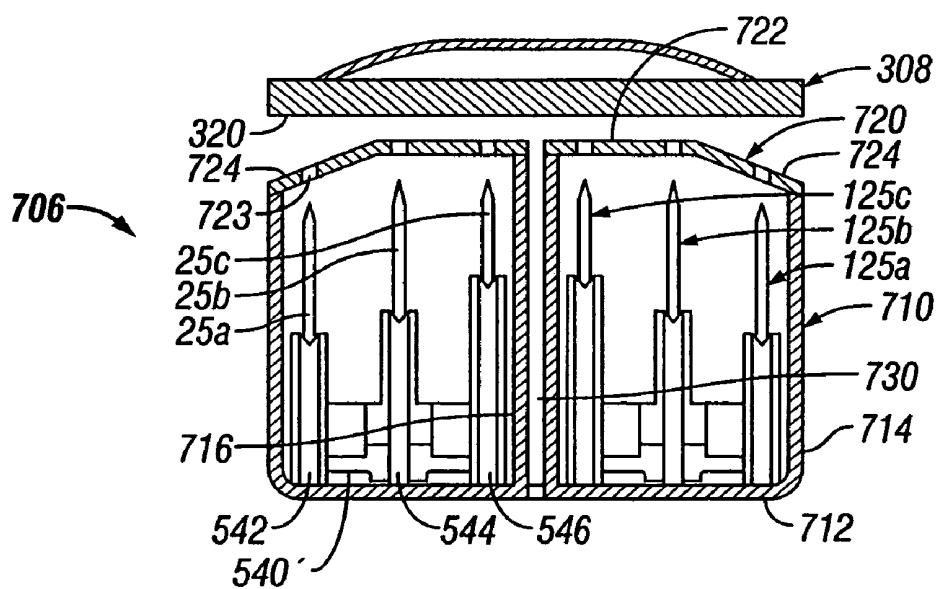

FIG. 14

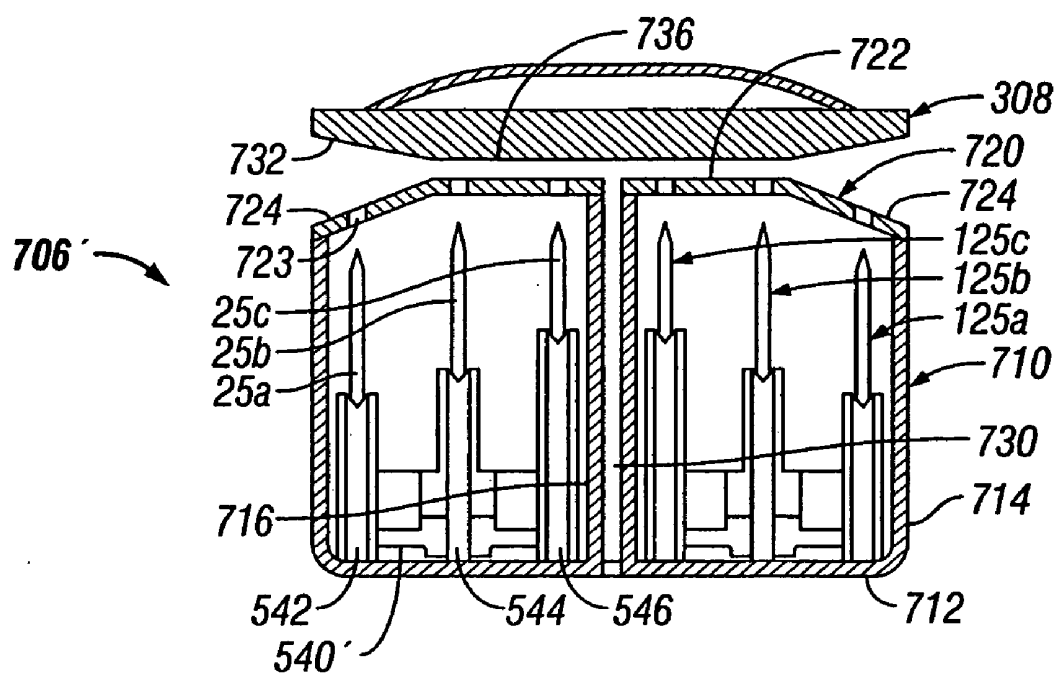

FIG. 15

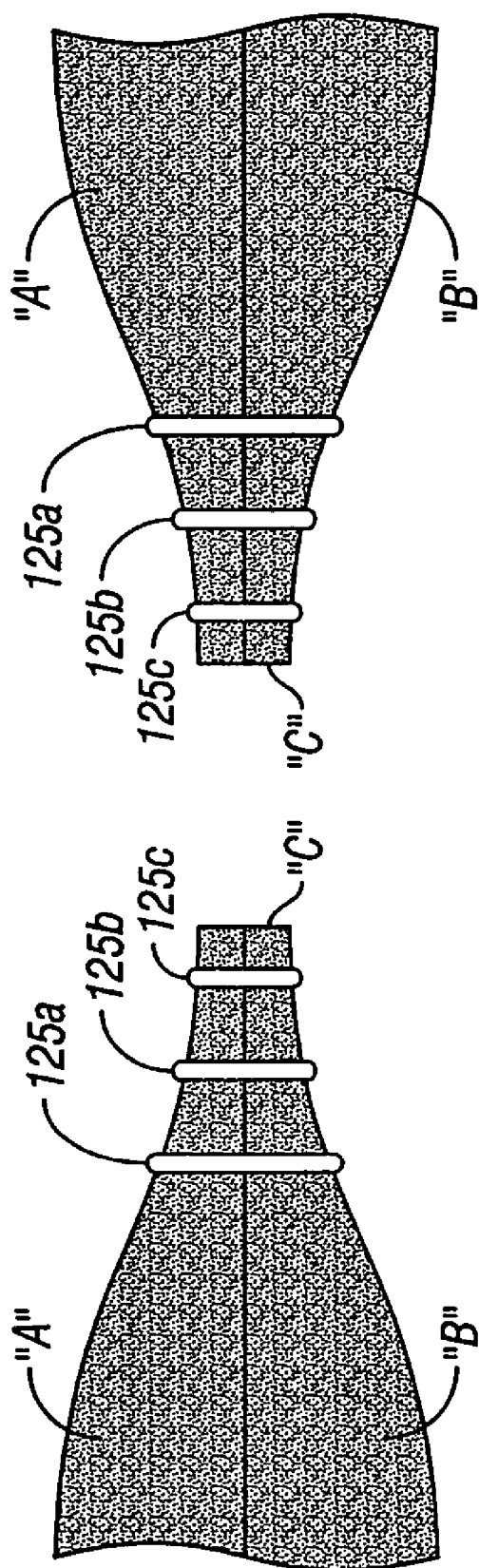

FIG. 16

SURGICAL STAPLING INSTRUMENTS INCLUDING A CARTRIDGE HAVING MULTIPLE STAPLE SIZES

BACKGROUND

[0001] 1. Technical Field

[0002] The present disclosure relates to surgical stapling instruments and, more particularly, to surgical stapling instruments including a cartridge having multiple staple sizes.

[0003] 2. Background of Related Art

[0004] There are several known types of surgical stapling instruments specifically adapted for use in various procedures such as end-to-end anastomosis, gastrointestinal anastomosis, endoscopic gastrointestinal anastomosis, and transverse anastomosis. Examples of stapling instruments for these various procedures can be found in U.S. Pat. Nos. 5,915,616; 6,202,914; 5,865,361; and 5,964,394.

[0005] Each surgical stapling instrument includes an anvil which is approximated relative to a staple cartridge. The staple cartridge typically has one or more laterally spaced rows of staples which, depending on the particular stapling instrument, may be arranged in a linear or non-linear configuration. The anvil includes staple forming depressions which are aligned with and/or in registration with the staple slots of the staples in the cartridge. In use, each of the surgical stapling instruments involves the gripping of tissue to be fastened, the ejecting of individual staples, the forcing of staples through the gripped tissue and the closing and/or forming of the staples against the staple forming depressions of the anvil.

[0006] A common issue in transecting tissue and/or in anastomosis procedures, employing any one of the surgical stapling instruments disclosed above, is the balance between anastomotic strength and the degree of hemostasis achievable. It is known to include different size staples in a surgical stapling apparatus having a constant gap (i.e. a uniform distance) between an anvil and a staple cartridge.

SUMMARY

[0007] The present disclosure is directed towards surgical stapling instruments configured to effectuate an improved balance between the anastomotic strength and the degree of hemostasis at the tissue interface. In particular, embodiments of the present disclosure include surgical fasteners of different sizes. Further still, the distance between an anvil member and a staple cartridge (i.e. the gap) varies from a centerline of the staple cartridge to an outer edge of the staple cartridge. Combining the different sizes of surgical fasteners with the varying gap between the anvil member and the staple cartridge improves the anastomotic strength and the degree of hemostasis at the tissue interface.

[0008] According to one aspect of the disclosure, the surgical stapling instrument includes a first structure defining having an anvil member operatively associated therewith, and a second structure defining a staple cartridge operatively associated therewith. The staple cartridge has a tissue contacting surface with a stepped cross-sectional profile. The tissue contacting surface of the staple cartridge also includes a plurality of retention slots formed therein for

retaining a surgical fastener. During operation of the surgical stapling instrument, the anvil member and the staple cartridge can be approximated relative to one another.

[0009] The stepped tissue contact surface of the staple cartridge defines a plurality of tissue contacting surfaces each having a different height. In one embodiment, the stepped tissue contacting surface of the cartridge includes an inner tissue contacting surface having a height, an intermediate tissue contacting surface having a height less than the height of the inner tissue contacting surface, and an outer tissue contacting surface having a height less than the height of the intermediate tissue contacting surface.

[0010] The inner, intermediate, and outer tissue contacting surfaces each include at least one row of retention slots formed therein. A plurality of surgical fasteners is disposed, one each, in each retention slot. Each surgical fastener includes a backspan and a pair of descending legs.

[0011] The surgical fasteners retained in the retention slots formed in the inner tissue contacting surface have a first leg length, the surgical fasteners retained in the retention slots formed in the intermediate tissue contacting surface have a second leg length, and the surgical fasteners retained in the retention slots formed in the outer tissue contacting surface have a third leg length. In one embodiment, the surgical fasteners retained in the retention slots formed in the inner tissue contacting surface have a leg length of about 2.3 mm, while the surgical fasteners retained in the retention slots formed in the intermediate tissue contacting surface have a leg length of about 3.5 mm, and the surgical fasteners retained in the retention slots formed in the outer tissue contacting surface have a leg length of about 4.1 mm.

[0012] It is envisioned that the surgical stapling instrument can be a circular-type surgical stapling instrument wherein the anvil member and the staple cartridge can be annular. In one embodiment, the plurality of tissue contacting surfaces decreases in height in a radially outward direction. Accordingly, the inner tissue contacting surface is closest to the center and the outer tissue contacting surface is furthest from the center of the annular staple cartridge. Moreover, surgical fasteners having relatively short leg lengths are retained in the retention slots closest to the center of the annular staple cartridge while surgical fasteners having relatively longer leg lengths are retained in the retention slots furthest from the center of the annular staple cartridge.

[0013] It is further envisioned that the surgical stapling instrument can be a linear-type surgical stapling instrument wherein the anvil member and the staple cartridge are linear. In these instruments, the staple cartridge and/or the anvil member may define a knife cut line. Accordingly, the plurality of tissue contacting surfaces decreases in height in a direction orthogonally outward from the knife cut line. In particular, the inner tissue contacting surface is closest to the knife cut line while the outer tissue contacting surface is furthest from the knife cut line. In addition, surgical fasteners having relatively short leg lengths are retained in the retention slots closest to the knife cut line while surgical fasteners having relatively longer leg lengths are retained in the retention slots furthest from the knife cut line.

[0014] It is envisioned that the anvil member can have a tissue contacting surface with a stepped cross-sectional profile including a plurality of tissue contacting surfaces,

wherein each tissue contacting surface has a different height. In addition, each one of the plurality of tissue contacting surfaces can include at least one annular and/or linear row of surgical fastener forming depressions formed therein.

[0015] In one embodiment, the anvil member can have a tissue contacting surface which is shaped (i.e. stepped) to complement the stepped tissue contacting surface of the staple cartridge. In another embodiment, the anvil member can have a tissue contacting surface which is stepped while the tissue contacting surface of the staple cartridge is substantially planar. In yet another embodiment, the anvil member can have a tissue contacting surface which is shaped to substantially complement the stepped tissue contacting surface of the staple cartridge (i.e. the depths of the tissue contacting surfaces of the stepped anvil member are not equal to the heights of the individual tissue contacting surfaces of the tissue contacting surface of the staple cartridge). In still another embodiment, the anvil member can have a tissue contacting surface which is stepped to mirror the tissue contacting surface of the staple cartridge (i.e. the depths of individual tissue contacting surfaces of the tissue contacting surface of the anvil member are substantially equal to the depths of the individual tissue contacting surfaces of the staple cartridge).

[0016] In other embodiments of the present disclosure, a surgical stapling instrument includes an operative tool disposed at one end thereof. The operative tool includes an anvil member and a staple cartridge. The staple cartridge may be included in a disposable surgical stapling apparatus or in a reusable surgical stapling apparatus. Further still, a replaceable loading unit may be located in either the disposable or the reusable surgical stapling apparatus. In one embodiment, the replaceable loading unit includes a staple cartridge, while an alternate embodiment of the replaceable loading unit includes a staple cartridge and an anvil member. In particular, the staple cartridge includes a plurality of surgical fasteners disposed in rows of retention slots. The surgical fasteners may have different leg lengths wherein a plurality of surgical fasteners having substantially the same leg length is disposed in a row. A number of fastener ejection members are disposed in the staple cartridge wherein each fastener ejection member includes a plurality of staple pushers for ejecting the surgical fasteners in cooperation with an actuation mechanism.

[0017] The staple cartridge may include an angled tissue contacting surface that peaks at a centerline of the staple cartridge and tapers towards outer walls of the staple cartridge. Alternatively, the tissue contacting surface of the staple cartridge may have a surface that is parallel with the bottom surface of the staple cartridge or parallel to a plane defined by the backspans of surgical fasteners disposed in a selected row. The parallel surface of the tissue contacting surface has a width dimension that is sufficient to accommodate at least one row of surgical fasteners. The staple cartridge may include a knife channel.

[0018] In cooperation with the presently disclosed staple cartridge, the anvil member may include a planar tissue contacting surface that is substantially parallel to the bottom surface of the staple cartridge or parallel to a plane defined by the backspans of surgical fasteners disposed in a selected row. In the alternative, the tissue contacting surface of the anvil member may be angled in an opposed manner to the

angle of the tissue contacting surface of the staple cartridge. Further still, the tissue contacting surface of the anvil member may have a planar surface that is substantially parallel to the bottom surface of the staple cartridge or parallel to a plane defined by the backspans of surgical fasteners disposed in a selected row and tapered surfaces that define angles opposite to the angles defined by the tissue contacting surface of the staple cartridge. The parallel surfaces of the anvil member have a width dimension that corresponds to a width dimension of the parallel surface of the staple cartridge.

[0019] It is further contemplated that one embodiment of the surgical stapling apparatus includes structures for supplemental sealing of the fastened layers of tissue. In one embodiment, the surgical stapling apparatus includes a wound closure assembly having a reservoir and a supply line. The reservoir is adapted for storing a quantity of a wound closure material and is fluidly coupled to the staple cartridge via the supply line for delivering amounts of the wound closure material to the plurality of retention slots.

[0020] The presently disclosed surgical stapling instruments, together with attendant advantages, will be more clearly illustrated below by the description of the drawings and the detailed description of the embodiments.

[0021] Other objects and features of the present disclosure will become apparent from consideration of the following description taken in conjunction with the accompanying drawings.

BRIEF DESCRIPTION OF THE DRAWINGS

[0022] Embodiments of the presently disclosed surgical stapling apparatus are described herein with reference to the accompanying drawings, wherein:

[0023] FIG. 1 is a perspective view of a surgical stapling instrument constructed in accordance with the present disclosure;

[0024] FIG. 2 is a schematic cross-sectional side elevational view of the distal end portion of the surgical stapling instrument of FIG. 1, as taken through 2-2 of FIG. 1;

[0025] FIG. 3A is an enlarged schematic representation of the indicated area of FIG. 2, illustrating tissue contacting surfaces in accordance with an alternate embodiment of the present disclosure;

[0026] FIG. 3B is an enlarged schematic representation of the indicated area of FIG. 2, illustrating tissue contacting surfaces in accordance with another embodiment of the present disclosure;

[0027] FIG. 3C is an enlarged schematic representation of the indicated area of FIG. 2, illustrating tissue contacting surfaces in accordance with still another embodiment of the present disclosure;

[0028] FIG. 3D is an enlarged schematic representation of the indicated area of FIG. 2, illustrating tissue contacting surfaces in accordance with a further embodiment of the present disclosure;

[0029] FIG. 4 is a perspective view of an alternative surgical stapling instrument constructed in accordance with the present disclosure;

[0030] FIG. 5 is a perspective view of yet another surgical stapling instrument constructed in accordance with the present disclosure;

[0031] FIG. 6 is a perspective view of still another surgical stapling instrument constructed in accordance with the present disclosure;

[0032] FIG. 6A is a perspective view of a portion of an anvil member of FIG. 6;

[0033] FIG. 7 is a schematic cross-sectional side elevational view of the distal end portion of the surgical stapling instruments of FIGS. 4-6, as taken through 7-7 of each of FIGS. 4-6;

[0034] FIG. 7A is a schematic cross-sectional side elevational view of an alternate embodiment of the distal portion of the surgical stapling instrument of FIG. 6

[0035] FIG. 8 is a perspective view of a staple cartridge according to another embodiment of the present disclosure;

[0036] FIG. 9 is a cross-sectional end view of the staple cartridge of FIG. 8 showing a first arrangement of surgical fasteners;

[0037] FIG. 10 is an alternate embodiment of the staple cartridge of FIG. 9 illustrating a second embodiment of the surgical fasteners;

[0038] FIG. 11 is an alternate embodiment of an anvil member and the staple cartridge of FIG. 10;

[0039] FIG. 12 is a further embodiment of the staple cartridge of FIG. 8;

[0040] FIG. 13 is another embodiment of the anvil member and the staple cartridge of FIG. 12;

[0041] FIG. 14 is another embodiment of the staple cartridge and anvil member of FIG. 8;

[0042] FIG. 15 is alternate embodiment of an anvil member with the staple cartridge of FIG. 14; and

[0043] FIG. 16 is a cross-sectional side elevational view of the resulting tissue interface following the firing of surgical stapling instrument of FIGS. 7 and 10-15.

DETAILED DESCRIPTION OF EMBODIMENTS

[0044] Embodiments of the presently disclosed surgical stapling instruments will now be described in detail with reference to the drawing figures wherein like reference numerals identify similar or identical elements. In the drawings and in the description which follows, the term “proximal”, as is traditional, will refer to the end of the surgical stapling instrument which is closest to the operator while the term “distal” will refer to the end of the device which is furthest from the operator.

[0045] The present disclosure relates to a staple cartridge and an anvil member for use in a disposable or re-usable surgical stapling apparatus. The presently disclosed staple cartridge and anvil member, as will be discussed in detail hereinbelow, may be used with any of the surgical stapling apparatus shown in FIGS. 1, 4, 5, or 6. In addition, a replaceable loading unit may be located in either the disposable or the reusable surgical stapling apparatus. In one embodiment, the replaceable loading unit includes a staple cartridge, including any of the staple cartridges disclosed

herein. Alternatively, the replaceable loading unit includes the staple cartridge and an anvil member, including any of the anvil members disclosed herein. In combination with the disposable or the reusable surgical stapling apparatus, the replaceable loading unit provides improved flexibility of the respective surgical stapling apparatus in that the respective surgical stapling apparatus is readily adaptable for different stapling procedures.

[0046] Referring now in detail to FIGS. 1-2, in which like reference numerals identify similar or identical elements, a surgical stapling instrument, in accordance with a first embodiment of the disclosure, is generally designated as 100.

[0047] As seen in FIG. 1, surgical stapling instrument 100 includes a handle assembly 102 having at least one pivotable actuating handle member 103, and further includes advancing means 105. Extending from handle assembly 102, there is provided a tubular body portion 104 which may be constructed so as to have a curved shape along its length. Tubular body portion 104 terminates in a fastener ejection member assembly 106 having a circular staple cartridge 118 including a tissue contacting surface 121 disposed at a distal end thereof.

[0048] As seen in FIG. 2, tissue contacting surface 121 is stepped including an outer tissue contacting surface 121a, an intermediate tissue contacting surface 121b, and an inner tissue contacting surface 121c. Each tissue contacting surface 121a-121c has a different height from one another as measured from a bottom surface 131 of a staple pusher or fastener ejection member 130. Specifically, tissue contacting surfaces 121a-121c are planar structures that are substantially parallel to one another, but are not co-planar (i.e. stepped) with one another. In addition, each tissue contacting surface 121a-c defines a planar axis that extends through the respective tissue contacting surface 121a-c. A first wall surface interconnects tissue contacting surfaces 121a and 121b, while a second wall surface interconnects tissue contacting surfaces 121b and 121c. The first and second wall surfaces are planar structures wherein each wall surface defines a planar axis. In one embodiment, the planar axes of the wall surfaces are orthogonal to the planar axes of tissue contacting surfaces 121a-c.

[0049] Inner tissue contacting surface 121c has the greatest height, outer tissue contacting surface 121a has the least height, and intermediate tissue contacting surface 121b has a height between the heights of outer and inner tissue contacting surfaces 121a, 121c. While tissue contacting surfaces 121a-121c are shown as increasing in height from outer tissue contacting surface 121a to inner tissue contacting surface 121c (i.e. radially inward), it is within the scope of the present disclosure that the heights of each tissue contacting surface can vary depending on the particular surgical procedure. For example, tissue contacting surfaces 121a-121c can increase in height in a radially outward direction, the intermediate tissue contacting surface 121b can be the highest or the lowest tissue contacting surface, or at least two of tissue contacting surfaces 121a-121c can have the same height.

[0050] In one embodiment, each tissue contacting surface 121a-121c includes a respective annular row 119a-119c of retention slots 123 formed therein. Each retention slot 123 of annular rows 119a-119c is configured and dimensioned to

retain a staple or surgical fastener **125** therein. Each surgical fastener **125** includes a backspan (not shown) and a pair of depending legs **25**. In one embodiment, each annular row **119a-119c** of slots **123** includes a respective surgical fastener **125a-125c** having its own characteristic features.

[0051] As seen in FIG. 2, legs **25a** of surgical fasteners **125a** have a first leg length, legs **25b** of surgical fasteners **125b** have a second leg length, and legs **25c** of surgical fasteners **125c** have a third leg length. In particular, surgical fasteners **125a-125c** increase in height in a radially outward direction. In one embodiment, legs **25c** of surgical fasteners **125c** have a leg length of about 2.3 mm, legs **25b** of surgical fasteners **125b** have a leg length of about 3.5 mm, and legs **25a** of surgical fasteners **125a** have a leg length of about 4.1 mm. As such, inner tissue contacting surface **121c** has the greatest height and retains surgical fasteners **125c** having the shortest leg lengths, and outer tissue contacting surface **121a** has the least height and retains surgical fasteners **125a** having the longest leg lengths. Having tissue contacting surface **121** step progressively downward at intermediate tissue contacting surface **121b** and then again at outer tissue contacting surface **121a** results in the formation of surgical fasteners **125b** and **125c**, respectively. It is envisioned and within the scope of the present disclosure that any number of arrangements are possible.

[0052] While a single annular row **119a-119c** of retention slots **123** is shown for each tissue contacting surface **121a-121c**, it is envisioned and within the scope of the present disclosure that each tissue contacting surface **121a-121c** can include multiple annular rows of retention slots.

[0053] As seen in FIG. 2, a fastener ejection assembly **106** of surgical stapling instrument **100** includes fastener ejection member **130** disposed within staple cartridge **118**. Fastener ejection member **130** includes a proximal portion **132** having a generally frusto-conical shape and a distal portion defining concentric rings of peripherally spaced staple pushers **134a-c**, each one of which is received within a respective staple retention slot **123** and is cooperative with its respective surgical fastener **125a-c** disposed in annular rows **119a-c**. In one embodiment, it is envisioned that proximal portion **132** of fastener ejection member **130** is configured and dimensioned to be contacted by a distal end of a driver tube **138**. Hence, upon advancing fastener ejection member **130** by advancing driver tube **138**, staple pushers **134a-c** will pass further into retention slots **123** thereby pushing surgical fasteners **125** contained therein axially outward.

[0054] In an alternate embodiment, staple pushers **134a-c** of fastener ejection member **130** have different heights for cooperating with different sized surgical fasteners. In particular, staple pushers **134a-c** are sized such that when surgical fasteners **125a-c** are disposed in their respective annular rows **119a-c**, tips of surgical fasteners **125a-c** are located substantially in the same plane despite the difference in leg lengths between each row of surgical fasteners.

[0055] Surgical stapling instrument **100** further includes a circular anvil assembly **108** having an anvil head **109** and an anvil shaft **110** extending from a proximal end thereof and adapted to engage a shaft **111** extending distally from staple cartridge **118**. Anvil head **109** includes an annular anvil member **112** disposed at a proximal end thereof, wherein anvil member **112** includes at least one, row of fastener forming depressions **114** formed circumferentially there-

about. In one embodiment, surgical stapling instrument **100** includes three laterally spaced rows of fastener forming depressions **114** formed circumferentially thereabout. Each fastener forming depression **114** is in registration with a corresponding retention slot **123**.

[0056] While anvil member **112** is shown in FIG. 2 as having a substantially planar tissue contacting surface, it is envisioned and within the scope of the present disclosure for surgical stapling instrument **100** to have a number of alternate configurations. For example, as seen in FIG. 3A, anvil member **112** can have a tissue contacting surface **112a** which is shaped (i.e. stepped) to complement stepped tissue contacting surface **121** of staple cartridge **118** or, as seen in FIG. 3B, anvil member **112** can have a tissue contacting surface **112b** which is stepped while tissue contacting surface **121** of staple cartridge **118** is substantially planar. In addition, for example, as seen in FIG. 3C, anvil member **112** can have one row of staple pockets **114b** that extends a greater distance than staple pockets **114a** or **114c** into anvil member **112** for accommodating surgical fasteners having a longer leg length or, as seen in FIG. 3D, anvil member **112** can have a tissue contacting surface **112d** which is stepped to mirror tissue contacting surface **121** of staple cartridge **118** (i.e. the depths of individual tissue contacting surfaces of tissue contacting surface **112d** of anvil member **112** are substantially equal to the depths of the individual tissue contacting surfaces **121a-121c** of staple cartridge **118**).

[0057] The sizes of surgical fasteners **125a-125c** are selected and intended for use in gastric firings typically required in bariatric procedures. However, it is envisioned and within the scope of the present disclosure that the sizes of surgical fasteners **125a-125c** selected can be chosen for performance in different types of tissue, such as, for example, the colon, bowels, lungs, the bronchus, pulmonary vessels, the liver, and the like.

[0058] In operation, surgical stapling instrument **100** is positioned within a tubular organ in the body of the patient and the ends of the organ to be joined are positioned in a gap between staple cartridge **118** and anvil assembly **108**. As is conventional, the ends of the organ may be secured around anvil shaft **110** by a purse string suture prior to approximation of anvil assembly **108** to staple cartridge **118**. Surgical stapling instrument **100** is then approximated and fired. An example of a surgical stapling apparatus and methods for its use are disclosed in U.S. Pat. No. 5,915,616, currently assigned to Tyco Healthcare Group LP, the entire contents of which is incorporated herein by reference.

[0059] Turning now to FIGS. 4 and 7, a surgical stapling instrument, of the gastro-intestinal anastomosis type for performing surgical anastomotic stapling, in accordance with another embodiment of the disclosure, is generally designated as **200**. Surgical stapling instrument **200** includes a first handle **202** having a jaw **230** defining a staple cartridge receiving section extending from a distal end thereof, a staple cartridge **204** receivable in jaw **203**, a second handle **206** having a jaw **205** defining an anvil member receiving section extending from a distal end thereof, and an anvil member **208** operatively associated with jaw **205**. First and second handles **202**, **206** are configured such that staple cartridge **204** is substantially aligned with anvil member **208**.

[0060] As seen in FIG. 7, staple cartridge **204** includes a stepped tissue contacting surface **121** including an outer

tissue contacting surface **121a**, an intermediate tissue contacting surface **121b**, and an inner tissue contacting surface **121c**, each of which has a different height from one another as measured from a bottom surface **231** of staple cartridge **204**. Tissue contacting surfaces **121a-121c** are planar structures that are substantially parallel to one another, but are not co-planar with one another. For example, tissue contacting surfaces **121a-121c**, as shown in FIG. 7, can decrease in height in a direction orthogonally outward from knife track **222**. In embodiments that do not include knife track **222**, tissue contacting surfaces **121a-c** decrease in height in a direction orthogonally outward from a centerline of staple cartridge **204**.

[0061] Each tissue contacting surface **121a-121c** includes a respective linear row **119a-119c** of retention slots **123** formed therein. Each retention slot **123** of linear rows **119a-119c** is configured and dimensioned to retain a surgical fastener **125** therein. Each linear row **119a-119c** of slots **123** includes a respective surgical fastener **125a-125c** having its own characteristic features.

[0062] As seen in FIG. 7, legs **25a** of surgical fasteners **125a** have a first leg length of about 4.1 mm, legs **25b** of surgical fasteners **125b** have a second leg length of about 3.5 mm, and legs **25c** of surgical fasteners **125c** have a third leg length of about 2.3 mm. In particular, surgical fasteners **125a-125c** increase in height in an orthogonally outward direction relative towards optional knife track **222**. Knife track **222** is disposed along a centerline of staple cartridge **204**, **310**, or **412** and is adapted for slidably receiving an optional knife (not shown). Having tissue contacting surface **121** step progressively downward at intermediate tissue contacting surface **121b** and then again at outer tissue contacting surface **121a** results in the formation of surgical fasteners **125b** and **125c**, respectively. It is envisioned and within the scope of the present disclosure that any number of arrangements are possible.

[0063] In operation, surgical stapling instrument **200** is fired similarly to and in accordance with other known surgical stapling instruments. An example of a surgical stapling apparatus and methods for its use are disclosed in U.S. Pat. No. 6,202,914, currently assigned to Tyco Healthcare Group LP, the entire contents of which is incorporated herein by reference.

[0064] Referring additionally to FIG. 16, following the firing of surgical stapling instrument **200**, the resulting tissue interface is seen in cross-section. Accordingly, surgical fasteners **125a** and **125b** (i.e. the two rows of surgical fasteners furthest from knife cut line "C") serve to hold tissues "A" and "B" to one another while surgical fasteners **125c** (i.e. the row of surgical fasteners closest to knife cut line "C") serve to provide the hemostasis.

[0065] While surgical stapling instrument **200** is a linear-type surgical stapler, it is envisioned and within the scope of the present disclosure, that surgical stapling instrument **200** can include a tissue contacting surface having a cross-sectional profile for at least one of the anvil member and the staple cartridge which is substantially similar to the tissue contacting surfaces of the anvil member and the staple cartridge of surgical stapling instrument **100**, as shown in FIGS. 3A-3D.

[0066] Turning now to FIGS. 5 and 7, a surgical stapling instrument, of the laparoscopic type for performing surgical

anastomotic stapling, in accordance with another embodiment of the disclosure, is generally designated as **300**. Surgical stapling instrument **300** includes a handle **302**, an operative tool **306**, and an elongated shaft **304** for interconnecting operative tool **306** to handle **302**. In general, operative tool **306** is designed to clamp over and then to staple and divide tissue held therein. Accordingly, as seen in FIG. 5, operative tool **306** is a pair of opposed jaws including an anvil member **308** and a staple cartridge **310** pivotally coupled to one another.

[0067] Staple cartridge **310** of surgical stapling instrument **300** includes a stepped tissue contacting surface **121** similar to tissue contacting surface **121** of staple cartridge **204** of surgical stapling instrument **200**. Accordingly, reference is made to FIG. 7 and the above detailed discussion of tissue contacting surface **121** of staple cartridge **204** for an illustration and a discussion of tissue contacting surface **121** of staple cartridge **310** of surgical stapling instrument **300**.

[0068] In operation, surgical stapling instrument **300** is fired similarly to and in accordance with other known surgical stapling instruments. For a detailed discussion of the approximation and firing of surgical stapling instrument **300**, reference is made to commonly assigned U.S. Pat. No. 5,865,361, currently assigned to Tyco Healthcare Group LP, the entire contents of which is incorporated herein by reference.

[0069] Following the firing of surgical stapling instrument **300** the resulting tissue interface, as seen in cross-section, is substantially similar to the resulting tissue interface, as seen in cross-section, following the firing of surgical stapling instruments **100** and **200**. Accordingly, as seen in FIG. 16, surgical fasteners **125a** and **125b** (i.e. the two rows of surgical fasteners furthest from knife cut line "C") serve to hold tissues "A" and "B" to one another while surgical fasteners **125c** (i.e. the row of surgical fasteners closest to knife cut line "C") serve to provide the hemostasis.

[0070] While surgical stapling instrument **300** is a linear-type surgical stapler as compared to surgical stapling instrument **100**, it is envisioned and within the scope of the present disclosure, that surgical stapling instrument **300** can include a tissue contacting surface having a cross-sectional profile for at least one of the anvil and the staple cartridge which is substantially similar to the tissue contacting surfaces of the anvil and the staple cartridge of surgical stapling instrument **100**, as shown in FIGS. 3A-3D.

[0071] Turning now to FIGS. 6, 6A, 7, and 7A, a surgical stapling instrument, of the transverse anastomosis type for performing surgical anastomotic stapling, in accordance with yet another embodiment of the disclosure, is generally designated as **400**. Surgical stapling instrument **400** includes a handle **402**, a barrel **404** extending from handle **402**, and an arm **406** extending from the distal end of barrel **404**. Surgical stapling instrument **400** further includes an anvil member **408** orthogonally affixed to a distal end of arm **406** and a staple cartridge receiver **410** operatively coupled to the distal end of barrel **404** for holding a disposable staple cartridge **412** thereon. Anvil member **408** is illustrated in further detail in FIG. 6A and includes a tissue contacting surface **420** wherein tissue contacting surface **420** has a plurality of pockets **425** that substantially align with retention slots **123** (FIG. 7). Cooperative alignment between pockets **425** and retention slots **123** form completed surgical

fasteners **125** upon actuation of the actuation mechanism in surgical stapling instrument **400**.

[0072] Staple cartridge **412** of surgical stapling instrument **400** includes a stepped tissue contacting surface **121** similar to tissue contacting surface **121** of staple cartridge **204** of surgical stapling instrument **200**. Accordingly, reference is made to FIG. 7 and the above detailed discussion of tissue contacting surface **121** of staple cartridge **204** for an illustration and a discussion of tissue contacting surface **121** of staple cartridge **412** of surgical stapling instrument **400**. Further still, staple cartridge **412** may include knife track **222** for slidably receiving a knife (not shown) therein.

[0073] In a further embodiment of the present disclosure, staple cartridge **412'** is illustrated in FIG. 7A and discussed in detail hereinafter. Staple cartridge **412'** is similar to staple cartridge **412**, but only includes three rows **119a-c** of retention slots **123** disposed between outer walls of staple cartridge **412'**. As in the previously discussed embodiment, each row **119a-c** includes a plurality of surgical fasteners wherein surgical fasteners in row **119a** have a different leg length from surgical fasteners disposed in row **119b**, while surgical fasteners disposed in row **119c** have a leg length that is different from at least one of rows **119a** or **119b**. This embodiment of the staple cartridge does not include a knife track. The arrangement and interrelationship of tissue contacting surfaces **125a-c** is similar to that previously disclosed with reference to FIG. 7.

[0074] In operation, surgical stapling instrument **400** is fired similarly to and in accordance with other known surgical stapling instruments. For a detailed discussion of the approximation and firing of surgical stapling instrument **400**, reference is made to commonly assigned U.S. Pat. No. 5,964,394, currently assigned to Tyco Healthcare Group LP, the entire contents of which is incorporated herein by reference.

[0075] Following the firing of surgical stapling instrument **400** the resulting tissue interface, as seen in cross-section, is substantially similar to the resulting tissue interface, as seen in cross-section, following the firing of surgical stapling instruments **100-300**. Accordingly, as seen in FIG. 16, surgical fasteners **125a** and **125b** (i.e. the two rows of surgical fasteners furthest from knife cut line "C") serve to hold tissues "A" and "B" to one another while surgical fasteners **125c** (i.e. the row of surgical fasteners closest to knife cut line "C") serve to provide the hemostasis.

[0076] While surgical stapling instrument **400** is a linear-type surgical stapler as compared to surgical stapling instrument **100**, it is envisioned and within the scope of the present disclosure, that surgical stapling instrument **400** can include a tissue contacting surface having a cross-sectional profile for at least one of the anvil and the staple cartridge which is substantially similar to the tissue contacting surfaces of the anvil and the staple cartridge of surgical stapling instrument **100**, as shown in FIGS. 3A-3D.

[0077] While each of the surgical stapling instruments described above and shown herein are configured and adapted to fire surgical fasteners **125**, it is envisioned and within the scope of the present disclosure, that tissue contacting surfaces of surgical instruments used in connection with applying two-part fasteners can also have stepped configurations as shown and described herein. A typical

two-part surgical fastener applying instrument is shown and described in commonly assigned U.S. Pat. No. 5,573,169, currently assigned to Tyco Healthcare Group LP, the entire contents of which is incorporated herein by reference.

[0078] In one further embodiment of the present disclosure, as illustrated in FIGS. 8-10, surgical stapling apparatus **300** includes an operative tool **506** disposed at one end of elongated shaft **304**. Operative tool **506** includes anvil member **308** and a staple cartridge **510**. Staple cartridge **510** may be included in a disposable surgical stapling apparatus or in a reusable surgical stapling apparatus. In particular, staple cartridge **510** includes a tissue contacting surface **520** having a plurality of retention slots **523** disposed therein and arranged in rows that are substantially aligned with a longitudinal axis of staple cartridge **510**. As seen in FIG. 8, each row of retention slots **523** is longitudinally offset from an adjacent row of retention slots. In particular, an optional knife channel **530** is disposed along the longitudinal axis of staple cartridge **510** that is adapted for slidably receiving a knife (not shown).

[0079] Referring now to FIG. 9, operative tool **506** is shown in cross-section and illustrates the several components included in staple cartridge **510**. Anvil member **308** includes a substantially planar tissue contacting surface **320** that is substantially parallel to a bottom surface **512** or parallel to a plane defined by the backspans of surgical fasteners **125a**, **125b**, or **125c**. Staple cartridge **510** includes outer walls **514** having a first height and inner walls **516** having a second height wherein the second height is greater than the first height. Tissue contacting surface **520** is attached to inner walls **516** and to outer walls **514** and defines an angle with respect to a plane that is orthogonal to inner walls **516**. Tissue contacting surface **520** defines a generally curved path between outer walls **514** (i.e. generally convex or elliptical as viewed in cross-section). Additionally, a plurality of surgical fasteners **125a-c** are disposed in staple cartridge **510** wherein each row of retention pockets **523** includes a number of substantially identical surgical fasteners (i.e. **125a**, **125b**, or **125c**). Similar to previous embodiments, legs **25a-c** of surgical fasteners **125a-c** have different lengths. In this embodiment, surgical fasteners **25a** have a leg length of about 3.8 mm, surgical fasteners **25b** have a leg length of about 3.5 mm, and surgical fasteners **25c** have a leg length of about 2.5 mm. As seen in FIG. 9, surgical fasteners **125a-c** are disposed in staple cartridge **510** such that surgical fasteners **125c** are proximate to outer walls **514**, surgical fasteners **125a** are disposed proximate to inner walls **516**, and surgical fasteners **125b** are disposed therebetween. In cooperation with the surgical fasteners of varying height, staple cartridge **510** includes fastener ejection members **540** that include staple pushers **542**, **544**, and **546** of differing heights. Staple pusher **542** has the greatest height dimension, staple pusher **546** has the least height dimension, and staple pusher **544** has a height dimension therebetween. In this embodiment, surgical fasteners **125a-c** are arranged to cooperate with staple pushers **546**, **544**, and **542** respectively. Fastener ejection member **540** is adapted for substantially vertical movement when it cooperatively engages with an actuation mechanism (not shown). An example of a suitable actuation mechanism is disclosed in U.S. Pat. No. 5,865,361 as discussed with reference to previously disclosed surgical stapling instrument **300**.

[0080] Alternatively, as shown in FIG. 10, surgical fasteners 125a-c are disposed in staple cartridge 510' such that surgical fasteners 125a are proximate to outer walls 514, surgical fasteners 125c are disposed proximate to inner walls 516, and surgical fasteners 125b are disposed therebetween. Contrary to the previous embodiment, surgical fasteners 125a-c are arranged to cooperate with staple pushers 542, 544, and 546 respectively. After a number of layers of body tissue are positioned between tissue contacting surfaces 320 and 520, the actuation mechanism is actuated for sequentially ejecting surgical fasteners 125a-c through retention slots 523 whereby interaction between surgical fasteners 125a-c and anvil member 308 forms completed surgical fasteners for joining the layers of body tissue.

[0081] When tissue contacting surface 320 of anvil member 308 is repositioned proximate to tissue contacting surface 520 of staple cartridge 510', the amount of pressure applied to the layers of tissue disposed therebetween varies along a plane that is transverse to the longitudinal axis of staple cartridge 510'. Since the distance between tissue contacting surfaces 320 and 520 is at a minimum in the region nearest inner walls 516 (i.e. the centerline of staple cartridge 510'), a maximum pressure is applied to the layers of tissue disposed in this region. Conversely, the distance between tissue contacting surfaces 320 and 520 is at a maximum in the region near outer walls 514, a minimum pressure is applied to the layers disposed in this region. In addition, the proximal relationship between anvil member 308 and staple cartridge 510' defines a plurality of gaps therebetween. A first gap is defined between tissue contacting surfaces 320 and 520 (i.e. along the centerline of staple cartridge 510'), while a second gap is defined between tissue contacting surfaces 320 and 520 along outer walls 514. As seen in FIG. 10, the first gap is not equal to the second gap. Further still, a number of other gaps may be defined between tissue contacting surfaces 320 and 520 at other points of reference existing between the centerline and outer walls 514 in staple cartridge 510'. Since tissue contacting surface 520 slopes toward outer walls 514 to define a substantially uniform angle, the pressure applied to the layers of tissue disposed between tissue contacting surfaces 320 and 520 uniformly decreases from inner wall 516 to outer wall 514.

[0082] By angling tissue contacting surface 520 downwards from the centerline of staple cartridge 510', reduced compressive forces are applied to the layers of tissue disposed between tissue contacting surfaces 320 and 520 thereby minimizing trauma to the layers of tissue disposed therebetween. Therefore, layers of tissue disposed between tissue contacting surfaces 320 and 520 will have a minimum thickness nearest knife channel 530 (i.e. nearest the centerline of staple cartridge 510') and a maximum thickness nearest outer walls 514. In addition, anvil member 308 and staple cartridge 510' are dimensioned and arranged such that compressive forces applied to the layers of tissue are minimal thereby further reducing trauma to the layers of tissue. This configuration defines a gap between tissue contacting surfaces 320 and 520 that is a maximum along knife channel 530 (i.e. the centerline of staple cartridge 510 or 510') and a minimum along outer walls of staple cartridge 510 (FIG. 9) or 510' (FIG. 10).

[0083] Further still, this configuration is applicable to similar staple cartridges and anvil members as will be discussed in detail hereinafter with respect to FIGS. 11-15.

When anvil member 308 is repositioned into proximity with staple cartridge 510' (i.e. in a pre-fire position) to retain layers of body tissue therebetween, the layers of tissue are compressed. The maximum compression occurs along the centerline (i.e. first or minimum gap) and urges fluid stored in the layers of tissue towards the outer edges of the tissue (i.e. away from the centerline of staple cartridge 510'). By reducing the amount of fluid retained in the layers of tissue proximal to the centerline, the overall thickness of the tissue layers decreases. The decrease in overall tissue thickness is such that a staple having a shorter leg length (i.e. surgical fastener 125c) is capable of fastening both layers of tissue while minimizing trauma to the fastened layers of tissue. The gap increases towards the outer walls of staple cartridge 510' (i.e. the amount of compression decreases) and surgical fasteners having a longer leg length (i.e. surgical fasteners 125a and 125b) are capable of fastening both layers of tissue.

[0084] Leg lengths of surgical fasteners 125c, 125b, and 125a increase in a direction moving from inner walls 516 towards outer walls 514. By providing surgical fasteners having increasing leg lengths along a plane that is orthogonal to inner walls 516, the completed (i.e. formed) surgical fasteners join increasing thicknesses of tissue without unduly traumatizing the joined layers of tissue.

[0085] In a further embodiment, as illustrated in FIG. 11, operative tool 506" includes staple cartridge 510' and anvil member 308'. Staple cartridge 510' was previously discussed in detail hereinabove with reference to FIG. 10. Tissue contacting surface 520 may define a more uniform angle (FIG. 11) than in the embodiments of FIGS. 9 and 10 wherein the angle or pitch of tissue contacting surface is substantially constant between inner walls 516 and outer walls 514. Anvil member 308' includes tissue contacting surface 320' having tapered surfaces 322' and 324'. Surfaces 322' and 324' are connected to outer walls of anvil member 308' while extending inwards (i.e. towards the centerline of staple cartridge 510') and downwards (i.e. towards tissue contacting surface 520) thereby defining an angle. It is envisioned that the angle defined by tapered surfaces 322' and 324' will be substantially similar to the angle defined by tissue contacting surface 520, but in an opposed direction forming a generally V-shaped configuration. Thus, compressive forces applied to the layers of tissue will be further reduced thereby further reducing the trauma to layers of tissue disposed between tissue contacting surfaces 520 and 320'. As in the embodiment of FIG. 10, the maximum pressure applied to the layers of tissue will exist in the region near knife channel 530 while pressures applied to the layers of tissue will decrease uniformly towards outer walls 514. Formation and location of surgical fasteners 125a-c is substantially similar to that of the embodiment of FIG. 10 along with the attendant advantages.

[0086] Referring now to FIG. 12, a further embodiment of the present disclosure is shown as part of operative tool 606. Operative tool 606 includes a staple cartridge 610 and anvil member 308. In this embodiment, tissue contacting surface 620 includes surfaces 622 and 624. Surface 622 is bisected along its longitudinal axis by knife channel 630 and substantially parallel to a bottom surface 612 or parallel to a plane defined by the backspans of surgical fasteners 125a, 125b, or 125c. In addition, surface 622 has a width dimension sufficient to accommodate at least one row of retention

slots **623** on each side of knife channel **630**. Surface **624** connects outer edges of surface **622** to outer walls **614** defining an angle on either side of knife channel **630** with respect to a plane that is substantially orthogonal to inner walls **616** (i.e. substantially parallel to surface **622**) and has a width dimension sufficient to accommodate at least one row of retention slots on each side of knife channel **630**. Staple cartridge **610** includes a plurality of surgical fasteners **125a-c** and fastener ejection members **540** that were previously discussed in detail with respect to FIGS. **9** and **10**. In particular, staple cartridge **610** includes the arrangement of surgical fasteners **125a-c** and fastener ejection members **540** as described with respect to staple cartridge **510'** (FIGS. **10** and **11**).

[0087] Similarly to operative tool **506**, tissue contacting surface **320** is repositioned proximate to tissue contacting surface **620** of staple cartridge **610**. In this arrangement, the amount of pressure applied to the layers of tissue disposed therebetween varies along a plane that is transverse to the longitudinal axis of staple cartridge **610**. Specifically, the distance between tissue contacting surface **320** and surface **622** is a minimum, a maximum pressure is applied to the layers of tissue disposed in this region. Conversely, the distance between tissue contacting surface **320** and surfaces **624** is at a maximum in the region near outer walls **614**, a minimum pressure is applied to the layers disposed in this region. Since surface **624** slopes toward outer walls **614** to define a substantially uniform angle, the pressure applied to the layers of tissue disposed between tissue contacting surface **320** and surfaces **624** uniformly decreases from an outer edge of surface **622** towards outer wall **614**.

[0088] By angling surface **624** downwards from the edge of surface **622**, reduced compressive forces are applied to the layers of tissue disposed between tissue contacting surface **320** and surfaces **624** thereby minimizing trauma to the layers of tissue disposed therebetween. Layers of tissue disposed between tissue contacting surfaces **320** and **620** will have a minimum thickness nearest knife channel **630** and a maximum thickness nearest outer walls **614**. In addition, anvil member **308** and staple cartridge **610** are dimensioned and arranged such that compressive forces applied to the layers of tissue are minimal thereby further reducing trauma to the layers of tissue.

[0089] Leg lengths of surgical fasteners **125c**, **125b**, and **125a** increase in a direction moving from inner walls **616** towards outer walls **614**. By providing surgical fasteners having increasing leg lengths along a plane that is orthogonal to inner walls **616**, the completed (i.e. formed) surgical fasteners join increasing thicknesses of tissue without unduly traumatizing the joined layers of tissue.

[0090] In a further embodiment, operative tool **606'** is illustrated in FIG. **13**. Operative tool **606'** includes staple cartridge **610**, that was described in detail hereinabove with respect to FIG. **12**, and anvil member **608**. Anvil member **608** includes a tissue contacting surface **620** formed from surfaces **632** and **636**. Surface **636** is substantially parallel to surface **622** and has a width dimension that is substantially similar to the width dimension of surface **622**. Surfaces **632** are tapered and connected to outer walls of anvil member **608** and extend inwards (i.e. towards the centerline of staple cartridge **610**) and downwards (i.e. towards tissue contacting surface **620**) thereby defining an angle. It is envisioned that

the angle defined by tapered surfaces **632** will be substantially similar to the angle defined by surfaces **624**, but in an opposed direction. Thus, compressive forces applied to the layers of tissue will be further reduced thereby further reducing the trauma to layers of tissue disposed between surfaces **624** and **632**. As in the embodiment of FIG. **10**, the maximum pressure applied to the layers of tissue will exist in the region along surface **622** while pressures applied to the layers of tissue will decrease uniformly along surfaces **624** towards outer walls **614**. Formation and location of surgical fasteners **125a-c** is substantially similar to that of the embodiment of FIG. **12** along with the attendant advantages.

[0091] In yet another embodiment, operative tool **706** is illustrated in FIG. **14**. Staple cartridge **710** is similar to staple cartridge **610**. The differences between staple cartridges **610** and **710** will be discussed hereinafter. As in staple cartridge **610** (FIG. **12**), staple cartridge **710** includes tissue contacting surface **720** formed from surfaces **722** and **724**. Surface **722** differs from surface **622** in that it has a width dimension sufficient to accommodate at least two rows of surgical fasteners. As in staple cartridge **610**, surfaces **724** are attached to outer edges of surface **722** and outer walls **714** to define angles. The interaction between staple cartridge **710** and anvil member **308** for capturing tissue and forming surgical fasteners is substantially similar to the interaction between staple cartridge **610** and anvil member **308** and, for the sake of brevity, will not be repeated herein.

[0092] In a further embodiment, operative tool **706'** is shown in FIG. **15** and includes staple cartridge **710**, as described with respect to FIG. **14**, and anvil member **708**. Anvil member **708** includes a tissue contacting surface **720** formed from surfaces **732** and **736**. Surface **736** is substantially parallel to surface **722** and has a width dimension that is substantially similar to the width dimension of surface **722**. Surfaces **732** are tapered and connected to outer walls of anvil member **708** and extend inwards (i.e. towards the centerline of staple cartridge **710**) and downwards (i.e. towards tissue contacting surface **720**) thereby defining an angle. It is envisioned that the angle defined by tapered surfaces **732** will be substantially similar to the angle defined by surfaces **724**, but in an opposed direction. Thus, compressive forces applied to the layers of tissue will be further reduced thereby further reducing the trauma to layers of tissue disposed between surfaces **724** and **732**. As in the embodiment of FIG. **14**, the maximum pressure applied to the layers of tissue will exist in the region along surface **722** while pressures applied to the layers of tissue will decrease uniformly along surfaces **724** towards outer walls **714**. Formation and location of surgical fasteners **125a-c** is substantially similar to that of the embodiment of FIG. **14** along with the attendant advantages.

[0093] In FIG. **15**, an alternate embodiment of operative tool **706'** is illustrated. Operative tool **706'** includes staple cartridge **710**, as discussed in detail hereinabove, and anvil member **708**. Anvil member **708** includes a tissue contacting surface **720** formed from surfaces **732** and **736**. Surface **736** is substantially parallel to surface **722** and has a width dimension that is substantially similar to a width dimension of surface **722**. Surfaces **732** are tapered and connected to outer walls of anvil member **708** and extend inwards (i.e. towards centerline of staple cartridge **710**) and downwards (i.e. towards tissue contacting surface **720**) thereby defining

an angle. It is envisioned that the angle defined by tapered surfaces **732** will be substantially similar to the angle defined by surfaces **724**, but in an opposed direction. Thus, compressive forces applied to the layers of tissue will be further reduced, thereby further reducing the trauma to the layers of tissue disposed between surfaces **724** and **732**. As in the embodiment of FIG. **14**, the maximum pressure applied to the layers of tissue will exist in the region along surface **722** while pressures applied to the layers of tissue will decrease uniformly along surfaces **724** towards outer walls **714**. Formation and location of surgical fasteners **125a-c** is substantially similar to that of the embodiment of FIG. **14** along with the attendant advantages.

[**0094**] Turning now to FIG. **16**, a cross-section of the resulting tissue interface, following the firing of staple cartridge **510'**, is shown. As seen in FIG. **16**, the tissue interface has a substantially tapered profile. In particular, surgical fasteners **125a** and **125b** (i.e. the two rows of surgical fasteners furthest from knife cut line "C") serve to hold tissues "A" and "B" to one another while surgical fasteners **125c** (i.e. the row of surgical fasteners closest to knife cut line "C") serve to provide the hemostasis. This resulting cross-section is also applicable to the firing of staple cartridges **610** and **710**. When staple cartridge **510** is fired, surgical fasteners **125b** and **125c** (i.e. the two rows of surgical fasteners furthest from knife cut line "C") serve to hold tissues "A" and "B" to one another while surgical fasteners **125a** (i.e. the row of surgical fasteners closest to knife cut line "C") serve to provide the hemostasis.

[**0095**] In a further embodiment of the present disclosure, as shown in FIGS. **8** and **10**, operative tool **506'** includes a wound closure assembly **50**. Wound closure assembly **50** includes at least one storage device or reservoir **52** and at least one supply line **54**. Supply line **54** fluidly couples reservoir **52** to staple cartridge **510'** for delivering an amount of a wound closure material "W". In particular, supply line **54** delivers wound closure material "W" into knife channel **530** such that when surgical fasteners **125a-c** are formed, wound closure material "W" migrates along the layers of tissue adjacent to tissue contacting surface **520** (i.e. the target site). By providing wound closure material "W" in combination with surgical fasteners **125a-c**, the bond formed between the layers of tissue has improved strength.

[**0096**] Compression of reservoir **52** causes wound closure material "W" contained therein to be urged through supply line **54** and dispensed via knife channel **530**. Preferably, wound closure material "W" is dispensed during the staple firing procedure so that wound closure material "W" is dispensed along the length of the staple line and/or a knife cut line. Although wound closure assembly is discussed and illustrated with respect to FIG. **10**, it is contemplated that wound closure assembly **50** is adaptable for use with other disclosed embodiments of staple cartridge **510'** (i.e. **510**, **610**, or **710**). It is further contemplated that an additional reservoir may be included for wound closure materials formed by combining two substances or that reservoir **52** may include a plurality of internal chambers (shown in phantom) for storing quantities of substances to be combined to form wound closure material "W". Further still, wound closure assembly **50** may be included in surgical stapling apparatus **100** (FIG. **1**) wherein at least one opening **56** is disposed in a wall of anvil shaft **110** for dispensing wound closure material "W".

[**0097**] It is envisioned that wound closure material "W" can include one or a combination of adhesives, hemostats, sealants. Surgical biocompatible wound closure materials which can be employed in or applied the surgical instruments, especially surgical staplers, include adhesives **110** whose function is to attach or hold organs, tissues or structures, sealants to prevent fluid leakage, and hemostats to halt or prevent bleeding. Examples of adhesives which can be employed include protein derived, aldehyde-based adhesive materials, for example, the commercially available albumin/glutaraldehyde materials sold under the trade designation BioGlue™ by Cryolife, Inc., and cyanoacrylate-based materials sold under the trade designations Indermil™ and Derma Bond™ by Tyco Healthcare Group, LP and Ethicon Endosurgery, Inc., respectively. Examples of sealants, which can be employed, include fibrin sealants and collagen-based and synthetic polymer-based tissue sealants. Examples of commercially available sealants are synthetic polyethylene glycol-based, hydrogel materials sold under the trade designation CoSeal™ by Cohesion Technologies and Baxter International, Inc. Examples of hemostat materials, which can be employed, include fibrin-based, collagen-based, oxidized regenerated cellulose-based and gelatin-based topical hemostats. Examples of commercially available hemostat materials are fibrinogen-thrombin combination materials under sold the trade designations CoStasis™ by Tyco Healthcare Group, LP, and Tisseel™ sold by Baxter International, Inc. Hemostats herein include astringents, e.g., aluminum sulfate, and coagulants.

[**0098**] It is to be understood that the dispensing of wound closure material "W" can be as a fluid spray of any suitable volume, including a mist, applied temporarily, continuously, or continually. Particulate material, e.g. a fine powder is contemplated to be a fluid within the scope of this disclosure.

[**0099**] It is provided that a number of different wound closure materials "W" can be dispensed by wound closure assembly **50** or a combination of the number of different wound closure materials "W". The wound closure material dispensed by wound closure assembly **50** can, for example, be an astringent, such as a sulfate of aluminum, which causes small blood vessels to close and helps the blood to coagulate. It is provided that wound closure material "W" can be an astringent provided in the material commercially available under the trade designation No Nix Styptic Pencils from Requa™, Inc.

[**0100**] In addition, while each of the surgical stapling instruments described above and shown herein include tissue contacting surfaces having a stepped profile, it is envisioned that any of the surgical stapling instruments disclosed herein can have tissue contacting surfaces having any one of a number of profiles including and not limited to angles, conical, tapered, arcuate and the like, as disclosed in commonly assigned U.S. patent application Ser. No. 10/411,686, filed on May 11, 2003, entitled "Surgical Stapling Apparatus Including an Anvil and Cartridge Each Having Cooperating Mating Surfaces," currently assigned to Tyco Healthcare Group LP, the entire contents of which is incorporated herein by reference.

[**0101**] It will be understood that various modifications may be made to the embodiments of the presently disclosed surgical stapling instruments. Therefore, the above descrip-

tion should not be construed as limiting, but merely as exemplifications of embodiments. Those skilled in the art will envision other modifications within the scope and spirit of the present disclosure.

What is claimed is:

1. A replaceable loading unit for a surgical stapling apparatus comprising:

a) a cartridge having:

i) at least two cartridge tissue contacting surfaces, one of the cartridge tissue contacting surfaces having a different height than the other,

ii) the at least two cartridge tissue contacting surfaces defining retention slots for retaining staples,

iii) the staples in the retention slots including at least a first staple and a second staple, the first staple having a first leg length different from a second leg length of the second staple.

2. The replaceable loading unit of claim 1, further comprising an anvil having an anvil tissue contacting surface defining staple forming depressions.

3. The replaceable loading unit of claim 1, wherein the cartridge is a circular staple cartridge defining the at least two cartridge tissue contacting surfaces.

4. The replaceable loading unit of claim 1, wherein the retention slots are arranged in at least one circular row.

5. The replaceable loading unit of claim 1, wherein the retention slots are arranged in at least one linear row.

6. The replaceable loading unit of claim 1, wherein the at least two cartridge tissue contacting surfaces comprises a first tissue contacting surface and a second tissue contacting surface.

7. The replaceable loading unit of claim 6, wherein the staples in the retention slots of the first tissue contacting surface have a leg length of about 2.3 millimeters and the staples in the retention slots of the second tissue contacting surface have a leg length of about 3.5 millimeters.

8. The replaceable loading unit of claim 7, further comprising a third tissue contacting surface, the staples in the retention slots of the third tissue contacting surface have a leg length of about 4.1 millimeters.

9. The replaceable loading unit of claim 1, wherein the surgical stapling apparatus is a gastrointestinal stapler.

10. The replaceable loading unit of claim 6, wherein the cartridge defines a knife track.

11. The replaceable loading unit of claim 10, wherein the cartridge includes a plurality of rows of staples, the staples of the first tissue contacting surface being disposed adjacent the knife track.

12. The replaceable loading unit of claim 1, wherein the surgical stapling apparatus is a laparoscopic stapler.

13. A surgical stapling apparatus comprising:

a) an anvil having an anvil tissue contacting surface defining staple forming depressions;

b) a cartridge having:

i) a first tissue contacting surface and a second tissue contacting surface, the first tissue contacting surface having a first height and the second tissue contacting surface having a second height, the first height being greater than the second height,

ii) the first and second tissue contacting surfaces defining retention slots for retaining staples, and

iii) the staples in the retention slots of the second tissue contacting surface having a larger leg length than the staples in the retention slots of the first tissue contacting surface.

14. The surgical stapling apparatus of claim 13, further comprising a drive assembly for moving pushers within the retention slots to urge the staples from the retention slots against the staple forming depressions.

15. The surgical stapling apparatus of claim 13, further comprising a handle assembly.

16. The surgical stapling apparatus of claim 15, further comprising a tubular body portion.

17. The surgical stapling apparatus of claim 13, wherein the tubular body portion is curved along its length.

18. The surgical stapling apparatus of claim 13, wherein the cartridge is a circular staple cartridge defining the first and second tissue contacting surfaces.

19. The surgical stapling apparatus of claim 18, wherein the retention slots are arranged in circular rows.

20. The surgical stapling apparatus of claim 13, further comprising a wound closure assembly.

21. The surgical stapling apparatus of claim 13, wherein the wound closure assembly includes a reservoir having a wound closure material.

22. The surgical stapling apparatus of claim 13, wherein the anvil comprises a circular anvil.

23. The surgical stapling apparatus of claim 22, further comprising an anvil shaft.

24. The surgical stapling apparatus of claim 13, wherein the surgical stapling apparatus is configured for dispensing a wound closure material to tissue adjacent the first tissue contacting surface.

25. The surgical stapling apparatus of claim 13, wherein the staples in the retention slots of the second tissue contacting surface have a leg length of about 3.5 millimeters and the staples in the retention slots of the first tissue contacting surface have a leg length of about 2.3 millimeters.

26. The surgical stapling apparatus of claim 13, wherein the staples in the retention slots of the second tissue contacting surface have a leg length of about 4.1 millimeters and the staples in the retention slots of the first tissue contacting surface have a leg length of about 3.5 millimeters.

27. The surgical stapling apparatus of claim 13, further comprising a third tissue contacting surface having a third height.

28. The surgical stapling apparatus of claim 27, wherein the third tissue contacting surface has retention slots having staples disposed therein.

29. The surgical stapling apparatus of claim 28, wherein the staples in the retention slots of the first tissue contacting surface have a leg length of about 2.3 millimeters, the staples in the retention slots of the second tissue contacting surface have a leg length of about 3.5 millimeters, and the staples in the retention slots of the third tissue contacting surface have a leg length of about 4.1 millimeters.

30. The surgical stapling apparatus of claim 13, wherein the surgical stapling apparatus is a gastrointestinal stapler.

31. The surgical stapling apparatus of claim 13, wherein the cartridge defines a knife track.

32. The surgical stapling apparatus of claim 13, wherein the cartridge includes a plurality of rows of staples, the staples of the first tissue contacting surface being disposed adjacent the knife track.

33. The surgical stapling apparatus of claim 13, wherein the surgical stapling apparatus is a laparoscopic stapler.

34. The surgical stapling apparatus of claim 33, further comprising a handle.

35. The surgical stapling apparatus of claim 34, further comprising an elongated shaft.

36. The surgical stapling apparatus of claim 35, wherein the cartridge defines a knife track.

* * * * *

专利名称(译)	外科缝合器械包括具有多种钉尺寸的钉仓		
公开(公告)号	US20070034668A1	公开(公告)日	2007-02-15
申请号	US11/512943	申请日	2006-08-29
[标]申请(专利权)人(译)	柯惠有限合伙公司		
申请(专利权)人(译)	泰科医疗集团LP		
当前申请(专利权)人(译)	泰科医疗集团LP		
[标]发明人	HOLSTEN HENRY E VIOLA FRANK J EMMONS CLIFFORD L		
发明人	HOLSTEN, HENRY E. VIOLA, FRANK J. EMMONS, CLIFFORD L.		
IPC分类号	A61B17/04		
CPC分类号	A61B17/00491 A61B17/068 A61B17/072 A61B17/07207 A61B17/11 A61B2017/320052 A61B17/115 A61B17/1155 A61B17/32053 A61B2017/07235 A61B2017/07242 A61B17/1114 A61B2017/07264		
其他公开文献	US7837079		
外部链接	Espacenet USPTO		

摘要(译)

外科缝合器械包括钉仓和砧构件。钉仓包括设置在多排保持槽中的多个外科紧固件。钉仓可具有环形或线性构造的保持槽。钉仓的组织接触表面可以是锥形的或阶梯状的。砧座构件具有组织接触表面，该组织接触表面包括多个口袋，这些口袋布置成与保持槽基本对齐。另外，砧座构件的组织接触表面可以与钉仓的组织接触表面互补。

