



US007890211B2

(12) **United States Patent**
Green

(10) **Patent No.:** **US 7,890,211 B2**
(45) **Date of Patent:** ***Feb. 15, 2011**

(54) **MASTER-SLAVE MANIPULATOR SYSTEM
AND APPARATUS**

(75) Inventor: **Philip S. Green**, Redwood City, CA
(US)

(73) Assignee: **Intuitive Surgical Operations, Inc.**,
Sunnyvale, CA (US)

(*) Notice: Subject to any disclaimer, the term of this
patent is extended or adjusted under 35
U.S.C. 154(b) by 485 days.

This patent is subject to a terminal dis-
claimer.

(21) Appl. No.: **11/765,883**

(22) Filed: **Jun. 20, 2007**

(65) **Prior Publication Data**

US 2007/0276423 A1 Nov. 29, 2007

Related U.S. Application Data

(63) Continuation of application No. 11/360,745, filed on
Feb. 22, 2006, now Pat. No. 7,248,944, which is a
continuation of application No. 11/015,212, filed on
Dec. 16, 2004, now Pat. No. 7,107,124, which is a
continuation of application No. 08/709,930, filed on
Sep. 9, 1996, now Pat. No. 6,963,792, which is a con-
tinuation of application No. 07/823,932, filed on Jan.
21, 1992, now abandoned.

(51) **Int. Cl.**
G05B 19/04 (2006.01)

(52) **U.S. Cl.** **700/251; 348/65; 700/245;**
700/259; 700/264; 700/275; 901/30

(58) **Field of Classification Search** 700/245,
700/250, 251, 254, 257, 264, 3, 247, 258,
700/259, 260, 275; 348/E13.014, E13.016,
348/E13.025, E13.038, E13.04, E13.059,
348/E13.071, 65; 901/3, 46, 47, 1, 2, 9, 30,
901/33, 34, 41; 318/568.1; 600/130, 101,
600/102, 103, 104, 109, 118, 424, 427, 429,
600/595; 414/3, 4, 7, 8; 606/60, 68, 167,
606/170, 256, 258, 1, 130; 382/128, 154,
382/296, 311

See application file for complete search history.

(56) **References Cited**

U.S. PATENT DOCUMENTS

1,418,184 A 5/1922 Trunick

(Continued)

FOREIGN PATENT DOCUMENTS

CH 482439 12/1969

(Continued)

OTHER PUBLICATIONS

Vertut, Jean et al., Robot Technology: Teleoperation and Robotics
Evolution and Development, 1986, vol. 3A, 332 pages, English trans-
lation Prentice-Hall, Inc., Englewood Cliffs, NJ, USA.

Primary Examiner—Khoi Tran

Assistant Examiner—Stephen Holwerda

(57) **ABSTRACT**

A teleoperator system with telepresence is shown which
includes right and left hand controllers (72R and 72L) for
control of right and left manipulators (24R and 24L) through
use of a servomechanism that includes computer (42). Cam-
eras (46R and 46L) view workspace (30) from different
angles for production of stereoscopic signal outputs at lines
(48R and 48L). In response to the camera outputs a 3-dimen-
sional top-to-bottom inverted image (30I) is produced which,
is reflected by mirror (66) toward the eyes of operator (18). A
virtual image (30V) is produced adjacent control arms (76R
and 76L) which is viewed by operator (18) looking in the
direction of the control arms. Use of the teleoperator system
for surgical procedures also is disclosed.

22 Claims, 9 Drawing Sheets

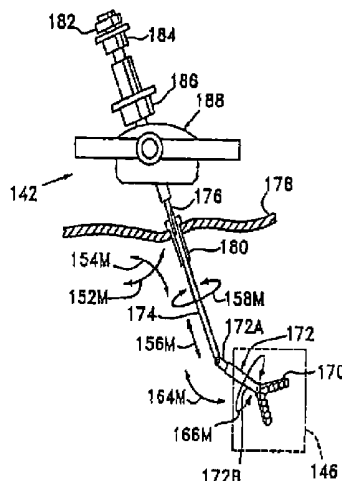

U.S. PATENT DOCUMENTS

1,620,828 A 3/1927 Molony
 2,640,994 A 6/1953 Anderson
 2,815,697 A 12/1957 Saunders-Singer
 2,861,699 A * 11/1958 Youmans 414/4
 2,901,258 A 8/1959 Brandafi
 3,145,333 A 8/1964 Pardini et al.
 3,241,687 A 3/1966 Orloff
 3,463,329 A 8/1969 Gartner
 3,818,125 A 6/1974 Butterfield
 3,921,445 A 11/1975 Hill et al.
 3,923,166 A 12/1975 Fletcher et al.
 3,934,201 A 1/1976 Majefski
 4,062,455 A 12/1977 Flatau
 4,113,115 A 9/1978 Yoshio
 4,149,278 A 4/1979 Frosch
 4,260,319 A 4/1981 Motoda et al.
 4,264,266 A 4/1981 Trechsel
 4,302,138 A 11/1981 Zarudiansky
 4,349,837 A 9/1982 Hinds
 4,367,998 A 1/1983 Causer
 4,419,041 A 12/1983 Rose
 4,505,166 A 3/1985 Tesar
 4,510,574 A 4/1985 Guittet et al.
 4,511,305 A 4/1985 Kawai
 4,562,463 A 12/1985 Lipton
 4,582,067 A 4/1986 Silverstein et al.
 4,583,117 A 4/1986 Lipton et al.
 4,636,138 A 1/1987 Gorman
 4,651,201 A 3/1987 Schoolman
 4,672,964 A 6/1987 Dee et al.
 4,674,501 A 6/1987 Greenberg
 4,744,363 A 5/1988 Hasson
 4,750,475 A 6/1988 Yoshihashi
 4,751,925 A 6/1988 Tontarra
 4,762,455 A 8/1988 Coughlan et al.
 4,766,775 A 8/1988 Hodge
 4,780,047 A 10/1988 Holt
 4,808,898 A 2/1989 Pearson
 4,831,531 A 5/1989 Adams et al.
 4,837,734 A 6/1989 Ichikawa et al.
 4,855,822 A 8/1989 Narendra et al.
 4,862,873 A 9/1989 Yajima et al.
 4,873,572 A 10/1989 Miyazaki et al.
 4,874,998 A 10/1989 Hollis
 4,880,015 A 11/1989 Niernan
 4,883,400 A 11/1989 Kuban et al.
 4,899,730 A 2/1990 Stennert et al.
 4,922,338 A 5/1990 Arpino
 4,941,106 A 7/1990 Krieger
 4,942,539 A 7/1990 McGee et al.
 4,947,702 A * 8/1990 Kato 74/490.03
 4,950,273 A * 8/1990 Briggs 606/113
 5,002,418 A 3/1991 McCown et al.
 5,020,933 A * 6/1991 Salvestro et al. 403/90
 5,045,936 A * 9/1991 Lobb et al. 348/67
 5,060,532 A * 10/1991 Barker 74/490.01
 5,062,761 A * 11/1991 Glachet 414/729
 5,078,140 A 1/1992 Kwoh
 5,096,236 A 3/1992 Thony
 5,105,367 A 4/1992 Tsuchihashi et al.
 5,141,519 A 8/1992 Smith et al.
 5,142,930 A 9/1992 Allen et al.
 5,174,300 A 12/1992 Bales
 5,178,032 A 1/1993 Zona
 5,195,388 A 3/1993 Zona
 5,209,747 A 5/1993 Knoepfler
 5,217,003 A 6/1993 Wilk
 5,217,453 A 6/1993 Wilk
 5,219,351 A 6/1993 Teubner et al.
 5,236,432 A 8/1993 Matsen, III et al.
 5,253,706 A 10/1993 Reid

5,254,130 A 10/1993 Poncet
 5,257,998 A 11/1993 Ota et al.
 5,260,319 A 11/1993 Effland et al.
 5,264,266 A 11/1993 Yokoyama et al.
 5,273,039 A 12/1993 Fujiwara et al.
 5,275,608 A 1/1994 Forman et al.
 5,279,309 A 1/1994 Taylor et al.
 5,281,220 A 1/1994 Blake, III
 5,284,130 A 2/1994 Ratliff
 5,318,589 A 6/1994 Lichtman
 5,325,866 A 7/1994 Krzyzanowski
 5,339,799 A 8/1994 Kami et al.
 5,368,015 A 11/1994 Wilk
 5,374,277 A 12/1994 Hasser
 5,382,885 A 1/1995 Salcudean
 5,397,323 A 3/1995 Taylor et al.
 5,425,528 A 6/1995 Rains et al.
 5,430,643 A 7/1995 Seraji
 5,441,505 A 8/1995 Nakamura
 5,474,566 A 12/1995 Alesi et al.
 5,480,409 A 1/1996 Riza
 5,636,138 A 6/1997 Gilbert et al.
 5,710,870 A 1/1998 Ohm
 5,762,458 A 6/1998 Wang et al.
 5,784,542 A 7/1998 Ohm
 5,791,231 A 8/1998 Cohn
 5,808,665 A * 9/1998 Green 348/65
 5,976,156 A 11/1999 Taylor et al.
 6,102,850 A 8/2000 Wang et al.
 6,223,100 B1 * 4/2001 Green 700/264
 6,244,809 B1 6/2001 Wang et al.
 6,259,806 B1 7/2001 Green
 6,364,888 B1 4/2002 Niemeyer et al.
 6,424,885 B1 7/2002 Niemeyer et al.
 6,731,988 B1 * 5/2004 Green 700/3
 6,788,999 B2 * 9/2004 Green 700/275
 6,850,817 B1 * 2/2005 Green 700/245
 6,889,116 B2 5/2005 Jinno
 6,963,792 B1 * 11/2005 Green 700/251
 6,993,413 B2 1/2006 Sunaoshi
 6,994,716 B2 2/2006 Jinno et al.
 6,999,852 B2 * 2/2006 Green 700/245
 7,006,895 B2 * 2/2006 Green 700/245
 7,043,338 B2 5/2006 Jinno
 7,248,944 B2 * 7/2007 Green 700/245

FOREIGN PATENT DOCUMENTS

DE 2819976 11/1979
 DE 3806190 9/1988
 DE 4213426 10/1992
 EP 239409 9/1987
 EP 0291292 11/1988
 EP 0595291 5/1994
 FR 2460762 1/1981
 FR 2593106 3/1990
 GB 2040134 8/1980
 GB 2117732 10/1983
 JP 04-146097 5/1992
 JP 05-076482 3/1993
 JP 2003-61969 3/2003
 WO WO-9216141 10/1992

OTHER PUBLICATIONS

0/0/0000, 0/0/0000. Introduction to New Project for the National Research Development Program (Large-Scale Project) in FY 1991—Micromachine Technology, Agency of Industrial Science and Technology Ministry of International Trade and Industry, Japan, 1991, pp. 1-11.
 Alexander D III, Impacts of Telemation on Modern Society, 1973. vol. 2, 122-136.
 Another Pair of Hands for Surgeon, The Blue Cross magazine Perspective, 1972, 3 Pages Total.

- Asada et al., Development of a direct drive arm using high torque brushless motors, Robotics Research, MIT Press, 1984, pp. 583-599.
- Bejczy A.K. et al., Controlling Remote Manipulators through Kinesthetic Coupling., Computers in Mechanical Engineering, 1983, pp. 48-60.
- Fisher S.S., Virtual interface environment, IEEE/AIAA 7th Digital Avionics Systems Conference Ft. Worth TeXas, Oct. 13-16, 1986, pp. 346-350.
- Jau BM, Anthropomorphic Remote Manipulator, NASA Tech Briefs, Apr. 1991, pp. 92.
- Kazerooni, Design and Analysis of the Statically Balanced Direct-Drive Robot Manipulator, Robotics and Computer-Integrated Manufacturing, Nov. 4, 1989, 6, 287-293.
- Michael J. Mack Minimally Invasive and Robotic Surgery, 2001, vol. 285, No. 5, 568-572.
- Ng W S et al., Robotic Surgery, IEEE Engineering in Medicine and Biology, Mar. 1993, pp 120-125.
- Richard Held, Telepresence, Time Delay, and Adaptation, 1989, 17 Pages Total.
- Richter. Telesurgery may bridge future gaps, Jan. 24, 1988, pp. A1 A16.
- S.M.O.S.: Stereotaxical Microtelemanipulator for Ocular Surgery (Aicha Guerrouad and Pierre Vidal) , IEEE, 1989, pp. 879-880.
- Spain Edward H, Stereo Advantage for a Peg in Hole Task Using a Force Feedback Manipulator SPIE Stereoscopic Displays and Applications, 1990, vol. 1256, pp. 244-254.
- Tachi et al., Tele Existence Master Slave System for Remote Manipulation (II), IEEE Conference on Decision and Control Honolulu Hawaii, Dec. 5-7 1990. vol 1 of 6. pp 85-90.
- Taubes et al. Surgery in cyberspace, Discover magazine, 1994, vol. 15/No. 12, pp. 85-92.
- Taylor et al.. A Telerobotic Assistant for Laparoscopic Surgery, IEEE Engineering in Medicine and Biology, May/Jun. 1995, pp. 279-288.
- The Cleveland Clinic Heart Center web site for "Minimally Invasive Heart Surgery" (May 21, 2003).
- Trevelyan, James P. et al Motion Control for a Sheep Shearing Robot , Proceedings of the 1st International Symposium on Robotics Research, MIT Cambridge, Massachusetts, USA, 1983, 175-190.
- USPTO Examiner's Interview Summary regarding U.S. Appl. No. 09/578,202—Mailing date Oct. 2, 2001.
- USPTO Interview Summary regarding U.S. Appl. No. 09/578,202—Mailing date Aug. 1, 2002.
- USPTO Office Action regarding U.S. Appl. No. 09/578,202—Mailing date Dec. 1, 2001.
- USPTO Office Action regarding U.S. Appl. No. 09/578,202—Mailing date Jul. 19, 2001.
- USPTO Office Action regarding U.S. Appl. No. 09/578,202—Mailing date Jun. 4, 2002.
- USPTO Office Action regarding U.S. Appl. No. 09/578,202—Mailing date May 28, 2003.
- USPTO Office Action regarding U.S. Appl. No. 09/578,202—Mailing date Nov. 12, 2002.
- USPTO Office Action regarding U.S. Appl. No. 09/578,202—Mailing date Apr. 2, 2001.
- Wang, Potential for Robotics Technology in Surgery. NET Journal, 2002, 5 Pages Total.
- Won S. Kim et al. A Helmet Mounted Display for Telerobotics, IEEE, 1988, CH2539-5, 543-547.

* cited by examiner

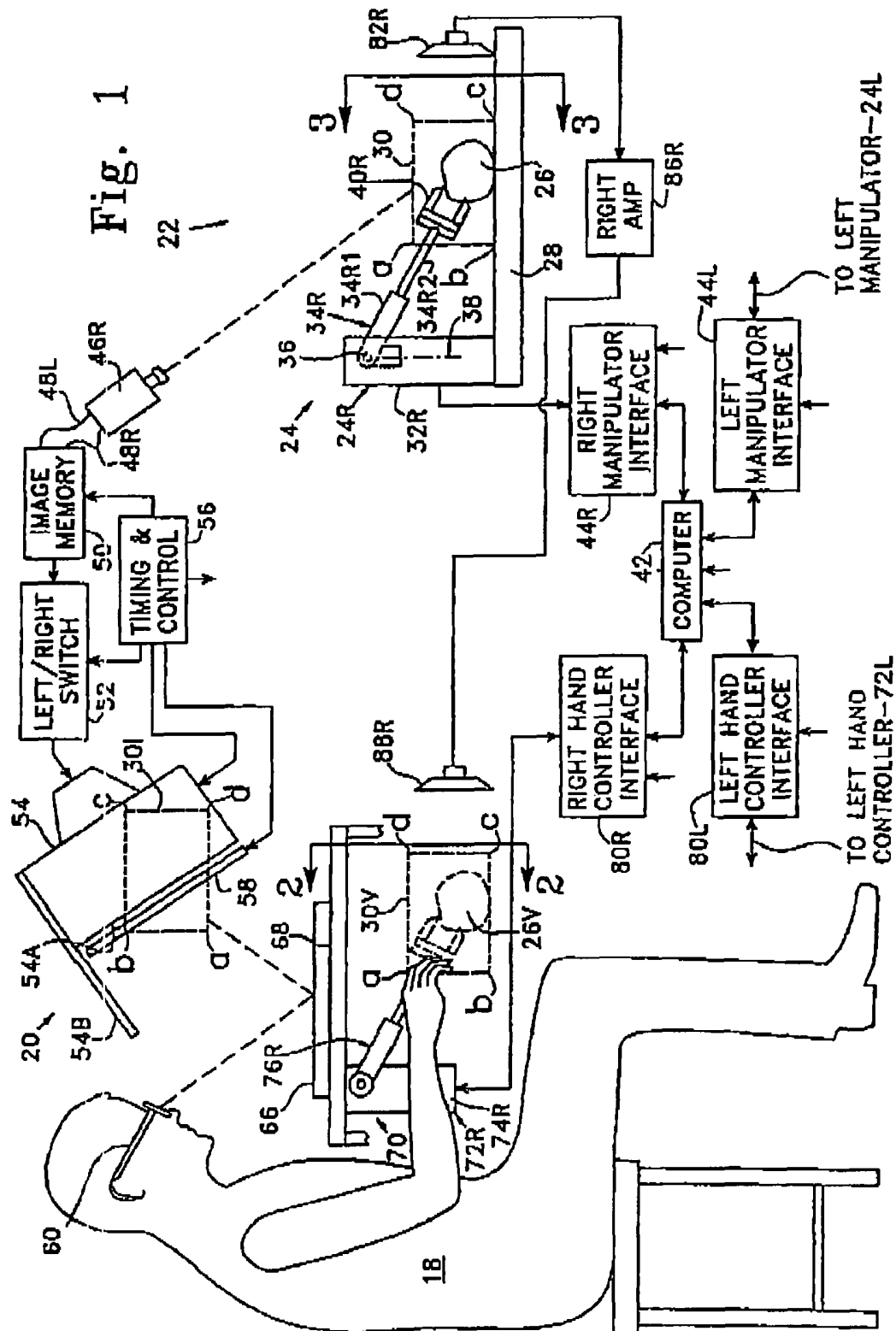

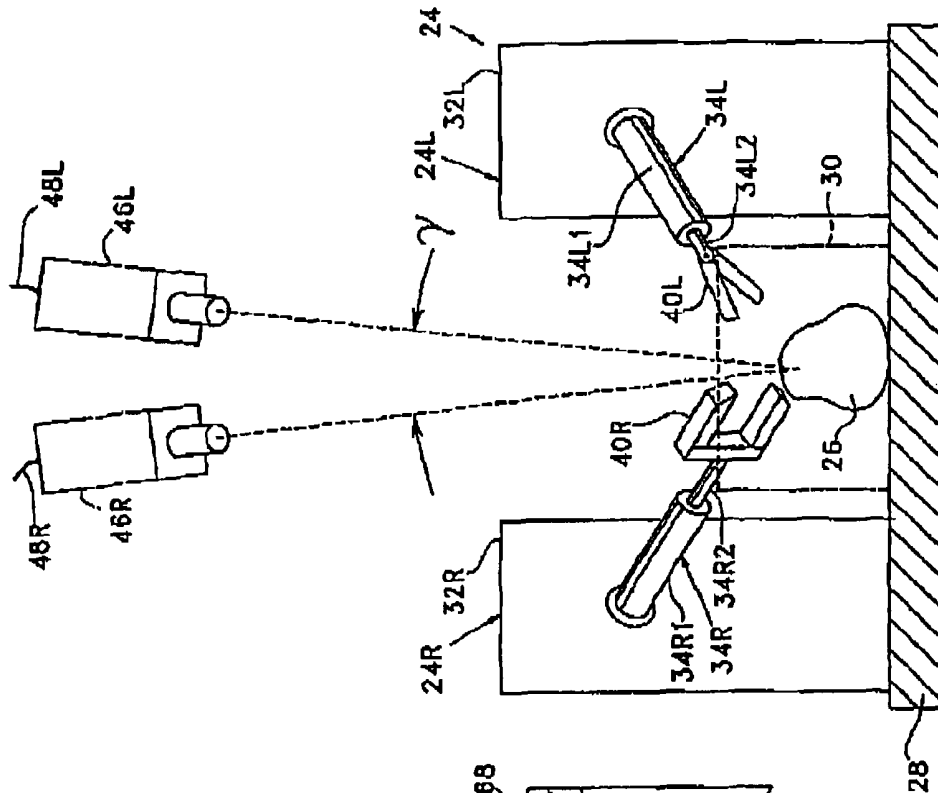

Fig. 3

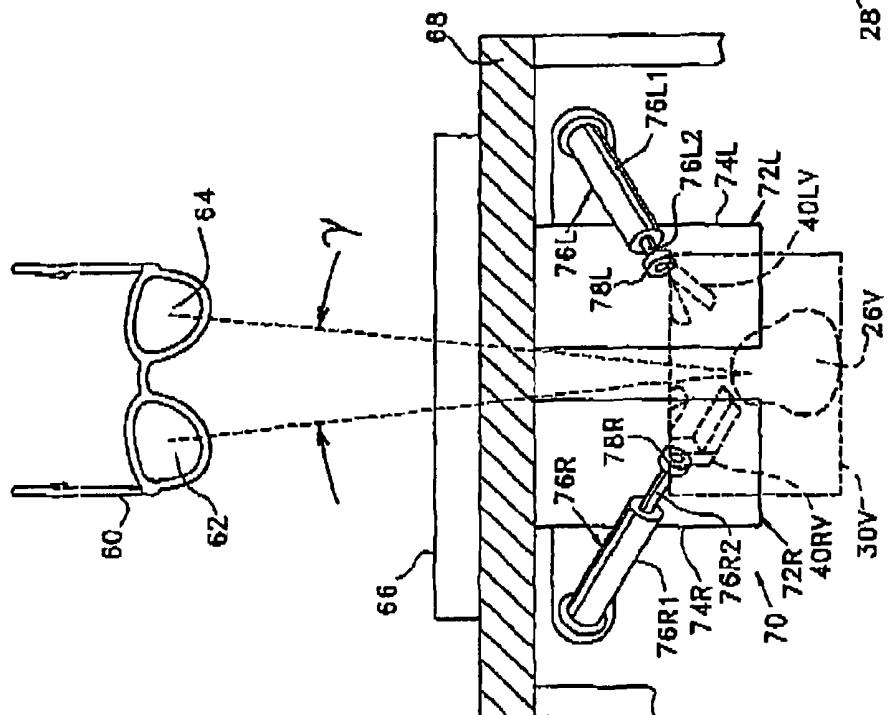

Fig. 2

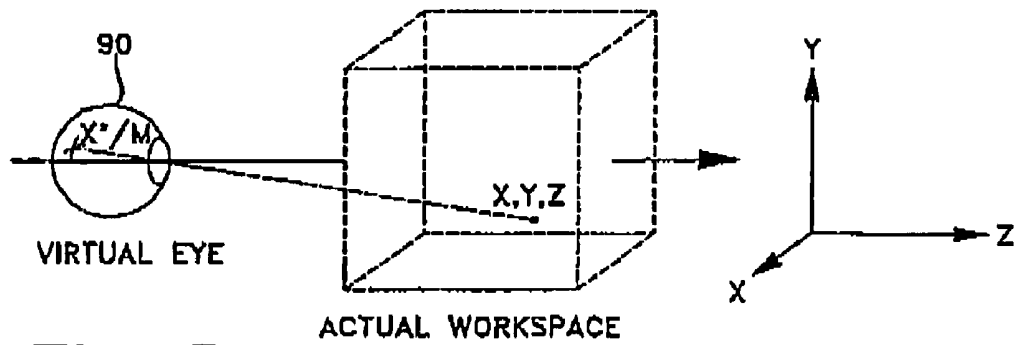

Fig. 5

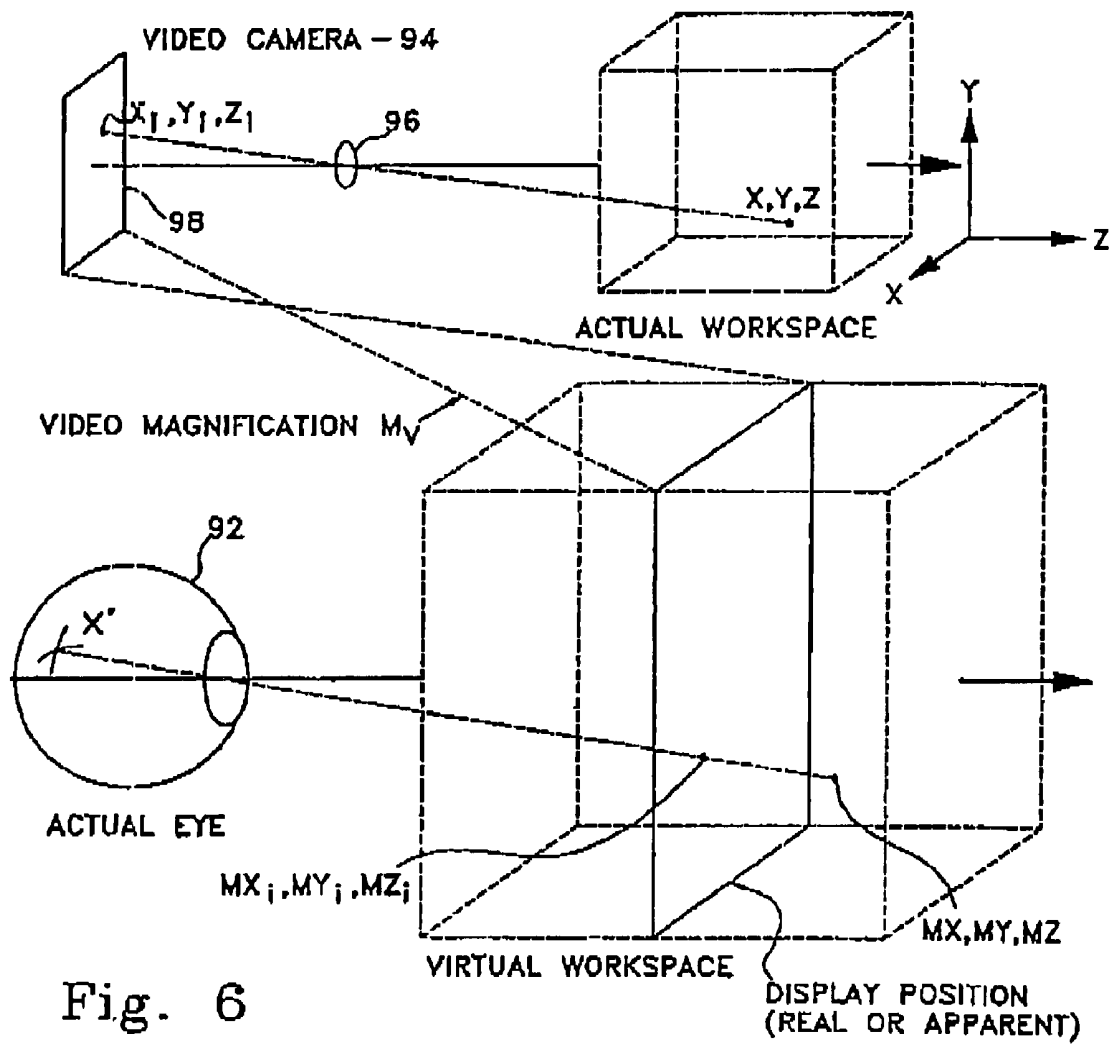
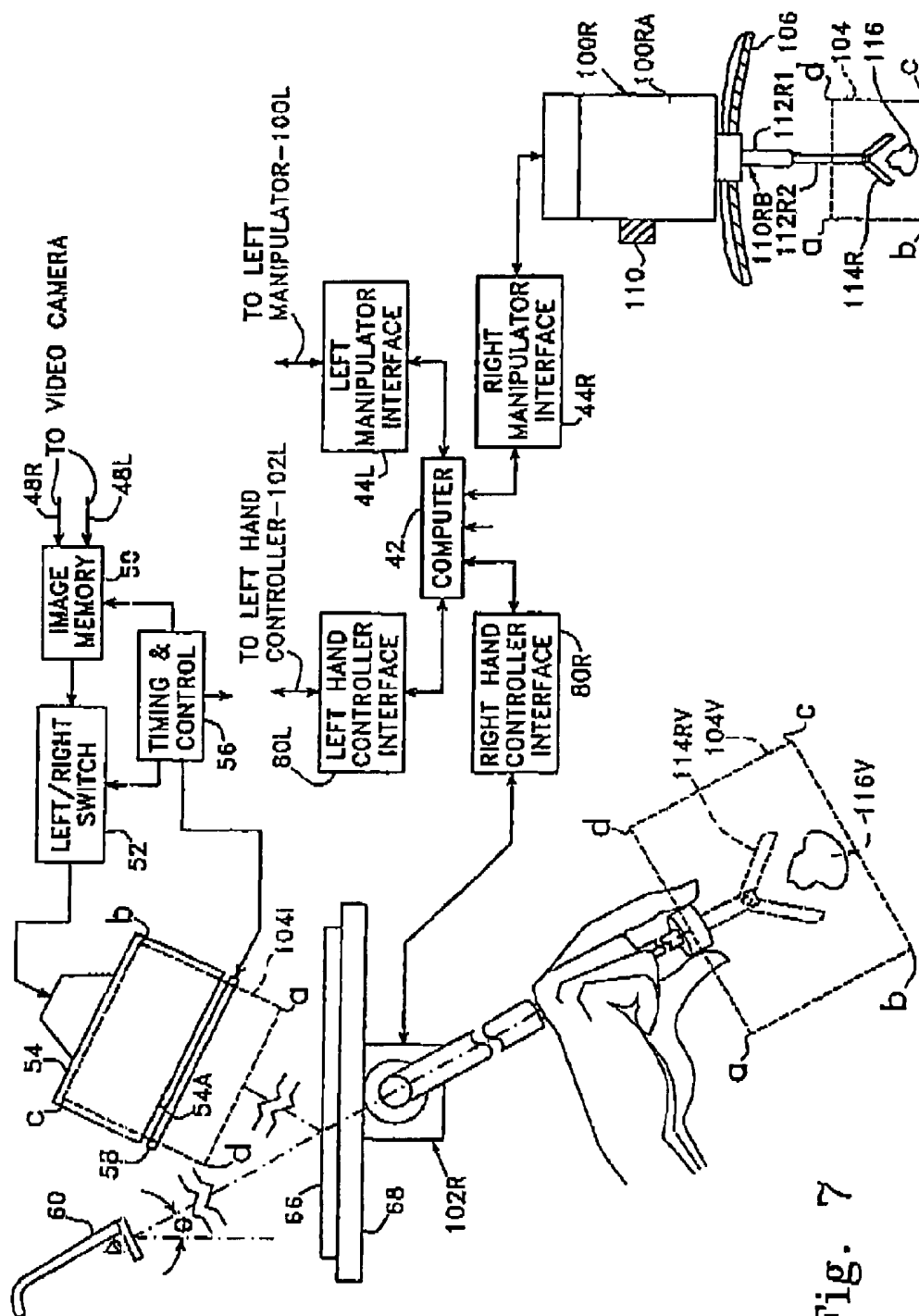

Fig. 6



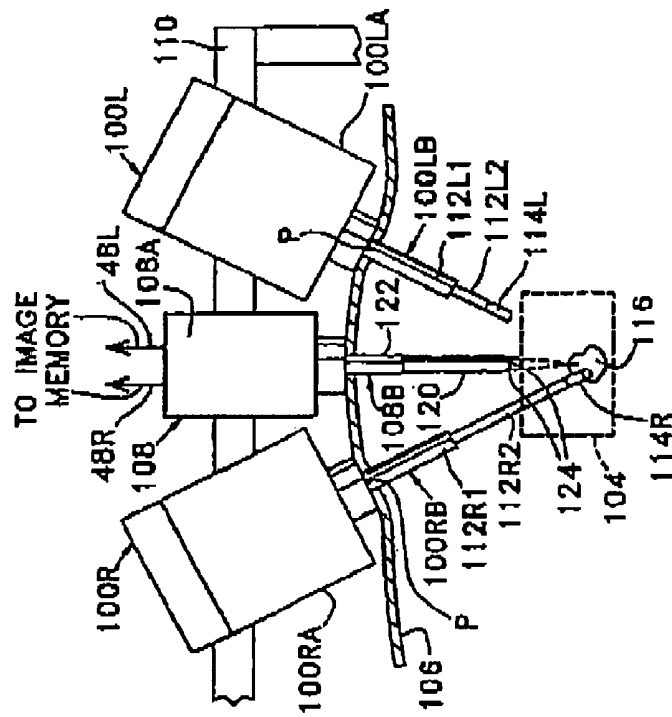
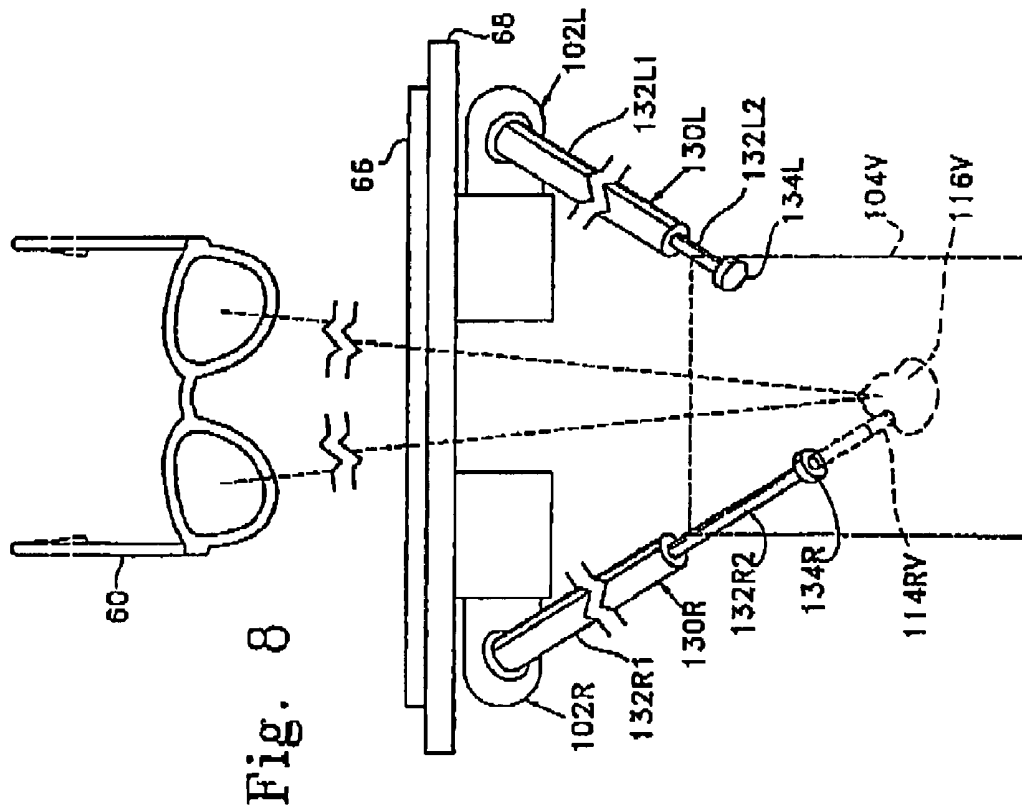

Fig. 10

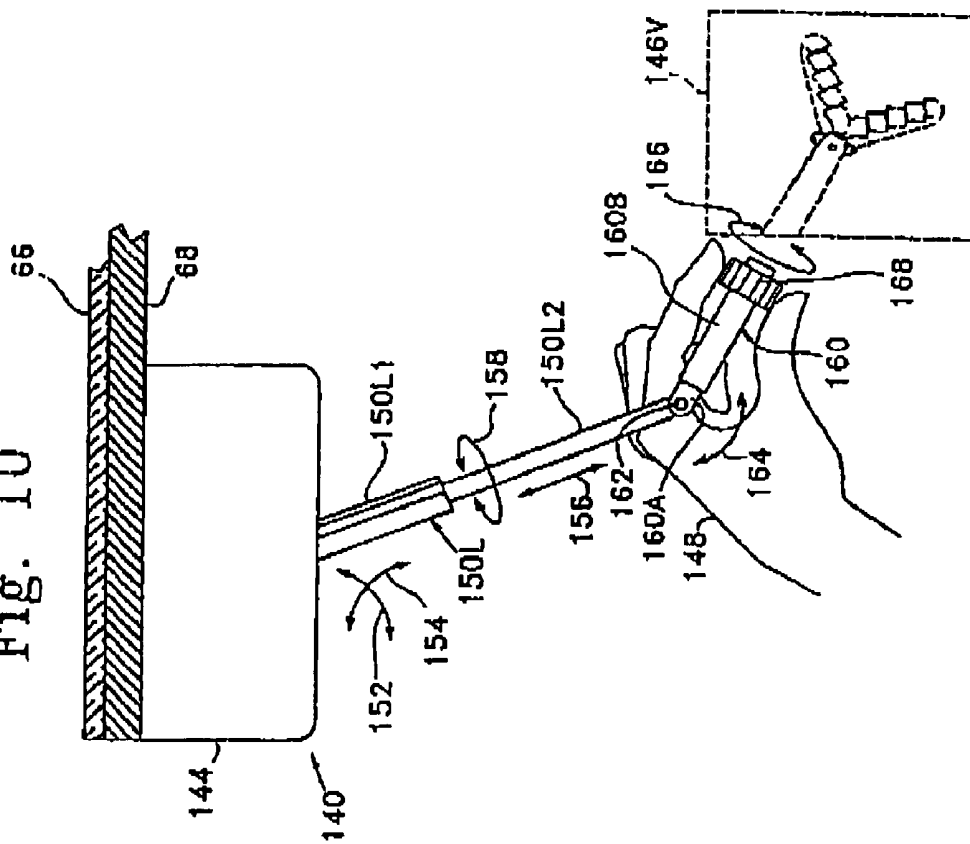
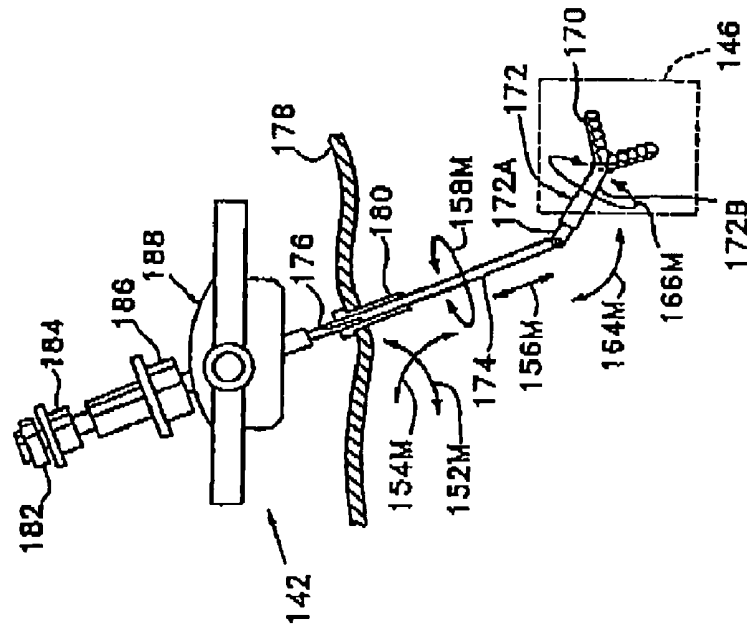

Fig. 11



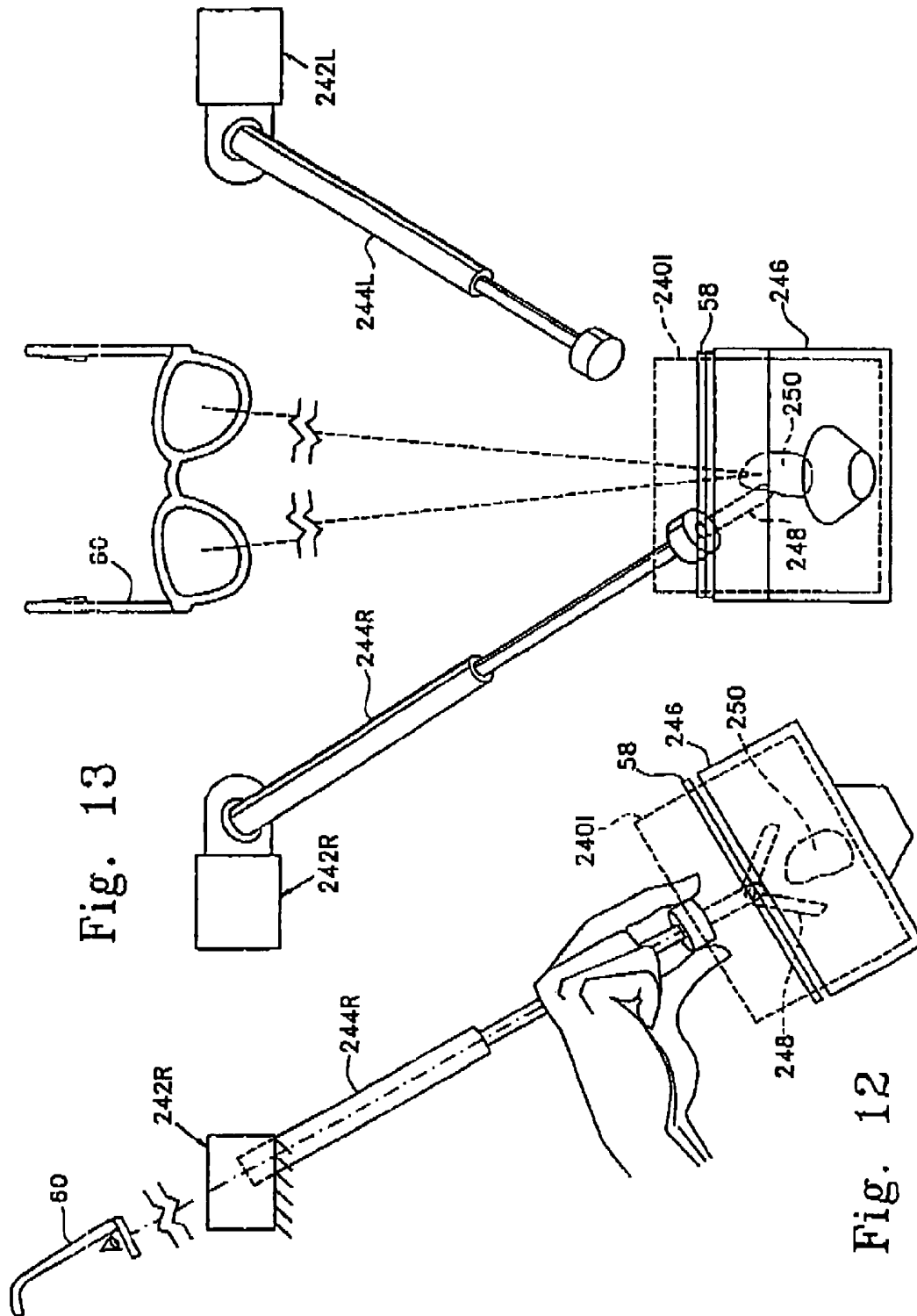

Fig. 13

Fig. 12

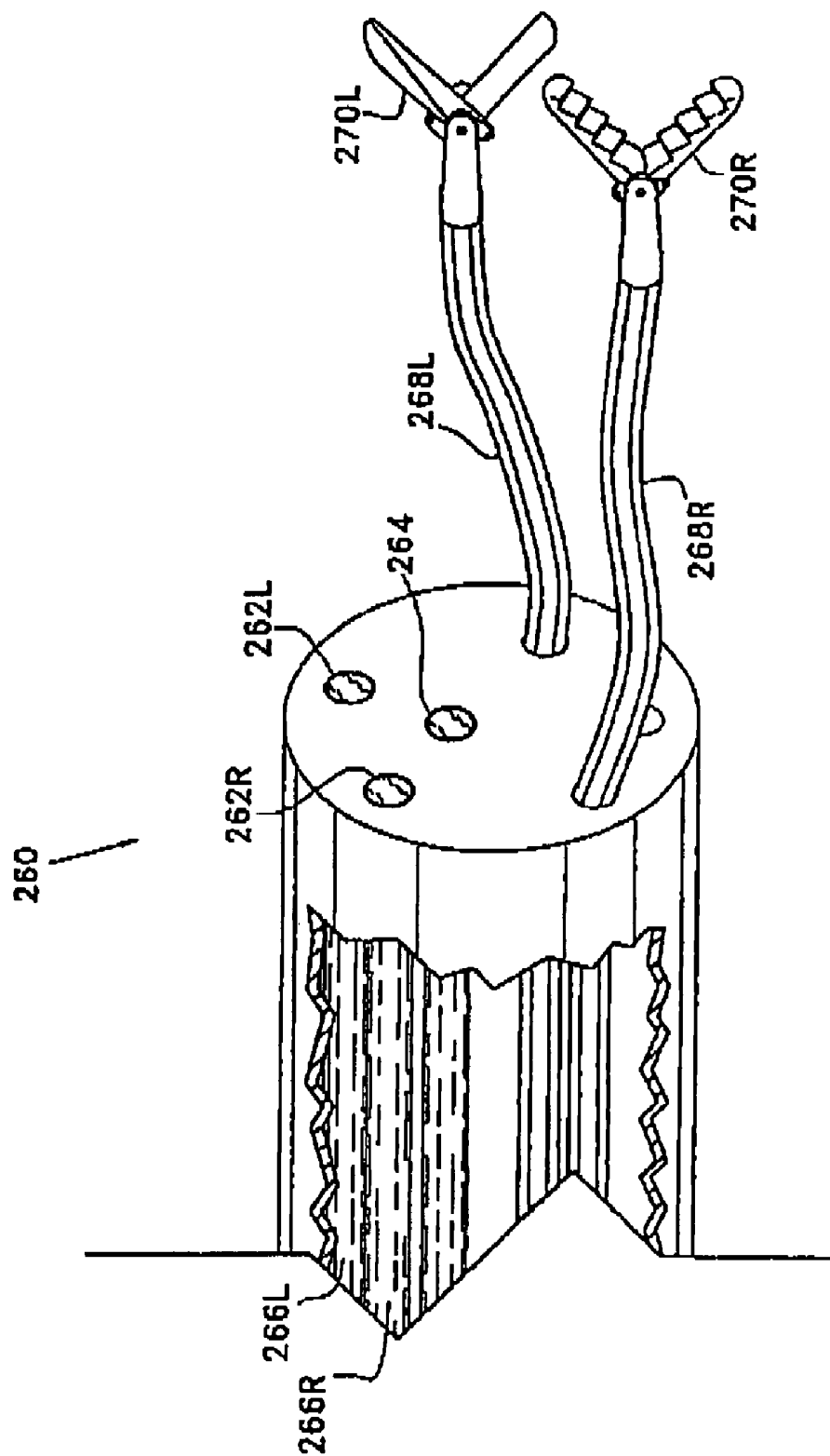

Fig. 14

**MASTER-SLAVE MANIPULATOR SYSTEM
AND APPARATUS****CROSS-REFERENCES TO RELATED
APPLICATIONS**

This application is a continuation of U.S. patent application Ser. No. 11/015,212 filed Dec. 16, 2004; which is a continuation of U.S. patent application Ser. No. 08/709,930 filed Sep. 9, 1996 (now U.S. Pat. No. 6,963,792), which is a continuation of U.S. patent application Ser. No. 07/823,932 filed Jan. 21, 1992 (now abandoned), the full disclosures of which are incorporated herein by reference.

**STATEMENT AS TO RIGHTS TO INVENTIONS
MADE UNDER FEDERALLY SPONSORED
RESEARCH OR DEVELOPMENT**

Not Applicable

**REFERENCE TO A "SEQUENCE LISTING," A
TABLE, OR A COMPUTER PROGRAM LISTING
APPENDIX SUBMITTED ON A COMPACT DISK**

Not Applicable

FIELD OF THE INVENTION

This invention relates generally to teleoperator method and apparatus, and particularly to those which include means for providing the operator of remote apparatus with the same sense as working directly with his hands at the worksite.

BACKGROUND OF THE INVENTION

Teleoperating, which is well known, includes the human performance of tasks at a remote location using manipulators. Telepresence includes providing the teleoperator with the same feedback and control that he would have were he actually at the worksite carrying out the operation with his own hands. Telepresence operation generally includes use of a stationary visual display, particularly a stereographic visual display of the remote workspace. Stereoscopic television systems are well known as shown, for example, in U.S. Pat. Nos. 4,562,463 and 4,583,117 and in U.K. Patent Application GB 2,040,134.

Remote manipulators employing stereoscopic TV viewing together with force feedback also are well known as shown, for example, in an article entitled, "Controlling Remote Manipulators Through Kinesthetic Coupling," Bejczy et al, Computers in Mechanical Engineering, July 1983, pps. 48-60, and in an article entitled, "Stereo Advantage for a Peg-In-Hole Task Using a Force-Feedback Manipulator" by E. H. Spain, SPIE Vol. 1256 Stereoscopic Displays and Applications, 1990, pps. 244-254. In the Bejczy et al. article) force-torque feedback is disclosed. Also, in U.S. Pat. No. 3,921,445, a manipulator which includes force, torque and slip sensors of a type which may be employed with the present invention is shown.

Even though the operator of prior art manipulators is provided with a stationary three-dimensional image of the workspace, and manual controllers for control of the manipulators are provided with feedback, the operator is not provided with a sense of actually being present at the worksite. The present invention is directed to a viewing arrangement for use in a remote manipulation system which substantially adds to the operator's sense of presence at the remote manipulator site.

BRIEF SUMMARY OF THE INVENTION

An object of this invention is the provision of an improved teleoperator system and method which include an improved viewing system to enhance the operator's sense of presence at remote manipulators controlled by the operator from a remote location.

An object of this invention is the provision of an improved teleoperator system and method of the above-mentioned type wherein an image of manipulator end effectors for viewing by the operator are sensed by the operator as comprising an integral part of hand-controllers used by the operator to control the end effectors, thereby giving the operator a strong sense of presence at the worksite.

An object of this invention is the provision of an improved teleoperator system and method of the above-mentioned type which is well adapted for use in a wide variety of applications including military, industrial, biomedical, and the like.

The present invention includes manipulators located at a worksite and which are controlled by hand-operated means at a remote operator control station. End effectors at the manipulators are used for manipulating objects located in a workspace at the worksite, and force-torque feedback is employed for transmitting back to the operator mechanical resistance encountered by the end effectors. Stereographic visual display means provide the operator with an image of the workspace. In accordance with the present invention, the image is located adjacent the hand-operated means so that the operator looks in the direction of the hand-operated means for viewing the image adjacent the hand-operated means. Either a real or virtual image of the workspace may be provided adjacent the hand-operated means. Display means for display of a real image may be located adjacent the hand-operated means for direct viewing of the real image by the operator. For display of a virtual image of the workspace, a mirror is located between the operator's eyes and the hand-operated means. In this case, display means provide a real image which is inverted from top to bottom, which inverted image is viewed via the mirror, which mirror inverts the image and provides the operator with a virtual image of the workspace, which appears to be located adjacent the hand-operated means. By locating the image of the workspace adjacent the hand-operated means the operator is provided with a sense that the end effectors and hand-operated means are substantially integral despite the fact the end effectors are located at the worksite and the hand-operated means are located at the remote operator's station. A stereophonic sound system may be included to provide the operator with stereophonic sound from the worksite. Video camera means are provided for viewing the workspace from which an image of the workspace is obtained. Various other sensors and associated responders may be located at the worksite and operator's station, respectively, for transmission of pressure, tactile, heat, vibration and similar information for enhanced telepresence operation.

Depending upon the application, different scaling may be provided in the transmission of information between the operator's station and worksite. For example, for microsurgery, microsurgery and like operations involving small part manipulation, optical and/or video magnification may be employed to provide an enlarged 3-dimensional image for viewing by the operator. With similar scaling between the hand operated means and manipulators, the perception of the operator is substantially that which a miniature operator would have were he at the worksite.

BRIEF DESCRIPTION OF THE DRAWINGS

The invention, together with other objects and advantages thereof will be better understood from the following description considered with the accompanying drawings. It will be understood that the drawings are for purposes of illustration and example only, and that the invention is not limited thereto. In the drawings, wherein like reference characters refer to the same parts in the several views,

FIG. 1 is a diagrammatic showing of a teleoperator system embodying the present invention including side elevational views of a worksite and remote control operator's station;

FIG. 2 is an enlarged rear elevational view of the operator's station taken substantially along line 2-2 of FIG. 1;

FIG. 3 is an enlarged rear elevational view of the worksite taken substantially along line 3-3 of FIG. 1;

FIG. 4 is a simplified side elevational view which is similar to FIG. 1 and showing dimensional relationships between elements at the worksite and elements at the operator's station;

FIG. 5 is a diagrammatic view to illustrate visual perception by a miniature virtual eye, and FIG. 6 is a diagrammatic view to illustrate visual perception by the operator when image magnification is employed;

FIG. 7 is a diagrammatic view which is similar to that of FIG. 1 but showing the teleoperator system used for telepresence surgery;

FIG. 8 is a rear elevational view of the operator's station shown in FIG. 7;

FIG. 9 is a rear elevational view of the worksite shown in FIG. 7;

FIGS. 10 and 11 are fragmentary side elevational views of modified forms of operator's station and manipulator, respectively, having increased degrees of freedom;

FIG. 12 is a side elevational view of a modified form of operator's station wherein display means are positioned for direct viewing by the operator;

FIG. 13 is a rear elevational view of the modified form of operator's station shown in FIG. 12; and

FIG. 14 shows a fragmentary portion of the insertion portion of an endoscope for use with the present invention.

DETAILED DESCRIPTION OF THE INVENTION

Reference now is made to FIGS. 1-3 wherein the teleoperator system is shown to include an operators station 20 (FIGS. 1 and 2) and worksite 22 (FIGS. 1 and 3). An operator 18 at the operator's station controls manipulator means 24 at the remote worksite. Manipulator means 24, comprising right and left manipulators 24R and 24L, respectively, are used for manipulating objects, such as object 26 which is shown located on a platform, or base, 28 within a workspace 30 shown in broken lines. For purposes of illustration only, and not by way of limitation, the right manipulator 24R is shown to comprise a housing 32R affixed to base 28 and from which housing a telescopic arm 34R extends. The inner end 34R1 of arm 34R is mounted for pivotal movement in any pivotal direction using conventional mounting means. For example, the inner end of arm 34R may be mounted for pivotal movement about a horizontal pivot axis 36 which pivot axis, in turn, is adapted for pivotal movement about vertical axis 38.

Arm 34R includes telescopic inner section 34R1 and outer section 34R2, which outer section is adapted both for axial movement into and out of inner section 34R1 and for rotation about its longitudinal axis. An end effector 40R is carried at the outer end of the arm which, for purposes of illustration, is shown to comprise a gripper. Motor means, not shown, con-

trol pivotal movement of arm 34R about pivot axes 36 and 38, axial and rotary movement of outer arm section 34R along and about the longitudinal axis of the arm, and opening and closing of gripper 40R. The motor means, together with motor control circuits for control of the motors, may be included in housing 32R. The motors are under control of a computer 42 connected thereto through right manipulator interface 44R and the above-mentioned motor control circuits.

The left manipulator 24L is of substantially the same design as the right manipulator 24R and the same reference numerals, but with the suffix L instead of R, are used to identify similar parts. For purposes of illustration, the left end effector 40L, shown in FIG. 3, is seen to comprise cutting blades which operate to cut in the manner of a pair of scissor blades.

The worksite is provided with a pair of video cameras 46R and 46L for viewing workspace 30 from different angles for production of stereoscopic signal outputs therefrom at lines 48R and 48L. The angle γ between the optical axes of the cameras shown in FIG. 3 is substantially equal to the operator's interocular viewing angle γ of an image of the workspace as shown in FIG. 2.

The video camera outputs at lines 48R and 48L are supplied to an image memory 50 for momentary storage of video fields of right and left images from the cameras. Fields of right and left images from image memory 50 are alternately supplied through left/right switch means 52 to visual display means 54, such as a television monitor, for alternate display of the two images at the face 54A of the monitor. Timing and control means 56 provide timing and control signals to various elements of the system, including elements included in the stereographic display system, for signal timing and control of the system. If digital storage means 50 are employed, then conversion of the camera signal outputs to digital signal form by analog to digital converter means prior to storage, and conversion of the digital signal output from left/right switch means to analog signal form in preparation for display at monitor 54 may be employed.

An electrooptical device 58 at the face of the display means 54 controls polarization of light received from display means 54 under control of a left/right synchronizing signal from timing and control unit 56. The left and right image fields are viewed by operator 18 wearing a pair of passive polarized glasses 60 having right and left polarizing elements 62 and 64 polarized in orthogonal directions. The polarization of light from display 54 through electrooptical device 58 is synchronized field by field such that the right field is occluded from the left eye and the left field is occluded from the right eye for stereographic viewing by the operator. Other means for stereographic viewing of left and right image fields are well known, including, for example, those using active stereographic glasses) which may be used in the practice of this invention to provide the operator with a stereoscopic view of the remote workspace.

The vertical deflection coil connections for monitor 54 are reversed, causing the monitor to scan from bottom to top thereby creating a top-to-bottom inverted image 30I of workspace 30. Letters a, b, c and d are used to identify corresponding corners of the workspace 30 and inverted workspace image 30I. The inverted workspace image 30I is viewed by the operator via a mirror 66 at the top of a table 68, which mirror inverts image 30I to return the image as viewed by the operator to an upright position. Looking downwardly in the direction of the mirror, the operator views a virtual image 30V of workspace 30. In accordance with one aspect of the present invention, the image viewed by the operator, which in the

FIG. 1-3 embodiment comprises a virtual image, is located adjacent controller means 70 used by the operator for control of manipulator means 24 at the worksite.

Controller means 70 are shown located beneath the table top 68 and include right and left controllers 72R and 72L for control of the respective right and left manipulators 24R and 24L. The right and left controllers are of substantially the same design so that a description of one applies to both. As with the manipulators, the suffixes R and L are used to distinguish elements of the right controller from those of the left controller. For purposes of illustration, and not by way of limitation, the right controller 72R is shown to comprise a housing 74R affixed to the bottom of table top 68 and from which hand-operated means 76R in the form of a telescopic control arm, or stick, extends.

The right and left control arms 76R and 76L are provided with the same degrees of freedom as the associated manipulator arms 34R and 34L, respectively. For example, the inner end of control arm 76R is mounted for pivotal movement about a horizontal pivot axis, corresponding to manipulator pivot axis 36, which axis, in turn, is adapted for pivotal movement about an intersecting vertical axis, corresponding to manipulator axis 38. Control arm 76R also includes inner section 76R1 and outer section 76R2, which outer section is adapted both for axial movement into and out of inner section 76R1 and for rotation about its longitudinal axis. It will be apparent that the control arm 76R is provided with the same four degrees of freedom as the associated manipulator arm 34R. Additionally, sensor means 78R are located adjacent the outer end of outer arm section 76R2 for use in controlling gripping action of gripper 40R. Similar sensor means 78L adjacent the outer end of control arm 76L are adapted for use in controlling operation of scissor blades 40L.

Right and left controllers 72R and 72L are included in a servomechanism system wherein mechanical motion of control arms 76R and 76L controls the position of manipulator arms 34R and 34L, and pressure on sensor means 78R and 78L controls opening and closing of end effectors 40R and 40L, respectively. In FIG. 1, right and left hand controller interfaces 80R and 80L, respectively, are shown for connection of the controllers to computer 42. Servomechanisms for control of mechanical motion at a remote location are well known, including those which provide force and torque feedback from the manipulator to the hand-operated controller means. Any suitable prior art servomechanism may be used in the practice of the present invention, with those incorporating force and torque feedback being particularly preferred for telepresence operation of the system. In the illustrated system, right and left microphones are included at the worksite, outputs from which microphones are amplified by right and left amplifiers and supplied to right and left speakers at the operators' station for providing a stereophonic sound output to provide the operator with an audio perspective present at the workspace. In FIG. 1, only the right channel of the stereophonic system is shown including right microphone 82R, right amplifier 86R and right speaker 88R. The left microphone and speaker are located directly behind the respective right microphone and speaker at the worksite and operator's control station as viewed in FIG. 1. Obviously, earphones may be provided for use by the operator in place of the speakers which would help to block out external noises at the operators control station. Also, in FIG. 1 a light shield 54B at the monitor is shown for blocking direct viewing of the monitor face by the operator.

Reference now is made to FIG. 4 wherein a simplified diagrammatic view of the system illustrated in FIGS. 1-3 is shown and wherein various lengths and angular positions are

identified by reference characters. In FIG. 4, the optical path length between the cameras and a point F at the workspace is identified by reference character L. A corresponding path length between the operator's eyes and point F at the virtual image of the workspace is identified by the distance a+b, where a is the distance from the eyes of the operator to mirror 66, and b is the distance from the mirror to point F at the virtual image. Other dimensions shown include the height G of the cameras above the pivot point of manipulator arm 34R and corresponding height g of the operator's eyes above the pivot point of control arm 76R. With the control arm 76R at length d, the manipulator arm 34R adjusts to length D. Similarly, with the control arm 76R at an angle β_A , with the vertical, the manipulator arm 34R is positioned at the same angle from vertical. The angle from vertical at which the cameras view the workspace and the eyes view the virtual image of the workspace is identified by α .

Between elements of the worksite and operator station, the following relationships pertain:

$$a+b=kL, \quad (1)$$

$$d=kD, \text{ and} \quad (2)$$

$$g=kG \quad (3)$$

where k is a scale factor constant.

When k equals 1 such that $a+b=L$, $d=D$ and $g=G$, no scaling of worksite dimensions is required.

Any scale factor may be employed, the invention not being limited to full-scale manipulation. For example, the worksite can be small, including microscopic in size, in which case the optical parameters, including distance to object, interocular distance and focal length, and mechanical and dimensional parameters are appropriately scaled.

By using appropriate scaling and image magnification and force and torque feedback, and by locating the image 30V of the workspace 30 adjacent hand-operated control means 76R and 76L, the operator is provided with a strong sense of directly controlling the end effectors 40R and 40L. The operator is provided with a sense that the end effectors 40R and 40L and respective control arms 76R and 76L are substantially integral. This same sense of togetherness of the hand-operated control means and end effectors is not provided in prior art arrangements wherein the image viewed by the operator is not located adjacent the hand-operated control means. Even where the prior art includes stereoscopic viewing and force and torque feedback, there is a feeling of disconnectedness of the hand notions from the visual image object being worked upon. The present invention overcomes this sense of disconnectedness by locating the workspace image where the operator's hands appear to exercise direct control over the end effectors.

For small-scale manipulation, such as required for surgical applications, it is desired to replicate the visual experience that a miniature observer would have were he closely adjacent the actual worksite. In FIG. 5, the virtual eye 90 of a hypothetical miniature observer is shown viewing an actual workspace. Light from a source at a point X, Y, Z in the actual workspace produces a stimulus on the miniature observer's eye 90 at a point identified as X'/M. In FIG. 6, an eye 92 of an actual operator is shown viewing an enlarged image of the virtual workspace produced by means of a video camera 94 used to view the actual workspace. The illustrated camera includes a light-receiving lens 96 and solid state imaging device such as a charge-coupled-device (CCD) array 98 where the point light source at X, Y, Z is shown imaged at point X_i, Y_i, Z_i . With correct scaling, a corresponding light

source is produced at point MX_i , MY_i , MZ_i at either the real or apparent position of the face of the visual display which, due to stereoscopic operation of the system appears to the operator to originate from point MX , MY , MZ corresponding to point X , Y , Z at the actual workspace. At the retina of the actual eye **92**, a stimulus is produced at point X' at proportionately the same position as point X'/M at eye **90** of the hypothetical observer. This relationship is ensured by selecting a correctly scaled camera distance and lens focal length such that the optical magnification $M_o = M/M_v$, where M is the desired overall magnification and M_v is the video magnification. A typical video magnification, M_v , which equals the ratio of the CCD-array **98** width to the display width, is about 40.

Reference now is made to FIGS. 7 through 9 wherein a modified form of this invention is shown for medical use. Here, right and left manipulators **100R** and **100L** are shown which are under control of right and left controllers **102R** and **102L**, respectively. Elements of the imaging system are substantially the same as those employed in the imaging system illustrated in FIGS. 1-3 described above except that an enlarged virtual image **104V** of actual workspace **104** is provided for viewing by the operator. Also, servomechanism elements for connection of the right and left controllers **102R** and **102L** to the respective manipulators **100R** and **100L** are substantially the same as those described above with reference to FIGS. 1-3. In the illustrated arrangement, the right and left manipulators are of substantially the same construction as are the right and left controllers, such that a description of one manipulator and one controller applies to both. Again, suffixes R and L are used to distinguish between right and left elements thereof.

The manipulators include outer control sections **100RA** and **100LA** and insertion sections **100RB** and **100LB**, which insertion sections are adapted for insertion into a body cavity through cylindrical tubes, or cannulas, not shown. For purposes of illustration, the manipulators are shown inserted through the abdomen wall **106** of a subject. As is well understood, for laparoscopic surgical procedures, wall **106** is separated from internal organs by insufflation wherein a gas is introduced into the abdomen by any suitable means not shown. Manipulator motors and associated motor control circuits are contained in the outer control sections **100RA** and **100LA** of the manipulators for control of the insertion section. The manipulators, together with a laparoscope **103** for viewing organs within the cavity, are carried by a fixed rail **110** forming part of a surgical table upon which the subject is supported.

The insertion sections **100RB** and **100LB** of the manipulators may be of substantially the same design as manipulator arms **34R** and **34L** described above with reference to the FIGS. 1-3 embodiment. The insertion sections are of relatively small size for use inside the body. Insertion section **100RB** includes telescopic inner section **112R1** and outer section **112R2**, which outer section is adapted for both axial movement into and out of inner section **112R1** and for rotation about its longitudinal axis. End effectors **114R** and **114L** are carried at the outer ends of the respective right and left sections **112R2** and **112L2** for manipulation of organ **116**. The inner section **112R1** is adapted for pivotal movement about intersecting perpendicular axes located substantially at point P where the insertion section intersects wall **106**. Exclusive of operation of end effectors **114R** and **114L** the manipulator arms each are provided with four degrees of freedom, the same as in the embodiment shown in FIGS. 1-3. End effectors **114R** and **114L** simply may comprise, essentially, microsurgical instruments with their handles removed including, for

example, retractors, electrosurgical cutters and coagulators, micro-forceps, microneedle holders, dissecting scissors, blades, irrigators, and sutures.

Laparoscope **108** for viewing the workspace **104** is shown comprising an outer operating section **108A** and insertion section **108B**. The outer end section **120** of insertion section **108B** is axially and rotatably movable within the inner end **122** thereof, and is provided with a pair of image transmission windows **124**, **124** for stereoscopic viewing of workspace **104**. The laparoscope also is provided with illuminating means, not shown, for illuminating the workspace, and with liquid inlet and outlet means, not shown, for flow of liquid past the windows. Video camera means within section **108A** are responsive to light, received through the viewing windows for generation of left and right electronic images at output lines **48R** and **48L** for connection to image memory **50**. A magnified 3-dimensional image **104I** is produced at display means **54** for viewing by the operator wearing cross-polarized glasses **60** via mirror **66**. As with the embodiment shown in FIGS. 1-3, a virtual image **104V** of the workspace **104** is produced adjacent control arms **130R** and **130L** of controllers **102R** and **102L**. Control arms **130R** and **130L** are of the same type as control arms **76R** and **76L** included in the FIGS. 1-3 embodiment described above. They include telescopic inner and outer sections **132R1** and **132R**, and **132L1** and **132L2**. Sensor means **134R** and **134L** located adjacent the outer ends of the control arms control operation of end effectors **114R** and **114L**, respectively, in the manner described above with reference to FIGS. 1-3. It here will be noted that the angle from vertical at which the image is viewed by the operator need not equal the angle from vertical at which the object is viewed by the cameras. In the arrangement illustrated in FIGS. 7-9, the operator is shown to view the image **104V** at an angle θ from vertical (FIG. 7) whereas the object **116** is shown as viewed directly downwardly. With no external reference, the sense of vertical within a body is not particularly great, and no confusion is produced in the mind of the operator as a result of the different observer and camera viewing angles relative to vertical.

With the FIGS. 7-9 embodiment, not only is a magnified virtual image **104V** of the workspace provided for viewing by the operator, but control arms **130R** and **130L** of greater length than the length of the manipulator insertion sections **100RB** and **100LB** are employed. Servomechanism scaling of axial movement of the telescopic control arms is provided such that axial extension or retraction thereof results in a smaller extension or retraction of the telescopic insertion sections. Angular pivotal motion of the control arms **130R** and **130L** produces the same angular pivotal motion of insertion sections **100RB** and **100LB**, and rotational movement of the end sections **132R** and **132L2** of the control arms produces the same rotational motion of end sections **112R2** and **112L2** of the insertion sections of the right and left manipulators, without scaling. This embodiment of the invention, with its magnified image, is of particular use in the area of microsurgery, and especially in those cases where the surgeon cannot reach an area by hand because of size constraints.

The present invention is not limited to use with manipulators having any particular number of degrees of freedom. Manipulators with different degrees of freedom which are well known in the art may be used in the practice of this invention. In FIGS. 10 and 11, to which reference now is made a controller **140** and manipulator **142**, respectively, are shown which include a wrist joint to provide the same with additional freedom of movement. The illustrated controller **140** includes a housing **144** affixed to the bottom of table top **68** upon which table mirror **66** is located. An enlarged virtual

image **146V** of actual workspace **146** is provided adjacent the operator's hand **148** viewable by the operator when looking downwardly onto the mirror **66** in a manner described above.

A control arm **150L** comprising inner and outer sections **150L1** and **150L2**, respectively, is mounted within housing **144** for pivotal movement in any pivotal direction as indicated by intersecting double-headed arrows **152** and **154**. The outer section **150L2** is adapted for axial movement into and out of inner section **150L1** in the direction of double-headed arrow **156**. It also is adapted for rotation about its longitudinal axis in the direction of double-headed arrow **158**. In this embodiment, the control arm includes an end section **160** pivotally attached to outer section **150L2** by wrist joint **162** for pivotal movement in the direction of double-headed arrow **164**. End section **160** comprises axially aligned inner and outer sections **160A** and **160B**, the outer section **160B** of which is rotatable about its longitudinal axis in the direction of double-headed arrow **166**. As with the above-described arrangements, sensor means **168** are located adjacent the free end of the control arm for operation of an end effector **170** at manipulator **142** shown in FIG. **11**.

Referring to FIG. **11**, end effector **170** is shown to comprise a pair of movable jaws attached to a wrist **172** comprising axially aligned links **172A** and **172B**. Outer link **172B** is rotatable about its longitudinal axis relative to inner link **172A** by motor means, not shown, in the direction of double-headed arrow **166M** in response to rotation of section **160B** of the hand-operated control unit in the direction of arrow **166**. Wrist link **172A** is pivotally attached to manipulator forearm **174** for pivotal movement in the direction of double-headed arrow **164M** in response to pivotal movement of end section **160** of the hand-operated control means about pivot axis **162**. Forearm **174** is longitudinally axially movable in the direction of double-headed arrow **156M** in response to axial movement of outer section **150L2** of control arm **150L** in the direction of double-headed arrow **156**. It also is rotatable about its longitudinal axis in the direction of double-headed arrow **158M** in response to rotation of outer section **150L2** of control arm **150L** in the direction of double-headed arrow **158**. Additionally, it is pivotally movable about point **176** in the directions of double-headed arrows **152M** and **154M** in response to pivotal movement of control arm **150L** in the directions of double-headed arrows **152** and **154**, respectively. For biomedical use, such as remote laparoscopic surgery, pivot point **176** is substantially located at the level of abdominal wall **178** through which the manipulator extends. In FIG. **11**, manipulator arm **174** is shown extending through a cannula **180** which penetrates the abdominal wall.

The outer operating end of the manipulator is adapted for attachment to a supporting rail, not shown, of the surgery table upon which the subject is supported. It includes an end effector drive motor **182** for opening and closing of gripper **170**. Wrist drive motor **184** controls pivotal movement of wrist **172** in the direction of double-headed arrow **164M**, and extension drive motor **186** controls axial movement of manipulator arm **174** in the direction of double-headed arrow **156M**. Forearm pivotal control motors and linkages, identified generally by reference numeral **188**, provide for pivotal movement of arm **174** about pivot point **176** in the directions of arrows **152M** and **154M**. Pivotal motion about point **176** is provided by simultaneous lateral movement of the outer operating end of the manipulator and pivotal movement of arm **174**. Movements are coordinated such that the center of rotation of forearm **174** is fixed in space at point **176** at the level of the abdominal wall.

Controller **140** and manipulator **142** are included in a system such as shown in FIGS. **7**, **8** and **9** which includes a

second controller and manipulator for use by the operator's right hand, and associated servomechanism means of any suitable type, not shown, for remote control of the manipulators by the hand-operated controllers. Video camera means at the worksite, such as shown in FIG. **9**, together with display means, such as shown in FIG. **7**, are employed for providing the operator with an image of the workspace at a location adjacent the left and right hand-operated control means. By using manipulators with a wrist joint, an added degree of freedom is provided for increased maneuverability and usefulness thereof. However, as noted above, the present invention is not limited to use with manipulators with any particular degree of freedom.

Reference now is made to FIGS. **12** and **13** wherein a modified form of this invention is shown which provides for direct viewing of a 3-dimensional image **240I** of a workspace, not shown. In FIGS. **12** and **13**, only the operator's station is shown, which includes right and left controllers **242R** and **242L** and associated right and left hand-operated means **244R** and **244L** which may be of the same type as controllers and control arms described above. The operator's station is adapted for remote control of manipulators which also may be of the above-described type. The 3-dimensional image **240I** of the workspace is provided by visual display means **246** in conjunction with electrooptical device **58** at the face of the display means and cross-polarized glasses **60** worn by the operator, to which display means left and right video fields from left and right video cameras that view the workspace are alternately supplied, all in the manner described in detail above. End effector and object images **248** and **250**, respectively, are shown within the workspace image as viewed by video cameras at the worksite. The display means **246** is located adjacent the left and right hand-operated means **244R** and **244L** for direct viewing by the operator. With this arrangement, the end effector and object images together with the hand-operated means **244R** and **244L** are simultaneously viewable by the operator. Since the hand-operated means also are visible, the operator is provided with a visual sense of connection between the end effector means and hand-operated means whereby they appear substantially as being integral.

Reference now is made to FIG. **14** wherein the distal end portion, or tip, **260** of the insertion section of an endoscope is shown which is of substantially the same type as shown in the above-mentioned publication entitled "Introduction to a New Project for National Research and Development Program (Large-Scale Project) in FY 1991" which endoscope may be used in the practice of the present invention. The insertion end of the endoscope includes a pair of spaced viewing windows **262R** and **262L** and an illumination source **264** for viewing and illuminating a workspace to be observed. Light received at the windows is focused by objective lens means, not shown, and transmitted through right and left fiber-optic bundles **266R** and **266L** to a pair of cameras at the operating end of the endoscope, not shown. The camera outputs are converted to a 3-dimensional image of the workspace which image is located adjacent hand-operated means at the operators station, not shown. Right and left steerable catheters **268R** and **268L** pass through accessory channels in the endoscope body, which catheters are adapted for extension from the distal end portion, as illustrated. End effectors **270R** and **270L** are provided at the ends of the catheters which may comprise conventional endoscopic instruments. Force sensors, not shown, also are inserted through the endoscope channels. Steerable catheters which include control wires for controlling bending of the catheters and operation of an end effector suitable for use with this invention are well known. Control motors for

operation of the control wires are provided at the operating end of the endoscope, which motors are included in a servomechanism of a type described above for operation of the steerable catheters and associated end effectors from a remote operator's station. As with the other embodiments, the interfacing computer in the servomechanism system remaps the operator's hand motion into the coordinate system of the end effectors, and images of the end effectors are viewable adjacent the hand-operated controllers in a manner described above. With this embodiment, the operator has the sensation of reaching through the endoscope to put his hands directly on the end effectors for control thereof. Endoscopes of different types may be employed in this embodiment of the invention so long as they include one or more accessory channels for use in control of end effector means, and suitable viewing means for use in providing a visual display of the workspace. For example, gastric, colonoscopic, and like type, endoscopes may be employed.

The invention having been described in detail in accordance with requirements of the Patent Statutes, various other charges and modifications will suggest themselves to those skilled in this art. For example, as noted above, the invention may include the use of tactile feedback to provide the subtle sensations for palpation and for manipulating tissues and instruments. To provide this feedbacks tactile sensor arrays may be included on the end effectors which are coupled to tactile sensor stimulator arrays on the hand-operated control means, which reproduce the tactile sensation on the operator's hands. A variety of transduction technologies for teleoperator tactile sensing are known including resistive/conductive, semiconductor, piezoelectric capacitive and photoelectric. Hand-operated control means and manipulators of different types may be employed using a wide variety of well-known mechanisms and electromechanical elements including, for example, gimbals, linkages, pulleys, cables, drive belts and bands, gears, optical or electromagnetic position encoders, and angular and linear motors. Force feedback to the operator requires use of body contact with hand-operated control means. Both hand grip type hand controllers such as those illustrated, and control brace type hand controllers are well adapted for use with the present invention for force feedback to the operator. Control brace hand controllers include use of structures with positive sensors mounted on the operator at joints for measuring joint angles. Force feedback then can be applied to each joint. Similarly, light fabric gloves with variable-resistance or fiber-optic flex sensors mounted on the joints for measuring bending of individual fingers may be used. Gloves of this type also may be provided with force feedback to provide for telepresence interaction with real objects. Regardless of the type of hand-operated control means employed, an image of the workspace is produced adjacent thereto to provide the operator with a sense that the end effector means and hand-operated control means are substantially integral. Also, as noted above, servomechanisms of many different types are well known in the robotic and teleoperator system arts, and the invention is not limited to any particular type. Those that include force and torque feedback to the operator are preferred to contribute to a telepresence sense of operation. In addition, many different means for producing a stereoscopic image of the workspace are known. For example, instead of using two cameras, a single camera may be employed together with switched cross-polarizing elements in the image receiving path. In this case, a pair of spaced stereoscopic lenses are used for viewing the workspace from different angles and providing first and second images thereof to the camera. In the FIG. 9 arrangement, wherein a laparoscope is shown, other types of endo-

scopes may be used for viewing the workspace. As noted above, the invention is not limited to any particular application or use. In the biomedical field, uses include, for example, open surgery, including surgery from a remote location, microsurgery, and minimum invasive surgery such as laparoscopic and endoscopic surgery. Laboratory use including microscopic manipulation also is contemplated. Industrial use of the invention include, for example, hazardous materials handling, remote operations, microassembly, and the like. Military and undersea use of the teleoperator system of this system are apparent. It is intended that the above and other such changes and modifications shall fall within the spirit and scope of the invention defined in the appended claims.

What is claimed is:

1. A robotic system comprising:

a master manipulator;

a slave manipulator comprising an elongate shaft, the shaft comprising a proximal end and a distal end, the shaft having a reference point located between the proximal and distal ends, the slave manipulator further comprising an end effector coupled to the distal end of the shaft; and

a motor unit coupled to the proximal end of the shaft, the motor unit configured to translate movement of the master manipulator into corresponding movement of the distal end of the shaft by moving the proximal end of the shaft in at least two degrees of freedom, said movement in at least two degrees of freedom coordinated such that said reference point is fixed in space during movement of the proximal end of the shaft, said movement in at least two degrees of freedom comprising translating the proximal end of the shaft in at least two degrees of freedom to pivot the shaft about the reference point.

2. The robotic system of claim 1, said movement in at least two degrees of freedom further comprising at least a third degree of freedom comprising rotation about the longitudinal axis of the shaft.

3. The robotic system of claim 1, the motor unit further configured to translate the shaft along its longitudinal axis.

4. The robotic system of claim 1, the slave manipulator further comprising a wrist member between the distal end of the shaft and the end effector, the wrist member having a longitudinal axis, the end effector rotatable about the longitudinal axis of the wrist.

5. The robotic system of claim 4, the end effector comprising a pair of jaws.

6. The robotic system of claim 4, movement of the slave manipulator being related to movement of the master manipulator by a scale factor.

7. The robotic system of claim 4, further comprising servomechanisms for providing force feedback from said surgical manipulator to said master manipulator.

8. The robotic system of claim 4, the at least two degrees of freedom comprising two lateral degrees of freedom.

9. The robotic system of claim 8, the master manipulator engageable with an operator's hand, the master manipulator configured to sense movement of the operator's hand, the robotic system further comprising:

a display apparatus configured to display an image of the slave manipulator to the operator's eye, the location of the master manipulator coincident with the image of the slave manipulator displayed to the operator's eye.

10. The robotic system of claim 8, the slave manipulator further comprising a wrist member between the distal end of the shaft and the end effector, the wrist member having a longitudinal axis, the end effector rotatable about the longitudinal axis of the wrist.

13

11. The robotic system of claim 8, the end effector comprising a pair of jaws.

12. The robotic system of claim 8, movement of the slave manipulator being related to movement of the master manipulator by a scale factor.

13. The robotic system of claim 8, further comprising servomechanisms for providing force feedback from said surgical manipulator to said master manipulator.

14. The robotic system of claim 8, further comprising a laparoscope for viewing organs within a human body cavity. 10

15. The robotic system of claim 8, the master manipulator engageable with an operator's hand, the master manipulator configured to sense movement of the operator's hand, the robotic system further comprising:

a display apparatus configured to display an image of the slave manipulator to the operator's eye, the location of the master manipulator coincident with the image of the slave manipulator displayed to the operator's eye. 15

16. The robotic system of claim 8, further comprising:

a second master manipulator; 20

a second slave manipulator comprising an elongate shaft comprising a proximal end and a distal end, the shaft having a reference point located between the proximal and distal ends, the slave manipulator further comprising an end effector coupled to the distal end of the shaft; 25

a second motor unit coupled to the proximal end of the shaft, the motor unit configured to translate movement of the second master manipulator into corresponding movement of the distal end of the shaft by moving the proximal end of the shaft in at least two degrees of freedom, said movement in at least two degrees of freedom coordinated such that said reference point is fixed in space during movement of the proximal end of the shaft. 30

17. The robotic system of claim 16, wherein a surgeon can control the master manipulator through the surgeon's left

14

hand; and the surgeon can control the second master manipulator through the surgeon's right hand.

18. The robotic system of claim 15, wherein said master manipulator comprises master grippers, and said end effector comprises grippers that can open or close in response to said master grippers being opened or closed.

19. A surgical apparatus comprising:

a master manipulator; and

a slave manipulator comprising an elongate shaft comprising a proximal end and a distal end, the shaft having a reference point located between the proximal and distal ends, the slave manipulator further comprising an end effector coupled to the distal end of the shaft;

the proximal end of the shaft movable in at least two degrees of freedom, the at least two degrees of freedom coordinated such that said reference point is fixed in space during movement of the proximal end of the shaft, said movement in at least two degrees of freedom comprising translating the proximal end of the shaft in at least two degrees of freedom to pivot the shaft about the reference point;

the slave manipulator further comprising a wrist member between the distal end of the shaft and the end effector, the wrist member having a longitudinal axis, the end effector rotatable about the longitudinal axis of the wrist.

20. The surgical apparatus of claim 19, the end effector comprising a pair of jaws.

21. The surgical apparatus of claim 19, further comprising servomechanisms for providing force feedback from said surgical manipulator to said master manipulator.

22. The surgical apparatus of claim 19, further comprising motors for turning said shaft about its longitudinal axis.

* * * * *

UNITED STATES PATENT AND TRADEMARK OFFICE
CERTIFICATE OF CORRECTION

PATENT NO. : 7,890,211 B2
APPLICATION NO. : 11/765883
DATED : February 15, 2011
INVENTOR(S) : Green

Page 1 of 1

It is certified that error appears in the above-identified patent and that said Letters Patent is hereby corrected as shown below:

On the Face Sheet:

Please replace paragraph (73) with the following:

(73) Assignee: SRI International, Menlo Park, CA (US) as recorded on January 21, 1992

Signed and Sealed this
Twelfth Day of July, 2011

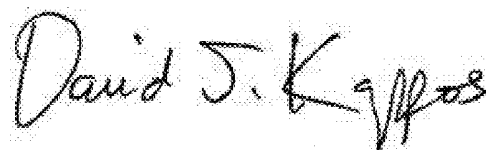
A handwritten signature in black ink that reads "David J. Kappos". The signature is written in a cursive, flowing style with a large initial 'D' and a stylized 'K'.

David J. Kappos
Director of the United States Patent and Trademark Office

专利名称(译)	主从机械手系统和装置		
公开(公告)号	US7890211	公开(公告)日	2011-02-15
申请号	US11/765883	申请日	2007-06-20
[标]申请(专利权)人(译)	斯坦福研究院		
申请(专利权)人(译)	SRI国际公司		
当前申请(专利权)人(译)	Intuitive Surgical公司运营，INC.		
[标]发明人	GREEN PHILIP S		
发明人	GREEN, PHILIP S.		
IPC分类号	G05B19/04 A61B17/00 A61B19/00 B25J3/04 B25J19/02 H04N13/00		
CPC分类号	A61B1/00193 A61B17/00234 A61B19/22 A61B19/52 B25J3/04 B25J19/023 H04N13/0239 H04N13/0246 H04N13/0296 H04N13/0434 H04N13/0438 H04N13/0497 A61B19/5212 A61B19/5225 A61B2019/2211 A61B2019/2223 A61B2019/223 A61B2019/2234 A61B2019/2249 A61B2019/2292 A61B2019/2296 A61B2019/464 A61B2019/5227 H04N13/0055 H04N13/0059 A61B34/35 A61B34/37 A61B34/70 A61B34/72 A61B34/76 A61B34/77 A61B90/36 A61B90/361 A61B90/37 A61B2034/301 A61B2034/305 A61B2090/064 A61B2090/371 B25J13/025 H04N13/189 H04N13/194 H04N13/239 H04N13/246 H04N13/296 H04N13/337 H04N13/341 H04N13/398		
其他公开文献	US20070276423A1		
外部链接	Espacenet USPTO		

摘要(译)

示出了具有远程呈现的遥控操作系统，其包括右手和左手控制器（72R和72L），用于通过使用包括计算机（42）的伺服机构来控制左右操纵器（24R和24L）。摄像机（46R和46L）从不同角度观察工作空间（30），以在线（48R和48L）处产生立体信号输出。响应于摄像机输出，产生三维的从上到下的倒置图像（30I），其由镜子（66）朝向操作者（18）的眼睛反射。在控制臂（76R和76L）附近产生虚像（30V），操作者（18）观察控制臂的方向。还公开了远程操作系统用于外科手术的用途。

