



US 20010014801A1

(19) **United States**(12) **Patent Application Publication**  
Tovey et al.(10) **Pub. No.: US 2001/0014801 A1**(43) **Pub. Date: Aug. 16, 2001**(54) **ROBOTIC ARM DLUS FOR PERFORMING SURGICAL TASKS**

provisional of provisional application No. 60/049, 923, filed on Jun. 18, 1997.

(75) **Inventors:** H. Jonathan Tovey, Monro, CT (US);  
Keith Ratcliff, Newtown, CT (US);  
Kenneth E. Toso, Wilton, CT (US);  
Peter W.J. Hinchliffe, New Haven, CT (US)**Publication Classification**(51) **Int. Cl.<sup>7</sup>** ..... **A61B 17/00; A61B 17/32**(52) **U.S. Cl.** ..... **606/1; 606/10; 606/167**Correspondence Address:  
**United States Surgical Corp.**  
**150 Glover Avenue**  
**Norwalk, CT 06856 (US)**(73) **Assignee: United States Surgical Corporation**(21) **Appl. No.: 09/804,531**(22) **Filed: Mar. 12, 2001****Related U.S. Application Data**

(60) Division of application No. 09/099,740, filed on Jun. 18, 1998, now Pat. No. 6,231,565, which is a non-

**ABSTRACT**

Disposable loading units (DLUs) configured for mounting to a robotic arm for performing at least one surgical task are presented. Each DLU includes an attachment platform having at least one connector for engaging at least one connector on a distal end of the robotic arm for connecting the DLU to the robotic arm, a head portion connected to the attachment platform at one end and configured for housing an electro-mechanical actuation assembly therein, and at least one surgical tool member extending from the head portion and operatively associated with the electro-mechanical actuation assembly for controlling the operation and movement of the at least one surgical tool member. The at least one surgical tool member may include a cutting assembly, an aortic hole punch assembly, a lasing assembly, a coring assembly, or a vascular suturing assembly.

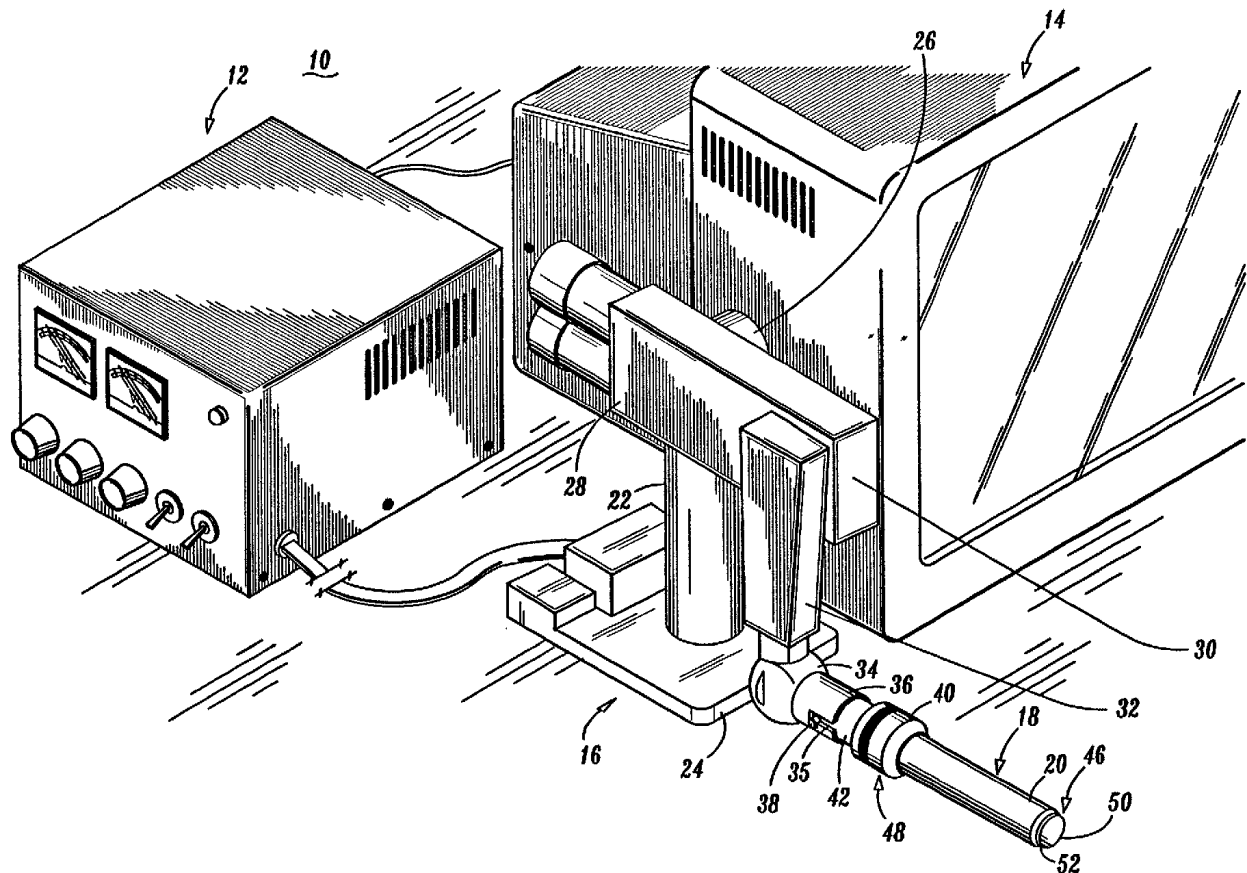

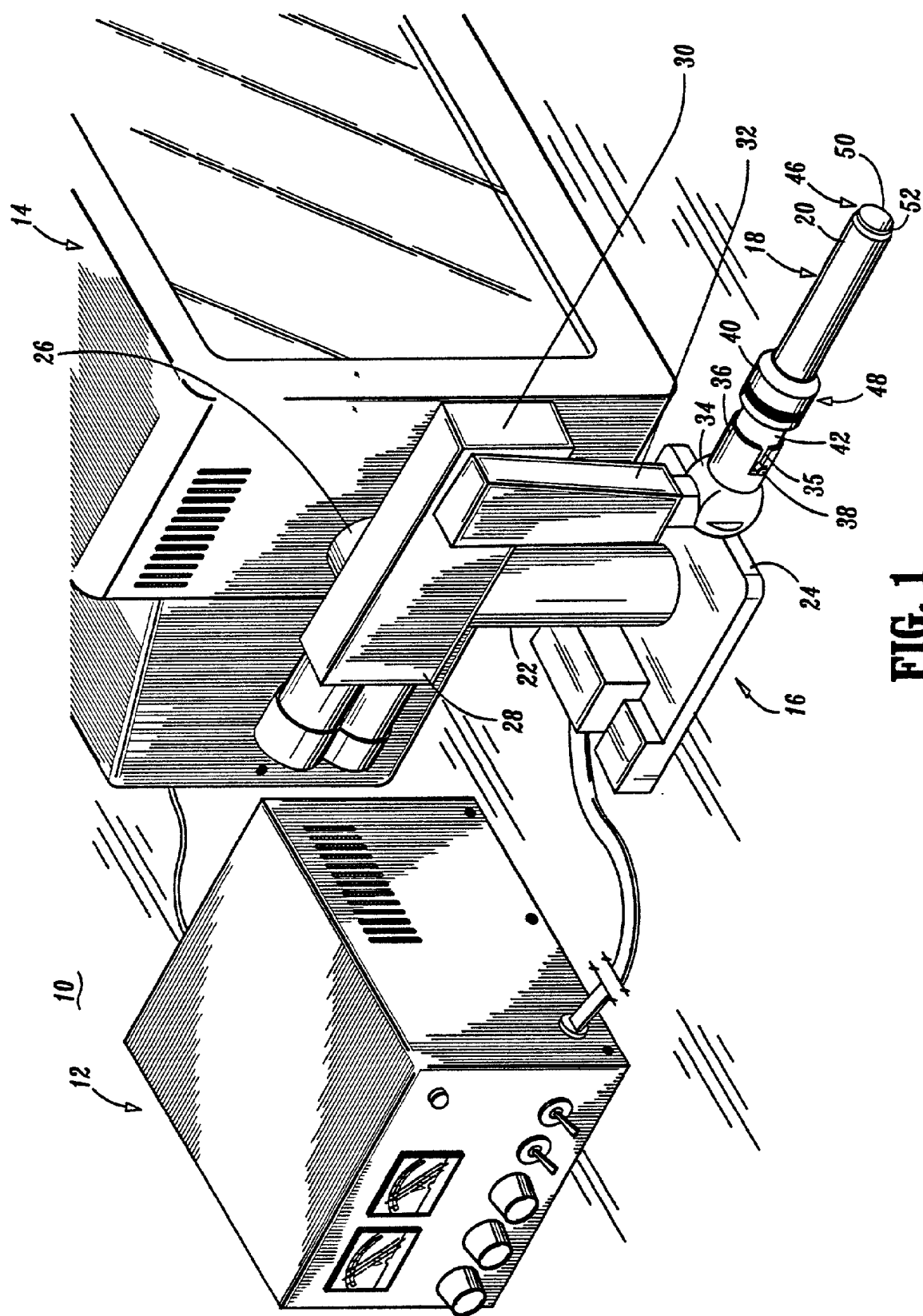
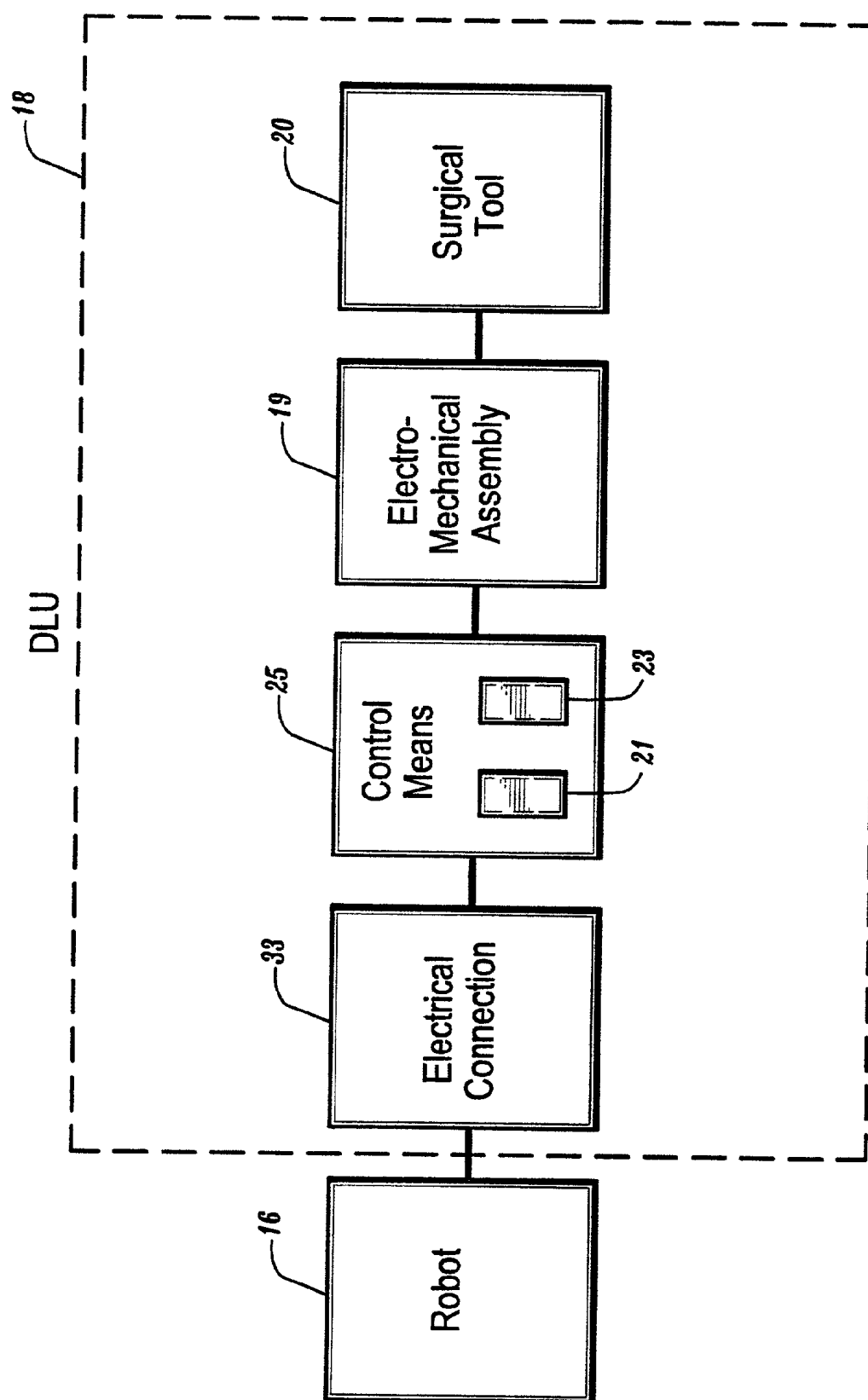
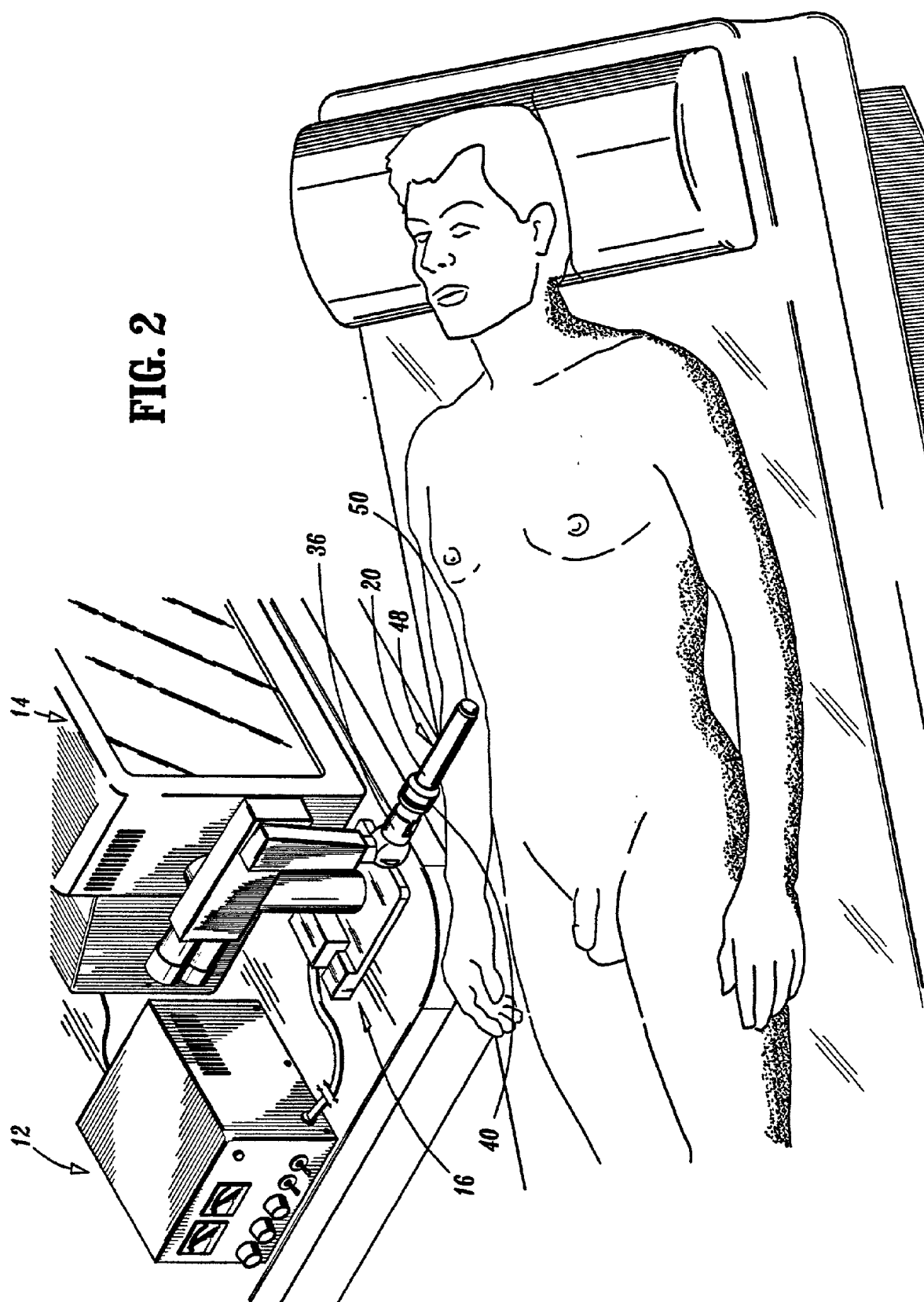
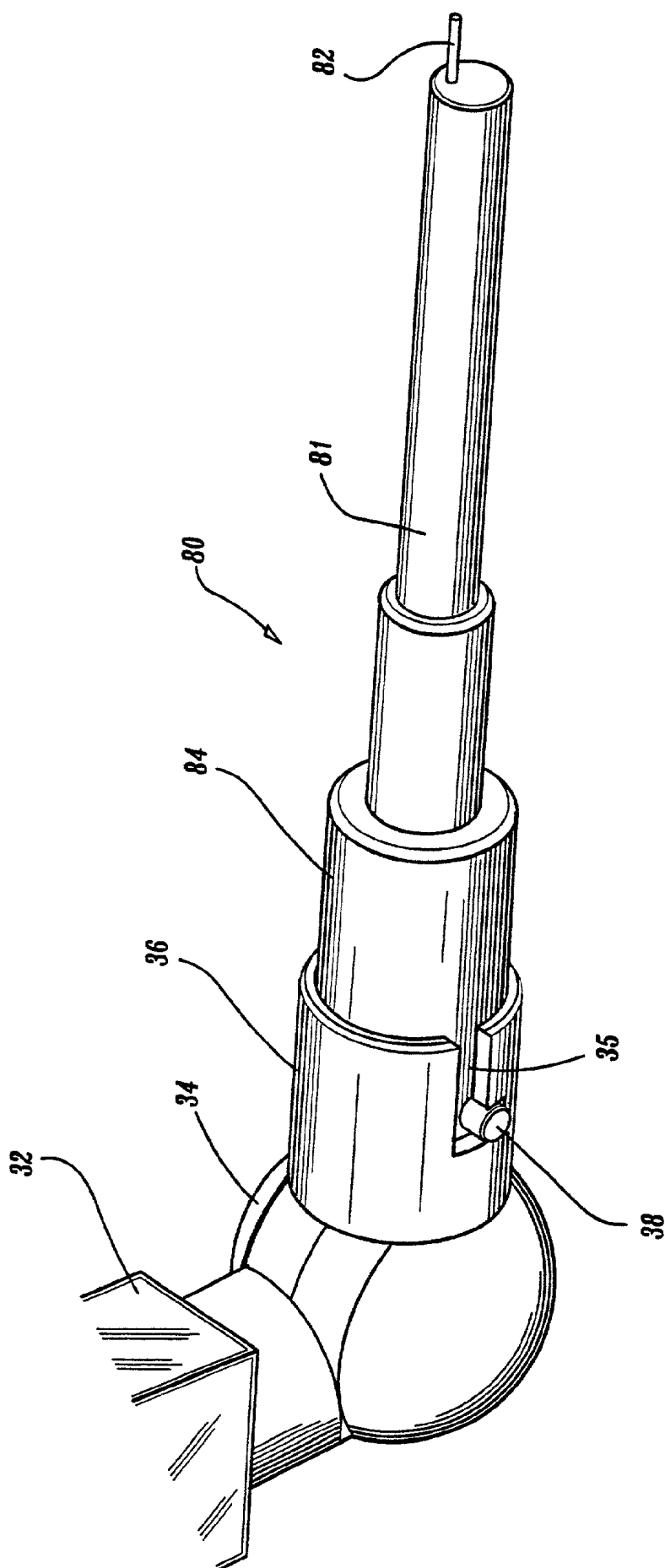

FIG. 1

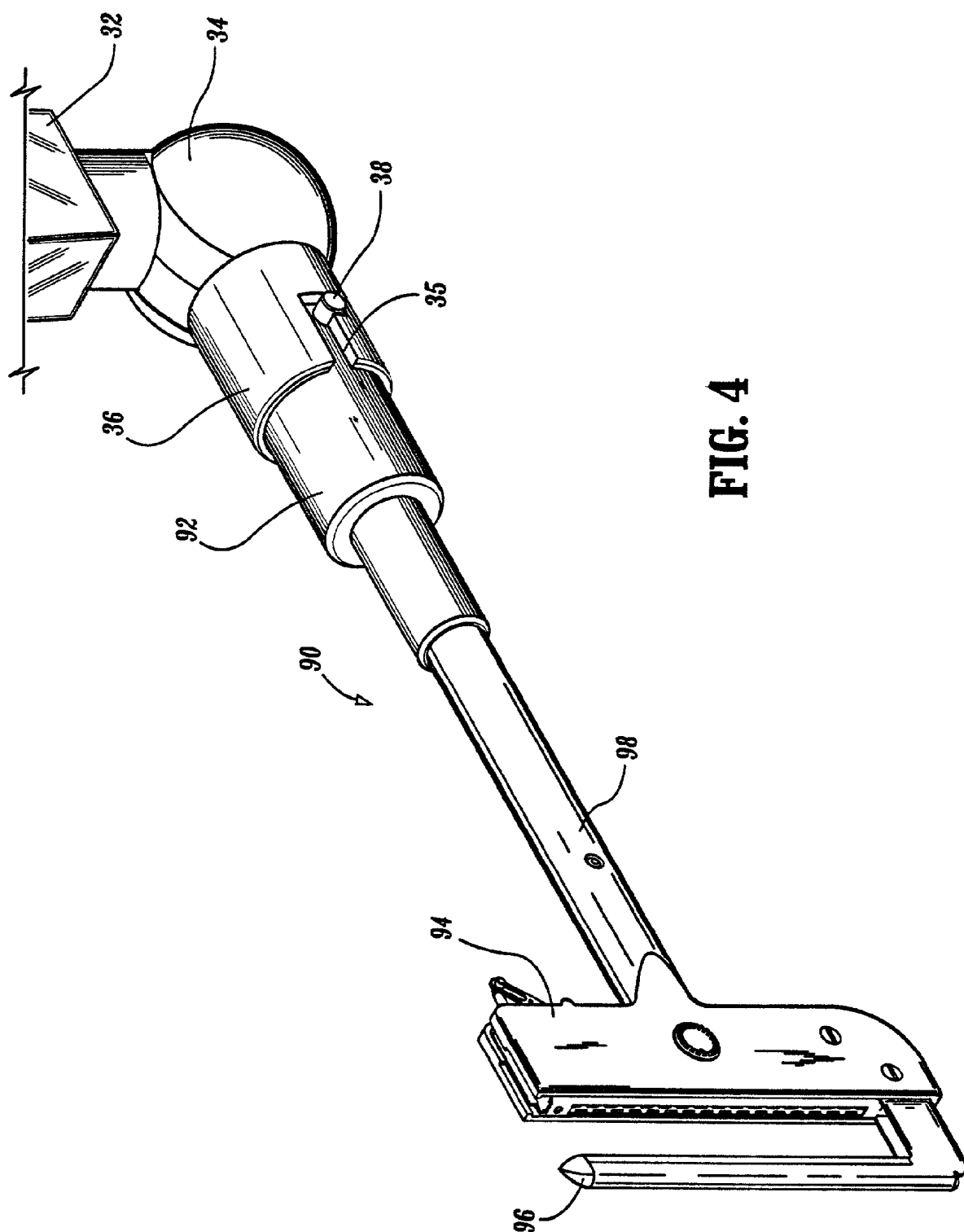

**FIG. 1A**





**FIG. 3**



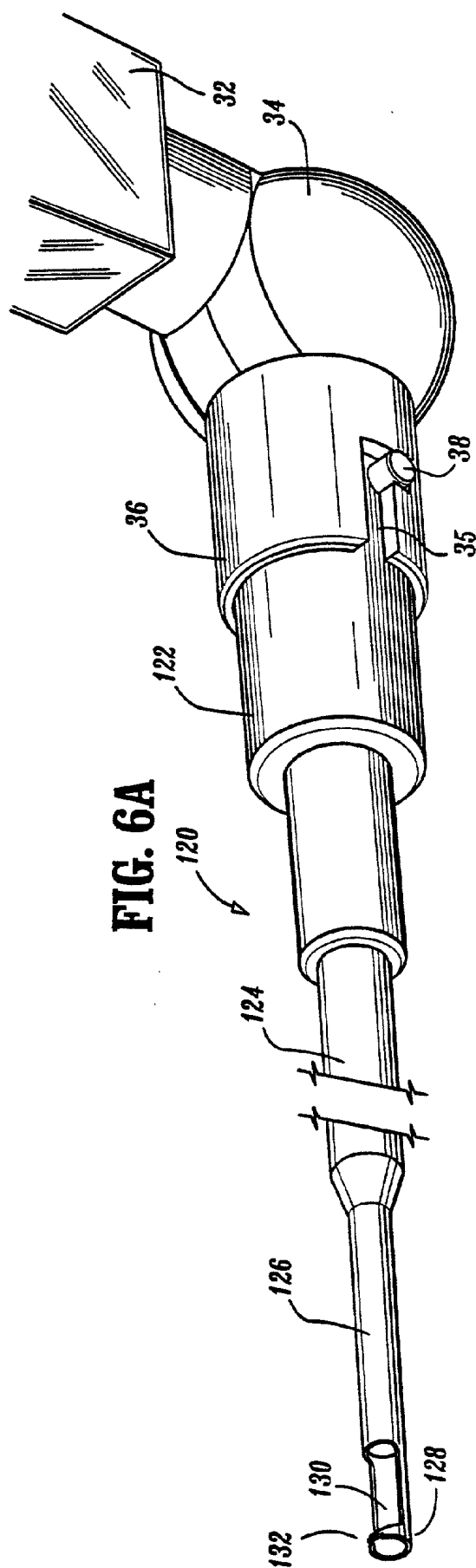
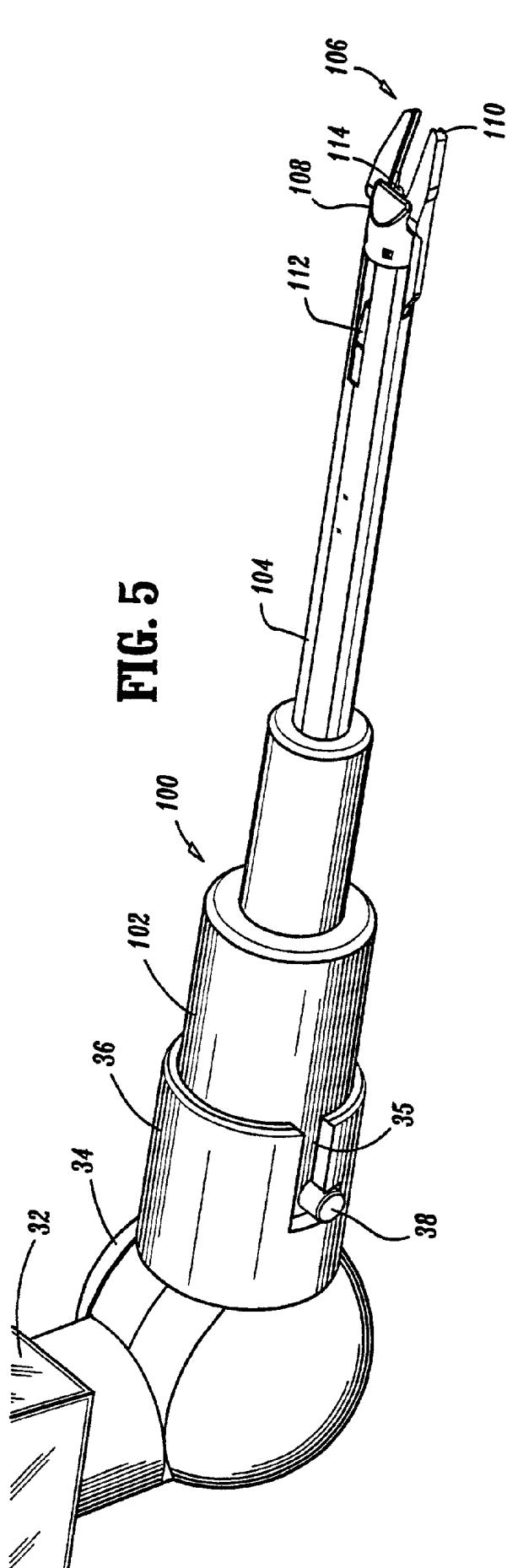

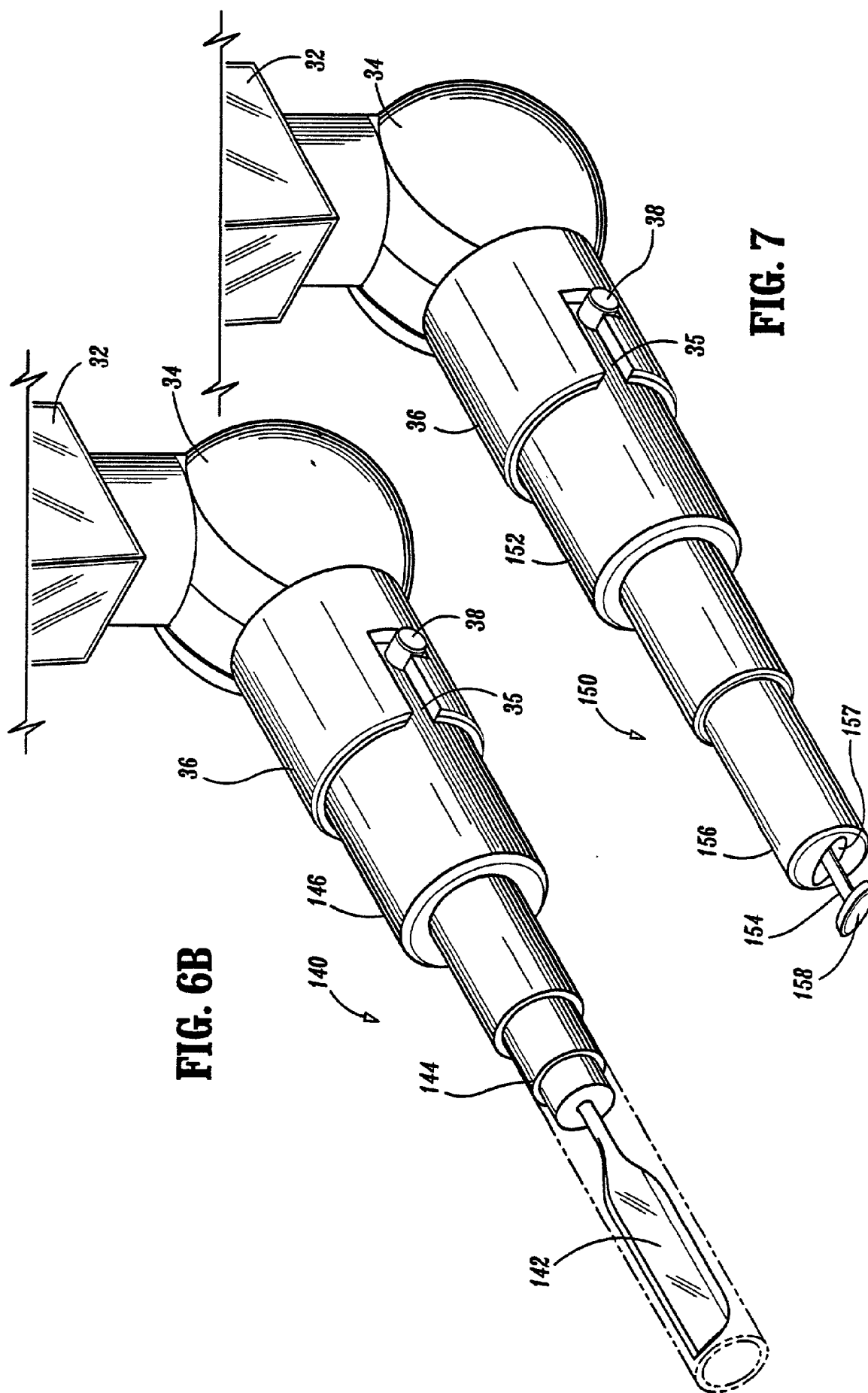
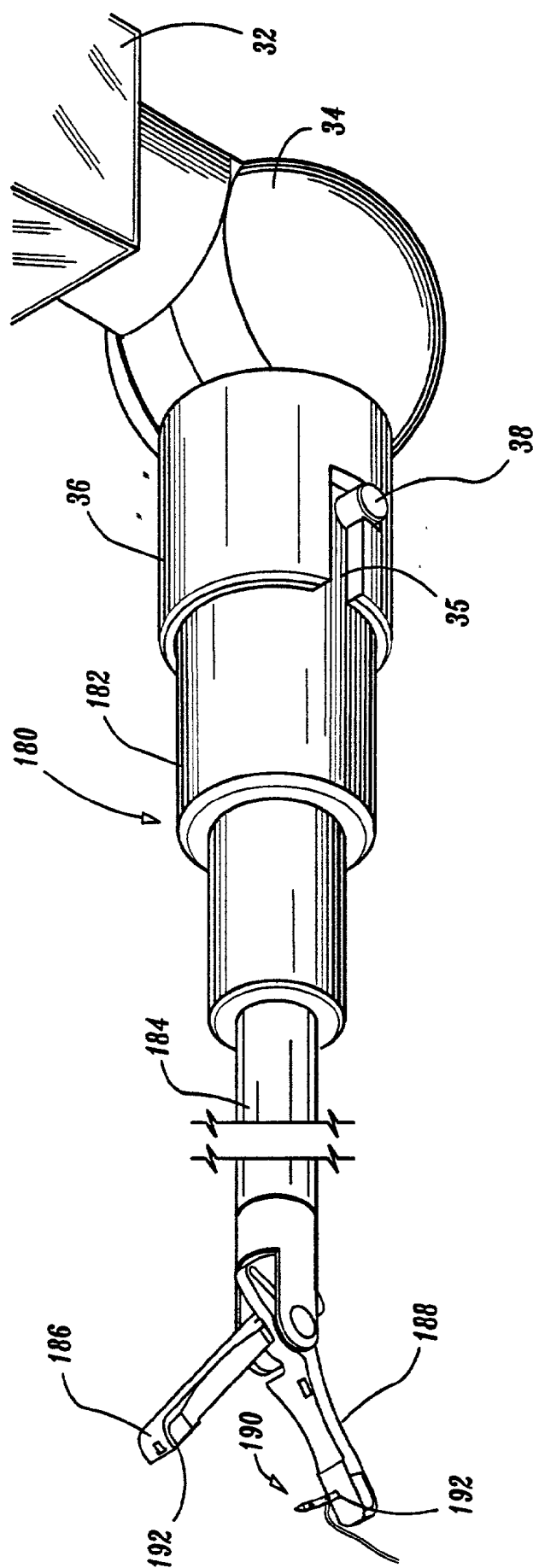

FIG. 6B

FIG. 7





**FIG. 8**

## ROBOTIC ARM DLUS FOR PERFORMING SURGICAL TASKS

[0001] This application claims priority to a Provisional Application filed on Jun. 18, 1997 having Ser. No. 60/049, 923.

### BACKGROUND

#### [0002] 1. Technical Field

[0003] The present disclosure relates to an apparatus and method for performing surgical tasks. In particular, the disclosure relates to disposable loading units (DLUs) configured for mounting to a robotic arm and having at least one automatically actuated surgical tool for performing a surgical task.

#### [0004] 2. Description of Related Art

[0005] Accurate and precise manipulation of surgical instruments at or near a surgical site is required during surgical procedures, especially during minimally invasive procedures such as laparoscopic and endoscopic procedures. In laparoscopic and endoscopic surgical procedures, a small incision is made in the patient's body to provide access for a tube or cannula device. Once extended into the patient's body, the cannula allows insertion of various surgical instruments for acting on organs, blood vessels, ducts, or body tissue far removed from the incision site. Such instruments may include apparatus for applying surgical clips as disclosed in U.S. Pat. No. 5,084,057; apparatus for applying surgical staples as disclosed in U.S. Pat. Nos. 5,040,715 and 5,289,963; and apparatus for suturing body tissue as disclosed in U.S. Pat. No. 5,403,328.

[0006] In minimally invasive procedures, the ability to perform surgical tasks is complicated due to limited maneuverability and reduced visibility. Therefore, a need exists for an apparatus and a procedure that enables the remote actuation of surgical instruments during minimally invasive procedures in a consistent, easy and rapid manner.

[0007] In non-laparoscopic and non-endoscopic procedures, accurate and precise manipulation and operation of surgical instruments is also required. For example, in a transmyocardial vascularization (TMR) procedure, wherein holes are formed in the heart wall to provide alternative blood flow channels for ischemic heart tissue, careful advancement and control of a lasing or coring device is necessary to form holes in the ischemic areas of the heart tissue.

[0008] In other cardiovascular procedures such as laser angioplasty wherein an optical fiber is inserted and advanced into a patient's vasculature to apply laser energy to obstructions and/or restrictions typically caused by plaque build-up, precise manipulation and operation is also required. Both continuous wave and pulsed high energy lasers have been used to provide the vaporizing laser energy. Insuring the plaque is actually ablated and not just pushed aside is important to prevent or delay restenosis.

[0009] The advent of computer imaging systems have enabled surgeons to precisely position and map the direction of travel of a surgical instrument prior to the utilization of the instrument in the operation. For example, an imaging system can locate the exact location of a lesion within a patient and allocate X, Y and Z coordinates to that lesion in

space. A coring device can then be manually advanced to that location to slice the distal flat end face of the core so that a complete specimen can be removed for biopsy.

[0010] Robotic systems have also been developed to aid a surgeon in precisely mounting and positioning surgical instruments to perform a surgical task. For example, U.S. Pat. No. 5,571,110 to Matsen, III et al. discloses an orthopedic saw guide for confining the blade of a surgical saw to movement in a single plane while allowing translational and rotational movement of the blade within the plane to facilitate the performance of a surgical bone alteration task. The saw guide is positioned relative to a patient's bone by a robot-aided system.

[0011] However, known robotic systems, such as the saw guide disclosed in the Matsen et al. '110 patent, are typically limited to specific surgical tasks and are not adaptive for performing a wide variety of surgical tasks. Therefore, there is a need for a robotic system for aiding a surgeon to perform a wide variety of surgical tasks.

[0012] Another disadvantage of known robotic systems having surgical application is that the surgeon is required to manually control the position and operation of the surgical instrument. For example, systems have been developed wherein the surgeon is fitted with a mechanism which translates the surgeon's movements into mechanical movements whereby servo motors are actuated to manipulate the surgical instrument. For example, U.S. Pat. No. 5,624,398 to Smith et al. discloses a robotic system having a pair of articulate robotic arms responsive to the surgeon's movements during the surgery. However, any error in the surgeon's movements results in undesired manipulation of the robotic arms. Therefore, a fully automatic robotic system for aiding a surgeon to perform a wide variety of surgical tasks would be advantageous.

[0013] Another disadvantage with known robotic systems is their inability to remotely operate a conventional surgical tool, such as an apparatus for applying surgical staples or an apparatus for suturing body tissue which is mounted to the robotic arm.

[0014] Therefore, it would be advantageous to provide disposable loading units (DLUs) configured for mounting to a robotic arm of a robotic system and having at least one surgical tool extending from one end for performing a surgical task. The DLU would be actuated by an actuation assembly operatively associated with the robotic arm for controlling the operation and movement of the DLU. The DLU would include an electro-mechanical assembly operatively associated with the actuation assembly for controlling the operation and movement of the surgical tool.

### SUMMARY

[0015] The subject disclosure is directed to disposable loading units configured for mounting to a robotic arm and having at least one automatically actuated surgical tool for performing a surgical task. The robotic arm acts on the DLUs with the dexterity and mobility of a surgeon's hand and can be programmed via an actuation assembly to actuate the surgical tool to perform the surgical task. Actuation commands are transmitted by electrical signals via cables from the actuation assembly to an electro-mechanical assembly within the DLUs. The electro-mechanical assem-

bly within each DLU is configured to move and operate the surgical tool for performing the surgical task. For example, the electro-mechanical assembly may include servo motors for advancing, rotating and retracting a coring member of a coring DLU device; for harmonically oscillating a scalpel of a cutting DLU device; or for pivotally moving a suturing needle positioned on an axis of a longitudinal casing of a suturing DLU device.

[0016] One DLU presented and configured for mounting to the robotic arm is a coring DLU device for minimally invasive surgery, such as removing a specimen for biopsy. Still another DLU presented is a lasing DLU device for performing surgical procedures entailing the use of laser energy, such as TMR and angioplasty. Additional DLUs presented include a surgical fastener applying DLU device, a vessel clip applying DLU device, a cutting DLU device, a hole punching DLU device, and a vascular suturing DLU device.

#### BRIEF DESCRIPTION OF THE DRAWINGS

[0017] Various robotic arm DLUs for performing surgical tasks will be described hereinbelow with reference to the drawings wherein:

[0018] FIG. 1 is a perspective view of a robotic system constructed in accordance with the present disclosure and illustrating a coring DLU device;

[0019] FIG. 1A is a block diagram illustrating the components of a DLU device;

[0020] FIG. 2 illustrates a surgeon utilizing the apparatus of FIG. 1 in the performance of a surgical procedure;

[0021] FIG. 3 is a perspective view of a lasing DLU device;

[0022] FIG. 4 is a perspective view of a surgical fastener applying DLU device;

[0023] FIG. 5 is a perspective view of a vessel clip applying DLU device;

[0024] FIG. 6A is a perspective view of a first embodiment of a cutting DLU device;

[0025] FIG. 6B is a perspective view of a second embodiment of a cutting DLU device;

[0026] FIG. 7 is a perspective view of a hole-punching DLU device; and

[0027] FIG. 8 is a perspective view of a vascular suturing DLU device.

#### DETAILED DESCRIPTION OF THE PREFERRED EMBODIMENTS

[0028] The robotic arm disposable loading units (DLUs) and accompanying robotic system of the present disclosure shall be discussed in terms of performing a variety of surgical tasks, which include but not limited to endoscopic, arthroscopic and/or laparoscopic procedures. The present disclosure introduces and discusses several DLUs, which include a coring DLU, two cutting DLUs, an aortic hole-punching DLU, a lasing DLU, a fastener applying DLU, and a vascular suturing DLU. However, the present disclosure should not be construed to limit the present application to only these DLUs.

[0029] Referring now to the drawings wherein like reference numerals indicate similar structural elements, there is illustrated in FIG. 1 a robotic system designated generally by reference numeral 10. Robotic system 10 can be used to performing a wide variety of surgical tasks, such as operate surgical instrumentation within the abdominal cavity of a patient with a fine degree of dexterity and accuracy.

[0030] The robotic system 10 includes an actuation assembly 12, a monitor 14, a robot 16, and a DLU 18 releasably attached to the robot 16 and having at least one surgical tool 20 for performing at least one surgical task. The robot 16 includes a trunk 22 extending from a base 24, a shoulder 26 connecting the trunk to an upper arm 28, an elbow 30 connecting the upper arm 28 to a lower arm 32, and a wrist 34 attached to the lower arm 32 from which extends a mounting flange 36. The mounting flange 36 is capable of moving in six degrees of freedom.

[0031] The DLU 18 further includes a head portion 40 for housing an electro-mechanical assembly 19 (FIG. 1A) therein for operating the surgical tool 20 and an attachment platform 42 for releasably attaching the DLU 18 to the robot 16 via the mounting flange 36. The mounting flange 36 includes two slots 35 which matingly engage protrusions 38 of the attachment platform 42 to connect the mounting flange 36 with the DLU 18. Other forms of releasable mechanical attachment of these components are envisioned as well, such as bayonet coupling, tongue and groove arrangements, snap-fit arrangements, interference fit arrangements, and locking screw arrangements. It is also contemplated to provide an electrical connection 33 between the slots 35 and the protrusions 38 for powering the electro-mechanical assembly 19 as shown by FIG. 1A.

[0032] The DLU 18 can be removed from the mounting flange 36 and be replaced with another DLU having a different surgical tool for performing a different surgical procedure. It is also contemplated to design a DLU having several surgical tools capable of performing several surgical procedures where the robot 16 can rotate the mounting flange 36 to select one of the surgical tools of the DLU when required.

[0033] In operation, the surgeon controls the actuation assembly 12 to control the movement and operation of the robot 16 and the DLU 18. Depending on the amount of rotation of the knobs 44 on the actuation assembly 12, the actuation assembly 12 transmits electrical signals to the robot 16 to electro-mechanically operate the moveable parts of the robot 16, such as to rotate the robot 16 about the vertical trunk 22 or to advance the mounting flange 36. The actuation assembly 12 may include a processor therein for storing operational commands and for transmitting digital signals to the electro-mechanical assembly 19. The actuation assembly 12 can also transmit electrical signals to the mounting flange 36 in the form of electrical signals for positioning and operating the DLU 18.

[0034] The actuation assembly 12 further transmits electrical signals to the electro-mechanical assembly 19 housed within the head portion 40 of the DLU 18 for actuating the electro-mechanical assembly 19 which in turn actuates the surgical tool 20. The electro-mechanical assembly 19 includes mechanisms for moving and operating the surgical tool 20, such as servo motors for harmonically oscillating a scalpel of a cutting DLU device, or rods for pivotally

moving a suturing needle positioned on an axis of a longitudinal casing of a suturing DLU device. The DLU 18 may further include integrated circuitry, including a receiver 21 and a processor 23 for receiving digital signals from the actuation assembly. The receiver 21 and processor 23 are included within control means 25 electrically connected to the electro-mechanical assembly 19 as shown by FIG. 1A.

[0035] One type of electro-mechanical assembly can be used to advance, rotate and retract a coring portion 46 of a coring DLU device 48 as shown by FIG. 1. Coring DLU device 48 is suited for performing a coring procedure, such as coring body tissue for removing a specimen for biopsy, as shown by FIG. 2. The coring portion 46 includes a tubular member 50 having a cutting edge 52. The linear advancement of the tubular member 50 is automatically controlled by the electro-mechanical assembly 19.

[0036] When the coring DLU device 48 is actuated by transmitting electrical signals to the electro-mechanical assembly 19, the tubular member 50 can be distally and proximally moved by rods traversing the longitudinal axis of the coring portion 46 and operatively associated with the electro-mechanical assembly 19.

[0037] A lasing DLU device 80 is illustrated in FIG. 3 for performing surgical procedures requiring laser energy, such as a TMR procedure. Laser DLU device 80 includes a laser energy transmission mechanism 82 partially disposed within a body portion 81 and mounted for controlled longitudinal movement relative to a head portion 84 of the DLU 80. The actuation assembly 12 can be provided with a laser energy generator which is optically connected to the laser energy transmission mechanism 82 for initiating laser energy. The laser energy generator may also be incorporated within the electro-mechanical assembly 19. The laser energy transmission mechanism 82 typically includes at least one optical fiber for transmitting laser energy. The at least one optical fiber in the laser energy transmission mechanism 82 traverses the body portion 81 and is optically associated with the laser energy generator.

[0038] A controlled advancement mechanism is provided within the DLU head portion 84 and in engagement with the laser energy transmission mechanism 82 for advancing the laser energy transmission mechanism 82 at a controlled rate coordinated with the laser energy generator output to ablate body tissue. Controlled advancement mechanisms which can be incorporated within the head portion 84 include constant and/or variable rate springs, motors, and other mechanisms which can be coordinated with the laser energy generator to advance one or both of the laser energy transmission mechanism 82 during ablation.

[0039] A surgical fastener applying DLU device 90 is illustrated in FIG. 4 for applying an array of surgical fasteners to body tissue. Surgical fastener applying DLU device 90 includes an actuator incorporated within a head portion 92 to perform fast closure and incremental advancement of a cartridge assembly 94 with respect to an anvil assembly 96 at a distal end of body portion 98.

[0040] Reference can be made to U.S. Pat. No. 4,508,253 issued to Green on Apr. 2, 1985 or European Patent Application No. 92 116880.3 published on Apr. 21, 1993, the contents of both documents are incorporated herein by reference, for a more detailed explanation of the operation of

the body portion components during a surgical fastening procedure. It is provided that the hand portion of the fastener applying apparatus disclosed in the '006 patent is incorporated within the structure and construction of the electro-mechanical assembly 19 of the surgical fastener applying DLU device 90 for operating the body portion components in the same manner as the hand portion operates the body portion components in the above-noted '006 patent.

[0041] FIG. 5 is a perspective view of a vessel clip applying DLU device 100 for applying surgical clips to body tissue. Vessel clip applying DLU device 100 includes a head portion 102, a body portion 104 extending distally from the head portion 102 and defining a longitudinal axis, and a plurality of surgical clips disposed within the body portion 104. A jaw assembly 106 is mounted adjacent a distal end portion 108 of the body portion 104. The jaw assembly 106 includes first and second jaw portions 110 movable between a spaced-apart and approximated position.

[0042] A clip pusher is provided within body portion 104 to individually distally advance a distal-most surgical clip to the jaw assembly 106 while the jaw portions 110 are in the spaced-apart position. An actuator 112 disposed within the body portion 104 is longitudinally movable in response to actuation of the electro-mechanical assembly 19 within the head portion 102. A jaw closure member 114 is positioned adjacent the first and second jaw portions 110 to move the jaw portions 110 to the approximated position. The actuator 112 and the jaw closure member 114 define an interlock therebetween to produce simultaneous movement of the actuator 112 and the jaw closure member 114 when the actuator 112 is positioned adjacent the distal end portion of the body portion 104.

[0043] Reference can be made to U.S. Pat. No. 5,300,081 issued to Young et al. on Apr. 5, 1994, the contents of which are incorporated herein by reference, for a more detailed explanation of the operation of the body portion components during a vessel clip applying procedure. It is provided that the hand portion of the vessel clip applying apparatus disclosed in the '081 patent is incorporated within the structure and construction of the electro-mechanical assembly 19 of the vessel clip applying DLU device 100 for operating the body portion components in the same manner as the hand portion operates the body portion components in the above-noted '081 patent.

[0044] With reference to FIG. 6A, a first embodiment of a cutting DLU device 120 is illustrated for cutting and storing sections of body tissue. Cutting DLU device 120 includes an actuator incorporated within a head portion 122, a body portion 124 having an outer tube 126 extending from the head portion 122, and a cutting tube 128 positioned within the outer tube 126 and movable in response to actuation of the electro-mechanical assembly 19 between a retracted position and a distal position to cut body tissue. The cutting tube 128 has a chamber 130 formed therein for storing the cut tissue sections.

[0045] A release lever is included within the electro-mechanical assembly 19 and is movable from a blocking position to allow the cutting tube 128 to be removed from the outer tube 126. An anvil 132 is positioned at a distal end of the outer tube 126 for forcing each cut tissue section proximally into the chamber 130 of the cutting tube 128 as the cutting tube 128 is advanced to cut the body tissue. The

electro-mechanical assembly may include an oscillation assembly operatively associated with the cutting tube **128** to harmonically oscillate the cutting tube **128**.

[0046] A second embodiment of a cutting DLU device **140** is shown by **FIG. 6B**. This embodiment includes a scalpel **142** which can be encased within a cylinder **144** capable of being moved proximally and distally. A harmonic oscillator may be incorporated within the head portion **146** to harmonically oscillate the scalpel **142**. In addition, it is contemplated to provide mechanisms within the head portion **146** for rotating and longitudinally moving the scalpel **142**.

[0047] With reference to **FIG. 7**, there is shown a hole-punching DLU device **150** for facilitating the formation of an elliptical hole in the aorta during a coronary artery bypass grafting (CABG) procedure. Hole-punching DLU device **150** includes a head portion **152** having an actuator therein for actuating an actuating rod **154** disposed in body portion **156** and mounted for longitudinal movement between an unactuated position and an actuated position, and a punch blade **158** disposed at the distal end of the actuating rod **154**.

[0048] The distal end of body portion **156** includes an elliptical opening **157** to receive punch blade **158** when the actuating rod **154** is moved to the unactuated position. The elliptical opening **157** includes a sharp circumference for cutting tissue disposed between the distal end of body portion **156** and the punch blade **158** when the actuating rod **154** is moved proximally for forming an elliptical hole in a coronary artery for the performance of the CABG procedure.

[0049] Finally, with reference to **FIG. 8**, a vascular suturing DLU device **180** is illustrated for suturing vascular tissue sections together. Vascular suturing DLU device **180** includes a head portion **182** and a body portion **184** extended distally therefrom. A pair of needle receiving jaws **186**, **188** are pivotally mounted at a distal end of the body portion **184** and are configured to repeatedly pass a surgical needle and associated length of suture material therebetween. The apparatus further includes needle holding structure **190** mounted within the jaws **186** for reciprocal movement into and out of needle holding recesses **192** formed in the jaws **186**, **188**. During an anastomosis procedure, the vascular suturing DLU device **180** will advantageously respond to movement commands transmitted from the actuation assembly to apply fasteners to tissue.

[0050] Reference can be made to U.S. Pat. No. 5,478,344 issued to Stone et al. on Dec. 26, 1995, the contents of which are incorporated herein by reference, for a more detailed explanation of the operation of the body portion components during a vascular suturing procedure. It is provided that the hand portion of the vascular suturing apparatus disclosed in the '344 patent is incorporated within the structure and construction of the electro-mechanical assembly **19** of the vascular suturing DLU device **180** for operating the body portion components in the same manner as the hand portion operates the body portion components in the above-noted '344 patent.

[0051] It is contemplated to have feedback forces initiated by pressure and other parameters indicative of the surgical task being performed by the at least one surgical tool of the DLU transmitted back through a microprocessor to a digital-to-analog circuit board. This force feedback control system allows the robotic system to be programmed before the

surgical task is performed with guidance, pressure, and other parameters which can be continuously monitored to control the operation and movement of the DLU and of the at least one surgical tool.

[0052] While the invention has been illustrated and described as embodied in an apparatus and method for performing surgical tasks, it is not intended to be limited to the details shown, since it will be understood that various omissions, modifications, substitutions and changes in the forms and details of the device illustrated and its operation can be made by those skilled in the art without departing in any way from the spirit or scope of the appended claims.

What is claimed is:

1. A robotic system for performing surgical tasks comprising:

- a) a robotic arm defining a longitudinal axis;
- b) an actuation assembly operatively associated with the robotic arm for controlling the operation and movement of the robotic arm; and
- c) an electro-mechanical device mounted to the robotic arm, the electro-mechanical device including at least one surgical tool member and control means operatively associated with the actuation assembly and the at least one surgical tool member for controlling the operation and movement of the at least one surgical tool member.

2. A robotic system as recited in claim 1, wherein the control means includes a processor and a receiver for receiving electrical signals transmitted from the actuation assembly to control the operation and movement of the at least one surgical tool member.

3. A robotic system as recited in claim 1, wherein the electro-mechanical device is electro-mechanically coupled to the robotic arm for electrically operating the electro-mechanical device and for articulating the electro-mechanical device with respect to the longitudinal axis.

4. A robotic system as recited in claim 1, wherein the electro-mechanical device is releasably mounted to the robotic arm.

5. A robotic system as recited in claim 1, wherein the at least one surgical tool member is selected from a group consisting of a cutting assembly, an aortic hole punch assembly, a lasing assembly, a fastener applying assembly, a coring assembly, or a vascular suturing assembly.

6. A robotic system as recited in claim 1, wherein the electro-mechanical device includes at least one connector for connecting the electro-mechanical device to the robotic arm.

7. A robotic system as recited in claim 6, wherein the at least one connector is electrically associated with the robotic arm for providing electrical energy to the control means from the actuation assembly.

8. A robotic system for performing surgical tasks comprising:

- a) means for communicating commands in the form of electrical signals from a processor within an actuation assembly to an electro-mechanical device having at least one surgical tool member and configured for mounting at a distal end of a robotic arm; and
- b) control means within the electro-mechanical device and operatively associated with the communicating

means for receiving the electrical signals for controlling the operation and movement of the at least one surgical tool member according to the electrical signals.

9. A robotic system as recited in claim 8, wherein the at least one surgical tool member is selected from a group consisting of a cutting assembly, an aortic hole punch assembly, a lasing assembly, a coring assembly, or a vascular suturing assembly.

10. A robotic system as recited in claim 8, wherein the electro-mechanical device is removably associated with the robotic arm.

11. A robotic system as recited in claim 8, wherein the at least one surgical tool member is configured for endoscopic surgical tasks.

12. A robotic system as recited in claim 8, wherein the at least one surgical tool member is configured for laparoscopic surgical tasks.

13. A disposable loading unit configured for mounting to a robotic arm for performing at least one surgical task, the disposable loading unit comprising:

- a) an attachment platform having at least one connector for releasably engaging at least one connector on a distal end of the robotic arm for attaching the disposable loading unit to the robotic arm;
- b) a head portion connected to the attachment platform and configured for housing an electro-mechanical assembly therein; and
- c) at least one surgical tool member extending from the head portion and operatively associated with the electro-mechanical assembly for performing the at least one surgical task.

14. A disposable loading unit as recited in claim 13, wherein the at least one surgical tool member is selected

from a group consisting of a cutting assembly, an aortic hole punch assembly, a lasing assembly, a coring assembly, or a vascular suturing assembly.

15. A disposable loading unit robotic system as recited in claim 13, wherein the attachment platform includes means for electrically connecting the DLU with the robotic arm.

16. A disposable loading unit as recited in claim 13, wherein the at least one surgical tool member is configured for endoscopic surgical tasks.

17. A disposable loading unit as recited in claim 13, wherein the at least one surgical tool member is configured for laparoscopic surgical tasks.

18. A disposable loading unit as recited in claim 13, wherein the head portion is electro-mechanically coupled to the robotic arm for electrically operating the electro-mechanical assembly and for articulating the head portion with respect to a longitudinal axis of the robotic arm.

19. A kit for use with a robotic system adapted to perform surgical procedures, the robotic system characterized by having a robotic arm, and an actuation assembly operatively associated with the robotic arm for controlling the operation and movement of the robotic arm, the kit comprising:

at least two disposable loading units, each disposable loading unit being adapted for releasable mounting to the robotic arm, each disposable loading unit including at least one surgical tool member for performing a surgical procedure and control means operatively connectable with the actuation assembly for controlling the operation and movement of the one surgical tool member.

20. A kit as recited in claim 19, wherein the one surgical tool member is selected from a group consisting of a cutting assembly, an aortic hole punch assembly, a lasing assembly, a coring assembly, or a vascular suturing assembly.

\* \* \* \* \*

专利名称(译)	用于执行手术任务的机械臂DLU		
公开(公告)号	<a href="#">US20010014801A1</a>	公开(公告)日	2001-08-16
申请号	US09/804531	申请日	2001-03-12
申请(专利权)人(译)	美国外科CORPORATION		
当前申请(专利权)人(译)	COVIDIEN LP		
[标]发明人	TOVEY H JONATHAN RATCLIFF KEITH TOSO KENNETH E HINCHLIFFE PETER W J		
发明人	TOVEY, H. JONATHAN RATCLIFF, KEITH TOSO, KENNETH E. HINCHLIFFE, PETER W.J.		
IPC分类号	A61B17/00 A61B17/04 A61B17/06 A61B17/072 A61B17/128 A61B17/32 A61B18/20 A61B19/00 A61K C07D		
CPC分类号	A61B10/0233 A61B2019/2292 A61B17/0491 A61B17/062 A61B17/068 A61B17/072 A61B17/07207 A61B17/1285 A61B17/32053 A61B17/3211 A61B18/20 A61B19/22 A61B19/2203 A61B2017/0023 A61B2017/00247 A61B2017/00464 A61B2017/00477 A61B2017/00778 A61B2017/06047 A61B2017/0609 A61B2018/00392 A61B2019/2234 A61B17/0469 A61B34/70 A61B34/30 A61B34/76 A61B2034 /305		
优先权	60/049923 1997-06-18 US		
其他公开文献	US6827712		
外部链接	<a href="#">Espacenet</a> <a href="#">USPTO</a>		

#### 摘要(译)

提供了一次性装载单元 ( DLU ) ，其配置用于安装到机器人臂以执行至少一个手术任务。每个DLU包括附接平台，该附接平台具有至少一个连接器，用于接合机器人臂的远端上的至少一个连接器，用于将DLU连接到机器人臂，头部在一端连接到附接平台并且被配置用于容纳其中的机电致动组件，以及至少一个外科工具构件，其从头部延伸并且可操作地与机电致动组件相关联，用于控制至少一个外科工具构件的操作和移动。所述至少一个手术工具构件可包括切割组件，主动脉孔冲头组件，激光组件，取芯组件或血管缝合组件。

