



US006955643B2

(12) **United States Patent**  
**Gellman et al.**

(10) **Patent No.:** **US 6,955,643 B2**  
(45) **Date of Patent:** **Oct. 18, 2005**

(54) **ENDOSCOPIC SUTURE INSTRUMENT**

(75) Inventors: **Barry N. Gellman**, N. Easton, MA  
(US); **Jozef Slanda**, Milford, MA (US)

(73) Assignee: **Boston Scientific Scimed, Inc.**, Maple  
Grove, MN (US)

(\*) Notice: Subject to any disclaimer, the term of this  
patent is extended or adjusted under 35  
U.S.C. 154(b) by 106 days.

GB	2 268 690	1/1994
WO	WO/90/03766	4/1990
WO	WO 92/12674	8/1992
WO	WO/94/05123	8/1992
WO	WO/93/01750	2/1993
WO	99/47050	2/1993
WO	WO 94/05213	3/1994
WO	WO/94/13211	6/1994
WO	WO 96/09796	4/1996
WO	96/09796	4/1996
WO	WO 96/27331	9/1996
WO	01/28432	4/2001

(21) Appl. No.: **10/459,826**

(22) Filed: **Jun. 12, 2003**

(65) **Prior Publication Data**

US 2003/0233108 A1 Dec. 18, 2003

**Related U.S. Application Data**

(60) Provisional application No. 60/388,458, filed on Jun. 12,  
2002.

(51) **Int. Cl.**<sup>7</sup> ..... **A61B 1/00**

(52) **U.S. Cl.** ..... **600/104; 600/106; 606/139**

(58) **Field of Search** ..... 600/104, 106;  
606/125, 138, 139, 114–148

(56) **References Cited**

**U.S. PATENT DOCUMENTS**

342,773 A	6/1886	Bailey
919,138 A	4/1909	Drake et al.
1,037,864 A	9/1912	Carlson et al.
1,449,087 A	3/1923	Bugbee
1,815,725 A	7/1931	Pilling et al.
1,822,330 A	9/1931	Ainslie
2,577,240 A	12/1951	Findley

(Continued)

**FOREIGN PATENT DOCUMENTS**

EP	0 140 557	5/1985
EP	0 589 409	3/1994
EP	0 674 875	10/1995

**OTHER PUBLICATIONS**

Lecture “Human Gross Anatomy and Embryology Pelvic  
Organs and Pelvic Diaphragm” by Dr. Roberts, University  
of Minnesota Medical School. Lecture given Fall 2000.  
Information posted tot he internet before Oct. 17, 2000.  
Describes pelvic floor area.

GyneFlex™— Instructions : Female Pelvic Floor Muscles.  
Shows color diagrams of the pelvic floor area. Printed Feb.  
7, 2003.

“Physicaians/Plastic Surgery/Pelvic Floor Dysfunction”,  
Abington Memorial Hospital. Printed Feb. 6, 2003. Describe  
what the pelvic area constitutes.

*Primary Examiner*—Beverly M. Flanagan

(74) *Attorney, Agent, or Firm*—Edwards & Angell, LLP

(57) **ABSTRACT**

Suturing instruments in accordance with the invention are  
dimensioned and configured to apply sutures to  
approximate, ligate, or fixate tissue in, for example, open,  
mini-incision, trans-vaginal, laparoscopic, or endoscopic  
surgical procedures. In some embodiments, the suturing  
instruments include a distal portion that is deflectably and/or  
pivotally coupled to the remainder of the instrument for  
improved maneuverability and functionality during surgery.  
In other embodiments, the suturing instruments are capable  
of housing multiple needle and suture assemblies and/or  
reloading the needle and suture assembly without removing  
the instrument from the surgical site.

**14 Claims, 30 Drawing Sheets**

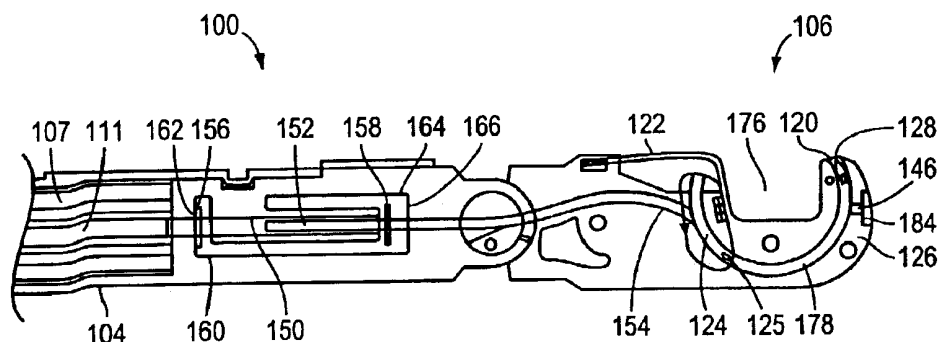

## U.S. PATENT DOCUMENTS

2,579,192 A	12/1951	Kohl	5,387,221 A	2/1995	Bisgaard
3,013,559 A	12/1961	Thomas	5,389,103 A	2/1995	Melzer et al.
3,160,157 A	12/1964	Chisman	5,391,174 A	2/1995	Weston
3,470,875 A	10/1969	Johnson	5,417,699 A	5/1995	Klein et al.
3,638,653 A	2/1972	Berry	5,417,700 A	5/1995	Egan
3,840,017 A	10/1974	Violante	5,454,823 A	10/1995	Richardson et al.
3,918,455 A	11/1975	Coplan	5,458,609 A	10/1995	Gordon et al.
3,946,740 A	3/1976	Bassett	5,527,321 A	6/1996	Hinchliffe
3,986,468 A	10/1976	Szostak et al.	5,540,704 A	7/1996	Gordon et al.
4,161,951 A	7/1979	Scanlan, Jr.	5,540,705 A	7/1996	Meade et al.
4,164,225 A	8/1979	Johnson et al.	5,549,617 A	8/1996	Green et al.
4,224,947 A	9/1980	Fukuda	5,562,686 A	10/1996	Sauer et al.
4,235,177 A	11/1980	Arbuckle	5,573,542 A	11/1996	Stevens
4,235,238 A	11/1980	Ogiu et al.	5,575,800 A	11/1996	Gordon
4,236,470 A	12/1980	Stenson	5,578,044 A	11/1996	Gordon et al.
4,312,337 A	1/1982	Donohue	5,591,179 A	1/1997	Edelstein
4,345,601 A	8/1982	Fukuda	5,593,421 A	1/1997	Bauer
4,493,323 A	1/1985	Albright et al.	5,662,664 A	9/1997	Gordon et al.
4,548,202 A	10/1985	Duncan	5,662,666 A	9/1997	Onuki et al.
4,557,265 A	12/1985	Andersson	5,665,096 A	9/1997	Yoon
4,579,072 A	4/1986	Koike et al.	5,690,653 A	11/1997	Richardson et al.
4,596,249 A	6/1986	Freda et al.	5,700,272 A	12/1997	Gordon et al.
4,602,635 A	7/1986	Mulhollan et al.	5,700,273 A	12/1997	Buelna et al.
4,621,640 A	11/1986	Mulhollan et al.	5,713,910 A	2/1998	Gordon et al.
4,635,638 A	1/1987	Weintraub et al.	5,741,277 A	4/1998	Gordon et al.
4,762,260 A	8/1988	Richards et al.	5,741,279 A	4/1998	Gordon et al.
4,781,190 A	11/1988	Lee	5,755,727 A	5/1998	Kontos
4,890,615 A	1/1990	Caspari et al.	5,759,188 A	6/1998	Yoon
4,898,155 A	2/1990	Ovil et al.	5,779,718 A	7/1998	Green et al.
4,899,746 A	2/1990	Brunk	5,782,845 A	7/1998	Shewchuk
4,923,461 A	5/1990	Caspari et al.	5,827,298 A	10/1998	Hart et al.
4,926,860 A	5/1990	Stice et al.	5,843,001 A	12/1998	Goldenberg
4,935,027 A	6/1990	Yoon	5,855,585 A	1/1999	Kontos
4,957,498 A	9/1990	Caspari et al.	5,860,992 A	1/1999	Daniel et al.
5,037,433 A	8/1991	Wilk et al.	5,899,909 A	5/1999	Claren et al.
5,047,039 A	9/1991	Avant et al.	5,904,692 A	5/1999	Steckel et al.
5,067,957 A	11/1991	Jervis	5,908,428 A	6/1999	Scirica et al.
5,100,415 A	3/1992	Hayhurst	5,911,727 A	6/1999	Taylor
5,100,418 A	3/1992	Yoon et al.	5,919,199 A	7/1999	Mers Kelly et al.
5,100,421 A	3/1992	Christoudias	5,954,732 A	9/1999	Hart et al.
5,100,498 A	3/1992	Takeuchi et al.	6,048,351 A	4/2000	Gordon et al.
5,188,636 A	2/1993	Fedotov	6,051,006 A	4/2000	Shluzas et al.
5,258,011 A	11/1993	Drews	6,117,067 A	9/2000	Gil-Vernet
5,281,237 A	1/1994	Gimpelson	6,224,525 B1	5/2001	Stein
5,306,281 A	4/1994	Beurrier	6,443,962 B1	9/2002	Gaber
5,308,353 A	5/1994	Beurrier	6,454,778 B2	9/2002	Kortenbach
5,324,298 A	6/1994	Phillips et al.	6,755,843 B2 *	6/2004	Chung et al. .... 606/139
5,336,231 A	8/1994	Adair	2002/0107530 A1 *	8/2002	Sauer et al. .... 606/139
5,364,408 A	11/1994	Gordon			

\* cited by examiner

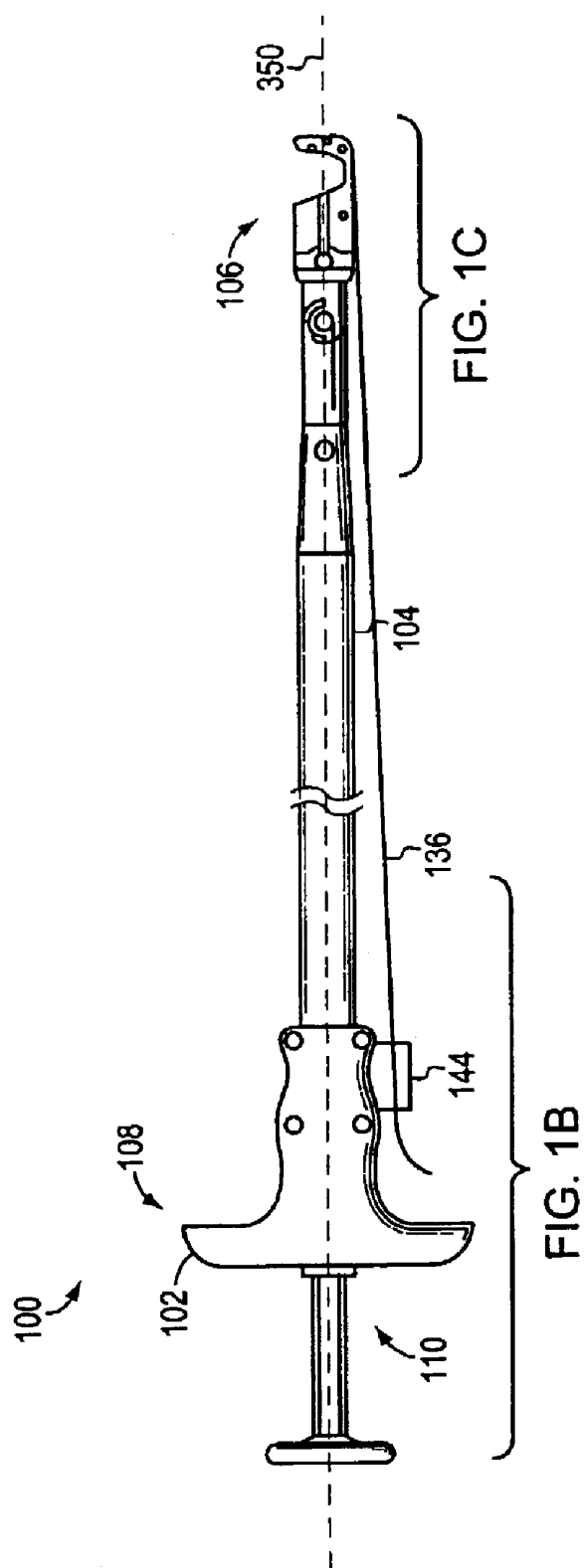

FIG. 1A

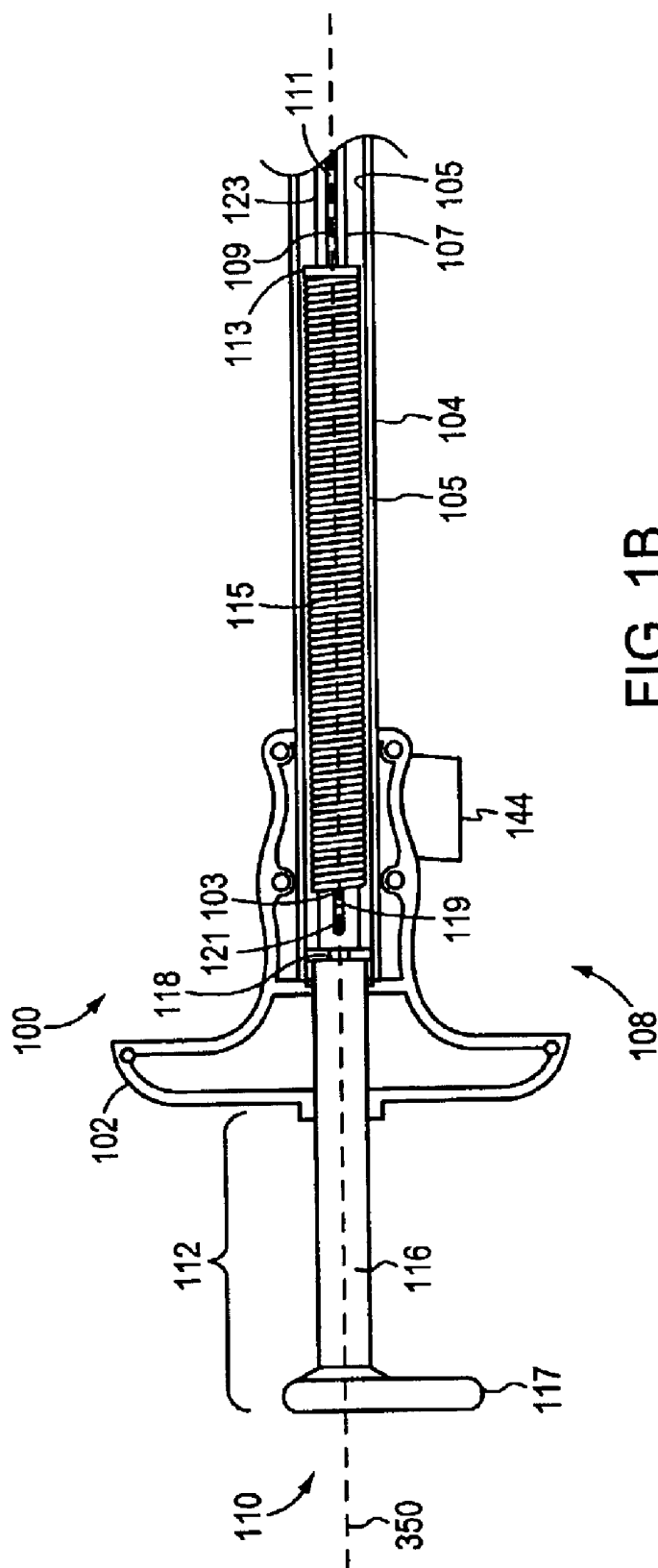

FIG. 1B

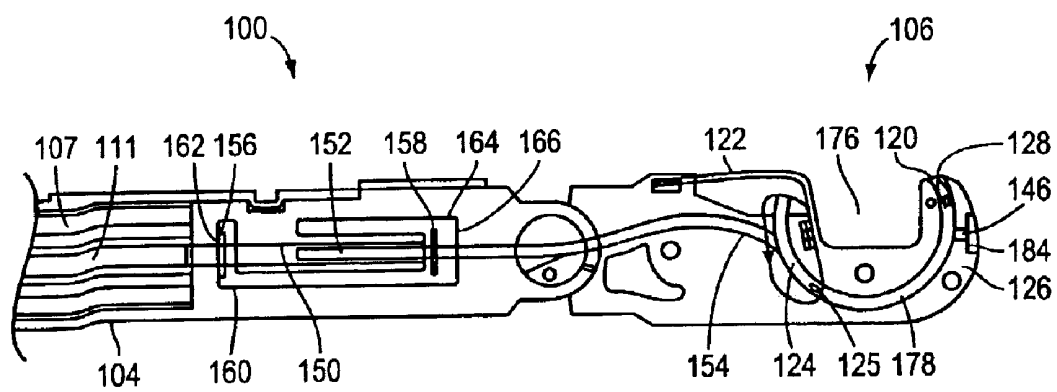

FIG. 1C

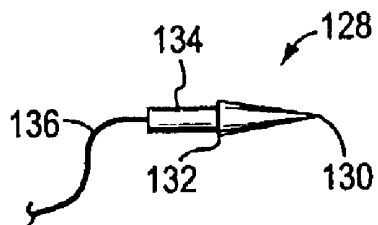

FIG. 2A

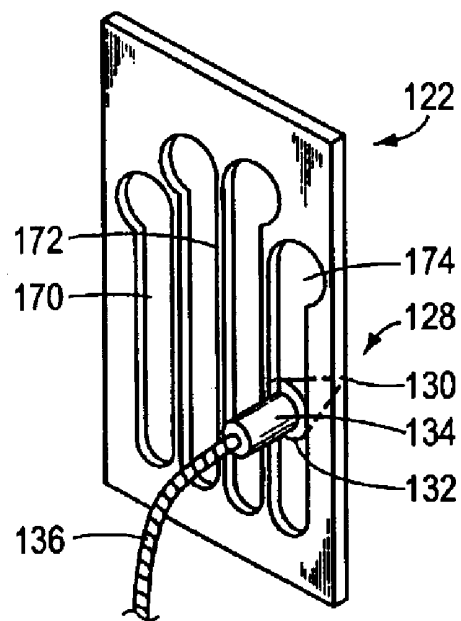

FIG. 2B

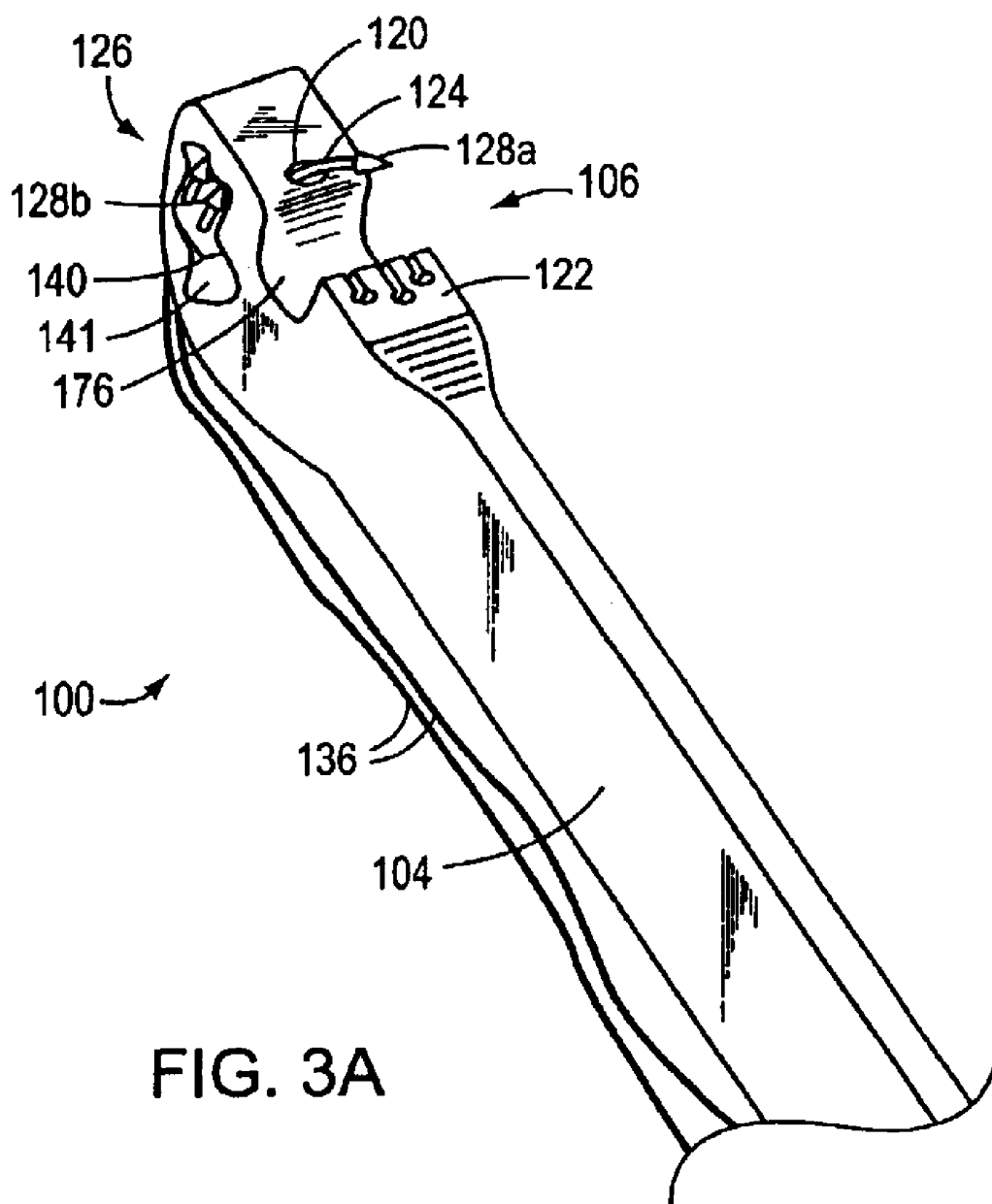

FIG. 3A

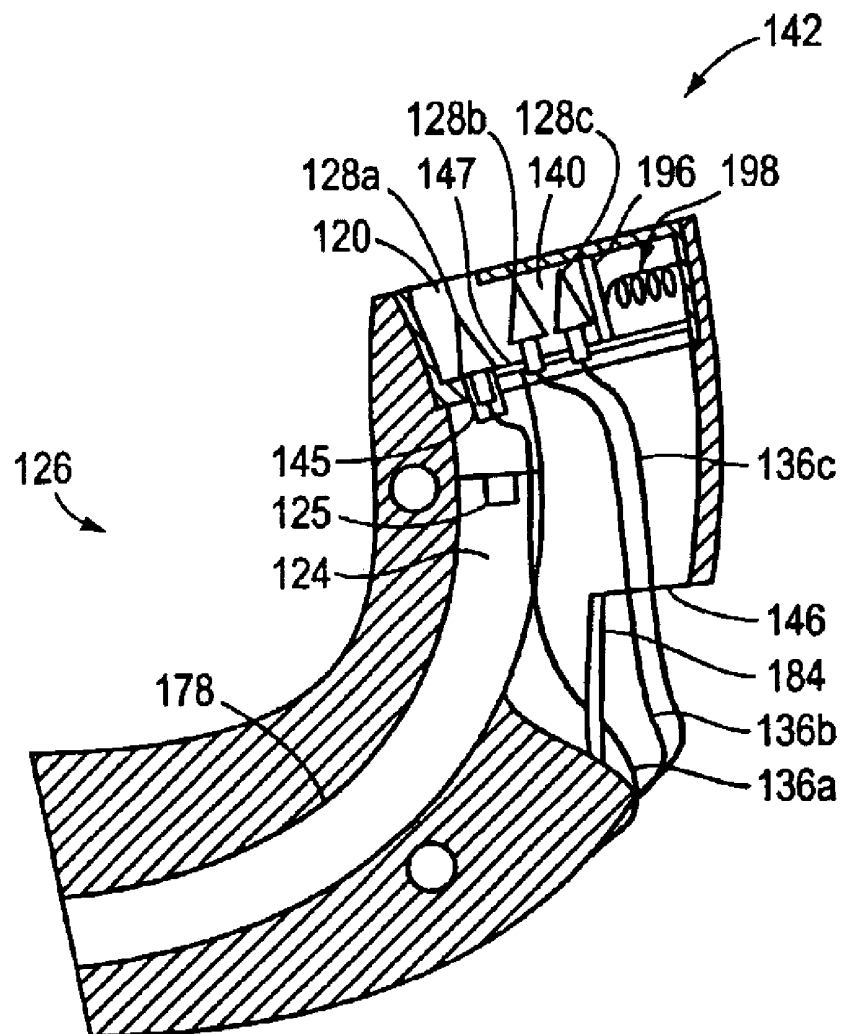

FIG. 3B



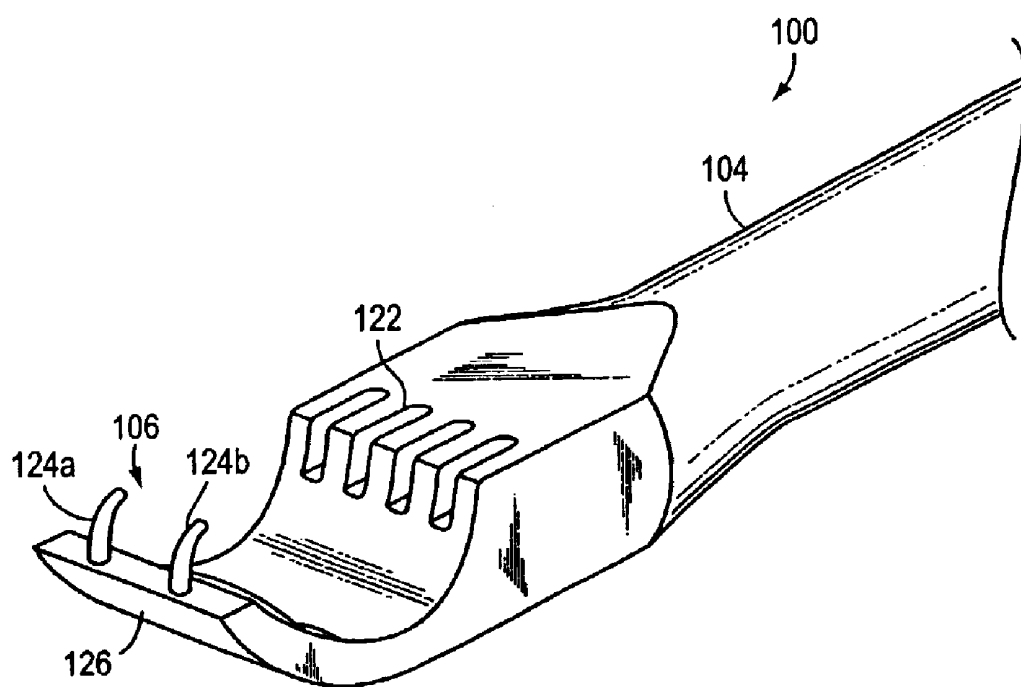

FIG. 4A

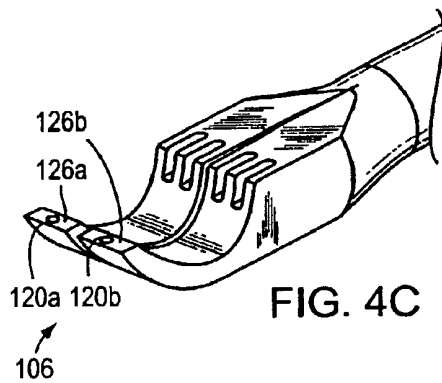

FIG. 4C

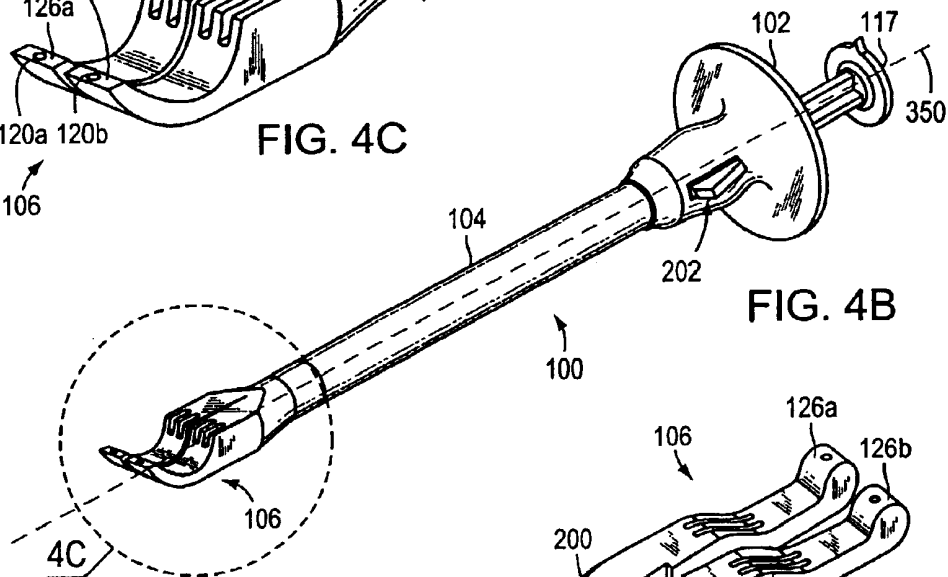

FIG. 4B

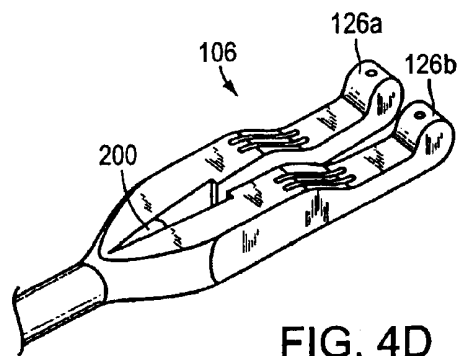

FIG. 4D

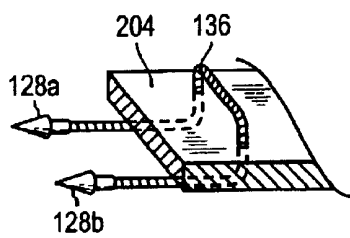

FIG. 4E

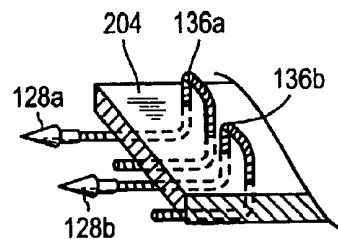

FIG. 4F

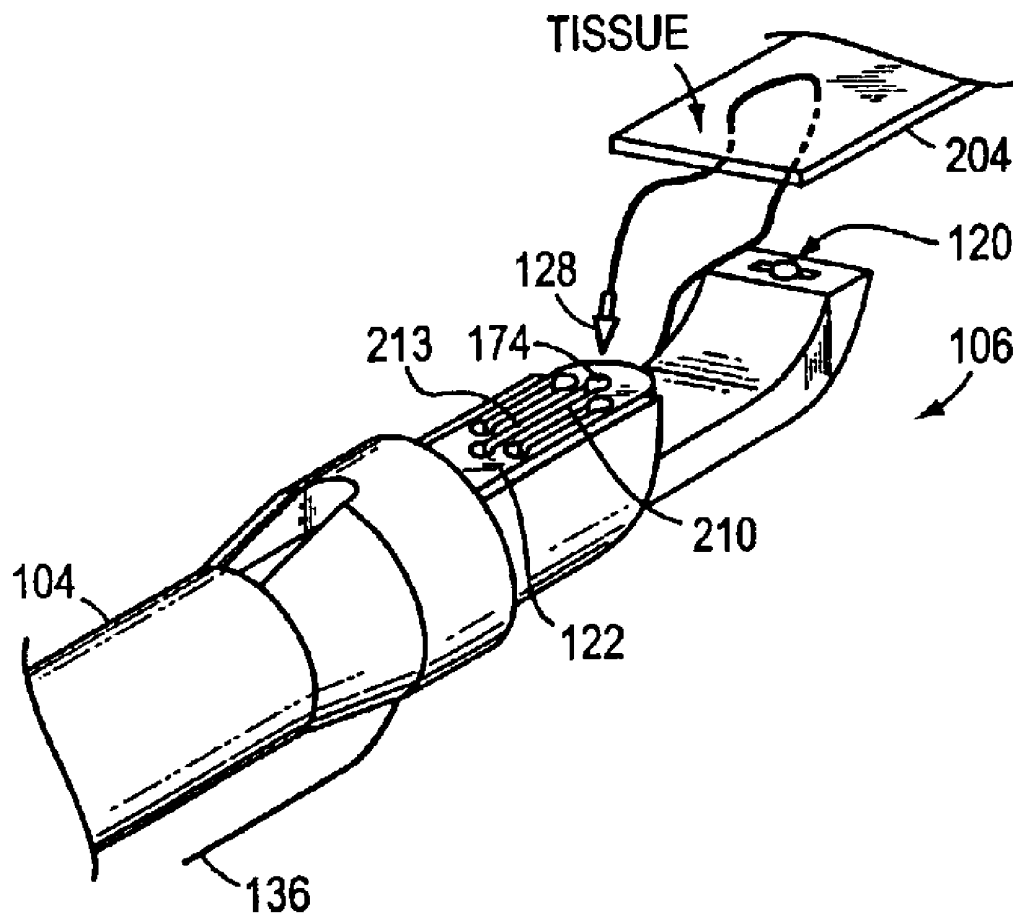

FIG. 5A

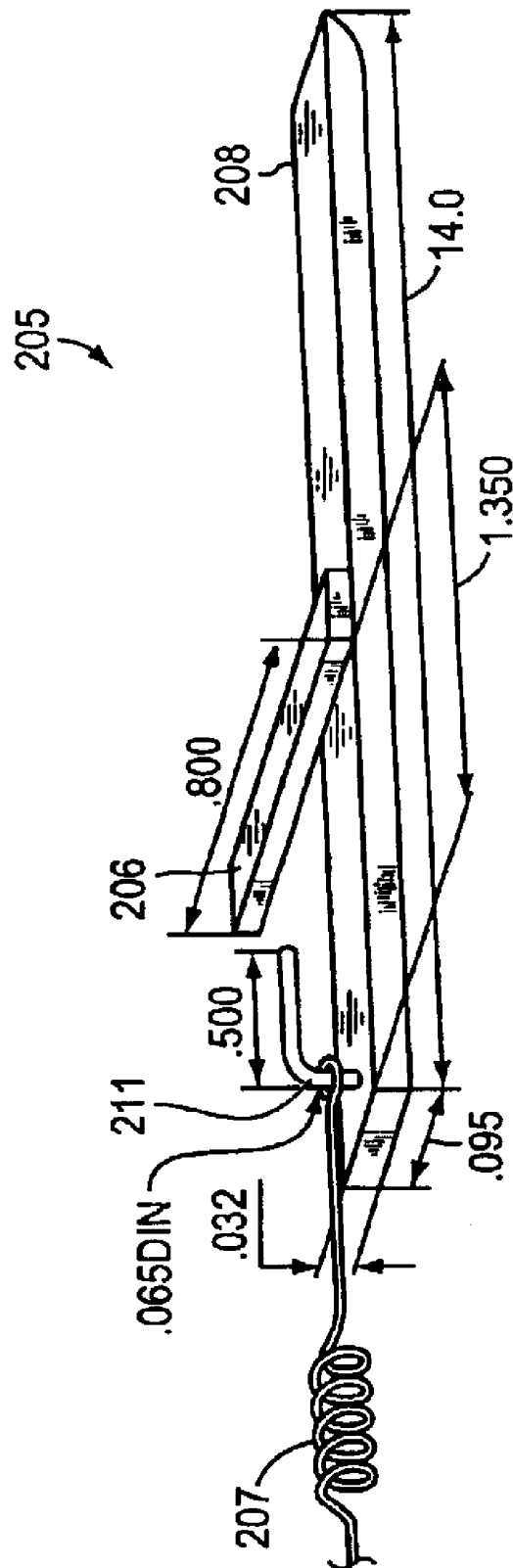

FIG. 5B

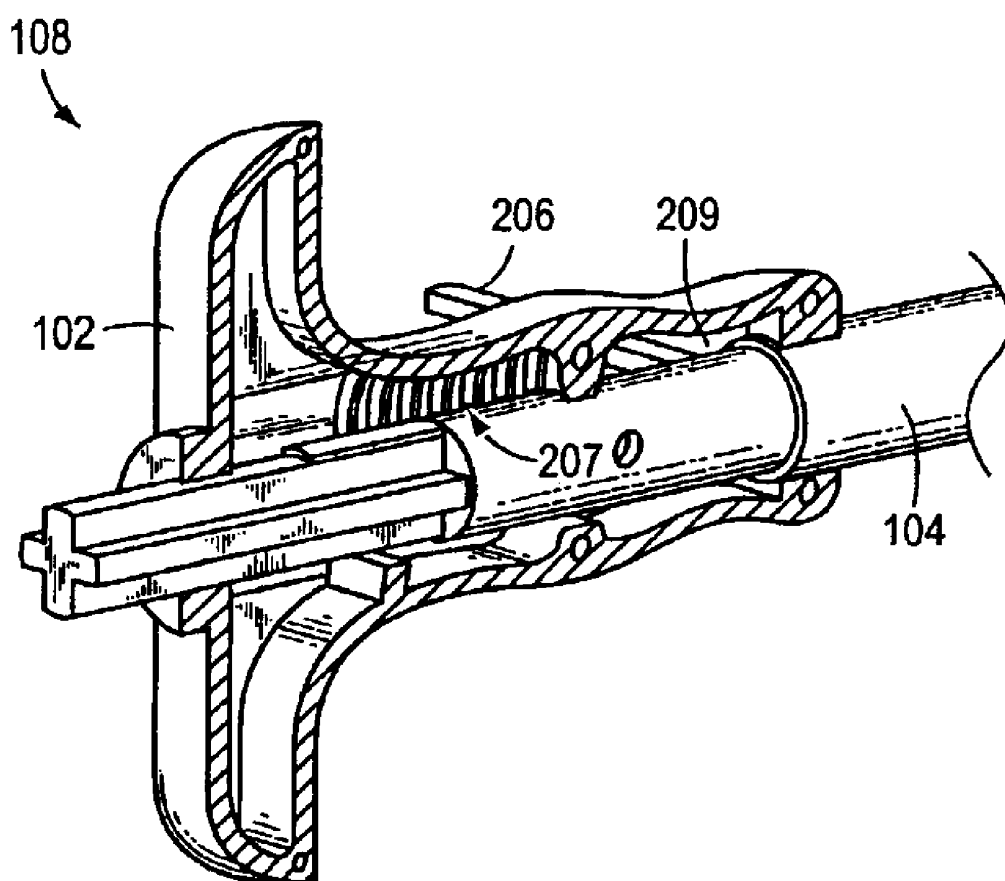

FIG. 5C

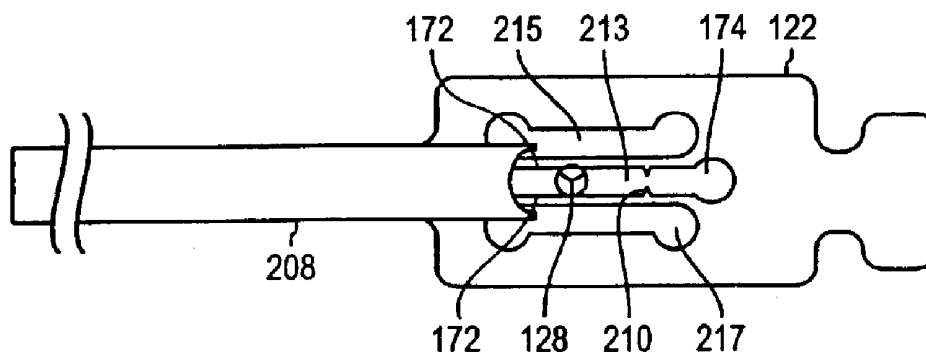

FIG. 5D

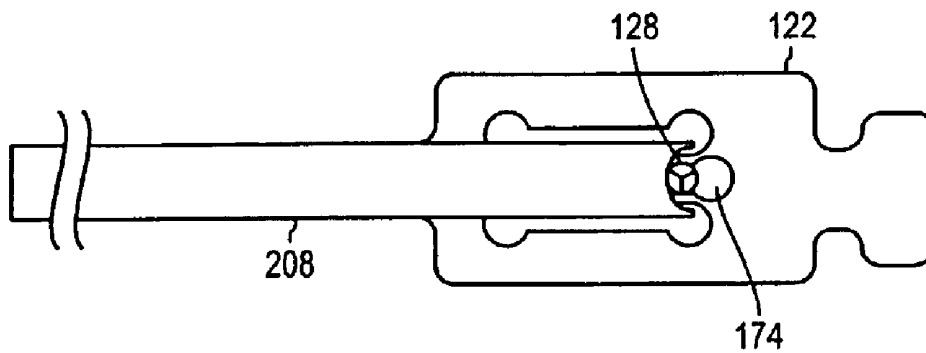

FIG. 5E

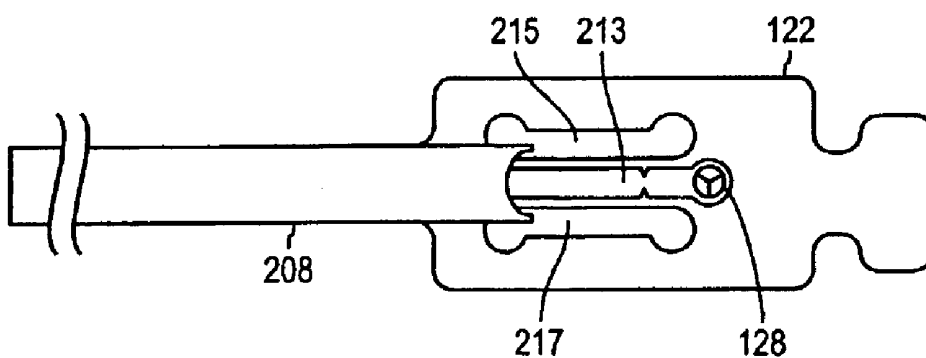

FIG. 5F

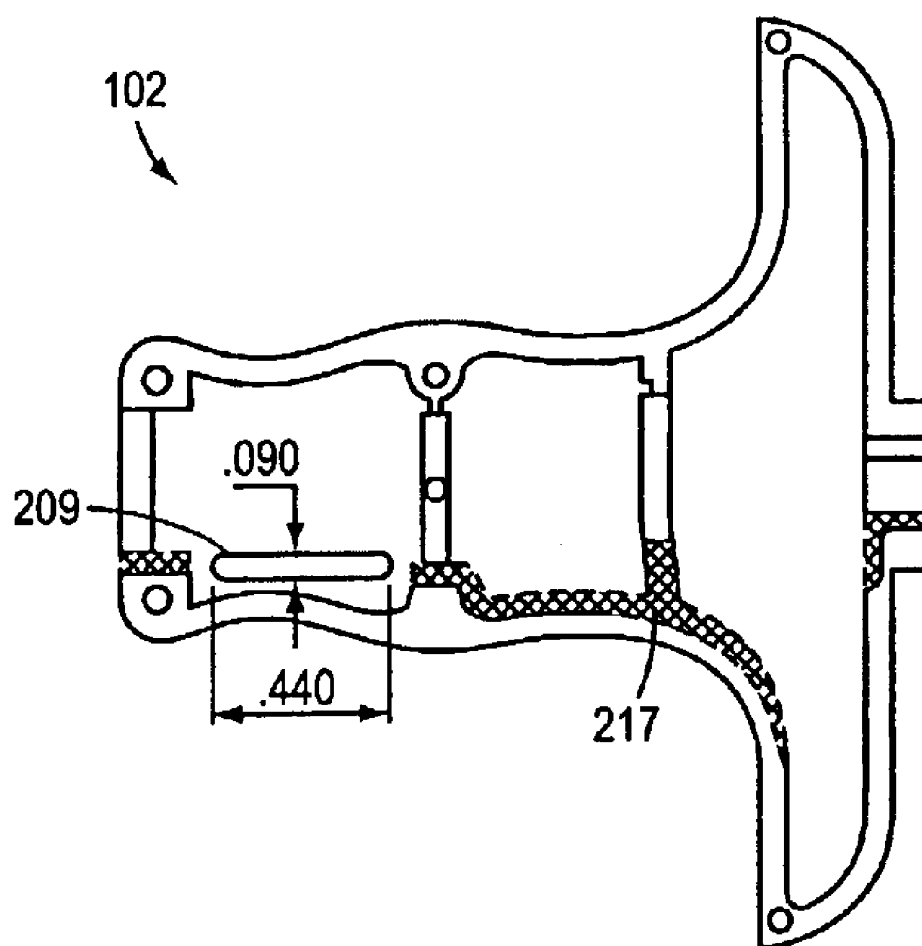

FIG. 5G

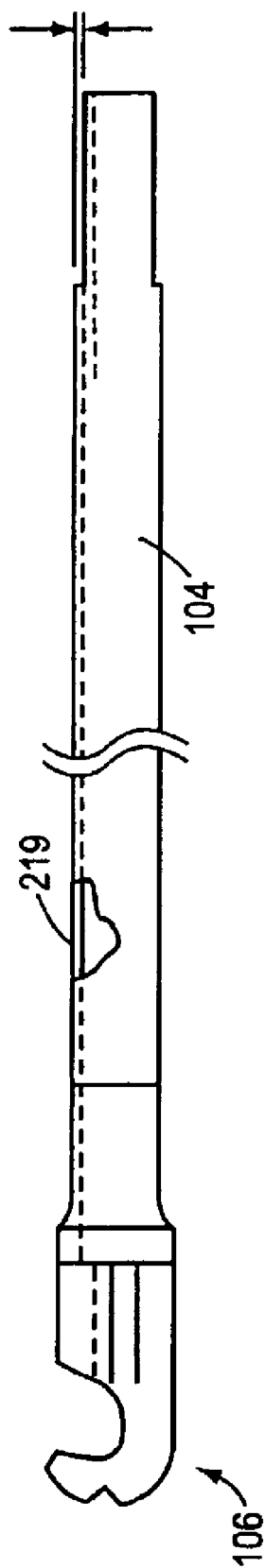
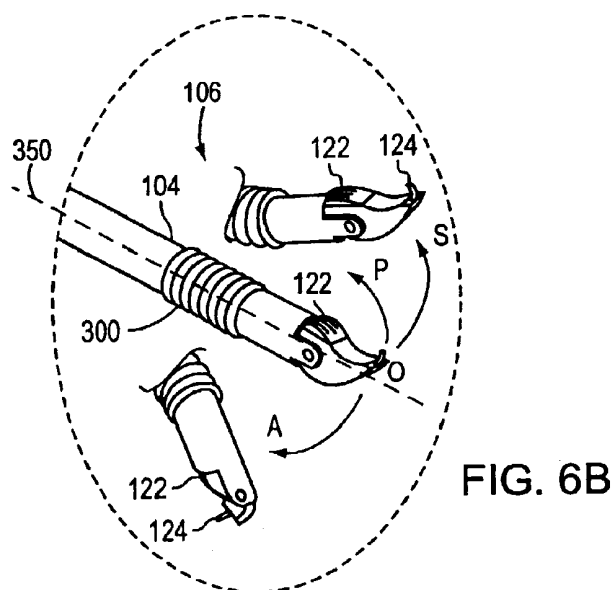
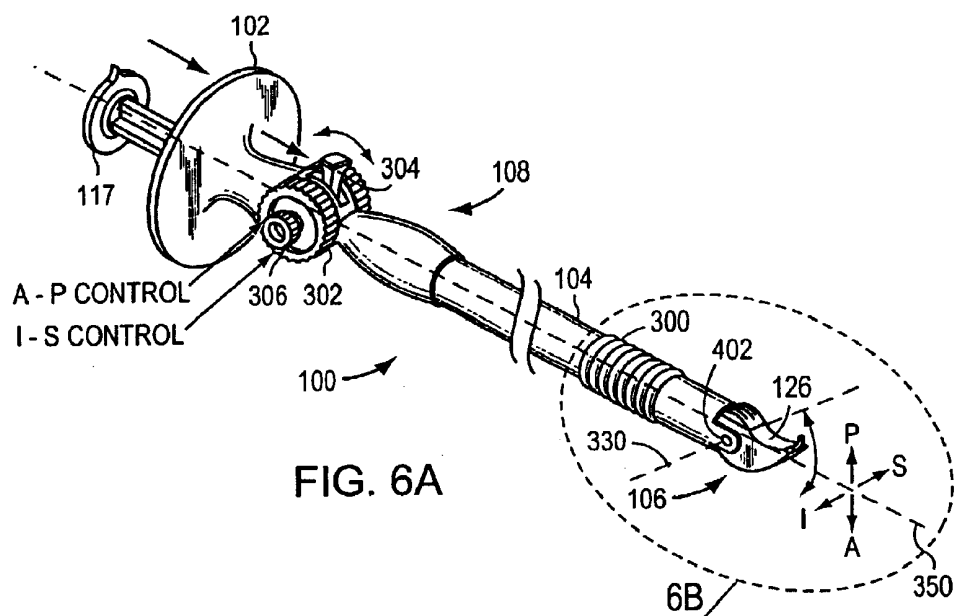
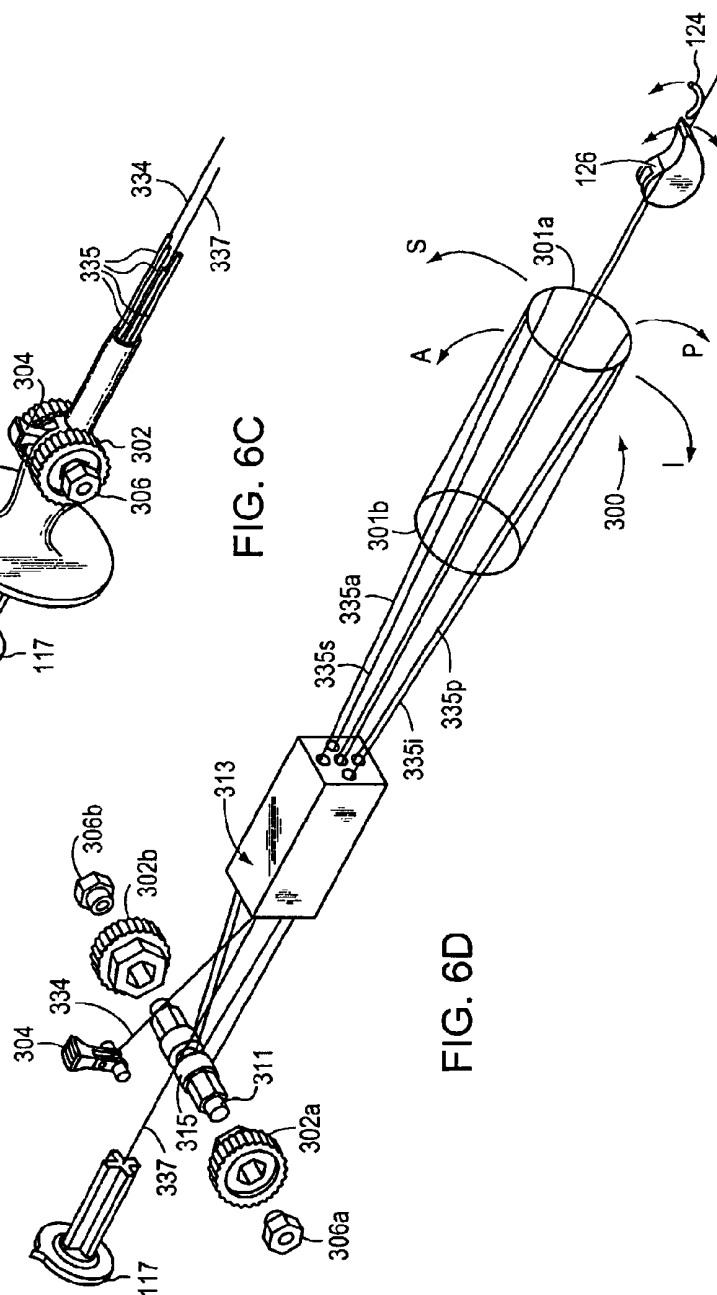
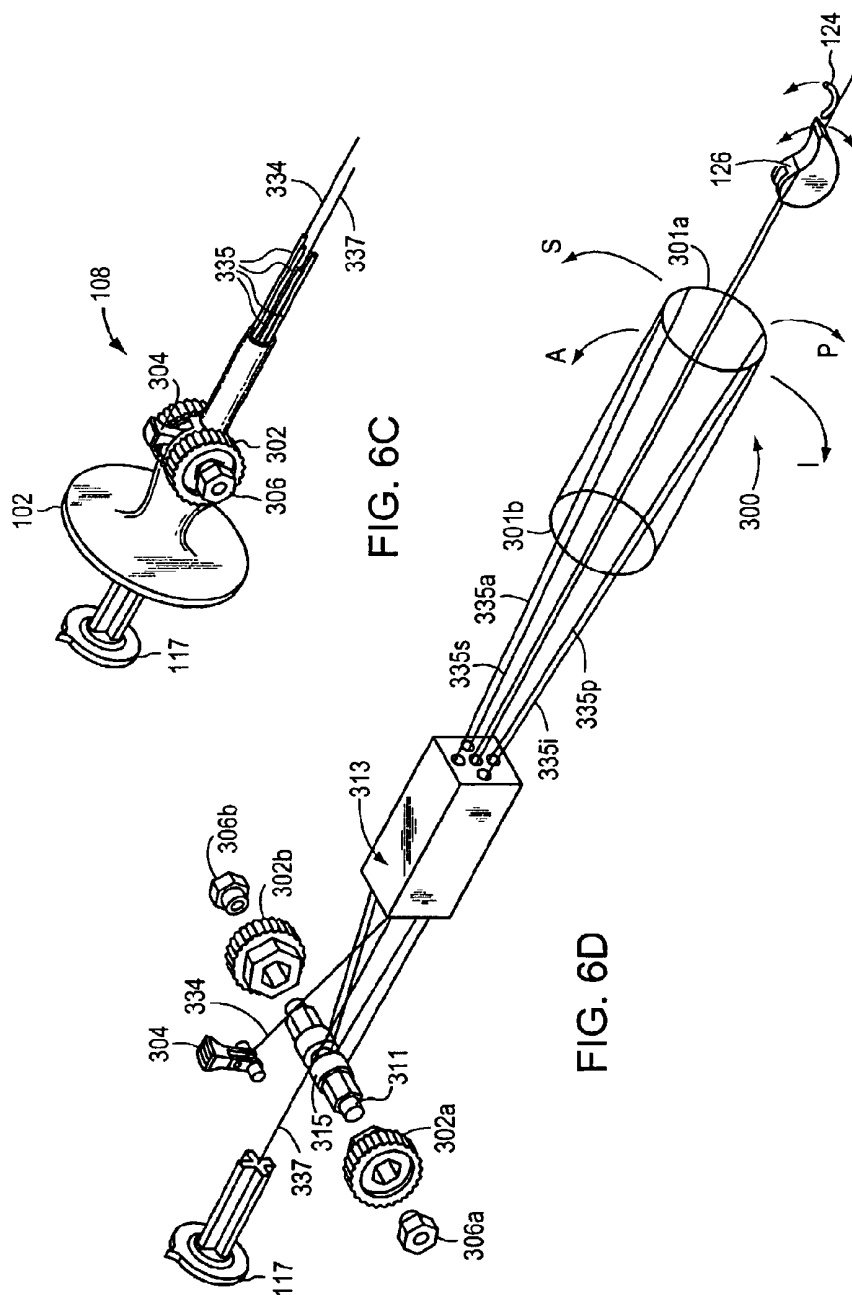
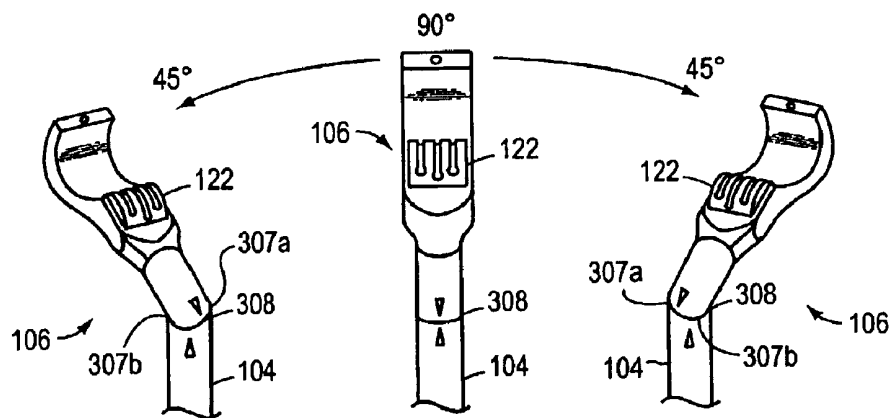
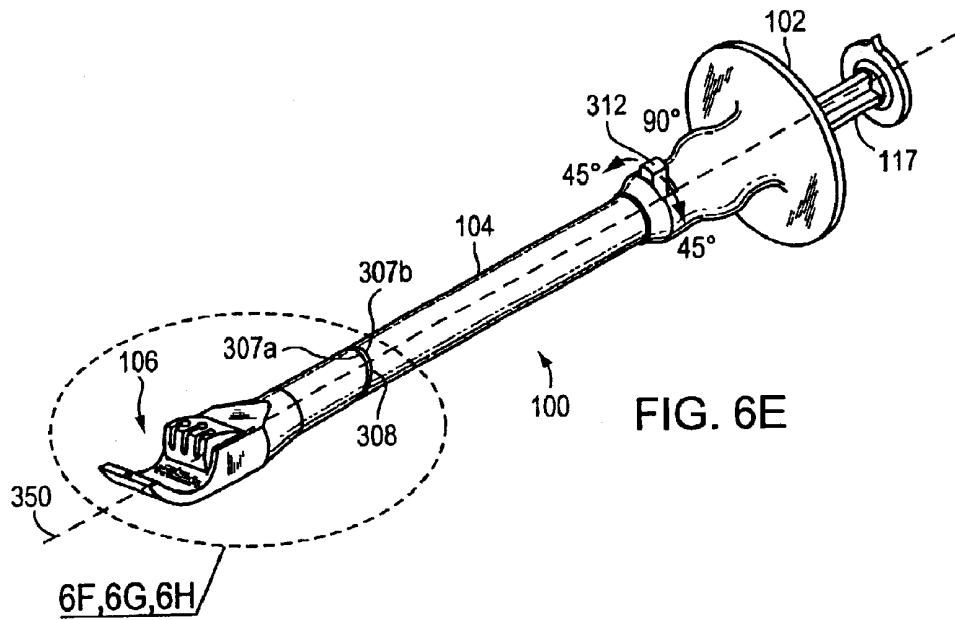

FIG. 5H









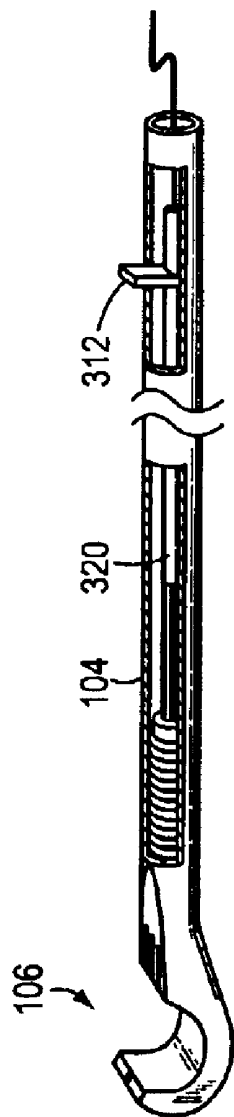

FIG. 6I

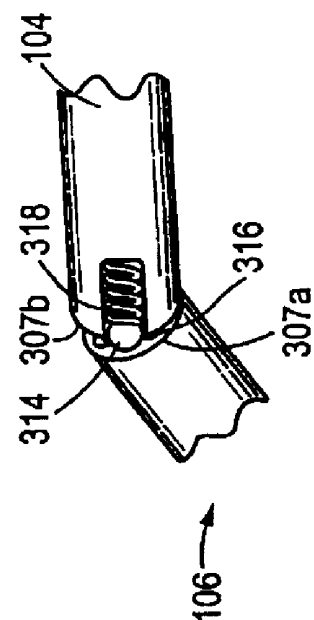

FIG. 6J

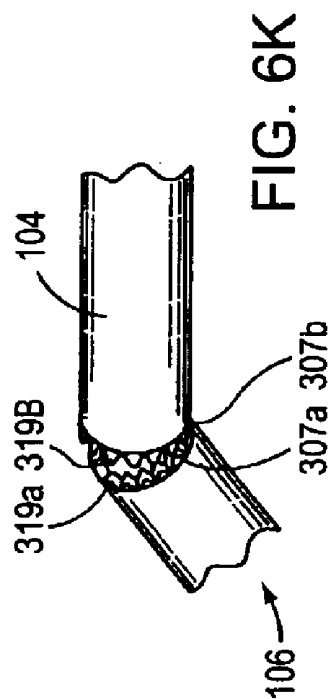

FIG. 6K

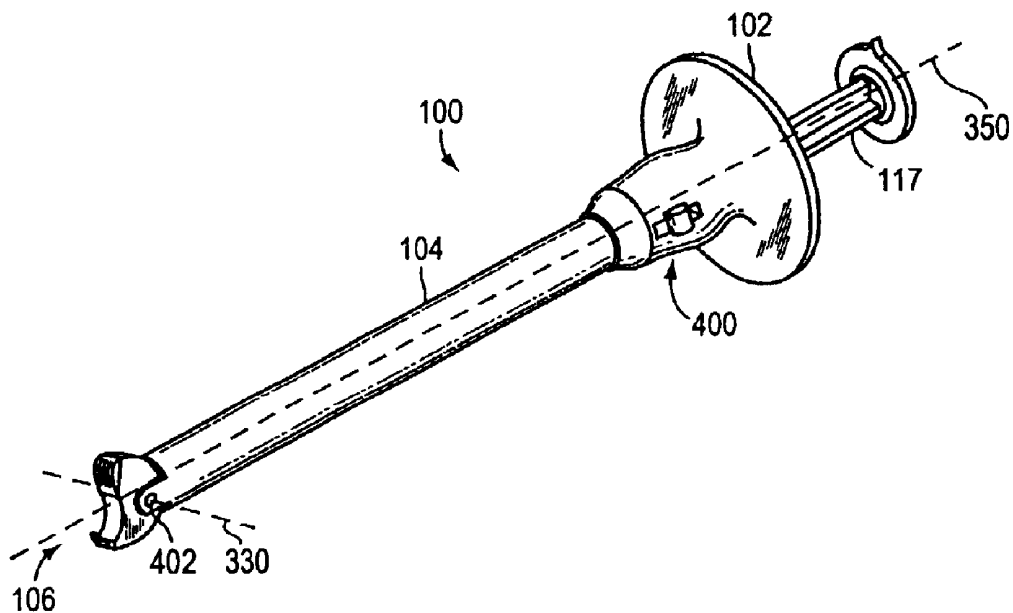

FIG. 7A

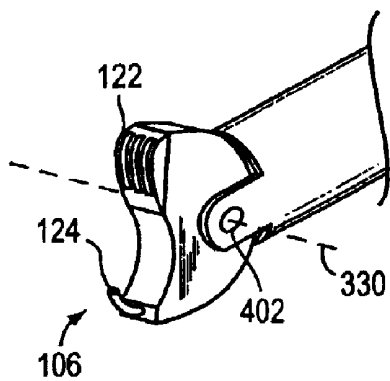

FIG. 7B

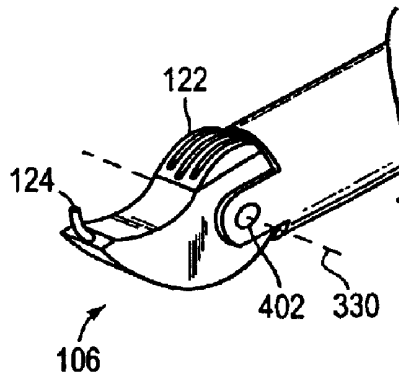

FIG. 7C

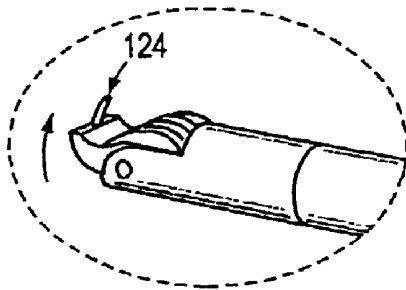

FIG. 7G

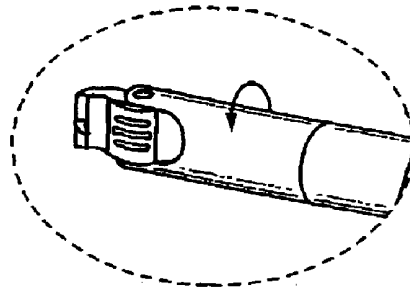

FIG. 7H

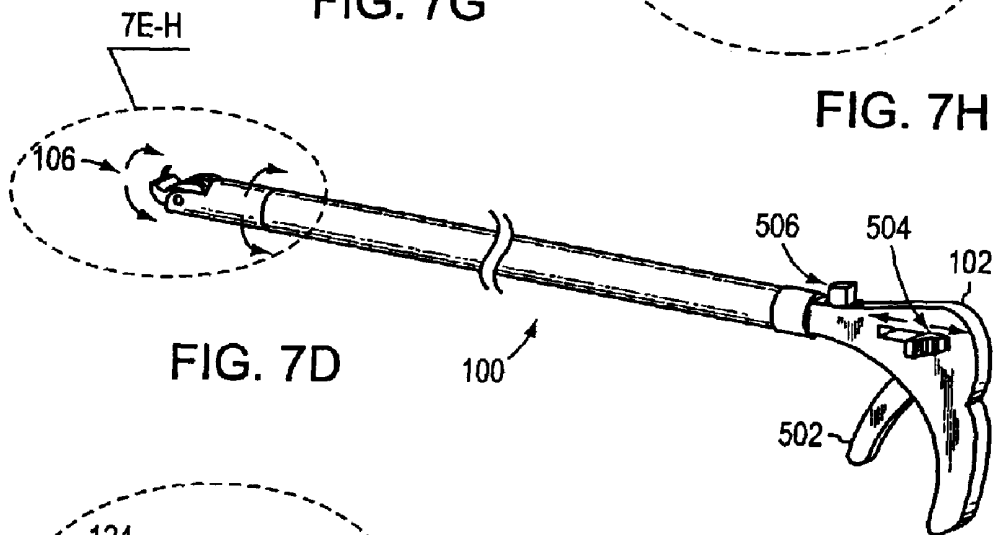

FIG. 7D

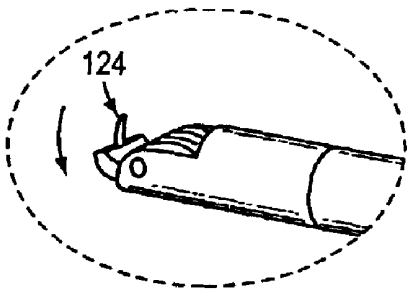

FIG. 7E

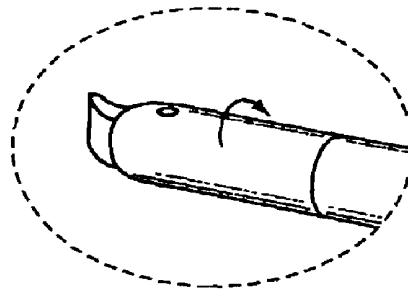

FIG. 7F

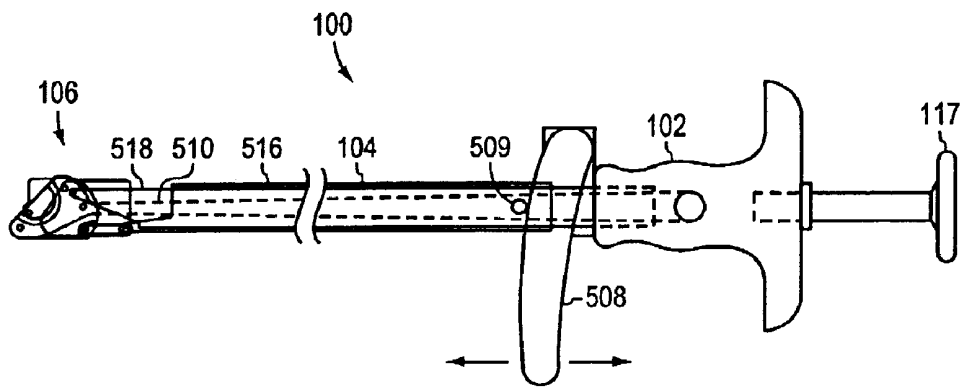

FIG. 8A

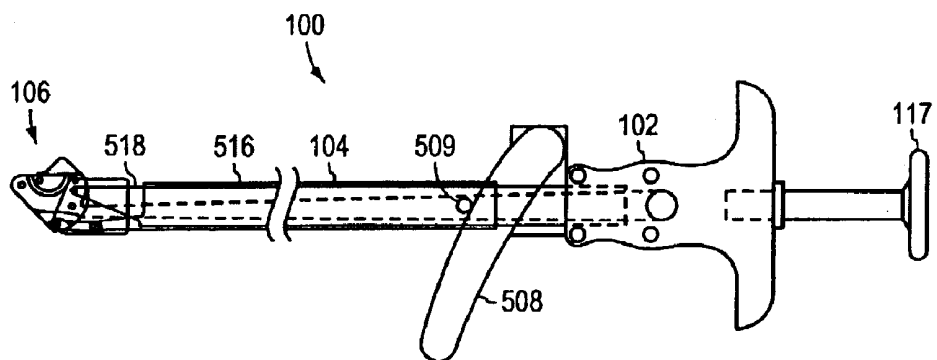

FIG. 8C

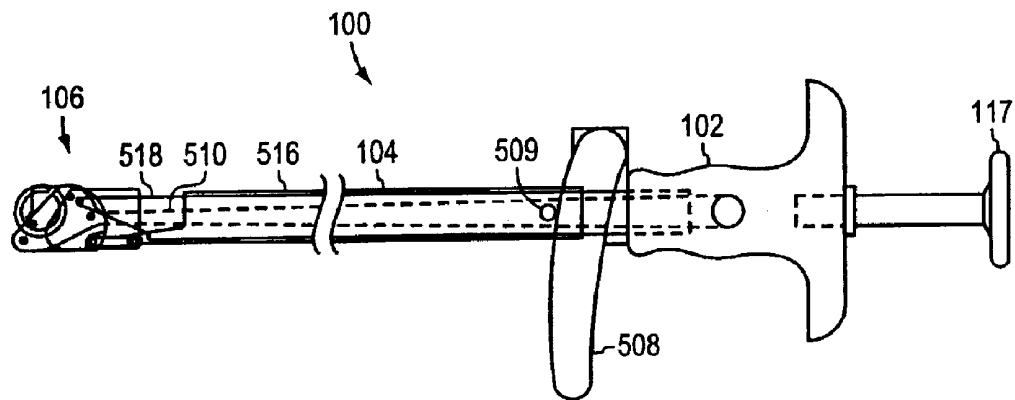

FIG. 8B



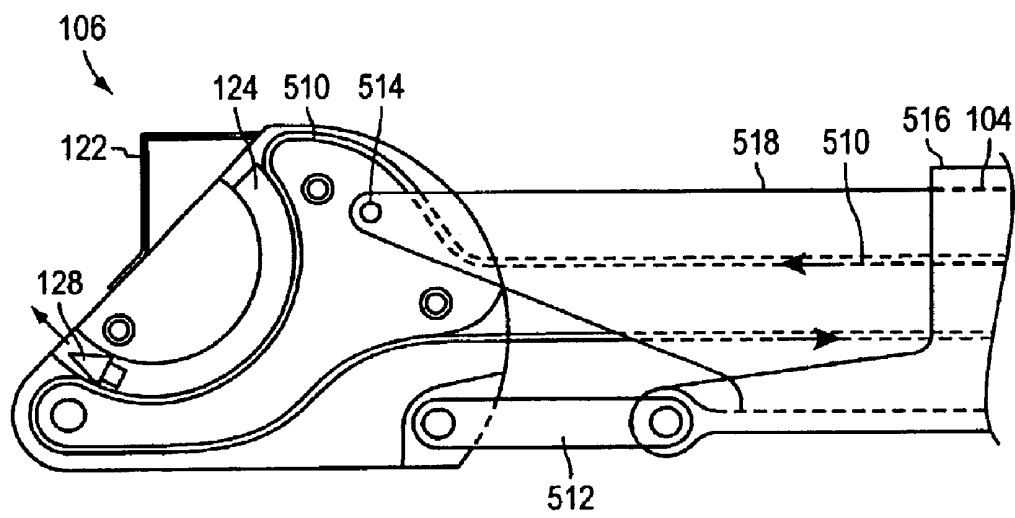

FIG. 8D

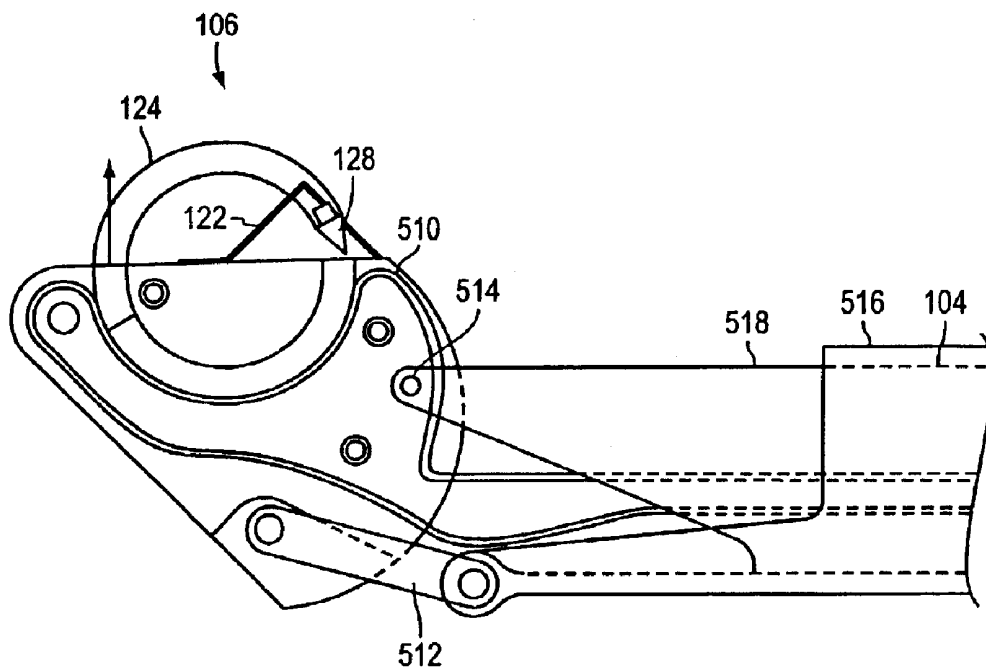

FIG. 8E

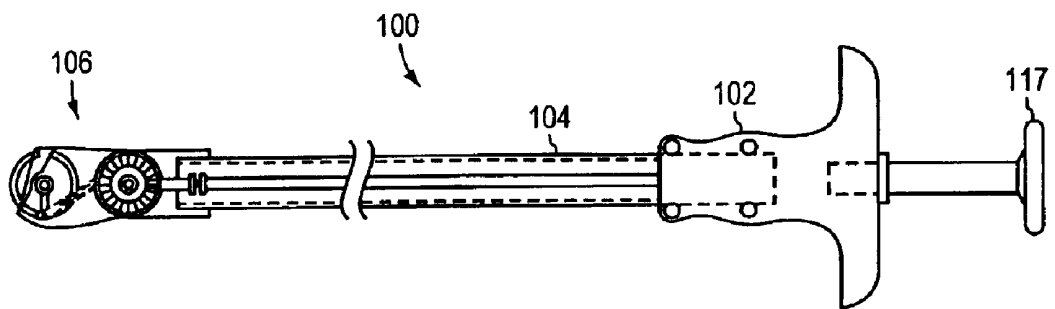

FIG. 9A

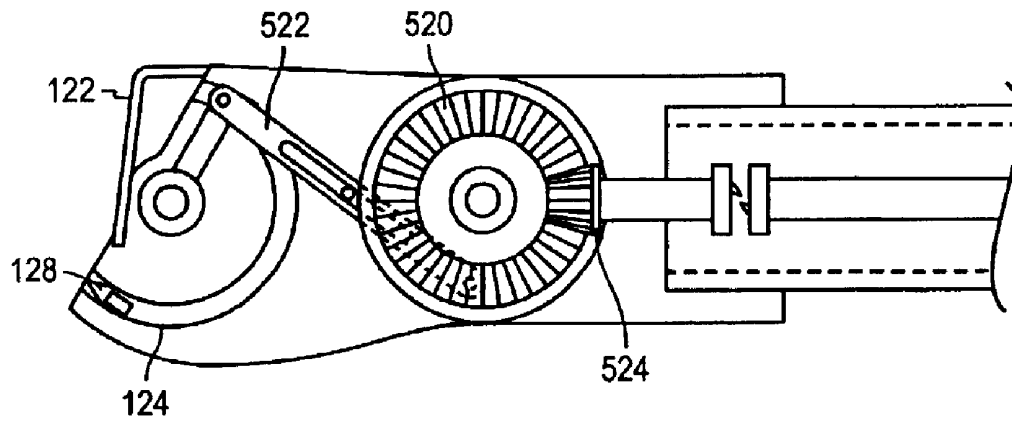

FIG. 9B

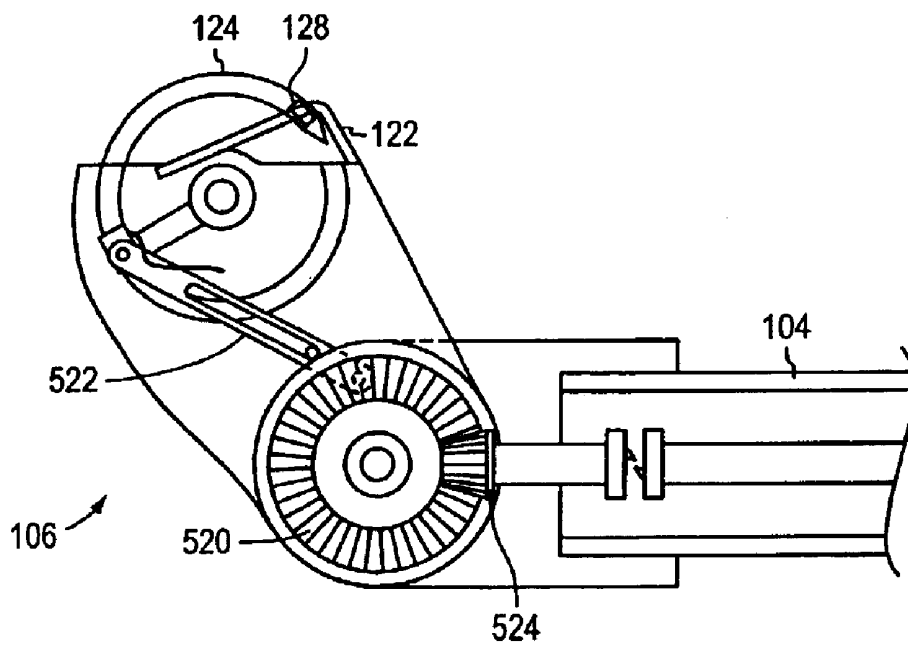

FIG. 9C

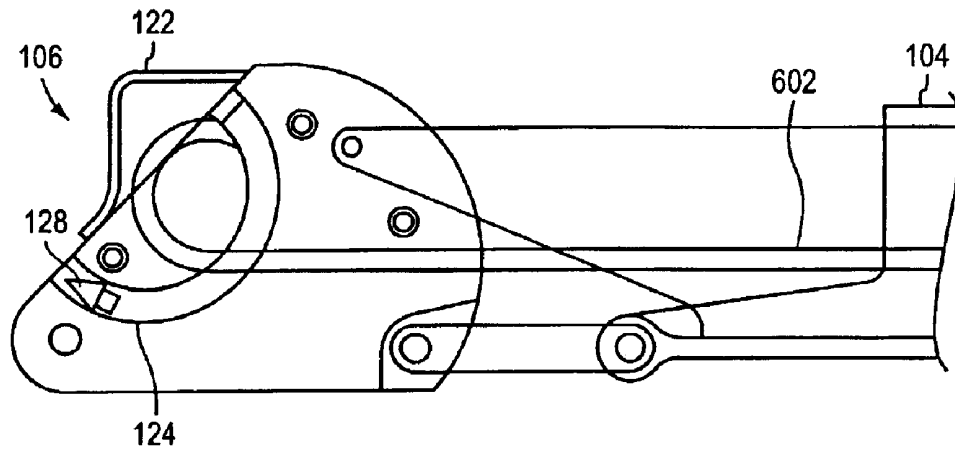

FIG. 10A

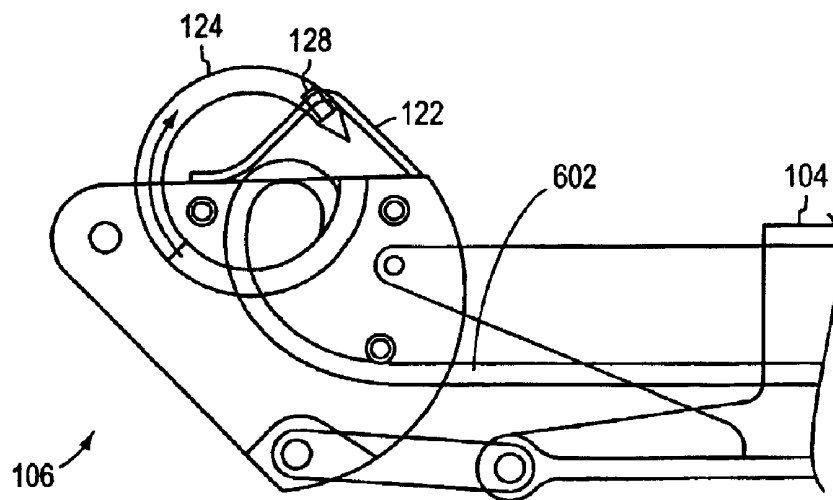

FIG. 10B

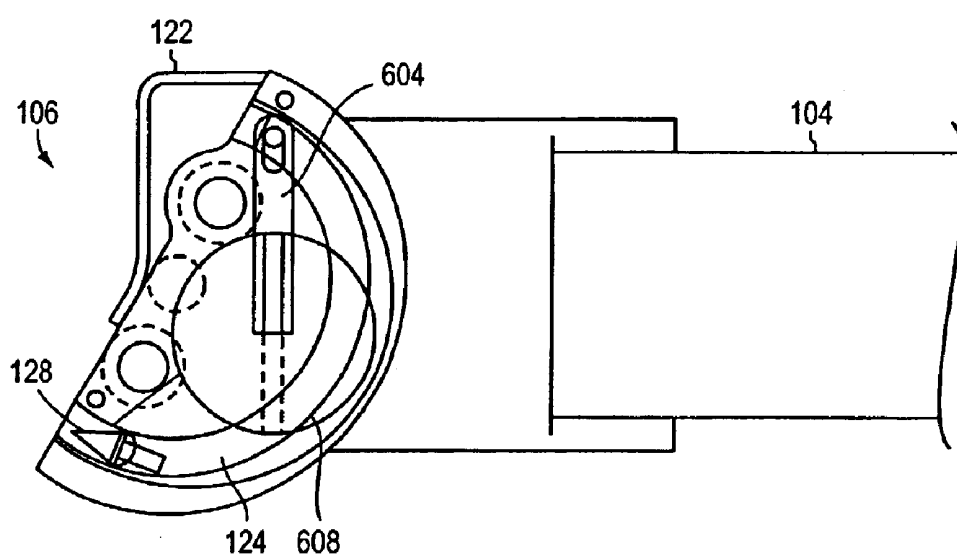

FIG. 11A

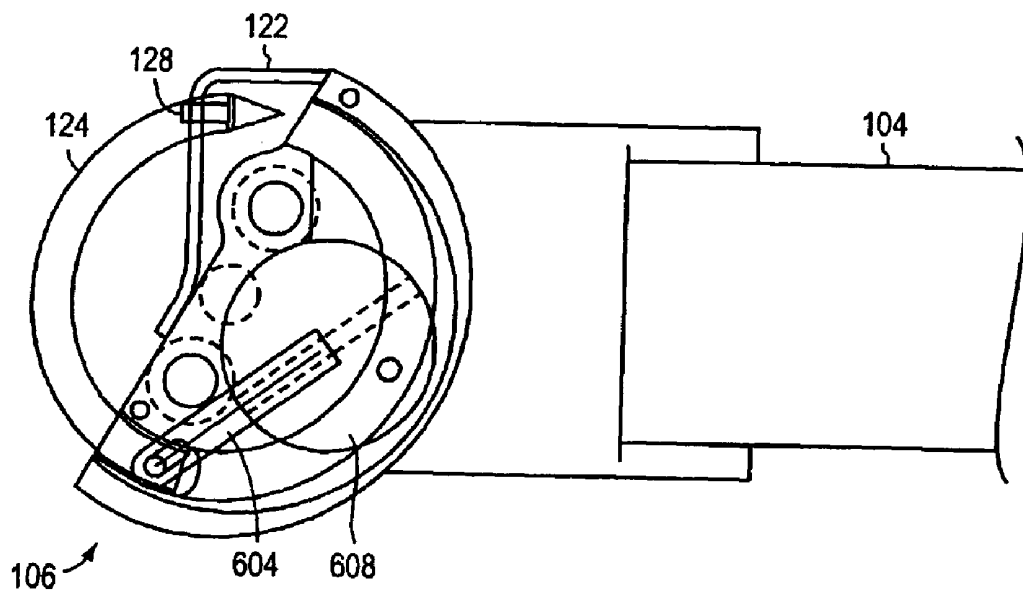
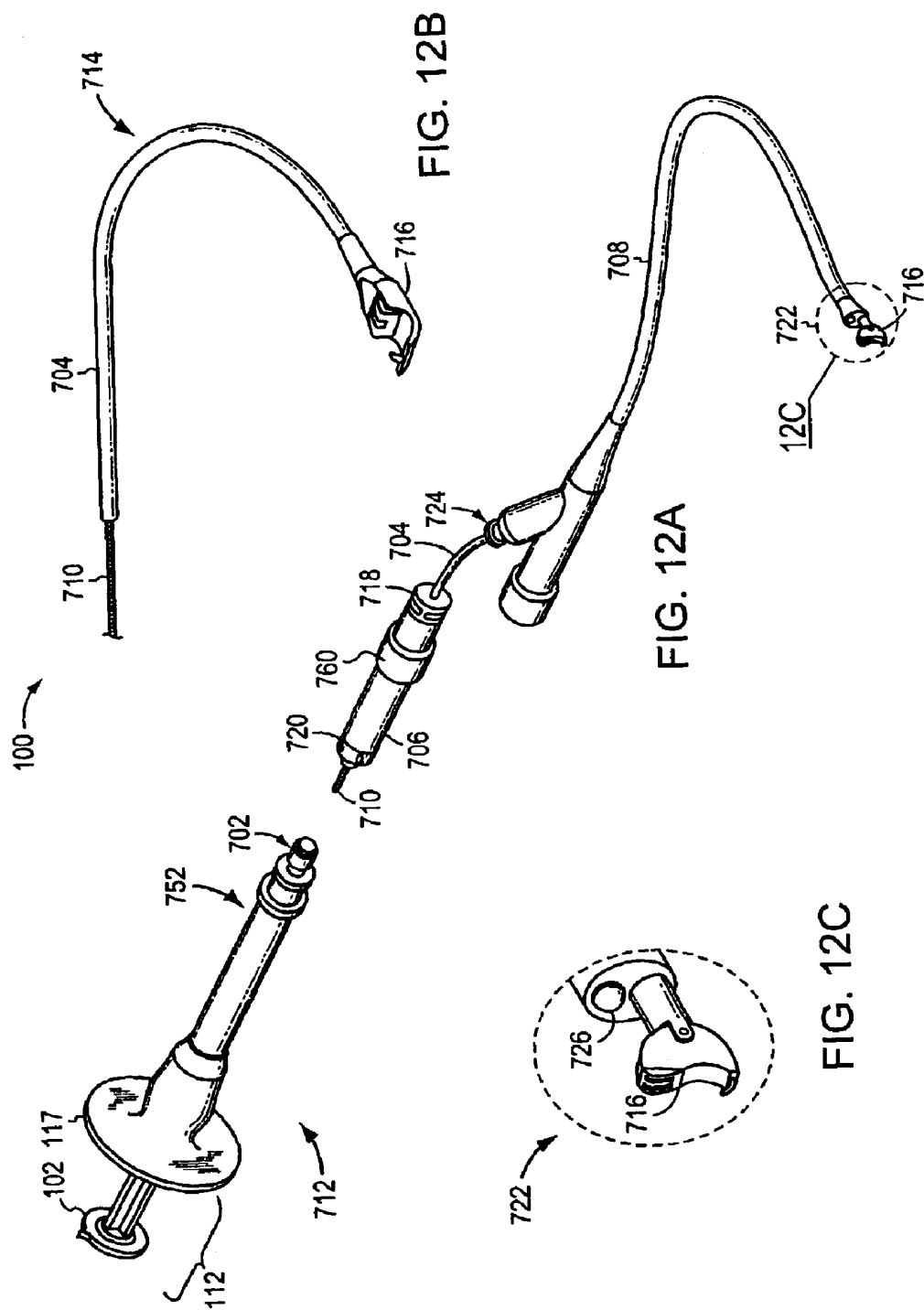

FIG. 11B





**ENDOSCOPIC SUTURE INSTRUMENT****CROSS-REFERENCE TO RELATED APPLICATION**

This application incorporates by reference, and claims priority to and the benefit of, provisional U.S. Patent Application Ser. No. 60/388,458, which was filed on Jun. 12, 2002.

**TECHNICAL FIELD**

The invention relates to medical devices and, more specifically, to devices for approximation, ligation, or fixation of tissue using sutures.

**BACKGROUND INFORMATION**

Suturing of body tissue is a time consuming aspect of many surgical procedures. For many surgical procedures, it is necessary to make a large opening in the human body to expose the area that requires surgical repair. There are instruments available that allow for viewing of certain areas of the human body through a small puncture wound without exposing the entire body cavity. These instruments, called endoscopes, can be used in conjunction with specialized surgical instruments to detect, diagnose, and repair areas of the body that previously required open surgery to access.

Some surgical instruments used in endoscopic procedures are limited by the manner in which they access the areas of the human body in need of repair. In particular, the instruments may not be able to access tissue or organs located deep within the body or that are in some way obstructed. Also, many of the instruments are limited by the way they grasp tissue, apply a suture, or recapture the needle and suture. Furthermore, many of the instruments are complicated and expensive to use due to the numerous parts and/or subassemblies required to make them function properly.

Suturing instruments, and more specifically suturing instruments used in endoscopic procedures, are generally rigid and do not provide the operator a range of motion to access difficult to reach parts of the anatomical region requiring sutures. Accordingly, multiple instruments of various configurations and sizes must be used to access all of the necessary tissue areas. These limitations of suturing instruments complicate the endoscopic procedure for the surgeon by requiring the insertion and removal of multiple instruments from a surgical site as the target suturing area changes during the course of the surgical procedure.

Many medical procedures require that multiple sutures be placed within a patient. Typical suturing instruments enable a surgeon to place only one suture at a time. With such suturing instruments, the surgeon is required to remove the instrument from a surgical site and reload the instrument between placing each suture. Further, the surgeon may be required to use forceps or other instruments to help place the suture. In some instances, the forceps or other instruments may require an additional incision to access the surgical site.

Thus, suturing remains a delicate and time-consuming aspect of most surgeries, including those performed endoscopically. Accordingly, there is an unresolved need in the art to provide a suturing instrument with improved maneuverability, efficiency, and functionality during a surgical procedure.

**SUMMARY OF THE INVENTION**

The invention generally relates to surgical instruments for performing a surgical procedure, such as placing one or

more sutures through tissue. The suturing instruments disclosed herein are dimensioned and configured to apply sutures to approximate, ligate, or fixate tissues in, for example, open, mini-incision, trans-vaginal, laparoscopic, or endoscopic surgical procedures.

More particularly, in some embodiments, the invention is directed to suturing instruments that include a distal portion that is deflectably and/or pivotally coupled to the remainder of the instrument for improved maneuverability and functionality during surgery.

In other embodiments the invention is directed to suturing instruments capable of housing multiple needle and suture assemblies and/or reloading the needle and suture assembly without removing the instrument from the surgical site. Such suturing instruments allow a surgeon to place multiple sutures without having to reload the instrument after each suture is placed, which is more efficient and less invasive than a procedure where the surgeon has to remove the instrument from the surgical site to reload. This is particularly helpful when the surgical site is located deep within a body and not easily repeatably accessible.

In general, in a first aspect, the invention features a suturing instrument that includes an elongate body member having a middle portion and a distal portion. The distal portion extends distally from the middle portion and is deflectable at a predetermined angle relative to the middle portion. The predetermined angle of deflection of the distal portion may range from about  $-90^\circ$  to about  $90^\circ$ . The suturing instrument also includes a needle deployment mechanism disposed at least partially within the elongate body member. The needle deployment mechanism is connectable to a needle for moving the needle out of the distal portion of the elongate body member.

In one embodiment according to the first aspect of the invention, the elongate member also includes at least one tension member that is slidably disposed at least partially in the elongate member and is connected to its distal portion. In this embodiment, the suturing instrument may include at least one deflection control member coupled to the tension member and disposed opposite the distal portion of the elongate body member for controlling deflection of the distal portion.

In another embodiment according to the first aspect of the invention, the distal portion is pivotable about a first axis that is perpendicular to the longitudinal axis of the elongate body member. In this embodiment, the suturing instrument may include a first pivot control lever disposed opposite the distal portion of the elongate body member, and a pivot wire rotatably disposed in the elongate body member and coupled to the distal portion. The first pivot control lever may be coupled to the pivot wire for controlling pivoting of the distal portion.

In yet another embodiment according to the first aspect of the invention, the distal portion includes a first beveled surface for contacting the middle portion and the middle portion includes a second beveled surface for contacting the distal portion. According to one feature of this embodiment, a first angle defined by the first beveled surface and a second angle defined the second beveled surface are substantially equal. The sum of the angles may substantially equal  $90^\circ$ . According to another feature, the elongate body member includes a first resilient member for biasing the distal portion towards the middle portion along a longitudinal axis of the elongate member. The suturing instrument of this embodiment may also include a deflection control mechanism coupled to the distal portion for deflecting the distal portion

at the predetermined angle relative to the middle portion by rotating the distal portion about a longitudinal axis of the elongate body member.

In still another embodiment according to the first aspect of the invention, the elongate body member includes a locking mechanism for securing the distal portion at the predetermined angle relative to the middle portion. The locking mechanism may include a first plurality of teeth disposed on the first beveled surface and a second plurality of teeth disposed on the second beveled surface that are configured to mesh with the first plurality of teeth. Alternatively, the locking mechanism may include a plurality of detents that are defined by the first beveled surface and are circumferentially disposed about the first beveled surface; and a ball disposed in the second beveled surface and dimensioned to fit at least one of the plurality of detents. In this feature, the second beveled surface may define an aperture for receiving the ball therein. Also, a second resilient member may be disposed in the aperture for biasing the ball into engagement with the at least one of the plurality of detents.

In yet another embodiment according to the first aspect of the invention, the needle deployment mechanism includes a needle carrier that is disposed at least partially within the distal portion of the elongate body member and is slidably movable out of the distal portion. The needle deployment mechanism optionally includes an actuator coupled to the needle carrier and disposed opposite the distal portion. The actuator may be at least partially housed by a handle disposed opposite the distal portion.

The invention is also related generally to a method for placing sutures in tissue. The method includes the step of providing a suturing instrument having an elongate body member that includes a middle portion and a distal portion extending distally from the middle portion and deflectable at a predetermined angle relative to the middle portion; and a needle deployment mechanism disposed at least partially within the elongate body member and connectable to a needle for moving the needle out of the distal portion. The method further includes the steps of disposing a needle within the distal portion; disposing the suturing instrument in a body; deflecting the distal portion of the suturing instrument thereby positioning the distal portion proximal to the tissue; and actuating the needle deployment mechanism thereby moving the needle out of the distal portion and through the tissue.

In general, in a second aspect, the invention features a suturing instrument that includes an elongate body member having a longitudinal axis. The elongate body member has a distal portion that is pivotable about at least one axis that is substantially perpendicular to the longitudinal axis of the elongate body member. The suturing instrument also includes a needle deployment mechanism disposed at least partially within the elongate body member. The needle deployment mechanism is connectable to a needle for moving the needle out of the distal portion. Also, the elongate body member may include a handle disposed opposite the distal portion.

In one embodiment according to the second aspect of the invention, the suturing instrument also includes a pivot control lever disposed opposite the distal portion of the elongate body member for controlling pivoting of the distal portion. In a first version of this embodiment, the suturing instrument includes a pivot mechanism disposed in the elongate body member and coupled to the distal portion. The pivot control lever may be coupled to the pivot mechanism for controlling pivoting of the distal portion. In a second

version of this embodiment, the elongate body member may include an inner portion coupled to the distal portion, and an outer portion coupled to the pivot control lever and slidably disposed at least partially along the inner portion. According to one feature, the suturing instrument also has a linkage coupled to the outer portion and the distal portion. The linkage is configured to cause the distal portion to pivot about the first axis when the outer portion is displaced relative to the inner portion. According to another feature, the suturing instrument also includes a resilient member for biasing the outer portion towards the proximal portion of the elongate body member.

Further, in various features of the needle deployment mechanism of this embodiment of the suturing instrument, the needle deployment mechanism includes a needle carrier that is disposed at least partially within the distal portion of the elongate body member and is slidably movable out of the distal portion.

According to one particular feature of the second version of this embodiment, the needle deployment mechanism also has a resilient loop of material disposed at least partially within the elongate body member and coupled to the needle carrier. The needle deployment mechanism also includes an actuator that is coupled to the needle carrier via the resilient loop of material to move the needle carrier of the distal portion. The actuator may be at least partially housed by the handle.

According to another feature, the needle deployment mechanism also includes a needle carrier control rod that is slidably disposed at least partially within the elongate body member and coupled to the needle carrier. The needle carrier control rod may optionally be made of a superelastic material, such as a nickel-titanium alloy. The needle carrier control rod is configured to move the needle carrier when the needle carrier control rod is slidably advanced. The needle deployment mechanism may include an actuator coupled to the needle carrier control rod to advance the needle carrier control rod. The actuator is disposed opposite the distal portion of the elongate member, for example, at least partially housed by the handle.

According to yet another feature of the second version of this embodiment, the needle deployment mechanism also includes a camshaft disposed within the distal portion of the elongate body member and coupled to the needle carrier and a drum rotatably disposed within the distal portion of the elongate body member and coupled to the camshaft for moving the camshaft when the drum rotates. The needle deployment mechanism according to this feature further includes a push wire slidably disposed within the elongate body member and having a distal end coupled to the drum for causing the drum to rotate. The needle deployment mechanism may also include an actuator coupled to a proximal end of the push wire for advancing the push wire. The actuator is disposed opposite the distal portion of the elongate member, for example, at least partially housed by the handle.

In another embodiment according to the second aspect of the invention, the distal portion of the suturing instrument includes a first gear that is rotatable about a first axis substantially perpendicular to the longitudinal axis of the elongate body member. According to one feature of this embodiment, a middle portion of the elongate body member includes a second gear rotatable about the longitudinal axis and meshed with the first gear. According to this feature, the distal portion pivots about the first axis when the second gear rotates about the longitudinal axis. Optionally, the suturing

instrument includes a pivot control mechanism disposed at least partially within the middle portion and coupled to the second gear for causing the second gear to rotate about the longitudinal axis, a pivot control lever disposed opposite the distal portion of the elongate body member and coupled to the pivot control mechanism for controlling pivoting of the distal portion.

In yet another embodiment according to the second aspect of the invention, the distal portion is rotatable about the longitudinal axis of the elongate body member. In this embodiment, the suturing instrument may include a rotation control mechanism disposed opposite the distal portion of the elongate body member, and a rotation rod rotatably disposed in the elongate body member and coupled to the distal portion. The rotation control mechanism may be coupled to the rotation rod for controlling rotation of the distal portion.

In general, in a third aspect, the invention features a suturing instrument for use with an endoscope. The suturing instrument according to this aspect of the invention includes an elongate body member having a flexible tubular member and a distal portion attached to a distal end of the flexible tubular member. The flexible tubular member is dimensioned to slidably and rotationally fit within a working channel of an endoscope. The suturing instrument according to this aspect of the invention also includes a needle deployment mechanism disposed at least partially within the elongate body member and connectable to a needle for moving the needle out of the distal portion.

In one embodiment according to the third aspect of the invention, the needle deployment mechanism includes a needle carrier that is disposed at least partially within the distal portion of the elongate body member and is slidably movable out of the distal portion; a carrier drive wire slidably disposed within a lumen defined by the flexible tubular member and coupled to the needle carrier; and an actuator coupled to the carrier drive wire. According to one feature of this embodiment, the elongate body member may include a proximal portion including a handle at least partially housing the actuator. The tubular member may be releasably attached to the proximal portion. Optionally, the distal portion is rotatable about a longitudinal axis of the elongate body member relative to the proximal portion. The suturing instrument may also include a rotation control mechanism disposed in the proximal portion of the elongate body member for controlling rotation of the distal portion. Also, according to this feature, the proximal portion includes a carrier drive wire socket releasably coupled to the proximal portion for receiving the carrier drive wire. The proximal portion may also include a locking socket that is rotationally and releasably coupled to the carrier drive wire socket and serves to secure a proximal end of the tubular member. Further, the proximal portion may also include a scope adapter for securing the proximal portion to the working channel of the endoscope.

In another embodiment according to the third aspect of the invention, the distal portion of the elongate body member is pivotable about a first axis, which is substantially perpendicular to a longitudinal axis of the elongate body member.

Also, the invention features a method for placing sutures in tissue. The method includes the step of providing an endoscope defining a working channel through. The working channel of the endoscope has an opening at a distal end of the endoscope. The method further includes the step of providing a suturing instrument that includes an elongate

body member having a flexible tubular member with a distal end and a proximal end; the flexible tubular member dimensioned to slidably and rotationally fit within the working channel of the endoscope, and a distal portion attached to the distal end of the flexible tubular member. The suturing instrument also includes a needle deployment mechanism disposed at least partially within the elongate body member and connectable to a needle for moving the needle out of the distal portion. The method also includes the steps of inserting the proximal end of the flexible tubular member into the opening; passing the flexible tubular member through the working channel of the endoscope, disposing a needle within the distal portion, disposing the endoscope within a body, positioning the distal portion proximal to the tissue, and actuating the needle deployment mechanism thereby moving the needle out of the distal portion and through the tissue.

In various embodiments according to the foregoing aspects of the invention, the suturing instrument includes a needle disposed within the distal portion. Also, the distal portion of the suturing instrument of claim may include a needle catch configured to receive a needle, the needle catch defining a retention slot including at least two flexible edges.

In general, in a fourth aspect, the invention features a suturing instrument that includes an elongate body member having a distal portion. The distal portion includes a needle catch defining an aperture. The suturing instrument according to this aspect of the invention includes a needle deployment mechanism disposed at least partially within the elongate body member for moving a needle out of the distal portion and to the needle catch as well as a needle reloading mechanism disposed at least partially within the elongate body member for pushing the needle into the aperture of the needle catch. The needle catch is optionally slidably movable along a longitudinal axis of the elongate body member.

In one embodiment according to the fourth aspect of the invention, the needle deployment mechanism includes a needle carrier that is disposed at least partially within the distal portion of the elongate body member and is slidably movable out of the distal portion. The needle deployment mechanism also includes an actuator that is coupled to the needle carrier and disposed opposite the distal portion of the elongate body member. The needle carrier has a distal end that, optionally, defines a lumen for receiving the needle therein.

In another embodiment according to the fourth aspect of the invention, the needle reloading mechanism includes a pusher rod and a rod actuator for moving the pusher rod towards the distal portion of the elongate body member. According to one feature of this embodiment, the rod actuator is disposed opposite the distal portion of the elongate body member substantially perpendicularly to the pusher rod. According to another feature, the pusher rod comprises a substantially concave distal end. Also, according to yet another feature, the needle reloading mechanism has a hook coupled to a resilient member for biasing the pusher rod away from the distal portion of the elongate body member.

In still another embodiment according to the fourth aspect of the invention, the needle catch defines a retention slot including at least two flexible edges for retaining the needle therein, the retention slot in communication with the aperture. At least one of the flexible edges may have at least one protrusion extending into the retention slot. According to another feature of this embodiment, the suturing instrument includes a needle disposed within the distal portion. The

needle has a suture attached thereto and is releasable from the needle catch by pulling on the free end of the suture after the needle reloading mechanism pushes the needle into the aperture.

In yet another embodiment according to the fourth aspect of the invention, the suturing instrument also includes a handle disposed opposite the distal portion of the elongate body member, which at least partially houses the needle deployment mechanism and the needle reloading mechanism.

In general, in a fifth aspect, the invention features a suturing instrument that includes an elongate body member having a distal portion. The distal portion includes a first operative portion and a second operative portion. The suturing instrument also includes a needle deployment mechanism that is disposed at least partially within the elongate body member and includes a first needle carrier disposed at least partially within the first operative portion and connectable to a first needle for moving the first needle out of the first operative portion, and a second needle carrier disposed at least partially within the second operative portion and connectable to a second needle for moving the second needle out of the second operative portion.

In a first embodiment according to the fifth aspect of the invention, the suturing instrument includes a handle that is disposed opposite the distal portion of the elongate body member and at least partially houses the needle deployment mechanism.

In a second embodiment according to the fifth aspect of the invention, the first operative portion and the second operative portion of the distal portion form a unitary operative portion.

In a third embodiment according to the fifth aspect of the invention, the suturing instrument includes an actuator coupled to the first needle carrier and the second needle carrier and disposed opposite the distal portion of the elongate body member. According to one feature of this embodiment, the actuator includes a first sub-actuator coupled to the first needle carrier and a second sub-actuator coupled to the second needle carrier. The first needle carrier and the second needle carrier are actuatable either sequentially or simultaneously.

In a fourth embodiment according to the fifth aspect of the invention, the suturing instrument includes a first needle disposed within the first operative portion, and a second needle disposed within the second operative portion. According to one feature of this embodiment of the suturing instrument, a first suture is attached to the first needle and a second suture is attached to the second needle. According to another feature of this embodiment, the suturing instrument includes a suture having a first end attached to the first needle and a second end attached to the second needle.

In a fifth embodiment according to the fifth aspect of the invention, the distal portion of the suturing instrument includes a first needle catch configured to receive a first needle; and a second needle catch configured to receive a second needle. Optionally, the first needle catch and the second needle catch form a unitary needle catch. At least one of the first needle catch and the second needle catch may define a retention slot including at least two flexible edges.

In a sixth embodiment according to the fifth aspect of the invention, the first operative portion of the distal portion defines a first needle port and the second operative portion of the distal portion defines a second needle port. In this embodiment, the distance between the first needle exit port and second needle exit port is laterally adjustable by deflect-

ing at least one of the first operative portion and the second operative portion outwardly from the elongate body member. According to one feature of this embodiment, the suturing instrument includes a deflecting mechanism for adjusting the distance between the first needle exit port and the second needle exit port. A deflection actuator disposed opposite the distal portion of the elongate body member may be included for actuating the deflecting mechanism. The deflecting mechanism may include, for example, a wedge, a cam, an elbow linkage, a rotational separator, and a track-and-follower assembly.

Lastly, in general, in a sixth aspect, the invention features a suturing instrument that includes an elongate body member having a distal portion. The distal portion includes a needle catch. The suturing instrument also includes a cartridge that is disposed at least partially within the distal portion and houses a first needle and a second needle, as well as a needle deployment mechanism that is disposed at least partially within the elongate body member and is connectable sequentially to the first needle and the second needle for moving the first needle and then the second needle from the cartridge out of the distal portion to the needle catch. The cartridge may be removable from the distal portion of the elongate body member or integrally formed within the distal portion. Also, the distal portion of the elongate body member is optionally rotatable relative to a remainder of the elongate body member.

Further, in one embodiment of the sixth aspect of the invention, the needle deployment mechanism includes a needle carrier that is disposed at least partially within the distal portion of the elongate body member and is slidably movable out of the distal portion and an actuator coupled to the needle carrier and disposed opposite the distal portion of the elongate body member.

In another embodiment of the sixth aspect of the invention, the cartridge defines an exit aperture for receiving at least one of the first needle and the second needle. According to one feature of this embodiment, the cartridge further defines a loading slot connected to the exit aperture. At least one of the first needle and the second needle can be received in the loading slot. The second needle transitions from the needle loading slot to the exit aperture after the first needle is deployed from the cartridge. In one version of this feature, the suturing instrument includes a pusher for transitioning the second needle from the needle loading slot to the exit aperture after the first needle is deployed from the cartridge through the opening. Optionally, the pusher includes a push plate for contacting the second needle and a resilient member for biasing the push plate towards the exit aperture. In another version of this feature, the suturing instrument includes a suture having one end attached to the second needle, so that the second needle is transitioned from the loading slot to the exit aperture after the first needle is deployed from the cartridge by pulling on the free end of the suture. The suturing instrument may also include a means for pulling the free end of the suture optionally attached to the elongate body member and disposed opposite the distal portion thereof, such as, for example, a spool or a lever.

In yet another embodiment of the sixth aspect of the invention, the cartridge also contains a third needle. In this embodiment, the needle deployment mechanism is connectable sequentially to the first needle and the second needle and the third needle for moving the first needle and then the second needle and then the third needle from the cartridge out of the distal portion to the needle catch.

In still another embodiment of the sixth aspect of the invention, the suturing instrument includes a handle that is

disposed opposite the distal portion of the elongate body member and at least partially houses the needle deployment mechanism.

The invention also features a method for placing sutures in multiple tissue sites. The method includes the step of providing a suturing instrument having an elongate body member with a distal portion. The distal portion of the suturing instrument includes a needle catch. The suturing instrument also has a cartridge disposed at least partially within the distal portion. The cartridge includes a first needle disposed within the cartridge and a second needle disposed within the cartridge. Also, the suturing instrument includes a needle deployment mechanism disposed at least partially within the elongate body member and connectable sequentially to the first needle and the second needle. The method of the invention further contemplates the steps of disposing the suturing instrument in a body, positioning the distal portion proximal to a first tissue site in the body, actuating the needle deployment mechanism thereby moving the first needle out of the cartridge to the needle catch, positioning the distal portion proximal to a second tissue site in the body without withdrawing the suturing instrument from the body, moving the second needle in the cartridge, and actuating the needle deployment mechanism thereby moving the second needle out of the cartridge to the needle catch.

In various embodiments according to the foregoing aspects of the invention, the elongate body member is adapted to access remote organs or tissue within a body. Also, the suturing instrument disclosed above may include one, two, or more bends.

Advantages and features of the present invention herein disclosed will become apparent through reference to the following description, the accompanying drawings, and the claims. Furthermore, it is to be understood that the features of the various embodiments described herein are not mutually exclusive and can exist in various combinations and permutations.

#### BRIEF DESCRIPTION OF THE DRAWINGS

In the drawings, like reference characters generally refer to the same parts throughout the different views. Also, the drawings are not necessarily to scale, emphasis instead generally being placed upon illustrating the principles of the invention. In the following description, various embodiments of the present invention are described with reference to the following drawings, in which:

FIG. 1A is a schematic plan view of one embodiment of a suturing instrument in accordance with the invention;

FIG. 1B is a schematic cross-sectional view of a proximal portion of the suturing instrument of FIG. 1A;

FIG. 1C is a schematic cross-sectional view of a distal portion of the suturing instrument of FIG. 1A;

FIG. 2A is a schematic plan view of a needle coupled to a suture for use in a suturing instrument in accordance with the invention;

FIG. 2B is a schematic perspective view of a needle catch for use with the suturing instrument of FIG. 1A;

FIG. 3A is a schematic perspective view of a distal portion of a suturing instrument including a multi-load needle cartridge in accordance with the invention;

FIG. 3B is an enlarged cross-sectional view of the suturing instrument of FIG. 3A;

FIG. 4A is a schematic perspective view of a distal portion of a multi-needle suturing instrument in accordance with the invention;

FIG. 4B is a schematic perspective view of an alternative multi-needle suturing instrument having two operative portions in accordance with the invention;

FIG. 4C is an enlarged schematic perspective view of the operative portions of the suturing instrument of FIG. 4B in an aligned position;

FIG. 4D is an enlarged schematic perspective view of the operative portions of the suturing instrument of FIG. 4B in a spread position;

FIG. 4E is a schematic perspective view of a single suture placement in tissue;

FIG. 4F is a schematic perspective view of a double suture placement in tissue;

FIG. 5A is a schematic cross-sectional perspective view of a distal portion of a suturing instrument including a needle reloading mechanism in accordance with the invention;

FIG. 5B is a schematic perspective view of a pusher rod for use with the suturing instrument of FIG. 5A;

FIG. 5C is a schematic cross-sectional perspective view of a proximal portion of the suturing instrument of FIG. 5A;

FIGS. 5D–5F are schematic plan views of the needle reloading mechanism of the suturing instrument of FIGS. 5A–5C in operation;

FIG. 5G is a schematic cross-sectional view of a modified handle for use with the suturing instrument of FIGS. 5A–5C;

FIG. 5H is a schematic plan view of a modified elongate body member for use with the suturing instrument of FIGS. 5A–5C;

FIG. 6A is a schematic perspective view of one embodiment of a suturing instrument having a deflectable and pivotable distal portion in accordance with the invention;

FIG. 6B is an enlarged schematic perspective view of the deflectable distal portion of the suturing instrument of FIG. 6A;

FIG. 6C is a schematic perspective view of the proximal portion of the suturing instrument of FIG. 6A;

FIG. 6D is a schematic perspective view of the deflection and rotation mechanisms of the suturing instrument of FIG. 6A;

FIG. 6E is a schematic perspective view of an alternative embodiment of a suturing instrument having a deflectable distal portion;

FIGS. 6F–6H are schematic perspective views of the deflectable distal portion of the suturing instrument of FIG. 6E in different positions;

FIG. 6I is a schematic cross-sectional view of the suturing instrument of FIG. 6E;

FIG. 6J is a schematic cross-sectional view of one embodiment of a locking mechanism for use with a suturing instrument in accordance with the invention;

FIG. 6K is a schematic cross-sectional view of an alternative embodiment of the locking mechanism of FIG. 6J;

FIG. 7A is a schematic perspective view of a suturing instrument having a distal portion that is pivotable about one axis in accordance with the invention;

FIGS. 7B and 7C are enlarged schematic perspective views of the pivotable distal portion of the suturing instrument of FIG. 7A;

FIG. 7D is a schematic perspective view of a suturing instrument including a distal portion that is pivotable about two axes in accordance with the invention;

FIGS. 7E–7H are enlarged schematic perspective views of the distal portion of the suturing instrument of FIG. 7D;

FIGS. 8A–8C are schematic plan views of a suturing instrument including an alternative embodiment of a pivotable distal portion in accordance with the invention;

FIG. 8D is an enlarged schematic view of the distal portion of the suturing instrument of FIG. 8A;

FIG. 8E is an enlarged schematic cross-sectional view of the distal portion of the suturing instrument of FIG. 8C;

FIG. 9A is a schematic plan view of a suturing instrument including an alternative embodiment of a pivotable distal portion of a suturing instrument in accordance with the invention;

FIG. 9B is an enlarged schematic partial cross-sectional view of the distal portion of the suturing instrument of FIG. 9A;

FIG. 9C is an enlarged schematic partial cross-sectional view of the distal portion of the suturing instrument of FIG. 9A in a pivoted position;

FIG. 10A is a schematic cross-sectional view of an alternative embodiment of a pivotable distal portion of a suturing instrument in accordance with the invention;

FIG. 10B is a schematic cross-sectional view of the pivotable distal portion of FIG. 10A in a pivoted position;

FIG. 11A is a schematic cross-sectional view of an alternative embodiment of a pivotable distal portion of a suturing instrument including a drum-and-camshaft needle deployment mechanism in accordance with the invention;

FIG. 11B is a schematic cross-sectional view of the distal portion of the suturing instrument of FIG. 11A with a needle deployment mechanism in a deployed position;

FIG. 12A is a schematic perspective view of a suturing instrument configured for use with an endoscope in accordance with the invention;

FIG. 12B is a schematic perspective view of a distal portion of the suturing instrument of FIG. 12A attached to a sheath having a carrier drive wire disposed therein; and

FIG. 12C is a schematic perspective view of a pivotable distal portion of the suturing instrument of FIG. 12A.

#### DESCRIPTION

Referring to FIG. 1A, in one embodiment, a suturing instrument 100 includes a handle 102, an elongate body member 104, and a needle deployment mechanism 110 disposed within the elongate body member 104 and the handle 102. The suturing instrument 100 also includes a distal portion 106 and a proximal portion 108. The elongate body member 104 is mechanically coupled to the handle 102 at the proximal portion 108 and the suturing components are at least partially disposed within the distal portion 106 of the suturing instrument 100.

The handle 102 can take a variety of forms, for example, the handle 102 could be one of the types compatible with suturing systems available from Boston Scientific Corporation of Natick, Mass., in particular with the Capiro® Push & Catch suturing system. A suture clip 144 may be coupled to the handle 102 or the elongate body member 104 and used to hold an end of one or more sutures 136 prior to placement in a patient. Generally, the needle deployment mechanism 110 extends longitudinally through the elongate body member 104 to the distal portion 106 of the suturing instrument 100, where the needle deployment mechanism 110 is coupled to a needle 128 (shown in FIG. 2A). The needle deployment mechanism 110 moves the needle 128 between a retracted position and a deployed position. One possible needle deployment mechanism 110 is shown in greater detail in FIGS. 1B and 1C.

Referring to FIG. 1B, in one embodiment, the proximal portion 108 of the suturing instrument 100 includes the handle 102, the elongate body member 104, the suture clip 144, and the needle deployment mechanism 110. The needle deployment mechanism 110 includes an actuator button 117 and a shaft 116 that together form an actuator 112. The needle deployment mechanism 110 also includes a bearing 118 and a button end 119 that defines a hole 121 formed therein. The hole 121 is preferably formed along the central longitudinal axis of the button end 119. The bearing 118 rides along the surface of a lumen 105 that is defined by the inside diameter of the elongate body member 104. A wire-form 103 is inserted into the hole 121 of the button end 119, so that the wireform 103 is coupled to the actuator button 117. A spring 115 encircles the wireform 103, abuts the button end 119, and is compressed between the button end 119 and a spring washer 113. The spring washer 113 is seated upon a center tube 107. The center tube 107 is housed by the lumen 105 and is constrained in the distal portion 106. A pusher wire 111 is attached to the wireform 103 by means of a weld, a coupling, adhesive, or other means, and is slidably disposed within a guidance sleeve 109, the sleeve 109 being disposed within the surface of a lumen 123 defined by the inside diameter of the center tube 107.

In one embodiment, the pusher wire 111 is constructed of an elastic material having “superelastic” properties. Such a material may include alloys of In—Ti, Fe—Mn, Ni—Ti, Ag—Cd, Au—Cd, Au—Cu, Cu—Al—Ni, Cu—Au—Zn, Cu—Zn, Cu—Zn—Al, Cu—Zn—Sn, Cu—Zn—Xe, Fe<sub>3</sub>Be, Fe<sub>3</sub>Pt, Ni—Ti—V, Fe—Ni—Ti—Co, and Cu—Sn. In the illustrative embodiment, the superelastic material is a nickel and titanium alloy, commonly known as Nitinol® available from Memry Corp of Brookfield, Conn. or SMA Inc. of San Jose, Calif., so chosen for its combination of properties that allow for bendability and high column strength when constrained. The ratio of nickel and titanium in Nitinol® may vary. One preferred example includes a ratio of about 50% to about 56% nickel by weight. Nitinol® also possesses shape retention properties.

Referring to FIG. 1C, the distal portion 106 of the elongate body member 104 includes the distal components of the needle deployment mechanism 110 (described in detail below), an operative portion 126, and a needle catch 122. In one embodiment, the operative portion 126 has an arcuate shape and partially encircles a suturing field 176. The operative portion 126 also defines a lumen 178 therein having a needle exit port 120 at an opening into the suturing field 176. A needle 128 is disposed in the needle exit port 120 and is held in place by a slight friction fit. In one embodiment, the suture 136 is attached to the needle 128. The free end of the suture 136 extends out of a suture slot 146.

Referring again to the needle deployment mechanism 110, the pusher wire 111 is attached by welding or other means to a coupling 150, which is slidably disposed within a track 152. The coupling 150 is attached to a carrier wire 154, which, by virtue of its attachment to the coupling 150, is also slidably disposed within the track 152. The coupling 150 abuts a backstop washer 156 that is slidably disposed about the pusher wire 111 and is contained within a pocket 160 that includes a back wall 162, against which the backstop washer 156 rests. The track 152 terminates distally in a pocket 164 that includes a wall 166. A downstop washer 158 is slidably disposed about the carrier wire 154 and constrained within the pocket 164.

The carrier wire 154 is mechanically coupled to an extendable needle carrier 124 by welding, coupling, use of

adhesives, or by other means. The needle carrier **124** is slidably disposed in the lumen **178** of the operative portion **126** and has a lumen **125** formed at a distal end of the needle carrier **124**. The lumen **125** is dimensioned to releasably receive the non-penetrating end of the needle **128**. The needle carrier **124** is configured to push the needle **128** out of the needle exit port **120** through tissue proximate the suturing field **176**, and into the needle catch **122**, as will be described in further detail below. In one embodiment, the needle **128** is held within the lumen **125** by a slight friction fit.

FIG. 2A depicts one embodiment of the needle **128** for use in a suturing instrument in accordance with the invention. In this embodiment, the needle **128** includes a penetrating tip **130** and a shaft **134** coupled to the tip **130**, thereby forming a shoulder **132**. The shaft **134** is coupled to the suture **136**. Other configurations of the needle **128** can also be used without deviating from the scope of the invention. As shown in FIG. 1C, in one embodiment, when the needle **128** is disposed in the needle exit port **120**, the free end of the suture **136** extends out of a needle carrier suture slot **148** and the suture slot **146**.

Referring to FIG. 2B, the needle catch **122** includes openings **170** defined by successive ribs **172**. When the needle catch **122** receives the needle **128** coupled to the suture **136** through opening **170**, the ribs **172** deflect slightly to allow the needle **128** to pass through. After the shoulder **132** has passed the ribs **172**, the ribs **172** spring back to their original position defining the openings **170**, and the needle **128** remains captured in the needle catch **122**. The openings **170** are chosen to be smaller in dimension than the shoulder **132**. This causes the needle catch **122** to retain the needle **128**, because the flat rear surface of the shoulder **132** prevents the needle **128** from passing back through the opening **170**. When it is necessary to remove the needle **128** from the needle catch **122**, the needle **128** may be moved toward an enlarged portion **174** of the opening **170**. The enlarged portion **174** is sized to allow the shoulder **132** to pass through without resistance. The needle catch **122** may be constructed of thin stainless steel of high temper, such as ANSI 301 full hard. The needle catch **122** may be fabricated by means of stamping, laser machining, or chemical etching.

Referring again to FIGS. 1A–1C and 2A–2B, in operation, a user (such as a physician or other medical personnel) actuates the needle deployment mechanism **110** by pushing on the button **117**, which, via the attachment to the wireform **103**, is attached to the pusher wire **111**, moves the coupling **150** along the track **152** concomitantly moving the carrier wire **154**, which in turn slidably moves the needle carrier **124** through the lumen **178** towards the needle exit port **120**. The user continues to push the button **117** until the needle carrier **124** receives the needle **128** in the lumen **125**, and further until the needle **128** penetrates tissue proximate the suturing area **176** and then enters and is retained in the needle catch **122**. Then, the user releases the button **117** and the spring **115** urges the button **117** proximally, thereby moving the pusher wire **111**, the coupling **150**, the carrier wire **154**, and the needle carrier **124** proximally along with the button **117** to the retracted position. As the needle carrier **124** moves back to the retracted position, the needle **128** slides out of the lumen **125** and the needle is released from the needle carrier **124**.

In one embodiment, after one or more sutures **136** have been placed, the user withdraws the suturing instrument **100** from the patient. The user then detaches one or more sutures **136** from one or more needles **128** and ties a knot or knots in the sutures **136**. The user can then use a knot pusher **184** to push one or more knots into the patient as the knots are tightened.

The suturing instrument's component materials should be biocompatible. For example, the handle **102**, the elongate body member **104**, and portions of the needle deployment mechanism **110** may be fabricated from extruded, molded, or machined plastic material(s), such as polypropylene, polyethylene, polycarbonate, or glass-filled polycarbonate. Other components, for example the needle **128**, may be made of stainless steel. Other suitable materials will be apparent to those skilled in the art. The material(s) used to form the suture should be biocompatible. The surgeon will select the length, diameter, and characteristics of the suture to suit a particular application. Additionally, the mechanical components and operation are similar in nature to those disclosed in U.S. Pat. Nos. 5,364,408 and 6,048,351, and commonly owned U.S. patent application Ser. No. 10/210,984, each of which is incorporated by reference herein in its entirety.

FIGS. 3A and 3B depict two embodiments of a suturing instrument having a multi-load cartridge **140** in accordance with the invention. Such a suturing instrument advantageously allows the user to place multiple sutures without removing the suturing instrument from the surgical site. According to both embodiments, the suturing instrument **100** includes the cartridge **140** that houses two or more needles **128** disposed therein. Referring to FIG. 3A, the cartridge **140** is integrally formed within the distal portion **106**. In this embodiment, the distal portion **106** defines a sidewall access opening **141** to allow the user to load one or more needles **128** into the cartridge **140**. Referring to FIG. 3B, the cartridge **140** is either integrally formed or removably disposed at a distal end **142** of the operative portion **126**. Having a removable cartridge allows the user to choose a cartridge having a specific number of needles for a specific application. Also, the suturing instrument **100** may be reusable with different needle cartridges.

Referring still to FIG. 3B, the multi-load needle cartridge **140** defines an exit aperture **145** and a needle loading slot **147**. The multi-load needle cartridge **140** is designed to hold essentially any number of needles, for example, 2–20 needles. The multi-load needle cartridge **140** is preloaded and capable of feeding the needle and suture assembly into the needle carrier **124**. In one embodiment, the cartridge **140** can be reloaded by the user in situ by adding needles **128** using, for example, the sidewall access opening **141** (FIG. 3A) or the exit port **120** (FIG. 3B). The multi-load needle cartridge **140** may include a push plate **196** and a spring **198** that biases the push plate **196** towards the exit aperture **145**.

Both embodiments operate in essentially the same manner, enabling a user to place multiple sutures **136** in a patient without removing the suturing instrument **100** from the surgical site. As described above, the preloaded multi-load needle cartridge **140** can include one or more needles **128** each with the suture **136** coupled thereto. Referring to FIG. 3B, in one embodiment, the needle cartridge **140** includes three needles **128a**, **128b**, **128c**. Sutures **136a**, **136b**, **136c** extend out of the suture slot **146**. Alternatively, the sutures **136** may run through the elongate body member **104**. The first needle **128a** is disposed in the exit aperture **145**, and the remaining needles **128b**, **128c** are disposed in the loading slot **147**.

The needle carrier **124**, which is part of the needle deployment mechanism **110**, is sequentially connectable to the needles **128** stored in the cartridge **140**. This means that each needle **128** stored in the needle cartridge **140** is connected to, and then deployed by, the needle carrier **124** one at a time in the order the needles **128** are dispensed from the needle cartridge **140**.

In operation, the user inserts the elongate body member **104** into a patient and orients the elongate body member **104** so that the tissue to be sutured is disposed proximate the suturing field **176** and the needle exit port **120** is proximate to or in contact with the tissue. The user then pushes the button **117** (FIG. 1B), as described above. Pushing the button **117** causes the needle carrier **124** to receive the needle **128a** in the lumen **125** and then to extend out of the needle exit port **120** and push the needle **128a** through the tissue. As the first needle **128a** is pushed through the tissue, the first needle **128a** pulls the first suture **136a** through the tissue. As the user continues to push the button **117**, the needle carrier **124** continues to advance out of the needle exit port **120** and directs the first needle **128a** and the first suture **136a** toward the needle catch **122**. The user continues to push the button **117** until the first needle **128a** contacts and becomes captured by the needle catch **122**. The user then retracts the needle carrier **124** by releasing the button **117**, as previously described.

After the user retracts the needle carrier **124**, the first needle **128a** and the first suture **136a** are left captured within the needle catch **122**, with the first suture **136a** extending through the tissue. When the needle carrier **124** returns to a fully retracted position, the spring **198** causes the needle push plate **196** to push the second needle **128b** into the exit aperture **145**. The needle **128b** is thereby forced through the loading slot **147** and either into the lumen **125** of the needle carrier **124** or in position to be captured by the needle carrier **124**. The second suture **136b** extends out of the suture slot **146**. The user then advances the needle carrier **124** as described above until the second needle **128b** is captured by the needle catch **122**. The user then retracts the needle carrier **124** as described above leaving the second needle **128b** and the second suture **136b** captured by the needle catch **122**. This procedure can be repeated for the third needle **128c**, or for as many needles as may be stored in the needle cartridge **140**. After one or more sutures **136** have been placed, the user withdraws the suturing instrument **100** from the patient. The user detaches the suture(s) **136** from the needle(s) **128** and ties a knot or knots in the suture(s) **136**. The user can then use the knot pusher **184** to push the knot(s) in the patient as the knot(s) is tightened.

Alternatively, other mechanisms could be used to advance the needle **128** from the needle cartridge **140** to the carrier **124**. In one embodiment, the needles **128** in the needle cartridge **140** are held in the loading slot **147** by a friction fit and are pushed into the exit aperture **145** when the needle push plate **196** is activated by the user. For example, instead of the spring **198**, a dispensing control rod coupled to a button on the handle **102** and the push plate **196** may be provided. Alternatively, a spring release mechanism coupled to the spring **198** and a button on the handle **102** may be provided to enable the user to release the spring **198** so that the push plate loads the needle **128** into the exit aperture **145** to be received in the lumen **125** of the needle carrier **124**. In another embodiment, the user may load the needle **128** into the exit aperture **145** by pulling the free end of the suture **136**. In yet another embodiment, the suturing instrument **100** may include a means for pulling the free end of the suture **136** such as, for example, a spool or a lever attached to the elongate body member and disposed, for example, on or within the handle **102**.

Referring to FIG. 4A, in another embodiment, the operative portion **126** of the distal portion **106** of the suturing instrument **100** includes a mechanism for deploying two or more needles **128**. The needles **128** can be deployed sequentially or simultaneously. The deployment mechanism

includes a separate needle carrier **124a**, **124b** for each needle **128**. The handle **102** can include one button **117** to advance both needles **128** or the handle **102** can include two buttons **117a**, **117b** to advance the needles **128** sequentially or simultaneously (if pressed at the same time). Passing two single armed needles into an incision site enables a user to place, for example, two ligating sutures simultaneously, withdrawing the device, and tying two knots. Ligating between the sutures is possible in a shorter time-frame.

In operation, this embodiment functions largely the same way as the embodiments previously described. For simultaneous advancement, the user advances the needle carriers **124** by pressing the button(s) **117** (FIG. 1A) until the needles **128** are driven through the tissue and captured by the needle catch **122**. After the needles **128** are captured in the needle catch **122**, the needle carriers **124** are retracted. For sequential advancement, the user advances one needle carrier **124a** by pressing one button **117a** until the first needle **128a** is driven through the tissue and captured by the needle catch **122**. The user then retracts the first needle carrier **124a**. The user then advances the second needle carrier **124b** by pressing the second button **117b** until the second needle **128b** is driven through the tissue and captured by the needle catch **122**. The user then retracts the second needle carrier **124b**.

Referring to FIGS. 4B–4D, in another embodiment, the distal portion **106** includes two separate operative portions **126a**, **126b** separated a wedge **200**. The operative portions **126a**, **126b** include the needle exit ports **120a**, **120b** that are deflectable or spreadable outward relative to the elongate member **104** to adjust the distance between the exit ports **120a**, **120b**. The user may control the amount of separation between the operative portions **126a**, **126b** and, therefore, the distance between the exit ports **120a**, **120b** with a control lever **202** in the handle **102**. Other mechanisms that can be used to deflect the operative portions **126a**, **126b** include, but are not limited to, a cam or link, an elbow linkage, a rotational separation along a longitudinal axis **350** of the device, a pre-made track and follower assembly, or a manual separator. In a particular embodiment, the user actuates the control lever **202**, thereby advancing the wedge **200** and widening the space between the two operative portions **126a**, **126b**.

One benefit of the embodiments depicted in FIGS. 4A–4D and described above is that spreading the operative portions **126a**, **126b** allows a user to create a controlled or predetermined distance between the needle carriers' tissue entrance points. This feature enables the placing of sutures **136** at different spacing sequences. In addition, these embodiments also provide a means to place a double-armed suture (a suture with a needle at each end) in a patient. Referring to FIGS. 4E and 4F, the needle deployment mechanism **110** generally functions the same way as previously described and can be used to place a single suture **136** coupled to two needles **128a**, **128b** through tissue **204** (FIG. 4E) or to place two sutures **136a**, **136b** coupled to two needles **128a**, **128b**, respectively (FIG. 4F) through tissue **204**. Referring to FIG. 4E, where a single suture **136** is attached to the two needles **128a**, **128b**, the suture **136** is placed perpendicularly to the longitudinal axis **350** of the suturing instrument. Referring to FIG. 4F, where separate sutures **136a**, **136b** are attached to each of the two needles **128a**, **128b**, the sutures **136a**, **136b** can be placed in essentially any orientation relative to the longitudinal axis **350** of the suturing instrument.

Referring to FIGS. 5A–5H, in yet another embodiment, the suturing instrument **100** is modified to allow the user to place a so-called "whip stitch," i.e., a continuous running



suture. Typically, the suturing instrument must be removed from the surgical site so the user may disengage the needle from the needle catch and either reload the existing needle into the needle carrier or load a new needle and suture into the instrument. In this embodiment, the user can remove the needle from the catch and reload the needle into the needle carrier without removing the suturing instrument **100**. This allows the user to place a running stitch. This embodiment may be combined with any number of the other embodiments described herein.

Generally, the instrument is used to secure tissue with a continuous running suture by passing the suture through tissue, catching the suture needle, ejecting the needle from the catch in situ, and reloading the needle into the carrier. The suturing instrument **100** essentially operates in the same manner as the other instruments described herein. The instrument is modified, however, to add a needle reloading mechanism **205** described in detail below that, when advanced, pushes the needle **128** along the needle catch **122** to an opening that permits the needle to be discharged from the catch **122**. The needle **128** can be discharged by, for example, pulling on the suture **136**. Continued pulling on the suture **136** can reposition the needle **128** into the end of the needle carrier **124**. The reloaded carrier **124** can then be advanced again, continuing suture placement through multiple tissue passes, resulting in a whip stitch.

FIG. 5A depicts the distal portion **106** of the suturing instrument **100**. The needle carrier **124** and needle catch **122** are disposed in the distal portion **106**. The needle catch **122** is similar to the catch described hereinabove with respect to FIG. 2B; however, the catch **122** is slightly modified to include two protrusions **210** disposed between the ribs of the center opening **213** to create a narrow portion in the opening **213**. The protrusions **210** prevent the needle **128** from moving to the larger opening, i.e., the needle reloading aperture **174**, in the catch **122** before the suturing instrument **100** is ready for reloading. In one embodiment, the needle catch **122** is slidably movable towards the needle exit port **120**.

FIG. 5B depicts a needle reloading mechanism **205**. The mechanism **205** includes a pusher rod **208** and an actuator **206**. The actuator **206** is generally perpendicularly disposed relative to the rod **208** and is attached to the rod **208** by, for example, welding or other attachment means. Additionally, the mechanism **205** includes a hook **211** that couples to a spring **207** located within the handle **102** (FIG. 5C). The spring **207** acts to return the mechanism **205** to its original position once the actuator **206** is released. In a particular embodiment, the mechanism **205** is slidably disposed within the suturing instrument **100**.

Referring to FIG. 5C, the proximal portion **101** of the suturing instrument **100** is modified compared to the embodiment shown in FIG. 1A. Specifically, the handle **102** is modified to house at least a portion of the mechanism **205**, as well as to include a slot **209** to house the actuator **206**.

FIGS. 5D–5F are enlarged partial views of the needle catch **122** and pusher rod **208**. As shown, the needle **128** is held within the center opening **213** of the catch **122** between two ribs or flexible edges **172**. The pusher rod **208** includes a concave distal end that at least partially surrounds the needle **128** when the rod **208** is advanced into contact with the needle **128** (FIG. 5E). The pusher rod **208** pushes the needle **128** along the center opening **213** to the larger opening **174**. The needle **128** is moved past the protrusions **210** by the force of the pusher rod **208**. The force causes the ribs **172** to spread slightly to allow the needle **128** to pass.

When the pusher rod **208** is fully advanced, the needle **128** will be positioned within the reloading aperture **174** (FIG. 5F). Alternatively, the needle **128** could be held within one of the lateral openings **215**, **217** in a catch **122** further modified to include protrusions **210** in the lateral openings **215**, **217**. The pusher mechanism **205** can also be modified to push a needle **128** held in one or both of the lateral openings **215**, **217**.

FIG. 5G depicts the modified handle **102**. As described hereinabove, the handle **102** includes the slot **209** for the actuator **206** and a void **217** for housing the proximal portion of the rod **208** and the spring **207** and hook **211**. While the actuator **206** described herein is slidably disposed within the handle **102**, other mechanical linkages are contemplated, for example, a push button and push wire assembly. The dimensions shown are for illustrative purposes only and are not meant to be limiting.

FIG. 5H depicts the modified elongate body member **104** compared to the embodiment depicted in FIG. 1A. The body member **104** is modified to house at least partially the pusher mechanism **205**, specifically the pusher rod **208**. The body member **104** includes a slot **219** that runs substantially the entire length of the body member **104**. The pusher rod **208** is slidably disposed within the slot **219**.

Operation of the instrument is described generally with reference to FIGS. 5A–5H. The basic operation is similar to that described hereinabove with reference to FIGS. 1A–1C, insofar as the user presses the button **117** thereby advancing the needle carrier **124** and pushing the needle **128** into the catch **122**. After the user drives the needle through the tissue **204** and into the catch **122**, the user positions the distal portion **106** of the suturing instrument **100** so that the tissue **204** is no longer in the surgical field **176**. During operation, the suture **136** is preferably maintained in tension. A free end of the suture **136** remains outside of the surgical site and accessible to the user. Next, the user advances the needle reloading mechanism **205** into contact with the needle **128** by pushing the actuator **206** distally. Once the pusher mechanism **205** is fully advanced, the needle **128** is positioned within the needle reloading aperture **174**. In this position, the free end of the suture **136** can be pulled to release the needle **128** from the catch **122** and, in turn, lead the needle **128** into the needle carrier. In addition, the needle carrier can be partially advanced to assist reloading of the needle **128** into the carrier. Also, the distal end of the needle carrier **124** can be modified to facilitate reloading. For example, the distal end of the carrier **124** and the lumen **125** could be enlarged to create a sufficient lead in for recapturing the needle **128**. Further, as described above, the needle catch **122** may be slidable distally to position the needle **128** close to the carrier **124** before releasing the needle **128**. After the needle **128** is recaptured in the lumen **125** of the needle carrier **124** and the needle carrier **124** is fully retracted into the operative portion **126**, the user maneuvers the suturing instrument **100** and/or the tissue **204** so that the tissue **204** is disposed again proximate the suturing field **176** and the exit port **120** is proximate to the next stitching position in the tissue **204**.

Referring to FIGS. 6A and 6B, in another embodiment, the suturing instrument **100** includes a distal portion **106** that is independently deflectable and/or pivotable relative to the elongate member **104**. Specifically, the distal portion **106** includes a deflectable portion **300** that connects the elongate body member **104** to the distal portion **106**. The distal portion **106** is deflectable relative to the elongate member **104** in the “A-P” and “I-S” directions. Also, the operative portion **126** of the distal portion **106** may be pivotable about

pivot nodes that define an axis 330 perpendicular to the longitudinal axis 350 of the elongate member 104. Alternatively, the operative portion 126 of the distal portion 106 may be pivotable about a pin 402 that is perpendicular to the longitudinal axis 350 of the elongate member 104 and defines the axis 330.

Referring to FIGS. 6C and 6D, movements of the distal portion 106 are controlled by one or more deflection control members 302, 306, and/or a pivot control lever 304 included in the proximal portion 108, for example, in the handle 102. The deflection control members 302 are coupled to a tension roller 315. The deflection control members 306 are coupled to a tension roller 311. Tension members 335 are connected to the tension rollers 311, 315, extend through the elongate member 104, and are coupled to a front portion 301a of a deflectable portion 300 for causing the distal portion 106 to deflect. The pivot control lever 304 is coupled to a pivot wire 334 that extends along the longitudinal axis 350 of the elongate member 104 and is coupled to the operative portion 126 of the distal portion 106 to cause it to pivot. The tension members 335 and the pivot wire 334 pass through a wire equalizer 313 disposed within the elongate body member 104 and are formed from, for example, stainless steel or Nitinol® alloy.

In operation, the user can pivot the operative portion 126 of the distal portion 106 about the axis 330 perpendicular to the longitudinal axis 350 of the elongate body member 104 by manipulating the pivot control lever 304 in the handle 102. The pivot control lever 304, when turned, causes the pivot wire 334 to pull or push the operative portion 126, thereby rotating it around the axis 330.

The deflection control members 302, 306 cause the tension rollers 311, 315 to turn when the deflection control members 302, 306 are turned, thereby causing the distal portion 106 to bend. Specifically, the user can bend the deflectable portion 300 of the distal portion 106 at its rear portion 301b up to +/-90 degrees (A-P direction) by manipulating the deflection control member 302, that causes the tension roller 315 to rotate and either tighten the tension member 335a and relax the tension member 335p, or tighten the tension member 335p and relax the tension member 335a. The user can also bend the deflectable portion 300 at its rear portion 301b up to +/-90 degrees (I-S direction) by manipulating the deflection control member 306, that causes the tension roller 311 to rotate and either tighten the tension member 335i and relax the tension member 335s, or tighten the tension member 335s and relax the tension member 335i.

Referring to FIGS. 6E-6H, in another embodiment, the suturing instrument 100 includes a distal portion 106 having a beveled surface 307a for contacting the elongate body member 104 and the elongate body member includes a beveled surface 307b for contacting the distal portion. According to one feature of this embodiment, the acute angle defined by the beveled surface 307a and the acute angle defined by the beveled surface 307b are substantially equal. In one embodiment, each of these angles substantially equals 45 degrees. The surfaces 307a, 307b are secured against each other by a spring 310 disposed in the elongate member 104. In an aligned position, the surfaces 307a, 307b are aligned such that the distal portion 106 and the elongate body member 104 combine to produce a shaft that is substantially linear. The handle 102 includes a deflection control lever or member 312 that is coupled to a first end of a rod 320 that extends through the elongate member 104. A second end of the rod 320 is coupled to the distal portion 106. When the user manipulates the deflection control lever 312, the distal portion 106 rotates and, by virtue of the

contacting beveled surfaces 307a, 307b, a rotation point 308 forms, thereby enabling suturing of tissue at any angle relative to the elongate body member's longitudinal axis 350 (or angles of surface contact).

In the embodiment shown in FIG. 6J, the suturing device 100 includes a locking mechanism that includes a ball 314 and a plurality of detents 316. The ball 314 is coupled to the beveled surface 307b of the elongate member 104 at a point radially outward from the longitudinal axis 350 of the distal portion 106. The ball 314 is positioned on the elongate member 104 to allow it to contact the beveled surface 307a of the distal portion 106. Each of the plurality of detents 316 may be disposed equally about the circumference about the beveled surface 307a of the distal portion 106. The circle of detents 314 may be centered on the longitudinal axis of the distal portion 106. Each detent 316 may have a radial distance from the longitudinal axis of the distal portion 106 equal to that of the ball 314. As the user deflects the distal portion 106 by manipulating the deflection control lever 312, the ball 314 moves out of one detent 316 and into another detent 316. The detents are spaced such that the distal portion rotates in a stepwise manner. Each step may be a fixed number of degrees of rotation. In another embodiment, the ball 314 is coupled to a spring 318 disposed in an aperture 321 formed in the beveled surface 307b. The spring 318 provides enough force to keep the ball 314 socketed in one of the detents when the user is not trying to change the angle of the distal portion 106 relative to the longitudinal axis 350 of the elongate body member 104. The spring 318 is, however, compressible such that the ball 314 is at least partially withdrawn into the aperture 321 and the user can easily change the angle of the distal portion 106 relative to the longitudinal axis 350 of the elongate body member 104 by moving the ball 314 from one detent 316a to another detent 316b.

In another embodiment, shown in FIG. 6K, the distal portion 106 and the elongate member 104 may include meshed teeth 319a, 319b that engage to lock the distal portion 106 and the elongate member 104 at a particular angle. In operation, the user pushes the distal portion 106 distally from the elongate member 104, so the beveled surfaces 307a, 307b do not contact each other and the teeth 319a, 319b no longer engage, and then deflects the distal portion 106 to a desired angle. Then, when the beveled surfaces 307a, 307b are brought into contact with each other, the teeth 319a, 319b engage or mesh to lock the distal portion 106 in place.

Referring to FIGS. 7A-7C, in another embodiment, the suturing instrument 100 includes a distal portion 106 that is independently pivotable about the axis 330 perpendicular to the longitudinal axis 350 of the elongate member 104 and rotatable about the longitudinal axis 350 of the elongate member 104. In one version of this embodiment, the degree of pivot is controlled by a pivot control lever 400 located on the handle 102 and coupled to a pivot control mechanism disposed within the elongate member 104. The pivot control mechanism is coupled to the distal portion 106. When the user manipulates the pivot control lever 400 slidably moving the pivot control mechanism within the elongate member 104, the distal portion 106 pivots about the pivot axis 330. This embodiment enables the suturing of tissue at angles up to 90 degrees from the longitudinal axis 350 of the elongate body member 104. The suturing instrument 100 also allows for removal from a 10 mm trocar without repositioning the distal portion 106.

Referring to FIGS. 7D-7H, in an alternative embodiment, the suturing instrument 100 includes a pivoting and rotating

distal portion 106. The suturing instrument 100 also includes a pivot control lever 504, a rotation control lever 506, and a needle deployment trigger 502. The user can pivot the distal portion 106 by manipulating the pivot control lever 504 on the handle 102. The distal end 106 can be pivoted to a position perpendicular to the tissue plane to be sutured. The internal operation of the pivoting mechanism is similar to embodiments discussed above. The user can also rotate the distal portion 106 by manipulating the rotation control lever 506 also disposed on the handle 102, that is coupled to a rotation mechanism, which, in turn, is coupled to the distal portion 106. The needle 128 is deployed by pulling the needle deployment trigger 502. The needle deployment mechanism operates similar to other embodiments previously described.

Referring to FIGS. 8A–8E, in another embodiment, the suturing instrument 100 includes a pivoting distal portion 106 and a pivot control lever 508. The elongate member 104 includes an outer portion 516 and an inner portion 518, and is coupled to the distal portion 106 at a pivot point 514 and via linkage 512 (FIG. 8D). The user controls the pivoting action by manipulating the pivot control lever 508, thereby causing the outer portion 516 to slide relative to the inner portion 518. Pushing the control lever 508 causes the outer portion 516 to push the linkage 512, which, in turn, pushes the distal portion 106. As the distal portion 106 is pushed by the linkage 512, the distal portion pivots about the pivot point 514. The distal portion 106 can pivot up to 90 degrees relative to the longitudinal axis 350 of the elongate body member 104. Pulling the control lever 508 causes the outer portion 516 to pull the linkage 512, which pulls the distal portion 106. As the distal portion 106 is pulled by the linkage 512, the distal portion 106 pivots about the pivot point 514 and returns to its original position. In one embodiment, the control lever 508 may be coupled to the outer portion 516 via a pin 509 or other attachment means. Alternatively, the control lever 508 is not coupled to the outer portion 516, but is pushed into contact with the outer portion 516 via, for example, the pin 509. Further, the outer portion 516 may be biased against the control lever 508 by a spring that causes the distal portion 106 to return to its starting position when the control lever 508 is released.

According to this embodiment of the invention, in one version, the needle deployment mechanism 110 includes a loop 510 for advancing the needle carrier 124. The loop 510 is formed from a resilient material, such as rubber. The loop 510 is coupled to the button 117 at the proximal end of the elongate member 104 and coupled to the needle carrier 124 at a distal end. In operation, the user presses the button 117, which causes the loop 510 to advance. As the loop 510 advances, the needle carrier 124, which is coupled to the loop 510, also advances until the needle 128 in the needle carrier 124 is captured by the needle catch 122. After the needle 128 is captured in the needle catch 122, the user releases the button 117 and the loop 510 retracts thereby causing the needle carrier 124 to also retract.

Referring to FIGS. 9A–9C, in another version of this embodiment, the needle deployment mechanism 110 in the distal portion 106 includes a first gear 520, a second gear 524, and a linkage 522. The linkage 522 is coupled to the first gear 520 and the needle carrier 124. In operation, the user manipulates the button 117, which causes the second gear 524 to turn. The second gear 524 engages the first gear 520, thereby causing the first gear 520 to turn and pivot the distal portion 106. As the first gear 520 turns, the linkage 522 moves and advances the needle carrier 124 until the needle 128 is captured by the needle catch 122. After the needle 128

is captured by the needle catch 122, the user releases the button 117 and the first gear 524 and the second gear 520 turn in the opposite direction causing the linkage 522 to retract the needle carrier 124.

Referring to FIGS. 10A and 10B, in yet another embodiment, the needle deployment mechanism in the distal portion 106 includes a superelastic pusher 602. A proximal end of the superelastic pusher 602 is coupled to the button 117 (shown in FIG. 1B) and a distal end of the superelastic pusher 602 is coupled to the needle carrier 124. In operation, the user pushes the button 117, which causes the superelastic pusher 602 to advance the needle carrier 124 until the needle 128 is captured in the needle catch 122. After the needle 128 is captured by the needle catch 122, the user releases the button 117 and the superelastic pusher 602 retracts the needle carrier 124. This embodiment operates similarly to the embodiment described with reference to FIGS. 1A–1C. The superelastic pusher can be formed from an elastic material having “superelastic” properties, such as Nitinol®.

Referring to FIGS. 11A and 11B, in another embodiment, the needle deployment mechanism in the distal portion 106 includes a drum 608 and a camshaft 604. The drum 608 is coupled to a distal end of a push wire. A proximal end of the push wire is coupled to the button 117. The drum 608 is also coupled to the camshaft 604 and the camshaft 604 is coupled to the needle carrier 124. In operation, the user pushes the button 117, which causes the push wire to rotate the drum 608. As the drum 608 rotates, the camshaft 604 moves and advances the needle carrier 124 until the needle 128 is captured in the needle catch 122. After the needle 128 is captured by the needle catch 122, the user releases the button 117 and the push wire rotates the drum 608 in the opposite direction, thereby causing the camshaft 604 to retract the needle carrier 124. The push wire can be formed from, for example, stainless steel or nickel-titanium alloy.

Referring to FIGS. 12A–12C, in still another embodiment, the suturing instrument 100 is configured to be used with an endoscope 708. A proximal portion 712 of the suturing instrument 100 includes the handle 102, a carrier drive wire socket 702 attached to a distal end 752 of the handle 102, and an actuator 112 including a needle deployment button 117. The proximal portion 712 also includes a scope adapter 706 having a distal end 718 that is connectable to an access port 724 of the endoscope 708 and a proximal end 720 that is connectable to the carrier drive wire socket 702.

The suturing instrument further includes an elongate member 714 that includes a carrier drive wire 710, which can be formed from, for example, stainless steel or a nickel-titanium alloy, covered by a flexible sheath 704. The sheath 704 is coupled to a distal portion 716. The carrier drive wire 710 is connectable to the needle carrier for moving a needle from the distal portion in accordance with any of the embodiments disclosed herein. Also, the distal portion 716 can be stationary, pivoting, or rotatable in accordance with any of the embodiments disclosed herein.

In operation, the elongate member 714 is fed into a distal end 722, through a working channel 726, and out of an access port 724 of the endoscope 708. The distal end 718 of the adapter 706 is coupled to the access port 724 of the endoscope 708 and the carrier drive wire 710 is fed through the adapter 706. The carrier drive wire 710 is then coupled to the carrier drive wire socket 702 and the proximal portion 712 of the suturing instrument 100 is secured to the proximal end 720 of the adapter 706. The endoscope 708 can then be inserted into a patient. The adapter 706 can include any

standard or custom fittings necessary to couple to the access port **724** and the proximal portion **712** of the suturing instrument **100**. For example, the adapter **706** can include a luer fitting or a threaded fitting to couple to the endoscope **708**.

In one embodiment, the sheath **704** is fixedly coupled to the distal portion **716**, and the distal portion **716** can be rotated by rotating the flexible sheath **704**, using, for example, a rotation controller **760** disposed in the scope adapter **706**. In another embodiment, the handle **102** of the suturing instrument **100** includes two subassemblies. The subassemblies include a thumb-button/finger grasper assembly and a thumb-button/scope assembly.

Other embodiments incorporating the concepts disclosed herein may be used without departing from the spirit and scope of the invention. The described embodiments are to be considered in all respects as only illustrative and not restrictive. Therefore, it is intended that the scope of the invention be only limited by the following claims.

What is claimed is:

1. A suturing instrument for use with an endoscope, the suturing instrument comprising:

an elongate body member comprising:

a flexible tubular member dimensioned to slidably and rotationally fit within a working channel of an endoscope;

a proximal portion attached to a proximal end of the flexible tubular member; and

a distal portion attached to a distal end of the flexible tubular member, the distal portion being rotatable about a longitudinal axis of the elongate body member and relative to the proximal portion; and

a needle deployment mechanism disposed at least partially within the elongate body member and connectable to a needle for moving the needle out of the distal portion.

2. The suturing instrument of claim 1 wherein the needle deployment mechanism comprises:

a needle carrier disposed at least partially within the distal portion of the elongate body member; the needle carrier slidably movable out of the distal portion;

a carrier drive wire slidably disposed within a lumen defined by the flexible tubular member and coupled to the needle carrier; and

an actuator coupled to the carrier drive wire.

3. The suturing instrument of claim 2 wherein the proximal portion comprises a handle at least partially housing the actuator.

4. The suturing instrument of claim 3 further comprising a rotation control mechanism disposed in the proximal portion of the elongate body member for controlling rotation of the distal portion.

5. The suturing instrument of claim 3 wherein the proximal portion comprises a carrier drive wire socket releasably coupled to the proximal portion for receiving the carrier drive wire.

6. The suturing instrument of claim 5 wherein the proximal portion further comprises a locking socket for securing a proximal end of the tubular member therein; the locking socket rotationally and releasably coupled to the carrier drive wire socket.

7. The suturing instrument of claim 6 wherein the proximal portion further comprises a scope adapter for securing the proximal portion to the working channel of the endoscope.

8. The suturing instrument of claim 3 wherein the flexible tubular member is releasably coupled to the proximal portion.

9. The suturing instrument of claim 1 wherein the distal portion of the elongate body member is pivotable about a first axis, the first axis substantially perpendicular to the longitudinal axis of the elongate body member.

10. The suturing instrument of claim 1 wherein the distal portion comprises a needle catch configured to receive the needle, the needle catch defining a retention slot including at least two flexible edges.

11. The suturing instrument of claim 1 further comprising the needle disposed within the distal portion.

12. A method for placing sutures in tissue, the method comprising:

providing an endoscope defining a working channel extending therethrough, the working channel having an opening at a distal end of the endoscope;

providing a suturing instrument comprising:

an elongate body member comprising:

a flexible tubular member having a distal end and a proximal end, the flexible tubular member dimensioned to slidably and rotationally fit within the working channel of the endoscope,

a proximal portion attached to the proximal end of the flexible tubular member, and

a distal portion attached to the distal end of the flexible tubular member, the distal portion being rotatable about a longitudinal axis of the elongate body member and relative to the proximal portion; and

a needle deployment mechanism disposed at least partially within the elongate body member and connectable to a needle for moving the needle out of the distal portion;

inserting the proximal end of the flexible tubular member into the opening;

passing the flexible tubular member through the working channel of the endoscope;

disposing the needle within the distal portion;

disposing the endoscope within a body;

positioning the distal portion proximal to the tissue; and actuating the needle deployment mechanism thereby moving the needle out of the distal portion and through the tissue.

13. A suturing instrument for use with an endoscope, the suturing instrument comprising:

an elongate body member comprising:

a flexible tubular member dimensioned to slidably and rotationally fit within a working channel of an endoscope,

a proximal portion attached to a proximal end of the flexible tubular member, the proximal portion comprising a handle at least partially housing an actuator, and

a distal portion attached to a distal end of the flexible tubular member, the distal portion being rotatable about a longitudinal axis of the elongate body member and relative to the proximal portion; and

a needle deployment mechanism disposed at least partially within the elongate body member and connectable to a needle for moving the needle out of the distal portion, the needle deployment mechanism comprising:

a needle carrier disposed at least partially within the distal portion of the elongate body member, the needle carrier slidably movable out of the distal portion,

## 25

a carrier drive wire slidably disposed within a lumen defined by the flexible tubular member and coupled to the needle carrier, and the actuator coupled to the carrier drive wire.

14. A suturing instrument for use with an endoscope, the suturing instrument comprising:

an elongate body member comprising:

a flexible tubular member dimensioned to slidably and rotationally fit within a working channel of an endoscope,

a proximal portion attached to a proximal end of the flexible tubular member, the proximal portion comprising:

a handle at least partially housing an actuator;

a carrier drive wire socket releasably coupled to the proximal portion for receiving the carrier drive wire; and

a locking socket for securing a proximal end of the tubular member therein; the locking socket rotationally and releasably coupled to the carrier drive wire socket,

## 26

a distal portion attached to a distal end of the flexible tubular member, and

a needle deployment mechanism disposed at least partially within the elongate body member and connectable to a needle for moving the needle. Out of the distal portion, the needle deployment mechanism comprising:

a needle carrier disposed at least partially within the distal portion of the elongate body member, the needle carrier slidably movable out of the distal portion;

a carrier drive wire slidably disposed within a lumen defined by the flexible tubular member and coupled to the needle carrier; and the actuator coupled to the carrier drive wire.

\* \* \* \* \*

专利名称(译)	内窥镜缝合器械		
公开(公告)号	<a href="#">US6955643</a>	公开(公告)日	2005-10-18
申请号	US10/459826	申请日	2003-06-12
申请(专利权)人(译)	SCIMED LIFE SYSTEMS INC.		
当前申请(专利权)人(译)	BOSTON SCIENTIFIC SCIMED , INC.		
[标]发明人	GELLMAN BARRY N SLANDA JOZEF		
发明人	GELLMAN, BARRY N. SLANDA, JOZEF		
IPC分类号	A61B17/04 A61B17/28 A61B1/00		
CPC分类号	A61B17/0469 A61B17/0482 A61B2017/00323 A61B2017/2927 A61B2017/0479 A61B2017/2905 A61B2017/0472		
优先权	60/388458 2002-06-12 US		
其他公开文献	US20030233108A1		
外部链接	<a href="#">Espacenet</a> <a href="#">USPTO</a>		

#### 摘要(译)

根据本发明的缝合器械的尺寸和构造设计成在例如开放式，小型切口，经阴道，腹腔镜或内窥镜外科手术中施加缝合线以接近，结扎或固定组织。在一些实施例中，缝合器械包括远侧部分，该远侧部分可偏转地和/或可枢转地联接到器械的其余部分，以在手术期间改善可操作性和功能性。在其他实施例中，缝合器械能够容纳多个针和缝合线组件和/或重新加载针和缝合线组件，而无需从手术部位移除器械。

