



(19) **United States**

(12) **Patent Application Publication** (10) Pub. No.: US 2004/0186468 A1  
 Edwards (43) Pub. Date: Sep. 23, 2004

(54) TREATMENT OF URINARY INCONTINENCE  
AND OTHER DISORDERS BY APPLICATION  
OF ENERGY AND DRUGS

(52) U.S. Cl. .... **606/41**; 606/42; 607/101;  
607/105

(76) Inventor: **Stuart D. Edwards**, Portola Valley, CA  
(US)

Correspondence Address:  
**GLENN PATENT GROUP**  
**3475 EDISON WAY, SUITE L**  
**MENLO PARK, CA 94025 (US)**

(21) Appl. No.: **10/769,153**

(22) Filed: **Jan. 29, 2004**

### Related U.S. Application Data

(62) Division of application No. 09/407,658, filed on Sep. 28, 1999, now Pat. No. 6,692,490.

## Publication Classification

(51) **Int. Cl.<sup>7</sup>** ..... **A61B 18/18**

(57) **ABSTRACT**

The invention provides a method and system for treating disorders in parts of the body. A particular treatment can include one or more of, or some combination of: ablation, nerve modulation, three-dimensional tissue shaping, drug delivery, mapping stimulating, shrinking and reducing strain on structures by altering the geometry thereof and providing bulk to particularly defined regions. The particular body structures or tissues can include one or more of or some combination of region, including: the bladder, esophagus, vagina, penis, larynx, pharynx, aortic arch, abdominal aorta, thoracic, aorta, large intestine, sinus, auditory canal, uterus, vas deferens, trachea, and all associated sphincters. Types of energy that can be applied include radiofrequency, laser, microwave, infrared waves, ultrasound, or some combination thereof. Types of substances that can be applied include pharmaceutical agents such as analgesics, antibiotics, and anti-inflammatory drugs, bulking agents such as biologically non-reactive particles, cooling fluids, or dessicants such as liquid nitrogen for use in cryo-based treatments.

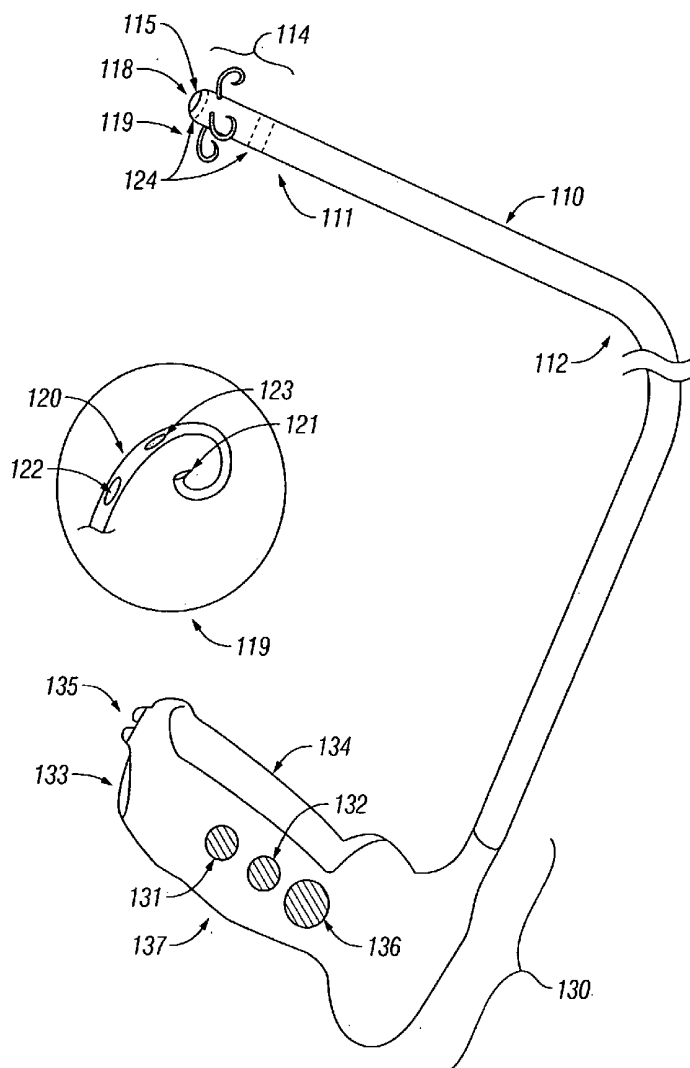

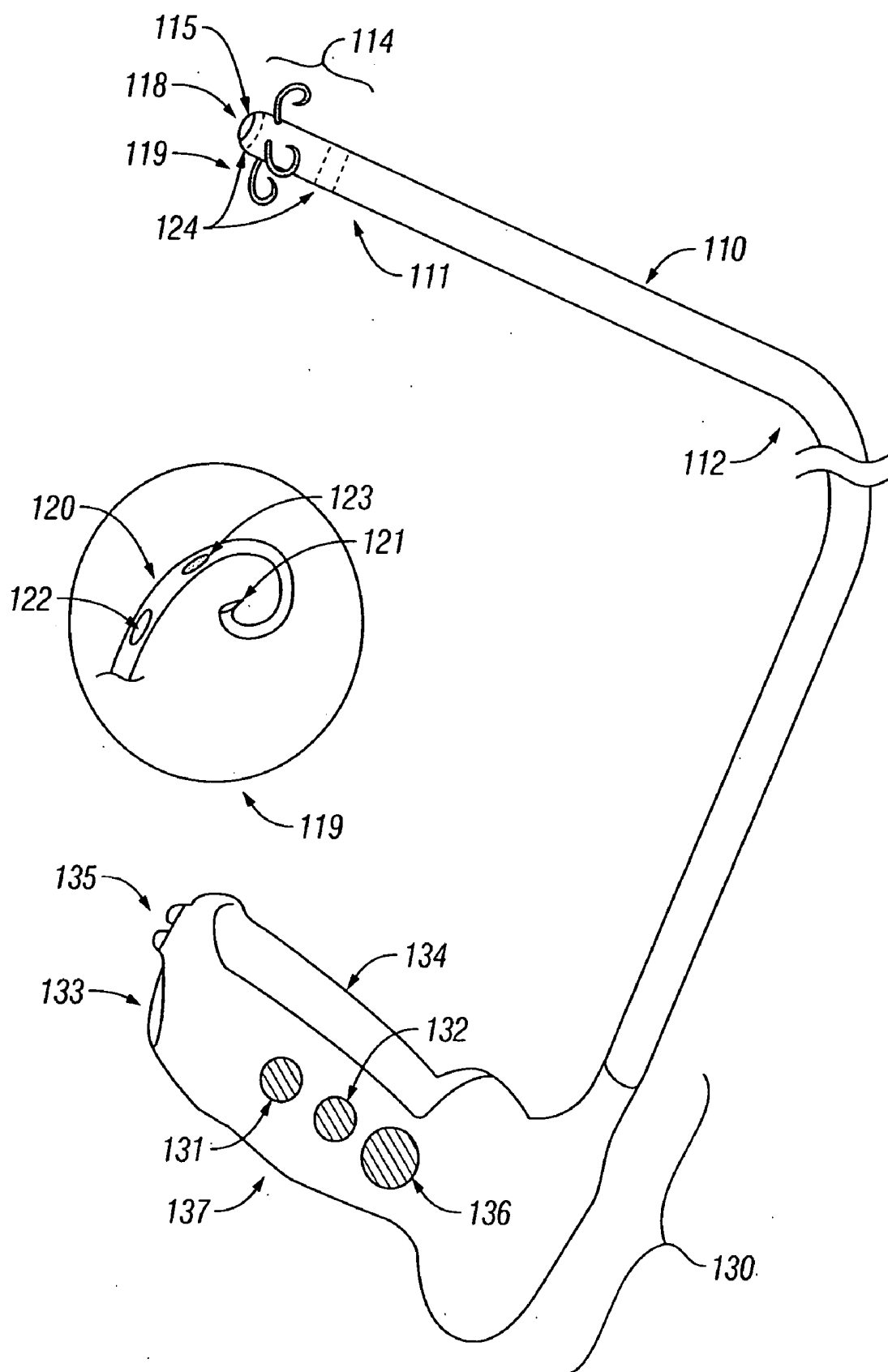
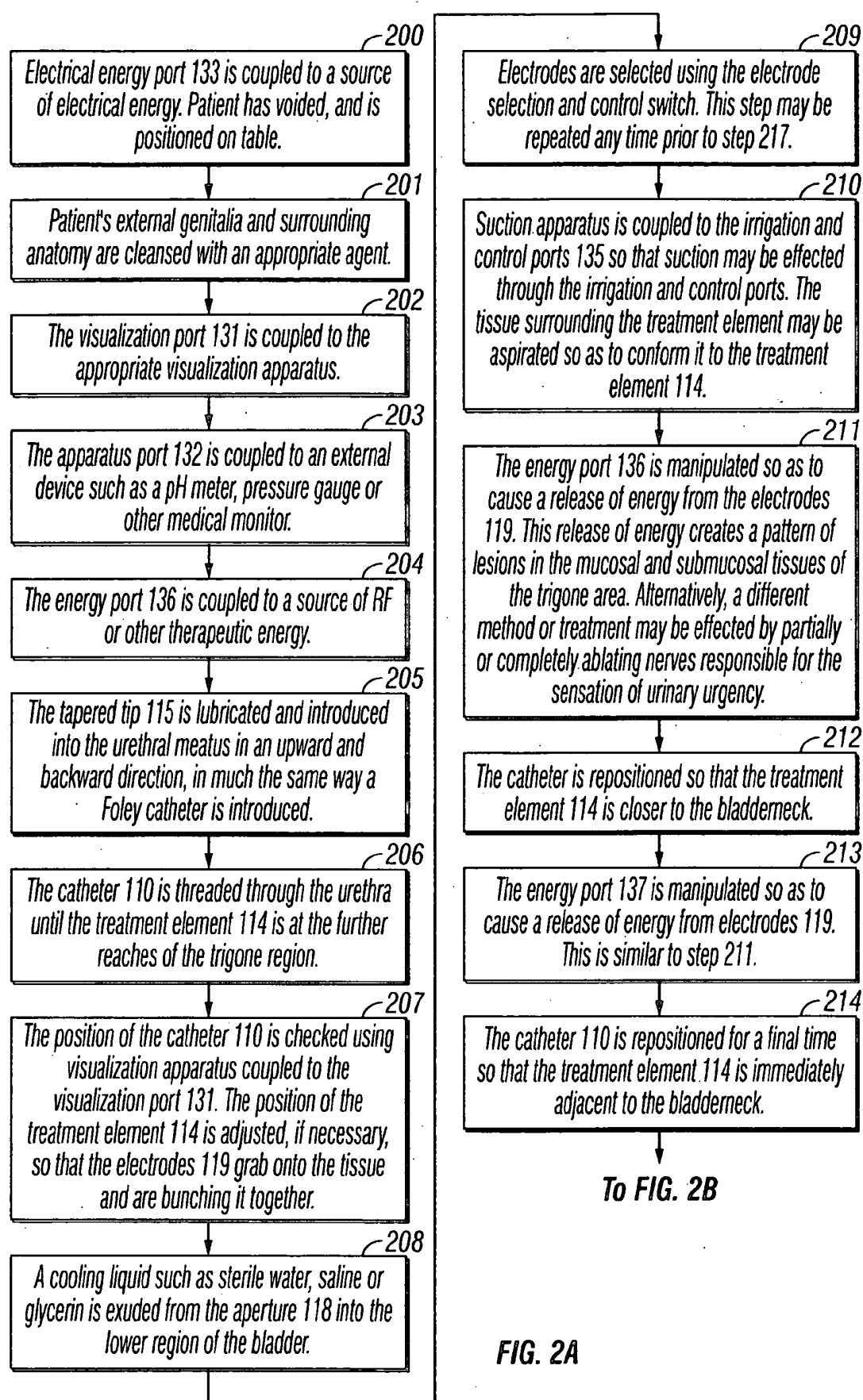
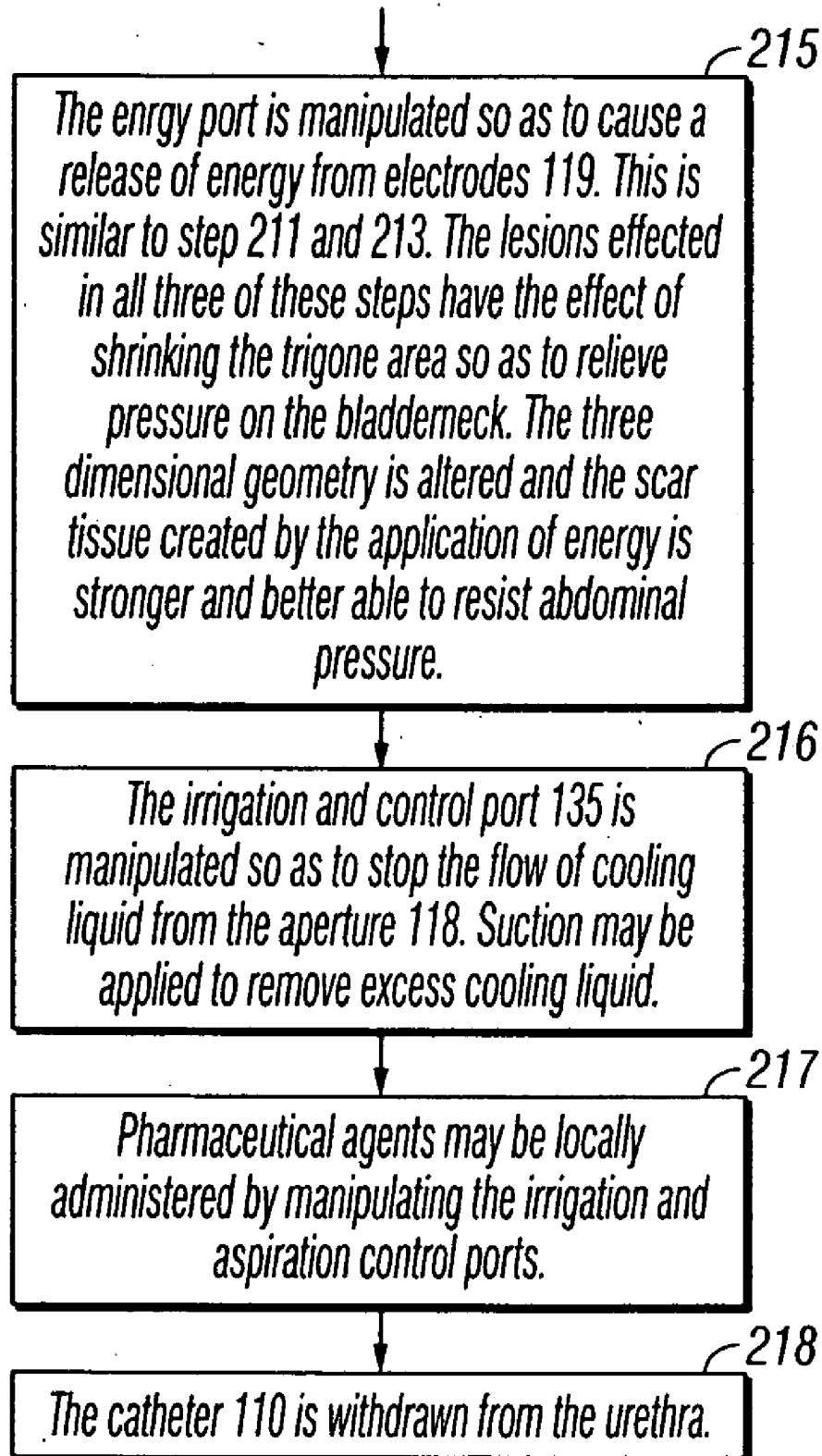

FIG. 1



**From FIG. 2A****FIG. 2B**

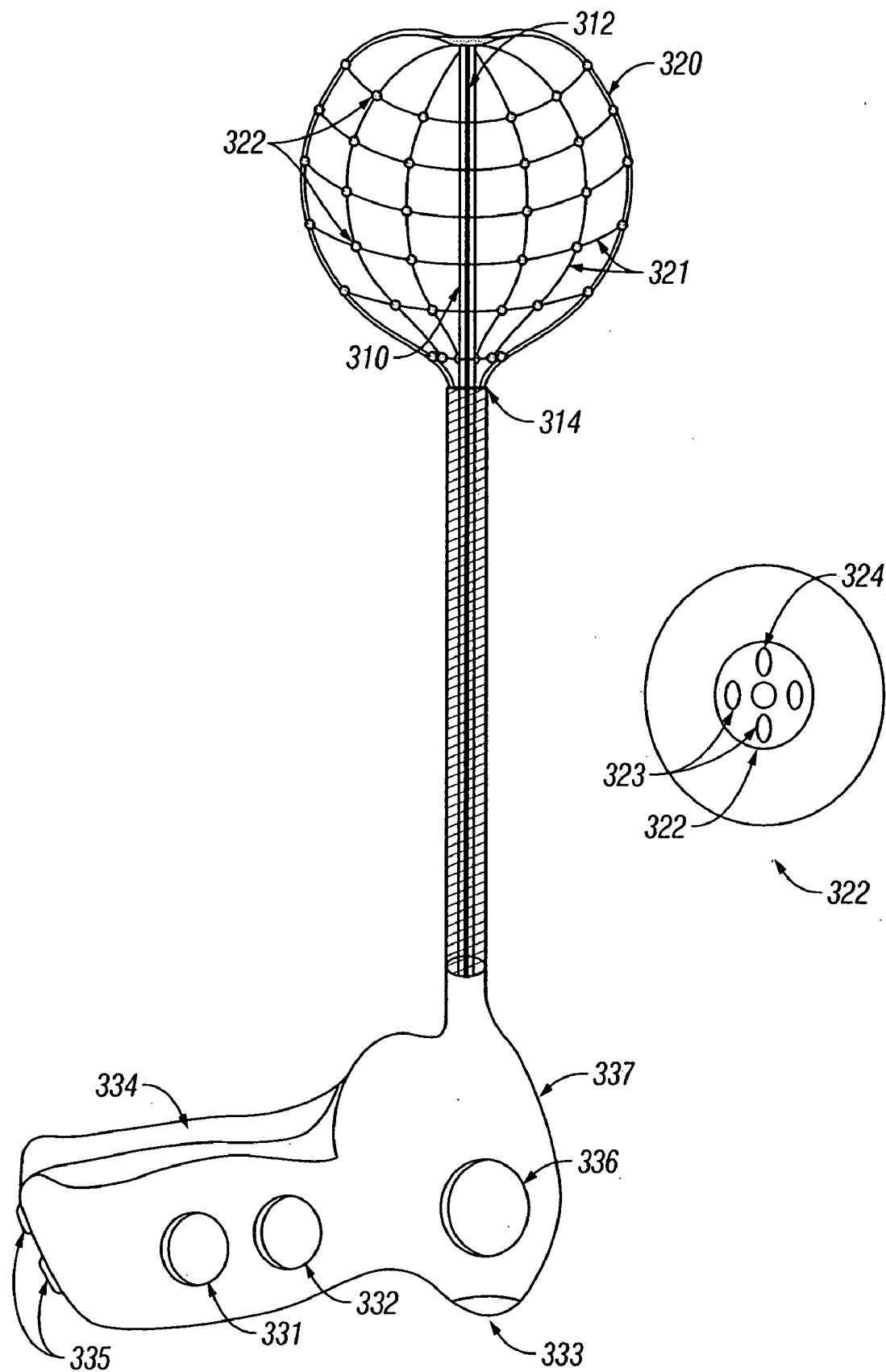

FIG. 3

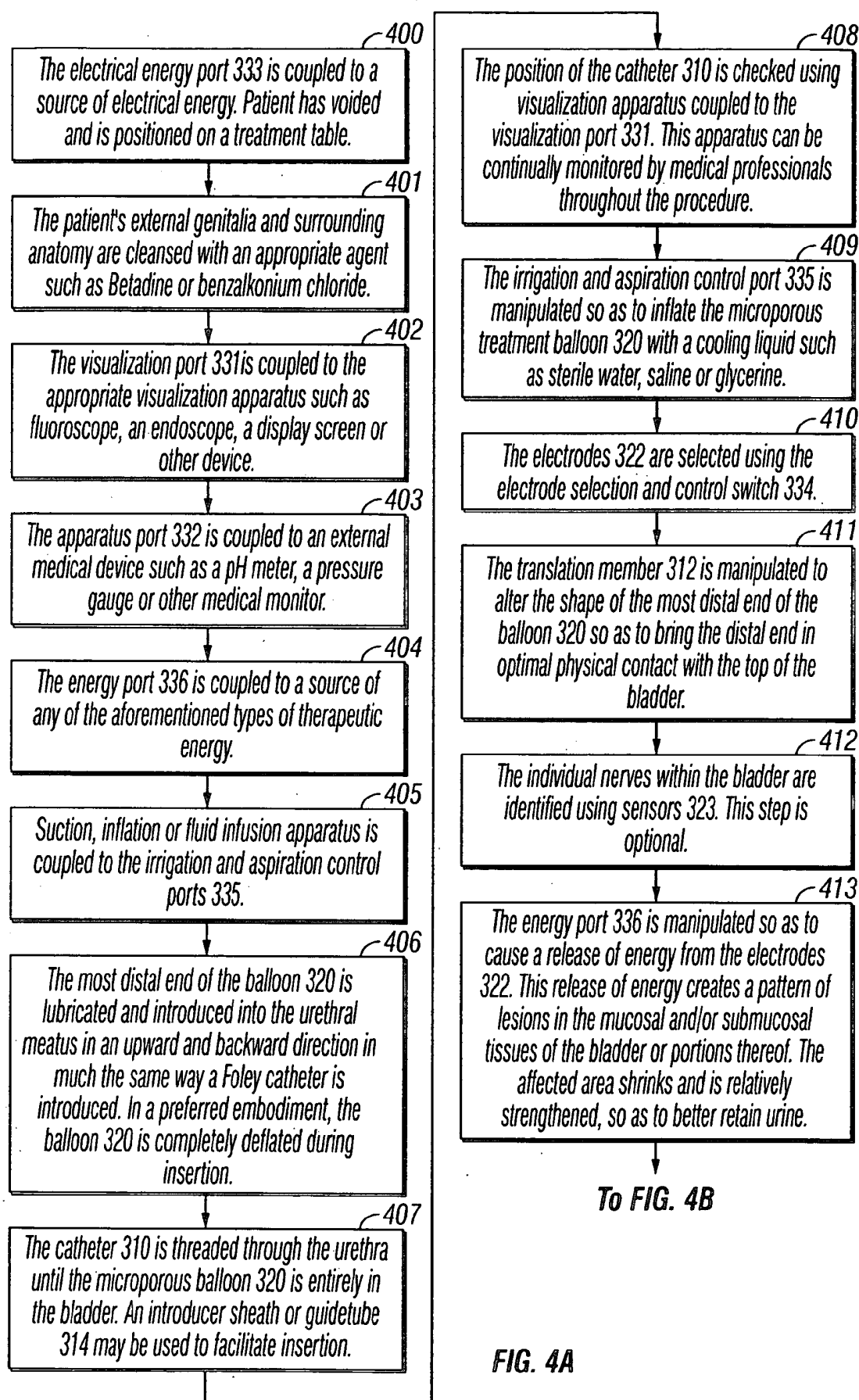
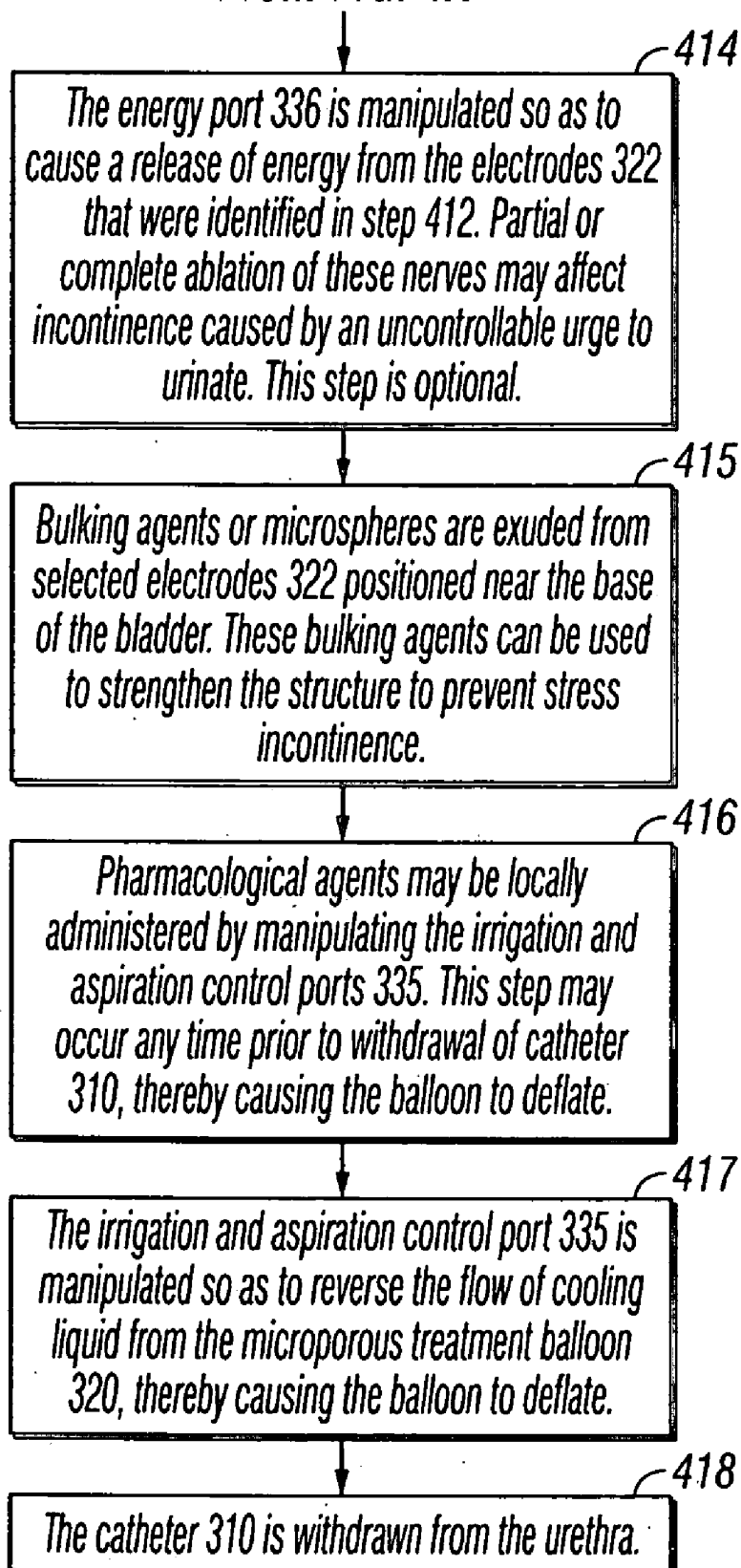

FIG. 4A

**From FIG. 4A****FIG. 4B**

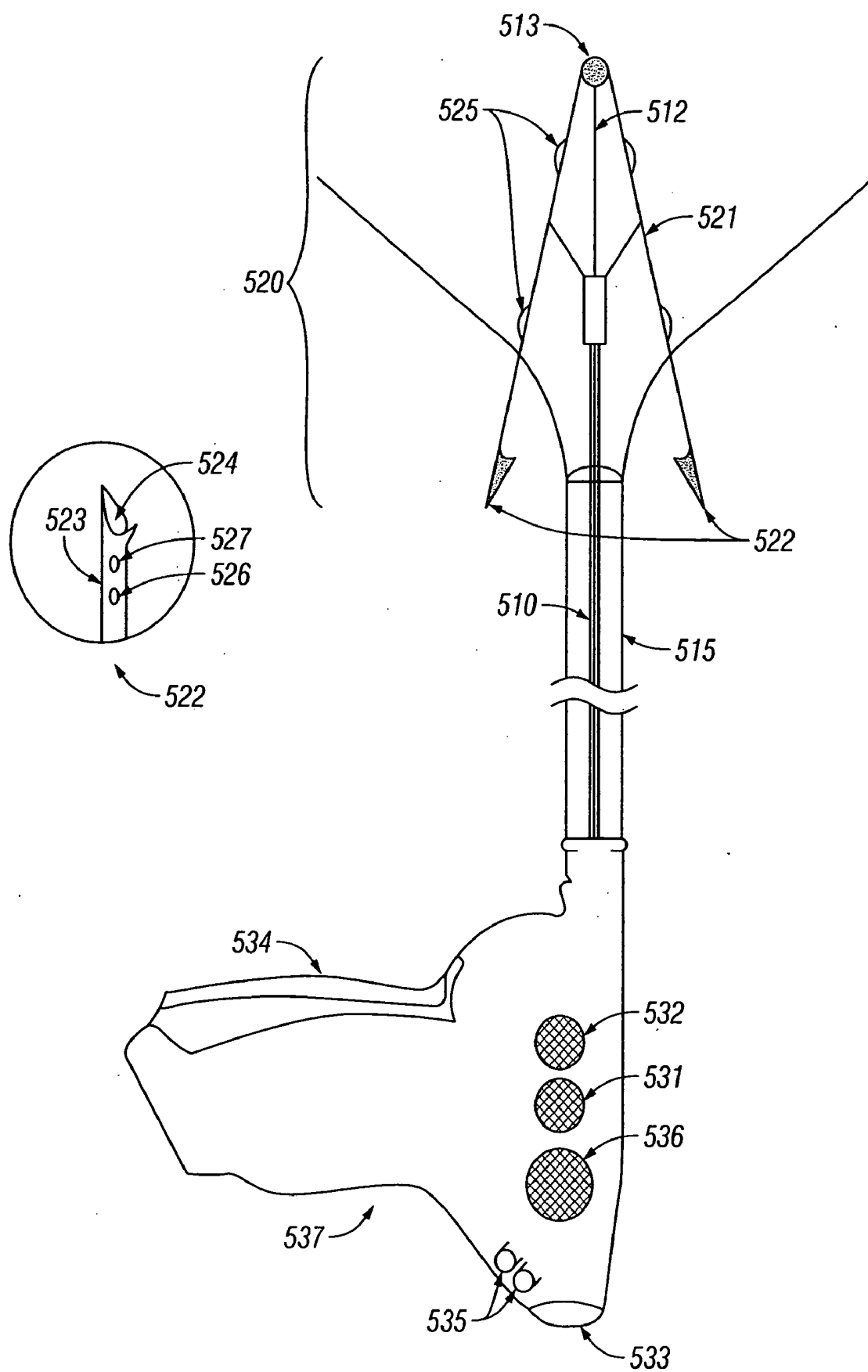
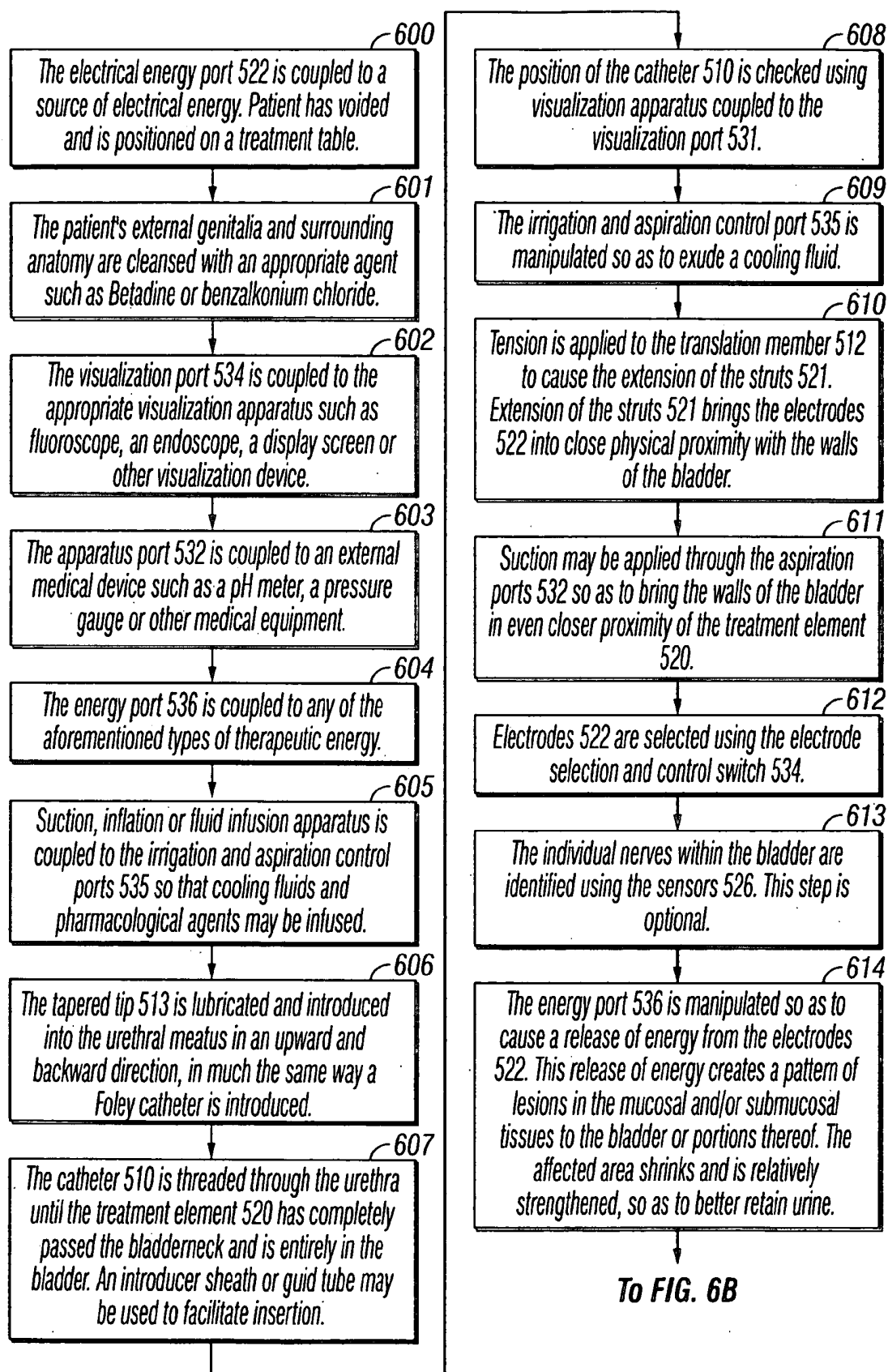
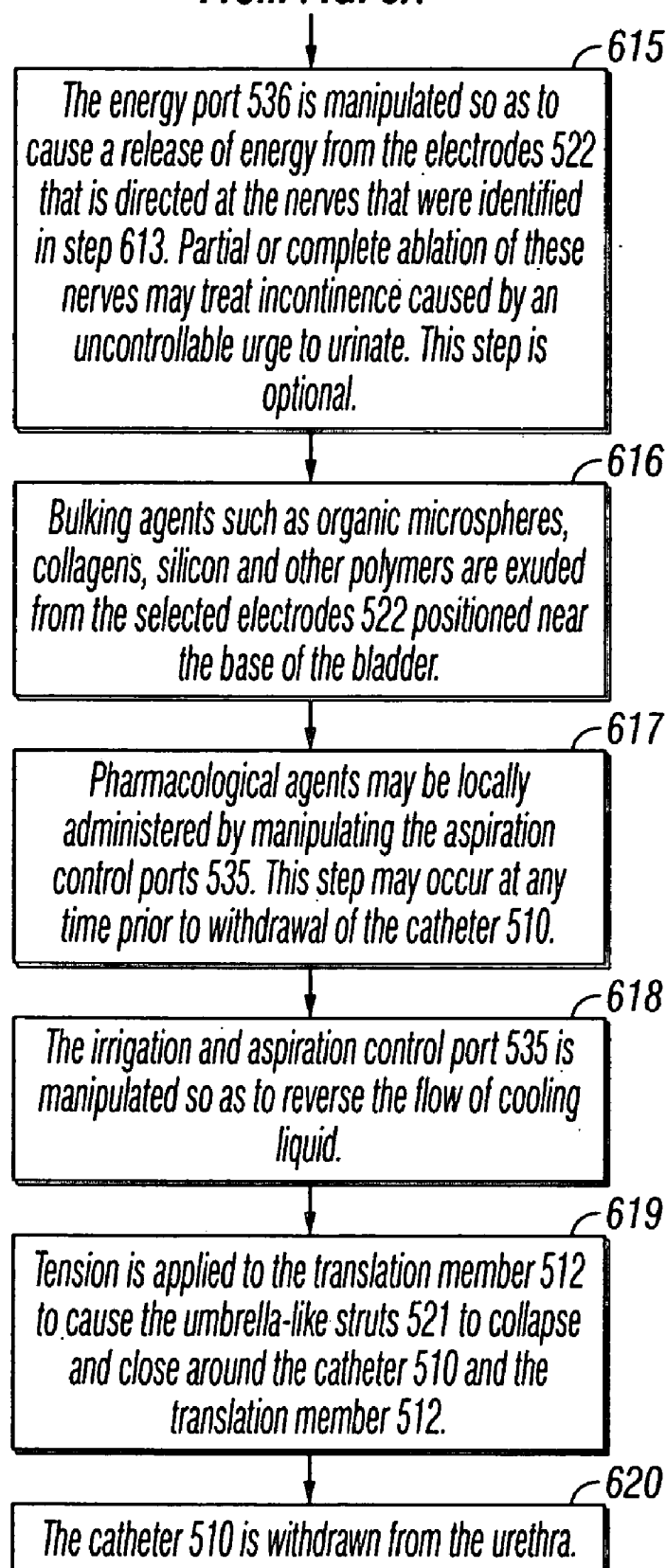

FIG. 5





**FIG. 6A**

**From FIG. 6A****FIG. 6B**

## TREATMENT OF URINARY INCONTINENCE AND OTHER DISORDERS BY APPLICATION OF ENERGY AND DRUGS

### CROSS REFERENCE TO RELATED APPLICATIONS

[0001] This application is a division of U.S. patent application Ser. No. 09/407,658, filed Sep. 28, 1999.

### BACKGROUND OF THE INVENTION

#### [0002] 1. Field of the Invention

[0003] This invention relates to treating body tissue, particularly to treating body tissue by altering the shape, density, relative geometry or tension of that body tissue using energy or substances deployed from an interstitial location in the body.

#### [0004] 2. Related Art

[0005] Urinary incontinence results from a number of factors. Increasing age, injury from childbirth and related stresses can cause the relative tone of the bladder and accessory muscles to weaken, which, in turn, causes an impaired inability to retain urine. Weight gain and overall deterioration of muscle tone can cause increased abdominal pressure which overcomes sphincter resistance. Nerve pathways that cause the "urge" to urinate can be hyperactive. The relative tension of the urethra can change with age, causing poor urinary control. Injury to the detrusor muscles or to the trigone area also results in impaired urinary continence.

[0006] These factors do not usually occur by themselves. The typical patient usually presents with two or more of them. Therefore, it is desirable to provide a treatment that can address many of these factors.

[0007] Given the complex etiology of varied causal factors, the ideal treatment for urinary incontinence requires a device that can perform many different functions. For example, a treatment for female urinary incontinence might rely upon some or all of the following:

[0008] (1) reshaping the bladder to alter the urethrovesical angle and re-suspend the bladder neck, (2) manipulation of the detrusor muscles, (3) mapping and modulating nervous pathways responsible for urinary urgency, (4) reducing strain on the bladder neck by changing the structural geometry, (5) shrinking discrete and non-discrete areas of the bladder by creating thermal lesions, (6) three-dimensional modeling of tissue by adding bulk so as to achieve better closure, (7) strengthening the structure integrity of a tissue by providing a pattern of scar tissue, and (8) application of pharmaceutical agents both as a curative and to promote healing post treatment.

[0009] The use of a catheter to apply radio frequency (RF) and other types of energy to ablate tissue in the body (such as heart muscle tissue) is known in the art of cardiac treatment. However, known systems using RF and other types of energy are still subject to several drawbacks.

[0010] A first problem in the known art involves providing a device that can perform all of the aforementioned functions. While known systems can perform one or more of these functions, nothing in the related art is capable of

performing all of these functions. Patients are frequently required to return for multiple treatments until a cure is finally effected.

[0011] A second problem in the known art involves identification, modulation and/or stimulation of nerves in a targeted tissue. Known systems do not provide for protection of sensitive nerves during treatment or allow nerves during treatment or allow nerves to be identified and stimulated. This is particularly problematic because many tissue disorders, especially those involving tone or contractile ability of a sphincter, arise from afferent and efferent nerves are either under-stimulated or over-stimulated.

[0012] A third problem in the known art involves providing a treatment surface that can reach all of the desired treatment areas, such as the entire surface of the detrusor muscles. While the use of a catheter to deploy energy is known, none is disposed to flexibility adapt to the interior shape of an organ so as to provide optimal uniform treatment.

[0013] A fourth problem is the known art involves removal of tissue and substances used in treatment. Known systems do not provide for removal of excess substances used in treatment such as cooling fluids, collagen or bulking substances. Similarly, known systems do not provide for removal of substances that hinder or otherwise obstructs the healing process such as pus, purulent discharges, suppuration and pockets of infection.

[0014] A fifth problem in the known art involves directing and positioning the electrodes in the body cavity orifice. Difficulties in accurately positioning the electrodes in the target orifice detract from treatment. Frequently, unhealthy tissue remains untreated while healthy tissue is compromised. Difficulties in directing and positioning the electrodes are particularly problematic because one of the goals of treatment is to minimize collateral damage to healthy tissue and to completely treat diseased tissue.

[0015] A sixth problem in the known art involves minimizing thermal injury to the patient. Some known systems rely upon simultaneous application of energy and infusion of a cooling liquid into the targeted area for treatment. While such infusion of liquid minimizes thermal injury to the patient, it is not applicable to all parts of the body. For example, infusion of cooling liquids into an internal body cavity such as a bladder, uterus, or stomach can rupture the targeted organ or cause osmotic imbalance within the tissue.

[0016] A seventh problem in the known art involves difficulty in the simultaneous use of complimentary technology. Known systems do not provide for optimal, simultaneous use of auxiliary tools for visualization, monitoring pH and pressure or drug administration.

[0017] An eighth problem in the known art is that it can be difficult to block the flow of body fluids and gases into an area of the body where tissue ablation is taking place. Bodily fluids can dissipate and detrimentally absorb the energy to be applied to the tissue to be ablated. Dissipation of bodily fluids detracts from the goal of treatment of diseased tissue.

[0018] Accordingly, it would be advantageous to provide a method and apparatus for treatment of body structures, especially internal body structures involving unwanted features or other disorders, that does not require relatively

invasive surgery, and is not subject to other drawbacks noted with regard to the known art. This advantage is achieved in an embodiment of the invention in which a relatively minimally invasive catheter is inserted into a body, a variety of different treatments of the body structures is applied using electrodes and a cooling element, and the unwanted features or disorders are relatively cured.

#### SUMMARY OF THE INVENTION

[0019] The invention provides a method and system for treating disorders of the genitourinary tract and other disorders in other parts of the body. A particular treatment can include one or more of, or some combination of ablation, nerve modulation, three-dimensional tissue shaping, drug delivery, mapping, stimulating, shrinking (by creation of a pattern of thermal lesions) and reducing strain on structures by altering the geometry thereof and providing bulk to particularly defined regions.

[0020] The particular body structures or tissues can include one or more of, or some combination of regions, including the bladder, esophagus, vagina, penis, larynx, pharynx, aortic arch, abdominal aorta, thoracic aorta, large intestine, small intestine, sinus, auditory canal, uterus, vas deferens, trachea and all associated sphincters.

[0021] In one aspect of the invention, a catheter is deployed in the body. It may enter the body via orifice, a stoma, or surgically created opening that is made for the purpose of inserting the catheter. Insertion may be facilitated with the use of a guide or wire or a generic support structure or visualization apparatus.

[0022] In a second aspect of the invention, the treatment can include application of energy and substances to effect changes in the target tissue. Types of energy that can be applied include radio frequency, laser, microwave, infrared waves, ultrasound or some combination thereof. Types of substances that can be applied include pharmaceutical agents such as analgesics, antibiotics and anti-inflammatory drugs, bulking agents such as biologically nonreactive particles, cooling fluids, and dessicants such as liquid nitrogen for use in cryo-based treatments.

#### BRIEF DESCRIPTION OF THE DRAWINGS

[0023] FIG. 1 is a block drawing of a system for treatment of female urinary incontinence using a first device;

[0024] FIG. 2 is a process flow drawing of a method for treatment of female incontinence using a first device;

[0025] FIG. 3 is a block drawing of a system for treatment of female urinary incontinence using a second device;

[0026] FIG. 4 is a process flow drawing of a method for treatment of female urinary incontinence using a second device;

[0027] FIG. 5 is a block drawing of system for treatment of female urinary incontinence using a third device; and

[0028] FIG. 6 is a flow drawing of a method for treatment of female urinary incontinence using a third device.

#### DETAILED DESCRIPTION OF THE PREFERRED EMBODIMENT

[0029] In the following description, a preferred embodiment of the invention is described with regard to referred

process steps and data structures. Embodiments of the invention can be implemented using general-purpose processors or special purpose processors operating under program control, or other circuits, adapted to particular process steps and data structures described herein. Implementation of the process steps and data structures described herein would not require undue experimentation or further invention.

#### [0030] System Elements

[0031] FIG. 1 is block drawing of a system for treatment of female urinary incontinence using a first device.

[0032] A system 100 includes a catheter 110, a treatment element 114, a control assembly 130 and a shielding element 140. In an alternate embodiment, the shielding element 140 is not present.

#### [0033] The Catheter

[0034] The catheter 110 includes a distal segment 111 and a proximal segment 112. The distal segment 111 and proximal segment 112 form one continuous piece. Two or more lumens 113 (not shown) run the entire interior length of the catheter 110 and are coupled to the control assembly 140. It is through these lumens 113 that energy is conducted and flowable substances are exuded.

[0035] The distal segment 111 includes a treatment element 114 and a tapered tip 115. In a preferred embodiment, the tapered tip 115 is rigid so as to allow easy insertion into a urethra. In other preferred embodiments, the tapered tip 115 may be of varying degrees of flexibility depending where it is in the body it is deployed. In alternative embodiments, the catheter 110 may be introduced into the target tissue using an introducer sheath 116 or guide wire 117 (not shown). The most distal end of the tapered tip 115 includes an aperture 118. Substances that flow through the lumens 113 may be applied to the tissue through this aperture 118.

[0036] In the preferred embodiment, the distal segment 111 is disposed for insertion into a cavity of the body such as a female urethra and bladder. In alternative embodiments, the cavity may include one or more of, or some combination of the following:

[0037] any portion of the bronchial system, the cardiovascular system, the genito-urinary tract, the lymphatic system, the pulmonary system, the vascular system, the locomotor system, the reproductive system or other systems in the body; any biological conduit or tube, such as a biologic lumen that is patent or one that is subject to a stricture;

[0038] any biologic operational structure, such as a gland, or a muscle or other organ (such as the colon, the diaphragm, the heart, a uterus, a kidney, a lung, the rectum an involuntary or voluntary sphincter);

[0039] any biologic structure, such as a herniated body structure, a set of diseased cells, a set of dysplastic cells, a surface of a body structure, (such as the sclera) a tumor, or a layer of cells (such as fat muscle or skin); and

[0040] any biologic cavity or space or the contents thereof, such as a cyst, a gland, a sinus, a layered structure, or a medical device implanted or inserted into the body.

**[0041]** The Treatment Element

**[0042]** The treatment element **114** includes a set of curvilinear electrodes **119** and three sets of irrigation and aspiration ports **124**.

**[0043]** The electrode **119** contained in the set of electrodes are evenly spaced around the tapered tip **115**. Each electrode **119** includes a metallic tube **120** defining a hollow lumen **121** and is disposed so that it curves away from the tapered tip **115** and has a barbed end, much like a fishhook. Being arced in this direction allows the device to be inserted easily into an orifice without causing unintended tissue damage. Once the device is inserted, the barbed ends of electrodes **119** grab the tissue of the bladder neck and upper urethra in a claw-like manner and bunch it together. Energy is delivered through the electrodes to the bunched tissue, causing shrinkage to occur in the area surrounding the treatment element **114**. This three dimensional shaping improves continence by improving the structural integrity of the tissue.

**[0044]** In a preferred embodiment, there are four electrodes **119**. Other preferred embodiments may have more or less than four electrodes. Each electrode **119** is coupled to at least one sensor **122** capable of measuring such factors as temperature, conductivity, pressure, impedance and other variables. In a preferred embodiment, each electrode is also coupled to a radiopaque marker **123** for use in fluoroscopic visualization.

**[0045]** In a preferred embodiment, the electrodes **119** can be operated separately or in combination with each other. Treatment can be directed at a single area or several different areas of a bladder or other orifice by operation of selective electrodes. Different patterns of sub-mucosal lesions, mucosal lesions, ablated, bulked, plumped desiccated or necrotic regions can be created by selectively operating different electrodes. Production of different patterns of treatment makes it possible to remodel tissues and alter their overall geometry with respect to each other.

**[0046]** Each electrode **119** can be disposed to treat tissue by delivering one or more of, or some combination or any of the following in either a unipolar or bipolar mode:

**[0047]** Radiofrequency (RF) energy, such as RF in about the 300 kilohertz to 500 kilohertz range;

**[0048]** Chemical treatments, such as acids, antibiotics enzymes, radioactive tracers or other bioactive substances;

**[0049]** Infrared energy, such as from an infrared laser or diode laser;

**[0050]** Microwave energy, such as electromagnetic energy in about the 915 megahertz or 2.45 gigahertz range;

**[0051]** Sonic energy, including ultrasound;

**[0052]** Photodynamic therapy (PDT)

**[0053]** Non-infrared laser energy

**[0054]** Cryothermia

**[0055]** In addition to treating tissues by delivering energy, the set of electrodes **119** are disposed to delivery at least one flowable substance to the area of the body where treatment is to take place. In a preferred embodiment, the flowable

substance includes water which aids in cooling of body structures during RF application. However, in alternative embodiments, the deliverable flowable liquids include other substances, including saline, anesthetic drugs, anti-inflammatory agents, chemotherapeutic agents, systemic or topical antibiotics, collagen and radioactive substances such as labeled tracers. In one alternative embodiment, saline is used to increase the local conductivity of tissue, enhancing the penetration of RF energy so as to create larger lesions. The saline can be delivered through the needle submucosally so as to achieve greatest effect.

**[0056]** Three rings of irrigation and aspiration ports **124** circle the distal end of the catheter **110**. Each ring contains numerous irrigation and aspiration ports **124**, evenly distributed around the width of the catheter. One ring of irrigation and aspiration ports **124** lies between the aperture **118** and the set of electrodes **119**; the other two rings of irrigation and aspiration ports **124** are located on the proximal side of the electrodes **119**. Application of positive pressure makes irrigation and cooling of tissues is possible. Alternatively, application of negative pressure causes the tissue to be uniformly conformed around the treatment element **114**, thereby achieving the most optimal therapeutic value of the energy and substances.

**[0057]** The Control Assembly **130**

**[0058]** The control assembly **130** includes a visualization port **131**, an apparatus port **132**, an electrical energy port **133**, an electrode selection and control switch **134**, one or more irrigation and aspiration control ports **135**, an therapeutic energy port **136** and a handle **137**.

**[0059]** The visualization port **131** can be coupled to visualization apparatus, such as fiberoptic device, fluoroscopic device, an oscopy, a laparoscope or other type of catheter.

**[0060]** The apparatus port **132** can be coupled to other medical devices that may be useful during treatment such as a pH meter, a pressure monitor, drug administration apparatus, or other device used to monitor or treat the patient.

**[0061]** In a preferred embodiment, devices coupled to both the visualization port **131** and the apparatus ports **132** are controlled from a location outside the body, such as by an instrument in an operating room or an external device for manipulating the inserted catheter **110**.

**[0062]** In an alternative embodiment the apparatus port **132** may be coupled to devices that are implanted or inserted into the body during a medical procedure. For example, the apparatus port **132** may be coupled to a programmed AICD (artificial implanted cardiac defibrillator), a programmed glandular substitute (such as an artificial pancreas) or other device for use during surgery or other medical procedures.

**[0063]** The electrical energy port **133** includes conductive element such as an electrical adapter that can be coupled to a source of alternating or direct current such as a wall socket, battery or generator.

**[0064]** The electrode section and control switch **134** includes an element that is disposed to select and activate individual electrodes **119**.

**[0065]** The irrigation and aspiration control ports **135** can be coupled to a pump or other apparatus to deliver fluid

through the aperture **118** or apply suction through the set of irrigation and aspiration ports **134**.

[**0066**] The therapeutic energy port **136** includes a receptor port for coupling to a source of any of the following types of therapeutic energy:

- [**0067**] radiofrequency (RF) energy, such as RF in about the 300 kilohertz to 500 kilohertz range;
- [**0068**] chemical treatments, such as acids, antibiotics, enzymes, radioactive tracers or other bioactive substances;
- [**0069**] infrared energy, such as from an infrared laser or diode laser;
- [**0070**] microwave energy, such as electromagnetic energy in about the 915 megahertz or 2.45 gigahertz range;
- [**0071**] sonic energy, including ultrasound;
- [**0072**] photodynamic therapy (PDT);
- [**0073**] non-infrared laser energy; and
- [**0074**] cryothermia

[**0075**] The handle **137** is disposed for manipulation by medical or veterinary personnel and can be shaped for being held in the hand. The visualization port **131**, the apparatus port **132**, the electrical energy port **133**, the electrode selection and control switch **134** and the one or more irrigation and aspiration control ports **135** and the therapeutic energy port **136** are all mounted in the handle **137** to allow for easy operation.

[**0076**] The Shielding Element

[**0077**] The shielding element **140** lies on the proximal side of treatment element **114** and is disposed to isolate the treatment area. It can also help position the catheter **110** in the body. For example, in a preferred embodiment in which the catheter **110** is inserted into the urethra, the shielding element **140** can prevent the catheter **110** from being inserted further into the urethral canal and prevent substances used in treatment from escaping. In an alternative embodiment, the shield element **140** is optional.

[**0078**] FIG. 2 is a process flow drawing of a method for treatment of female urinary incontinence using a first device.

[**0079**] A method **200** is performed by a system **100**, including a catheter **110** and a control assembly **140**. Although the method **200** is described serially, the steps of the method **200** can be performed by separate elements in conjunction or in parallel, whether asynchronously, in a pipelined manner, or otherwise. There is no particular requirement that the method **200** be performed in the same order in which this description lists the steps, except where so indicated.

[**0080**] At a flow point **200**, electrical energy port **133** is coupled to a source of electrical energy. The patient has voided and is positioned on a treatment table, in an appropriate position such as horizontal, jackknife or lithotomy. Due to the potential for inducing pain, the area surrounding the urinary meatus may be pretreated with a topical anesthetic before insertion of the catheter **110**; depending upon the circumstances, a muscle relaxant or short term tranquilizer may be indicated. The position of the patient and choice

of pharmaceutical agents to be used are responsive to judgments by medical personnel.

[**0081**] At a step **201**, the patient's external genitalia and surrounding anatomy are cleansed with an appropriate agent such as BETADINE, or benzalkonium chloride.

[**0082**] At a step **202**, the visualization port **131** is coupled to the appropriate visualization apparatus, such as a fluoroscope, an endoscope, a display screen or other visualization device. The choice of visualization apparatus is responsive to judgments by medical personnel.

[**0083**] At a step **203**, the apparatus port **132** is coupled to an external medical device such as a pH meter, a pressure gauge, or other such equipment. The choice of apparatus is responsive to judgments by medical personnel.

[**0084**] At a step **204**, the therapeutic energy port **136** is coupled to a source of any of the aforementioned types of therapeutic energy.

[**0085**] At a step **205**, the tapered tip **115** is well lubricated and introduced into the urethral meatus in an upward and backward direction, in much the same way a Foley catheter **110** is introduced.

[**0086**] In a step **206**, the catheter **110** is threaded through the urethra until the treatment element **114** is at the further reaches of the trigone region. An introducer sheath **116** or guidewire **117** may also be used to facilitate insertion.

[**0087**] In a step **207**, the position of the catheter **110** is checked using visualization apparatus coupled to the visualization port **131**. The position of the treatment element **114** is adjusted, if necessary, so that the electrodes **119** have grabbed onto the tissue and are bunching it together. This apparatus can be continually monitored by medical professionals throughout the procedure.

[**0088**] In a step **208**, irrigation and aspiration control port **135** is manipulated so as to exude a cooling liquid such as sterile water, saline or glycerin from the aperture **118** into the lower region of the bladder. This cooling fluid lowers the relative temperature of the targeted tissues and prevents collateral thermal damage. In alternative embodiments, other devices may be coupled to the apparatus port **132** to chill the cooling fluid or to cause sonic cooling, gas expansion, magnetic cooling or others cooling methodologies. The choice of cooling fluid or methodology is responsive to judgments by medical personnel.

[**0089**] In a step **209**, electrodes **119** are selected using the electrode selection and control switch **134**. In a preferred embodiment, all electrodes are deployed at once. In another preferred embodiment, electrodes may be individually selected. This step may be repeated at any time prior to step **217**.

[**0090**] In a step **210**, suction apparatus is coupled to the irrigation and aspiration control ports **135** so that suction may be effected through the irrigation and aspiration ports **124**. The tissue surrounding the treatment element **114** may be aspirated so as to conform it to the treatment element **114**. The aspiration also removes excess cooling fluid that was supplied in step **209**.

[**0091**] In a step **211**, the therapeutic energy port **136** is manipulated so as to cause a release of energy from the electrodes **119**. The duration and frequency of energy are

responsive to judgments by medical personnel. This release of energy creates a pattern of lesions in the mucosal and sub-mucosal tissues of the trigone region. The affected area shrinks and is relatively strengthened, so as to better retain urine. Alternatively, a different method of treatment can be affected by partially or completely ablating nerves responsible for the sensation of urinary urgency.

[0092] In a step 212, the catheter 110 is repositioned so that the treatment element 114 is closer to the bladder neck. Prior to repositioning the catheter 110, the electrodes 119 are either retracted or covered by the introducer sheath 116 to prevent unintended damage to tissue while the catheter is being moved.

[0093] In a step 213, the energy port 137 is manipulated so as to cause a release of energy from the electrodes 119. The duration and frequency of energy are responsive to judgments by medical personnel. This release of energy creates another pattern of lesions in the mucosal and sub-mucosal tissues of the trigone area. The affected tissue shrinks and is relatively strengthened, so as to better retain urine. By creating a selective pattern of lesions in various areas as in steps 211 and 115, the three-dimensional modeling of the trigone area can be affected. Alternatively, a different method of treatment can be effected by partially or completely ablating nerves responsible for the sensation of urinary urgency.

[0094] In a step 214, the catheter 110 is re-positioned for a final time so that the treatment element 114 is immediately adjacent to the bladder neck. Prior to repositioning the catheter 110, the electrodes 119 are either retracted or covered by the introducer sheath 116 to prevent unintended damage to tissue while the catheter is being removed.

[0095] In a step 215, the energy port 137 is manipulated so as to cause a release of energy from the electrodes 119. The duration and frequency of energy are responsive to judgments by medical personnel. This release of energy creates another pattern of lesions in the sub-mucosal and mucosal tissues around the bladder neck. The affected tissue shrinks and is relatively strengthened, so as to better retain urine. Taken together with the lesions, created in step 211, and 213, the trigone area has been completely remodeled so that the bladder has shrunk and re-suspended itself. The relative pressure on the bladder neck is relieved. The scar tissue created by application of the energy is stronger and better able to resist abdominal pressure on the sphincter.

[0096] In a step 216, the irrigation and aspiration control port 135 is manipulated so as to stop the flow of cooling liquid from the aperture 118.

[0097] In a step 217, pharmaceutical agents may be locally administered by manipulating the irrigation and aspiration control ports 135. These agents may include lubricants, anesthetics, anti-spasmodics, anti-inflammatories, antibiotics or other agents as deemed appropriate by the judgment of medical personal. This step may occur any time prior to withdrawal of the catheter 110, to either pre-treat tissue or post treat tissues.

[0098] In a step 218, the catheter 110 is withdrawn from the urethra.

[0099] FIG. 3 is a block drawing of a system for treatment of female urinary incontinence using a second device.

[0100] A system 300 includes a catheter 310, a microporous treatment balloon 320, a control assembly 330, and a shielding element 340 (not shown). In an alternative embodiment, the shielding element 340 is not present.

[0101] The Catheter 310

[0102] The catheter 310 includes two or more lumens 311 (not shown) and a translation member 312. The two or more lumens 311 and translation member 312 traverse the entire interior length of the catheter 310. The catheter 310 and lumens 311 are coupled at a distal end to a treatment balloon 320; they are coupled at a proximal end to a control assembly 330. The translation member 312 is coupled to the distal end of the treatment balloon 320; it is coupled at the proximal end to a control assembly 330.

[0103] In a preferred embodiment, the catheter 310 and treatment balloon 320 are introduced into cavity of the body, such as a female urethra and bladder using an introducer sheath 313 or a guide tube 314. In alternative embodiments, the cavity may include one or more of, or some combination of the following:

[0104] any portion of the bronchial system, the cardiovascular system, the genito-urinary tract, the lymphatic system, the pulmonary system, the vascular system, the locomotor system, the reproductive system or other systems in the body;

[0105] any biological conduit or tube, such as a biologic lumen that is patent or one that is subject to a stricture;

[0106] any biologic operational structure, such as a gland, or a muscle or other organ (such as the colon, the diaphragm, the heart, a uterus, a kidney, a lung, the rectum, an involuntary or voluntary sphincter);

[0107] any biologic structure, such as a herniated body structure, a set of diseased cells, a set of dysplastic cells, a surface of a body structure, (such as the sclera) a tumor, or a layer of cells (such as fat, muscle or skin); and

[0108] any biologic cavity or space or the contents thereof, such as a cyst, a gland, a sinus, a layered structure, or a medical device implanted or inserted in the body.

[0109] The Microporous Treatment Balloon 320

[0110] The microporous treatment balloon 320 is comprised of a relatively flexible and heat resistant material such as Kevlar, polyurethane, polyvinyl chloride (PVC), polyamide, PET, nylon or other materials. The shape of the balloon can be manipulated by varying the degree of inflation and the amount of tension placed on the translation member 312. By varying the degree of inflation and the tension on the translation member, the surface of the treatment balloon can be brought in contact with the entire interior surface of the muscles, including the detrusor muscles and the top of the bladder. In this way, it is possible to treat the entire organ simultaneously.

[0111] The treatment balloon 320 also includes a flexible basket-like structure 321 and a set of surface electrodes 322. The basket-like structure 321 has horizontal and vertical members that completely encompass the balloon 320. The set of surface electrodes 322 are evenly distributed on all the

members of the basket-like structure **321**. Each electrode **322** includes a sensor **323** to measure temperature, pressure, impedance, flow, nervous activity, pH, conductivity or other property of the tissue or treatment. Each surface electrode **322** is also coupled to a radiopaque marker **324** for use in fluoroscopic visualization.

[0112] In an alternative embodiment, the surface electrodes **322** and sensors **323** are embedded directly into the exterior surface of the microporous treatment balloon **320**. In this preferred embodiment, the basket-like structure **321** is optional.

[0113] In both the preferred and alternative embodiments, the electrodes **322** can be operated separately or in combination with each other. Treatment can be directed at a single area, several different areas, or the entire interior of a bladder or other orifice by operation of selective electrodes. Different patterns of sub-mucosal lesions, mucosal lesions, ablated, bulked or plumped, desiccated or necrotic regions can be created by selectively operating different electrodes. Production of different patterns of treatment makes it possible to remodel tissues and alter their overall geometry with respect to each other.

[0114] Each electrode **322** can be disposed to treat tissue by delivering one or more of, or some combination or any of the following in either a unipolar or bipolar mode:

- [0115] radiofrequency (RF) energy, such as RF in about the 300 kilohertz to 500 kilohertz range;
- [0116] chemical treatments, such as acids, antibiotics, enzymes, radioactive tracers or other bioactive substances;
- [0117] infrared energy, such as from an infrared laser or diode laser;
- [0118] microwave energy, such as electromagnetic energy in about the 915 megahertz or 2.45 gigahertz range;
- [0119] sonic energy, including ultrasound;
- [0120] photodynamic therapy (PDT);
- [0121] non-infrared laser energy; and
- [0122] cryothermia

[0123] In addition to treating tissues by delivering energy, the set of electrodes **322** and the micropores in the balloon **320** are disposed to deliver at least one flowable substance to the area of the body where treatment is to take place. In a preferred embodiment, the flowable substance includes sterile water, which aids in cooling and hydration of body structures. In other preferred embodiments, the flowable substance includes saline with a concentration of less than about 10% NaCl, which locally enhances tissue conductivity, resulting in selective areas of ablation or creation of thermal lesions at or below the surface of the tissue. However, in alternative embodiments, the deliverable flowable liquids include other substances, including anesthetic drugs, anti-inflammatory agents, chemotherapeutic agents, systemic or topical antibiotics, collagen and radioactive substances such as labeled tracers. In other alternative embodiments, the sensors on the electrodes are used for mapping the foci or pathways of electrical activity in the bladder, the bladder neck or urethra. This information is used to guide delivery of energy.

[0124] In other alternative embodiments, the balloon **320** is not microporous. In this alternative embodiment, electrodes **322** or other energy delivery devices may be mounted upon or proximate to a surface of the balloon.

[0125] The Control Assembly **330**

[0126] The control assembly **330** includes a visualization port **331**, an apparatus port **332**, an electrical energy port **333**, an electrode selection and control switch **334**, one or more irrigation and aspiration control ports **335**, an therapeutic energy port **336** and a handle **337**.

[0127] The visualization port **331** can be coupled to visualization apparatus, such as a fiber optic device, a fluoroscopic device, an anoscope, a laparoscope, an endoscope or other type of catheter.

[0128] The apparatus port **332** can be coupled to other medical devices that may be useful during treatment such as a pH meter, a pressure monitor, drug administration apparatus, or other devices used to monitor or treat the patient.

[0129] In a preferred embodiment, devices coupled to both the visualization port **331** and the apparatus ports **332** are controlled from a location outside the body, such as by an instrument in an operating room or an external device for manipulating the inserted catheter **310**.

[0130] In an alternative embodiment the apparatus port **332** may be coupled to devices that are implanted or inserted into the body during a medical procedure. For example, the apparatus port **332** may be coupled to a programmed AICD (artificial implanted cardiac defibrillator), a programmed glandular substitute (such as an artificial pancreas) or other device for use during surgery or other medical procedures.

[0131] The electrical energy port **333** includes a conductive element such as an electrical adapter that can be coupled to a source of alternating or direct current such as a wall socket, battery or generator.

[0132] The electrode selection and control switch **334** includes an element that is disposed to select and activate individual electrodes **322**.

[0133] The irrigation and aspiration control ports **335** can be coupled to a pump or other apparatus to inflate or deflate the balloon and deliver fluids through the micropores of the treatment balloon **320**.

[0134] The therapeutic energy port **336** includes a receptor port for coupling to a source of any of the following types of therapeutic energy:

- [0135] radio frequency (RF) energy, such as RF in about the 300 kilohertz to 500 kilohertz range;
- [0136] chemical treatments, such as acids, antibiotics, enzymes, radioactive tracers or other bioactive substances;
- [0137] infrared energy, such as from an infrared laser or diode laser; microwave energy, such as electromagnetic energy in about the 915 megahertz or 2.45 gigahertz range;
- [0138] sonic energy, including ultrasound;
- [0139] photodynamic therapy (PDT);



[0140] non-infrared laser energy; and

[0141] cryothermia

[0142] The handle 337 is disposed for manipulated by medical or veterinary personnel and can be shaped for being held in the hand. The visualization port 331, the apparatus port 332, the electrical energy port 333, the electrode selection and control switch 334 and the one or more irrigation and aspiration control ports 335 and the therapeutic energy port 336 are all mounted in the handle 337 to allow for easy operation.

[0143] The Shielding Element 340

[0144] The shielding element 340 lies on the proximal side of the microporous treatment balloon 320 and is disposed to isolate the treatment area. It can also help position the catheter 310 in the body. For example, in a preferred embodiment in which the catheter 310 is inserted into the urethra, the shielding element 340 can prevent the catheter 310 from being inserted further into the urethral canal or bladder and prevent substances used in treatment from escaping. In an alternative embodiment, the shielding element 340 is optional.

[0145] FIG. 4 is a process flow drawing of a method for treatment of female urinary incontinence using a second device.

[0146] A method 400 is performed by a system 300 including a catheter 310, a treatment balloon 320 and a control assembly 330. Although the method 400 is described serially, the steps of the method 400 can be performed by separate elements in conjunction or in parallel, whether asynchronously, in a pipelined manner, or otherwise. There is no particular requirement that the method 400 be performed in the same order in which this description lists the steps, except where so indicated.

[0147] At a flow point 400, electrical energy port 333 is coupled to a source of electrical energy. The patient has voided and is positioned on a treatment table, in an appropriate position such as horizontal, jackknife or lithotomy. Due to the potential for inducing pain, the area surrounding the urinary meatus may be pretreated with a topical anesthetic before insertion of the catheter 310; depending upon the circumstances, a muscle relaxant or short term tranquilizer may be indicated. The position of the patient and choice of pharmaceutical agents to be used are responsive to judgments by medical personnel.

[0148] At a step 401, the patient's external genitalia and surrounding anatomy are cleansed with an appropriate agent such as BETADINE, or benzalkonium chloride.

[0149] At a step 402, the visualization port 431 is coupled to the appropriate visualization apparatus, such as a fluoroscope, an endoscope, a display screen or other visualization device. The choice of visualization apparatus is responsive to judgments by medical personnel.

[0150] At a step 403, the apparatus port 332 is coupled to an external medical device such as a pH meter, a pressure gauge, or other medical equipment. The choice of apparatus is responsive to judgments by medical personnel.

[0151] At a step 404, the therapeutic energy port 336 is coupled to a source of any of the aforementioned types of therapeutic energy.

[0152] In a step 405, suction, inflation or fluid infusion apparatus is coupled to the irrigation and aspiration control ports 335 so that the treatment balloon may be later be inflated and deflated and substances may be administered.

[0153] At a step 406, the most distal end of the treatment balloon 320 is lubricated and introduced into the urethral meatus in an upward and backward direction, in much the same way a Foley catheter is introduced. The choice of lubricant is responsive to judgments by medical personnel. In a preferred embodiment, the balloon 320 is completely deflated during insertion.

[0154] In a step 407, the catheter 310 is threaded through the urethra until the microporous balloon 320 has completely passed the bladder neck and is entirely in the bladder. An introducer sheath 313 or guide tube 314 may also be used to facilitate insertion.

[0155] In a step 408, the position of the catheter 310 is checked using visualization apparatus coupled to the visualization port 331. This apparatus can be continually monitored by medical professionals throughout the procedure.

[0156] In a step 409, the irrigation and aspiration control port 335 is manipulated so as to inflate the microporous treatment balloon 320. In a preferred embodiment, the treatment balloon 320 is inflated with a cooling liquid such as sterile water, saline or glycerin. This cooling fluid lowers the relative temperature of the targeted tissues that are in physical contact and prevents collateral thermal damage. In alternative embodiments, other devices may be coupled to the apparatus port 132 to chill the cooling fluid or cause sonic cooling, gas expansion, magnetic cooling or others cooling methodologies. The choice of cooling fluid or methodology is responsive to judgments by medical personnel.

[0157] In a step 410, electrodes 322 are selected using the electrode selection and control switch 334.

[0158] In a step 411, the translation member 312 is manipulated to alter the shape of the most distal end of the balloon so as to bring the distal end of the balloon in optimal physical contact with the top of the bladder.

[0159] In a step 412, individual nerves within the bladder are identified using sensors 323. This step is optional.

[0160] In a step 413, the therapeutic energy port 336 is manipulated so as to cause a release of energy from the electrodes 322. The duration and frequency of energy are responsive to judgments by medical personnel. This release of energy creates a pattern of lesions in the mucosal or sub-mucosal tissues of the bladder or portions thereof. The affected area shrinks and is relatively strengthened, so as to better retain urine.

[0161] In a step 414, the therapeutic energy port 336 is manipulated, so as to cause a release of energy from the electrodes 322 that is directed at the nerves that were identified in step 412. Manipulation and modulation of these nerves may directly or indirectly affect incontinence related to an uncontrolled urge to urinate. This step is optional.

[0162] In a step 415, bulking agents such as organic microspheres, collagens, silicone, PVC and other organic breathable and unbreathable polymers are exuded from selected electrodes 322 positioned near the base of the bladder. The type of microspheres and bulking substances

and the locations where they are exuded are responsive to judgment by medical personnel. These bulking agents can be used to strengthen these structures so as to prevent incontinence caused by stress.

[0163] In a step 416, pharmaceutical agents may be locally administered by manipulating the irrigation and aspiration control ports 335. These agents may help include lubricants, anesthetics, anti-spasmodics, anti-inflammatories, antibiotics or other agents as deemed appropriate by the judgment of medical personal. This step may occur any time prior to withdrawal of the catheter 310, to either pre-treat tissue or post-treat tissues.

[0164] In a step 417, the irrigation and aspiration control port 335 is manipulated so as to reverse the flow of cooling liquid into the microporous treatment balloon 320 and cause it to deflate.

[0165] In a step 418, the catheter 310 is withdrawn from the urethra.

[0166] FIG. 5 is a block drawing of a system for treatment of female urinary incontinence using a third device.

[0167] A system 500 includes a catheter 510, treatment element 520, a control assembly 530 and a shielding element 540. In an alternative embodiment, the shielding element 540 is not present.

[0168] The Catheter 510

[0169] The catheter 510 includes two or more lumens 511, a translation member 512 and a tapered tip 513. The lumens 511 and translation member 512 run the entire interior length of the catheter 510. The proximal end of the lumens 511 is coupled to the control assembly 530; the distal end of the lumens 511 is coupled to the treatment element 520. It is through these lumens 511 that energy is conducted and flowable substances are exuded. The proximal end of the translation member 512 is coupled to the control assembly 530; the distal end of the translation member 512 is coupled to the taper tip 513.

[0170] In a preferred embodiment, the tapered tip 513 is rigid so as to allow easy insertion into a urethra. In other preferred embodiments, the tapered tip 513 may be of varying degrees of flexibility depending where it in the body it is deployed. In alternative embodiments, the catheter 510 may be introduced into the target tissue using an introducer sheath 514 or a guide wire 515.

[0171] In a preferred embodiment, the tapered tip 513 is disposed for insertion into a cavity of the body such as a female urethra and bladder. In alternative embodiments, the cavity may include one or more of, or some combination of the following:

[0172] any portion of the bronchial system, the cardiovascular system, the genito-urinary tract, the lymphatic system, the pulmonary system, the vascular system, the locomotor system, the reproductive system or other systems in the body;

[0173] any biological conduit or tube, such as a biologic lumen that is patent or one that is subject to a stricture;

[0174] any biologic operational structure, such as a gland, or a muscle or other organ (such as the colon,

the diaphragm, the heart, a uterus, a kidney, a lung, the rectum and or voluntary sphincter);

[0175] any biologic structure, such as a herniated body structure, a set of diseased cells, a set of dysplastic cells, a surface of a body structure, (such as the sclera) a tumor, or a layer of cells (such as fat, muscle or skin); and

[0176] any biologic cavity or space or the contents thereof, such as a cyst, a gland, a sinus, a layered structure, or a medical device implanted or inserted in the body.

[0177] The Treatment Element 520

[0178] The treatment element 520 includes a set of umbrella-like struts 521, a set of electrodes 522, a set of irrigation and aspiration ports 525 and a set of sensors 526. The set of umbrella-like struts 521 are several centimeters long. One end of the struts 521 is not attached to any part of the device. The other end of the strut 521 is coupled to the distal end of the translation member 512 at the tapered tip 513 in such a way that when tension is applied to the proximal end of the translation member 512, the umbrella-like struts 521 open up in much the same way as an umbrella.

[0179] A set of electrodes 522 is evenly distributed on the outer surface of each strut 521. Each free-floating end of a strut 521 includes at least one electrode 522. Each electrode 522 includes a metallic tube 523 defining a hollow lumen 524. In a preferred embodiment, the set of electrodes 522 are needle electrodes; other preferred embodiments include surface electrodes or a combination of needle electrodes and surface electrodes.

[0180] Each electrode 522 is coupled to at least one sensor 526 capable of measuring such factors as temperature, conductivity, pressure, impedance and other variables. In a preferred embodiment, each electrode 522 is also coupled to a radiopaque marker 527 for use in fluoroscopic visualization.

[0181] In a preferred embodiment, the electrodes 522 can be operated separately or in combination with each other. Treatment can be directed at a single area or several different areas of a bladder or other orifice by operation of selected electrodes. Different patterns of sub-mucosal lesions, mucosal lesions, ablated, bulked, plumped, desiccated or necrotic regions can be created by selectively operating different electrodes. Production of different patterns of treatment makes it possible to remodel tissues and alter their overall geometry with respect to each other.

[0182] Each electrode 522 can be disposed to treat tissue by delivering one or more of, or some combination or any of the following in either a unipolar or bipolar mode:

[0183] radiofrequency (RF) energy, such as RF in about the 300 kilohertz to 500 kilohertz range;

[0184] chemical treatments, such as acids, antibiotics, enzymes, radioactive tracers or other bioactive substances;

[0185] infrared energy, such as from an infrared laser or diode laser;

[0186] microwave energy, such as electromagnetic energy in about the 915 megahertz or 2.45 gigahertz range;

[0187] sonic energy, including ultrasound;

[0188] photodynamic therapy (PDT)

[0189] non-infrared laser energy; and

[0190] cryothermia

[0191] In addition to treating tissues by delivering energy, the set of electrodes **522** are disposed to deliver at least one flowable substance to the area of the body where treatment is to take place. In a preferred embodiment, the flowable substance includes sterile water which aides in cooling and hydration of body structures. In another preferred embodiment, the flowable substance includes saline with a concentration of less than about 10% NaCl. Saline is used to increase the local conductivity of tissue, enhancing the penetration of RF energy so as to create larger lesions. The saline can be delivered through the needle electrode sub-mucosally so as to achieve greatest effect. However, in alternative embodiments, the deliverable flowable liquids include other substances, including anesthetic drugs, anti-inflammatory agents, chemotherapeutic agents, systemic or topical antibiotics, collagen and radioactive substances such as labeled tracers.

[0192] A set of irrigation and aspiration ports **525** are also evenly distributed on the outer surface of each strut **521**. Each free-floating end of a strut **521** also includes at least one irrigation and aspiration port **525**. Suction can be applied through these ports so as to bring the targeted tissue in closer physical proximity to the electrodes **522**. The irrigation and aspiration ports **525** can also be used to administer cooling fluids in such a way as to minimize thermal damage. Drugs, bulking agents and other flowable substances can be infused through the irrigation and aspiration ports **525**.

[0193] The Control Assembly **530**

[0194] The control assembly **530** includes a visualization port **531**, an apparatus port **532**, an electrical energy port **533**, an electrode selection and control switch **534**, one or more irrigation and aspiration control ports **535**, a therapeutic energy port **536** and a handle **537**.

[0195] The visualization port **531** can be coupled to visualization apparatus, such as a fiber optic device, a fluoroscopic device, an anoscope, a laparoscope, an endoscope or other type of catheter.

[0196] The apparatus port **532** can be coupled to other medical devices that may be useful during treatment such as a pH meter, a pressure monitor, drug administration apparatus, or other device used to monitor or treat the patient.

[0197] In a preferred embodiment, devices coupled to both the visualization port **531** and the apparatus ports **532** are controlled from a location outside the body, such as by an instrument in an operating room or an external device for manipulating the inserted catheter **510**.

[0198] In an alternative embodiment the apparatus port **532** may be coupled to devices that are implanted or inserted into the body during a medical procedure. For example, the apparatus port **532** may be coupled to a programmed AICD

(artificial implanted cardiac defibrillator), a programmed glandular substitute (such as an artificial pancreas) or other device for use during surgery or other medical procedures.

[0199] The electrical energy port **533** includes a conductive element such as an electrical adapter that can be coupled to a source of alternating or direct current such as a wall socket, battery or generator.

[0200] The electrode selection and control switch **534** includes an element that is disposed to select and activate individual electrodes **522**.

[0201] The irrigation and aspiration control ports **535** can be coupled to a pump or other apparatus to deliver fluid through the irrigation and aspiration ports **525** or electrodes **522** or to apply suction through the set of irrigation and aspiration ports **525**.

[0202] The therapeutic energy port **536** includes a receptor port for coupling to a source of any of the following types of therapeutic energy:

[0203] radiofrequency (RF) energy, such as RF in about the 300 kilohertz to 500 kilohertz range;

[0204] chemical treatments, such as acids, antibiotics, enzymes, radioactive tracers or other bioactive substances;

[0205] infrared energy, such as from an infrared laser or diode laser;

[0206] microwave energy, such as electromagnetic energy in about the 915 megahertz or 2.45 gigahertz range;

[0207] sonic energy, including ultrasound;

[0208] photodynamic therapy (PDT);

[0209] non-infrared laser energy; and

[0210] cryothermia

[0211] The handle **537** is disposed for manipulated by medical or veterinary personnel and can be shaped for being held in the hand. The visualization port **531**, the apparatus port **532**, the electrical energy port **533**, the electrode selection and control switch **534** and the one or more irrigation and aspiration control ports **535** and the therapeutic energy port **536** are all mounted in the handle **537** to allow for easy operation.

[0212] The Shielding Element **540**

[0213] The shielding element **540** lies on the proximal side of treatment element **520** and is disposed to isolate the treatment area. It can also help position the catheter **510** in the body. For example, in a preferred embodiment in which the catheter **510** is inserted into the urethra, the shielding element **540** can prevent the catheter **510** from being inserted further into the urethra canal and prevent substances used in treatment from escaping. In an alternative embodiment, the shielding element **540** is optional.

[0214] FIG. 6 is a process flow drawing of a method for treatment of female urinary incontinence using a third device. Although the method **600** is described serially, the steps of the method **600** can be performed by separate elements in conjunction or in parallel, whether asynchronously, in a pipelined manner, or otherwise. There is no

particular requirement that the method **600** be performed in the same order in which this description lists the steps, except where so indicated.

[0215] A method **600** is performed by a system **500** including a catheter **510**, a treatment element **520** and a control assembly **530**.

[0216] At a flow point **600**, electrical energy port **533** is coupled to a source of electrical energy. The patient has voided and is positioned on a treatment table, in an appropriate position such as horizontal, jackknife or lithotomy. Due to the potential for inducing pain, the area surrounding the urinary meatus may be pretreated with a topical anesthetic before insertion of the catheter **510**; depending upon the circumstances, a muscle relaxant or short term tranquilizer may be indicated. The position of the patient and choice of pharmaceutical agents to be used are responsive to judgments by medical personnel.

[0217] At a step **601**, the patient's external genitalia and surrounding anatomy are cleansed with an appropriate agent such as BETADINE, or benzalkonium chloride.

[0218] At a step **602**, the visualization port **531** is coupled to the appropriate visualization apparatus, such as a fluoroscope, an endoscope, a display screen or other visualization device. The choice of visualization apparatus is responsive to judgments by medical personnel.

[0219] At a step **603**, the apparatus port **532** is coupled to an external medical device such as a pH meter, a pressure gauge, or other medical equipment. The choice of apparatus is responsive to judgments by medical personnel.

[0220] At a step **604**, the therapeutic energy port **535** is coupled to a source of any of the aforementioned types of therapeutic energy.

[0221] In a step **605**, suction, inflation or fluid in fusion apparatus is coupled to the irrigation and aspiration control ports **535** so that cooling fluids and pharmacological agents may be administered.

[0222] At a step **606**, the tapered tip **513** is lubricated and introduced into the urethral meatus in an upward and backward direction, in much the same way a Foley catheter is introduced. The choice of lubricant is responsive to judgments by medical personnel. In a preferred embodiment, the treatment element **520** is completely closed to facilitate insertion.

[0223] In a step **607**, the catheter **510** is threaded through the urethra until the treatment element **520** has completely passed the bladder neck and is entirely in the bladder. An introducer sheath **513** or guide tube **514** may also be used to facilitate insertion.

[0224] In a step **608**, the position of the catheter **510** is checked using visualization apparatus coupled to the visualization port **531**. This apparatus can be continually monitored by medical professionals throughout the procedure.

[0225] In a step **609**, the irrigation and aspiration control port **535** is manipulated so as to exude a cooling fluid. In a preferred embodiment, the cooling fluid may include sterile water, saline or glycerin. This cooling fluid lowers the relative temperature of the targeted tissues that are in physical and prevents collateral thermal damage. In alternative embodiments, other devices may be coupled to the apparatus

port **532** to chill the cooling fluid or cause sonic cooling, gas expansion, magnetic cooling or others cooling methodologies. The choice of cooling fluid or methodology is responsive to judgments by medical personnel.

[0226] In a step **610**, tension is applied to the translation member **512** to cause extension of the struts **522**. Extension of the struts **522** brings the electrodes **522** into physical proximity with the walls of the bladder.

[0227] In a step **611**, the irrigation and aspiration control ports **535** are manipulated so as to apply suction through the irrigation and aspiration ports **525** and bring the walls of the bladder in even closer proximity to the treatment element **520**.

[0228] In a step **612**, electrodes **522** are selected using the electrode selection and control switch **534**. In a preferred embodiment, all electrodes are selected. In another embodiment, individual electrodes may be deployed.

[0229] In a step **613**, individual nerves within the bladder are identified using sensors **526**. This step is optional.

[0230] In a step **614**, the therapeutic energy port **536** is manipulated so as to cause a release of energy from the electrodes **522**. The duration and frequency of energy are responsive to judgments by medical personnel. This release of energy creates a pattern of lesions in the mucosal and/or sub-mucosal tissues of the bladder or portions thereof. The affected area shrinks and is relatively strengthened, so as to better retain urine.

[0231] In a step **615**, the therapeutic energy port **536** is manipulated so as to cause a release of energy from the electrodes **522** that is directed at the nerves that were identified in step **613**. Manipulation and modulation of these nerves may directly or indirectly affect incontinence related to an uncontrolled urge to urinate. This step is optional.

[0232] In a step **616**, bulking agents such as organic microspheres, collagens, silicone, PVC and other organic breathable and unbreathable polymers are exuded from selected electrodes **522** into tissues near the base of the bladder. The type of microspheres and bulking substances and the locations where they are exuded are responsive to judgment by medical personnel. These bulking agents can be used to strengthen these structures so as to prevent incontinence caused by stress. This step is optional.

[0233] In a step **617**, pharmaceutical agents may be locally administered by manipulating the irrigation and aspiration control ports **535**. These agents may help include lubricants, anesthetics, anti-spasmodics, anti-inflammatories, antibiotics or other agents as deemed appropriate by the judgment of medical personnel. This step may occur any time prior to withdrawal of the catheter **510**, either to pre-treat tissue or post-treat tissues.

[0234] In a step **618**, the irrigation and aspiration control port **535** is manipulated so as to reverse the flow of cooling liquid.

[0235] In a step **619**, tension is applied to the translation member **512** to cause the umbrella like struts **521** to collapse and close around the catheter **510**.

[0236] In a step **620**, the catheter **510** is withdrawn from the urethra.

## GENERALITY OF THE INVENTION

[0237] The invention has substantial generality of application to various fields for biopsy or treatment of medical conditions. These various fields include, one or more of, or a combination of, any of the following (or any related fields):

[0238] As noted above, the invention can be used in any area of the body, including the biologic systems and locations noted herein. The invention can be used for the general purpose of reducing, plumping, or reshaping body structures, tissues, or regions of the body otherwise empty (or filled with biologic substances).

[0239] For examples, the invention can be used in one or more of, or some combination of, the following:

[0240] in the head and neck, such as the cheeks, eyes, sinuses, middle ear, nostrils, inner ear, Eustachian tubes, pharynx, larynx, or other structures;

[0241] for the purpose of reforming damaged body parts, for the purpose of reshaping misshapen body parts, dilating occluded tissues, or for cosmetic affects; and

[0242] for the purpose of replacing the volume filled by body parts that are missing, whether due to congenital defect, infection, or surgery.

## ALTERNATIVE EMBODIMENTS

[0243] Although preferred embodiments are disclosed herein, many variations are possible which remain within the concept, scope, and spirit of the invention, and these variations would become clear to those skilled in the art after perusal of this application.

## 1. A method comprising steps of:

inserting a catheter into a body at a selected location;

positioning at least one electrode and irrigation and aspiration port in said body so that one or more electrodes are proximate to the tissue to be treated;

allowing passage of a flowable substance through said one surface; and

delivering any of energy and chemical treatment from at least one electrode proximate to said one surface.

2. A method as in claim 1, including a step of independently controlling at least a first and a second in a sequence of electrodes included in said at least one electrode.

3. A method as in claim 1, including a step of inserting said catheter either laparoscopically or manually into said selected location, using a guidewire introducer sheath if necessary.

4. A method as in claim 1, wherein said applied energy includes one or more of:

Rf energy at about 300 to about 500 kilohertz;

photodynamic therapy;

microwave energy in about the 915 megahertz to 2.45 gigahertz range;

sonic energy; and

infrared;

and wherein said chemical treatment includes one or more of:

enzymes;

acid-base reactions;

radioactive tracers; and

chemical desiccants.

5. A method as in claim 1, including a step of providing a liquid-tight seal in a region proximate to said selected location.

6. A method as in claim 5, wherein said step of providing a liquid-tight seal uses a shielding element, said element including any of an inflatable balloon, a sponge and a polymer shield.

7. A method as in claim 1, including a step of aspirating said tissue so as to conform it to the at least one electrode.

8. A method as in claim 1, including a step of delivering electromagnetic energy from said selected location to a location outside said body.

9. A method as in claim 1, wherein said step of delivering energy includes a step of providing at least one of:

an electromagnetic impedance sensor;

an optical sensor;

a conductivity sensor;

a pH sensor;

a pressure sensor;

a temperature sensor; and

a sensor that detect nervous activity.

10. A method as in claim 1, including a step of regulating a temperature proximate to said selected location.

11. A method as in claim 10, wherein said step of regulating uses a chilled liquid disposed proximate to said one surface or the interior of said balloon.

12. A method as in claim 10, wherein said step of regulating relies upon the volume of the said chilled liquid to shape said balloon so as to occupy the interior of said body cavity and bring said at least one electrode into proximity with said body cavity.

13. A method as in claim 12, including a step of manipulating a pullwire to alter the shape of said balloon to bring said at least one electrode into proximity with said body cavity.

14. A method as in claim 1, including a step of manipulating a pullwire to alter the position of a set of umbrella-like struts to bring said at least one electrode into proximity with said body cavity.

15. A method as in claim 1, including a step of delivering a flowable substance to said selected location, said flowable substance being responsive to any of said energy and chemical treatment.

16. A method as in claim 15, including a step of eliciting a selected response to any of said energy and chemical treatment.

17. A method as in claim 16, said step of eliciting said selected response including any of the steps of:

receiving any of said energy and chemical treatment for any of ablation, coating, expansion, plumping, shaping and shrinking tissue;

mapping position of nerves and stimulating them;

shrinking a sphincter by creating a pattern of thermal lesions;

reducing compliance or stiffness in a tissue;

reducing strain on a tissue by changing the relative geometry thereof; and

delivering a drug.

**18.** A method as in claim 1, including a step of controlling application of said energy and/or chemical treatment within an interior region of a body cavity.

**19.** A method as in claim 18, wherein said step of controlling application includes a step of distributing said energy and/or chemical treatment uniformly in said interior region.

**20.** A method as in claim 1, including a step of delivering a flowable substance from outside the body to said selected location.

**21.** A method as in claim 20, wherein said flowable substance includes at least one of: a drug, a gas, a radioisotope, an analgesic, an antibiotic, an antiinflammatory, an anti-spasmodic and a bulking agent.

**22.** A method as in claim 21, wherein said bulking agent comprises any of:

microbeads suspended in a delivery vehicle;

glycerin; and

saline.

**23.** A method as in claim 1, wherein said selected location is disposed within a human being or other mammal; and said energy and/or chemical treatment is delivered proximate to said selected location to a sphincter, to muscle tissue, or to nerve tissue.

**24.** A method as in claim 23, wherein said sphincter or tissue is proximate to a bladder, esophagus, uterus, fallopian tube or vas deferens, sinus cavity, aorta, larynx, or pharynx.

**25.** A method as in claim 23, wherein the sphincter or tissue includes any of: the trigone area of a bladder, the detrusor muscles of a bladder, the bladder neck and the urethra and nerves that inform any of said trigone area, said detrusor muscles, said bladder neck and said urethra.

\* \* \* \* \*

专利名称(译)	通过应用能量和药物治疗尿失禁和其他疾病		
公开(公告)号	<a href="#">US20040186468A1</a>	公开(公告)日	2004-09-23
申请号	US10/769153	申请日	2004-01-29
[标]申请(专利权)人(译)	EDWARDS STUART D		
申请(专利权)人(译)	EDWARDS STUART D.		
当前申请(专利权)人(译)	NOVASYS MEDICAL , INC.		
[标]发明人	EDWARDS STUART D		
发明人	EDWARDS, STUART D.		
IPC分类号	A61N1/36 A61B17/00 A61B17/22 A61B18/00 A61B18/02 A61B18/12 A61B18/14 A61B18/18 A61B18/24 A61B19/00 A61M25/00 A61N5/04 A61N5/06 A61N7/02		
CPC分类号	A61B1/32 A61N7/02 A61B18/1477 A61B18/1492 A61B18/18 A61B18/24 A61B2017/00084 A61B2017/22062 A61B2018/00214 A61B2018/0022 A61B2018/00267 A61B2018/00494 A61B2018/00505 A61B2018/00517 A61B2018/00523 A61B2018/00654 A61B2018/00791 A61B2018/00797 A61B2018/00898 A61B2018/1467 A61B2018/1472 A61B2019/4036 A61B2019/5217 A61B2218/002 A61B2218/007 A61N5/0601 A61N5/062 A61B18/02 A61B2090/0436 A61B2090/3614		
其他公开文献	US7326235		
外部链接	<a href="#">Espacenet</a> <a href="#">USPTO</a>		

## 摘要(译)

本发明提供了一种治疗身体部位疾病的方法和系统。特定治疗可以包括一种或多种或一些组合：消融，神经调节，三维组织整形，药物递送，映射刺激，收缩和通过改变其几何形状和减少特定界定区域的体积来减少结构上的应变。特定的身体结构或组织可包括一个或多个区域或某些区域的组合，包括：膀胱，食道，阴道，阴茎，喉，咽，主动脉弓，腹主动脉，胸主动脉，大肠，小肠，窦，耳道，子宫，输精管，气管和所有相关的括约肌。可以应用的能量类型包括射频，激光，微波，红外波，超声波或它们的一些组合。可以施用的物质的类型包括诸如镇痛药，抗生素和抗炎药的药剂，诸如生物非反应性颗粒的填充剂，冷却流体，或用于基于冷冻的治疗的液体氮等干燥剂。

