



US 20190274666A1

(19) **United States**

(12) **Patent Application Publication**
Gomez et al.

(10) **Pub. No.: US 2019/0274666 A1**

(43) **Pub. Date: Sep. 12, 2019**

(54) **BALANCED ERGONOMIC SURGICAL HANDLE**

Publication Classification

(71) Applicant: **Innerspace Surgical Corporation,**
Coconut Creek, FL (US)

(51) **Int. Cl.**
A61B 17/00 (2006.01)

(72) Inventors: **Ricardo Alexander Gomez,**
Lighthouse, FL (US); **Sandy Lawrence Heck,** Los Angeles, CA (US); **Eric William Conley,** South Berwick, ME (US)

(52) **U.S. Cl.**
CPC **A61B 17/00** (2013.01); **A61M 25/0136** (2013.01); **A61B 2017/00424** (2013.01); **A61B 2017/00292** (2013.01)

(73) Assignee: **Innerspace Surgical Corporation,**
Coconut Creek, FL (US)

(57) **ABSTRACT**

(21) Appl. No.: **16/293,887**

(22) Filed: **Mar. 6, 2019**

Related U.S. Application Data

(60) Provisional application No. 62/639,081, filed on Mar. 6, 2018.

An ergonomic medical device handle which allows for multiple type grip styles and reduces operator fatigue by balancing the weight of the device about a fulcrum point. More particularly a laparoscopic suction irrigation device having its tubing centrally located to allow the handle to rest comfortably and balanced on the hand in any of the commonly used grips. This dramatically reduces the fatigue associated with holding devices for long periods of time.

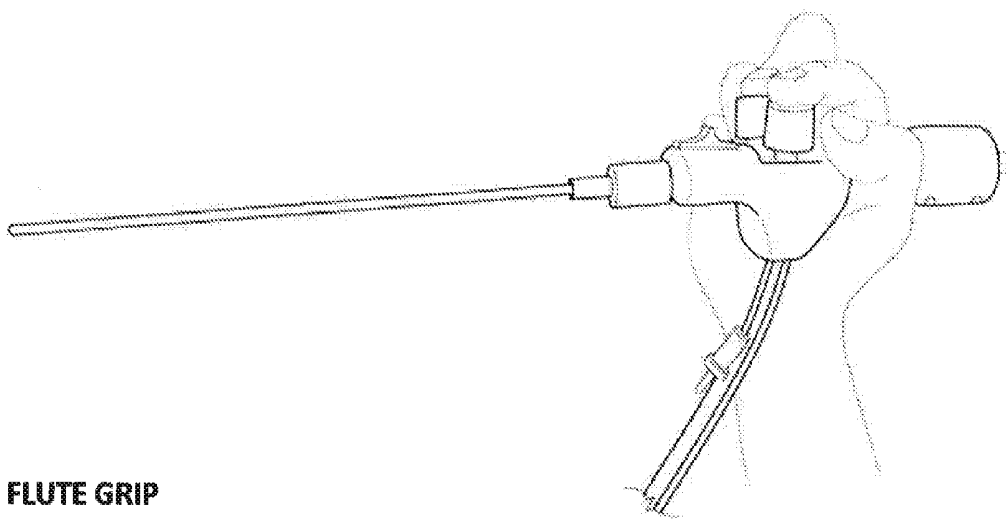

FLUTE GRIP

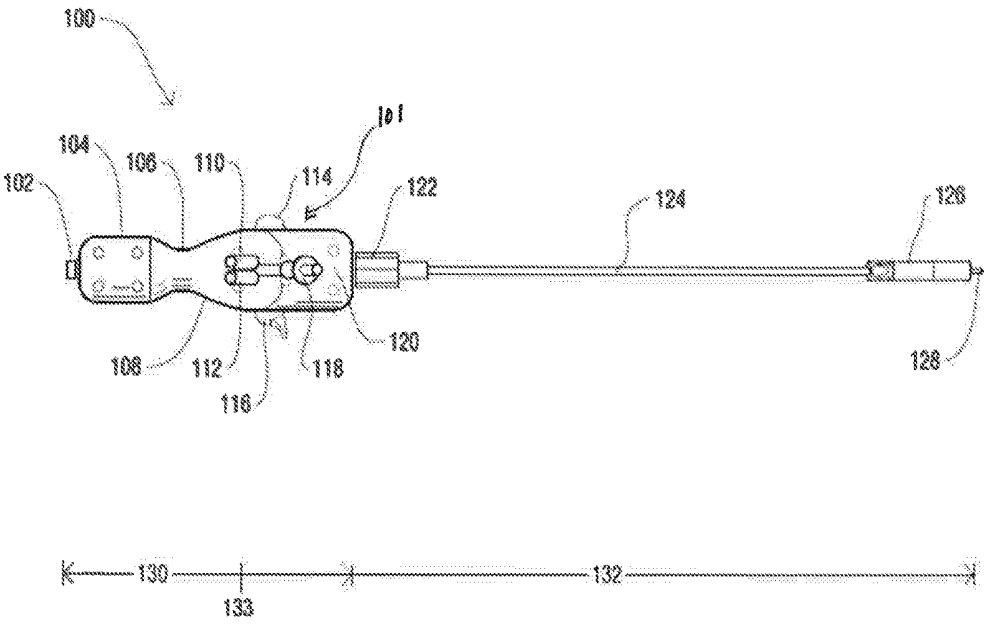

FIG. 1

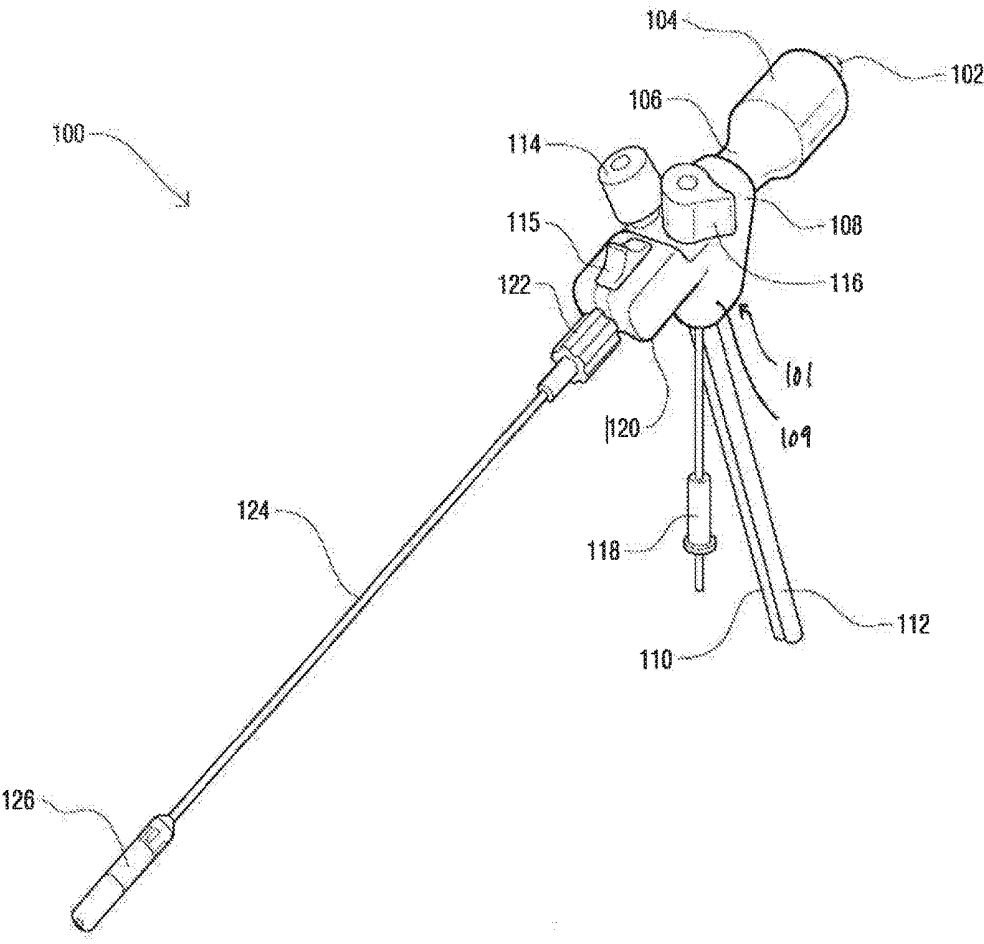

FIG. 2

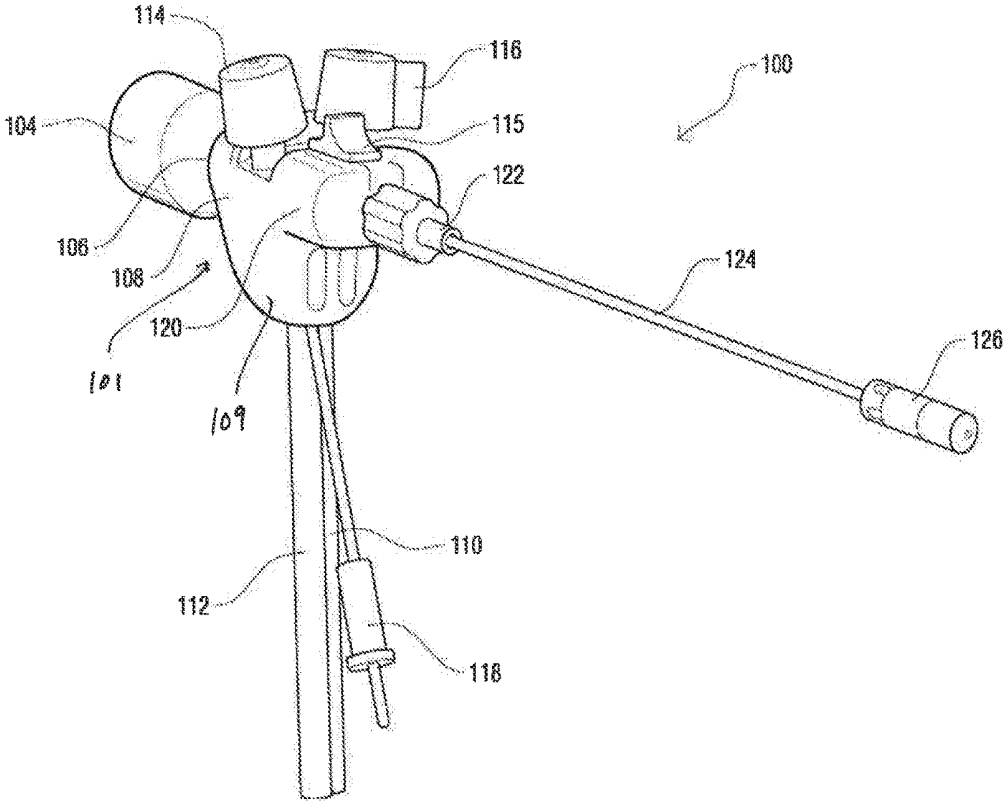
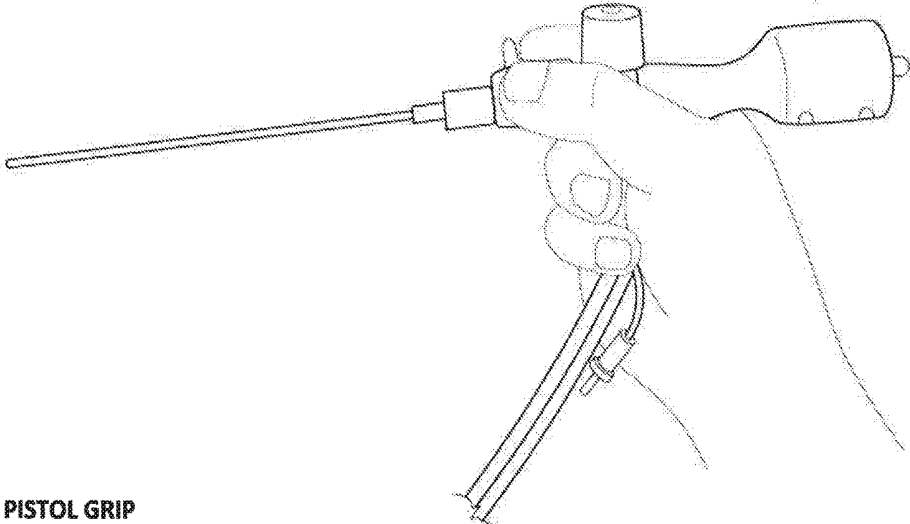
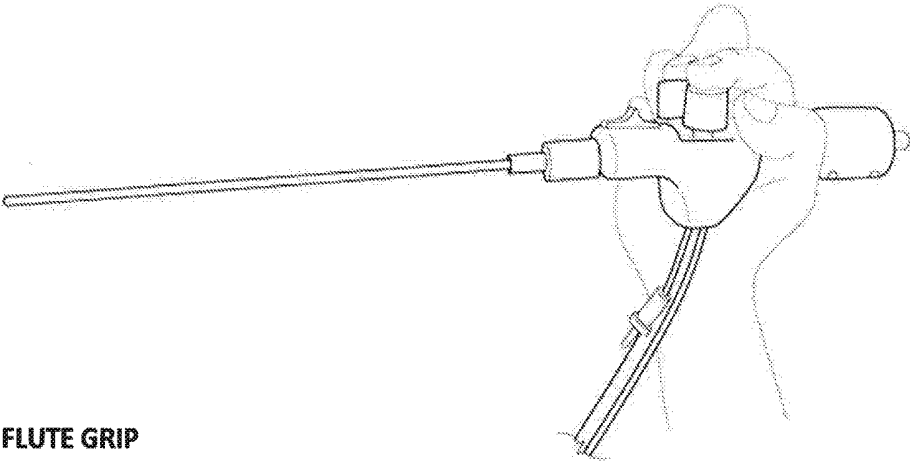

FIG. 3



PISTOL GRIP

FIG. 4A



FLUTE GRIP

FIG. 4B

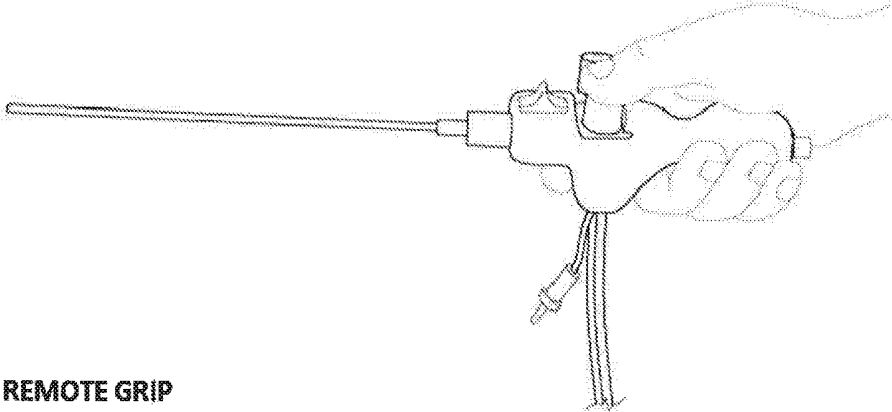

REMOTE GRIP

FIG. 5A

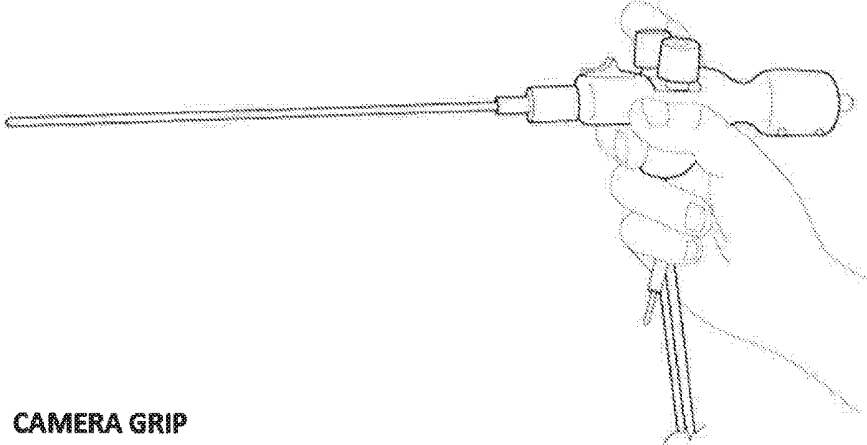

CAMERA GRIP

FIG. 5B

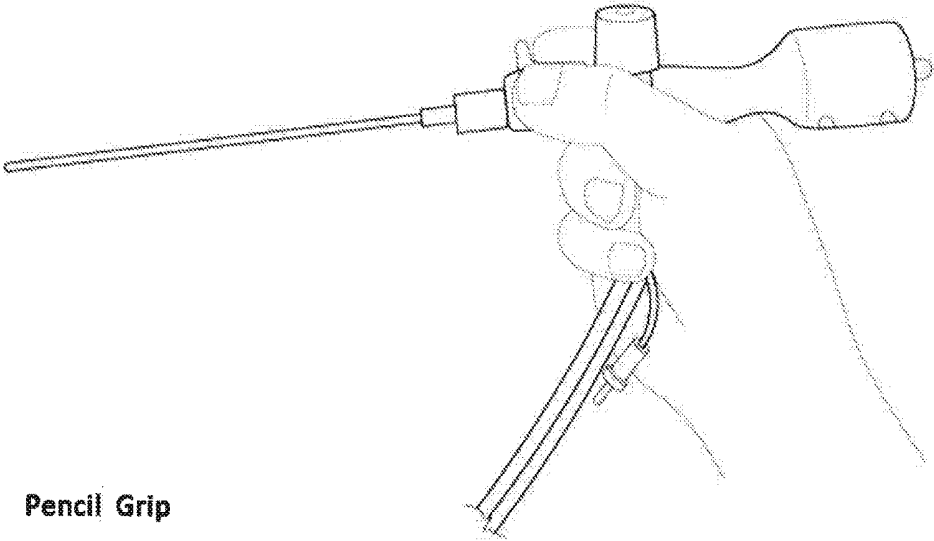

FIG. 6

BALANCED ERGONOMIC SURGICAL HANDLE

CROSS-REFERENCE TO RELATED APPLICATIONS

[0001] This application claims the priority benefit of U.S. Provisional Patent Application No. 62/639,081 filed on Mar. 6, 2018, entitled “Balanced Ergonomic Surgical Handle” of Ricardo Alexander Gomez, Sandy Lawrence Heck, Eric William Conley, hereby incorporated by reference for all that is disclosed as though fully set forth herein.

FIELD OF THE INVENTION

[0002] The present invention relates to surgical instruments and, more specifically, to a balanced, weighted suction irrigator device used in laparoscopic surgery having an ergonomic handle. The balanced ergonomic surgical handle is designed to minimizing fatigue to the user and to accommodate multiple grip styles.

BACKGROUND OF THE INVENTION

[0003] The use of medical instruments is a necessity in modern surgery. Many of the surgical procedures performed today are laparoscopic in nature. Laparoscopy, which is a form of endoscopy, is performed in the abdomen of a patient through small holes made in the abdominal wall. Due to the small ports used, specialized tools are required.

[0004] Studies have shown that as laparoscopic techniques develop, greater demands are placed on surgeons. Poorly designed laparoscopic tools increase physician fatigue, particularly of the hands. Accordingly, there will always be a need for well designed handles especially as advances in technology continue. A good understanding of handle designs is important for many reasons. In surgical procedures, it is important to consider the efficiency, safety, and accommodation to the intended user. Is the user sitting down, standing or moving? Determination must also be taken as to whether the handles need to be small, large, soft, stiff, sharp or extra safe. In addition, when dealing with robotics, special consideration must to be taken to help plan a good working relation. The interface between the desired result and the hand of the user is a considerable factor. A handle that is not accommodating can result in unnecessary fatigue and may be inefficient to use.

[0005] Suction/irrigator devices are one type of instrument used in laparoscopic surgeries, and have an elongated shaft that is adapted to pass through the lumen of a trocar, and long tubes attached to them that are used for administering or removing fluids encountered during surgery. The tubes are typically adjoined and located at the proximal end of the device. Surgical procedures may take hours to perform, and often require a person to hold the instrument in place. The longer the procedure the longer the fatigue caused on the hands.

[0006] Existing suction/irrigator devices typically use rigid elongated shafts that are inserted through a trocar and adapted to be coupled to a suction/irrigation source used for flushing liquid such as saline inside the abdomen. Its main purpose is to irrigate or evacuate bodily fluids from an abdominal area. The knobs that activate the action are usually spring loaded to a valve. The device is commonly held throughout the procedure; when the knobs are depressed by the finger actions, they provide a suction or

irrigation action. Most such devices are designed to be used like a trumpet, or pistol, with the problem being that the connected tubing pulls the handle in different directions, particularly upwardly. Accordingly, during surgical procedures surgeons counter-balance the upward motion of such devices by pushing down with force, which can cause fatigue over the course of the procedure.

[0007] Further to the above, depending on the type of instrument and on the surgeon’s personal preference, different grip styles can be needed, requiring that current instruments be offered with different handles to accommodate different grips such as, for example, “Pistol Grip”, “Flute Grip”, “Remote Grip”, “Camera Grip” and “Pencil Grip”. This is costly and burdensome for hospitals, since they must stock multiple versions of each instrument and keep track of which surgeon needs which type of handle.

[0008] In view of the above, there is a need for an ergonomic surgical handle that minimizes operator fatigue and accommodates or provides for a variety of different grip positions.

SUMMARY OF THE INVENTION

[0009] It is an object of the present invention to provide an ergonomically balanced handle that can be used in laparoscopic surgery.

[0010] A further object of the invention is to provide a light-weight handle that reduces the fatigue on the hands of the holder, caused by the weight of the suction/irrigation tubing pulling on the device.

[0011] A further object of the invention is to provide a handle shape that allows the user to grip the handle in several of the different methods/styles commonly used during laparoscopy, including, but not limited to, the “Pistol Grip”, “Flute Grip”, “Remote Grip”, “Camera Grip” and “Pencil Grip”.

[0012] A further object of the invention is to provide an ergonomic handle having a “universal” handle shape that accommodates all of the most common types of grips, and which has buttons positioned in a way that allows the fingers to access them in all the different grip positions. The tubing is positioned in a way that allows it to be incorporated into the grip, rather than interfere with it. The handle also has a space for the pulcrue of the hand to fit, so that the handle can rest comfortably and securely in the hand.

[0013] The present invention overcomes the deficiencies of the known art and the problems that remain unsolved by providing an ergonomically balanced medical device that fits comfortably in the user’s hand and reduces the fatigue associated with prolonged use in this unbalanced position over an extended period of time. These and other aspects, features, and advantages of the present invention will become more readily apparent from the attached drawings and the detailed description of the preferred embodiments, which follow.

BRIEF DESCRIPTION OF THE DRAWINGS

[0014] The preferred embodiments of the invention will hereinafter be described in conjunction with the appended drawings provided to illustrate and not to limit the invention, in which:

[0015] FIG. 1 presents a bottom perspective view of an exemplary suction/irrigation device.

[0016] FIG. 2 presents a top left side, perspective view of the exemplary suction irrigator device.

[0017] FIG. 3 presents a side perspective view of the exemplary suction irrigator device.

[0018] FIG. 4A presents a perspective view of the Pistol Grip.

[0019] FIG. 4B presents a perspective view of the Flute Grip.

[0020] FIG. 5A presents a perspective view of the Remote Grip.

[0021] FIG. 5B presents a perspective view of a Camera Grip.

[0022] FIG. 6 presents a perspective view of the Pencil Grip.

[0023] Like reference numerals refer to like parts throughout the several views of the drawings.

DETAILED DESCRIPTION

[0024] The following detailed description is merely exemplary in nature and is not intended to limit the described embodiments or the application and uses of the described embodiments. As used herein, the word “exemplary” or “illustrative” means “serving as an example, instance, or illustration.” Any implementation described herein as “exemplary” or “illustrative” is not necessarily to be construed as preferred or advantageous over other implementations. All of the implementations described below are exemplary implementations provided to enable persons skilled in the art to make or use the embodiments of the disclosure and are not intended to limit the scope of the disclosure, which is defined by the claims. For purposes of description herein, the terms “upper”, “lower”, “left”, “rear”, “right”, “front”, “vertical”, “horizontal”, and derivatives thereof shall relate to the invention as oriented in FIG. 1. Furthermore, there is no intention to be bound by any expressed or implied theory presented in the preceding technical field, background, brief summary or the following detailed description. It is also to be understood that the specific devices and processes illustrated in the attached drawings, and described in the following specification, are simply exemplary embodiments of the inventive concepts defined in the appended claims. Hence, specific dimensions and other physical characteristics relating to the embodiments disclosed herein are not to be considered as limiting, unless the claims expressly state otherwise.

[0025] An ergonomic laparoscopic device 100 is presented in various configurations in the illustrations of FIGS. 1 through 3. As shown therein, the laparoscopic device includes a main body 101 having a top, a bottom, and opposed first and second sides. The main body 101 includes a flared, first resting area 108, a second resting area 120 forward of the first resting area 108, and a downwardly depending weighted area 109, the purposes of which will be described hereinafter. The device 100 further includes a ballast or balancer element 104 connected to the rear of the main body 101 through a recessed or narrow portion 106 (also referred to herein as recessed hand purlicue area 106). The recessed hand purlicue area 106 has a reduced cross-sectional area as compared to the ballast 104 and main body 101.

[0026] In an embodiment, the ballast 104 has an elongated ellipsoid shape, although other configurations are also possible without departing from the broader aspects of the invention. As discussed below, the length of the ballast 104

may be selected to provide for optimal balancing of the laparoscopic device. In some embodiments, the length of the ballast 104 is variable or adjustable to provide proper balancing. The ballast 104 may be held in place by 4 screws attaching the bottom half to the top half, although other attachment means are also possible.

[0027] With further reference to FIGS. 1-3, the laparoscopic device 100 includes a shaft connector 122 that connects an elongated shaft 124 to the main body 101. The elongated shaft 124 is configured to receive a head 126 having a distal tip. As best shown in FIGS. 2 and 3, suction tubing 110 and irrigation tubing 112, as well as a cauterizing plug 118 are connected to the main body 101, preferably at the bottom/underside thereof (e.g., through the weighted area 109). A suction knob 114 and an irrigation knob 116 are located atop the main body 101 and are actuable via an index finger and thumb of a user to control the suction and irrigation functions of the device 100.

[0028] With reference to FIGS. 4A-6, the recessed hand purlicue area 106 provides a resting area for the hand of the user, and the flared resting area 108 puts into communication the purlicue area 106 of the hand with the laparoscopic device 100, for better gripping and comfort. In particular, the recessed purlicue area 106 permits the hand to rest comfortably, while the flared resting area 108 helps draw the device 100 to the hand. Importantly, therefore, the laparoscopic device 100 is designed in such a way that it comfortably rests in the hand of the user.

[0029] Referring once again to FIG. 1, the main body 101 encompasses the hand holding area 130 which is used to balance the distal area 132 of the laparoscopic device 100. The laparoscopic device 100 pivots slightly downward about its fulcrum located near the tubing area (i.e., the area where the suction tubing 110 and irrigation tubing 112 connect to the main body 101), thereby allowing the weight of the tubing to pull down centrally, increasing stability in the hand. This is in contrast to most existing suction irrigators, which position the suction irrigation tubing at the rear of the device which causes the tip of the device to tilt upward. This upward action forces the person holding the device to grasp it tighter and counter balance it downwards, which may not seem like much effort, but after 30 minutes or so it can start putting a strain on the hand.

[0030] Importantly, and as perhaps best shown in FIGS. 2 and 3, the suction tubing 110, irrigation tubing 112, and cauterizing plug 118 are all adjoined, helping to provide a center of balance. The main body 101 and ballast 104 (i.e., the portion of the device denoted by reference numeral 130 in FIG. 1) balances the distal body 132 of the laparoscopic device 100 at its fulcrum point near the tubing area. As indicated above, the elongated ellipsoid shaped balancer 104 can be designed longer to properly balance longer elongated shafts 124.

[0031] Referring once again to FIG. 3, a side perspective view of the laparoscopic device 100 is illustrated showing how the device is in a slightly downward tilt. This downward tilt helps keep the fingers comfortably situated in the resting area 120 with little to no effort. The elongated ellipsoid shaped balancer 104 is configured to help balance the weight of the distal area 132 of FIG. 1. As the weight of the distal area 132 changes due to a longer or shorter elongated shaft 124, the elongated ellipsoid shaped balancer, i.e., ballast 104, is designed to counter balance the weight. The suction tubing 110, irrigation tubing 112 and cauterizing plug con-

nector **122** are all situated about the fulcrum point **133** of FIG. 1. The fulcrum point **133** is an invisible vertical line where equilibrium of the laparoscopic device **100** is located. The suction knob **114**, irrigation knob **116**, and inner shaft controller **115** are all located along the fulcrum point **133**. The area between the shaft connector **122** and the distal tip of the head **126** (e.g., peanut ablation head **126**), produces a downward force to the main body **101**.

[0032] In an embodiment, the suction knob **114** and suction tubing **112** are color coded to easily distinguish which knob works with which tubing. The cauterizing plug connector **118** is color coded different, such as, for example, the color red, to indicate that an electrical current will flow through it. The current path will follow a metal rod (not shown) located inside the elongated shaft **124** to a spatula tip, of FIG. 1.

[0033] The main body **101** defining the handle of the device **100** is preferably made of, but not limited to, polycarbonate materials which have excellent heat resistance properties that can be combined with flame retardant materials without significant material degradation. The polycarbonate material is also excellent in its light weight characteristics. The handle design does not have to be limited to suction/irrigation devices, but could be used on any laparoscopic instrument to improve ergonomics and accommodate a wider variety of grips.

[0034] While the above description provides examples of the embodiments, it will be appreciated that some features and/or functions of the described embodiments are susceptible to modification without departing from the spirit and principles of operation of the described embodiments. Accordingly, what has been described above has been intended to be illustrative of the invention and non-limiting and it will be understood by persons skilled in the art that other variants and modifications may be made without departing from the scope of the invention as defined in the claims appended hereto. The scope of the claims should not be limited by the preferred embodiments and examples, but should be given the broadest interpretation consistent with the description as a whole.

What is claimed is:

1. An ergonomic laparoscopic device, comprising:
 - a main body having a tubing area for the connection of tubing to the laparoscopic device;
 - an elongated shaft having a head having a distal tip, the elongated shaft extending forward from the main body; and
 - a ballast extending rearward from the main body and being configured to counterbalance the weight of the elongated shaft.
2. The laparoscopic device of claim 1, wherein:
 - the main body includes a fulcrum located towards a bottom of the main body, wherein the fulcrum comprises a weight that pulls down centrally on the laparoscopic device.
3. The laparoscopic device of claim 1, further comprising:
 - a recessed hand purlicue area intermediate the ballast and the main body.
4. The laparoscopic device of claim 3, wherein:
 - the main body includes a first flared resting area and a second resting area forward of the first flared resting area.

5. The laparoscopic device of claim 1, further comprising:
 - a suction knob and an irrigation knob located towards a top portion of the main body; and
 - a suction tubing adjoined to an irrigation tubing located at the tubing area.
6. The laparoscopic device of claim 5, wherein:
 - the suction knob and the irrigation knob are actuatable with an index finger and thumb.
7. The laparoscopic device of claim 1, wherein the main body is formed from a polycarbonate material having heat resistant properties.
8. The laparoscopic device of claim 7, wherein:
 - the material is a flame-retardant material.
9. The laparoscopic device of claim 5, further comprising:
 - a cauterizing plug.
10. The laparoscopic device of claim 9, wherein:
 - the cauterizing plug, suction tubing, and irrigation tubing are situated about a fulcrum point on the main body.
11. The laparoscopic device of claim 1, wherein the head is a peanut ablation head.
12. The laparoscopic device of claim 1, wherein:
 - the suction knob, suction tubing, and cauterizing plug connector are colored; and
 - wherein the suction knob is a different color than the cauterizing plug connector.
13. An ergonomic laparoscopic device comprising:
 - a main body comprising:
 - a top, a first side, a second side, and a bottom;
 - an elongated ellipsoid shaped balancer along a proximal end of the laparoscopic device, wherein the elongated shaped balancer is configurable to shorter or longer length for proper balancing of the laparoscopic device;
 - a hand holding area comprising a handle, the handle comprising a recessed hand purlicue area and a flared resting area;
 - a suction knob, an irrigation knob, and an inner shaft controller located towards a top portion of the laparoscopic device;
 - a suction tubing adjoined to an irrigation tubing located at a balancing area of the laparoscopic device;
 - a tubing area and a fulcrum located towards the bottom of the main body, wherein the fulcrum comprises fulcrum point and a weight that pulls down centrally on the laparoscopic device;
 - a cauterizing plug connector comprising a capability to conduct electrical current;
 - a shaft connecting an elongated shaft to the main body, wherein the elongated shaft comprises a head;
 - the elongated shaft comprising a metal rod located inside the elongated shaft capable of conducting electrical current; and
 - the head comprising a distal tip.
14. The laparoscopic device of claim 13, wherein the suction knob and the irrigation knob are situated on a top portion of the laparoscopic device and are actuated with an index finger and thumb.
15. The laparoscopic device of claim 13, wherein the handle comprises a polycarbonate material that comprises heat resistance properties.
16. The laparoscopic device of claim 13, wherein the handle comprises at least one flame retardant material.
17. The laparoscopic device of claim 13, wherein the elongated ellipsoid shaped balancer counter-balances the weight of the elongated shaft connected to the main body.

18. The laparoscopic device of claim **13**, wherein the cauterizing plug connector located at the balancing area of the laparoscopic device.

19. The laparoscopic device of claim **18**, wherein the cauterizing plug, suction tubing, and irrigation tubing are situated about the fulcrum point on the main body.

20. The laparoscopic device of claim **13**, wherein the elongated shaped balancer is ellipsoid shaped.

21. The laparoscopic device of claim **13**, wherein the cauterizing plug connector is colored red.

* * * * *

专利名称(译)	平衡符合人体工程学的手术手柄		
公开(公告)号	US20190274666A1	公开(公告)日	2019-09-12
申请号	US16/293887	申请日	2019-03-06
[标]申请(专利权)人(译)	公司内部的手术		
申请(专利权)人(译)	INNERSPACE手术CORPORATION		
当前申请(专利权)人(译)	INNERSPACE手术CORPORATION		
[标]发明人	GOMEZ RICARDO ALEXANDER HECK SANDY LAWRENCE CONLEY ERIC WILLIAM		
发明人	GOMEZ, RICARDO ALEXANDER HECK, SANDY LAWRENCE CONLEY, ERIC WILLIAM		
IPC分类号	A61B17/00		
CPC分类号	A61B2017/00424 A61B17/00 A61B2017/00292 A61M25/0136 A61B17/00234 A61B18/1482 A61B90/92 A61B2018/00595 A61B2217/007 A61B2218/002 A61B2218/007		
优先权	62/639081 2018-03-06 US		
外部链接	Espacenet USPTO		

摘要(译)

符合人体工程学的医疗设备手柄，通过平衡设备围绕支点的重量，可实现多种类型的抓握方式并减轻操作员疲劳。更具体地说，腹腔镜抽吸装置具有位于中心位置的管，以允许手柄在任何常用手柄中舒适地平衡并且在手上平衡。这大大减少了长时间保持装置的疲劳。

