



US 20190029661A1

(19) **United States**

(12) **Patent Application Publication**  
**Widenhouse et al.**

(10) **Pub. No.: US 2019/0029661 A1**  
(43) **Pub. Date: Jan. 31, 2019**

(54) **SURGICAL BOWEL RETRACTOR DEVICES**

*A61B 17/115* (2006.01)

(71) Applicant: **Ethicon LLC**, Guaynabo, PR (US)

*A61B 17/00* (2006.01)

(72) Inventors: **Tamara Widenhouse**, Clarksville, OH (US); **Frederick E. Shelton, IV**, Hillsboro, OH (US)

(52) **U.S. Cl.**

*A61B 17/34* (2006.01)

(21) Appl. No.: **16/150,589**

(22) Filed: **Oct. 3, 2018**

CPC *A61B 17/0293* (2013.01); *A61B 2017/00353* (2013.01); *A61B 17/068* (2013.01); *A61B 17/072* (2013.01); *A61B 17/1155* (2013.01); *A61B 17/00234* (2013.01); *A61B 2017/00477* (2013.01); *A61B 2017/00287* (2013.01); *A61B 17/3417* (2013.01); *A61B 2017/0225* (2013.01); *A61B 2017/0287* (2013.01); *A61B 2017/07257* (2013.01); *A61B 2560/0443* (2013.01); *F04C 2270/0421* (2013.01); *A61B 17/0218* (2013.01)

**Related U.S. Application Data**

(63) Continuation of application No. 14/788,923, filed on Jul. 1, 2015, now Pat. No. 10,130,352, which is a continuation of application No. 13/181,827, filed on Jul. 13, 2011, now Pat. No. 9,089,330.

(57)

**ABSTRACT**

Bowel retractor devices. In various forms, the bowel retractor devices are configurable from a collapsed position wherein the retractor may be inserted through a trocar cannula or other opening in a patient's body to a second expanded position wherein at least a portion of the patient's bowel may be advantageously supported in a desired position.

**Publication Classification**

(51) **Int. Cl.**

*A61B 17/02* (2006.01)  
*A61B 17/068* (2006.01)  
*A61B 17/072* (2006.01)

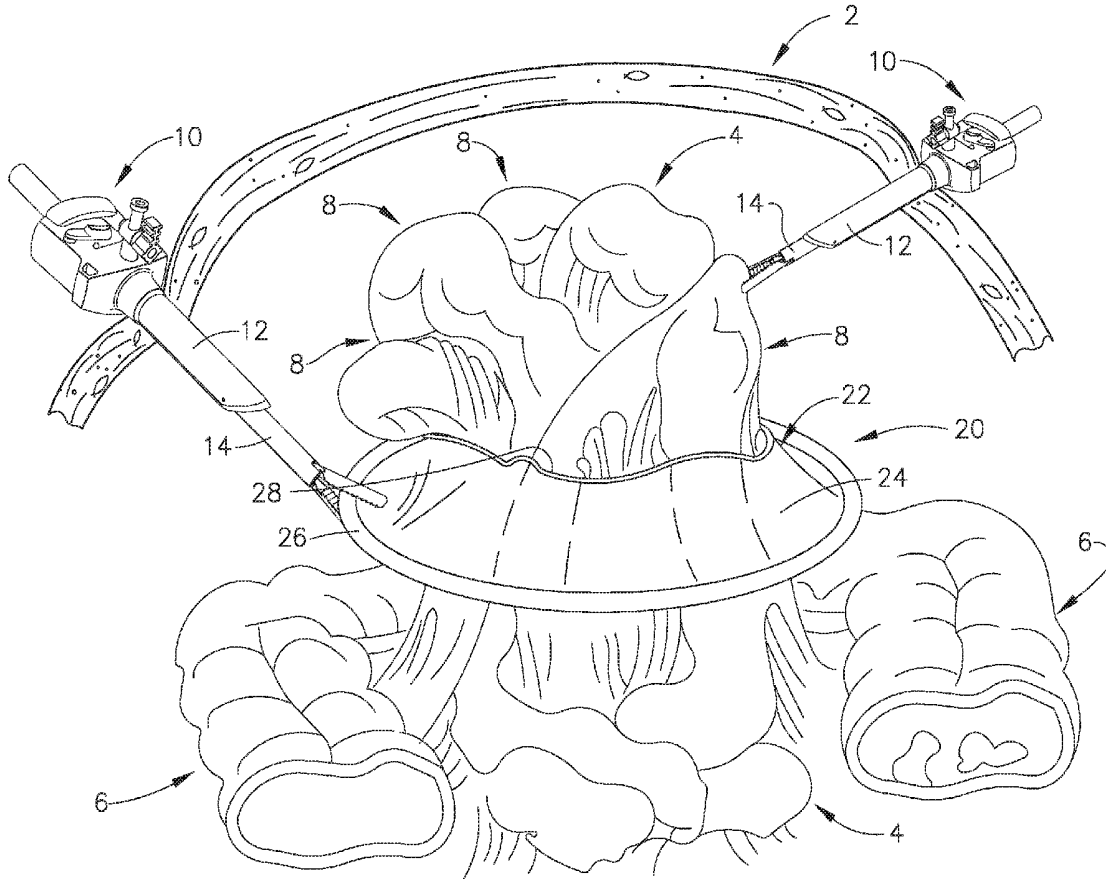

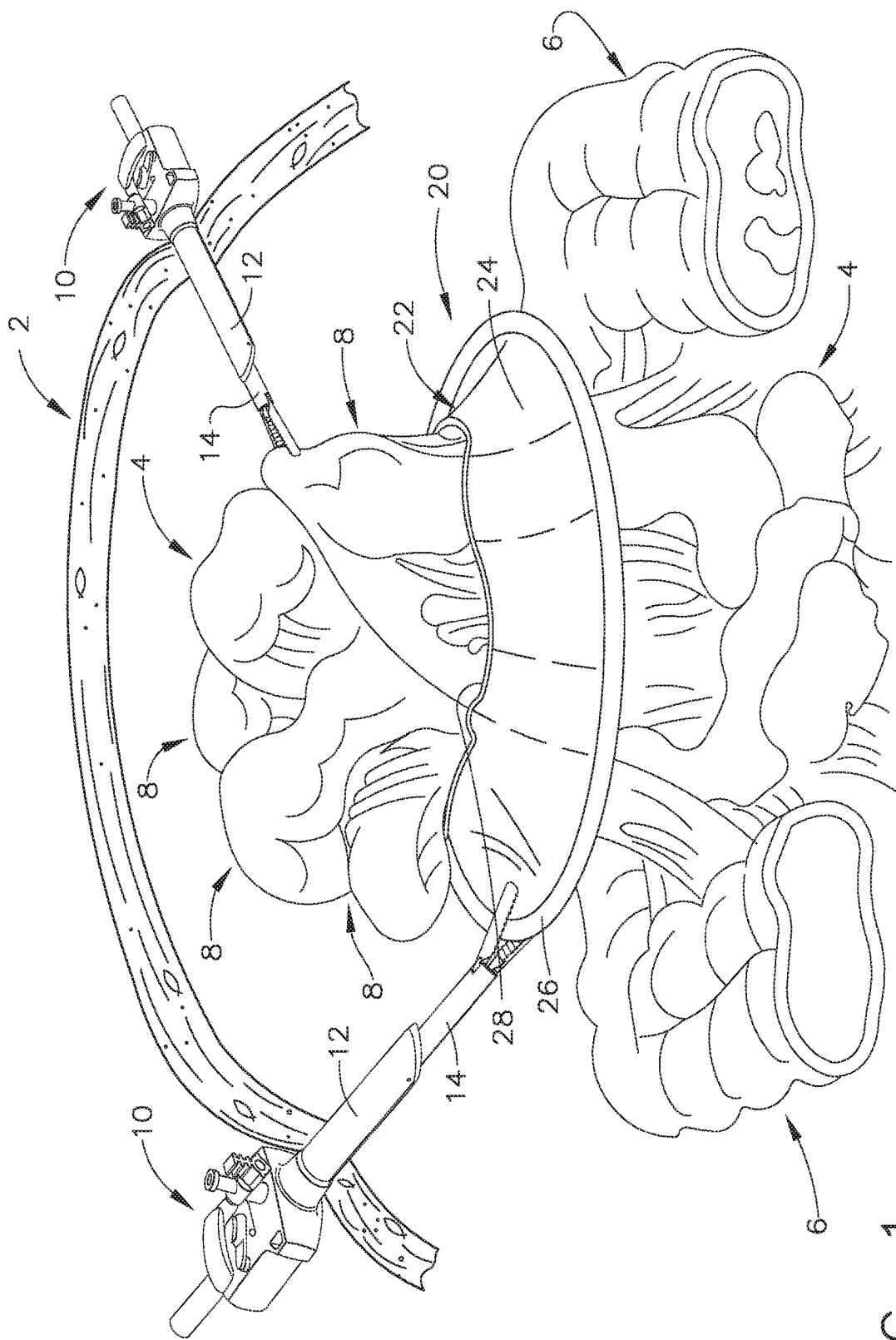

FIG. 1

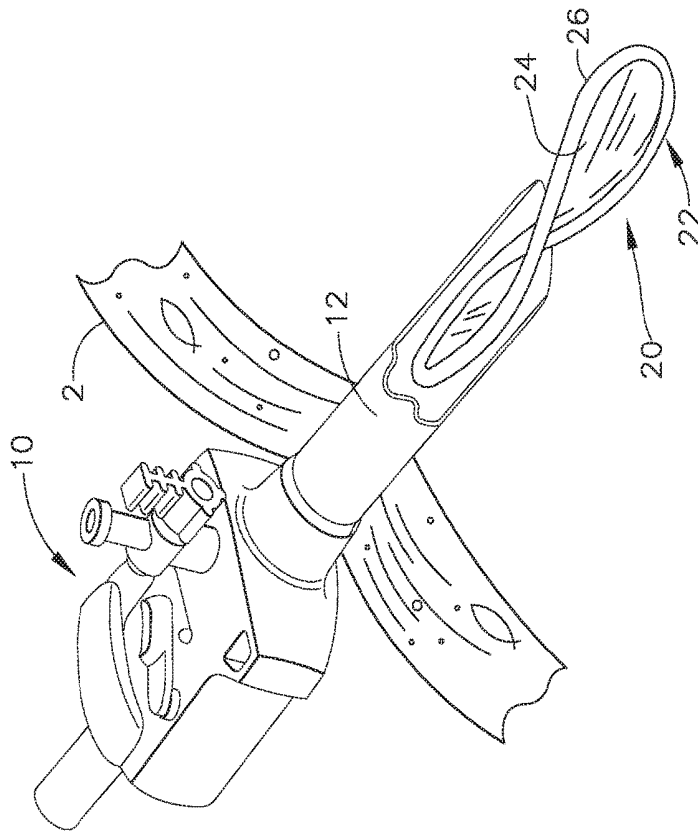

FIG. 2

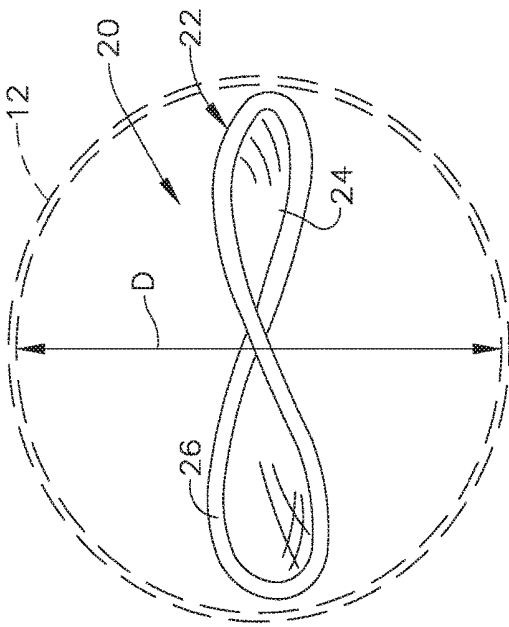

FIG. 3

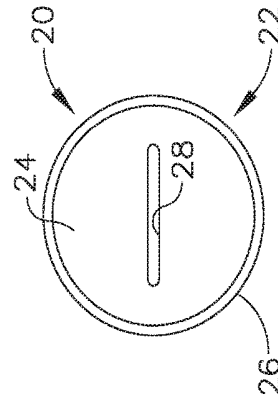

FIG. 4

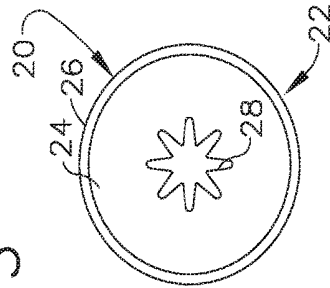

FIG. 5

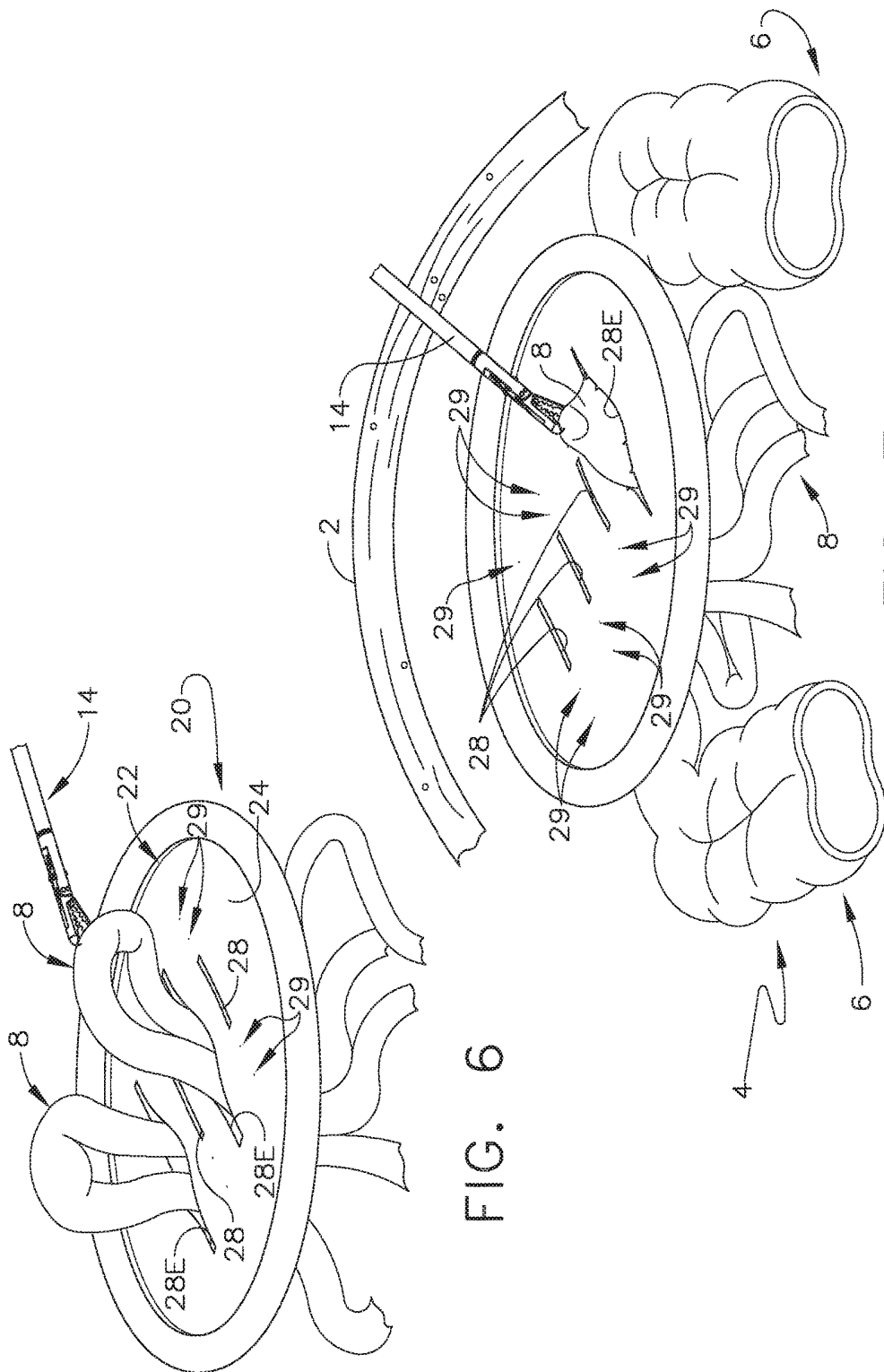

FIG. 6

FIG. 7

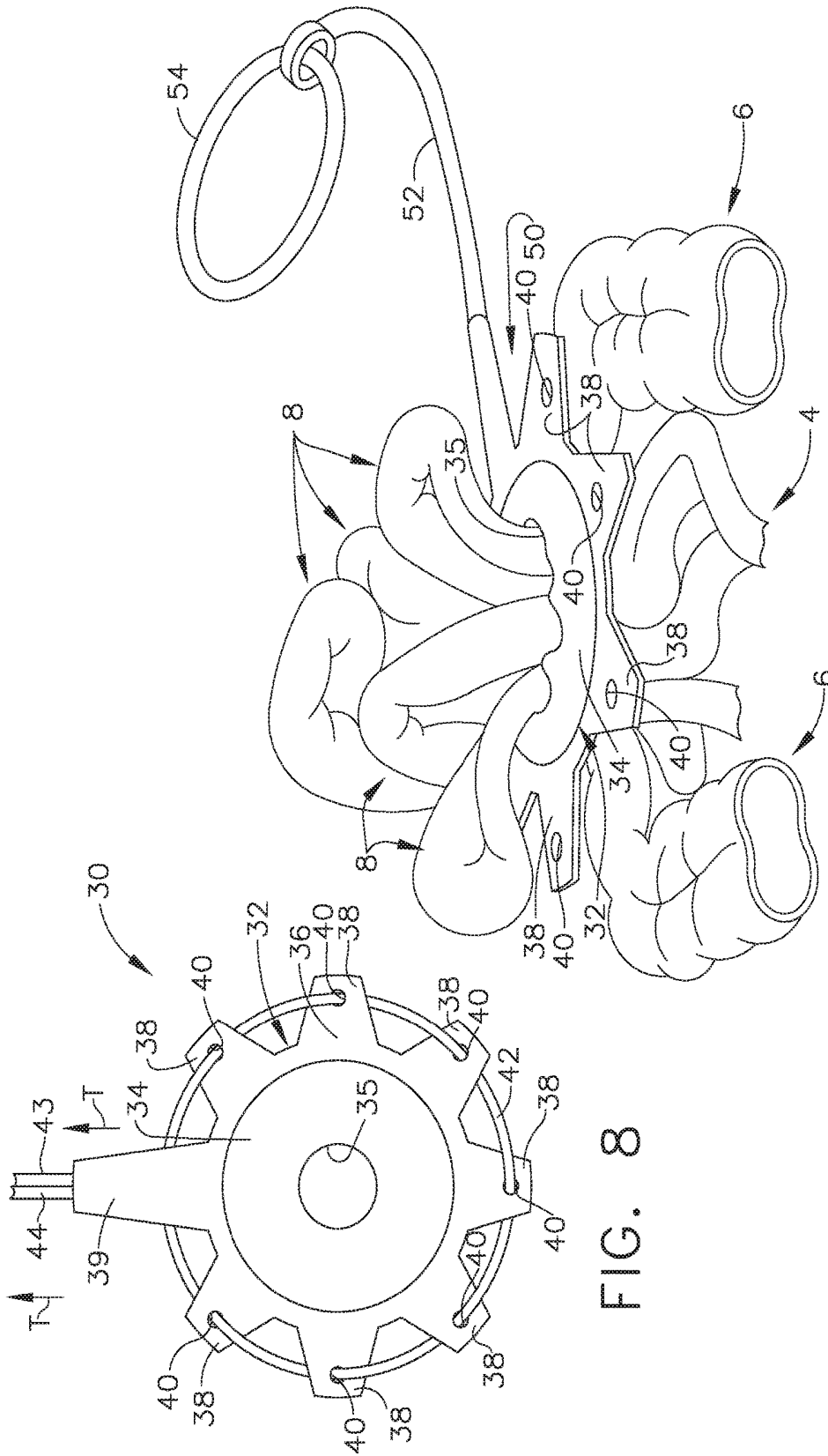

FIG. 8

FIG. 9

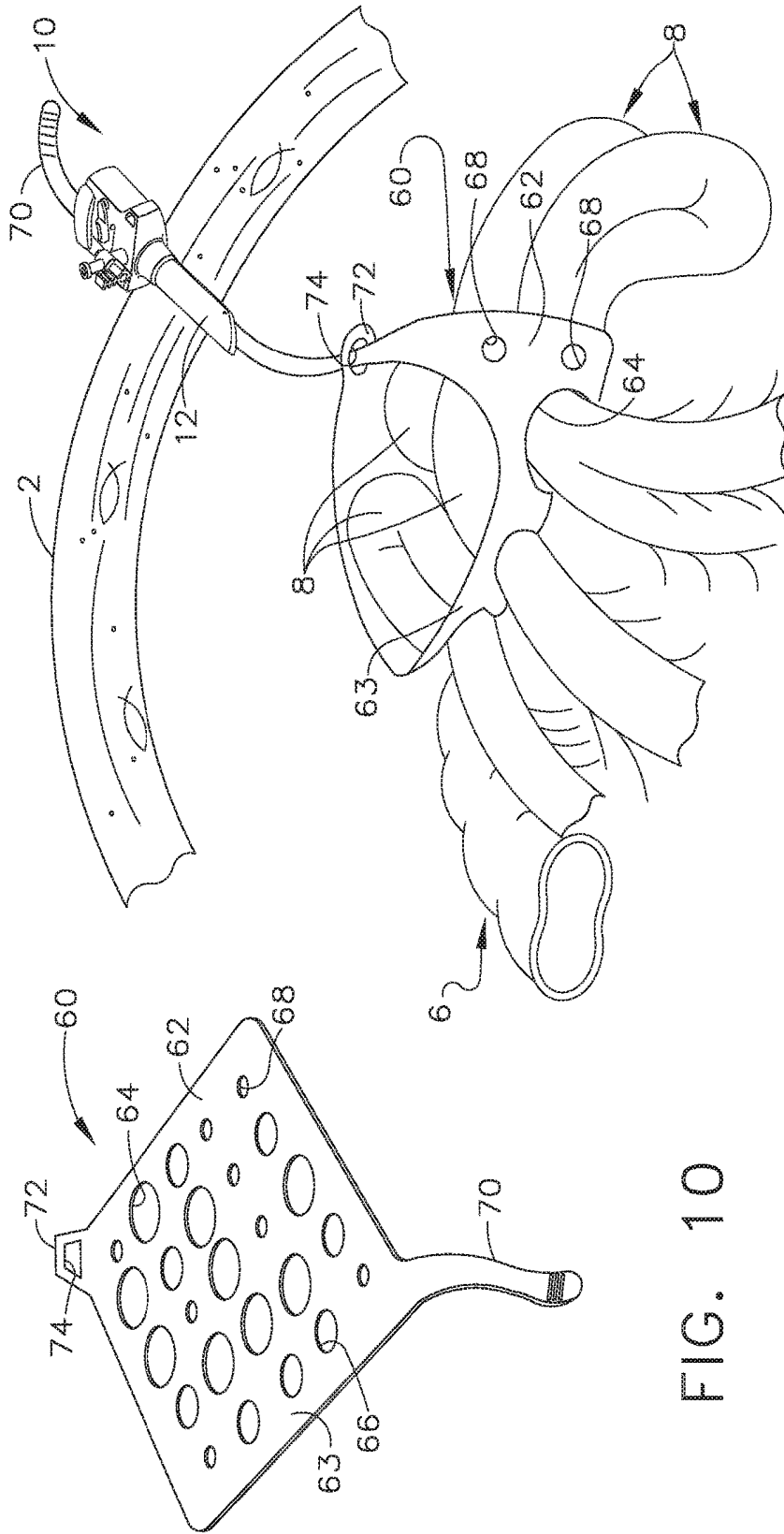

FIG. 10

FIG. 11

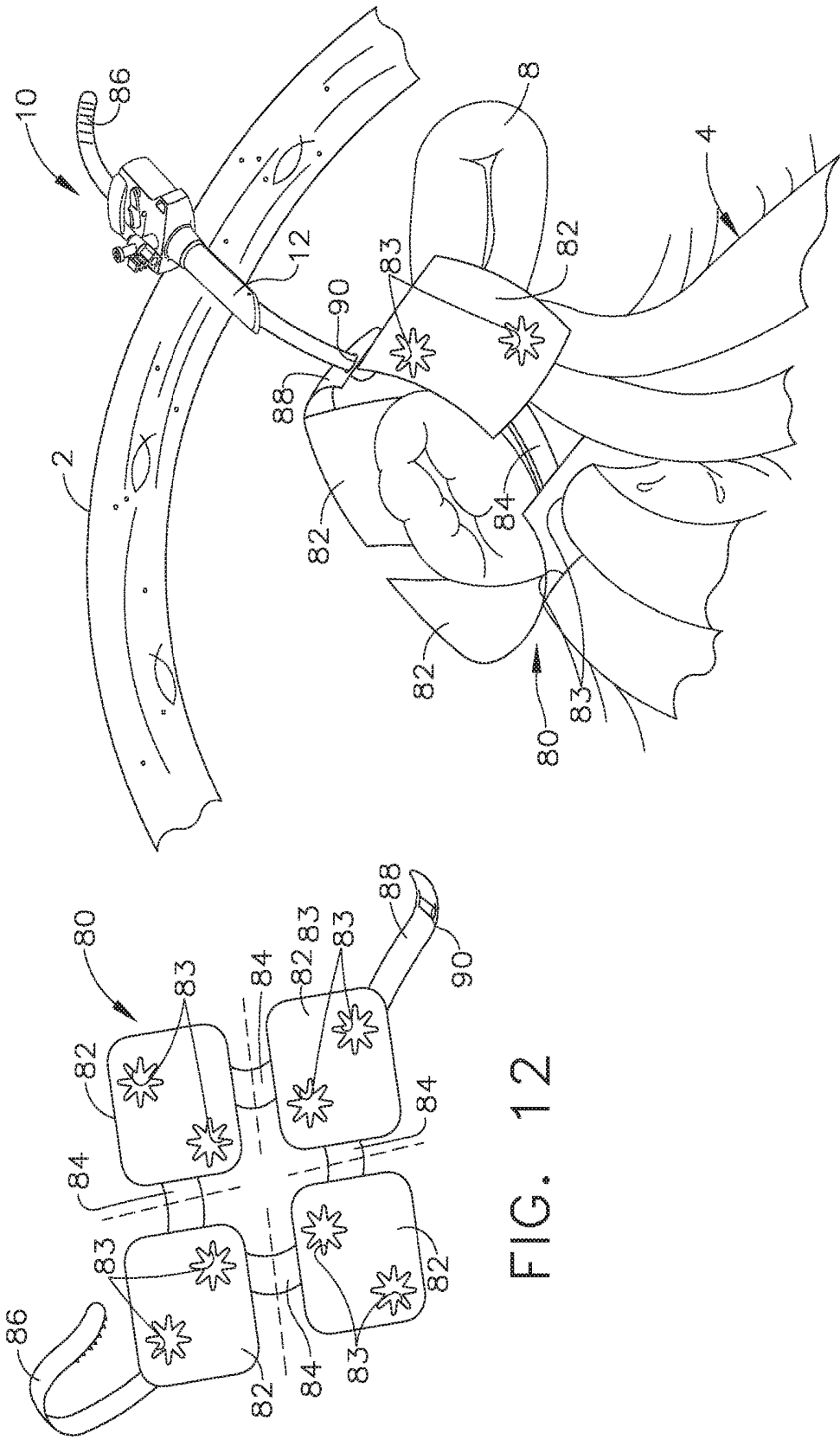

FIG. 12

FIG. 13

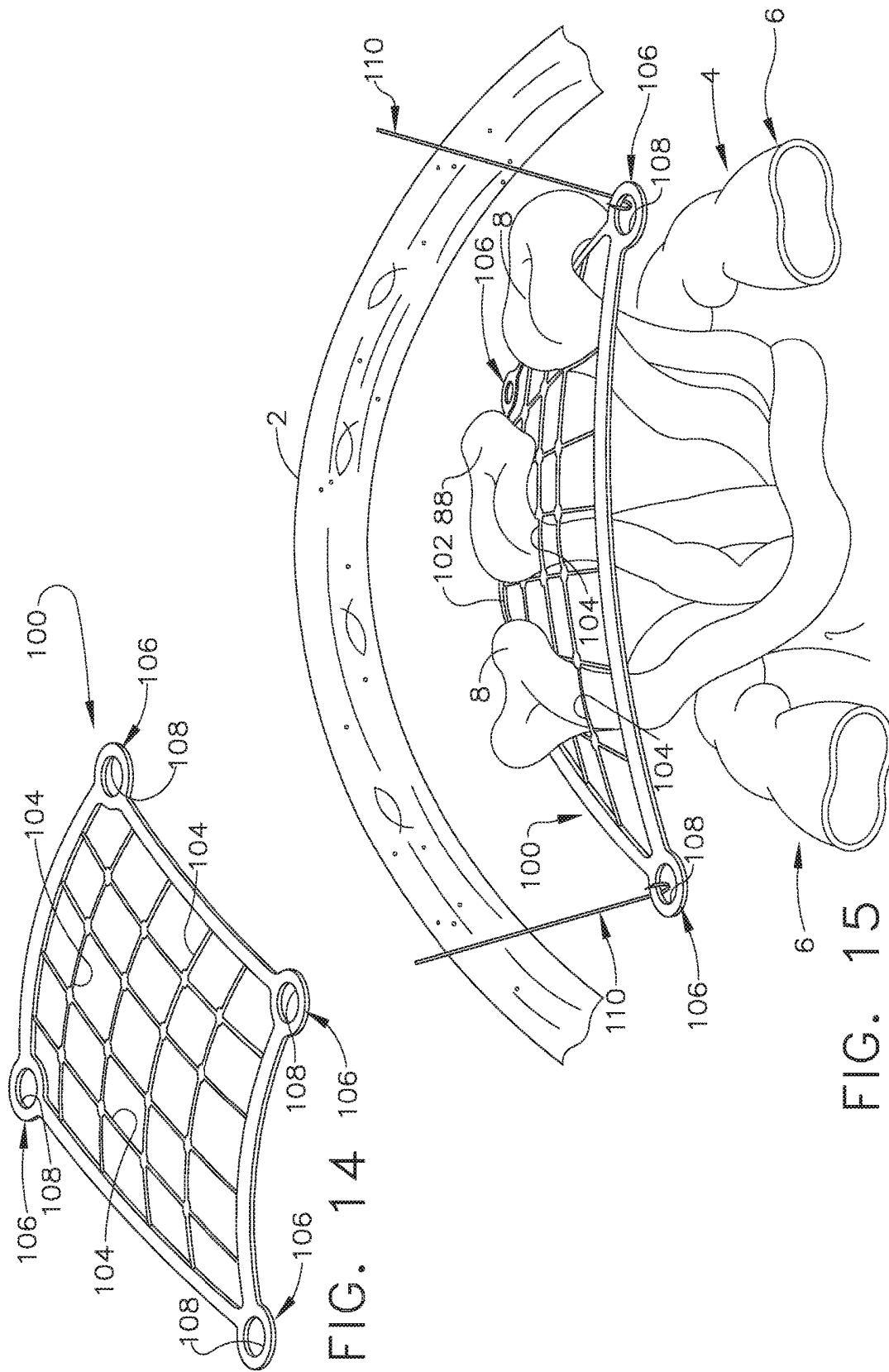

FIG. 14

FIG. 15



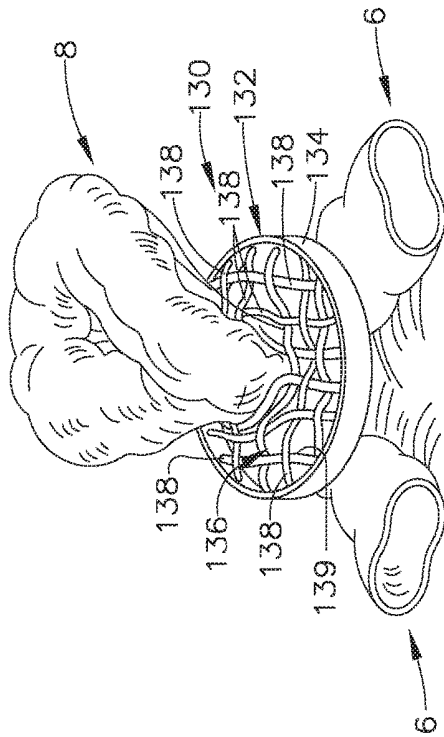

FIG. 17

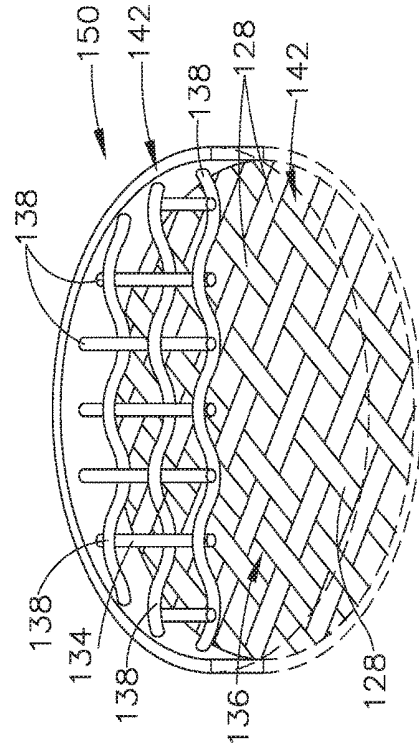

FIG. 19

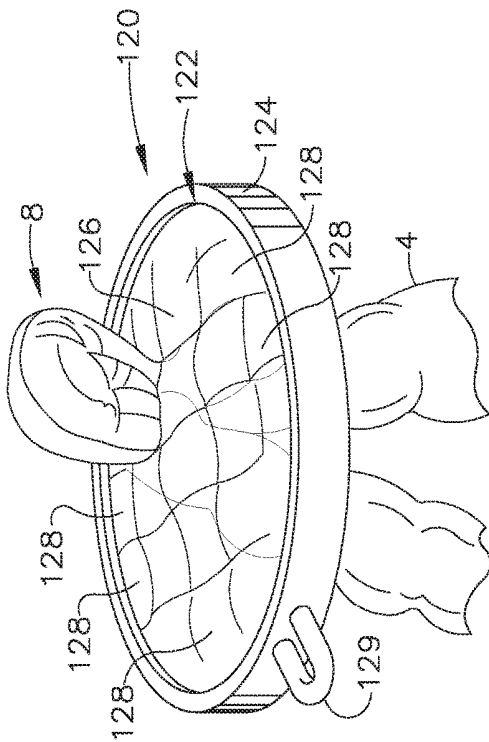

FIG. 16

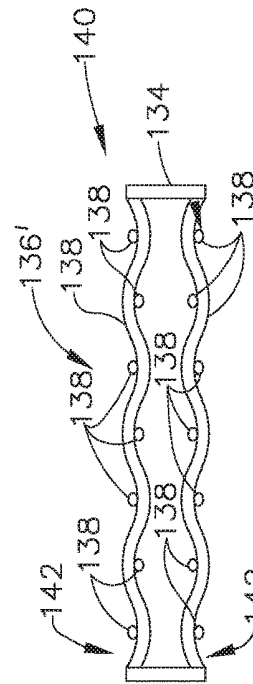

FIG. 18

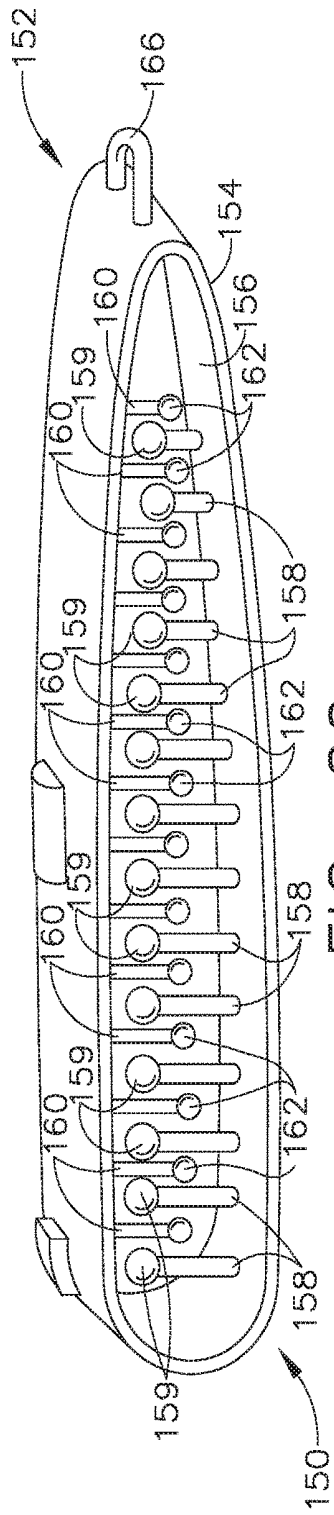

FIG. 20

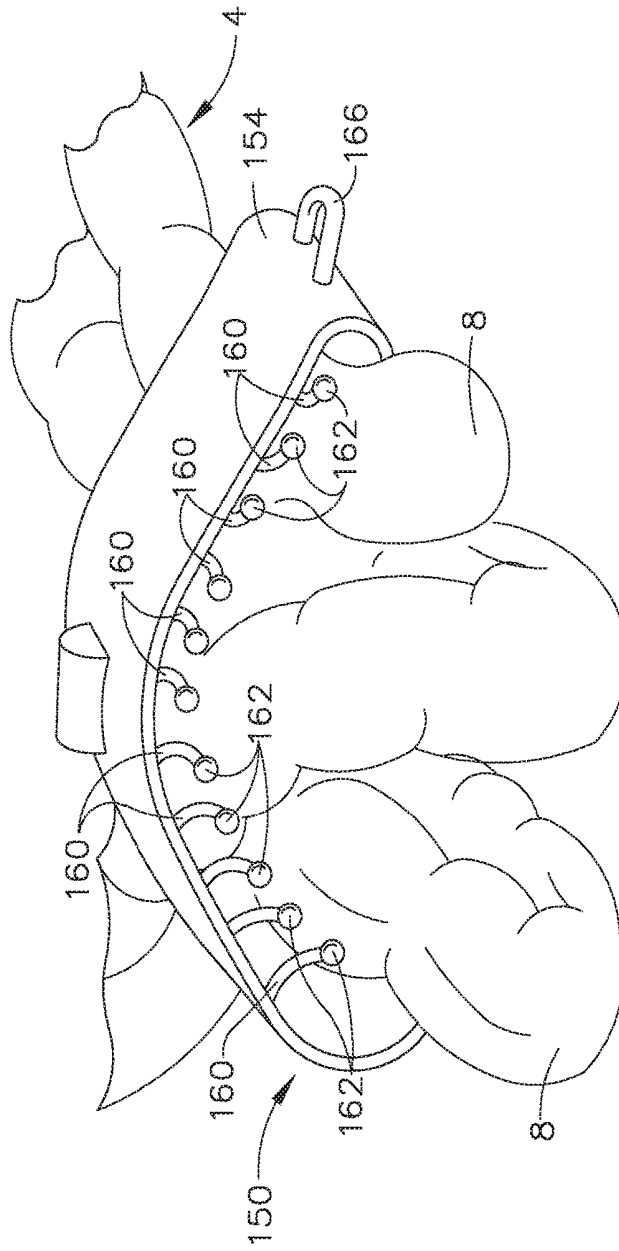

FIG. 21

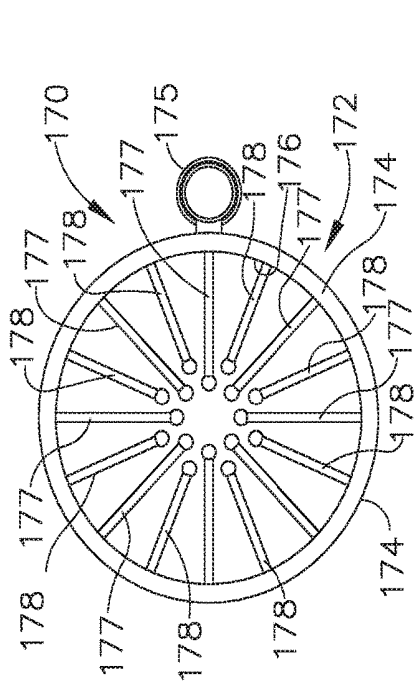

FIG. 22

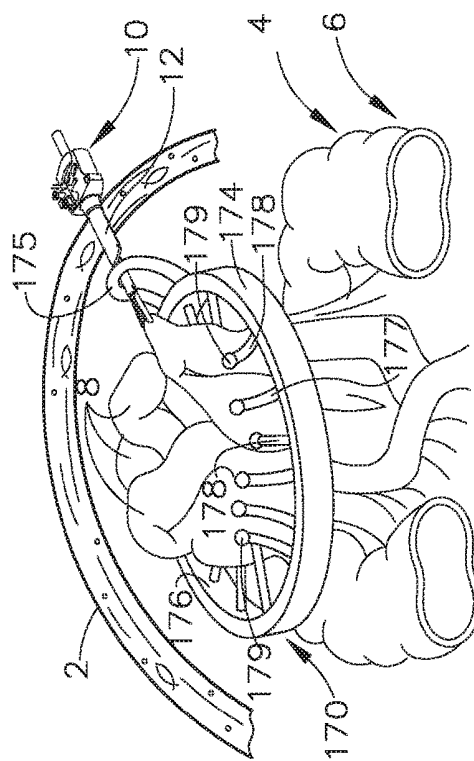

FIG. 23

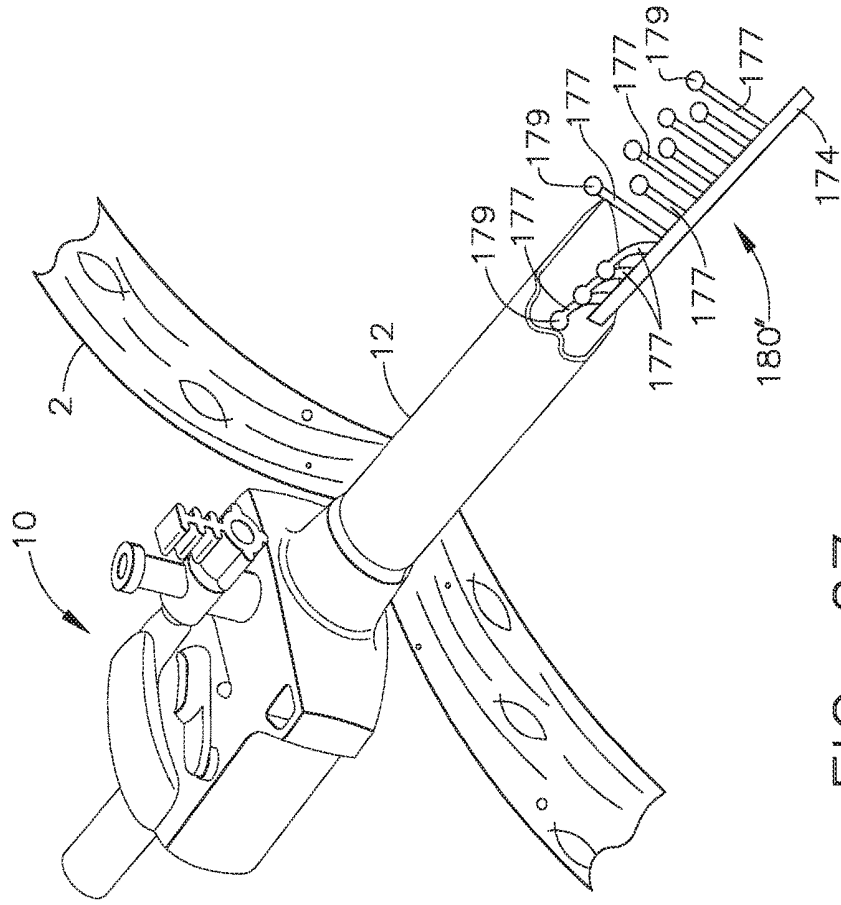

FIG. 27

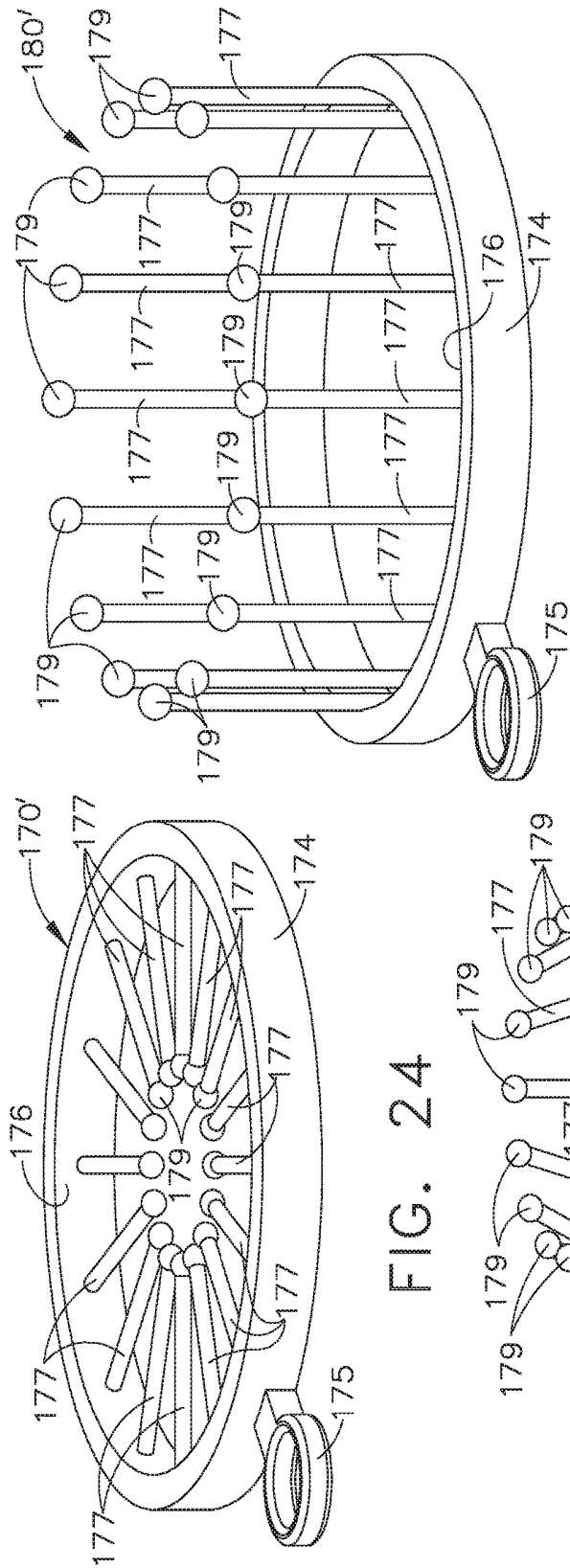

FIG. 24

FIG. 26

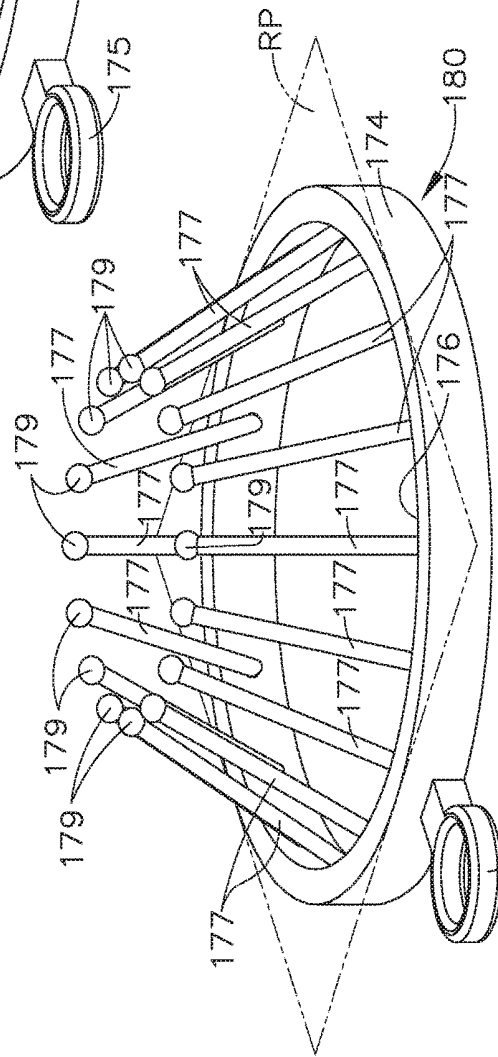

FIG. 25

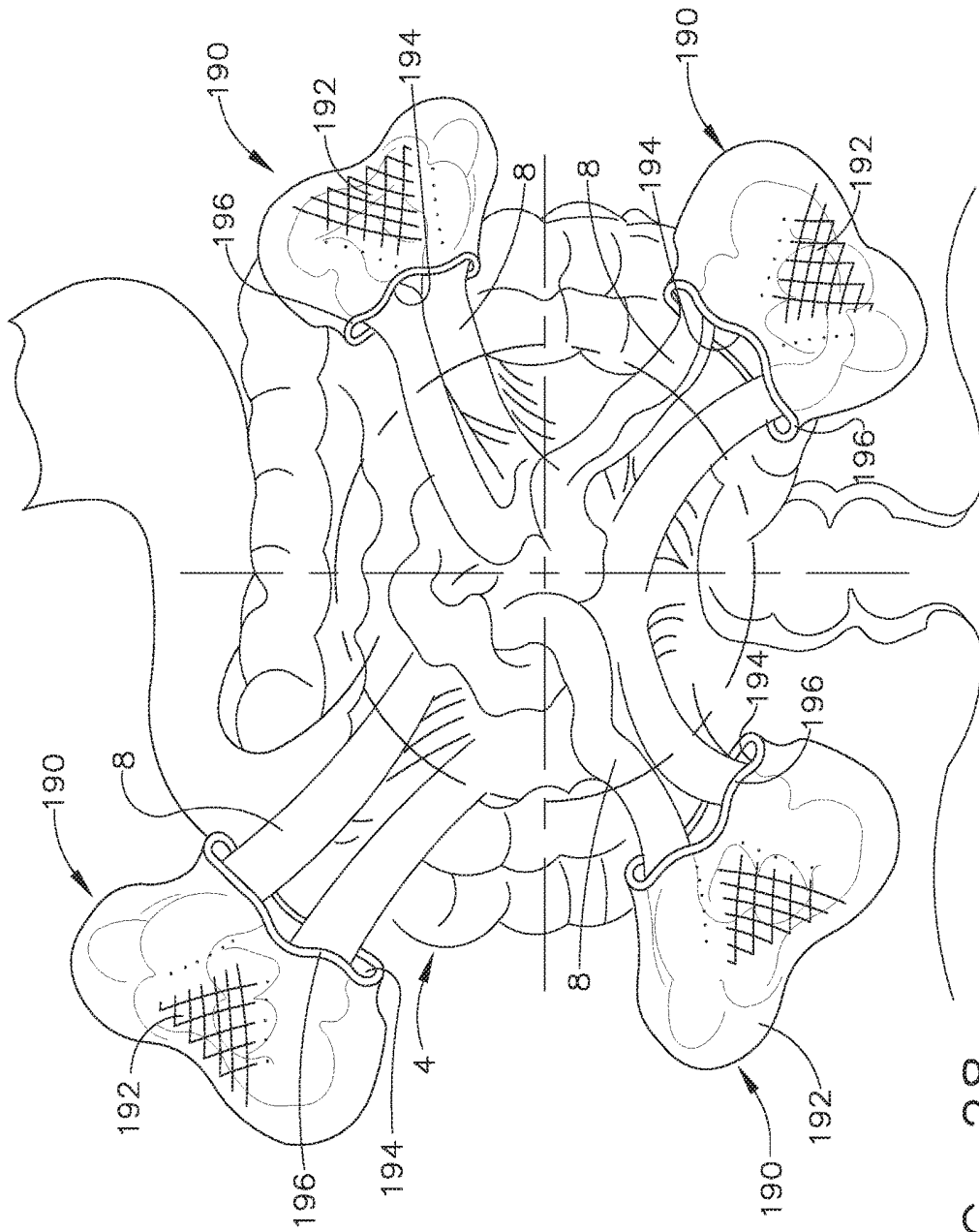

FIG. 28

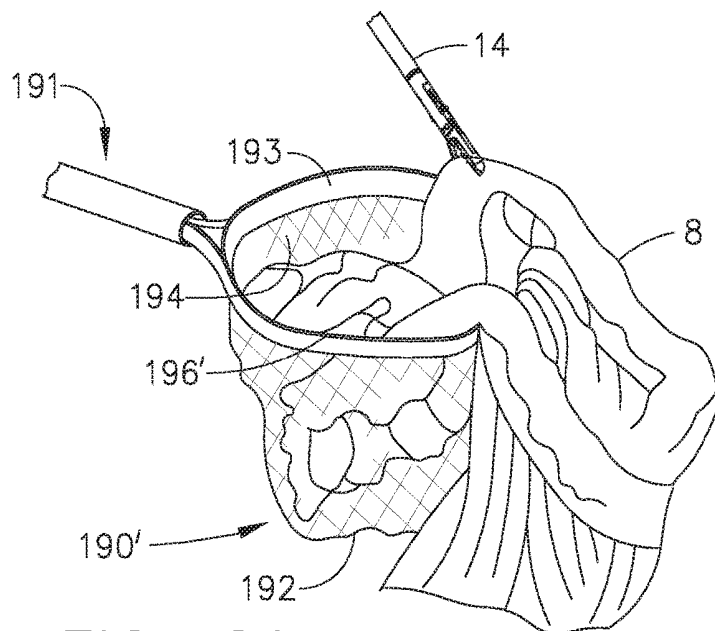

FIG. 29

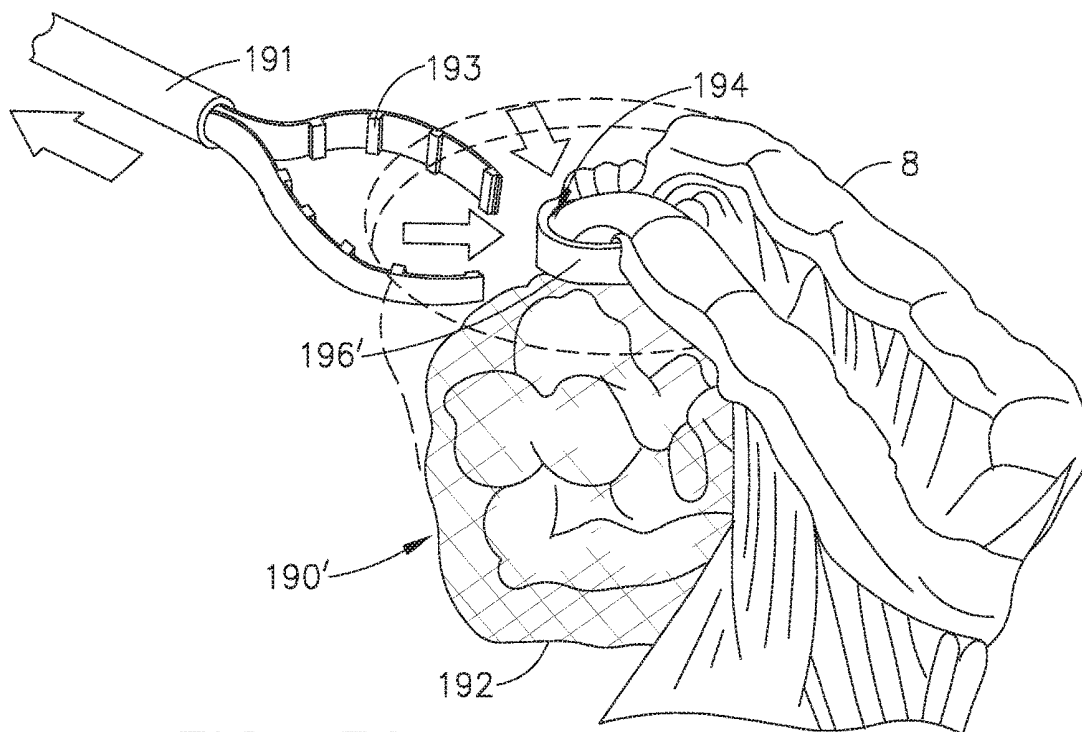

FIG. 30

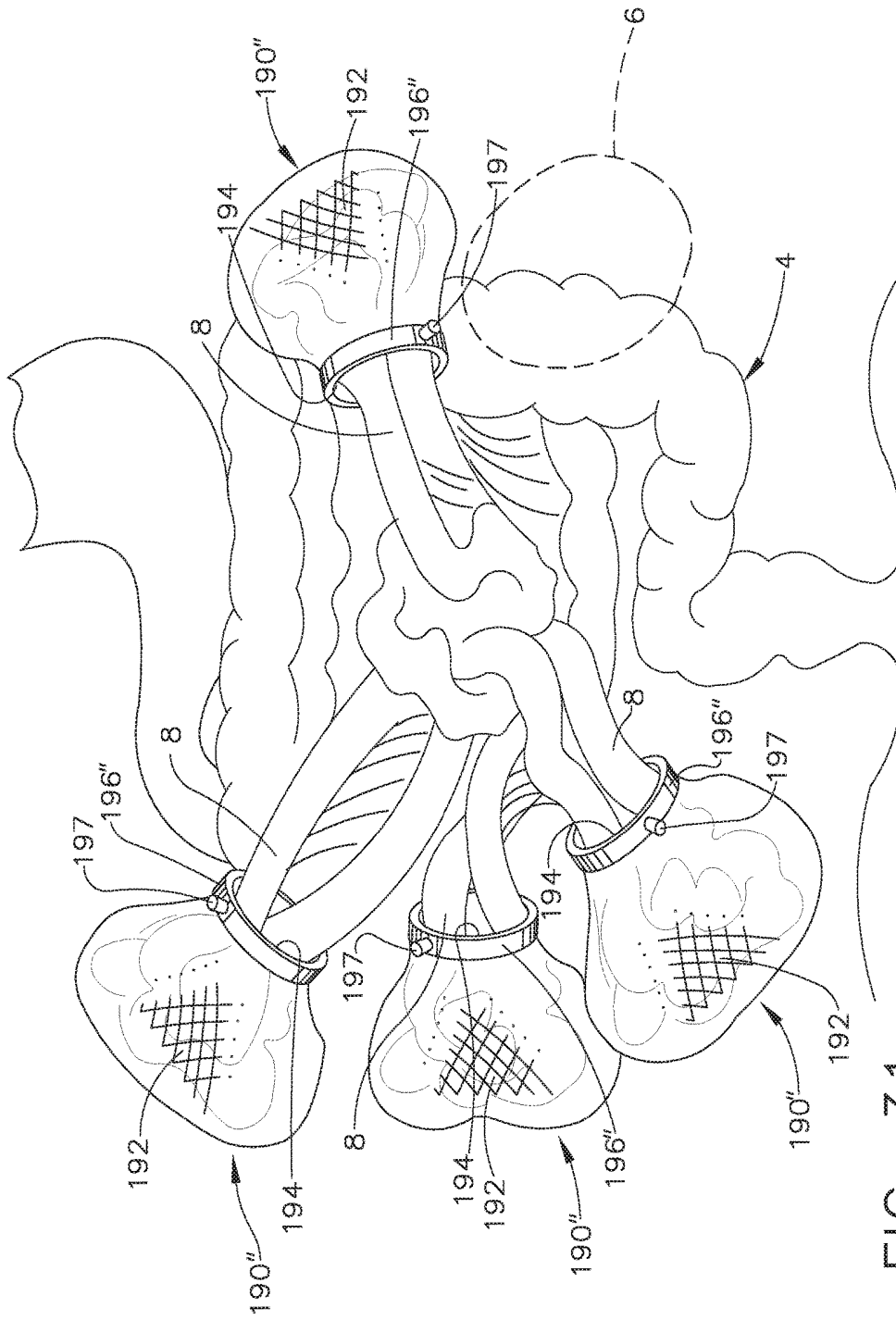

FIG. 31

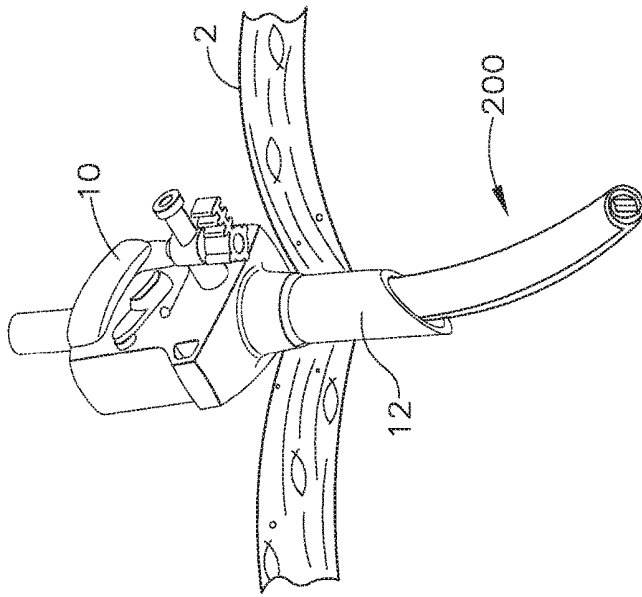

FIG. 34

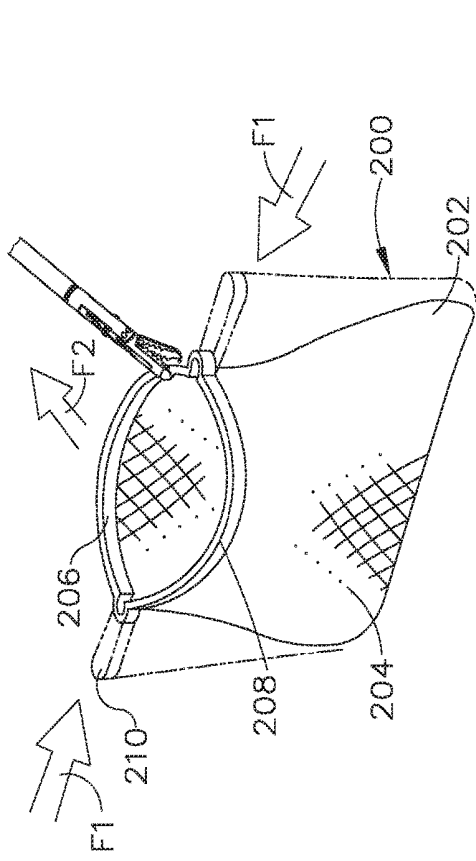

FIG. 32

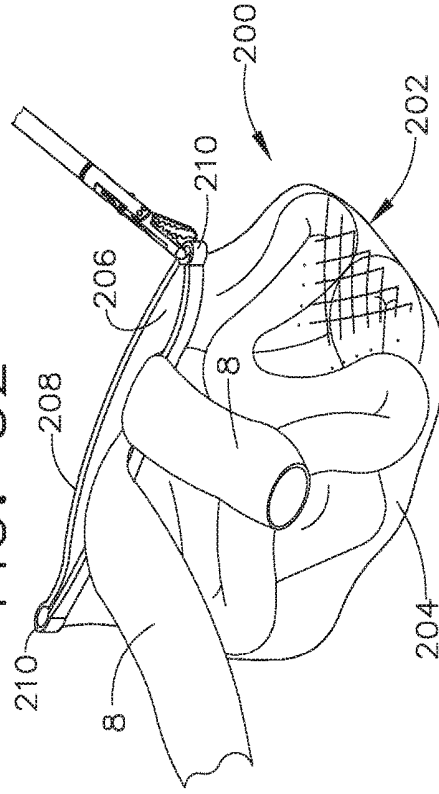

FIG. 33

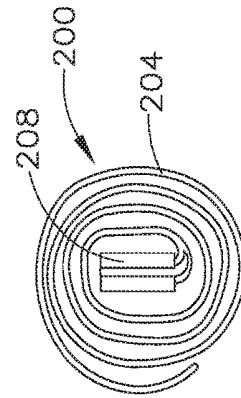

FIG. 35



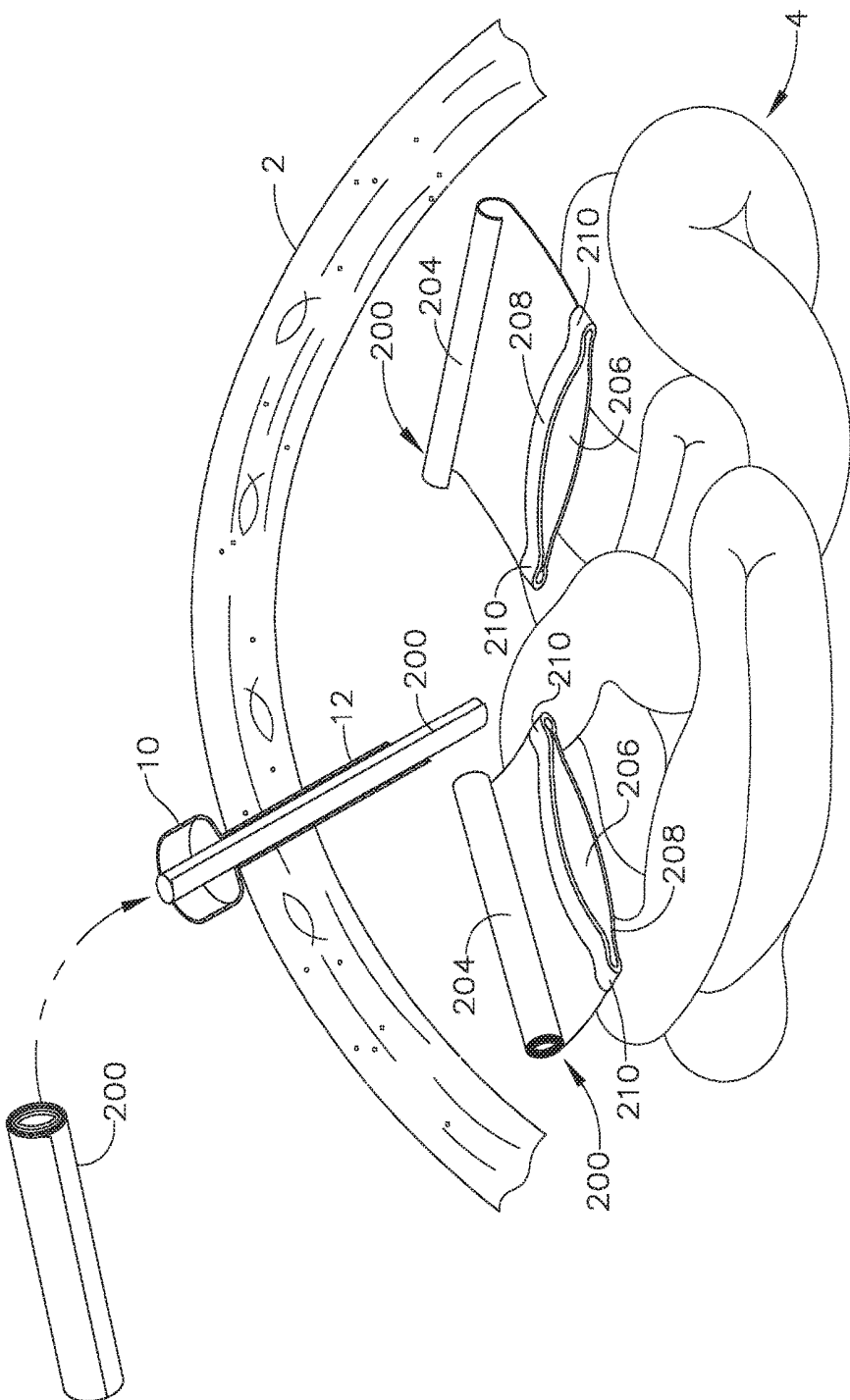
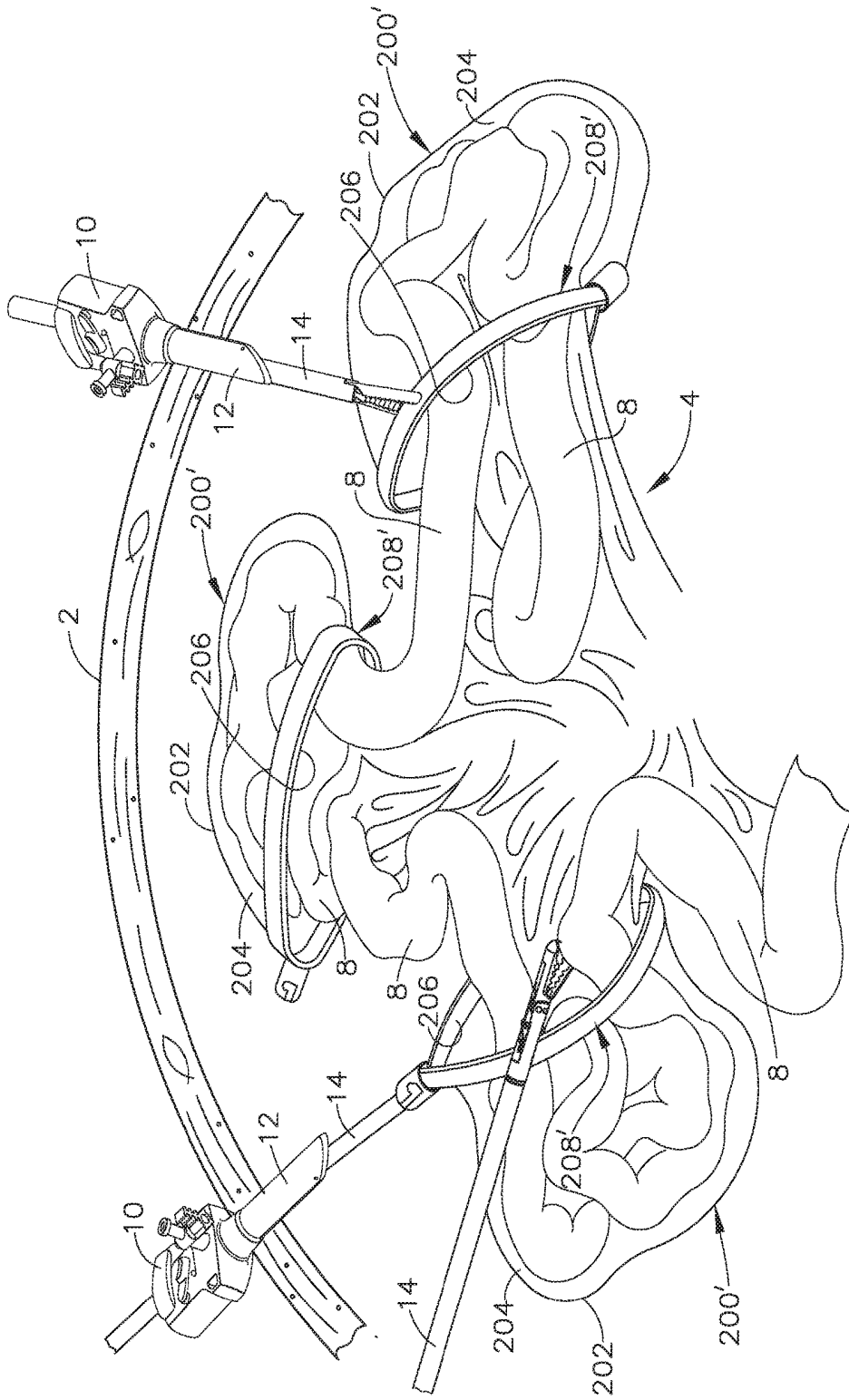

FIG. 36



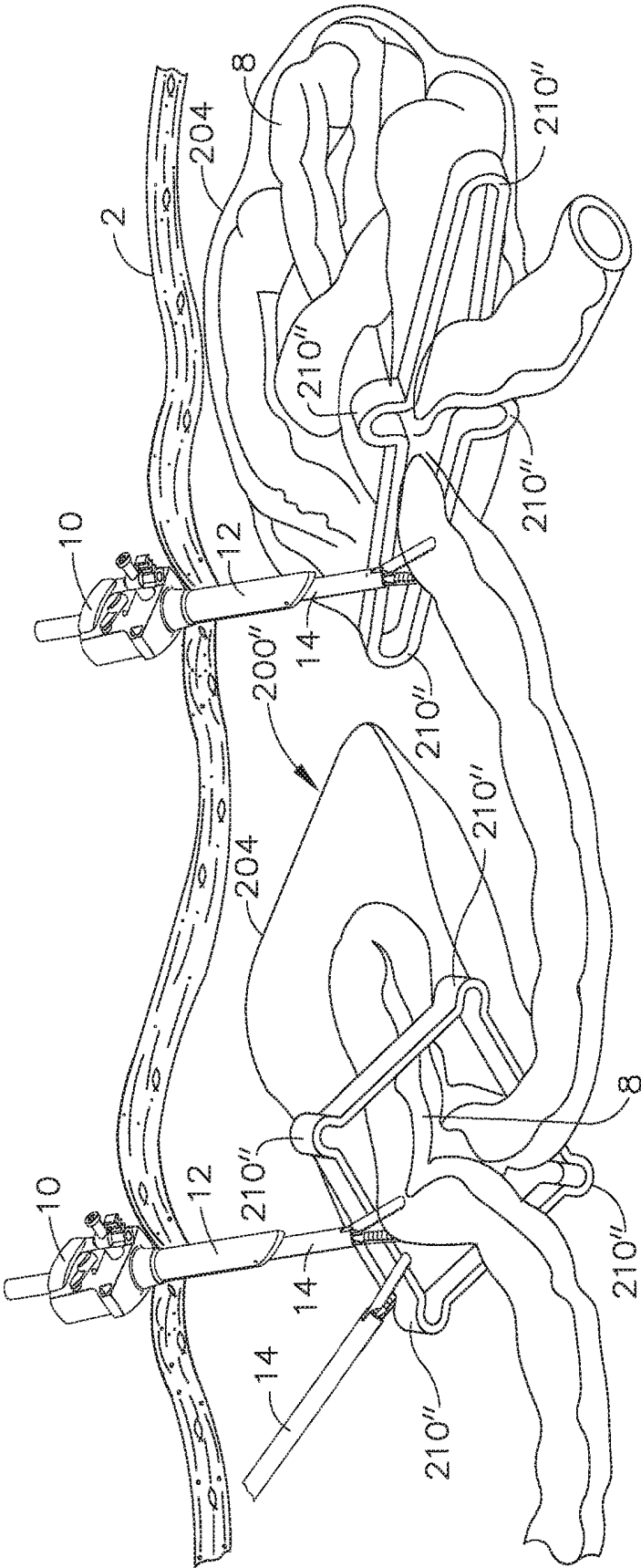

FIG. 38

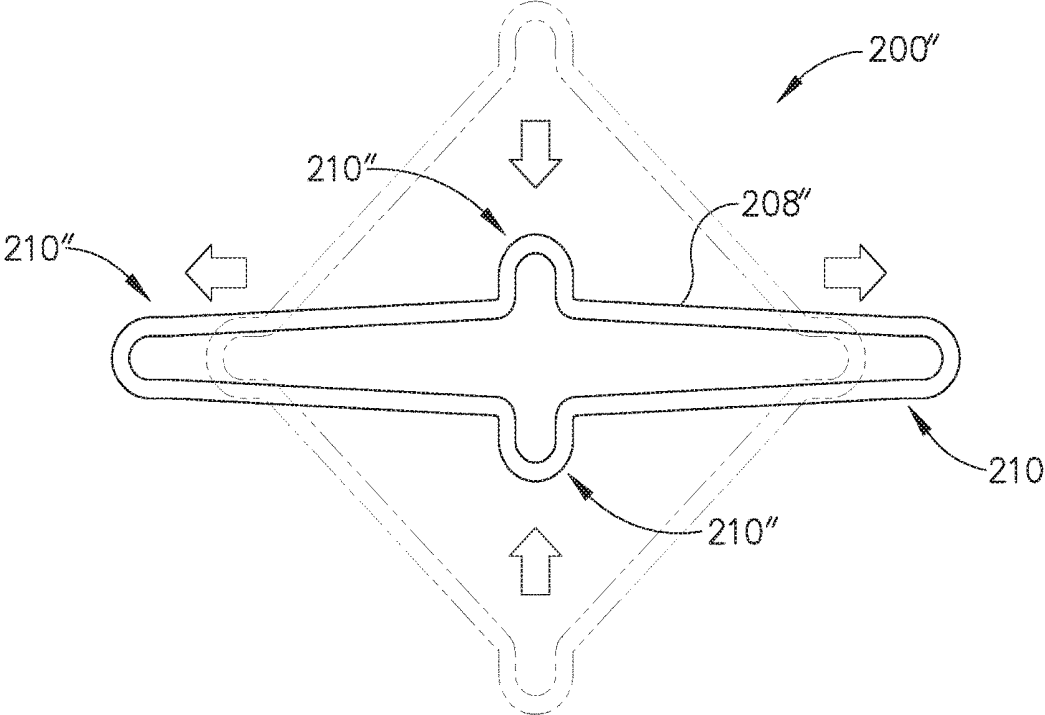

FIG. 39

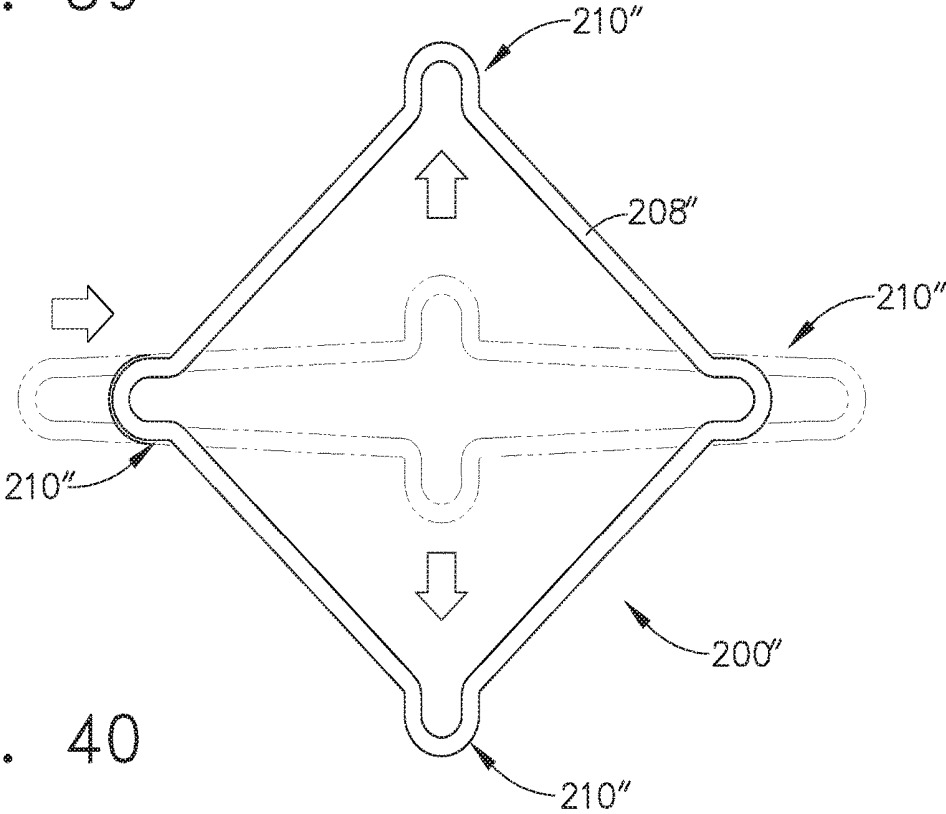

FIG. 40

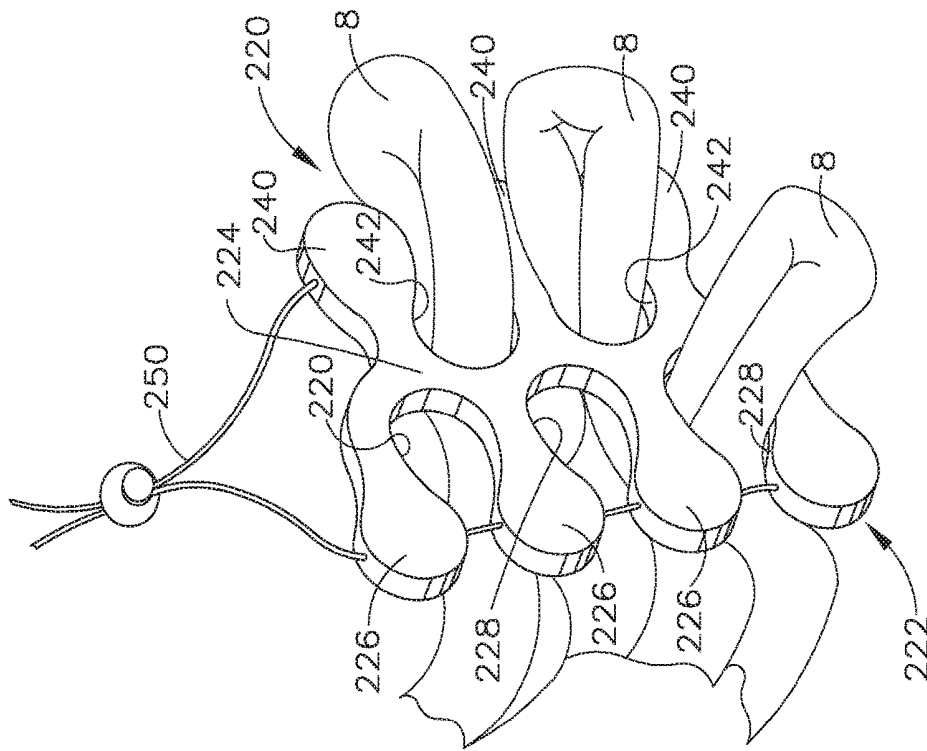

FIG. 42

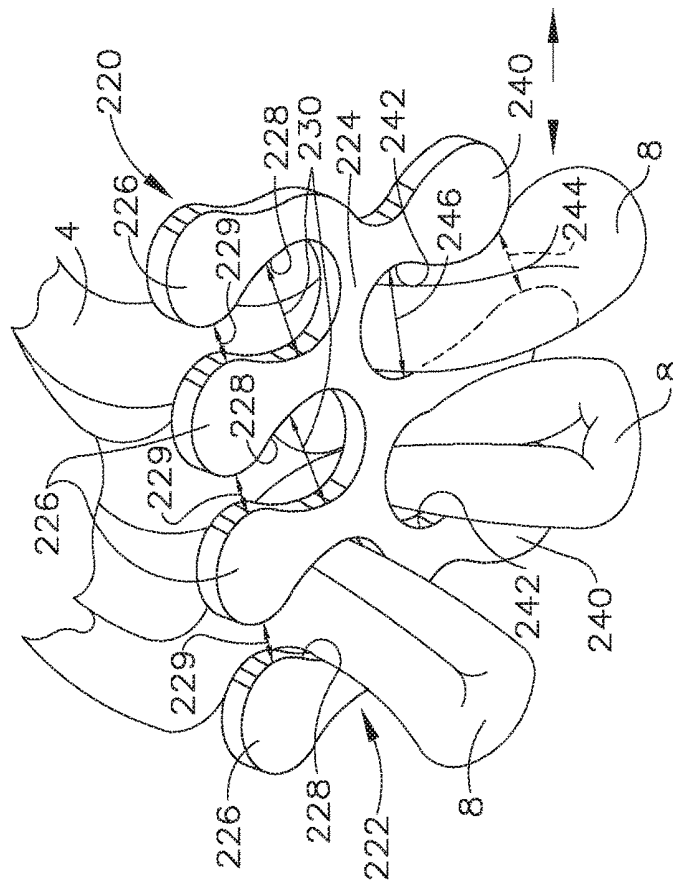

FIG. 41

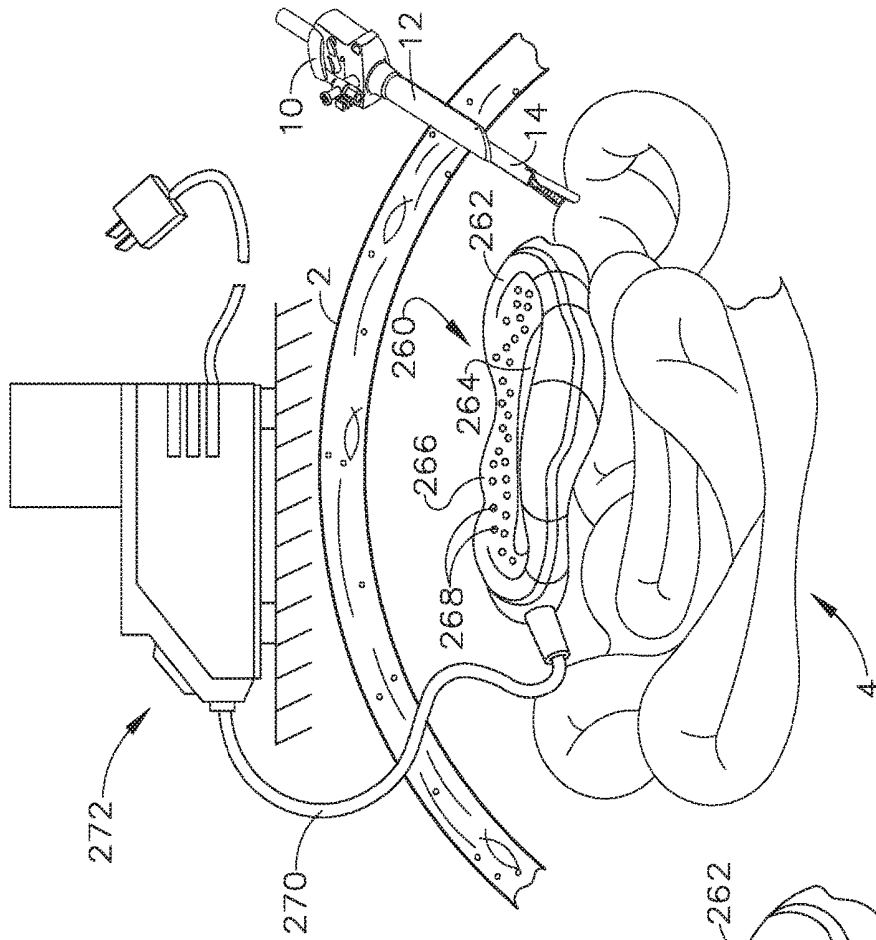

FIG. 45

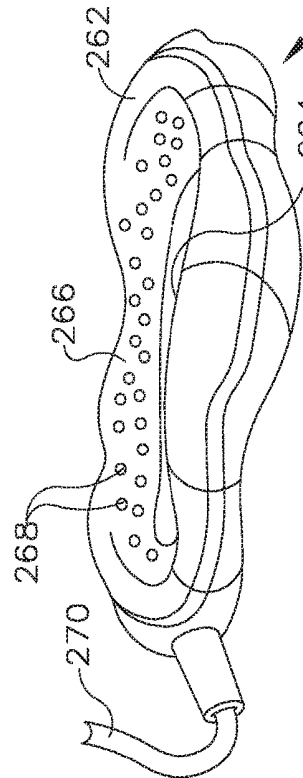

FIG. 43

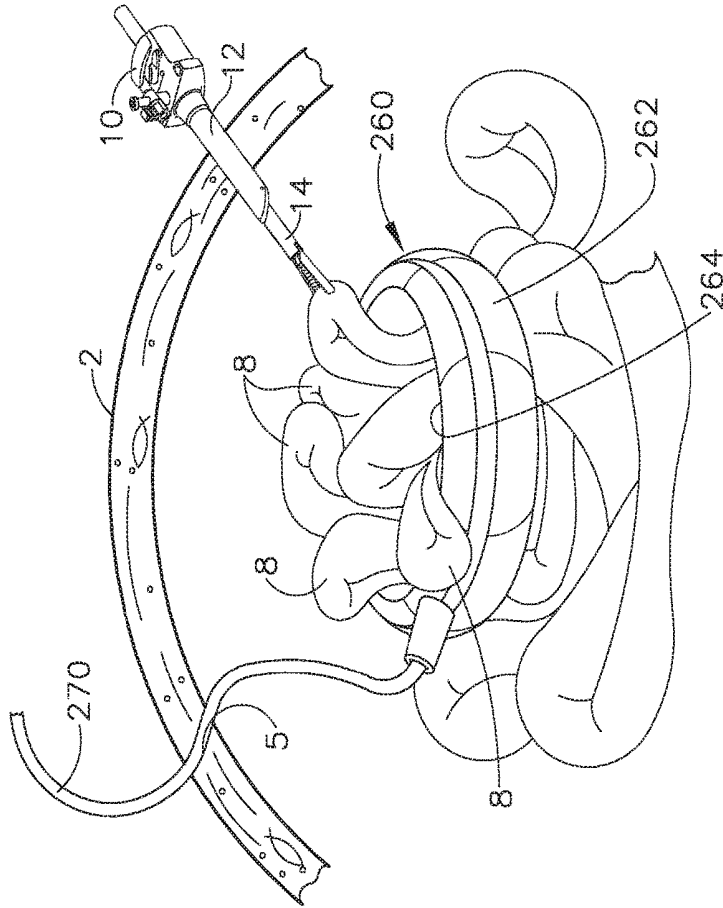

FIG. 46

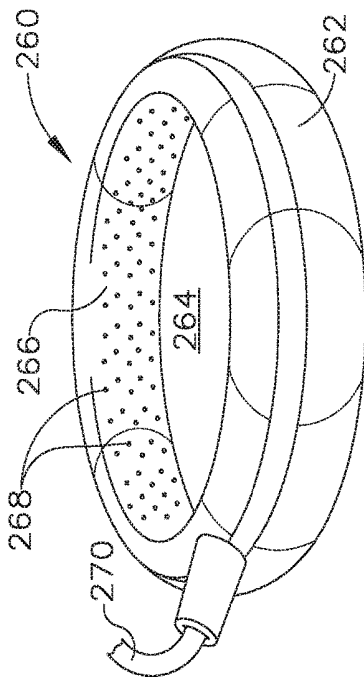

FIG. 44

## SURGICAL BOWEL RETRACTOR DEVICES

### CROSS-REFERENCE TO RELATED APPLICATIONS

[0001] This application is a continuation application claiming priority under 35 U.S.C. § 120 to U.S. patent application Ser. No. 14/788,923, entitled SURGICAL BOWEL RETRACTOR DEVICES, filed on Jul. 1, 2015, now U.S. Patent Application Publication No. 2015/0297210, which claims priority under 35 U.S.C. § 120 to U.S. patent application Ser. No. 13/181,827, entitled SURGICAL BOWEL RETRACTOR DEVICES, filed Jul. 13, 2011, which issued on Jul. 28, 2015 as U.S. Pat. No. 9,089,330, the entire disclosures of which are hereby incorporated by reference herein.

### FIELD OF THE INVENTION

[0002] The present invention generally relates to surgical devices for temporarily retaining and supporting tissues and organs in a desired orientation during surgery, and more particularly, to devices for retracting portions of the bowel during surgery.

### BACKGROUND

[0003] One major challenge to employing laparoscopic colorectal techniques is the ability to move all of the unrelated or non-involved tissue out of the surgical site to permit better physical and visual access to the target tissue or organ. In an open procedure, large metal retractors would be used to pull the masses of small intestines away and then pack them off with surgical sponges. When performing various colorectal surgical procedures, the surgeon often must manipulate the surgical instruments through a pile or collection of bowel to open up a window to operate in.

[0004] Thus, the need exists for devices that can be used to support portions of the bowel during laparoscopic colorectal operations in unobtrusive orientations to provide better physical and visual access to the portion of the bowel to be operated on.

[0005] The foregoing discussion is intended only to illustrate some of the shortcomings present in the field of the invention at the time, and should not be taken as a disavowal of claim scope.

### BRIEF SUMMARY

[0006] In connection with general aspects of various embodiments of the present invention, there is provided a bowel retractor device that, in various forms, comprises an elastic body that is configurable from a first collapsed position wherein the elastic body is insertable through an opening in a patient's body to a second expanded position wherein a portion of the patient's bowel may be supported by a central portion of the elastic body in a desired orientation.

[0007] In connection with yet another general aspect of one form of the present invention, there is provided a bowel retractor device that includes a central portion that has a first plurality of flexible first arms protruding therefrom in a first direction. The plurality of first flexible arms defines a first opening between each adjacent flexible arm. A second plurality of flexible second arms protrude from the central portion in a second direction wherein each flexible second arm protrudes from the central portion at positions opposite

from the first openings and wherein the flexible second arms are spaced from each other to form a second opening therebetween.

[0008] In accordance with still another general aspect of one form of the present invention, there is provided a bowel retractor device that includes a selectively inflatable ring that has a textured annular surface that defines an interior area. A supply conduit is coupled to the selectively inflatable ring and a source of pressurized medium.

[0009] In accordance with other general aspects of various forms of the present invention, there is provided a method for performing laparoscopic bowel surgery on a target portion of a patient's bowel. In one form of the present invention, the method includes inserting at least one bowel retractor device through an opening in the patient. Each of the bowel retractor devices comprises a body that is configurable from a first collapsed position wherein the body is insertable through the opening to a second expanded position. The method further includes engaging a corresponding non-target portion of the bowel with a central portion of each of the at least one bowel retractor devices when in the second expanded position and positioning the at least one bowel retractor device to locate the corresponding non-target bowel portion engaged thereby in non-obtrusive positions to thereby provide physical and visual access to the target portion of the bowel.

### BRIEF DESCRIPTION OF THE FIGURES

[0010] The accompanying drawings, which are incorporated in and constitute a part of this specification, illustrate embodiments of the invention, and, together with the general description of the invention given above, and the detailed description of the embodiments given below, serve to explain the principles of the present invention.

[0011] FIG. 1 is a view of a portion of a patient's abdomen and bowel segment with two trocars installed through the abdominal wall and one of the bowel retraction device embodiments of the present invention with non-target portions of the patient's bowel installed therein;

[0012] FIG. 2 is a perspective view showing a conventional trocar installed through the abdominal wall of a patient and being used to pass a bowel retractor embodiment of the present invention into a surgical area within the abdomen;

[0013] FIG. 3 is a view of a bowel retractor embodiment of the present invention inserted in a twisted orientation into a cannula of a trocar;

[0014] FIG. 4 is a top view of a bowel retractor device embodiment of the present invention;

[0015] FIG. 5 is a top view of another bowel retractor device embodiment of one form of the present invention;

[0016] FIG. 6 is a perspective view of another bowel retractor device embodiment with non-target portions of a patient's bowel supported therein;

[0017] FIG. 7 is another perspective view of a bowel retractor device located inside a patient's abdomen and wherein the surgeon is using a grasping device to pull non-target portions of the patient's bowel through an opening in the bowel retractor device;

[0018] FIG. 8 is a top view of another bowel retractor device embodiment of the present invention;

[0019] FIG. 9 is a perspective view of the bowel retractor device of FIG. 8 supporting non-target portions of a patient's bowel therein;



[0020] FIG. 10 is a front perspective view of another bowel retractor device embodiment of the present invention;

[0021] FIG. 11 is a perspective view of the bowel retractor device of FIG. 10 supporting non-target portions of a patient's bowel therein and wherein the tether portion thereof has been inserted through the cannula of a trocar;

[0022] FIG. 12 is a top view of another bowel retractor device embodiment of the present invention;

[0023] FIG. 13 is a perspective view of the bowel retractor device of FIG. 12 supporting non-target portions of a patient's bowel therein and wherein the tether portion thereof has been inserted through the cannula of a trocar;

[0024] FIG. 14 is a perspective view of another bowel retractor device embodiment of the present invention;

[0025] FIG. 15 is a perspective view of the bowel retractor device of FIG. 14 supporting non-target portions of a patient's bowel therein and wherein retractor manipulation needles have been inserted through the abdominal wall to engage portions of the bowel retractor device;

[0026] FIG. 16 is a perspective view of another bowel retractor device embodiment of the present invention;

[0027] FIG. 17 is another perspective view of the bowel retractor device embodiment of FIG. 16 with a non-target portion of a patient's bowel being supported thereby;

[0028] FIG. 18 is a cross-sectional view of the bowel retractor device embodiment of FIG. 16;

[0029] FIG. 19 is a partial perspective view of another bowel retractor device embodiment of the present invention;

[0030] FIG. 20 is a side view of another bowel retractor device embodiment of the present invention;

[0031] FIG. 21 is a perspective view of the bowel retractor device embodiment of FIG. 20 with portions of a patient's bowel supported therein;

[0032] FIG. 22 is a top view of another bowel retractor device embodiment of the present invention;

[0033] FIG. 23 is a perspective view of the bowel retractor device embodiment of FIG. 22 inside a portion of a patient's abdomen and supporting a non-target bowel portion therein;

[0034] FIG. 24 is a perspective view of another bowel retractor device embodiment of the present invention;

[0035] FIG. 25 is a perspective view of another bowel retractor device embodiment of the present invention;

[0036] FIG. 26 is a perspective view of another bowel retractor device embodiment of the present invention;

[0037] FIG. 27 is a perspective view of a trocar device inserted through the abdominal wall of a patient with a bowel retractor device embodiment being passed through the trocar cannula;

[0038] FIG. 28 is a perspective view of a portion of a patient's colon with four bowel retractor device embodiments of the present invention supporting non-target bowel portions;

[0039] FIG. 29 is a partial perspective view of another bowel retractor device embodiment of the present invention being supported in an expanded position by an installation tool embodiment of the present invention;

[0040] FIG. 30 is another perspective view of the bowel retractor device embodiment of FIG. 29 supporting a bowel portion therein with the installation tool removed therefrom;

[0041] FIG. 31 is a perspective view of a portion of a patient's colon with four other bowel retractor device embodiments of the present invention supporting non-target bowel portions;

[0042] FIG. 32 is a perspective view of another bowel retractor device embodiment of the present invention in an open position and supported by a grasping instrument;

[0043] FIG. 33 is another perspective view of the bowel retractor device embodiment of FIG. 32 and supporting a bowel portion therein;

[0044] FIG. 34 is a partial perspective view of a trocar device inserted through a portion of a patient's abdominal wall with the bowel retractor device of FIGS. 32 and 33 being inserted through the trocar cannula;

[0045] FIG. 35 is a top view of the bowel retractor device embodiment of FIGS. 32-34 in a collapsed or rolled-up position wherein the retractor device may be inserted through a trocar cannula or other opening in a patient's body;

[0046] FIG. 36 is a perspective view of three bowel retractor device embodiments of FIGS. 32-35 inside a portion of a patient's abdomen;

[0047] FIG. 37 is a perspective view of a patient's abdomen and bowel retractor device embodiments of the present invention supporting portions of the patient's bowel therein;

[0048] FIG. 38 is a perspective view of a patient's abdomen and bowel retractor device embodiments of the present invention supporting portions of the patient's bowel therein;

[0049] FIG. 39 is a top view of one of the bowel retractor devices depicted in FIG. 38 in a closed position;

[0050] FIG. 40 is another top view of the bowel retractor device of FIGS. 38 and 39 in an open position;

[0051] FIG. 41 is a partial perspective view of another bowel retractor device embodiment of the present invention supporting a portion of a patient's bowel therein;

[0052] FIG. 42 is a partial perspective view of another bowel retractor device embodiment of the present invention supporting a portion of a patient's bowel therein;

[0053] FIG. 43 is a perspective view of a portion of another bowel retractor device embodiment of the present invention in an uninflated state;

[0054] FIG. 44 is another perspective view of the portion of bowel retractor device embodiment of FIG. 43 in an inflated state;

[0055] FIG. 45 is a partial perspective view of a portion of a patient's abdomen supporting the bowel retractor device embodiment of FIG. 43 therein in an uninflated state; and

[0056] FIG. 46 is another partial perspective view of a portion of a patient's abdomen containing the bowel retractor device embodiment of FIG. 44 therein and supporting a portion of the patient's bowel therein.

#### DETAILED DESCRIPTION

[0057] The assignee of the present application also owns the following applications which were contemporaneously filed herewith on Jul. 13, 2011 and which are each herein incorporated by reference in their respective entireties:

[0058] U.S. patent application Ser. No. 13/181,779, entitled MULTIPLE PART ANVIL ASSEMBLIES FOR CIRCULAR SURGICAL STAPLING DEVICES, now U.S. Pat. No. 9,125,654;

[0059] U.S. patent application Ser. No. 13/181,798, entitled MODULAR SURGICAL TOOL SYSTEMS, now U.S. Pat. No. 9,113,884;

[0060] U.S. patent application Ser. No. 13/181,801, entitled SPECIMEN RETRACTION DEVICES AND METHODS, now U.S. Pat. No. 8,632,462;

[0061] U.S. patent application Ser. No. 13/181,807, entitled MODULAR OCCLUSION AND TISSUE ACQUISITION MECHANISMS FOR CIRCULAR STAPLING DEVICES, now U.S. Pat. No. 8,827,903;

[0062] U.S. patent application Ser. No. 13/181,831, entitled TISSUE MANIPULATION DEVICES, now U.S. Pat. No. 8,858,590;

[0063] U.S. patent application Ser. No. 13/181,768, entitled COLLAPSIBLE ANVIL PLATE ASSEMBLIES FOR CIRCULAR SURGICAL STAPLING DEVICES, now U.S. Pat. No. 9,113,883;

[0064] U.S. patent application Ser. No. 13/181,786, entitled CIRCULAR STAPLING DEVICES WITH TISSUE-PUNCTURING ANVIL FEATURES, now U.S. Pat. No. 9,033,204;

[0065] U.S. patent application Ser. No. 13/181,774, entitled ANVIL ASSEMBLIES WITH COLLAPSIBLE FRAMES FOR CIRCULAR STAPLERS, now U.S. Pat. No. 8,978,955;

[0066] U.S. patent application Ser. No. 13/181,842, entitled RECTAL MANIPULATION DEVICES, now U.S. Pat. No. 8,734,478; and

[0067] U.S. patent application Ser. No. 13/181,836, entitled SURGICAL ACCESS DEVICES WITH ANVIL INTRODUCTION AND SPECIMEN RETRIEVAL STRUCTURES, now U.S. Pat. No. 9,211,122.

[0068] Certain exemplary embodiments will now be described to provide an overall understanding of the principles of the structure, function, manufacture, and use of the devices and methods disclosed herein. One or more examples of these embodiments are illustrated in the accompanying drawings. Those of ordinary skill in the art will understand that the devices and methods specifically described herein and illustrated in the accompanying drawings are non-limiting exemplary embodiments and that the scope of the various embodiments of the present invention is defined solely by the claims. The features illustrated or described in connection with one exemplary embodiment may be combined with the features of other embodiments. Such modifications and variations are intended to be included within the scope of the present invention.

[0069] Reference throughout the specification to “various embodiments,” “some embodiments,” “one embodiment,” or “an embodiment”, or the like, means that a particular feature, structure, or characteristic described in connection with the embodiment is included in at least one embodiment. Thus, appearances of the phrases “in various embodiments,” “in some embodiments,” “in one embodiment”, or “in an embodiment”, or the like, in places throughout the specification are not necessarily all referring to the same embodiment. Furthermore, the particular features, structures, or characteristics may be combined in any suitable manner in one or more embodiments.

[0070] The terms “proximal” and “distal” are used herein with reference to a clinician manipulating the handle portion of the surgical instrument. The term “proximal” referring to the portion closest to the clinician and the term “distal” referring to the portion located away from the clinician. It will be further appreciated that, for convenience and clarity, spatial terms such as “vertical”, “horizontal”, “up”, and “down” may be used herein with respect to the drawings.

However, surgical instruments are used in many orientations and positions, and these terms are not intended to be limiting and/or absolute.

[0071] FIG. 1 illustrates a portion of a patient’s abdominal wall **2** and portions of the patient’s bowel or colon **4**. More specifically, a bowel retractor device **20** embodiment of the present invention is employed to support/retract non-target bowel portions **8** from target bowel portions **6**. As used herein, the term “target bowel portion(s)” refers to that portion or portions of the bowel on which the surgical procedure is to be performed. The term “non-target bowel portions” refers to those portions of the bowel that are not the subject of the surgical procedure and which often obscure physical and/or visual access to the target portions. In the depicted Figure, two conventional trocar devices **10** have been inserted through the abdominal wall **2**. Such trocar devices **10** include a cannula **12** that is configured to form of a passage through the abdominal wall **2** through which surgical instruments **14** may be inserted. A variety of styles and sizes of trocars are known. In general, the trocars are sized based on the inner diameter of their respective cannula.

[0072] In various non-limiting embodiments, the bowel retractor device **20** comprises an elastic body portion **22** that is configurable from a first collapsed orientation that permits the elastic body portion **22** to be inserted through a trocar cannula **12** to a second expanded position wherein a non-target portion or portions **8** of a patient’s bowel **4** are supported by a central portion **24** of the bowel retractor device **20**. In various embodiments, the central portion **24** may comprise a substantially flexible film such as for example silicone or neoprene film having a thickness ranging from, for example, 0.020 inches to 0.120 inches that has a collar or flexible outer ring **26** formed therearound. The flexible outer ring **26** may comprise for example in at least one embodiment, an embedded stainless steel wire or titanium wire. In at least one embodiment, when the retractor device **20** is in the first or collapsed position, it is in a twisted configuration such as those shown in FIGS. 2 and 3. When the retractor device **20** is in the second or expanded position, the retractor device **20** may assume the positions shown in FIGS. 1, 4, and 5. The flexible central portion **24** has a first amount of elasticity and the flexible outer ring **26** has a second amount of elasticity. In some embodiments, the second amount of elasticity is less than the first amount of elasticity. That is the outer ring **26** may be more rigid than the flexible central portion **24**.

[0073] As can be seen in FIGS. 4 and 5, the central portion **24** of the bowel retractor device **20** has at least one opening **28** therein. The size, shape, number, and orientation(s) of such opening(s) may vary. For example, in FIG. 4, the opening **28** comprises an elongated slot and the opening **28** in FIG. 5 has a multiple-pointed star shape.

[0074] The retractor devices **20** may be used as follows in connection with one exemplary method of the present invention. To commence the surgical process, at least two trocars **10** are installed through the patient’s abdominal wall **2** in a known manner. One of the trocars **10** may be initially used to pass the retractor device or devices **20** therethrough. The other trocar **10** may be used to enable the surgeon to pass a conventional surgical instrument such as a grasper **14** to grab the retractor device **20** and position it over the non-target bowel portions **8**. Once the retractor device **20** has exited the trocar cannula **12**, the surgeon may also use that trocar **10** to

pass a second grasper **14** therethrough to assist in drawing the non-target portions **8** of bowel through the opening(s) **28** in the retractor device **20**. Such arrangement enables the non-target bowel portions **8** to be retained away from the target bowel portions **6**. By introducing three or four of the retractor devices **20**, for example, multiple quadrants of non-target bowel portions **8** could be tucked away and easily movable to clear the surgical site. The coupled group could be pulled en masse to one side or the other of the target bowel portion(s) **6** making it very easy to negotiate the multiple bowel quadrants to perform the surgical procedure on the target bowel portions **6**. In various embodiments, the surgeon may pull one section **8** of bowel **4** multiple times through the opening **26** to bunch up and constrain that non-target portion **8** of the bowel **4**.

[0075] In some embodiments, the outer ring or collar **26** may be bendable as opposed to being purely elastic. For example, in some embodiments, the collar **26** may comprise a bendable metal wire or cable that is encapsulated in a flexible material such as silicone, neoprene, etc. In such arrangement, the surgeon may bend or twist the collar or outer ring **26** into a desired configuration and the metal wire will retain it in that configuration. Once the retractor device **20** has been fully inserted into the patient, the surgeon may bend the retractor device **20** into whatever restraining form that would be most useful to keep the clump of non-target bowel **8** out of the working space. For example, the retractor device **20** may be folded or bent and then lodged up behind the trocar cannula **12** or held back with a grasping instrument **14**, whichever is more convenient. The flexible fit holds the non-target bowel portion **8** together without strangulating it or interfering with the peristalsis which might cause swelling. The fit between the non-target portion(s) **8** pulled through the opening(s) is such that the non-target bowel portion(s) would not slip back out of the opening **28**.

[0076] FIGS. **6** and **7** illustrate bowel retractor devices **20** with alternative opening arrangements. In particular, the openings **28** comprises a plurality of slots and perforations **29**. The perforations **29** are aligned off of each end of the slots **28** as shown and enable the flexible center portion **24** to rupture to enable the slots **28** to enlarge or expand as needed as the bowel portions **8** are pulled therethrough. In FIGS. **7** and **8**, those slots that have expanded are designated as slots “**28E**”.

[0077] FIG. **8** illustrates another retractor device **30** embodiment of the present invention that includes a body portion **32** that is configurable from a first collapsed orientation that permits the body portion **32** to be inserted through a trocar cannula or other opening in a patient's body to a second expanded position wherein a non-target portion or portions **8** of a patient's bowel **4** are supported by a central portion **34** of the bowel retractor device **30**. In various embodiments, the central portion **34** may comprise a substantially flexible film such as, for example, a silicone or neoprene film having a thickness ranging from, for example, 0.020 inches to 0.120 inches that has a collar or flexible outer ring **36** formed therearound. As can be seen in FIG. **8**, the outer collar **36** is formed with a plurality of spaced radially outwardly extending tabs **38**. Each tab **38** has a hole **40** therethrough that is configured to receive a cinchable member **42** such as, for example, a vectran, nylon, polyglycolic acid (PGA), catgut, or polypropylene cable to be woven therethrough as shown. The end portions **43, 44** of the cinchable member **42** pass through a grommet portion **39**

of the collar **36**. By applying tension “**T**” to the end portions **43, 44** will cause the bowel retractor **30** to be cinched around the non-target bowel portions **8** pulled through an opening **35** in the central portion **34**. The cinchable member **42** may also be used to manipulate the retractor **30** and retrain it in a desired position.

[0078] In FIG. **9**, the bowel retractor device **50** is substantially similar to the bowel retractor device **30**, except that the bowel retractor device **50** lacks the cinchable member. Instead a flexible tether **52** extends from the device **50**. The tether has a manipulation ring **54** attached thereto as shown. The outwardly extending tabs **38** form portions of the device **50** that may be easily grasped with a grasping instrument to facilitate the installation, manipulation and positioning of the bowel retractor device **50**.

[0079] FIGS. **10** and **11** illustrate another bowel retractor device embodiment **60** of the present invention. The bowel retractor **60** includes an elastic body portion **62** that comprises a flexible plate member **63** that has a plurality of openings **64, 66, 68** therethrough. In various embodiments, the flexible plate member **63** may comprise, for example, a silicone or neoprene film having thicknesses that range from 0.020 inches to 0.150 inches. In the illustrated embodiment, three different sizes of openings are shown. In other embodiments, all of the openings may have the same size and/or have different shapes. The scope of this embodiment of the present invention is intended to cover embodiments with a variety of differently-shaped openings and different arrangements of openings—having the same size and having different sizes. As can be further seen in FIGS. **10** and **11**, a tether **70** is attached to other otherwise formed with the body portion **62** such that it protrudes therefrom. In addition, a retention tab or portion **72** is also formed on or attached to the body portion **62**. In the illustrated embodiment, the body portion **62** is substantially square-shaped and the tether **70** and retention tab **72** are formed on opposite corners of the plate member **63**.

[0080] The bowel retractor device **60** may be used as follows. After the device **60** has been inserted through the trocar **10** or otherwise located at the surgical site, the surgeon may use graspers or other surgical instruments to draw the non-target portions **8** of the patient's bowel **4** through one or more of the openings **64, 66, 68** in the body portion **62** in the manner described above. Once the non-target bowel portion(s) **8** have been drawn through one or more of the openings **64, 66, 68** the surgeon may loop the tether **70** through an opening **74** in the retention tab **72** and extend the tether **70** back through the trocar cannula **12** to enable the surgeon to retain, manipulate and/or position the retractor device **60** and retained non-target bowel portion(s) **8** from outside of the patient.

[0081] FIGS. **12** and **13** illustrate another bowel retractor device embodiment **80** of the present invention. As can be seen in FIG. **12**, in at least one embodiment, the device **80** comprises a plurality of (four are shown) of flexible plate members **82** that are interconnected by flexible straps **84**. Each plate member **82** has at least one (two are shown) openings **83** therein. The openings **83** shown have a multiple pointed star shape. The number, shape and orientation of openings **83** may vary. One or more plate members **82** may have different numbers of differently shaped openings in arrangements that differ from the openings and arrangements in one or more other plate members **82**. In still other embodiments, at least one plate member **82** has at least one

opening 83 therethrough. As can also be seen in FIG. 12, a tether 86 is attached to, or is otherwise formed with, one of the plate members 82 such that it protrudes therefrom. In addition, a retention strap 88 is attached to, or is otherwise formed with, another plate member 82. In the illustrated embodiment, the four plate members 82 are shown and the tether 86 and retention strap 72 are formed on the corners of opposite plate members 82.

[0082] The bowel retractor device 80 may be used as follows. After the device 80 has been inserted through the trocar 10 or otherwise located at the surgical site, the surgeon may use graspers or other surgical instruments to draw the non-target portions 8 of the patient's bowel 4 through one or more of the openings 83 in the plate members 82 in the manner described above. Once the non-target bowel portion(s) 8 have been drawn through one or more of the openings 83, the surgeon may loop the tether 86 through an opening 90 in the retention strap 88 and extend the tether 86 back through the trocar 10 to enable the surgeon to retain, manipulate and/or position the device and retained non-target bowel portion(s) 8 from outside of the patient.

[0083] FIGS. 14 and 15 illustrate another bowel retractor embodiment 100 of the present invention. The bowel retractor 100 includes a body portion 102 that comprises a flexible mesh portion that has a plurality of openings 104 therethrough. In various embodiments, the body portion may be fabricated from, for example, silicone, neoprene, etc. In the illustrated embodiment, openings 104 may be arranged in a grid-like fashion. In other embodiments, the openings may have different sizes. The scope of this embodiment of the present invention is intended to cover embodiments with a variety of differently-shaped openings and different arrangements of openings—having the same size and having different sizes. As can be further seen in FIGS. 14 and 15, at least one manipulation formation 106 is formed on the body portion 102. In the illustrated embodiment, the device 100 is substantially square-shaped and a manipulation formation 106 is formed on each corner thereof. Each manipulation formation 106 has a hole 108 therethrough to enable a manipulation tool to engage and manipulate the device 100. The manipulation tool may comprise a grasper or other surgical instrument. In the illustrated embodiment, two needle-like hook members 110 are inserted through the patient's abdominal wall and serve to hook the openings 108 in the manipulation formations 106.

[0084] The bowel retractor device 100 may be used as follows. After the device 100 has been inserted through the trocar 10 or otherwise located at the surgical site, the surgeon may use graspers or other surgical instruments to draw the non-target portions 8 of the patient's bowel 4 through one or more of the openings 104 in the body portion 102 in the manner described above. Once the bowel portions 8 have been drawn through one or more of the openings 104, the surgeon may insert one or more of the needle-like hook members 110 through the abdominal wall 2 to hookingly engage one or more of the manipulation formations 106 to position and or retain the device 100 in a desired orientation.

[0085] FIG. 16 illustrates another bowel retractor device embodiment 120 of the present invention. The bowel retractor device 120 includes a body portion 122 that comprises a flexible annular ring 124 that has a flexible central portion 126 attached thereto. In at least one embodiment, the flexible central portion 126 comprises a plurality of interwoven flexible ribbon-like members 128. In various embodiments,

the flexible annular ring may be fabricated from, for example, Polypropylene, Santoprene, etc. The interwoven ribbon members 128 will have weave tightness that permits non-target portion(s) 8 of the patient's bowel to be pulled therethrough without damaging the bowel, yet retain the non-target bowel portion(s) in position. To assist the surgeon with the manipulation and support of the device 120, a manipulation formation 129 may be formed on the annular ring 124 as shown.

[0086] The bowel retractor device 120 may be used as follows. After the device 120 has been inserted through the trocar 10 or otherwise located at the surgical site, the surgeon may use graspers or other surgical instruments to draw the non-target portions 8 of the patient's bowel 4 between the ribbons 128 in the manner described above. Once the bowel portions 8 have been drawn between the ribbons 128, the surgeon may use a grasper or other surgical instrument to engage the manipulation formation 129 to position and or retain the device 120 in a desired orientation.

[0087] FIG. 17 illustrates another bowel retractor device embodiment 130 of the present invention. The bowel retractor device 130 includes a body portion 132 that comprises a flexible annular ring 134 that has a flexible central portion 136 attached thereto. In at least one embodiment, the flexible central portion 136 comprises a plurality of interwoven flexible strips 138. In various embodiments, the flexible annular ring 134 may be fabricated from, for example, Santoprene, polypropylene, etc. In at least one embodiment, the interwoven flexible strips 138 have a substantially circular cross-sectional shape. The interwoven strips 138 define a plurality of openings 139 and will have weave tightness that permits non-target portion(s) 8 of the patient's bowel 4 to be pulled through one or more of the openings 139 without damaging the bowel, yet retain the bowel in position. To assist the surgeon with the manipulation and support of the device 120, a manipulation formation (not shown) may be formed on the annular ring 134 as shown.

[0088] The bowel retractor device 130 may be used as follows. After the device 130 has been inserted through the trocar 10 or otherwise located at the surgical site, the surgeon may use graspers or other surgical instruments to draw the non-target portions 8 of the patient's bowel 4 through one or more of the openings 139 in the manner described above. Once the non-target bowel portion(s) 8 have been drawn between the flexible strips 138, the surgeon may use a grasper or other surgical instrument to engage the manipulation formation to position and or retain the device 130 in a desired orientation.

[0089] FIG. 18 illustrates another bowel retractor device embodiment 140 of the present invention which is substantially similar to the bowel retractor device 130 described above except that the central portion 136' comprises a plurality of layers 142 of interwoven flexible strips 138. The bowel portions 8 may be drawn through the openings 139 in one or more of the layers 142. FIG. 19 illustrates another bowel retractor device embodiment 150 of the present invention which is substantially similar to the bowel retractor device 140 described above, except that one of the layers 142 comprises a plurality of interwoven ribbons 128 and another layer 142 comprises a plurality of interwoven flexible strips 138.

[0090] FIG. 20 illustrates another bowel retractor device embodiment 150 of the present invention. The bowel retractor device 150 includes a body portion 152 that comprises a

flexible endless collar member **154** that defines an inner area **156**. In various embodiments, the flexible endless collar member **154** is elongated and is sized to be passed down through a trocar cannula **12** or other opening through the abdominal wall **2**. The flexible endless collar member **154** may be fabricated from, for example, Santoprene, polypropylene, etc. The device **150** further includes a plurality of flexible fingers **156**, **160** that protrude inwardly from the endless collar member **154**. In at least one embodiment, the flexible fingers **158** extend between fingers **160** and have a cross-sectional size that differs from a cross-sectional size of fingers **160**. Also in various embodiments, each of the fingers **158** have a ball-shaped member **159** formed on the end thereof and each of the fingers **160** have a ball-shaped member **162** formed on the end thereof. In at least one embodiment, each of the ball-shaped members **159** have a diameter that differs from the diameter of the ball-shaped members **162**.

[0091] The bowel retractor device **150** may be used as follows. After the device **150** has been inserted through the trocar **10** or otherwise located at the surgical site, the surgeon may use graspers or other surgical instruments to draw the non-target portions **8** of the patient's bowel **4** through the central area **156**. Once the non-target bowel portions **8** have been drawn between the flexible fingers **158**, **160**, the surgeon may use a grasper or other surgical instrument to engage the manipulation formation **166** formed on the endless collar member **154** to position and or retain the device **150** in a desired orientation.

[0092] FIG. **22** illustrates another bowel retractor device embodiment **170** of the present invention. The bowel retractor device **170** includes a body portion **172** that comprises a flexible endless collar member **174** that defines an inner area **176**. In various embodiments, the flexible endless collar member **174** is elongated and is sized to be passed down through a trocar cannula **12** or other opening through the abdominal wall **2**. The flexible end less collar member **174** may be fabricated from, for example, Santoprene, polypropylene, etc. The device **170** further includes a plurality of flexible fingers **177**, **178** that protrude inwardly from the endless collar member **174**. In at least one embodiment, the flexible fingers **178** extend between fingers **177**. The flexible fingers **178** have a length that is shorter than the length of fingers **177**. Also in various embodiments, each of the fingers **177**, **178** have a ball-shaped member **179** formed on the end thereof. In at least one embodiment, the fingers **177**, **178** lie along a common plane. Also in one embodiment, a manipulation formation **175** is formed on the endless collar member **174** to enable the device **170** to be easily manipulated with a surgical instrument such as a grasping instrument.

[0093] The bowel retractor device **170** may be used as follows. After the device **170** has been inserted through the trocar **10** or otherwise located at the surgical site, the surgeon may use graspers or other surgical instruments to draw the non-target portions **8** of the patient's bowel **4** through the central area **176**. Once the non-target bowel portions **8** have been drawn between the flexible fingers **177**, **178**, the surgeon may use a grasper or other surgical instrument to engage the manipulation formation **175** formed on the endless collar member **174** to position and or retain the device **170** in a desired orientation.

[0094] FIG. **24** illustrates a bowel retractor device **170'** that is substantially identical in construction and use as

bowel retractor device **170** except that device **170'** only has fingers **177** that all have a common length. FIG. **25** illustrates a bowel retractor device **180** that is substantially identical in construction and use as bowel retractor device **170'**, except that fingers **177** protrude out of the inner area **176**. In particular, the endless collar **174** defines a reference plane "RP" and each of the fingers **177** extend transversely to reference plane RP. The bowel retractor device embodiment **180** depicted in FIG. **25** is substantially identical to bowel retractor device **170'**, except that fingers **177** all taper away from the endless collar **174** in a general frusto-conical configuration. That is, each of the fingers **177** extend along an axes that will ultimately intersect at a common point. The bowel retractor device **180'** in FIG. **26** is substantially identical in construction and use as bowel retractor device **180** except that the fingers **177** extend out of the open area such that they are substantially perpendicular to the reference plane RP and are substantially parallel to each other. The bowel retractor device **180''** in FIG. **27** is substantially identical to the bowel retractor device **180'** except that the fingers **177** have different lengths. The bowel retractor devices **170'**, **180**, **180'**, **180''** may all be used in the various manners described above.

[0095] FIG. **28** illustrates the use of four bowel retractor devices **190** for supporting the non-target bowel portions **8** in each of four quadrants involved in the surgical procedure. In at least one embodiment, each bowel retractor device **190** comprises a flexible pouch **192** that has an opening **194** therein. In one embodiment, the opening is surrounded by a collar member **196** in the form of an elastic band. The pouches **192** may be rolled up into a first collapsed position to enable them to be inserted through a trocar cannula **12**. Once the pouches **192** have been inserted into the surgical area, the surgeon may open each pouch **192** and install it over a portion of non-target bowel **8**. Once the pouches have been installed over the various non-target bowel portion(s) **8**, they may be separated into quadrants which provide the surgeon with physical and visual access to the target bowel portion. Those of ordinary skill of the art will understand that various numbers of pouches **192** may be employed as needed.

[0096] FIGS. **29** and **30** illustrate another bowel retractor device **190'** that is substantially identical to bowel retractor device **190**, except that the collar member comprises an elastic band **196'** that may be expanded from a non-expanded or collapsed state to an expanded state by inserting a selectively expandable and contractible installation head **193** of an installation tool **191** into the opening **194**. When the installation head **193** is expanded, the elastic collar or band **196'** is retained in the expanded state to permit the non-target bowel portions **8** to be inserted into the pouch **192** through the opening **194**. Once the non-target bowel portion **8** has been inserted into the pouch, the installation head **193** is moved to the contracted position and removed from the elastic collar **196'** which lightly contracts around the non-target bowel portions **8** protruding through the opening **194** to retain the non-target bowel portion **8** within the pouch **192** without damaging the non-target bowel portion **8** protruding therefrom.

[0097] The bowel retractor device **190''** in FIG. **31** is substantially identical in construction and use as bowel retractor device **190** except that the collar **196''** is a cinchable member. For example, the collar **196''** may comprise an expandable belt-type member that may be expanded to form

a desired opening and then locked in position by a lock screw 197. Thus, the surgeon may release the lock screw 197 to enable the opening to be expanded for installation over a portion of the non-target bowel portion 8 and thereafter cinched in and locked with locking screw 197 to retain the pouch 192 on the non-target bowel portion 8 captured therein.

[0098] FIGS. 32-36 illustrate another form of bowel retractor device 200 embodiment of the present invention. In various forms, the bowel retractor device 200 comprises a body portion 202 in the form of a pouch 204. In various embodiments, the pouch 204 may have a cinchable opening 206 therein. In at least one embodiment, a closure member 208 is attached to the pouch 204 such that it extends around the opening 206. The closure member 208 may be configured with two diametrically opposed hinge portions 210 that facilitates movement of the closure member 208 from a collapsed or closed position (FIG. 33) to an open position (FIG. 32). As illustrated in FIG. 32, the closure member 208 may be moved to the open position by applying opposing forces "F1" on the hinge portions 210 as well as applying opening forces "F2" in opposite directions to the closure member 208. The bowel retractor device 200 may be inserted into the patient through a trocar 10 as shown in FIG. 34. To facilitate insertion of the retractor device 200 through the trocar cannula 12, the device 200 may be rolled up as shown in FIGS. 34-36. FIG. 37 illustrates another bowel retractor device 200' that is substantially identical in construction and use as bowel retractor device 200 except that the closure member 208' is substantially spring-loaded. Such spring loading may be created by the configuration of the closure member itself or be assisted with one or more spring members (not shown) embedded therein. FIGS. 38-40 illustrate another bowel retractor embodiment 200'' that is essentially the same as the bowel retractor 200, except that the closure member 208'' has four hinge portions 210''.

[0099] The closure members 208, 208', 208'' of the bowel retractor devices 200, 200', 210'', respectively are designed in their normal state to be biased to a closed position or state. When in the closed state, however, the closure members 208, 208', 208'' may be designed to limit the closure force exerted onto the portion of the bowel received therein to minimize the risk of occlusion of blood flow to the captured bowel portion as well as to allow peristalsis to continue. Such closure bias is designed to immediately immobilize the non-target portions 8 of the bowel placed in the pouch so that it does not slip back out. The hinge portions 210, 210', 210'' enable the closure members 208, 208', 210'' to be forced open for the entire loading period, or more preferably, the closure member could be opened only as bowel segments are pulled in. The closure portions then maintain the opening in a closed position while the surgeon moves to grasp the next section of bowel to be introduced into the pouch. Thus, use of the biased closed temporary bowel retractor devices 200, 200', 200'' improve the ease of introducing bowel portions therein as the closure portions thereof can automatically close itself to keep the non-target bowel portion from slipping back out of the pouch. The maximum cinching load also prevents inadvertent damage to the non-target bowel during retraction. In use, the surgeon may insert several of the devices 200, 200', and/or 200'' through a trocar, trocars or other openings in the patient at the beginning of the surgical procedure. Lengths of the non-target bowel portions 8 would be placed into a pouch and then

when the pouch became sufficiently full, the closure member thereof would be "snapped" shut. This procedure may be repeated with other bowel retractor devices 200, 200', 200'' as needed. These loaded pouches could then be easily moved from one position to another in the abdomen cavity during the procedure. The surgeon is able to easily grasp and move en masse sections of the bowel 4 to move it out of the way. Additionally, the pouches could be temporarily clipped or pinned to different abdomen wall structures to facilitate more retraction. Also, the various pouch-type bowel retractor devices disclosed above may include a grasper access hole through the bottom of the pouch to enable a grasper instrument to be inserted therethrough and out through the pouch opening to grasp bowel portions to draw them into the pouch. Such arrangement serves to facilitate easy introduction of the bowel portions into the pouch. The hinge arrangements also serve to bias the closure members closed around the bowel portions as they are drawn into the pouch.

[0100] FIGS. 41 and 42 illustrate another bowel retractor device embodiment 220 of the present invention. Various embodiments include a substantially elastic body portion 222 that is insertable through an opening in a patient's body to a second expanded position wherein a portion of the patient's bowel may be supported thereby. In various embodiments, the body portion 222 includes a central portion 224 that has at least three flexible first arms 226 that protrude from the central portion 224 in a first direction. A first opening 228 is formed between each first arm 226. In at least one embodiment, each first opening has a shape that generally resembles a portion of an hourglass. In particular, each first opening 228 has a first neck portion 229 that is narrower than a first bottom portion 230. As can be further seen in FIGS. 41 and 42, the bowel retractor device 220 further comprises at least two flexible second arms 240 that protrude from a second side of the central portion 224 in a second direction. In one embodiment, each second arm 240 protrudes from the center portion 224 at positions opposite to the first opening 228. In other embodiments, the second arms 240 may be aligned with corresponding first arms 226. A second opening 242 is formed between each second arm 240. In at least one embodiment, each second opening 242 has a shape that generally resembles a portion of an hourglass. In particular, each second opening 242 has a second neck portion 244 that is narrower than a second bottom portion 246. In other embodiments, the first and second openings may be provided in other shapes.

[0101] Various embodiments of the bowel retractor device 220 are fabricated from a foam material or other elastic material. In other embodiments, each of the first and second arms 226, 240 have a bendable wire member or wire members (nitinol, spring steel, etc.) embedded therein to enable the arms 226, 240 to be advantageously bent in position to facilitate insertion of the retractor device 220 through a trocar or other opening. In still other embodiments, the center portion 224 may have a bendable wire portion therein. In other arrangements, bendable wires may be embedded in the center portion 224 and each of the first and second arms 226, 240. In other embodiments, at least one bendable wire is embedded in at least one of the center portion 224, a first arm 226 and/or a second arm 240. Such arrangements facilitate the bending of the device 220 in a position that facilitates its insertion through a trocar cannula. In other embodiments, however, the device 220 may be

sized such that it can pass through a trocar cannula without having to be bent or collapsed.

[0102] In use, once the bowel retractor device 220 has been inserted into the patient through a trocar or other opening in the patient's body, the surgeon may grasp the retractor 220 with a grasping instrument and then pull non-target bowel portions 8 through the first and/or second openings 228, 242. The bowel portions 8 may be held in place by manipulating the formable arms 226, 240. In various embodiments, a suture drawstring 250 (FIG. 42) is provided to further support and tie down the retractors position. This step could be repeated several times creating a grouped clump of small bowel that can be moved around merely by moving the bowel retractor 220. Various embodiments of the retractor 220 can be bent into whatever restraining form would be most useful to keep the clump out of the working space. It could be lodged up behind a trocar cannula 12 or held back with a grasping instrument 14, whatever is convenient for the specific case. The flexible fit holds the small bowel together without strangulating it or interfering with the peristalsis causing swelling. The fit is tight enough to prevent the bowel from slipping right back out.

[0103] FIGS. 43-46 illustrate another bowel retractor device embodiment 260 of the present invention. In various embodiments, the retractor 260 comprises an inflatable ring 262 that defines an interior area 264. The inwardly facing surface 266 of the inflatable ring 262 is textured with, for example, dimples 269, etc. The ring 262 is supplied with a pressurized medium such as, for example, through a supply conduit 270 that is attached to a source of pressurized medium 272 located outside of the patient's body. See FIG. 45.

[0104] To use the bowel retractor device 260, the retractor 262 (in its collapsed or uninflated state) as well as the supply conduit may be inserted through a trocar 10 mounted in the abdominal wall 2 or it may be inserted into the surgical site through another opening 5 in the abdominal wall 2 as shown in FIG. 46. Once in position, the surgeon may then grasp non-target bowel portions 8 with one or more grasping instruments 14 to pull the non-target bowel portions 8 through the interior area 264. The surgeon may first inflate the ring 262 prior to pulling the non-target bowel portions 8 through the interior area 264 or the surgeon may pull the non-target bowel portions 8 through the interior area 264 prior to inflating the ring 262. Once inflated, the textured surface 266 retains the bowel portions in position. One or more retractors 260 may be used in the various methods described above to advantageously provide the surgeon with physical and visual access to the target tissue during the operation.

[0105] The various bowel retraction devices disclosed herein represent vast improvements over other retraction devices and methods commonly employed with performing operations on a patient's bowel. Many embodiments may be easily inserted into the patient through a common trocar cannula. The devices are easily manipulatable with common grasping instruments. Several of such devices may be used as necessary to advantageously locate non-target portion(s) of bowel in a desired position to provide the surgeon with physical and visual access to the target tissue. Once bunches of bowel have been gathered together, the bunches may be easily moved and positioned en masse to a desired location. The retractors may be easily clipped to portions of the abdomen to hold the retractor in position if necessary. While

the various retractor devices disclosed herein have been described in detail for use in connection with bowel surgeries, it is conceivable that various embodiments of the present invention could also be employed to retract other forms of tissue/organs without departing from the spirit and scope of the present invention.

[0106] Any patent, publication, or other disclosure material, in whole or in part, that is said to be incorporated by reference herein is incorporated herein only to the extent that the incorporated materials does not conflict with existing definitions, statements, or other disclosure material set forth in this disclosure. As such, and to the extent necessary, the disclosure as explicitly set forth herein supersedes any conflicting material incorporated herein by reference. Any material, or portion thereof, that is said to be incorporated by reference herein, but which conflicts with existing definitions, statements, or other disclosure material set forth herein will only be incorporated to the extent that no conflict arises between that incorporated material and the existing disclosure material.

[0107] The invention which is intended to be protected is not to be construed as limited to the particular embodiments disclosed. The embodiments are therefore to be regarded as illustrative rather than restrictive. Variations and changes may be made by others without departing from the spirit of the present invention. Accordingly, it is expressly intended that all such equivalents, variations and changes which fall within the spirit and scope of the present invention as defined in the claims be embraced thereby.

What is claimed is:

1. A bowel retractor device comprising an elastic body that is configurable from a first collapsed position wherein said elastic body is configured to be fully passed through an opening in a patient's body and a second expanded position wherein a portion of the patient's bowel may be pulled through a central portion of said elastic body in a desired orientation.

2. The bowel retractor device of claim 1, wherein said central portion comprises an elastic flexible film having a first amount of elasticity and at least one opening there-through configured to permit a portion of the bowel to pass therethrough and be retained therein and wherein said flexible film is coupled to a flexible outer ring having a second amount of elasticity that is less than said first amount of elasticity.

3. The bowel retractor device of claim 2, wherein when said flexible film is in said first collapsed position, said flexible film is in a substantially twisted configuration and when said flexible film is in said second open position, said flexible film is substantially planar.

4. The bowel retractor device of claim 2, wherein said at least one opening comprises at least one expandable opening.

5. The bowel retractor device of claim 4, wherein said at least one expandable opening comprises:

an elongated slot having two ends; and

at least one additional opening adjacent to each end of said elongated slot and spaced therefrom such that a portion of said flexible film between each said end and each said adjacent additional opening is rupturable.

6. The bowel retractor device of claim 4, wherein said at least one expandable opening comprises a plurality of rupturable perforations in said flexible film.



7. The bowel retractor device of claim 1, wherein said central portion comprises an elastic flexible film that has at least one opening therethrough that is configured to permit a portion of the bowel to pass therethrough and be retained therein and wherein said flexible film is coupled to an outer ring comprising a selectively bendable member.

8. The bowel retractor device of claim 1, wherein said elastic body comprises a flexible outer collar that defines said central portion and has a flexible cinchable member woven therethrough and wherein said central portion comprises a flexible film having at least one opening therethrough.

9. The bowel retractor device of claim 8, wherein said flexible outer collar has a plurality of spaced radially outwardly protruding tabs formed thereon and wherein said flexible cinchable member comprises a flexible cable woven through the tabs.

10. The bowel retractor device of claim 1, further comprising at least one tether member attached to said elastic body.

11. The bowel retractor device of claim 10, wherein said elastic body comprises a flexible plate member having a plurality of openings therethrough and wherein said plate member has a retention portion protruding therefrom opposite to said tether such that said tether may be inserted through a tether opening in said retention portion.

12. The bowel retractor device of claim 1, wherein said elastic body comprises

a plurality of substantially flexible plate members, each said plate member having at least one opening therethrough and wherein said substantially flexible plate members are attached to each other in a spaced apart relationship by at least one flexible strap member.

13. The bowel retractor device of claim 12, wherein said plurality of substantially flexible plate members comprises four spaced apart said flexible plate members and wherein one said plate member has a retention strap protruding therefrom that is insertable through a retention opening in a retention tab protruding from another one of said flexible plate member.

14. The bowel retractor device of claim 1, wherein said elastic body comprises a flexible mesh portion having a plurality of openings therethrough arranged in a grid-like fashion.

15. The bowel retractor device of claim 1, wherein said elastic body comprises a flexible annular ring extending around said central portion and wherein said central portion comprises a plurality of interwoven flexible members.

16. The bowel retractor device of claim 15, wherein said plurality of interwoven flexible members comprises a plurality of interwoven flexible ribbon members.

17. The bowel retractor device of claim 15, wherein said plurality of interwoven flexible members comprises:

a first layer of interwoven members; and  
a second layer of interwoven members spaced from said first layer of interwoven members.

18. The bowel retractor device of claim 17, wherein each said interwoven member has a substantially circular cross-sectional shape.

19. The bowel retractor device of claim 1, wherein said elastic body comprises:

a flexible endless outer collar member defining an inner area; and

a plurality of flexible fingers protruding inwardly into said inner area from said flexible endless outer collar member.

20. The bowel retractor device of claim 19, wherein each said flexible finger terminates in a ball-shaped member.

21. The bowel retractor device of claim 19, wherein said endless outer collar defines a reference plane and wherein each said flexible finger extends from said endless outer collar in a direction substantially transverse to said reference plane.

22. The bowel retractor device of claim 1, wherein said elastic body comprises a collar portion having at manipulation formation thereon for interaction with a manipulation tool and wherein said central portion comprises a flexible mesh portion defining a plurality of openings therein.

23. The bowel retractor device of claim 1, wherein said central portion of said elastic body comprises a flexible pouch defining a selectively cinchable opening.

24. The bowel retractor device of claim 23, wherein said cinchable opening comprises:

an annular member coupled to said flexible pouch and defining said opening, said annular member formed from an expandable and contractible band to facilitate selective adjustment of a size of said opening; and  
a releasable locking member interacting with said expandable and contractible band to selectively lock the band in a desired position.

25. The bowel retractor device of claim 1, wherein said central portion of said elastic body comprises:

a flexible pouch defining an opening; and  
a closure member attached to said flexible pouch and extending around said opening, said closure member configured to be moved from a closed position wherein said opening is substantially collapsed to an open position upon application of at least one opening motion thereto and return to said closed position upon discontinuing said application of said at least one opening motion.

26. The bowel retractor device of claim 1, wherein said central portion of said elastic body comprises a flexible pouch defining an opening having an elastic collar member extending therearound and wherein said bowel retractor further comprises an installation tool configured to support said elastic collar in an expanded orientation during installation and is selectively releasable from said elastic collar to enable said elastic collar to assume an unexpanded orientation.

27. A bowel retractor device, comprising:

a central portion;  
a first plurality of flexible first arms protruding from said central portion in a first direction and defining a first opening between each said adjacent flexible arm; and  
a second plurality of flexible second arms protruding from said central portion in a second direction wherein each said flexible second arm protrudes from said central portion at positions opposite from said first openings wherein said flexible second arms are spaced from each other to form a second opening therebetween and wherein a portion of a patient's bowel may be pulled through said central portion.

28. The bowel retractor device of claim 27, wherein when said elastic body is in said second expanded position, said first flexible arms and said second flexible arms are substantially coplanar with said central portion.



**29.** The bowel retractor device of claim **27**, further comprising a cinchable member extending through each of said first and second flexible arms.

**30.** The bowel retractor device of claim **27**, wherein at least one said arm has a selectively bendable member embedded therein.

**31.** A bowel retractor device comprising:

a selectively inflatable ring having a textured annular surface defining an interior area wherein a portion of a patient's bowel may be pulled through said interior area; and

a supply conduit coupled to said selectively inflatable ring and a source of pressurized medium.

**32.** A method for performing laparoscopic bowel surgery on a target portion of a patient's bowel comprising:

inserting at least one bowel retractor device through an opening in the patient, each said bowel retractor device comprising a body configurable from a first collapsed position wherein the body is insertable through the opening to a second expanded position;

engaging a corresponding non-target portion of the bowel with a central portion of each of the at least one bowel retractor devices when in the second expanded position; and

positioning the at least one bowel retractor device to locate the corresponding non-target bowel portion engaged thereby in non-obtrusive positions to thereby provide physical and visual access to the target portion of the bowel.

\* \* \* \* \*

专利名称(译)	手术肠牵开器装置		
公开(公告)号	<a href="#">US20190029661A1</a>	公开(公告)日	2019-01-31
申请号	US16/150589	申请日	2018-10-03
[标]申请(专利权)人(译)	ETHICON, LLC		
申请(专利权)人(译)	ETHICON LLC		
当前申请(专利权)人(译)	ETHICON LLC		
[标]发明人	WIDENHOUSE TAMARA SHELTON IV FREDERICK E		
发明人	WIDENHOUSE, TAMARA SHELTON, IV, FREDERICK E.		
IPC分类号	A61B17/02 A61B17/068 A61B17/072 A61B17/115 A61B17/00 A61B17/34		
CPC分类号	A61B2560/0443 A61B2017/0287 A61B17/00234 A61B17/0293 A61B17/068 A61B17/1155 A61B2017/0225 A61B2017/07257 A61B17/072 A61B17/3417 A61B17/0218 A61B2017/00287 A61B2017/00477 F04C2270/0421 A61B2017/00353 A61B17/07207		
外部链接	<a href="#">Espacenet</a> <a href="#">USPTO</a>		

摘要(译)

肠牵开器装置。在各种形式中，肠牵开器装置可从折叠位置配置，其中牵开器可通过套管针套管或患者体内的其他开口插入第二扩展位置，其中患者肠的至少一部分可有利地被支撑在一个理想的位置。

