



US 20150005582A1

(19) **United States**
(12) **Patent Application Publication**
POLL et al.

(10) **Pub. No.: US 2015/0005582 A1**
(43) **Pub. Date: Jan. 1, 2015**

(54) **SYSTEMS AND METHODS FOR OPTIMIZING AND MAINTAINING VISUALIZATION OF A SURGICAL FIELD DURING THE USE OF SURGICAL SCOPES**

(60) Provisional application No. 61/121,514, filed on Dec. 10, 2008, provisional application No. 61/170,864, filed on Apr. 20, 2009.

(71) Applicants: **Wayne L. POLL**, New Albany, OH (US); **Matthew J. HUDDLESTON**, GALENA, OH (US); **Caroline M. CRISAFULLI**, Columbus, OH (US); **Adam LANDIS**, Reynoldsburg, OH (US); **Gregory P. DRACH**, Liberty Township, OH (US)

(72) Inventors: **Wayne L. POLL**, New Albany, OH (US); **Matthew J. HUDDLESTON**, GALENA, OH (US); **Caroline M. CRISAFULLI**, Columbus, OH (US); **Adam LANDIS**, Reynoldsburg, OH (US); **Gregory P. DRACH**, Liberty Township, OH (US)

(21) Appl. No.: **14/490,501**
(22) Filed: **Sep. 18, 2014**

Related U.S. Application Data

(63) Continuation of application No. 12/653,148, filed on Dec. 9, 2009, now Pat. No. 8,888,689, which is a continuation-in-part of application No. 11/765,340, filed on Jun. 19, 2007.

Publication Classification

(51) **Int. Cl.**
A61B 1/00 (2006.01)
A61B 1/313 (2006.01)
A61M 13/00 (2006.01)
A61B 1/12 (2006.01)
(52) **U.S. Cl.**
CPC *A61B 1/00135* (2013.01); *A61B 1/126* (2013.01); *A61B 1/3132* (2013.01); *A61M 13/003* (2013.01)
USPC **600/123**

(57) **ABSTRACT**

A method of defogging and cleaning a laparoscope includes: (1) inserting a laparoscope into a sheath; (2) inserting the laparoscope and sheath into a body cavity; (3) providing gas to a plurality of gas lumens within a wall of the sheath such that the gas flows through the gas lumens and over a lens of the laparoscope to defog the lens while the laparoscope is in the body cavity; and (4) providing a fluid comprising a surface-active agent to a fluid lumen within the wall of the sheath such that the fluid flows through the fluid lumen and over the lens to clean the lens while the laparoscope is in the body cavity.

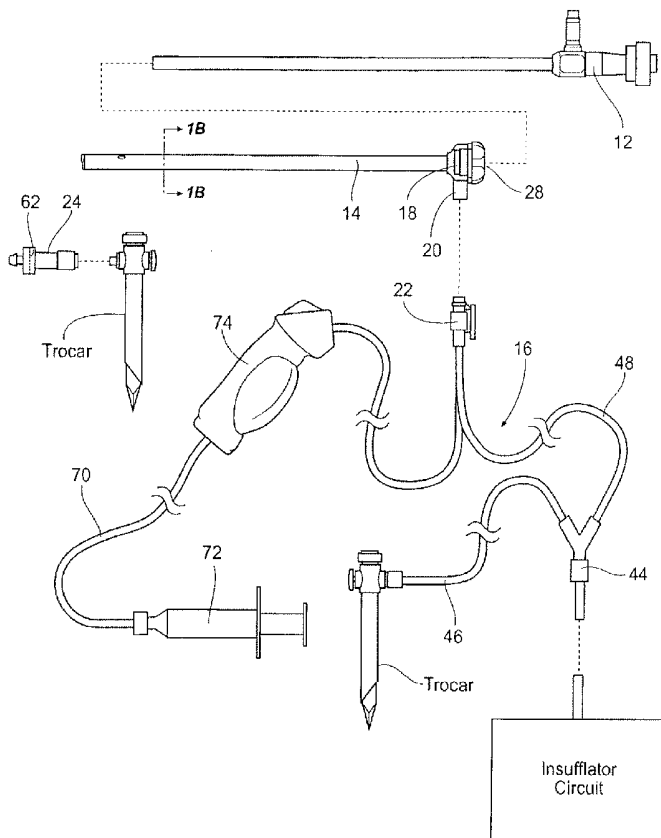

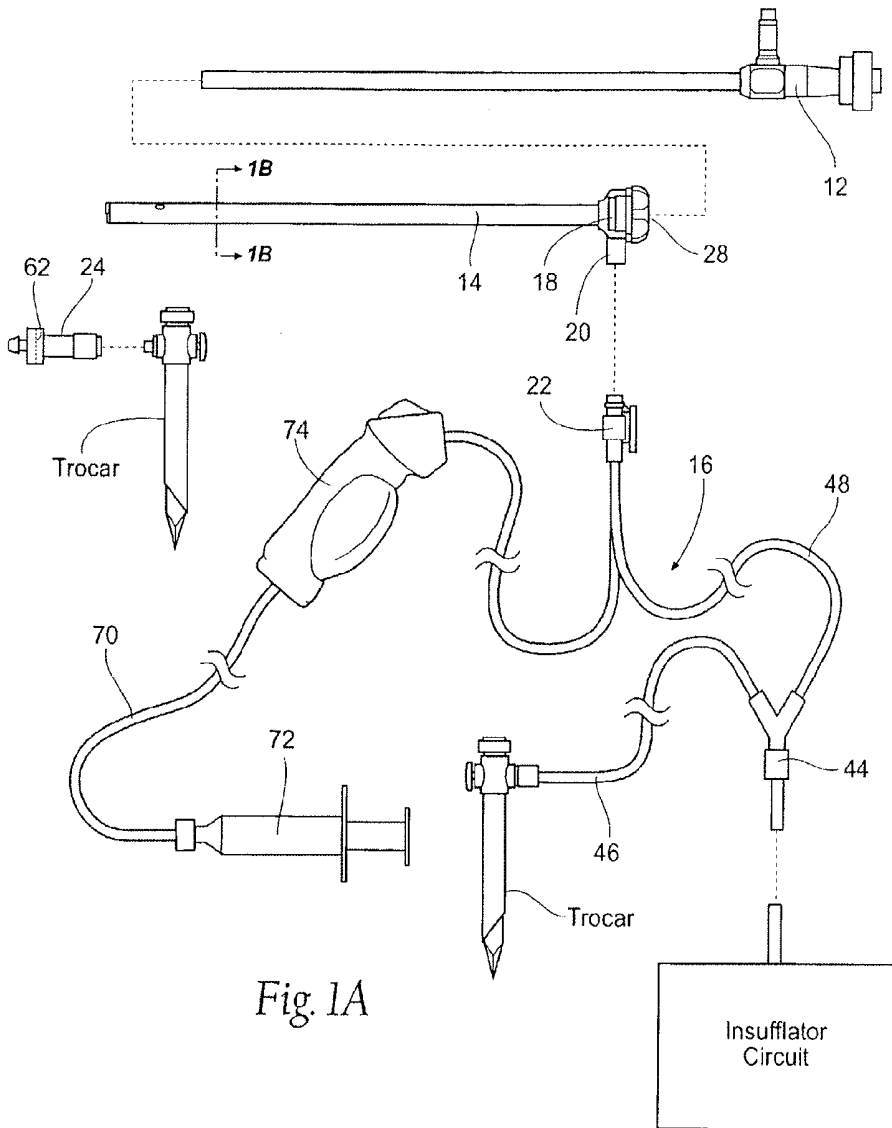

Fig. 1A

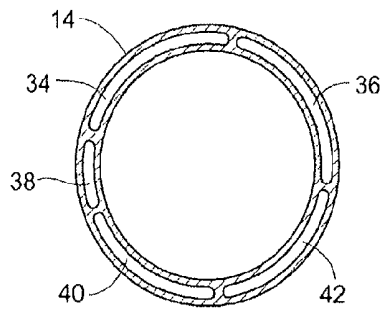
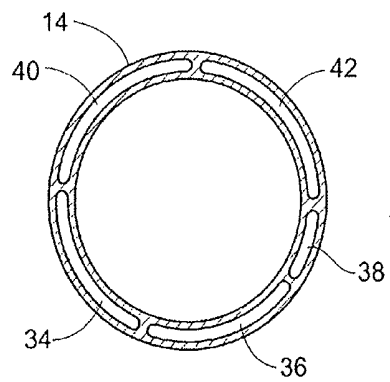
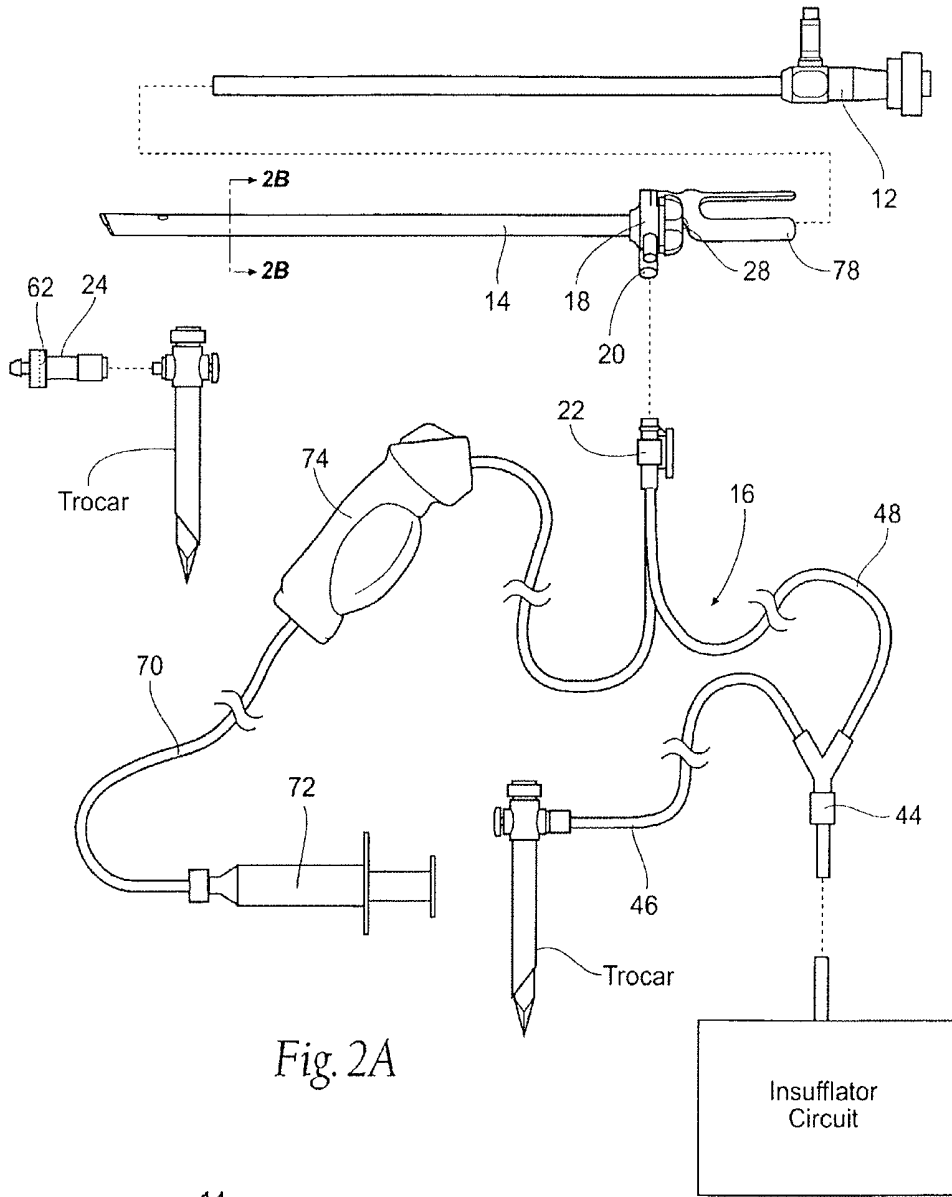

Fig. 1B



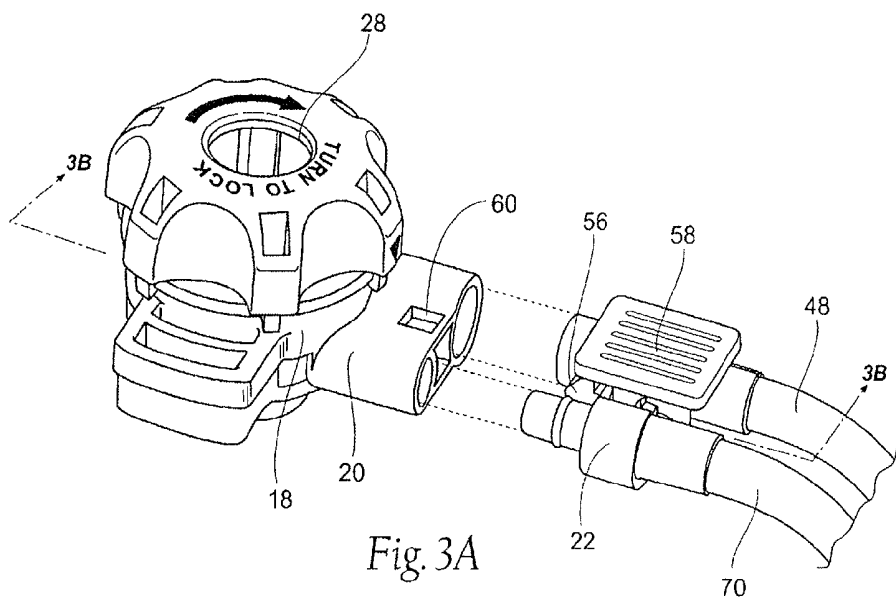

Fig. 3A

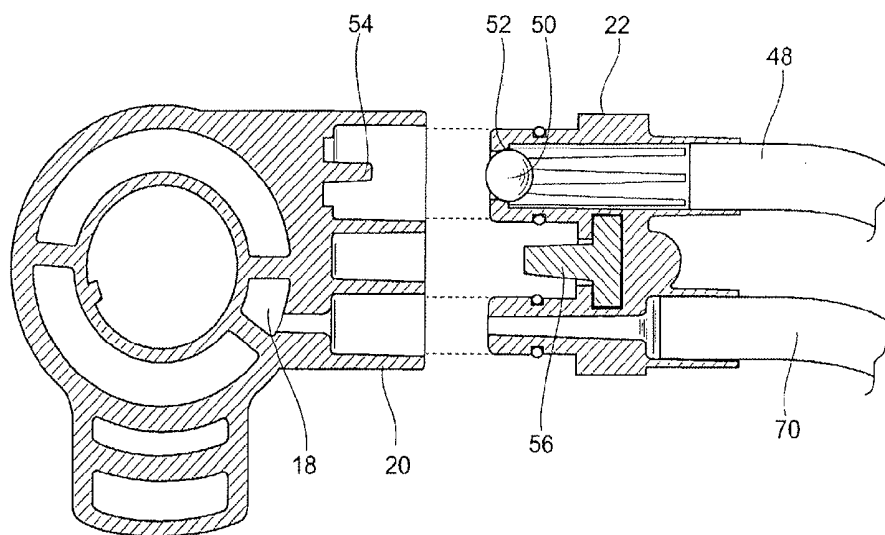

Fig. 3B

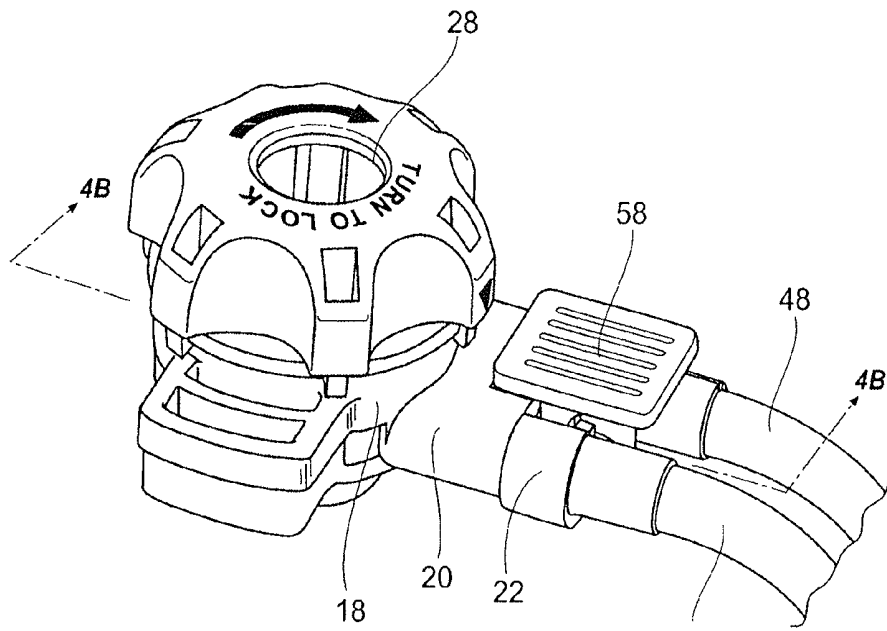

Fig. 4A

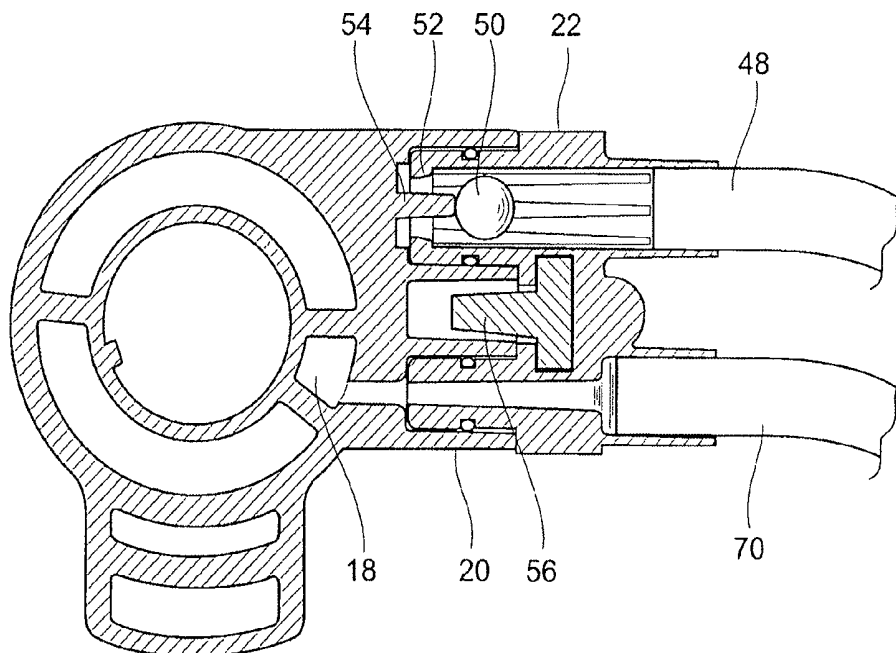

Fig. 4B

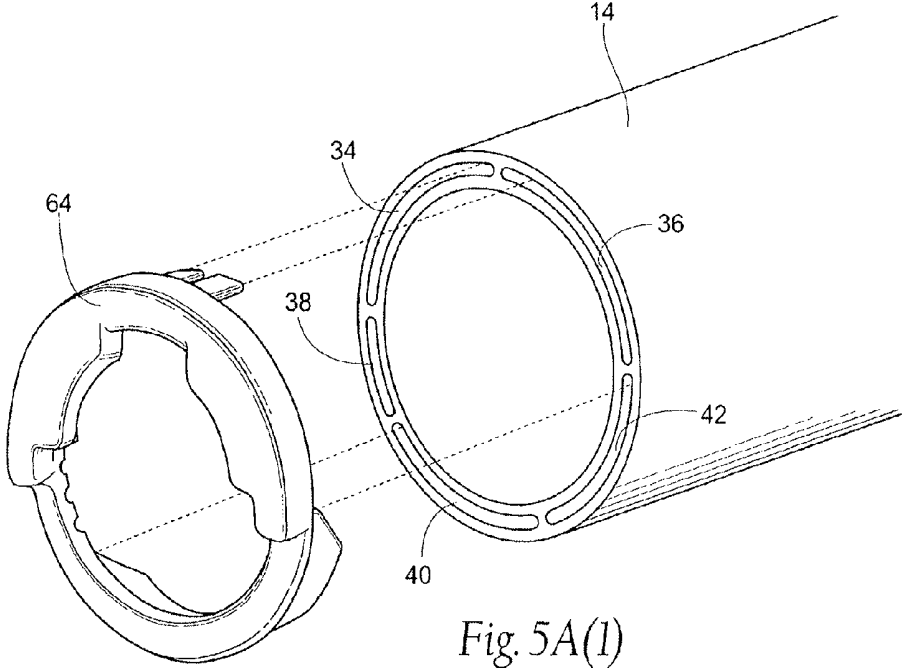

Fig. 5A(1)

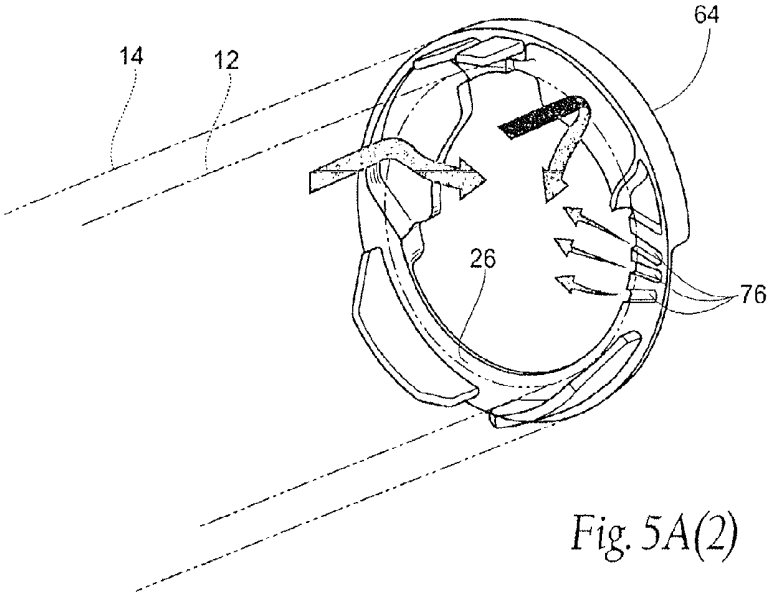

Fig. 5A(2)

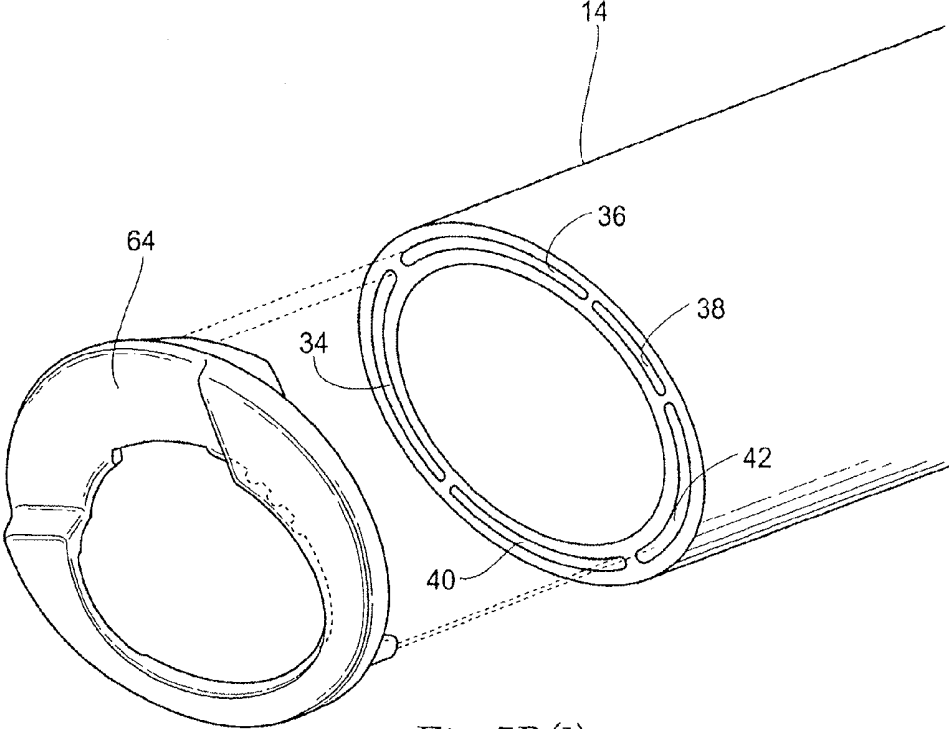

Fig. 5B(1)

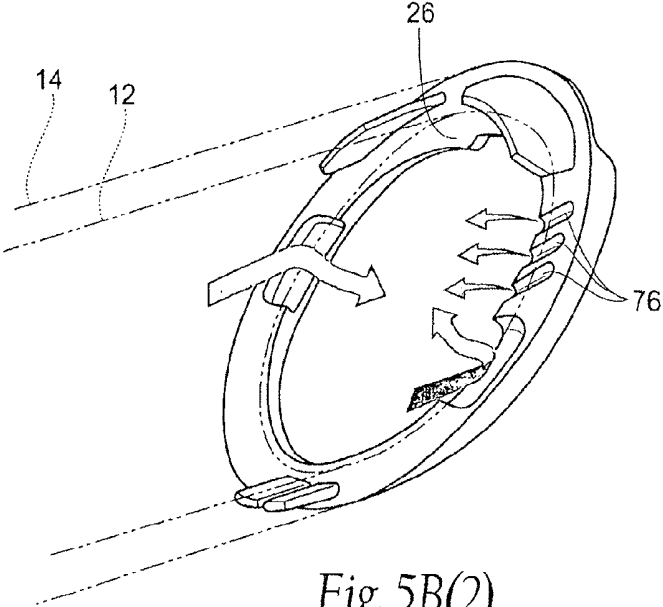

Fig. 5B(2)

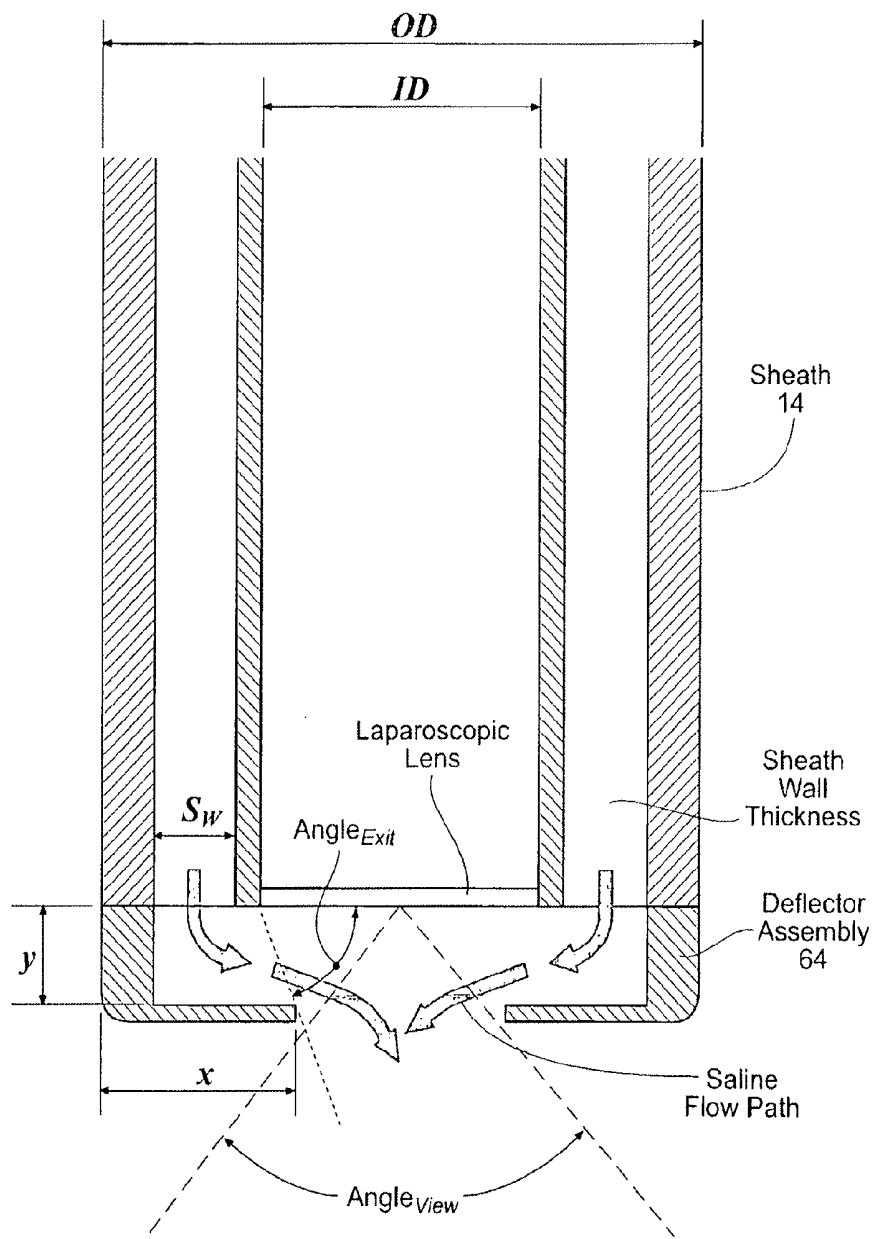

Fig. 6

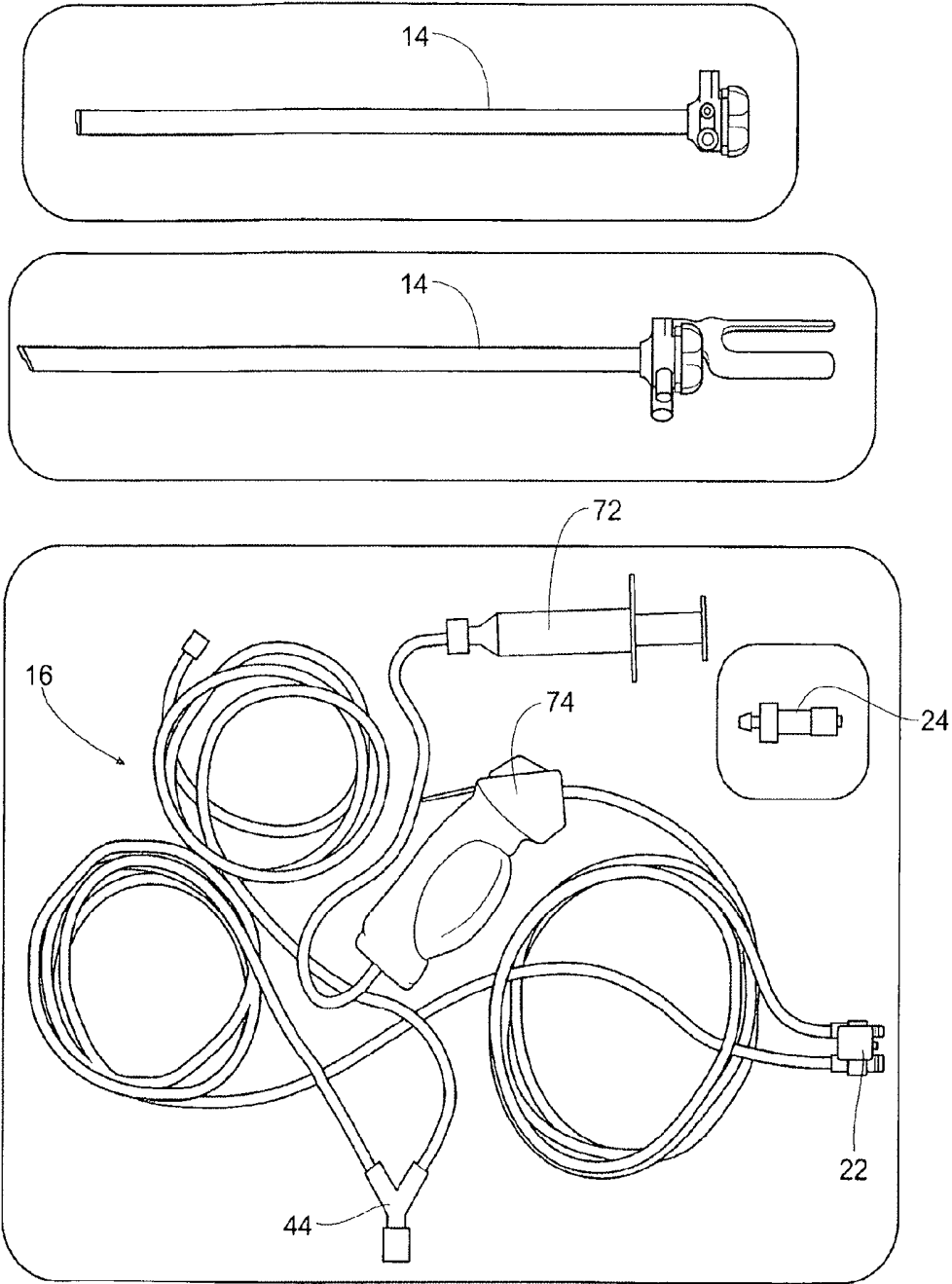

Fig. 7

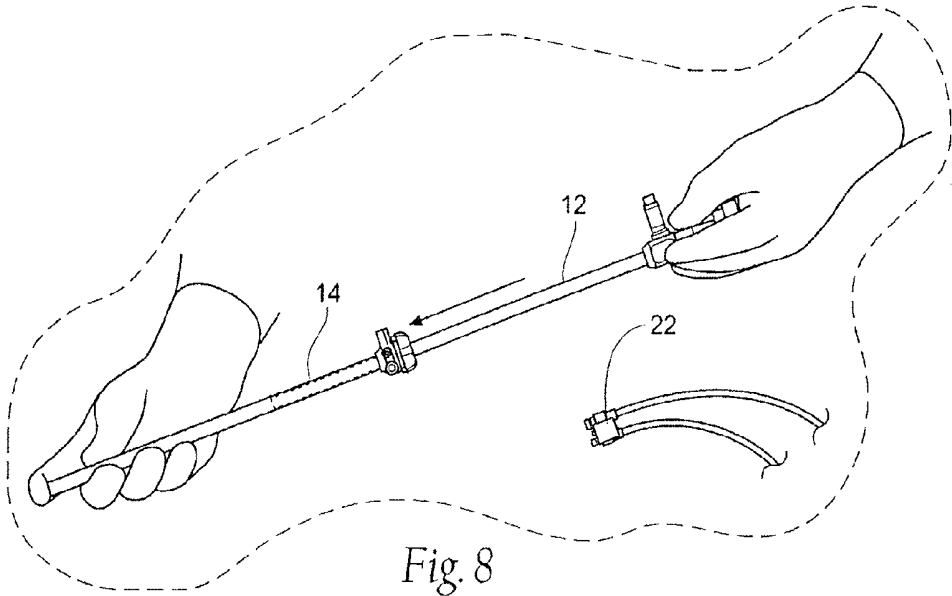

Fig. 8

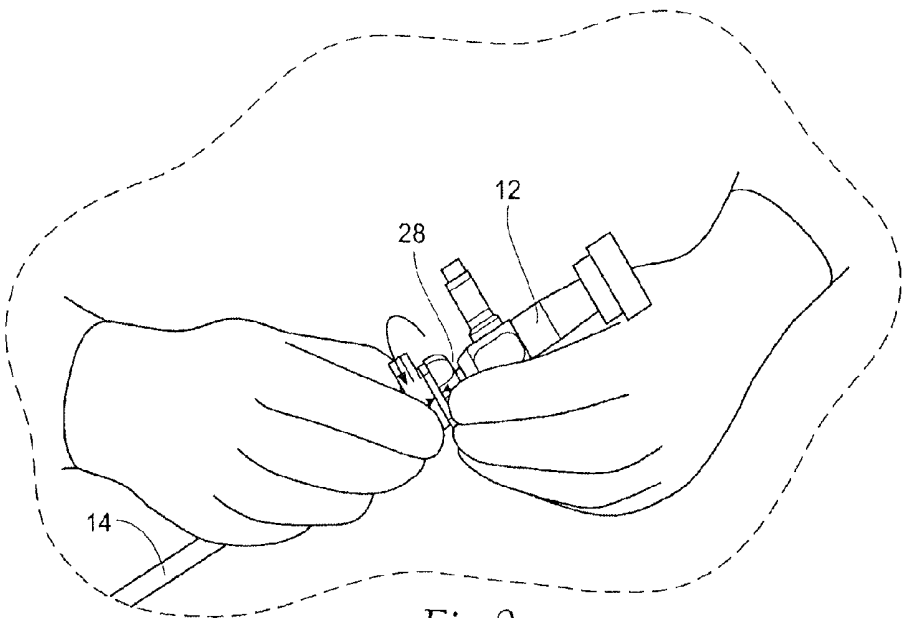
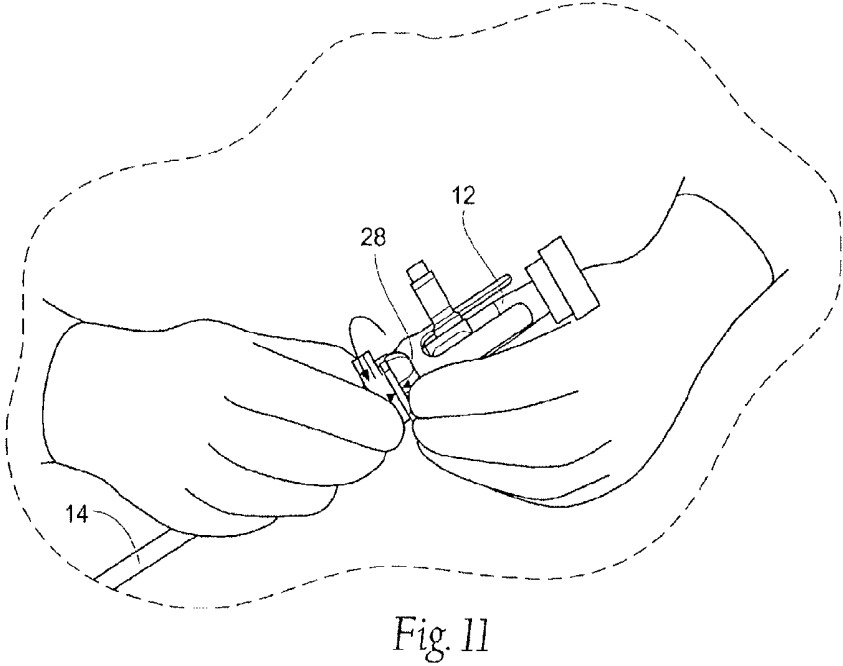
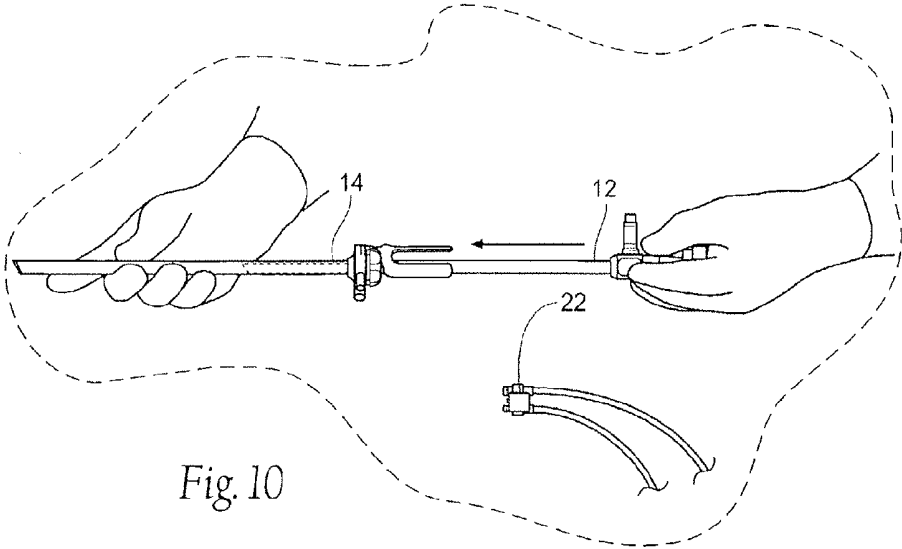

Fig. 9



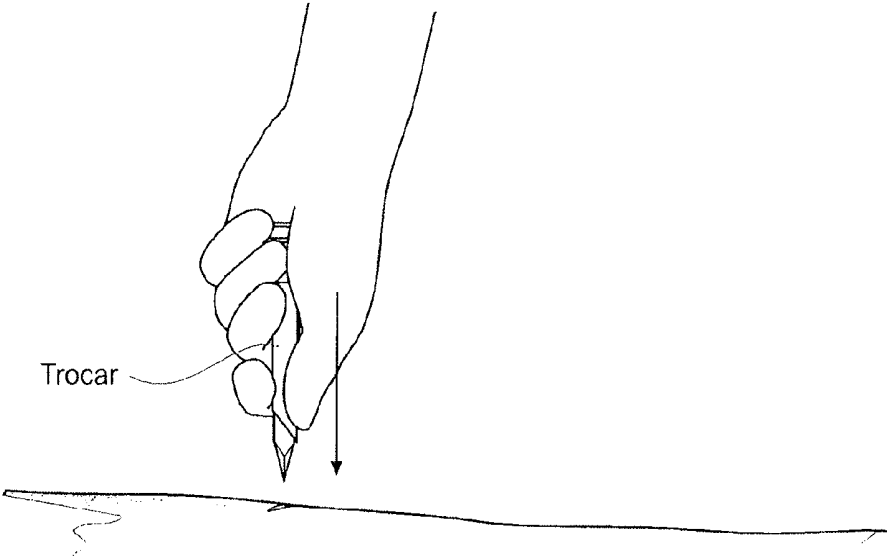

Fig. 12

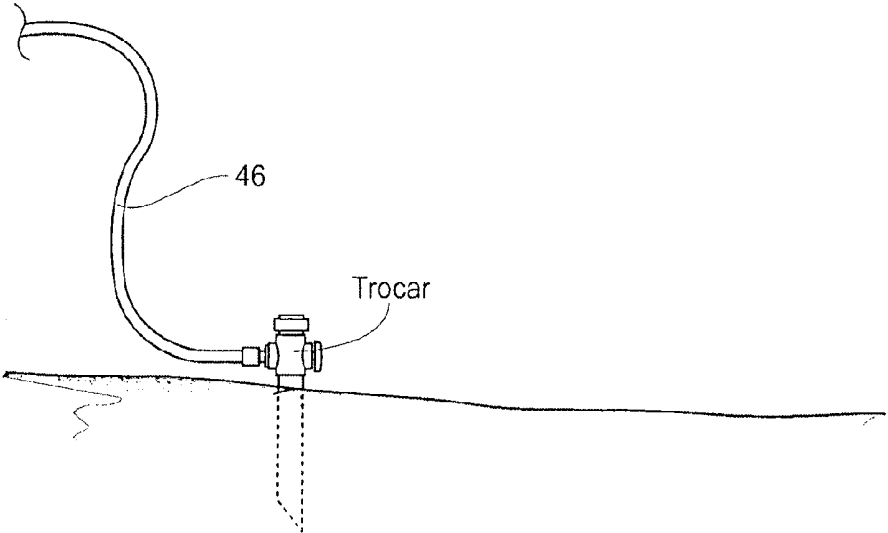
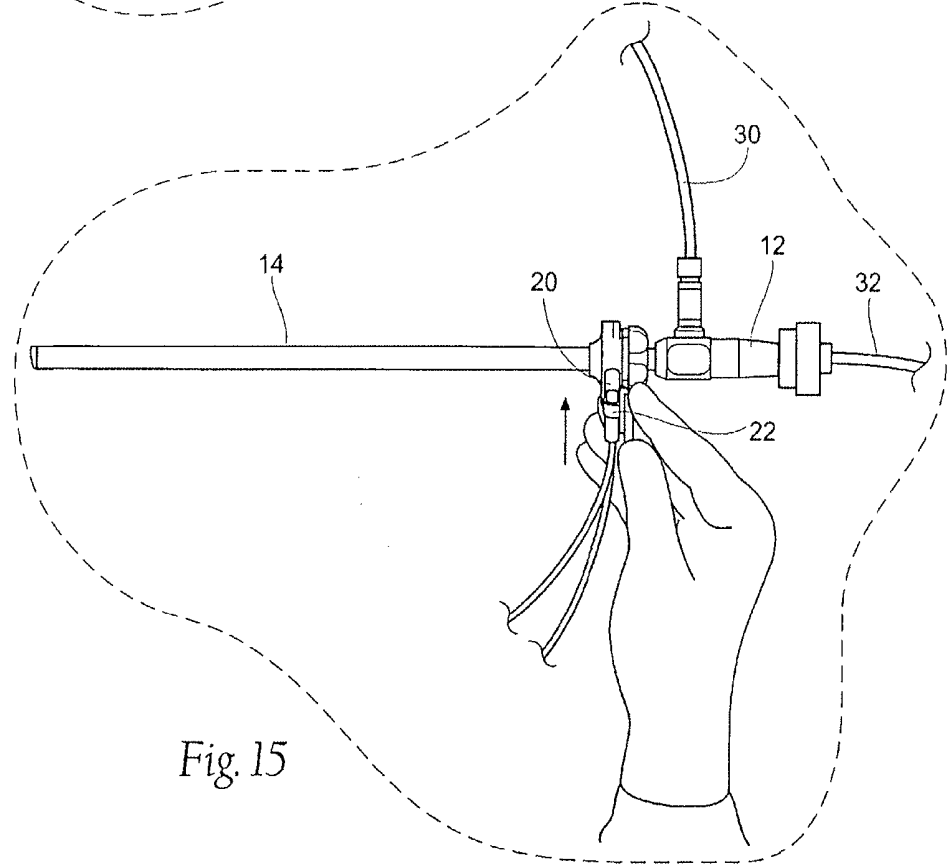
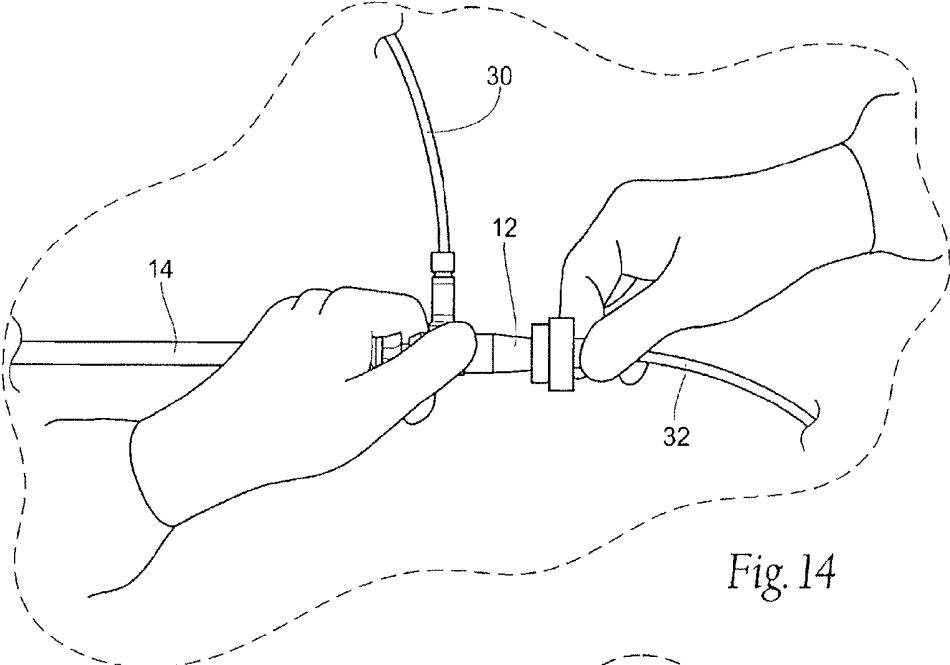

Fig. 13



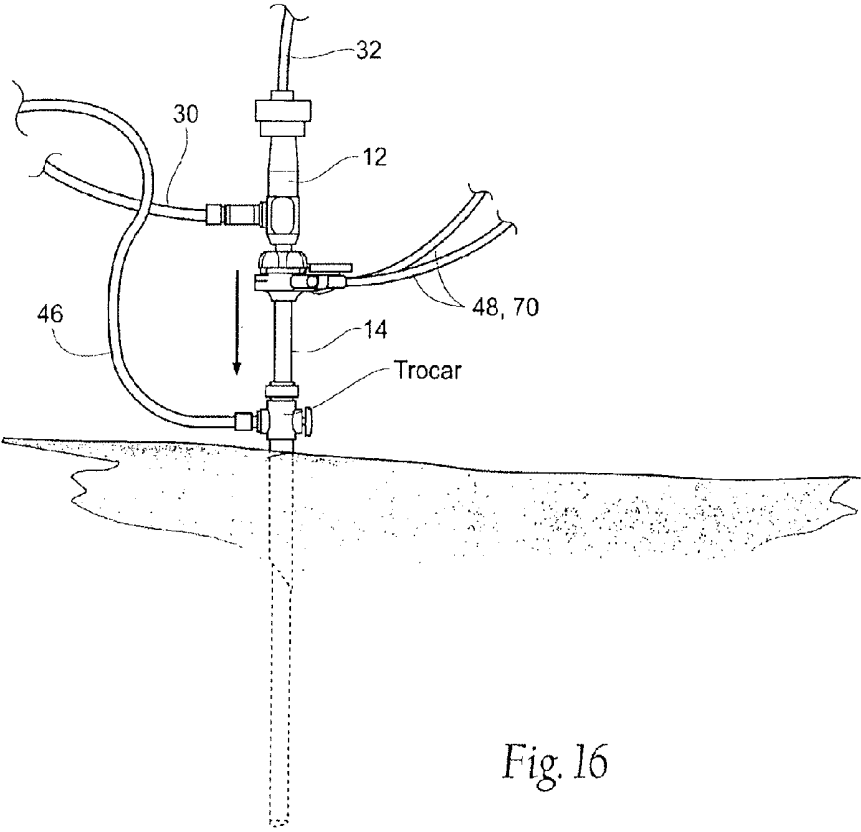

Fig. 16

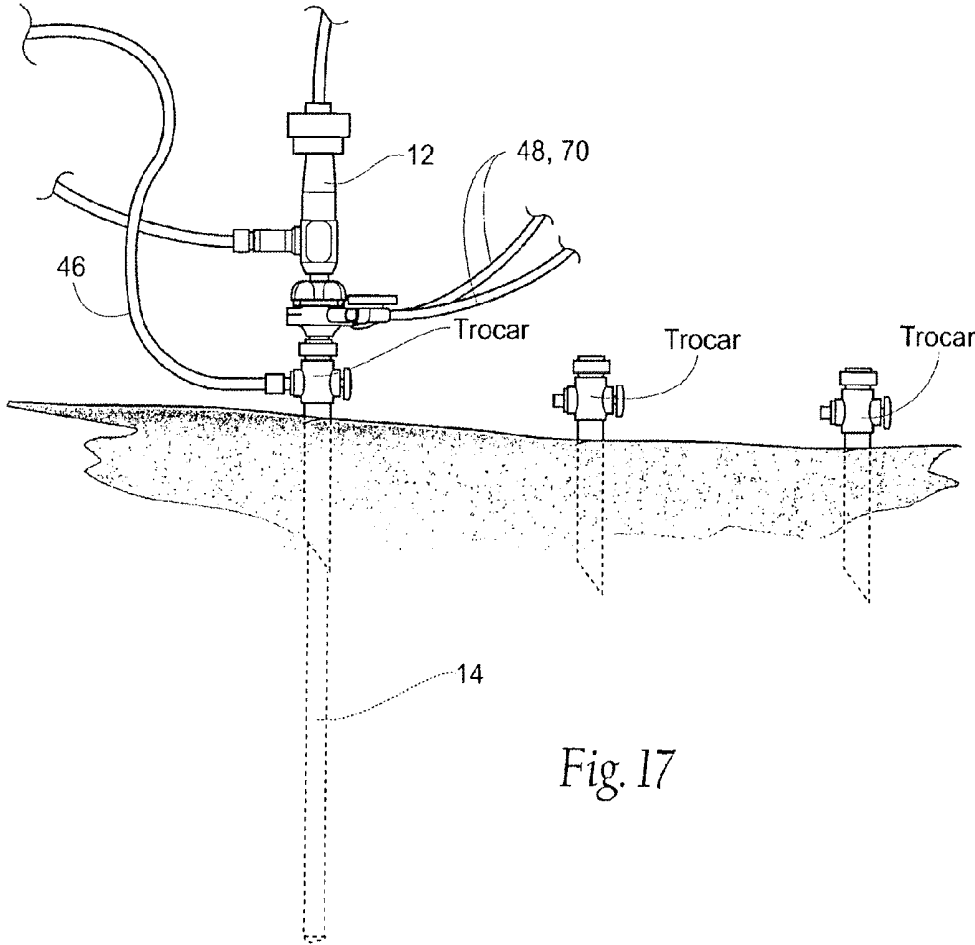

Fig. 17

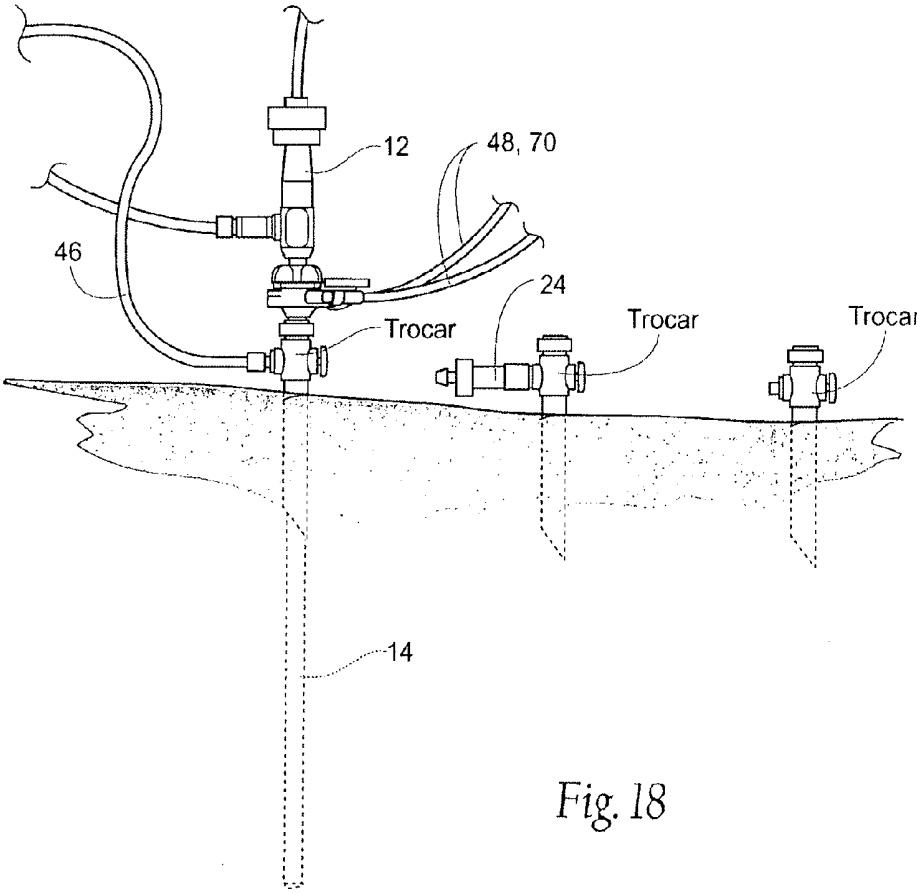

Fig. 18

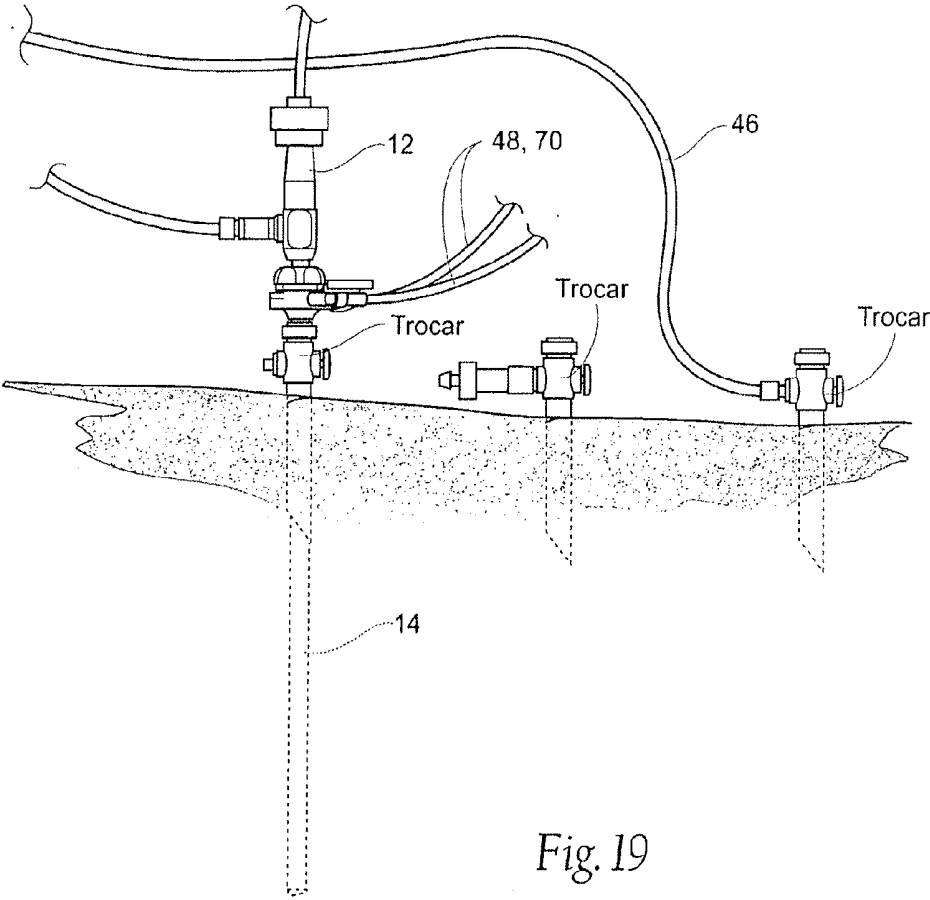

Fig. 19

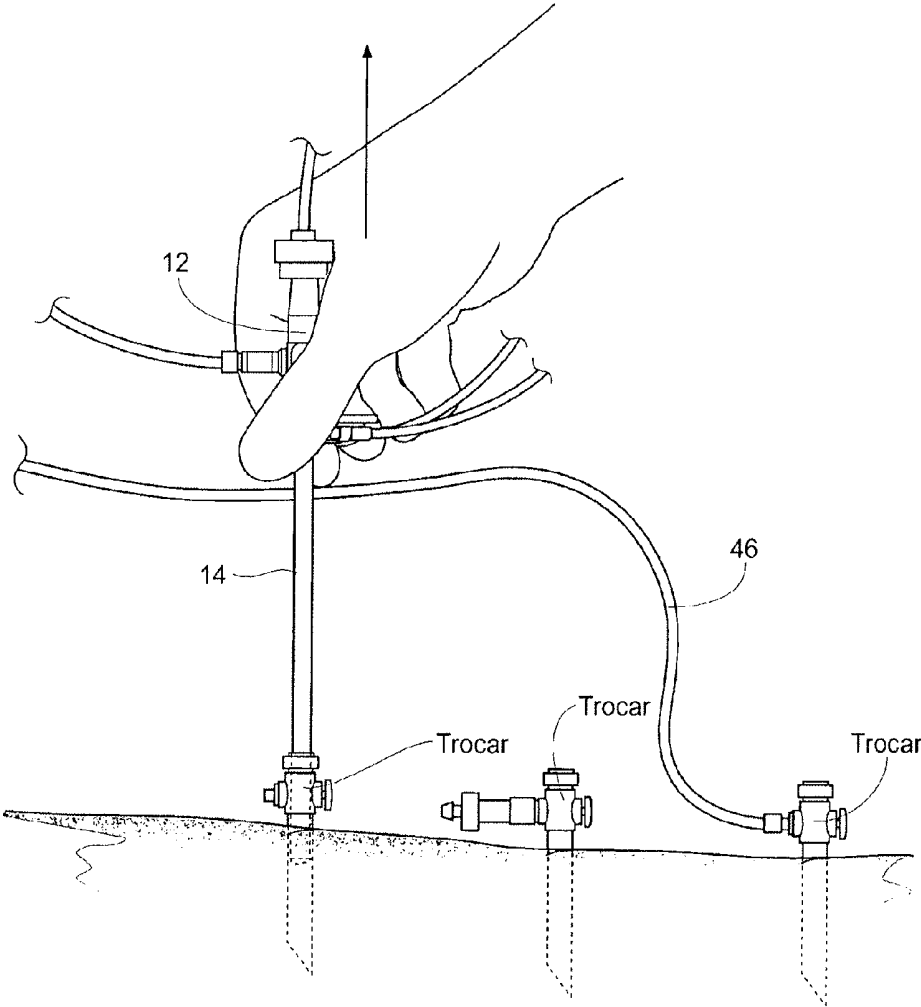
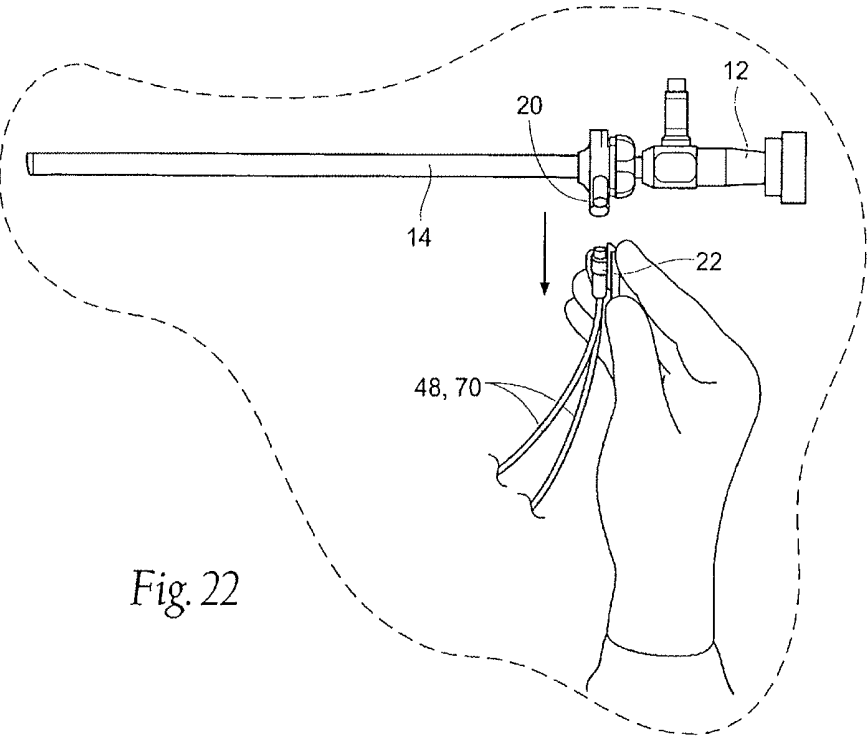
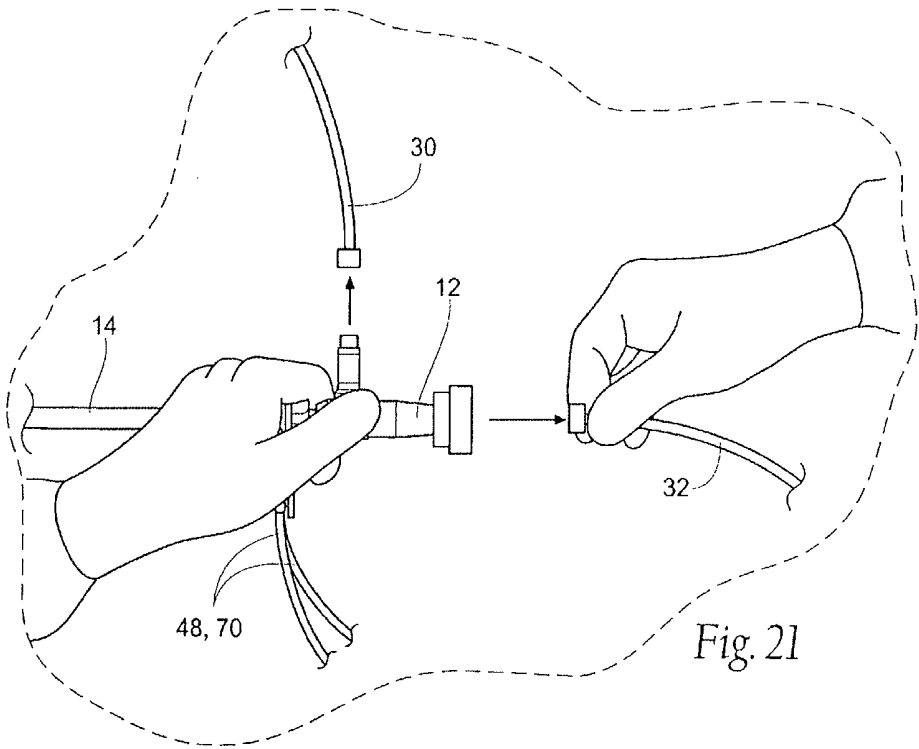

Fig. 20



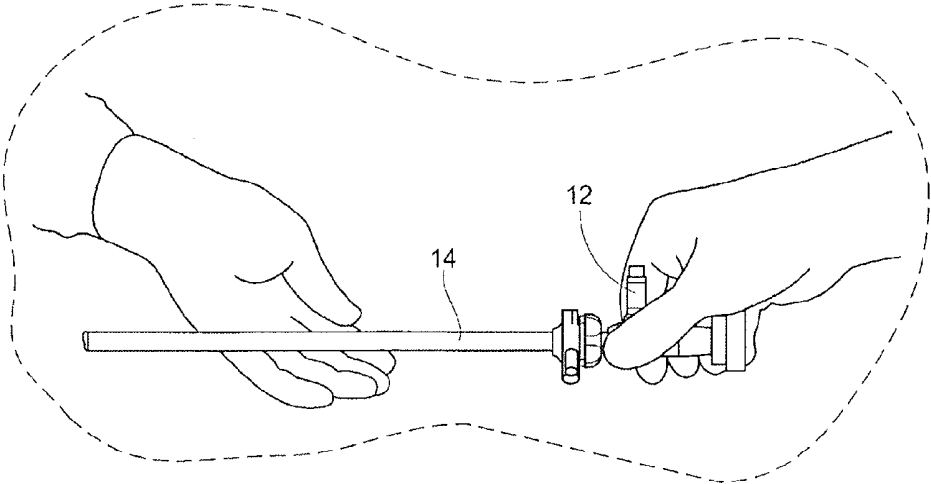

Fig. 23

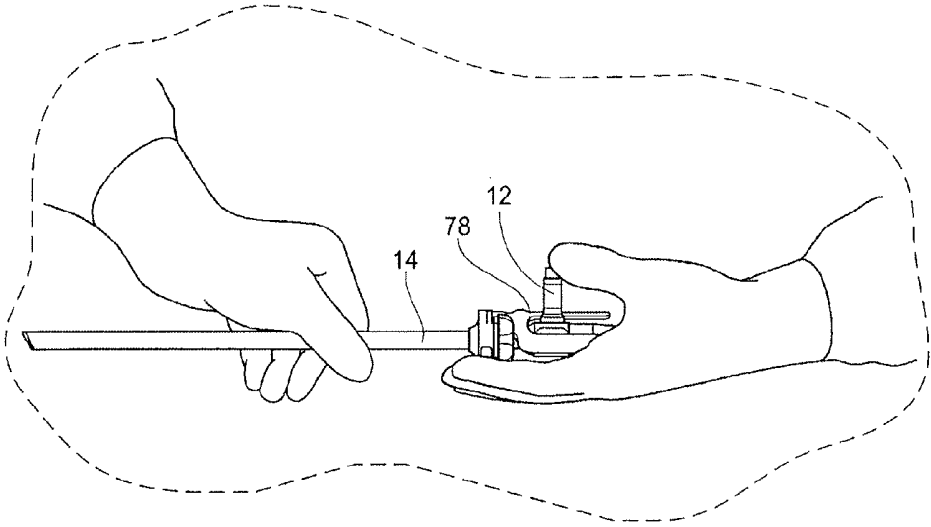

Fig. 24

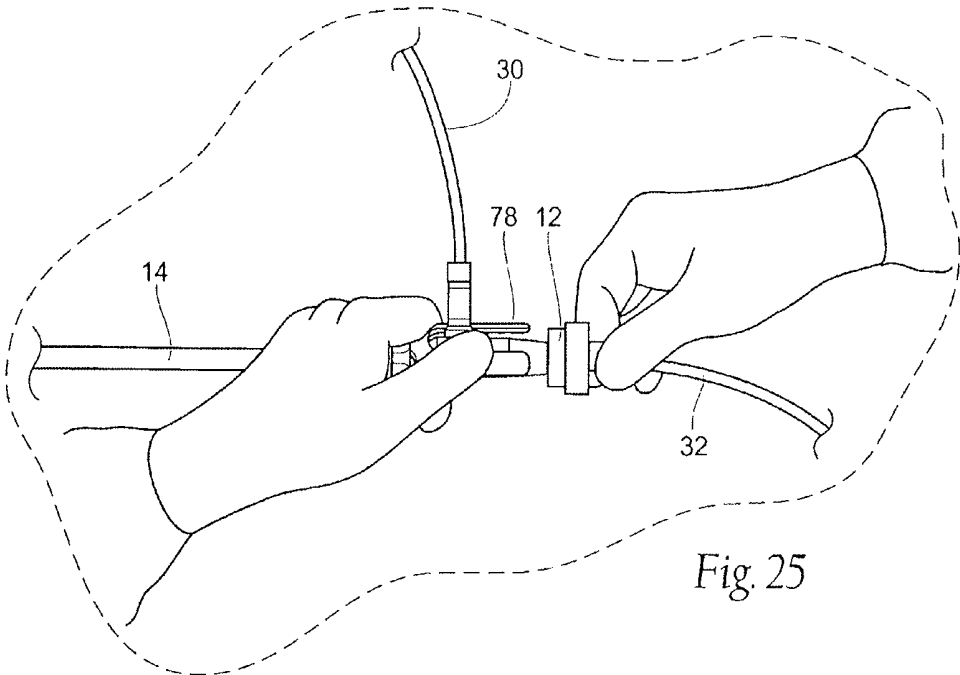

Fig 25

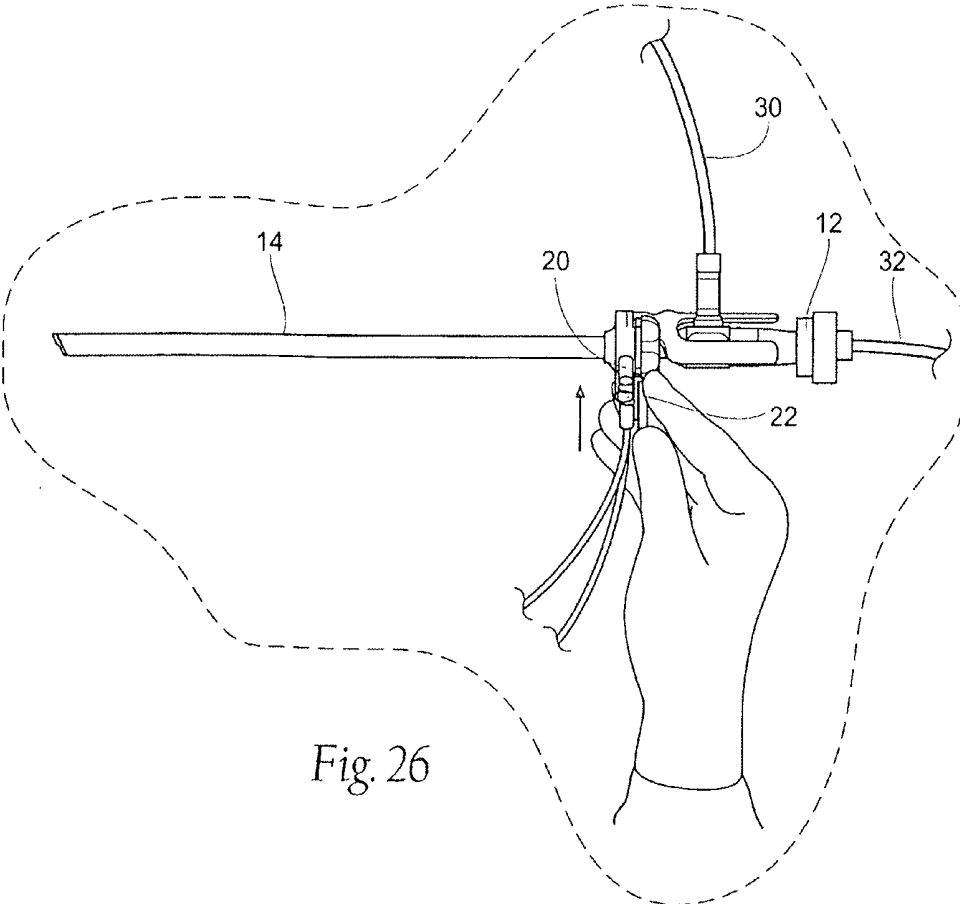

Fig 26

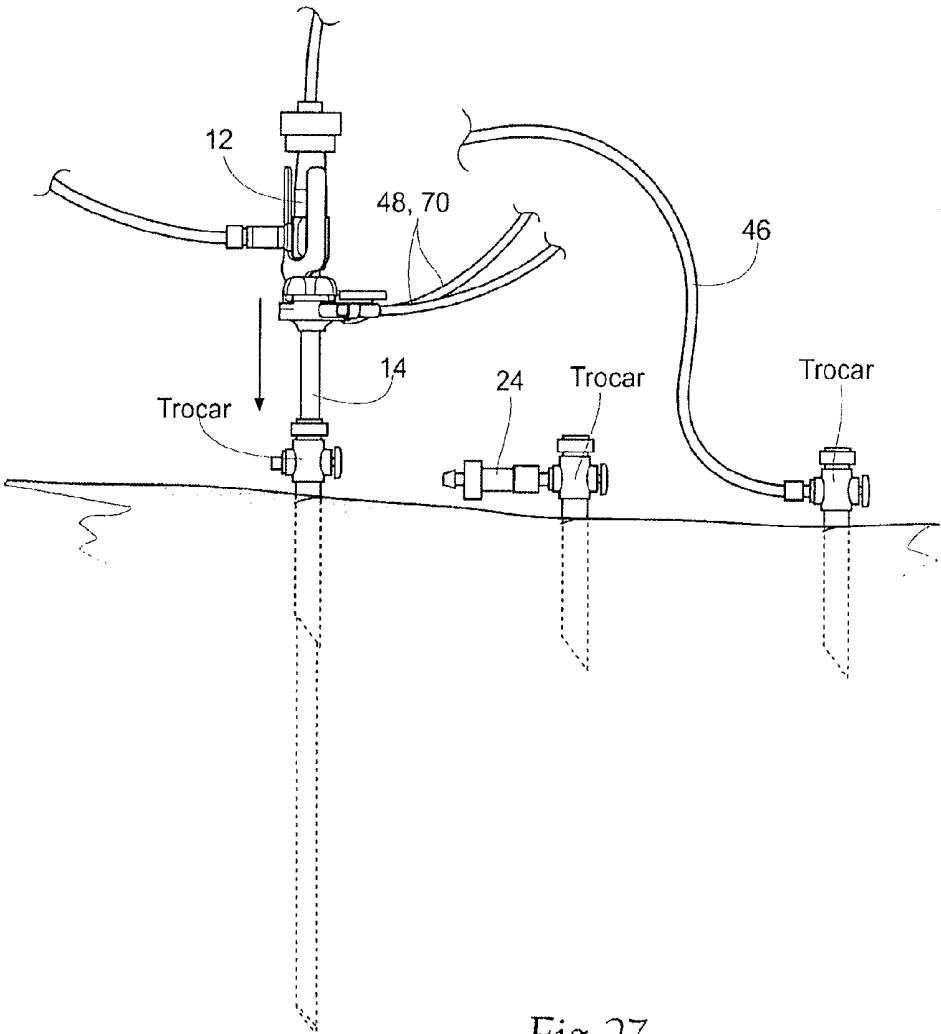

Fig. 27

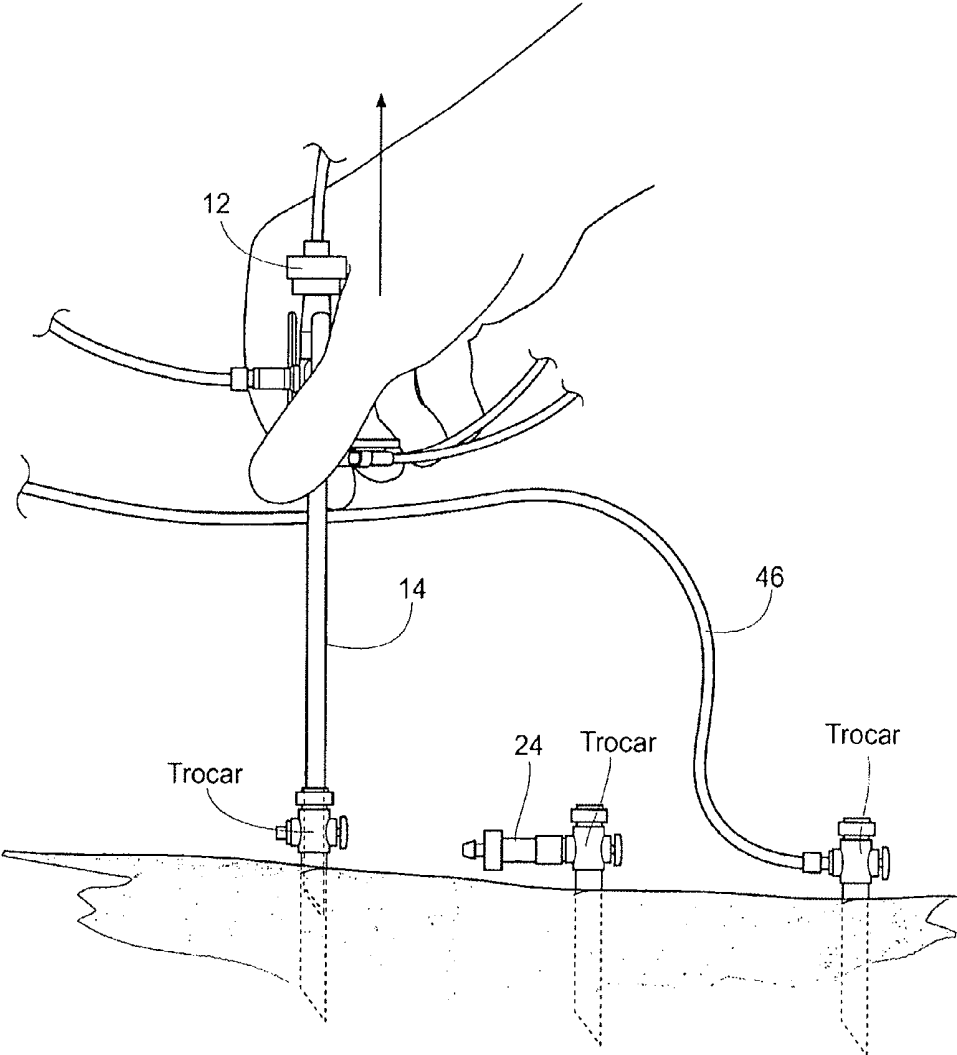
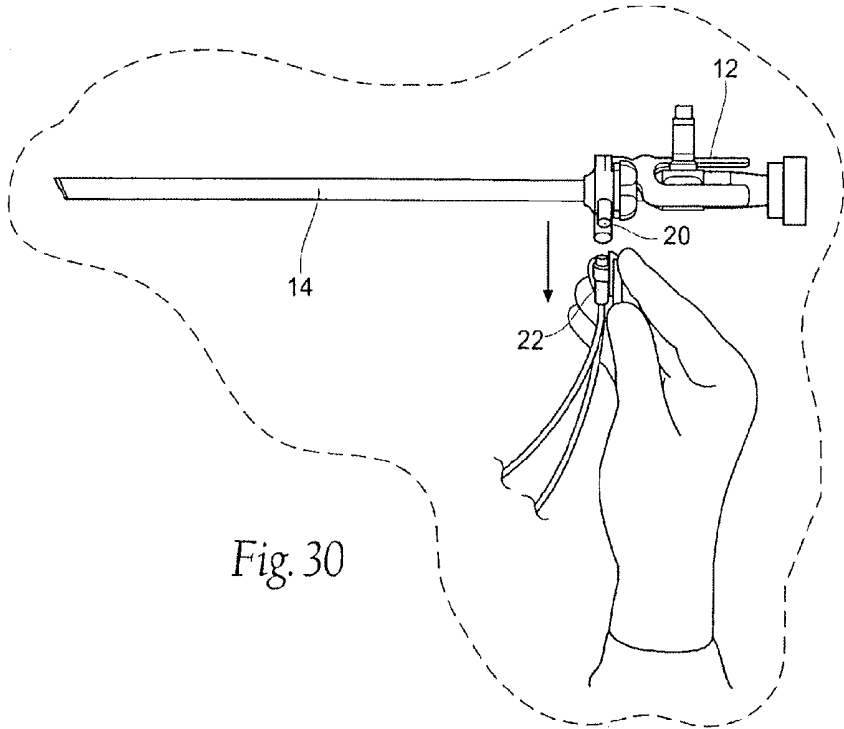
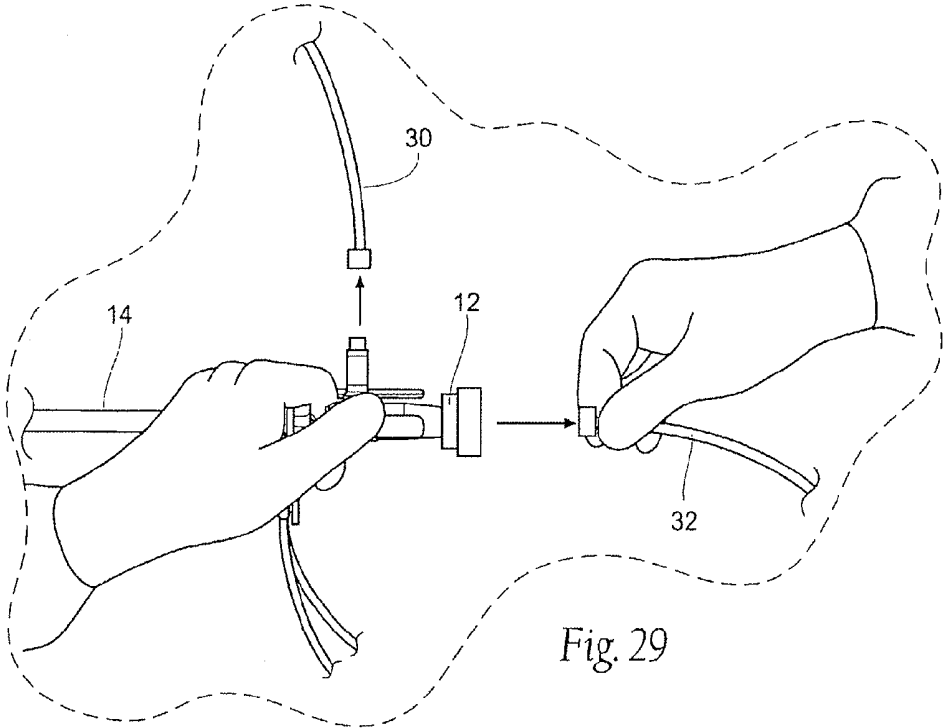

Fig. 28



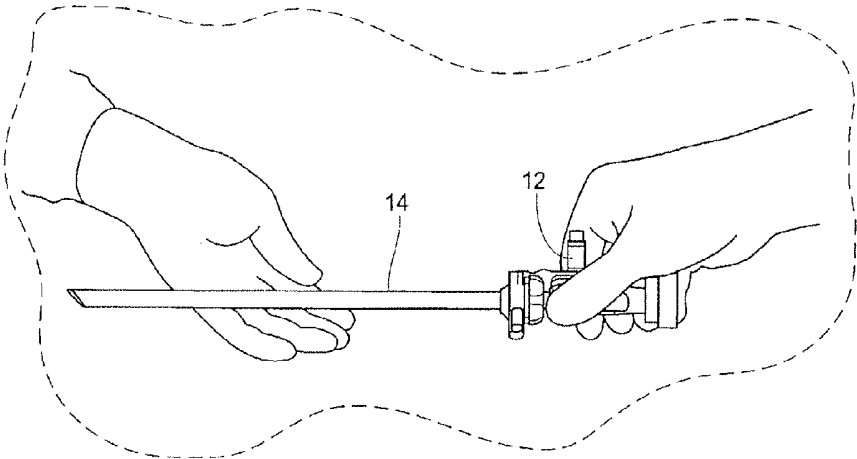

Fig. 31

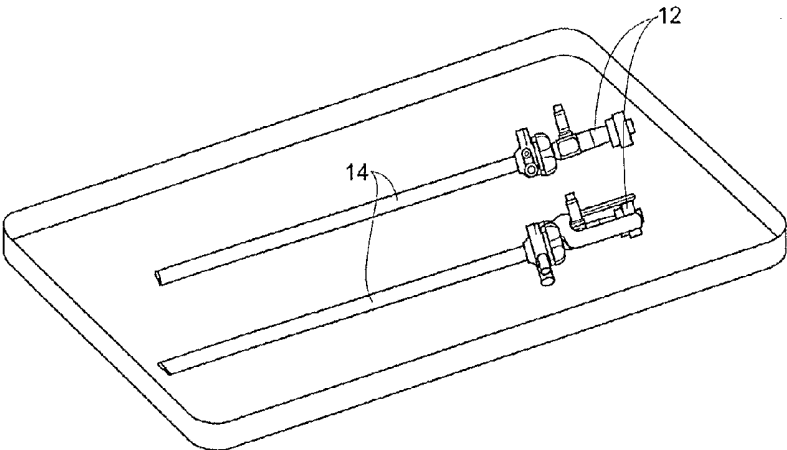

Fig. 32

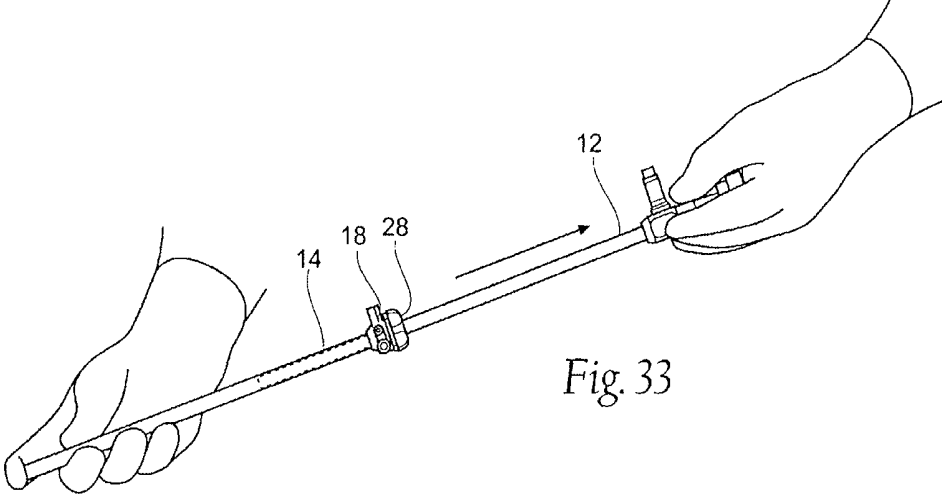

Fig. 33

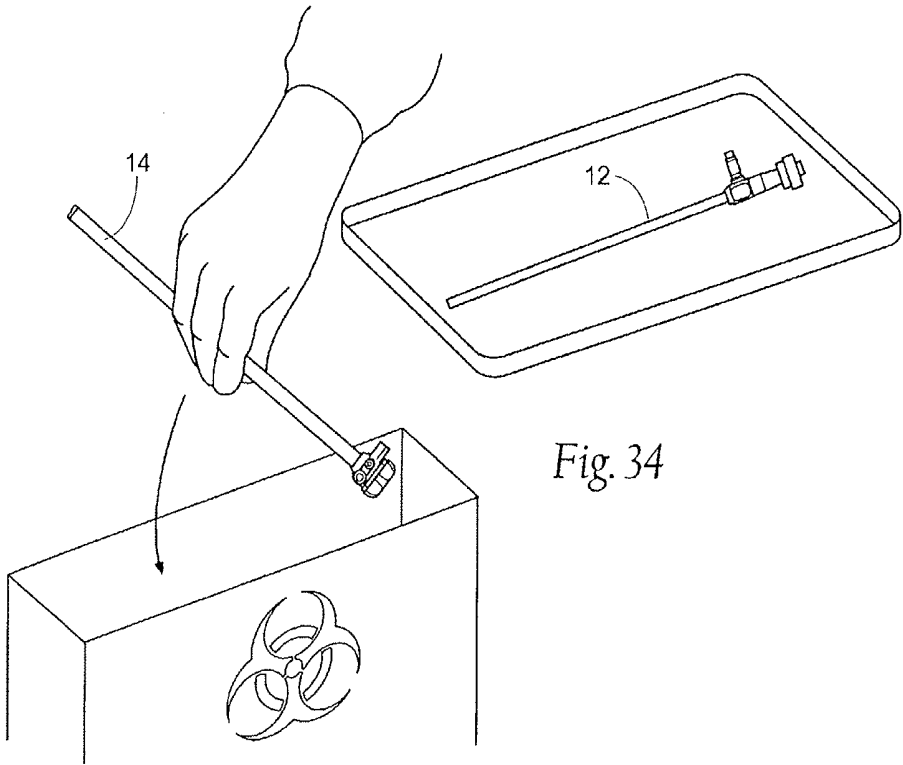

Fig. 34

**SYSTEMS AND METHODS FOR OPTIMIZING
AND MAINTAINING VISUALIZATION OF A
SURGICAL FIELD DURING THE USE OF
SURGICAL SCOPES**

CROSS REFERENCE TO RELATED
APPLICATIONS

[0001] This application is a continuation of U.S. patent application Ser. No. 12/653,148, filed on Dec. 9, 2009, titled "SYSTEMS AND METHODS FOR OPTIMIZING AND MAINTAINING VISUALIZATION OF A SURGICAL FIELD DURING THE USE OF SURGICAL SCOPES," now U.S. Patent Application Publication No. 2010-0198014-A1, which claims the benefit of U.S. Provisional Patent Application No. 61/121,514, filed Dec. 10, 2008, and titled "DEVICE FOR MAINTAINING VISUALIZATION WITH SURGICAL SCOPES," each of which is incorporated herein by reference.

[0002] U.S. patent application Ser. No. 12/653,148 also claims the benefit of U.S. Provisional Patent Application No. 61/170,864 filed Apr. 20, 2009, and titled "SURGICAL SCOPE STABILIZER FOR USE WITH DEVICE FOR MAINTAINING VISUALIZATION WITH SURGICAL SCOPES," which is also incorporated herein by reference.

[0003] U.S. patent application Ser. No. 12/653,148 is also a continuation-in-part of U.S. patent application Ser. No. 11/765,340, filed on Jun. 19, 2007, titled "DEVICE FOR MAINTAINING VISUALIZATION WITH SURGICAL SCOPES," now U.S. Patent Application Publication No. 2008-0319266-A1, which corresponds to International Application No. PCT/US2008/067426, filed Jun. 19, 2008, and titled "DEVICE FOR MAINTAINING VISUALIZATION WITH SURGICAL SCOPES," each of which is incorporated herein by reference.

FIELD

[0004] The invention generally relates to surgical scopes, and, more particularly, for optimizing and maintaining visualization of a surgical field when using a surgical scope, such as, e.g., a laparoscope.

BACKGROUND

[0005] Minimally invasive surgical procedures utilizing surgical scopes are desirable because they often provide one or more of the following advantages: reduced blood loss; reduced post-operative patient discomfort; shortened recovery and hospitalization time; smaller incisions; and reduced exposure of internal organs to possible contaminants.

[0006] Generally, minimally invasive surgeries utilize scopes, such as laparoscopes, that permit remote visualization of a surgical site within a patient's body while the surgical procedure is being performed. During a laparoscopic procedure, the patient's abdominal or pelvic cavity is accessed through two or more relatively small incisions rather than through a single large incision that is typical in a conventional surgery. Surgical scopes, such as laparoscopes, usually consist in part of a rigid or relatively rigid rod or shaft having an objective lens at one end and an eyepiece and/or integrated visual display at the other. The scope may also be connected to a remote visual display device or a video camera to record surgical procedures.

[0007] In laparoscopic surgeries, the abdomen is typically inflated with a gas through the use of an insufflator, to distend

the abdominal space by elevating the abdominal wall above the internal organs and thereby create a sufficient working and viewing space for the surgeon. Carbon dioxide is usually used for insufflation, though other suitable gases may also be used. Conventional insufflators are adapted to cycle on and off to maintain a preset and suitable pressure within the patient's body cavity.

[0008] The local environment within a patient's abdominal space is generally rather warm and humid, and the use of devices such as harmonic scalpels and other cutting and coagulating devices generate mist, smoke, and other debris that is released into the surgical field and often becomes suspended throughout the expanded abdominal space. Additionally, blood, bodily fluids, pieces of tissue, fat or other bodily material may come in contact with or even attach to the lens. As a result of these conditions, visualization through the scope can be significantly diminished. Typically, the only solution to fogging and debris collection on the lens is removal of the scope from the body cavity and defogging or cleaning the lens by wiping it with a cloth, warming the scope tip, or utilizing another defogging method. The need to remove the scope to defog and remove debris from the lens is inconvenient for the scope operator and the surgeon and can interrupt and undesirably prolong surgical procedures.

SUMMARY OF THE DISCLOSURE

[0009] One aspect of the invention provides a view optimizing assembly having a deflector assembly with critical physical, pneumatic, and optical characteristics that make possible intra-operative defogging, surgical debris deflection, and cleaning of a laparoscope lens during minimally invasive surgery, while also maintaining visualization of the surgical site. In use, the view optimizing assembly makes possible the practice of a surgical method for maintaining clear visualization of the surgical site without removing the laparoscope 12 from the abdominal cavity for the purpose of cleaning or de-fogging its lens.

[0010] Another aspect of the invention provides a view optimizing assembly having a quick exchange feature. In use, the quick exchange feature makes possible a surgical method for maintaining clear visualization that includes the ability to make a quick exchange of laparoscopes having different operating characteristics (e.g., laparoscopes with different tip angles, lengths, or diameters) entirely on the sterile operating field and without interference with the preexisting surgical set-up on the sterile operating field. The view optimizing assembly integrates with the existing suite of minimally invasive instrumentation. It does not interfere with the surgical set-up, and it requires minimal change in the process or practice of a surgical operating room (OR) team.

BRIEF DESCRIPTION OF THE DRAWINGS

[0011] FIG. 1A is a somewhat schematic views of a view optimizing assembly for use with a laparoscope having a 0° shaft tip.

[0012] FIG. 1B is a section view of the sheath, showing internal fluid flow lumens, taken generally along line 1B-1B in FIG. 1A.

[0013] FIG. 2A is a somewhat schematic of a view optimizing assembly for use with a laparoscope having an angled shaft tip.

[0014] FIG. 2B is a section view of the sheath, showing internal fluid flow lumens, taken generally along line 2B-2B in FIG. 2A.

[0015] FIG. 3A is an enlarged perspective view of a manifold that the view optimizing assembly shown in FIG. 1A or FIG. 2A incorporates, including a quick exchange coupling, and a quick exchange coupler that the tubing set shown in FIG. 1A or FIG. 2A incorporates, the coupling and the coupler being disconnected.

[0016] FIG. 3B is a sectional view taken generally along line 3B-3B in FIG. 3A, showing a one way check valve that is normally closed.

[0017] FIG. 4A is an enlarged perspective view of the manifold including a quick exchange coupling and the quick exchange coupler of the tubing set, as shown in FIG. 3A, but now connected.

[0018] FIG. 4B is a sectional view taken generally along line 4B-4B in FIG. 4A, showing the one way check valve that is opened by the connection of the quick exchange coupling and connectors.

[0019] FIGS. 5A(1) and 5A(2) are enlarged, exploded views of the deflector assembly for use with a laparoscope having a 0° shaft tip.

[0020] FIGS. 5B(1) and 5B(2) are enlarged, exploded views of the deflector assembly for use with a laparoscope having an angled shaft tip.

[0021] FIG. 6 is a schematic view of the critical physical, pneumatic, and optical characteristics of the deflector assembly shown in FIGS. 5A and 5B.

[0022] FIGS. 7 to 34 illustrate a representative method including the set up and use of the view optimizing assembly using sterile technique by technicians/operating room personnel.

DETAILED DESCRIPTION

[0023] Although the disclosure hereof is detailed and exact to enable those skilled in the art to practice the invention, the physical embodiments herein disclosed merely exemplify the invention, which may be embodied in other specific structure. While the preferred embodiment has been described, the details may be changed without departing from the invention, which is defined by the claims.

[0024] I. View Optimizing Assembly

[0025] A. Overview

[0026] FIGS. 1A/1B and FIG. 2A/2B show a view optimizing assembly 10 for use in association with a state of the art laparoscope 12. In FIGS. 1A/1B, the laparoscope 12 possesses a 0° (blunt) shaft tip. In FIGS. 2A/2B, the laparoscope possess an angled shaft tip (e.g., a 30° shaft tip or 45° shaft tip). The components of the view optimizing assembly 10 may be made from plastic materials (extruded and/or molded), but other suitable materials, such as metal or a composite material, or combinations thereof could be used.

[0027] As will be described in greater detail, the view optimizing assembly 10 facilitates intra-operative defogging, surgical debris deflection, and cleaning of a laparoscope lens during minimally invasive surgery, while also maintaining visualization of the surgical site. The view optimizing assembly 10 is intended to be a single-use, disposable laparoscopic accessory. The view optimizing assembly 10 is desirably a sterile accessory for immediate set up and use on a sterile operating field.

[0028] As shown in FIGS. 1A and 2A, the view optimizing assembly 10 comprises a multi-lumen sheath assembly 14,

which mounts over the shaft of the laparoscope 12. The end of the shaft is sized and configured to match the size and configuration of the corresponding laparoscope 12, having a blunt tip in FIG. 1A and angled tip in FIG. 2A. The assembly 10 includes a tubing set 16 to connect the sheath 14 to an existing anhydrous carbon dioxide (CO₂) insufflation circuit.

[0029] In use, the view optimizing assembly 10 makes possible the practice of a surgical method for maintaining clear visualization of the surgical site without removing the laparoscope 12 from the abdominal cavity for the purpose of cleaning or de-fogging its lens. Furthermore, the view optimizing assembly 10 also makes possible a surgical method for maintaining clear visualization that includes the ability to make a quick exchange of laparoscopes having different operating characteristics (e.g., laparoscopes with different tip angles, lengths, or diameters) entirely on the sterile operating field and without interference with the preexisting surgical set-up on the sterile operating field. The view optimizing assembly 10 integrates with the existing suite of minimally invasive instrumentation. It does not interfere with the surgical set-up, and it requires minimal change in the process or practice of a surgical operating room (OR) team.

[0030] The view optimization assembly 10 desirably comes packaged for use in sterile peel away pouches (see FIG. 7). As also shown in FIGS. 1A and 2A, the pouches contain the components of the view optimization assembly 10, including the sheath 14 and a manifold 18 that is assembled to the sheath 14 and that includes a quick exchange coupling 20; the tubing set 16 which includes a quick exchange coupler 22 that mates with the quick exchange coupling 20 on the manifold 18; and (optionally) a vent device 24.

[0031] B. The Sheath/Manifold Assembly

[0032] As shown in FIGS. 1A and 2A, the sheath 14/manifold 18 assembly includes a sheath 14 that is sized and configured to receive a laparoscope 12 having a prescribed tip angle, length, and diameter. The sheath 14 includes a stop 26 (see FIGS. 5A(2) and 5B(2)) formed adjacent the distal end of the sheath 14. The stop 26 prevents advancement of the laparoscope 12 beyond the distal end of the sheath 14, so that lens at the distal end of the laparoscope 12 rests in a desired, generally coterminous alignment with the distal end of the sheath 14. The sheath 14 also includes a locking collar 28 at its proximal end to frictionally engage the laparoscope 12 and resist axial withdrawal of the laparoscope 12 from the sheath 14.

[0033] In use, it is expected that the laparoscope 12 will be inserted into the sheath 14 by a scrub nurse during set-up for the operation (see FIGS. 8 to 11). The assembled laparoscopic and sheath 14 will then be handed as a unit to personnel at the operating room (OR) table at the desired time. The laparoscope 12 is then connected by personnel at the OR table in conventional fashion to a light cable 30 (which directs light to illuminate the operative field) and the camera cable 32 (which takes the image from the scope and displays it on monitors in the OR) (see FIG. 14). The sheath 14 is sized and configured not to interfere with this normal set-up of the laparoscope 12.

[0034] In use, the assembled laparoscopic and sheath 14 are placed as a unit through a trocar into the body cavity (e.g., the abdominal cavity), for viewing the surgical procedure as it is performed (see FIG. 16).

[0035] As shown in FIGS. 1A and 2A, and as further shown in FIG. 3A, the sheath 14/manifold 18 assembly also includes the manifold 18 at the proximal end of the sheath 14. The

manifold 18 communicates with multiple lumens (five, 34 to 42, are shown in the illustrated embodiment) formed within the wall of the sheath 14 (see FIGS. 1B and 2B). In use, the lumens 34 to 42 convey anhydrous CO₂ to the distal end of the sheath 14; vent or exhaust air from the distal end of the sheath 14 through the manifold 18; and, if desired, convey sterile fluid and bursts of air to the distal end of the sheath 14. In a representative embodiment (see FIGS. 1B and 2B), two lumens 34 and 36 are dedicated to the transport of CO₂; two lumens 40 and 42 are dedicated to venting; and one lumen 38 is dedicated to the transports of sterile fluid or air.

[0036] C. The Tubing Set

[0037] As previously described, the tubing set 16 includes a quick exchange coupler 22 that mates with the quick exchange coupling 20 on the manifold 18 (see FIGS. 3A/3B and 4A/4B). The tubing set 16 includes lengths of flexible medical grade tubing with individual end couplers (best shown in FIGS. 1A and 2A) that connect to an existing CO₂ insufflation circuit and, if desired, a source of sterile fluid (saline or sterile water, preferably with a “surface active agent”) on the sterile operating field (e.g., a bag or a syringe). The tubing set 16 includes a Y-connector 44 that divides the anhydrous CO₂ output of the insufflation circuit in a first branch 46 for coupling to an insufflation trocar inserted in the body cavity (as will be described later), and a second branch 48 coupled to the quick exchange coupler 22.

[0038] The second branch 48 diverts a small portion of the CO₂ output (e.g., 20% or less) to the quick exchange coupler 22.

[0039] As shown in FIGS. 3B and 4B, the quick exchange coupler 22 includes a one way check valve 50 that communicates with the second branch 48 of the tubing set 16. In the illustrated embodiment, the check valve 50 comprises a ball valve. Insufflation pressure normally presses the ball valve 50 against a ball valve seat 52 (as shown in FIG. 3B). A projection 54 in the manifold 18 displaces the ball valve 50 from the valve seat 52 when the quick exchange coupler 22 mates with the quick exchange coupling 20 on the manifold 18 (as shown in FIG. 4B). Unseating the ball valve 50 opens flow communication through the check valve 50. In the absence of coupling the quick exchange coupler 22 on the tubing set 16 to the quick exchange coupling 20 on the manifold 18, the check valve 50 remains closed, normally blocking flow of CO₂ through the second branch 48.

[0040] Thus, the tubing set 16 accommodates the set-up of the supply of the entire CO₂ output to an insufflation trocar through the tubing set 16, separate and independent of the connection of the tubing set 16 to the manifold 18 of the sheath 14.

[0041] As FIGS. 3A and 4A further show, a latch 56 carried on a spring-biased button 58 on the quick exchange coupler 22 “clicks” into a detent 60 on the quick exchange coupling 20 on the manifold 18 to reliably lock the coupler 22 and coupling 20 together for use, opening the check valve to flow CO₂ through the second branch 48 (shown in FIGS. 4A/4B). Depressing the button 58 allows the quick exchange coupler 22 and coupling 20 to be separated, and the check valve 50 will close in response to insufflation pressure in the second branch 48 (as shown in FIGS. 3A/3B).

[0042] Connection of the quick exchange coupling 20 on the manifold 18 to the quick exchange coupler 22 on the tubing set 16 is intended to occur at the OR table in the normal course, after the laparoscope 12 is connected to the light cable 30 and the camera cable 32 (see FIG. 15). Upon coupling, the

one way check valve 50 is opened, and the manifold 18 directs the small portion of CO₂ from the CO₂ insufflation circuit. Disconnection of the of the quick exchange coupling 20 on the manifold 18 to the quick exchange coupler 22 on the tubing set 16 is also intended to occur at the OR table in the normal course, after a removal and/or exchange of a laparoscope 12 (see FIG. 22).

[0043] D. The Vent Device

[0044] The vent device 24 (see FIGS. 1A and 2A) comprises a tube with an inline membrane 62 that restricts air flow through the tube. A proximal end of the tube is sized and configured to couple to a stopcock valve of a conventional trocar, as will be described later. In use, the vent device 24 provides a controlled leak of CO₂ from the operating cavity, as will also be described in greater detail later.

[0045] E. The Deflector Assembly

[0046] 1. CO₂

[0047] The sheath 14 includes at its distal end a deflector assembly 64 (see FIGS. 5A(1) and 5A(2) for a blunt shaft tip and FIGS. 5B(1) and 5B(2) for an angled shaft tip). The deflector assembly 64 projects a predetermined distance beyond the distal end of the sheath 14, and thus also a predetermined distance beyond the lens at the distal end of the laparoscope 12. The deflector assembly 64 communicates with the lumens in the sheath 14. The deflector assembly 64 is sized and configured to direct the small portion of the CO₂ from the insufflation circuit in a prescribed flow path and flow velocity continuously across the laparoscopic lens.

[0048] The desired flow path and flow velocity of CO₂ established by the deflector assembly 64 continuously across the laparoscopic lens creates a “wind shear.” The wind shear path of anhydrous CO₂ prevents fogging. The desired flow path and flow velocity of CO₂ established by the deflector assembly 64 continuously across the laparoscopic lens also desirably serves to deflect smoke and surgical debris away from the laparoscopic lens during surgery.

[0049] 2. Physical, Pneumatic, and Optical Characteristics of the Deflector Assembly

[0050] The size and configuration of the deflector assembly are defined and constrained by several, sometime overlapping considerations including (i) prescribed physical characteristics, which are imposed due to the need to access the operating environment in as minimally invasive manner as possible and to be compatible with state of the art laparoscopes and other laparoscopic surgical instruments and techniques; (ii) prescribed pneumatic characteristics, which are imposed due to the need to create a particular “wind shear” effect in terms of the flow path and flow velocity of CO₂ across the laparoscopic lens; and (iii) prescribed optical characteristics, which are imposed due to the need to prevent interference with the field of view and the visualization of the operating field by the laparoscope 12.

[0051] 3. Physical Characteristics

[0052] The size and configuration requirements for minimally invasive access compatible with state of the art laparoscopic instrumentation and techniques are paramount. These requirements impose constraints upon the minimum inside diameter of the sheath 14 as well as the maximum outside diameter of the sheath 14. Because state of the art laparoscopes are provided with different shaft diameters, lengths, and lens configurations, the sheath dimensions and configuration change for compatibility with them. The view optimizing assembly 10 actually includes a family of sheath 14/manifold 18 assemblies differently sized and configured to

accommodate different classes of laparoscopes, to make possible compatibility with the families of state of the art laparoscopes that are in use.

[0053] For example, state of the art laparoscopes include 10 mm laparoscopes, 5 mm laparoscopes, and, within these sizes, 0° shaft tips, 30° shaft tips, and 45° shaft tips. Further, within these classes of laparoscopes, manufacturing tolerances typically vary from scope to scope, as well as from manufacturer to manufacturer. A given sheath **14**/manifold **18** assembly for a given laparoscope class (e.g., 10 mm or 5 mm) desirably takes these typical manufacturing and manufacturer variances into account, and is desirably sized and configured to fit the largest scope variance encountered within a given laparoscope class.

[0054] To maximize the fluid flow lumen area within the sheath **14**, the minimum inside diameter of a given sheath **14** must closely conform to the maximum outside diameter of the shaft of the particular state of the class of laparoscope **12** selected for use, which the sheath **14** must accommodate in a smooth, sliding fit. Further, a gap between the outside diameter of the laparoscope shaft and the inside diameter of the sheath **14** must be minimized to avoid the transport and leakage of blood and fluids from the operating field. Still further, minimizing the gap also assures that the laparoscope **12** self-centers in the sheath **14**, thereby assuring faithful and accurate visualization through the laparoscope lens.

[0055] For example, for a typical laparoscope **12** in the 10 mm class, which measures 0.392 inch, the inside diameter of the sheath **14** is manufactured to 0.405 inch, providing a gap thickness of 0.0064 inch. For a 5 mm laparoscope **12** in the 5 mm class, which measures 0.196 inch, the inside diameter of the sheath **14** is manufactured to 0.218 inch, providing gap thickness of 0.011 inch.

[0056] The maximum outside diameter of the sheath **14** for minimally invasive access must take into account the minimum inside diameter of the trocar, which the maximum outside diameter cannot exceed.

[0057] For example, for a typical 10 mm trocar that measures 0.509 inch, the outside diameter of the sheath **14** is manufactured to 0.486 inch, providing a gap thickness of 0.0115 inch. For a typical 5 mm trocar that measures 0.324 inch, the outside diameter of the sheath **14** is manufactured to 0.300 inch, providing a gap thickness of 0.012 inch.

[0058] It is desirable, given the particular size and configuration constraints of the laparoscopic instrumentation and techniques used, to maximize the outside diameter to the extent possible. This is because, together the inside and outside diameters of the sheath **14** define the wall thickness for the sheath S_w . The wall thickness S_w , together with the length of the sheath **14**, in turn, define the maximum area available for the transport of the CO₂ and fluids by the sheath **14**. The area of the fluid flow lumen or lumens dedicated to the supply of CO₂, in turn, defines the maximum flow rate of the CO₂ directed by the deflector assembly **64**. The flow rate should be sufficient at a minimum, given the output of the insufflator selected for use, to supply anhydrous CO₂ across the lens of the laparoscope **12** sufficient to prevent fogging. Also affecting the effectiveness of the CO₂ to defog the lens, is the water content of the anhydrous CO₂. Given the same flow rate, the less water that is present in the anhydrous CO₂, the greater is the defogging capacity of the assembly. Further, the flow rate desirable should also be sufficient to deflect smoke and surgical debris away from the viewing field of the laparoscopic

lens during surgery, so that the anhydrous CO₂ directed by the deflector assembly **64** both defogs and deflects debris.

[0059] Medical grade CO₂ for use with conventional insufflators is typically 99% pure, that is, no more than 1% of the gas is other than CO₂, and such medical grade anhydrous CO₂ generally has a maximum moisture content of 25 parts per million by volume. Typically, a state of the art insufflator circuit delivers anhydrous CO₂ at a max flow rate of about 20 liters per hour. Typically, the insufflator circuit will sense pressure in the circuit and cycle off when the sensed pressure is at or above 15 mmHg and cycle on when the sensed pressure is below 15 mmHg.

[0060] Given the above sheath dimensions, and given the supply of typical medical grade anhydrous CO₂, a flow rate of at least about 1.0 liters per minute is critical to achieving this objective. Given the above dimensions, and the supply of typical medical grade anhydrous CO₂, a flow rate less than 0.8 liters per minute is not sufficient to prevent significant accumulation of moisture on the laparoscope lens.

[0061] In a representative embodiment, for a sheath **14** having an inside diameter of 0.405 inch and an outside diameter of 0.486 inch, and a length of 11.25 inch (which accommodates passage of a typical 10 mm laparoscope and its own passage through a conventional trocar) (i.e., $S_w=0.081$ inch), the total area available in the sheath wall is 0.056 square inches. Based upon required structural support within the wall (inside, outside, and radial) the total available area for lumens to transport fluids is 0.027 square inch.

[0062] In a representative embodiment, the total lumen area is occupied by five lumens **34** to **42**, two for transporting CO₂ (**34** and **36**), one for sterile fluid (**38**), and two for passive exhaust air venting (**40** and **42**).

[0063] The area of each lumen can be maximized by selection of lumen geometry. In a representative embodiment, lumen geometry is generally triangular or pie shaped with rounded corners. The radial walls that separate the lumens within the sheath **14** are sized to minimize the spacing between the lumens.

[0064] In a representative embodiment, CO₂ transport is accomplished by two lumens **34** and **36** that extend about 175 degrees about the outer circumference of the sheath **14** and comprising a flow area of 0.013 square inches. Sterile fluid transport is accomplished by one lumen **38** comprising a flow area of 0.003 square inches. Exhaust air venting is accomplished by two lumens **40** and **42** comprising a flow area of 0.011 square inches. The distal openings of the exhaust lumens **40** and **42** desirably are spaced from the distal end of the sheath, to prevent uptake of blood and fluids.

[0065] 4. Pneumatic Characteristics.

[0066] As diagrammatically shown in FIG. 6, the deflector assembly **64** must overhang the laparoscopic lens by a prescribed transverse distance, defining a deflection width X, sufficient to change the direction of CO₂ flowing axially through lumens of the sheath **14** (i.e., along the axis of the laparoscope shaft) into a non-axially, transverse path across the laparoscopic lens (i.e., at an angle relative to the axis of the laparoscope shaft). Still, the distance of the deflection width X should not extend to the point that obstructs the field of the view of the laparoscopic lens. This is an example where a pneumatic characteristic of the deflector assembly **64** overlaps with an optical characteristic. Further optical characteristics will be described in greater detail below.

[0067] The deflector assembly **64** must also project axially beyond the distal terminus of the sheath **14** by a prescribed

axial distance, defining an air channel distance Y , sufficient to maintain the CO_2 flowing along the path bounded by the deflection width X at a distance sufficiently close (proximal) to the laparoscopic lens to achieve the desired shear flow effect, but without forming an abrupt flow bend that can lead to a reduction in the desired CO_2 flow velocity.

[0068] Together, the deflection width X and the channel distance Y define the pneumatic characteristics of the deflection assembly. At the desired minimum flow rate, the pneumatic characteristics create a flow path that conveys CO_2 continuously across the laparoscopic lens at the desired flow velocity, in shorthand called the “wind shear.” The pneumatic characteristics of the CO_2 “wind shear” across the laparoscopic lens prevent fogging, as well as desirably deflect smoke and surgical debris away from the viewing field of the laparoscopic lens during surgery.

[0069] Together, the pneumatic characteristics defined by the deflection width X and the channel distance Y create an exit angle A_{EXT} , measured between the plane of the laparoscopic lens and the terminal edge of the deflector assembly **64**. The exit angle A_{EXT} must be less than a maximum angle of 45 degrees, else the flow path of the CO_2 will not pass sufficiently both across and proximal to the laparoscopic lens. To maintain a desired exit angle A_{EXT} , the channel distance Y should be at least equal to the wall thickness of the sheath S_w and should not exceed 1.5 times the wall thickness of the sheath S_w . The deflection width X should be at least equally to two times the channel distance Y , but not extend into the field of view of the laparoscopic lens.

[0070] 5. Optical Characteristics

[0071] The optical characteristics of the deflector assembly **64** are selected (i) to not block or reduce the illuminated image of the operating field provided by the laparoscope **12**; (ii) not decrease the intensity of the illumination provided by the laparoscope **12** on the operating field; and (iii) prevent reflection of illumination light at the lens of the laparoscope **12**.

[0072] As discussed above, the maximum deflection width X takes into account one of the desirable optical characteristics; namely, the deflection width X should not obstruct the field of the view of the laparoscopic lens.

[0073] To prevent the decrease of the illumination, the deflector assembly **64** is desirably made from a material having high light transmission properties (i.e., transparency), to not interfere with the passage of light through the light cable **30** onto the operating field as well as the passage of the reflected image conveyed to the camera cable **32** of the laparoscope **12**.

[0074] Furthermore, the material and surface finish of the deflector assembly **64** must pose minimal reflectivity to light. In a representative embodiment, the deflector assembly **64** is made from Bayer Makrolon Rx1805 with a surface finish defined as SPI/SPE A-3.

[0075] 6. Orientation

[0076] As before described, CO_2 transport is accomplished by two lumens **34** and **36** that extend about 175 degrees about the outer circumference of the sheath **14**. For a 0° shaft tip (see FIG. **5A**), the orientation of the deflector assembly **64** relative to the laparoscopic lens is not critical. However, for angled shafts (e.g., 30° shaft tips and 45° shaft tips) (see FIG. **5B**), the orientation of the deflector assembly **64** relative to the laparoscopic lens is critical.

[0077] As FIG. **5B** shows, the angled tip of a typical laparoscope **12** has a high end **66** and a low end **68**. The lens

slopes at the prescribed angle between the high end **66** and the low end **68**. In a laparoscope **12** having a angled tip, the illumination cable **30** (transmitting light onto the operating field) is located at the high end **66** of the angled tip, and the camera cable **32** (transmitting reflected light back to the camera) is located at the low end **68** of the angled tip. To provide the desired wind shear effect on an angled tip, it is critical that the deflector assembly **64** be oriented relative to the sloped laparoscopic lens such that the flow CO_2 is directed across the sloped plane of the lens from the low end **68** of the tip toward the high end **66** of the tip. In this arrangement, the defogging and debris deflection flow path originates proximal to the camera cable **32**, which effectively comprises the eyes of the OR team. In this arrangement, the desired exit angle A_{EXT} directs the flow path of the CO_2 both sufficiently across and proximal to the sloped plane of the laparoscopic lens to achieve optimal defogging and debris deflection.

[0078] F. Sterile Fluid Flush

[0079] As previously explained, if desired, the tubing set **16** can also include, connected to the quick exchange coupler **22**, a length of tubing **70** sized and configured for connection to a source **72** of sterile fluid, such as saline or sterile water (as shown in FIGS. **1A** and **2A**). Preferably, the sterile fluid includes in solution a “surface-active agent” that stabilizes mixtures of oil and water (e.g., fat) by reducing the surface tension at the interface between the oil and water molecules.

[0080] The quick exchange coupling **20** on the manifold **18** (see FIGS. **3A/3B** and **4B/4B**) can also include a port to integrally connect the sterile fluid tubing **70** to direct the sterile fluid through the separate lumen **38** in the sheath **14** to the distal end of the sheath **14**. The deflector assembly **64** directs the sterile fluid across the laparoscopic lens.

[0081] As shown in FIGS. **1A/2A**, the sterile fluid tubing **70**, if present, desirably includes an in-line pumping device **72**. The in-line pumping device **72** is sized and configured to be operated on demand by a person at the OR table to convey bursts of sterile fluid through the manifold **18** through the lumen to the distal end of the sheath **14**. The in-line pumping device **72** and source can be integrated and comprise, e.g., a 20 cc syringe filled with sterile fluid and connected by a tubing Luer-lock on the saline tubing. Alternatively, the in-line pumping device **72** and source can be separate and comprise, e.g., a bag of sterile fluid, a spike connection on the saline tubing of the tubing set **16** to open communication with the bag in conventional fashion, and an inline squeeze bulb or the like to pump burst of sterile fluid from the bag to the quick exchange coupler **22**.

[0082] In this arrangement, the deflector assembly **64** is also sized and configured to direct the burst of sterile fluid in a desired path across the laparoscopic lens. The bursts of sterile fluid serve to flush debris off the end of the lens that may eventually accumulate, thereby cleaning the lens. Thereafter, bursts of air supplied through the deflector assembly **64** by a squeeze pump **74** in the tubing set **16** (see FIGS. **1A/2A**) serve to clear residual fluid droplets off the lens and away from the deflector assembly **64** to maintain the desired flow path and flow velocity of CO_2 established by the deflector assembly **64** continuously across the laparoscopic lens, to maintain an acceptable view.

[0083] In an illustrative embodiment (see FIGS. **5A** and **5B**), the deflector assembly **64** directs the bursts of sterile fluid or air along a plurality of individual diverging channels **76** (three are shown). The diverging channels **76** distribute the bursts of sterile fluid or air in a fanning pattern across the lens

of the laparoscope **12**. In the illustrative embodiment, the diverging channels **76** discharge the bursts of sterile fluid or air in a path that is generally ninety-degrees to the path of CO₂. This orientation of the sterile fluid path relative to the CO₂ path across the lens, optimal for effective lens cleaning, applies to both 0° shaft tips and angled tips (e.g., 30° shaft tips and 45° shaft tips).

[0084] II. Use of the View Optimizing Assembly

[0085] The view optimizing assembly is well suited for use as a single-use disposable laparoscopic accessory device to facilitate intra-operative defogging and debris deflection (due to the flow of anhydrous CO₂) and cleaning of the lens of a laparoscope **12** (due to burst of sterile fluid, preferably including a “surface-active agent”) during minimally invasive surgery, while also maintaining visualization of the surgical site.

[0086] FIGS. **7** to **34** illustrate a representative method including the set up and use of the view optimizing assembly using sterile technique by qualified technicians/operating room personnel.

[0087] The procedure can be incorporated into written instructions for use that accompany the packaging. The instructions can also be supplied separately, e.g., embodied in separate instruction manuals, or in video or audio tapes, CD's, and DVD's. The instructions for use can also be available through an internet web page.

[0088] The instructions can direct the OR set-up to peel open the outer pouches in which the components of the view optimizing assembly (shown in FIG. **7**), and remove the sterile contents on the sterile field. The sheath **14**/manifold **18** assembly is removed, taking care to prevent damage to the walls of the sheath **14** or to its distal end, and also keeping the tubing set **16** and vent device **24** on the sterile field prior to making necessary connections.

[0089] During set up (see FIGS. **8** and **9**), the sheath **14** (with the manifold **18**, which is integrally connected to the sheath **14** during manufacture, called a sheath assembly) can be assembled to the corresponding laparoscope **12**. In this representative example, it is contemplated that the OR team plan to use a 0-degree laparoscope **12** (see FIGS. **8** and **9**) and at least one angled laparoscope **12** (see FIGS. **10** and **11**), e.g., a 30-degree and/or a 45-degree laparoscope **12**. Therefore, during set-up, a sheath assembly for each laparoscope **12** selected for use will be pre-assembled to the corresponding laparoscope **12**.

[0090] As FIGS. **8** and **10** show, while gently pressing the tip of the sheath assembly against one hand or finger-tip, the laparoscope **12** can be inserted down into the sheath **14**. The sheath **14** is sized and configured so that the laparoscope **12** will slide smoothly through the sheath **14**. Insertion continues until the lens and distal rim of the laparoscope **12** seat against the stop at the distal end of the sheath **14**. The laparoscope **12** will “bottom out” inside the sheath **14** against the stop **26**, assuring correct axial alignment of the lens with the deflector assembly **64**.

[0091] If the laparoscope **12** is angled (as shown in FIG. **10**), the corresponding sheath assembly will also include an alignment fork guide **78**. The light post of the scope seats within the alignment fork guide **78**, therefore assuring correct rotational alignment between the angled lens and the deflector assembly **64**.

[0092] The laparoscope **12** (now fully inserted into the sheath **14**) the manifold **18** are supported by hand, a member of the OR set-up team rotates the locking collar **28** on the sheath assembly in the desired direction, e.g., clockwise (see

FIGS. **9** and **11**), indicated by an arrow on the locking collar **28**, until a firm stop is felt tactilely (e.g., after approximately one-third (1/3) of a turn). Registration of an alignment mark on the locking collar **28** and an alignment mark on the manifold **18** serves to visually confirm that the laparoscope **12** is secured against axial movement relative to the sheath **14**.

[0093] The insufflator is set up off the sterile field. Once the patient is draped on the sterile field, and it is expected that the end of the output tubing from the insufflator (originating from the insufflator off the sterile field) will be brought onto the sterile field. It is also expected that the light cable **30** and the camera cable **32** for the laparoscope **12** will be brought onto the sterile field.

[0094] As FIGS. **12** and **13** generally show, the OR team makes an incision to gain access to the laparoscopic operating site within the body, e.g., into the abdominal cavity through the abdominal wall. A first trocar with a stopcock valve (which may take the form of an optical trocar) is inserted through the incision. Alternatively, according to physician preference, the first trocar can be pushed through abdominal wall with only a skin incision. The obturator (the sharp inner insert of the trocar) is removed from the first trocar once it is in position.

[0095] The insufflator line of the tubing set **16** on the sterile field is connected to the output tubing of the insufflator circuit on the sterile field. The first branch **46** of the tubing set **16** on the sterile field, originating at the Y-connector **44**, is coupled to the stopcock valve of the first trocar (see FIG. **13**). The stopcock valve is opened, and the insufflator is turned on. CO₂ output of the insufflation circuit inflates the abdomen through the first trocar.

[0096] During this time (see FIGS. **8** and **10**), the second branch **48** of the tubing set **16** on the sterile field, also originating at the Y-connector **44**, and the quick exchange coupler **22** integrally attached to it can remain on the sterile field in a free, unconnected condition as the insufflator supplies CO₂ through the first branch **46**. The one-way check valve in the quick exchange coupler **22** serves to block flow of CO₂ through the second branch **48**, even as the insufflator supplies CO₂ through the first branch **46**. The entire CO₂ pressure of the insufflator circuit is, at the present, delivered to the first trocar through the first branch **46**.

[0097] The first laparoscope **12** selected for use, which has been pre-inserted into the sheath **14** by the OR set-up team as just described, is handed to personnel at the OR table at the appropriate time. On the sterile field, personnel at the OR table connect the light cable **30** and the camera cable **32** to the laparoscope **12** (see FIG. **14**). On the sterile field, personnel at the OR table now connect the quick exchange coupler **22** of the tubing set **16** to the quick exchange coupling **20** of the manifold **18** (see FIG. **15**). The one way valve opens, and a small portion of the output of the insufflator circuit is routed by the second branch **48** through the manifold **18** into to the sheath **14**.

[0098] The laparoscope/sheath assembly is then placed as an integrated unit through the first trocar to get an initial view of the abdominal cavity (see FIG. **16**). Due to the technical features of the deflector assembly **64**, CO₂ flows over the lens, eliminating fogging and also deflecting away debris. If present, the pump (e.g., the 20 cc syringe) filled with sterile fluid (preferably with a “surface-active agent”) and connected to the tubing luer-lock, can be operated by personnel at the OR table to flush sterile fluid through the deflector assembly **64** of the sheath **14**. The deflector assembly **64** directs the fluid

bursts across the lens in a path generally 90-degrees offset from the CO₂ path. Once this is done, the bulb on the tubing set 16 can be pumped several times introduce bursts of air to clear droplets off the lens and away from the tip deflector, to maintain to the continuous directed flow of CO₂ across the laparoscopic lens.

[0099] Once a satisfactory view is achieved, additional ancillary trocars with stopcock valves, e.g. three to four, or more, are also placed through incisions to provide access for other instruments (see FIG. 17). The trocar vent device 24 provided with the view optimizing assembly is desirably placed in the stopcock of one of the ancillary trocars, and the stopcock valve is opened (see FIG. 18).

[0100] As FIG. 19 shows, a member of the OR team preferable decouples the main insufflation line (the first branch 46 tubing of the Y-connector 44 of the tubing set 16) from the first trocar to the stopcock valve of another available trocar on the sterile field (except the trocar to which the vent device 24 is coupled). This other trocar then serves as the main insufflation trocar, separate from the first trocar, which now serves as the main visualization trocar. In this way, the main CO₂ insufflation provided for the duration of the surgery is provided by an insufflation trocar that is also not the visualization trocar. The controlled leak of insufflation pressure that the vent device 24 provides creates a pressure gradient within the pneumo-peritoneum that helps maintain a generally continuous flow of CO₂ from the deflector assembly 64 across the lens, despite periodic cycling of the insufflator. Lumens 40 and 42 in the sheath 14 (previously described) can also serve as additional passive vents, to leak insufflation pressure out through the manifold 18.

[0101] The surgery proceeds. The deflector assembly 64 provides intra-operative defogging and cleaning of the laparoscope lens during the minimally invasive surgery, while maintaining visualization of the surgical site. The sterile fluid flush mechanism can be used, as desired, if required to augment visualization by flushing the lens. If this is done, the bulb on the tubing set 16 should be pumped several times to clear droplets off the lens and away from the deflector assembly 64 to maintain the CO₂ curtain across the lens.

[0102] During the surgery, the OR team can decide, e.g., that one portion of the procedure is better visualized with a different angle scope. The quick exchange features of the coupler of the tubing set 16 and the coupling of the manifold 18, greatly facilitate the exchange of one laparoscope 12 for another with minimal interruption of the surgical procedure and without compromising the sterile field.

[0103] To exchange one laparoscope 12 for another, a member of the OR team withdraws the laparoscope/sheath assembly an integrated unit from the visualization trocar (see FIG. 20). A member of the OR team disconnects the laparoscope 12 from the light cable 30 and camera cable 32 (see FIG. 21). A member of the OR team uncouples the quick exchange coupler 22 from the quick exchange coupling 20, freeing the laparoscope/sheath assembly from the tubing set 16 (see FIG. 22). The disconnected laparoscope/sheath assembly is handed as an integrated unit to a member of the OR team, e.g., a scrub nurse (see FIG. 23). There is no reason to remove the sheath 14 from the matching laparoscope 12 at this time. This can be accomplished later, after the surgery is all done.

[0104] The laparoscope/sheath assembly that includes the second laparoscope 12 that is to be used, has already been assembled into an integrated unit, as previously described.

This pre-assembled unit is handed to a member of the OR team (see FIG. 24). A member of the OR team connects the second laparoscope 12 to the light cable 30 and camera cable 32 (see FIG. 25). A member of the OR team couples the quick exchange coupler 22 of the tubing set 16 to the quick exchange coupling 20, connecting the second laparoscope/sheath assembly in flow communication with the tubing set 16 (see FIG. 26), completing the quick exchange. The second laparoscope/sheath assembly is inserted into the visualization trocar (see FIG. 27).

[0105] The quick connect feature functions with a manifold 18 associated with every sheath 14. The tubing set 16 on the sterile field can be rapidly disconnected, but need not, and desirably is not, exchanged with another tubing set 16. During a given surgical procedure, the same tubing set 16 serves every laparoscope/sheath assembly used (unneeded tubing sets 16 that came with the additional sheaths can be simply discarded).

[0106] The surgery proceeds using the second laparoscope/sheath assembly.

[0107] Additional quick exchanges of laparoscopes can be accomplished as surgery proceeds in the manner just described.

[0108] Once surgery is completed, all instruments, including the laparoscope/sheath assembly in use are removed from the visualization trocar (see FIG. 28). A member of the OR team disconnects the laparoscope 12 from the light cable 30 and camera cable 32 (see FIG. 29). A member of the OR team uncouples the quick exchange coupler 22 from the quick exchange coupling 20, freeing the laparoscope/sheath assembly from the tubing set 16. The laparoscope/sheath assembly is handed to a member of the OR team (see FIG. 31), and placed alongside previously used laparoscope/sheath assemblies (see FIG. 32).

[0109] Access sites are closed. The insufflator is shut off. The tubing set 16 is disconnected from the insufflator circuit. The lock collars on the manifolds 18 are loosened, and laparoscopes are withdrawn from the sheaths for reuse (FIG. 33). The sheaths and tubing set 16 are disposed of (FIG. 34).

[0110] Some trocars are called "optical trocars" that have a lumen within the obturator, that is within the trocar. If the lens of a laparoscope 12 is first placed into the center of an optical trocar to guide the first trocar insertion, then the sheath 14 cannot be present on the laparoscope 12, as the combination cannot fit through the lumen of the obturator. In this situation, the laparoscope 12 is used without a sheath 14 is used to place the first trocar. The laparoscope 12 is then inserted through the sheath 14, and connection of the tubing set 16 occurs in the manner just described. With the obturator removed from the trocar, the laparoscope/sheath assembly is placed through the first trocar in the manner described.

What is claimed is:

1. A method of defogging and cleaning a laparoscope, comprising:

inserting a laparoscope into a sheath;

inserting the laparoscope and sheath into a body cavity;

providing gas to a plurality of gas lumens within a wall of the sheath such that the gas flows through the gas lumens and over a lens of the laparoscope to defog the lens while the laparoscope is in the body cavity; and

providing a fluid comprising a surface-active agent to a fluid lumen within the wall of the sheath such that the fluid flows through the fluid lumen and over the lens to clean the lens while the laparoscope is in the body cavity.

2. The method of claim 1, further comprising providing a burst of air through the gas lumens to clear droplets of the fluid from the lens.

3. The method of claim 1, wherein the gas is from an insufflator coupled with the sheath.

4. The method of claim 1, wherein the fluid is from a syringe coupled with the sheath.

5. The method of claim 1, further comprising deflecting the gas from distal ends of the gas lumens over the lens with a deflector connected to a distal end of the sheath.

6. The method of claim 1, further comprising deflecting the fluid from a distal end of the fluid lumen over the lens with a deflector connected to a distal end of the sheath.

7. The method of claim 1, further comprising locking the laparoscope in place relative to the sheath.

8. The method of claim 1, further comprising attaching the sheath to a source of gas or a source of fluid through a quick disconnect mechanism.

9. The method of claim 1, further comprising venting air from the body cavity through a trocar to provide a pressure gradient within the body cavity to maintain a continuous flow of gas from the gas lumens over the lens.

10. The method of claim 1, wherein the surface active agent stabilizes mixtures of oil and water on the lens within the body cavity by reducing surface tension at the interface between the oil and water molecules.

11. A view optimizing assembly, comprising:
a sheath configured to receive a laparoscope;
a plurality of gas lumens extending within a wall of the sheath;
a fluid lumen extending within the wall of the sheath; and

a manifold connected to the sheath and configured to connect a source of fluid comprising a surface-active agent to the fluid lumen and a source of gas to the gas lumens such that the fluid and gas can flow through the lumens and across a lens of the laparoscope.

12. The assembly of claim 11, further comprising a deflector at a distal end of the sheath.

13. The assembly of claim 11, wherein there are five lumens in the sheath.

14. The assembly of claim 13, wherein there are four gas lumens and one fluid lumen in the sheath.

15. The assembly of claim 11, wherein the source of gas is an insufflator.

16. The assembly of claim 11, wherein the source of fluid is a syringe.

17. The assembly of claim 11, further comprising a burst actuator connected to the sheath and configured to provide a burst of air through the gas lumens to clear droplets of the fluid from the lens.

18. The assembly of claim 11, wherein the gas is CO₂.

19. The assembly of claim 11, wherein the surface active agent stabilizes mixtures of oil and water on the lens within the body cavity by reducing surface tension at the interface between the oil and water molecules.

20. The assembly of claim 11, further comprising a quick-disconnect mechanism configured to connect the source of fluid and the source of gas to the manifold.

* * * * *

专利名称(译)	用于在手术镜的使用期间优化和维持手术视野的可视化的系统和方法		
公开(公告)号	US20150005582A1	公开(公告)日	2015-01-01
申请号	US14/490501	申请日	2014-09-18
[标]申请(专利权)人(译)	投票WAYNE大号 赫德尔斯顿MATTHEW J CRISAFULLI CAROLINE中号 LANDIS ADAM 德劳奇GREGORY P		
申请(专利权)人(译)	民意调查显示, WAYNE L. 赫德尔斯顿, MATTHEW J. CRISAFULLI, CAROLINE M. LANDIS, ADAM 德劳奇, GREGORY P.		
[标]发明人	POLL WAYNE L HUDDLESTON MATTHEW J CRISAFULLI CAROLINE M LANDIS ADAM DRACH GREGORY P		
发明人	POLL, WAYNE L. HUDDLESTON, MATTHEW J. CRISAFULLI, CAROLINE M. LANDIS, ADAM DRACH, GREGORY P.		
IPC分类号	A61B1/00 A61M13/00 A61B1/313 A61B1/12		
CPC分类号	A61B1/00135 A61M13/003 A61B1/3132 A61B1/126 A61B1/127 A61B1/00091 A61B17/3474 A61B2017/347 A61M2202/0225 A61M2205/3344 A61B1/00142 A61B1/015 A61B1/313		
优先权	61/170864 2009-04-20 US 61/121514 2008-12-10 US		
其他公开文献	US10231609		
外部链接	Espacenet USPTO		

摘要(译)

一种除雾和清洁腹腔镜的方法包括：(1) 将腹腔镜插入护套中；(2) 将腹腔镜和鞘管插入体腔内；(3) 向护套壁内的多个气体腔提供气体，使得气体流过气体腔并通过腹腔镜的透镜，以在腹腔镜处于体腔内时使透镜除雾；(4) 将包含表面活性剂的流体提供给护套壁内的流体腔，使得流体流过流体腔并在镜片上方以在腹腔镜处于体腔内时清洁镜片。

