



(51) International Patent Classification:  
A61B 17/00 (2006.01)

(21) International Application Number:  
PCT/US2009/069837

(22) International Filing Date:  
30 December 2009 (30.12.2009)

(25) Filing Language: English

(26) Publication Language: English

(30) Priority Data:  
61/141,437 30 December 2008 (30.12.2008) US

(71) Applicants (for all designated States except US): **BAXTER INTERNATIONAL INC.** [US/US]; One Baxter Parkway, Deerfield, IL 60015 (US). **BAXTER HEALTHCARE S.A.** [CH/CH]; Thurgauerstrasse 130, CH-8152 Glattpark (Opfikon) (CH).

(71) Applicant (for US only): **REDL, Heinz** [AT/AT]; Windmuehlgasse 7, A-1070 Vienna (AT).

(72) Inventors; and

(75) Inventors/Applicants (for US only): **KHAKPOUR, Zafar** [AT/AT]; Gerasdorferstrasse 320/H18, A-1210 Vienna (AT). **FORTELVNY, Rene** [AT/AT]; Kirchmayergasse 19B, Weidling, Austria, A-3411 (AT).

(74) Agent: **KRIEGEL, Jeremy, R.**; Marshall, Gerstein & Borun LLP, 233 S. Wacker Drive, Suite 6300, Sears Tower, Chicago, IL 60606-6357 (US).

(81) Designated States (unless otherwise indicated, for every kind of national protection available): AE, AG, AL, AM, AO, AT, AU, AZ, BA, BB, BG, BH, BR, BW, BY, BZ, CA, CH, CL, CN, CO, CR, CU, CZ, DE, DK, DM, DO, DZ, EC, EE, EG, ES, FI, GB, GD, GE, GH, GM, GT, HN, HR, HU, ID, IL, IN, IS, JP, KE, KG, KM, KN, KP, KR, KZ, LA, LC, LK, LR, LS, LT, LU, LY, MA, MD, ME, MG, MK, MN, MW, MX, MY, MZ, NA, NG, NI, NO, NZ, OM, PE, PG, PH, PL, PT, RO, RS, RU, SC, SD, SE, SG, SK, SL, SM, ST, SV, SY, TH, TJ, TM, TN, TR, TT, TZ, UA, UG, US, UZ, VC, VN, ZA, ZM, ZW.

(84) Designated States (unless otherwise indicated, for every kind of regional protection available): ARIPO (BW, GH, GM, KE, LS, MW, MZ, NA, SD, SL, SZ, TZ, UG, ZM, ZW), Eurasian (AM, AZ, BY, KG, KZ, MD, RU, TJ, TM), European (AT, BE, BG, CH, CY, CZ, DE, DK, EE, ES, FI, FR, GB, GR, HR, HU, IE, IS, IT, LT, LU, LV, MC, MK, MT, NL, NO, PL, PT, RO, SE, SI, SK, SM, TR), OAPI (BF, BJ, CF, CG, CI, CM, GA, GN, GQ, GW, ML, MR, NE, SN, TD, TG).

**Declarations under Rule 4.17:**

— as to applicant's entitlement to apply for and be granted a patent (Rule 4.17(ii))

[Continued on next page]

(54) Title: TISSUE SEALING SYSTEM AND APPARATUS

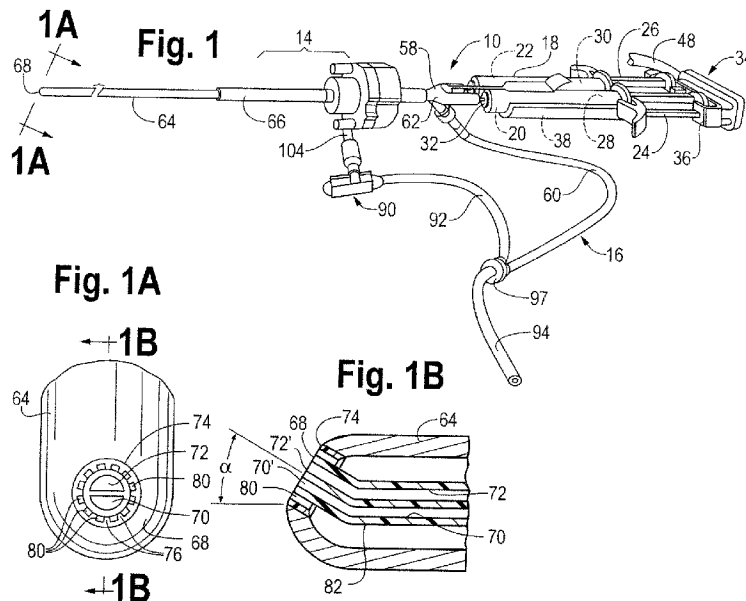

(57) Abstract: A laparoscopic tissue sealant spray apparatus and system having a laparoscopic tissue sealant spray assembly combined with a trocar assembly, the tissue sealant spray assembly having an elongate delivery tube. A spray outlet at a distal end of the elongate delivery tube may be rounded or angled. A ring member provided at the distal end of the elongate delivery tube directs a spray cone toward a portion of a target tissue site, and the spray cone may be repositioned to a different portion of the target tissue site by rotation of the elongate delivery tube. The trocar assembly includes a vent opening that connects to a venting valve member that provides a vent path which passively opens upon operation of the tissue sealant spray assembly, avoiding excessive pressure build-up within a body cavity.

WO 2010/078439 A1



---

— *as to the applicant's entitlement to claim the priority of the earlier application (Rule 4.17(iii))* — *before the expiration of the time limit for amending the claims and to be republished in the event of receipt of amendments (Rule 48.2(h))*

**Published:**

— *with international search report (Art. 21(3))*

## TISSUE SEALING SYSTEM AND APPARATUS

### REFERENCE TO RELATED APPLICATIONS

[0001] This application claims the benefit of the filing date of United States Provisional Application No. 61/141,437, filed December 31, 2008, the disclosure of which is incorporated herein by reference.

### BACKGROUND

Filed of the Disclosure

[0002] This disclosure is generally directed to systems for applying a sealant to a work surface and, more particularly, to an apparatus and system for applying tissue sealant to biological tissue employing structure that facilitates controlled spray application of tissue sealant and passive control of gas pressure.

### DESCRIPTION OF THE RELATED ART

[0003] Various apparatus and systems have been disclosed for application of tissue sealants. One such disclosure is U.S. Patent No. 7,537,174, entitled "Hand Triggered Tissue Sealant Spray Apparatus and System," the entirety of which is incorporated herein by reference. An effective tissue sealant is a two-component tissue sealant made up of fibrinogen and thrombin. Because these two components react quickly with one another to cause clotting, it is desirable to isolate the two components from one another for as long as possible, until they are sprayed onto a target tissue site, such as a bodily organ.

[0004] A trocar device, which is known for use in laparoscopic surgical procedures, may be employed with an elongate delivery tube to deliver the two components, *e.g.*, fibrinogen and thrombin, from a double-barrel syringe to a target tissue site. In order to spray the

components of the tissue sealant onto a target tissue site, gas is introduced, such as through a Y-shaped spray adapter, as described in the aforementioned U.S. Patent No. 7,537,174.

**[0005]** While such tissue sealing systems have been described and used, these systems limit the ability of the surgeon to direct the spray. With existing laparoscopically-introduced tissue spray systems, the surgeon can apply tissue sealant to a particular portion of a target tissue site, but then needs to withdraw the delivery tube at least partially into, or completely from, the trocar, reposition the delivery tube, then apply more tissue sealant to another portion of the target tissue site. This interrupted application of tissue sealant undesirably increases procedure time.

**[0006]** Another disadvantage of existing gas driven tissue delivery systems is the need for the surgeon or other medical professionals to carefully monitor the gas pressure introduced via the trocar to a bodily cavity. To perform most endoscopic, and in particular, laparoscopic procedures, the abdomen or other bodily cavity is filled with CO<sub>2</sub> gas, controlled by a special controller device where the pressure range is preset and maintained by monitoring, automatically delivering more CO<sub>2</sub> gas as needed. With certain newer controller devices, the release of gas from the bodily cavity may also be controlled. With such gas driven tissue delivery systems, an unacceptable increase of intracavity pressure may be realized if no venting is performed. In order not to overdistend the abdomen or other bodily cavity, and to avoid excessive pressure increase, the amount of gas employed for spraying should be limited. Moreover, the pressure on the surface of the target tissue to be sprayed should not exceed the pressure in small blood vessels, so as to avoid a gas embolism in the vasculature.

**[0007]** Venting can be accomplished by the surgeon by opening of a manually-operated valve at the trocar. Alternately, certain newer laparoscopic gas controller devices can

actively control the supply of gas introduced into, or released from, the bodily cavity. However, these solutions require nearly-constant monitoring of intracavity pressure and pressure of gas, such as CO<sub>2</sub> or helium, used in the spray device or otherwise introduced into the bodily cavity.

[0008] It would therefore be desirable to provide a laparoscopic tissue sealant spray delivery system and apparatus that speeds up procedure time and reduces the need for monitoring of the pressure of gas introduced into the bodily cavity, thereby permitting the surgeon or other medical professionals to pay more attention to other matters relating to the procedure.

#### SUMMARY OF THE DISCLOSURE

[0009] Various embodiments of a laparoscopic tissue sealant spray delivery system and apparatus are described below. In one embodiment, the laparoscopic tissue sealant spray assembly is provided with an elongate delivery tube having a rounded distal end. In another embodiment, the elongate delivery tube is provided with an angled end, such as in a range of 30° to 45°. In either of these embodiments, the elongate delivery tube is preferably provided with separate passageways, one for each component of a two component fluid, such as a tissue sealant, and these separate sealant component passageways are surrounded by a gas passageway. The sealant component passageways and the gas passageway terminate at a ring member provided at the distal end of the elongate delivery tube, with the ring member having a plurality of teeth projecting radially inwardly from an inner diameter thereof.

[0010] The inner diameter of the ring member, the teeth, and an outer wall of the sealant component passageways define a plurality of apertures at the distal end of the elongate delivery tube for gas in the passageway to first be exposed to the two components as the components are simultaneously ejected from the elongate delivery tube, thereby spraying the

tissue sealant onto a target tissue site. The rounded or angled distal end may be easily repositioned by simply rotating the elongate delivery tube to direct a conical spray of tissue sealant to a different portion of a target tissue site.

[0011] Another aspect of the present disclosure is a venting valve member provided at a vent opening of a trocar assembly of the laparoscopic tissue sealant spray apparatus and system. The venting valve member has a gas inlet in fluid communication with a gas passageway branched off from the gas supply passageway that delivers gas to the tissue sealant spray assembly. A valve within the venting valve member is biased by a spring in the direction of the gas inlet, closing a vent path within the venting valve member. When the tissue sealant spray system is in operation, pressurized gas entering the gas inlet of the venting valve member urges the valve therein against the spring, thereby opening the vent path and permitting gas to be vented from a bodily cavity, through a trocar tube and vent opening of the trocar assembly, and out through the venting valve member.

[0012] The venting valve member includes a movable valve rod having a first axially-extending section of a diameter sufficient to block the vent path, and a second axially-extending section of a smaller diameter, permitting gas to pass through the vent path, around the second axially-extending section of the valve rod. The first axially-extending section of the valve rod may include a hollowed interior cavity to accommodate the spring that biases the valve rod toward a sealed condition in which the first axially-extending section closes the vent path. The second axially-extending section includes an end cap in sealed communication with an interior of a valve conduit within the venting valve member, thereby permitting gas pressure from the pressurized gas P to build up and exert a force sufficient to overcome the biasing force of the spring. The sealed communication also serves to isolate the pressurized gas employed to actuate the valve rod from the gas being vented from the bodily

cavity. The venting valve member significantly diminishes gas build-up within the bodily cavity during the laparoscopic tissue spray procedure. These and other aspects of the present disclosure will now be described in more detail, with reference to the following drawings.

#### BRIEF DESCRIPTION OF THE SEVERAL VIEWS OF THE DRAWINGS

[0013] Fig. 1 is a perspective view of a laparoscopic tissue sealant spray apparatus and system of a first embodiment of the present disclosure;

[0014] Fig. 1A is an enlarged end view of a portion of the laparoscopic tissue sealant spray apparatus and system of Fig. 1, taken along lines 1A-1A of Fig. 1, showing the distal end of an elongate delivery tube surrounded by a trocar;

[0015] Fig. 1B is a cross-sectional view of the distal end of the elongate delivery tube of Fig. 1A, taken along lines 1B-1B of Fig. 1A;

[0016] Fig. 2 is a perspective view of a laparoscopic tissue sealant spray assembly with an elongate delivery tube, partially broken away, and prior to insertion into a trocar assembly;

[0017] Fig. 3 is a perspective view of the laparoscopic tissue sealant spray assembly of Fig. 2, in combination with a trocar assembly having a venting valve member of the present disclosure provided on a valve opening of the trocar assembly;

[0018] Fig. 4 is a plan view of an elongate delivery tube of a laparoscopic tissue sealant spray apparatus of the first embodiment of the present disclosure, with a segment of the elongate delivery tube and most of the laparoscopic tissue sealant spray assembly broken away for clarity;

[0019] Fig. 4A is an end view of the elongate delivery tube shown in Fig. 4, taken along the lines 4A-4A of Fig. 4;

[0020] Fig. 5 is an environmental view of a bodily cavity, showing the distal end portion of the elongate delivery tube shown in Fig. 4, illustrating the manner in which the elongate delivery tube of the laparoscopic tissue sealant spray apparatus of the first embodiment of the present disclosure may be manipulated within the bodily cavity and without being pulled back into the trocar in order to direct tissue sealant to distinct portions of a target site;

[0021] Fig. 6 is a perspective view, in cross-section, of a venting valve member of the present disclosure; and

[0022] Fig. 7 is a plan view of the venting valve member of Fig. 6, taken along directional lines 7-7 of Fig. 6.

#### DETAILED DESCRIPTION OF THE PREFERRED EMBODIMENTS

[0023] The laparoscopic tissue sealant spray apparatus and system 10 of the present disclosure includes a tissue sealant spray assembly 12, a trocar assembly 14, and a network of gas supply tubing 16. The tissue sealant spray assembly 12 has a barrel assembly 18 defining a compartment for a tissue sealant. The fluid to be delivered is preferably a tissue sealant, and is most preferably a multi-component tissue sealant, such as a two-component sealant including thrombin and fibrinogen. Much of the tissue sealant spray apparatus and system, up to and including a generally Y-shaped spray adapter member, may be as described in U.S. Patent No. 7,537,174, wherein the components of the apparatus and system are described in greater detail than is provided here.

[0024] In the case of a two-component sealant where the components must be isolated from one another until their application to a target site, the barrel assembly 18 includes two interior bores 20, 22, with each component stored in one of the interior bores 20, 22. Pistons 24, 26 are movably positioned in each of the respective interior bores 20, 22. Each of the pistons 24, 26 is provided with a plunger member 28, 30 at the distal end thereof, each of the

plunger members 28, 30 forming a seal with an inner wall of the respective interior bore 20, 22, such that advancement of the pistons 24, 26 toward a distal end 32 of the barrel assembly 18 ejects the components of the tissue sealant from the interior bores 20, 22.

[0025] In order to provide simultaneous ejection of the two components of the tissue sealant, a pusher member 34 that bridges both of the pistons 24, 26 is operatively associated with the pistons 24, 26. The pusher member 34 may be provided with a proximal platform 36 slidably attached to a frame 38. Each of the plunger members 28, 30 terminates in a flanged end 40, 42 received in a corresponding slot 44, 46 of the proximal platform 36.

[0026] A gas passageway 48 connects to the pusher member 34. An opening 50 on the proximal platform 36 is restricted as the user actuates the pusher member 34. This blockage of the opening 50 causes the gas pressure to increase to the static pressure of the gas and generates a supply signal to a gas supplying device (not shown). This signal operates a valve on the gas supplying device which in turn operatively supplies gas to the network of gas supply tubing 16. In an embodiment this gas may be carbon dioxide, but such gas may be any gas which is suitable for the application.

[0027] At the distal end 32 of the barrel assembly 18, each of the interior bores 20, 22 is in fluid communication with a respective tissue sealant inlet 52, 54 of a generally Y-shaped spray adapter member 56. The generally Y-shaped spray adapter member 56 also includes a gas inlet connection 58, to which a gas supply tube 60 that one branch of the network of supply tubing 16 connects. Thus activation of the valve on the gas supplying device by selective blockage of the opening 50 provides a flow of gas into the network 16 and thereby the supply tubing 16 and such gas flows into the gas inlet connection 58 of the Y-shaped adapter member 56.

Elongate Delivery Tube

[0028] The generally Y-shaped spray adapter member 56 is provided with a connection outlet 62 in fluid communication with both the gas inlet connection 58 and the tissue sealant inlets 52, 54. The connection outlet 62 is in fluid communication with an elongate delivery tube 64, which extends through a trocar tube 66 of the trocar assembly 14.

[0029] In the embodiment shown in Figs. 1, 1A and 1B, a spray outlet 68 at the distal end of the elongate delivery tube 64 is rounded. The elongate delivery tube 64 defines a conduit therein with separate sealant component passageways 70, 72, one for each of the tissue sealant components. A ring member 74 having a plurality of teeth 76 projecting radially inwardly is provided at the rounded spray outlet 68 at the distal end of the elongate delivery tube 64. The elongate delivery tube 64 also includes a gas passageway 78 in fluid communication with the connection outlet 62 of the generally Y-shaped spray adapter member 56. The gas passageway 78 surrounds the sealant component passageways 70, 72 and terminates at the rounded spray outlet 68 at the distal end of the elongate delivery tube 64. Gas in the gas passageway 78 is able to pass through the rounded spray outlet 68 of the elongate delivery tube 64 via apertures 80 defined by the teeth 76, the inner diameter of the ring 74, and an exterior wall 82 of the sealant component passageways 70, 72.

[0030] The connection between the generally Y-shaped spray adapter member 56 and the elongate delivery tube 64 is such that gas from the gas supply tube 60 enters the gas inlet connection 58 of the generally Y-shaped spray adapter member 56, but rather than mixing with the tissue sealant components in the spray adapter member 56, the gas remains isolated from the components, and the components remain isolated from one another, down the entire length of the elongate delivery tube 64. The gas is only exposed to the tissue sealant components at the spray outlet 68, simultaneously with the tissue sealant components first

being exposed to one another, when the gas passes through the apertures 80. Distributing gas delivery via a plurality of apertures 80, as is achieved with the ring member 74, advantageously significantly reduces the pressure and flow rate of the gas necessary to achieve the desired spray mixing of the components as the mixed components are applied at the target tissue surface. The present design also reduces gas volume which is emitted from the delivery tube compared to existing laparoscopic spray systems, and results in a more defined spray cone diameter, enabling more precision in the location of sealant application.

[0031] The ring member 74 and the openings 70', 72' at the distal end of the separate sealant component passageways 70, 72 are preferably displaced slightly from the rounded distal end 68 and inclined at an angle  $\alpha$  in the range of  $30^\circ$  -  $45^\circ$  relative to a main axis of the elongate delivery tube, and inclined preferably at a  $45^\circ$  angle. By so positioning the ring member 74, the spray cone may be easily re-directed during operation of the laparoscopic tissue sealant spray apparatus and system 10, by simply rotating the elongate delivery tube 64. Moreover as the openings 70', 72' are displaced slightly from the spray outlet 68 the spray outlet 68 forms a smooth surface that upon contacting the tissue of a patient provides a touch control to the surgeon without irritating the tissue. In addition, when the spray outlet 68 is in contact with the patient tissue, the displacement of the openings 70', 72' prevents the tissue from blocking the openings thereby lessening the potential for clogs.

[0032] Turning to Figs. 4, 4A and 5, the laparoscopic tissue sealant spray apparatus and system is substantially the same as in the previous embodiment, but the rounded spray outlet 82 at the distal end of the elongate delivery tube 64 includes an angled portion 82' that extends at least short distance beyond an outer perimeter of the ring member 74.

[0033] As illustrated in Fig. 5, a benefit of the angled portion of the rounded spray outlet 82 is that the spray cone 84 formed when the gas disperses the combined tissue sealant

components may be redirected within a bodily cavity 86 from a first portion of a target tissue site to a second portion of the target tissue site by simply manipulating the elongate delivery tube 64 by rotation, as indicated by the directional arrow R. As is the case with the elongate delivery tube 64 illustrated in Figs. 1, 1A and 1B, a ring member 74 is provided in the spray outlet 82, having teeth 76 projecting radially-inwardly from an inner diameter of the ring member 74, defining a plurality of apertures 80 for gas to eject from the gas passageway within the elongate delivery tube 64 surrounding the separate passageways 70, 72 for the tissue sealant components.

#### Venting Valve Member

[0034] Referring to Figs. 1 and 3 in conjunction with Figs. 6 and 7, a venting valve member 90 is connected to a gas passageway 92 of the network of supply tubing 16. The gas passageway 92 and the gas supply tube 60 branch off from a main gas tube 94 at a connector 97. The gas passageway 92 is secured to a gas connecting end 96 of the venting valve member 90. The venting valve member 90 includes a movable valve rod 98 biased by a spring 100 in a direction toward the gas connecting end 96 and a vent path 102 in fluid communication with a valve opening 104 of the trocar assembly 14. The vent path 102 is selectively opened by gas pressure P from the gas passageway 90 urging the valve rod 98 against the restoring force of the spring 100, as indicated by the arrow V in Fig. 7. Fig. 7 also illustrates in phantom lines the position of the valve rod 98 when displaced by the gas pressure P, against the spring 100, to the position in which the vent path 102 is open.

[0035] The vent path 102 is selectively opened by gas pressure P from the gas passageway 90 urging the valve rod 98 against the spring 100, as indicated by the arrow V in Fig. 7. Fig. 7 also illustrates in phantom lines the position of the valve rod 98 when displaced by the gas pressure P, against the spring 100, to the position in which the vent path 102 is

open. The geometry of the valve rod 98 of the venting valve member 90 is such that a first axially-extending section 108 is of a sufficient diameter to block the vent path 102 when the valve rod 98 is in the closed position, as illustrated in solid lines in Fig. 7. A second axially-extending section 110 of the valve rod 98 has a narrower diameter than the first axially-extending section, such that when the valve rod 98 is actuated by gas pressure P from the gas passageway 90, gas may be vented through the vent path 102, around the second axially-extending section.

[0036] The second axially-extending section 110 of the valve rod 98 terminates at a solid end cap 112 opposite the first axially-extending section 108. The end cap 112 is in sealed, yet axially-movable, communication with a valve conduit 114 within the venting valve member 90 in which the valve rod 98 is seated. This sealed engagement permits gas pressure from the pressurized gas P to build up and exert a force sufficient to overcome the biasing force of the spring, and isolates pressurized gas P from the gas passageway from gas in the bodily cavity being vented through the vent path 102. The end cap 112 also serves to limit the travel of the valve rod 98. As illustrated in Figs. 6 and 7, the valve conduit 114 is stepped radially inwardly (from right-to-left in the drawing figures), from a first inner diameter approximately equal to an outer diameter of the end cap 112, to a second inner diameter that is less than the outer diameter of the end cap 112, but large enough to accommodate the first axially-extending section 108 of the valve rod 98. A gasket 116, such as an O-ring, is preferably provided at an end of the first inner diameter region of the valve conduit 114 adjacent the step radially inwardly to the first inner diameter region. The gasket 116 dampens vibrations and reduces noise resulting from impact between the end cap 112 and the stepped portion of the valve conduit 114 as the pressurized gas P forces the valve rod 98 against the spring 100.

[0037] The first axially-extending section 108 of the valve rod 98 preferably includes a hollowed interior cavity 118 to accommodate a portion of the spring 100.

[0038] When, as described previously, the opening 50 (Fig. 3) is blocked to signal the gas delivery device (not shown) to supply gas under pressure to the supply tubing 16 (and therefore the gas inlet connection 58), this flow of gas also pressurizes the gas within the gas passageway 92. This gas pressure within the gas passageway 92 forms pressure P within the gas connecting end 92, which urges the valve rod 98 against the restoring force of the spring 100, thereby opening the vent path 102. This opening of the vent path 102 thereby coincides with the supply of gas through the Y-shaped adapter member 56, gas passageway 78 and apertures 80 into the patient. This allows for the selective venting or evacuation of this volume of gas from the bodily cavity (e.g., the abdominal cavity), as it is being supplied, through the trocar tube 66 and the valve opening 104 of the trocar assembly 14, and to the atmosphere, with the end result being very minimal net pressure increase or increase in volume of gas in the patient's cavity, during continuous spraying of tissue sealant. When the opening 50 is uncovered, spraying is stopped, gas flow into the patient is interrupted, and the gas pressure P ceases to be supplied to the gas connecting end 96 of the venting valve member 90, upon which the valve rod 98 of the venting valve member 90 is closed by the restoring force of the spring 100.

[0039] The vent path 102 of the venting valve member 90 may be secured to the valve opening 104 of the trocar assembly by a locking member 106, which may be internally threaded and may engage external threads (not shown) on the valve opening 104 of the trocar assembly 14. In an embodiment this locking member 106 and valve opening 104 may be formed as a standard luer fitting. A vent path connector end 120 is configured to attach to a vent outlet at the valve opening 104 of the trocar assembly, the vent path 102 being in fluid

communication with the vent path connector end 120. The venting valve member 90 further includes a vent opening 122 at a terminus of the vent path 102 and in fluid communication with the second inner diameter region of the valve conduit 114.

**[0040]** While various aspects of the present disclosure have been described, it will be understood by those of ordinary skill in the art that variations may be made thereto that are still within the scope of the appended claims.

CLAIMS

What is claimed is:

1. An improved tissue sealant applicator having a barrel assembly containing a tissue sealant, a piston movably positioned in a proximal end of the barrel assembly, and an elongate delivery tube, in combination with a trocar assembly having a trocar tube for introducing the elongate delivery tube into a bodily cavity, the improvement comprising:

a spray adapter member having

a gas inlet connection;

a tissue sealant inlet in fluid communication with both the gas inlet connection and a distal end of the barrel assembly; and

a connector outlet in fluid communication with both the gas inlet connection and the tissue sealant inlet;

the elongate delivery tube having a proximal end connected to the connector outlet of the adapter member and a spray outlet at an opposite distal end, the elongate delivery tube received in the trocar tube of the trocar assembly, with the spray outlet at the distal end of the elongate delivery tube exposed and the elongate delivery tube being rotatable relative to the trocar tube; and

wherein the spray outlet at the distal end of the elongate delivery tube is angled relative to a main axis of the elongate delivery tube.

2. An improved tissue sealant applicator having a barrel assembly containing a multi-component tissue sealant including a distinct chamber for each of the components, a piston movably positioned in a proximal end of the barrel assembly, and an elongate delivery tube, in combination with a trocar assembly having a trocar tube for introducing the elongate delivery tube into a bodily cavity, the improvement comprising:

a spray adapter member having

a gas inlet connection;

a distinct chamber for each component of the multi-component tissue sealant;

a tissue sealant inlet in fluid communication with both the gas inlet connection and a distal end of the barrel assembly; and

a connector outlet in fluid communication with both the gas inlet connection and the tissue sealant inlet;

the elongate delivery tube having a proximal end connected to the connector outlet of the adapter member, a distinct chamber for each component of the multi-component tissue sealant and a spray outlet at an opposite distal end, the elongate delivery tube received in the trocar tube of the trocar assembly, with the spray outlet at the distal end of the elongate delivery tube exposed and the elongate delivery tube being rotatable relative to the trocar tube; and

wherein the spray outlet at the distal end of the elongate delivery tube is angled relative to a main axis of the elongate delivery tube.

3. The improved tissue sealant applicator and trocar combination of claim 2, wherein the elongate delivery tube includes a gas passageway in fluid communication with the connector outlet of the spray adapter member.

4. The improved tissue sealant applicator and trocar combination of claim 3, wherein the gas passageway of the elongate delivery tube surrounds the separate passageways for the components of the tissue sealant.

5. The improved tissue sealant applicator and trocar combination of claim 4, wherein the gas passageway and the separate passageways for the components of the tissue sealant terminate at a distal end of the elongate delivery tube at a ring member having a plurality of

teeth projecting radially inwardly from an inner diameter of the ring, the teeth extending across an outlet end of the gas passageway and around an outer wall of the separate passageways, whereby the outer wall of the separate passageways, the teeth, and the inner diameter of the ring member define a plurality of apertures in the distal end of the elongate delivery tube.

6. The improved tissue sealant applicator and trocar combination of claim 5, wherein the distal end of the elongate delivery tube is rounded, and the ring member is off-center on the rounded distal end.

7. The improved tissue sealant applicator and trocar combination of claim 1, wherein the trocar assembly is provided with a valve opening permitting gas to be vented from the trocar tube to an exterior of the trocar assembly, and further comprising a venting valve member secured to the valve opening, the venting valve member including:

a gas connecting end;

a valve rod biased by a spring in a direction toward the gas connecting end; and

a vent path in fluid communication with the valve opening of the trocar assembly, the vent path selectively opened by gas pressure urging the valve rod against the spring.

8. The improved tissue sealant applicator and trocar combination of claim 7, wherein the venting valve member is provided with a threaded locking member selectively securable to an exterior of the valve opening of the trocar assembly.

9. The improved tissue sealant applicator and trocar combination of claim 7, further comprising a branched gas supply tube having a first end connected to a source of gas, a second end in fluid communication with the gas inlet connection of the spray adapter member, and a third end in fluid communication with the gas connecting end of the venting valve member.

10. The improved tissue sealant applicator and trocar combination of claim 1, wherein a spray outlet at the distal end of the elongate delivery tube is angled relative to a main axis of the elongate delivery tube and the angle is in a range of 30° - 45°.

11. An improved tissue sealant spray applicator for applying a multiple component fluid into a bodily cavity through a trocar assembly extending into the body cavity, the multiple component fluid being contained within a multiple component assembly having a barrel assembly containing the multi-component fluid, the barrel assembly including a distinct chamber for each of the components, a piston movably positioned in a proximal end of the barrel assembly, the trocar assembly having a trocar tube for introducing the elongate delivery tube into a bodily cavity, a vent outlet and forming a vent passageway for placing the vent outlet in fluid communication with the bodily cavity, the improvement comprising:

a spray adapter member having

a gas inlet connection;

a plurality of fluid inlets, with at least one of the fluid inlets in corresponding fluid communication with one of the chambers; and

an adapter member outlet in fluid communication with the gas inlet connection and the plurality of fluid inlets;

an elongate delivery tube having a proximal end connected to the adapter member outlet of the adapter member, an opposite distal end region forming a spray outlet in fluid communication with the gas inlet and the plurality of tissue sealing inlets, the elongate delivery tube received in the trocar tube of the trocar assembly, and sized to extend through the trocar tube with the distal end region of the elongate delivery tube exposed and the elongate delivery tube being rotatable relative to the trocar tube;

a main gas tube in fluid communication with the gas inlet;

a gas supply tube in fluid communication with the main gas tube;

a venting valve assembly including a gas connecting end attached to the gas supply tube, a valve conduit in fluid communication with the gas connecting end, a vent path connector end configured to attach to the vent outlet of the trocar assembly and a vent path in fluid communication with the vent path connector end, the venting valve assembly also including a biased movable valve rod slidably located within the valve conduit and configured to provide a seal within the vent path, the valve rod being operable by gas pressure within the valve conduit to slide against the bias and provide a selective opening for gas to pass from the vent path to the atmosphere; and

a vent opening, wherein the vent opening is in fluid communication with the vent path upon said selective opening of the valve rod.

12. A venting valve member for use with a trocar assembly having a trocar tube and a trocar body having a valve opening permitting gas to be vented from the trocar tube to an exterior of the trocar assembly, the venting valve member comprising:

a gas connecting end;

a valve biased by a spring in a direction toward the gas connecting end; and

a vent path in fluid communication with the valve opening of the trocar assembly, the vent path selectively opened by gas pressure urging the valve against the spring.

13. The venting valve member of claim 12, further comprising a locking member selectively securable to an exterior of the valve opening of the trocar assembly.

14. The venting valve member of claim 12, in combination with a gas supply tube having a first end in fluid communication with the gas connecting end of the venting valve member and a second end in fluid communication with a gas source.

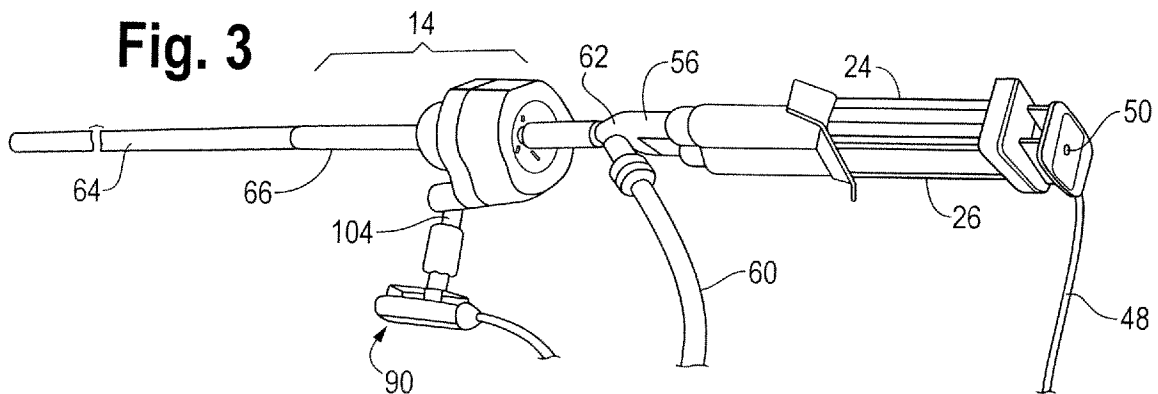
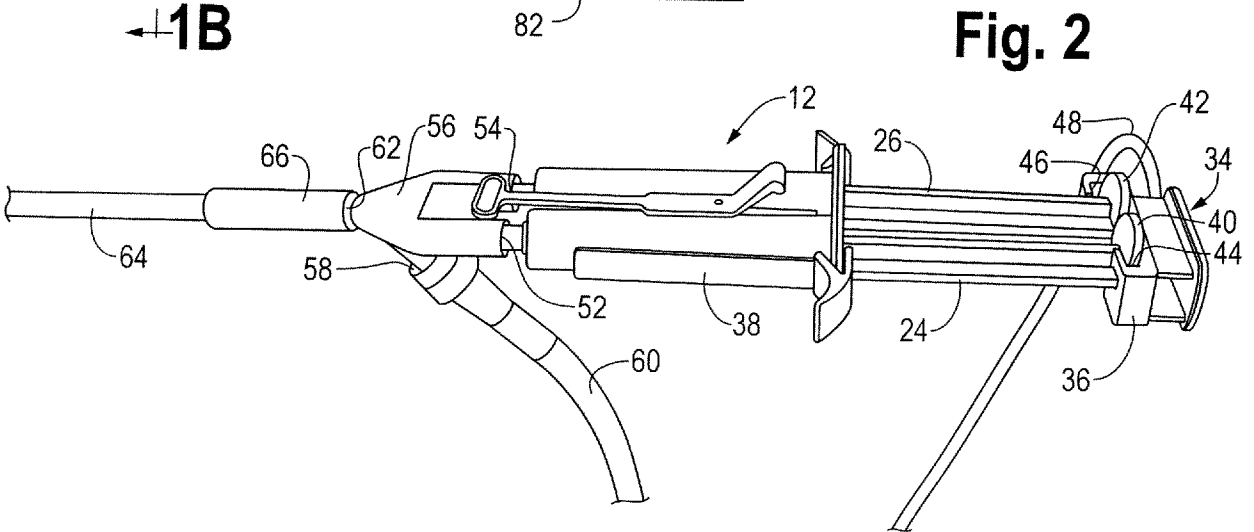
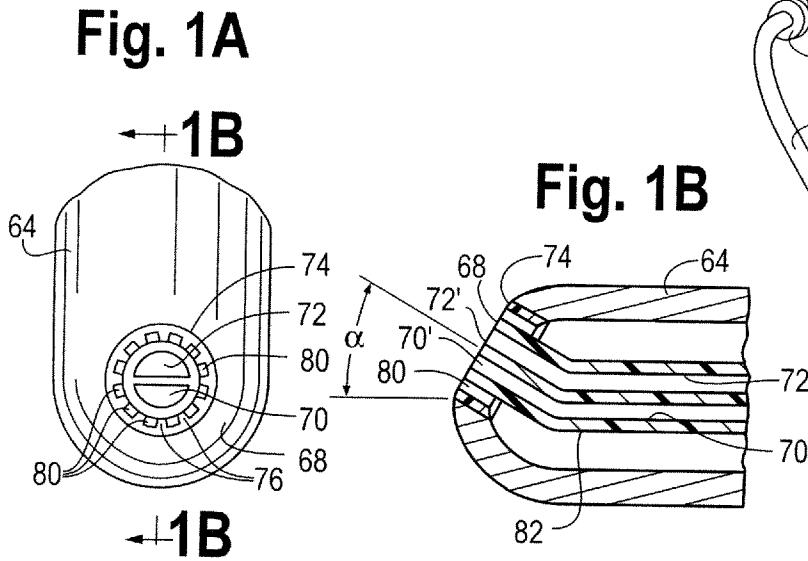
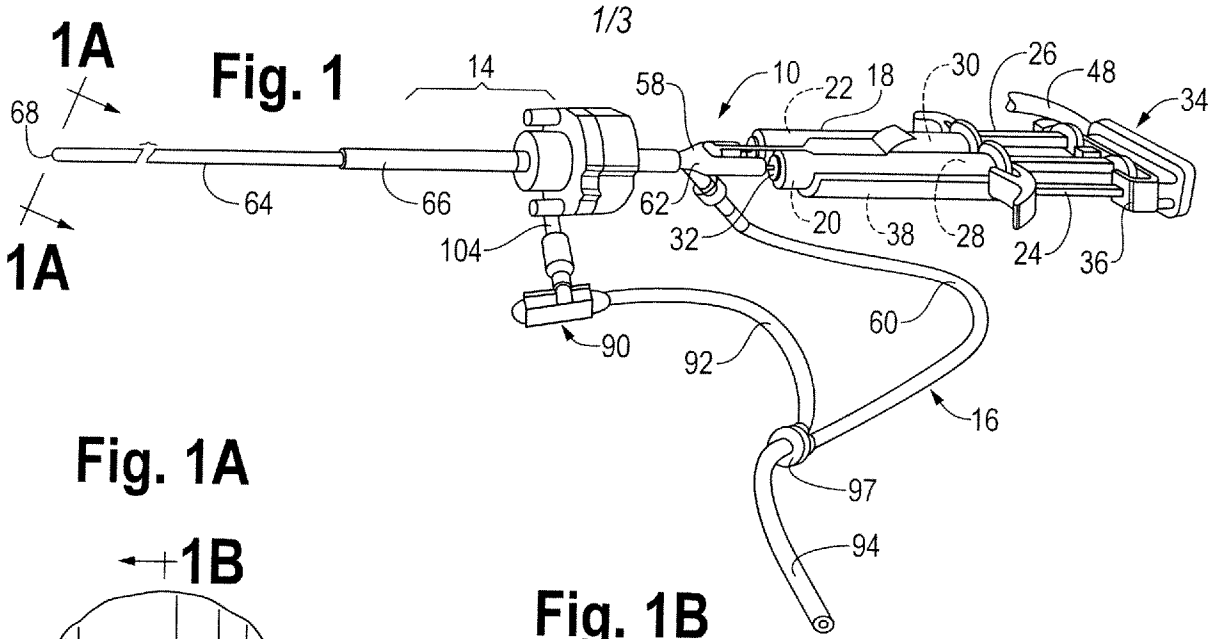

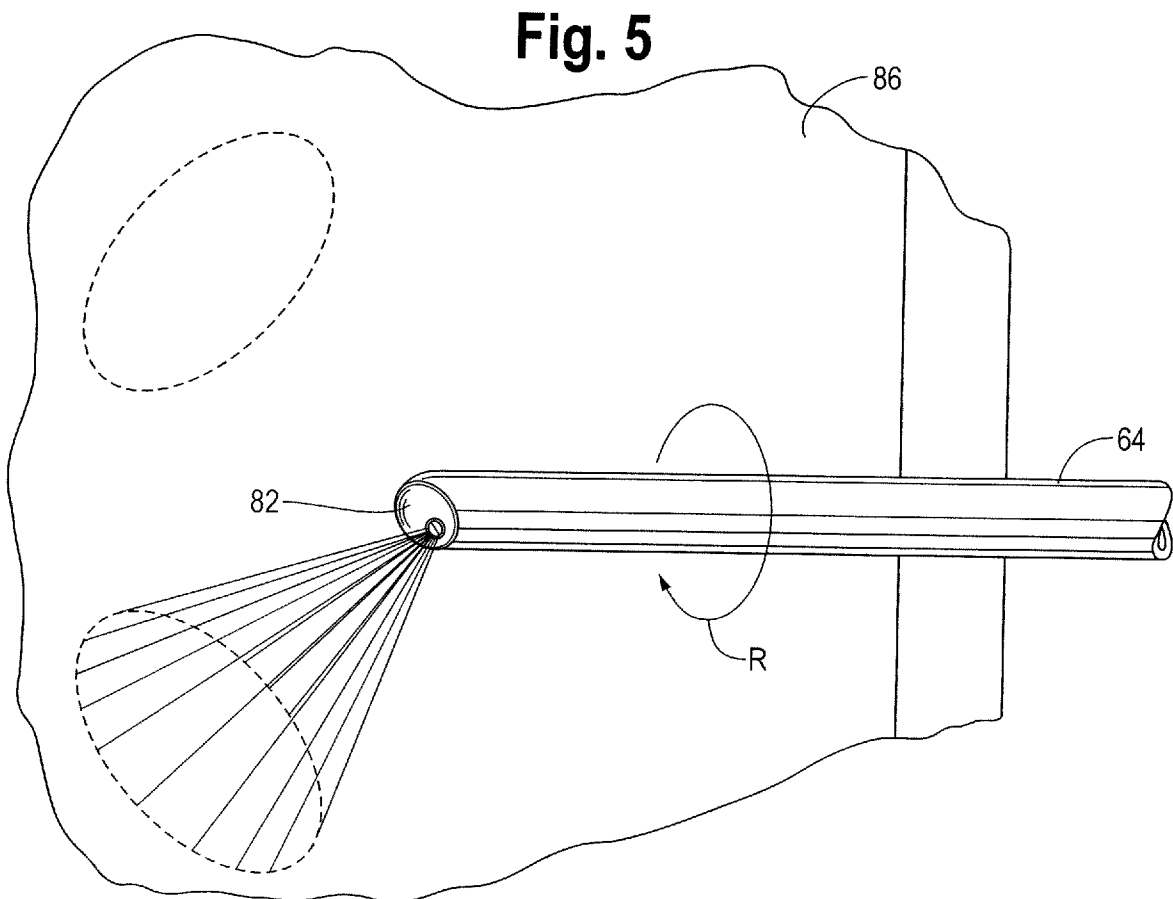
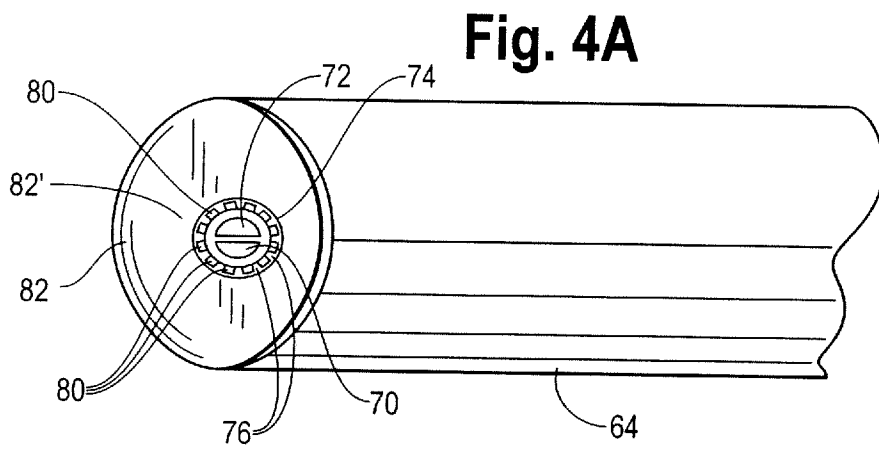
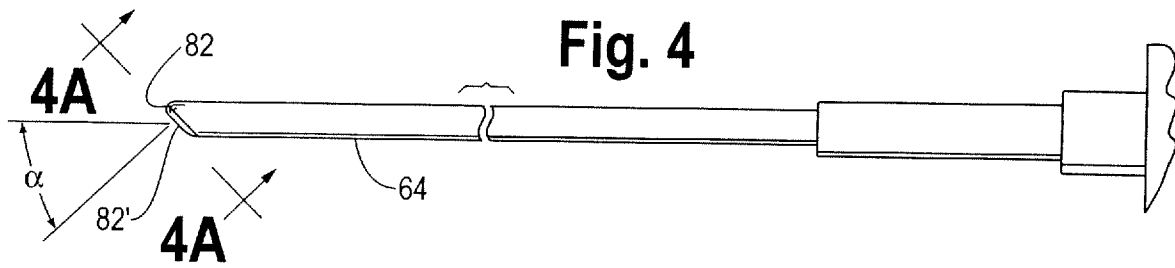

3/3

**Fig. 6**

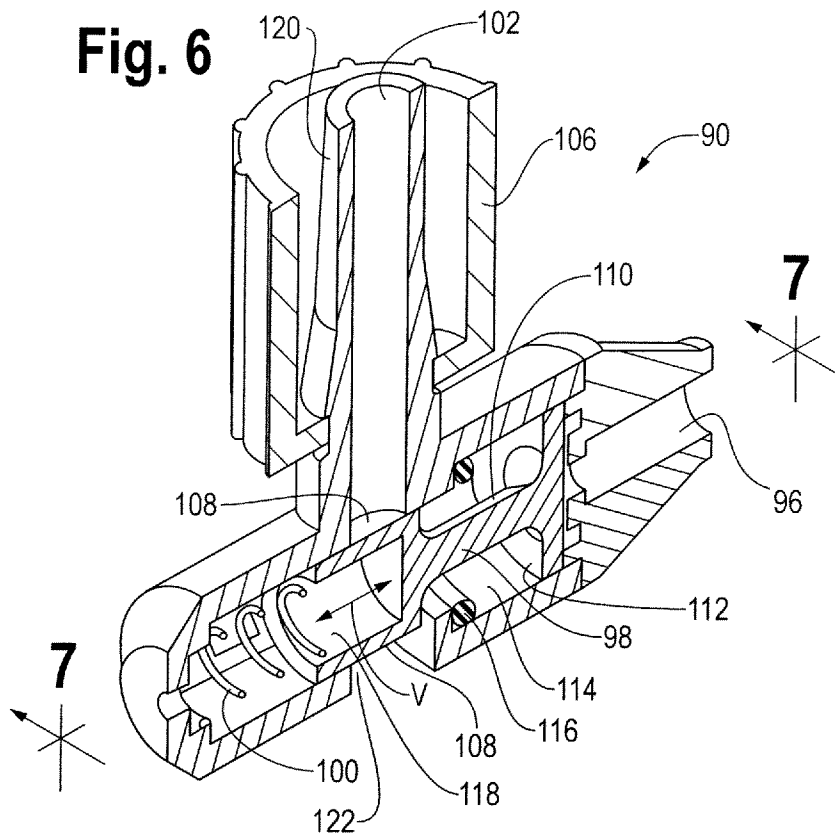

**Fig. 7**

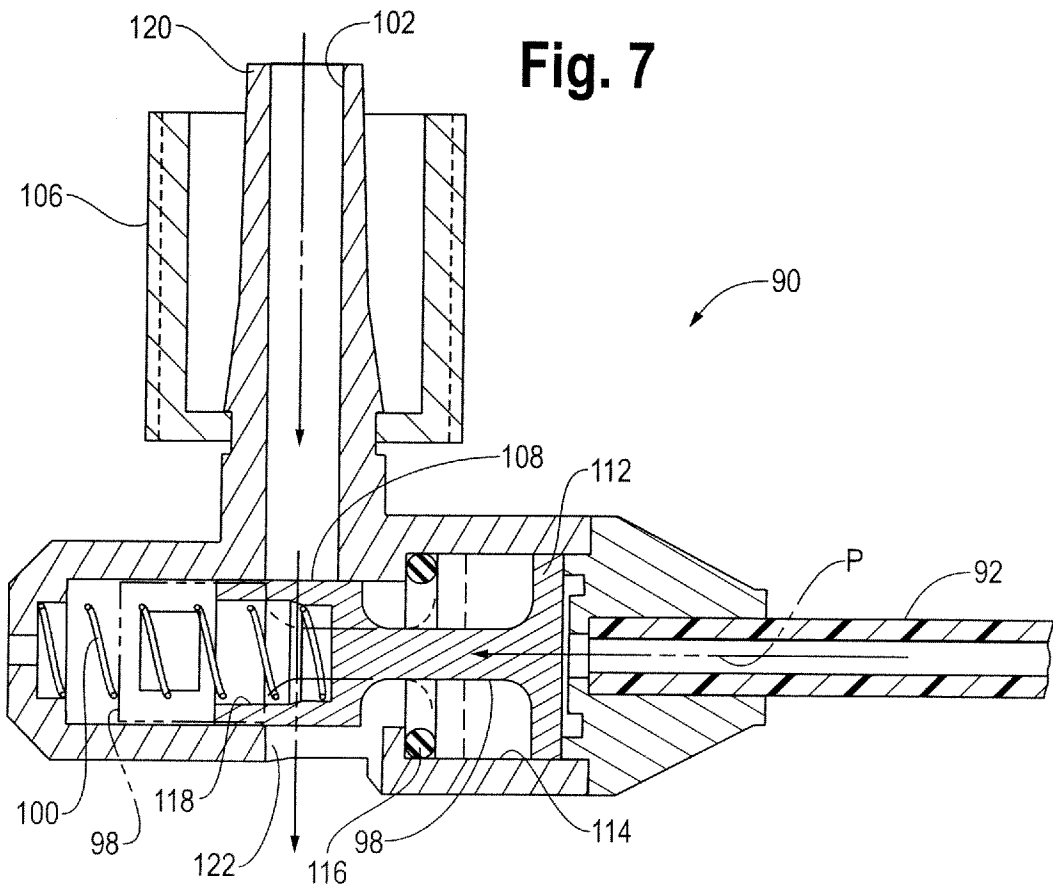

**INTERNATIONAL SEARCH REPORT**

International application No  
PCT/US2009/069837

**A. CLASSIFICATION OF SUBJECT MATTER**  
 INV. A61B17/00  
 ADD. A61B19/00

According to International Patent Classification (IPC) or to both national classification and IPC

**B. FIELDS SEARCHED**

Minimum documentation searched (classification system followed by classification symbols)  
**A61B**

Documentation searched other than minimum documentation to the extent that such documents are included in the fields searched

Electronic data base consulted during the international search (name of data base and, where practical, search terms used)  
**EPO-Internal**

Category*	Citation of document, with indication, where appropriate, of the relevant passages	Relevant to claim No.
X	US 5 810 885 A (ZINGER FREDDY [IL]) 22 September 1998 (1998-09-22) columns 3-5; figures 1,2	1-4, 10
X	JP 05 168714 A (NISSHO KK) 2 July 1993 (1993-07-02)	1-4, 10
Y	the whole document	11
Y	WO 2006/076427 A2 (BAXTER INT [US]; BAXTER HEALTHCARE SA [CH]; REDL HEINZ [AT]; KHAKPOUR) 20 July 2006 (2006-07-20) pages 17-19; figures 1,3,5	1-4, 10
Y	US 2004/059283 A1 (KIRWAN JOHN M [US] ET AL) 25 March 2004 (2004-03-25) pages 2-4	1-4, 10
	----- -/--	

<input checked="" type="checkbox"/> Further documents are listed in the continuation of Box C.	<input checked="" type="checkbox"/> See patent family annex.
<p>* Special categories of cited documents :</p> <p>"A" document defining the general state of the art which is not considered to be of particular relevance</p> <p>"E" earlier document but published on or after the international filing date</p> <p>"L" document which may throw doubts on priority claim(s) or which is cited to establish the publication date of another citation or other special reason (as specified)</p> <p>"O" document referring to an oral disclosure, use, exhibition or other means</p> <p>"P" document published prior to the international filing date but later than the priority date claimed</p> <p>"T" later document published after the international filing date or priority date and not in conflict with the application but cited to understand the principle or theory underlying the invention</p> <p>"X" document of particular relevance; the claimed invention cannot be considered novel or cannot be considered to involve an inventive step when the document is taken alone</p> <p>"Y" document of particular relevance; the claimed invention cannot be considered to involve an inventive step when the document is combined with one or more other such documents, such combination being obvious to a person skilled in the art.</p> <p>"&amp;" document member of the same patent family</p>	
Date of the actual completion of the international search  <b>26 May 2010</b>	Date of mailing of the international search report  <b>02/06/2010</b>
Name and mailing address of the ISA/ European Patent Office, P.B. 5818 Patentlaan 2 NL - 2280 HV Rijswijk Tel. (+31-70) 340-2040, Fax: (+31-70) 340-3016	Authorized officer  <b>Chopinaud, Marjorie</b>

INTERNATIONAL SEARCH REPORT

International application No  
PCT/US2009/069837

C(Continuation). DOCUMENTS CONSIDERED TO BE RELEVANT		
Category*	Citation of document, with indication, where appropriate, of the relevant passages	Relevant to claim No.
A	WO 00/09199 A1 (INCEPT LLC [US]) 24 February 2000 (2000-02-24) the whole document -----	1-11
Y	EP 2 000 215 A2 (TERUMO CORP [JP]) 10 December 2008 (2008-12-10)	11
A	the whole document -----	1-10

# INTERNATIONAL SEARCH REPORT

International application No.  
PCT/US2009/069837

## Box No. II Observations where certain claims were found unsearchable (Continuation of item 2 of first sheet)

This international search report has not been established in respect of certain claims under Article 17(2)(a) for the following reasons:

1.  Claims Nos.:  
because they relate to subject matter not required to be searched by this Authority, namely:
  
2.  Claims Nos.:  
because they relate to parts of the international application that do not comply with the prescribed requirements to such an extent that no meaningful international search can be carried out, specifically:
  
3.  Claims Nos.:  
because they are dependent claims and are not drafted in accordance with the second and third sentences of Rule 6.4(a).

## Box No. III Observations where unity of invention is lacking (Continuation of item 3 of first sheet)

This International Searching Authority found multiple inventions in this international application, as follows:

see additional sheet

1.  As all required additional search fees were timely paid by the applicant, this international search report covers all searchable claims.
2.  As all searchable claims could be searched without effort justifying an additional fees, this Authority did not invite payment of additional fees.
3.  As only some of the required additional search fees were timely paid by the applicant, this international search report covers only those claims for which fees were paid, specifically claims Nos.:  
  
1-11
4.  No required additional search fees were timely paid by the applicant. Consequently, this international search report is restricted to the invention first mentioned in the claims; it is covered by claims Nos.:

### Remark on Protest

- The additional search fees were accompanied by the applicant's protest and, where applicable, the payment of a protest fee.
- The additional search fees were accompanied by the applicant's protest but the applicable protest fee was not paid within the time limit specified in the invitation.
- No protest accompanied the payment of additional search fees.

FURTHER INFORMATION CONTINUED FROM PCT/ISA/ 210

This International Searching Authority found multiple (groups of) inventions in this international application, as follows:

1. claims: 1-10

A tissue sealant applicator having a barrel with a tissue sealant, a piston and an elongated delivery tube, the applicator comprising a spray adapter with a gas inlet connection, at least a chamber for one tissue sealant, a tissue sealant inlet and a connector outlet wherein the spray outlet is angled relative to a main axis of the elongate delivery tube.

---

2. claim: 11

A tissue sealant applicator having a barrel with a tissue sealant, a piston and an elongated delivery tube, the applicator comprising a spray adapter with a gas inlet connection, a plurality of chambers for tissue sealants, a tissue sealant inlet and a connector outlet, a main gas tube, a gas supply tube and a venting valve assembly wherein the spray outlet is angled relative to a main axis of the elongate delivery tube.

---

3. claims: 12-14

A venting valve member comprising a gas connecting end, a valve biased by a spring and a vent path in fluid communication with the valve opening of the trocar assembly.

---

# INTERNATIONAL SEARCH REPORT

Information on patent family members

International application No <b>PCT/US2009/069837</b>
--

Patent document cited in search report	A	Publication date	CA	Patent family member(s)	Publication date
US 5810885	A	22-09-1998	CA	2208554 A1	04-07-1996
JP 5168714	A	02-07-1993	NONE		
WO 2006076427	A2	20-07-2006	AU	2006205001 A1	20-07-2006
			BR	PI0606642 A2	14-07-2009
			CA	2593973 A1	20-07-2006
			CN	101102722 A	09-01-2008
			EP	1871237 A2	02-01-2008
			HR	20070311 A2	30-09-2007
			JP	2008526436 T	24-07-2008
			KR	20070100286 A	10-10-2007
			ZA	200705689 A	31-12-2008
US 2004059283	A1	25-03-2004	AT	432653 T	15-06-2009
			AU	2003247666 A1	08-04-2004
			CA	2499107 A1	01-04-2004
			EP	1538990 A2	15-06-2005
			JP	2006500100 T	05-01-2006
			WO	2004026145 A2	01-04-2004
WO 0009199	A1	24-02-2000	AU	5560899 A	06-03-2000
			CA	2340381 A1	24-02-2000
			EP	1104324 A1	06-06-2001
			JP	4159254 B2	01-10-2008
			JP	2002522177 T	23-07-2002
			US	6165201 A	26-12-2000
EP 2000215	A2	10-12-2008	JP	2008289986 A	04-12-2008
			US	2008294099 A1	27-11-2008

专利名称(译)	组织密封系统和设备		
公开(公告)号	<a href="#">EP2391276A1</a>	公开(公告)日	2011-12-07
申请号	EP2009805983	申请日	2009-12-30
[标]申请(专利权)人(译)	巴克斯特国际公司 巴克斯特医疗保健股份有限公司		
申请(专利权)人(译)	百特国际有限公司. 百特医疗用品SA		
当前申请(专利权)人(译)	百特国际有限公司. 百特医疗用品SA		
[标]发明人	KHAKPOUR ZAFAR FORTELVNY RENE REDL HEINZ		
发明人	KHAKPOUR, ZAFAR FORTELVNY, RENE REDL, HEINZ		
IPC分类号	A61B17/00		
CPC分类号	A61B17/00491 A61B17/3474 A61B2017/00495 A61B2017/00522		
优先权	61/141437 2008-12-30 US		
其他公开文献	EP2391276B1		
外部链接	<a href="#">Espacenet</a>		

#### 摘要(译)

一种腹腔镜组织密封剂喷雾装置和系统，其具有与套管针组件结合的腹腔镜组织密封剂喷雾组件，该组织密封剂喷雾组件具有细长的输送管。细长输送管的远端处的喷射出口可以是圆形的或成角度的。设置在细长输送管的远端处的环构件将喷雾锥导向目标组织部位的一部分，并且可通过细长输送管的旋转将喷雾锥重新定位到目标组织部位的不同部分。套管针组件包括通气开口，该通气开口连接到通气阀构件，该通气阀构件提供通气路径，该通气路径在组织密封剂喷雾组件的操作时被动地打开，从而避免在体腔内积聚过多的压力。