



(11) **EP 2 329 789 B1**

(12) **EUROPEAN PATENT SPECIFICATION**

(45) Date of publication and mention of the grant of the patent:
08.02.2017 Bulletin 2017/06

(51) Int Cl.:
A61B 17/00 ^(2006.01) **A61B 17/02** ^(2006.01)
A61B 34/00 ^(2016.01) **A61B 34/30** ^(2016.01)
A61B 90/30 ^(2016.01) **A61B 90/00** ^(2016.01)
A61B 1/00 ^(2006.01)

(21) Application number: **10252055.8**

(22) Date of filing: **03.12.2010**

(54) **Laparoscopic scaffold assembly**

Laparoskopische Gerüstanordnung

Ensemble de support laparoscopique

(84) Designated Contracting States:
AL AT BE BG CH CY CZ DE DK EE ES FI FR GB GR HR HU IE IS IT LI LT LU LV MC MK MT NL NO PL PT RO RS SE SI SK SM TR

(30) Priority: **04.12.2009 US 266994 P**
09.11.2010 US 942046

(43) Date of publication of application:
08.06.2011 Bulletin 2011/23

(73) Proprietor: **Covidien LP**
Mansfield, MA 02048 (US)

(72) Inventors:
• **Heinrich, Russell S.**
Madison, CT 06443 (US)
• **Viola, Frank**
Sandy Hook, CT 06482 (US)
• **Stanley, Eric Alexander**
Milford, CT 06460 (US)

(74) Representative: **Soames, Candida Jane et al**
Maschio & Soames IP Limited
30 Carlton Crescent
Southampton SO15 2EW (GB)

(56) References cited:
WO-A1-93/18712 WO-A2-2009/019288

EP 2 329 789 B1

Note: Within nine months of the publication of the mention of the grant of the European patent in the European Patent Bulletin, any person may give notice to the European Patent Office of opposition to that patent, in accordance with the Implementing Regulations. Notice of opposition shall not be deemed to have been filed until the opposition fee has been paid. (Art. 99(1) European Patent Convention).

Description**BACKGROUND***Technical Field*

[0001] This application generally relates to the field of minimally invasive surgery. More particularly, the present disclosure relates to an assembly and a method for providing power, data, illumination, and instrumentation into a body cavity.

Description of Related Art

[0002] Laparoscopy is a minimally invasive surgical procedure performed in the abdominal cavity. It has become the treatment of choice for several routinely performed interventions.

[0003] However, known laparoscopy technologies are limited in scope and complexity due in part to 1) mobility restrictions resulting from using rigid tools inserted through access ports, and 2) limited visual feedback. That is, long rigid laparoscopic tools inserted through small incisions in the abdomen wall limit the surgeon's range of motion and therefore the complexity of the surgical procedures being performed. Similarly, using a 2-D image from a typically rigid laparoscope inserted through a small incision limits the overall understanding of the surgical environment. Current technology requires a third port to accommodate a laparoscope (camera). Each new viewpoint requires an additional incision and thus, more pain and scarring for the patient and an added effort for the surgeon.

[0004] US 5,474,056 discloses a lateral suspension device comprising: a wire guide for supporting a wire; a horizontal arm for supporting said wire guide; a pivot means for supporting said horizontal arm, said pivot means slidably receiving said horizontal arm for movement relative thereto, said pivot means being rotatable about a horizontal axis; first lock means for releasably preventing sliding movement of said horizontal arm relative to said pivot means; first clamp means, fixedly attached to said pivot means, for clampingly holding an end of a wire; second clamp means, slidably attached to said pivot means for movement relative thereto, for clampingly holding an end of a wire; gear means for moving said second clamp means relative to said pivot means; second lock means, connected to said gear means, for locking said second clamp means in position relative to said pivot means; vertical support means for supporting said pivot means above a surgical table; and third clamp means for releasably connecting said vertical support means to said surgical table.

SUMMARY

[0005] The present invention provides a scaffold assembly for minimally invasive surgery, e.g. laparoscopic

surgery, including an instrument pod and a plurality of actuatable movers. The instrument pod may include one or more instruments operably coupled thereto. The instrument pod is configured for insertion through a tissue tract into a body cavity. In some embodiments, the instrument pod is configured to fit through a cannula of an access device. The instrument pod may be configured to collapse for insertion and then expand inside the body cavity. In some embodiments, the instrument pod is selectively movable between two movers. In other embodiments, the instrument pod is selectively movable between three movers.

[0006] The instrument pod (support) can have an elongated configuration having first and second opposing end portions and a line of a first of the movers is attached at the first end portion and a line of a second of the movers in attached at a second end portion. The plurality of movers in one embodiment can comprise three movers and the instrument pod can have a substantially triangular configuration, a line of each of the movers attached adjacent a vertex of the instrument pod.

[0007] Each mover includes an insertion member extending therefrom for insertion within tissue. Each mover has at least one line extending through the insertion portion and removably attachable to the instrument pod, and each mover includes a moving portion for selective retraction and/or extension of the at least one line and is configured to move the instrument pod between different positions within the body cavity relative to each mover upon actuation of the at least one of the movers.

[0008] Each mover can be actuatable manually, electrically or by other methods. Each manually actuatable mover can include a handle or a knob. In some embodiments, a power source is operably connected to one or more of the electrically actuatable movers. The one or more instruments supported by the instrument pod may include one or more of a camera, an illumination source, a grasper, a retractor, and a sensor. One or more movers may include a rotatable spool operably associated with the one or more lines. The one or more lines may include one or both of a fiber optic wire/cable or an electrical wire/cable which operably couple to one or more ports of the instrument pod. The one or more lines may be operably connected to a CPU controller. The one or more lines are preferably movable through the cannula of one of the respective movers. The one or more instruments are preferably selectively operable within the body cavity.

[0009] A method of movably suspending an instrument pod within a body cavity is disclosed which includes providing a scaffold assembly including an instrument pod and a plurality of movers. The instrument pod includes one or more instruments operably associated therewith. Each mover includes a cannula and at least one line extending therefrom. The at least one line is selectively extendable and retractable from each respective mover. The method includes inserting the instrument pod into a body cavity and attaching the at least one line of one or more of the movers to the instrument pod while the in-

strument pod and the at least one line is positioned within the body cavity. The method further includes selectively extending or retracting the one or more lines such that the instrument pod moves within the body cavity.

[0010] An exemplary method includes selectively moving the instrument pod within the body cavity between two movers. Another exemplary method includes selectively moving the instrument pod within the body cavity between three movers. The method further includes selectively operating the one or more instruments within the body cavity wherein the one or more instruments may include one or more of a camera, an illumination source, a grasper, a retractor, and a sensor or the like.

BRIEF DESCRIPTION OF THE DRAWINGS

[0011] The above and other aspects, features, and advantages of the present disclosure will become more apparent in light of the following detailed description when taken in conjunction with the accompanying drawings in which:

Fig. 1 is a perspective view of one embodiment of a laparoscopic scaffold assembly having a pair of movers and an instrument pod in accordance with the present disclosure;

Fig. 2 is an enlarged perspective view, with parts separated, of the instrument pod of Fig. 1;

Fig. 3 is a perspective view of the laparoscopic scaffold assembly of Fig. 1 with the movers shown mounted to a patient's body and the instrument pod shown inserted by a grasper through an access device into a body cavity;

Fig. 4 is an enlarged perspective view illustrating the instrument pod of Fig. 2 being attached to a line extending from one of the movers;

Fig. 5 is a perspective view of the laparoscopic scaffold assembly of Fig. 1 illustrating the instrument pod being movably suspended within the body cavity between each mover;

Fig. 6 is a partial perspective view of one embodiment of an instrument pod and a complimentary embodiment of a line of a mover in accordance with the present disclosure;

Fig. 7 is a partial perspective view of another embodiment of an instrument pod and a complimentary embodiment of a line of a mover in accordance with the present disclosure;

Fig. 8 is perspective view illustrating an accessory light being hung on a line within a body cavity in accordance with the principles of the present disclosure;

Fig. 9 is a perspective view of another embodiment of an instrument pod in accordance with the present disclosure;

Fig. 10 is a perspective view of another embodiment of a laparoscopic scaffold assembly including manual and electrical movers each having an anchor por-

tion and a moving portion in accordance with the present disclosure;

Fig. 11 is an enlarged, perspective view, with parts separated, of the area of detail of Figure 10 showing the anchor portion and the moving portion of one of the movers;

Fig. 12 is an enlarged, partial side elevational view of the anchor portion of Figure 10;

Fig. 13 is an enlarged, partial perspective view of one embodiment of an instrument pod and a complimentary mover line;

Fig. 14 is an enlarged, partial perspective view of another embodiment of an instrument pod and a complimentary mover line;

Fig. 15 is a perspective view of one embodiment of an instrument pod in accordance with the present disclosure.

Fig. 16 is a perspective view of another embodiment of an instrument pod positioned in a first condition in accordance with the present disclosure;

Fig. 17 is a perspective view, with parts separated, of the instrument pod of Fig. 16;

Fig. 18 is a perspective view of the instrument pod of Figs. 16 and 17 positioned in a second condition for insertion through a cannula;

Fig. 19 is a perspective view of the instrument pod of Figs. 16-18 shown positioned within a body cavity; and

Fig. 20 is a perspective view of the laparoscopic scaffold assembly of Fig. 1 shown as a kit in accordance with the present disclosure.

DETAILED DESCRIPTION

[0012] Various embodiments of the present disclosure will now be described in detail with reference to the drawings, wherein like reference numerals identify similar or identical elements. In the drawings and in the description that follows, the term "proximal," will refer to the end that is closer to the operator, while the term "distal" will refer to the end that is farther from the operator.

[0013] Turning now to Fig. 1, one embodiment of a laparoscopic scaffold assembly 100 includes an instrument pod 10 and two actuatable movers 20. The instrument pod 10 includes a body portion 10a having a pair of catches 12, 14 extending from the distal ends thereof. The instrument pod 10 can have catches of any suitable shape such as a knob "K" illustrated in Fig. 6 or a curvilinear hook "H" illustrated in Fig. 7. As best shown in Fig. 2, the instrument pod 10 includes one or more receptacles "R" that are configured to receive one or more instruments "I" (see Fig. 16) therein. Examples of such instruments "I" include, but are not limited to, clip appliers, graspers, dissectors, retractors, staplers, laser probes, illumination sources, photographic devices, endoscopes and laparoscopes, tubes, and the like. The instrument pod 10 of Fig. 2 includes a plurality of instruments "I" affixed to the one or more receptacles "R", which are

illumination sources (e.g., light bulbs). However, other instruments "I" may be mounted therein such as those discussed above and shown in Fig. 16. Some of these instruments (e.g. illumination sources such as light bulbs) may be powered by one or more batteries 18 housed within the instrument pod 10 by a back plate 10b that is held in position by one or more screws 10s. In addition, some of these instruments (e.g., photographic devices) operate on input/output type signal transmission. Accordingly, the instrument pod 10 may be configured to receive and send analog or digital signals through wired or wireless transmissions which will be described in greater detail hereinbelow.

[0014] Referring again to Fig. 1, each mover 20 includes a moving portion 30 and an anchor portion 40. The moving portion 30 includes a base 32, a crank 34, a spool 36 and a line 38 in the form of a suture. The crank 34 and spool 36 are rotatably mounted to the base 32. The line 38 is operably coupled to the spool 36 such that upon rotation of the crank 34, the line 38 extends and retracts with respect to the spool 36. The line 38 has an attachment feature 38a (e.g. a loop) disposed at the distal end thereof. The attachment feature can be any suitable shape such as an integrally formed ring "N" shown in Fig. 6 or an adjustable loop "AL" shown in Fig. 7. The anchor portion 40 includes a platform 42 for supporting the moving portion 30 and an insertion member in the form of a tubular member or cannula 44 extending therefrom for insertion within tissue through a tissue tract to access a body cavity "BC" (Fig. 3). The line 38 is adapted for movement through the cannula 44 upon the selective retraction and/or extension of the line 38 of each mover 20. The laparoscopic scaffold assembly may be assembled in the form of a kit 500 as illustrated in Fig. 20.

[0015] In use, shown best in Figs. 3-5, each mover 20 is mounted to a patient's body "B" such that the cannula 44 extends into the body cavity "BC." The line 38 and attachment feature 38a of each mover 20 are adapted for movement through the cannula 44 upon rotation of the crank 34 and the extension and retraction of the line 38. An access device "D" is then mounted within the body cavity "BC." With reference to Fig. 3, the instrument pod 10 is then positioned in a vertically elongate condition so that it may be inserted through a longitudinal passage "P" of an access device "D" via a grasper "G" or other appropriate surgical instrumentation such as first instrument "I1" or second instrument "I2."

[0016] Once the instrument pod 10 is inserted through the longitudinal passage "P" and into the body cavity "BC", the attachment feature 38a of each mover 20 is then removably attached to the catches 12, 14 of the instrument pod 10 for movably suspending the instrument pod 10 in a substantially horizontally elongate condition within the body cavity "BC." As shown in Fig. 5, the instrument pod 10 can then be selectively movable between different positions (i.e. closer or further from one of the movers) relative to the movers 20 in response to the rotation the crank 34 of each mover 20 and the ex-

tension and retraction of each line 38. In this manner, the one or more suspended instruments "I" can be used in combination with the grasper "G" or other surgical instrumentation within the body cavity "BC." In addition, an accessory light or laparoscope "L" or other surgical instrumentation inserted into the body cavity "BC" may be mounted on or placed on the line 38 within the body cavity "BC" for providing additional or enhanced surgical benefits, as illustrated in Fig. 8. The illumination or instrumentation attached to instrument pod 10 can be moved along the line 38 to horizontally adjust their position by movement of the instrument pod 110 by the respective crank 34.

[0017] With reference to Figs. 9 and 10, an alternate embodiment of a laparoscopic scaffold assembly 200 is illustrated. The assembly 200 includes an instrument pod 210 and a plurality of movers 220 such as movers 220a, 220b, 220c. The instrument pod 210 includes a plurality of ports 212 (FIG. 9) disposed thereabout, e.g. at each of the vertices, for operably coupling to one or more lines 249 of the plurality of movers 220. The instrument pod 210 also includes one or more receptacles "R" on a lower surface (facing into the body cavity) adapted for receiving one or more instruments "I" (e.g., an illumination source, camera, etc, such as received by instrument pod 400 of Fig. 16) therein. As shown in Fig. 9, the one or more receptacles "R" each has an instrument "I" such as illumination source (e.g. light bulb) mounted therein. However, other instruments "I" may be mounted therein such as those discussed above and shown in Fig. 16 discussed below. In some embodiments, one or more of the plurality of ports 212 may be configured to send or receive wired signals through fiber optic wires or electrical wires operably associated with the one or more lines 249 of the movers 220. The fiber optic wires/cables or electrical wires/cables may be operably connected to the one or more ports 212 via a communication port such as a universal serial bus (USB), serial ports, parallel ports, or other suitable electrical connections operably coupled thereto. In some embodiments, these signals may be manually or automatically controlled by a central processing unit. In some embodiments, the instrument pod 210 may be configured for wireless communication with a power source and/or a controller such as a CPU or processor. The laparoscopic scaffold assembly 200 can include wireless technology for transmitting a signal. Thus, the movers 220 can be moved manually or powered remotely.

[0018] As illustrated in Fig. 9, the instrument pod 210 may be substantially triangularly shaped. In this manner, the instrument pod 210 may be coupled to three movers via lines extending therefrom which enables greater mobility thereof. This permits movement along the x-axis and the y-axis (see Fig. 10). That is, the pod 210 can be moved along the axis of the lines somewhat horizontal to the body cavity. The provision of three lines increases the stability of the platform. In some embodiments, the instrument pod may be formed of any suitable circular or

noncircular shape (e.g. polygonal such as square, pentagonal, etc.), each of which may be operably connectable to any number of movers associated therewith to provide enhanced mobility.

[0019] Referring now to Figs. 10-12, the plurality of movers 220 each include an anchoring portion 230 and a moving portion 240 that may be manually operable or electrically operable or fluid powered. As best shown in Figs. 11-12, the anchoring portion 230 includes a body portion 232 having a T-shaped slot 232a, a clamp 234, and a fastener 236 so that the anchoring portion 230 may be affixed to a separate support "S" (e.g. a table or a ledge). The fastener 236, which operably couples the clamp 234 and the body portion 232, approximates and unapproximates the clamp 234 to the separate support "S" upon rotation of the fastener 236 so that the moving portion 240 and the anchoring portion 230 can be removably affixed to the separate support "S."

[0020] As shown in Fig. 11, the moving portion 240 includes an anchor 242 for engaging the slot 232a so that the moving portion 240 may be removably affixed to the anchoring portion 230 for interchanging or replacing moving portions 240 of movers 220a, 220b, 220c with respect to each anchoring portion 230. The moving portion 240 of each mover 220a, 220b, 220c includes a crank 244a, a spool 246, a base 248, and the one or more lines 249. The movers 220a, 220b, and 220c can be manually operable, electrically operable or both manually and electrically. They can also be fluid powered. By way of example, in the embodiment illustrated in Fig. 10, mover 220a has a crank 244a that is electrically operable, while mover 220b has a crank 244b that is electrically and manually operable, and mover 220c has a crank 244c that is only manually operable.

[0021] In some embodiments, electrically operable movers 220a, 220b may be operably coupled to a power source and a controller as illustrated in Fig. 10 or may be battery operated and actuable via one or more switches (not shown) to cause the spool 246 thereof to rotate, the one or more lines 249 to extend and retract, and the instrument pod 210 to move between the movers 220a, 220b, 220c. The manually operable movers 220b, 220c may include a knob 221 or a handle 223 for rotating the spool 246 thereof. Accordingly, each crank 244 and spool 246 is rotatably mounted to the base 248. The line 249 is operably coupled to the spool 246 such that upon rotation of the crank 244, the line 249 extends and retracts with respect to the spool 246. In some embodiments, the one or more lines 249 may include one or both of a fiber optic wire/cable or an electrical wire/cable, each of which may be housed within the one or more lines 249. In addition, the one or more lines 249 may be operably connected to a central processing unit "CPU" controller for selectively operating the laparoscopic scaffold assembly 200. Instead of a spool as described above, pinch rollers, timing belts, sprockets, and/or linear actuators such as air cylinders or solenoids, or other mechanisms, can be used to extend and retract the lines.

[0022] With reference to Figs. 13-14, each line 249 may include an attachment feature such as the cylindrical shaped attachment feature 249a or the half cylindrical attachment feature 249b illustrated therein. Each attachment feature is configured to removably engage a port 212 (Fig.9) in a side wall of pod 210 such as ports 212a, 212b of the instrument pod 210 such that the instrument pod 210 and each mover 220 are operably connected. As described above, ports 212a, 212b may include one or more universal serial buses (USB), serial ports, or parallel ports to send and receive signals to and from a power source and/or a controller.

[0023] Another embodiment of an instrument pod 310 is shown in Fig. 15. In this embodiment, the instrument pod 310 includes a body portion 310a having a pair of catches 312, 314 extending from the distal ends thereof and an instrument slot 316 configured to slidably receive a plurality of functional accessories. For example, instrument slot 316 may be configured to receive first accessory assembly 320 which includes a sensor 322. Similarly, instrument slot 316 may be configured to receive second accessory assembly 330 which includes a camera 332 and a surgical instrument engaging clip 334 for selectively affixing a plurality of surgical instruments thereto. However, any suitable instrument may be affixed thereto including an illumination source, a grasper, a retractor, a sensor, etc.

[0024] Referring now to Figs. 16-19, an alternate embodiment of an instrument pod 400 includes a body portion 410 substantially triangular in configuration in the expanded condition. Body portion 410 has a plurality of sections 410a, 410b, 410c pivotably mounted thereto via a hinge 414 such that the instrument pod 400 is positionable between a collapsed condition (Fig. 18) for insertion through an access port or body opening into the body cavity and an expanded condition (Fig. 16). Each section 410a, 410b, 410c includes one or more ports 412 for operably coupling to one or more movers 220a, 220b, 220c in the mover similar to pod 210 discussed above. Each section 410a, 410b, 410c includes one or more instruments "I" (e.g., a camera, an illumination source, a grasper, a retractor, and a sensor) for performing a surgical procedure within a body cavity "BC."

[0025] It should be appreciated that a various number of moves can be utilized to provide the platform of the present disclosure. For example, instead of two movers, one mover and a spring can be provided. Additionally, instead of three movers, two movers and one or more springs could be provided. Also the pods can be of different shapes than shown.

[0026] While several embodiments of the disclosure have been shown in the drawings, it is not intended that the disclosure be limited thereto. Therefore, the above description should not be construed as limiting, but merely as exemplifications of particular embodiments. Those skilled in the art will envision other modifications within the scope of the claims appended hereto.

Claims

1. A scaffold assembly (100; 200) for minimally invasive surgery, comprising:

an instrument pod (10; 210; 400) configured for insertion through a tissue tract into a body cavity; and
 a plurality of actuatable movers (20; 220), each mover (20; 220) including an insertion member (44) extending therefrom for insertion within tissue, each mover (20; 220) having at least one line (38; 249) extending through the insertion member (44) and removably attachable to the instrument pod (10; 210; 400), and each mover (20; 220) including a moving portion (30; 240) for selective retraction and/or extension of the at least one line (38; 249) and configured to move the instrument pod (10; 210; 400) between different positions relative to each mover (20; 220) upon the actuation of at least one of the movers (20; 220) to move the instrument pod (10; 210; 400) within the body cavity.

2. The scaffold assembly (100; 200) of claim 1, further comprising at least one instrument ("I") operably coupled to the instrument pod (10; 210; 400) wherein the at least one instrument ("I") is suspended within the body cavity.

3. The scaffold assembly (100; 200) of claim 2, wherein the at least one instrument ("I") includes at least one of a camera, an illumination source, a grasper, a retractor, and a sensor.

4. The scaffold assembly (100; 200) of claim 2 or claim 3, wherein the at least one instrument ("I") is selectively operable within the body cavity.

5. The scaffold assembly (200) of any preceding claim, wherein the instrument pod (400) is movable between a first collapsed configuration for insertion into the body cavity and a second expanded configuration.

6. The scaffold assembly (100; 200) of any preceding claim, wherein each mover (20; 220) is manually actuatable.

7. The scaffold assembly (200) of any one of claims 1 to 5, wherein each mover (220) is electrically actuatable.

8. The scaffold assembly (100) of any preceding claim, wherein the instrument pod (10) has an elongated configuration having first and second opposing end portions and a line (38) of a first of the movers (20) is attached at the first end portion and a line (38) of

a second of the movers (20) is attached at a second end portion.

9. The scaffold assembly (200) of any one of claims 1 to 7, wherein the plurality of movers (220) comprises three movers (220) and the instrument pod (210; 400) has a substantially triangular configuration, a line (249) of each of the movers (220) attached adjacent a vertex of the instrument pod (210; 400).

10. The scaffold assembly (100; 200) of any preceding claim, wherein at least one mover (20; 220) includes a rotatable member (36; 246) operably associated with the at least one line (38; 249).

11. The scaffold assembly (100; 200) of any preceding claim, wherein the at least one mover (20; 220) includes a rotatable actuator (34; 221) operably associated with the at least one line (38; 249).

12. The scaffold assembly (100; 200) of any of claims 1 to 10, wherein at least one mover (20; 220) includes a linear actuator operably associated with the at least one line (38; 249).

13. The scaffold assembly (100; 200) of any preceding claim, wherein the at least one line (38; 249) includes at least one of a fiber optic wire/cable or an electrical wire/cable which operably couples to at least one port of the instrument pod (10; 210; 400), preferably wherein the at least one line (38; 249) is operably connected to a CPU controller.

14. The scaffold assembly (100; 200) of any preceding claim, wherein the at least one line (38; 249) is adapted for movement through a cannula (44) of one of the respective movers (20; 220).

15. The scaffold assembly (100; 200) of any preceding claim, wherein the instrument pod (10) is selectively movable between two movers (20), or wherein the instrument pod (210; 400) is selectively movable between three movers (220).

Patentansprüche

1. Gerüstanordnung (100; 200) für die minimalinvasive Chirurgie, welche Folgendes umfasst:

einen Instrumentenbehälter (10; 210; 400), der zur Einführung durch einen Gewebetrakt in eine Körperhöhle ausgebildet ist, und mehrere betätigbare Bewegungseinrichtungen (20; 220), wobei jede Bewegungseinrichtung (20; 220) ein Einführungselement (44) aufweist, das sich zur Einführung in Gewebe von dieser erstreckt, wobei jede Bewegungseinrichtung

- (20; 220) mindestens eine Leitung (38; 249) aufweist, die sich durch das Einführungselement (44) erstreckt und abnehmbar an dem Instrumentenbehälter (10; 210; 400) angebracht ist, und wobei jede Bewegungseinrichtung (20; 220) einen Bewegungsteil (30; 240) zum selektiven Zurückziehen und/oder Ausfahren der mindestens einen Leitung (38; 249) aufweist, und der bei Betätigung von mindestens einer der Bewegungseinrichtungen (20; 220) zum Bewegen des Instrumentenbehälters (10; 210; 400) zwischen verschiedenen Positionen relativ zu jeder Bewegungseinrichtung (20; 220) ausgebildet ist, um den Instrumentenbehälter (10; 210; 400) innerhalb der Körperhöhle zu bewegen.
2. Gerüstanordnung (100; 200) nach Anspruch 1, welche ferner mindestens ein Instrument ("I") umfasst, das betriebsfähig mit dem Instrumentenbehälter (10; 210; 400) gekoppelt ist, wobei das mindestens eine Instrument ("I") innerhalb der Körperhöhle aufgehängt ist.
 3. Gerüstanordnung (100; 200) nach Anspruch 2, wobei das mindestens eine Instrument ("I") eine Kamera, eine Beleuchtungsquelle, ein Greifelement, ein Zurückziehelement und/oder einen Sensor aufweist.
 4. Gerüstanordnung (100; 200) nach Anspruch 2 oder Anspruch 3, wobei das mindestens eine Instrument ("I") selektiv innerhalb der Körperhöhle betriebsfähig ist.
 5. Gerüstanordnung (200) nach einem vorhergehenden Anspruch, wobei der Instrumentenbehälter (400) zwischen einer ersten zusammengefalteten Konfiguration zur Einführung in die Körperhöhle und einer zweiten ausgefalteten Konfiguration bewegbar ist.
 6. Gerüstanordnung (100; 200) nach einem vorhergehenden Anspruch, wobei jede Bewegungseinrichtung (20; 220) manuell betätigbar ist.
 7. Gerüstanordnung (200) nach einem der Ansprüche 1 bis 5, wobei jede Bewegungseinrichtung (220) elektrisch betätigbar ist.
 8. Gerüstanordnung (100) nach einem vorhergehenden Anspruch, wobei der Instrumentenbehälter (10) eine längliche Konfiguration mit einem ersten und einem zweiten entgegengesetzten Endteil aufweist, und wobei eine Leitung (38) einer ersten der Bewegungseinrichtungen (20) an dem ersten Endteil angebracht ist, und eine Leitung (38) einer zweiten der Bewegungseinrichtungen (20) an einem zweiten Endteil angebracht ist.
 9. Gerüstanordnung (200) nach einem der Ansprüche 1 bis 7, wobei die mehreren Bewegungseinrichtungen (220) drei Bewegungseinrichtungen (220) umfassen, und wobei der Instrumentenbehälter (210; 400) eine im Wesentlichen dreieckige Konfiguration aufweist, wobei eine Leitung (249) von jeder der Bewegungseinrichtungen (220) benachbart zu einer Spitze des Instrumentenbehälters (210; 400) angebracht ist.
 10. Gerüstanordnung (100; 200) nach einem vorhergehenden Anspruch, wobei mindestens eine Bewegungseinrichtung (20; 220) ein drehbares Element (36; 246) aufweist, das betriebsfähig mindestens einer Leitung (38; 249) zugeordnet ist.
 11. Gerüstanordnung (100; 200) nach einem vorhergehenden Anspruch, wobei die mindestens eine Bewegungseinrichtung (20; 220) einen drehbaren Aktuator (34; 221) aufweist, der betriebsfähig der mindestens einen Leitung (38; 249) zugeordnet ist.
 12. Gerüstanordnung (100; 200) nach einem der Ansprüche 1 bis 10, wobei mindestens eine Bewegungseinrichtung (20; 220) einen linearen Aktuator aufweist, der betriebsfähig der mindestens einen Leitung (38; 249) zugeordnet ist.
 13. Gerüstanordnung (100; 200) nach einem vorhergehenden Anspruch, wobei die mindestens eine Leitung (38; 249) einen faseroptischen Draht /Kabel oder einen elektrischen Draht /Kabel aufweist, welcher betriebsfähig an mindestens einen Anschluss des Instrumentenbehälters (10; 210; 400) angekoppelt ist, wobei bevorzugt die mindestens eine Leitung (38; 249) betriebsfähig mit einer Prozessorsteuerung verbunden ist.
 14. Gerüstanordnung (100; 200) nach einem vorhergehenden Anspruch, wobei die mindestens eine Leitung (38; 249) zur Bewegung durch eine Kanüle (44) einer der jeweiligen Bewegungseinrichtungen (20; 220) ausgebildet ist.
 15. Gerüstanordnung (100; 200) nach einem vorhergehenden Anspruch, wobei der Instrumentenbehälter (10) selektiv zwischen zwei Bewegungseinrichtungen (20) bewegbar ist, oder wobei der Instrumentenbehälter (210; 400) selektiv zwischen drei Bewegungseinrichtungen (220) bewegbar ist.

Revendications

1. Ensemble de support (100 ; 200) pour une chirurgie invasive au minimum, comprenant:
un bloc instrumental (10 ; 210 ; 400) configuré

- pour une insertion à travers une voie tissulaire dans une cavité corporelle ; et une pluralité de mécanismes actionnables (20 ; 220), chaque mécanisme (20 ; 220) comprenant un élément d'insertion (44) qui s'en étend pour insertion dans un tissu, chaque mécanisme (20 ; 220) ayant au moins une ligne (38 ; 249) s'étendant à travers l'élément d'insertion (44) et fixable de manière amovible au bloc instrumental (10 ; 210 ; 400), chaque mécanisme (20 ; 220) comprenant une partie mobile (30 ; 240) pour une rétraction et/ou un déploiement sélectif de la au moins une ligne (38 ; 249) et étant configuré pour déplacer le bloc instrumental (10 ; 210 ; 400) entre différentes positions par rapport à chaque mécanisme (20 ; 220) lors de l'actionnement d'au moins l'un des mécanismes (20 ; 220) pour déplacer le bloc instrumental (10 ; 210 ; 400) dans la cavité corporelle.
2. Ensemble de support (100 ; 200) selon la revendication 1, comprenant en outre au moins un instrument (« I ») couplé en service au bloc instrumental (10 ; 210 ; 400), dans lequel le au moins un instrument (« I ») est suspendu dans la cavité corporelle.
 3. Ensemble de support (100 ; 200) selon la revendication 2, dans lequel le au moins un instrument (« I ») comprend au moins l'un ou l'une d'une caméra, d'une source d'éclairage, d'un élément de préhension, d'un écarteur et d'un capteur.
 4. Ensemble de support (100 ; 200) selon la revendication 2 ou la revendication 3, dans lequel le au moins un instrument (« I ») peut être actionné sélectivement dans la cavité corporelle.
 5. Ensemble de support (200) selon l'une quelconque des revendications précédentes, dans lequel le bloc instrumental (400) est mobile entre une première configuration repliée pour insertion dans la cavité corporelle et une seconde configuration déployée.
 6. Ensemble de support (100 ; 200) selon l'une quelconque des revendications précédentes, dans lequel chaque mécanisme (20 ; 220) est actionnable manuellement.
 7. Ensemble de support (200) selon l'une quelconque des revendications 1 à 5, dans lequel chaque mécanisme (220) est actionnable électriquement.
 8. Ensemble de support (100) selon l'une quelconque des revendications précédentes, dans lequel le bloc instrumental (10) a une configuration allongée ayant une première et une seconde partie d'extrémité opposées et une ligne (38) d'un premier des mécanismes (20) est fixée à la première partie d'extrémité et une ligne (38) d'un deuxième des mécanismes (20) est fixée à une seconde partie d'extrémité.
 9. Ensemble de support (200) selon l'une quelconque des revendications 1 à 7, dans lequel la pluralité de mécanismes (220) comprend trois mécanismes (220) et le bloc instrumental (210 ; 400) a une configuration sensiblement triangulaire, une ligne (249) de chacun des mécanismes (220) étant fixée de manière adjacente à un sommet du bloc instrumental (210 ; 400).
 10. Ensemble de support (100 ; 200) selon l'une quelconque des revendications précédentes, dans lequel au moins un mécanisme (20 ; 220) comprend un élément rotatif (35 ; 246) associé en service à la au moins une ligne (38 ; 249).
 11. Ensemble de support (100 ; 200) selon l'une quelconque des revendications précédentes, dans lequel le au moins un mécanisme (20 ; 220) comprend un actionneur rotatif (34 ; 221) associé en service à la au moins une ligne (38 ; 249).
 12. Ensemble de support (100 ; 200) selon l'une quelconque des revendications 1 à 10, dans lequel au moins un mécanisme (20 ; 220) comprend un actionneur linéaire associé en service à la au moins une ligne (38 ; 249).
 13. Ensemble de support (100 ; 200) selon l'une quelconque des revendications précédentes, dans lequel la au moins une ligne (38 ; 249) comprend au moins l'un parmi un fil/câble de fibre optique ou un fil/câble électrique qui se couple en service à au moins un orifice du bloc instrumental (10 ; 210 ; 400), de préférence dans lequel la au moins une ligne (38 ; 249) est connectée en service à un dispositif de commande CPU.
 14. Ensemble de support (100 ; 200) selon l'une quelconque des revendications précédentes, dans lequel la au moins une ligne (38 ; 249) est adaptée à un déplacement à travers une canule (44) de l'un des mécanismes respectifs (20 ; 220).
 15. Ensemble de support (100 ; 200) selon l'une quelconque des revendications précédentes, dans lequel le bloc instrumental (10) est mobile sélectivement entre deux mécanismes (20) ou dans lequel le bloc instrumental (210 ; 400) est mobile sélectivement entre trois mécanismes (220).

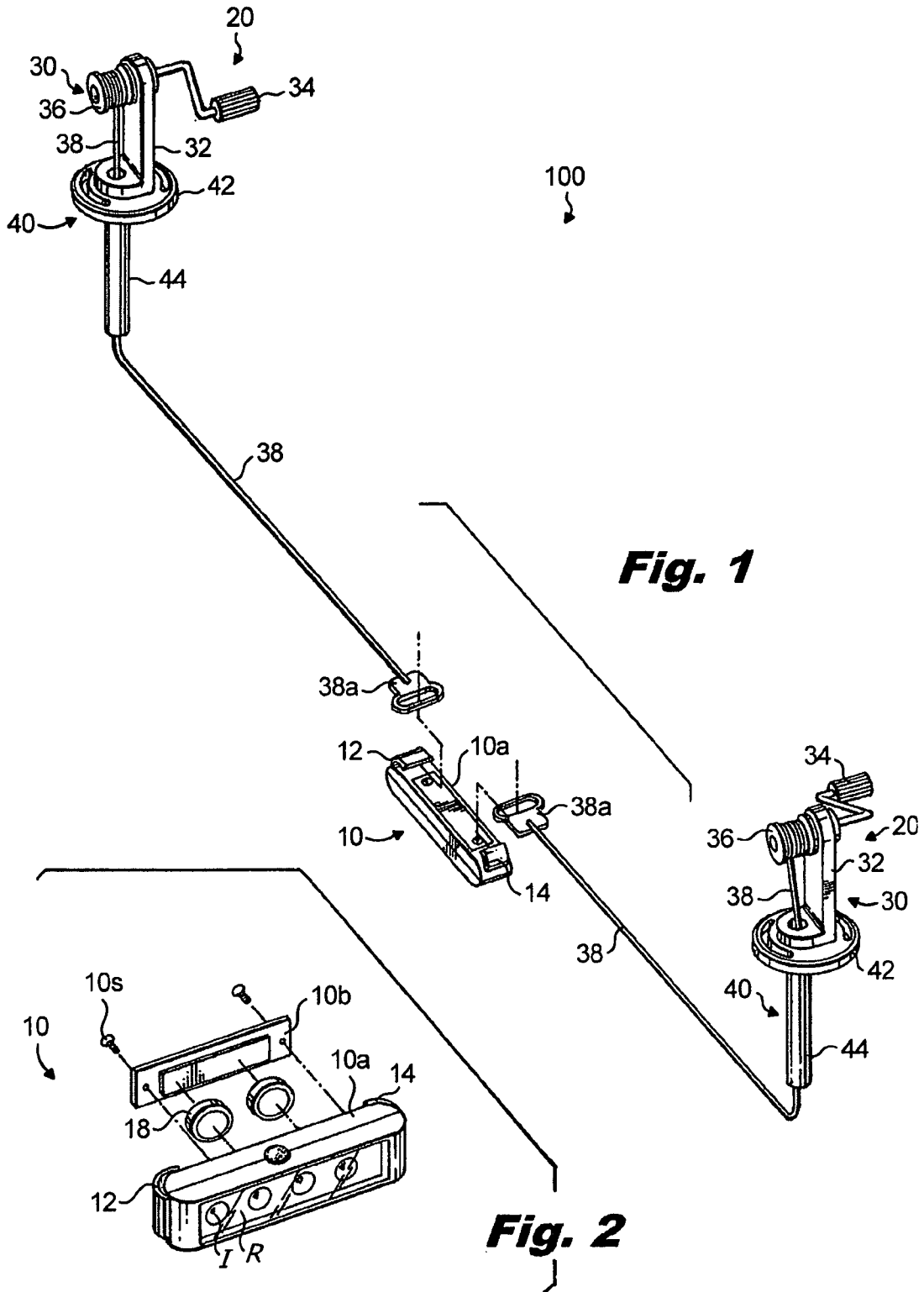

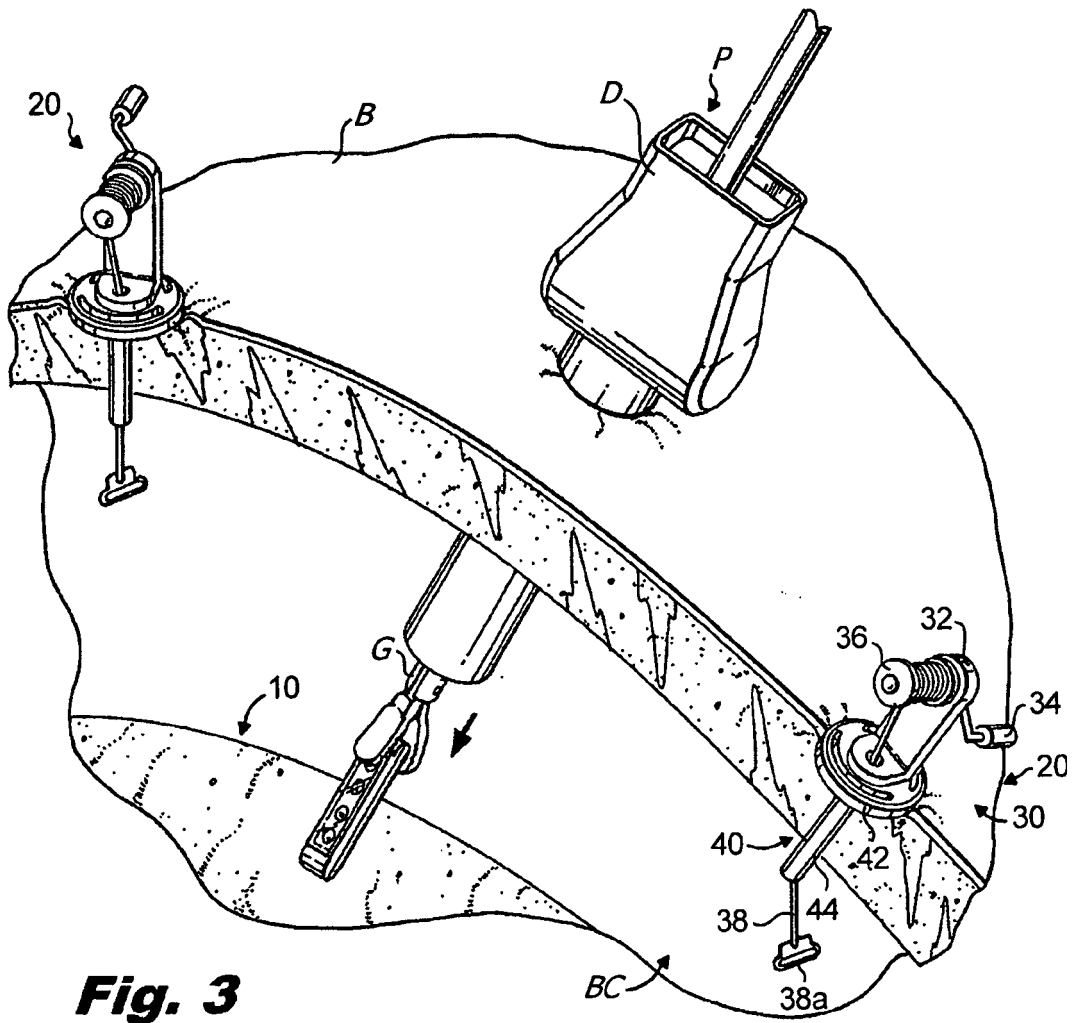

Fig. 3

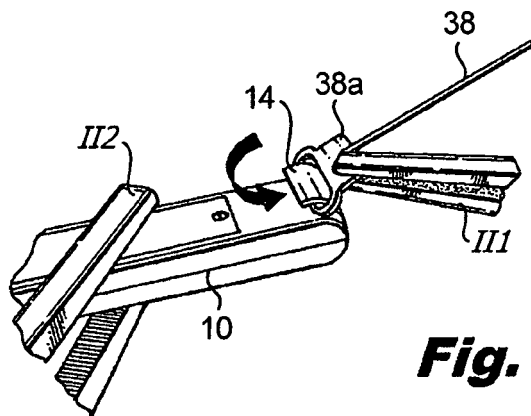

Fig. 4

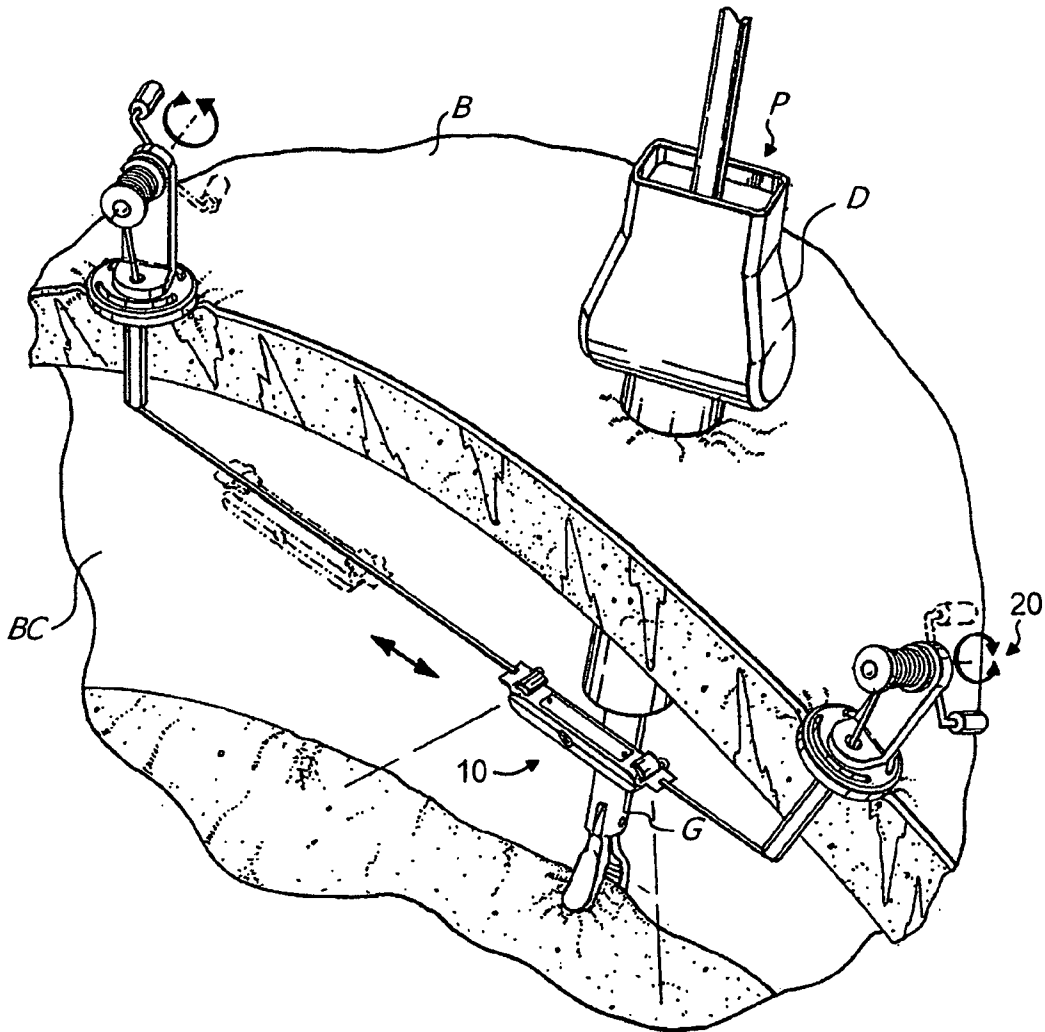

Fig. 5

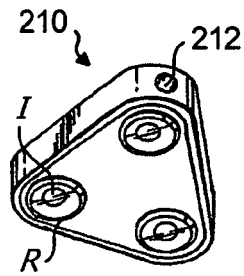

Fig. 9

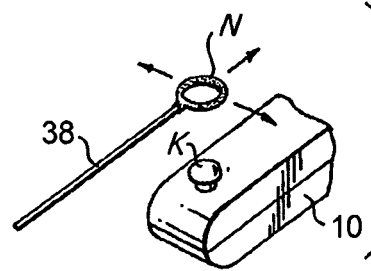

Fig. 6

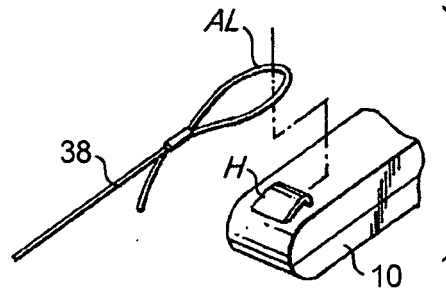

Fig. 7

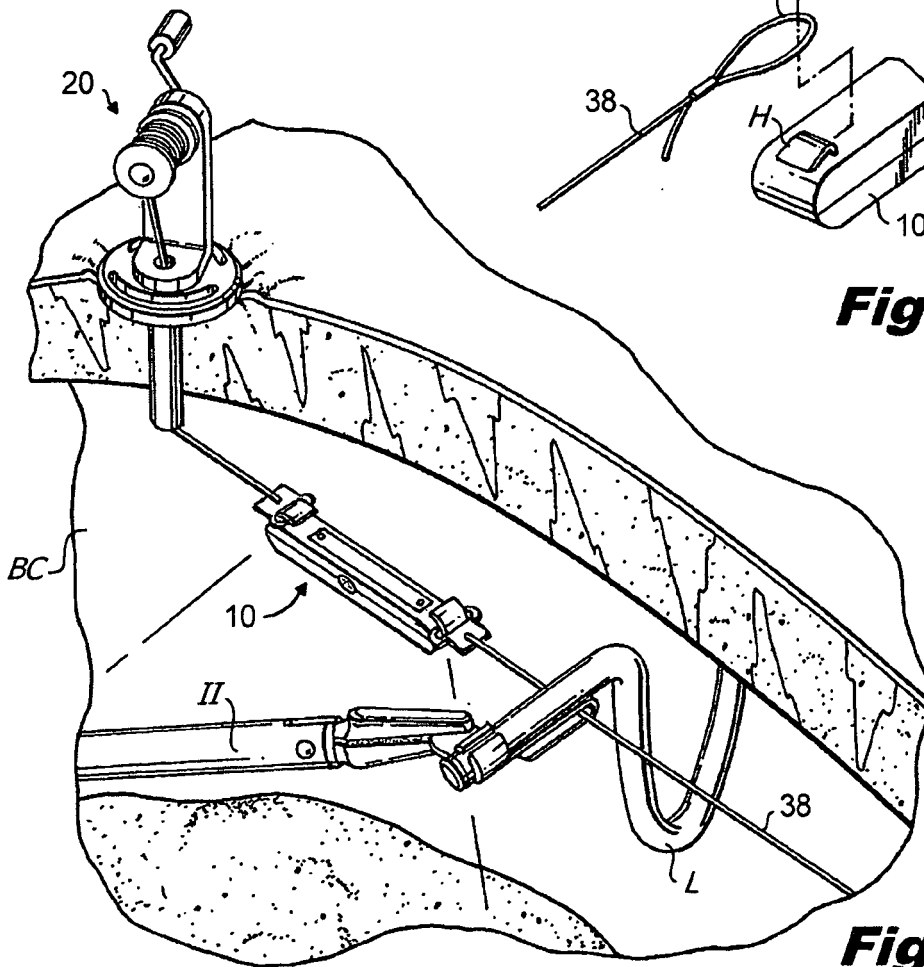
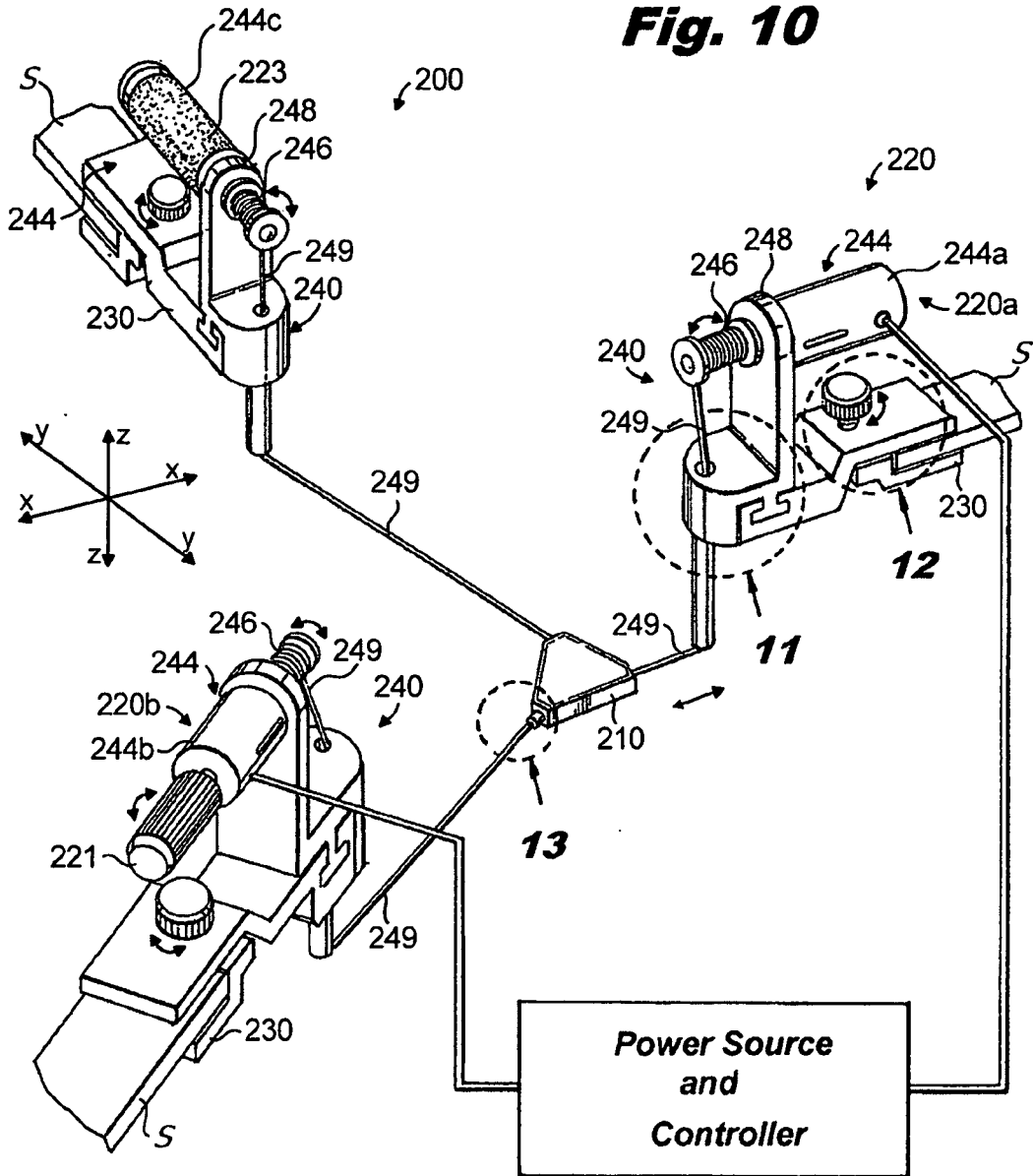

Fig. 8

Fig. 10



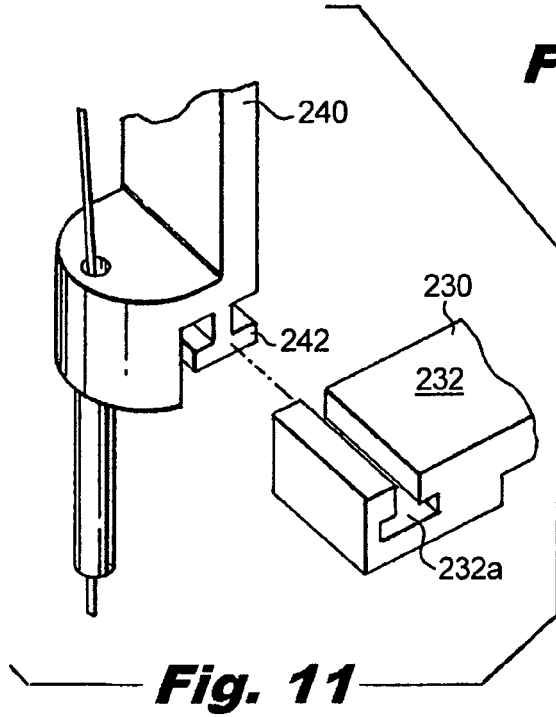

Fig. 11

Fig. 13

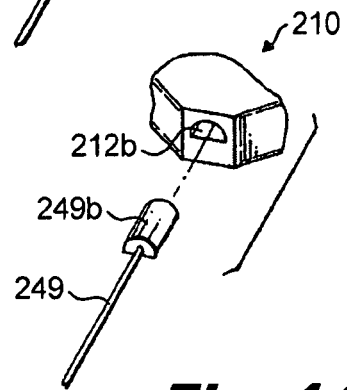
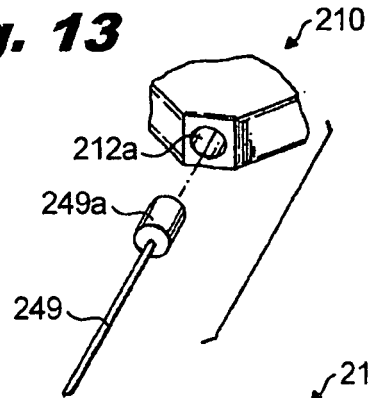

Fig. 14

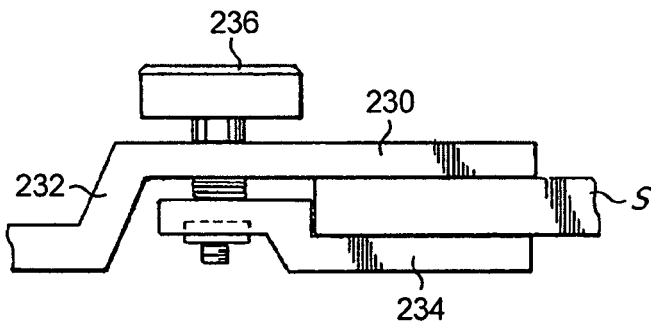

Fig. 12

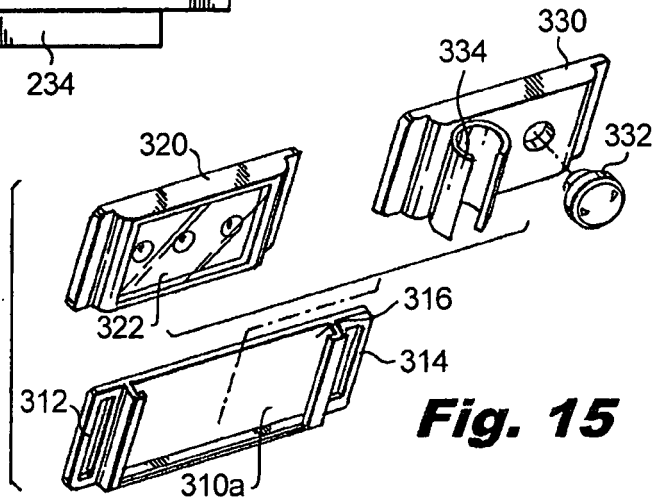

Fig. 15

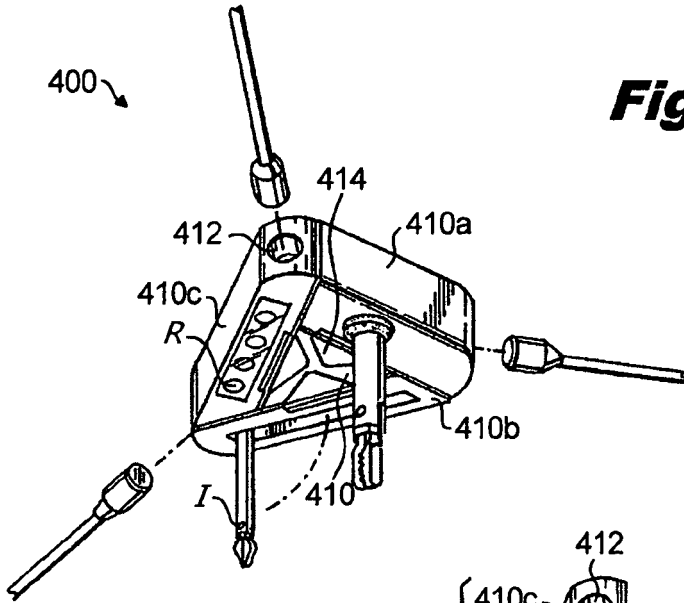

Fig. 16

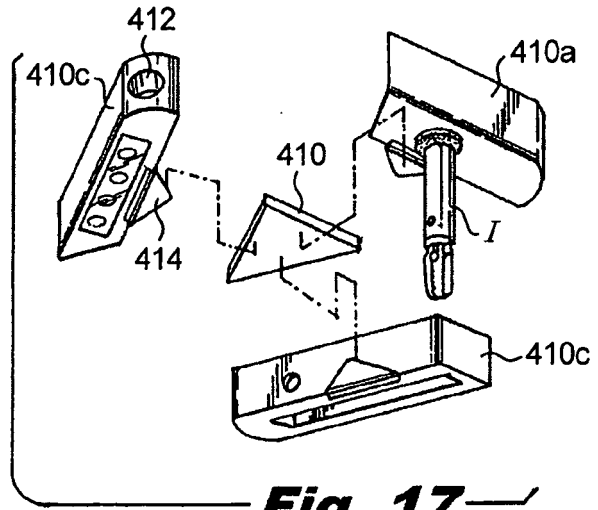

Fig. 17

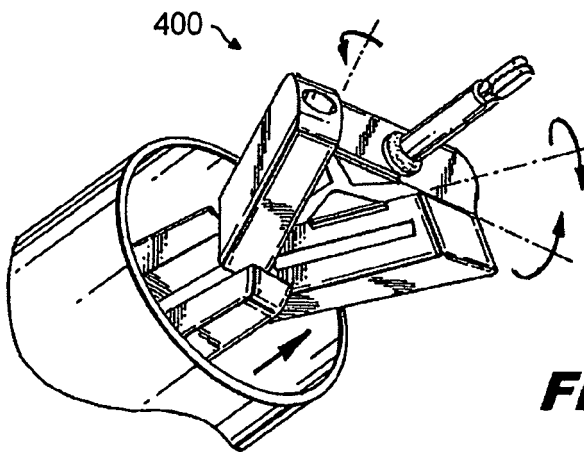
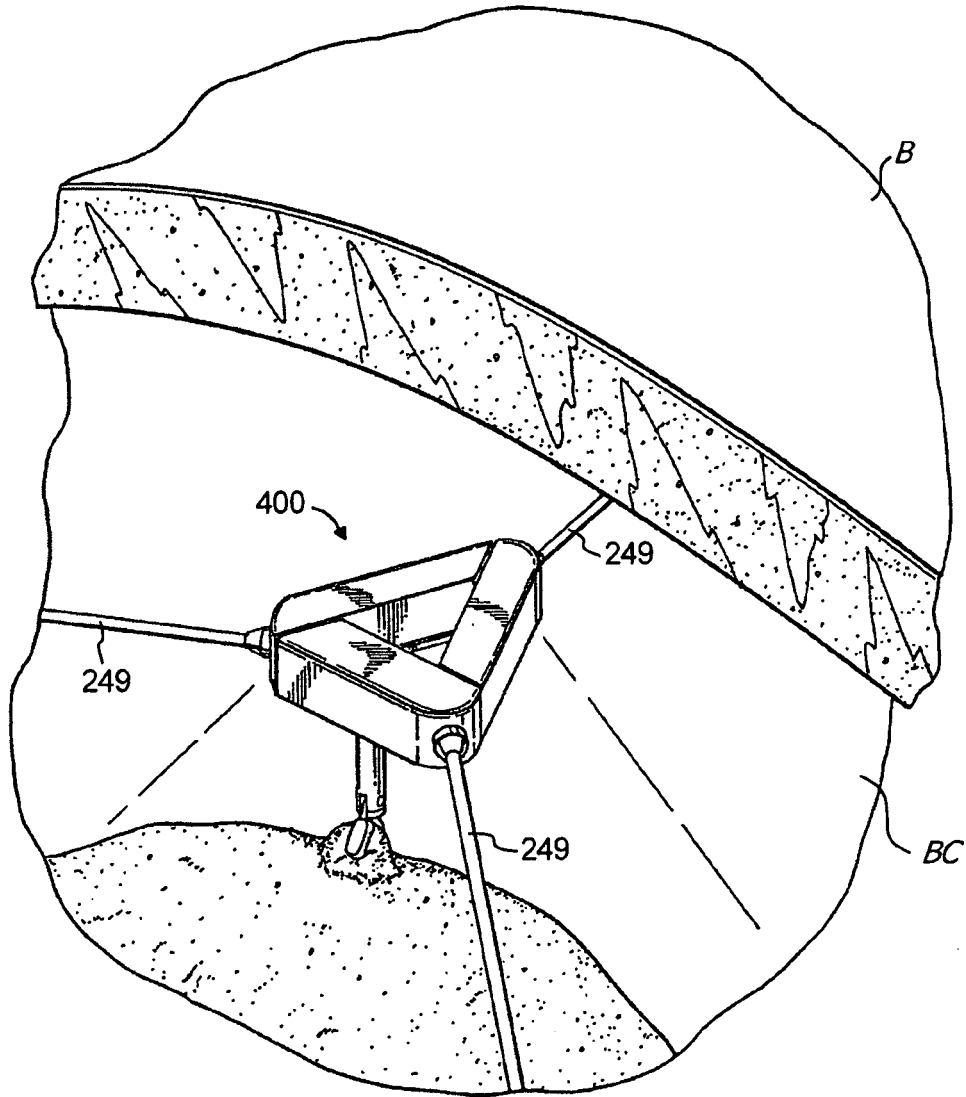

Fig. 18

Fig. 19



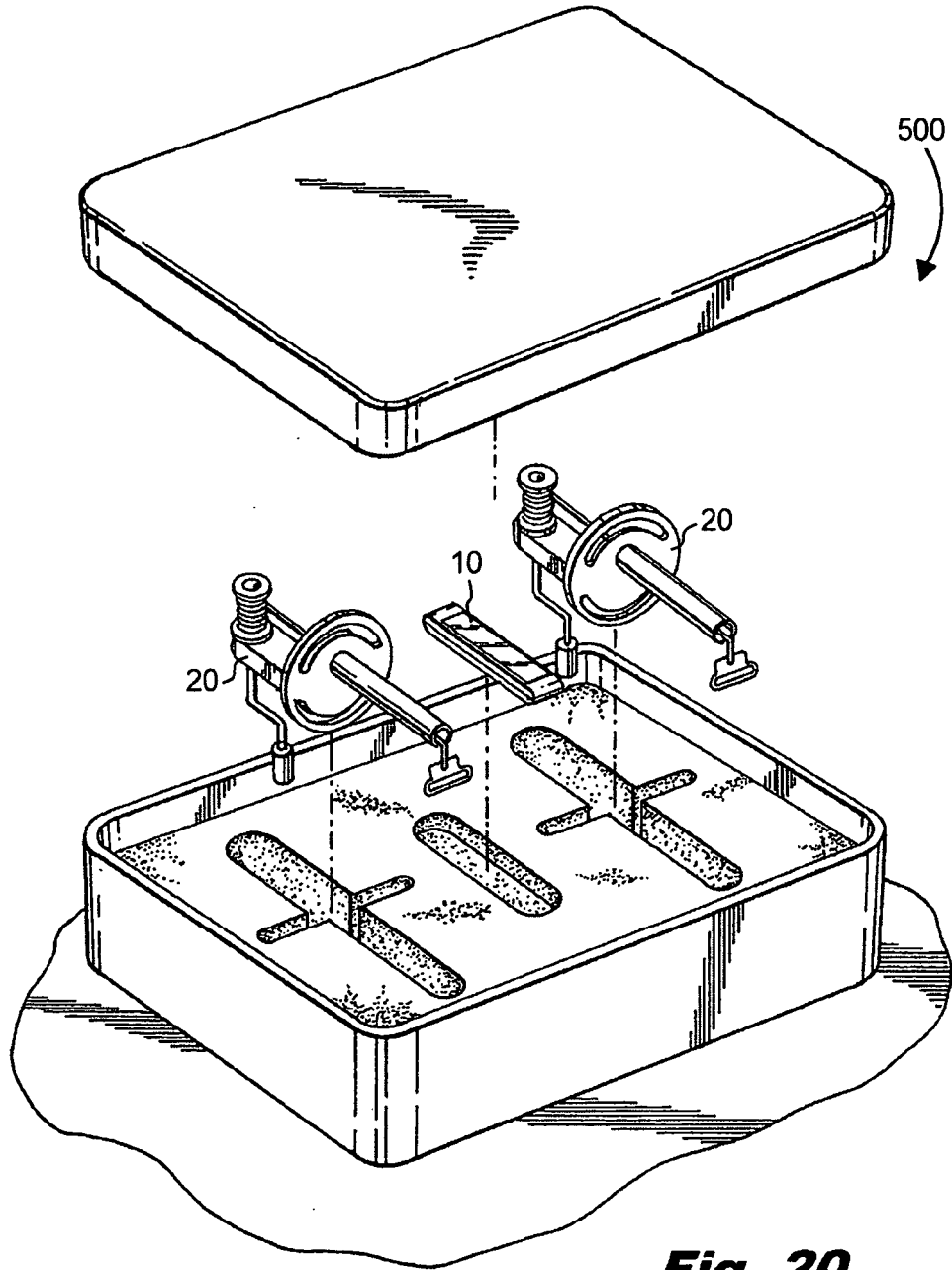

Fig. 20

REFERENCES CITED IN THE DESCRIPTION

This list of references cited by the applicant is for the reader's convenience only. It does not form part of the European patent document. Even though great care has been taken in compiling the references, errors or omissions cannot be excluded and the EPO disclaims all liability in this regard.

Patent documents cited in the description

- US 5474056 A [0004]

专利名称(译)	腹腔镜支架组装		
公开(公告)号	EP2329789B1	公开(公告)日	2017-02-08
申请号	EP2010252055	申请日	2010-12-03
[标]申请(专利权)人(译)	柯惠有限合伙公司		
申请(专利权)人(译)	泰科医疗集团LP		
当前申请(专利权)人(译)	COVIDIEN LP		
[标]发明人	HEINRICH RUSSELL S VIOLA FRANK STANLEY ERIC ALEXANDER		
发明人	HEINRICH, RUSSELL S. VIOLA, FRANK STANLEY, ERIC ALEXANDER		
IPC分类号	A61B17/00 A61B17/02 A61B34/00 A61B34/30 A61B90/30 A61B90/00 A61B1/00		
CPC分类号	A61B1/00105 A61B1/0011 A61B17/00234 A61B17/0218 A61B34/70 A61B34/71 A61B50/30 A61B90/361 A61B2017/00221 A61B2017/00283 A61B2017/00398 A61B2034/302 A61B2034/304 A61B2090/306 Y10T29/49826		
优先权	61/266994 2009-12-04 US 12/942046 2010-11-09 US		
其他公开文献	EP2329789A1		
外部链接	Espacenet		

摘要(译)

支架组件包括器械盒和多个可致动的移动器。器械盒可包括可操作地连接到其上的一个或多个器械。将器械盒通过组织管道插入体腔。每个可致动的动子包括从其延伸的插入构件，用于插入组织内。每个移动器具有一个或多个可拆卸地连接到器械盒的线，其构造成在一个或多个移动器致动时使器械盒相对于每个移动器在不同位置之间移动，以使器械盒在体腔内移动。





EP 2 329 789 B1

EUROPEAN PATENT SPECIFICATION

(41) Date of publication and mention of the grant of the patent: 08.02.2017, Bulletin 2017/06

(42) Application number: 10252055.8

(43) Date of filing: 03.12.2010

(54) **Laparoscopic scaffold assembly**
Laparoskopische Gerüstassemblierung
Ensemble de support laparoscopique

(51) Int. Cl.
A61B 1/00 (2006.01)
A61B 34/00 (2006.01)
A61B 90/00 (2006.01)
A61B 1/00 (2006.01)
A61B 90/00 (2006.01)

(72) Inventors:
- Heinrich, Russell S.
Medford, CT 06453 (US)
- Viola, Frank
Storley, ERIC ALEXANDER
Medford, CT 06456 (US)

(74) Representative: Stearns, Candice Jane et al
Mansfield & Stearns IP Limited
30 Carlton Crescent
Southampton SO15 2EW (GB)

(56) References cited:
WO-A1-93/18712 WO-A2-2009/01288

(64) Designated Contracting States:
AL AT BE BG CH CY CZ DE DK EE ES FI FR GB GR HU IE IL IT LI LU LV MC MK NL NO PL PT RO RS SE SI SK SM TR

(30) Priority: 04.12.2009 US 940984 P
09.11.2010 US 942046

(43) Date of publication of application: 08.02.2011, Bulletin 2011/03

(73) Proprietor: Covidien LP
Mansfield, MA 02948 (US)

Note: Within nine months of the publication of the invention of the grant of the European patent in the European Patent Bulletin, any person may give notice to the European Patent Office of opposition to that patent, in accordance with the Implementing Regulations. Notice of opposition shall not be deemed to have been filed until the opposition fee has been paid. (Art. 99(1) European Patent Convention)

PUBLISHED BY: ZEPH/ PATENT OFFICE

EP 2 329 789 B1