



US 20190282326A1

(19) **United States**(12) **Patent Application Publication**  
**Nita et al.**(10) **Pub. No.: US 2019/0282326 A1**(43) **Pub. Date: Sep. 19, 2019**(54) **CONNECTOR FOR SECURING  
ULTRASOUND CATHETER TO  
TRANSDUCER**(71) Applicant: **Flowcardia, Inc.**, Franklin Lakes, NJ  
(US)(72) Inventors: **Henry Nita**, Redwood City, CA (US);  
**Martinos Tran**, Tracy, CA (US)(21) Appl. No.: **16/430,580**(22) Filed: **Jun. 4, 2019****Related U.S. Application Data**

(63) Continuation of application No. 15/256,233, filed on Sep. 2, 2016, now Pat. No. 10,349,964, which is a continuation of application No. 14/169,009, filed on Jan. 30, 2014, now Pat. No. 9,433,433, which is a continuation of application No. 12/831,883, filed on Jul. 7, 2010, now Pat. No. 8,641,630, which is a continuation of application No. 11/192,749, filed on Jul. 29, 2005, now Pat. No. 7,758,510, which is a continuation of application No. 10/666,459, filed on Sep. 19, 2003, now Pat. No. 6,942,620.

**Publication Classification**(51) **Int. Cl.**  
*A61B 90/50* (2006.01)  
*A61B 8/00* (2006.01)  
*A61B 8/12* (2006.01)  
(52) **U.S. Cl.**  
CPC ..... *A61B 90/50* (2016.02); *A61B 8/445*  
(2013.01); *A61B 2017/320069* (2017.08);  
*C08L 2201/12* (2013.01); *A61B 8/12*  
(2013.01)(57) **ABSTRACT**

An ultrasonic system includes an ultrasound transducer housing, an ultrasonic catheter, and a transducer mechanism. The ultrasound transducer housing contains a transducer horn configured to be connected to a signal generator. The ultrasonic catheter includes an ultrasound transmission member having a proximal end and disposed in the lumen, a sonic connector that connects the proximal end of the ultrasound transmission member with the transducer horn, a control ring, and a nesting piece configured to selectively receive the sonic connector. The control ring is operatively coupled to the nesting piece to move the nesting piece. The transducer mechanism is configured to move from a first position to a second position, and wherein the transducer mechanism is configured such that movement of the transducer mechanism from the first position to the second position engages the control ring on the catheter to move the nesting piece.

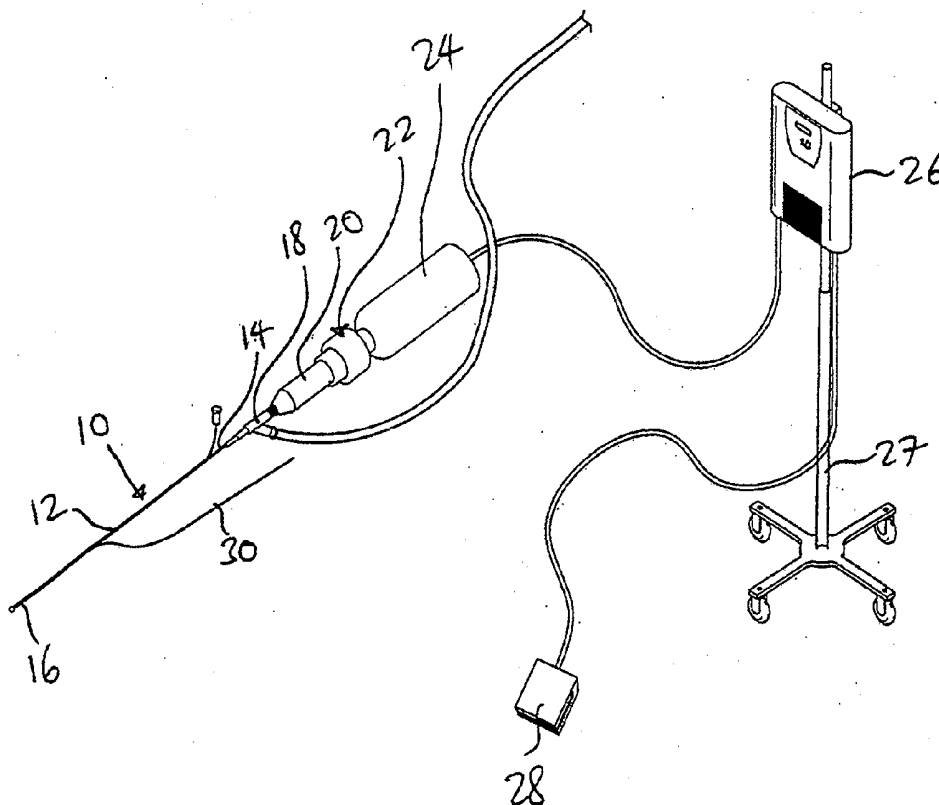

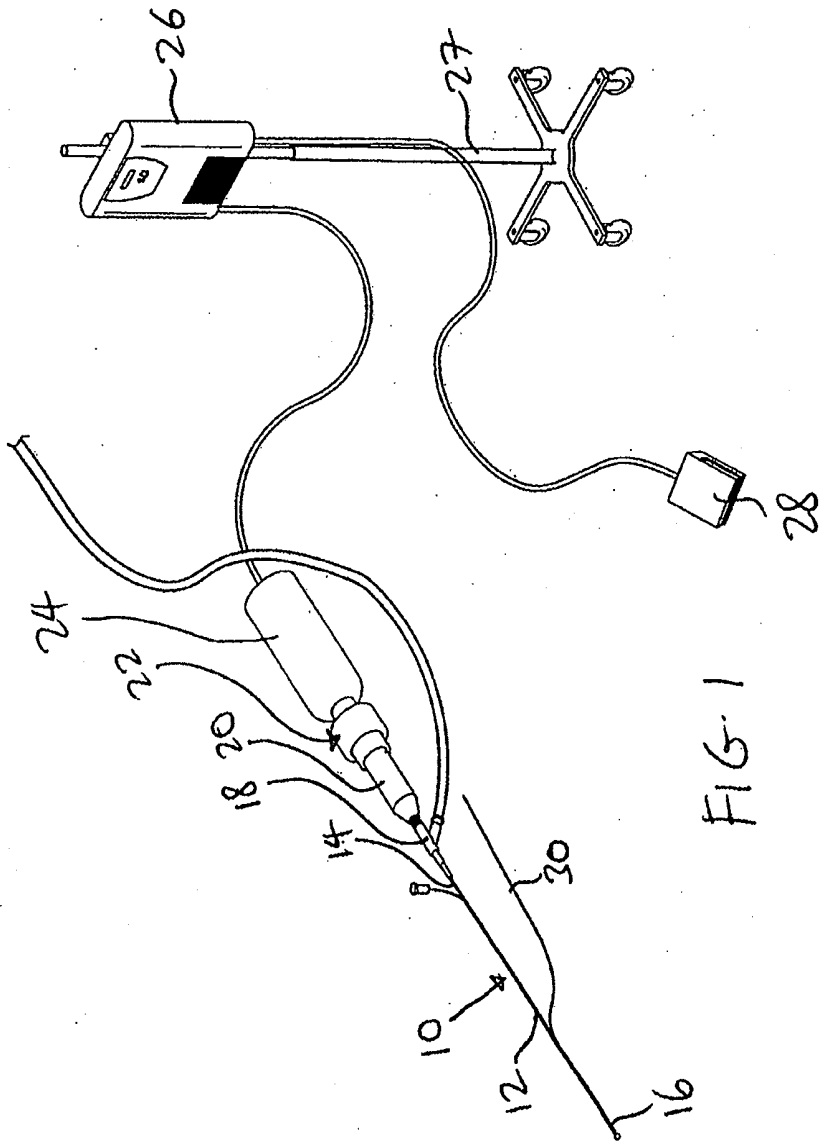

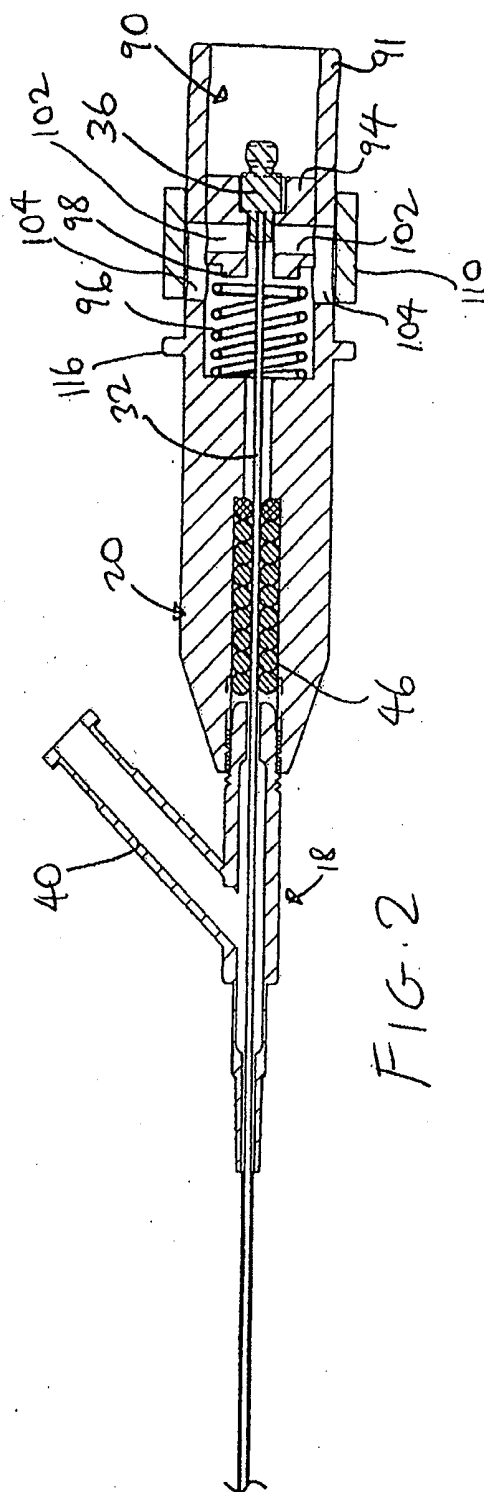

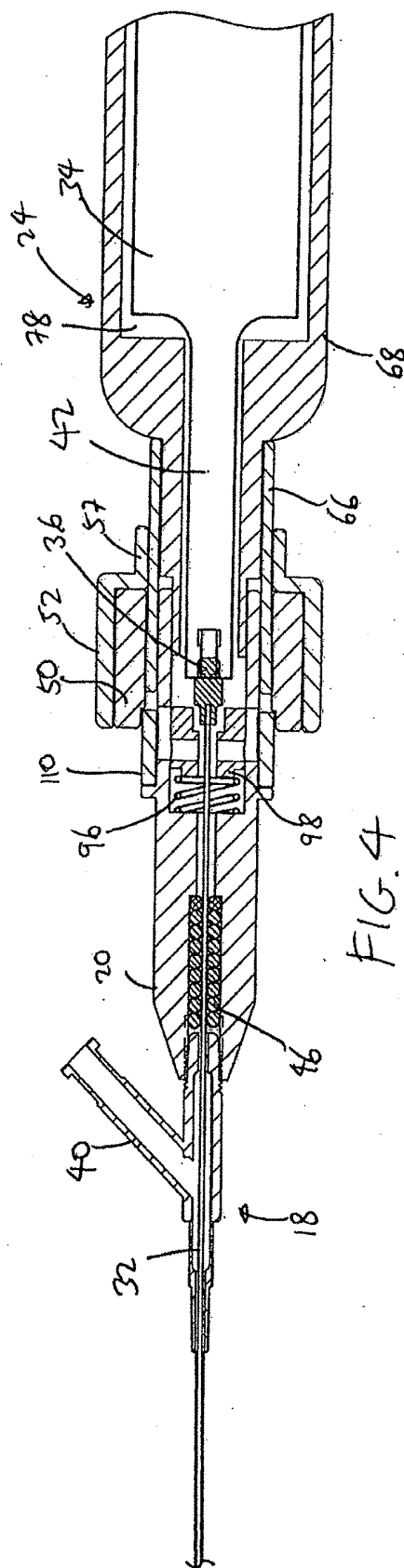
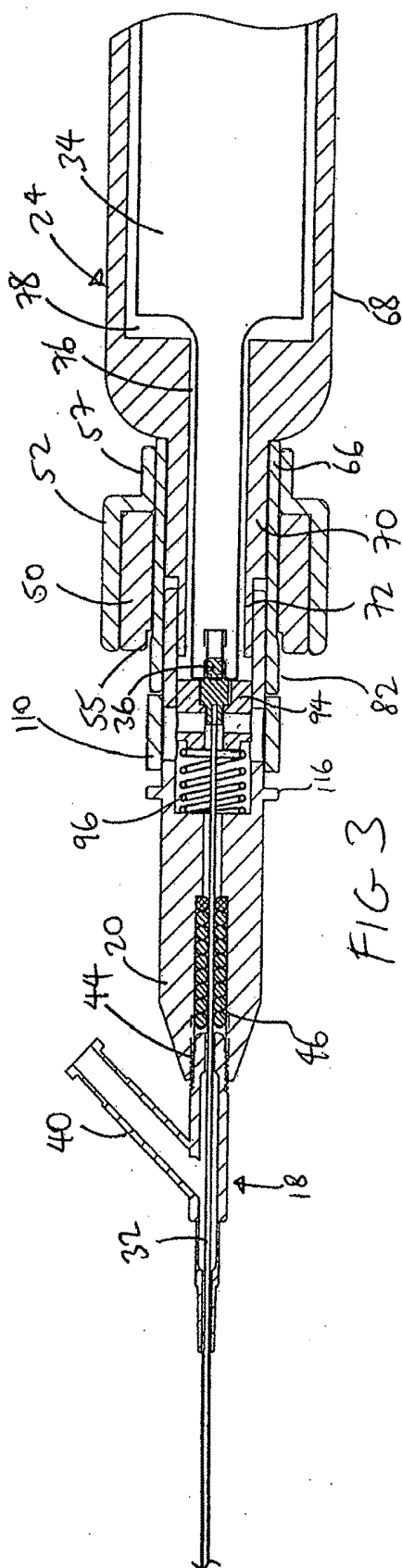

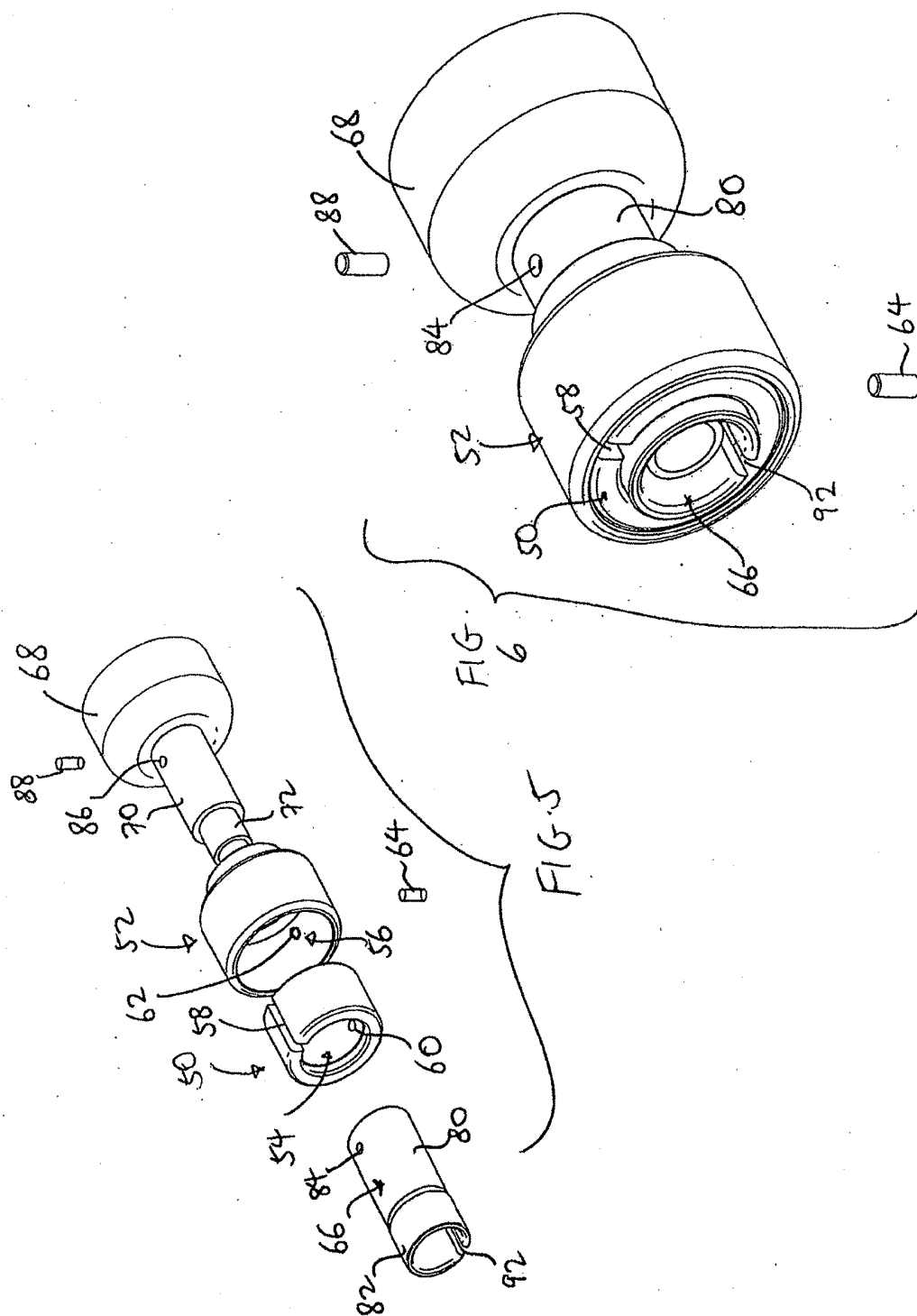

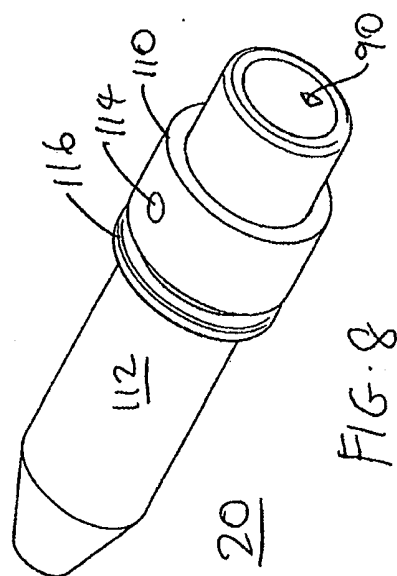
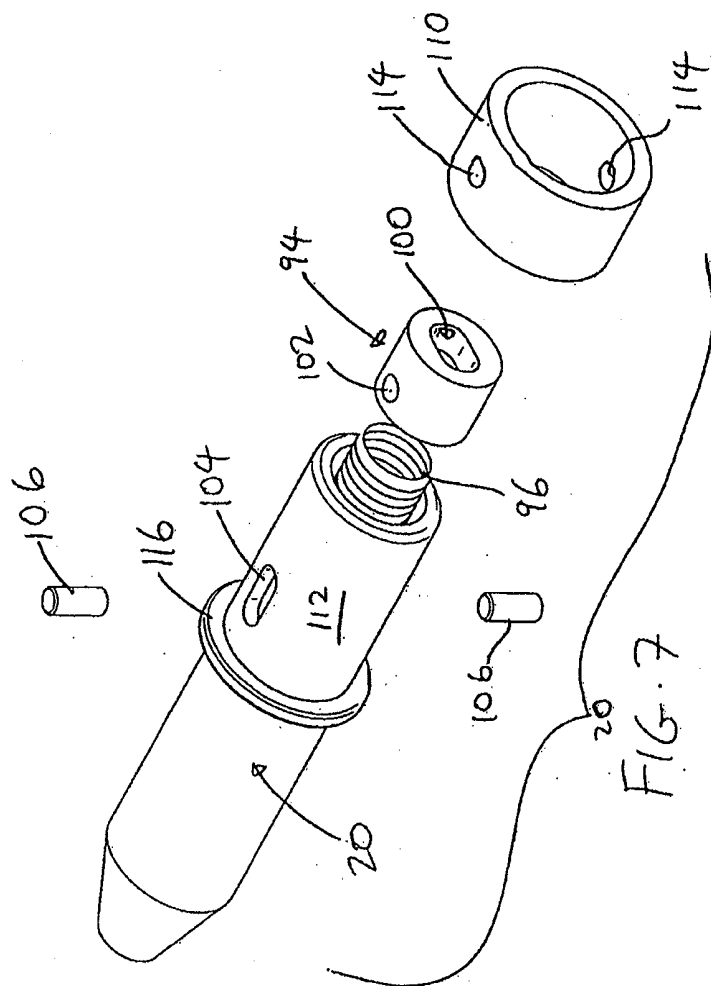

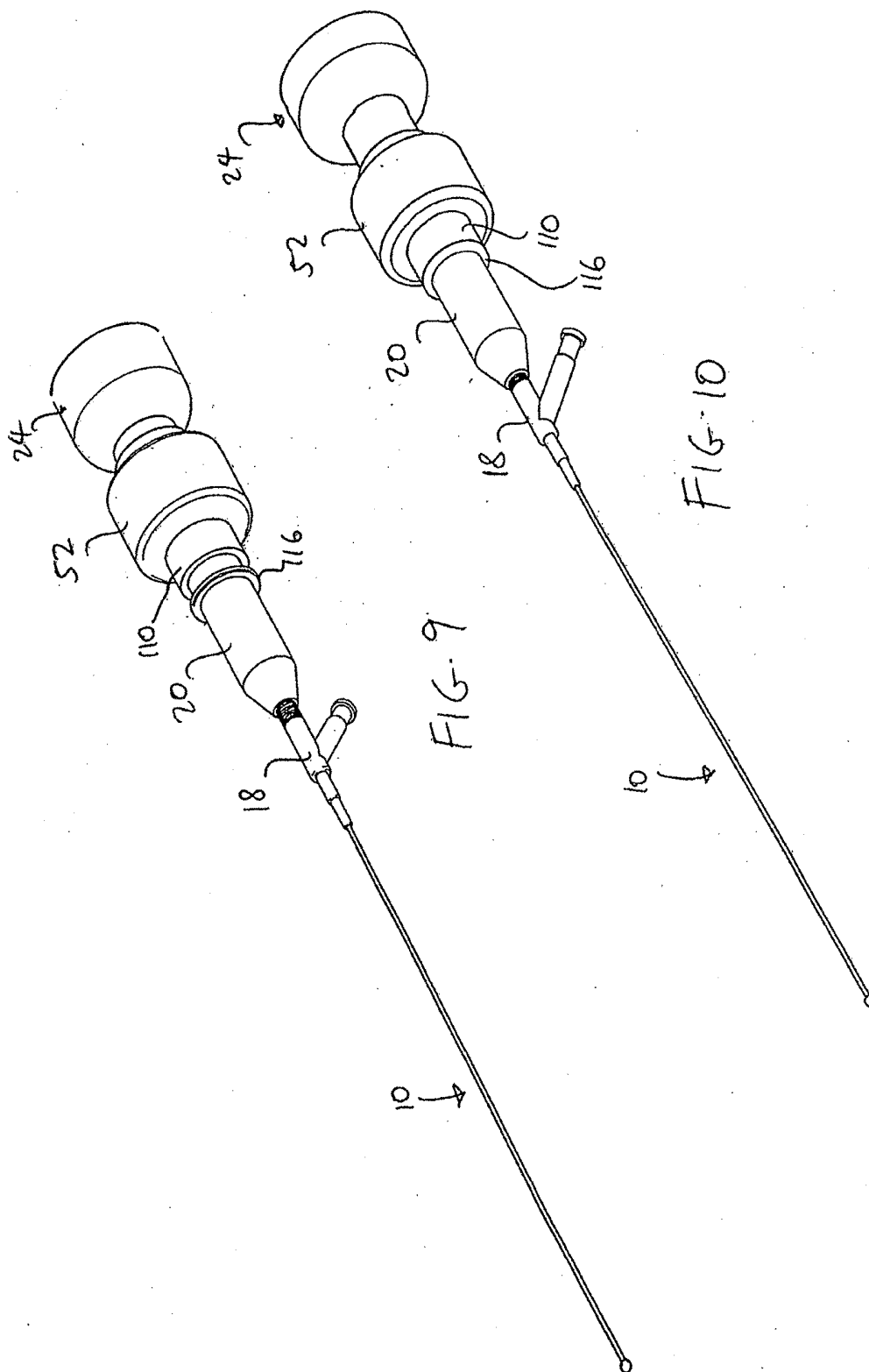

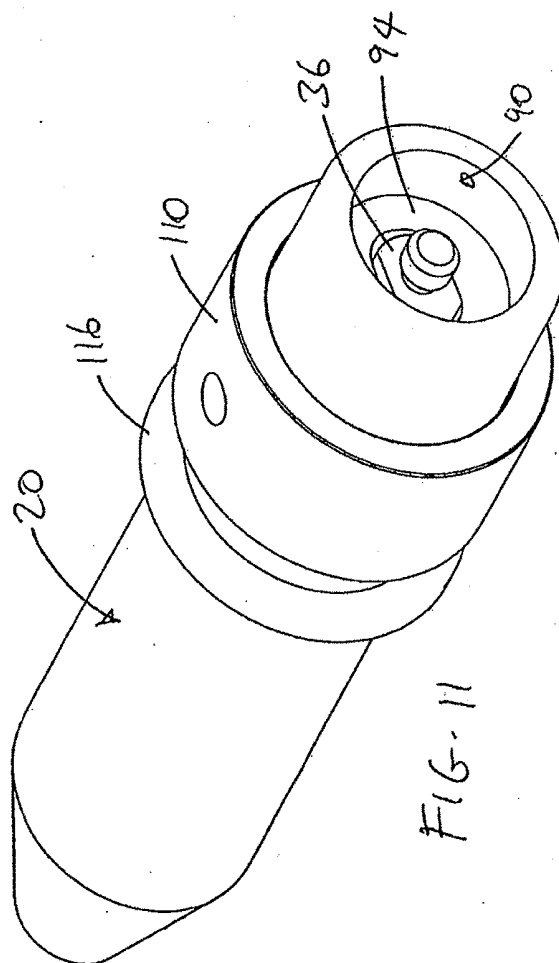
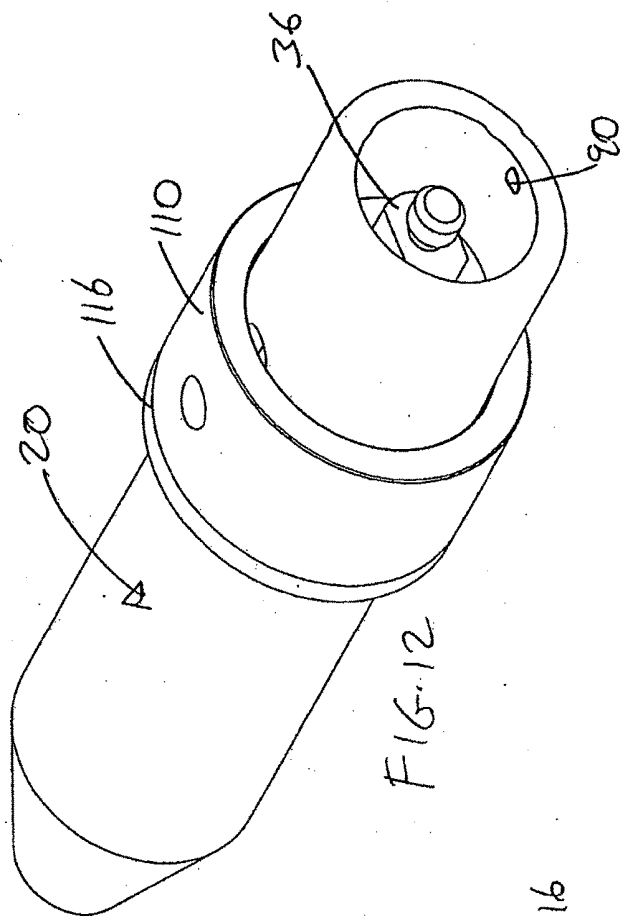



## CONNECTOR FOR SECURING ULTRASOUND CATHETER TO TRANSDUCER

### CROSS-REFERENCE TO RELATED APPLICATIONS

[0001] This application is a continuation of Ser. No. 12/831,883, which is a continuation of Ser. No. 11/192,749, filed Jul. 29, 2005, entitled "Connector for Securing Ultrasound Catheter to Transducer" (now U.S. Pat. No. 7,758,510), which is a continuation of Ser. No. 10/666,459, filed Sep. 19, 2003, entitled "Connector for Securing Ultrasound Catheter to Transducer" (now U.S. Pat. No. 6,942,620), each of which is incorporated by reference as though set forth fully herein.

### BACKGROUND OF THE INVENTION

#### Field of the Invention

[0002] The present invention pertains to medical equipment, and more particularly, to a device and method for attaching an ultrasound catheter to an ultrasound transducer which prevents frequency shifts and minimizes the mechanical impact of the handling connection area during a medical procedure.

#### Description of the Related Art

[0003] A number of ultrasound systems and devices have heretofore been proposed for use in ablating or removing obstructive material from blood vessels. Ultrasound catheters have been utilized to ablate various types of obstructions from blood vessels of humans and animals. Successful applications of ultrasound energy to smaller blood vessels, such as the coronary arteries, require the use of relatively small diameter ultrasound catheters which are sufficiently small and flexible to undergo transluminal advancement through the tortuous vasculature of the aortic arch and coronary tree. These ultrasound catheters incorporate a very small diameter ultrasound transmission member which extends through such catheters. The proximal end of the ultrasound transmission member is typically connected to an ultrasound transducer via a sonic connector.

[0004] The attachment of the ultrasound transmission member to an ultrasound transducer plays a very important role in ultrasound energy propagation. The attachment region needs to be accurately aligned and free of mechanical stress and other interfaces. For example, undesirable stress at the attachment region can be caused by pressing upon, pushing, pulling, torquing, bending or bumping the attachment region during use of the ultrasound catheter. In addition, it is preferable for the sonic connector to be free from any interface (i.e., contact) with any other component during energy transmission. Otherwise, such stresses and interfaces can negatively impact the propagation of ultrasound energy through the ultrasound transmission member. Contact of the sonic connector with any other part of the catheter housing during the delivery of ultrasound energy might also cause a shift in frequency and impact performance.

[0005] Thus, there still exists a need for an improved connection of the proximal end of the ultrasound transmission member to an ultrasound transducer.

### SUMMARY OF THE INVENTION

[0006] It is an object of the present invention to provide an improved connection between the ultrasound catheter and the ultrasound transducer.

[0007] It is yet another object of the present invention to improve the propagation of ultrasound energy by limiting and minimizing the impact of undesirable external forces.

[0008] In order to accomplish the objects of the present invention, there is provided an ultrasound system and method of using the ultrasound system during a medical procedure. The ultrasound system has an ultrasound transducer having a transducer housing and a horn provided at the distal end of the transducer housing, an ultrasound transmission member, a sonic connector that is connected to the horn and the proximal end of the ultrasound transmission member, and a catheter knob having a proximal end that is coupled to the distal end of the transducer housing. The catheter knob has a proximal bore that houses the sonic connector. The system also includes a nesting piece that is retained inside the proximal bore of the catheter knob. The nesting piece can be moved from a first position where the sonic connector is received inside the nesting piece to a second position where the sonic connector is separated from the nesting piece when ultrasound energy is being propagated through the ultrasound transmission member.

### BRIEF DESCRIPTION OF THE DRAWINGS

[0009] FIG. 1 is a perspective view of an ultrasound system according to one embodiment of the present invention.

[0010] FIG. 2 is a cross-sectional view of the Y-connector and catheter knob of the system of FIG. 1.

[0011] FIG. 3 is a cross-sectional view of the Y-connector, the catheter knob, the slide collar assembly and the transducer housing of the system of FIG. 1 with the slide collar assembly in the non-supporting position.

[0012] FIG. 4 is a cross-sectional view of the Y-connector, the catheter knob, the slide collar assembly and the transducer housing of the system of FIG. 1 with the slide collar assembly in the supporting position.

[0013] FIG. 5 is an exploded perspective view of some of the elements of the slide collar assembly of the system of FIG. 1.

[0014] FIG. 6 is an assembled perspective view of the elements of FIG. 5.

[0015] FIG. 7 is an exploded perspective view of the catheter knob of the system of FIG. 1.

[0016] FIG. 8 is an assembled perspective view of the catheter knob of FIG. 7.

[0017] FIG. 9 is a perspective view of the system of FIG. 1 with the slide collar assembly in the non-supporting position.

[0018] FIG. 10 is a perspective view of the system of FIG. 1 with the slide collar assembly in the supporting position.

[0019] FIG. 11 is a perspective view of the catheter knob of the system of FIG. 1 with the slide collar assembly in the non-supporting position.

[0020] FIG. 12 is a perspective view of the catheter knob of the system of FIG. 1 with the slide collar assembly in the supporting position.

# DETAILED DESCRIPTION OF THE PREFERRED EMBODIMENT

[0021] The following detailed description is of the best presently contemplated modes of carrying out the invention. This description is not to be taken in a limiting sense, but is made merely for the purpose of illustrating general principles of embodiments of the invention. The scope of the invention is best defined by the appended claims. In certain instances, detailed descriptions of well-known devices, compositions, components, mechanisms and methods are omitted so as to not obscure the description of the present invention with unnecessary detail.

[0022] FIG. 1 illustrates an ultrasound system according to the present invention for use in ablating and removing occlusive material inside the vessel of an animal or human being. The ultrasound system includes an ultrasonic catheter device 10 which has an elongate catheter body 12 having a proximal end 14, a distal end 16, and defining at least one lumen extending longitudinally therethrough. The ultrasound catheter device 10 is operatively coupled at its proximal end 14, by way of a Y-connector 18, a catheter knob 20, and a slide collar assembly 22, to an ultrasound transducer housing 24. As shown in FIGS. 3-4, an ultrasound transducer 34 is housed inside the transducer housing 24. The ultrasound transducer 34 is connected to a signal generator 26, which can be provided with a foot actuated on-off switch 28. The signal generator 26 can be supported by an IV pole 27. When the on-off switch 28 is depressed, the signal generator 26 sends an electrical signal to the ultrasound transducer 34, which converts the electrical signal to ultrasound energy. Such ultrasound energy subsequently passes through the catheter device 10 and is delivered to the distal end 16.

[0023] Referring also to FIGS. 2-4, an ultrasound transmission member 32 extends through the lumen of the catheter 10 from the distal end 16 to the proximal end 14. The ultrasound transducer 34 is coupled via a sonic connector 36 (described in greater detail below) to the ultrasound transmission member 32, so that the ultrasound energy can be passed through the sonic connector 36 and the ultrasound transmission member 32 to be delivered to the distal end 16 of the catheter 10. A guidewire 30, which can be any conventional monorail or over-the-wire guidewire, may be utilized in conjunction with the catheter 10 in a manner that is well-known in the catheter art.

[0024] The frontal portion of the Y-connector 18 is connected to the proximal end 12 of the catheter 10 using techniques that are well-known in the catheter art. An injection pump (not shown) or IV bag (not shown) can be connected, by way of an infusion tube (not shown), to an infusion port or sidearm 40 of the Y-connector 18. The injection pump can be used to infuse coolant fluid (e.g., 0.9% NaCl solution) into and/or through the lumen of the catheter 10. Such flow of coolant fluid may be utilized to prevent overheating of the ultrasound transmission member 32 extending longitudinally through the lumen of the catheter 10. Such flow of the coolant fluid through the lumen of the catheter 10 serves to bathe the outer surface of the ultrasound transmission member 32, thereby providing for an equilibration of temperature between the coolant fluid and the ultrasound transmission member 32. Thus, the temperature and/or flow rate of coolant fluid may be adjusted to provide adequate cooling and/or other temperature control of the ultrasound transmission member 32. In

addition to the foregoing, the injection pump may be utilized to infuse a radiographic contrast medium into the catheter 10 for purposes of imaging.

[0025] Examples of iodinated radiographic contrast media which may be selectively infused into the catheter 10 via the injection pump are commercially available as Angiovisc 370 from Berlex Labs, Wayne, N.J. and Hexabrix from Mallinckrodt, St. Louis, Mo.

[0026] The proximal end of the ultrasound transmission member 32 is attached to the sonic connector 36 which is configured to effect operative and removable attachment of the proximal end of the ultrasound transmission member 32 to the distal horn 42 of the ultrasound transducer 34. The sonic connector 36 is preferably configured and constructed to permit passage of ultrasound energy through the ultrasound transmission member 32 with minimal lateral side-to-side movement of the ultrasound transmission member 32 while, at the same time, permitting unrestricted longitudinal forward/backward vibration or movement of the ultrasound transmission member 32.

[0027] The ultrasound transmission member 32 may be formed of any material capable of effectively transmitting the ultrasonic energy from the ultrasound transducer 34 to the distal end 16 of the catheter 10, including but not necessarily limited to metal, plastic, hard rubber, ceramic, fiber optics, crystal, polymers, and/or composites thereof. In accordance with one aspect of the invention, all or a portion of the ultrasound transmission member 32 may be formed of one or more materials which exhibit super-elasticity. Such materials should preferably exhibit super-elasticity consistently within the range of temperatures normally encountered by the ultrasound transmission member 32 during operation of the catheter 10. Specifically, all or part of the ultrasound transmission member 32 may be formed of one or more metal alloys known as "shape memory alloys". Such super-elastic metal alloys are well-known in the art and will not be described in any further detail herein.

[0028] The proximal end of the Y-connector 18 is attached to the distal end of the catheter knob 20 by threadably engaging the proximal end of the Y-connector 18 inside a threaded distal bore 44 at the distal end of the catheter knob 20. O-rings 46 are provided in the threaded distal bore 44 to minimize transverse vibrations. The proximal end of the catheter knob 20 receives the extension 70 of the transducer housing 24 and is supported by the slide collar assembly 22. The slide collar assembly 22 is positioned over the distal end of the transducer housing 24, and has a non-supporting position where the slide collar assembly 22 is retracted towards the transducer housing 24; and has a supporting position where the slide collar assembly 22 is extended to cover at least a portion of the catheter knob 20. Thus, the slide collar assembly 22 functions as a support member that is disposed on the transducer housing 24 to support at least a portion of the catheter knob 20.

[0029] Referring also to FIGS. 5 and 6, the slide collar assembly 22 has an inner ring 50 (also referred to as collar 50) and an outer ring 52 (also referred to as collar 52). The inner ring 50 has a bore 54 and a longitudinal slit 58 that extends through the length of the inner ring 50. The distal portion of the bore 54 can be stepped as shown at 55 (see FIG. 3) to function as a pushing surface that pushes a nesting piece 94 (described below) in a distal direction as the inner ring 50 is moved from the non-supporting position to the supporting position. The outer ring 52 also has a bore 56,

and has a narrowed proximal end 57. The inner ring 50 is retained inside the bore 56 of the outer ring 52 and abuts the narrowed proximal end 57 which acts as a stop to limit the proximal movement of the inner ring 50. Each of the inner ring 50 and the outer ring 52 has an opening 60 and 62, respectively, that are aligned with each other and that are adapted to receive a locking pin 64. A tubular inner sleeve 66 extends through the inside of the bore 54 of the inner ring 50 to ensleeve the first extension 70 of the transducer housing 24, as explained below. The sleeve 66 has a proximal section 80 and an enlarged distal section 82. The inner ring 50 is normally fitted around the proximal section 80 when the slide collar assembly 22 is in the non-supporting position, but the inner ring 50 is fitted around the distal section 82 when the slide collar assembly 22 is in the supporting position. Thus, providing the distal section 82 in an enlarged configuration allows for the inner ring 50 to achieve a friction-fit with the distal section 82, while the inner ring 50 experiences a loose fit over the proximal section 80.

[0030] The transducer housing 24 has a cylindrical wall 68 having a distal extension that comprises two stepped cylindrical extensions 70 and 72 extending from the distal end of the cylindrical wall 68. The first extension 70 is attached to the distal end of the cylindrical wall 68, and has a greater outer diameter than the second extension 72 that is attached to the distal end of the first extension 70. A throughbore 76 extends from the hollow interior 78 of the cylindrical wall 68 and through the extensions 70 and 72. The throughbore 76 can have the same diameter throughout its length. The second extension 72 is adapted to be received inside the proximal bore 90 of the catheter knob 20, while the first extension 70 is received inside the sleeve 66. In addition, an opening 84 is provided in the proximal section 80 of the sleeve 66 and is aligned with a corresponding opening 86 on the first extension 70, with the openings 84, 86 adapted to receive a locking pin 88 that secures the sleeve 66 to the first extension 70 at a fixed position.

[0031] A longitudinal slot 92 is provided on the sleeve 66. When the slide collar assembly 22 is in the non-supporting position (i.e., inner ring 50 positioned over the proximal section 80), the slot 92 is opened. However, when the slide collar assembly 22 is moved to the supporting position, the inner ring 50 is positioned over the distal section 82 and compresses the enlarged distal section 82 to close the slot 92. With the slot 92 closed, the sleeve 66 provides a frictional grip of the proximal end 91 of the catheter knob 20.

[0032] Referring now to FIGS. 2-4 and 7-8, the catheter knob 20 has a proximal bore 90 that can be sleeved over the second extension 72 in a manner such that the outer surface of the catheter knob 20 can be substantially flush with the outer surface of the first extension 70 (as best shown in FIGS. 3 and 4). The proximal bore 90 houses the sonic connector 36 and a nesting piece 94. An elastic element 96, such as a spring, is seated in the distal part of the proximal bore 90, and has one end carried on a projection 98 provided at the distal end of the nesting piece 94. The nesting piece 94 has a generally cylindrical configuration and has a receptacle 100 which functions to selectively retain the sonic connector 36, as will be explained in greater detail below. In addition, a control ring 110 is positioned around the outer surface 112 of the catheter knob 20. The control ring 112 cooperates with the nesting piece 94 to move the nesting

piece 94 in a reciprocal manner inside the proximal bore 90 of the catheter knob 20, as explained below.

[0033] The nesting piece 94 has two opposite and aligned openings 102; only the top opening 102 is shown in FIG. 7, but the bottom opening is the same and is aligned on a straight line with the top opening 102. Similarly, the catheter knob 20 has two opposite and aligned channels 104; only the top channel 104 is shown in FIG. 7, but the bottom channel is the same and is aligned on a straight line with the top channel 104. In addition, the control ring 110 has two opposite and aligned openings 114. The channels 104 and the openings 102, 114 are aligned, as best shown in FIGS. 3 and 4. Two opposing pins 106 are provided, with each pin 106 adapted to be fitted inside a corresponding set of channel 104 and openings 102, 114, so as to couple the control ring 110 and the nesting piece 94 as a unitary moving piece. The width of the channels 104 define the distal and proximal limits of movement for the control ring 110 and the nesting piece 94. The catheter knob 20 also has an annular flange 116 provided about its outer surface 112 that also defines the distal limit of the movement of the control ring 110.

[0034] In use, the sonic connector 36 is shown in FIGS. 3-4 as connecting the transducer horn 42 (e.g., with a threaded connection) with the ultrasound transmission member 32. The sonic connector 36 is always located at a fixed position inside the proximal bore 90 of the catheter knob 20. When the slide collar assembly 22 is in the non-supporting position shown in FIGS. 3, 9 and 11, the elastic element 96 normally biases the nesting piece 94 in the proximal direction so that the sonic connector 36 is received inside the receptacle 100 of the nesting piece 94 to be supported by the nesting piece 94. The proximal movement of the nesting piece 94 will cause the pins 106 to move in the proximal direction inside the channels 104, thereby causing the control ring 110 to move proximally away from the flange 116. The outer ring 52 and the inner ring 50 are positioned completely over the proximal section 80 of the sleeve 66, with the narrowed proximal end 57 positioned adjacent the cylindrical wall 68 of the transducer housing 24.

[0035] When the slide collar assembly 22 is now moved from the non-supporting position to the supporting position shown in FIGS. 4, 10 and 12, the user pushes the outer ring 52 in the distal direction. The step 55 on the distal end of the inner ring 50 engages the proximal end of the control ring 110 and pushes the control ring 110 in the distal direction. Movement of the control ring 110 in the distal direction will cause the pins 106 to move in the distal direction inside the channels 104, thereby causing the nesting piece 94 to counter the bias of the elastic element 96 and move in the distal direction. As the nesting piece 94 moves in the distal direction, the sonic connector 36 becomes free from the receptacle 100 of the nesting bore 94. In addition, the distal movement of the inner ring 50 will cause the inner surface of the inner ring 50 to engage the enlarged distal section 82 of the sleeve 66, which functions to close the slot 92 so as to frictionally grip the proximal portion 91 of the knob 20 when the slide collar assembly 22 is in the supporting position. The flange 116 and the width of the channels 104 function as stops to limit the distal movement of the control ring 110.

[0036] In the supporting position, the sonic connector 36 is not supported by the nesting piece 94 so that the sonic connector 36 can be free from any component or material interfaces, thereby promoting improved ultrasound energy

propagation. The medical procedure can then be carried out while the slide collar assembly 22 is in the supporting position. Upon completion of the medical procedure, the above-described steps are reversed. In particular, the combined inner and outer rings 50, 52 (slide collar assembly 22) are retracted in the proximal direction so that they are now positioned over the proximal section 80 of the sleeve 66. The bias of the elastic element 96 will push the nesting piece 94 in the proximal direction so that the sonic connector 36 is received inside the receptacle 100 of the nesting piece 94. In addition, the proximal movement of the nesting piece 94 will cause the pins 106 to move in the proximal direction inside the channels 104, thereby causing the control ring 110 to move proximally away from the flange 116. Now, the catheter 10 can be disconnected from the transducer 34.

[0037] While the description above refers to particular embodiments of the present invention, it will be understood that many modifications may be made without departing from the spirit thereof. The accompanying claims are intended to cover such modifications as would fall within the true scope and spirit of the present invention.

1-11. (canceled)

12. An ultrasonic system, comprising:

an ultrasound transducer housing containing a transducer horn configured to be connected to a signal generator; an ultrasonic catheter that includes an ultrasound transmission member having a proximal end and disposed in the lumen, a sonic connector that connects the proximal end of the ultrasound transmission member with the transducer horn, a control ring, and a nesting piece configured to selectively receive the sonic connector, the control ring operatively coupled to the nesting piece to move the nesting piece; and

a transducer mechanism configured to move from a first position to a second position, and wherein the transducer mechanism is configured such that movement of the transducer mechanism from the first position to the second position engages the control ring on the catheter to move the nesting piece.

13. The ultrasonic system of claim 12, wherein in the first position, the sonic connector is received inside the nesting piece, and in the second position, the sonic connector is separated from the nesting piece.

14. The ultrasonic system of claim 12, wherein the ultrasonic catheter includes a catheter knob having a proximal end that is coupled to a distal end of the transducer housing, the catheter knob having a proximal bore that houses the sonic connector, the nesting piece being retained inside the proximal bore of the catheter knob.

15. The ultrasonic system of claim 14, wherein the transducer mechanism includes a slide collar assembly that is positioned over a distal end of the transducer housing, the slide collar assembly being movable between a non-supporting position and a support position, wherein when the slide collar assembly is in the non-supporting position the slide collar assembly is configured to not grip the catheter knob, and when the slide collar assembly is in the support position, the slide collar assembly provides a frictional grip of the catheter knob.

16. The ultrasonic system of claim 15, wherein the slide collar assembly includes an outer collar and an inner collar, the slide collar assembly movable from a retracted position

where the outer collar and inner collar are spaced apart from the control ring, to an extended position where the inner collar engages and pushes the control ring.

17. The system of claim 16, wherein the inner collar has a first bore and the outer collar has a second bore, with the inner collar received inside the second bore of the outer collar, and wherein the proximal end of the control ring is positioned inside the first bore of the inner collar when the inner collar is in the extended position.

18. The ultrasonic system of claim 17, wherein the slide collar assembly includes a sleeve partially retained inside the first bore of the inner collar, the sleeve having a longitudinal slot, and wherein each of the inner collar and the outer collar has an opening, with a pin extending through the opening in the inner collar and the opening in the outer collar.

19. The ultrasonic system of claim 18, wherein the longitudinal slot is opened when the slide collar assembly is in the non-supporting position and the slot is closed when the slide collar assembly is in the supporting position, and wherein the sleeve grips the catheter knob when the slot is closed.

20. The ultrasonic system of claim 15, wherein when slide collar assembly is in the supporting position, the sonic connector is not supported by the nesting piece so that the sonic connector can be free from any component or material interfaces, thereby promoting improved ultrasound energy propagation.

21. The ultrasonic system of claim 15, wherein when the slide collar assembly is in the non-supporting position, the combined inner collar and outer collar are retracted in a proximal direction so that the inner collar is positioned over the proximal section of the sleeve, wherein a bias of an elastic element will push the nesting piece in the proximal direction so that the sonic connector is received inside the nesting piece.

22. The ultrasonic system of claim 21, wherein the proximal movement of the nesting piece will cause the control ring to move proximally so that the ultrasonic catheter can be disconnected from the transducer housing.

23. The ultrasonic system of claim 14, wherein the catheter knob has a longitudinal channel, and wherein each of the nesting piece and the control ring has an opening, with a pin extending through the opening in the nesting piece and the opening in the control ring, and the pin traveling within the longitudinal channel, and further comprising an elastic element to push the nesting piece in the proximal direction so that the sonic connector is received inside the nesting piece, and wherein the proximal movement of the nesting piece will cause the control ring to move proximally so that the ultrasonic catheter can be disconnected from the transducer housing.

24. The ultrasonic system of claim 12, wherein the sonic connector and the transducer horn are joined by a threaded connection.

25. The ultrasonic system of claim 12, wherein the sonic connector and the transducer horn are joined by a frictional connection.

\* \* \* \* \*

专利名称(译)	用于将超声导管固定到换能器的连接		
公开(公告)号	<a href="#">US20190282326A1</a>	公开(公告)日	2019-09-19
申请号	US16/430580	申请日	2019-06-04
[标]申请(专利权)人(译)	FLOWCARDIA		
申请(专利权)人(译)	FLOWCARDIA INC.		
当前申请(专利权)人(译)	FLOWCARDIA INC.		
[标]发明人	NITA HENRY TRAN MARTINOS		
发明人	NITA, HENRY TRAN, MARTINOS		
IPC分类号	A61B90/50 A61B8/00 A61B8/12 A61B6/00 A61B8/14		
CPC分类号	A61B90/50 A61B8/12 A61B2017/00867 A61B8/445 C08L2201/12 A61B2017/320069		
外部链接	<a href="#">Espacenet</a> <a href="#">USPTO</a>		

#### 摘要(译)

超声系统包括超声换能器壳体，超声导管和换能器机构。超声换能器壳体包含换能器喇叭，其被配置为连接到信号发生器。超声波导管包括具有近端并设置在内腔中的超声波传输构件，连接超声波传输构件的近端与换能器喇叭的声波连接器，控制环，以及构造成选择性地接收声波的嵌套件连接器。控制环可操作地连接到嵌套件以移动嵌套件。换能器机构被配置为从第一位置移动到第二位置，并且其中换能器机构被配置成使得换能器机构从第一位置到第二位置的移动接合导管上的控制环以移动嵌套件。。

