



US 20020123689A1

(19) **United States**(12) **Patent Application Publication**  
**Furia**(10) **Pub. No.: US 2002/0123689 A1**(43) **Pub. Date: Sep. 5, 2002**(54) **NEEDLE-GUIDE DEVICE, PARTICULARLY  
FOR ULTRASOUND PROBES**(52) **U.S. Cl. .... 600/461**(76) **Inventor: Roberto Furia, Genova (IT)**(57) **ABSTRACT**

Correspondence Address:  
**Woodard, Emhardt, Naughton,  
Moriarty and McNett  
Bank One Center/Tower  
111 Monument Circle, Suite 3700  
Indianapolis, IN 46204-5137 (US)**

(21) **Appl. No.: 10/082,703**(22) **Filed: Feb. 25, 2002**(30) **Foreign Application Priority Data****Mar. 5, 2001 (IT) ..... SV2001A000008****Publication Classification**(51) **Int. Cl.<sup>7</sup> ..... A61B 8/14**

A needle-guide device, particularly for ultrasound probes, or the like, comprising a base body having means for connection to the probe and at least one elongated guide hole for receiving a needle-like surgical tool, characterized in that said needle-guide device (2, 12) is made of at least two removably connectable parts (102, 112; 202, 212), which are shaped in such a manner that each of them forms complementary parts of the peripheral delimiting wall of the elongated guide hole for the surgical tool (3), which peripheral wall parts complete each other when said two parts (102, 112; 202, 212) of the needle-guide device (2, 12) are connected, thereby forming an elongated guide hole for guiding the needle with a 360° covering delimiting wall.

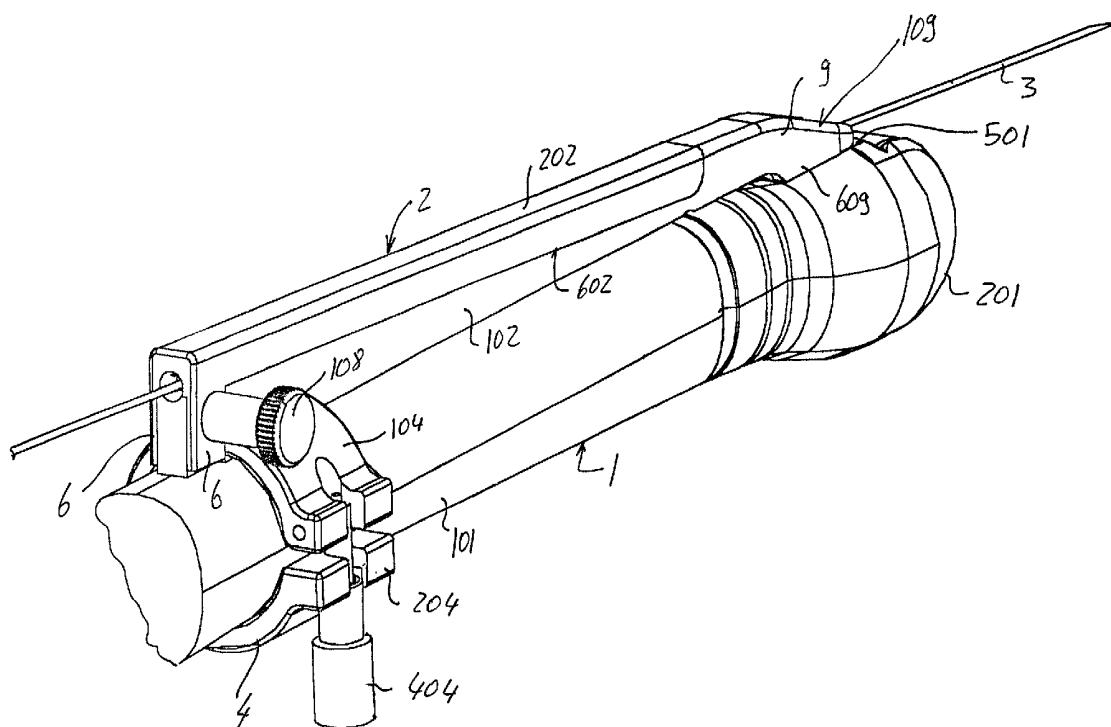

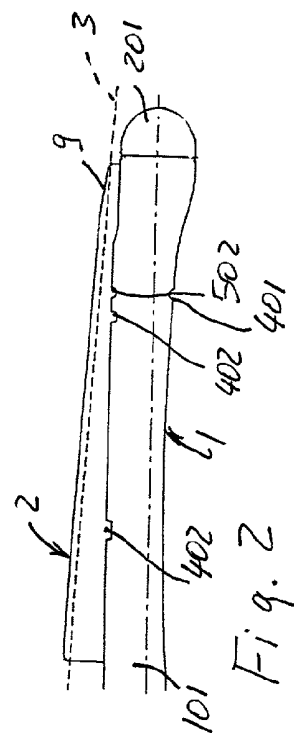
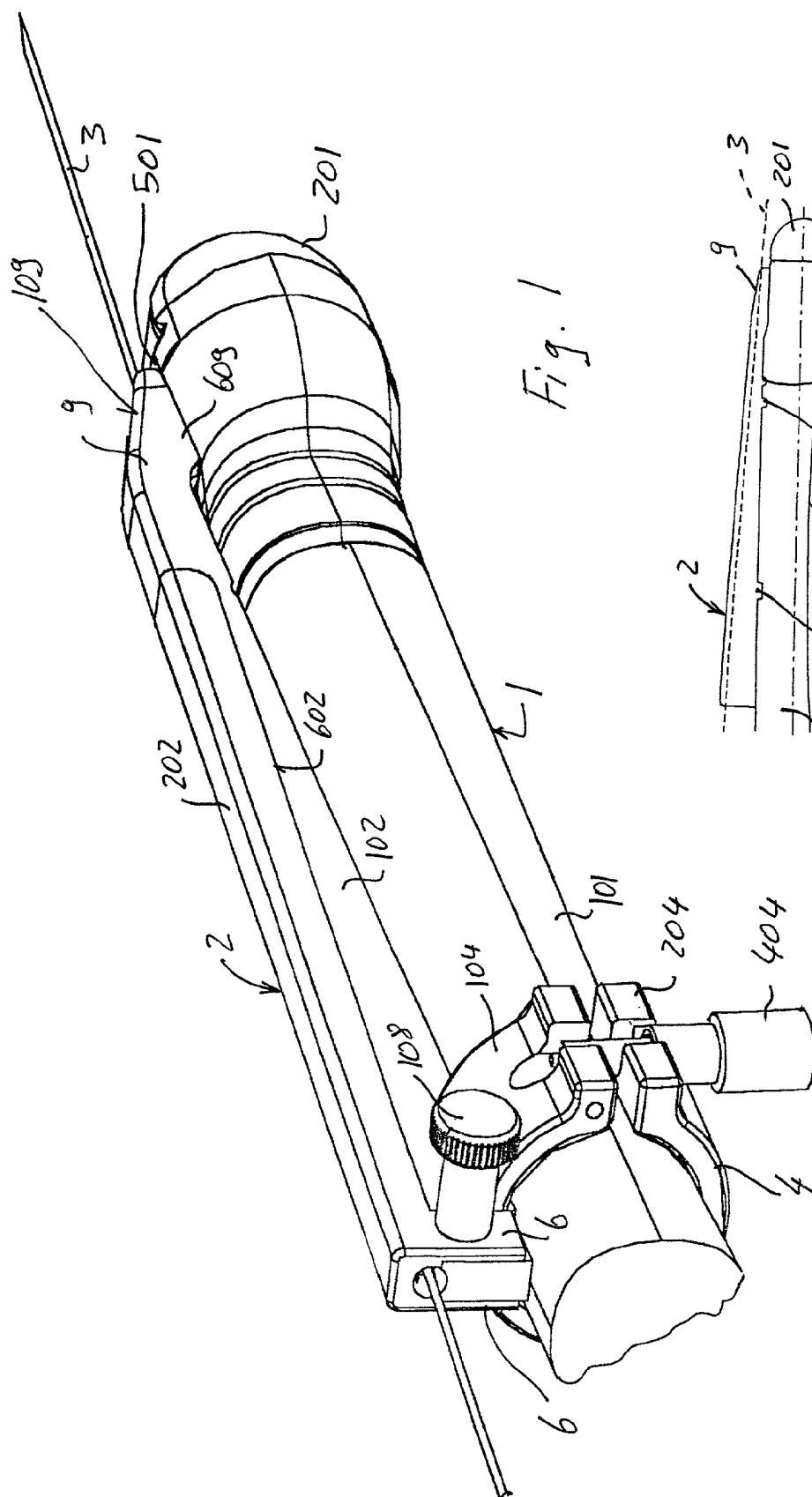

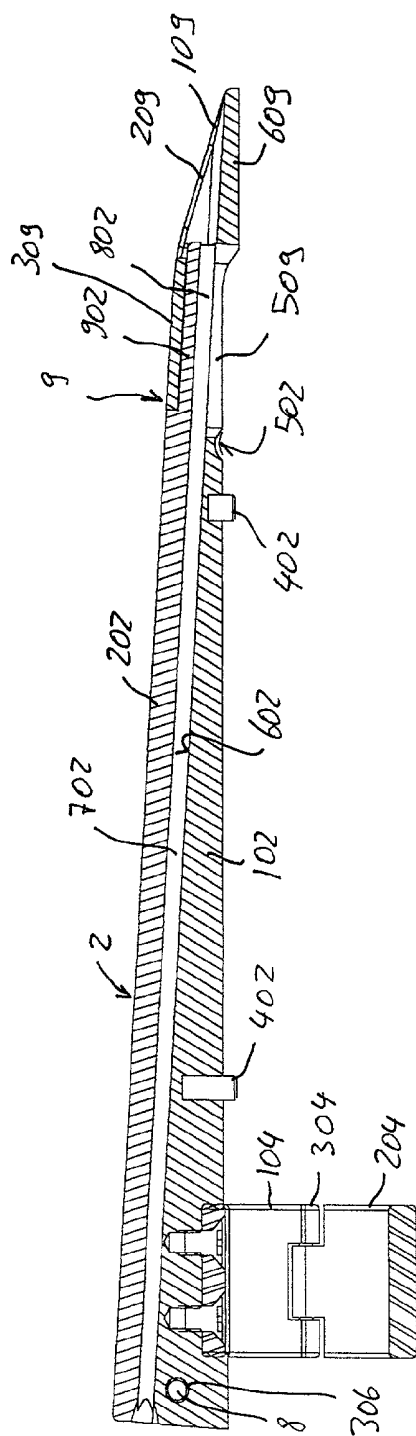

Fig. 10

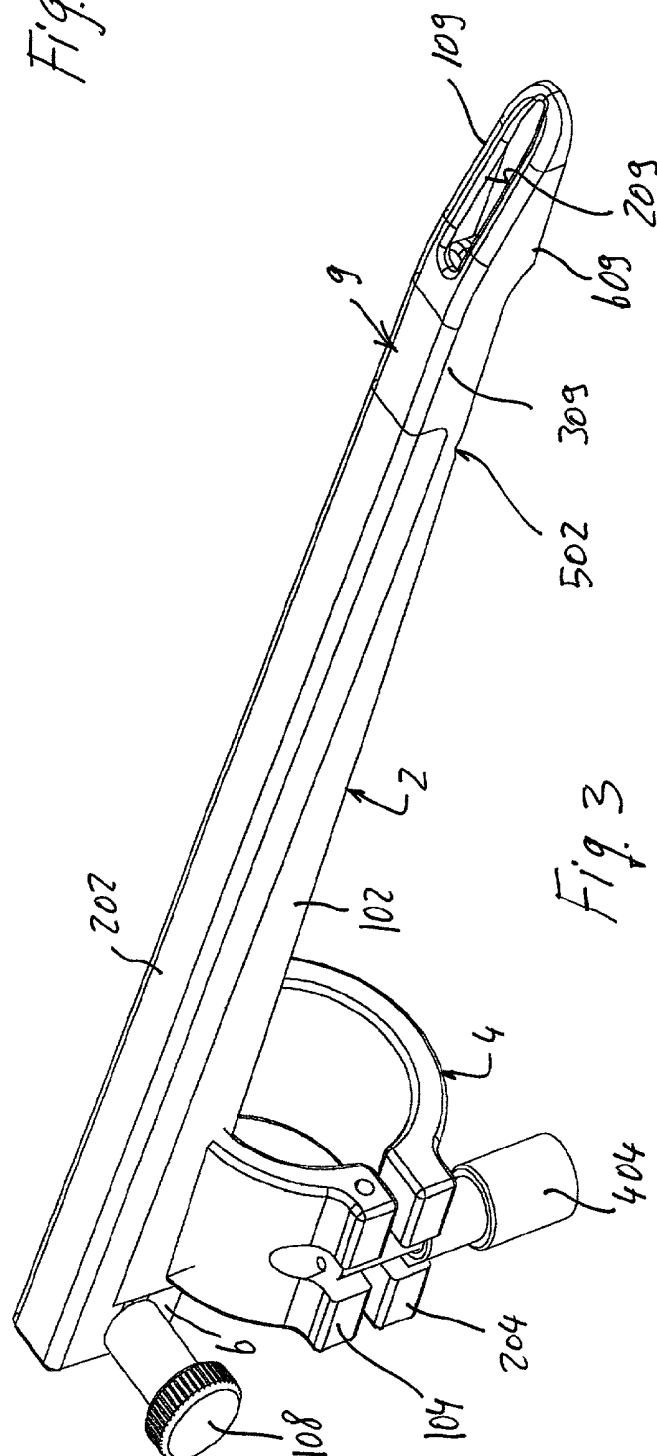
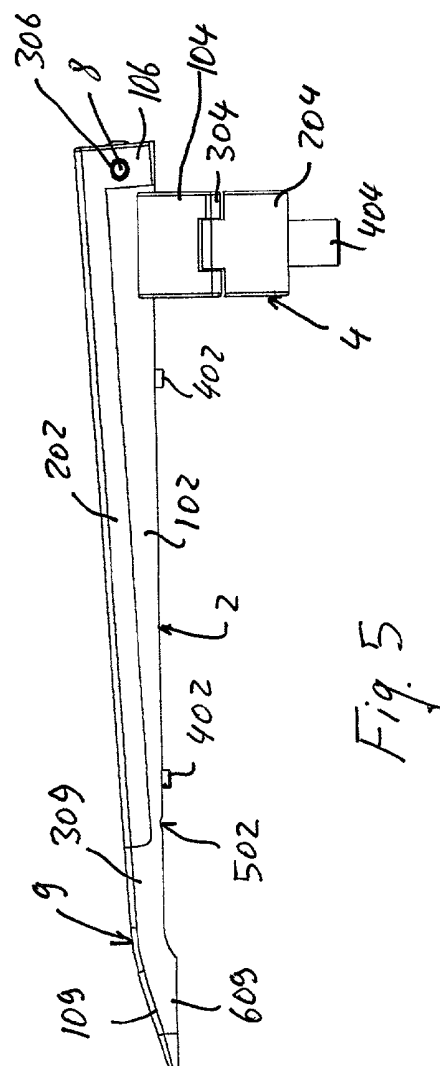
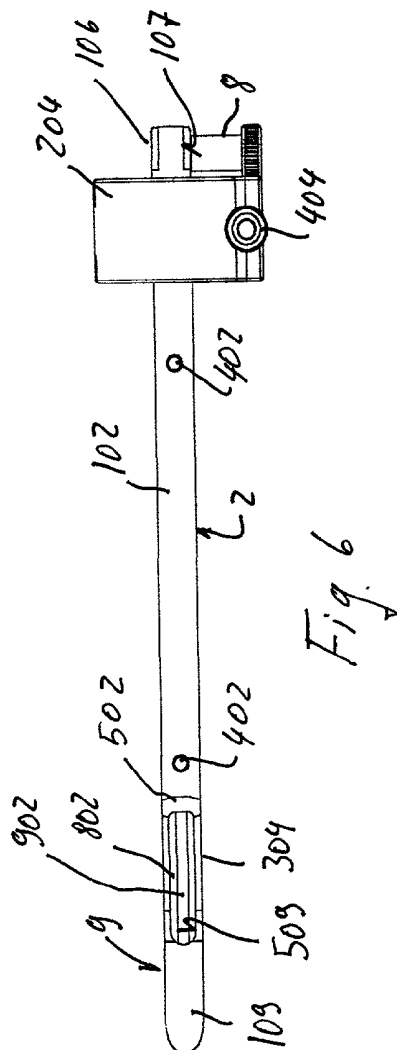
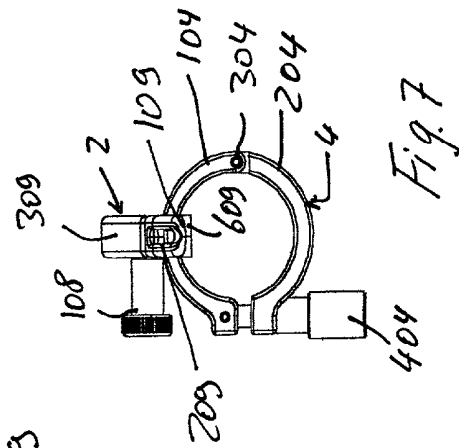
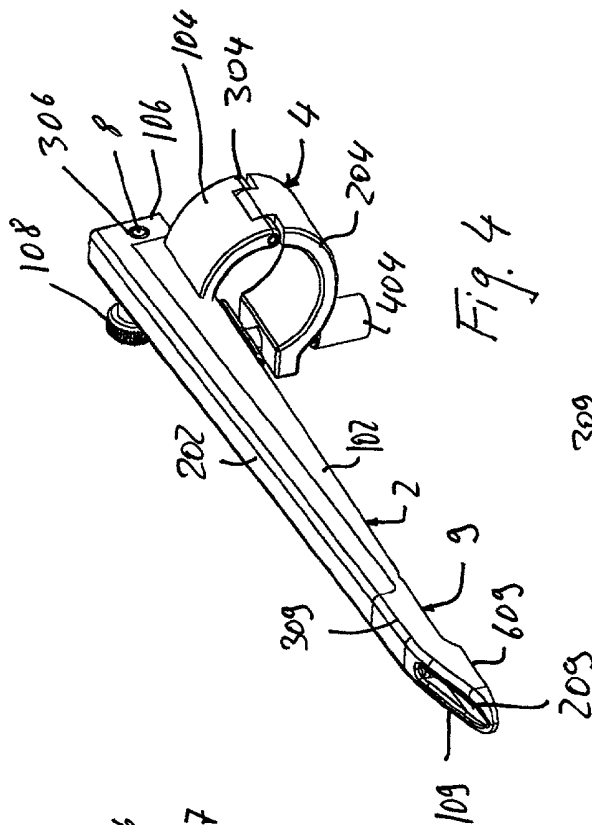
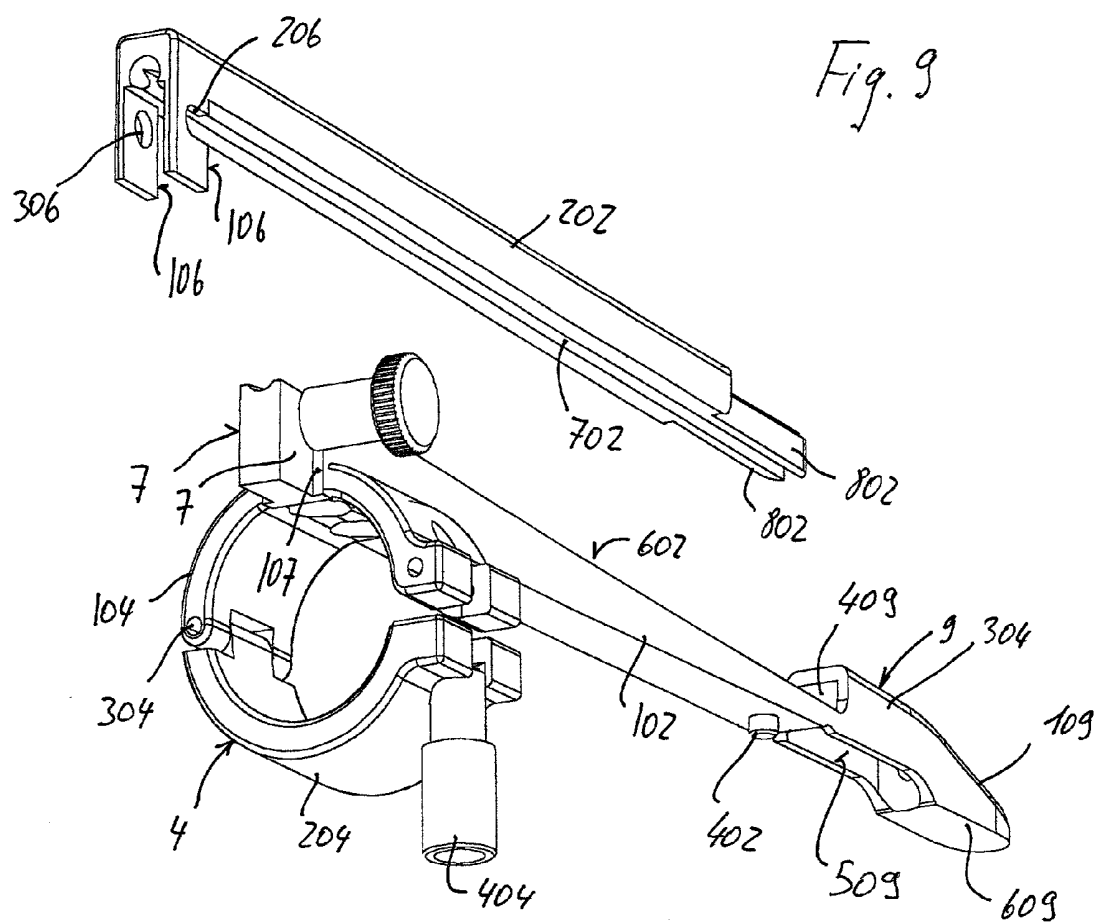
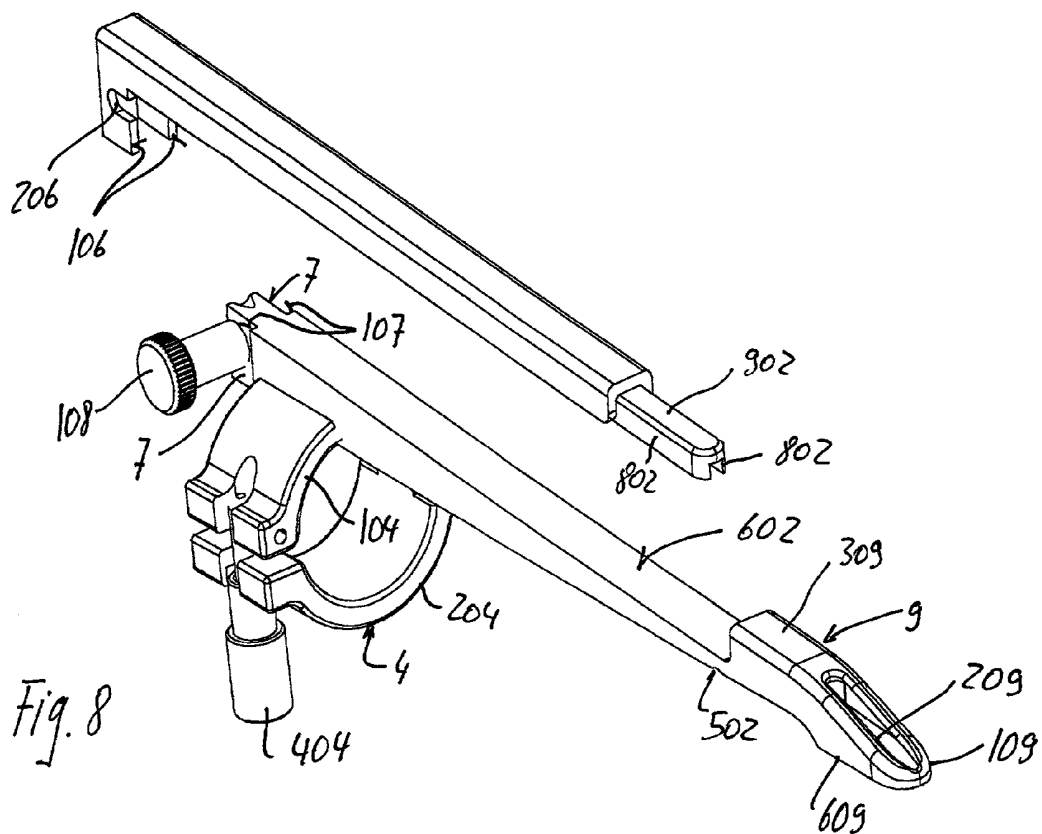
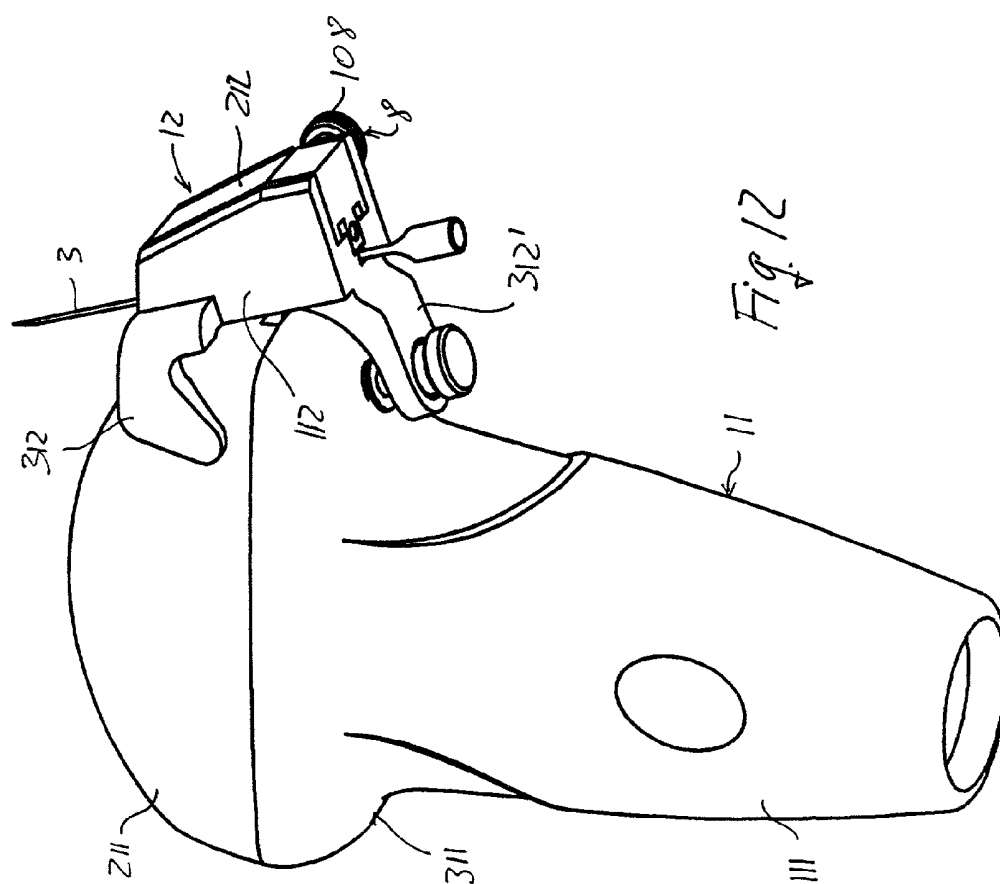
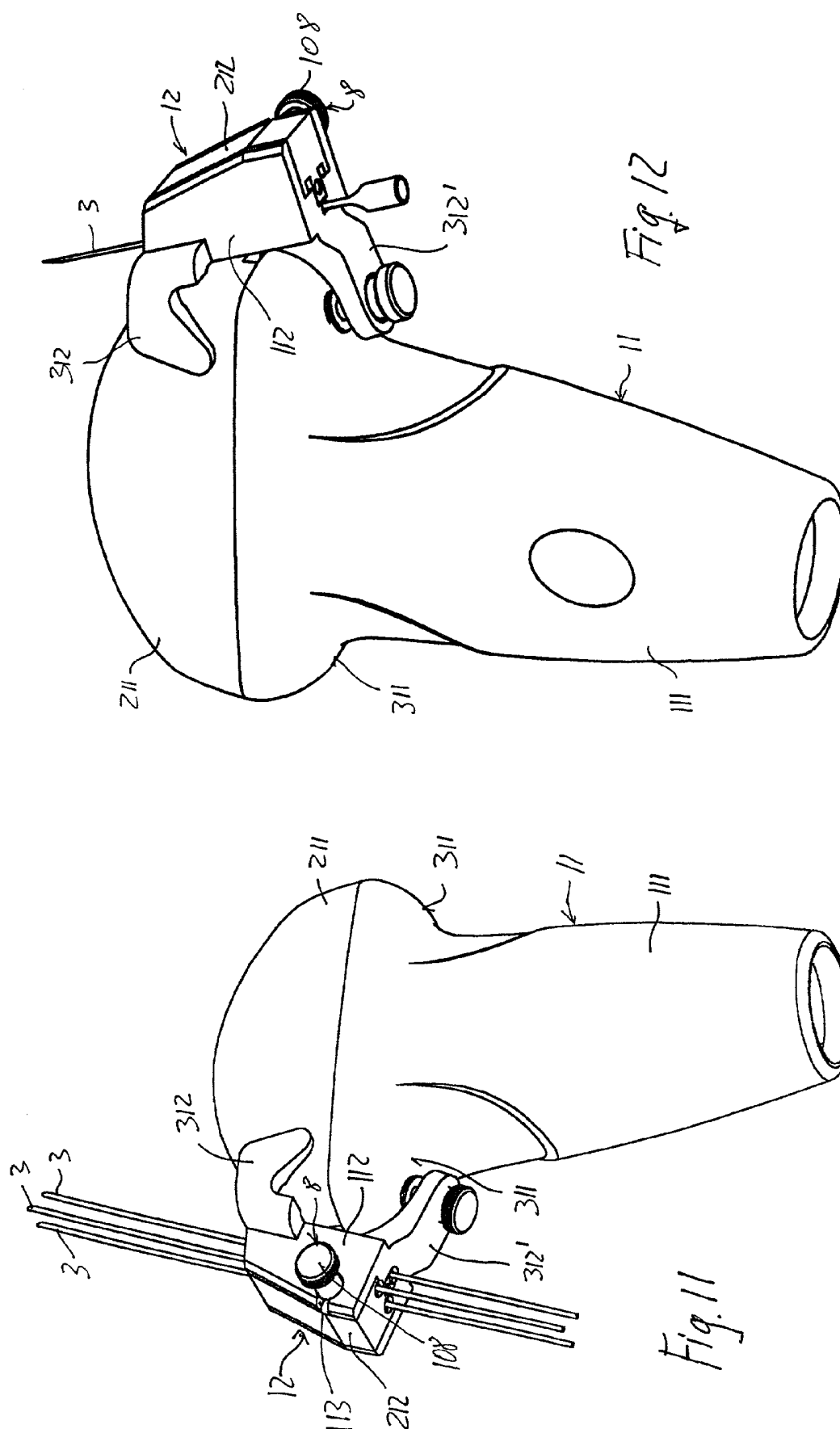

Fig. 3







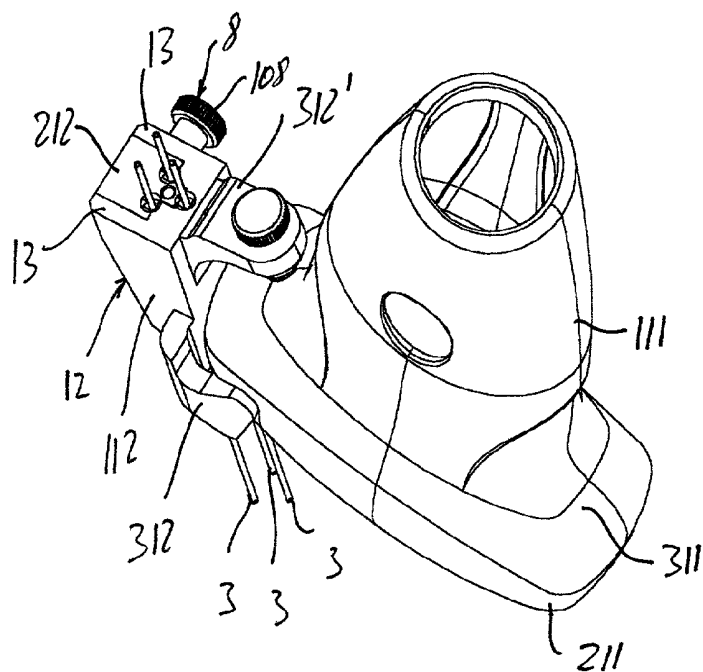

Fig. 14

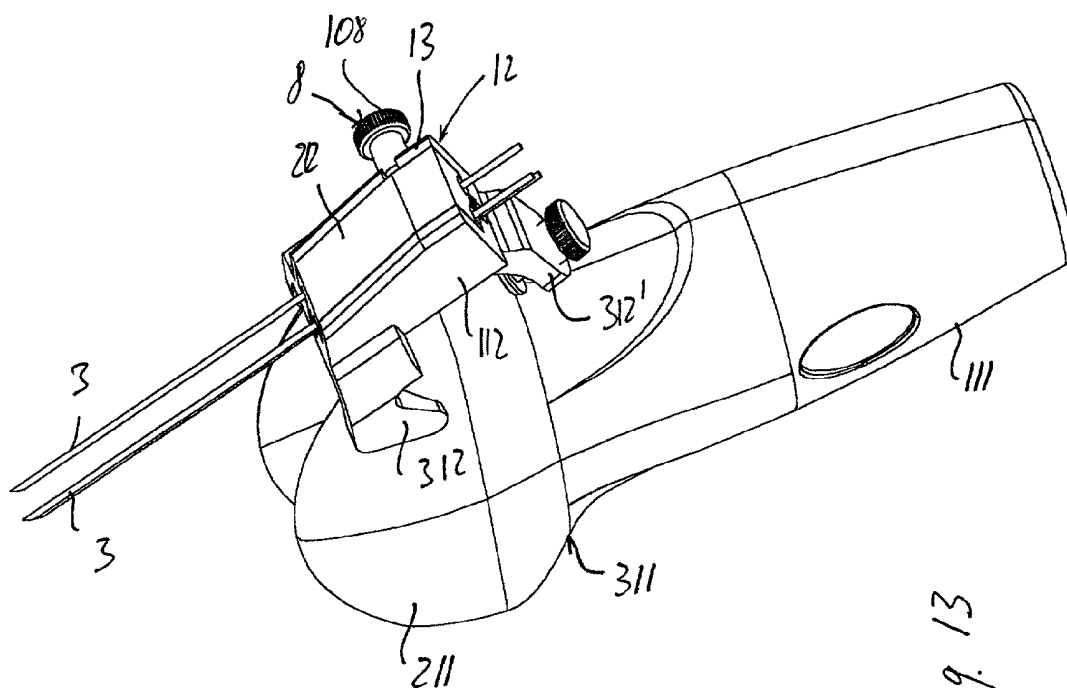

Fig. 13

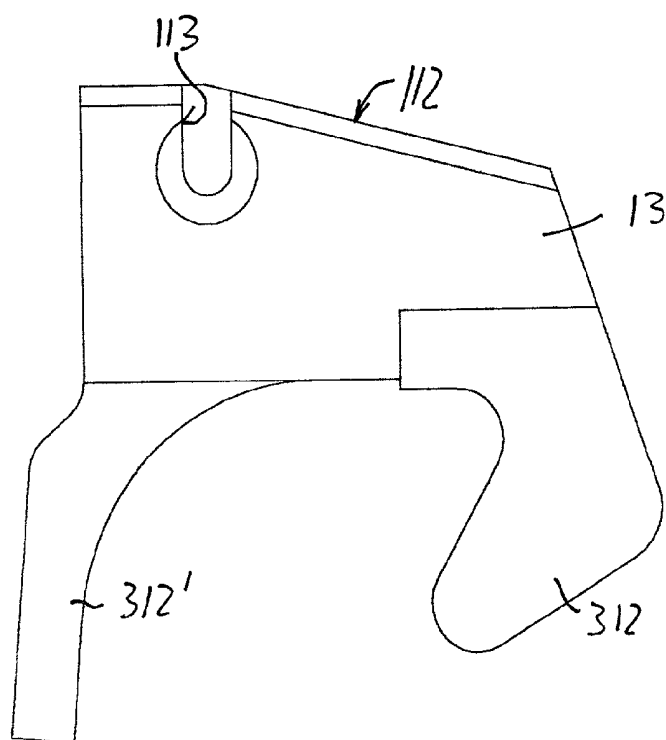

Fig. 15

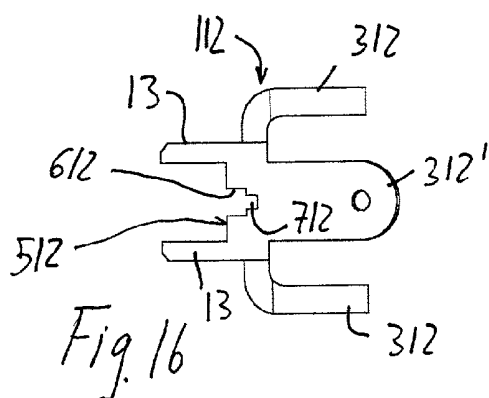

Fig. 16

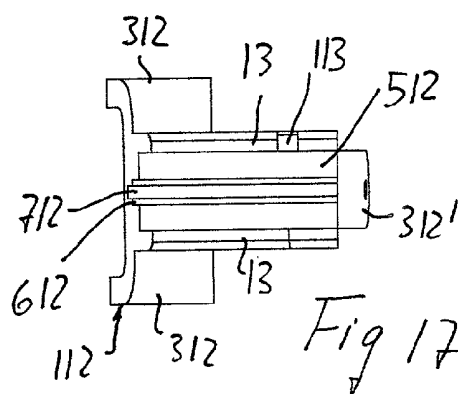

Fig. 17

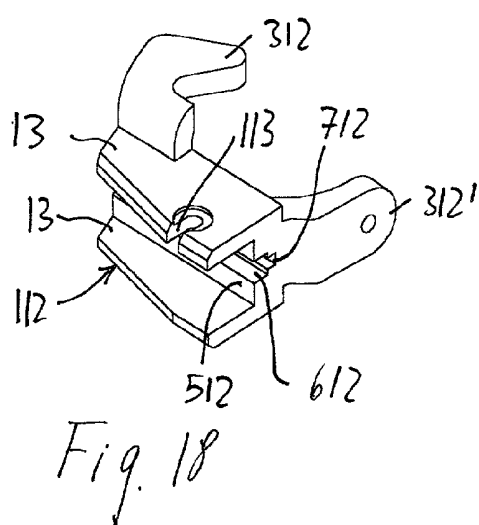

Fig. 18

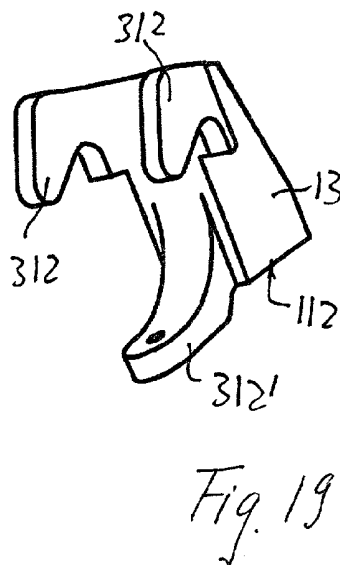
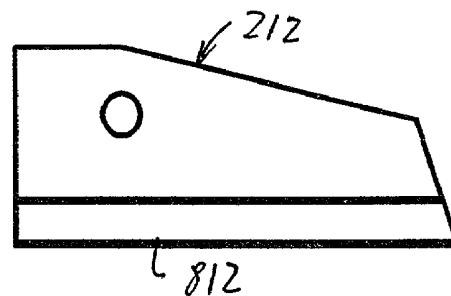
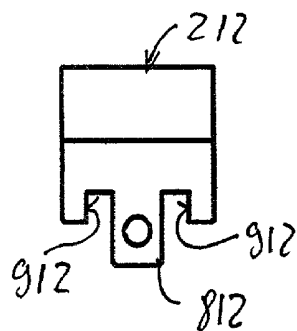
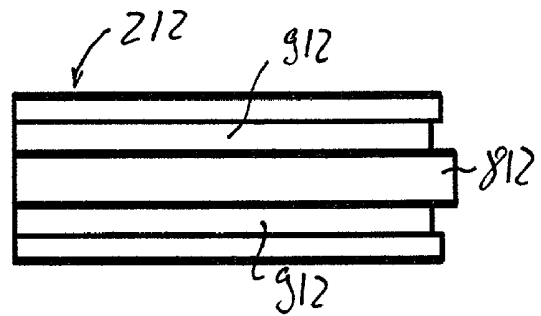
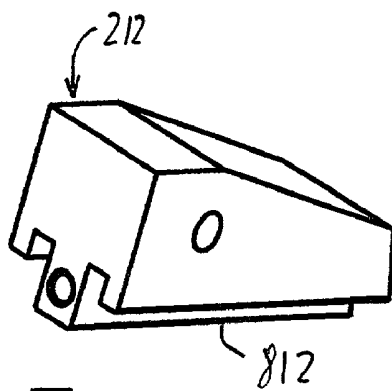
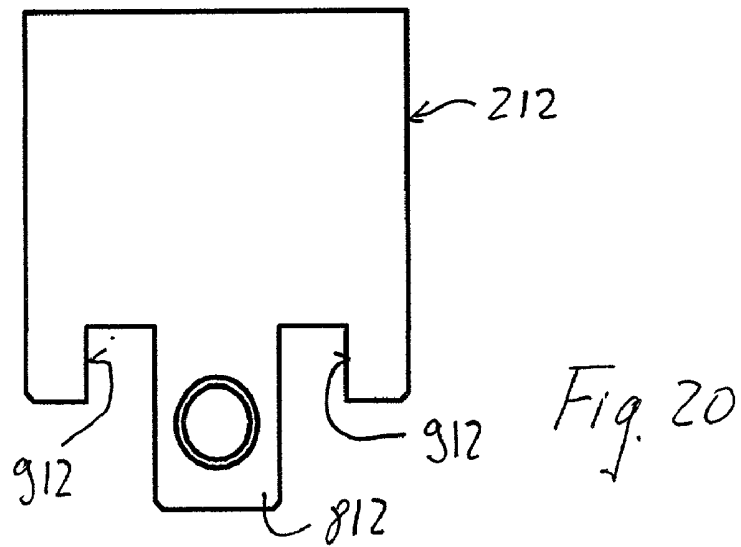

Fig. 19





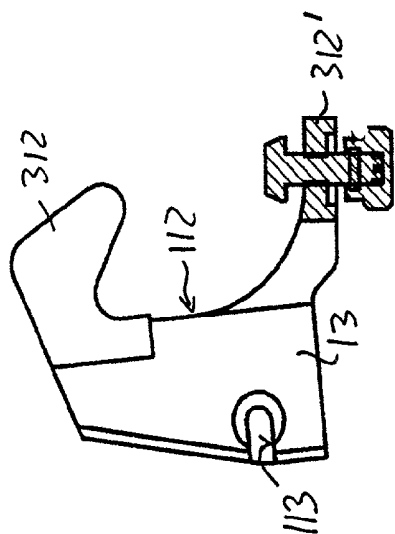

Fig. 25

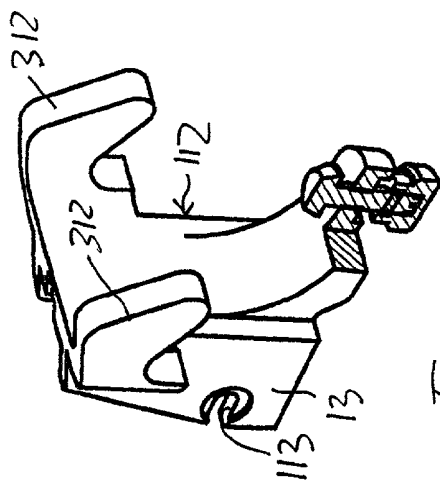

Fig. 26

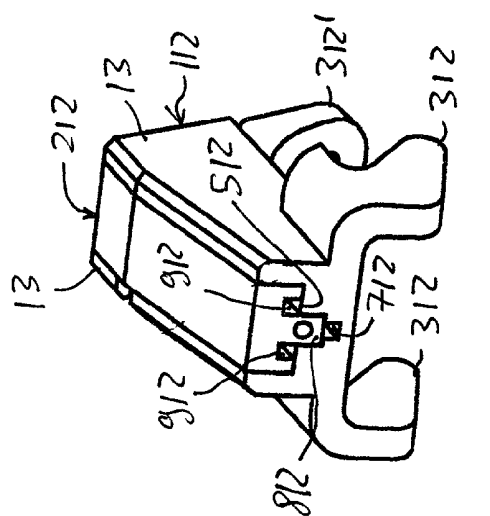

Fig. 27

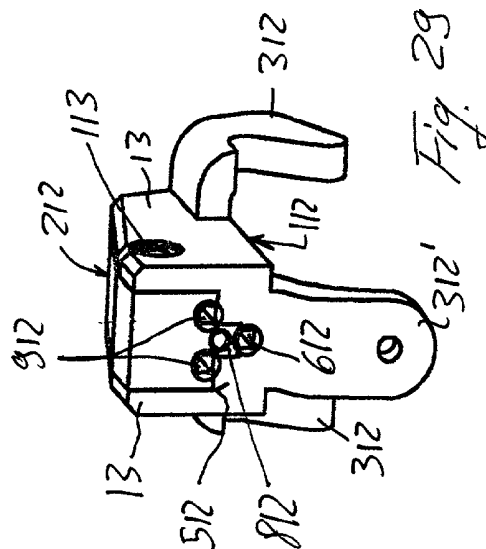

Fig. 28

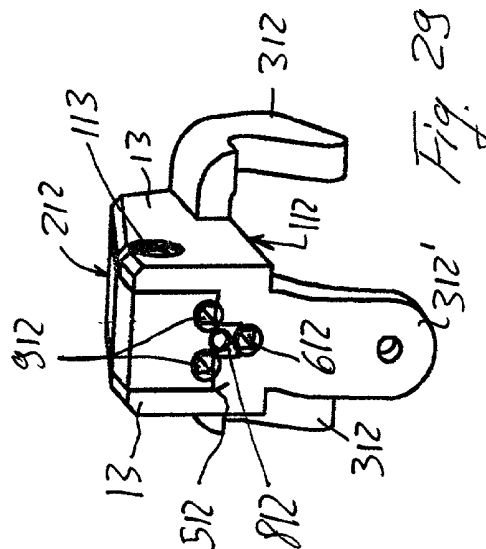

Fig. 29

## NEEDLE-GUIDE DEVICE, PARTICULARLY FOR ULTRASOUND PROBES

### REFERENCE TO RELATED APPLICATION

[0001] The present patent application claims foreign priority benefits under 35 U.S.C. §119 to Italian patent application No. SV2001A000008, filed Mar. 5, 2001, now pending.

### BACKGROUND OF THE INVENTION

[0002] The present invention relates to a needle-guide device, particularly for ultrasound probes, or the like, comprising a base body having means for connection to the probe and at least one elongated guide tube for an elongated, rodlike diagnostic or surgical tool, named needle.

[0003] Such devices are currently used to accurately guide diagnostic or therapeutic tools, such as needles for biopsy, thermoablation, alcoholization or localized injection of substances, especially of chemotherapeutic agents.

[0004] However, the word needle is used in the present description and in claims, to define any diagnostic or therapeutic tool for localized operation, which has a rodlike conformation, for at least a portion of its extension, for instance for a portion of a support stem of the tool.

[0005] Localized applications, such as biopsies, thermoablation or localized injection of therapeutic substances are currently performed in combination with imaging means, and particularly in combination with ultrasound probes. Ultrasonic imaging allows to see the needle, or at least one of the needles and the target region to safely orient and move the needle to the target point.

[0006] The needle/s are moved to their position by appropriately orienting the probe manually or mechanically and/or by sliding them inside a guide seat. Hence, the probe shall have a needle-guide for safely and stably accommodating the needle, thereby avoiding any mutual staggering and wrong positioning or insertion of the needle/s.

[0007] To this end, needle-guide devices such as the one described hereinbefore are known, which comprise an elongated cannula-shaped hole, or the like, wherein the needle is inserted.

[0008] These devices have the drawback of not allowing a sufficiently safe sterilization. In fact, hardly removable microbial residues may infiltrate in the elongated holes or cannulae. For this reason, single-use needle-guides of the above type are currently known, particularly made of plastic. However, this involves some drawbacks. Besides obvious cost drawbacks (considering that stable attachment of ultrasound probes often requires rather complex adaptations of the needle-guides, thereby involving rather high fabrication costs), material waste is caused, with a consequently higher environmental load and the materials in use do not often have a good stability, for instance to thermal action, which is a critical condition, in applications like thermoablation.

[0009] Therefore, the invention has the object of providing a needle-guide such as the one described hereinbefore which, by relatively inexpensive construction arrangements, allows to obviate the drawbacks of prior art needle-guides. Also, the invention has the object of improving needle-

guides to achieve a better functionality with reference to the diagnostic and/or therapeutic techniques which use those tools.

[0010] The invention achieves the above purposes by providing a needle-guide as described hereinbefore, which is made of at least two removably connectable parts, which two parts are shaped in such a manner that each of them forms complementary parts of the peripheral delimiting wall of the elongated hole and/or cannula for the needle (3), which complete each other when said two parts of the needle-guide are connected, thereby forming an elongated hole for guiding the needle or a cannula with a 360° covering delimiting wall.

[0011] Particularly, the two needle-guide parts have mutual abutment surfaces which are tangent or secant to the elongated needle-guiding hole, whereas this hole is obtained by a combination of grooves which are formed either integrally on one of the mutual abutment surfaces of one of the two needle-guide parts or partly on one and partly on the other of the two abutment surfaces of both needle-guide parts.

[0012] The separation plane between the two needle-guide parts is parallel to the axis of the elongated hole and secant or substantially tangent to the hole.

[0013] The elongated needle-guiding hole may be provided with a section corresponding to the outer section of the needle, with the wall of the elongated hole adhering to the whole needle surface.

[0014] Possibly and advantageously, the elongated needle-guiding holes may also have polygonal, particularly square or rectangular sections, said square or rectangular sections having such a size as to be able to inscribe therein the cylindrical or elliptical or oval section of the needle. This provides the advantage of a wider range of position choices for the separation plane between the two needle-guide parts in the elongated hole area, there being no undercut situation if the separation plane intersects the hole with an orientation parallel to at least two sides thereof. Moreover, since the needle has to be held accurately as regards orientation but must be able to slide inside the hole in the direction of its axis, the use of rectangular or square holes limits the contact surfaces between the needle and the guide hole wall to individual tangent lines or bands, thereby obtaining a lower friction between the needle and the hole wall (friction force being also proportional to the contact surface) and an effective and safe hold of the needle in the oriented position.

[0015] According to an advantageous embodiment, the needle guide is composed of at least two removable parts, at least one base part and at least one second part, which two parts are separated from each other by a separation surface whose cross section is a broken rectangular curve, and forms a succession of alternate and parallel complementary engageable ribs, there being provided, in the opposite mutual abutment surfaces of the ribs of one or both of the two needle-guide parts, grooves having such a size and shape as to form together an elongated needle-guiding hole or cannula.

[0016] The broken rectangular line-shaped separation surface between said two needle-guide parts may have variable widths and generate guiding holes with different relative positions.

[0017] Obviously, the needle-guide may be divided in such a manner as to consist of more than two parts, for instance three parts, shaped in such a manner as to form complementary parts of the peripheral delimiting wall of the needle-guiding elongated hole or cannula.

[0018] Advantageously, in a preferred embodiment, the needle-guide is composed of a base for connection to the ultrasound probe, which has at least one longitudinal groove, for engaging longitudinally continuous or discontinuous extensions of the side walls of a longitudinal groove provided in the other needle-guide part. Here, the bottom of the longitudinal groove in the base forms the complementary part for completing the elongated hole or cannula, whose other peripheral walls consist of the bottom of the longitudinal groove of the other needle-guide part, of the side walls of said groove and of the extensions of said side walls of the groove in the second part of the needle-guide.

[0019] By this arrangement, at least but not only in the disassembled condition, the elongated hole is longitudinally completely open, whereby it may be cleaned and sterilized with the highest safety but, unlike the case of the separation plane secant to the elongated hole or cannula and parallel to the longitudinal axis thereof, a perfect mutual centering effect between the two needle-guide parts is ensured, as well as a stable hold of said proper position with reference to transverse staggering.

[0020] Obviously, alternatively to the above, instead of two extensions of the side walls of the longitudinal grooves of the second needle-guide part, the second needle-guide part may be arranged to have a single extension of one of the two side walls of the longitudinal groove, whereas the other extension may be provided on the base part, as an extension of the opposite side wall of the longitudinal groove in the base part of the needle-guide. Here, each of the two parts of the needle-guide forms two of the opposite walls of the elongated hole or cannula.

[0021] The arrangement of the extensions of the side walls of the grooves in the two parts of the needle-guide may be also alternate and complementary over the length of the two extensions in the longitudinal direction of the grooves, either on one side and along the two opposite sides.

[0022] The second part of the needle-guide may be stably and removably secured to the needle-guide base in any manner, and particularly by means of screw-threaded devices, such as fastening bolts, or the like. In a particularly advantageous embodiment, one of the parts of the needle-guide, particularly the base part, has a wall parallel to the connecting direction, i.e. perpendicular to the separation plane, which has a recess for accommodating a fastening bolt which is screwed into a threaded hole formed in the other part, in an adjacent wall, adhering against said wall of the first part of the needle-guide. Alternatively to using bolts, said second part of the needle-guide may have a threaded pin of such a length as to project beyond the wall of the first part, through the recess provided in said wall and onto which threaded pin a nut screw is tightened.

[0023] Alternatively, the two mutually adhering walls of said two parts of the needle-guide may have, the inner one, a threaded hole and the other one a through hole, a threaded bolt with a tightening head being provided to fasten said two walls together.

[0024] According to an additional characteristic, the needle-guide may have a slender or tapering head, particularly having rounded edges, especially being wedge-shaped.

[0025] As a whole, the needle-guide may have a shape tapering toward the front end, especially a wedge shape. This is particularly advantageous in combinations of the above needle-guide with endocavitary probes, such as for uterine biopsy applications or the like.

[0026] In order to limit the presence of discontinuities, which might cause damages or pain to the patient, the front head, also perforated, is arranged to be a single piece, and preferably made of one piece with the base part of the needle-guide.

[0027] In this case, the through hole in said head part is widened on at least one side or for a portion of its inner delimiting surface, the second part of the needle-guide being provided, on its end side, with a wall extension which may be axially fitted in the through hole of the front head, coinciding with said wider portion and complementary thereto so as to complete, even in the front head of the needle-guide, the delimiting wall of the elongated through hole.

[0028] Advantageously, the second part of the needle-guide has said extensions on two opposite sides and in the form of front extension wings of the two side walls of the groove provided in said second part of the needle-guide, whereas the front head of the needle-guide has complementary widened portions in the corresponding walls.

[0029] In a further improvement, the bottom wall of the groove of the second needle-guide part also has an extension wing, the front head of the needle-guide being arranged to be accordingly widened even in the area of said extension wing of the bottom side of the groove of the second needle-guide part.

[0030] The extension wings of the side and/or bottom walls of the groove in the second part of the needle-guide are thinner than the wall of the second part of the needle-guide and than the head of the needle-guide, whereby an abutment step is formed between the front end of the second part of the needle-guide and the facing rear end side of the front head.

[0031] In accordance with an additional advantageous characteristic, the front head of the needle-guide, which is integral with the base part of the needle-guide, has a through aperture which communicates with the elongated hole provided therein at at least one of the sides of said head, preferably at one of the two transverse sides, not coinciding with the extension wings of the second part of the needle-guide and particularly at the side of the base part of the needle-guide which is opposite the second part of the needle-guide and meant to adhere against or turned toward the probe, whereas in the front head, the needle is only substantially guided on three sides and through less than 360° at least in coincidence with the through aperture.

[0032] Advantageously, the front head of the needle-guide is relatively short as compared with the length of the rest of the needle-guide, in which the elongated hole or cannula have a continuous delimiting surface.

[0033] According to a further improvement, the front head of the needle-guide has a steeper tapered front end than the remaining portion of said head on the side connected to the

second part of the needle-guide, whereas in said end portion and in the wall opposite the one with the aperture, the needle projection opening is provided, which takes an elongated shape, and in said end, the elongated hole delimiting walls are continuous and made of one piece, as well as directly accessible from the entry aperture.

[0034] Particularly, said front end of the front head of the needle-guide still has a needle guiding surface on the aperture side opposite to the one wherein the second part of the needle-guide fits, which surface extends from the front end of said aperture to the front apex of the front head.

[0035] As stated above, the needle-guide is designed to be mounted on an ultrasound probe, wherefore the invention also relates to a combination of a needle-guide and an ultrasound probe, wherein the base of the needle-guide is removably attachable to the probe body in a stable and predetermined position, said base having one or more shape mating extensions which adhere to a portion of the outer surface of the ultrasound probe body and/or mutual interlock engagement means, as well as clamping means.

[0036] In one embodiment, the needle-guide as described herein, having a tapered front head is designed to be connected to an endocavitary probe, which typically has a substantially cylindrical or other similar shape, also being elongated and having a rounded head, the base of the needle-guide having a surface whereby it rests on the probe case only in a few partial portions of the longitudinal extension and particularly in the end portions of the base of the needle-guide.

[0037] Further, the facing surfaces of the base of the needle-guide and of the probe case have complementary centering projections and recesses arranged over their length.

[0038] According to an improvement, the probe case may have recesses for accommodating supporting feet or extensions of the base of the needle-guide, provided at least at the ends thereof.

[0039] Particularly, the front head of the needle-guide has a front engagement extension on the side turned toward the probe case, which is designed to engage in a recess of the probe case, in such a manner that the tapered end of said front head can be connected thereto without forming outer steps or discontinuities.

[0040] In this case, since the centering pins and the means for engaging the front head of the needle-guide to the probe are effective position-holding means for the base of the needle-guide, the needle-guide is removably secured to the probe by means of a clamping collar provided at the rear end portion of the needle-guide.

[0041] An additional embodiment of the needle-guide combined with an external ultrasound probe having a bulged shape and a wider head as compared with the handgrip, has a base with two front extensions for resting on preferably symmetrically coincident front widened portions of the bulged shape, and an extension with a fastening screw which overlaps the rear side of the widened head against which the fastening screw is tightened. The fastening action so obtained is substantially concentrated in three points and is highly stable.

[0042] According to a further improvement, the needle-guide may have two, three or more elongated holes or two, three or more elongated guiding cannulae which are arranged in such a manner as to bring at least one of the needles in an ultrasound probe imaging position, whereas the other needle/s have predetermined and fixed positions relative to the former.

[0043] Hence a proper guiding action of the needle set is obtained, and the target area may be widened, for instance for a thermoablation application or for a localized injection of substances.

[0044] Advantageously, the invention proposes that this needle-guide type is also composed of two parts, a separation plane or surface being provided between the at least two parts, which is parallel to the axis of the corresponding elongated hole or cannula, and is secant or at least tangent to the corresponding hole, so that, by the separation between said at least two parts, all the elongated holes or cannulae are longitudinally open on at least one portion of a side.

[0045] Here again combinations of grooves and walls may be provided in said two parts which, by their mutual engagement, simultaneously form the complementary parts of the delimiting surfaces of the two, three or more holes in the needle-guide.

[0046] In an advantageous embodiment which includes three needle guiding elongated holes or cannulae and in which the needle-guide is divided into a base and a second part to be removably fastened to the base, the base of the needle-guide has a groove which accommodates the second part of the needle-guide, and has longitudinal side walls and a bottom wall, whereas an additional narrower groove is provided in the middle of the bottom wall and in turn has an additional groove in its bottom wall, which forms two longitudinal side walls and a longitudinal bottom wall for guiding the needle, whereas the second part of the needle-guide has, on the surface turned toward the bottom of the housing groove, a longitudinal median rib which coincides with the narrower longitudinal median groove in the base part and forms the missing needle guiding surface, completing the surfaces provided in the third groove, whereas, in the surfaces of the second part of the needle-guide, on the two sides of the longitudinal median rib, longitudinal grooves are provided which form, with the facing surfaces of the first groove for accommodating the base part, at the two sides of the median groove, the delimiting surfaces of the two additional needle guiding elongated holes.

[0047] The advantages of the present invention are self-evident from the above description. The needle-guide device may be easily disassembled and allows to access the guiding elongated holes for a complete and safe sterilization. This allows to manufacture reusable needle-guides, from metal materials which do not involve drawbacks in various applications.

[0048] The needle-guide of the invention perfectly fits any application, as proven by the application embodiments to both endocavitary and external probes.

[0049] It shall further be noted that the individually described characteristics may be provided in any combination, even regardless of the individual specific embodiments.

[0050] The invention relates to further improvements which will form the subject of the appended claims.

## SUMMARY OF THE INVENTION

[0051] A needle-guide device, particularly for ultrasound probes, according to one embodiment of the present invention comprises a base body having means for connection to an ultrasound probe and at least one elongated guide tube for an elongated, rodlike diagnostic tool characterized in that the needle-guide is made of at least two removably connectable parts which are shaped in such a manner that each of them forms complementary parts of a peripheral delimiting wall of an elongated hole for cannula for the needle which peripheral wall parts complete each other when the two parts of the needle-guide are connected, thereby forming the elongated hole for guiding the needle (or cannula) with a 360 degree covering delimiting wall.

[0052] A needle-guide device, particularly for ultrasound probes, according to another embodiment of the present invention comprises a base body constructed and arranged for connection to a probe and at least one elongated guide tube for an elongated, rodlike diagnostic tool, characterized in that the needle-guide device has a plurality of elongated holes or a plurality of cannulae for guiding a plurality of needles or rod-like tools which are arranged with their axes coincident with a single plane or having axes arranged on more than one plane, particularly having hole axes arranged at the vertices of ideal polygonal elements, such as triangles, quadrilaterals, or the like, or in any other different mutual arrangement.

[0053] A combination of a needle-guide device and an ultrasound probe according to another embodiment of the present invention comprises a hand grip portion characterized in that a base of the needle-guide is removably attachable to a body portion of the probe in a stable and predetermined position, the base having one or more shape mating extensions which adhere to a portion of the outer surface of the ultrasound probe body and mutual interlock engagement features and clamping means.

[0054] One object of the present invention is to provide an improved needle-guide device for an ultrasound probe as well as a needle guide device in combination with an ultrasound probe.

[0055] Related objects and advantages of the present invention will be apparent from the following description.

## BRIEF DESCRIPTION OF THE DRAWINGS

[0056] FIG. 1 is a perspective view of the rear side of an endocavitary ultrasound probe, where to a needle-guide according to a first embodiment of the invention is connected.

[0057] FIG. 2 is a sectional view of a detail of the probe as shown in FIG. 1, with a needle-guide as shown in FIG. 1 connected thereto.

[0058] FIG. 3 is a perspective view of the needle-guide only, as shown in the previous Figures, and as seen from the front side.

[0059] FIG. 4 is a perspective view of the needle-guide as shown in FIG. 3, and as seen from the other side.

[0060] FIG. 5 is a bottom plan view of the FIG. 3 needle-guide.

[0061] FIG. 6 is a side elevational view of the FIG. 3 needle-guide.

[0062] FIG. 7 is a rear elevational view of the FIG. 3 needle-guide.

[0063] FIG. 8 is a perspective view like that of FIG. 3, in which the two parts of the needle-guide are shown separately, in exploded view form.

[0064] FIG. 9 is a perspective view of the rear side of the two parts of the needle-guide, shown in FIG. 8.

[0065] FIG. 10 is a sectional view as seen through a median plane passing through the axis of the needle and/or of the elongated guiding hole.

[0066] FIG. 11 is a perspective view of an additional embodiment of the probe/needle-guide combination according to the invention, particularly in which the probe is an external probe with a head shaped as a sector of a circle and wider than the handgrip.

[0067] FIG. 12 is a perspective view of an additional embodiment of the probe/needle-guide combination according to the invention, particularly in which the probe is an external probe with a head shaped as a sector of a circle and wider than the handgrip.

[0068] FIG. 13 is a perspective view of an additional embodiment of the probe/needle-guide combination according to the invention, particularly in which the probe is an external probe with a head shaped as a sector of a circle and wider than the handgrip.

[0069] FIG. 14 is a perspective view of an additional embodiment of the probe/needle-guide combination according to the invention, particularly in which the probe is an external probe with a head shaped as a sector of a circle and wider than the handgrip.

[0070] FIG. 15 is a side elevational view of the base part of the needle-guide as shown in FIGS. 11 to 14.

[0071] FIG. 16 is a bottom plan view of the base part of the needle-guide as shown in FIGS. 11 to 14.

[0072] FIG. 17 is a top plan view of the base part of the needle-guide as shown in FIGS. 11 to 14.

[0073] FIG. 18 is a top perspective view of the base part of the needle-guide as shown in FIGS. 11 to 14.

[0074] FIG. 19 is a bottom perspective view of the base part of the needle-guide as shown in FIGS. 11 to 14.

[0075] FIG. 20 is a front elevational view of the second part of the needle-guide as shown in FIGS. 11 to 14.

[0076] FIG. 21 is a front perspective view of the second part of the needle-guide as shown in FIGS. 11 to 14.

[0077] FIG. 22 is a top plan view of the second part of the needle-guide as shown in FIGS. 11 to 14.

[0078] FIG. 23 is a front elevational view of the second part of the needle-guide as shown in FIGS. 11 to 14.

[0079] FIG. 24 is a side elevational view of the second part of the needle-guide as shown in FIGS. 11 to 14.

[0080] FIG. 25 is a perspective view of the needle-guide as shown in FIGS. 11 to 14.

[0081] FIG. 26 is a perspective view, in partial section, of the needle-guide as shown in FIGS. 11 to 14.

[0082] FIG. 27 is a side elevational view, in partial section, of the needle-guide as shown in FIGS. 11 to 14.

[0083] FIG. 28 is a perspective view of the needle-guide as shown in FIGS. 11 to 14.

[0084] FIG. 29 is a perspective view of the needle-guide as shown in FIGS. 11 to 14.

#### DESCRIPTION OF THE PREFERRED EMBODIMENT

[0085] For the purposes of promoting an understanding of the principles of the invention, reference will now be made to the embodiments illustrated in the drawings and specific language will be used to describe the same. It will nevertheless be understood that no limitation of the scope of the invention is thereby intended, such alterations and further modifications in the illustrated device, and such further applications of the principles of the invention as illustrated therein being contemplated as would normally occur to one skilled in the art to which the invention relates.

[0086] Referring to FIGS. 1 to 10, the invention is shown in the form of a combination of a needle-guide 2 and an endocavitary probe 1. The probe 1 has a substantially cylindrical shape with a handgrip portion 101 and a head 201 which contains the ultrasonic pulse emitting and receiving transducers.

[0087] The needle-guide 2 has an elongated shape with a wedge-shaped profile tapering from back to front and is composed of two connectable and separable and removably fastenable parts 201, 202, i.e. a base part 102 and a second part 202. The two parts define an elongated through hole which extends all along the needle-guide 2 from the rear end to the front head 9 thereof. The elongated hole is designed to accommodate a rodlike tool 3 for diagnostic or therapeutic applications, particularly a biopsy needle, a thermoablation needle, or a needle for injecting chemotherapeutic agents, or the like. The elongated hole has such a size, as related to the diameter of the needle 3 as to be able to hold the needle 3 in the proper position and to allow it to be axially displaced inside the needle-guide 2.

[0088] The needle-guide 2 is disposed with its longitudinal axis having the same front-to-back orientation as the needle in relation to the probe, in the front-to-back direction of the probe 1. Also, the elongated hole for guiding the needle 3 has such an inclination as related to the axis of the probe 1, that the front end of the needle falls within the target scan area of the probe 1 to be imaged during use.

[0089] Advantageously, the inclination of the hole for guiding the needle 3 substantially corresponds to the inclination of the free inclined end of the second needle-guide part 202. This provides a visual impression of needle inclination and facilitates the fabrication of the second needle-guide part.

[0090] The base 102 of the needle-guide has a clamping collar 4 at the rear end (with reference to the head 201 of the probe 1), one half 104 thereof being integral with said base 102, whereas the other half 204 of the collar 4 is hinged in 304 to an end of said first half 104, and the two opposite free

ends of the halves 104, 204 may be clamped together by screw threaded means 404 in a manner which is typical for clamping collars.

[0091] On the lower side resting on the probe 1, the base 102 has means 402, 502 for centering and positioning it on the probe, consisting of ridges or pins which cooperate with coincident recesses or notches 401 formed on the outer body of the probe 1. Possibly, the centering means 402, 502 have such a height as to keep the side of the base 102 turned toward the probe case slightly raised therefrom.

[0092] The base 102 has a surface 602 for supporting the second part 202 of the needle-guide, whereas the second part 202 of the needle-guide has a central groove 702 which is open toward said support surface 602. The second part 202 of the needle-guide has tapered extensions 802, 902 of the delimiting walls of the groove 702 at its front end. The extensions 802, 902 are externally tapered and extend flush with the inner delimiting sides of the groove 702, while forming an outer step 5 with the end side of the second part 202 of the needle-guide.

[0093] The second part 202 of the needle-guide has, at its rear side, two lateral lower wings 6, which rest on the two appropriately recessed corresponding opposite sides 7 of the rear side of the base 102. The lateral lower wings 6 and the rear recesses 7 have facing end sides 106, 107 which form axial abutment surfaces for the needle between the two needle-guide parts 102, 202.

[0094] In one of the two lateral recessing surfaces 7 of the base part 102, a threaded hole is provided into which a threaded pin 8 with a tightening head is screwed. The corresponding wing 6 of the second part 202 of the needle-guide 2 has a recess 206 open on the side turned toward the front end of the needle-guide 2 and coincident with the threaded hole, in which the threaded pin 8 is engaged, thereby allowing the two parts of the needle-guide 2 to be mutually clamped. In accordance with an improvement, the threaded hole for the threaded pin 8 is a through hole and the opposite wing 6 of the second part 202 of the needle-guide also has a coincident hole for engaging the end of the threaded pin 8. The latter is of such a length that, in the clamped position, it is engaged in the hole 306 of the wing 6 without projecting therefrom, and also remains partly engaged in said hole 306 in an incomplete clamping position of the threaded pin 8.

[0095] The base part 102 of the needle-guide 2 has a front head at the front end, which is made of one piece therewith. The head 9 has a steeper front portion 109, in which a projection opening 209 for the needle 3 is provided, which takes a slot-like shape due to inclination. The steeper portion 109 is followed by a portion 309 having an inclination corresponding to that of the second part 202 of the needle-guide when it is mounted on the base 102. This portion 309 has substantially the same length as the extensions 802, 902 of the walls of the groove 702 in the second part 202 of the needle-guide. The front head 9 has a hole 409 for engaging said extensions, whose internal shape is complementary to the external shape of the extensions, whereas the end edge of the second part 202 of the needle-guide 2 forms a shoulder for abutment against the rear end side of the front head 9 and is connected thereto for a substantially flush completion thereof.

[0096] A slot-like aperture 509 is provided on the front head side 9 turned toward the probe 1 and lying over the

open side of the extension of the groove **702**, coincident with said extension, which aperture extends transversely all along the engagement hole **409** of the front head **9**. At the more tapered end **109** of the front head **9**, the side turned toward the probe **1** is closed and is completely accessible from the needle projection hole which, due to the inclination in the corresponding side has the shape of a slot. Further, at said end side **109**, the front head **9** has an extension **609** toward the probe **1** which is designed to be engaged in a complementary recess **501** formed in the case of the probe **1**. The depth of the recess and the profile of the probe and of the front portion **109** of the head **9** of the needle-guide are such that, in the assembled position, the steeper front side **109** of said front head is joined to the outer surface of the case of the probe **1** substantially without forming any step therewith, and being connected therewith in a substantially harmonic manner.

[0097] In the embodiment as shown in the Figures, the separation plane between the two parts **102**, **202** of the needle-guide **2** is substantially tangent to the lower side of the hole for guiding the needle **3**, which is formed by the side for supporting the second part **202** of the needle-guide **2** on the base part **102** of the needle-guide **2**. This plane may be also arranged to be secant to the position of the elongated hole for guiding the needle **3**, and in this case, a portion of the groove **702** must be obviously also provided in the surface of the base part **102** against which the second part **202** rests.

[0098] Moreover, in this embodiment, the mutual position of the two needle-guide parts is maintained by complementary engagement means transverse to the needle axis, on the rear side of the needle-guide, from the end engagement between the two needle-guide parts to the front end.

[0099] According to a possible variant, which will be explained more clearly in the description of the next embodiment, the separation plane between the two needle-guide parts may also have a square wave profile, as related to the cross section of the needle-guide.

[0100] Here, for example, extensions may be provided not only for the front end of the second part **202** of the needle-guide **2**, but also for the side walls of the groove **702**, in this case forming ribs which project on both sides of the groove, toward the surface resting on the base **102** of the needle-guide **2**. The base may have a groove of such a width and depth as to accommodate in a substantially accurate manner the two ribs extending from the side walls of the groove **702**, which form the bottom of the groove in the base **102**, and the wall for completing and/or closing the elongated needle guiding hole. The whole may be dimensioned in such a manner that the lumen and size of said elongated hole for guiding the needle **3** has the necessary size to accommodate the needle safely and possibly in an axially slidable manner. As stated above, other variants are also possible, e.g. one of the two ribs extending from the side walls of the groove **702** may be integral with the second part **202** of the needle-guide **2** while the other is integral with the base **102** of the needle-guide **2**, or longitudinally discontinuous ribs may be provided on both parts **102**, **202**, alternating in such a manner as to be mutually engaged in a comb-like arrangement.

[0101] FIGS. **11** to **19** show an additional embodiment of a combination of a probe **11** and a needle-guide **12** according to the invention.

[0102] Referring to this embodiment, the probe **11** is of the type ordinarily in use for external imaging applications and has a handgrip part **111** and a widened head **211**, which is curved on the front side and bulged in the direction of the axis of curvature, and forms a transverse shoulder on the rear side **311** for connection to the handgrip **111**.

[0103] The needle-guide **12** is still composed of two parts, a base part **112** and a second part **212** which is removably securable to the base **112** and forms needle guiding holes therewith.

[0104] The base **112** has means for securing it to the probe **11**, which consist of two lateral front wings **312** which are shaped in such a manner **11** as to adhere to the bulged portion of the case of the probe **11** in the end tapered portion thereof and on the two opposite surfaces with reference to the axis of curvature of the head of the probe **11**. The base **112** has on its rear side a rear extension **312'** which extends behind the shoulder **311** formed by the widened head of the probe **11**, and the rear extension **312'** has a threaded clamping bolt which is tightened against said shoulder **311**.

[0105] Also, other connection means may be provided, not shown in the Figures, like those described in the previous embodiment, such as combinations of centering ridges and recesses over the case of the probe **11** and the base **112**, as well as possible profiles of the case and of the wall of the base **112** turned toward it to define a certain orientation angle for the needles, to allow at least one of the needles **3** to be brought inside the scan area.

[0106] The needle-guide **12** is made in such a manner as to have three needle guiding holes and to be able to house three needles **3** at the same time. If the needles **3** were disposed all on the same plane, then the needle-guide **12** might have substantially the same construction as that of the needle-guide **2** of the previous embodiment.

[0107] However, in this embodiment the needles are in such a relative arrangement that their axes are coincident with the vertices of a triangle, particularly an isosceles or equilateral triangle. Therefore, the axis of one needle guiding hole is not on the same plane as the other two holes.

[0108] In order to ensure, nevertheless, that the needle guiding holes are at least partly openable on one side, by simply separating the two parts **112**, **212** of the needle-guide, the separation surface has a cross section shaped like a rectangular curve.

[0109] The base **112** has a groove **612** in the middle position of the surface **512** for supporting the second removable part **212** of the needle-guide. In the bottom wall of said groove **612** an additional parallel groove **712** is provided, which has a proper size for the needle guiding hole, whereas the second removable part **212** of the needle-guide **12** has a rib **812** in a position coinciding with the groove **612**, which engages in the groove **612** when said two parts **112**, **212** are mutually connected, and forms the missing closing side of the guiding hole with the edge turned toward the inner groove **712**.

[0110] The other two guiding holes are formed by two grooves **912** formed in the two abutment surfaces of the second removable part **212** against the facing surfaces of the base **112**, which are disposed on the two sides of the rib **812**. Said two grooves **912** have such a depth and such a width



that, like the groove **712**, form the two additional guiding holes, with the abutment surfaces **512** on the base part **112**.

[0111] Obviously, the size of the rib **812** and of the groove **612** are such that, when said rib **812** abuts against the bottom of the groove **612**, the abutment surfaces with the grooves **912** also abut against the surfaces **512** of the base part.

[0112] In the end walls of the area of the rib **812**, niches or recesses **912** may be provided, for instance for gripping purposes.

[0113] As is apparent from the above, the inventive principle allows to provide different configurations of several substantially parallel needle-guiding holes, having any different position.

[0114] In order that the second removable part **212** of the needle-guide **12** may be held in position on the base **112**, the latter has side walls **13** which overlap the side walls of the second part **212** of the needle-guide. The two parts may be fastened in a substantially identical, through reverted manner, with respect to the previous embodiment. One of the side walls of the second part **212** of the needle-guide has a threaded hole into which a threaded pin **8**, having a widened head **108** may be screwed, whereas, in a coincident position, the corresponding side wall **12** of the base part **112** has a recess for engaging the pin which is open on the side in which said second part **212** of the needle-guide is introduced between the walls **13** of the base part **112** of the needle-guide.

[0115] Once again, in this example, the hole into which the pin is screwed may be a through hole and the side wall **13** on the side opposite to the one through which the pin **8** is screwed may have a coincident hole in which the end of the threaded pin is engaged in the same manner as in the previous embodiment when the two parts are clamped or almost clamped together.

[0116] It shall be noted that, when needed, the three-needle configuration of the needle-guide **12** may be extended without requiring any inventive activity to the endocavitary probe-specific embodiment, described with reference to FIGS. **1** to **10**, the front head part of the needle-guide being easily changeable by anyone skilled in the art.

[0117] The inclination of the three needles, and their mutual position are such that one needle is situated closer to the probe and in such a position as to be able to enter the scan field thereof. The other two needles are beyond said scan field, but have a well defined and predetermined position. Particularly, the arrangement of the axes of the three needles at the vertexes of a triangle allows to easily locate the other two needles when the first is imaged upon scanning and also allows to perform a local treatment over a wider area. It shall be also noted that the provision of several needle guiding holes allows the combined use of a greater number of therapeutic and diagnostic tools, thereby allowing both a combination of therapeutic and/or surgical actions and the use of additional control probes near the therapeutic or surgical action area, to improve monitoring of the operations, both visually, by ultrasound imaging, and by detecting additional measurable parameters.

[0118] Moreover, the grooves which generate the guiding holes in combination with the facing abutment surfaces on

the other part of the needle-guide **12** may be provided, for the same hole, on the one or the other of the two parts of the needle-guide and may also have extensions of the side walls, as described in the previous embodiment, any combination or subcombination of the characteristics described with reference to one embodiment with one or more characteristics or with subcombinations or with the complete combination of characteristics described with reference to the other embodiment as illustrated and described in the present disclosure being allowed.

[0119] The invention is not limited to the embodiments described and illustrated herein, but may be widely varied, especially as regards construction, without departure from the guiding principle disclosed above and claimed below. So, for example, while the needle-guides of the invention are described and shown in combined applications with ultrasound probes, they may be also used with other probes or other therapeutic or diagnostic tools.

1. A needle-guide device, particularly for ultrasound probes, or the like, comprising a base body having means for connection to the probe and at least one elongated guide hole for an elongated, rodlike diagnostic or surgical tool, characterized in that said needle-guide device (**2**, **12**) is made of at least two removably connectable parts (**102**, **112**; **202**, **212**), which are shaped in such a manner that each of them forms complementary parts (**602**, **702**; **512**, **612**, **712**, **812**, **912**) of the peripheral delimiting wall of said elongated guide hole for a needle (**3**), which peripheral wall parts (**602**, **702**; **512**, **612**, **712**, **812**, **912**) complete each other when said two parts (**102**, **112**; **202**, **212**) of the needle-guide device (**2**, **12**) are connected, thereby forming said elongated guide hole for guiding the needle with a 360 degree covering delimiting wall.

2. A needle-guide device as claimed in claim 1, characterized in that the two parts (**102**, **112**, **202**, **212**) of the needle-guide device (**1**, **12**) have mutual abutment surfaces (**602**, **512**, **812**) which are tangent or secant to the elongated guide hole for guiding the needle (**3**), whereas said elongated guide hole is obtained by a combination of grooves (**702**, **612**, **712**, **912**) which are formed either integrally on one of the mutual abutment surfaces of one of the two parts (**102**, **112**, **202**, **212**) of the needle-guide device (**2**, **12**) or partly on one and partly on the other of the two abutment surfaces of both parts of the needle-guide device.

3. A needle-guide device as claimed in claim 1 or 2, characterized in that the separation plane between the two parts of the needle-guide device (**2**, **12**) is parallel to the axis of the elongated guide hole and secant or substantially tangent to the hole.

4. A needle-guide device as claimed in one or more of the preceding claims, characterized in that said elongated guide hole has a section which corresponds to the outer section of the needle, with the wall of the elongated guide hole adhering to the whole needle surface.

5. A needle-guide device as claimed in one or more of the preceding claims 1 to 3, characterized in that said elongated guide hole has polygonal sections, particularly square or rectangular sections, said square or rectangular sections having such a size as to be able to inscribe therein the cylindrical or elliptical or oval section of the needle and generating needle-guiding surfaces tangent to the outer surface of the needle.

6. A needle-guide device as claimed in one or more of the preceding claims, characterized in that the needle-guide device (2, 12) is composed of at least two removable parts, at least one base part (102, 112) and at least one second part (202, 212), which two parts are separated from each other by a separation surface (512, 612, 812) whose cross section is a broken rectangular curve, and forms a succession of alternate and parallel complementary engageable ribs, there being provided, in the opposite mutual abutment surfaces of the ribs of one or both of the two parts (102, 112, 202, 212) of the needle-guide device (2, 12) grooves (712, 912) having such a size and shape as to form together said elongated guide hole.

7. A needle-guide device as claimed in claim 6, characterized in that the broken rectangular line-shaped separation surface between said two parts of the needle-guide (2, 12) has constant or variable widths to generate guiding holes aligned on one or more planes and with different relative positions.

8. A needle-guide device as claimed in one or more of the preceding claims, characterized in that the needle-guide device (2, 12) may be divided in such a manner as to consist of more than two parts, for instance three parts, shaped in such a manner as to form complementary parts of the peripheral delimiting wall of said elongated guide hole.

9. A needle-guide device as claimed in one or more of the preceding claims, characterized in that it is composed of a base (102) for connection to an ultrasound probe (1), which has an abutment or support surface (602) for the second part (202) of the needle-guide device (2), which second part (202) has in turn at least one longitudinal groove (702) whose size corresponds to the needle size, and forms the side walls and a wall transverse thereto for delimiting the needle-guiding hole, whereas its support surface (602) on the base (102) of the needle-guide device (2) forms the missing wall of the elongated guide hole, when the two parts (102, 202) of the needle-guide device are connected.

10. A needle-guide device as claimed in one or more of the preceding claims, characterized in that the two mutual abutment surfaces of the two parts (102, 112, 202, 212) of the needle-guide device (2, 12) have each a groove whose width corresponds to the width of the needle and a partial depth relative to the corresponding dimension of the needle, the two grooves being coincident and completing mutually when the two parts (102, 112, 202, 212) of the needle-guide device (2, 12) are connected, thereby forming the elongated guide hole for guiding the needle (3).

11. A needle-guide device as claimed in one or more of the preceding claims, characterized in that the base part (102, 112) of the needle-guide device (2, 12) has at least a longitudinal groove in the surface abutting against the second removable part (202, 212) of the needle-guide device (1, 12), for engagement of longitudinally continuous or discontinuous extensions of the side walls of a longitudinal groove formed in said second removable part (202, 212) of the needle-guide device, thereby forming the bottom of the longitudinal groove of the base (102, 112), the missing completing wall of the elongated guide hole, whose additional delimiting walls are formed by the bottom of the longitudinal groove in said second part (202, 212) of the needle-guide device, the side walls of said groove and the extensions of said side walls of the groove in said second part of the needle-guide device.

12. A needle-guide device as claimed in claim 11, characterized in that, alternatively, instead of two extensions of the side walls of the longitudinal grooves in the second part (202, 212) of the needle-guide device (2, 12), the second part (202, 212) of the needle-guide device (2, 12) may be arranged to have a single extension of one of the two side walls of the longitudinal groove, whereas the other extension may be provided on the base part (102, 112), as an extension of the opposite side wall of the longitudinal groove in the base part of the needle-guide device, whereby each of the two parts (102, 112, 202, 212) of the needle-guide device (2, 12) forms two of the opposite walls of the elongated guide hole.

13. A needle-guide device as claimed in one or more of the preceding claims, characterized in that the arrangement of the extensions of the side walls of the grooves in the two parts (102, 112, 202, 212) of the needle-guide device (2, 12) is alternate and complementary over the length of the two extensions in the longitudinal direction of the grooves, either on one side and along the two opposite sides.

14. A needle-guide device as claimed in one or more of the preceding claims, characterized in that it has means (6, 7, 106, 107, 9, 409, 802, 902) for centering and partially interlocking the two parts (102, 202) of the needle-guide device (2).

15. A needle-guide device as claimed in one or more of the preceding claims, characterized in that the two parts (102, 112, 202, 212) of the needle-guide device (2, 12) have removable mutually locking means (8).

16. A needle-guide device as claimed in claim 15, characterized in that the two parts (102, 112, 202, 212) of the needle-guide device (2, 12) have mutually clamping screw threaded means (8).

17. A needle-guide device as claimed in claim 16, characterized in that the mutually clamping screw threaded means (8) of the two parts (102, 112, 202, 212) of the needle-guide device (2, 12) have means (206, 306, 113) for engaging said two parts of the needle-guide device in a non-separable condition, and in a incompletely clamped condition.

18. A needle-guide device, particularly for ultrasound probes, or the like, comprising a base body having means for connection to the probe and at least one elongated guide hole for receiving a needle-like surgical tool, characterized in that it has a plurality of elongated guide holes for guiding a plurality of surgical tools arranged with their axes coincident with a single plane or having axes arranged on more planes, particularly having hole axes arranged at the vertices of ideal polygonal elements, such as triangles, quadrilaterals, or the like, or in any other different mutual arrangement.

19. A needle-guide device as claimed in claim 18, characterized in that it has, individually or in combination, the characteristics of one or more of claims 1 to 17.

20. A needle-guide device as claimed in claims 18 or 19, characterized in that said needle-guide device (12) is composed of a base part (112) to be secured, for instance, to an ultrasound probe (11) and of a removable part (212), a separation plane or surface (512, 812) being provided between the at least two parts (112, 212), which is parallel to the axis of the corresponding elongated guide hole, and is secant or at least tangent to the corresponding hole, and combinations of grooves (612, 712, 912) and walls in the mutual abutment surfaces of said two parts (112, 212) which, by their mutual engagement, form the complemen-

tary parts of the surfaces delimiting the two, three or more holes of the needle-guide device, so that, by separating said at least two parts (112, 212), all the elongated guide holes are longitudinally open on at least one portion of a side.

21. A needle-guide device as claimed in one or more of claims 18 to 20, characterized in that it includes three elongated guide holes and wherein the needle-guide device (12) is divided into a base (112) and a second part (212) to be removably fastened to the base, the base (112) of the needle-guide device (12) having a surface (512) whereby it abuts against the second part (212) of the needle-guide device, wherein a first groove (612) is provided in a median position, in turn having a second groove (712) in its bottom wall, which is designed to form two longitudinal side walls and a longitudinal bottom wall of one of the elongated guide holes for one of the needles (3), whereas the second part (212) of the needle-guide device (12) has, on the surface turned toward the abutment surface (512) of the base part (112), a longitudinal median rib (812) which coincides with the longitudinal median groove (612) in the base part (112) and forms the missing delimiting surface of the corresponding elongated guide hole, thereby completing the delimiting surfaces formed by the second groove (712), whereas, in the surfaces of the second part (212) of the needle-guide device (12), on the two sides of the longitudinal median rib (812), longitudinal grooves (912) are provided which form, with the bands of the abutment surface (512) of the base (112) on both sides of the first groove (612), the delimiting surfaces of the two additional elongated guide holes.

22. A needle-guide device as claimed in claim 21, characterized in that the grooves (712, 912) which form a portion of the side walls and a wall transverse thereto for delimiting the elongated guide hole are provided partially in both opposite mutual abutment surfaces of the two parts (112, 212) of the needle-guide device (12).

23. A needle-guide device as claimed in one or more of the preceding claims, characterized in that the needle-guide device (2) has a slender or tapering head (9), particularly having rounded edges, especially being wedge-shaped.

24. A needle-guide device as claimed in one or more of the preceding claims, characterized in that the whole needle-guide device (9) has a shape tapering toward the front end, especially a wedge shape.

25. A needle-guide device as claimed in one or more of the preceding claims, characterized in that at least one elongated guide hole for guiding at least one needle is inclined in a manner corresponding to the wedge-shaped profile of the needle-guide device (2).

26. A needle-guide device as claimed in one or more of the preceding claims, characterized in that the front head (9), also perforated (209), is arranged to be a single piece, and preferably made of one piece with the base part (102) of the needle-guide device (2).

27. A needle-guide device as claimed in one or more of the preceding claims, characterized in that the front head (9), which is integral with the base (102) and the second removable part (202) of the needle-guide device (2) have complementary mutually engaging means (409, 802, 902).

28. A needle-guide device as claimed in one or more of the preceding claims, characterized in that the through hole (409) in said head part (9) is widened on at least one side or for a portion of its delimiting surface inside the head (9), the second part (202) of the needle-guide device (2) having a wall extension (802, 902) at its end which may be axially

engaged in the through hole (409) of the front head (9), and which is coincident with said widened portion and complementary thereto so as to form and/or complete the delimiting wall of the through elongated guide hole, at least on a few sides, even at the front head (9) of the needle-guide device (2).

29. A needle-guide as claimed in one or more of the preceding claims, characterized in that the second part (202) of the needle-guide device (2) has said extensions (802, 902) on two opposite sides and in the form of front extension wings of the two side walls of the groove (702) provided in said second part (202) of the needle-guide device, whereas the front head (9) of the needle-guide device has complementary widened portions in the corresponding walls of the through hole (409).

30. A needle-guide device as claimed in one or more of the preceding claims, characterized in that an extension wing (902) is also provided from the bottom wall of the groove (702) of the second part (202) of the needle-guide device, the front head (9) of the needle-guide device being arranged to be accordingly widened even at said extension wing (902) of the bottom side of the groove (702) of the second part (202) of the needle-guide device.

31. A needle-guide device as claimed in one or more of the preceding claims, characterized in that the extension wings (802, 902) of the side and/or bottom walls of the groove (702) in the second part (202) of the needle-guide device are thinner than the wall of the second part (202) of the needle-guide device and than the head (9) of the needle-guide device, whereby an abutment step is formed between the front end of the second part (202) of the needle-guide device and the facing rear end side of the front head (9).

32. A needle-guide device as claimed in one or more of the preceding claims, characterized in that the front head (9) of the needle-guide device, which is integral with the base part (102) of the needle-guide device, has a through aperture (509) which communicates with the elongated guide hole provided therein at at least one of the sides of said head, preferably at one of the two transverse sides, not coinciding with the extension wings (802, 902) of the second part (202) of the needle-guide device and particularly at the side of the base part (102) of the needle-guide device which is opposite the second part (202) of the needle-guide device and meant to adhere against or turned toward the probe, whereas in the front head (9), the needle is only substantially guided on three sides and through less than 360° at least in coincidence with the through aperture (509).

33. A needle-guide device as claimed in one or more of the preceding claims, characterized in that the front head (9) has a steeper tapering inclination in the portion projecting beyond the aperture (509) on one of the sides, and that the needle projection aperture (209) is provided in the inclined front side, and is slot-shaped due to the inclination of the front end of the head (9).

34. A needle-guide device as claimed in one or more of the preceding claims, characterized in that the length of the front head (9) wherein each needle (3) is guided only on a few sides is relatively small as compared with the length of the rest of the needle-guide device in which the elongated guide hole has a continuous delimiting surface.

35. A needle-guide device as claimed in claim 34, characterized in that the front head (9) has needle guiding surfaces covering less than 360° and wherein the missing

part of the guiding wall is alternated in different positions through successive sectors of the head (9).

36. A needle-guide device as claimed in one or more of claims 33 to 35, characterized in that, at the more tapered front end, the elongated guide hole delimiting walls are continuous and made of one piece, as well as directly accessible from the aperture (209) wherefrom a needle (3) projects.

37. A combination of a needle-guide device and an ultrasound probe comprising a handgrip part (101, 111) and a scan head (201, 211), characterized in that the base (102, 112) of the needle-guide device is removably attachable (4, 312, 312') to the probe body (1, 11) in a stable and predetermined position, said base (102) having one or more shape mating extensions (609, 501, 403, 502, 401, 312, 312', 311) which adhere to a portion of the outer surface of the ultrasound probe body and/or mutual interlock engagement means, as well as clamping means (4).

38. A combination as claimed in claim 37, characterized in that the needle-guide device (2, 12) is as claimed in one or more of the preceding claims 1 to 36.

39. A combination as claimed in claim 38, characterized in that the needle-guide device (2) has a tapered front head (9) and the probe is an endocavitary probe (1), which typically has a substantially cylindrical or other similar shape, also being elongated and having a rounded head (101), the base (102) of the needle-guide device having a surface whereby it rests on the probe case only in a few partial portions of the longitudinal extension and particularly in the end portions of the base (102) of the needle-guide device.

40. A combination as claimed in claim 39, characterized in that the facing surfaces of the base (102) of the needle-guide device and of the probe case (1) have complementary centering projections and recesses (402, 502, 401) arranged over their length.

41. A combination as claimed in claim 39 or 40, characterized in that the probe case may have recesses (501) for accommodating supporting feet or extensions (609) of the base (102) of the needle-guide device, provided at least at the ends thereof.

42. A combination as claimed in claim 41, characterized in that the tapered front head (9) of the needle-guide device has an engagement extension (609) on the side turned toward the probe case (1), which is designed to engage in a recess (510) of the probe case (1), in such a manner that the tapered end of said front head (9) is connected thereto without substantially forming steps or discontinuities external the surface of the probe case.

43. A combination as claimed in one or more of the preceding claims 37 to 42, characterized in that the engagement means between the front head (9) of the needle-guide device and the probe (1) form means for holding the needle-guide device base (102) in position, whereas the needle-guide device is removably secured to the probe by means of a clamping collar (4) provided at the rear end portion of the needle-guide device.

44. A combination as claimed in one of claims 37 or 38, characterized in that it includes an external ultrasound probe (11) having a bulged shape and a wider head (211, 311) as compared with the handgrip (111), wherein the probe head (211) has its greatest circumference in an intermediate position between the front end and the portion connected to the handgrip, whereas the needle-guide device has a base (212) having two preferably symmetrically coincident extensions (312) before the greatest circumference of the probe head, and an extension (312') with a fastening screw which overlaps the rear side (311) of the widened head (211) against which the fastening screw is tightened.

45. A combination as claimed in one or more of the preceding claims 37 to 44, characterized in that at least one elongated guide hole is arranged to have such an inclination with respect to the central axis of the cone of view of the ultrasound probe and at least one needle falls within the probe imaging region upon scanning, whereas at least one, preferably all the other needles have predetermined and fixed positions relative to the former.

\* \* \* \* \*

专利名称(译)	针引导装置，特别是用于超声探头		
公开(公告)号	<a href="#">US20020123689A1</a>	公开(公告)日	2002-09-05
申请号	US10/082703	申请日	2002-02-25
[标]申请(专利权)人(译)	FURIA ROBERTO		
申请(专利权)人(译)	FURIA ROBERTO		
当前申请(专利权)人(译)	FURIA ROBERTO		
[标]发明人	FURIA ROBERTO		
发明人	FURIA, ROBERTO		
IPC分类号	A61B8/08 A61B17/34 A61B8/14		
CPC分类号	A61B8/0833 A61B17/3403 A61B2017/00296 A61B2017/3411 A61B2017/3413		
优先权	SV2001000008 2001-03-05 IT		
其他公开文献	US7241267		
外部链接	<a href="#">Espacenet</a> <a href="#">USPTO</a>		

#### 摘要(译)

一种针引导装置，特别是用于超声探头等的针引导装置，包括具有用于连接探针的装置的基体和用于接收针状手术工具的至少一个细长引导孔，其特征在于，所述针引导装置（2,12）由至少两个可拆卸连接的部件（102,112; 202,212）制成，这些部件的形状使得它们中的每一个形成细长导向孔的周边定界壁的互补部分。手术工具（3），当针引导装置（2,12）的所述两个部分（102,112; 202,212）连接时，其周壁部分彼此完整，从而形成用于引导针的细长引导孔带有360°覆盖限制墙。

