



US006540679B2

(12) **United States Patent**  
**Slayton et al.**

(10) **Patent No.:** **US 6,540,679 B2**  
(45) **Date of Patent:** **Apr. 1, 2003**

(54) **VISUAL IMAGING SYSTEM FOR  
ULTRASONIC PROBE**

(75) Inventors: **Michael H. Slayton**, Tempe, AZ (US);  
**Peter G. Barthe**, Phoenix, AZ (US)

(73) Assignee: **Guided Therapy Systems, Inc.**, Mesa,  
AZ (US)

(\*) Notice: Subject to any disclaimer, the term of this  
patent is extended or adjusted under 35  
U.S.C. 154(b) by 46 days.

5,720,287 A *	2/1998	Chapelon et al. ....	600/439
5,727,554 A *	3/1998	Kalend et al. ....	600/407
5,748,767 A	5/1998	Raab	
5,817,013 A	10/1998	Ginn et al.	
5,891,034 A *	4/1999	Bucholz	
5,997,471 A *	12/1999	Gumb et al.	
6,004,262 A *	12/1999	Putz et al.	
6,050,943 A *	4/2000	Slayton et al. ....	600/439
6,216,029 B1 *	4/2001	Paltieli .....	600/411
6,325,758 B1 *	12/2001	Carol et al. ....	128/916
6,361,531 B1 *	3/2002	Hissong .....	600/437
6,390,982 B1 *	5/2002	Bova et al. ....	75/737
2002/0062077 A1 *	5/2002	Emmenegger et al. ....	600/443

(21) Appl. No.: **09/750,816**

(22) Filed: **Dec. 28, 2000**

(65) **Prior Publication Data**

US 2002/0087080 A1 Jul. 4, 2002

(51) **Int. Cl.**<sup>7</sup> ..... **A61B 8/00**

(52) **U.S. Cl.** ..... **600/439; 600/440; 600/446**

(58) **Field of Search** ..... 600/439, 440,  
600/443, 444, 446, 463

(56) **References Cited**

**U.S. PATENT DOCUMENTS**

4,860,732 A	8/1989	Hasegawa et al.	
5,224,467 A	7/1993	Oku	
5,230,338 A	7/1993	Allen et al.	
5,503,320 A	4/1996	Webster et al.	
5,526,812 A	6/1996	Dumoulin et al.	
5,577,991 A	11/1996	Akui et al.	
5,609,562 A	3/1997	Kaali	
5,617,858 A *	4/1997	Taverna et al. ....	600/109
5,638,819 A *	6/1997	Manwaring et al. ....	600/103
5,647,373 A *	7/1997	Paltieli .....	600/461
5,685,820 A	11/1997	Riek et al.	
5,701,900 A	12/1997	Shehada et al.	

\* cited by examiner

*Primary Examiner*—Marvin M. Lateef

*Assistant Examiner*—Runa Shah Qaderi

(74) *Attorney, Agent, or Firm*—Snell & Wilmer

(57) **ABSTRACT**

A non-invasive visual imaging system is provided, wherein the imaging system procures an image of a transducer position during diagnostic or therapeutic treatment. In addition, the system suitably provides for the transducer to capture patient information, such as acoustic, temperature, or ultrasonic images. For example, an ultrasonic image captured by the transducer can be correlated, fused or otherwise combined with the corresponding positional transducer image, such that the corresponding images represent not only the location of the transducer with respect to the patient, but also the ultrasonic image of the region of interest being scanned. Further, a system is provided wherein the information relating to the transducer position on a single patient may be used to capture similar imaging planes on the same patient, or with subsequent patients. Moreover, the imaging information can be effectively utilized as a training tool for medical practitioners.

**40 Claims, 10 Drawing Sheets**

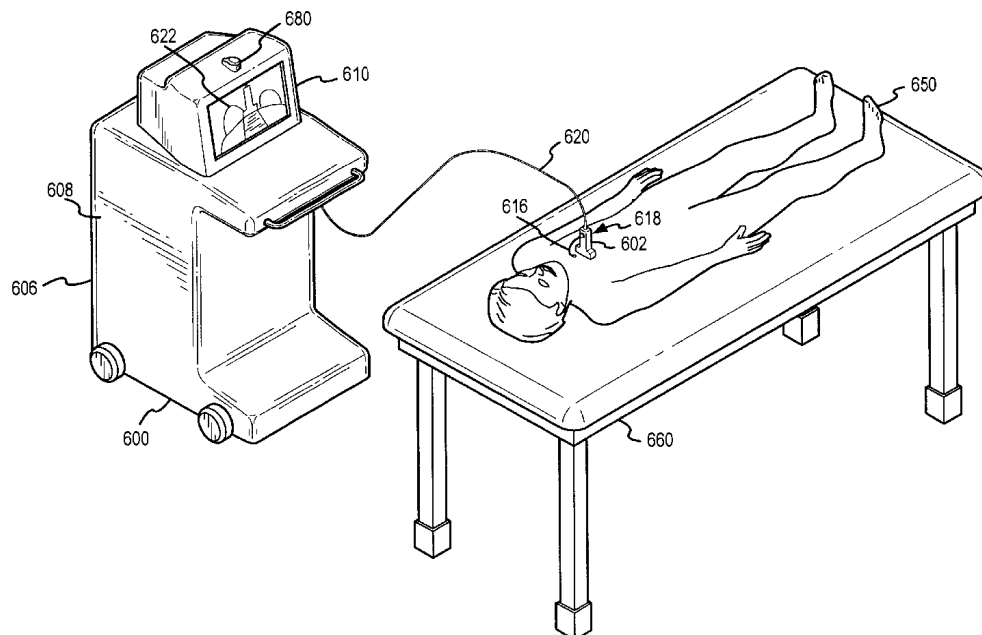

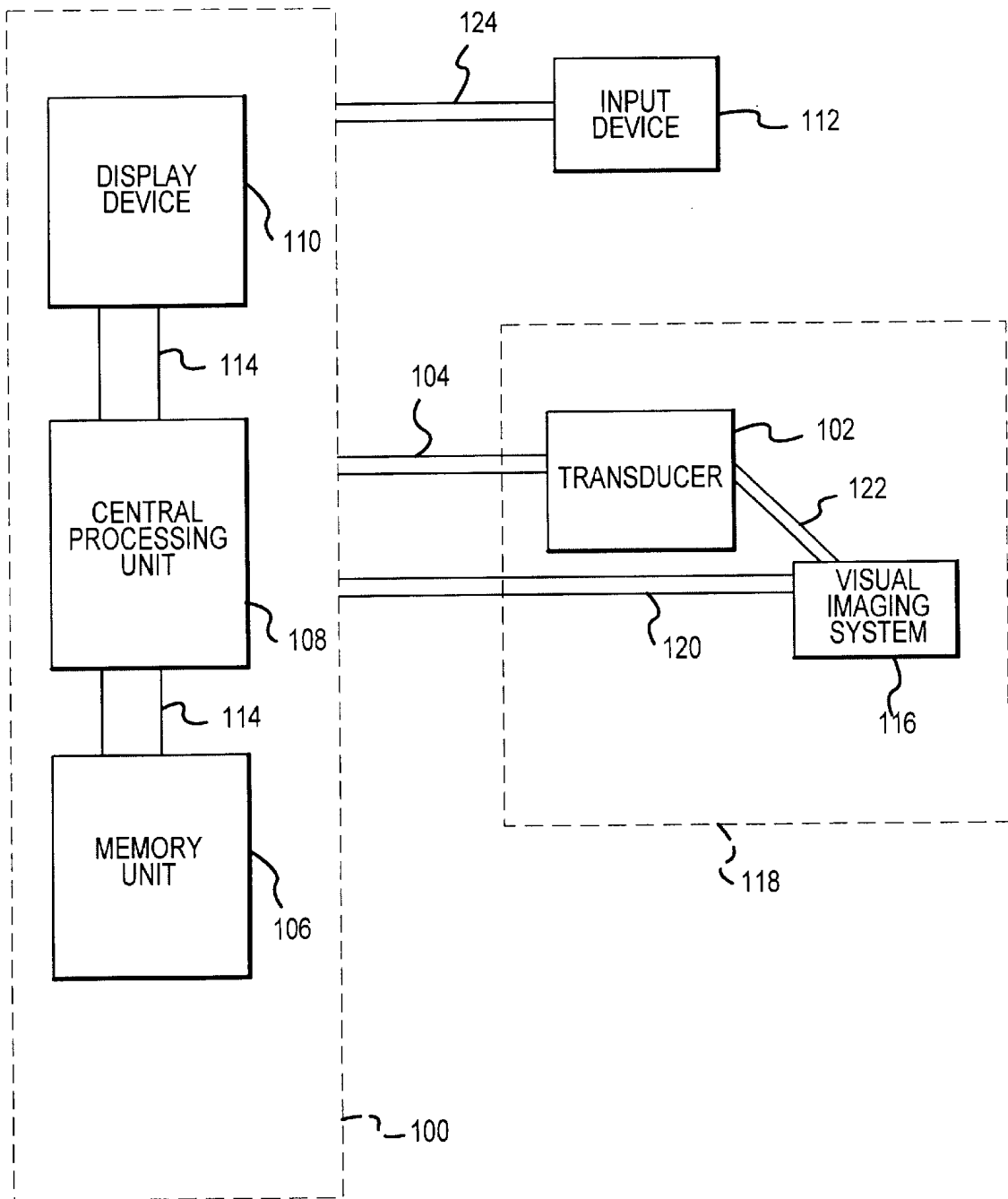

FIG. 1

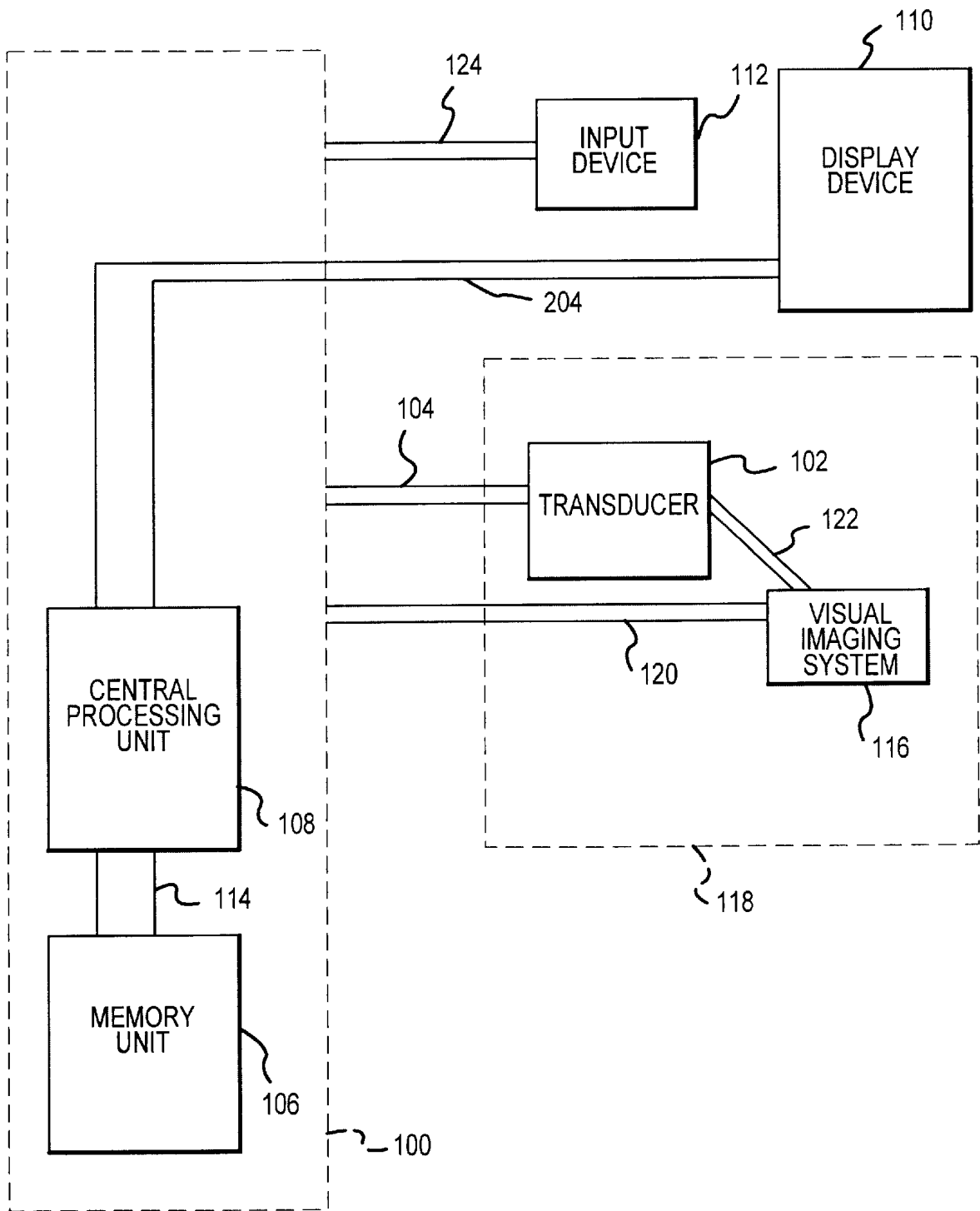

FIG. 2

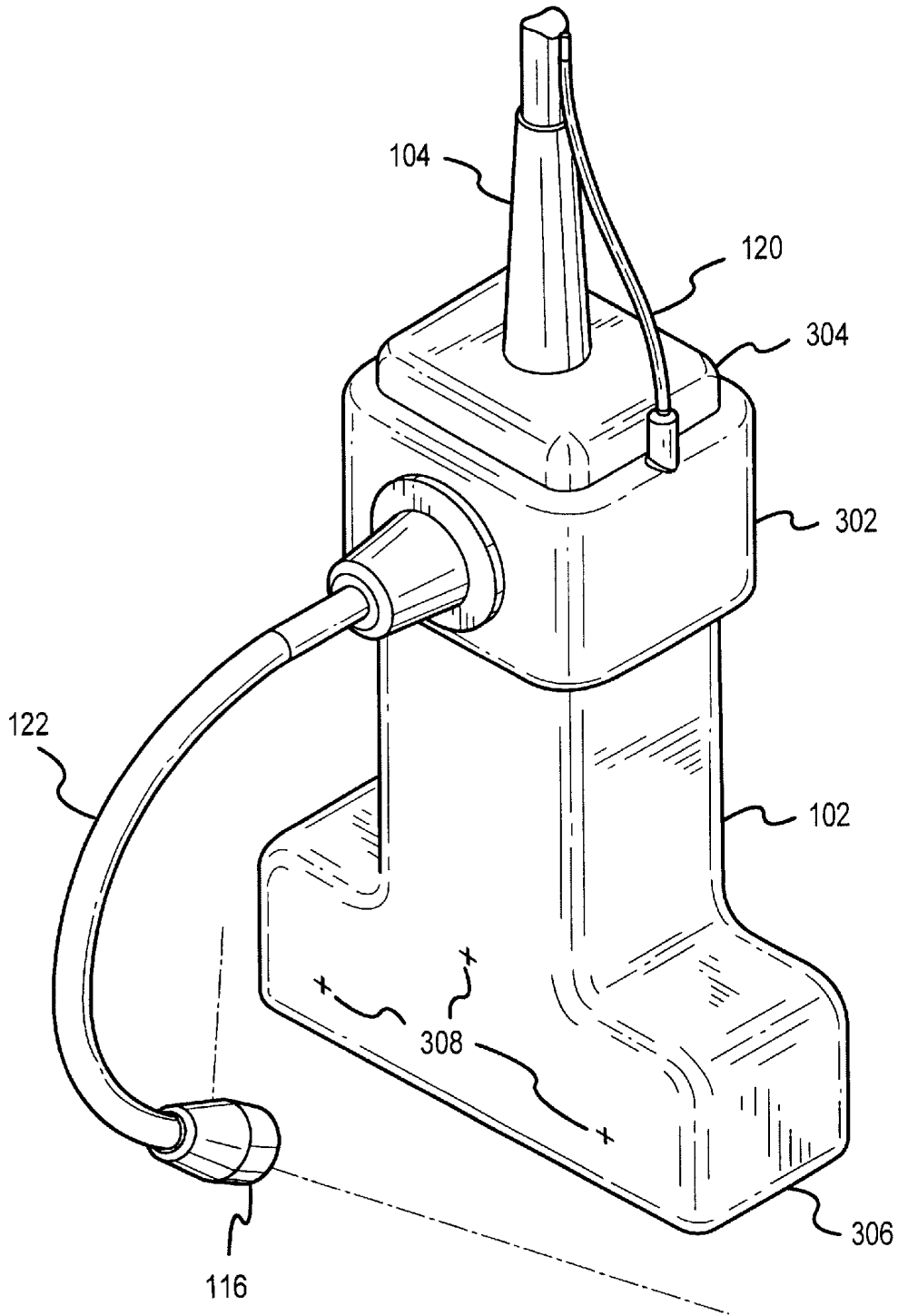

FIG.3

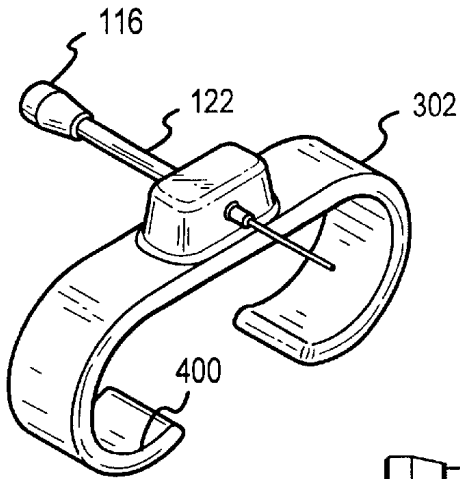

FIG. 4A

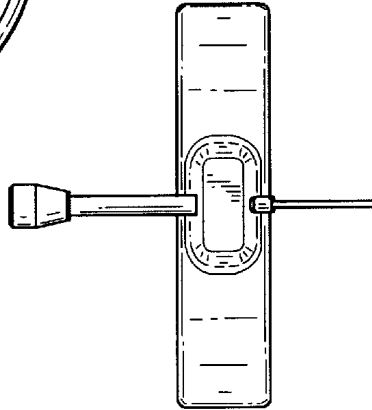

FIG. 4D

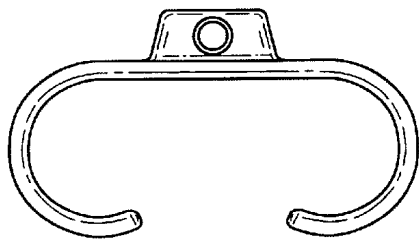

FIG. 4B

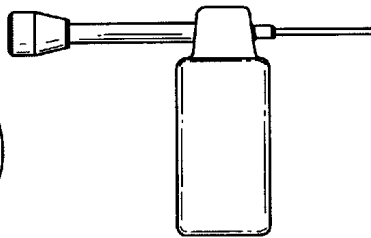

FIG. 4E

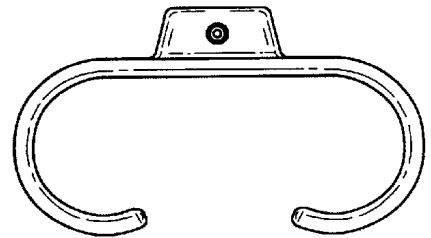

FIG. 4C

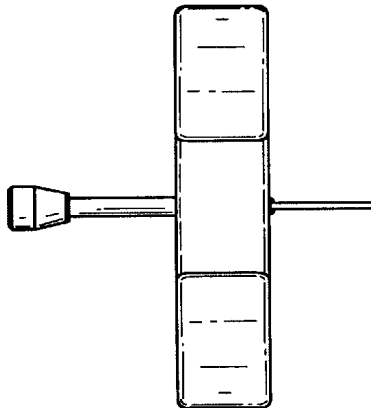

FIG. 4F

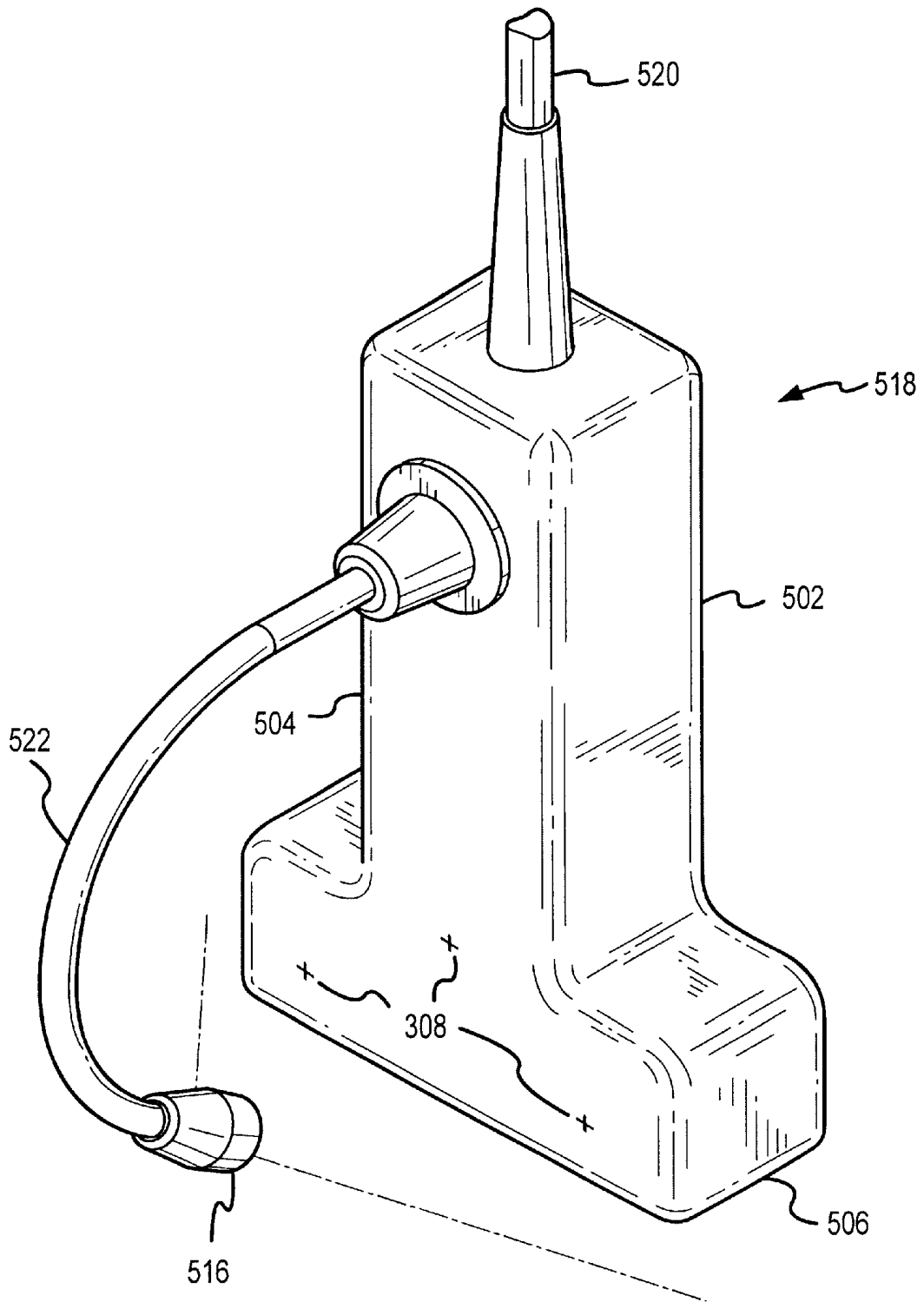

FIG.5

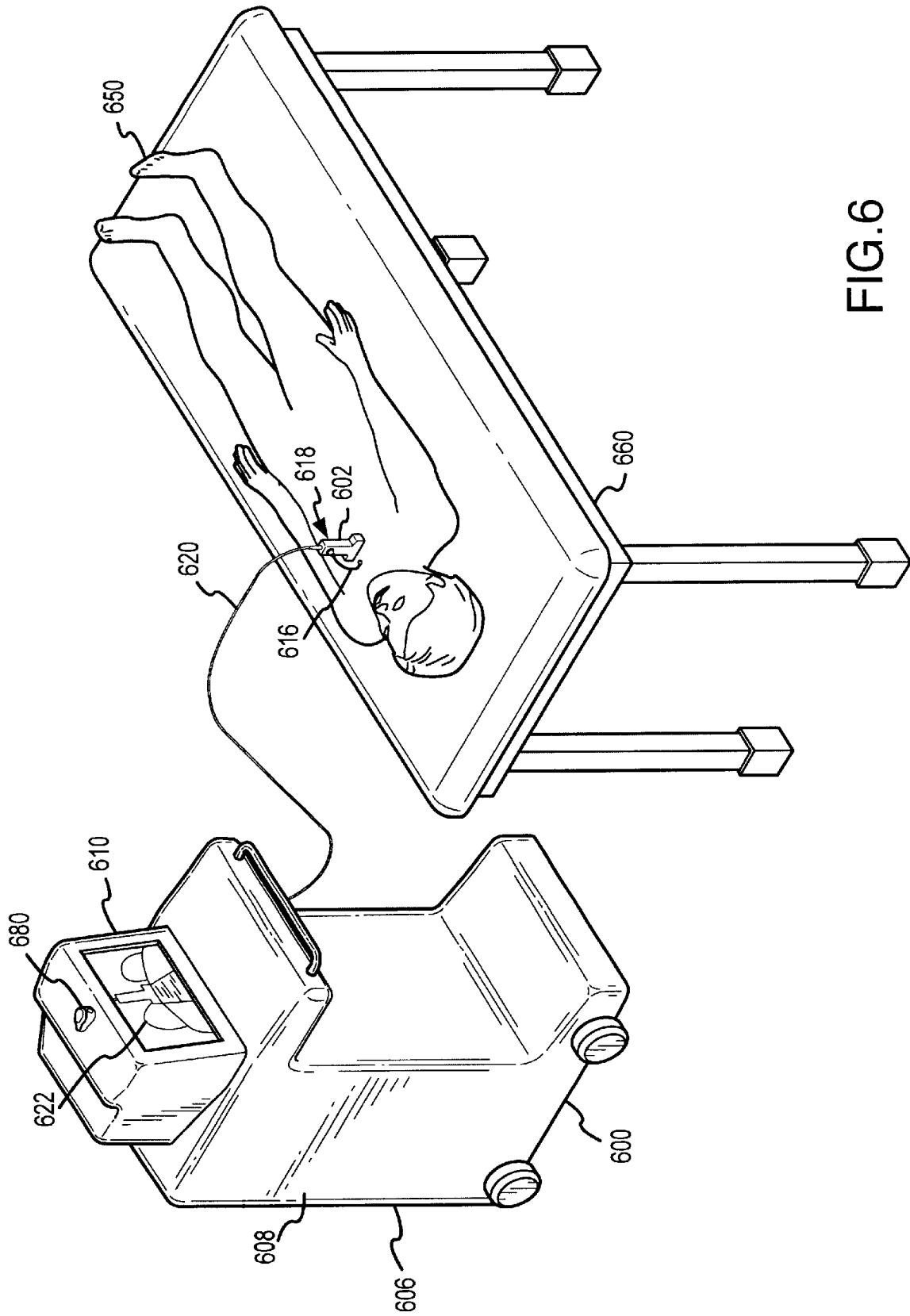

FIG. 6

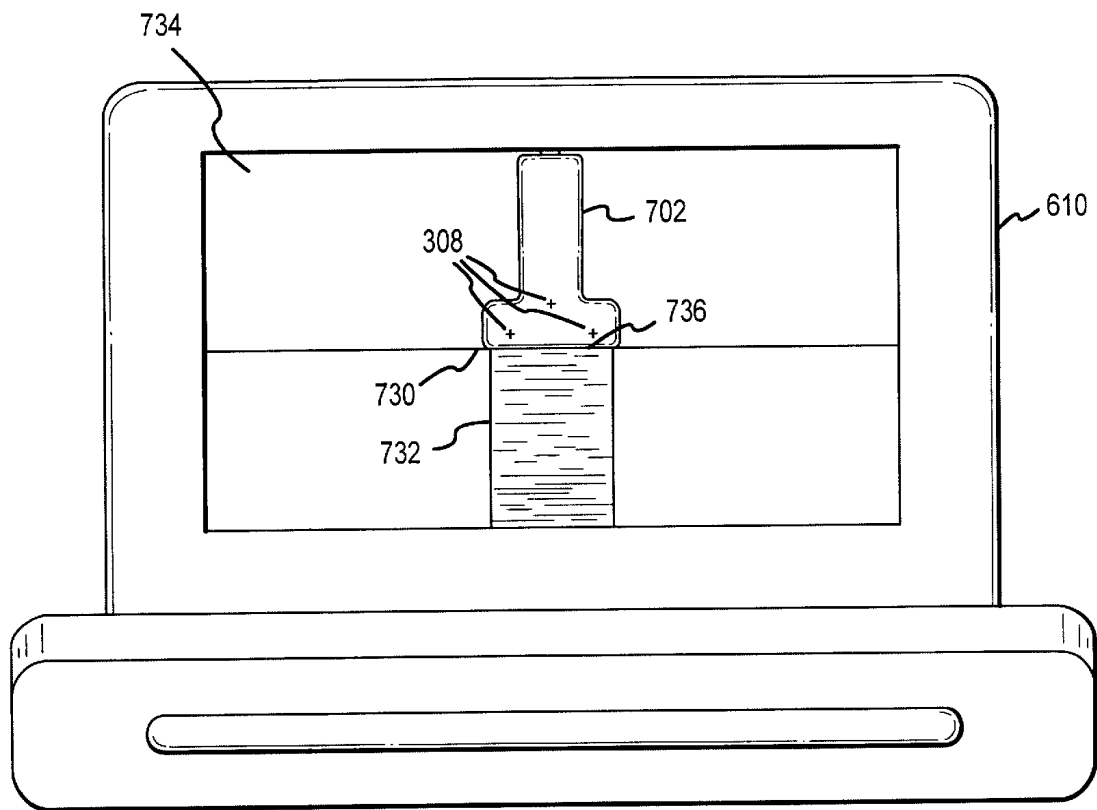

FIG. 7



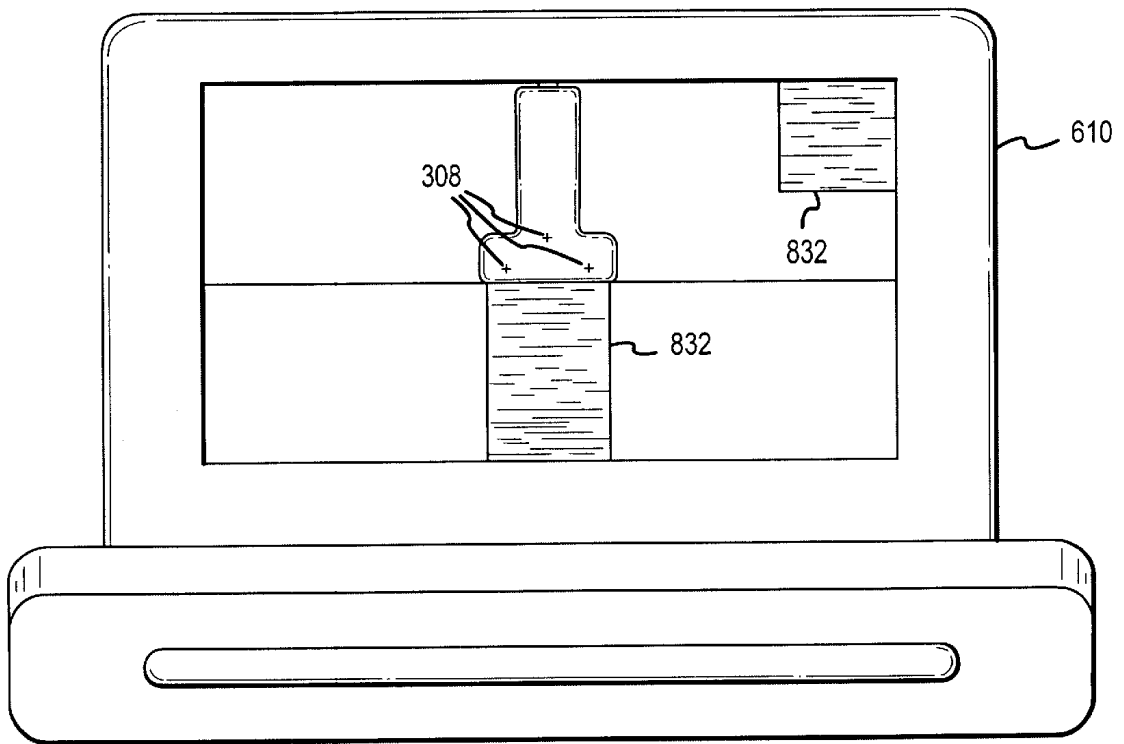

FIG. 8

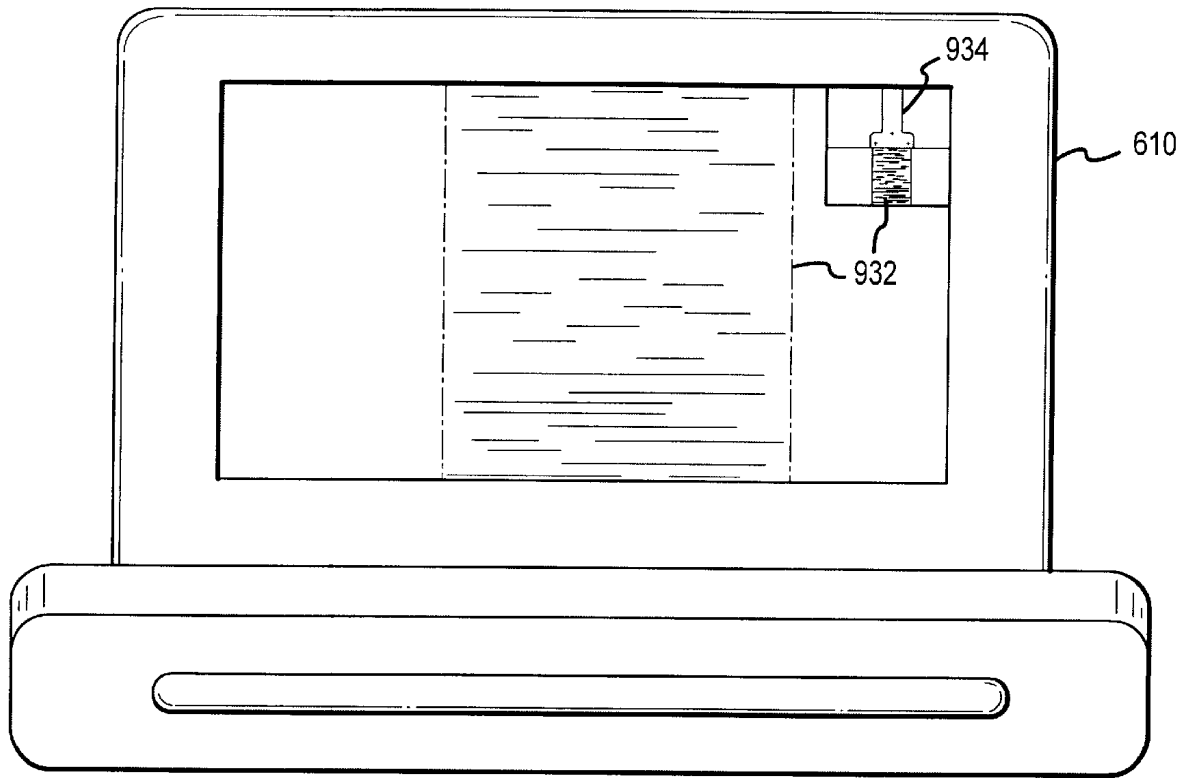

FIG. 9

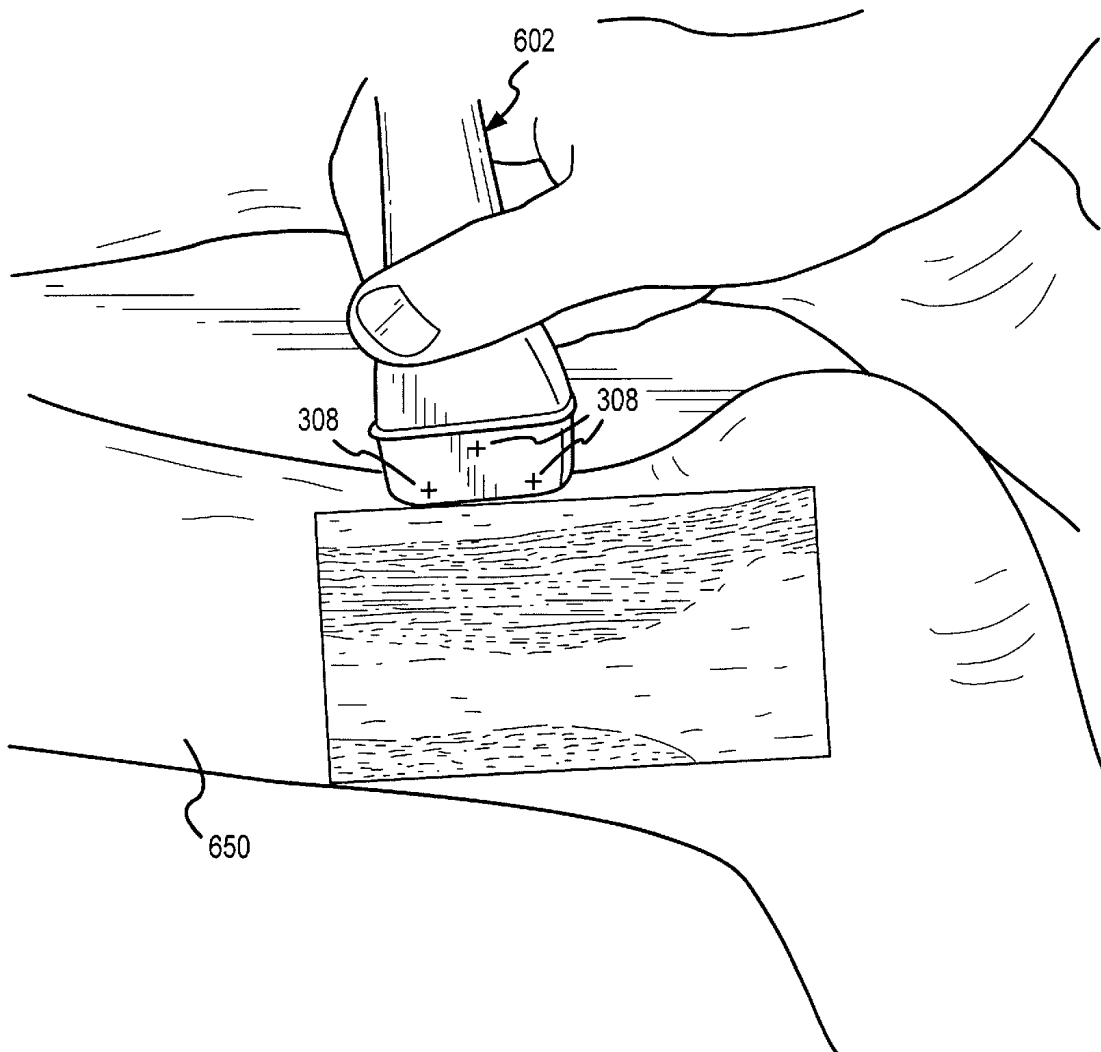

FIG.10

1

## VISUAL IMAGING SYSTEM FOR ULTRASONIC PROBE

### BACKGROUND OF THE INVENTION

#### 1. Field of the Invention

This invention generally relates to a non-invasive ultrasonic system, and more particularly, to a system which is capable of generating ultrasonic imaging data and information related to the positioning of a transducer during medical treatment and diagnosis.

#### 2. Description of the Related Art

There are a number of well known non-invasive imaging techniques for the diagnosis and treatment of patients. These techniques generally allow a physician to obtain high fidelity views of the human anatomic structure without the advent of invasive procedures. Such imaging systems which provide a cross-sectional (tomographic) view of the human body include computer-aided tomography (CAT scans) x-ray imagers magnetic resonance (MRI) imagers, positron emission tomographic scanning (PET), and magnetoencephalographic scanning (MEG). Typically, when a patient is scanned using one of these conventional cross-sectional imaging techniques, the patient's entire body or limb is imaged or mapped and the resulting anatomic topology is stored in an imaging database for later use.

While CAT scans, MRI's, PET's, and MEG's allow imaging of the entire body or entire limb requiring treatment, ultrasonic hand-held transducers are generally used to obtain a more localized image of a treatment area. In general, the hand-held transducer contains an imaging element which includes an ultrasonic sensor for placing in contact with the patient's skin. During operation, the imaging element of the transducer sends ultrasonic waves from the transducer into the patient's body to the region of interest, and scattered waves reflected from the region of interest within the body are collected by an ultrasonic sensor within the transducer. The resulting electrical signals can then be processed to produce an image corresponding to the structure imaged by the transducer.

Many imaging systems, such as, those described above, include a feature that allows the operator to indicate the source or location of the scanned image. In particular, the operator makes use of a model pattern representing the human body. In marking the location of the recorded image, the operator places a specially configured cursor representing the image plane of the scanning device over a model pattern to illustrate the imaging plane's orientation with respect to the patient's body.

For hand-held transducers, however, any movement of the transducer's orientation with respect to the patient's body changes the orientation of the imaging plane. This change in the imaging plane thereby requires the operator to readjust the specially configured cursor with respect to the model pattern. As a consequence, if the patient's body shifts between taking images, or if the transducer must be repositioned after imaging, it is often difficult to recapture the prior image location.

Moreover, an additional problem associated with the aforementioned scanning techniques is that each imaging process is particular to a patient, and thus sensitive to the patient's position with respect to the imaging device. Therefore, each set of images has a discrete, unique orientation related to a single patient resulting from a single scanning session. Because of their unique or distinct

2

features, images formed at different times, or from different vantage points, cannot be suitably compared on a point-by-point basis. This prevents an accurate comparison of the scanning regions from one scanning session to another, and from one patient to another. Such a comparison would be desirable in cases where the practitioner wishes to accurately compare scanned images from a healthy patient to the images of the patient undergoing the treatment, or where a practitioner wants to assess the responsiveness or improvements of a patient to a particular treatment. When such a comparison is desired, a system which enables the practitioner to place a transducer or other medical device in a prior imaging position would be tremendously beneficial.

Prior art systems for aiding or guiding the positioning of medical devices are generally cumbersome and complex. For example, U.S. Pat. No. 5,748,767 issued to Raab discloses a method for aiding a medical practitioner in the re-positioning of a surgical tool in a prior location, such as when the patient has moved. This re-positioning of the apparatus is accomplished by providing a correlation between the coordinates of the pre-treatment image and the image acquired during the treatment procedure. In addition, Raab necessarily requires the use of an apparatus which can transpose the imaging information from the reference system of the imaging system to the reference system of the apparatus. The system disclosed in Raab provides a method to enable the surgical tool to be positioned and re-positioned in relatively the same position with an acceptable accuracy by coordinating the pre-treatment and treatment reference systems.

During operation of the Raab system, the pre-treatment and treatment coordinates are continually calculated with respect to a specially designed reference block attached to an electrogoniometer. The electrogoniometer is further used to determine the orientation of the instruments used in the treatment process. This system, however, uses a mechanical linkage for maintaining the surgical tool in a fixed relationship with the reference block. Such machinations of the probing process creates a system that is relatively cumbersome for the practitioner using a hand-held transducer.

An additional problem with existing systems is found in the difficulty with which a prior imaging plane can be recaptured for comparison purposes, a problem which becomes even more significant with the use of hand-held transducer. For example, in one therapeutic application using a hand-held transducer, the objective of the treatment is to create a very well-placed thermal gradient in the treatment area to selectively destroy certain regions thereof. An example of this is the hypothermia technique wherein a temperature near about 43 degrees Celsius is required to be maintained in the specific treatment area, or the focused ultrasound surgery technique which has a goal of elevating the treatment area temperature to above and beyond 55 degrees Celsius. During the therapeutic treatment process, the physiological response of the target tissue is directly related to the spatial extent and temporal duration of the heating pattern. Consequently, in order to appropriately perform feedback and control of the therapeutic treatment process, it is absolutely essential to control the temperature in the target tissue so as to know whether or not the temperature in the treatment region has been raised to a level that produces a desired therapeutic effect or the destruction of the tissue. Moreover, as with the hypothermia and focused ultrasound surgery techniques, and any other technique whereby the success of the therapy must be evaluated from one treatment session to the next, it is critical to be able to accurately image the treatment area undergoing treatment for comparison to subsequent treatment sessions.

Another method for enabling a particular image to be recaptured from one session to the next may be accomplished by using a three-dimensional coordinate system that is fixed within a human anatomy. For example, U.S. Pat. No. 5,230,338 issued to Allen et al. discloses a method for interactively guiding a surgical tool, wherein three or more fiducial implants are implanted in three separate, spaced locations within the human body. With the Allen method, the three fiducial implants are arranged in a non-collinear manner such that a plane is formed which defines a three dimensional coordinate system. Once the external coordinate system is established, a scan of the treatment area is performed. During subsequent scans, the patient's orientation may change relative to the imaging apparatus, but the new orientation of the patient can be measured by locating the fiducial implants in relation to the imaging apparatus. In this manner, the images of subsequent scans of a patient relating to a new position or orientation can be configured to correspond to the earlier recorded scans for comparison. A disadvantage inherent in the Allen system, however, is that the fiducial implants remain implanted in the patient between imaging session. In addition, the Allen system does not facilitate the scanning or diagnosis of other patients, but only operates effectively for the same patient.

As described above, several prior art techniques exist for monitoring and recording the position of tools used in the diagnosis and treatment of patients, or for recapturing an image scanned in a prior scanning session. Generally, these techniques are complex as in the U.S. Pat. No. 5,748,767 issued to Raab, or are limited in their use, as in U.S. Pat. No. 5,230,338 issued to Allen et al. That is, use of such techniques essentially requires the implementation of cumbersome equipment, such as an electrogoniometer and reference block, or requires that elements of the system remain with the patient between scans, such as the implants in Allen. In that regard, such methods are inadequate for medical specialist who desire a simpler and less cumbersome manner to record a tool position or orientation which correlates with a prior image, to facilitate the return to the precise location of the prior treatment in that patient or, alternatively, a second patient undergoing similar treatment.

Thus, a need exists for a less cumbersome and easy to use system capable of monitoring and recording the position of a transducer to facilitate the desired-positioning of the transducer within a treatment area.

### SUMMARY OF THE INVENTION

A visual imaging system in accordance with the present invention overcomes various problems of the prior art. In accordance with various aspects of the present invention, a noninvasive visual imaging system is provided, wherein the imaging system procures an image of a transducer position during diagnostic or therapeutic treatment. In addition, the system suitably provides for the transducer to capture patient information, such as acoustic, temperature, or ultrasonic images. For example, an ultrasonic image captured by the transducer can be correlated or otherwise fused or combined with the corresponding positional transducer image, such that the corresponding images represent not only the location of the transducer with respect to the patient, but also the ultrasonic image of the region of interest being scanned.

In accordance with another aspect of the present invention, the imaging system can comprise a positioning indicator located within the transducer which can facilitate the determination of the position and/or orientation of the transducer with respect to the patient. In addition, this

positioning information can be utilized to suitably scale the ultrasonic image of the treatment region to correspond with the positional image of the patient to provide a fused image.

Further, in accordance with another aspect of the present invention, a system is provided wherein the information relating to the transducer position on a single patient may be used to capture similar imaging planes on the same patient, or with subsequent patients. This information captured may also be utilized for training purposes.

### BRIEF DESCRIPTION OF THE DRAWINGS FIGURES

A more complete understanding of the present invention may be derived by referring to the various exemplary embodiments of the present invention which are described in conjunction with the appended drawing figures in which like numerals denote like elements, and in which:

FIG. 1 illustrates a block diagram of an exemplary embodiment in accordance with the present invention;

FIG. 2 illustrates a block diagram of another exemplary embodiment in accordance with the present invention;

FIG. 3 illustrates an exemplary embodiment of a probe assembly in accordance with the present invention;

FIGS. 4A-4F illustrate an exemplary embodiment of an attachment device in accordance with the present invention;

FIG. 5 illustrates another exemplary embodiment of a probe assembly in accordance with the present invention;

FIG. 6 illustrates an exemplary embodiment of the visual imaging system in operation in accordance with the present invention;

FIG. 7 illustrates an exemplary combined image capable of being shown on the display screen in accordance with the present invention;

FIG. 8 illustrates another exemplary combined image capable of being shown on the display screen in accordance with the present invention;

FIG. 9 illustrates yet another exemplary combined image capable of being shown on the display screen in accordance with the present invention; and

FIG. 10 illustrates an exemplary embodiment of the visual imaging system in operation as may be displayed in accordance with the present invention.

### DETAILED DESCRIPTION OF VARIOUS EXEMPLARY EMBODIMENTS

The present invention may be described herein in terms of various components and processing steps. It should be appreciated that such components and steps may be realized by any number of hardware components configured to perform the specified functions. For example, the present invention may employ various medical treatment devices, visual imaging and display devices, input terminals and the like, which may carry out a variety of functions under the control of one or more control systems or other control devices. In addition, those skilled in the art will appreciate that the present invention may be practiced in any number of medical contexts and that the exemplary embodiment relating to an ultrasonic transducer as described herein is merely one exemplary application for the invention. For example, the principles, features and methods discussed may be applied to any medical application. Further, various aspects of the present invention may be suitably applied to other industrial, manufacturing or engineering applications, such as the inspection of materials such as steel, plastics, concrete or wood.

In accordance with one aspect of the present invention, a medical treatment and diagnosis system comprises a visual imaging system suitably configured with a probe assembly to facilitate the accurate and consistent placement of the probe assembly during treatment and diagnosis of a patient. The probe system can be suitably configured to perform any of various functions, such as the obtaining of information relating to a region of interest of the patient, and/or the providing of therapeutic treatment of the region of interest. In addition, the probe system can comprise various medical devices, such as transducers for imaging, heating or temperature measurement, audio devices, or any other device for obtaining patient information.

The visual imaging system is suitably configured to provide information relating to the position of the probe system with respect to the patient, or the region of interest. This information can include various forms, such as, for example, video or photographic images, or graphical representations, relating to the position of the probe system during operation. Moreover, the visual imaging system can comprise various components, such as video or other like imaging devices. In addition, the visual imaging can be configured directly within, or connected to, the probe system to facilitate the identification of the positional information of the probe system during its use.

In accordance with another aspect of the present invention, the visual imaging system is suitably configured to provide information relating to the position of the probe system to a control system for further assessment and recommendations. In accordance with this aspect, the control system is configured to receive imaging information from the visual imaging system and patient information from the probe system and suitably correlate both components of information to provide various advantages to the medical practitioner. For example, the control system can provide information which facilitates the positioning of the probe system during use. This information could be a reference position of the probe system from a prior use of the probe with a particular patient, or from other patients. In addition, the control system could provide information directing the probe system to a specific position of the patient to observe or treat a particular region of interest for that patient. Further, this imaging information can be suitably utilized for the training of medical practitioners.

To further explain in more detail various aspects of the present invention, exemplary embodiments of a visual imaging system as used with a control system and an ultrasonic probe system will be provided. However, it should be noted that the following exemplary embodiments are for illustrative purposes, and that the present invention can comprise various other configurations for a medical treatment and diagnostic system. In addition, although not illustrated in the drawing figures, the medical treatment and diagnostic system can further include components associated with a therapy or diagnostic system, such as any required power sources, system control electronics or additional memory locations.

With reference to FIG. 1, an exemplary embodiment of a medical treatment and diagnostic system in accordance with the present invention is shown. In accordance with this embodiment, the system comprises a probe assembly **118** and a control system **100**. Probe assembly **108** suitably comprises a transducer **102** for rendering localized diagnosis and treatment of patients and a visual imaging system **116** for transmitting information to control system **100** relating to the position and/or orientation of transducer **102** with respect to the patient. Transducer **102** may comprise any

conventional type of transducer used by practitioners in the diagnosis or treatment of patients. Preferably, transducer **102** comprises an ultrasonic transducer configured to provide various features. For example, transducer **102** can include a visual imaging element capable of imaging a patient's treatment region. Transducer **102** can also be configured for recording or measuring acoustic or temperature data and for transmitting the acoustic or temperature data to the control unit **100** via communications channel **104**. Further, transducer **102** can be suitably configured to providing therapeutic treatment to the region of interest. In accordance with an exemplary embodiment, transducer **102** can comprise a combined imaging, therapy, and temperature measurement transducer, as disclosed more fully in

U.S. Pat. No. 6,050,943, entitled IMAGING, THERAPY AND TEMPERATURE MONITORING ULTRASONIC SYSTEM and issued on Apr. 18, 2000, as well as a three-dimensional ultrasonic image as disclosed more fully in U.S. patent application Ser. No. 09/502,174, entitled IMAGING, THERAPY AND TEMPERATURE MONITORING ULTRASONIC SYSTEM, both hereby incorporated herein by reference.

Visual imaging system **116** may comprise any conventional device capable of capturing visual information relating to the position and/or orientation of transducer **102** and for transmitting the information to control device **100**, via such as signal cable **120**. For example, imaging system **116** can comprise a video camera for capturing real-time or substantially-real-time visual information. Visual imaging system **116** can also comprise a photographic camera for providing still-photos representative of the position and/or orientation of transducer **102**.

In addition, visual imaging system **116** can be suitably connected to transducer **102** to follow the movement of transducer **102** during operation. As a result, a transducer **102** moves about the patient, visual imaging system **116** can suitably follow along in real-time. This connection can be facilitated by various devices and in various manners. In addition, visual imaging system **116** can be permanently or removably attached to transducer **102**. Further, the position and/or orientation of visual imaging system **116** with respect to transducer **102** can be suitably configured in various manners, as will be described in more detail below. As a result, the positional and/or orientation information of transducer **102** can be correlated with any imaging, acoustic or temperature measurements obtained by transducer **102**.

Control system **100** is configured to control the operation of probe assembly **118**, including the receiving of information from probe assembly, such as from transducer **102** and imaging system **116**. In addition, control system **100** can be configured to process the information collected from transducer **102** and imaging system **116**. From this processed information, control system **100** can provide various types of information to the medical practitioner.

For example, control system **100** can indicate to the practitioner a desired position and/or orientation of transducer **102** based on the prior use of probe assembly **118** with the present patient being observed. In addition, control system **100** can also provide information based on use of probe assembly **118** for other patients. Moreover, control system **100** can include a historical database of previous applications of probe assembly **118**. This database can provide position and/or orientation information for a particular region of interest, and can be utilized for further review and diagnosis of the patient, as well as being used for training of medical practitioners.

Control system **100** can comprise various hardware configurations. In accordance with an exemplary embodiment, control system **100** comprises a memory unit **106**, a central processing unit **108**, and a display device **110**. The memory unit **106** of control system **100** may be of any conventional type capable of storing a plurality of data and software programs, including video, audio, numerical or statistical data. Memory unit **106** is suitably configured to provide memory locations for storing various items of data to be directly or indirectly input to, or directly or indirectly output from, control system **100**. Memory unit **106** can also comprise a conventional database for the storage of a plurality of data and software programs, including video, audio, numerical or statistical data. For example, video streaming of the positional imaging information and ultrasonic imaging information of transducer **102** during operation may be suitably stored, such as a segment of a couple seconds, minutes or longer, or even still segments of information.

Memory unit **106** can be connected to central processing unit **108** in any conventional manner, such as, for example, through a bus **114**. Central processing unit **108** is configured for receiving and decoding incoming instructions, executing commands, and manipulating data stored in memory unit **106**. Central processing unit **108** may also be configured to receive instructions from an input device **112**, such as any conventional type keyboard, for example, a touch-type or touch entry keyboard. The instructions from the input device **112** may further require the central processing unit **108** to retrieve data or software programs stored in memory unit **106**. Central processing unit **108** is further capable of executing computer software programs and sending the processed information to display device **110**.

Central processing unit **108** may comprise various software algorithms configured for correlating, fusing or otherwise combining acoustic, thermal, or ultrasonic imaging information from transducer **102** with the positional and/or orientation information from imaging device **116**. For example, in accordance with an exemplary embodiment, and with momentary reference to FIGS. 7–10, the software algorithms can be configured to provide a combined image wherein the positional image of transducer **102** can be suitably displayed with the ultrasonic image of the patient to provide a “fused” image. In addition, such a fused or combined image can be suitably scaled to as to appear to provide a cross-sectional view of the patient and treatment region during operation of transducer **102**.

Display device **110** suitably comprises any display for providing at least one of video, audio, graphical data or images. Display device **110** may be a component of control system **100**, or display device **110** may be a separate device from control system **100**, for example as is depicted in FIG. 2. Where display device **110** is apart from control system **100** as in FIG. 2, display device **110** can be connected to the control system **100** via communications channel **204**. Further, display device **110** may also be of any conventional type capable of displaying data input through input device **112**, stored in memory unit **106**, or processed through processing unit **108**. For example, display device **110** is capable of displaying video and ultrasonic images in simultaneous or singular fashion, for example, a fused image or separate images of the position of transducer **102** and the ultrasonic image of the patient.

Referring now to FIG. 3, an exemplary embodiment of probe assembly **118** is illustrated. In accordance with this embodiment, transducer **102** further includes a transducer imaging element **306** encased within a transducer housing **304**. Transducer imaging element suitably comprises a ultra-

sonic transducer element configured for sending ultrasonic signals to a region of interest and then suitably receiving signals to provide an ultrasonic image of the region of interest.

Visual imaging device **116**, such as a video camera, can be suitably attached or connected to transducer **102** by various manners. For example, to connect imaging device **116** and transducer **102**, an arm member **122** can be provided. Arm member **122** may be any configuration of attachment structure, and may comprise various materials, for example, plastics, metals or other like materials. In accordance with one embodiment, arm member **122** is adjustable. In this embodiment, arm member **122** can be suitably configured for moving with relative freedom to enable imaging device **116** to be suitably stationed in various positions with respect to transducer **102**, i.e., the arm member can position imaging device **116** in various fixed positions with respect to transducer **102** to provide multiple views of transducer **102** with respect to the patient. For example, arm member can comprise a section of flexible conduit, such as that utilized in various adjustable lighting systems. Thus, arm member **122** can be suitably positioned, and/or re-positioned as desired by the medical practitioner. However, arm member **122** can also comprise a rigid or substantially rigid member configured to maintain a more permanent position of imaging device **116** relative to transducer **102**. Accordingly, arm member **122** suitably facilitates the procurement of images relating to the position of the transducer **102** from imaging device **116** by providing a fixed position of imaging device **116** with respect to transducer **102** during operation.

Arm member **122**, and thus visual imaging system **116** can be suitably attached or connected to transducer **102** in various manners. For example, transducer **102** can suitably include an attachment device **302**. Attachment device **302** can be permanently or removably affixed to transducer **102** such that when affixed, attachment device **302** is in continuous contact with the transducer housing **304**. In addition, attachment device **302** can provide for the fixed connection of arm member **122** to transducer **102**. Attachment device **302** can also comprise any material, for example, plastics, metals, wood and the like, and any configuration, for example, clamps, clips, clasps and the like, for facilitating connection or attachment of arm member **122** to transducer **102**.

With momentary reference to FIGS. 4A through 4F, various perspective, top, bottom and side views of an exemplary attachment device **302** are illustrated. In this embodiment, the attachment device **302** comprises a clip **400**. As shown, clip **400** is suitably designed as to be capable of being securely attached to transducer housing **304**. In addition, the inner contour **400** of clip **400** is preferably shaped to the outer contour of transducer housing **304** such that once clip **400** is firmly attached to transducer housing **304**, the position of clip **400**, relative to transducer housing **304**, is substantially fixed. As a result of attachment device **302** and arm member **122**, the visual image transmitted by imaging device **116** can follow in a direct correlation to the movement and position of transducer **102**.

Although FIG. 4 depicts a clip **400** wherein the clip is formed to fit securely and immobile to a transducer housing, it should be noted that clip **302** is not so limited. That is, imaging device **116** and arm member **122** may be affixed to the transducer housing **304** using any conventional mechanism which ensures that once arm member **122** is held substantially rigid or fixed, then the spatial relationship between imaging device **116** and transducer **102** remains substantially fixed. Accordingly, attachment device **302** may

comprise any assembly or arrangement such that the attached components are rendered relatively fixed with respect to one another.

Although an attachment device **302** can facilitate attachment of arm member **122** to transducer **102**, other methods and devices for connecting the components together can be utilized. For example, arm member **122** and transducer **304** can be suitably configured for integration of arm member **122** directly into transducer **102**. With reference to FIG. 5, another exemplary embodiment of probe assembly **118** is illustrated. In accordance with this embodiment, a transducer **502**, including a transducer housing **504** and transducer imaging element **506** are provided. In addition, an arm member **522** is suitably integrated into transducer housing **504**. Further, this exemplary embodiment of the probe assembly **118** includes imaging device **516** attached to transducer **502** via arm member **522**. It should be noted that transducer **502**, imaging device **516** and arm member **522** are similar in characteristics and operation to transducer **102**, visual imaging device **116** and arm member **122** described above. In addition, probe assembly **118** includes a transducer cable **520** which is capable of transmitting data from transducer sensor **506** and visual images from imaging device **516** to control unit **100**.

In accordance with another aspect of the present invention, probe assembly **108** may be configured to provide a fused image for display which is representative of the combining of the position and/or orientation information of transducer **102** and the ultrasonic imaging information of the treatment region. This fusing of images can be suitably provided by software algorithms within control system **100**. While this fusing of images can be readily provided once the orientation and position of transducer **102** is known, once transducer **102** is moved or tilted such that the angle of scan or the geometry of transducer **102** with respect to the patient changes, the scaling of the ultrasonic imaging information needs to be reconfigured.

To further facilitate the providing of a fused image which represents an image similar to a cross-sectional view of transducer **102** and patient, for example, as illustrated in FIGS. 7-10, transducer **102** can be configured with a positioning indicator. With reference to FIG. 3, an exemplary positioning indicator **308** is illustrated.

In accordance with this exemplary embodiment, positioning indicator **308** comprises a series of marks which are suitably configured to facilitate the determination and assessment of the positional and/or orientation information of transducer **102** with respect to the patient. Positioning indicator **308** is suitably configured to permit control system **100** to suitably correlate the geometry, i.e., position and orientation, of transducer **102** to the geometry of a corresponding ultrasonic image of the treatment region. For example, positioning indicator **308** can comprise triangulation marks, i.e., three marks configured in a triangular manner, configured at known distances apart to permit the software algorithm of central processing unit **108** to assess and determine the orientation and geometry of transducer **102** during operation.

For example, transducer **102** can include three cross-like triangulation marks, 1 mm in length, separated by fixed distances, e.g., 3 to 10 mm or more apart, that can provide the software with a reference point for the orientation of transducer **102**. In addition, by knowing the fixed distances of the triangulation marks, the software within central processing unit **108** can determine the position and distance of imaging device **116** with respect to transducer **102**. Thus, as

transducer **102** changes the angle of scan or otherwise the orientation with respect to the region of interest, the software within central processing unit **108** can suitably follow these changes in orientation and position. Accordingly, by knowing the orientation and geometry of transducer **102** with respect to the patient, positional and/or orientation information and ultrasonic imaging information can be suitably fused into a combined image. In addition, the respective positional and/or orientation information and ultrasonic imaging information can be suitably scaled by the software algorithm to provide an image similar to a cross-sectional view of transducer and treatment region, such as is illustrated in FIG. 10.

While an exemplary embodiment of a positioning indicator can comprise a series of marks **308**, such as two, three, four or more, or a single mark, positioning indicator **308** can comprise any mechanism for facilitating the determination of the geometry of transducer **102** with respect to the patient. Thus, the positioning indicator can also comprise any three-dimensional positioning indicator devices that can provide information regarding the position of transducer **102** with respect to the patient. For example, the positioning indicator can comprise an electromagnetic device configured within transducer **102** that can be suitably tracked by electromagnetic sensors configured with control system **100**. In addition, the positioning indicator can comprise a gravitational accelerometer configured to provide the assessment of three axis or rotation of transducer **102** in three dimensions. Such a collection of three-dimensional information could also be suitably correlated with three-dimensional imaging information, as disclosed more fully in U.S. patent application Ser. No. 09/502,174, entitled IMAGING, THERAPY AND TEMPERATURE MONITORING ULTRASONIC SYSTEM, hereby incorporated herein by reference.

Having described various aspects and features of a probe assembly and control system, the operation of an exemplary embodiment of the present invention will now be described. With respect to the following description, the operation of ultrasonic transducers will not be described in great detail. Although the present embodiment will be described with respect to the use of an ultrasonic transducer, it is to be understood that the present invention is not so limited. For example, the present invention may be used with any extra-corporeal probe or transducer used in the diagnosis or treatment of patients, such as general radiology, OB/GYN, breast, musculoskeletal, and other imaging or treatment applications.

With reference to FIG. 6, an exemplary embodiment of the present invention during operation is illustrated. In accordance with this embodiment, a patient **650** is illustrated lying on a treatment table **660** while undergoing treatment or diagnosis in accordance with the present invention. The medical treatment and diagnosis system includes a control system **600** and a display device **610**, wherein both the control system **600** and the display unit **610** comprise characteristics to the like elements of FIGS. 1 and 2. Further, a probe assembly **618** is included for providing imaging and treatment features, such as the probe assembly described in more detail above.

During operation, the medical practitioner, not shown, can manually image a treatment area of patient **650** by scanning the patient with probe assembly **618**. Transducer **602** of probe assembly **618** images the treatment area and sends an ultrasonic image to the control system **600** via data cable **620**. Meanwhile, visual imaging device **616**, such as a video camera, of probe assembly **618** captures a visual image of the position and/or orientation of transducer **602** with



respect to the patient treatment area, and transmits the visual image to the control system 600, also via data cable 620. The treatment area comprises the region of interest that the practitioner has determined the scanning will occur using the transducer 602.

Once the control system 600 receives the visual position and/or orientation images from imaging device 616 and the transducer image from transducer 602, the processing unit 608 suitably processes the images for further display and use. In addition, the images can be suitably transmitted to memory unit 606 for storage. and later reference, for example, for training purposes or for use later with the same patient or other patients. During processing of the images by processing unit 608, the visual and transducer images can be suitably correlated into a combined image such that the resulting combined image comprises both the ultrasonic, acoustic and/or thermal treatment image information captured by the transducer 602 during operation and the positional image depicting the position and/or orientation of the transducer 602 on the surface of the treatment area at the time the transducer image is captured. Once the visual and transducer images are processed by central processing unit 608, such as by a suitable algorithm, the respective visual and transducer images, and/or the combined image, i.e., the fused image, can be sent to memory unit 606 for storage and later reference. In addition, the respective images and/or the combined image can be further transmitted to the display device 610 for interpretation by the medical practitioner.

In accordance with another exemplary embodiment, the medical treatment and diagnosis system can include other visual imaging devices for capturing information regarding the position and/or orientation of the patient and the transducer. For example, other imaging devices or cameras can be located with the system, such as a probe assembly having two or more arm members suitably connected to two or more visual imaging devices. This configuration could provide different views of the position and/or orientation of the transducer, or even a three-dimensional view if desired. In addition, additional imaging devices could be included from within or proximate the control system or display, such as an additional visual imaging device 680. Moreover, other systems for determining the position of a medical instrument, such as the triangulation methods described above, can be combined with the probe assembly of the present invention.

The positional and/or orientation image and the transducer image can be configured in various manners. For example, display 610 can be configured to display each image separately, for example, on an individual screen basis, or on the same screen, such as a split screen or a "picture-in-picture" concept as is utilized on various television or computer monitors. In addition, in accordance with an exemplary embodiment, the images can be configured in a combined image which facilitates the analysis and assessment of the image information during or after operation.

With reference to FIG. 7, and with continued reference to FIG. 6, a combined image in accordance with an exemplary embodiment is illustrated. In this embodiment, display device 610 suitably displays a combined image comprising a positional image 734, representative of the position and/or orientation of transducer 602, and a transducer image 732, such as the ultrasonic images of the treatment region received and processed by the central processing unit 608. In addition, the respective images can be suitably combined into a single image. For example, the single image can include positional image 734 with an inlay of transducer image 732, i.e., positional image 734 and transducer image 732 are suitably fused into a combined image which is

representative of transducer 602 while in contact with the treatment area 736. In other words, the combined image can show the region of interest that is imaged under the patient's skin as represented by the transducer image 732, in correlation with the position and/or orientation of transducer 602 in contact with the patient's skin, as represented by positional image 734. As a result, a medical practitioner can view the combined image as if a cross-sectional view of the treatment region is available for assessment, i.e., the combined image is similar to a cross-sectional view of the patient and the treatment region. For example, with reference to FIG. 10, as transducer 602 is obtaining an ultrasonic image of a patient's heel, leg or foot 650, a combined image displaying the position and orientation of transducer fused together with a suitably scaled ultrasonic image of patient 650 is provided. Moreover, as transducer 602 is moved about the patient, the combined image can be suitably scaled on a real-time basis by software algorithms within control system 600, such as described above. As will be discussed below, such a combined image provides various advantages.

As illustrated in FIG. 8 and FIG. 9, in accordance with the present invention, control system 600 is also capable of generating various other combined image configurations, such as, split-screen images or "picture-in-picture" images. For example, FIG. 8 illustrates a combined image wherein the combined image comprises the primary image and includes an additional inlay of the transducer image 832 comprising a secondary image. Further, with reference to FIG. 9, a combined image is illustrated that includes the transducer image 932 being central to the display device 912 screen as a primary image, and a secondary image being included wherein the secondary image represents the combined transducer image 932 and positional image 934 as the secondary image. It should be noted that other variations of the images, including different sizes, locations or types, such as two-dimensional or three-dimensional images, can be suitably displayed in accordance with various other embodiments of the present invention.

As a result of the imaging information provided, medical practitioners can utilize the information to facilitate the treatment and diagnosis of their patients. In addition, the information can be utilized in various manners. For example, as the medical treatment and diagnosis system is utilized and imaging information is being observed, a medical practitioner can obtain a real-time assessment of the correlation between the position and/or orientation of the transducer and the imaging, temperature or therapeutic effects provided by the transducer for the treatment region. Accordingly, the medical practitioner can utilize the system to guide the transducer to desirable positions on the patient's surface to obtain the desired treatment or imaging information.

In addition, as the information is received, the control system can suitably store the imaging information in a database for later use and retrieval. For example, it is often difficult when treating patients on subsequent visits to repeat the ultrasonic treatment, imaging, or measurements obtained from prior visits. However, through use of the medical treatment and diagnosis system of the present invention, medical practitioners can realize repeatability and consistency in their treatment of previous patients.

Moreover, the information captured and stored by the control system can also be utilized as a guidance tool with respect to new or different patients. For example, if a particular position on a patient, for example, a fixed distance from a patient reference point, yields favorable or desired results, medical practitioners can utilize the system to suit-

ably re-position the transducer to the ideal or desired position for obtaining similar results. Further, the system can be utilized to train medical practitioners as to the most suitable positions for the transducer depending on the medical operation to be performed. For example, a video stream demonstrating 10 to 15 seconds of operation of a transducer through display of a combined image can demonstrate appropriate techniques for scanning of a treatment region.

In addition to storing the information, the control system can also be configured to process the information, such as through various algorithms and the like, to further improve the treatment process. For example, various artificial intelligence and other system learning functions can be implemented to provide an ever-improving system for facilitating treatment of patients.

The present invention has been described above with reference to various exemplary embodiments. However, those skilled in the art will recognize that changes and modifications may be made to the exemplary embodiments without departing from the scope of the present invention. For example, the various operational steps, as well as the components for carrying out the operational steps, may be implemented in alternate ways depending upon the particular application or in consideration of any number of cost functions associated with the operation of the system, e.g., various of the steps may be deleted, modified, or combined with other steps. Further, it should be noted that while the visual imaging system is described above is suitably for use by a medical practitioner proximate the patient, the system can also be accessed remotely, i.e., the medical practitioner can view through a remote display having imaging information transmitted in various manners of communication, such as by satellite/wireless or by wired connections such as IP or digital cable networks and the like, and can direct a local practitioner as to the suitably placement for the transducer. These and other changes or modifications are intended to be included within the scope of the present invention, as set forth in the following claims.

We claim:

**1.** A non-invasive medical treatment and diagnostic imaging system comprising:

a control system configured for control and operation of said system;

an extracorporeal probe assembly configured for diagnosis of a patient, said probe assembly comprising a transducer configured for obtaining patient information; and

a visual imaging device configured for capturing positional information of said transducer with respect to a patient, said visual imaging device being rigidly attached to said transducer to follow any movement of said transducer, wherein said control system is configured for assessing the patient information and the positional information to facilitate use of said transducer at a desired position with respect to the patient.

**2.** A system according to claim 1, wherein said transducer comprises an ultrasonic transducer, said ultrasonic transducer being adapted to send imaging information comprising ultrasonic images of a treatment region of the patient to said control system.

**3.** A system according to claim 2, wherein said control system further comprises a central processing unit, said central processing unit comprising an algorithm configured for processing the imaging information and the positional information.

**4.** A system according to claim 3, wherein said control system further comprises a memory unit for storing the imaging information and the positional information.

**5.** A system according to claim 3, wherein said control unit further comprises a display unit for displaying the imaging information and the positional information.

**6.** A system according to claim 5, wherein the positional information is combined via said algorithm within said control system with at least one of an acoustic image, a thermal image, or a therapy treatment image to provide a combined image.

**7.** A system according to claim 3, wherein the positional information is combined via said algorithm and said control system with the imaging information to provide a fused image.

**8.** A system according to claim 7, wherein said fused image comprises the positional information configured to display a position of said transducer relative to the patient in fusion with the imaging information configured to display an ultrasonic image of a treatment region.

**9.** A system according to claim 8, wherein said fused image provides an image similar to a cross-sectional view of the patient and the treatment region.

**10.** A system according to claim 8, wherein said display unit is configured to display a primary image comprising said fused image, and is configured to display a secondary image comprising one of the positional information configured to display the position of said transducer relative to the patient and the imaging information configured to display the ultrasonic image of the treatment region.

**11.** A system according to claim 7, wherein said probe assembly comprises a positioning indicator configured with said transducer, said positioning indicator configured to permit said control system to correlate a geometry position of said transducer with respect to the patient to a geometry of an ultrasonic image of a treatment region of the patient.

**12.** A system according to claim 11, wherein said positioning indicator facilitates scaling of the fused image during changes in position of said transducer.

**13.** A system according to claim 11, wherein said positioning indicator comprises a series of triangulation marks.

**14.** A system according to claim 11, wherein said positioning indicator comprises at least one of an electromagnetic device and a gravitational accelerometer.

**15.** A system according to claim 1, wherein said transducer comprises at least one of an acoustic, therapy and treatment monitoring transducer and is configured for transmitting said patient information to said control system.

**16.** A system according to claim 1, wherein said transducer comprises a combined ultrasonic imaging, therapy and temperature monitoring transducer and is configured for transmitting said patient information to said control system.

**17.** A system according to claim 1, wherein said visual imaging device comprises a video camera configured for sending a video stream to said control system, said video stream correlative of the positional information of said transducer during treatment.

**18.** A system according to claim 1, wherein said probe assembly further comprises an arm member connecting said visual imaging device to a housing of said transducer in a fixed position relative to said transducer, said arm member being configured to facilitate the capturing of positional information by said visual imaging device of said transducer during operation.

**19.** A system according to claim 18, wherein said probe assembly further comprises an attachment device for attaching said arm member to the housing of said transducer.

**20.** A visual imaging system for use in providing non-invasive medical treatment and diagnostic analysis, said system comprising:

15

an extracorporeal probe assembly configured for diagnosis of a patient, said extracorporeal probe assembly comprising an ultrasonic transducer, said ultrasonic transducer being adapted to send imaging information comprising ultrasonic images of a treatment region of the patient; and

a visual imaging device configured for capturing positional information of said transducer with respect to a patient during operation, said visual imaging device being physically attached in a fixed position relative to said transducer during operations of said transducer, wherein said non-invasive medical treatment and diagnostic imaging system is configured to permit a control system to assess the positional information to facilitate use of said transducer at a desired position with respect to the patient.

21. A system according to claim 20, wherein said transducer comprises a combined ultrasonic imaging, therapy and temperature monitoring transducer and is configured for transmitting patient information to a control system.

22. A system according to claim 20, wherein said probe assembly further comprises an arm member connecting said visual imaging device to a housing of said transducer, said arm member being configured to facilitate the capturing of positional information of said transducer during operation.

23. A system according to claim 22, wherein said arm member comprises an adjustable device which can position said imaging device in a plurality of fixed positions with respect to said transducer to provide multiple views of said transducer with respect to a patient.

24. A system according to claim 22, wherein said arm member comprises a substantially rigid member which can position said imaging device in a substantially permanent position with respect to said transducer to provide a fixed view of said transducer with respect to a patient.

25. A system according to claim 22, wherein said arm member is integrated directly into the housing of said transducer.

26. A system according to claim 22, wherein said probe assembly further comprises an attachment device for attaching said arm member to the housing of said transducer.

27. A system according to claim 22, wherein said attachment device comprises a clip configured to securely attach said arm member to the housing of said transducer, said clip having an inner contour shaped to an outer contour of the housing of said transducer such that once said clip is attached to said transducer, said imaging device can follow in a direct correlation to movement and position of said transducer.

28. A system according to claim 20, wherein said probe assembly further comprises a positioning indicator configured to provide geometric information regarding the positional information of said transducer during operation.

29. A system according to claim 20, wherein said imaging information and said positional information are combined to provide a fused image.

30. A system according to claim 29, wherein said fused image comprises the positional information configured to display a position of said transducer relative to the patient in fusion with the imaging information configured to display an ultrasonic image of treatment region.

16

31. A system according to claim 30 wherein said fused image is substantially identical to a cross-sectional view of the patient and the treatment region.

32. A system according to claim 28, wherein said positioning indicator facilitates scaling of the fused image during changes in position of said transducer.

33. A non-invasive medical treatment and diagnostic imaging system comprising: a control system configured for operation of said treatment and diagnostic system; an extracorporeal probe assembly configured for facilitating non-invasive treatment of a patient, said probe assembly comprising a transducer configured for obtaining imaging information; and a visual imaging device configured for capturing orientation information of said transducer with respect to the patient, said visual imaging device being rigidly attached to said transducer during positioning of said transducer, wherein said control system is configured for assessing said imaging information and said orientation information to facilitate use of said transducer at a desired position with respect to the patient.

34. The treatment and diagnostic system according to claim 33, wherein said orientation information is combined with said imaging information via an algorithm within said control system to provide a fused image.

35. The treatment and diagnostic system according to claim 34, wherein said display unit is configured to display a primary image comprising said fused image, and is configured to display a secondary image comprising one of said orientation information and said imaging information.

36. The treatment and diagnostic system according to claim 33, wherein said transducer comprises a positioning indicator configured to allow said control system to correlate orientation of said transducer with respect to the patient.

37. The treatment and diagnostic system according to claim 36, wherein said positioning indicator comprises a series of triangulation marks.

38. A visual imaging system for use in providing non-invasive medical treatment and diagnostic analysis, said visual imaging system comprising: an extracorporeal probe assembly configured for non-invasive diagnosis of a patient, said extracorporeal probe assembly comprising an ultrasonic transducer, said ultrasonic transducer being adapted to obtain imaging information of a treatment region of the patient; and a visual imaging device configured for capturing orientation information of said transducer with respect to the patient, said visual imaging device being physically attached in a fixed position relative to said transducer during positioning of said transducer.

39. The visual imaging system according to claim 38, wherein said visual imaging device is connected to said transducer through an arm member comprising a substantially rigid member which can position said visual imaging device in multiple substantially fixed positions with respect to said transducer.

40. The visual imaging system according to claim 38, wherein said transducer further comprises a positioning indicator configured to facilitate capturing of geometric information of said transducer during operation.

\* \* \* \* \*

专利名称(译)	超声探头视觉成像系统		
公开(公告)号	<a href="#">US6540679</a>	公开(公告)日	2003-04-01
申请号	US09/750816	申请日	2000-12-28
[标]申请(专利权)人(译)	斯雷顿MICHAEL ^ h BARTHE PETER 摹		
申请(专利权)人(译)	斯雷顿MICHAEL H. BARTHE PETER G.		
当前申请(专利权)人(译)	引导治疗系统公司.		
[标]发明人	SLAYTON MICHAEL H BARTHE PETER G		
发明人	SLAYTON, MICHAEL H. BARTHE, PETER G.		
IPC分类号	A61B8/00		
CPC分类号	A61B8/00 A61B8/463 A61B8/42		
其他公开文献	US20020087080A1		
外部链接	<a href="#">Espacenet</a> <a href="#">USPTO</a>		

摘要(译)

提供了一种非侵入性视觉成像系统，其中成像系统在诊断或治疗处理期间获取换能器位置的图像。另外，该系统适当地提供换能器以捕获患者信息，例如声学，温度或超声图像。例如，由换能器捕获的超声图像可以与相应的位置换能器图像相关，融合或以其他方式组合，使得相应的图像不仅代表换能器相对于患者的位置，而且还代表超声图像。被扫描的感兴趣区域。此外，提供了一种系统，其中与单个患者上的换能器位置有关的信息可用于捕获同一患者或随后患者的类似成像平面。此外，成像信息可以有效地用作医疗从业者的训练工具。

