



US009901274B2

(12) **United States Patent**  
**Bishay et al.**

(10) **Patent No.:** **US 9,901,274 B2**  
(45) **Date of Patent:** **\*Feb. 27, 2018**

(54) **ELECTROCARDIOGRAPHY PATCH**

(71) Applicant: **Bardy Diagnostics, Inc.**, Charlotte, NC (US)

(72) Inventors: **Jon Mikalson Bishay**, Seattle, WA (US); **Gust H. Bardy**, Carnation, WA (US); **Jason Felix**, Vashon Island, WA (US)

(73) Assignee: **Bardy Diagnostics, Inc.**, Seattle, WA (US)

(\* ) Notice: Subject to any disclaimer, the term of this patent is extended or adjusted under 35 U.S.C. 154(b) by 0 days.

This patent is subject to a terminal disclaimer.

(21) Appl. No.: **15/406,627**

(22) Filed: **Jan. 13, 2017**

(65) **Prior Publication Data**

US 2017/0188871 A1 Jul. 6, 2017

**Related U.S. Application Data**

(63) Continuation of application No. 14/080,717, filed on Nov. 14, 2013, now Pat. No. 9,545,204.

(Continued)

(51) **Int. Cl.**

**A61B 5/04** (2006.01)

**A61B 5/0408** (2006.01)

(Continued)

(52) **U.S. Cl.**

CPC ..... **A61B 5/04085** (2013.01); **A61B 5/02055** (2013.01); **A61B 5/04087** (2013.01);

(Continued)

(58) **Field of Classification Search**

CPC . A61B 5/04085; A61B 5/0006; A61B 5/6833; A61B 5/04087; A61B 5/0402;

(Continued)

(56) **References Cited**

U.S. PATENT DOCUMENTS

3,215,136 A 11/1965 Holler et al.

3,699,948 A 10/1972 Ota et al.

(Continued)

FOREIGN PATENT DOCUMENTS

DE 19955211 5/2001

EP 1859833 11/2007

(Continued)

OTHER PUBLICATIONS

US 6,527,714, 03/2003, Bardy (withdrawn)

(Continued)

*Primary Examiner* — Joseph Stoklosa

*Assistant Examiner* — Brian M Antiskay

(74) *Attorney, Agent, or Firm* — Patrick J. S. Inouye; Krista A. Wittman

(57) **ABSTRACT**

An electrocardiography patch is provided. A flexible backing is formed of an elongated strip of stretchable material and a pair of electrodes is respectively affixed on a contact surface of each end of the elongated strip. A flexible circuit is affixed on each end of the elongated strip and includes a pair of circuit traces electrically coupled to each electrode. A non-conductive receptacle is securely adhered on the one end of the elongated strip opposite the contact surface and formed to removably receive an electrocardiography monitor and house a battery. Electrical pads are provided on a bottom surface of the non-conductive receptacle to interface with electrical contacts protruding from the electrocardiography monitor. A pair of the electrical pads is formed to electrically couple with the electrodes. A pair of battery leads is formed on the non-conductive receptacle to electrically interface the battery to another pair of the electrical pads.

**20 Claims, 4 Drawing Sheets**

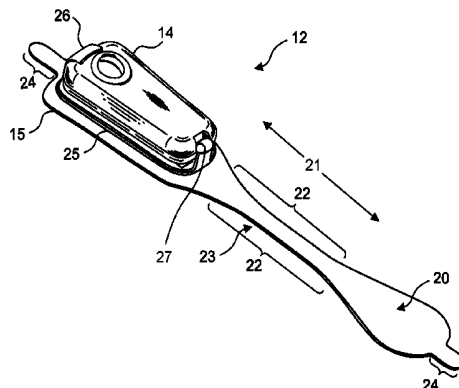

<b>Related U.S. Application Data</b>					
(60)	Provisional application No. 61/882,403, filed on Sep. 25, 2013.			5,819,741 A	10/1998 Karlsson et al.
				5,850,920 A	12/1998 Gilman et al.
				D407,159 S	3/1999 Roberg
				5,876,351 A	3/1999 Rohde
				5,906,583 A	5/1999 Rogel
				5,951,598 A	9/1999 Bishay et al.
(51)	<b>Int. Cl.</b>			5,957,857 A	9/1999 Hartley
	<i>A61B 5/00</i> (2006.01)			5,984,102 A	11/1999 Tay
	<i>A61B 5/0205</i> (2006.01)			6,032,064 A	2/2000 Devlin et al.
	<i>A61B 5/145</i> (2006.01)			6,038,469 A	3/2000 Karlsson et al.
	<i>A61B 5/021</i> (2006.01)			6,101,413 A	8/2000 Olsen et al.
	<i>A61B 5/08</i> (2006.01)			6,115,638 A	9/2000 Groenke
	<i>A61B 5/087</i> (2006.01)			6,117,077 A	9/2000 Del Mar et al.
	<i>A61B 5/091</i> (2006.01)			6,134,479 A	10/2000 Brewer et al.
(52)	<b>U.S. Cl.</b>			6,148,233 A	11/2000 Owen et al.
	CPC ..... <i>A61B 5/6823</i> (2013.01); <i>A61B 5/6833</i> (2013.01); <i>A61B 5/021</i> (2013.01); <i>A61B 5/087</i> (2013.01); <i>A61B 5/0816</i> (2013.01); <i>A61B 5/091</i> (2013.01); <i>A61B 5/14532</i> (2013.01); <i>A61B 5/14542</i> (2013.01); <i>A61B 2560/0412</i> (2013.01); <i>A61B 2562/164</i> (2013.01)			6,149,602 A	11/2000 Arcelus
				6,149,781 A	11/2000 Forand
				6,188,407 B1	2/2001 Smith et al.
				D443,063 S	5/2001 Pisani et al.
				6,245,025 B1	6/2001 Torok et al.
				6,246,330 B1	6/2001 Nielsen
				6,249,696 B1	6/2001 Olson et al.
				D445,507 S	7/2001 Pisani et al.
				6,269,267 B1	7/2001 Bardy et al.
(58)	<b>Field of Classification Search</b>			6,272,385 B1	8/2001 Bishay et al.
	CPC ..... A61B 2018/00351; A61N 1/04; A61N 1/0484			6,298,255 B1	10/2001 Cordero et al.
	USPC ..... 600/372, 382, 384, 386, 388, 390-393, 600/508-509			6,301,502 B1	10/2001 Owen et al.
	See application file for complete search history.			6,304,773 B1	10/2001 Taylor et al.
				6,304,780 B1	10/2001 Owen et al.
				6,304,783 B1	10/2001 Lyster et al.
				6,374,138 B1	4/2002 Owen et al.
				6,416,471 B1	7/2002 Kumar et al.
				6,418,342 B1	7/2002 Owen et al.
(56)	<b>References Cited</b>			6,424,860 B1	7/2002 Karlsson et al.
	<b>U.S. PATENT DOCUMENTS</b>			6,427,083 B1	7/2002 Owen et al.
	3,893,453 A	7/1975	Goldberg	6,454,708 B1	9/2002 Ferguson et al.
	4,123,785 A	10/1978	Cherry et al.	6,456,872 B1	9/2002 Faisandier
	4,328,814 A	5/1982	Arkans	6,463,320 B1	10/2002 Xue et al.
	4,441,500 A	1/1984	Sessions et al.	6,546,285 B1	4/2003 Owen et al.
	4,532,934 A	8/1985	Kelen	6,605,046 B1	8/2003 Del Mar
	4,546,342 A	10/1985	Weaver et al.	6,607,485 B2	8/2003 Bardy
	4,550,502 A	11/1985	Grayzel	6,611,705 B2	8/2003 Hopman et al.
	4,580,572 A	4/1986	Granek et al.	6,671,545 B2	12/2003 Fincke
	4,716,903 A	1/1988	Hansen	6,671,547 B2	12/2003 Lyster et al.
	4,809,705 A	3/1989	Ascher	6,694,186 B2	2/2004 Bardy
	4,915,656 A	4/1990	Alferness	6,704,595 B2	3/2004 Bardy
	5,007,429 A	4/1991	Treatch et al.	6,705,991 B2	3/2004 Bardy
	5,025,794 A	6/1991	Albert et al.	6,719,701 B2	4/2004 Lade
	5,168,876 A	12/1992	Quedens et al.	6,754,523 B2	6/2004 Toole
	5,215,098 A	6/1993	Steinhaus	6,782,293 B2	8/2004 Dupelle et al.
	D341,423 S	11/1993	Bible	6,856,832 B1	2/2005 Matsumura et al.
	5,265,579 A	11/1993	Ferrari	6,860,897 B2	3/2005 Bardy
	5,333,615 A	8/1994	William et al.	6,866,629 B2	3/2005 Bardy
	5,341,806 A	8/1994	Gadsby et al.	6,887,201 B2	5/2005 Bardy
	5,355,891 A	10/1994	Wateridge et al.	6,893,397 B2	5/2005 Bardy
	5,365,934 A	11/1994	Leon et al.	6,904,312 B2	6/2005 Bardy
	5,392,784 A	2/1995	Gudaitis	6,908,431 B2	6/2005 Bardy
	D357,069 S	4/1995	Plahn et al.	6,913,577 B2	7/2005 Bardy
	5,402,780 A	4/1995	Faasse, Jr.	6,944,498 B2	9/2005 Owen et al.
	5,402,884 A	4/1995	Gilman et al.	6,960,167 B2	11/2005 Bardy
	5,450,845 A	9/1995	Axelgaard	6,970,731 B1	11/2005 Jayaraman et al.
	5,458,141 A	10/1995	Neil	6,978,169 B1	12/2005 Guerra
	5,473,537 A	12/1995	Glazer et al.	6,993,377 B2	1/2006 Flick et al.
	5,483,969 A	1/1996	Testerman et al.	7,020,508 B2	3/2006 Stivoric et al.
	5,511,553 A	4/1996	Segalowitz	7,027,864 B2	4/2006 Snyder et al.
	5,540,733 A	7/1996	Testerman et al.	7,065,401 B2	6/2006 Warden
	5,546,952 A	8/1996	Erickson	7,085,601 B1	8/2006 Bardy et al.
	5,549,655 A	8/1996	Erickson	7,104,955 B2	9/2006 Bardy
	5,579,919 A	12/1996	Gilman et al.	7,134,996 B2	11/2006 Bardy
	5,582,181 A	12/1996	Ruess	7,137,389 B2	11/2006 Berthon-Jones
	D377,983 S	2/1997	Sabri et al.	7,147,600 B2	12/2006 Bardy
	5,601,089 A	2/1997	Bledsoe et al.	7,215,991 B2	5/2007 Besson et al.
	5,623,935 A	4/1997	Faisandier	7,248,916 B2	7/2007 Bardy
	5,682,901 A	11/1997	Kamen	7,257,438 B2	8/2007 Kinast
	5,697,955 A	12/1997	Stolte	7,277,752 B2	10/2007 Matos
	5,749,902 A	5/1998	Olsen et al.	D558,882 S	1/2008 Brady
	5,788,633 A	8/1998	Mahoney	7,328,061 B2	2/2008 Rowlandson et al.
	5,817,151 A	10/1998	Olsen et al.	7,412,395 B2	8/2008 Rowlandson et al.
				7,429,938 B1	9/2008 Corndorf

(56)

References Cited

U.S. PATENT DOCUMENTS

7,552,031 B2	6/2009	Vock et al.	2003/0176802 A1	9/2003	Galen et al.
D606,656 S	12/2009	Kobayashi et al.	2003/0211797 A1	11/2003	Hill et al.
7,706,870 B2	4/2010	Shieh et al.	2004/0008123 A1	1/2004	Carrender
7,756,721 B1	7/2010	Falchuk et al.	2004/0019288 A1	1/2004	Kinast
7,787,943 B2	8/2010	McDonough	2004/0034284 A1	2/2004	Aversano et al.
7,874,993 B2	1/2011	Bardy	2004/0049132 A1	3/2004	Barron et al.
7,881,785 B2	2/2011	Massif et al.	2004/0073127 A1	4/2004	Istvan et al.
D639,437 S	6/2011	Bishay et al.	2004/0087836 A1	5/2004	Green et al.
7,959,574 B2	6/2011	Bardy	2004/0093192 A1	5/2004	Hasson et al.
8,116,841 B2	2/2012	Bly et al.	2004/0148194 A1	7/2004	Wellons et al.
8,150,502 B2	4/2012	Kumar et al.	2004/0207530 A1	10/2004	Nielsen
8,160,682 B2	4/2012	Kumar et al.	2004/0236202 A1	11/2004	Burton
8,172,761 B1	5/2012	Rulkov et al.	2004/0243435 A1	12/2004	Williams
8,180,425 B2	5/2012	Selvitelli et al.	2004/0256453 A1	12/2004	Lammle
8,200,320 B2	6/2012	Kovacs	2004/0260188 A1	12/2004	Syed et al.
8,231,539 B2	7/2012	Bardy	2004/0260192 A1	12/2004	Yamamoto
8,231,540 B2	7/2012	Bardy	2005/0096717 A1	5/2005	Bishay et al.
8,239,012 B2	8/2012	Felix et al.	2005/0108055 A1	5/2005	Ott et al.
8,249,686 B2	8/2012	Libbus et al.	2005/0154267 A1	7/2005	Bardy
8,260,414 B2	9/2012	Nassif et al.	2005/0182308 A1	8/2005	Bardy
8,266,008 B1	9/2012	Siegal et al.	2005/0182309 A1	8/2005	Bardy
8,277,378 B2	10/2012	Bardy	2005/0215918 A1	9/2005	Frantz et al.
8,285,356 B2	10/2012	Bly et al.	2005/0222513 A1	10/2005	Hadley et al.
8,285,370 B2	10/2012	Felix et al.	2005/0228243 A1	10/2005	Bardy
8,308,650 B2	11/2012	Bardy	2005/0245839 A1	11/2005	Stivoric et al.
8,315,687 B2*	11/2012	Cross	2006/0025696 A1	2/2006	Kurzweil et al.
		A61B 5/04085	2006/0025824 A1	2/2006	Freeman et al.
		600/391	2006/0030767 A1	2/2006	Lang et al.
			2006/0041201 A1	2/2006	Behbehani et al.
			2006/0122469 A1	6/2006	Martel
			2006/0124193 A1	6/2006	Orr et al.
8,366,629 B2	2/2013	Bardy	2006/0224072 A1	10/2006	Shennib
8,374,688 B2	2/2013	Libbus et al.	2006/0235320 A1	10/2006	Tan et al.
8,412,317 B2	4/2013	Mazar	2006/0253006 A1	11/2006	Bardy
8,460,189 B2	6/2013	Libbus et al.	2006/0264730 A1	11/2006	Stivoric et al.
8,473,047 B2	6/2013	Chakravarthy et al.	2006/0264767 A1	11/2006	Shennib
8,478,418 B2	7/2013	Fahey	2007/0003115 A1	1/2007	Patton et al.
8,554,311 B2	10/2013	Warner et al.	2007/0038057 A1	2/2007	Nam et al.
8,591,430 B2	11/2013	Amurthur et al.	2007/0050209 A1	3/2007	Yered
8,594,763 B1	11/2013	Bibian et al.	2007/0078324 A1	4/2007	Wijisiriwardana
8,600,486 B2	12/2013	Kaib et al.	2007/0078354 A1	4/2007	Holland
8,613,708 B2	12/2013	Bishay et al.	2007/0093719 A1	4/2007	Nichols, Jr. et al.
8,613,709 B2	12/2013	Bishay et al.	2007/0100248 A1	5/2007	Van Dam et al.
8,620,418 B1	12/2013	Andover	2007/0100667 A1	5/2007	Bardy
8,626,277 B2	1/2014	Felix et al.	2007/0123801 A1	5/2007	Goldberger et al.
8,668,653 B2	3/2014	Nagata et al.	2007/0136091 A1	6/2007	McTaggart
8,684,925 B2	4/2014	Manicka et al.	2007/0179357 A1	8/2007	Bardy
8,688,190 B2	4/2014	Libbus et al.	2007/0185390 A1	8/2007	Perkins et al.
8,718,752 B2	5/2014	Libbus et al.	2007/0203415 A1	8/2007	Bardy
8,744,561 B2	6/2014	Fahey	2007/0203423 A1	8/2007	Bardy
8,774,932 B2	7/2014	Fahey	2007/0208232 A1	9/2007	Kovacs
8,790,257 B2	7/2014	Libbus et al.	2007/0208233 A1	9/2007	Kovacs
8,790,259 B2	7/2014	Katra et al.	2007/0208266 A1	9/2007	Hadley
8,795,174 B2	8/2014	Manicka et al.	2007/0225611 A1	9/2007	Kumar et al.
8,798,729 B2	8/2014	Kaib et al.	2007/0244405 A1	10/2007	Kue et al.
8,798,734 B2	8/2014	Kuppuraj et al.	2007/0249946 A1	10/2007	Kumar
8,818,478 B2	8/2014	Scheffler et al.	2007/0255153 A1	11/2007	Kumar
8,818,481 B2	8/2014	Bly et al.	2007/0265510 A1	11/2007	Bardy
8,823,490 B2	9/2014	Libbus et al.	2007/0276270 A1	11/2007	Tran
8,938,287 B2	1/2015	Felix et al.	2007/0276275 A1	11/2007	Proctor et al.
8,965,492 B2	2/2015	Baker et al.	2007/0293738 A1	12/2007	Bardy
9,066,664 B2	6/2015	Karjalainen	2007/0293739 A1	12/2007	Bardy
9,155,484 B2	10/2015	Baker et al.	2007/0293740 A1	12/2007	Bardy
9,204,813 B2	12/2015	Kaib et al.	2007/0293741 A1	12/2007	Bardy
9,277,864 B2	3/2016	Yang et al.	2007/0293772 A1	12/2007	Bardy
9,339,202 B2	5/2016	Brockway et al.	2007/0299325 A1	12/2007	Farrell et al.
9,439,566 B2*	9/2016	Arne	2007/0299617 A1	12/2007	Willis
		A61B 5/0022	2008/0027339 A1	1/2008	Nagai et al.
2002/0013538 A1	1/2002	Teller	2008/0051668 A1	2/2008	Bardy
2002/0013717 A1	1/2002	Ando et al.	2008/0058661 A1	3/2008	Bardy
2002/0103422 A1	8/2002	Harder et al.	2008/0091097 A1	4/2008	Linti et al.
2002/0109621 A1	8/2002	Khair et al.	2008/0108890 A1	5/2008	Teng et al.
2002/0120310 A1	8/2002	Linden et al.	2008/0114232 A1	5/2008	Gazit
2002/0184055 A1	12/2002	Naghavi et al.	2008/0139953 A1	6/2008	Baker et al.
2002/0193668 A1	12/2002	Munneke	2008/0143080 A1	6/2008	Burr
2003/0004547 A1	1/2003	Owen et al.	2008/0177168 A1	7/2008	Callahan et al.
2003/0073916 A1	4/2003	Yonce	2008/0194927 A1	8/2008	KenKnight et al.
2003/0083559 A1	5/2003	Thompson	2008/0208009 A1	8/2008	Shklarski
2003/0097078 A1	5/2003	Maeda	2008/0208014 A1	8/2008	KenKnight et al.
2003/0139785 A1	7/2003	Rif et al.			

(56)

## References Cited

## U.S. PATENT DOCUMENTS

2008/0284599 A1 11/2008 Zdeblick et al.  
 2008/0288026 A1 11/2008 Cross et al.  
 2008/0306359 A1 12/2008 Zdeblick et al.  
 2008/0312522 A1 12/2008 Rowlandson et al.  
 2009/0054952 A1 2/2009 Glukhovskiy et al.  
 2009/0062897 A1 3/2009 Axelgaard  
 2009/0069867 A1 3/2009 KenKnight et al.  
 2009/0073991 A1 3/2009 Landrum et al.  
 2009/0076336 A1 3/2009 Mazar et al.  
 2009/0076341 A1 3/2009 James et al.  
 2009/0076342 A1 3/2009 Amurthur et al.  
 2009/0076343 A1 3/2009 James et al.  
 2009/0076346 A1 3/2009 James et al.  
 2009/0076349 A1 3/2009 Libbus et al.  
 2009/0076397 A1 3/2009 Libbus et al.  
 2009/0076401 A1 3/2009 Mazar et al.  
 2009/0076559 A1 3/2009 Libbus et al.  
 2009/0088652 A1 4/2009 Tremblay  
 2009/0112116 A1 4/2009 Lee et al.  
 2009/0131759 A1 5/2009 Sims et al.  
 2009/0216132 A1 8/2009 Orbach  
 2009/0264792 A1 10/2009 Mazar  
 2009/0270708 A1 10/2009 Shen et al.  
 2009/0270747 A1 10/2009 Van Dam et al.  
 2009/0292194 A1 11/2009 Libbus et al.  
 2010/0007413 A1 1/2010 Herleikson et al.  
 2010/0022897 A1 1/2010 Parker et al.  
 2010/0056881 A1 3/2010 Libbus et al.  
 2010/0081913 A1 4/2010 Cross et al.  
 2010/0185063 A1 7/2010 Bardy  
 2010/0185076 A1 7/2010 Jeong et al.  
 2010/0191154 A1 7/2010 Berger et al.  
 2010/0191310 A1 7/2010 Bly  
 2010/0234715 A1 9/2010 Shin et al.  
 2010/0234716 A1 9/2010 Engel  
 2010/0280366 A1 11/2010 Arne et al.  
 2010/0324384 A1 12/2010 Moon et al.  
 2011/0021937 A1 1/2011 Hugh et al.  
 2011/0054286 A1 3/2011 Crosby et al.  
 2011/0066041 A1 3/2011 Pandia et al.  
 2011/0077497 A1 3/2011 Oster et al.  
 2011/0144470 A1 6/2011 Mazar et al.  
 2011/0160548 A1 6/2011 Forster et al.  
 2011/0224564 A1 9/2011 Moon et al.  
 2011/0237924 A1 9/2011 McGusty et al.  
 2011/0245699 A1 10/2011 Snell et al.  
 2011/0245711 A1 10/2011 Ktra et al.  
 2012/0003933 A1 1/2012 Baker et al.  
 2012/0029306 A1 2/2012 Paquet et al.  
 2012/0029315 A1 2/2012 Raptis et al.  
 2012/0029316 A1 2/2012 Raptis et al.  
 2012/0035432 A1 2/2012 Ktra et al.  
 2012/0088998 A1 4/2012 Bardy et al.  
 2012/0088999 A1 4/2012 Bishay et al.  
 2012/0089000 A1 4/2012 Bishay et al.  
 2012/0089001 A1 4/2012 Bishay et al.  
 2012/0089037 A1 4/2012 Bishay et al.  
 2012/0089412 A1 4/2012 Bardy et al.  
 2012/0089417 A1 4/2012 Bardy et al.  
 2012/0095352 A1 4/2012 Tran  
 2012/0101358 A1 4/2012 Boettcher et al.  
 2012/0101396 A1 4/2012 Solosko et al.  
 2012/0165645 A1 6/2012 Russel et al.  
 2012/0172695 A1 7/2012 Ko et al.  
 2012/0302906 A1 11/2012 Felix et al.  
 2012/0330126 A1 12/2012 Hoppe et al.  
 2013/0041272 A1 2/2013 Guillen Arredondo et al.  
 2013/0077263 A1 3/2013 Oleson et al.  
 2013/0079611 A1 3/2013 Besko  
 2013/0085403 A1 4/2013 Gunderson et al.  
 2013/0096395 A1 4/2013 Ktra et al.  
 2013/0116533 A1 5/2013 Lian et al.  
 2013/0123651 A1 5/2013 Bardy  
 2013/0158361 A1 6/2013 Bardy  
 2013/0197380 A1 8/2013 Oral et al.

2013/0225963 A1 8/2013 Kodandaramaiah et al.  
 2013/0225966 A1 8/2013 Macia Barber et al.  
 2013/0243105 A1 9/2013 Lei et al.  
 2013/0274584 A1 10/2013 Finlay et al.  
 2013/0275158 A1 10/2013 Fahey  
 2013/0324809 A1 12/2013 Lisogurski et al.  
 2013/0324855 A1 12/2013 Lisogurski et al.  
 2013/0324856 A1 12/2013 Lisogurski et al.  
 2013/0325359 A1 12/2013 Jarverud et al.  
 2013/0331665 A1 12/2013 Libbus et al.  
 2013/0338448 A1 12/2013 Libbus et al.  
 2013/0338472 A1 12/2013 Macia Barber et al.  
 2014/0012154 A1 1/2014 Mazar et al.  
 2014/0140359 A1 5/2014 Kalevo et al.  
 2014/0189928 A1 7/2014 Oleson et al.  
 2014/0206977 A1 7/2014 Bahney et al.  
 2014/0215246 A1 7/2014 Lee et al.  
 2014/0358193 A1 12/2014 Lyons et al.  
 2015/0048836 A1 2/2015 Guthrie et al.  
 2015/0257670 A1 9/2015 Ortega et al.  
 2015/0359489 A1 12/2015 Baudenbacher et al.  
 2016/0217691 A1 7/2016 Kadobayashi et al.

## FOREIGN PATENT DOCUMENTS

EP 2438851 4/2012  
 EP 2438852 4/2012  
 EP 2465415 6/2012  
 EP 2589333 5/2013  
 JP H06319711 11/1994  
 JP 2004129788 4/2004  
 WO 200078213 12/2000  
 WO 2003032192 4/2003  
 WO 2006009767 1/2006  
 WO 2006014806 2/2006  
 WO 2007066270 6/2007  
 WO 2007092543 8/2007  
 WO 2008010216 1/2008  
 WO 2008057884 5/2008  
 WO 2009036306 3/2009  
 WO 2009036313 3/2009  
 WO 2009036327 3/2009  
 WO 2009112976 9/2009  
 WO 2009112978 9/2009  
 WO 2009112979 9/2009  
 WO 2009142975 11/2009  
 WO 2010066507 6/2010  
 WO 2010105045 9/2010  
 WO 2011047207 4/2011  
 WO 2012140559 10/2012  
 WO 2012146957 10/2012

## OTHER PUBLICATIONS

Duttweiler et al., "Probability Estimation in Arithmetic and Adaptive-Huffman Entropy Coders," IEEE Transactions on Image Processing, vol. 4, No. 3, Mar. 1, 1995, pp. 237-246.  
 Gupta et al., "An ECG Compression Technique for Telecardiology Application," India Conference (INDICON), 2011 Annual IEEE, Dec. 16, 2011, pp. 1-4.  
 Nave et al., "ECG Compression Using Long-Term Prediction," IEEE Transactions on Biomedical Engineering, IEEE Service Center, NY, USA, vol. 40, No. 9, Sep. 1, 1993, pp. 877-885.  
 Skretting et al., "Improved Huffman Coding Using Recursive Splitting," NORSIG, Jan. 1, 1999.  
 A Voss et al., "Linear and Nonlinear Methods for Analyses of Cardiovascular Variability in Bipolar Disorders," Bipolar Disorders, vol. 8, No. 5p. 1, Oct. 1, 2006, pp. 441-452, XP55273826, DK ISSN: 1398-5647, DOI: 10.1111/i.1399-5618.2006.00364.x.  
 "Varicrad-Kardi Software User's Manual Rev. 1.1", Jul. 8, 2009 (Jul. 8, 2009), XP002757888, retrieved from the Internet: URL:<http://www.ehrlich.tv/KARDiVAR-Software.pdf> [retrieved on May 20, 2016].  
 BIOPAC Systems, Inc. #AS148-Automated ECG Analysis, Mar. 24, 2006.  
<https://web.archive.org/web/20130831204020/http://www.biopac.com/research.asp?CatID=37&Main=Software> (Aug. 2013).

(56)

## References Cited

## OTHER PUBLICATIONS

Adinstruments:ECG Analysis Module for LabChart & PowerLab, 2008.

15 of the Hottest Wearable Gadgets, URL <<http://thehottestgadgets.com/2008/09/the-15-hottest-wearable-gadgets-001253>> (Web page cached on Sep. 27, 2008).

Alivecor's Heart Monitor for iPhone Receives FDA Clearance, URL <<http://www.businesswire.com/news/home/20121203005545/en/AliveCor%E2%80%99s-Heart-Monitor-iPhone-Receives-FDA-Clearance#.U7rtq7FVTyF>> (Dec. 3, 2012).

Bharadwaj et al., Techniques for Accurate ECG signal processing, *EE Times*, URL <[http://www.eetimes.com/document.asp?doc\\_id=1278571](http://www.eetimes.com/document.asp?doc_id=1278571)> (Feb. 14, 2011).

Chen et al., "Monitoring Body Temperature of Newborn Infants At Neonatal Intensive Care Units Using Wearable Sensors," *BodyNets 2010*, Corfu Island, Greece. (Sep. 10, 2010).

Epstein, Andrew E. et al.; ACC/AJA/HRS 2008 Guidelines for Device-Based Therapy of Cardiac Rhythm Abnormalities. *J. Am. Coll. Cardiol.* 2008; 51; el-e62, 66 Pgs.

Fitbit automatically tracks your fitness and sleep, URL <<http://www.fitbit.com/>> (Web page cached on Sep. 10, 2008).

Smith, Kevin, "Jawbone Up VS. Fitbit Flex: Which Is the Best Fitness Band?" URL <<http://www.businessinsider.com/fitbit-flex-vs-jawbone-up-2013-5?op=1>> (Jun. 1, 2013).

Kligfield, Paul et al., Recommendations for the Standardization and Interpretation of the Electrocardiogram: Part I. *J. Am. Coll. Cardiol.* 2007; 49; 1109-27, 75 Pgs.

Lauren Gravitiz, "When Your Diet Needs a Band-Aid," *Technology Review*, MIT. (May 1, 2009).

Lieberman, Jonathan, "How Telemedicine Is Aiding Prompt ECG Diagnosis in Primary Care," *British Journal of Community Nursing*, vol. 13, No. 3, Mar. 1, 2008 (Mar. 1, 2008), pp. 123-126, XP009155082, ISSN: 1462-4753.

McManus et al., "A Novel Application for the Detection of an Irregular Pulse using an iPhone 4S in Patients with Atrial Fibrillation," vol. 10(3), pp. 315-319 (Mar. 2013).

Nike+ Fuel Band, URL <[http://www.nike.com/us/en\\_us/c/nikeplus-fuelband](http://www.nike.com/us/en_us/c/nikeplus-fuelband)> (Web page cached on Jan. 11, 2013).

P. Libby et al., "Braunwald's Heart Disease—A Textbook of Cardiovascular Medicine," Chs. 11, pp. 125-148 and 12, pp. 149-193 (8th ed. 2008), American Heart Association.

Initial hands-on with Polar Loop activity tracker, URL <<http://www.dcrainmaker.com/2013/09/polar-loop-firstlook.html>> (Sep. 17, 2013).

Sittig et al., "A Computer-Based Outpatient Clinical Referral System," *International Journal of Medical Informatics*, Shannon, IR, vol. 55, No. 2, Aug. 1, 1999, pp. 149-158, XO004262434, ISSN: 1386-5056(99)00027-1.

Sleepview, URL <<http://www.clevemed.com/sleepview/overview.shtml>> (Web pages cached on Feb. 23, 2010, Dec. 29, 2012 and Sep. 4, 2013).

Actigraphy/ Circadian Rhythm SOMNOWatch, URL <<http://www.somnomedics.eu/news-events/publications/somnowatchtm.html>> (Web page cached on Jan. 23, 2010).

Zio Event Card, URL <<http://www.irhythmtech.com/zio-solution/zio-event/>> (Web page cached on Mar. 11, 2013).

Zio Patch System, URL <<http://www.irhythmtech.com/zio-solution/zio-system/index.html>> (Web page cached on Sep. 8, 2013).

Libbus. "Adherent Cardiac Monitor With Wireless Fall Detection for Patients With Unexplained Syncope." Abstracts of the First AMA-IEEE Medical Technology Conference on Individualized Healthcare. May 22, 2010.

Daoud et al. "Fall Detection Using Shimmer Technology and Multiresolution Analysis." Aug. 2, 2013. URL: <https://decibel.ni.com/content/docs/DOC-26652>.

Chan et al. "Wireless Patch Sensor for Remote Monitoring of Heart Rate, Respiration, Activity, and Falls." pp. 6115-6118. 2013 35th Annual International Conference of the IEEE Engineering in Medical and Biology Societ. Jul. 1, 2013.

Saadi et al. "Heart Rhythm Analysis Using ECG Recorded With a Novel Sternum Based Patch Technology—A Pilot Study." *Cardio technix 2013—Proceedings of the International Congress on Cardiovascular Technologies*, Sep. 20, 2013.

Anonymous. "Omegawave Launches Consumer App 2.0 in U.S. Endurance Sportswire—Endurance Sportswire." Jul. 11, 2013. URL:<http://endurancesportswire.com/omegawave-launches-consumer-app-2-0-in-u-s/>.

\* cited by examiner

**Fig. 1.**

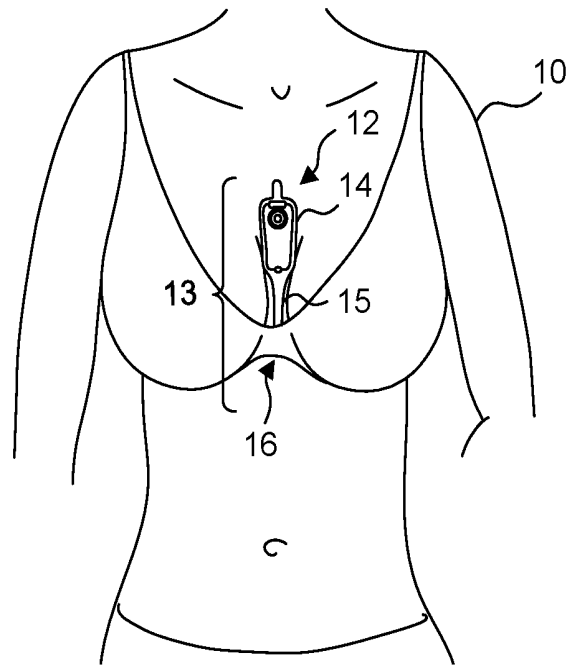

**Fig. 2.**

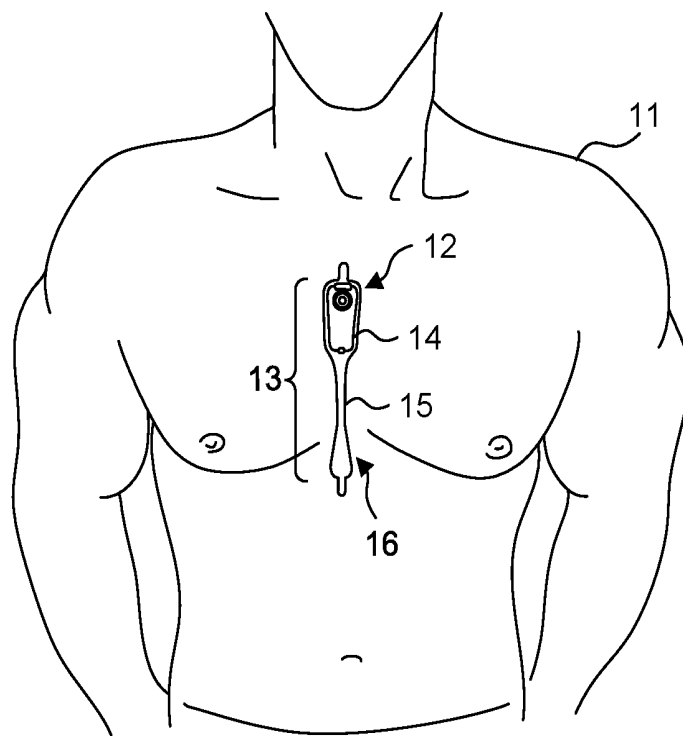

Fig. 3.

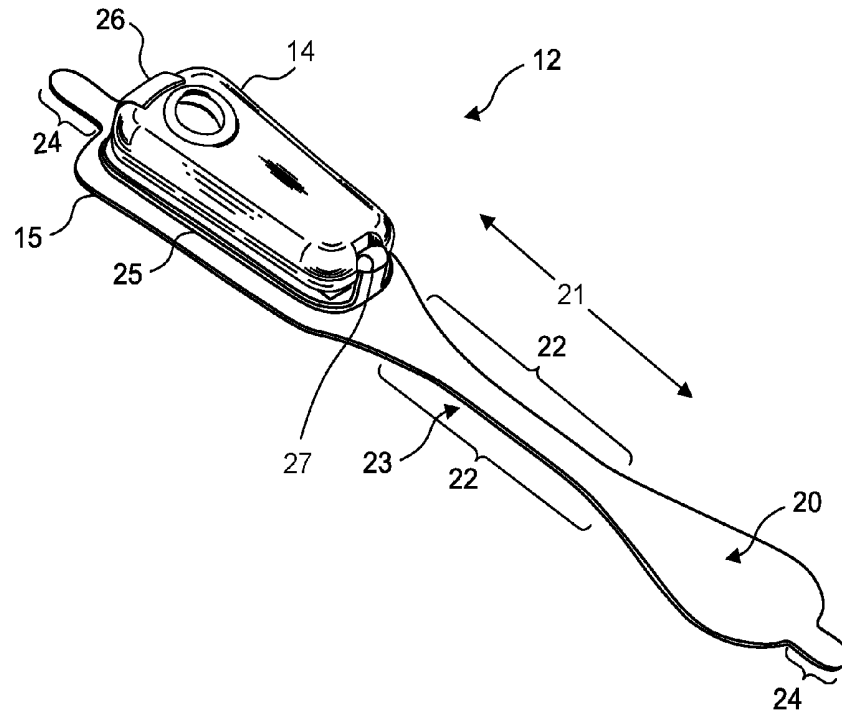

Fig. 4.

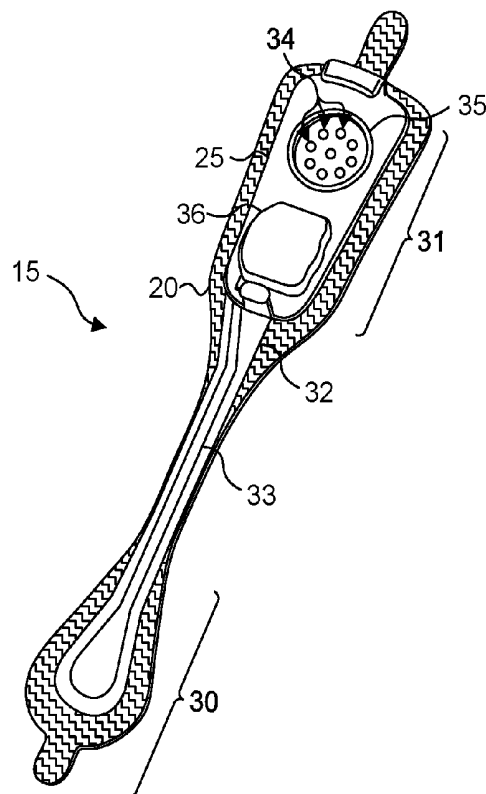

Fig. 5.

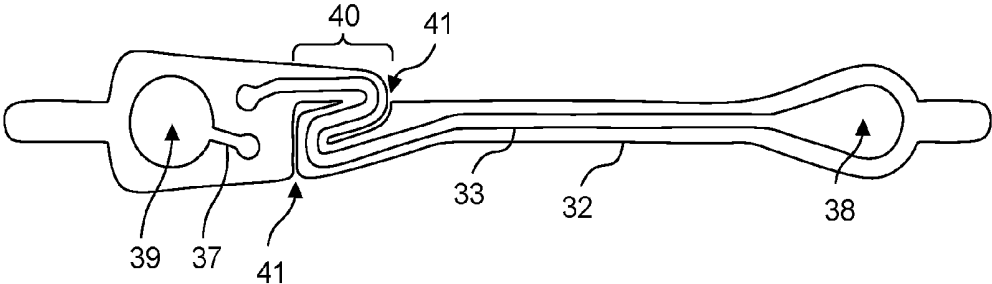

Fig. 6.

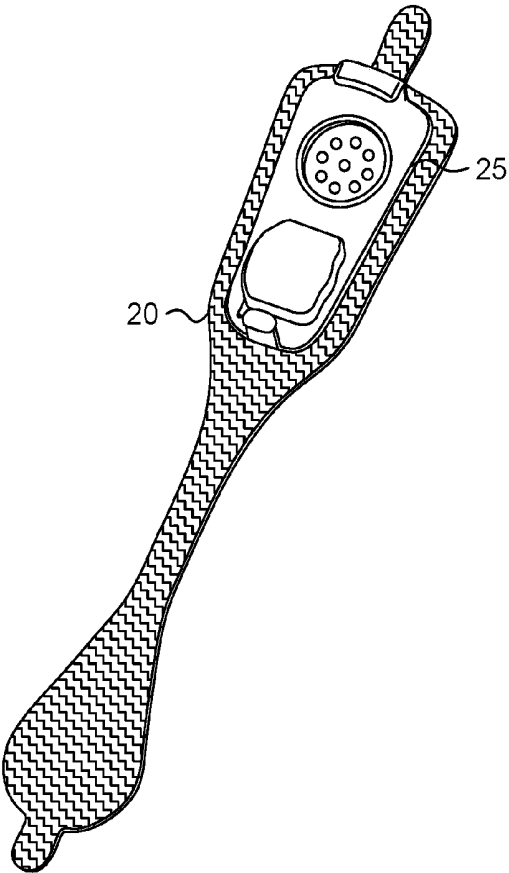

Fig. 7.

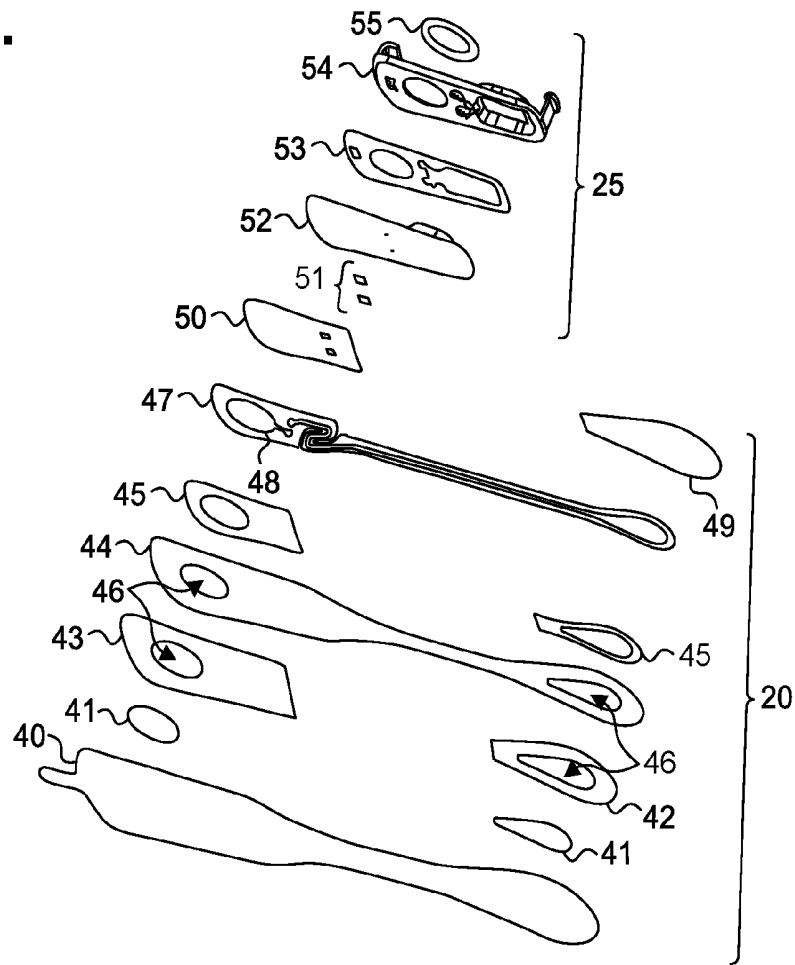
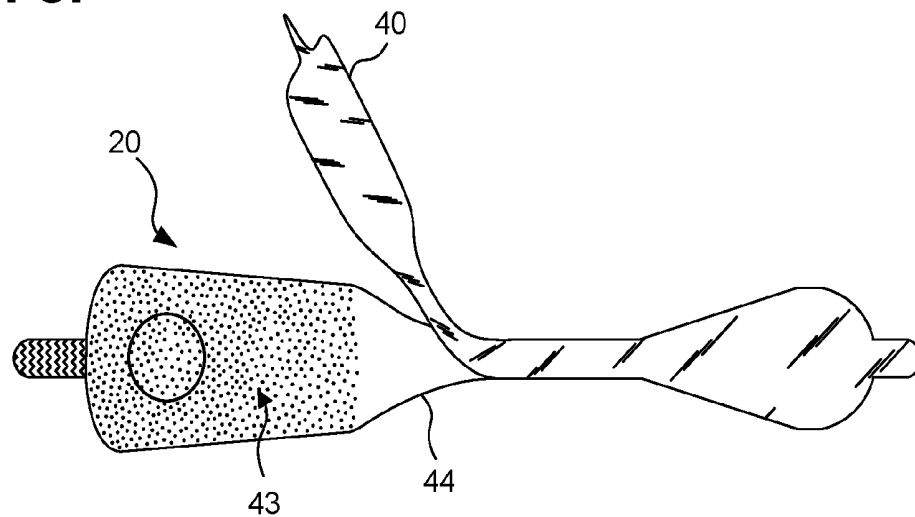

Fig. 8.



**ELECTROCARDIOGRAPHY PATCH****CROSS-REFERENCE TO RELATED APPLICATION**

This U.S. patent application is a continuation of U.S. patent application Ser. No. 14/080,717, filed Nov. 14, 2013, which claims priority under 35 U.S.C. § 119(e) to U.S. Provisional Patent application Ser. No. 61/882,403, filed Sep. 25, 2013, the disclosure of which is incorporated by reference.

**FIELD**

This application relates in general to electrocardiographic monitoring and, in particular, to an electrocardiography patch.

**BACKGROUND**

The heart emits electrical signals as a by-product of the propagation of the action potentials that trigger depolarization of heart fibers. An electrocardiogram (ECG) measures and records such electrical potentials to visually depict the electrical activity of the heart over time. Conventionally, a standardized set format 12-lead configuration is used by an ECG machine to record cardiac electrical signals from well-established traditional chest locations. Electrodes at the end of each lead are placed on the skin over the anterior thoracic region of the patient's body to the lower right and to the lower left of the sternum, on the left anterior chest, and on the limbs. Sensed cardiac electrical activity is represented by PQRSTU waveforms that can be interpreted post-ECG recordation to derive heart rate and physiology. The P-wave represents atrial electrical activity. The QRSTU components represent ventricular electrical activity.

An ECG is a tool used by physicians to diagnose heart problems and other potential health concerns. An ECG is a snapshot of heart function, typically recorded over 12 seconds, that can help diagnose rate and regularity of heartbeats, effect of drugs or cardiac devices, including pacemakers and implantable cardioverter-defibrillators (ICDs), and whether a patient has heart disease. ECGs are used in-clinic during appointments, and, as a result, are limited to recording only those heart-related aspects present at the time of recording. Sporadic conditions that may not show up during a spot ECG recording require other means to diagnose them. These disorders include fainting or syncope; rhythm disorders, such as tachyarrhythmias and bradyarrhythmias; apneic episodes; and other cardiac and related disorders. Thus, an ECG only provides a partial picture and can be insufficient for complete patient diagnosis of many cardiac disorders.

Diagnostic efficacy can be improved, when appropriate, through the use of long-term extended ECG monitoring. Recording sufficient ECG and related physiology over an extended period is challenging, and often essential to enabling a physician to identify events of potential concern. A 30-day observation day period is considered the "gold standard" of ECG monitoring, yet achieving a 30-day observation day period has proven unworkable because such ECG monitoring systems are arduous to employ, cumbersome to the patient, and excessively costly. Ambulatory monitoring in-clinic is implausible and impracticable. Nevertheless, if a patient's ECG could be recorded in an ambulatory setting, thereby allowing the patient to engage in activities of daily living, the chances of acquiring meaningful information and

capturing an abnormal event while the patient is engaged in normal activities becomes more likely to be achieved.

For instance, the long-term wear of ECG electrodes is complicated by skin irritation and the inability ECG electrodes to maintain continual skin contact after a day or two. Moreover, time, dirt, moisture, and other environmental contaminants, as well as perspiration, skin oil, and dead skin cells from the patient's body, can get between an ECG electrode, the non-conductive adhesive used to adhere the ECG electrode, and the skin's surface. All of these factors adversely affect electrode adhesion and the quality of cardiac signal recordings. Furthermore, the physical movements of the patient and their clothing impart various compressional, tensile, and torsional forces on the contact point of an ECG electrode, especially over long recording times, and an inflexibly fastened ECG electrode will be prone to becoming dislodged. Moreover, dislodgment may occur unbeknownst to the patient, making the ECG recordings worthless. Further, some patients may have skin that is susceptible to itching or irritation, and the wearing of ECG electrodes can aggravate such skin conditions. Thus, a patient may want or need to periodically remove or replace ECG electrodes during a long-term ECG monitoring period, whether to replace a dislodged electrode, reestablish better adhesion, alleviate itching or irritation, allow for cleansing of the skin, allow for showering and exercise, or for other purpose. Such replacement or slight alteration in electrode location actually facilitates the goal of recording the ECG signal for long periods of time.

Conventionally, Holter monitors are widely used for long-term extended ECG monitoring. Typically, they are often used for only 24-48 hours. A typical Holter monitor is a wearable and portable version of an ECG that include cables for each electrode placed on the skin and a separate battery-powered ECG recorder. The cable and electrode combination (or leads) are placed in the anterior thoracic region in a manner similar to what is done with an in-clinic standard ECG machine. The duration of a Holter monitoring recording depends on the sensing and storage capabilities of the monitor, as well as battery life. A "looping" Holter (or event) monitor can operate for a longer period of time by overwriting older ECG tracings, thence "recycling" storage in favor of extended operation, yet at the risk of losing event data. Although capable of extended ECG monitoring, Holter monitors are cumbersome, expensive and typically only available by medical prescription, which limits their usability. Further, the skill required to properly place the electrodes on the patient's chest hinders or precludes a patient from replacing or removing the precordial leads and usually involves moving the patient from the physician office to a specialized center within the hospital or clinic.

The ZIO XT Patch and ZIO Event Card devices, manufactured by iRhythm Tech., Inc., San Francisco, Calif., are wearable stick-on monitoring devices that are typically worn on the upper left pectoral region to respectively provide continuous and looping ECG recording. The location is used to simulate surgically implanted monitors. Both of these devices are prescription-only and for single patient use. The ZIO XT Patch device is limited to a 14-day monitoring period, while the electrodes only of the ZIO Event Card device can be worn for up to 30 days. The ZIO XT Patch device combines both electronic recordation components and physical electrodes into a unitary assembly that adheres to the patient's skin. The ZIO XT Patch device uses adhesive sufficiently strong to support the weight of both the monitor and the electrodes over an extended period of time and to resist disadherence from the patient's body, albeit at the cost

of disallowing removal or relocation during the monitoring period. The ZIO Event Card device is a form of downsized Holter monitor with a recorder component that must be removed temporarily during baths or other activities that could damage the non-waterproof electronics. Both devices represent compromises between length of wear and quality of ECG monitoring, especially with respect to ease of long term use, female-friendly fit, and quality of atrial (P-wave) signals.

Therefore, a need remains for an extended wear continuously recording ECG monitor practicably capable of being worn for a long period of time, especially in women where breast anatomy can interfere with signal quality in both men and women and capable of recording atrial signals reliably.

A further need remains for a device capable of recording signals ideal for arrhythmia discrimination, especially a device designed for atrial activity recording.

### SUMMARY

Physiological monitoring can be provided through a wearable monitor that includes two components, a flexible extended wear electrode patch and a removable reusable monitor recorder. The wearable monitor sits centrally (in the midline) on the patient's chest along the sternum oriented top-to-bottom. The placement of the wearable monitor in a location at the sternal midline (or immediately to either side of the sternum), with its unique narrow "hourglass"-like shape, significantly improves the ability of the wearable monitor to cutaneously sense cardiac electric signals, particularly the P-wave (or atrial activity) and, to a lesser extent, the QRS interval signals in the ECG waveforms indicating ventricular activity. The electrode patch is shaped to fit comfortably and conformal to the contours of the patient's chest approximately centered on the sternal midline. To counter the dislodgment due to compressional and torsional forces, a layer of non-irritating adhesive, such as hydrocolloid, is provided at least partially on the underside, or contact, surface of the electrode patch, but only on the electrode patch's distal and proximal ends. To counter dislodgment due to tensile and torsional forces, a strain relief is defined in the electrode patch's flexible circuit using cutouts partially extending transversely from each opposite side of the flexible circuit and continuing longitudinally towards each other to define in 'S'-shaped pattern. Each of these components are distinctive and allow for comfortable and extended wear, especially by women, where breast mobility would otherwise interfere with monitor use and comfort.

One embodiment provides an extended wear electrocardiography patch. A flexible backing is formed of an elongated strip of stretchable material with a narrow longitudinal midsection evenly tapering inward from both ends. The elongated strip is adherable only on each end of a contact surface to serve as a crimp relief to facilitate compression of the narrow longitudinal midsection in response to compressional and torsional forces. A pair of electrocardiographic electrodes is respectively affixed to and conductively exposed on the contact surface of each end of the elongated strip. A flexible circuit is affixed on each end to the elongated strip. The flexible circuit includes a pair of circuit traces both originating within one of the ends of the elongated strip and which are electrically coupled to each electrocardiographic electrode. A laterally-extendable strain relief is defined in the flexible circuit and formed to facilitate extension and rotation of the flexible circuit in response to tensile and torsional forces. A non-conductive receptacle is securely adhered on

the one end of the elongated strip opposite the contact surface and is formed to removably receive an electrocardiography monitor. The non-conductive receptacle includes electrode terminals aligned to electrically interface the pair of circuit traces to the electrocardiography monitor.

A further embodiment provides an electrocardiography patch. A flexible backing is formed of an elongated strip of stretchable material and a pair of electrodes is respectively affixed on a contact surface of each end of the elongated strip. A flexible circuit is affixed on each end of the elongated strip and includes a pair of circuit traces electrically coupled to each electrode. A non-conductive receptacle is securely adhered on the one end of the elongated strip opposite the contact surface and formed to removably receive an electrocardiography monitor and house a battery. Electrical pads are provided on a bottom surface of the non-conductive receptacle to interface with electrical contacts protruding from the electrocardiography monitor. A pair of the electrical pads is formed to electrically couple with the electrodes. A pair of battery leads is formed on the non-conductive receptacle to electrically interface the battery to another pair of the electrical pads.

The monitoring patch is especially suited to the female anatomy. The narrow longitudinal midsection can fit nicely within the intermammary cleft of the breasts without inducing discomfort, whereas conventional patch electrodes are wide and, if adhered between the breasts, would cause chafing, irritation, frustration, and annoyance, leading to low patient compliance.

The foregoing aspects enhance ECG monitoring performance and quality facilitating long-term ECG recording, critical to accurate arrhythmia diagnosis.

In addition, the foregoing aspects enhance comfort in women (and certain men), but not irritation of the breasts, by placing the monitoring patch in the best location possible for optimizing the recording of cardiac signals from the atrium, another feature critical to proper arrhythmia diagnosis.

Still other embodiments will become readily apparent to those skilled in the art from the following detailed description, wherein are described embodiments by way of illustrating the best mode contemplated. As will be realized, other and different embodiments are possible and the embodiments' several details are capable of modifications in various obvious respects, all without departing from their spirit and the scope. Accordingly, the drawings and detailed description are to be regarded as illustrative in nature and not as restrictive.

### BRIEF DESCRIPTION OF THE DRAWINGS

FIGS. 1 and 2 are diagrams showing, by way of examples, an extended wear electrocardiography monitor, including an extended wear electrode patch in accordance with one embodiment, respectively fitted to the sternal region of a female patient and a male patient.

FIG. 3 is a perspective view showing an extended wear electrode patch in accordance with one embodiment with a monitor recorder inserted.

FIG. 4 is a perspective view showing the extended wear electrode patch of FIG. 3 without a monitor recorder inserted.

FIG. 5 is a top view showing the flexible circuit of the extended wear electrode patch of FIG. 3.

FIG. 6 is a perspective view showing the extended wear electrode patch in accordance with a further embodiment.

FIG. 7 is an exploded view showing the component layers of the electrode patch of FIG. 3.

FIG. 8 is a bottom plan view of the extended wear electrode patch of FIG. 3 with liner partially peeled back.

#### DETAILED DESCRIPTION

Physiological monitoring can be provided through a wearable monitor that includes two components, a flexible extended wear electrode patch and a removable reusable monitor recorder. FIGS. 1 and 2 are diagrams showing, by way of examples, an extended wear electrocardiography monitor 12, including an extended wear electrode patch 15 in accordance with one embodiment, respectively fitted to the sternal region of a female patient 10 and a male patient 11. The wearable monitor 12 sits centrally (in the midline) on the patient's chest along the sternum 13 oriented top-to-bottom with the monitor recorder 14 preferably situated towards the patient's head. The electrode patch 15 is shaped to fit comfortably and conformal to the contours of the patient's chest approximately centered on the sternal midline 16 (or immediately to either side of the sternum 13). The distal end of the electrode patch 15 extends towards the Xiphoid process and, depending upon the patient's build, may straddle the region over the Xiphoid process. The proximal end of the electrode patch 15, located under the monitor recorder 14, is below the manubrium and, depending upon patient's build, may straddle the region over the manubrium.

The placement of the wearable monitor 12 in a location at the sternal midline 16 (or immediately to either side of the sternum 13) significantly improves the ability of the wearable monitor 12 to cutaneously sense cardiac electric signals, particularly the P-wave (or atrial activity) and, to a lesser extent, the QRS interval signals in the ECG waveforms that indicate ventricular activity. The sternum 13 overlies the right atrium of the heart and the placement of the wearable monitor 12 in the region of the sternal midline 13 puts the ECG electrodes of the electrode patch 15 in a location better adapted to sensing and recording P-wave signals than other placement locations, say, the upper left pectoral region. In addition, placing the lower or inferior pole (ECG electrode) of the electrode patch 15 over (or near) the Xiphoid process facilitates sensing of right ventricular activity and provides superior recordation of the QRS interval.

During use, the electrode patch 15 is first adhered to the skin along the sternal midline 16 (or immediately to either side of the sternum 13). A monitor recorder 14 is then snapped into place on the electrode patch 15 to initiate ECG monitoring. FIG. 3 is a perspective view showing an extended wear electrode patch 15 in accordance with one embodiment with a monitor recorder 14 inserted. The body of the electrode patch 15 is preferably constructed using a flexible backing 20 formed as an elongated strip 21 of wrap knit or similar stretchable material about 145 mm long and 32 mm at the widest point with a narrow longitudinal mid-section 23 evenly tapering inward from both sides. A pair of cut-outs 22 between the distal and proximal ends of the electrode patch 15 create a narrow longitudinal mid-section 23 or "isthmus" and defines an elongated "hourglass"-like shape, when viewed from above, such as described in commonly-assigned U.S. Design Patent application, entitled "Extended Wear Electrode Patch," Ser. No. 29/472,045, filed Nov. 7, 2013, the disclosure of which is incorporated by reference. The upper part of the "hourglass" is sized to allow an electrically non-conductive receptacle 25, sits on top of the outward-facing surface of the electrode patch 15, to be affixed to the electrode patch 15 with an ECG electrode

placed underneath on the patient-facing underside, or contact, surface of the electrode patch 15; the upper part of the "hourglass" has a longer and wider profile than the lower part of the "hourglass," which is sized primarily to allow just the placement of an ECG electrode.

The electrode patch 15 incorporates features that significantly improve wearability, performance, and patient comfort throughout an extended monitoring period. During wear, the electrode patch 15 is susceptible to pushing, pulling, and torquing movements, including compressional and torsional forces when the patient bends forward, and tensile and torsional forces when the patient leans backwards. To counter these stress forces, the electrode patch 15 incorporates crimp and strain reliefs, as further described infra respectively with reference to FIGS. 4 and 5. In addition, the cut-outs 22 and longitudinal midsection 23 help minimize interference with and discomfort to breast tissue, particularly in women (and gynecomastic men). The cut-outs 22 and longitudinal midsection 23 allow better conformity of the electrode patch 15 to sternal bowing and to the narrow isthmus of flat skin that can occur along the bottom of the intermammary cleft between the breasts, especially in buxom women. The cut-outs 22 and longitudinal midsection 23 help the electrode patch 15 fit nicely between a pair of female breasts in the intermammary cleft. In one embodiment, the cut-outs 22 can be graduated to form the longitudinal midsection 23 as a narrow in-between stem or isthmus portion about 7 mm wide. In a still further embodiment, tabs 24 can respectively extend an additional 8 mm to 12 mm beyond the distal and proximal ends of the flexible backing 20 to facilitate purchase when adhering the electrode patch 15 to or removing the electrode patch 15 from the sternum 13. These tabs preferably lack adhesive on the underside, or contact, surface of the electrode patch 15. Still other shapes, cut-outs and conformities to the electrode patch 15 are possible.

The monitor recorder 14 removably and reusably snaps into an electrically non-conductive receptacle 25 during use. The monitor recorder 14 contains electronic circuitry for recording and storing the patient's electrocardiography as sensed via a pair of ECG electrodes provided on the electrode patch 15, such as described in commonly-assigned U.S. patent application, entitled "Extended Wear Ambulatory Electrocardiography and Physiological Sensor Monitor," Ser. No. 14/080,725, filed Nov. 14, 2013, pending, the disclosure of which is incorporated by reference. The circuitry includes a microcontroller, flash storage, ECG signal processing, analog-to-digital conversion (where applicable), and an external interface for coupling to the electrode patch 15 and to a download station for stored data download and device programming. The monitor recorder 14 also includes external patient-interfaceable controls, such as a push button to facilitate event marking and a resonance circuit to provide vibratory output. In a further embodiment, the circuitry, with the assistance of the appropriate types of deployed electrodes or sensors, is capable of monitoring other types of physiology, in addition to ECGs. Still other types of monitor recorder components and functionality are possible.

The non-conductive receptacle 25 is provided on the top surface of the flexible backing 20 with a retention catch 26 and tension clip 27 molded into the non-conductive receptacle 25 to conformably receive and securely hold the monitor recorder 14 in place. The edges of the bottom surface of the non-conductive receptacle 25 are preferably rounded, and the monitor recorder 14 is nestled inside the

interior of the non-conductive receptacle **25** to present a rounded (gentle) surface, rather than a sharp edge at the skin-to-device interface.

The electrode patch **15** is intended to be disposable. The monitor recorder **14**, however, is reusable and can be transferred to successive electrode patches **15** to ensure continuity of monitoring. The placement of the wearable monitor **12** in a location at the sternal midline **16** (or immediately to either side of the sternum **13**) benefits long-term extended wear by removing the requirement that ECG electrodes be continually placed in the same spots on the skin throughout the monitoring period. Instead, the patient is free to place an electrode patch **15** anywhere within the general region of the sternum **13**.

As a result, at any point during ECG monitoring, the patient's skin is able to recover from the wearing of an electrode patch **15**, which increases patient comfort and satisfaction, while the monitor recorder **14** ensures ECG monitoring continuity with minimal effort. A monitor recorder **14** is merely unsnapped from a worn out electrode patch **15**, the worn out electrode patch **15** is removed from the skin, a new electrode patch **15** is adhered to the skin, possibly in a new spot immediately adjacent to the earlier location, and the same monitor recorder **14** is snapped into the new electrode patch **15** to reinitiate and continue the ECG monitoring.

During use, the electrode patch **15** is first adhered to the skin in the sternal region. FIG. **4** is a perspective view showing the extended wear electrode patch **15** of FIG. **3** without a monitor recorder **14** inserted. A flexible circuit **32** is adhered to each end of the flexible backing **20**. A distal circuit trace **33** from the distal end **30** of the flexible backing **20** and a proximal circuit trace (not shown) from the proximal end **31** of the flexible backing **20** electrically couple ECG electrodes (not shown) to a pair of electrical pads **34**. The electrical pads **34** are provided within a moisture-resistant seal **35** formed on the bottom surface of the non-conductive receptacle **25**. When the monitor recorder **14** is securely received into the non-conductive receptacle **25**, that is, snapped into place, the electrical pads **34** interface to electrical contacts (not shown) protruding from the bottom surface of the monitor recorder **14**, and the moisture-resistant seal **35** enables the monitor recorder **14** to be worn at all times, even during bathing or other activities that could expose the monitor recorder **14** to moisture.

In addition, a battery compartment **36** is formed on the bottom surface of the non-conductive receptacle **25**, and a pair of battery leads (not shown) electrically interface the battery to another pair of the electrical pads **34**. The battery contained within the battery compartment **35** can be replaceable, rechargeable or disposable.

The monitor recorder **14** draws power externally from the battery provided in the non-conductive receptacle **25**, thereby uniquely obviating the need for the monitor recorder **14** to carry a dedicated power source. The battery contained within the battery compartment **35** can be replaceable, rechargeable or disposable. In a further embodiment, the ECG sensing circuitry of the monitor recorder **14** can be supplemented with additional sensors, including an SpO<sub>2</sub> sensor, a blood pressure sensor, a temperature sensor, respiratory rate sensor, a glucose sensor, an air flow sensor, and a volumetric pressure sensor, which can be incorporated directly into the monitor recorder **14** or onto the non-conductive receptacle **25**.

The placement of the flexible backing **20** on the sternal midline **16** (or immediately to either side of the sternum **13**) also helps to minimize the side-to-side movement of the

wearable monitor **12** in the left- and right-handed directions during wear. However, the wearable monitor **12** is still susceptible to pushing, pulling, and torquing movements, including compressional and torsional forces when the patient bends forward, and tensile and torsional forces when the patient leans backwards. To counter the dislodgment of the flexible backing **20** due to compressional and torsional forces, a layer of non-irritating adhesive, such as hydrocolloid, is provided at least partially on the underside, or contact, surface of the flexible backing **20**, but only on the distal end **30** and the proximal end **31**. As a result, the underside, or contact surface of the longitudinal midsection **23** does not have an adhesive layer and remains free to move relative to the skin. Thus, the longitudinal midsection **23** forms a crimp relief that respectively facilitates compression and twisting of the flexible backing **20** in response to compressional and torsional forces. Other forms of flexible backing crimp reliefs are possible.

Unlike the flexible backing **20**, the flexible circuit **32** is only able to bend and cannot stretch in a planar direction. FIG. **5** is a top view showing the flexible circuit **32** of the extended wear electrode patch **15** of FIG. **3**. A distal ECG electrode **38** and proximal ECG electrode **39** are respectively coupled to the distal and proximal ends of the flexible circuit **32**. The flexible circuit **32** preferably does not extend to the outside edges of the flexible backing **20**, thereby avoiding gouging or discomforting the patient's skin during extended wear, such as when sleeping on the side. During wear, the ECG electrodes **38**, **39** must remain in continual contact with the skin. A strain relief **40** is defined in the flexible circuit **32** at a location that is partially underneath the battery compartment **36** when the flexible circuit **32** is affixed to the flexible backing **20**. The strain relief **40** is laterally extendable to counter dislodgment of the ECG electrodes **38**, **39** due to tensile and torsional forces. A pair of strain relief cutouts **41** partially extend transversely from each opposite side of the flexible circuit **32** and continue longitudinally towards each other to define in 'S'-shaped pattern, when viewed from above. The strain relief respectively facilitates longitudinal extension and twisting of the flexible circuit **32** in response to tensile and torsional forces. Other forms of circuit board strain relief are possible.

The flexible circuit **32** can be provided either above or below the flexible backing **20**. FIG. **6** is a perspective view showing the extended wear electrode patch **15** in accordance with a further embodiment. The flexible circuit (not shown) is provided on the underside, or contact, surface of the flexible backing **20** and is electrically interfaced to the set of electrical pads **34** on the bottom surface of the non-conductive receptacle **25** through electrical contacts (not shown) pierced through the flexible backing **20**.

The electrode patch **15** is intended to be a disposable component, which enables a patient to replace the electrode patch **15** as needed throughout the monitoring period, while maintaining continuity of physiological sensing through reuse of the same monitor recorder **14**. FIG. **7** is an exploded view showing the component layers of the electrode patch **15** of FIG. **3**. The flexible backing **20** is constructed of a wearable gauze, latex, or similar wrap knit or stretchable and wear-safe material **44**, such as a Tricot-type linen with a pressure sensitive adhesive (PSA) on the underside, or contact, surface. The wearable material **44** is coated with a layer **43** of non-irritating adhesive, such as hydrocolloid, to facilitate long-term wear. The hydrocolloid, for instance, is typically made of mineral oil, cellulose and water and lacks any chemical solvents, so should cause little itching or irritation. Moreover, hydrocolloid is thicker and more gel-

like than most forms of PSA and provides cushioning between the relatively rigid and unyielding non-conductive receptacle **25** and the patient's skin. In a further embodiment, the layer of non-irritating adhesive can be contoured, such as by forming the adhesive with a concave or convex cross-section; surfaced, such as through stripes or cross-hatches of adhesive, or by forming dimples in the adhesive's surface; or applied discontinuously, such as with a formation of discrete dots of adhesive.

As described supra with reference to FIG. **5**, a flexible circuit can be adhered to either the outward facing surface or the underside, or contact, surface of the flexible backing **20**. For convenience, a flexible circuit **47** is shown relative to the outward facing surface of the wearable material **44** and is adhered respectively on a distal end by a distal electrode seal **45** and on a proximal end by a proximal electrode seal **45**. In a further embodiment, the flexible circuit **47** can be provided on the underside, or contact, surface of the wearable material **44**. Through the electrode seals, only the distal and proximal ends of the flexible circuit **47** are attached to the wearable material **44**, which enables the strain relief **40** (shown in FIG. **5**) to respectively longitudinally extend and twist in response to tensile and torsional forces during wear. Similarly, the layer **43** of non-irritating adhesive is provided on the underside, or contact, surface of the wearable material **44** only on the proximal and distal ends, which enables the longitudinal midsection **23** (shown in FIG. **3**) to respectively bow outward and away from the sternum **13** or twist in response to compressional and torsional forces during wear.

A pair of openings **46** is defined on the distal and proximal ends of the wearable material **44** and layer **43** of non-irritating adhesive for ECG electrodes **38**, **39** (shown in FIG. **5**). The openings **46** serve as "gel" wells with a layer of hydrogel **41** being used to fill the bottom of each opening **46** as a conductive material that aids electrode signal pick up. The entire underside, or contact, surface of the flexible backing **20** is protected prior to use by a liner layer **40** that is peeled away, as shown in FIG. **8**.

The non-conductive receptacle **25** includes a main body **54** that is molded out of polycarbonate, ABS, or an alloy of those two materials to provide a high surface energy to facilitate adhesion of an adhesive seal **53**. The main body **54** is attached to a battery printed circuit board **52** by the adhesive seal **53** and, in turn, the battery printed circuit board **52** is adhered to the flexible circuit **47** with an upper flexible circuit seal **50**. A pair of conductive transfer adhesive points **51** or, alternatively, metallic rivets or similar conductive and structurally unifying components, connect the circuit traces **33**, **37** (shown in FIG. **5**) of the flexible circuit **47** to the battery printed circuit board **52**. The main body **54** has a retention catch **26** and tension clip **27** (shown in FIG. **3**) that fixably and securely receive a monitor recorder **14** (not shown), and includes a recess within which to circumferentially receive a die cut gasket **55**, either rubber, urethane foam, or similar suitable material, to provide a moisture resistant seal to the set of pads **34**.

While the invention has been particularly shown and described as referenced to the embodiments thereof, those skilled in the art will understand that the foregoing and other changes in form and detail may be made therein without departing from the spirit and scope.

What is claimed is:

1. An electrocardiography patch, comprising:  
a flexible backing formed of an elongated strip of stretchable material;

a pair of electrodes respectively affixed to and conductively exposed on a contact surface of each end of the elongated strip;

a flexible circuit affixed on each end to the elongated strip and comprising a pair of circuit traces both originating within one of the ends of the elongated strip and electrically coupled to each electrode;

a non-conductive receptacle securely adhered on the one end of the elongated strip opposite the contact surface and formed to removably receive an electrocardiography monitor and house a battery below the received electrocardiography monitor;

electrical pads provided within a moisture-resistant seal formed on a bottom surface of the non-conductive receptacle to interface with electrical contacts protruding from a bottom surface of the electrocardiography monitor and a pair of the electrical pads formed to electrically couple with the electrodes via the circuit traces; and

a pair of battery leads formed on the non-conductive receptacle to electrically interface the battery to another pair of the electrical pads.

2. An electrocardiography patch according to claim 1, further comprising:

one of the electrodes being disposed for being adhered to a region overlying the Xiphoid process on a patient's chest; and

an other of the electrodes being disposed for being adhered to the region near the manubrium on the patient's chest oriented centrally (in the midline) along the sternum upwards from the one electrode.

3. An electrocardiography patch according to claim 1, further comprising:

an upper part of the elongated strip defined on one end of the flexible backing and sized to be affixed to the bottom surface of the non-conductive receptacle, the other of the electrodes being affixed to and conductively exposed on the contact surface of the upper part; and

a lower part of the elongated strip defined on another end of the flexible backing; the one of the electrodes being affixed to and conductively exposed on the contact surface of the lower part,

wherein the lower part of the elongated strip is provided for being adhered to the region overlying the Xiphoid process on a patient's chest with the narrow longitudinal midsection oriented centrally (in the midline) along the sternum and the upper part of the elongated strip oriented upwards towards the manubrium.

4. An electrocardiography patch according to claim 1, further comprising:

a non-irritating adhesive dressing at least partially coated on each end of the elongated strip on the contact surface.

5. An electrocardiography patch according to claim 4, further comprising:

a contoured surface comprised on the non-irritating adhesive dressing on at least one end of the elongated strip.

6. An electrocardiography patch according to claim 1, further comprising:

a plurality of fasteners comprised on the non-conductive receptacle and oriented to securely receive and to hold captive the electrocardiography monitor into the non-conductive receptacle.

7. An electrocardiography patch according to claim 1, further comprising:

## 11

at least one of an SpO2 sensor, a blood pressure sensor, a temperature sensor, respiratory rate sensor, a glucose sensor, an air flow sensor, and a volumetric pressure sensor provided to supplement the electrocardiography monitor by one of direct incorporation into the electrocardiography monitor and direct receipt on the non-conductive receptacle.

8. An electrocardiography patch according to claim 1, further comprising:

a liner shaped to cover the contact surface of the flexible backing.

9. An electrocardiography patch according to claim 1, wherein the flexible circuit is adhered to one of the contact surface of the flexible backing and a surface opposite the contact surface of the flexible backing.

10. An electrocardiography patch according to claim 1, wherein the electrocardiography monitor draws power externally from the battery provided in the non-conductive receptacle.

11. An electrocardiography and physiological sensor monitor, comprising:

a disposable extended wear electrode patch comprising:

a flexible backing formed of an elongated strip of stretchable material;

a pair of electrodes respectively affixed to and conductively exposed on a contact surface of each end of the elongated strip;

a flexible circuit affixed on each end to the elongated strip and comprising a pair of circuit traces both originating within one of the ends of the elongated strip and electrically coupled to each electrode;

a non-conductive receptacle securely adhered on the one end of the elongated strip opposite the contact surface and formed to house a battery;

electrical pads provided within a moisture-resistant seal formed on a bottom surface of the non-conductive receptacle and a pair of the electrical pads formed to electrically couple with the electrodes via the circuit traces; and

a pair of battery leads formed on the non-conductive receptacle to electrically interface the battery to another pair of the electrical pads; and

a reusable electrocardiography monitor having a sealed housing adapted to be removably secured into the non-conductive receptacle, wherein the sealed housing comprises a cavity on a bottom surface to accommodate the battery on the extended wear electrode patch and protruding electrical contacts that interface with the electrical pads on the non-conductive receptacle.

12. An electrocardiography and physiological sensor monitor according to claim 11, further comprising:

one of the electrodes being disposed for being adhered to a region overlying the Xiphoid process on a patient's chest; and

an other of the electrodes being disposed for being adhered to the region near the manubrium on the patient's chest oriented centrally (in the midline) along the sternum upwards from the one electrode.

## 12

13. An electrocardiography and physiological sensor monitor according to claim 11, further comprising:

an upper part of the elongated strip defined on one end of the flexible backing and sized to be affixed to the bottom surface of the non-conductive receptacle, the other of the electrodes being affixed to and conductively exposed on the contact surface of the upper part; and

a lower part of the elongated strip defined on another end of the flexible backing; the one of the electrodes being affixed to and conductively exposed on the contact surface of the lower part,

wherein the lower part of the elongated strip is provided for being adhered to the region overlying the Xiphoid process on a patient's chest with the narrow longitudinal midsection oriented centrally (in the midline) along the sternum and the upper part of the elongated strip oriented upwards towards the manubrium.

14. An electrocardiography and physiological sensor monitor according to claim 11, further comprising:

a non-irritating adhesive dressing at least partially coated on each end of the elongated strip on the contact surface.

15. An electrocardiography and physiological sensor monitor according to claim 14, further comprising:

a contoured surface comprised on the non-irritating adhesive dressing on at least one end of the elongated strip.

16. An electrocardiography and physiological sensor monitor according to claim 11, further comprising:

a plurality of fasteners comprised on the non-conductive receptacle and oriented to securely receive and to hold captive the electrocardiography monitor into the non-conductive receptacle.

17. An electrocardiography and physiological sensor monitor according to claim 11, further comprising:

at least one of an SpO2 sensor, a blood pressure sensor, a temperature sensor, respiratory rate sensor, a glucose sensor, an air flow sensor, and a volumetric pressure sensor provided to supplement the electrocardiography monitor by one of direct incorporation into the electrocardiography monitor and direct receipt on the non-conductive receptacle.

18. An electrocardiography and physiological sensor monitor according to claim 11, further comprising:

a liner shaped to cover the contact surface of the flexible backing.

19. An electrocardiography and physiological sensor monitor according to claim 11, wherein the flexible circuit is adhered to one of the contact surface of the flexible backing and a surface opposite the contact surface of the flexible backing.

20. An electrocardiography and physiological sensor monitor according to claim 11, wherein the electrocardiography monitor draws power externally from the battery provided in the non-conductive receptacle.

\* \* \* \* \*

专利名称(译)	心电图贴片		
公开(公告)号	<a href="#">US9901274</a>	公开(公告)日	2018-02-27
申请号	US15/406627	申请日	2017-01-13
[标]申请(专利权)人(译)	BISHAY JON MIKALSON BARDY GUST ^ h FELIX JASON		
申请(专利权)人(译)	BISHAY , JON MIKALSON BARDY , GUST H. FELIX , JASON		
当前申请(专利权)人(译)	BARDY诊断 , INC.		
[标]发明人	BISHAY JON MIKALSON BARDY GUST H FELIX JASON		
发明人	BISHAY, JON MIKALSON BARDY, GUST H. FELIX, JASON		
IPC分类号	A61B5/04 A61B5/0408 A61B5/0205 A61B5/00 A61B5/087 A61B5/021 A61B5/08 A61B5/145 A61B5/091		
CPC分类号	A61B5/04085 A61B5/02055 A61B5/04087 A61B5/6823 A61B5/6833 A61B5/021 A61B2562/164 A61B5/0816 A61B5/091 A61B5/14532 A61B5/14542 A61B2560/0412 A61B5/087 A61B5/04017 A61B5/04325 A61B5/1116 A61B5/14551 A61B5/7455 A61B2505/07 A61B2560/0271 A61B2560/045 G01N27/307 A61B5/0006 A61B5/0022 A61B5/01 A61B5/0452 A61B5/04525 A61B5/1117 A61B5/1118 A61B5/4809 A61B5/6801 A61B2562/0219		
优先权	61/882403 2013-09-25 US		
其他公开文献	US20170188871A1		
外部链接	<a href="#">Espacenet</a> <a href="#">USPTO</a>		

摘要(译)

提供心电图补丁。柔性背衬由可拉伸材料的细长条形成，并且一对电极分别固定在细长条的每个端部的接触表面上。柔性电路固定在细长条的每一端上，并包括电耦合到每个电极的一对电路迹线。非导电插座牢固地粘附在与接触表面相对的细长条的一端上，并形成可拆卸地接收心电图监视器并容纳电池。电触点设置在非导电插座的底部表面上，以与从心电图监视器突出的电触点接合。一对电垫形成与电极电耦合。一对电池引线形成在非导电插座上以将电池电连接到另一对电垫。

