



US 20190350472A1

(19) **United States**

(12) **Patent Application Publication**
Zhovnirovsky

(10) **Pub. No.: US 2019/0350472 A1**

(43) **Pub. Date: Nov. 21, 2019**

(54) **SYSTEMS AND METHODS FOR
MINIMALLY INTRUSIVE DISPLAYS WITH
HEART RATE MONITORING**

(52) **U.S. Cl.**
CPC *A61B 5/02427* (2013.01); *G02C 11/10*
(2013.01); *A61B 2503/10* (2013.01); *A61B*
5/6803 (2013.01); *A61B 5/7445* (2013.01);
A61B 5/02438 (2013.01)

(71) Applicant: **FLIPPER, INC.**, Albany, CA (US)

(72) Inventor: **Yuri Zhovnirovsky**, Albany, CA (US)

(21) Appl. No.: **16/274,231**

(57) **ABSTRACT**

(22) Filed: **Feb. 12, 2019**

Related U.S. Application Data

(63) Continuation-in-part of application No. 15/985,365,
filed on May 21, 2018.

Publication Classification

(51) **Int. Cl.**
A61B 5/024 (2006.01)
G02C 11/00 (2006.01)
A61B 5/00 (2006.01)

A system includes a minimally intrusive display system (MIDS) configured to be disposed on an eyewear. The MIDS includes a display system and a sensor system configured to provide for a sensor data. The MIDS further includes a processor configured to process the sensor data to derive a physiological measure. The processor is further configured to display, via the display system, the physiological measure, wherein the display system is disposed in the eyewear so that the physiological measure is only viewed when a user of the eyewear turns the user's pupil towards the display system at angle α from a forward direction.

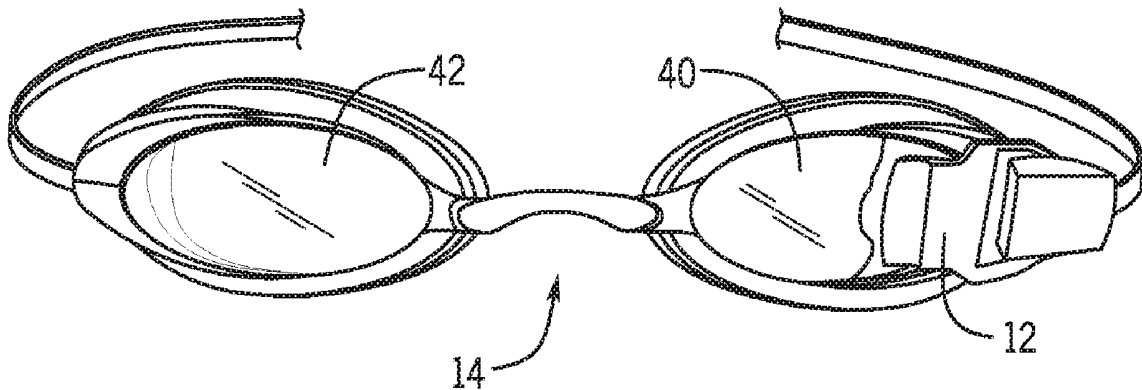

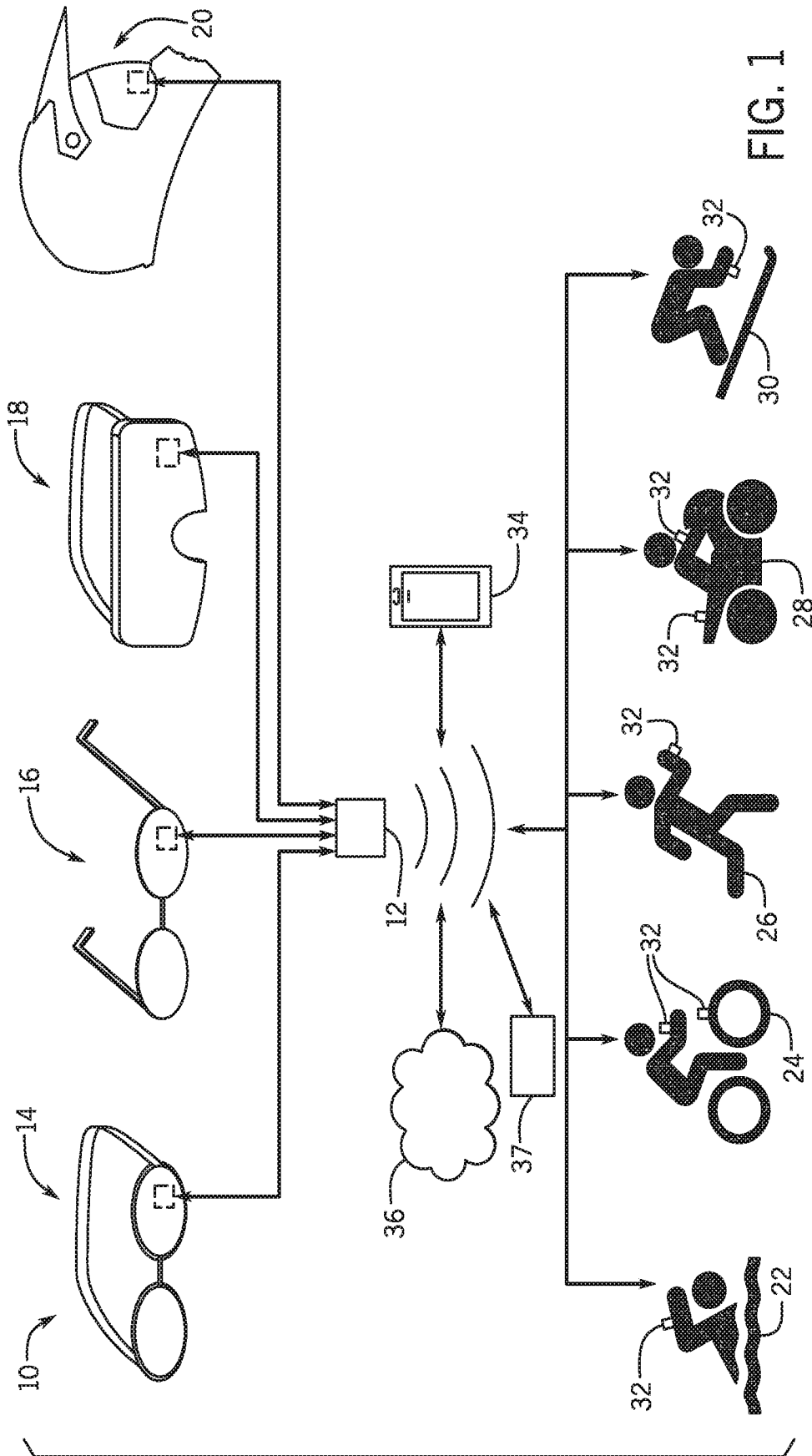

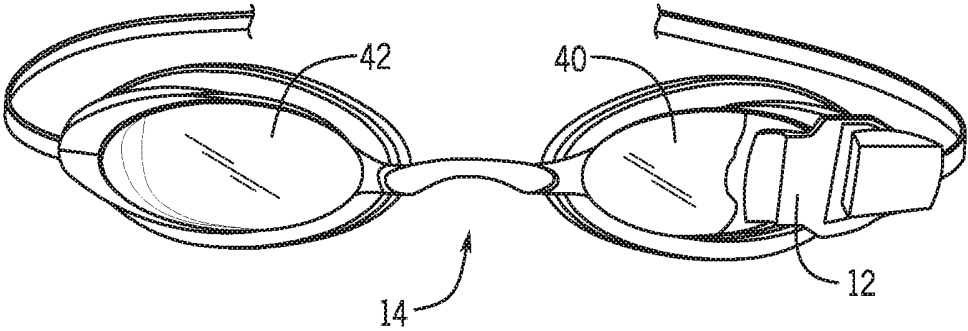

FIG. 2A

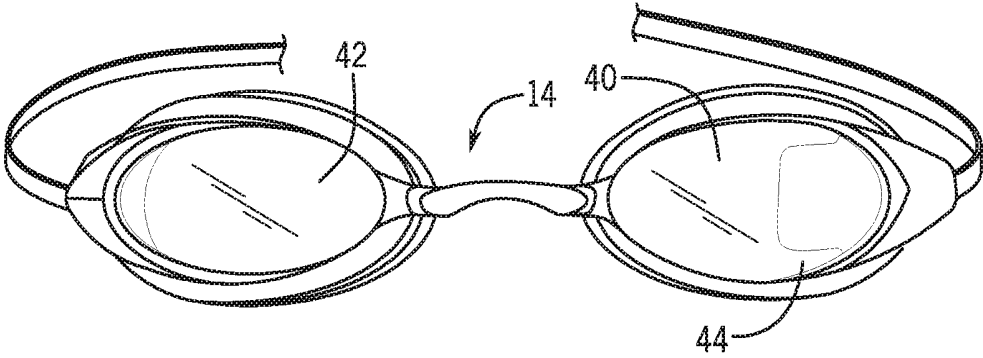

FIG. 2B

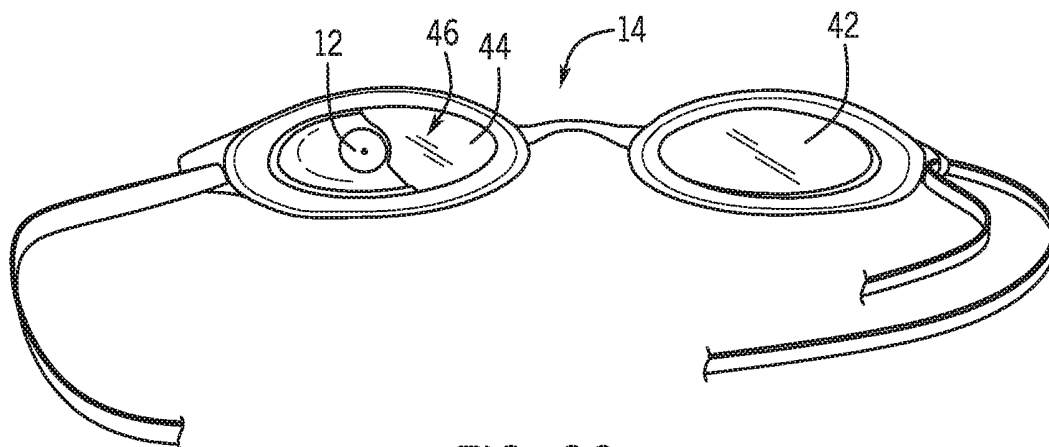

FIG. 2C

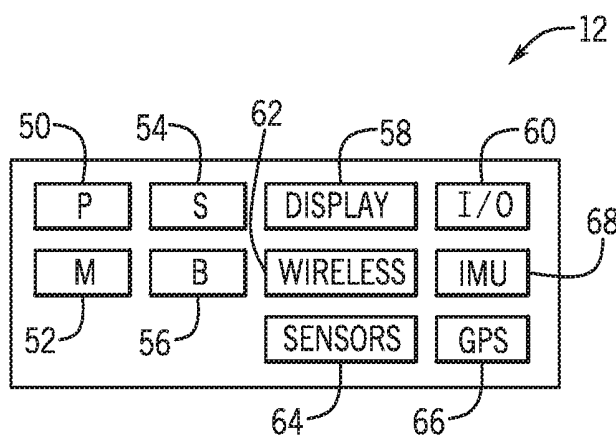

FIG. 3

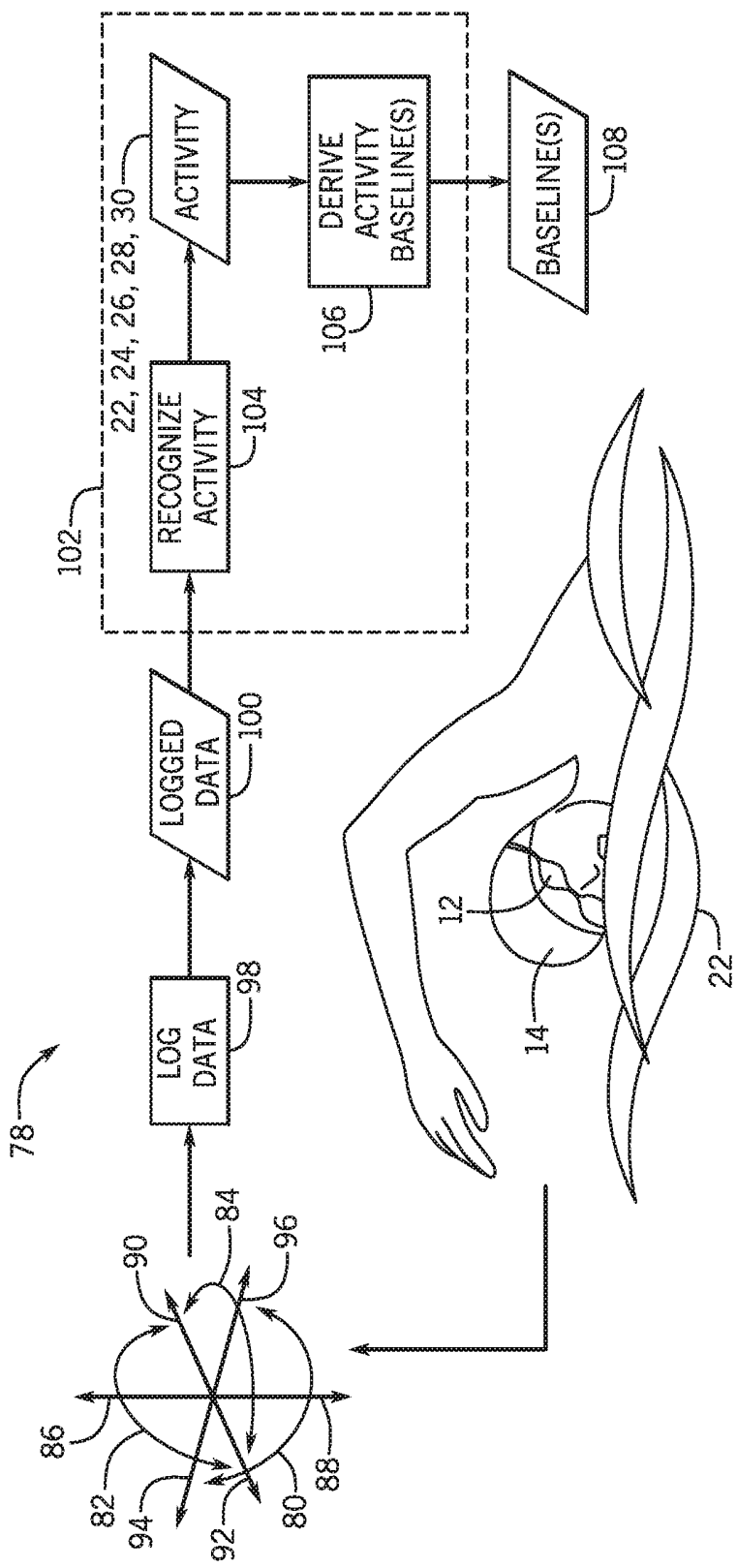

FIG. 4

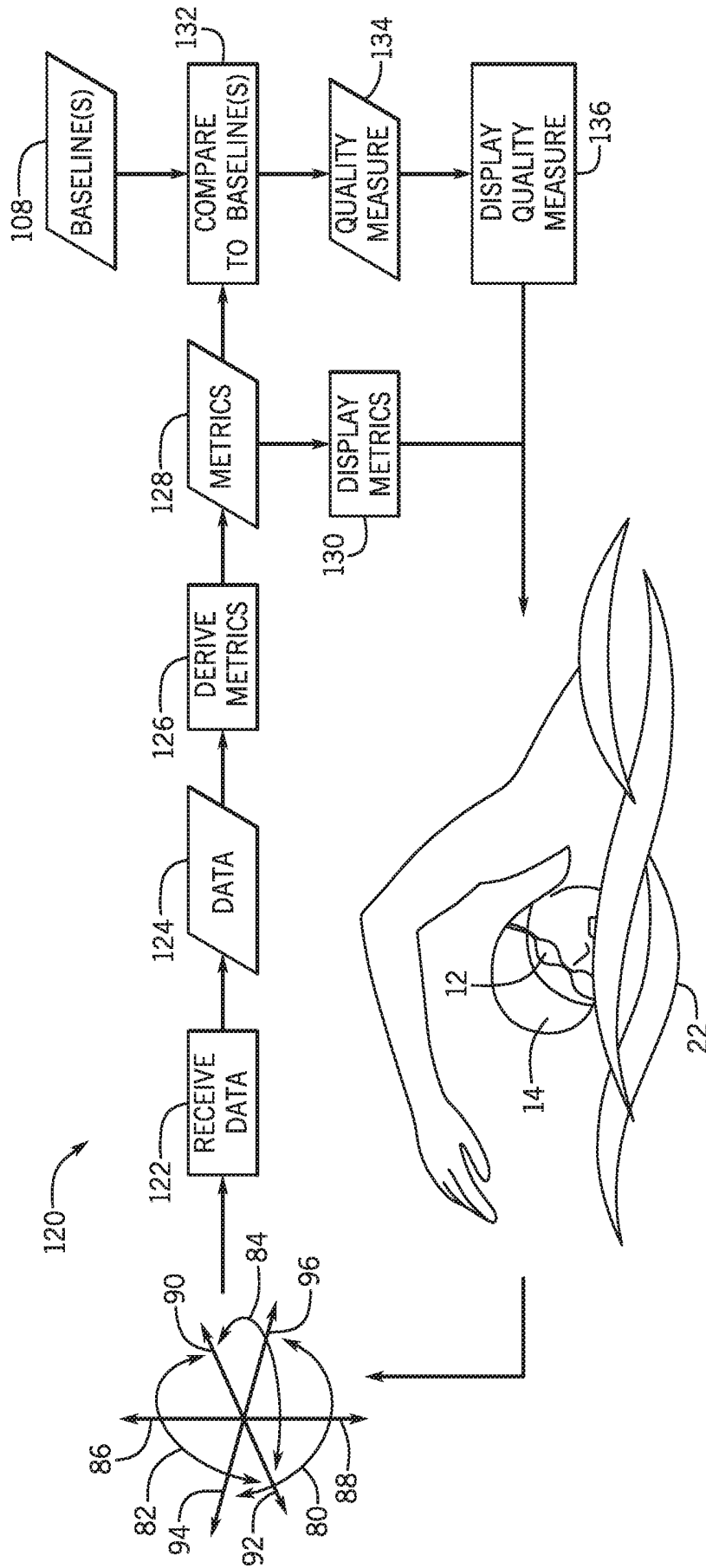

FIG. 5

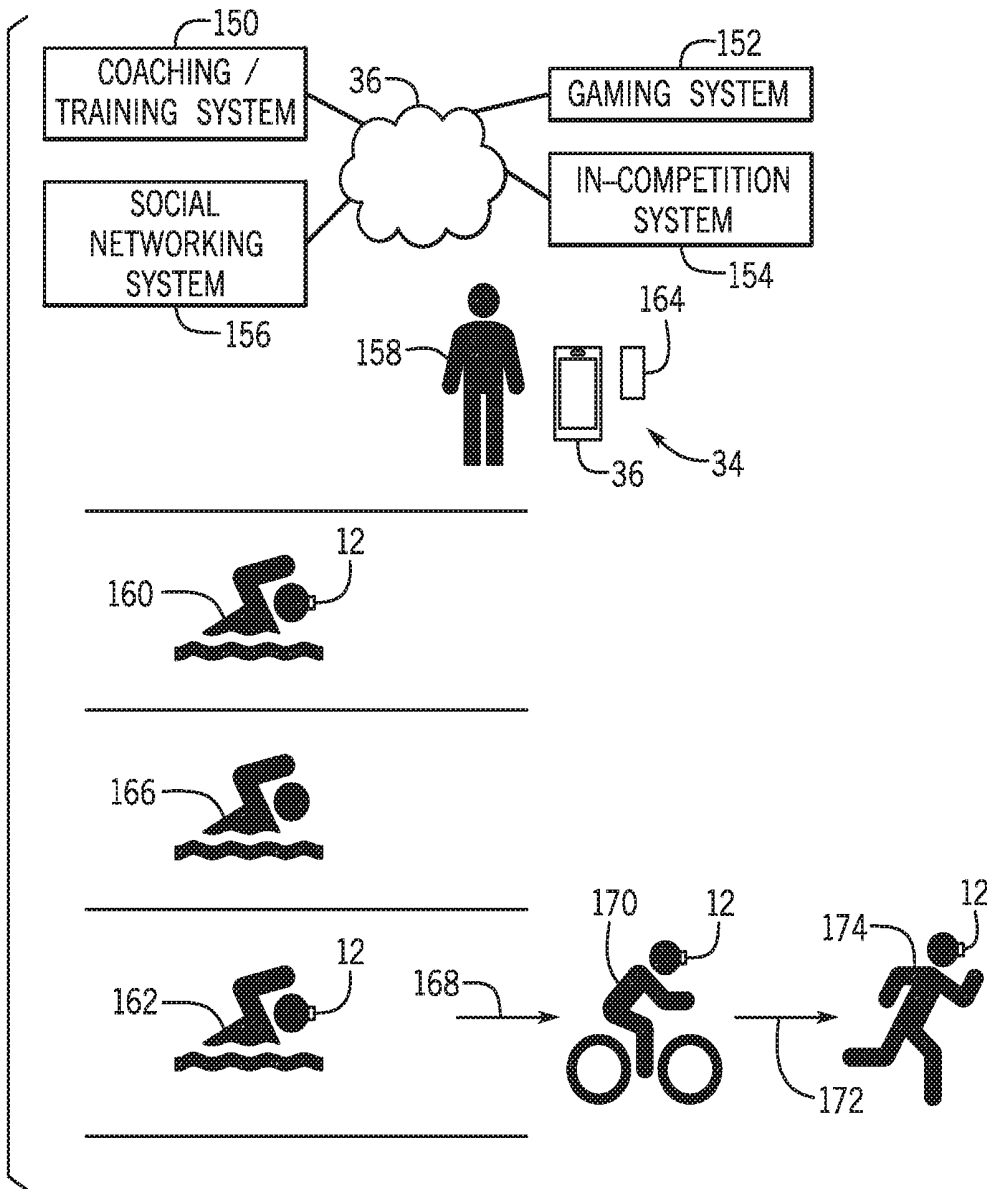
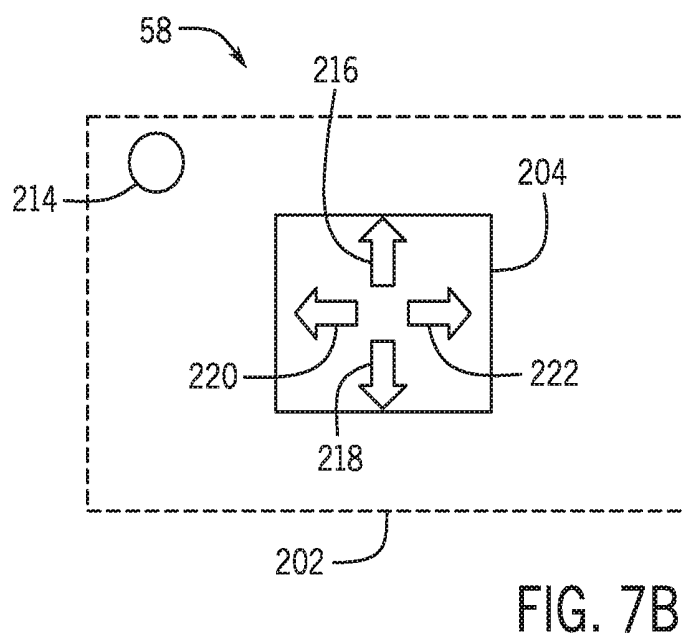
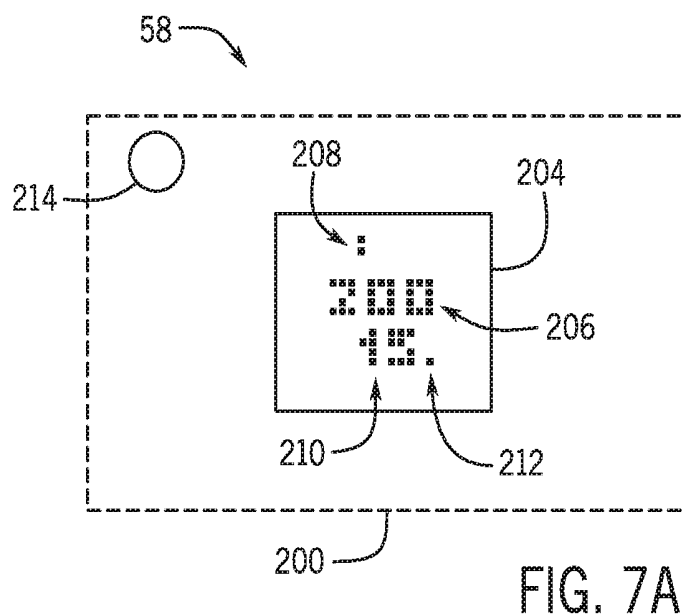

FIG. 6



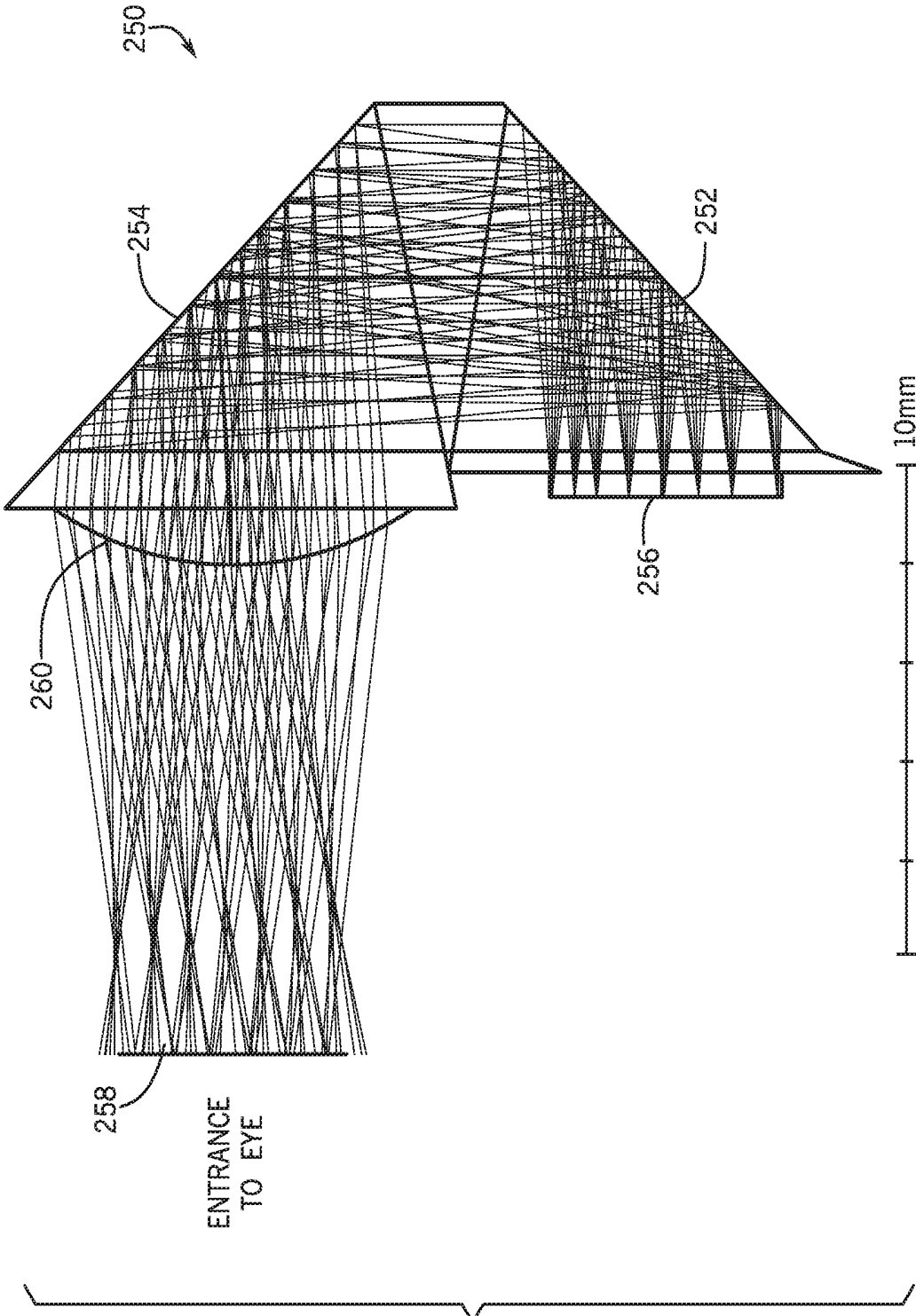

FIG. 8

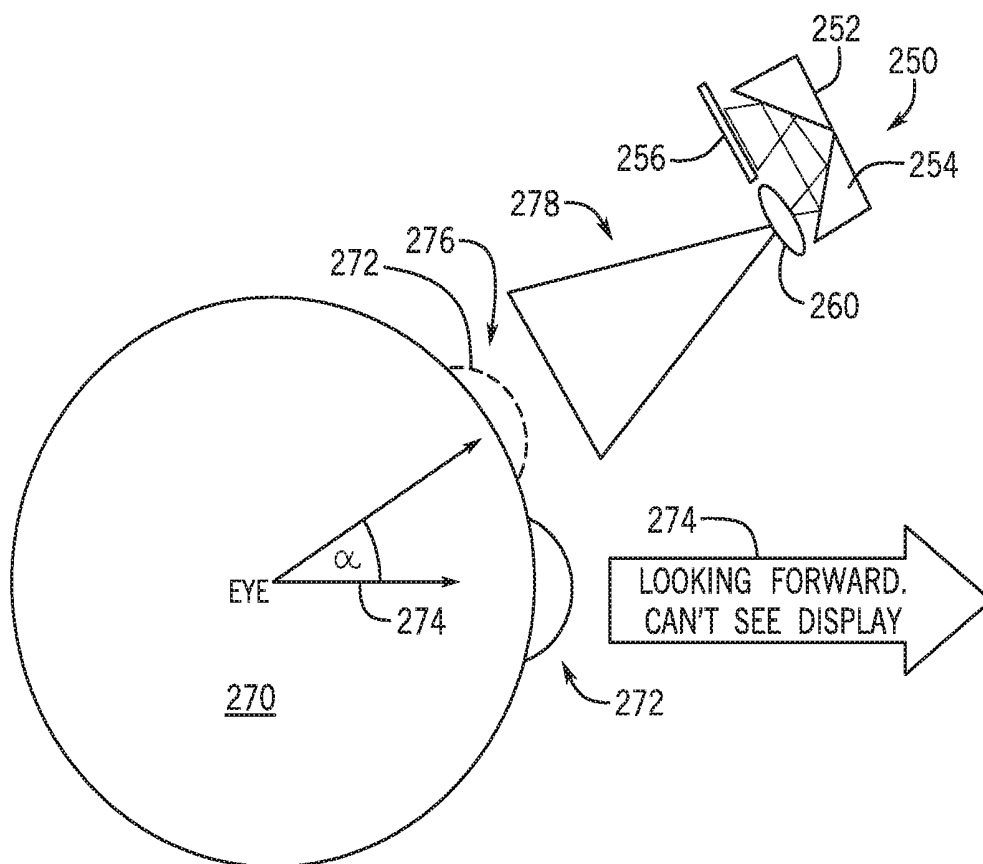

FIG. 9

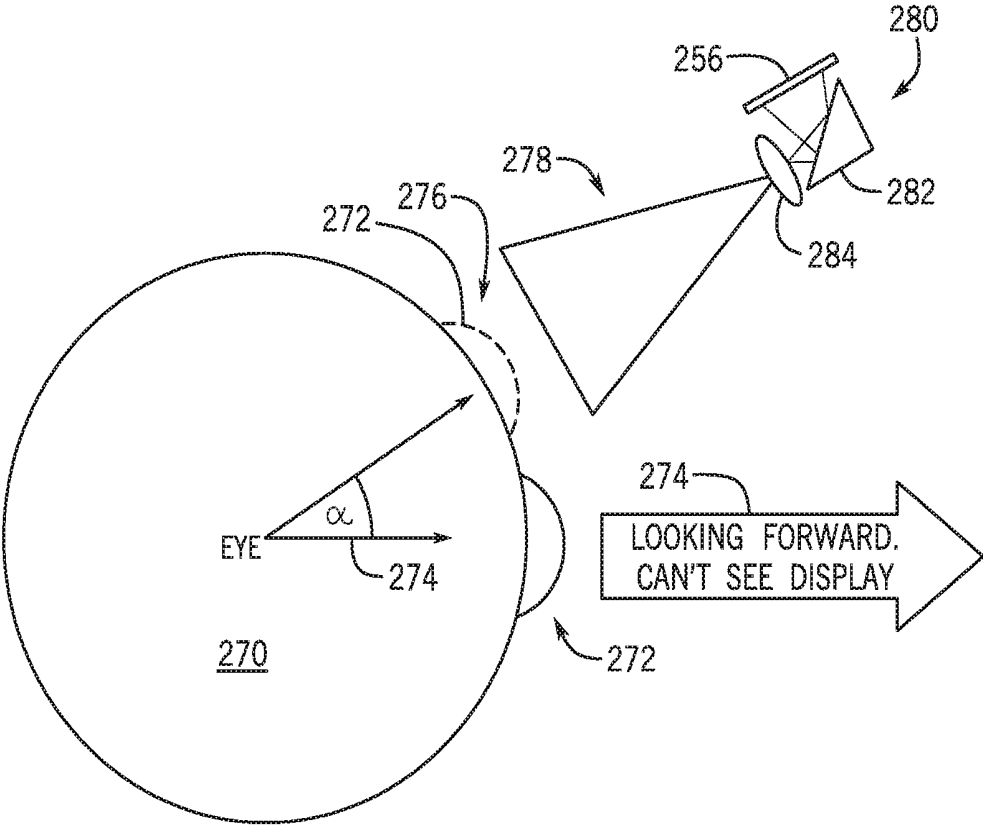

FIG. 10

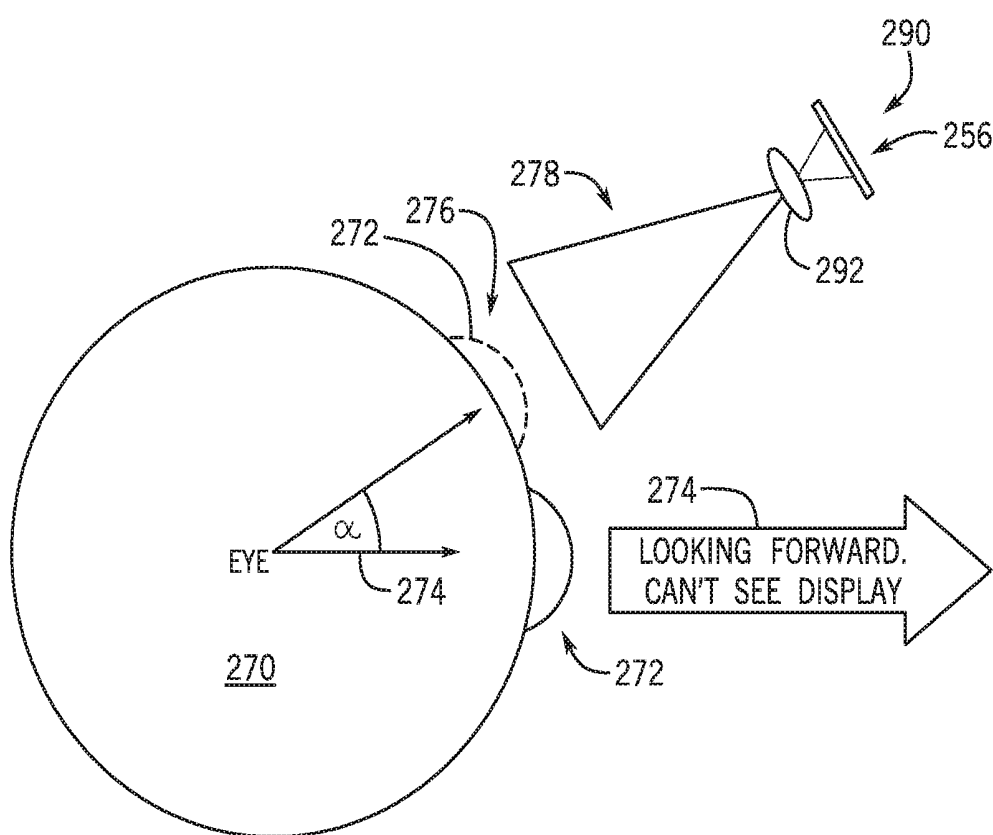

FIG. 11

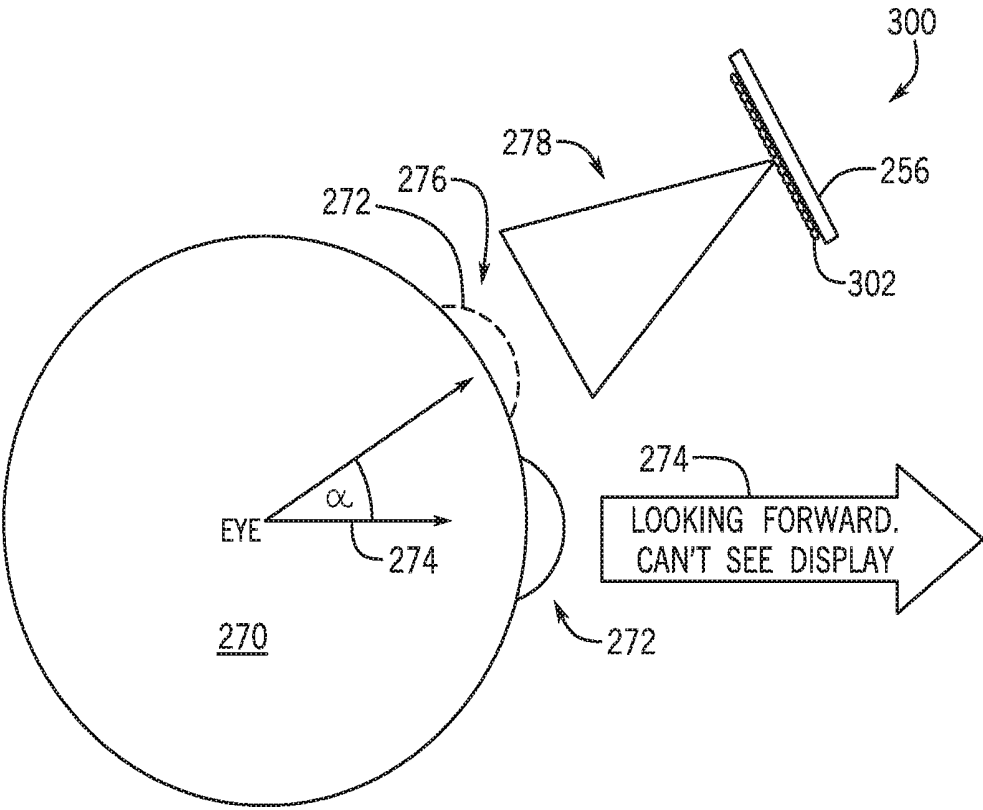

FIG. 12

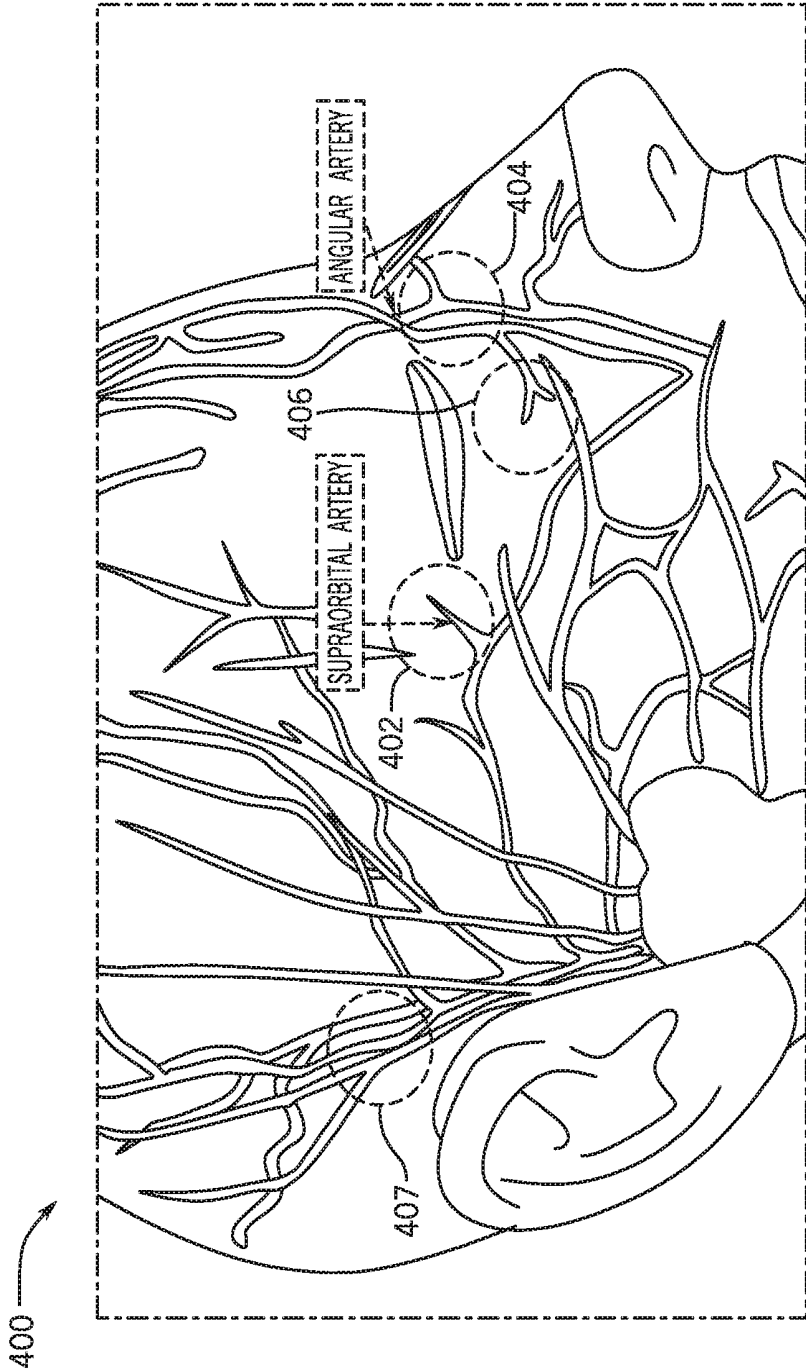

FIG. 13

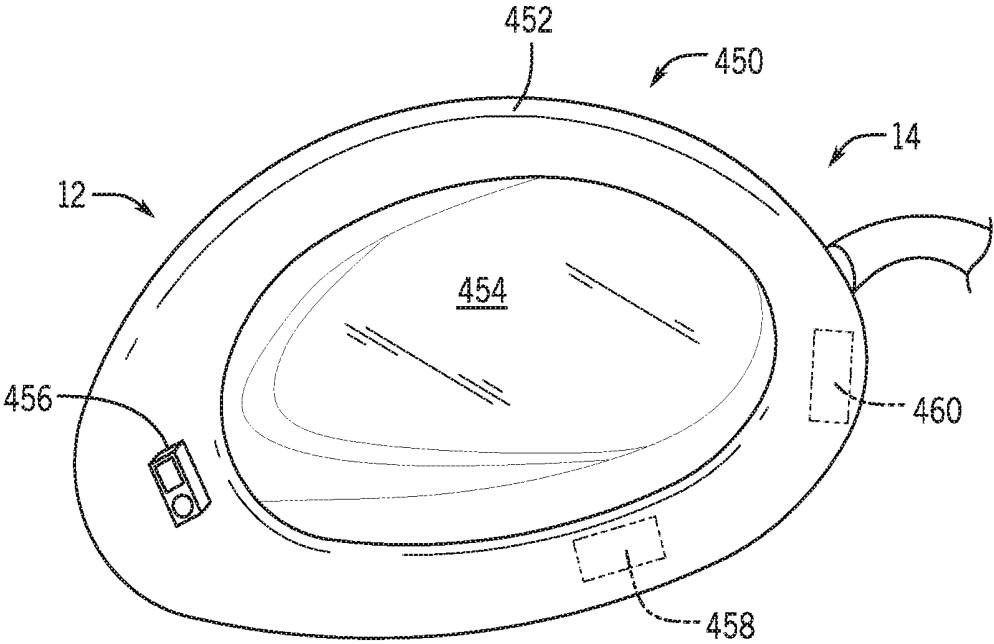

FIG. 14

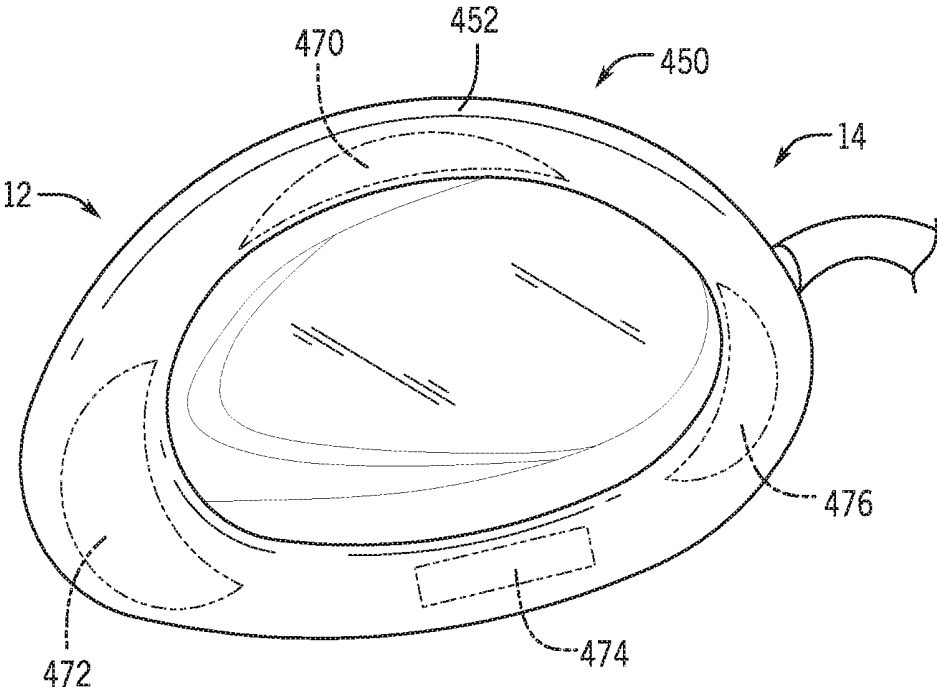

FIG. 15

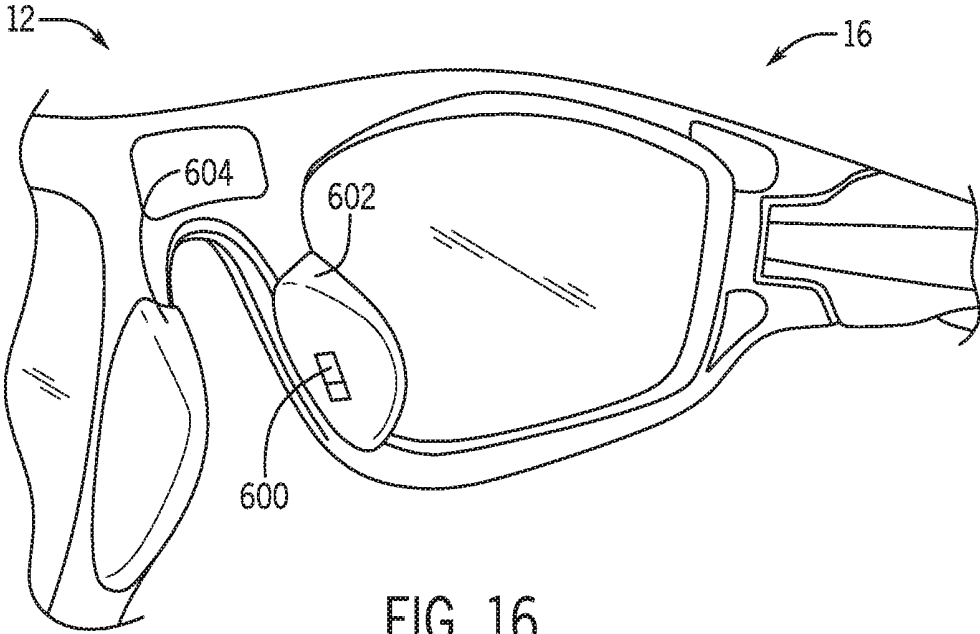

FIG. 16

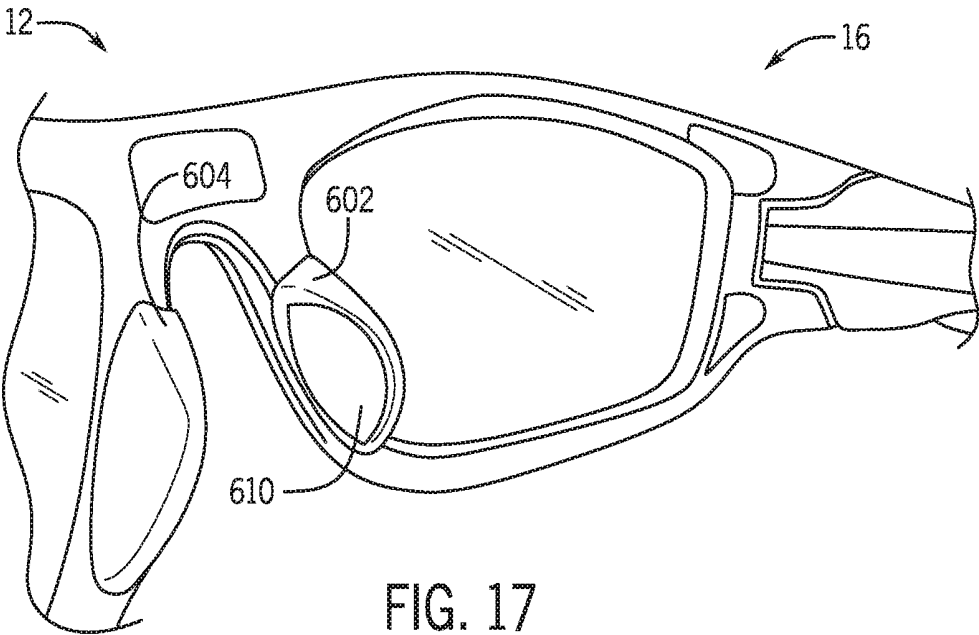

FIG. 17

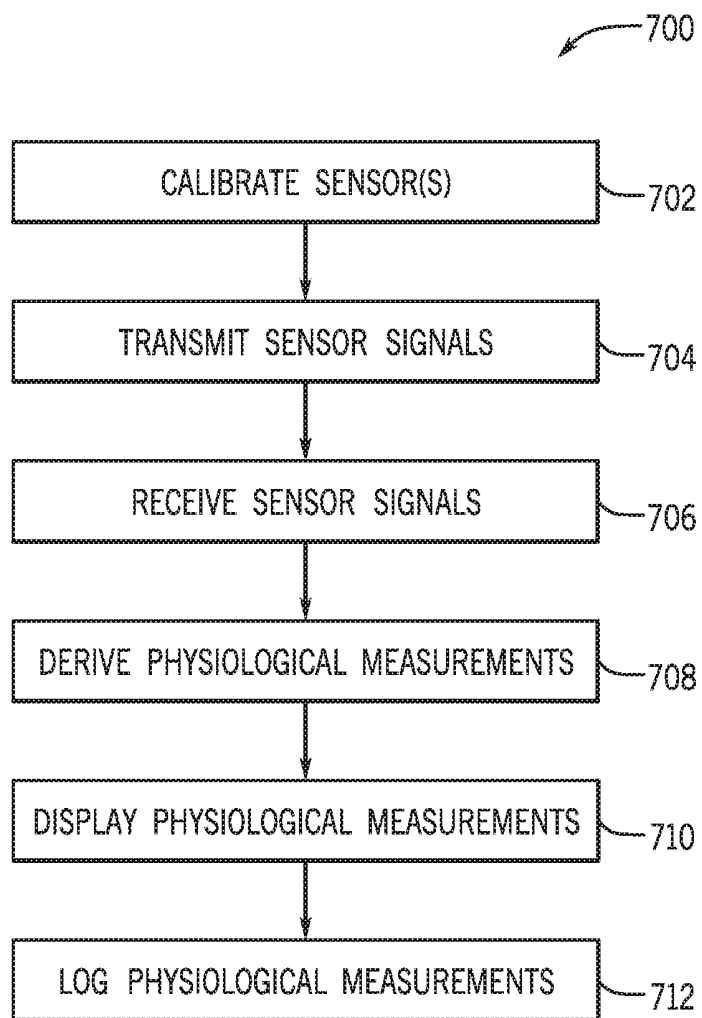

FIG. 18

SYSTEMS AND METHODS FOR MINIMALLY INTRUSIVE DISPLAYS WITH HEART RATE MONITORING

CROSS-REFERENCE TO RELATED APPLICATION

[0001] This application claims priority to and the benefit of U.S. Non-Provisional application Ser. No. 15/985,365, entitled "SYSTEMS AND METHODS FOR MINIMALLY INTRUSIVE DISPLAYS," filed May 21, 2018, which is hereby incorporated by reference in its entirety for all purposes.

BACKGROUND

[0002] The subject matter disclosed herein relates to displays, and more specifically, to minimally intrusive displays with heart rate monitoring.

[0003] Certain activities, such as swimming, running, bicycling, and the like, may benefit from specific eyewear. For example, swim goggles may provide for enhanced underwater views and for eye protection from water. Similarly, sunglasses, motorcycle visors, ski goggles, and so on, may be worn to protect a wearer's eyes and to enhance the wearer's vision during certain activities. Some eyewear may incorporate displays. It may be beneficial to provide for minimally intrusive displays with heart rate monitoring.

BRIEF DESCRIPTION

[0004] Certain embodiments commensurate in scope with the originally claimed invention are summarized below. These embodiments are not intended to limit the scope of the claimed invention, but rather these embodiments are intended only to provide a brief summary of possible forms of the invention. Indeed, the invention may encompass a variety of forms that may be similar to or different from the embodiments set forth below.

[0005] In one embodiment, a system includes a minimally intrusive display system (MIDS) configured to be disposed on an eyewear. The MIDS includes a display system and a sensor system configured to provide for a sensor data. The MIDS further includes a processor configured to process the sensor data to derive a physiologic measurement. The processor is further configured to display, via the display system, the physiologic measurement, wherein the display system is disposed in the eyewear so that the physiologic measurement is only viewed when a user of the eyewear turns the user's pupil towards the display system at angle α from a forward direction.

[0006] In another embodiment, a non-transitory computer readable medium includes executable instructions which, when executed by a processor, cause the processor to receive a sensor data from a sensor system disposed in a minimally intrusive display system (MIDS) configured to be disposed on an eyewear. The executable instructions additionally cause the processor to process the sensor data to derive a physiologic measurement. The executable instructions additionally cause the processor to display, via a display system disposed in the MIDS, the physiologic measurement, wherein the display system is disposed in the eyewear so that the physiologic measurement is only viewed when a user of the eyewear turns the user's pupil towards the display system at angle α from a forward direction.

[0007] In yet another embodiment, a method includes receiving a first sensor data from a sensor system disposed in a minimally intrusive display system (MIDS) configured to be disposed on an eyewear. The method further includes processing the sensor data to derive a physiologic measurement. The method additionally includes displaying, via a display system disposed in the MIDS, the physiologic measurement, wherein the display system is disposed in the eyewear so that the physiologic measurement is only viewed when a user of the eyewear turns the user's pupil towards the display system at angle α from a forward direction.

BRIEF DESCRIPTION OF THE DRAWINGS

[0008] These and other features, aspects, and advantages of the present invention will become better understood when the following detailed description is read with reference to the accompanying drawings in which like characters represent like parts throughout the drawings, wherein:

[0009] FIG. 1 is a block diagram of an embodiment of a sport-oriented system which includes one or more minimally intrusive display systems (MIDS);

[0010] FIG. 2A is a front perspective view of an embodiment of the MIDS of FIG. 1 shown disposed on swim goggles;

[0011] FIG. 2B is a front perspective view showing an embodiment of the swim goggles of FIG. 2A with the MIDS removed;

[0012] FIG. 2C is a rear perspective view illustrating an embodiment of the MIDS of FIG. 1 disposed in a lens of the swim goggles of FIGS. 2A and 2B;

[0013] FIG. 3 is a system architecture block diagram of an embodiment of the MIDS of FIG. 1;

[0014] FIG. 4 is a flow diagram depicting an embodiment of a process suitable for deriving certain performance baselines for wearers of the MIDS of FIG. 1;

[0015] FIG. 5 is a flow diagram illustrating an embodiment of a process suitable for deriving certain performance metrics and/or feedback for wearers of the MIDS of FIG. 1;

[0016] FIG. 6 is a block diagram illustrating an embodiment of a coaching/training system, a gaming system, an in-competition system, and a social networking system that may interface with the MIDS of FIG. 1;

[0017] FIG. 7A is a diagram illustrating an embodiment of a display system of the MIDS of FIG. 1 showing text;

[0018] FIG. 7B is a diagram illustrating an embodiment of a display system of the MIDS of FIG. 1 showing images.

[0019] FIG. 8 is a schematic view of an embodiment of a double mirrored display system that may be included in the MIDS of FIG. 1;

[0020] FIG. 9 is a schematic top view of an embodiment of the double mirrored display system of FIG. 8;

[0021] FIG. 10 is a schematic top view of an embodiment of a single mirrored display system that may be included in the MIDS of FIG. 1;

[0022] FIG. 11 is a schematic top view of an embodiment of a direct optical display system that may be included in the MIDS of FIG. 1;

[0023] FIG. 12 is a schematic top view of an embodiment of a direct display system that may be included in the MIDS of FIG. 1;

[0024] FIG. 13 is a perspective view of a human muscle and capillary head region showing placements for certain of embodiments of sensors included in the MIDS of FIG. 1;

[0025] FIG. 14 is a rear perspective view of an embodiment of the MIDS of FIG. 1 when provided in a swim goggles form factor;

[0026] FIG. 15 is a rear perspective view of another embodiment of the MIDS of FIG. 1 when provided in a swim goggles form factor;

[0027] FIG. 16 is a rear perspective view of an embodiment of the MIDS of FIG. 1 when provided in a sunglass or eyeglass form factor;

[0028] FIG. 17 is a rear perspective view of another embodiment of the MIDS of FIG. 1 when provided in a sunglass or eyeglass form factor; and

[0029] FIG. 18 is a flowchart of an embodiment of a process suitable for deriving one or more physiological measurements.

DETAILED DESCRIPTION

[0030] One or more specific embodiments will be described below. In an effort to provide a concise description of these embodiments, not all features of an actual implementation are described in the specification. It should be appreciated that in the development of any such actual implementation, as in any engineering or design project, numerous implementation-specific decisions must be made to achieve the developers' specific goals, such as compliance with system-related and business-related constraints, which may vary from one implementation to another. Moreover, it should be appreciated that such a development effort might be complex and time consuming, but would nevertheless be a routine undertaking of design, fabrication, and manufacture for those of ordinary skill having the benefit of this disclosure.

[0031] When introducing elements of various embodiments of the present invention, the articles "a," "an," "the," and "said" are intended to mean that there are one or more of the elements. The terms "comprising," "including," and "having" are intended to be inclusive and mean that there may be additional elements other than the listed elements.

[0032] Embodiments of the present disclosure may apply to a variety of eyewear, including sports-oriented eyewear such as swim goggles, sunglasses, ski goggles, motorcycle goggles, helmet visors, and so on. In certain embodiments, a minimally intrusive display system (MIDS) may be included in the eyewear, suitable for providing visual indications and feedback of ongoing user and/or sensor activities, as further described below. The MIDS may include a small form factor, such as 50x50 mm square, or less, that enables the user to more quickly identify useful information on a display while maintaining situational awareness. That is, the user may glance at information provided via a display included in the MIDS while still maintaining a field of view suitable for easy visualization of the surrounding environment. The MIDS may also include certain techniques to provide for heart monitoring of the user.

[0033] In certain embodiments, the MIDS may be removable and replaceable. For example, the user may toolessly remove the MIDS from a swim google and then place the MIDS into a set of sunglasses for use in a non-swimming activity. Indeed, the MIDS may be toolessly interchangeable between various types of eyewear. Additionally, the MIDS may include one or more processors that may interface with one or more sensors (internal sensors, external sensors) to derive certain performance metrics and/or feedback related to the user's activity.

[0034] For example, when swimming, feedback may be provided related to starts, turns, kicks, lap counts, breathing, speed, swim direction, and so on. When running, feedback may include speed, kick cadence, arm cadence, gait type, gait length, and the like. When bicycling, the feedback may include speed, pedaling cadence, power output, bicycle inclination, and so forth. Feedback for other activities is described below. The MIDS may communicate with external computing devices (e.g., cell phones, tablets, notebooks, cloud-based systems, smart watches, and the like) as well as with other MIDS to provide, for example, for virtual racing, improved coaching, sports social networking, and so on. Likewise, biometric information, such as heart rate, cardiac heart rest recovery time, health recovery time, heart variability, and so on, may be provided. By providing for the minimally intrusive techniques described herein, users may experience enhanced sports activities while improving their individual performance.

[0035] Turning now to FIG. 1, the figure is a block diagram of an embodiment of a sport-oriented system 10 which may include one or more minimally intrusive display systems (MIDS) 12. As mentioned earlier, the MIDS 12 may be disposed in a variety of eyewear, such as swim goggles 14, sunglasses 16, ski goggles 18, and/or helmet visors 20. In certain embodiments, a MIDS 12 may be permanently attached to each of the goggles 14, sunglasses 16, ski goggles 18, and/or helmet visors 20. In other embodiments, the MIDS 12 may be removable and replaceable. For example, the MIDS 12 may be toolessly removed from the swim goggles 14 and then toolessly attached to the sunglasses 16, the goggles 18, the visor 20, and/or to another swim google 14. It is also to be understood that the list of eyewear shown is not limiting, and that other eyewear may be used with the MIDS 12, including prescription sports glasses, shooting glasses, automobile driving glasses, and so on.

[0036] In use, the MIDS 12 may provide for a minimally intrusive information display suitable for presenting a variety of information related to the activity being performed by wearer, such as swimming 22, bicycling 24, running 26, motorcycling 28, skiing 30, biometrics and so on. Accordingly, the MIDS 12 may include one or more internal sensors described in more detail below, suitable providing data correlative with the activity being performed. The MIDS 12 may additionally interface with a variety of external sensors 32 that may be worn by the user and/or disposed in certain equipment, suitable for providing data also correlative with the activity being performed.

[0037] The external sensors 32 may include accelerometers, gyroscopic sensors, speed sensors, location sensors (e.g., GPS, GLONASS systems), ambient temperature sensors, humidity sensors, altitude sensors, magnetometric sensors (e.g., compass systems), wind sensors (e.g., wind speed, wind direction), barometric pressure sensors, biometric sensors (e.g., pulse oximeters, body temperature sensors, electrocardiogram sensors, health informatics sensors [e.g., ISO/IEEE 11073 sensors]), and the like, that may be communicatively coupled to one or more of the MIDS 12. For example, the MIDS 12 may include certain wireless systems, such as Wi-Fi (e.g., Institute of Electrical and Electronics Engineers [IEEE] 802.11X), cellular systems (e.g., high speed packet access [HSPA], HSPA+, long term evolution [LTE], WiMax), near field communications (NFC) systems, Bluetooth systems, personal area networks (PANs),

Zigbee systems, Z-wave systems, wireless mesh systems, and the like, and so on, suitable for wirelessly communicating with the sensors 32. It is to be noted that the sensors 32 may be included in other systems, such as smart watches, smart bands, pedometers, wearable heart monitors, disposed in vehicles, and so on, which include wireless communications.

[0038] The MIDS 12 may additionally or alternatively interface with mobile devices 34 (e.g., cell phones, tablets, notebooks, laptops), a cloud-based system 36, and/or other external computing system 37. For example, the mobile devices 34, cloud-based system 36, and/or external computing systems 37 may be used to configure settings of the MIDS 12 as well as to communicate data during activities, such as during the sports activities 22, 24, 26, 28, and/or 30. In certain embodiments, the communications may be one-way communications. For example, a tablet 34 carried by a swimming coach (e.g., poolside coach) may receive information (e.g., lap count, inhalation/exhalation patterns, head movement, body roll, kick pattern, speed, etc.) incoming from the MIDS 12 and/or derive the information via data incoming from the MIDS 12. The information may then be used to give feedback to the wearer of the MIDS 12 during swimming activities 22.

[0039] In other embodiments, MIDS 12 communications may be two-way communications. In such embodiments, the wearer may receive information from external systems, such as the mobile devices 34, the cloud-based system 36, and/or other external computing systems 37 (e.g., computing systems including workstations, desktops, smart TVs, etc.) for configuration of the MIDS 12 and/or to provide feedback on the activity being performed by the wearer. For example, virtual coaching and training, gaming, social networking, and the like, may be provided via two-way communication, as described in more detail below.

[0040] It may be beneficial to illustrate example views of the MIDS 12 disposed on an eyewear system. Accordingly, and turning now to FIG. 2A, the figure is a front perspective view of an example MIDS 12 disposed on the swim goggles 14. In the depicted embodiment, the MIDS 12 is disposed on a left lens 40 of the swim goggles 14. However, in other embodiments the MIDS 12 may be disposed on a right lens 42 of the swim goggles 14. In yet other embodiments, the MIDS 12 may be disposable in either the left lens 40 or the right lens 40 based on the user's preference. For example, the MIDS 12 (or the entire left lens 40) may be toollessly removed and repositioned onto the right lens 42 (or right side) of the swim goggle 14. Indeed, in some embodiments the MIDS 12 may be removed by hand and then placed onto another type of eyewear (e.g., sunglasses 16, ski goggles 18, helmet visors 20), another set of swim goggles 14, and/or to the other side or lens of the swim goggles 14. The MIDS 12 may thus be self-contained, such as enclosed in a waterproof housing of size of 40 mm by 40 mm, 30 mm by 30 mm, 20 mm by 20 mm, 10 mm by 10 mm, or less.

[0041] FIG. 2B is a front perspective view showing an embodiment of the swim goggles 14 with the MIDS 12 removed. More specifically, the figure illustrates an opening 44 suitable for deploying the MIDS 12 in situ. For example, the user may carry various swim goggles 14 with different opacities, goggles 14 for outdoor swimming, customizable goggles 14 (e.g., Swedish swim goggles), prescription goggles 14, and so on, and then easily insert the MIDS 12 into the opening 44 based on type of event, ambient condi-

tions, and so forth. In certain embodiments, the MIDS 12 may mechanically couple with the lens 40 via an interference fit between edges of the opening 44 and an outer shell of the MIDS 12. Other coupling techniques may include tongue and groove fastening techniques, magnetic fasteners, mechanical latches, catches, and so on.

[0042] In use, the MIDS 12 may provide for an improved field of view even with the MIDS 12 in place, as shown in FIG. 2C. More specifically, FIG. 2C is a rear perspective view illustrating an embodiment of the MIDS 12 disposed in the lens 44. As illustrated, the MIDS 12 may occlude only a small section of the lens 44, while leaving a larger section 46 unobstructed. Accordingly, the wearer may have and improved situational awareness and field of view when compared to larger display systems, useful in sports activities. It is to be note that while FIGS. 2A-2C depict the MIDS 12 using swim goggles 14 for context, the MIDS 12 may be disposed in openings 44 found in other eyewear, such as the sunglasses 16, the ski goggles 18, and/or the helmet visors 20.

[0043] FIG. 3 is a system architecture block diagram of an embodiment of the MIDS 12. As depicted, the MIDS 12 may include one or more processors 50 and memory 52. The processor 50 may include "general-purpose" microprocessors, special-purpose microprocessors, application specific integrated circuits (ASICs), a reduced instruction set (RISC) processors, field programmable arrays (FPGAs), or some combination thereof. The memory 52 may include a volatile memory, such as random access memory (RAM), and/or a nonvolatile memory, such as ROM. The memory 52 may store a variety of information and may be used for various purposes. For example, the memory 52 may store processor-executable instructions (e.g., firmware or software) for the processor(s) 50 to execute. The MIDS 12 may also include a storage device 54. The storage device 54 may include a hard drive, a flash drive, a solid state storage medium, or combination thereof, suitable for storing digital data. Power for the MIDS 12 and its systems may be provided via a power supply system 56, which may include one or more rechargeable batteries chargeable via induction charging techniques and/or wired charging techniques.

[0044] In use, visual data (e.g., text, icons, images) may be provided via a display system 58. The display system 58 may include a low power micro display system (e.g., micro LED display) having, for example, a total size of 40 mm by 40 mm, 30 mm by 30 mm, 20 mm by 20 mm, 10 mm by 10 mm, or less. The display system 58 may be positioned in peripherally to the eye as shown in FIGS. 2A-2C, such that the display system 58 does not disturb forward vision. Peripheral positioning may include the corner of the eye (left or right), but it may also include the bottom or top of the eye. When placed at the top or bottom positions, two MIDS 12 may be used so that two display systems 58 are placed in both eyes, creating binocular vision.

[0045] When positioned as described, if the athlete or wearer is not looking at the display system 58 then the athlete doesn't see the information and is not disturbed by the MIDS 12. In other words, the display system 58 may appear invisible unless looked at directly. Additionally, by having a direct display system 58, as opposed to an indirect display system having prisms, mirrors, projectors, and so forth, the MIDS 10 may be manufactured in a smaller and more reliable form factor, suitable for providing useful

information while also providing for situational awareness and a more open field of view.

[0046] In addition to or alternative to LED displays, the display system **58** may include one or more LED lights. Light feedback may be advantageous because it may not break exercise concentration or require deeper processing. Simple color lights may be used to indicate performance. For example, green would indicate good performance in swim turns, swim stroke, swim kick cadence, bike speed, run speed, bike cadence, run cadence, ski turns, motorcycle lean, and so on. Red may indicate when performance is not as desired. Accordingly, the MIDS **10** may be capable of filling the eyewear with colored light to provide feedback to the wearer.

[0047] Further, an input/output (I/O) system **60** may provide for other output modalities haptic output, and/or audio output. Haptic output may include force feedback such as “tapping” motions. Audio output may be provided via bone conduction, via wireless techniques (e.g., Bluetooth Advanced Audio Distribution Profile [A2DP], aptX), and/or via a waterproof audio port. Audio feedback may indicate a “good” noise when performance is desired, such as a chime, and a “bad” noise when performance is not as desired, such as a buzzer. Audio feedback may additionally or alternatively include a metronome-like sound played to help improve stroke count when swimming, cadence when biking and/or running, to keep track of elapsed time, and so on. The sound or “tappings” may also be set to operate adaptively by increasing/decreasing swimming stroke rate, bicycling/running cadence, skiing turns, and the like, by a fraction; and therefore slowly improving stroke rate, cadence, turning, and the like, without forcing the wearer to coarsely jump between rates. Audio output may also include voice coaching, music playing, and so on.

[0048] Input may be received via the I/O system **60**, for example, via one or more buttons, and/or via touch sensors. The touch sensors may be suitable for receiving gesture inputs, such as swiping, tapping, pressing, holding, and so on. Accordingly, the user may switch modes, turn displays on and off, and so on. A wireless system **62** may also be included in the MIDS **12**. As mentioned earlier, the wireless system **62** may include systems such as Wi-Fi (e.g., IEEE 802.11X), cellular systems (e.g., HSPA, HSPA+, long term evolution LTE, WiMax), near field communications (NFC) systems, Bluetooth systems including low power Bluetooth systems, personal area networks (PANs), Zigbee systems, Z-wave systems, wireless mesh systems, and the like, and so on, suitable for wirelessly communicating with other systems, such as the mobile system **34**, the cloud-based system **36**, and/or other external computing systems **37**. Internal sensors **64** may include accelerometers, gyroscopic sensors, temperature sensors, ambient temperature sensors, humidity sensors, altitude sensors, magnetometric sensors (e.g., compass systems), barometric pressure sensors, biometric sensors (e.g., pulse oximeters, body temperature sensors, electrocardiogram sensors, health informatics sensors [e.g., ISO/IEEE 11073 sensors]), and the like.

[0049] In certain embodiments, internal sensors **64** include heart monitoring sensors such as photoplethysmographic (PPG) sensors, plethysmographic sensors, piezoelectric sensors, pulse oximetry sensors (e.g., light sensors), and so on, suitable for measuring heart rate, v, oxygen saturation, and so on. The internal sensors **64** may be placed at certain locations around the eye and/or nose areas to more accu-

rately measure certain biological properties of the wearer, as shown in more detail below with respect to FIGS. **13-18**.

[0050] A global positioning system (GPS) and/or GLO-NASS system **66** may also be included in the MIDS **12**. The GPS system **66** may be used to provide for the MIDS **12** position of relative to a fixed global coordinate system, a fixed local coordinate system (e.g., indoor GPS), or a combination thereof. The GPS **66** may additionally use real time kinematic (RTK) techniques to enhance positioning accuracy. An inertial measurement unit (IMU) **68** may also be included, which may include one or more sensors, such as specific force sensors, angular rate sensors, accelerometers, gyroscopes, and/or magnetic field change sensors that may provide for the inertial measurements as the MIDS **10** moves. The IMU **68** may be used to provide for one or more degrees of freedom (DOF) measurements correlative with certain performance during activities **22, 24, 26, 28, 30** when the MIDS **12** is disposed on the wearer, as described in more detail with respect to FIG. **4**. By placing a small heads up display in the MIDS **12** and/or by using audio feedback techniques as described, the athlete doesn’t interrupt exercise cadence to consume information, unlike when using wrist-based devices. With wrist-based devices, the athlete typically has to stop swimming to see information or otherwise disrupt the activity such as by changing running cadence to allow the wrist to be raised and viewed, disrupting cycling pedaling cadence to examine a wrist or handlebar display.

[0051] FIG. **4** depicts an embodiment of a process **78** suitable for deriving certain performance baselines for wearers of the MIDS **12**. The process **78** or certain steps of the process **78** may be implemented as computer-executable instructions executed via the processor(s) **50**, the mobile device **34**, the cloud-based system **36**, and/or other external computing systems **37**. It to be understood that the process **78** may include steps that are optional, and that the steps may be performed in other order than the one shown.

[0052] In the depicted embodiment, the MIDS **12** is shown disposed in the swim goggles **14** during swimming activities **22**. As mentioned above, the IMU system **68** may include sensors (e.g., as specific force sensors, angular rate sensors, accelerometers, gyroscopes, and/or magnetic field change sensors) that may be used to sense multiple degrees of freedom of the wearer’s head. In the illustrated embodiment, 6 degrees of freedom are provided by the IMU system **68**, including pitch **80**, roll **82**, yaw **84**, up **86**, down **88**, left **90**, right, **92**, forward **94**, and back **96**. Accordingly, the MIDS **12** may receive and log (block **98**) real-time data representative of the 6 degrees of freedom as the user undergoes an activity, such as swimming **22**, resulting in logged data **100**. The logged data **100** may also include data from the internal sensors **64** and/or the external sensors **32**.

[0053] Certain techniques, such as a machine learning system **102**, may be used to process the logged data **100** to recognize (block **104**) the wearer’s activity (e.g., activities **22, 24, 26, 28, 30**) and the wearer’s performance during the activity. For example, logged data **100** may be tagged as swim data, and the machine learning system **102** trained to recognize that the wearer was swimming. Likewise, the machine learning system may be trained to recognize any one of the activities **24, 26, 28, 30**. The machine learning system **102** may then be used to derive (block **106**) certain baselines **108** based on the activity. For example, for swimming **22**, starts (e.g., block starts, outdoor swim starts), turns

(e.g., flip turns, side turns, buoy turns), splits and sets, times, strokes (e.g., freestyle, breaststroke, butterfly, backstroke, sidestroke), kicking cadence, breathing patterns, head position during the swim, and so on, may be baselined. For example, a professional athlete may be “recorded” (e.g., used to provide the logged data 100) during swim turns and the machine learning system 102 may then train a neural network to recognize a “good” turn. This trained network then may become one of the baselines 108. The baseline(s) 108 may also be provided by statistical analysis. For example, the logged data 100 may be analyzed to derive medians, averages, ranges, which may then act as the baseline(s) 108. Accordingly, deviations, such as standard deviations, percentile deviations, quartile deviations, and so on, from the medians, averages, and/or ranges, may be outside of the baseline(s) 108. In this manner, baselines may be derived for “good” starts, strokes, kicking, breathing, head position, and so on.

[0054] Each activity 22, 24, 26, 28, 30 may be similarly processed to derive “good” (and “bad”) baselines 108. For example, for bicycling 24, the baselines 108 may include recordings of flat terrain cadence, hill climbing cadence, sprinting, aero tuck head positioning, drafting, hill descent positioning, gear changes, and so on. For running 26 the baselines 108 may include flat terrain cadence, hill climbing cadence, hill descent cadence, arm rotation, foot landings, and so on. For motorcycle riding 28 the baselines 108 may include leaning on curved road sections, accelerating, braking (front wheel braking, rear wheel braking), and the like. For skiing 30 the baselines 108 may include parallel turning, edging, carving, cadence based on incline, and so on. The baselines 108 may also include biometrics, for example when biometric sensors 32 and/or 64 are used. The biometrics may include heart rate, body temperature, peripheral capillary oxygen saturation (e.g., SpO2 provided via pulse oximetry sensors), calories burned, heart rate, cardiac heart rest recovery time, health recovery time, heart variability, and the like.

[0055] The aforementioned baselines 108 are for example only and are non-limiting, as any number of baselines may be created based on a “recording” of a wearer performing some activity as well as manually through analysis of the logged data 100. It is to be noted that the baselines 108 are not restricted to logged data 100 recorded by professional athletes but may be derived for any user of the MIDS 12. For example, an amateur athlete may record” him or herself and then provide the recordings (e.g., logged data 100) to a coaching system for evaluation and/or to keep a record of progress, as further described below. The baselines 108 may also be used to analyze, in real-time, performance of the wearer of the MIDS 12 to provide feedback as to how to improve performance.

[0056] FIG. 5 depicts an embodiment of a process 120 suitable for deriving certain performance metrics and/or feedback for wearers of the MIDS 12. The process 120 or certain steps of the process 120 may be implemented as computer-executable instructions executed via the processor (s) 50, the mobile device 34, the cloud-based system 36, and/or other external computing systems 37. It to be understood that the process 120 may include steps that are optional, and that the steps may be performed in other order than the one shown.

[0057] In the depicted embodiment, the wearer of the MIDS 12 may be performing the swimming activity 22

while training, competing, or simply for enjoyment of the activity 22. The MIDS 12 may enhance the activity 22 by providing for certain feedback. For example, as the wearer swims, the process 120 may receive (block 122) data 124, such as the degrees of freedom via the IMU system 68, as well as other sensed data from the sensors 32, 64. In certain embodiments, the data may be processed to derive (block 126) certain metrics 128. Deriving (block 126) the metrics 128 may include deriving the activity being performed, e.g., activity 22, 24, 26, 28, 30. Accordingly, the metrics 128 may be correlative with the activity being performed. For example, for swimming 22, the metrics may include speed, direction of travel, compass heading and/or location (for open water swimming), elapsed time, splits and sets, number of laps, type of stroke used, breathing metrics, head position metrics, kicking cadence, stroke cadence, body roll metrics, and so on.

[0058] For bicycling 24, the metrics 128 may include speed, direction of travel, compass heading and/or location, elapsed time, elapsed distance, as well as data gathered via external sensors 32 such as crankarm RPM (e.g., crankarm cadence), power output at the pedals (in Watts), current gear selected, bike odometer, and so on. For running 26 the metrics 128 may include speed, direction of travel, compass heading and/or location, elapsed time, elapsed distance, running cadence, arm cadence, foot placement, kicking cadence, and so on. For motorcycling 28 the activity metrics may include speed, direction of travel, compass heading and/or location, elapsed time, elapsed distance, leaning metrics, braking metrics, acceleration metrics, as well as data gathered via external sensors 32 such as MPG, engine RPM, odometer, gas tank level, coolant level, oil level, remaining range, error codes, and so on. For skiing 32 the metrics 128 may include speed, direction of travel, compass heading and/or location, elapsed time, elapsed distance, parallel turning metrics, edging metrics, carving metrics, cadence based on incline metrics, and so on.

[0059] The metrics 128 may also include biometrics, for example when biometric sensors 32 are used. The biometrics may include heart rate, body temperature, peripheral capillary oxygen saturation (e.g., SpO2 provided via pulse oximetry sensors), calories burned, heart rate, cardiac heart rest recovery time, health recovery time, heart variability, and the like. The metrics 128 may also include ambient metrics such as temperature, ambient pressure, altitude, humidity, and the like. Additionally, the metrics 128 may include GPS/GLONASS metrics such as current position and compass heading. Any one or more of metrics 128 may then be displayed (block 130), for example via the display system 58 and/or I/O system 60. As described earlier, the display system 58 may be positioned so that if the athlete or wearer is not looking at the display system 58 then the athlete doesn’t see the information and is not disturbed by the MIDS 12. That is, the display system 58 may appear invisible unless looked at directly. In certain embodiments, the wearer may configure the MIDS 12 to create a user profile that may customize, for example, the set of metrics 128 to display for each of the activities 22, 24, 26, 28, 30.

[0060] The process 120 may also compare (block 132) the metrics 128 to the previously derived baseline(s) 108 to derive a quality measure 134. For example, a swim turn may include various metrics 128 such as head position at various points of the turn, speed of the head, leg positions/kicks, and/or body positions (via sensors 32 disposed on the body),

through the turn. The metrics **128** may be compared (block **132**) to metrics in the baseline(s) **108** to derive the quality measure **134**. The comparison may include comparison by range (e.g., if the observed metric **128** is inside a range found in the baseline(s) **108**), statistical comparisons (e.g., inside of a percentile, quartile, via standard deviation techniques, ANOVA techniques, MANOVA techniques, etc.), and/or AI comparisons (e.g., when the baseline(s) **108** include pattern recognition via neural networks, state vector machines, expert systems, fuzzy logic, and so on). The quality measure may be a binary measure, e.g., “good” and “bad”, and/or a number such as a number between 1-10, 1-100, and the like, for example, denoting how close the metrics **128** are to the baseline(s) **108**. Example quality measures for swimming include but are not limited to a swim turn quality measure, a kicking cadence quality measure, a body roll quality measure, a stroke performance quality measure, a head position quality measure, and so on. The quality measure **134** may then be displayed via the display system **58** and/or the I/O system **60**. By providing for feedback during the performance of activities in a minimally intrusive manner, the MIDS **12** may enable improved training, competition, and an increased enjoyment of the activities.

[0061] FIG. 6 is a block diagram illustrates an embodiment of multiple systems, including a coaching/training system **150**, a gaming system **152**, an in-competition system **154**, and a social networking system **156** that may interface with the MIDS **12** while worn by users. The systems **150**, **152**, **154**, **156** may include software systems executable via the MIDS **12**, the mobile device **34**, the cloud-based system **36**, and/or other external computing systems **37**.

[0062] In the depicted embodiment, the coaching/training system **150** may receive, for example, the metrics **128** and/or data representative of the metrics **128** in real-time and/or offline and then provide for a repository of the MIDS **12** data as well as for feedback. For example, wearers may track daily, weekly, monthly progress by logging into the coaching/training system and visualizing or comparing, via a tablet, cell phone, computer display, and the like, training and/or competition metrics **128** as well as training and/or competition quality measures **134** throughout a desired time period (e.g., day week, month). The coaching/training system **150** may also provide feedback to improve performance. For example, the coaching/training system **150** may use AI, statistical, and/or human based analysis to analyze the metrics **128** and/or quality measures **134** and provide feedback on how to improve swim turns (e.g., suggestion on when to start a turn, speed of the turn, improvements to head position, improvements to body tuck, when to leg push, and so on). Similarly, for swimming **22**, suggestions for stroke improvements, kicking cadence, breathing and breathing cadence, drafting, when to “attack” during competition, may be provided.

[0063] For running **24**, the coaching/training system **150** may provide feedback such as suggestions on cadence, kicking, arm movement, pacing for distance, head lean, and so on. For bicycling **26**, the coaching/training system **150** may provide feedback such as suggestions on speed, RPMs, when to get off the saddle, pedaling cadence, head position, gear shifting, drafting, and so on. For motorcycling **28**, the coaching/training system **150** may provide feedback such as suggestions on leaning, gear changes, acceleration, braking, head position, and so on. For skiing **30**, the coaching/training system **150** may provide feedback such as sugges-

tions on where to look, parallel turning, edging, carving, stopping (e.g., v-stop, side stop), foot rotation, and so forth.

[0064] The coaching/training system **150** may also enable for remote or virtual coaching. For example, a human coach **158** may be located at a different geographic location from wearer **160** and from wearer **162**. By using the coaching/training system **150**, for example via a software application (e.g., app) **164**, the coach **158** may receive real-time feedback, metrics **128**, and/or quality measures **134** while the wearers **160**, **162** are performing an activity, e.g., swimming **22**. The coach **158** may then provide for recommendations on technique, changes to certain techniques, new training schedules, and so on. In some embodiments, the coach’s **158** feedback may be displayed in the MIDS **12** (e.g., via display system **58**, I/O system **60**) or provided as audio. The coaching/training system **150** may also use the baselines **108** (e.g., heart rate, body temperature, peripheral capillary oxygen saturation (e.g., SpO2 provided via pulse oximetry sensors), calories burned, heart rate, cardiac heart rest recovery time, health recovery time, heart variability, and the like) to measure progress. For example, changes from the baselines **108** may then be used to determine workout changes, diet changes, recovery times, sleep times, and so on.

[0065] The gaming system **150** may provide for virtual racing against a virtual athlete **166** as well as against wearers **160** and **162** disposed in different geographic locations. The virtual athlete **166** may be an athlete that has been previously “recorded” with the techniques described herein. For example, the virtual athlete **166** may have been recorded in an Olympic size pool but then processed by the gaming system **150** to compete in open ocean swimming, in other pool lengths, and so on. Further, the virtual athlete **166** may be a previous recording from any wearer, including wearers **160**, **162**. The gaming system **150** may further process the wearer’s recording to extrapolate a different type of swim, e.g., open ocean swim, during a virtual race. Further, the virtual athlete may be a fictional athlete created for virtual competition (e.g., aquaman). By connecting wearers **160**, **162**, at different locations, and by providing for one or more virtual competitors **166**, the gaming system **150** may enable competitions across disparate geographic regions and with a broad category of competitors, including virtual athletes.

[0066] The in-competition system **154** may be used during actual competitions of the activities **22**, **24**, **26**, **28**, **30**. Each competition may include a different set of rules as to what functionality the MIDS **12** may provide during the competition. For example, coaching functionality may be disabled. Accordingly, the MIDS **12** may receive a competition template disabling and/or enabling certain MIDS **12** functionality during the competition. The MIDS **12** may also be used in lieu of or in addition to competition smart tags, such as by tracking arrival at certain designated spots, providing for GPS tracking of competitors, providing for health information of competitors (including providing data from external health sensors), and so on.

[0067] FIG. 6 also illustrates “hand-off” capabilities of the MIDS **12** during multi-sport events, such as biathlons, triathlons, relay sports, and so on. In the illustrated embodiment, once the wearer **162** may have previously set up two MIDS **12** for triathlon. One MIDS **12** may be disposed in swim goggles **14** and the second MIDS **12** may be disposed in sunglasses **16**. Once the wearer **162** exits the water and removes the swim goggles **14**, the removal motion may then trigger a transition portion **168**. During the transition portion

168 certain information may be tracked, such as a first triathlon transition time clock, to record transition times between swim-bike portions. Once the wearer 162 dons the sunglasses 16, the MIDS 12 on the sunglasses 16 may then take over and provide information during a bicycling portion 170 of the event. Once the bicycling portion 170 is complete, the wearer 162 may use the I/O system 60 to direct the second MIDS 12 disposed in the sunglasses 16 to begin a second transition 172. The second MIDS 12 may then, for example, begin a second triathlon transition time clock to record transition times between bike-run portions. The second MIDS 12 may then provide the wearer 162 information during a run portion 174 of the event. Data captured during the transitions may then be submitted to the systems 150, 152, 154, and/or 156. Indeed, the coaching/training system 150, the gaming system 152, the in-competition system 154, and/or the social networking system 156 may support data storage and analysis of multi-sport or relay sport data, including transitions 168, 172.

[0068] The social networking system 156 may enable meetings, virtual events, and data sharing between various users of the MIDS 12, including amateur users of various levels, professional users, and/or coaches. For example, the social networking system 156 may enable the discovery of other users of similar performance levels. The users may form networks for training, competition, and/or advice. For example, a network may be formed via the social networking system 156 for users interested in learning how to swim using the butterfly stroke. The social networking system 156 may then coordinate training meets, including virtual meets, coaching, and progress tracking amongst the group, virtual competitions for group members, creation of virtual awards and points earned, and so on. Coaches may sign up via the social networking system 156 and advertise their expertise. The coaches may then provide services via the coaching/training system 150 and the MIDS 12. The social networking system 156 may thus be communicatively coupled to the systems 150, 152, 154, to share data, to share functionality, and/or to provide for a single login into all systems 150, 152, 154, 156.

[0069] FIGS. 7A and 7B illustrate embodiments of certain areas 200, 202 of the MIDS 12 that may include the display system 58. In the embodiment depicted in FIG. 7A, the areas 200 includes a LED pixel display 204 that is shown displaying text. More specifically, the display 204 is displaying a time 206, a minute separator 208, a lap counter 210, and a swim indicator 212. The time displayed is thus 2:00 minutes, with 15 laps counted while still swimming. The display 204 may be small in size, such as between 10 mm by 10 mm to 40 mm by 40 mm or less. Accordingly, the display 204 may be disposed in a corner of eyewear to provide for a minimally intrusive display.

[0070] Further, FIG. 7A illustrates that the display system 58 may include a LED light 214, such as a multi-color LED. In use, the LED light 214 may be turned on at one or more colors based on the metrics 128 and/or the quality measure 134 derived during the various activities 22, 24, 26, 28, 30. For example, the color red may be displayed if certain metrics 128 and/or quality measures 134 are below a certain threshold, and the color green may be displayed if the metrics 128 and/or quality measures 134 are above the threshold. The light 214 and/or display 204 may be customizable by the wearer. For example, the wearer may select which of the various metrics 128 to be displayed as text,

such as but not limited to speed, elapsed distance, elapsed time, splits, sets, laps counted, kicking cadence, and stroke cadence. The quality measures 134 may also be customized by the wearer to select which ones are to be displayed as text, such as “good turn”, “bad turn”, “slow kick”, “fast kick”, and so on.

[0071] FIG. 7B illustrates the use of icons on the display 204. That is, in addition to text, icons may also be displayed. For example, the illustrated embodiments show an up arrow 216, a down arrow 218, a left arrow 220, and a right arrow 222. The arrows 216, 218, 220, 222 may be used to provide directions during certain activities as well as to provide feedback. For example, the up arrow 216 may indicate that a swimmer is swimming towards a desired direction during an outdoor swim, and when the swimmer strays from the desired direction, the left arrow 220 may be flashed to indicate to the swimmer to swim towards his or her left side to get back to the desired swim direction. Likewise, the right arrow 22 may be flashed to indicate to the swimmer to swim towards his or her right side to get back to the desired swim direction.

[0072] The up arrow 216 may also be displayed, akin to a “thumbs up”, when a desired metric 128 and/or performance measure 134 is reached, the down arrow 218 may be displayed if the metric 128 and/or performance measure 134 is not reached. It is to be noted that other icons may be used, such as emoji (e.g., thumbs up icon, thumbs down icon, smiley face, sad face, and so on).

[0073] FIG. 8 is a schematic view of an embodiment of a double mirrored display system 250 that may be included in the display system 58. The double mirrored display system 250 may use two mirrors 252 and 254 (e.g., “folded” mirrors) to increase a track length of the double mirrored display system 250, thus providing for a suitable presentation of visual information in a more compact package. That is, the mirrors 252 and 254 enable light to travel from a projective display system 256 into an eye entrance 258 with travel length or track length longer than directly projecting the light into the eye entrance 258. Accordingly, an improved view of data projected via the projective display system 256 may be provided.

[0074] The projective display system 256 (e.g., LCD, laser, etc.), which may be disposed on a printed circuit board (PCB). As light exits the projective display system 256, it then reflects off of the first mirror 252. The first mirror 252 may include a curvature, thus acting as a first lens suitable for magnifying the projected images. The light may then reflect off of the second mirror 254. The second mirror 254 may include a slight curvature to act as a slight correcting lens. The light may then be further enhanced via a normal aspheric lens surface 260. In some embodiments, the aspheric lens surface 260 may include a surface profile designed to reduce or to eliminate spherical and optical aberrations. In one embodiment, all components of the double mirrored display system 250 (e.g., the mirrors 252, 254, surface 260) may be manufactured as a single piece, for example, a piece molded in polymethyl methacrylate (PMMA), Polycarbonate, Zeonex, and so on. Additionally, the double mirrored display system 250, and indeed a variety of displays incorporated in the display system 58, may be disposed so that during the activity (e.g., activities, 22, 24, 26, 28, 30) the user may have a clear view of the activity and then with a slight movement of the eye, see information

displayed via the display system 58 as further described below with respect to FIGS. 9-12.

[0075] FIG. 9 is a schematic top view of an embodiment of the display system 58 where the display system 58 includes the double mirrored display system 250. In the depicted embodiment, the user's eye 270 is shown with the pupil 272 looking in a forward direction 274 away from the head (e.g., direction such that when both eyes are looking in the forward direction the corresponding vectors 274 for each eye are parallel to each other and to a plane that extends between and separates the frontal sinuses, bisecting the nose). When looking in the forward direction 274, the eye may not see information from the display system 250 and/or the display system 250 itself. Indeed, the user may look straight ahead during performance of the activities 22, 24, 26, 28, and/or 30 and have an unobstructed view. When the user then decides to receive information, such as information 130, 134 provided by the double mirrored display system 250, the user may glance to a side so that the pupil 272 moves from the forward direction 274 towards a position 276. That is, when the user moves the pupil 272 a certain angle α away from the forward direction 274 and towards the double mirrored display system 250, the user may now see information presented by the double mirrored display system 250. For example, at position 276, the pupil may enter the eye box 278 so that the light projected via the double mirrored display system 250 is now visible. In certain embodiments, the angle α may be between 10° to 90° .

[0076] FIG. 10 illustrates a schematic top view of an embodiment of the display system 58 where the display system 58 includes a single mirrored display system 280. In the depicted embodiment, the user's eye 270 is shown with the pupil 272 looking in the forward direction 274 away from the head. As mentioned above, when looking in the forward direction 276, the pupil 272 may not see information provided via the single mirrored display system 280 or the single mirrored display system 280 itself.

[0077] As illustrated, the projective display system 256 may project information, such as information 130, 134, via light. The light may reflect off of a mirror 282, and then be further modified via optics 284, which may include a lens or lenses, including correcting lens or lenses, aspheric lens or lenses, or a combination thereof. The single mirrored display system 280 may include a light travel length or track length longer than directly projecting the light into the eye 270, but shorter than the light travel length of the double mirrored display system 250. The user may look straight ahead, e.g., in the forward direction 274, during performance of the activities 22, 24, 26, 28, and/or 30 and have an unobstructed view. When the user then decides to receive information, such as information 130, 134 provided by the single mirrored display system 280, the user may glance to a side so that the pupil 272 moves from the forward direction 274 towards a position 276. That is, when the user moves the pupil 272 a certain angle α away from the forward direction 274 and towards the single mirrored display system 280, the user may now see information presented by the single mirrored display system 280. For example, at position 276, the pupil may be able to see inside of the eye box 278 so that the light projected via the single mirrored display system 280 is now visible. In certain embodiments, the angle α may be between 10° to 90° .

[0078] FIG. 11 illustrates a schematic top view of an embodiment of the display system 58 where the display system 58 includes a direct optical display system 290. In the depicted embodiment, the user's eye 270 is shown with the pupil 272 looking in the forward direction 274 away from the head. As mentioned above, when looking in the forward direction 276, the pupil 272 may not see information provided via the direct optical display system 290 or the direct optical display system 290 itself.

[0079] As illustrated, the projective display system 256 may project information, such as information 130, 134, via light. The light may then be further modified via optics 292, which may include a lens or lenses, including correcting lens or lenses, aspheric lens or lenses, or a combination thereof. The direct optical display system 290 may include a light travel length shorter than the light travel length of the double mirrored display system 250. The user may look straight ahead, e.g., in the forward direction 274, during performance of the activities 22, 24, 26, 28, and/or 30 and have an unobstructed view. When the user then decides to receive information, such as information 130, 134 provided by the direct optical display system 290, the user may glance to a side so that the pupil 272 moves from the forward direction 274 towards a position 276. That is, when the user moves the pupil 272 a certain angle α away from the forward direction 274 and towards the direct optical display system 290, the user may now see information presented by the direct optical display system 290. For example, at position 276, the pupil may be able to see inside of the eye box 278 so that the light projected via the direct optical display system 290 is now visible. In certain embodiments, the angle α may be between 10° to 90° .

[0080] FIG. 12 illustrates a schematic top view of an embodiment of the display system 58 where the display system 58 includes a direct display system 300. In the depicted embodiment, the user's eye 270 is shown with the pupil 272 looking in the forward direction 274 away from the head. As mentioned above, when looking in the forward direction 276, the pupil 272 may not see information provided via the direct display system 300 or the direct display system 300 itself.

[0081] As illustrated, the projective display system 256 may project information, such as information 130, 134, via light. The light may then be further modified via microlens or light-field projection optics 302. The microlens(es) may include diameters less than a millimeter, and may include gradient-index (GRIN) lenses, micro-Fresnel lenses, binary-optic lenses, and so on. The light-field projection optics may include lenslet arrays, projective arrays, and so on. The direct display system 300 may include a light travel length shorter than the light travel length of the double mirrored display system 250. The user may look straight ahead, e.g., in the forward direction 274, during performance of the activities 22, 24, 26, 28, and/or 30 and have an unobstructed view. When the user then decides to receive information, such as information 130, 134 provided by the direct display system 300, the user may glance to a side so that the pupil 272 moves from the forward direction 274 towards a position 276. That is, when the user moves the pupil 272 a certain angle α away from the forward direction 274 and towards the direct display system 300, the user may now see information presented by the direct display system 300. For example, at position 276, the pupil may be able to see inside of the eye box 278 so that the light projected via the direct

display system **300** is now visible. In certain embodiments, the angle α may be between 10° to 90° .

[0082] It is to be understood that while the various display systems, e.g., systems **58**, **250**, **280**, **290**, **300** are shown as disposed on a side of a lens (e.g., side of lens of swim goggles **14**, sunglasses **16**, ski goggles **18**, visor **20**) in the figures above, the various display systems, e.g., systems **58**, **250**, **280**, **290**, **300** may be disposed on top/bottom of lenses or in other portions of the swim goggles **14**, sunglasses **16**, ski goggles **18**, and/or visor **20** that are visible when placed over the eyes. Accordingly, the angle α away from the forward direction **274** may point towards any portion of the swim goggles **14**, sunglasses **16**, ski goggles **18**, and/or visor **20**, including lens portions, that are visible by moving the pupil **272** away from the forward direction **274**.

[0083] Turning now to FIG. **13**, the figure is a perspective view of a human muscle and capillary head region **400** showing placements for certain of the sensors **32**, **64**. For example, when using photoplethysmographic (PPG) and/or piezoelectric sensors, a supraorbital artery region **402**, a first angular artery region **404**, a second angular artery region **406**, and/or a temporal artery region **407** may improve measurement quality. Likewise, a temporal artery location **407** may be used. The PPG sensors **32** and/or **64** may use a light emitting diode (LED) to shine light at the user's skin and then measure the returning light. Differences between outgoing and returning light may be used to determine heart rate, to obtain a volumetric measurement (e.g., plethysmogram) for the regions **402**, **404**, **406**, **407** and the like. The heart rate and/or volumetric measurement may be used to monitor, cardiac cycle, respiration, hypovolemia, and/or hypervolemia.

[0084] For example, the processor(s) **50** may include algorithms that take as input signals from the PPG sensors **32** and/or **64** and then derive heart rate, cardiac cycle stages (e.g., 1 Isovolumic relaxation, 2a Inflow: (Ventricular filling), 2b Inflow: (Ventricular filling with Atrial systole), 3 Isovolumic contraction, 4 Ejection: Ventricular ejection), respiration (e.g., due to variance in the intrapleural pressure), fluid volumes and so on. For example, the data may be used to derive a Wiggers diagram, a pseudo electrocardiogram, a pseudo phonocardiogram, and so on. SpO₂ may also be derived via the PPG sensors **32** and/or **64**, and may be further used to estimate VO₂Max, where VO₂ is the volume of oxygen uptake. For example, changes in oxygen may be used to determine a rate at which oxygen is being used during physical activity. In certain embodiments, cardiac output (Q) may be derived by calculating stroke volume times heart rate. Both the stroke volume and the heart rate may be derived by the PPG sensors **32** and/or **64**. An arterio-venous difference or A-VO₂ difference may also be derived, for example with one PPG sensor **32** and/or **64** disposed in an arterial site and a second PPG sensor **32** and/or **64** in a venous site. Fick's equation: $VO_2 = Q \times A - VO_2$ difference, may then be used to calculate VO₂ max.

[0085] The piezoelectric sensors **32** and/or **64** may use a piezoelectric effect (e.g., electric signals generated by an applied mechanical force such as a tap) to detect pulse rate. For example, as the supraorbital and/or angular artery expands and contracts through the cardiac cycle, the piezoelectric sensors **32** and/or **64** may provide a signal that correlative with volumetric changes in the supraorbital and/or angular arteries. The piezoelectric signals may then be used to derive the heart rate, cardiac cycle stages, fluid

volumes, and the like. It is to be understood that multiple sensors types of the sensors **32** and/or **64** may be used, including PPG sensors, piezoelectric sensors, resistance-based sensors, cameras, body temperature sensors, electrocardiogram sensors, health informatics sensors (e.g., ISO/IEEE 11073 sensors), and so on.

[0086] Because of the placement, for example in regions **402**, **404**, **406**, and/or **407**, the techniques described herein may improve accuracy and result in a more compact MIDS **12** suitable for providing the MIDS **12** in a hydrodynamic shape to improve drag coefficients and minimize turbulence. In certain embodiments, the MIDS **12** may only include internal sensors **64**. Accordingly, the user, such as a competitive swimmer, may receive more accurate biofeedback data without having to wear chest straps, limb straps (watch straps, leg straps), and so on.

[0087] FIG. **14** is a rear perspective view of an embodiment of the MIDS **12** when provided in a swim goggles **14** form factor. In the depicted embodiment, the swim goggles **14** include a seal or gasket system **450**. The gasket system **450** may include a unibody silicone gasket **452** surrounding a translucent or transparent eyepiece **454**. In use, the gasket **452** may conformably seat the eyepiece **454** against a swimmer's eye socket, providing for a watertight seal during water immersion. Also shown are a PPG sensor **456** and two piezoelectric sensors **458** and **460**. The PPG sensor **456** may be slightly embedded inside of the gasket **452** and disposed to illuminate light into, for example, supraorbital artery region **402** (shown in FIG. **13**). The piezoelectric sensors **458** and **460** may be disposed on top of the gasket **452** and positioned to contact, for example, the first angular artery region **404**, the second angular artery region **406**, a temporal artery region **407**, or combination thereof. The sensors **458**, **460** are shown as square piezoelectric sensors, but other shapes may be used (e.g., circular shapes, oval shapes, trapezoidal shapes, multiangular shapes, or combination thereof). It is to be understood that the sensors **456**, **458**, and/or **460** may be placed at any location on the gasket **452**, and that one, two, three, four, five, or more sensors may be used. Further, the sensors may include any sensor type previously described with respect to sensors **32** and/or **64**.

[0088] FIG. **15** is a rear perspective view of another embodiment of the MIDS **12** when provided in a swim goggles **14** form factor. In the depicted embodiment, four piezoelectric sensors **470**, **472**, **474**, and **476** are shown. The piezoelectric sensors **470**, **472**, **474**, and **476** are disposed to cover a wider area of the gasket **452** when compared to FIG. **14**. The piezoelectric sensors **470**, **472**, and **476** are also shown as being multi-angled sensors covering more surface area when compared to the piezoelectric sensors **458**, **460** of FIG. **14**. During operations, the piezoelectric sensors **470**, **472**, **474**, and **476** may each provide a signal correlative with cardiac rhythm or heart rate. The signals from the piezoelectric sensors **470**, **472**, **474**, and **476** may then be processed by the processor(s) **50** and converted into measurements such as heart rate.

[0089] FIG. **16** is a rear perspective view of an embodiment of the MIDS **12** when provided in a sunglass **16** form factor. In the depicted embodiment, one PPG sensor **600** is shown disposed on a nose bridge pad **602** of the sunglass **16**. A second nose bridge pad **604** is also shown. In some embodiments, a second sensor (e.g., PPG or piezoelectric sensor) may be disposed on the second nose bridge pad **604**. The PPG sensor **600** may illuminate a nose bridge region

and used as described above to derive a variety of measurements, including heart rate, cardiac cycle stages (e.g., 1 Isovolumic relaxation, 2a Inflow: (Ventricular filling), 2b Inflow: (Ventricular filling with Atrial systole), 3 Isovolumic contraction, 4 Ejection: Ventricular ejection), respiration (e.g., due to variance in the intrapleural pressure), fluid volumes and so on. In addition to or alternative to the PPG sensor 600, a piezoelectric sensor may be used, as shown in FIG. 17.

[0090] FIG. 17 is a rear perspective view of another embodiment of the MIDS 12 when provided in a sunglass 16 form factor. In the depicted embodiment, one piezoelectric sensor 610 is shown disposed on the nose bridge pad 602 of the sunglass 16. The second nose bridge pad 604 is also shown. In some embodiments, a second sensor (e.g., PPG or piezoelectric sensor) may be disposed on the second nose bridge pad 604. The PPG sensor 610 may use the piezoelectric effect to detect cardiac rhythms in the nose area, and then derive various measurements as previously described.

[0091] FIG. 18 is a flowchart of an embodiment of a process 700 suitable for deriving one or more biological measurements for the user of the MIDS 12. The process 700 may be implemented as computer code or instructions executable by the processor(s) 50 and stored in the memory 52. It is to be understood that not all of the blocks shown may be performed by the process 700 and some of the blocks may be performed in other orders instead of the one shown. In the depicted embodiment, the process 700 may calibrate (block 702) certain sensors, such as the sensors 32 and/or 64. For example, when a swimmer dons the MIDS 12 (e.g., goggles 14), the swimmer may adjust the MIDS 12 to provide a watertight fit. When placed on the user and/or when requested by the user, the MIDS 12 may calibrate (block 702) the sensors 32 and/or 64 to account for environmental conditions, for example.

[0092] The process 700 may then transmit (block 704) sensor 32 and/or 64 sensor signals. That is, during operations, the sensors 32 and/or 64 may transmit signals correlative of certain physiological measurements, such as but not limited to heart rate, cardiac rhythm, cardiac cycle stages (e.g., 1 Isovolumic relaxation, 2a Inflow: (Ventricular filling), 2b Inflow: (Ventricular filling with Atrial systole), 3 Isovolumic contraction, 4 Ejection: Ventricular ejection), respiration (e.g., due to variance in the intrapleural pressure), fluid volumes and so on. The transmitted signals may be received (block 706) by the processor(s) 50, by signal processors (e.g., digital signal processors [DSPs]), by external systems (e.g., mobile devices 34, cloud-based system 36, external computing systems 37), and the like.

[0093] The process 700 may then derive (block 708) one or more physiological measurements, for example, during activities involving the MIDS 12. As mentioned earlier, heart rate, cardiac cycle, respiration, hypovolemia, hypervolemia, calories burned, heart rate, cardiac heart rest recovery time, health recovery time, heart variability, and so on. The derived measurements may then be displayed (block 710), for example, via the display 58 and/or displays included in external systems (e.g., mobile devices 34, cloud-based system 36, external computing systems 37). When displayed by the display 58, a user, such as a swimmer, may easily visualize current heart rate, respiration, calories, burned, and so on, without having to add extra equipment (e.g., chest sensors, limb sensors). The process 700 may additionally log (block 712) the physiological measure-

ments, for example to then provide a historical view of a training sessions, user progress, changes in technique and consequent impact to physiological measurements (e.g., changes in heart rate after changing swim stroke patterns), and so on.

[0094] Technical effects of the invention include providing for a minimally intrusive display system that may be disposed in a variety of eyewear to provide for feedback during certain activities, including sports activities. The minimally intrusive display system may derive certain metrics and performance measures during performance on an activity, and then display the metrics and performance measures to a wearer of the eyewear. Haptic and audio feedback may also be provided via the minimally intrusive display system.

[0095] This written description uses examples to disclose the invention, including the best mode, and also to enable any person skilled in the art to practice the invention, including making and using any devices or systems and performing any incorporated methods. The patentable scope of the invention is defined by the claims, and may include other examples that occur to those skilled in the art. Such other examples are intended to be within the scope of the claims if they have structural elements that do not differ from the literal language of the claims, or if they include equivalent structural elements with insubstantial differences from the literal languages of the claims.

1. A system, comprising:

- a minimally intrusive display system (MIDS) configured to be disposed on an eyewear, the MIDS comprising:
 - a waterproof container;
 - a battery system configured to provide power for the MIDS;
 - a display system;
 - a wireless communications system configured to communicate wirelessly with an external system;
 - a sensor system included in the eyewear configured to provide for sensor data; and
 - a processor configured to:

- process the sensor data to derive an activity metric;
 - display, via the display system, the activity metric, wherein the display system is disposed in the eyewear so that the activity metric is only viewed when a user of the eyewear turns the user's pupil towards the display system at angle α from a forward direction, wherein the battery system and the processor are enclosed in the waterproof container, and wherein the waterproof container comprises a minimally intrusive size sized to fit on the eyewear; and
 - adjust a setting of the MIDS communicated wirelessly from the external system.

2. The system of claim 1, wherein the sensor system comprises at least one photoplethysmographic (PPG) sensor, at least one piezoelectric sensor, or a combination thereof.

3. The system of claim 2, wherein the eyewear comprises swim goggles and wherein the at least one PPG sensor, the at least one piezoelectric sensor, or the combination thereof, is disposed in a gasket system included in the swim goggles.

4. The system of claim 2, wherein the eyewear comprises sunglasses, eyeglasses, or a combination thereof, and wherein the at least one PPG sensor, the at least one piezoelectric sensor, or the combination thereof, is disposed in a nose bridge of the sunglasses, the eyeglasses, or the combination thereof.

5. The system of claim 1, wherein the processor is configured to process the sensor data to derive a physiologic measure.

6. The system of claim 1, wherein the eyewear comprises swim goggles and wherein the activity metric comprises a swimming metric comprising a head position, a speed, a leg position, a body position, a direction of travel, a compass heading, a location, an elapsed time, a split, a set, a number of laps, a type of stroke used, a breathing metric, a kicking cadence, a stroke cadence, a swim turn metric, or a combination thereof.

7. The system of claim 1, wherein the MIDS system is entirely disposed in the eyewear.

8. The system of claim 7, wherein the MIDS system is entirely disposed on a goggle of the eyewear and wherein the angle α is between 10° to 90° .

9. The system of claim 1, wherein the external system comprises a cell phone.

10. The system of claim 5, wherein the external system is configured to process the sensor data to derive the physiological measure.

11. The system of claim 9, wherein the external system is configured to execute an app comprising a coaching/training system, a gaming system, an in-competition system, a social networking system, or a combination thereof, configured to use the physiological measure as input.

12. The system of claim 5, wherein physiological measure comprises a heart rate, a cardiac cycle, a respiration, a calories burned, a VO2Max, a peripheral capillary oxygen saturation (SpO2), a body temperature, a cardiac heart rest recovery time, a health recovery time, a heart variability, or a combination thereof.

13. A non-transitory computer readable medium comprising executable instructions which, when executed by a processor, cause the processor to:

receive a sensor data from a sensor system disposed in a minimally intrusive display system (MIDS) configured to be disposed on an eyewear, the MIDS comprising a waterproof container, a battery system configured to provide power for the MIDS, a display system, and the processor;

communicate wirelessly with an external system via a wireless communications system included in the MIDS;

process the sensor data to derive an activity metric; display, via a display system disposed in the MIDS, the activity metric, wherein the display system is disposed in the eyewear so that the activity metric is only viewed when a user of the eyewear turns the user's pupil towards the display system at angle α from a forward direction, and wherein the display system, the battery system, and the processor are enclosed in the waterproof container, and wherein the waterproof container comprises a minimally intrusive size sized to fit on the eyewear; and

adjust a setting of the MIDS communicated wirelessly from the external system.

14. The non-transitory computer readable medium of claim 13 wherein the sensor system comprises at least one photoplethysmographic (PPG) sensor, at least one piezoelectric sensor, or a combination thereof.

15. The non-transitory computer readable medium of claim 14, wherein the eyewear comprises swim goggles and wherein the at least one PPG sensor, the at least one piezoelectric sensor, or the combination thereof, is disposed in a gasket system included in the swim goggles.

16. The non-transitory computer readable medium of claim 13 wherein the eyewear comprises sunglasses, eyeglasses, or a combination thereof, and wherein the at least one PPG sensor, the at least one piezoelectric sensor, or the combination thereof, is disposed in a nose bridge of the sunglasses, the eyeglasses, or the combination thereof.

17. The non-transitory computer readable medium of claim 13, wherein the processor is configured to process the sensor data to derive a physiologic measure.

18. A method comprising:

receiving a sensor data from a sensor system disposed in a minimally intrusive display system (MIDS) configured to be disposed on an eyewear, the MIDS comprising a waterproof container, a battery system configured to provide power for the MIDS, a display system, and the processor;

communicating wirelessly with an external system via a wireless communications system included in the MIDS processing the sensor data to derive an activity metric;

communicating the activity metric for display via a display system disposed in the MIDS, wherein the display system is configured to be disposed in the eyewear so that the activity metric is only viewed when a user of the eyewear turns the user's pupil towards the display system at angle α from a forward direction, wherein the display system, the battery system, and the processor are enclosed in the waterproof container, and wherein the waterproof container comprises a minimally intrusive size sized to fit on the eyewear; and

adjusting a setting of the MIDS communicated wirelessly from the external system.

19. The method of claim 18, processing the sensor data to derive a physiologic measure, wherein physiological measure comprises a heart rate, a cardiac cycle, a respiration, a calories burned, a VO2Max, a peripheral capillary oxygen saturation (SpO2), a body temperature, a cardiac heart rest recovery time, a health recovery time, a heart variability, or a combination thereof.

20. The method of claim 18, wherein the activity metric comprises a swimming metric comprising a head position, a speed, a leg position, a body position, a direction of travel, a compass heading, a location, an elapsed time, a split, a set, a number of laps, a type of stroke used, a breathing metric, a kicking cadence, a stroke cadence, a swim turn metric, or a combination thereof.

* * * * *

专利名称(译)	具有心率监测功能的最小干扰显示器的系统和方法		
公开(公告)号	US20190350472A1	公开(公告)日	2019-11-21
申请号	US16/274231	申请日	2019-02-12
[标]发明人	ZHOVNIROVSKY YURI		
发明人	ZHOVNIROVSKY, YURI		
IPC分类号	A61B5/024 G02C11/00 A61B5/00		
CPC分类号	A61B5/02438 A61B5/7445 A61B5/02427 A61B5/6803 G02C11/10 A61B2503/10 A61B5/0077 A61B5/02055 A61B5/02405 A61B5/02433 A61B5/0408 A61B5/0816 A61B5/1116 A61B5/1118 A61B5/14542 A61B5/486 A61B5/4866 A61B5/7264 A61B5/7275 A61B2505/09 A61B2560/0257 A61B2562/0219 A61B2562/0247 A61B2562/029 A63B24/0062 A63B33/002 A63B2024/0025 A63B2024/0068 A63B2071/0625 A63B2071/065 A63B2071/0655 A63B2071/0666 A63B2207/02 A63B2209/08 A63B2209/10 A63B2220/12 A63B2220/16 A63B2220/17 A63B2220/18 A63B2220/30 A63B2220/34 A63B2220/40 A63B2220/50 A63B2220/51 A63B2220/62 A63B2220/64 A63B2220/72 A63B2220/73 A63B2220/74 A63B2220/75 A63B2220/76 A63B2220/80 A63B2220/803 A63B2220/805 A63B2220/83 A63B2220/833 A63B2220/836 A63B2225/12 A63B2225/50 A63B2225/60 A63B2230/04 A63B2230/207 A63B2230/50 A63B2230/75 G02B27/0172 G02B2027/014 G02B2027/0178 G02C7/086 G16H50/20 G16H50/30		
外部链接	Espacenet	USPTO	

摘要(译)

一种系统，包括配置为布置在眼镜上的最小干扰显示系统 (MIDS)。MIDS包括显示系统和被配置为提供传感器数据的传感器系统。MIDS还包括配置为处理传感器数据以导出生理测量值的处理器。处理器还被配置为经由显示系统显示生理测量，其中显示系统被布置在眼镜中，使得仅当眼镜的用户以一定角度将用户的瞳孔朝向显示系统转动时才观看生理测量。从向前方向的 α 。

