



US006671531B2

(12) **United States Patent**
Al-Ali et al.

(10) **Patent No.: US 6,671,531 B2**
(45) **Date of Patent: Dec. 30, 2003**

(54) **SENSOR WRAP INCLUDING FOLDABLE APPLICATOR**

4,865,038 A 9/1989 Rich et al.
5,090,410 A 2/1992 Saper et al.
5,158,323 A 10/1992 Yamamoto et al.

(75) Inventors: **Ammar Al-Ali**, Tustin, CA (US);
Eugene E. Mason, La Mirada, CA (US)

(List continued on next page.)

(73) Assignee: **Masimo Corporation**, Irvine, CA (US)

FOREIGN PATENT DOCUMENTS

(*) Notice: Subject to any disclaimer, the term of this patent is extended or adjusted under 35 U.S.C. 154(b) by 11 days.

EP 0 313 238 A2 10/1988
WO WO 01/41634 A2 6/2001

OTHER PUBLICATIONS

(21) Appl. No.: **10/020,664**

(22) Filed: **Dec. 11, 2001**

(65) **Prior Publication Data**

US 2002/0045807 A1 Apr. 18, 2002

MSP Industry Alert, "Masimo To Introduce NR7 At ASA", pp. 18, 19, and the front and back cover, vol. 3, No. 3, Fall 2001.

(List continued on next page.)

Related U.S. Application Data

(63) Continuation-in-part of application No. 09/456,666, filed on Dec. 9, 1999, now Pat. No. 6,377,829.

(60) Provisional application No. 60/324,873, filed on Sep. 25, 2001, and provisional application No. 60/306,635, filed on Jul. 18, 2001.

(51) **Int. Cl.⁷** **A61B 5/00**

(52) **U.S. Cl.** **600/344; 600/323**

(58) **Field of Search** 600/309-310,
600/322-323, 344; 356/39-42

(56) **References Cited**

U.S. PATENT DOCUMENTS

4,621,643 A 11/1986 New, Jr. et al.

Primary Examiner—Eric F. Winakur

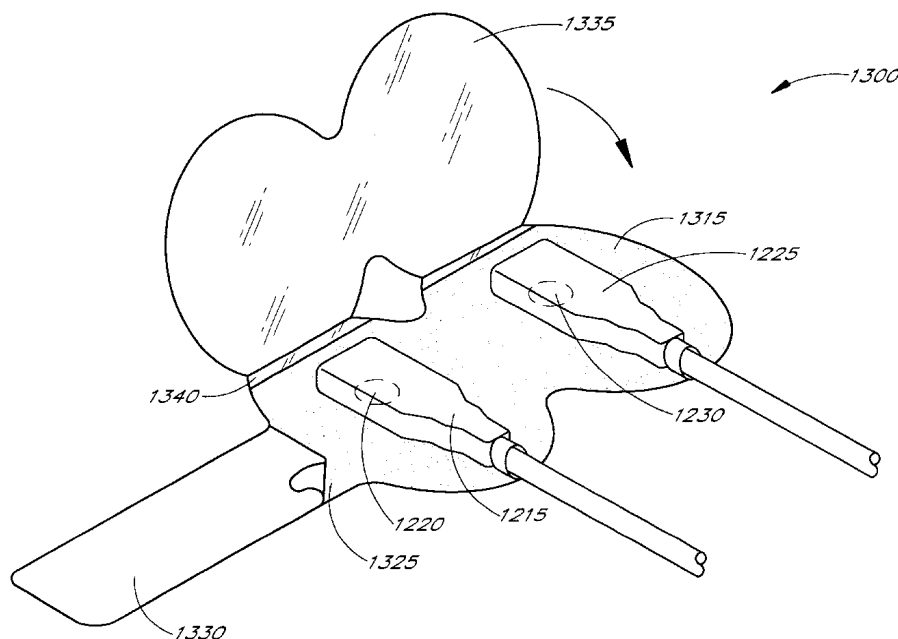
Assistant Examiner—Matthew Kremer

(74) *Attorney, Agent, or Firm*—Knobbe, Martens, Olson & Bear LLP.

(57) **ABSTRACT**

A sensor wrap including a foldable applicator which substantially and removably secures sensor elements within the sensor wrap before application of the sensor wrap to a measurement site. The sensor wrap may advantageously include disposable tape layers including an information element, a breakable conductor, or both.

39 Claims, 23 Drawing Sheets



U.S. PATENT DOCUMENTS

5,170,786 A	12/1992	Thomas et al.	
5,209,230 A	5/1993	Swedlow et al.	
5,638,818 A	6/1997	Diab et al.	
5,660,567 A	8/1997	Nierlich et al.	
5,673,693 A	10/1997	Solenberger	
5,678,544 A	10/1997	DeLonzor et al.	
5,758,644 A	6/1998	Diab et al.	
5,817,008 A *	10/1998	Rafert et al.	600/323
5,919,133 A	7/1999	Taylor et al.	
5,995,855 A	11/1999	Kiani et al.	
5,999,834 A	12/1999	Wang et al.	
6,014,576 A	1/2000	Raley	
6,061,584 A	5/2000	Lovejoy et al.	
6,256,523 B1	7/2001	Diab et al.	

OTHER PUBLICATIONS

<http://www.masimo.com.htm>, "System Overview & Performance", 2 pages, reviewed on Sep. 17, 1999.
<http://www.masimo.com/pandt.htm>, "Products & Technology", 1 page, reviewed on Sep. 17, 1999.

<http://www.masimo.co/cables.htm>, "Patient Cables", 1 page, review on Sep. 17, 1999.

<http://www.masimo.com/adt.htm>, "Inop adt—Adult Disposable Digit Sensor", 1 page, reviewed on Sep. 17, 1999.

http://www.mrequipment.com/products/pulse_oximetry.htm, "MR Equipment Magnetic Resonance Equipment Corporation, Pulse Oximetry in MRI Model 3500 Oximeter", 2 pages, reviewed on Sep. 17, 1999.

http://www.mrequipment.com/products/oximetry_patient_mntrg.htm, "MR Equipment Magnetic Resonance Equipment Corporation, MR-Compatible High-Performance Optical Fiber Sensors, Pulse Oximetry Sensors for MRI Fiber Optic Sensors for use with MR-Compatible Pulse Oximeter", 2 pages, reviewed on Sep. 17, 1999.

Masimo Corporation, "Discrete Saturation Transform Example", reviewed on Sep. 17, 1999.

* cited by examiner

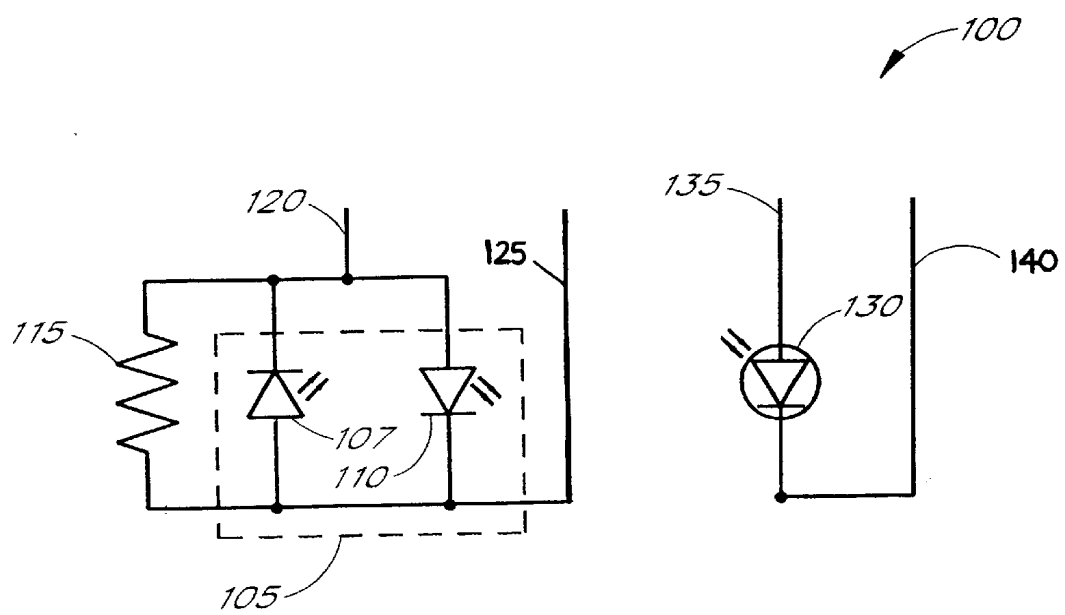
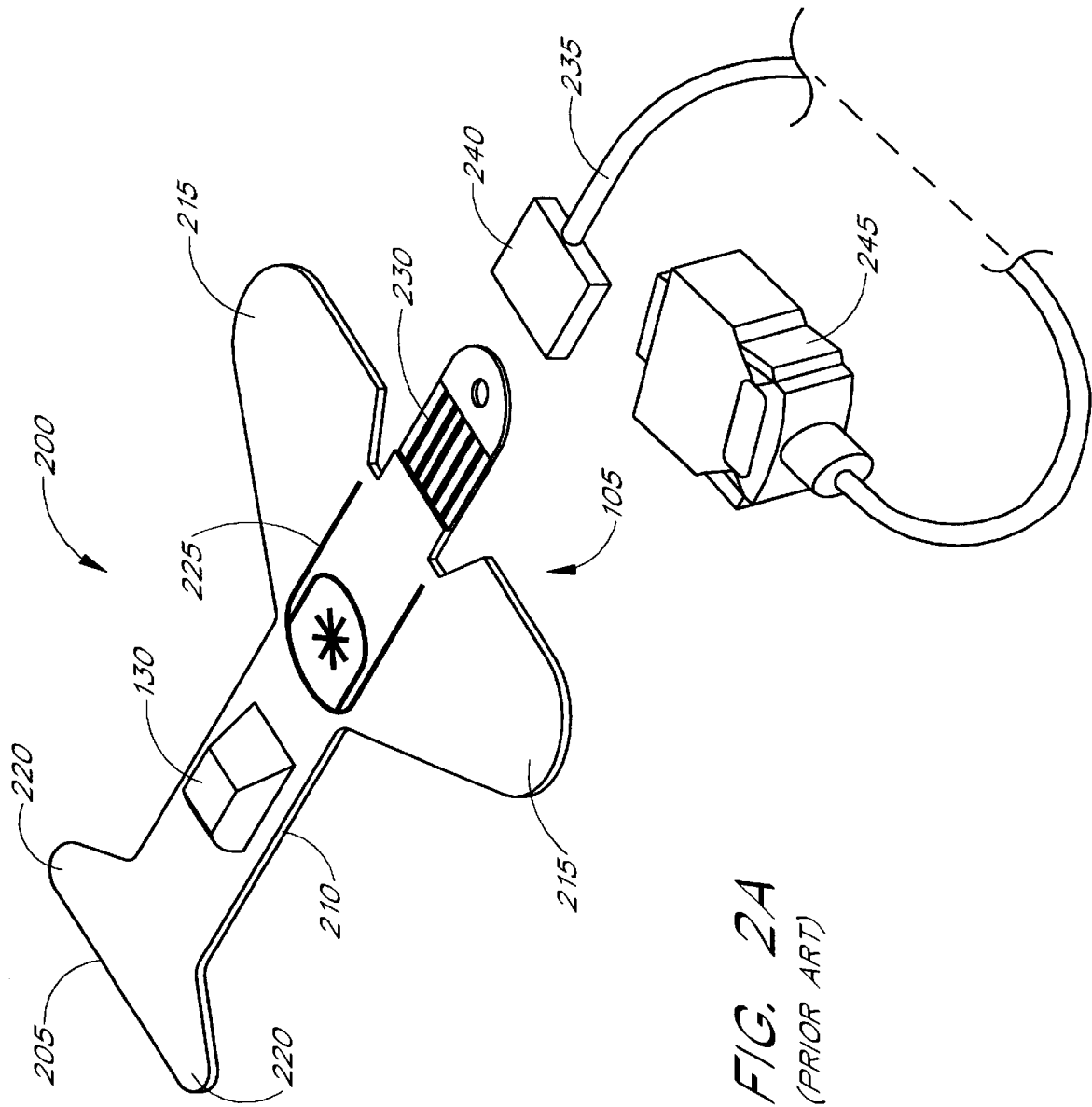
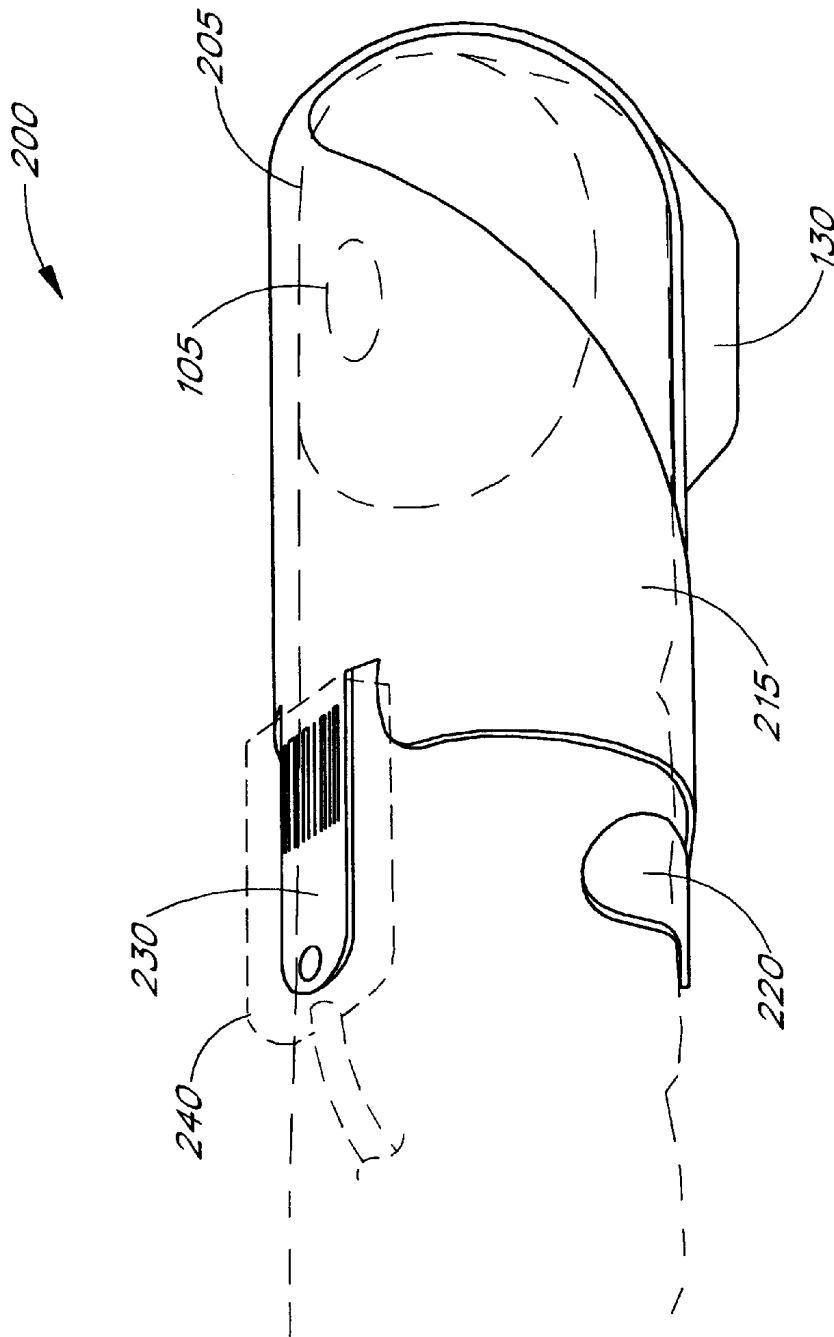
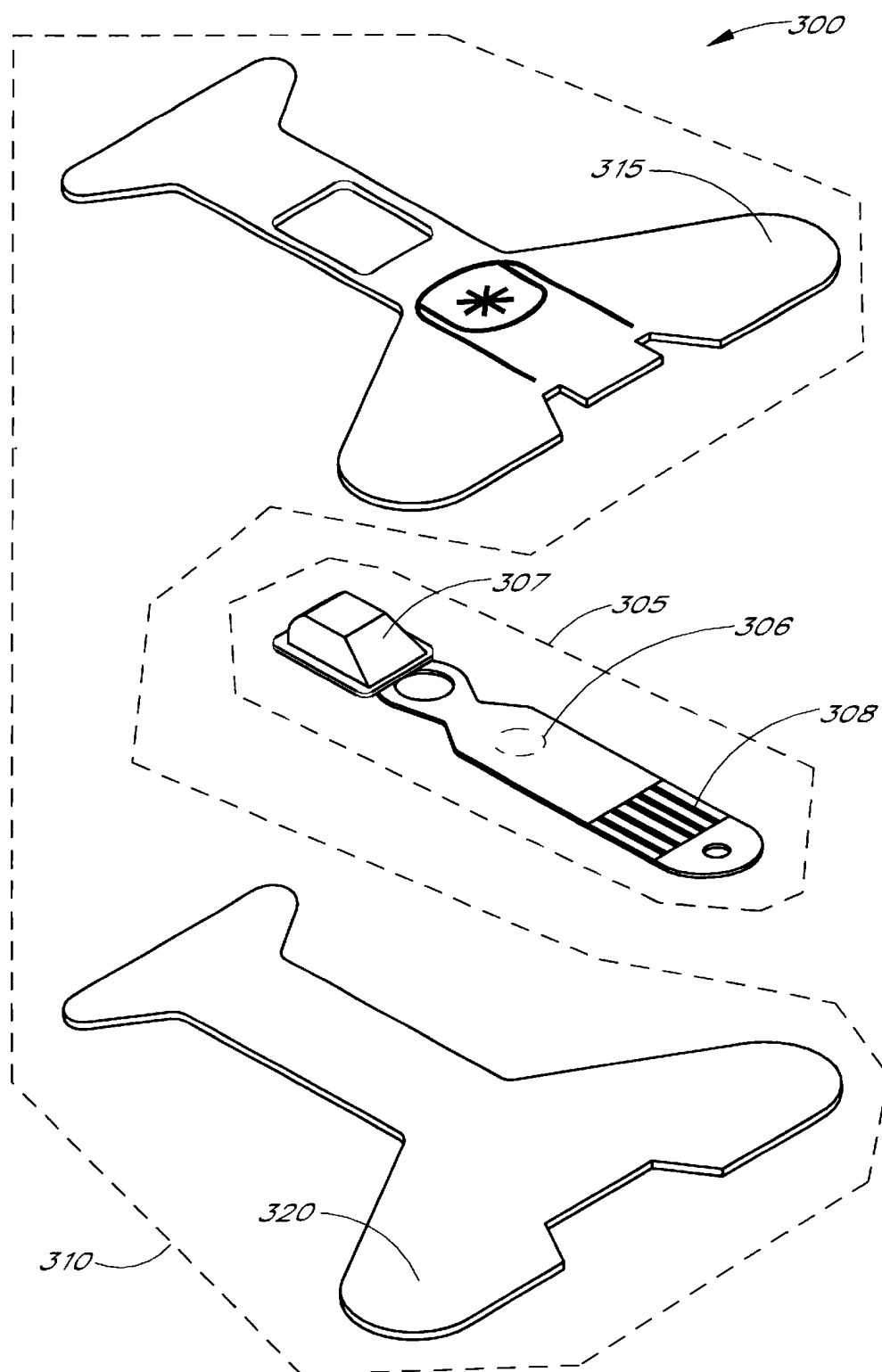
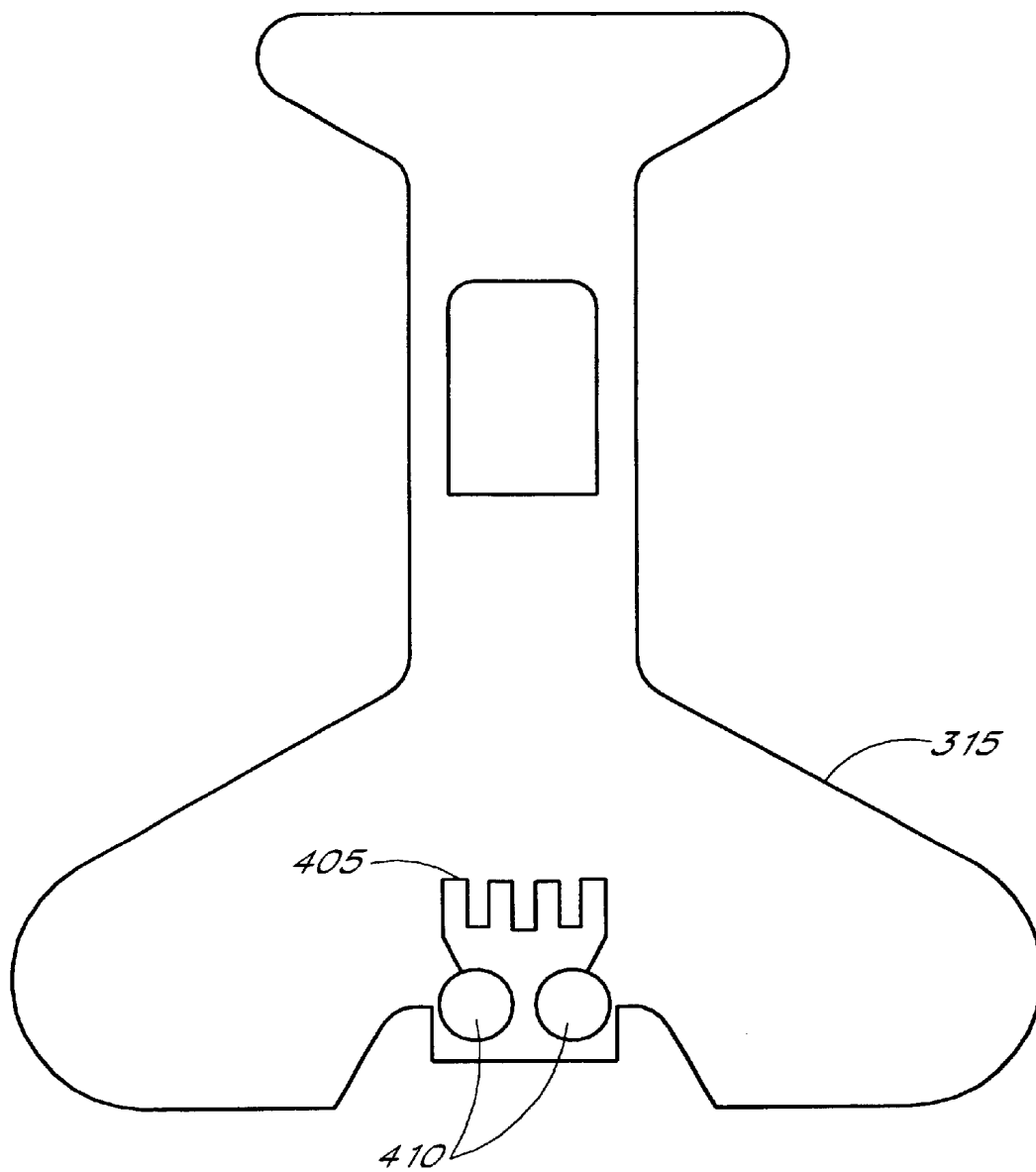


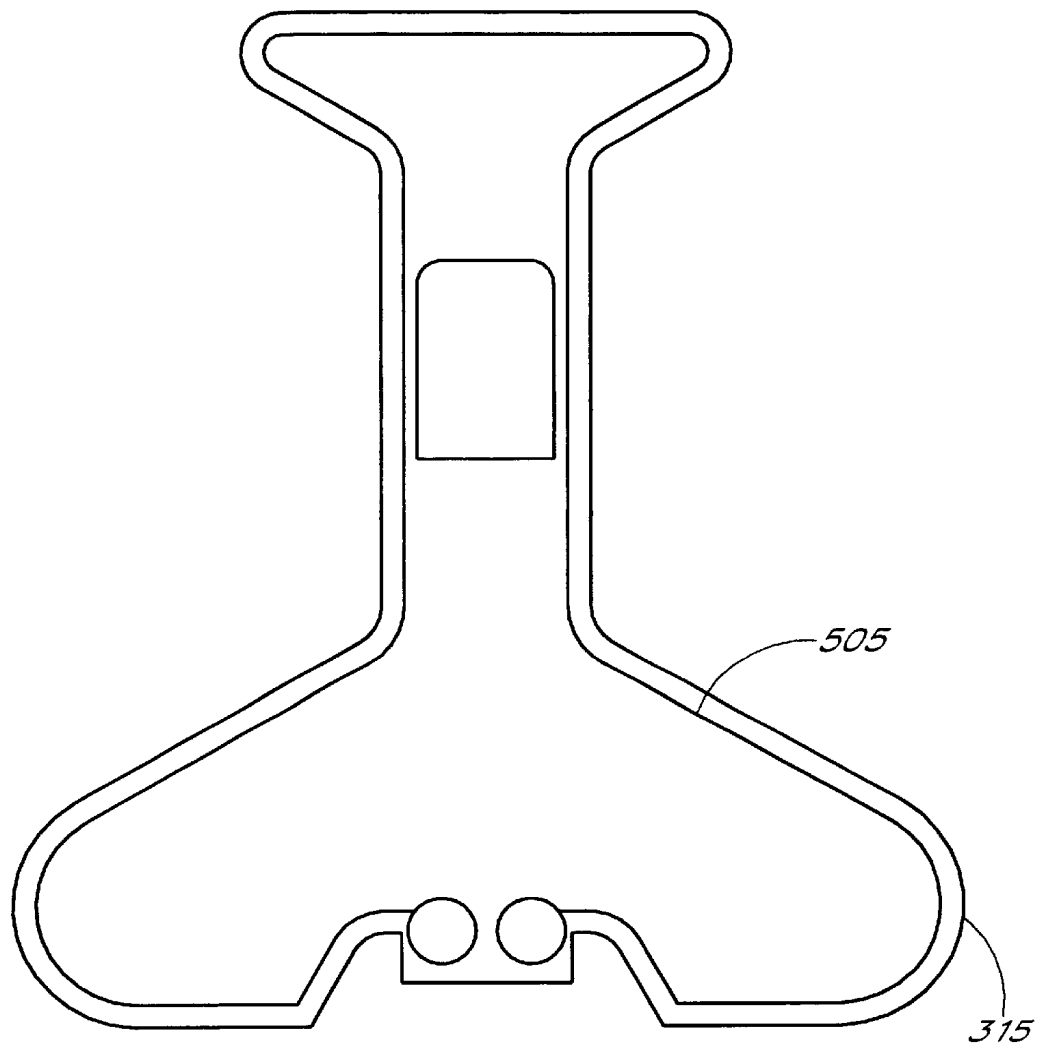
FIG. 1

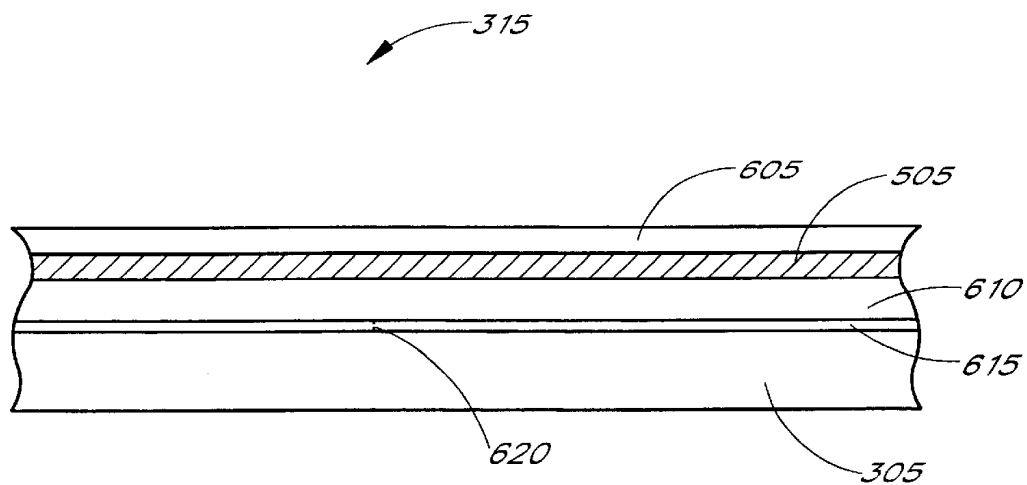
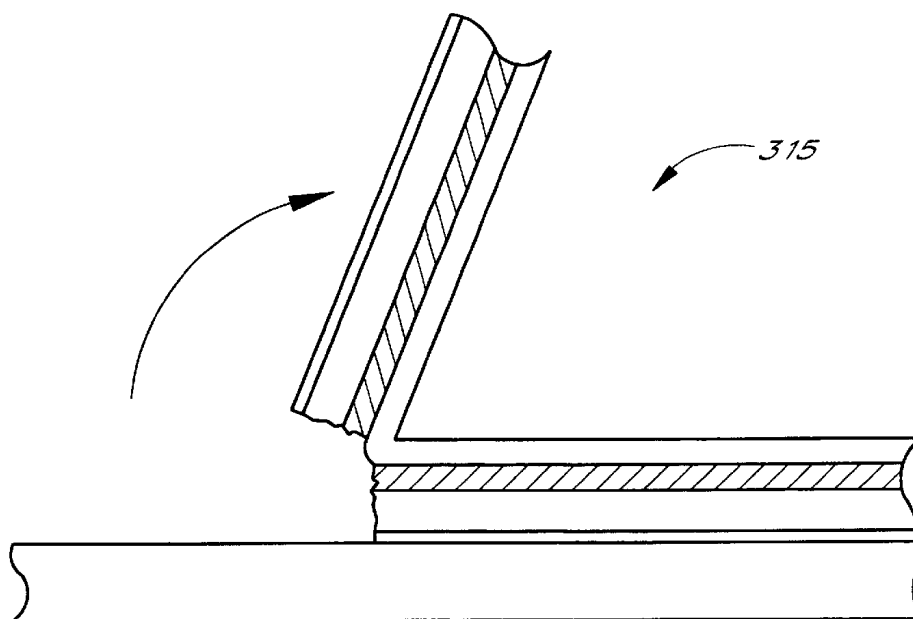


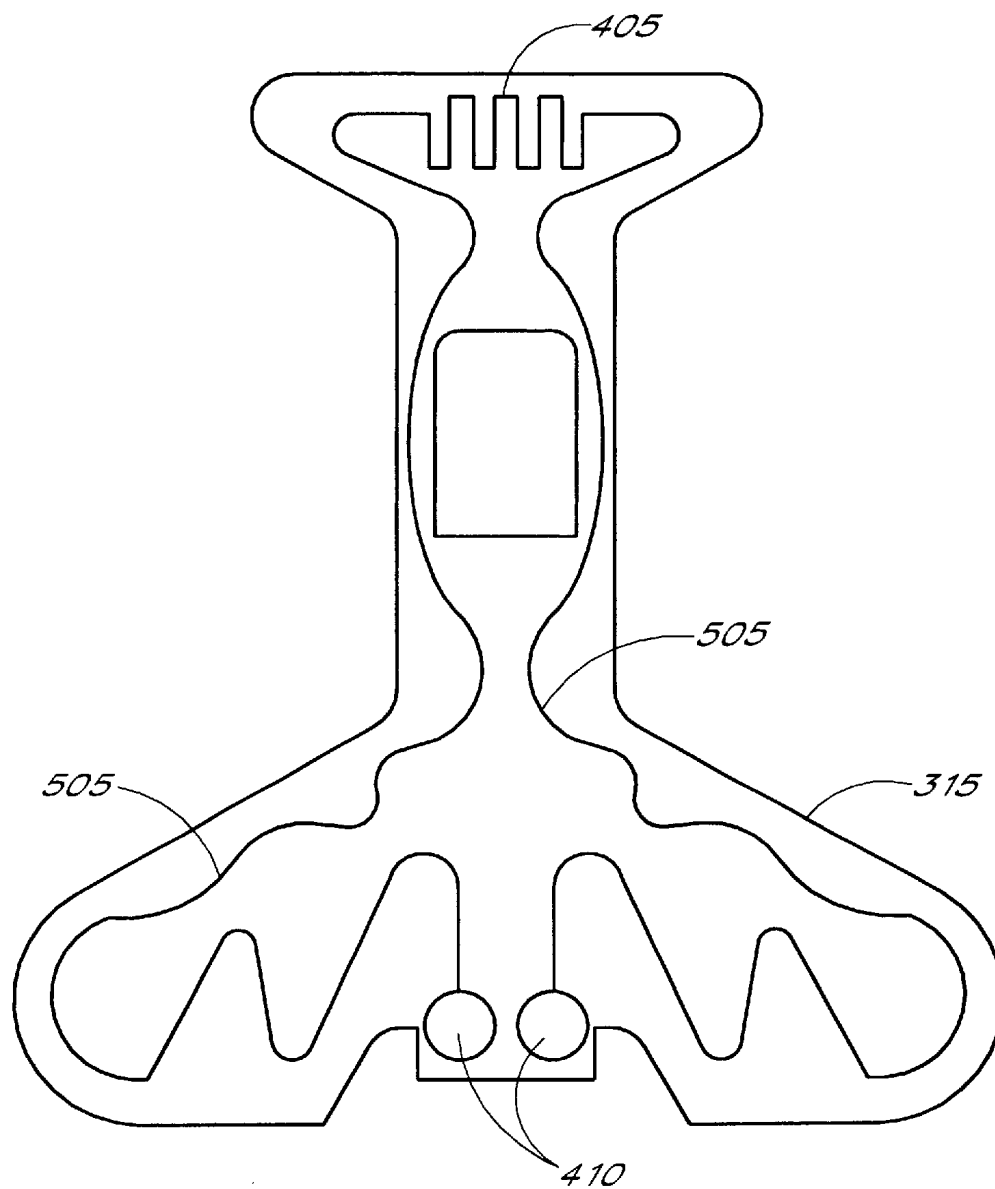


*FIG. 3*

*FIG. 4*

*FIG. 5*

*FIG. 6A**FIG. 6B*

*FIG. 7*

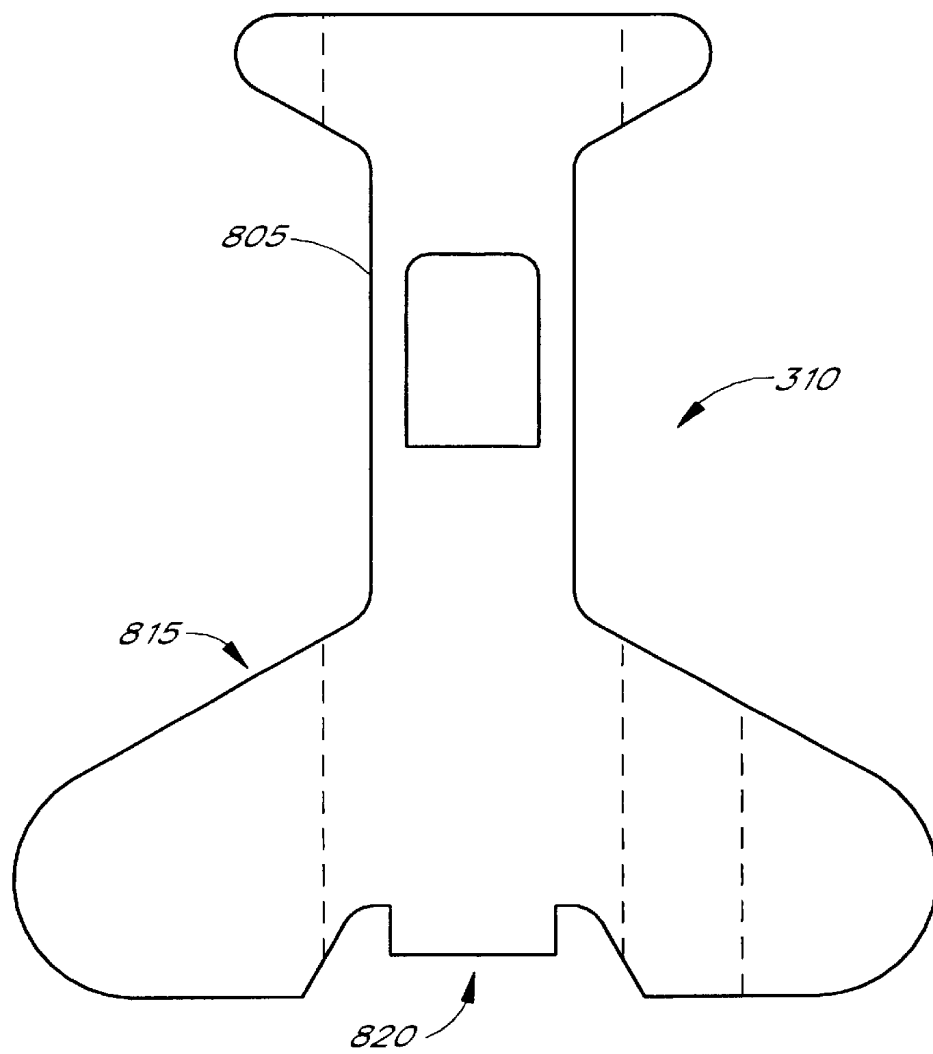


FIG. 8A

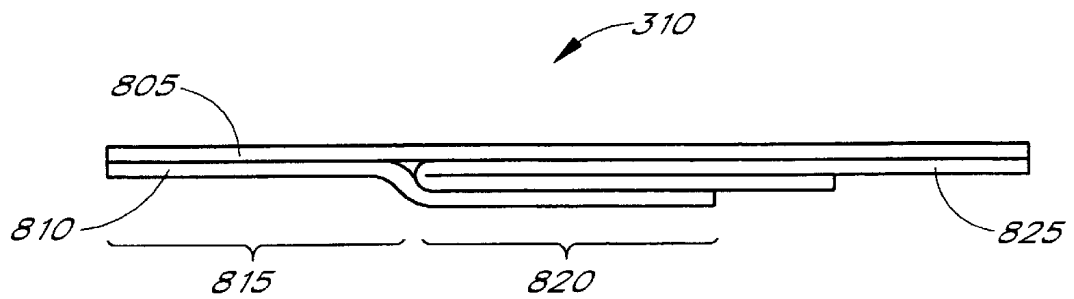
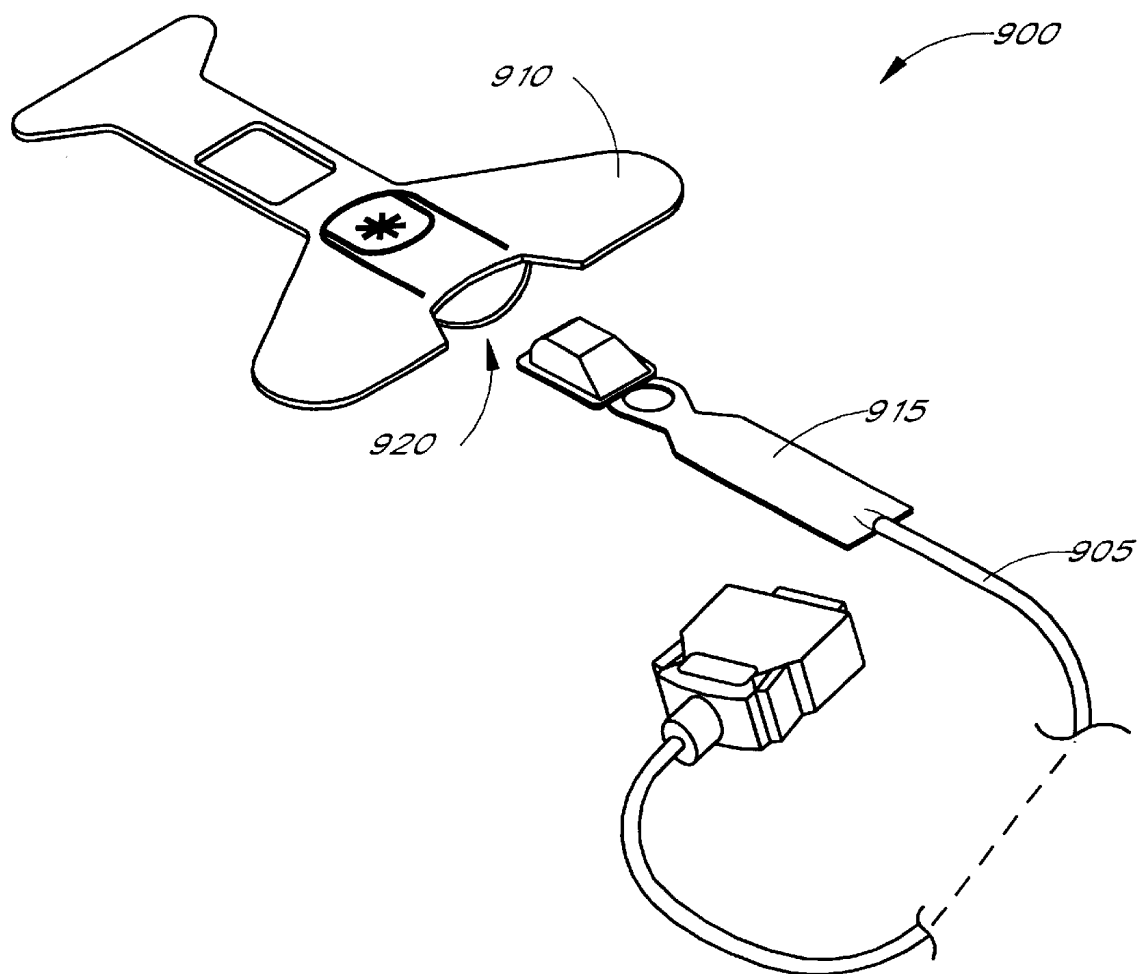


FIG. 8B

*FIG. 9A*

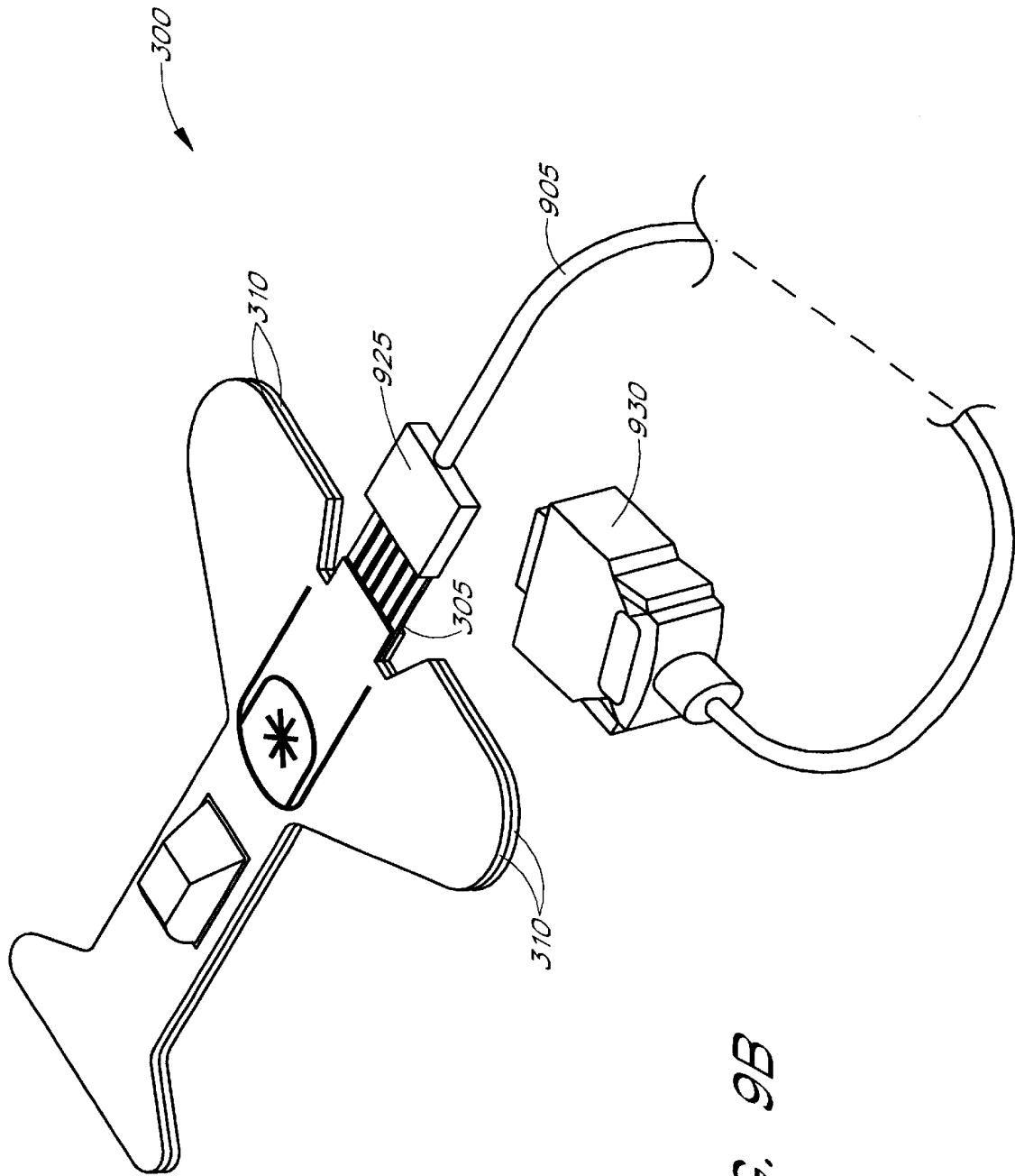


FIG. 9B

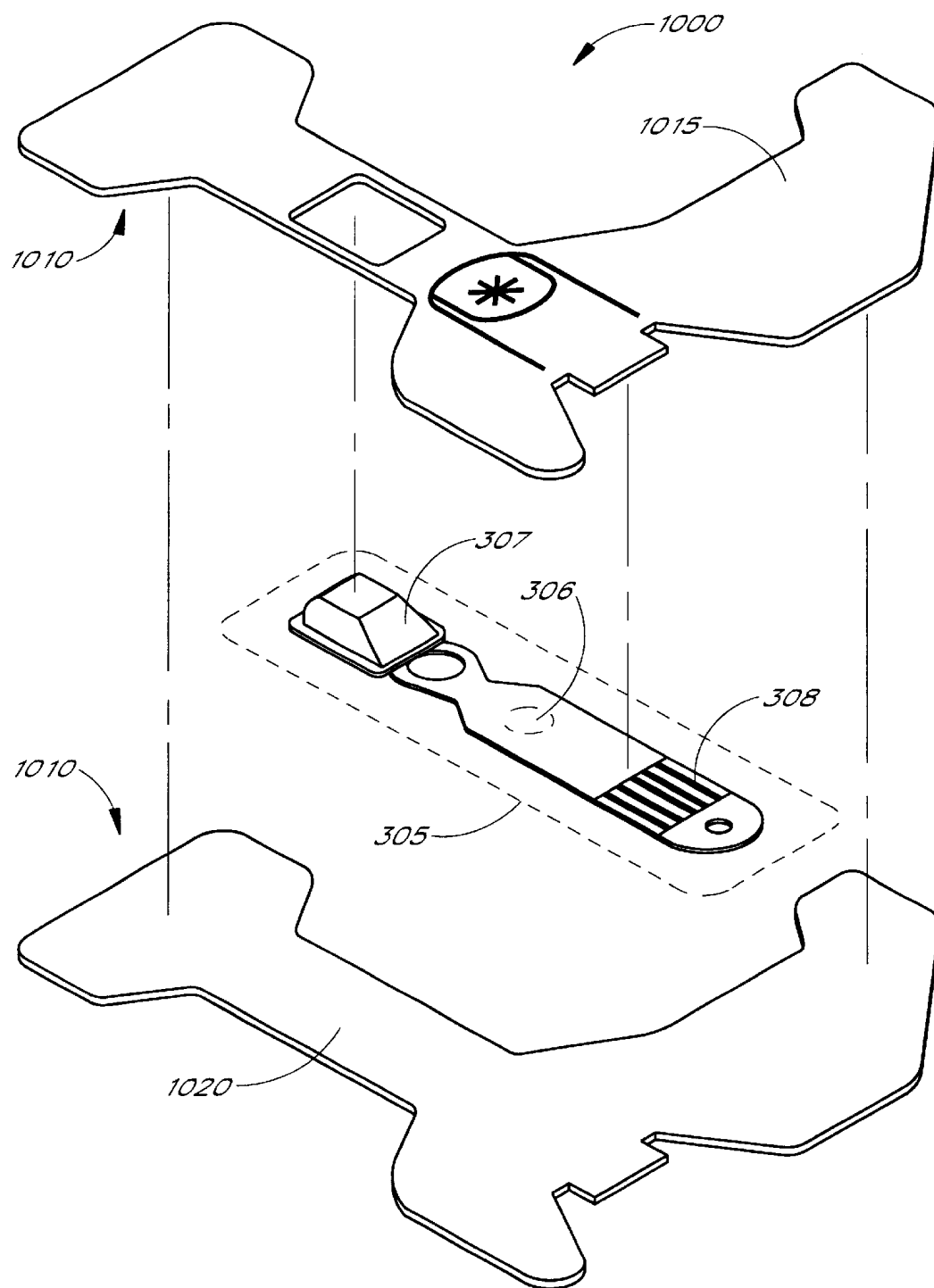
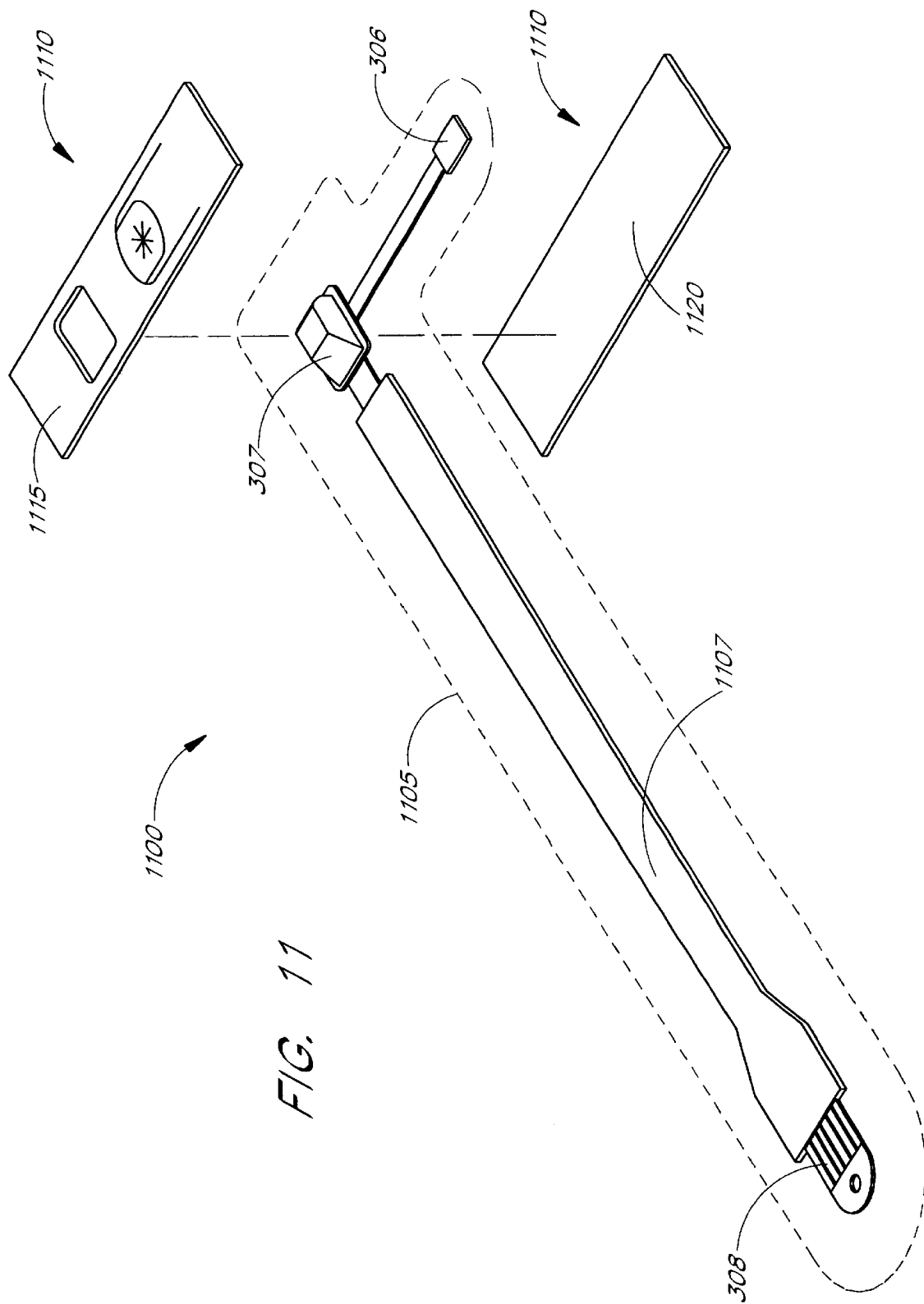


FIG. 10



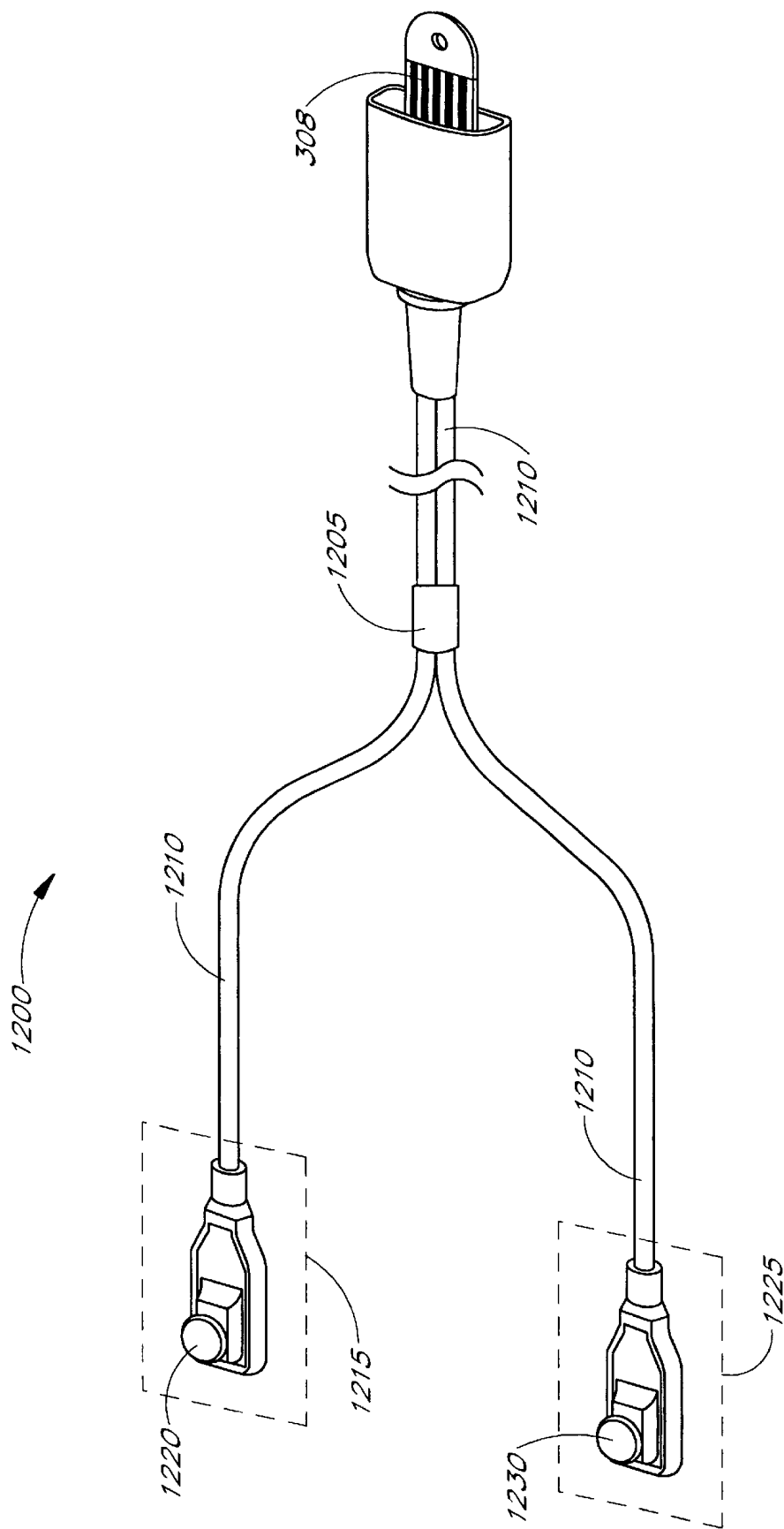


FIG. 12

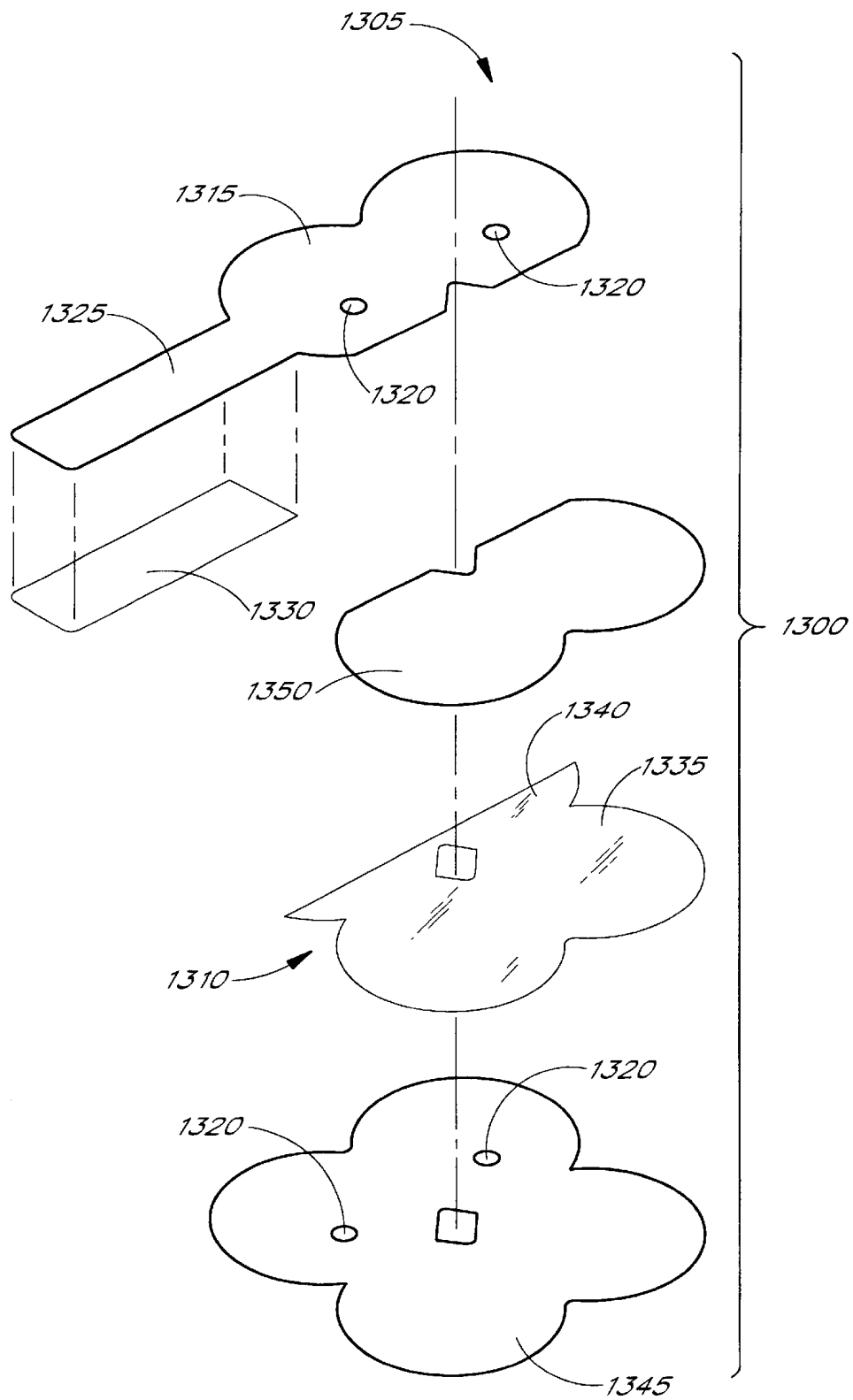
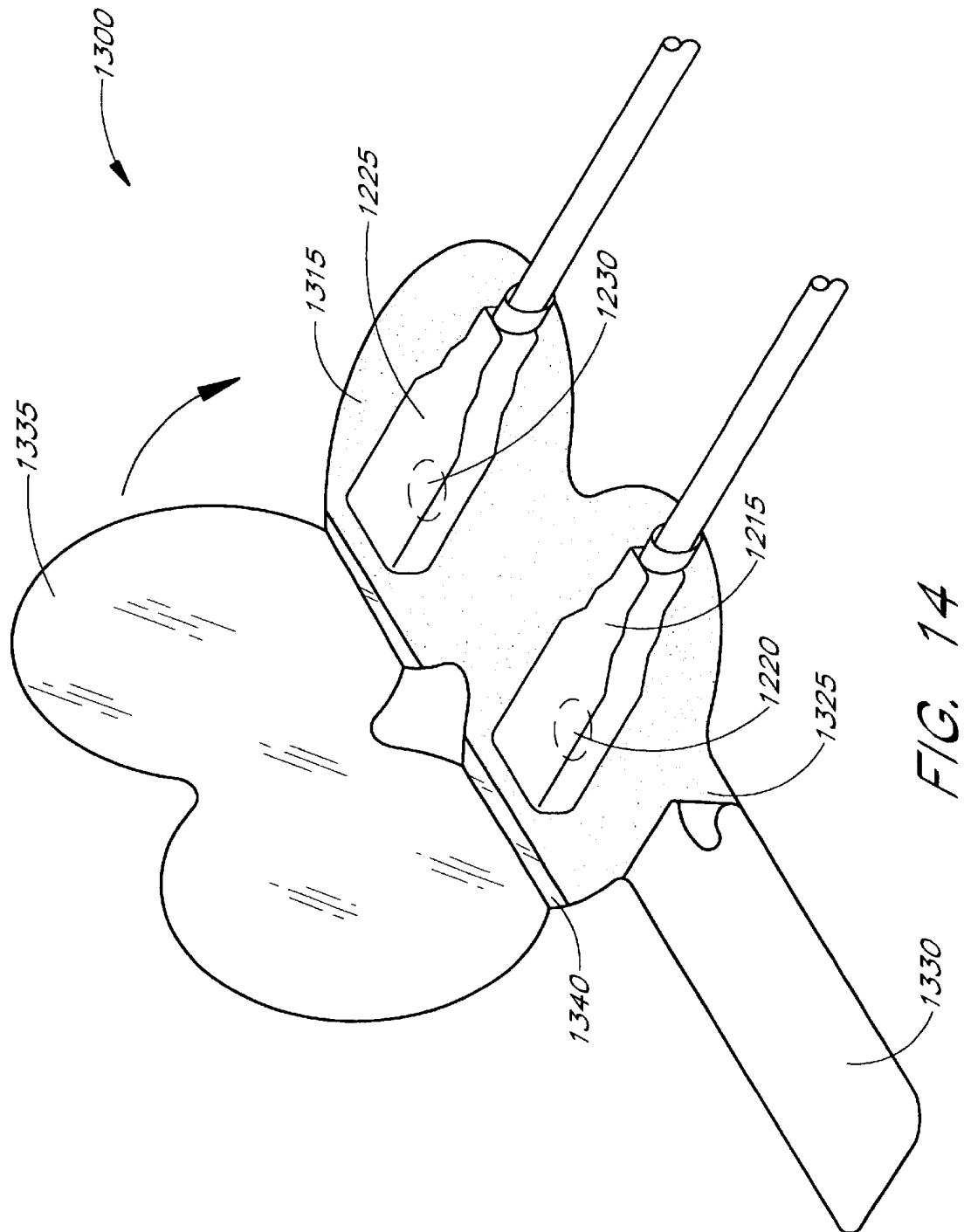


FIG. 13



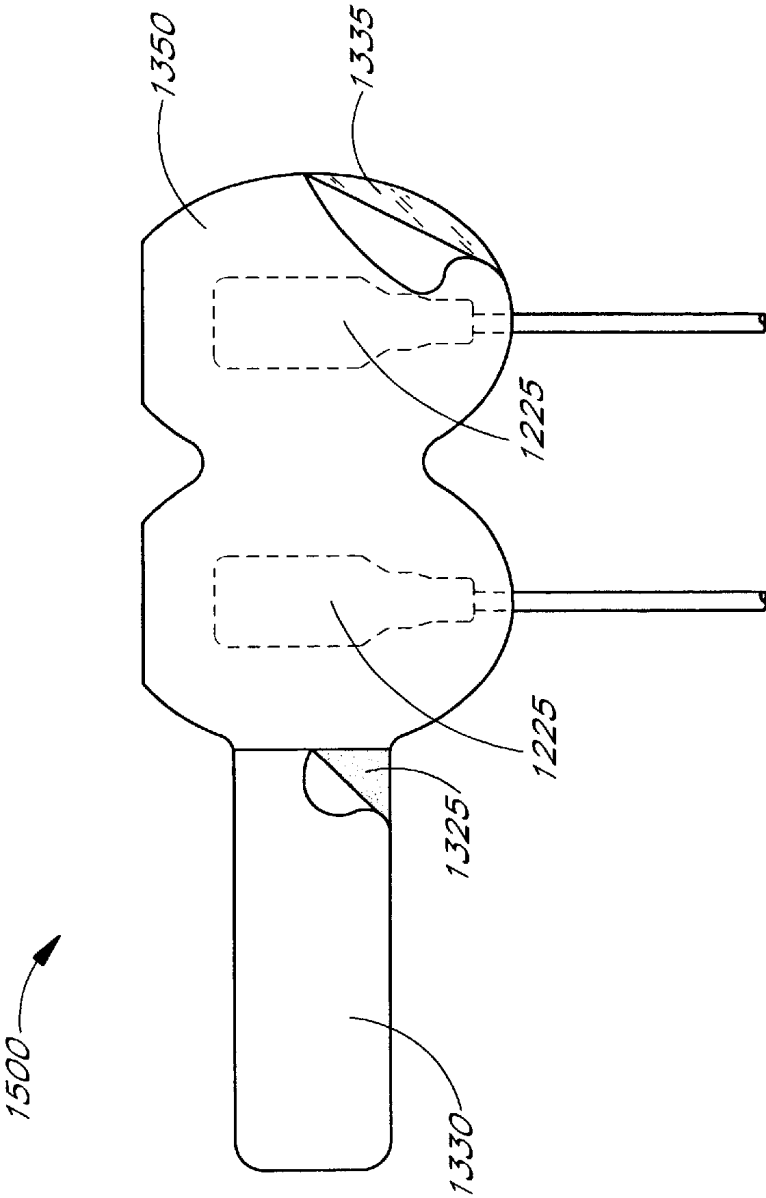


FIG. 15

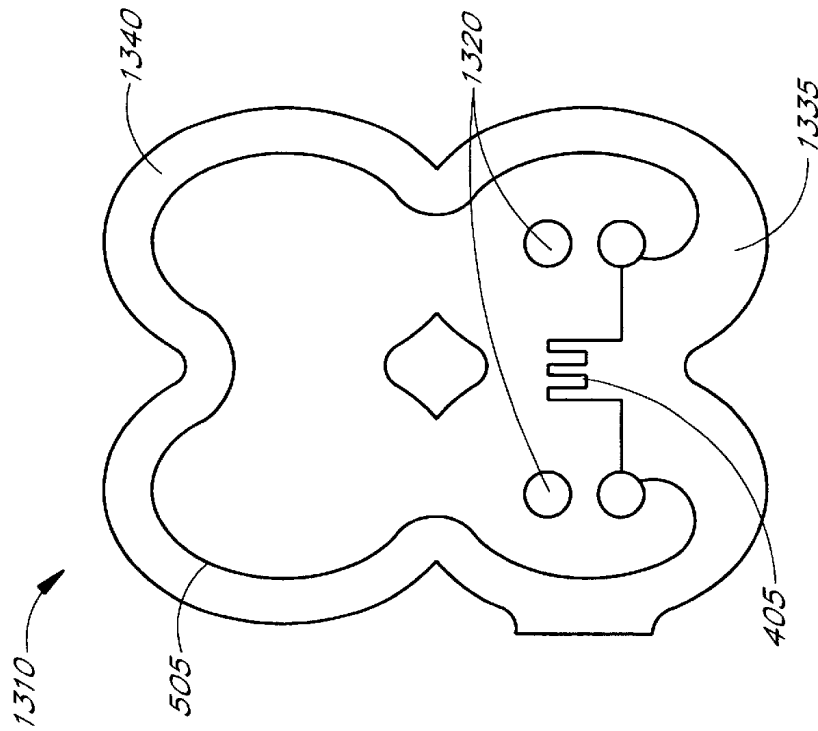


FIG. 16B

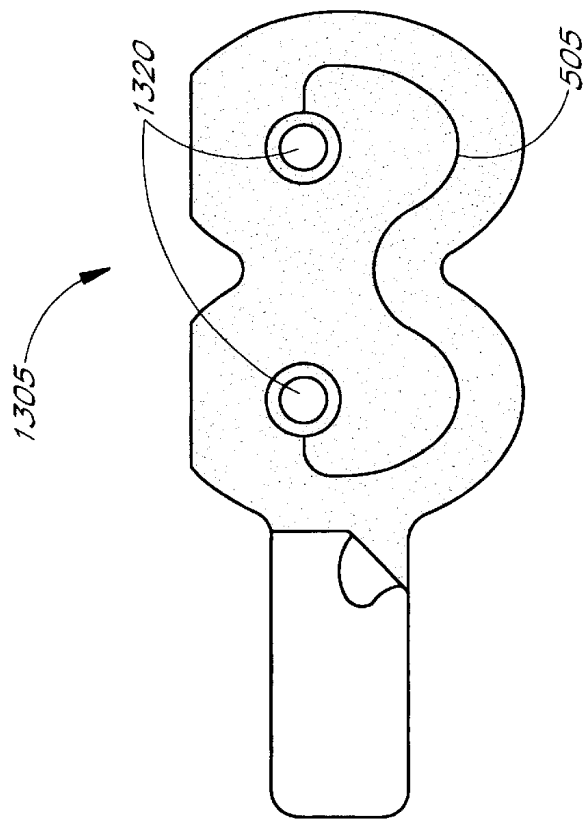
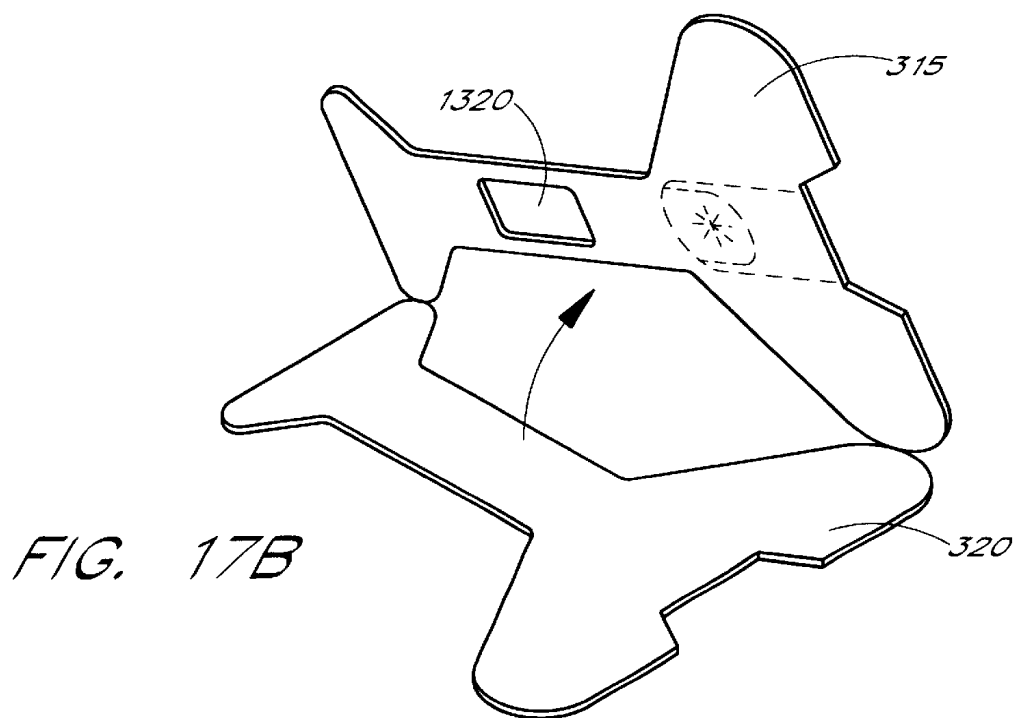
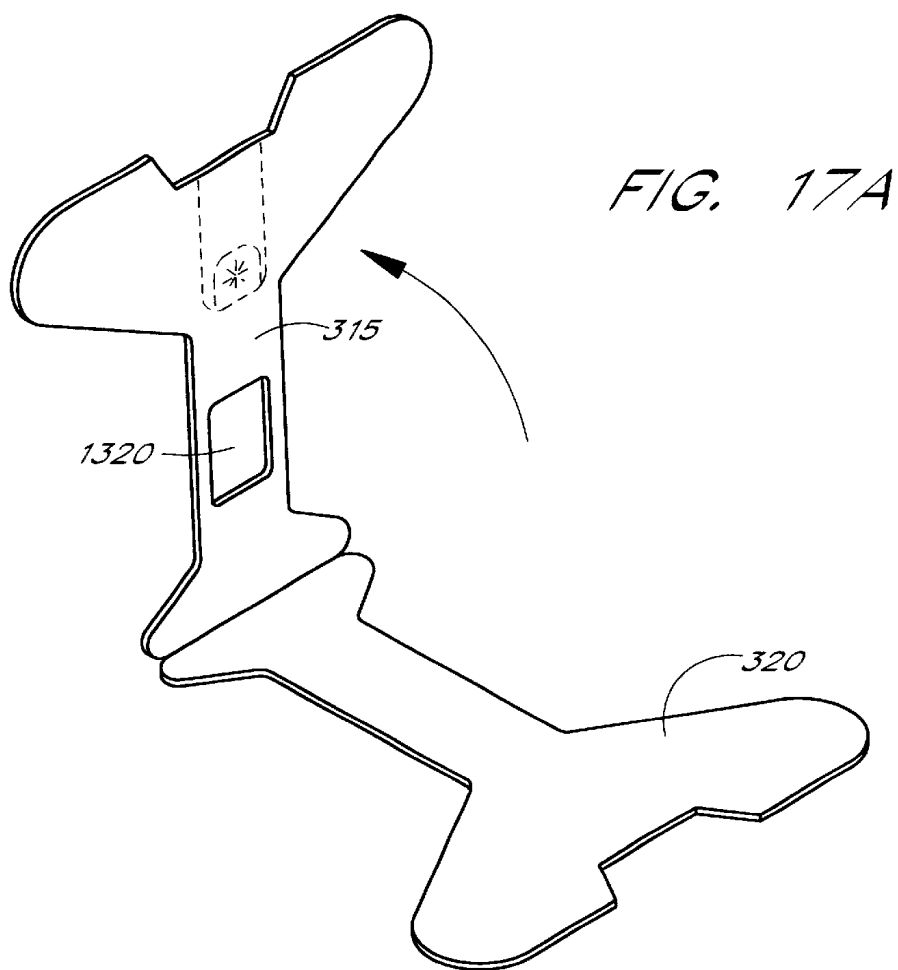
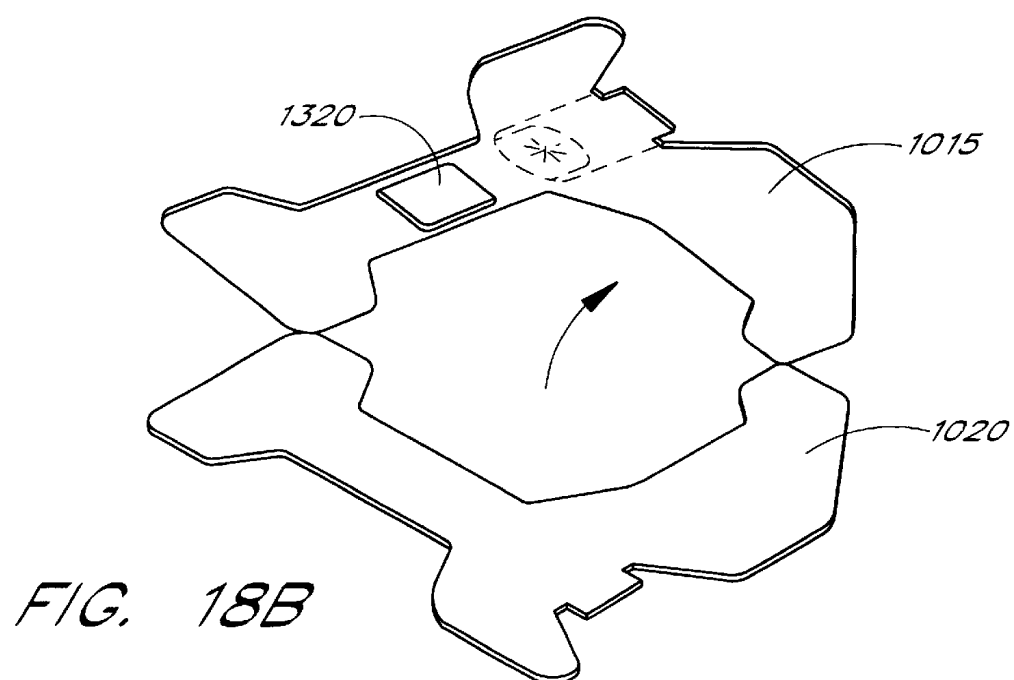
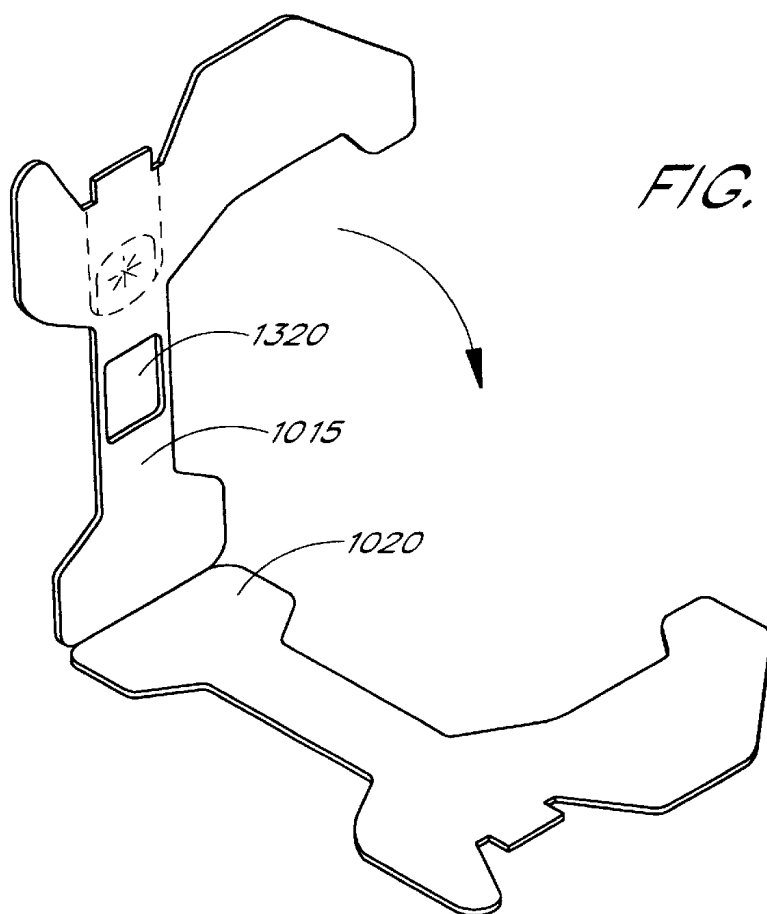


FIG. 16A





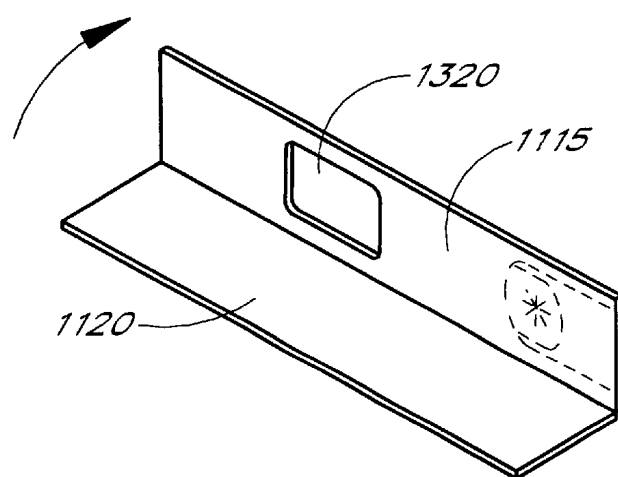
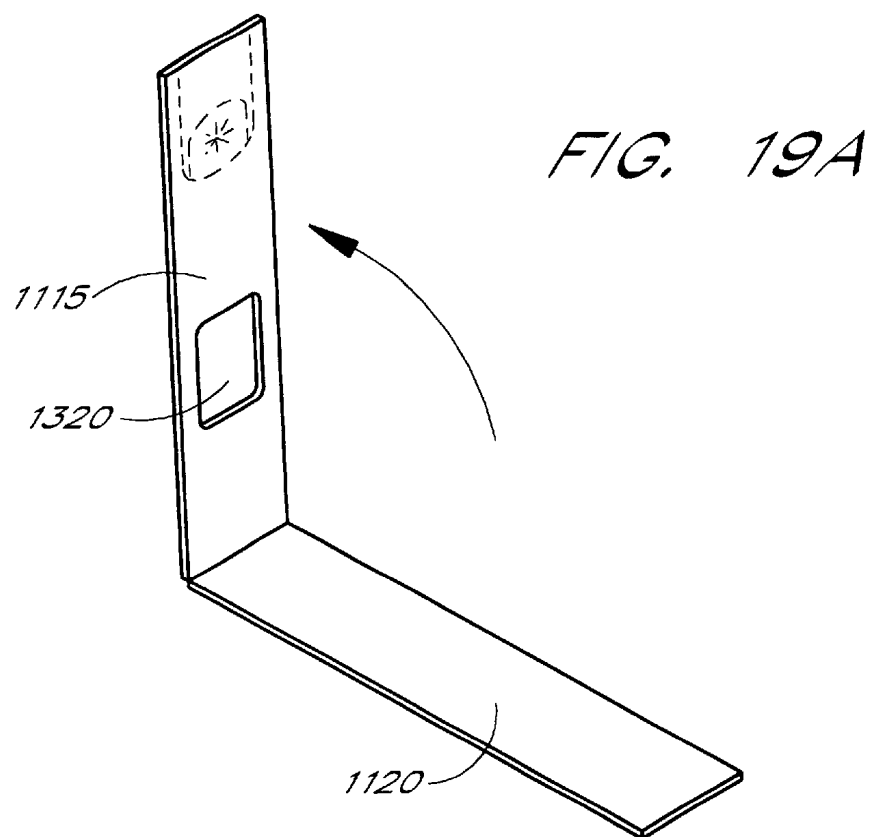
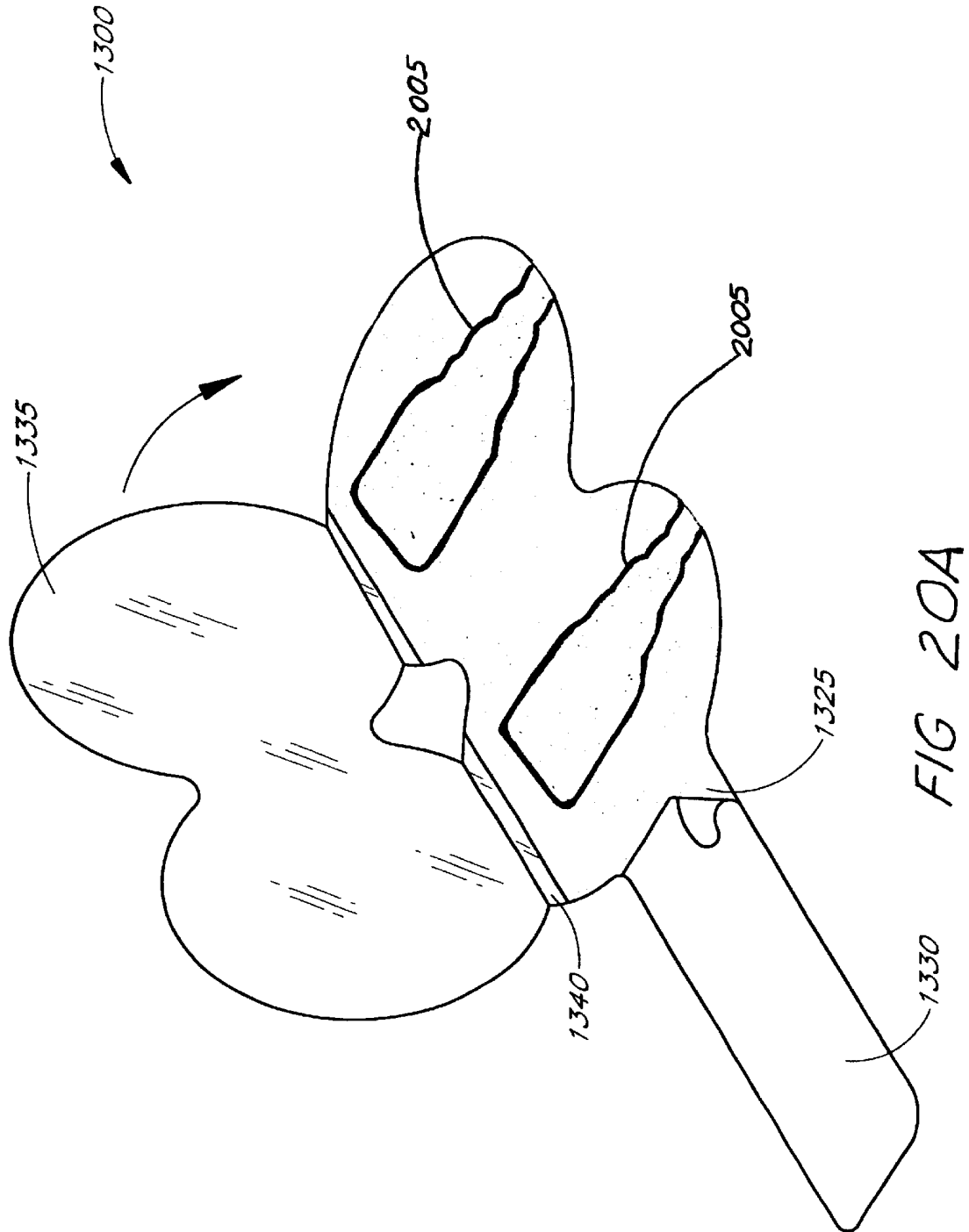
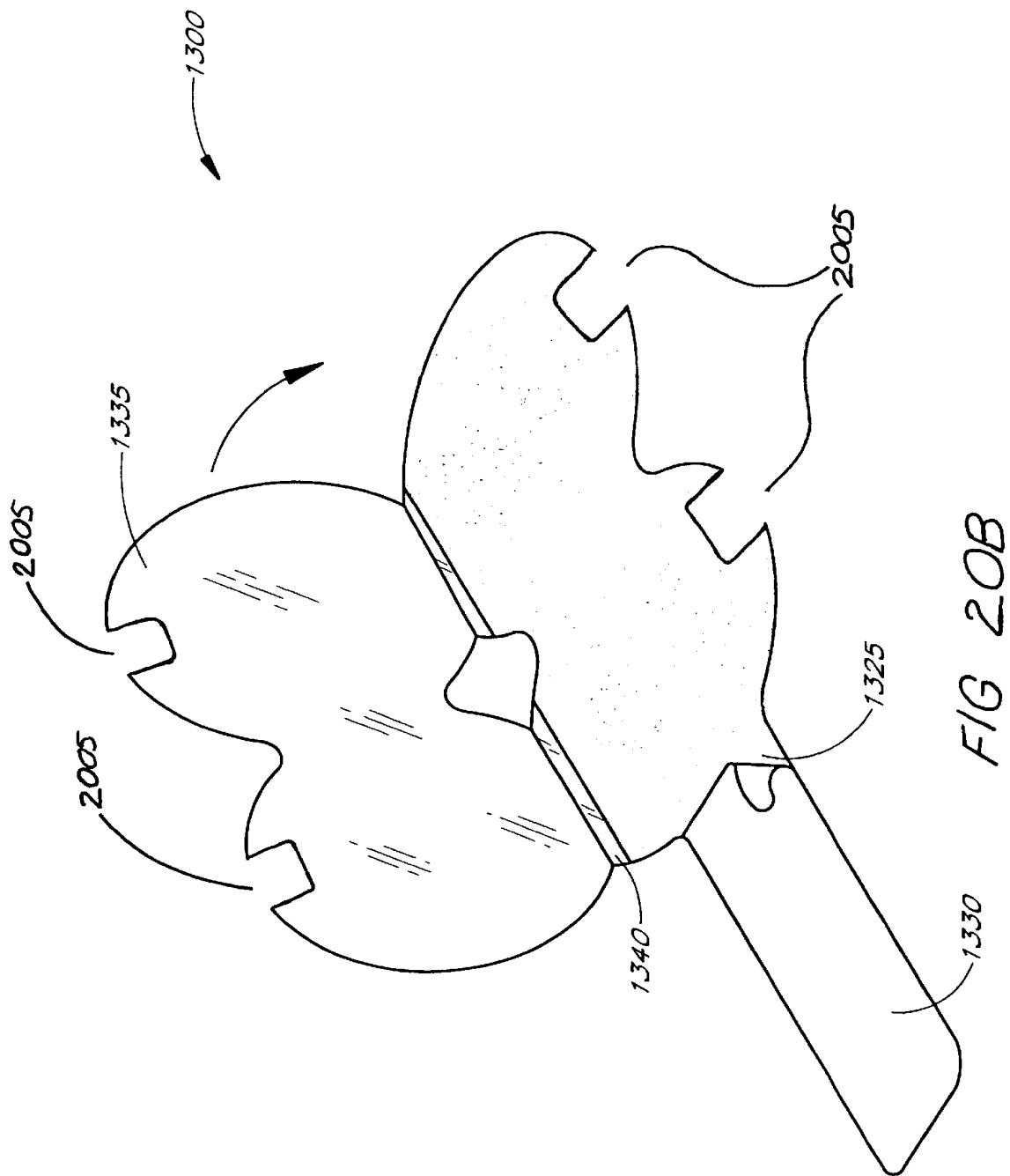


FIG. 19B





SENSOR WRAP INCLUDING FOLDABLE APPLICATOR

BACKGROUND OF THE INVENTION

REFERENCE TO RELATED APPLICATIONS

The present application is a continuation-in-part of U.S. patent application Ser. No. 09/456,666, filed Dec. 9, 1999, Now U.S. Pat. No. 6,377,829, entitled "RESPONSABLE PULSE OXIMETRY SENSOR," and claims priority benefit under 35 U.S.C. §120 to the same. Moreover, the present application claims priority benefit under 35 U.S.C. § 119(e) from U.S. Provisional Application No. 60/306,635, filed Jul. 18, 2001, entitled "SENSOR WRAP INCLUDING FOLDABLE APPLICATOR," and U.S. Provisional Application No. 60/324,873, filed Sep. 25, 2001, entitled "SENSOR WRAP INCLUDING FOLDABLE APPLICATOR." The present application incorporates the foregoing disclosures herein by reference.

1) Field of the Invention

Embodiments of the present invention relate in general to sensor wraps for securing a sensor to a measurement site, and relate in particular to sensor wraps including foldable applicators for securing elements of the sensor within the wrap.

2) Description of the Related Art

Early detection of low blood oxygen is critical in a wide variety of medical applications. For example, when a patient receives an insufficient supply of oxygen in critical care and surgical applications, brain damage and death can result in just a matter of minutes. Because of this danger, the medical industry developed oximetry, a study and measurement of the oxygen status of blood. One particular type of oximetry, pulse oximetry, is a widely accepted noninvasive procedure for measuring the oxygen saturation level of arterial blood, an indicator of the oxygen status of the blood. A pulse oximeter relies on a sensor attached to a patient in order to measure the blood oxygen saturation.

Conventionally, a pulse oximeter sensor has a red emitter, an infrared emitter, and a photodiode detector. The sensor is typically attached to a patient's finger, earlobe, or foot. For a finger, the sensor is configured so that the emitters project light through the outer tissue of the finger and into the blood vessels and capillaries contained inside. The photodiode is positioned at the opposite side of the finger to detect the emitted light as it emerges from the outer tissues of the finger. The photodiode generates a signal based on the emitted light and relays that signal to an oximeter. The oximeter determines blood oxygen saturation by computing the differential absorption by the arterial blood of the two wavelengths (red and infrared) emitted by the sensor.

Conventional sensors are either disposable or reusable. A disposable sensor is typically attached to the patient with an adhesive wrap, providing a secure contact between the patient's skin and the sensor components. A reusable sensor is typically a clip that is easily attached and removed, or reusable circuitry that employs a disposable attachment mechanism, such as an adhesive tape or bandage.

The disposable sensor has the advantage of superior performance due to conformance of the sensor to the skin and the rejection of ambient light. However, repeated removal and reattachment of the adhesive tape results in deterioration of the adhesive properties and tearing of the tape. Further, the tape eventually becomes soiled and is a potential source of cross-patient contamination. The disposable sensor must then be thrown away, wasting the long-lived emitters, photodiode and related circuitry.

On the other hand, the clip-type reusable sensor has the advantage of superior cost savings in that the reusable pulse sensor does not waste the long-lived and expensive sensor circuitry. However, as mentioned above, the clip-type reusable sensor does not conform as easily to differing patient skin shape, resulting in diminished sensitivity and increased ambient light.

Similar to the clip-type reusable sensor, the circuit-type reusable sensor advantageously does not waste the sensor circuitry. On the other hand, the circuit-type reusable sensor fails to provide quality control over the attachment mechanism. Much like the disposable sensors, the attachment mechanism for the circuit-type reusable sensor may become soiled or damaged, thereby leading to cross-patient contamination or improper attachment. Moreover, because the reusable circuit is severable from the attachment mechanism, operators are free to use attachment mechanisms that are either unsafe or improper with regard to a particular type of reusable circuitry.

Based on the foregoing, significant and costly drawbacks exist in conventional disposable and reusable oximetry sensors. Thus, a need exists for an oximetry sensor that incorporates the advantages found in the disposable and reusable sensors, without the respective disadvantages.

SUMMARY OF THE INVENTION

Accordingly, one aspect of the present invention is to provide a reusable/disposable (resposable) sensor including a disposable adhesive tape component that can be removed from other reusable sensor components. This hybrid sensor combines the longevity and associated cost advantages of the reusable sensor with the performance features of the disposable.

According to one embodiment, the disposable adhesive tape comprises a sensor wrap configured to properly position the reusable sensor components with respect to each other and a measurement site. According to one embodiment, the sensor wrap includes a foldable applicator for straightforwardly attaching the reusable sensor components to the sensor wrap.

In one embodiment of the resposable sensor, the disposable tape, or sensor wrap, includes an information element along with a mechanism for the electrical connection of the information element to the emitters. The information element provides an indication to an attached oximeter of various aspects of the sensor.

According to another embodiment, the information element provides an indication of the sensor type. According to yet another embodiment, the information element provides an indication of the operating characteristics of the sensor. In yet another embodiment, the information element provides security and quality control. For instance, the information element advantageously indicates that the sensor is from an authorized supplier.

According to yet another embodiment, the information element is advantageously located in the disposable portion and configured to be in communication with the reusable portion via a breakable conductor. The breakable conductor is also located within the disposable portion such that excessive wear of the disposable portion results in isolation of the information element, thereby indicating that the disposable portion should be replaced. Moreover, the information element may comprise one or more passive or active components, ranging from a single coding resistor to an active circuit, such as a transistor network, a memory device, or a central processing component.

3

Therefore, aspects of one embodiment of the sensor wrap include a sensor wrap for removably securing an emitter and a detector of a pulse oximetry sensor to a measurement site. The sensor wrap also comprises a center portion configured to position an emitter and a detector of a sensor and an elongated portion extending from the center portion and configured to removably secure the sensor wrap to a measurement site. Moreover, the wrap includes a foldable portion extending from the center portion and configured to fold over the emitter and the detector when the emitter and the detector are positioned within the center portion and before application of the sensor wrap to the measurement site, thereby removably securing the emitter and detector within the center portion.

Aspects of another embodiment of the sensor wrap include a sensor wrap including a foldable tape for positioning elements of a sensor within the sensor wrap before application of the sensor wrap to a measurement site, thereby properly positioning the elements of a sensor with respect to one another, and eventually with respect to the measurement site. The sensor wrap also comprises a base tape comprising a positioning portion which receives at least one element of a sensor. The wrap also comprises a foldable tape attached to the base tape, wherein the foldable tape folds over the at least one element of the sensor before application of the sensor wrap to a measurement site, thereby removably securing the at least one element within the sensor wrap, and a fastener which removably secures the sensor wrap to the measurement site.

Aspects of another embodiment include a method of manufacturing the sensor wrap. The method comprises forming a base tape including at least one positioning element configured to position sensor elements on the base tape and forming a foldable tape including adhesive on at least one side and configured to fold over the sensor elements positioned on the base tape before application of the sensor wrap to a measurement site, thereby removably securing the sensor elements within the sensor wrap. The method also comprises connecting the foldable tape to the base tape and attaching release liners to exposed adhesive.

Aspects of another embodiment of using the sensor wrap include a method of attaching a sensor having reusable and disposable portions. The method comprises removing a release liner on a center portion of a disposable positioning tape, attaching reusable elements of a sensor to the center portion by aligning positioning elements of the sensor with positioning elements within the center portion. The method also comprises folding a foldable portion over the reusable elements of the sensor before application of the disposable positioning tape to a measurement site, thereby securing the reusable elements of the sensor within the center portion. In addition, the method comprises removing release liners from other portions of the disposable positioning tape, and affixing the disposable positioning tape, with the reusable sensor elements, to a measurement site.

BRIEF DESCRIPTION OF THE DRAWINGS

The present invention is described in more detail below in connection with the attached drawings, which are meant to illustrate and not limit the invention.

FIG. 1 illustrates a circuit diagram of a conventional disposable sensor including an information element.

FIGS. 2A and 2B illustrate perspective views of the conventional disposable sensor.

FIG. 3 illustrates an exploded view of a resposable sensor including two disposable tape layers, according to one embodiment of the invention.

4

FIG. 4 illustrates a top view of one of the disposable tape layers of FIG. 3 incorporating an information element.

FIG. 5 illustrates a top view of one of the disposable tape layers of FIG. 3 incorporating a breakable conductor.

FIGS. 6A and 6B illustrate cross-sectional views of a portion of the disposable tape layer of FIG. 5.

FIG. 7 illustrates a top view of one of the disposable tape layers of FIG. 3 incorporating the information element with a breakable conductor.

FIGS. 8A and 8B illustrate a top view and a side view, respectively, of one of the disposable layers of FIG. 3 configured as a fold-over tape.

FIG. 9A illustrates a perspective view of a resposable sensor including a disposable portion configured as a tape sleeve and a reusable portion directly attached to a patient cable, according to another embodiment of the invention.

FIG. 9B illustrates a perspective view of a resposable sensor including a reusable portion removably attached to a patient cable, according to another embodiment of the invention.

FIGS. 10–11 illustrate exploded views of a resposable sensor including two disposable tape layers, according to other embodiments of the invention.

FIG. 12 illustrates a perspective view of a multisite sensor according to aspects of yet another embodiment of the invention.

FIG. 13 illustrates an exploded view of a sensor wrap, according to yet another embodiment of the invention.

FIG. 14 illustrates a perspective view of the assembly of the sensor wrap of FIG. 13 encapsulating sensor elements of the multisite sensor of FIG. 12, according to aspects of yet another embodiment of the invention.

FIG. 15 illustrates a bottom view of an assembled sensor wrap, according to aspects of yet another embodiment of the invention.

FIG. 16A illustrates a bottom view of the foam tape layer of FIG. 13 incorporating a breakable conductor, according to aspects of yet another embodiment of the invention.

FIG. 16B illustrates a bottom view of a clear tape layer incorporating a breakable conductor and an information element, according to aspects of yet another embodiment of the invention.

FIGS. 17–20 illustrate perspective views of other embodiments of a foldable sensor wrap.

DETAILED DESCRIPTION OF THE PREFERRED EMBODIMENT

The configuration of an information element for an oximeter sensor and method of reading an information element with an attached oximeter is described in U.S. Pat. No. 5,758,644, assigned to the assignee of the current application, and incorporated by reference herein. Accordingly, the configuration and the implementation of an information element will be greatly summarized as follows.

FIG. 1 illustrates a conventional oximeter sensor circuit 100. The oximeter sensor circuit 100 includes an emitter 105 comprising a first LED 107 and a second LED 110. The oximeter sensor circuit further includes an information element comprising a resistor 115. The first LED 107, the second LED 110 and the resistor 115 are connected in parallel. The parallel connection has a common input electrical connection 120 and a first common return 125. The oximeter sensor circuit 100 also includes a photodetector 130 including an input electrical connection 135 connected to one end and including a second return 140 connected to the other end.

5

As mentioned, the resistor **115** may be provided as an information element that can be read by an attached oximeter. In order to read the resistor **115**, the oximeter drives the oximeter sensor circuit **100** at a level where the emitter **105** draws effectively insignificant current. As is well understood in the art, the emitter **105** becomes active only if driven at a voltage above a threshold level. Thus, at this low level, significantly all of the current through the input electrical connection **120** flows through the resistor **115**. By reducing the drive voltage across the input electrical connection **120** and the first common return **125** to a low enough level to not activate the emitter **105**, the emitter **105** is effectively removed from the oximeter sensor circuit **100**. Thus, the oximeter can determine the value of the resistor **115**.

The value of the resistor **115** can be preselected to indicate, for example, the type of sensor (e.g., adult, pediatric, or neonatal), the operating wavelength, or other parameters about the sensor. The resistor **115** may also be utilized for security and quality control purposes. For example, the resistor **115** may be used to ensure that the oximeter sensor circuit **100** is configured properly for a given oximeter. For instance, the resistor **115** may be utilized to indicate that the oximeter sensor circuit **100** is from an authorized supplier.

Additionally, the elements of the oximeter sensor circuit **100** can advantageously be separated from one another. For example, the parallel connection between the emitter **105** and the resistor **115** can be spaced apart along the input electrical connection **120** and the first common return **125**. For example, one embodiment can include the emitter **105** electrically connected between the input electrical connection **120** and the first common return **125** near the end thereof, while the resistor **115**, still in parallel with the emitter **105**, is electrically connected between the input and return **125** at a point closer to, or even as part of, the attached oximeter.

An information element other than the resistor **115** may also be utilized. The information element need not be a passive device. Coding information may also be provided through an active circuit, such as a transistor network, memory chip, or other identification device.

Furthermore, it will be understood by a skilled artisan that a number of different circuit configurations can be implemented that allow the oximeter sensor circuit **100** to include an information element. For example, the emitter **105** and the information element may each have individual electrical connections.

As mentioned above, the resistor **115** is preselected such that at low drive voltages, it is the only circuit element sensed by the oximeter. On the other hand, the resistor **115** can also be preselected be of a sufficiently high value that when the drive voltage rises to a level sufficient to drive the emitter **105**, the resistor **115** is effectively removed from the oximeter sensor circuit **100**. Thus, the resistor **115** does not affect normal operations of the emitter **105**. In summary, an information element may form an integral part of the oximeter sensor circuit **100** by providing valuable information to the attached oximeter.

FIGS. 2A and 2B illustrate a conventional disposable sensor **200**. The disposable sensor **200** includes an adhesive substrate **205** including an elongated center portion **210** with front and rear flaps, **215** and **220**, extending outward from the elongated center portion **210**. The adhesive substrate **205** may also have an image **225** superimposed on the adhesive substrate **205** so as to indicate proper use.

The elongated center portion **210** includes the oximeter sensor circuit **100** of FIG. 1. For example, the emitter **105** is

6

housed on an underside of the elongated center portion **210** approximately beneath the superimposed image **225**. Thus, as shown in FIG. 2A, the emitter **105** may be housed approximately beneath the asterisk superimposed on the image of a fingernail. On the other hand, the photodetector **130** is housed on the topside of the elongated center portion **210** in proximity with the rear flaps **220**.

The elongated center portion **210** further includes an electrical connector **230** to drive the emitter **105** and to receive an output from the photodetector **130**. The electrical connector **230** is preferably configured to attach to a connector cable **235** via a sensor connector **240**. Also, the connector cable **235** attaches to or connects with an oximeter via an oximeter connector **245**.

FIG. 2B illustrates an example of how the disposable sensor **200** wraps the front and rear flaps **215** and **220** around a finger such that the adhesive substrate **205** provides a secure contact between the patient's skin, the emitter **105** and the photodetector **130**. FIG. 2B also illustrates an example of the sensor connector **240** (shown in broken lines) encompassing the electrical connector **230**.

As shown in FIGS. 1-2B, the conventional disposable sensor **200** integrates the components of the conventional oximeter sensor circuit **100** such that disposal of the disposable sensor **200** includes disposal of the longer lasting, expensive circuitry found therein.

FIG. 3 illustrates an exploded view of one embodiment of a resposable (reusable/disposable) sensor **300** according to the present invention. In this embodiment, the resposable sensor **300** includes a reusable portion **305** including an emitter **306**, a photodetector **307** and an electrical connector **308**. The resposable sensor also includes a disposable portion **310** including a face tape layer **315** and a clear base tape layer **320**. As shown in FIG. 3, the disposable portion **310** attaches to the reusable portion **305** by sandwiching the reusable portion **305** between a face tape layer **315** and a clear base tape layer **320**.

According to this embodiment, conventional adhesives or other attaching methodology may be used to removably attach the face tape layer **315** to the clear base tape layer **320**. Furthermore, the adhesive properties associated with the base of the conventional disposable sensor **200** may be the same as the adhesive properties on the base of the clear base tape layer **320**, as both portions are provided to attach to the patient's skin.

As mentioned, the disposable portion **310** removably attaches to the reusable portion **305** in, for example, a sandwich or layered style. After removably attaching the disposable portion **310** to the reusable portion **305**, the resposable sensor **300** functions similar to the disposable sensor **200**, i.e., the resposable sensor **300** wraps the flaps **215** around a patient's tissue such that the emitter **306** and the photodetector **307** align on opposite sides of the tissue. However, in contrast to the disposable sensor **200**, the resposable sensor **300** provides for reuse of the reusable portion **305**. For example, when the disposable portion **310** becomes contaminated, worn, or defective, rather than discarding the entire resposable sensor **300**, the disposable portion **310** is removed such that the reusable portion **305** may be re-removably attached to a new disposable portion **310**. The discarding of the disposable portion **310** completely avoids cross-contamination through the reuse of adhesive tapes between patients without wasting the more costly and longer lasting sensor circuitry of the reusable portion **305**. Note that optional sterilization procedures may be advantageously performed on the reusable portion **305**

before reattachment to either the new disposable portion **310** or to the patient, in order to further ensure patient safety.

FIG. 4 illustrates a top view of an embodiment of the face tape layer **315** of the disposable portion **310** of the responsible sensor **300**. According to this embodiment, the face tape layer **315** further includes an information element **405** as an integral part of the face tape layer **315**. In this embodiment, the information element **405** is a resistive element made by depositing a conductive ink trace including a predetermined length and width. As is known in the art, the length, width and conductivity of the conductive ink trace determines the resistance of the resistive element. The information element **405** is deposited between contacts **410** that are also implemented with conductive ink. From the disclosure herein, a skilled artisan will understand that a variety of methods can be used for mating the contacts **410** with the electrical circuitry of the reusable portion **305**. For example, the contacts **410** may advantageously physically touch the leads or the electrical connector **308** such that the reusable portion **305** is electrically configured to include the information element **405**. Such a configuration employs the oximeter sensor circuit **100** of FIG. 1, including elements thereof distributed in both the reusable portion **305** and the disposable portion **310** of the responsible sensor **300**.

In the foregoing embodiment, the disposable portion **310** comprises the information element **405** along with the face tape layer **315** and the clear base layer **320**. As mentioned, the disposable portion **310** is removably attached to the reusable portion **305** and is employed in a similar manner as the disposable sensor **200**. In contrast to the disposable sensor **200**, when the disposable portion **310** of the responsible sensor **300** becomes worn, the disposable portion **310** and the information element **405** are discarded and the reusable portion **305** is saved. By discarding the information element, the attached oximeter can perform quality control. For example, if the reusable portion **305** is reattached to a patient using either a simple adhesive or any other non-authorized disposable mechanism, the responsible sensor **300** will not include the information element **405**. As mentioned above, an attached oximeter can recognize the absence of the information element **405** and create an appropriate response indicating inappropriate use of the reusable portion **305** of the responsible sensor **300**.

FIG. 5 illustrates a top view of yet another embodiment of the face tape layer **315** of the disposable portion **310** of the responsible sensor **300**. In this embodiment, the face tape layer **315** includes a breakable conductor **505** comprising a conductive ink trace located approximately along the periphery of the face tape layer **315**. This location ensures that a tear along the periphery of the face tape layer **315** results in a tear, or electrical discontinuity, in the breakable conductor **505**. For example, FIGS. 6A and 6B illustrate the face tape layer **315** in which the breakable conductor **505** is layered between a tape stock **605** and a tape base **610**. The reusable portion **305** of the responsible sensor **300** then attaches to the tape base **610** through a pressure sensitive adhesive (PSA) **615**. The PSA **615**, the conductor **505** and the tape base **610** include a score **620** such that multiple attachment and removal of the responsible sensor **300** will result in a peripheral tear, or electrical discontinuity, in the breakable conductor **505**, as illustrated in FIG. 6B.

Thus, like the information element **405**, the breakable conductor **505** also provides security and quality control functions. In particular, repeated use of the disposable portion **310** of the responsible sensor **300** advantageously severs at least one part of the breakable conductor **505**. An attached oximeter can detect such severance and initiate an

appropriate notification to, for example, monitoring medical personnel. Providing security and quality control through a breakable conductor advantageously assists in controlling problems with patient contamination or improper attachment due to weakened adhesives.

FIG. 7 illustrates yet another embodiment of the face tape layer **315**. In this embodiment, the face tape layer **315** combines the breakable conductor **505** and the information element **405**. In this embodiment, the breakable conductor **505** is printed in a serpentine pattern to further increase the probability of a discontinuity upon the tearing of any portion of the face tape layer **315**. This combination of the information element **405** and the breakable conductor **505** advantageously adds significant safety features. For example, in this embodiment, the information element **405** is connected serially with the breakable conductor **505** and in parallel with the emitter **306** of the reusable portion **305**. Therefore, any discontinuity or tear in the breakable conductor **505** separates the information element **405** from the circuitry of the reusable portion **305**.

According to the foregoing embodiment, the attached oximeter receives an indication of both overuse and misuse of the responsible sensor **300**. For example, overuse is detected through the tearing and breaking of the breakable conductor **505**, thereby removing the information element **405** from the responsible sensor **300** circuitry. In addition, misuse through employment of disposable portions **310** from unauthorized vendors is detected through the absence of the information element **405**. Moreover, misuse from purposeful shorting of the contacts **410** is detected by effectively removing the emitter **306** from the circuit, thereby rendering the responsible sensor **300** inoperative. Therefore, the responsible sensor **300** of this embodiment advantageously provides a multitude of problem indicators to the attached oximeter. By doing so, the responsible sensor **300** advantageously prevents the likelihood of contamination, adhesive failure, and misuse. The responsible sensor **300** also advantageously maintains the likelihood of quality control.

A skilled artisan will recognize that the concepts of FIGS. 3-7 may be combined in total or in part in a wide variety of devices. For example, either or both of the breakable conductor **505** and the information element **405** may advantageously be traced into the clear base tape layer **320** rather than into the face tape layer **315**.

FIGS. 8A and 8B illustrate yet another embodiment of the disposable portion **310** of the responsible sensor **300** according to the present invention. As shown in this embodiment, the disposable portion **310** includes a face tape layer **805** and a clear base tape layer **810**. According to this embodiment, the clear base tape layer **810** includes a preattached section **815** and a fold over section **820**. The preattached section **815** attaches approximately one third of the face tape layer **805** to the clear base tape layer **810**. On the other hand, the fold over section **820** forms a flap configured to create a cavity between the face tape layer **805** and the clear base tape layer **810**. The cavity is configured to receive the reusable portion **305** of the responsible sensor **300**. According to one embodiment, a release liner **825** fills the cavity and separates the face tape layer **805** from the clear base tape layer **810**. When the release liner **825** is removed, newly exposed adhesive on the fold over section **820** and the face tape layer **805** removably attaches the reusable portion **305** between the face tape layer **805** and fold over section **820** of the clear base tape layer **810**.

According to another embodiment, the cavity is so formed that adhesive is not needed. For example, the fold over

section **820** may comprise resilient material that can form a friction fit relationship so as to fix the reusable portion **305** in an appropriate position relative to the disposable portion **310**. On the other hand, the fold over section **820** may also comprise material including other than resilient or adhesive properties, but still allow for proper placement of the reusable portion **305** and disposable portion **310** on the patient. For example, hook-and-loop type materials like VELCRO® may be used.

It will be understood that a skilled artisan would recognize that the fold over embodiment of the responsible sensor **300** may employ the properties discussed in relation to FIGS. 3–7, such as the information element **405** and the breakable conductor **505**.

FIG. 9A illustrates an embodiment of a responsible sensor **900** integrated with an attached patient cable **905**, according to another embodiment of the invention. In this embodiment, a disposable portion **910** is attached to a reusable portion **915** by removably inserting the reusable portion **915** into a tape envelope **920** formed in the disposable portion **910**.

A skilled artisan will recognize that the disposable portion **910** may include the information element **405**, the breakable conductor **505**, or both. Inclusion of one or both of these electronic components in the responsible sensor **900** advantageously provides the security, quality control, and safety features described in the foregoing embodiments.

FIG. 9B illustrates an embodiment of a responsible sensor **300** of FIG. 3, according to another embodiment of the invention. According to this embodiment, the responsible sensor **300** removably attaches to the patient cable **905** via a sensor connector **925**. The patient cable **905** then attaches to an oximeter via an oximeter connector **930**. Use of the sensor connector **925** enables the replacement of the reusable portion **305** of the responsible sensor **300** without replacement of the sensor connector **925** or the patient cable **905**. In such an embodiment, the disposable portion **310** would follow a different, more frequent, replacement schedule than that of the reusable portion **305**.

FIG. 10 illustrates an exploded view of yet another embodiment of a responsible sensor **1000** including two disposable tape layers **1010**. Similar to the responsible sensor **300** described with reference to FIG. 3, the responsible sensor **1000** includes various reusable components **305**, including the emitter **306**, the photodetector **307** and the electrical connector **308**. Although the reusable components of the responsible sensor **1000** are illustrated in a similar fashion to that of the flex circuit described with reference to FIG. 3, a skilled artisan will recognize from the disclosure herein a wide number of reusable circuit configurations, including the emitter **306** and detector **307** connected to the electrical connector **308** by one or more flexible wires or the like.

The responsible sensor **1000** also includes the disposable portion **1010** including a face tape layer **1015** and a base tape layer **1020**. As shown in FIG. 10, the disposable portion **1010** attaches to the reusable components **305** by sandwiching the reusable components **305** between the disposable tape layers **1015** and **1020**. Similar to the tape layers disclosed with reference to FIG. 3, the disposable portion **1010** removably attaches to the reusable components **305** such that when the disposable portion **1010** becomes contaminated, worn, or defective, it can be discarded without wasting the reusable components.

As shown in FIG. 10, one embodiment of the disposable portion **1010** comprises a boot-like shape where the toe of the boot is configured to wrap around the measurement site,

thereby substantially securing the sensor **1000** to the patient. However, a skilled artisan will recognize a wide number of shapes that advantageously secure the reusable components to differing types of measurement sites.

FIG. 11 illustrates an exploded view of yet another embodiment of a responsible sensor **1100** including reusable components **1105** and two disposable tape layers **1110**. Similar to responsible sensor **1000** disclosed with reference to FIG. 10, the responsible sensor **1100** includes various reusable components **1105**, including the emitter **306**, the photodetector **307** and the electrical connector **308**. Moreover, as shown in FIG. 11, the reusable components **1105** also include an elongated enclosed center portion **1107**. According to one embodiment, the center portion **1107** encloses an electrical pathway, such as, for example, one or more wires, a flex circuit having one or more conductive paths, one or more conductive traces, or the like, in a preferably flexible housing, such as, for example, a reusable tape layer, plastic housing, cable, or the like. The center portion **1107** connects the emitter **306** and the photodetector **307** to the electrical connector **308**. By employing the center portion **1107**, the responsible sensor **1100** advantageously provides for removal of connection devices from the immediate area of the measurement site, thereby providing additional convenience in the placement of potentially multiple wires from multiple patient monitoring devices, including the oximeter.

The responsible sensor **1100** also includes a disposable portion **1110** including a face tape layer **1115** and a base tape layer **1120**. As shown in FIG. 11, the disposable portion **1110** attaches to the reusable components **1105** by sandwiching at least some of the reusable components **1105** between the tape layers **1115** and **1120**. Similar to the tape layers disclosed with reference to FIG. 3, the disposable portion **1110** removably attaches to at least some of the reusable components **1105** such that when the disposable portion **1110** becomes contaminated, worn, or defective, it can be discarded without wasting the reusable components.

As shown in FIG. 11, one embodiment of the disposable portion **1110** comprises a generally rectangular shape. According to one embodiment, the rectangular portion may have a length substantially shorter than that of the center portion **1107**. According to one embodiment, the rectangular portion may have a length approximately one-third that of the center portion **1107**. However, a skilled artisan will recognize from the disclosure herein, a wide number of shapes that advantageously secure portions of the reusable components **1105** to a measurement site. Moreover, a skilled artisan will recognize from the disclosure herein that the disposable portions of FIGS. 9A–11 may advantageously include the information element **405**, the breakable conductor **505**, or both. In addition, the information element **405** or the breakable conductor **505** may advantageously be incorporated in one or both of the disclosed tape layers for each sensor.

Although the foregoing invention has been described in terms of certain preferred embodiments, other embodiments will be apparent to those of ordinary skill in the art. For example, select aspects of FIGS. 3–11 may be combined. For example, the envelope configured disposable portion **910** of FIG. 9A may be combined with the reusable portion **305** of FIG. 3. Also, the reusable components of the various disclosed embodiments may advantageously directly connect to a patient cable **905** as illustrated in FIG. 9A, use the sensor connector **925** of FIG. 9B, or the like.

FIG. 12 illustrates a perspective view of a multisite sensor **1200** according to aspects of yet another embodiment of the

11

invention. As shown in FIG. 12, the multisite sensor 1200 includes the electrical connector 308, a neck 1205, elongated flexible wire 1210, sensor elements or portions 1215 and 1225, each including one positioning member 1220 and 1230, respectively. According to one embodiment, the electrical connector 308 of the multisite sensor 1200 is adapted to connect to the sensor connector 925 to establish electrical communication to and from the sensor elements 1215 and 1225, through the elongated flexible wire 1210, and from and to a measurement device (not shown). For example, according to one embodiment where the multisite sensor 1200 comprises a pulse oximetry sensor, the sensor element 1215 may comprise circuitry similar to the emitter 306 and the sensor element 1225 may comprise circuitry similar to the photodetector 307. In such an exemplary case, the electrical connector 308 provides electrical communication from the emitter 306 and the photodetector 307, to, for example, an oximeter.

According to the embodiment shown in FIG. 12, the multisite sensor 1200 comprises the neck 1205 and the elongated flexible wire 1210, thereby advantageously providing for convenient positioning of each of the sensor elements 1215 and 1225.

The embodiment shown in FIG. 12 also illustrates the positioning members 1220 and 1230. According to one embodiment, the positioning members 1220 and 1230 are adapted to releasably attach to a sensor wrap configured to properly, straightforwardly and accurately position the respective sensor element to a measurement site. According to one embodiment, the positioning members 1220 and 1230 advantageously comprise button-style detents, or projections having flanges, rims, or the like. The positioning members 1220 and 1230 position and hold one mechanical part in relation to another so that the sensor elements 1215 and 1225 can be releasably attached to the sensor wrap, as disclosed further with reference to FIGS. 14–15.

Although embodiments of the multisite sensor 1200 are disclosed herein with reference to a pulse oximetry sensor including the sensor elements 1215 and 1225, a skilled artisan will recognize from the disclosure herein that the multisite sensor 1200 may advantageously comprise one or more sensor elements of a number of different sensor types. Moreover, the skilled artisan will recognize from the disclosure herein that each of the one or more sensor elements may advantageously include one or more positioning members.

FIG. 13 illustrates an exploded view of a sensor wrap 1300 according to aspects of yet another embodiment of the invention. As shown in FIG. 13, the sensor wrap 1300 includes an outer layer 1305 and an inner layer 1310. According to one embodiment, the outer layer 1305 may advantageously comprise a foam tape such as that commercially used in a wide variety of medical securing mechanisms, including popular adhesive bandages. A skilled artisan will recognize from the disclosure herein that the outer layer 1305 may comprise other materials having sufficient durability and moldability suitable for forming the ambient-facing portion of the sensor wrap 1300.

FIG. 13 also shows the outer layer 1305 comprises a positioning portion 1315, one or more positioning apertures 1320 and a securing wrap 1325. According to one embodiment, the positioning portion 1315 comprises two substantially oval portions connected to form a generally-figure-eight-like shape having one side at least partially flattened. According to one embodiment, the securing wrap 1325 extends from a side of the positioning portion 1315 and

12

comprises an elongated arm adapted to advantageously wrap around a wide variety of measurement sites, thereby advantageously and properly securing various sensor elements thereto. One embodiment of the securing wrap 1325 uses adhesive coated on one side to secure the sensor wrap 1300 to the measurement site. Accordingly, the securing wrap 1325 may advantageously include a release liner 1330 which covers the adhesive until the sensor wrap 1300 is ready to be applied to a measurement site. A skilled artisan will recognize from the disclosure herein that the release liner 1330 may comprise a wide variety of commercial forms from a wide variety of vendors.

The embodiment shown in FIG. 13 also includes two positioning apertures 1320 each placed approximately in the middle of one of the foregoing substantially oval portions of the positioning portion 1315. According to one embodiment, the positioning apertures 1320 are sized to releasably connect to the positioning members 1220 and 1230 of the multisite sensor 1200 disclosed with reference to FIG. 12. Moreover, in an embodiment where the positioning portion 1315 includes an adhesive side, the positioning members 1220 and 1230 snap into the positioning apertures 1320 of the sensor wrap 1300 and the adhesive of the positioning portion 1315 helps to secure the position and orientation of the sensor elements 1215 and 1225 within the sensor wrap 1300.

FIG. 13 also illustrates the inner layer 1310 of the sensor wrap 1300. According to one embodiment, the inner layer 1310 comprises a foldable side 1335 and an attached side 1340. As shown in FIG. 13, the foldable side 1335 comprises two substantially oval portions connected to form a generally-figure-eight-like shape substantially mirroring the shape of the positioning portion 1315 of the outer layer 1305. According to one embodiment, the foldable side 1335 is advantageously shaped to fold over and substantially match the positioning portion 1315 of the outer layer 1305, as disclosed further with reference to FIGS. 14–15.

According to another embodiment, the attached side 1340 comprises an extension of one edge of the foldable side 1335 appropriately shaped to attach to the positioning portion 1315 of the outer layer 1305. For example, the attached side 1340 may advantageously comprise an extension just sufficient enough to secure the foldable side 1335 to the outer layer 1305. There are at least several advantages in employment of a smaller extension as the foldable side 1335. For example, the extension uses less tape, and is therefore less expensive to manufacture on a per sensor wrap basis. Moreover, according to embodiments including adhesives applied to one or more sides of the foldable side 1335, removal of the sensor elements 1215 and 1225 for reuse is easier when the outer layer 1310 is not affixed to itself in and around the sensor elements 1215 and 1225.

On the other hand, another embodiment of the attached side 1340 may comprise an extension shaped substantially the same as the outer layer 1305, thereby fully attaching as a top layer of the same. According to this embodiment, the inner layer 1305 may advantageously include the positioning apertures 1320.

Although requiring more tape on a per sensor wrap basis, there are at least several advantages in employment of the larger extension as the foldable side 1335. For example, the smaller extensions sometimes use more complex alignment equipment during the assembly of the sensor wrap 1300, while the larger extensions can often take advantage of less expensive and more straightforward alignment equipment. Moreover, the larger extension can more securely affix the sensor elements 1215 and 1225 within the sensor wrap 1300.

13

A skilled artisan will recognize from the disclosure herein that the attached side **1340** of the inner layer **1310** may advantageously vary from a very small, even tabbed shape, to matching the shape of the outer layer **1305**. The determination of the size of the attached side **1340** can be made to balance or exploit one or more of the advantageous aspects disclosed above, such as, for example, the cost per sensor wrap or complexity of the alignment equipment.

According to one embodiment, at least the foldable side **1335** of the inner layer **1310** may comprise a substantially transparent applicator tape having adhesive on one or both sides. The substantially transparent applicator tape including adhesive is advantageous for a number of reasons. For example, when the foldable side **1335** of the inner layer **1310** is folded over the sensor elements **1215** and **1225**, the foldable side **1335** may advantageously removably adhere to the same. Moreover, as discussed in the foregoing, the inner layer **1310** folds over the sensor elements **1215** and **1225** on the measurement site-facing side of the sensor wrap **1300**. Thus, according to one embodiment, the transparent tape will not harmfully interfere with the emission and detection of light by the sensor elements **1215** and **1225**. In addition, adhesive on both sides of the foldable side **1335** of the inner layer **1310** may advantageously adhere directly to the measurement site.

FIG. **13** also shows the inner layer **1310** having release liners **1345** and **1350** to cover each side of the inner layer **1310**. According to one embodiment, the release liner **1345** covers the inner layer **1310** and the adhesive side of the positioning portion **1315** of the outer layer **1305** until encapsulating of the sensor elements **1215** and **1225**. According to another embodiment, the release liner **1350** covers the other side of the inner layer **1310** until application of the sensor wrap **1300** to a measurement site.

According to one embodiment, the sensor wrap **1300** may advantageously be manufactured as two elements, such as, for example, the outer layer **1305** and the inner layer **1310**. In such embodiments, each element may include additional release liners covering exposed adhesives of the same. For example, the attached side **1340** may advantageously include a release liner approximately adjacent to release liner **1350**, while the positioning portion **1315** may include a release liner approximately adjacent to release liner **1330**. The foregoing release liners can then be removed during assembly, thereby allowing the inner layer **1310** to sufficiently attach to the outer layer **1305**. On the other hand, a skilled artisan will recognize from the disclosure herein that the sensor wrap **1300** can be manufactured as a single element, thereby likely voiding the need for the additional release liners.

FIG. **14** illustrates a perspective view of the assembly of the sensor wrap **1300** of FIG. **13** encapsulating the sensor elements **1215** and **1225** of the multisite sensor **1200** of FIG. **12**, according to aspects of yet another embodiment of the invention. According to the embodiment shown in FIG. **14**, to assemble the sensor wrap **1300**, the release liner **1345** is removed from the foldable side **1335** of the inner layer **1310** and the adhesive side of the positioning portion **1315** of the outer layer **1305**. FIG. **14** illustrates the adhesive with dots. Once the adhesive is exposed, the sensor elements **1215** and **1225** are positioned on the positioning portion **1315** using the positioning apertures **1320** and positioning members **1220** and **1230** shown in phantom. According to this embodiment, the positioning portion **1315** adheres to the sensor elements **1215** and **1225** to substantially fix their position and orientation within the sensor wrap **1300**. As shown in FIG. **14**, the transparent foldable side **1335** is then

14

folded over the sensor elements **1215** and **1225**, thereby securing their positions within the sensor wrap **1300**. For example, the folded side **1335** releasably secures the vertical and horizontal spatial relationship between the sensor elements **1215** and **1225** within the sensor wrap **1300** before application thereof to a measurement site.

A skilled artisan will recognize from the disclosure herein that the positioning members **1220** and **1230** may advantageously be adapted to sufficiently fix the position and orientation of the sensor elements **1215** and **1225**, in place of or in addition to the adhesive disclosed in the foregoing. In addition, the skilled artisan will recognize from the disclosure herein other sensor types or other sensor wrap shapes, where the foldable aspects of the foregoing embodiments may be used to create a secure assembled sensor wrap.

FIG. **15** illustrates a bottom view of an assembled sensor wrap **1500**, according to aspects of an embodiment of the invention. As shown in FIG. **15**, the foldable side **1335** of the inner layer **1310** covers the sensor elements **1215** and **1225**, shown in phantom. In addition, FIG. **15** illustrates the assembled sensor wrap **1500** including the release liner **1330** and the release liner **1350** still covering the adhesives of the sensor wrap **1300**. Thus, the assembled sensor wrap **1500** advantageously provides for the proper positioning of reusable circuitry within a disposable wrap without exposing the measurement site attaching adhesives to the environment. Because the assembled sensor wrap **1500** still includes the release liners **1330** and **1350**, the assembled sensor wrap **1500** need not be immediately used. Thus, the assembled sensor wrap **1500** advantageously allows for wrap assembly before the need for actual use arises.

According to one embodiment, the assembled sensor wrap **1500** is applied to a measurement site, such as a finger, by first removing the release liners **1330** and **1350**. Then, the foldable side **1335** of the assembled sensor wrap **1500** is attached to the measurement site and the securing wrap **1325** is wrapped around the same, thereby accurately and appropriately placing the sensor elements **1215** and **1220** in relation to one another around the measurement site.

When the time arrives to dispose of the sensor wrap **1300**, the reusable circuitry, i.e., the sensor elements **1215** and **1225**, is removed from the sensor wrap **1300** and the sensor wrap **1300** is discarded. As with embodiments disclosed in the foregoing, the reusable circuitry may be optionally sterilized and then reinserted within a new sensor wrap **1300**.

Although the embodiments shown in FIGS. **14** and **15** employ apertures **1320** and positioning members **1220** and **1230** to position the sensor elements **1215** and **1225**, a skilled artisan will recognize from the disclosure herein other releasable attachment mechanisms that may be used in addition to, or as an alternative of the foregoing mechanism, such as, for example, adhesives, hook or slidable members, hook-and-loop attachment mechanisms, friction-fit or other detents, or the like.

Aspects of the embodiments disclosed with respect to FIGS. **12**–**15** illustrate a sensor wrap **1300** including a foldable applicator or side **1335** which advantageously keeps the reusable sensor elements **1215** and **1225** isolated from patient cross-contamination. For example, the foldable side **1335** substantially covers the entirety of the sensor elements **1215** and **1225**. Moreover, employment of the sensor wrap **1300** smoothes the topographical transition from the sensor elements **1215** and **1225**, to the inner layer **1310**, thereby reducing pressure points and the possibility of

15

pressure necrosis occurring in the measurement site. Moreover, according to one embodiment, proper application of the sensor wrap **1300** advantageously places the tops of the ovals in a position to be folded over the measurement site, thereby reducing the amount of ambient light available to the sensor element **1225**.

Although the foregoing invention has been described in terms of certain preferred embodiments, other embodiments will be apparent to those of ordinary skill in the art. For example, aspects of FIGS. **3–11** may be combined with those of FIGS. **12–15**. For example, as shown in FIGS. **16A** and **16B**, the breakable conductor **505** of FIG. **5**, the information element of FIG. **4**, or both, may advantageously be incorporated into one of the layers **1305** or **1310** in a wide number of potential trace shapes and configurations in a wide number of tape shapes. For example, FIG. **16A** illustrates the breakable conductor **505** incorporated into the foam tape layer **1305** via contacts surrounding the positioning apertures **1320**. Alternatively, FIG. **16B** illustrates an embodiment wherein the inner layer **1310** comprises an elongated side **1340** sized similar to the outer layer **1305**. As shown in FIG. **16B**, contacts connect the breakable conductor **505** and the information element **405** to the sensor elements **1215** and **1225**. As disclosed in the foregoing, the breakable conductor **505**, the information element, or both, advantageously add the ability to control overuse, misuse, and the like for the various sensor wraps disclosed herein.

Additionally, the skilled artisan will recognize from the disclosure herein a wide number of shapes of the sensor wrap **1300**, the outer layer **1305**, the inner layer **1310**, the foldable side **1335**, the securing wrap **1325**, or combinations thereof. Also, select aspects of FIGS. **12–16** may advantageously be combined with the shapes of the disposable tape disclosed with reference to FIGS. **3**, and **9–11**. For example, FIGS. **17–19** illustrate perspective views of other embodiments of sensor wraps having foldable sides **320**, **1020**, and **1120**, according to aspects of other embodiments of the invention. Similar to the disclosure of FIGS. **12–16**, the measurement site-facing side of the sensor wraps of FIGS. **17–19** may advantageously comprise transparent material, may have aperture openings, may have an adhesive coatings on each side, or the like. Moreover, the sensor wraps of FIGS. **17–19** may advantageously incorporate one or more positioning apertures **1320** for sensor components having one or more positioning members, similar to those disclosed with reference to FIGS. **10–11**.

A skilled artisan will also recognize from the disclosure herein that the foregoing sensor wraps of FIGS. **13** and **16–19** can be configured without positioning apertures to straightforwardly and accurately position sensor elements without positioning members within the sensor wraps. For example, FIGS. **20A** and **20B** illustrate sensor wraps **1300** having positioning indicators **2005** directing an assembler as to where to place sensor elements, such as an emitter, a detector, other reusable circuitry, or the like, within the sensor wraps. For example, FIG. **20A** shows the positioning indicators **2005** as solid ink outlines indicating where the elements are to be placed. As disclosed in the foregoing, once positioned within the sensor wrap using the positioning indicators **2005**, the foldable side **1335** of the sensor wrap can be folded over the sensor elements thereby substantially fixing their position within the wrap. A skilled artisan will recognize that the positioning indicators **2005** can be broken lines, phantom lines, scores on the tape, or the like. FIG. **20B** shows yet another embodiment where the indicators **2005** comprise notches, which can be stamped, scored, or the like, from one or more sides of the sensor wrap. Similar to FIG.

16

20A, an assembler can use the notches as a guide in placing the sensor elements within the sensor wrap.

Additionally, other combinations, omissions, substitutions and modifications will be apparent to the skilled artisan in view of the disclosure herein. Accordingly, the present invention is not intended to be limited by the reaction of the preferred embodiments, but is to be defined by reference to the appended claims.

What is claimed is:

1. A sensor wrap for removably securing an emitter and detector circuit assembly of a pulse oximetry sensor to body tissue of pulsing blood, the sensor wrap comprising:

- a center tape portion configured to position an assembled reusable emitter and detector circuit assembly of a pulse oximetry sensor;
- a securing tape portion extending from the center tape portion and configured to removably secure the sensor wrap proximate to body tissue carrying pulsing blood; and
- a foldable portion including an attached side and a free side, wherein at least a portion of the attached side is attached to the center tape portion and the free side is configured to, before application of the sensor wrap to the body tissue, fold over the emitter and detector circuit assembly when the emitter and detector circuit assembly are positioned within the center tape portion to affix the emitter and detector circuit assembly between the center tape portion and the foldable portion, thereby forming an assembled sensor capable of removably securing the emitter and detector circuit assembly proximate the body tissue carrying the pulsing blood.

2. The sensor wrap of claim **1**, wherein the foldable portion comprises a transparent layer.

3. The sensor wrap of claim **1**, wherein the center tape portion includes apertures configured to receive positioning portions of the emitter and detector circuit assembly.

4. The sensor wrap of claim **1**, further comprising a disposable information element within at least one of the center tape portion and the foldable portion, wherein the information element is configured to electrically connect to an emitter of the emitter and detector circuit assembly when the emitter and detector circuit assembly is positioned within the sensor wrap.

5. The sensor wrap of claim **1**, further comprising a breakable conductive trace within at least one of the center tape portion and the foldable portion, wherein the breakable conductive trace is configured to electrically disconnect an emitter of the emitter and detector circuit assembly when the emitter and detector circuit assembly is positioned within the sensor wrap and the breakable conductive trace is broken.

6. The sensor wrap of claim **1**, wherein the center tape portion is configured to position the assembled reusable emitter and detector circuit assembly comprising a Y-type sensor.

7. The sensor wrap of claim **1**, wherein the center tape portion is configured to position the assembled reusable emitter and detector circuit assembly comprising a flexible circuit.

8. A sensor wrap including a foldable tape for positioning elements of a sensor within the sensor wrap before application of the sensor wrap to a measurement site thereby properly positioning the elements of the sensor with respect to one another, and eventually with respect to the measurement site on body tissue carrying pulsing blood, the sensor wrap comprising:

17

- a base tape comprising a positioning portion which receives an assembled circuit assembly including an assembled emitter and an assembled detector;
- a foldable tape attached to the base tape, wherein the foldable tape folds over the assembled circuit assembly before application of the sensor wrap to a measurement site, thereby removably securing the assembled circuit assembly within the sensor wrap; and
- a fastener which removably secures the sensor wrap to the measurement site.
9. The sensor wrap of claim 8, wherein the base tape further comprises a breakable conductor.
10. The sensor wrap of claim 8, wherein the foldable tape further comprises a breakable conductor.
11. The sensor wrap of claim 8, wherein the base tape further comprises an information element.
12. The sensor wrap of claim 8, wherein the foldable tape further comprises an information element.
13. The sensor wrap of claim 8, wherein the base tape comprises a figure eight-like shape.
14. The sensor wrap of claim 8, wherein the foldable tape comprises a figure eight-like shape attached at a side.
15. The sensor wrap of claim 8, wherein the fastener comprises an elongated arm extending from one of the base tape and the foldable tape.
16. The sensor wrap of claim 8, wherein the positioning portion comprises at least one aperture.
17. The sensor wrap of claim 8, wherein the base tape comprises a boot-like shape, and wherein the fastener comprises a toe portion of the boot-like shape.
18. The sensor wrap of claim 8, wherein the foldable tape comprises a boot-like shape, and wherein the fastener comprises a toe portion of the boot-like shape.
19. The sensor wrap of claim 8, wherein the base tape comprises a substantially rectangular shape.
20. The sensor wrap of claim 8, wherein the foldable tape comprises a substantially rectangular shape.
21. The sensor wrap of claim 8, wherein the base tape comprises an elongated center section connecting front and rear flaps, and wherein the fastener comprises the front and rear flaps.
22. The sensor wrap of claim 8, wherein the foldable tape comprises an elongated center section connecting front and rear flaps, and wherein the fastener comprises the front and rear flaps.
23. The sensor wrap of claim 8, wherein the foldable tape is transparent.
24. The sensor wrap of claim 8, wherein the base tape receives the assembled circuit assembly comprising a Y-type sensor.
25. The sensor wrap of claim 8, wherein the base tape receives the assembled circuit assembly comprising a flexible circuit.
26. A method of manufacturing a sensor wrap, the method comprising:
- forming a base tape including at least one positioning element configured to position an assembled reusable sensor elements on the base tape;
- forming a foldable tape including adhesive on at least one side and configured to fold over the sensor elements

18

- positioned on the base tape before application of the sensor wrap to a measurement site, thereby removably securing the sensor elements within the sensor wrap; and
- connecting the foldable tape to the base tape.
27. The method of claim 26, further comprising attaching release liners to exposed adhesive.
28. The method of claim 26, wherein the act of connecting the foldable tape to the base tape further comprises:
- removing a release liner from a portion of the foldable tape; and
- attaching the portion to the base tape.
29. The method of claim 26, wherein the act of connecting the foldable tape to the base tape further comprises:
- removing a release liner from a portion of the base tape; and
- attaching the portion to the foldable tape.
30. The method of claim 26, wherein the forming the base tape further comprises forming a base tape configured to position a Y-type sensor.
31. The method of claim 26, wherein the forming the base tape further comprises forming a base tape configured to position a flexible circuit.
32. A method of attaching a sensor having reusable and disposable portions, the method comprising:
- removing a release liner on a center portion of a disposable positioning tape;
- attaching reusable fully-assembled elements of a sensor to the center portion; and
- folding a foldable portion over the reusable elements of the sensor before application of the disposable positioning tape to a measurement site, thereby securing the reusable elements of the sensor within the center portion.
33. The method of claim 32, wherein the attaching reusable elements comprises aligning positioning elements of the sensor with positioning elements within the center portion.
34. The method of claim 33, wherein the positioning element within the center portion comprises an aperture.
35. The method of claim 32, wherein at least one of the attaching the reusable elements and the folding the foldable portion includes electrically connecting an information element to one of the reusable elements of the sensor.
36. The method of claim 32, wherein at least one of the attaching the reusable elements and the folding the foldable portion includes electrically connecting a breakable conductor to one of the reusable elements of the sensor.
37. The method of claim 32, further comprising:
- removing release liners from other portions of the disposable positioning tape; and
- affixing the disposable positioning tape, with the reusable sensor elements, to a measurement site.
38. The method of claim 32, wherein the attaching reusable elements further comprises attaching a Y-type sensor.
39. The method of claim 32, wherein the attaching reusable elements further comprises attaching a flexible circuit.

* * * * *

专利名称(译)	传感器包装，包括可折叠涂抹器		
公开(公告)号	US6671531	公开(公告)日	2003-12-30
申请号	US10/020664	申请日	2001-12-11
[标]申请(专利权)人(译)	AL ALI AMMAR MASON EUGENEÊ		
申请(专利权)人(译)	AL-ALI AMMAR MASON EUGENE E.		
当前申请(专利权)人(译)	摩根大通银行，NATIONAL ASSOCIATION		
[标]发明人	AL ALI AMMAR MASON EUGENE E		
发明人	AL-ALI, AMMAR MASON, EUGENE E.		
IPC分类号	A61B5/00		
CPC分类号	A61B5/14552 A61B2562/12 A61B2560/0276		
助理审查员(译)	克里默MATTHEW		
优先权	60/306635 2001-07-18 US 60/324873 2001-09-25 US		
其他公开文献	US20020045807A1		
外部链接	Espacenet USPTO		

摘要(译)

一种传感器包裹物，包括可折叠的涂抹器，其在将传感器包裹物施加到测量部位之前基本上和可移除地将传感器元件固定在传感器包裹物内。传感器包裹物可有利地包括一次性带层，包括信息元件，可破坏导体或两者。

