



US006540673B2

(12) **United States Patent**  
**Gopinathan et al.**

(10) **Patent No.:** **US 6,540,673 B2**  
(45) **Date of Patent:** **\*Apr. 1, 2003**

(54) **TELE-DIAGNOSTIC DEVICE**

(75) Inventors: **Govindan Gopinathan**, Oradell, NJ (US); **Arthur R. Tilford**, Yorba Linda, CA (US)

(73) Assignee: **indeemd.com, inc.**, Great Neck, NY (US)

(\* ) Notice: Subject to any disclaimer, the term of this patent is extended or adjusted under 35 U.S.C. 154(b) by 0 days.

This patent is subject to a terminal disclaimer.

(21) Appl. No.: **09/741,283**

(22) Filed: **Dec. 19, 2000**

(65) **Prior Publication Data**

US 2001/0000526 A1 Apr. 26, 2001

**Related U.S. Application Data**

(63) Continuation of application No. 09/084,647, filed on May 26, 1998, now Pat. No. 6,224,548.

(51) **Int. Cl.**<sup>7</sup> ..... **A61B 5/00**

(52) **U.S. Cl.** ..... **600/300; 600/301; 600/485; 600/500; 600/508; 600/549; 600/561; 128/903**

(58) **Field of Search** ..... **600/300, 322-4, 600/500, 485, 561, 549, 508; 128/903-4**

(56) **References Cited**

**U.S. PATENT DOCUMENTS**

3,888,240 A	6/1975	Reinhold, Jr. et al.
4,016,868 A	4/1977	Allison
4,230,127 A	10/1980	Larson
4,381,012 A	4/1983	Russek
4,510,939 A	4/1985	Brenman et al.
4,583,547 A	4/1986	Granek et al.
4,608,987 A	9/1986	Mills
4,662,378 A	5/1987	Thomis
4,698,848 A	10/1987	Buckley

4,709,704 A	12/1987	Lukasiewicz
4,974,607 A	12/1990	Miwa
5,007,427 A	4/1991	Suzuki et al.
5,224,479 A	7/1993	Sekine
5,353,793 A	10/1994	Bornn
5,431,170 A	* 7/1995	Mathews ..... 600/500
5,442,729 A	* 8/1995	Kramer et al. .... 600/587
5,465,727 A	11/1995	Reinhold, Jr.
5,511,546 A	4/1996	Hon
5,640,953 A	6/1997	Bishop et al.
5,666,404 A	9/1997	Ciccotelli et al.
5,670,944 A	9/1997	Myllymaki
5,687,748 A	11/1997	Shapiro et al.
5,704,364 A	1/1998	Saltzstein et al.
5,730,140 A	3/1998	Fitch
5,738,104 A	* 4/1998	Lo et al. .... 600/513
5,771,001 A	6/1998	Cobb
5,771,891 A	* 6/1998	Gozani ..... 600/345
5,855,550 A	1/1999	Lai et al.
5,877,675 A	3/1999	Rebstock
6,022,321 A	* 2/2000	Amano et al. .... 600/500
6,217,523 B1	* 4/2001	Amano et al. .... 600/500
6,224,548 B1	5/2001	Gopinathan et al.
6,248,064 B1	6/2001	Gopinathan et al.

\* cited by examiner

*Primary Examiner*—Robert L. Nasser

(74) *Attorney, Agent, or Firm*—Brooks & Kushman P.C.

(57) **ABSTRACT**

A system (10) for collecting a plurality of diagnostic information and transmitting the diagnostic information to a remote location. The system (10) comprises a glove member (12) adaptable to be worn on a person's hand and an interface unit (20) in electrical communication with the glove member (12). The interface unit (20) is capable of transmitting information to, and receiving information from, a remote location. The glove member (12) comprises a palm portion (1), a wrist portion (3) and five phalange portions (5-13). The glove member (12) further comprises an EKG diagnostic device, a blood pressure and pulse rate diagnostic device (54) and a temperature device (64). The glove member (12) may also further comprise a %O<sub>2</sub> diagnostic device (70) and an auscultation device (80).

**37 Claims, 3 Drawing Sheets**

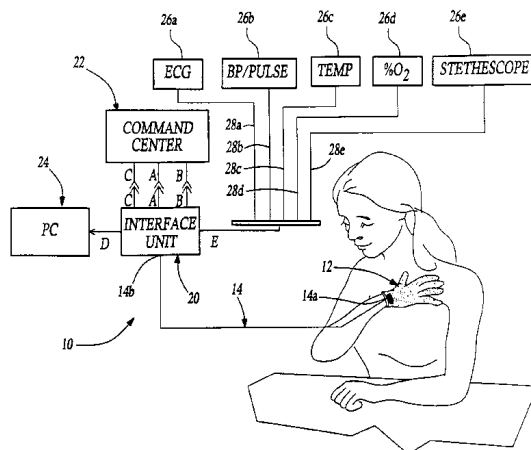

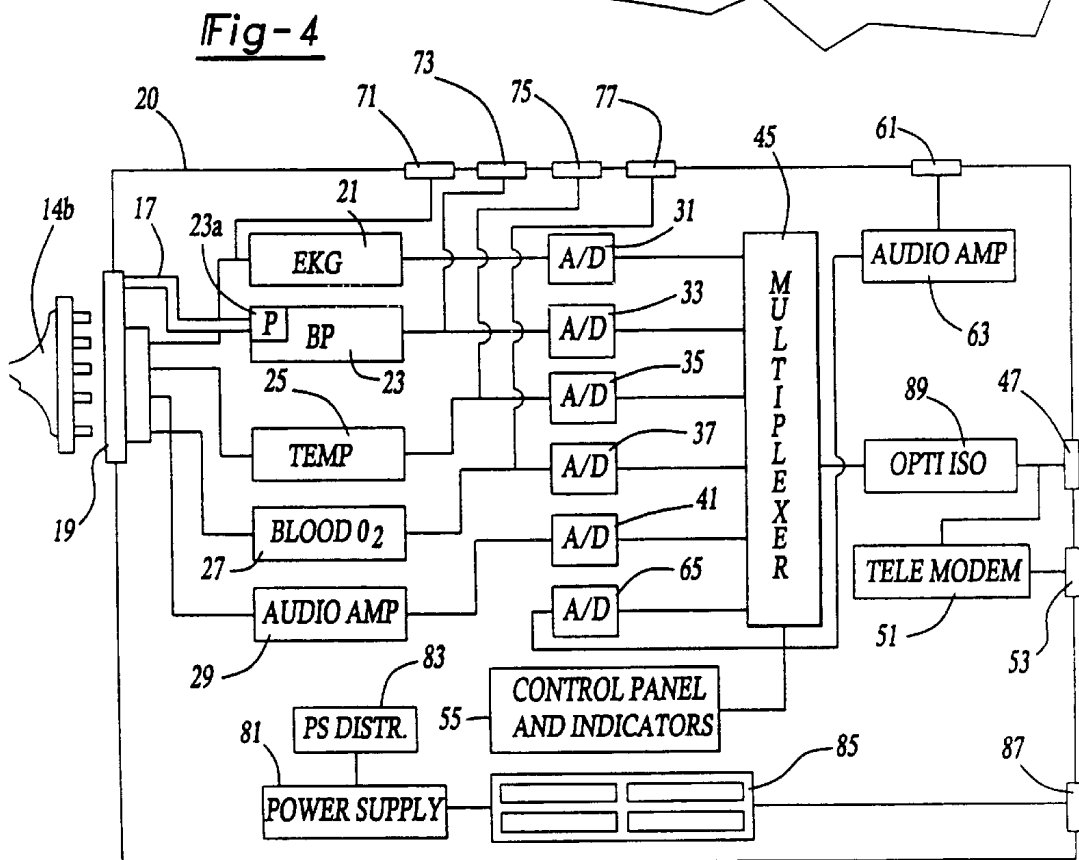
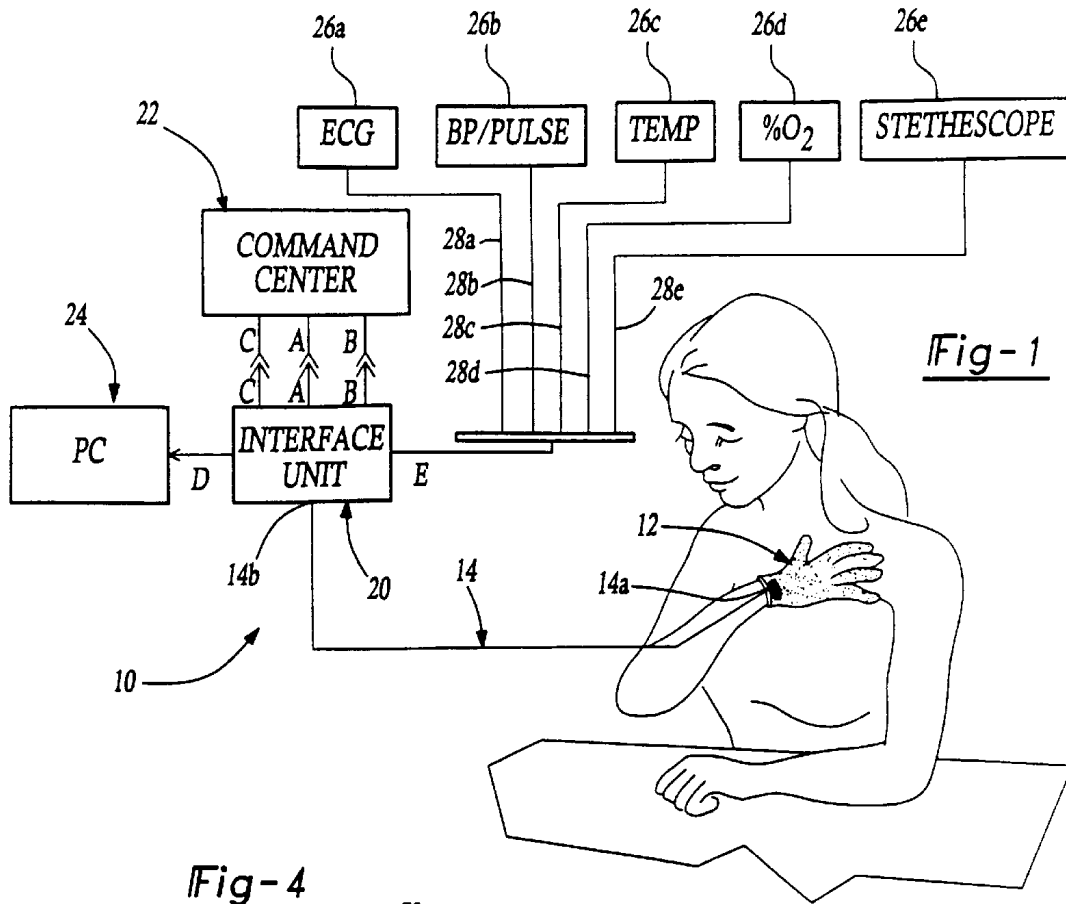

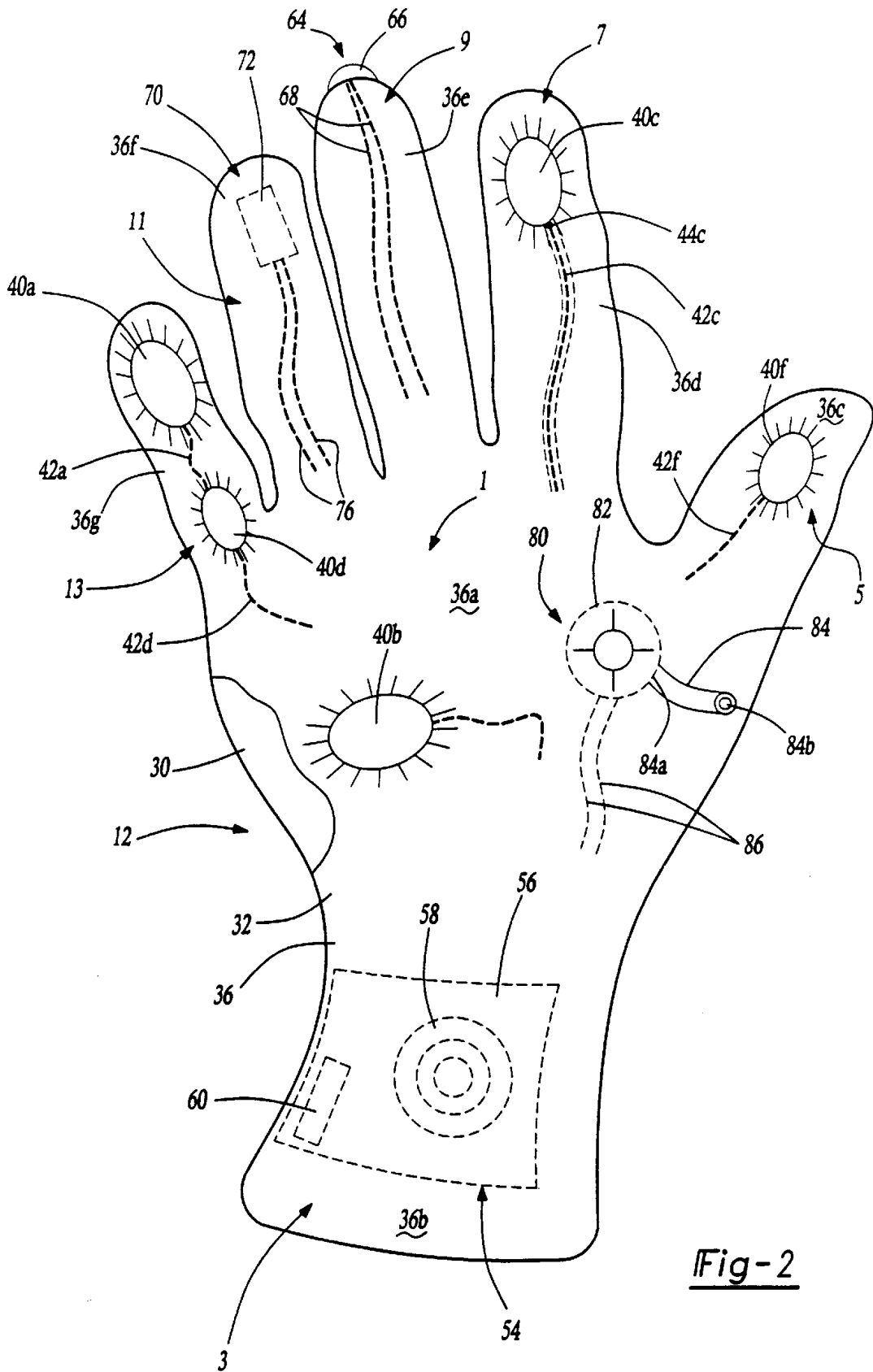

Fig-2



**TELE-DIAGNOSTIC DEVICE**

This is a continuation of application Ser. No. 09/084,647 filed on May 26, 1998 now U.S. Pat. No. 6,224,548.

**TECHNICAL FIELD**

This invention relates to a system, and a probe for use with the system, for obtaining a plurality of medical diagnostic information. In particular, the present invention relates to a system and probe for use with the system, for gathering cardiac-related diagnostic information and transmitting the information to a remote location, such as a medical monitoring command center.

**BACKGROUND**

Doctor-patient relationships are as old as human civilization itself. Over the centuries this relationship has undergone, surprisingly enough, very little change. One way or another the patient and the doctor came into contact with each other in person. This process was called a patient visit or doctor visit, as the case may be. From the very beginning of this patient-doctor interaction, a certain format and structure evolved and later this was laid down as a stipulated discipline in the practice of medicine. The doctor interrogates the patient in a methodical way, the patient provides the answers, which in fact, is the history of the evolution of the patient's illness. The doctor then examines the patient, makes crucial observations and gathers diagnostic data, or information, which are the fingerprints of the illness the patient is suffering from. An intellectual process ensues in the doctor's mind, where he correlates the history of the illness with the diagnostic information he gathered and the conclusion he arrives at, essentially, is the diagnosis of the patient's malady.

Over the years, innovations like the telegraph, the telephone, fax machines and of late, the e-mail and the Internet, has enhanced the patient-doctor relationship quite substantially. These innovations have curtailed the need for more frequent personal visits, by the patient or the doctor, as the case may be. Doctors on their part however, always prefer to speak to the patient and gather vital diagnostic information personally by themselves, even when the patient is located remotely from the doctor. Thus, it would be desirable to be able to gather and transmit a plurality of diagnostic information and converse with a doctor, or medical professional, at a remote location. Moreover, it would be desirable to provide a single apparatus which could collect a plurality of diagnostic information.

Moreover, it has been observed that at least about one third of the patients who visit emergency rooms (ER) across the country, do not have emergency problems. They visit the ER because they believed that they are having a heart attack or another medical emergency, or they prefer to use the emergency room instead of paying a visit to their general practitioner (GP) or primary care physician (PCP). These unnecessary visits to the ER sometimes prove to be quite costly to the patients and/or their healthcare underwriter in more ways than one. As a first example, if someone had epigastric pain from indigestion, a visit to the GP or PCP would cost, at the most about \$75.00. A visit to any ER for the same purpose could cost upwards of about \$500. Also, while medical professionals tend to a patient not actually requiring emergency treatment, another patient who actually could benefit from emergency treatment may go untreated. If the patient has been provided with a means for gathering and transmitting a plurality of diagnostic information and for

conversing with a medical professional at a remote location, the patient would be able to communicate with, and transmit diagnostic information to, a medical professional at a monitoring center (MC) or an ER, prior to visiting an ER. The medical professional, being able to communicate with and review a plurality of the patient's diagnostic information, can quickly decide if this patient has an emergency or not, and the medical professional is also in a position to periodically monitor this patient, over a period of several hours. This could be done at a cost which would be a fraction of an ER visit and would free up ER's to care for patients actually requiring emergency treatment.

Once we look beyond the urban areas, especially in large central and mid-western states, patients live hundreds of miles away from their doctors. Follow-up of these patients is a problem. Providing transportation to sick people is a lofty idea, but in practice is quite expensive. A means for gathering and transmitting a plurality of diagnostic information to, and for communicating with, a remote location provides the medical community with a formidable, cost-effective tool.

A means for gathering and transmitting a plurality of diagnostic information to, and for communicating with, a remote location, in addition to providing a means for preventing unnecessary ER visits, can also be helpful in providing emergency care to patients who, for all practical purposes, cannot get to an ER, such as airplane or boat passengers. The medical professional at a remote location can monitor the patient's diagnostic information and be able to communicate with the patient or persons by the patient's side for the purpose of providing medical instructions to the patient and/or persons.

In the prior art, there are devices which gather and transmit diagnostic information (such as EKG) to a remote location. However, these prior art devices are limited in the amount and type of diagnostic information they can gather and transmit. Moreover, these prior art devices are typically complicated and difficult to use. Accordingly, it would be desirable to provide a simple to use means for gathering and transmitting a plurality of diagnostic information and for communicating with a remote location.

If a patient were suffering from symptoms consistent with a heart attack, in order to provide an accurate diagnosis and/or course of action, the examining medical professional would preferably gather the following minimum diagnostic information: Electrocardiogram (EKG); Blood Pressure (BP); Pulse; and body temperature. In many instances, a medical professional would also prefer to be able to determine the percentage of oxygen saturation in the blood (%O<sub>2</sub>); and auscultation of the patient's heart and lungs. Also, the examining medical professional would prefer to communicate with the patient or person(s) by the patient's side to aid in gathering diagnostic information and/or to provide medical instructions. Accordingly, it would be desirable to provide an inexpensive and easy to use probe device which could gather and transmit to a remote location the above-mentioned diagnostic information and also provide the ability to allow oral communication with a remote location.

**DISCLOSURE OF THE INVENTION**

An object of the present invention is to provide an inexpensive and easy to use probe which could gather and transmit plurality of diagnostic information to a remote location.

In carrying out the above object, a system for collecting a plurality of diagnostic information and transmitting the

diagnostic information to a remote location is provided. The system comprises a glove member adaptable to be worn on a person's hand and an interface unit in electrical communication with the glove member. The interface unit is capable of transmitting information to, and receiving information from, a remote location. The glove member comprises a palm portion, a wrist portion and five phalange portions. The glove member further comprises an EKG diagnostic device, a blood pressure and pulse rate device and a temperature device. Also, the glove member could have a %O<sub>2</sub> device, as well as an auscultation device.

#### BRIEF DESCRIPTION OF THE DRAWINGS

FIG. 1 is a schematic view of the system of the present invention;

FIG. 2 is a plan view of a first side of an apparatus of the present invention;

FIG. 3 is a plan view of a second side of an apparatus of the present invention;

FIG. 4 is a schematic diagram of the circuit of the interface unit shown in FIG. 1; and

FIG. 5 is an exploded view of an EKG sensor used in FIGS. 2 and 3.

#### BEST MODE FOR CARRYING OUT THE INVENTION

The present invention relates to a system, and a diagnostic probe for use with the system, for obtaining a plurality of medical diagnostic information. In particular, the present invention relates to a system, a diagnostic probe device and an information transmission device for use with the system, for gathering cardiac related diagnostic information and transmitting the information to a remote location, such as a medical monitoring command center.

As representative of the present invention, FIG. 1, illustrates a system 10 for gathering, and transmitting, to a remote location a plurality of diagnostic information.

The system 10 includes a glove probe 12. The glove probe 12 is a unitary member which is adaptable to be worn over a person's hand. The glove probe 12 includes a plurality of medical diagnostic probes which gather diagnostic signals, as will be explained in more detail below. The glove probe 12 is connected via a cable 14 to an interface unit 20 and, thus communicates with, and is capable of transmitting diagnostic signals, or information, from the medical diagnostic probes to the interface unit. The interface unit 20 communicates with a remote command center 22 via a telephone wire or fiber A, a satellite connection B, or a radio wave connection C. The interface unit 20 alternatively communicates with a personal computer (PC) 24 via an interface connection D. The interface unit 20 also communicates with a plurality of local diagnostic readout apparatuses 26a, 26b, 26c, 26d, and 26e via an interface connection E via a plurality of interface connections, 28a, 28b, 28c, 28d, and 28e, respectively. The diagnostic readout apparatuses 26a-e are preferably an electrocardiogram (EKG) readout; a blood pressure (BP) and pulse readout, a %O<sub>2</sub> oxygen readout, a temperature readout, and a stethoscope, respectively.

Referring to FIG. 2, the glove probe 12 comprises a first glove layer 30 and a second glove layer 32 secured to the first glove layer such that the second glove layer overlies most of the first glove layer. The first glove layer 30 is preferably made of a cloth of natural or synthetic fibers. The second layer 32 is preferably made of a rubber or rubber-like material.

The glove probe 12 includes a palm portion 1, a wrist portion 3, a thumb phalange portion 5, an index finger phalange portion 7, a middle finger phalange portion 9, a ring finger phalange portion 11 and a pinky finger phalange portion 13. The glove probe 12 further includes a palmar side 36 (FIG. 2) and a dorsal side 38 (FIG. 3). The palmar side 36 (FIG. 2) includes a palmar palm portion surface 36a, a palmar wrist portion surface 36b, a palmar thumb phalange portion surface 36c, a palmar index finger phalange portion surface 36d, a palmar middle finger phalange portion surface 36e, a palmar ring finger phalange portion surface 36f and a palmar pinky finger phalange portion surface 36g. The dorsal side 38 (FIG. 3) includes a dorsal palm portion surface 38a, a dorsal wrist portion surface 38b, a dorsal thumb phalange portion surface 38c, a dorsal index finger phalange portion surface 38d, a dorsal middle finger phalange portion surface 38e, a dorsal ring finger phalange portion surface 38f and a dorsal pinky finger phalange portion surface 38g.

As discussed previously, the glove probe 12 contains a plurality of medical diagnostic devices. In the embodiment shown in FIGS. 2 and 3, the glove probe 12 contains an EKG diagnostic device, a blood pressure and pulse rate device 54, a temperature device 64, a %O<sub>2</sub> device 70 and an auscultation device 80.

The EKG device is capable of measuring the EKG currents of the heart muscle and preferably includes a plurality of sensors 40a (FIG. 2), 40b, 40c, 40d, 40e (FIG. 3), 40f (FIG. 2) and 40g (FIG. 3) which are secured to the first layer 30 (FIG. 2) of the glove probe 12. An exemplary sensor 40c is shown in FIG. 5. Each of the sensors 40a-40g includes a stainless-steel screen 41 and an EKG gelly sponge 43 disposed between the screen and, preferably, the first layer 30 (FIG. 5). Sensors 40a, 40b, 40c, 40d and 40f (FIG. 2) are provided on the palmar side 36 of the glove probe 12. Sensors 40e and 40g (FIG. 3) are provided on the dorsal side 38 of the glove probe 12. Sensors 40a-40d, 40f and 40g preferably extend through, or are not covered by, the second layer 32 so that they are exposed to the environment. Sensor 40e faces the palmar side 36 of the glove probe 12.

More specifically, sensor 40a (FIG. 2) is positioned on the tip portion of the palmar pinky finger phalange portion surface 36e of the glove probe 12. Sensor 40b is positioned on the left side of the palmar palm portion surface 36a of the glove probe 12. Sensor 40c is positioned on the upper portion of the palmar index finger phalange portion surface 36d of the glove probe 12. Sensor 40d is positioned on the base portion of the palmar pinky finger phalange portion surface 36g, between sensor 40a and sensor 40b, of the glove probe 12. Sensor 40e (FIG. 3) is located on the left side of the dorsal wrist portion surface 36b of the of the glove probe 12. Sensor 40f (FIG. 2) is positioned on the palmar thumb phalange portion surface 36c of the glove probe 12. Sensor 40g (FIG. 3) is positioned on the dorsal palm portion surface 38a of the glove probe 12.

Each of the sensors 40a-40g are connected to a wire 42a-42g, respectively, which extends between and electrically connects a respective one of the sensors 40a-40g with a female connection plug 48, which is preferably provided on the dorsal side of the glove probe 12. Each wire 42a-42g is preferably disposed between the first and second layers 30 and 32 of the glove probe 12, and is preferably secured to the first layer 30. Each wire 42a-42g is preferably shielded and has a powdered-iron bead 44c (FIG. 5), such as Part No. T12-41 from Amidon Associates in Santa Ana, Calif. (shown only with respect to sensor 40c) disposed adjacent to its respective sensors 40a-40g to help prevent the detection of unwanted noise.

The glove probe **12** includes a ground strip **50** (FIG. 3) which is preferably positioned on the palm portion **3** of the dorsal side **38** between the first and second layers **30** and **32**. Each wire **42a-42g** is connected to the ground strip **50**, preferably, via each respective wire shield. The ground strip **50** is connected to a wire **52**, which extends between and connects the ground strip **50** to the female connection plug **48**. The ground strip **50** functions to bring existing electromagnetic forces (EMF) noise to a single electrical voltage point for removal.

The blood pressure device **54**, which is capable of measuring systolic and diastolic blood pressure and pulse rate signals, is preferably secured to the first layer **30** of the glove probe **12** between the first layer and the second layer **32** on the wrist portion **3** of the dorsal side **38** of the glove probe. The blood pressure device **54** preferably includes an expandable air bladder **56** defining a chamber for accommodating air or another suitable inflation fluid, an acoustical coupler **58** in the chamber and an air tube **60**. The air tube **60** extends between and provides fluid and audio communication between the chamber of the air bladder **56** and the female connection plug **48**. The acoustical coupler **58** is capable of collecting the sound waves in the air bladder **56** and directing the sound waves towards, and through, the air tube **60**. The blood pressure device **54** is preferably made of parts similar, or identical, to parts of the UB-302 Systolic/Diastolic (Pulse) Digital Blood Pressure monitor from A+D Engineering Inc., of Milpitas, Calif.

The temperature device **64** is capable of measuring temperature signals and preferably includes a thermistor **66**. The thermistor **66** is preferably positioned on the tip of the middle finger phalange portion **9**. The thermistor **66** is preferably secured to the first layer **30** and extends through the second layer **32**. The temperature device **64** includes a pair of wires **68** which extend between and electrically connect the thermistor **66** and the female connection plug **48**. The temperature device **64** is preferably made of parts similar, or identical, to parts of the Cole-Parmer E-08402-00 thermometer and Generic thermistor E-08459-10 from Cole-Parmer Instrument Company of Vernon Hills, Ill.

The %O<sub>2</sub> device **70** is capable of measuring the percent oxygen saturation in the blood (%O<sub>2</sub>) signals and preferably includes a red (600-660 nm) and infra-red (880-1000 nm) LED emitter **72** and an LED (600-1000 nm) sensor **74**. The LED emitter **72** is preferably secured to the inner surface of the first layer **30** on the palmar side **36** of ring finger phalange portion **11** of the glove probe **12** and the LED sensor **74** is preferably secured to the inner surface on the dorsal surface **38** of the ring finger phalange portion **11** of the glove probe such that the LED emitter faces the LED sensor. The LED emitter **72** is connected to a pair of wires **76** which extend between and electrically connect the LED emitter and the female connection plug **48**. The LED sensor **74** is connected to a pair of wires **78** which extend between and electrically connect the LED sensor and the female connection plug **48**. The %O<sub>2</sub> device **70** is preferably made of parts similar, or identical, to parts of the Nonin Onyx blood flow and oxygen % reader, model No. 8500M from Nonin Medical, Inc., of Plymouth, Minn.

The auscultation device **80** is capable of detecting the sound waves local to the patient's heart and lungs and preferably includes an acoustical coupler and microphone **82**, an air tube **84**, and a pair of wires **86**. The acoustical coupler and microphone **82** is preferably secured to the right side of the palm portion **1** of the palmar side **36** of the glove probe **12**, preferably on the first layer **30**. The acoustical coupler and microphone **82** is capable of collecting and

amplifying sound waves in relative close proximity to the acoustical coupler and microphone. The air tube **84** includes a first end **84a** and a second end **84b**. The first end **84a** of the air tube **84** is preferably connected to the acoustical coupler and microphone **82** and the second end **84b** is adaptable for connection with a stethoscope. The air tube **84**, thus when connected to a stethoscope, extends between and provides audio communication between the acoustical coupler and microphone **82** and the stethoscope. The pair of wires **86** extend between and electrically connect the acoustical coupler and microphone **82** and the female plug **48**. The auscultation device **80** is preferably made of parts similar, or identical, to parts of the EG Company microphone 9445 from the Electrical Gold Co. Of Scottsdale, Ariz.

The glove probe **12** is manufactured by securing, by any suitable means, the wires, sensors, and other components to a glove, preferably made of cloth (i.e., the first layer **30**). It should be noted that the wires and/or sensors could be made using flexible circuit technology, such as by using a conductive printable ink. The components of the glove probe **12** which do not extend past the second layer **32** are then covered by the second layer in a suitable manner, such as by spraying or dip coating.

The cable **14** includes a first male plug **14a** (FIG. 3), which plugs into male receptors on the female connection plug **48** on the glove probe **12**, and a second male plug **14b** (FIG. 4), which plugs into male receptors on a female connection plug **19** on the interface unit **20**. The cable **14** (FIG. 1) preferably includes a plurality of electrical wires and air tubes which extend between plugs **14a** and **14b** to provide electrical, audio, and fluid communication between the glove probe **12** and the interface unit **20** when the male plugs **14a** (FIG. 3) and **14b** (FIG. 4) are plugged into their respective female connection plugs **48** (FIG. 3) and **19** (FIG. 4).

The interface unit **20** (FIG. 1) preferably includes an EKG circuit board **21** (FIG. 4) for receiving EKG currents detected by the sensors **40a-40g**, a blood pressure circuit board **23** for receiving systolic and diastolic blood pressure and pulse rate signals from the blood pressure device **54**, a temperature circuit board **25** for receiving temperature signals from the temperature device **64** and a %O<sub>2</sub> circuit board for receiving %O<sub>2</sub> signals from the %O<sub>2</sub> device **70**. The EKG circuit board **21** is capable of amplifying the EKG currents from the sensors **40a-40g** and converting the EKG currents to at least a plurality of EKG analog outputs. The blood pressure circuit board **23** is capable of (i) converting the systolic blood pressure signals to a systolic blood pressure analog output, (ii) the diastolic blood pressure signals to a diastolic blood pressure analog output, and (iii) the pulse rate signals to a pulse rate analog output. The blood pressure circuit board **23** includes a source of inflation fluid, such as an air pump **23a**, for supplying a source of inflation fluid for the air bladder **56**, and an acoustical sensor (not shown) for detecting the systolic and diastolic blood pressure and pulse rate signals. The pump **23a** is in fluid communication with the air bladder **56** (FIG. 2) via the air tube **60**, cable **14** (FIG. 1) and air conduit **17** (FIG. 4), which extends between and provides fluid and audio communication between the female connection plug **19** of the cable **14** and the blood pressure circuit board **23**. The temperature circuit board **25** converts the temperature signals to a temperature analog output. The %O<sub>2</sub> circuit board **27** converts the %O<sub>2</sub> signals to a %O<sub>2</sub> analog output. The interface unit **20** also includes an audio amp **29** for amplifying the sound waves received from the auscultation device **80** (FIG. 2).

The interface unit **20** further includes a first analog to digital converter **31** for converting the EKG analog outputs to an EKG digital data stream, a second analog to digital converter **33** for converting (i) the systolic blood pressure analog output to a systolic blood pressure digital data stream, (ii) the diastolic blood pressure analog output to a diastolic blood pressure digital data stream, and (iii) the pulse rate analog output to a pulse rate digital data stream, a third analog to digital converter **35** for converting the temperature analog output to a temperature digital data stream, a fourth analog to digital converter **37** for converting the %O<sub>2</sub> analog output to a %O<sub>2</sub> digital data stream, and a fifth analog to digital converter **41** for converting the sound waves from the first audio amp **29** to a sound digital data stream.

The interface unit **20** further includes a multiplexer **45** for combining the digital data streams from the analog to digital converters **31-37** and **41** to a combined digital data stream. The combined digital data stream can then be conveyed to the PC **24** via a first port **47**, or to the command center **22** (FIG. 1) by satellite connection B via a modem, or by radio wave connection C via the port **47**, or to the command center **22** by telephone wire, or fiber, A via telephone modem **51** (FIG. 4) and a second port **53** (FIG. 4). The digital data streams from the interface unit **20** are then converted or interpreted into readable diagnostic information in the command center **22** or the PC **24**. This circuitry enables the glove probe **12** and the interface unit **20** to be provided at a reasonable cost. The multiplexer **45** also communicates with a control panel and indicator circuit board **55**.

The interface unit **20** further includes a speaker/microphone **61** which communicates with the multiplexer **45**, via a second audio amp **63** and a sixth analog to digital converter **65**, to enable a medical professional in the command center **22** to communicate orally with the persons in relative close proximity to the speaker/microphone.

The interface unit **20** includes a third port **71** for receiving and transmitting EKG currents detected by sensors **40a-40g** to an EKG readout apparatus **26a** (FIG. 1) where the EKG currents will be converted or interpreted into readable diagnostic information. The interface unit **20** further includes a fourth, fifth and sixth port **73, 75** and **77**, respectively, for receiving and transmitting the analog outputs from the blood pressure circuit board **23**, the temperature circuit board **25** and the %O<sub>2</sub> circuit board **27**, respectively, to a blood pressure and pulse readout apparatus **26b**, a temperature readout apparatus **26c**, and a %O<sub>2</sub> readout apparatus **26d** where the analog outputs will be converted or interpreted into readable diagnostic information.

The interface unit **20** also includes a power supply **81** which supplies power, via power supply distributor **83**, to all of the components of the interface unit. The interface unit **20** also preferably includes a battery pack **85** and a battery charger port **87**.

The interface unit further includes an optical isolator **89** for electrically isolating the entire interface unit **20** and glove probe **12** from any destructive and damaging currents which might be encountered from external communication links.

The manner of operation of the system **10** will now be described. The patient places the glove probe **12** over his or her right hand so that each of the patient's fingers are received within a respective one of the phalange portions **5-13**. The glove probe **12** can then preferably be tightened around the patient's wrist by any suitable means such as a velcro strap. The glove probe **12** is then connected to interface unit **20** by cable **14**.

#### EKG Diagnostic Information

To obtain EKG diagnostic information, the palmar side **36** of the glove probe **12** is placed over the patient's chest area proximate to the patient's heart. The sensors **40a-40g** are located at strategic positions on the glove probe **12**, as described above, to enable a plurality of leadwire combinations to detect a plurality of standard leads when the glove probe **12** is placed over the patient's left breast. Some exemplary leadwire combinations are as follows:

##### I. Five-Leadwire Scenario:

With the glove probe **12** placed in a normal manner over the left breast, it is believed that at least the following leadwires are possible:

LL acting leadwire: Sensor **40a** on the tip portion of the pinky finger phalange **13** is positioned under the left breast.

RL leadwire: Sensor **40e** on the right wrist.

LA acting lead: Sensor **40c** on the tip portion of the index finger phalange **7** is positioned above the left breast at the left shoulder quadrant.

RA acting leadwire: Sensor **40f** on the tip portion of the thumb phalange **5** is positioned above and into the right shoulder quadrant.

C leadwire: Sensor **40b** on the palm portion is positioned at the right sternal border.

With the glove probe **12** positioned in the five leadwire scenario, it is believed that the following lead readings are possible: Lead **1**, Lead **2**, Lead **3**, AVR and AVL.

II. Alternate Five-Leadwire Scenario (yields a more dynamic waveform reading):

With the glove probe **12** rotated from the normal left breast position of the five leadwire scenario by 10 to 15 degrees toward the right breast and with the patient's free left wrist pressed against the dorsal surface **38** of the glove probe, it is believed that at least the following leadwires are possible:

LL leadwire: Sensor **40g** on the dorsal surface **38** of the glove probe **12** is positioned against the patient's left wrist.

RL leadwire: Sensor **40e** on the right wrist.

LA acting leadwire: Sensor **40c** on the tip portion of the index finger phalange **7** is positioned above the left breast at the left shoulder quadrant.

RA leadwire: Sensor **40f** on the tip portion of the thumb phalange **5** is positioned above and into the right shoulder quadrant.

C leadwire: Sensor **40b** on the palm portion is positioned at the right sternal border.

##### III. Seven-Leadwire Scenario:

With the glove probe **12** placed in the normal left breast position of the five leadwire scenario and the patient's left wrist pressed against the dorsal surface **38** of the glove probe, it is believed that at least the following leadwires are possible:

LL leadwire: Sensor **40g** on the dorsal surface **38** of the glove probe **12** is positioned against the patient's left wrist.

V2 leadwire: Sensor **40d** on the base portion of the pinky finger phalange **13** is positioned in the V2 position.

V4 leadwire: Sensor **40a** on the tip portion of the pinky finger phalange **13** is positioned in the V4 position.

RL leadwire: Sensor **40e** on the right wrist.

LA acting leadwire: Sensor **40c** on the tip portion of the index finger phalange **7** is positioned above the left breast at the left shoulder quadrant.

RA leadwire: Sensor **40f** on the tip portion of the thumb phalange **5** is positioned above and into the right shoulder quadrant.

C leadwire: Sensor **40b** on the palm portion is positioned at the right sternal border.

With the glove probe **12** positioned in the seven leadwire scenario, it is believed that at least the following lead readings are possible: Lead **1**, Lead **2**, Lead **3**, AVR, AVL, V2 and V4.

#### IV. Three-Leadwire Scenarios:

It is believed that the following leadwires are also possible:

##### Lead 1:

Positive leadwire: Sensor **40c** on the tip portion of the index finger phalange **7** is positioned above the left breast at the left shoulder quadrant.

Negative leadwire: Sensor **40f** on the tip portion of the thumb phalange **5** is positioned above and into the right shoulder quadrant.

Ground leadwire: Sensor **40e** on the right wrist.

##### Lead 2:

Positive leadwire: Sensor **40a** on the tip portion of the pinky finger phalange **13** is positioned under the left breast towards the V6 position.

Negative leadwire: Sensor **40f** on the tip portion of the thumb phalange **5** is positioned above and into the right shoulder quadrant.

Ground leadwire: Sensor **40e** on the right wrist.

##### Optional Lead 2:

Positive leadwire: Sensor **40g** on the dorsal surface **38** of the glove probe **12** is positioned against the patient's left wrist.

Negative leadwire: Sensor **40c** on the tip portion of the index finger phalange **7** is positioned above the left breast at the left shoulder quadrant.

Ground leadwire: Sensor **40e** on the right wrist.

##### Lead 3:

Position leadwire: Sensor **40a** on the tip portion of the pinky finger phalange **13** is positioned under the left breast towards the V6 position.

Negative leadwire: Sensor **40c** on the tip portion of the index finger phalange **7** is positioned above the left breast at the left shoulder quadrant.

Ground leadwire: Sensor **40e** on the right wrist.

##### Optional Lead 3:

Positive leadwire: Sensor **40g** on the dorsal surface **38** of the glove probe **12** is positioned against the patient's left wrist.

Negative leadwire: Sensor **40c** on the tip portion of the index finger phalange **7** is positioned above the left breast at the left shoulder quadrant.

Ground leadwire: Sensor **40e** on the right wrist.

##### MCL1 Lead:

Negative leadwire: Sensor **40c** on the tip portion of the index finger phalange **7** is positioned above the left breast at the left shoulder quadrant.

Positive leadwire: Sensor **40b** on the palm portion is positioned at the right sternal border.

Ground leadwire: Sensor **40e** on the right wrist.

##### MCL4 Lead:

Negative leadwire: Sensor **40c** on the tip portion of the index finger phalange **7** is positioned above the left breast at the left shoulder quadrant.

Positive leadwire: Sensor **40a** on the tip portion of the pinky finger phalange **13** is positioned in the V4 position.

Ground leadwire: Sensor **40e** on the right wrist.

It should be noted that other EKG scenarios can be accomplished at the discretion of the command center **22**. Such options are available since the following glove member positions relate to electrical heart activity as below:

G (ground) leadwire: Right wrist (sensor **40e**)

+(positive) leadwire: left wrist (sensor **40g**)

-or +leadwire: Index finger phalange **7** tip (sensor **40c**)

-(negative) leadwire: Thumb phalange **5** tip (sensor **40f**)

It should also be noted that, in the event that distortion of the EKG waveform occur due to misplacement of the glove EKG sensors **40a-g**, correction of such can be accomplished using waveform modification circuits located at the command center **22**. Such waveform modification circuitry accomplishes distortion correction utilizing waveshaping techniques which filter, compare, and re-shape into readable data.

The EKG currents, or leads, detected from the sensors **40a-40g** are transmitted to the female connection plug **48**, and through the cable **14** to the interface unit **20** where they can be sent to the command center **22** or PC **24** in a digital data stream, or to the EKG readout apparatus **26a**, as discussed above.

#### Blood Pressure and Pulse Rate Diagnostic Information

To obtain blood pressure and pulse rate diagnostic information, when the glove probe **12** wrist portion **3** is tightened around the patient's wrist, the air bladder **56** is ready to accept air pressure from the pump **23a** in the blood pressure circuit board **23**. The air pump **23a** then transmits inflation fluid, such as air, via the conduit **17**, cable **14** and air tube **60**, to the air bladder **56** to inflate the air bladder. Inflation of the air bladder **56** obliterates the radial artery. As the air bladder **56** releases the inflation fluid, pulse sound waves are acoustically picked-up by acoustical coupler **58** and are sent over the air tube **60** to the female connection plug **48**, and through the cable **14** to the interface unit **20** where they can be sent to the command center **22** or PC **24** in a digital data stream, or to the blood pressure and pulse rate readout **26b**, as discussed above.

#### Body Temperature Diagnostic Information

To obtain body temperature diagnostic information, the middle finger phalange portion **9** of the glove probe **12** is placed under the patient's tongue for a period of time sufficient to receive temperature signals from the thermistor **66**, preferably about one minute. The temperature signals from the temperature device **64** can be transmitted to the female connection plug **48**, and through the cable **14** to the interface unit **20** where they can be sent to the command center **22** or PC **24** in a digital data stream, or to the temperature readout apparatus **26c**, as discussed above.

#### %O<sub>2</sub> Diagnostic Information

To obtain %O<sub>2</sub> diagnostic information, the red LED emitter **72** (FIG. 2) emits red and infra-red light toward the LED sensor **74**. When the light from the LED emitter **72** is passed through the patient's finger (non-painted finger nails only) at the nail, the LED sensor **74** detects the color light waves present. These signals are translated from light intensity and color quality to oxygen levels. More oxygen yields a light red blood while less oxygen produces a darker red to purple blood. It should be noted that pulse rate can also be ascertained from these readings.

The %O<sub>2</sub> signals from the %O<sub>2</sub> device **70** are then sent to the female connection plug **48**, and through the cable **14** to the interface unit **20** where the %O<sub>2</sub> signals can be sent to the command center **22** or PC **24** in a digital data stream, or to the %O<sub>2</sub> readout apparatus **26d**, as discussed above.

#### Auscultation Diagnostic Information

To listen to the heart and lungs of the patient, the glove probe **12** is moved over the patient's body to enable the acoustical coupler and microphone **82** to pick up, or hear, sound waves from the patient's heart and lungs, much like a stethoscope would. The sound waves are then transmitted to the female connection plug **48**, via the pair of wires **86**, and then through the cable **14** to the interface unit **20**, where

## 11

they can be sent to the command center or PC 24, in a digital data stream as described above. Alternatively, the sound waves from the acoustical coupler of the acoustical coupler and microphone 82 could also be conducted via air tube 84 to a stethoscope 26e, as described above.

#### Oral Communication

To communicate orally with a remote location, such as the command center 22, the speaker/microphone 61 can transmit and receive sound waves as described above. It should be noted that the interface unit 20 may not be able to transmit or receive sound waves via speaker/microphone 61 when processing diagnostic information from the EKG diagnostic device, the blood pressure device 54, the temperature device 64, the %O<sub>2</sub> device 70 and/or the auscultation device 80.

While the best modes for carrying out the invention have been described in detail, those familiar with the art to which the invention relates will appreciate other ways of carrying out the invention defined by the following claims. For instance, the placement of the diagnostic devices on the glove probe 12 and/or specific design of the diagnostic devices could vary from that described above. For instance, the EKG device could have more or fewer sensors or the sensors could be located differently than that described above. Moreover, the glove probe could be adapted to be worn on the patient's left hand.

What is claimed is:

1. A system for collecting diagnostic information and transmitting the diagnostic information to a remote location, said system comprising:

a member contoured to at least a portion of a person's hand, said member comprising at least one diagnostic device, said diagnostic device comprising at least one EKG sensor capable of sensing diagnostic signals from a person; and

an interface unit in electrical communication with said member, said interface unit capable of transmitting information to a remote location, said member further comprises at least two phalange portions, said sensor being located on one of said phalange portions of said member.

2. The system of claim 1 wherein said member has a shape that corresponds to at least a substantial portion of a person's hand such that said member is capable of being worn on a person's hand.

3. The system of claim 2 where said member has a palmar side, said sensor being on said palmar side of said member.

4. The system of claim 2 wherein said diagnostic device includes at least two additional sensors.

5. The system of claim 4 wherein said diagnostic device is an EKG diagnostic device and said additional sensors comprise EKG sensors.

6. The system of claim 5 wherein said member further comprises a second diagnostic device selected from the group consisting of a blood pressure and pulse rate device, a temperature device, a percent of O<sub>2</sub> device, and an auscultation device.

7. The system of claim 2 wherein the member when worn on a first person's hand is capable of detecting diagnostic signals from a second person.

8. The system of claim 1 wherein said member comprises a glove.

9. The system of claim 2 wherein said member further comprises a palm portion and a wrist portion.

10. The system of claim 9 wherein said diagnostic device further comprises a second sensor located on said wrist portion, and a third sensor located on said palm portion.

11. The system of claim 10 wherein said diagnostic device comprises an EKG diagnostic device comprising at least seven EKG sensors.

## 12

12. The system of claim 11 wherein said member has a dorsal side with at least one of said sensors being located on the dorsal side.

13. A system for collecting diagnostic information and transmitting the diagnostic information to a remote location, said system comprising:

a member contoured to at least a portion of a person's hand, said member comprising at least one diagnostic device, said diagnostic device capable of sensing diagnostic signals from a person; and

an interface unit in electrical communication with said member, said interface unit capable of transmitting information to a remote location;

wherein said member comprises a first and a second diagnostic device, each diagnostic device being capable of detecting a different type of diagnostic information.

14. The system of claim 13 wherein said member comprises at least one phalange portion, one of said diagnostic devices including a percent O<sub>2</sub> diagnostic device comprising an LED emitter and an LED sensor, said LED sensor and LED emitter being located on said phalange portion.

15. The system of claim 13 wherein said first diagnostic device comprises an EKG diagnostic device.

16. The system of claim 15 wherein said member further includes a blood pressure device, a temperature device, and a percent O<sub>2</sub> diagnostic device.

17. The system of claim 16 wherein said member further includes an auscultation device.

18. The system of claim 16 wherein said interface unit comprises an EKG circuit board, a blood pressure circuit board, a temperature circuit board, a percent O<sub>2</sub> circuit board.

19. The system of claim 15 wherein said second diagnostic device is selected from the group consisting of a blood pressure and pulse rate device, a temperature device, a percent O<sub>2</sub> device, and an auscultation device.

20. The system of claim 19 wherein said member has a shape that corresponds to at least a substantial portion of a person's hand such that said member is capable of being worn on a person's hand.

21. The system of claim 13 wherein the member when worn on a first person's hand is capable of detecting diagnostic signals from a second person.

22. A system for collecting diagnostic information and transmitting the diagnostic information to a remote location, said system comprising:

a member contoured to at least a portion of a person's hand, said member comprising at least one diagnostic device, said diagnostic device capable of sensing diagnostic signals from a person; and

an interface unit in electrical communication with said member, said interface unit capable of transmitting information to a remote location; wherein said interface unit comprises a microphone,

23. The system of claim 22 wherein said member has a shape that corresponds to at least a substantial portion of a person's hand such that said member is capable of being worn on a person's hand.

24. The system of claim 23 wherein said member comprises a glove.

25. The system of claim 23 wherein said diagnostic device includes at least three sensors.

26. The system of claim 25 wherein said diagnostic device is an EKG diagnostic device and said sensors comprise EKG sensors.

27. The system of claim 26 wherein said member further comprises a second diagnostic device selected from the

13

group consisting of a blood pressure and pulse rate device, a temperature device, a percent of O<sub>2</sub> device, and an auscultation device.

28. The system of claim 22 wherein the member when worn on a first person's hand is capable of detecting diagnostic signals from a second person.

29. A system for collecting diagnostic information and transmitting the diagnostic information to a remote location, said system comprising:

a member comprising a palm portion, a wrist portion and at least one phalange portion, the said member comprising an EKG diagnostic device comprising a plurality of EKG sensors, wherein said EKG sensors are located on said member on at least two of said palm portion, said wrist portion, and said phalange portion; and

an interface unit in electrical communication with said member, said interface unit capable of transmitting information to a remote location.

30. The system of claim 29 wherein said EKG sensors are located on said member on said palm portion, said wrist portion and said phalange portion.

31. A system for collecting diagnostic information and transmitting the diagnostic information to a remote location, said system comprising a member contoured to at least portion of a persons hand, said member comprising a plurality of diagnostic devices, said plurality of diagnostic devices comprising at least two diagnostic devices selected from the group consisting of an EKG device, a blood pressure and pulse rate device, a temperature device, a percent O<sub>2</sub> device, and an auscultation device, said diag-

14

nostic devices being capable of sensing diagnostic signals from a person; and

an interface unit in electrical communication with said member, said interface unit capable of transmitting information to a remote location.

32. The system of claim 31 wherein said plurality of diagnostic devices comprises at least three diagnostic devices selected from the group consisting of an EKG device, a blood pressure and pulse rate device, a temperature device, a percent O<sub>2</sub> device, and an auscultation device.

33. The system of claim 31 wherein said plurality of diagnostic devices comprises at least four diagnostic devices selected from the group consisting of an EKG device, a blood pressure and pulse rate device, a temperature device, a percent O<sub>2</sub> device, and an auscultation device.

34. The system of claim 31 wherein said plurality of diagnostic devices comprises an EKG device, a blood pressure and pulse rate device, a temperature device, a percent O<sub>2</sub> device, and an auscultation device.

35. The system of claim 31 wherein said member has a shape that corresponds to at least a substantial portion of a person's hand such that said member is capable of being worn on a person's hand.

36. The system of claim 35 wherein said member comprises a glove.

37. The system of claim 31 wherein the member when worn on a first person's hand is capable of detecting diagnostic signals from a second person.

\* \* \* \* \*

专利名称(译)	远程诊断设备		
公开(公告)号	<a href="#">US6540673</a>	公开(公告)日	2003-04-01
申请号	US09/741283	申请日	2000-12-19
[标]申请(专利权)人(译)	INEEDMD.COM		
申请(专利权)人(译)	INEEDMD.COM INC.		
当前申请(专利权)人(译)	INDEEMD.COM INC.		
[标]发明人	GOPINATHAN GOVINDAN TILFORD ARTHUR R		
发明人	GOPINATHAN, GOVINDAN TILFORD, ARTHUR R.		
IPC分类号	A61B5/0205 A61B5/00 A61B5/0408 A61B5/024 A61B5/022 A61B7/00 A61B5/01 A61B5/04 A61B5/145 A61B5/1455		
CPC分类号	A61B5/0002 A61B5/02055 A61B5/6806 A61B5/022 A61B5/024 A61B5/02438 Y10S128/903 A61B5 /1455 A61B7/003 A61B2562/168 A61B5/04085		
其他公开文献	US20010000526A1		
外部链接	<a href="#">Espacenet</a> <a href="#">USPTO</a>		

摘要(译)

一种系统 ( 10 ) , 用于收集多个诊断信息并将诊断信息发送到远程位置。该系统 ( 10 ) 包括适于佩戴在人的手上的手套构件 ( 12 ) 和与手套构件 ( 12 ) 电连通的接口单元 ( 20 ) 。接口单元 ( 20 ) 能够向远程位置发送信息和从远程位置接收信息。手套构件 ( 12 ) 包括手掌部分 ( 1 ) , 手腕部分 ( 3 ) 和五个趾骨部分 ( 5-13 ) 。手套构件 ( 12 ) 还包括EKG诊断装置, 血压和脉搏率诊断装置 ( 54 ) 和温度装置 ( 64 ) 。手套构件 ( 12 ) 还可以进一步包括 %O<sub>2</sub> 诊断装置 ( 70 ) 和听诊装置 ( 80 ) 。

