



(12) **EUROPEAN PATENT APPLICATION**

(43) Date of publication:  
**20.11.2013 Bulletin 2013/47**

(51) Int Cl.:  
**A61G 7/015 (2006.01) A61G 7/05 (2006.01)**  
**A61B 5/00 (2006.01)**

(21) Application number: **13179526.2**

(22) Date of filing: **09.07.2010**

(84) Designated Contracting States:  
**AL AT BE BG CH CY CZ DE DK EE ES FI FR GB GR HR HU IE IS IT LI LT LU LV MC MK MT NL NO PL PT RO SE SI SK SM TR**

- **Stanley, Timothy A.**  
**Indianapolis, IN Indiana 46241 (US)**
- **O'Keefe, Christopher R.**  
**Batesville, IN Indiana 47006 (US)**

(30) Priority: **10.07.2009 US 224851 P**  
**15.07.2009 US 225920 P**

(74) Representative: **Findlay, Alice Rosemary**  
**Reddie & Grose LLP**  
**16 Theobalds Road**  
**London WC1X 8PL (GB)**

(62) Document number(s) of the earlier application(s) in accordance with Art. 76 EPC:  
**10251235.7 / 2 272 479**

(71) Applicant: **Hill-Rom Services, Inc.**  
**Batesville, IN 47006-9167 (US)**

Remarks:

This application was filed on 07-08-2013 as a divisional application to the application mentioned under INID code 62.

(72) Inventors:  
 • **Soderberg, Peter H.**  
**Boca Grande, FL Florida 33921-1023 (US)**

(54) **Systems for patient support, monitoring, and treatment**

(57) A hospital bed (10) comprises a frame (12); hospital bed electronics (45) carried by the frame (12), the hospital bed electronics (45) controlling each of the following: movement of portions of the frame (10) to reposition a patient, operation of an IV pump, operation of a vital signs monitor, and operation of a therapy device; at

least one barrier (16, 18) coupled to the frame (10); and at least one graphical display (91, 92, 97, 98) that is included as part of the barrier (16, 18) and that displays information pertaining to operation of the IV pump, information pertaining to operation of the vital signs monitor, and information pertaining to operation of the therapy device.

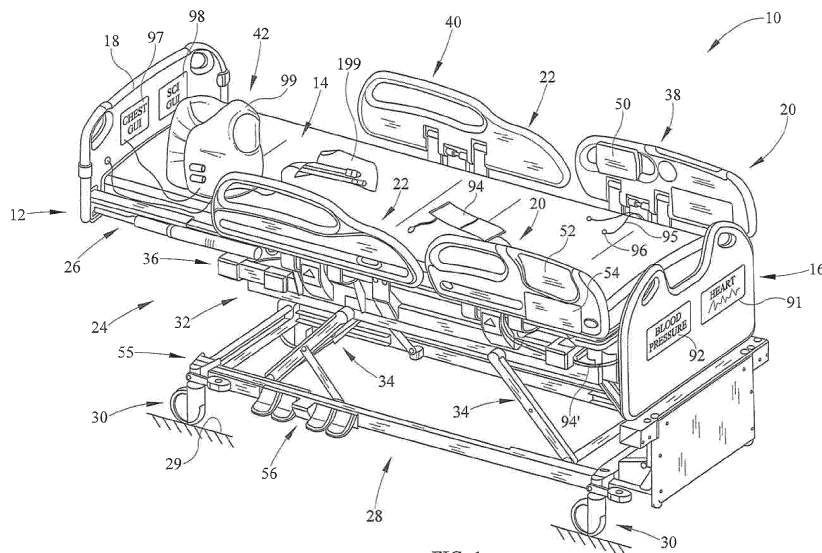

FIG. 1

## Description

**[0001]** The present disclosure relates generally to patient support systems, such as beds, stretchers, wheelchairs and the like. More particularly, the present disclosure relates to patient supports having therapy delivery devices and/or physiologic monitoring devices integrated therewith.

**[0002]** Patient support systems such as hospital beds conventionally have features adapted to provide comfort to the patient, as well as to assist the caregiver in positioning and transporting the patient. For example, such beds can include articulating sections to allow the patient to be placed in a variety of positions, for comfort of the patient and to assist the caregiver in caring for the patient. Such beds might also include electronic displays to indicate the status of the various features of the bed, such as the brake status, the siderail position, and the bed height. Additionally, such beds can allow for communications with caregivers via audio components.

**[0003]** While such patient support systems can be very useful in assisting caregivers and providing improved safety and comfort to patients, additional medical device and therapy capabilities are oftentimes not included in the conventional patient support systems. Some prior art patient support systems do have therapy and physiologic monitoring devices integrated therein, however. See, for example, U.S. Patent Nos. 5,664,270; 5,715,548; 6,493,568; 6,899,103; 7,038,588; 7,154,397; 7,343,916; 7,515,059; 7,641,623 and U.S. Patent Application Publication Nos. 20080126132; 20080005838; and 20050190068. However, a need persists for further contributions in this area of technology.

**[0004]** The present invention comprises one or more of the following features alone or in any combination.

**[0005]** According to this disclosure, a hospital bed may comprise a frame, a plurality of siderails coupled to the frame, a headboard coupled to the frame, and a footboard coupled to the frame. The hospital bed may further comprise a physiologic monitor sensing at least one physiologic parameter of a patient supported by the frame, and a plurality of graphical displays. A first graphical display of the plurality of graphical displays may be included as part of a first siderail of the plurality of siderails and a second graphical display of the plurality of graphical displays may be included as part of one of the headboard and the footboard. Each of the first and second graphical displays may be operable to display the physiologic parameter sensed by the physiologic monitor.

**[0006]** The second graphical display may be included as part of the headboard and may face away from the frame. A third graphical display may be included as part of the headboard. The second graphical display may display data relating to a first physiologic parameter of the patient and the third graphical display may display data relating to a second physiologic parameter of the patient. The second and third graphical displays may be located in spaced-apart, side-by-side relation on the headboard.

**[0007]** In some embodiments, the second graphical display may be included as part of the footboard and may face toward the frame. A third graphical display may be included as part of the footboard as well. The second graphical display may display data relating to a first physiologic parameter of the patient and the third graphical display may display data relating to a second physiologic parameter of the patient. The second and third graphical displays may be located in spaced-apart, side-by-side relation on the footboard.

**[0008]** According to an aspect of the present disclosure, a hospital bed may comprise a physiologic monitor sensing at least one physiologic parameter of a patient supported by the frame and a pneumatic therapy device operable to delivery therapy to the patient. The hospital bed may further comprise a plurality of graphical displays. A first graphical display of the plurality of graphical displays may be included as part of a headboard and a second graphical display of the plurality of graphical displays may be included as part of the footboard. One of first and second graphical displays may show information pertaining to one of the physiologic monitor and the pneumatic therapy device. The other of the first and second graphical displays may show information pertaining to the other of the physiologic monitor and the pneumatic therapy device.

**[0009]** In some embodiments, the first graphical display shows data pertaining to the physiologic monitor and the second graphical display shows information pertaining to the pneumatic therapy device. The pneumatic therapy device may comprise a respiratory therapy garment worn by a patient for high frequency chest wall oscillation therapy. Alternatively or additionally, the pneumatic therapy device may comprise a sequential compression therapy sleeve worn by a patient for prevention of deep vein thrombosis. The hospital bed may have a third graphical display included as part of a first siderail of the plurality of siderails. The third graphical display may show information pertaining to at least one of the physiologic monitor and the pneumatic therapy device.

**[0010]** According to another aspect of the present disclosure, a hospital bed may comprise a frame and hospital bed electronics carried by the frame. The hospital bed electronics may control each of the following: movement of portions of the frame to reposition a patient, operation of an IV pump, operation of a vital signs monitor, and operation of a therapy device.

**[0011]** The hospital bed may have at least one barrier coupled to the frame as well as having at least one graphical display that is included as part of the barrier. The at least one graphical display may display information pertaining to operation of the IV pump, information pertaining to operation of the vital signs monitor, and information pertaining to operation of the therapy device.

**[0012]** The hospital bed may have user inputs that are carried by the barrier and that are usable to command the hospital bed electronics regarding control of the operation of the IV pump, the vital signs monitor, and the

therapy device. The therapy device may comprise a respiratory therapy garment worn by a patient for high frequency chest wall oscillation therapy or a sequential compression therapy sleeve worn by a patient for prevention of deep vein thrombosis.

**[0013]** The hospital bed electronics may communicate via wireless signals with at least one computer device that is spaced from the hospital bed. In some embodiments, the hospital bed electronics may include a patient audio port to which a patient may attach a personal audio player. In some instances, the hospital bed electronics may be communicatively coupled via a hospital network to a medical records system and further comprising a keyboard coupled to the hospital bed electronics for entering patient vital signs information into a patient medical record via the hospital bed electronics.

**[0014]** According to one illustrative embodiment, a patient support system is provided comprising a deck, a base, a patient sensor, and an edge board along the deck. The deck is configured to support a patient, and the base supports the deck. The patient sensor is configured to monitor a vital sign of the patient. The edge board is positioned along an edge of the deck and supported by the base. The board includes a user interface configured to provide an indication of the status of the vital sign. The board may comprise an endboard or a siderail, for example, and may include other user functions for control of the deck.

**[0015]** According to another embodiment, a patient support system, comprising a deck configured to support a patient, a base supporting the deck, and a patient sensor configured to monitor a vital sign of the patient. The system further includes a component sensor configured to monitor the status of a component on the patient support, such as an actuator for example. An electronic circuit provided on the patient support system is configured to receive signals from the patient sensor and the component sensor. The system further includes a siderail board which is positioned adjacent a side edge of the deck, and an endboard which is positioned adjacent an end edge of the deck. In addition, the system includes a user interface system which is supported by the endboard and/or siderail. The user interface system is configured to receive signals from the electronic circuit to indicate the status of the patient vital sign and the component sensor.

**[0016]** In accordance with another embodiment, a patient support system is provided, which comprises a deck configured to support a patient, a base supporting the deck, a power cord configured to provide electrical power to the patient support system, and a patient monitor supported by the base and configured to monitor a vital sign of the patient. The system also includes a component sensor supported by the base and configured to monitor the status of a component on the patient support, and a pump supported by the base and configured to deliver therapy and/or medication to the patient. An actuator is supported by the base and configured to move at least

a portion of the deck relative to the base. The system further includes a user interface system supported by the base. The user interface system is configured to receive signals from the component sensor and the patient monitor and to allow control of the actuator and the pump. In addition, the patient support system includes a power circuit configured to receive the electrical power from the cord and provide power to the actuator, the pump, the patient monitor, and the user interface system.

**[0017]** In another embodiment, a patient support system is provided which comprises a deck configured to support a patient, a base supporting the deck, a power cord configured to provide electrical power to the patient support system, and a patient monitor circuit supported by the base and configured to monitor a vital sign of the patient. The patient support system further includes a component sensor supported by the base and configured to monitor the status of a component of the patient support system, and a pump supported by the base and configured to deliver therapy and/or medication to the patient. In addition, the system includes an actuator supported by the base and configured to move at least a portion of the deck relative to the base, and a user interface system supported by the base. The user interface system is configured to receive signals from the component sensor and the patient monitor and to allow control of the actuator and the pump. The patient support system further includes a microprocessor board supported by the base and configured to control operation of the pump and the actuator and to receive signals from the component sensor and the patient monitor circuit. Additionally, the patient support system of this embodiment includes a communication circuit supported by the base and connected with the microprocessor board. The communication board is configured to communicate signals indicating the status of the component sensor and at least one of the pump and patient monitor circuit to a remote location, such as to nurses station down the hall from the hospital room within which the patient support system is located. The patient support system further includes a power circuit configured to receive the electrical power from the cord and provide power to the actuator, the pump, the patient monitor, the microprocessor board, the communication circuit, and the user interface system.

**[0018]** According to another embodiment, a patient support system is provided comprising a deck configured to support a patient, a base supporting the deck, an actuator configured to move the deck relative to the base, and a pump supported by the base. In addition, the system includes a connector supported by the base and configured to place the pump into fluid communication with an air mattress, and a connector supported by the base and configured to place the pump into fluid communication with at least one of a sequential compression therapy device, a chest wall oscillation device, and a medication pumping device. Furthermore, the system includes a control system supported by the base and configured to control the actuator and the pump. Additionally, the pa-

tient support system includes a user interface system supported by the base and configured to modify the control of the control system to control the actuator and the pump, to thereby allow user control of the actuator, the mattress, and at least one of the sequential compression therapy device, the chest wall oscillation device, and the medication pumping device. Accordingly, the user can control the patient support (e.g., bed) functions, the air mattress, and medical equipment through the bed.

**[0019]** In another embodiment, a patient support system is provided comprising a deck configured to support a patient, a base supporting the deck, an actuator configured to move the deck relative to the base, a board such as an endboard configured to locate an edge of the deck, and an audio connector provided on the board and configured to receive a plug from an audio device. In addition, the patient support system includes a speaker supported by the base, and an electronics system supported by the base and configured to control the actuator and to drive the speaker according to the signal from an audio device. Accordingly, audio from devices such as MP3 players, laptops, cell phones, and the like can be played directly through the bed systems. In some embodiments, instead of or in addition to the audio connector, the endboard can include a data connector to connect the patient support system to a health information system or an electronic medical records system.

**[0020]** In yet another embodiment, a patient support system is provided comprising a deck configured to support a patient, a base supporting the deck, an actuator configured to move the deck relative to the base, a board configured to locate an edge of the deck, and a telephone storage recess provided on the board and configured to receive a telephone. In addition, the patient support system includes an electronics system supported by the base and configured to control the actuator and to control the communication of signals to and from a telephone. The electronics may connect wired or wireless to the phone and to a PBX or cellular system to allow the patient to place calls directly from the bed and via the bed system.

**[0021]** According to one embodiment, a patient support system is provided, comprising a deck configured to support a patient, a base supporting the deck, and an actuator configured to move the deck relative to the base. The system further comprises at least at least one board such as an endboard or footboard or siderail configured along at least one edge of the deck and supported by the base. The board includes at least one user interface configured to control the actuator. The user interface is further configured to control or monitor medical equipment, such as SCT equipment, hear rate monitors, blood pressure monitors, respiratory therapy equipment and the like. The patient support system comprises one or more of an obstacle detection system, a bed exit alarm system, a head of bed angle alarm system, a safety indicator indicating the bed is in a safe condition, a scale system, a powered transport system, and a patient turn assist system.

**[0022]** According to another embodiment, a patient support system is provided comprising a deck configured to support a patient, a base supporting the deck, an actuator configured to move the deck relative to the base.

5 The patient support system further comprises an electronic control system supported by the base and provided at one location along the patient support system, such as at the base, under the deck, in an endboard or the like. The electronic control system is configured to control the actuator and to receive signals from and/or provide signals to at least one of a consumer electronics device, a patient monitoring device connected to the patient, and a patient therapy device attached to the patient. Other electronics can also be provided throughout the patient support system. The patient support system further comprises one or more of an obstacle detection system, a bed exit alarm system, a head of bed angle alarm system, a safety indicator indicating the bed is in a safe condition, a scale system, a powered transport system, and a patient turn assist system.

**[0023]** The invention will now be further described by way of example with reference to the accompanying drawings, in which:

**[0024]** Fig. 1 is a perspective view of a patient support showing a patient support according to one embodiment including one or more principles of the present disclosure;

**[0025]** Fig. 2 is a side elevation view of the patient support of Fig. 1, showing the deck support in an upper position and the deck sections in a linear relationship or bed configuration;

**[0026]** Fig. 3 is a side elevation view of the patient support of Fig. 1, showing the deck support in the upper position of Fig. 2 and a head section of the deck elevated by a head section actuator and a seat section of the deck elevated by a seat section actuator;

**[0027]** Fig. 4 is a block diagram illustrating communication between the control system and various components of the patient support according to one or more principles of the present disclosure;

**[0028]** Fig. 5 is a side view of a patient support system according to another embodiment, in accordance with one or more principles of the present disclosure;

**[0029]** Fig. 6 is a perspective view of a footboard for a patient support, according to another embodiment of the present disclosure;

**[0030]** Fig. 7 is a perspective view of another embodiment of a patient support system and surrounding hospital infrastructure, in accordance with one or more principles of the present disclosure;

**[0031]** Fig. 8 is a block diagram of yet another embodiment of a patient support system, in accordance with one or more principles of the present disclosure;

**[0032]** Fig. 9 is a perspective view of another embodiment of a patient support system in the form of a hospital bed, according to one or more principles of the present disclosure;

**[0033]** Fig. 10 is a side perspective view of a sideboard

or siderail and associated user interface, according to one or more principles of the present disclosure;

**[0034]** Fig. 11 is a schematic view of a patient support system according to another embodiment having one or more principles of the present disclosure;

**[0035]** Fig. 12 is a schematic view of another embodiment of a patient support system having one or more principles of the present disclosure;

**[0036]** Fig. 13 is a perspective view of a patient support system and of the siderail thereof, according to another embodiment having one or more principles of the present disclosure;

**[0037]** Fig. 14 is a side view of a patient support system and a perspective view of the endboard of a patient support system, according to another embodiment having one or more principles of the present disclosure;

**[0038]** Fig. 15 is a cross-section view of an illustrative embodiment of a siderail 20', such as that of Fig. 5, having an incorporated display 529 for a patient monitor or other medical equipment, according to principles of the present disclosure; and

**[0039]** Fig. 16 is a block diagram of an illustrative embodiment of a bed control system having a medical equipment interface, according to principles of the present disclosure.

**[0040]** In general, a patient support system is provided having an electronic control system and user interface. In one embodiment, the electronic control system and user interface are provided on a hospital bed and can control bed functions, such as articulation of the head, seat, and leg sections of the bed deck. The electronic control system and user interface of the bed are also configured to control and/or monitor the operation of medical equipment, such as heart rate monitors, blood pressure monitors, thermometers, sequential compression therapy devices, blood warmers, IV pumps, chest wall oscillation devices, respiratory therapy devices, blood oxygen monitors, and the like. In addition, in some embodiments, the electronic control system and user interface of the bed are also configured to communicate with patient personal digital devices, such as audio players, computers, and phones. Furthermore, the electronic control system and user interface of the bed in some embodiments are configured for audio and data communication, wired or wirelessly, with remote hospital computers and communication devices. In one embodiment, a pump system is resident on the bed and is controlled by the electronic control system and user interface, for control of a powered air mattress on the bed deck, and for control of one or more pieces of medical equipment that utilize an air pump. The user interface may be provided in one or more of the endboards of the bed (such as the headboard or footboard) and/or on a siderail board of the bed.

**[0041]** A patient support 10 according to an illustrative embodiment of the present disclosure is shown in Figs. 1- 3. Patient support 10 includes a frame 12, a mattress 14 supported by frame 12, a headboard 16, a footboard

18, a pair of head end siderails 20, and a pair of foot end siderails 22. Frame 12 includes a deck support 24 and a deck 26 supporting mattress 14. Deck support 24 includes a base frame 28 supported on the floor 29 by a plurality of caster wheels 30, an intermediate frame 32, first and second pairs of lift arms 34 configured to raise and lower intermediate frame 32 relative to base frame 28, and a weigh frame 36 supported by intermediate frame 32, so as to allow the patient support 10 to be raised and lowered to any position between a high and a low position.

**[0042]** Deck 26 is supported by weigh frame 36 and is configured to articulate between a plurality of positions. More particularly, deck 26 illustratively includes a head section 38 pivotably coupled to weigh frame 32, a seat section 40 pivotably coupled to weigh frame 32, and an adjustable length leg section 42 pivotably coupled to seat section 40. The deck 26 is illustrated in a first configuration in Figs. 1 and 2, while the deck 26 is illustrated in a second configuration in Fig. 3. In the first configuration of Figs. 1 and 2, head section 38, seat section 40, and leg section 42 are in a substantially linear or planar relationship. In the second configuration of Fig. 3, head section 38 of deck 26 is elevated by a head section actuator 43a and seat section 40 of deck 26 is elevated by a seat section actuator 43b. A leg section actuator 43c is likewise configured to move leg section 42 relative to seat section 40. An extension actuator 44 is configured to extend and retract the adjustable length leg section 42.

**[0043]** Additional details of illustrative deck support 24 and deck 26 may be found in U.S. Pat. No. 6,658,680, issued Dec. 9, 2003 and U.S. Pat. No. 6,611,979, issued Sep. 2, 2003.

**[0044]** Head end siderails 20 are coupled to head section 38 of deck 26 and may be moved relative to mattress 14 between raised and lowered positions. Foot end siderails 22 are coupled to weigh frame 32 and may also be moved relative to mattress 14 between raised and lowered positions.

**[0045]** Referring now to FIG. 4, a control system 45 provides control of various functions of patient support 10. Control system 45 operates and monitors linear actuator 44 to extend and retract adjustable length leg section 42, and linear actuators 48 to move intermediate frame 32 relative to base frame 28. Control system 45 further operates and monitors linear actuators 43a, 43b and 43c to move head section 38 relative to weigh frame 36, seat section 40 relative to weigh frame 36, and leg section 42 relative to seat section 40, respectively.

**[0046]** Control system 45 includes a plurality of input devices including a detachable siderail controller 50 configured to removably couple to any of head and foot end siderails 20, 22, a first pair of permanent siderail controllers 52 coupled to head end siderails 20, a second pair of permanent siderail controllers 54 pivotably coupled to head end siderails 20, and a pair of foot pedal controls 56 coupled to base frame 28.

**[0047]** Control system 45 also illustratively includes an

interference detection device 55 coupled to base frame 28 to detect possible clearance issues between intermediate frame 32 and base frame 28. Control system 45 further illustratively includes a plurality of actuator position detectors or motor sensors (not shown) provided with each of the plurality of actuators 43a, 43b, 43c, 44, 48. A plurality of load cells 59 are provided between weigh frame 36 and intermediate frame 32 to provide signals that indicate the weight supported by intermediate frame 32. Control system 45 uses these signals to determine the weight of a patient positioned on mattress 14. Additionally, control system 45 illustratively includes a plurality of siderail position detectors or sensor 57 configured to provide signals indicative of the vertical position of siderails 20, 22.

**[0048]** As previously described and as shown in FIG. 1, deck support 24 includes a base frame 28 supported on the floor 29 by a plurality of caster wheels or caster devices 30, an intermediate frame 32, first and second pairs of lift arms 34 configured to raise and lower intermediate frame 32 relative to base frame 28, and a weigh frame 36 supported by intermediate frame 32. Linear actuators 48a and 48b, shown in FIG. 3, provide power to actuate lift arms 34 and in turn to raise and lower intermediate frame 32 relative to base frame 28.

**[0049]** Control panel 698 includes a series of buttons 710 for controlling the various functions of hospital bed 10. Deck 26 includes head, seat, thigh and foot portions or sections that can be tilted relative to intermediate frame 52 and several mechanisms configured to adjust the angular position of these deck sections. As will be described in greater detail below, foot section of deck 26 is extendable, seat section of deck 26 can be tilted relative to intermediate frame 52, head section of deck 26 can be tilted relative to intermediate frame 52.

**[0050]** As shown best in FIGS. 1 and 4, the bed 10 is configured to connect with, control, and monitor a wide variety of devices and equipment. In this example, the endboard 16 is fitted with a pair of displays 91 and 92 for controlling and/or monitoring the operation of a blood pressure sensor and a heart rate sensor, which may be connected to the patient. In this example, the electrical and/or air lines 94' for the blood pressure monitor 94 are managed by attachments (clips, conduits, notches and the like) on the bed frame 36 and/or 55 and connect to an electronic control system (e.g., FIG. 4) resident on the bed (e.g., supported by the base frame 28 by housing the system in or on the frame 32, the endboard 18 and/or the endboard 16). The same is true for the heart rate monitor and its associated lines 95 which connect the sensors/electrodes 96 back to the heart rate monitoring electronics which are resident in the bed's electronic system that are supported by the base frame 28. (Supported as used herein is not limiting and encompasses both indirect and direct support.) Accordingly, the electronics which control the heart rate and blood pressure monitoring are resident on the bed and part of the bed's overall electronic control system. These monitoring tasks and/or

the control tasks of the bed can be accomplished using one or more microprocessors resident in the bed's electronic system.

**[0051]** As also shown in FIG. 1, provided in the footboard 18 are GUI's 97 and 98 which can allow for control and/or monitoring of additional devices via the bed's resident electronic system. Here, GUI 98 controls and monitors a sequential compression therapy (SCT) electronics (e.g., processor, circuit or software) that provides SCT therapy to a sleeve 199, to treat deep vein thrombosis (DVT). Additionally, GUI 97 provides control and/or monitoring of a portion of the electronics in the bed that controls respiratory/chest therapy, such as via a respiratory therapy garment 99. Such therapy can comprise high frequency chest wall oscillation for example. Again, the software and/or hardware that control the respiratory therapy and the SCT therapy are part of the bed's electronic control system and can also control other bed functions.

**[0052]** As shown in the block diagram of FIG. 4, the system includes a user interface system 80 resident on the bed and supported by the base frame which controls not only the bed functions, but also the monitoring and therapy equipment functions via a main electronic control system 81. Control system 81 may include digital signal processing functions, input/output control functions, closed loop control functions, and other logic to control these various features of the bed. One or more microprocessors 82 can execute software and/or firmware to provide such control. In this example, in addition to the various bed functions controlled by the bed, control system 81 also controls air mattress control electronics 83 (hardware and/or software) for control of a pump 86 to control bladders in an air mattress 87. Additionally, control system 81 controls chest wall oscillation electronics 84 that control pump 86 to control the respiratory therapy garment 99, such as one worn on the upper body. Moreover, control system 81 controls SCT electronics 85 for control of an SCT garment 199, such as one worn on the foot or leg. In addition, control system 81 also monitors blood pressure electronics 77 that receive signals from and/or provides control of a blood pressure cuff 94 via lines 94'. Additionally, heart rate monitor electronics 79 are resident in the bed's electronic system and controlled by the control system 81 to monitor the patient's heart rate as monitored by electrodes 96 via lines 95.

**[0053]** As shown in FIG. 6, as another alternative, a footboard can be fitted with patient and/or vital signs monitor device controls and/or readouts and used with a bed, such as the bed of FIG. 1. This embodiment includes a modular control unit 692 for controlling the automated features of hospital bed 10. Footboard 18 further includes a base 694 and modular control unit 692 includes a support panel 696 slidably coupled to base 694 and a control panel 698 pivotably coupled to support panel 696. Control panel 698 is rotatable between a use position, as shown in FIG. 6, and a storage position in a recess 699 formed in support panel 696. Support panel 696 is also

formed to include a notch 697 in which a caregiver can grab a distal end of control panel 698 to rotate it back to the use position. Series of buttons 710 also includes a third pair of buttons 714 for raising and lowering back section relative to intermediate frame and a fourth pair of buttons 716 for simultaneously raising and lowering seat and back sections. Another set of buttons 718 is provided for controlling the various functions of a mattress on the bed. Series of buttons 710 includes a first pair of buttons 711 for raising and lowering intermediate frame (e.g., 32 of the embodiment of FIG. 1) and a second pair of buttons 712 for raising and lowering seat section (e.g., 40 of the bed of FIG. 1).

**[0054]** Control panel 698 further includes a display 719 for monitoring the status of the various functions of hospital bed. According to an alternative embodiment, the series of buttons also includes a pair of buttons for moving the intermediate frame between the Trendelenburg and reverse Trendelenburg positions, extending and retracting the foot section of the deck, and any other function of the bed. Control panel 698 can also include buttons and a display associated with a bed exit and weighing system of bed. Here, patient vital signs and/or other monitoring information about the patient are displayed on interface 696. This interface 696 may be a display, such as an LCD and/or light indicators, or other device for displaying information to the user.

**[0055]** As shown in FIG. 6, control unit 692 is removable from base 694 to permit replacement of control unit 692 for repairs or upgrading. Multiple configurations of modular control units can be provided at the manufacturing facility. Depending on the specific configuration of the hospital bed, a different control unit can be provided with the respective hospital bed by sliding the respective control unit into standard base 694.

**[0056]** As further shown in FIG. 6, the endboard 18 can include a screen or other display 696 which indicates the status of one or more patient monitors. The monitors may be integrated with the bed, as described in further detail above, or may be plugged into data ports on the bed. The patient monitors may monitor vital signs such as heart rate, respiration rate, temperature, blood pressure, blood oxygen saturation, and other signs regarding the patient. Accordingly, in this embodiment, a single user interface, and circuitry associated therewith, can be utilized for control of the patient support system and for monitoring the patient.

**[0057]** As shown in FIG. 9, in another embodiment a hospital bed 100 is provided including a base frame 120 positioned on the floor, a deck 140 coupled to frame 120, a mattress 130 positioned on deck 140, a headboard 160 coupled to frame 120, a footboard 180 coupled to deck 140, and a pair of split siderails 200, 210 coupled to frame 120. Frame 120 is configured to raise and lower deck 140 relative to the floor and to move deck 140 to the Trendelenburg position and the reverse Trendelenburg position.

**[0058]** As shown in FIG. 9, headboard or first board

160 includes a curved base 300 coupled to frame 120 and a center panel 340 removably coupled to base 300. Base 300 includes a pair of handles 480 to facilitate pushing hospital bed 100 about a care facility. In this embodiment, center panel 340 can be removed from base 300 to allow for retrofitting of new user interface headboards based on the desired capabilities of the bed. The removability of center panel 340 can also permit access to the patient during such a procedure from a head end of hospital bed 100.

**[0059]** Base 300 may be formed to include a pair of grooves configured to receive tongues 440 of center panel 340 so that center panel 340 is slidably coupled to base 300. As shown in FIG. 9 frame 120 can include a rectangular lower frame member or base frame 320, a plurality of casters 500 coupled to base frame 320, to permit hospital bed 100 to be rolled about a care facility, a rectangular upper frame member or intermediate frame 520, a linkage system 540 coupled to intermediate and base frames 520, 320 to permit relative motion therebetween, and an actuator system 560 providing power to actuate linkage system 540 and move upper member 520 relative to base frame 320. Linkage system 54 includes a pair of head links 580 pivotably coupled to a head end 530 of intermediate frame 520 and slidably coupled to base frame 320, a pair of foot links 600 pivotably coupled to a foot end 550 of intermediate frame 52 and slidably coupled to base frame 320, and a pair of guide links 620 pivotably coupled to respective foot links 600 and pivotably coupled to base frame 320 at a fixed pivot point.

**[0060]** In this embodiment, the module 692 which is movable into and out of engagement with the footboard 694 comprises a display, such as a graphical user interface LCD or the like, which monitors the operation of and/or allows control of a pump. The pump may be an IV pump, an air pump for the mattress 260, an air pump for a sequential compression therapy device (for DVT), an air pump for a respiratory therapy (such as high frequency chest wall oscillation therapy), or other medical pump. In addition, in this embodiment, the headboard panel 340 includes a display 360 (e.g., lights, screen, and/or GUI) for controlling the operation of and/or monitoring a patient vital signs monitor. In addition, the board 340 includes a display 441 for monitoring and/or controlling the bed functions, such as the hi-lo function, the articulation functions, and the Trendelenburg functions.

**[0061]** Another embodiment of a patient support apparatus having a multifunctional unified control and user interface system is shown in FIG. 5. Here the base frame 28' support an intermediate frame 32' and a deck 15' upon which rests a mattress 14'. Actuators 31' move links 34' to permit movement of the frame 32' relative the base 28'. Casters 30' allow for movement of the bed. Various boards are provided along edges of the bed to locate the edges of the bed and assist the patient and caregiver. In particular, endboards in the form of headboard 16' and footboard 18' are provided at the short sides of the bed

and various side boards, also known as siderails 20' and 22' are provided at the long sides of the bed. Each of these boards in this example provides controls or user interface capabilities for hospital equipment and/or patient devices. For example, siderail 22' includes a GUI 521 for controlling and/or monitoring the status of a pump for use in treating DVT, a GUI 523 for use in controlling and/or monitoring the actuators on the bed, and a GUI 525 for controlling and/or monitoring the status of an intravenous (IV) pump. The IV pump can be located on the bed and supported by the base 28' and used to deliver fluid from IV bag 543, which is retained on IV pole 541, through line 545, through the pump and ultimately through line 547 to the patient vein. The lines 545 and 547 can be retained to the deck 15, the frame 32', and/or the base 28', via suitable connectors, conduits, clips, and/or retainers. Like the IV pump and its associated electronics, the DVT pump and its associated electronics can likewise be provided on and built into the bed infrastructure. The DVT pump can thus provide SCT therapy through line 557 to DVT sleeve 559 on the patient's lower extremity. Additionally, siderail 20' includes a GUI 526 for controlling the bed actuators, and a monitor GUI 529 for controlling and/or monitoring the status of patient vital sign monitors. The monitor GUI 529 receives its signal from sensors 561 and 563 that connect to the patient and which contain cords or lines that can be run along or contained within the frame 32', deck 15' and/or base 28'. The electronics that run the various pumps and monitors can be built into the bed electronics system and unified or integrated therewith.

**[0062]** The headboard 16' of the bed of FIG. 5 includes an AC power outlet 571 for providing AC electrical power to external devices through the bed's infrastructure, as well as an audiovisual connector 573 for allowing an AV component to be hooked to the bed and communicate through the bed's electronic system. For example, an MP3 player or laptop could be hooked up to connector 573 and can play music through the bed's speakers (not shown). In this example, headboard 16' also includes a connector 581 to provide air to the air mattress 14' via air line 582 which connects to an air port 583 on the mattress. The pump that provides the air can be the same pump as the pump that provides the SCT therapy to the sleeve 559, or can be a separate pump, both of which are mounted to the base 28', frame 32', endboards 16'/18', and/or deck 15'. Footboard 18' likewise includes ports for hooking to external devices. In this example, a USB (universal serial bus) port 575 is provided on footboard 18' to allow devices to be powered from and/or communicate with the bed electronics system, and a LAN (local area network) port 577 is provided to allow devices to access a network and/or the Internet from the bed electronics.

**[0063]** A wireless phone 593 is mounted to the siderail 22', such as via a mounting port or station or via a connector or other attachment. The wireless phone 593 can wirelessly communicate with electronics in the bed to allow the phone to be used for calls within the hospital or

external calls to the public.

**[0064]** Another embodiment is shown in FIG. 7. This embodiment includes a bed status system 11, which is integrated with a patient/nurse call system 10' in accordance with a contemplated embodiment of the present disclosure. While bed status system 11 provides bed status information, the patient/nurse communication system 10' organizes, stores, maintains and facilitates retrieval of bed status information, along with the various non-bed calls placed in a hospital wing or ward, thereby optimizing communication capabilities among nurses and patients 12. More specifically, FIG. 7 shows a patient room 14' accessible from a hall 15' of the hospital wing, and a patient bed 16 located in the room 14'. Patient bed 16 is equipped with a variety of mechanical and electrical systems to assist hospital personnel in patient care. The state or condition of each of these systems is detected by circuitry included on bed 16. For example, patient bed 16 includes headrails 17a, 17b and footrails 19a, 19b for assisting a patient within the bed. The rails have an up or latched position, as indicated, by headrail 17b, and a down or unlatched position as indicated by headrail 17a. Each headrail 17a, 17b or footrail 19a, 19b of patient bed 16 is equipped with a latch sensor, such as headrail latch sensor 25 and footrail latch sensor 27 to detect whether the respective rails are in the latched or unlatched position. Furthermore, bed 16 is equipped with a patient exit detection system which includes pressure sensitive sensor strips 29 to detect whether the patient 12 has exited the bed or is still in the bed. The patient exit detection system may be armed or disarmed and a sensor (not shown in FIG. 1) indicates whether the system is armed. Other bed system conditions are also detected on bed 16 by various sensor systems. For example, in one embodiment contemplated by this disclosure, bed 16 is equipped with a sensor to indicate whether the bed break is set, a sensor to indicate whether the bed is at its lowest position, and a sensor to indicate whether the mattress 31 is in a particular firmness mode to enhance the comfort of the patient. Furthermore, other various features and functions of the bed might be monitored in accordance with the principles of the present disclosure. The various sensed bed conditions are associated with sensor signals, and the signals are presented via hard wire connections 33 to a bed electronics and interface board 35. Interface board 35 is connected through a junction box 37 to a serial cable 39 and plug 39p which, in turn, connects to a wall interface unit 40, which couples the bed status information to a patient/nurse communication system 10'. As part of the patient/nurse communication system 10' utilized with this embodiment, a patient station 41 is mounted to a head wall of the patient room 14' as shown in FIG. 7. The patient station 41 is connected by a hardwire connector 43 to wall interface unit 40, with connector 43 located behind the headwall of the room 14'. A pillow unit 44, on bed 16, connects via cable 45 to a bed outlet or plug 45p of the wall interface unit 40. Additionally, cable 39 plugs into a bed outlet or plug 39p

of the interface unit 40, while a second end of the cable 39 is electrically coupled to bed interface board 35 through junction box 37.

**[0065]** Like the embodiments described above, the bed of FIG. 7 can include one or more side or end boards which display or control other medical devices. Here, a user interface 719 is mounted in the headboard 100' to allow for vital signs of the patient to be displayed. Such vital signs can come from wireless electrodes 721 placed on the patient. A communication board 723 in the bed electronics receives signals from the electrodes 721 as well as from other devices. For example, the communication board 723 can wirelessly communicate bed and/or patient data to a remote computer 725 and/or a nurse call station 727 which are external to the hospital room 14'. The electronics board 35 can include one or more microprocessors that controls and/or communicates with the bed components, the bed sensors (such as 25/27), the monitor/sensors 721, the communication board 723 and the headboard GUI 719.

**[0066]** Another embodiment of an electronic control system for a patient support having adjustable mechanical components, patient therapy, and patient monitoring system is shown in FIG. 8. In this example, the control system 801 is confined within a patient support (e.g., a bed, stretcher, or wheelchair). The system 801 includes patient sensors 802 that provide patient monitoring signals to a lead/electrode control circuit 805 (which controls the signals provided to and from the electrodes). The output of the control circuit 805 is provided to an analog to digital converter 807 which provides signals representing the vital signs to a main control logic board 206 for the patient support 102. This board 206 may include one or more microprocessors 217 which executes algorithms in the form of software or firmware stored in memory 218. Additionally, the system 801 controls various components of the patient support via at least one motor 821. Control signals to control the motor provided from the control board 206, and monitoring signals regarding the status of the motor (or the mechanical parts it controls) are fed back to the control board 206. Additionally, a pump 831 is provided as part of the patient support system 102. The pump 831 provides air to a mattress 833 and to a respiratory therapy garment 835. The pump is controlled and monitored by the control board 206. The user operates the pump 831 and motors 821, and views the status (and/or history) of these components (as well as the patient vital signs from the sensors 803) via a user interface 208. The user interface 208 can include operator input devices 220 and one or more displays 108 and is in communication with the control board 208 to communicate control signals and display signals therebetween. Additionally, the patient support system 102 includes an AV input 853 to provide audio and/or video signals from an external consumer electronics device, such as an MP3 player 855. Moreover, the patient support system 102 includes an AV output to drive a speaker or headphone system 859. The user interface can be used to control

these connections and these devices 859/855. The user interface may also allow for connection to the Internet or to a list of entertainment choices (television shows, songs, etc.), and the entertainment can be delivered via the port 857 to the output device 859. The patient support 102 may include any one or more of the features described above with respect to the other embodiments.

**[0067]** FIG. 10 illustrates the shape of a removable GUI device that could be placed within an opening in the board of the patient support system to allow the user to control features of the patient support, as well as to monitor the patient. Here, the user interface device includes a housing 1001 that includes a display 1003 for monitoring patient vital signs, as well as user interface buttons 1005 for controlling movements of the patient support (e.g., the leg, seat and head sections of the deck). The housing 1001 can have a portion that fits into opening 1007 in the sideboard/siderail 1009, such as via interference/snap fit or via attachments. The patient support and siderail 1009 can operate and include components such as those described above.

**[0068]** FIG. 11 is an embodiment of a patient support system 1100 that is adapted to receive data/vital signs/patient status wirelessly from a variety of medical monitoring devices 1101 via a communication device 1103. A communication device 1109 on the patient support system 1100 receives and aggregates and processes the signals from the devices 1101. A user interface 1105 on the headboard 1104 then displays signals from the monitoring devices 1101. Such data can then be passed along wired or wirelessly to an electronic medical records system (EMR) 1107. The patient support system 1100 can include one or more of the features and components described above with respect to other embodiments.

**[0069]** Fig. 12 illustrates another embodiment. Here, a communication device 1203 on each of the medical devices 1201 communicates wirelessly with a communication device 1209 on the patient support 1200 via IEEE802.15.4 protocol. The location of the patient support 1200 is determined from ultrasonic and RF beacons 1210, such as via location technology. The medical device data is then transmitted to a display 1205, an EMR 1207, and other computers 1211 via wireless IEEE802.11 protocol. The device 1209 can be located on the patient support 1200, as can the display 1205. A display on the headboard or siderail of the support 1200 can display the data from the devices 1201. The patient support system 1200 can include one or more of the features and components described above with respect to other embodiments.

**[0070]** Fig. 13 illustrates another example where the patient support system 1300 (in this example the siderail 1301) includes one or more device ports to plug in headphones or an MP3 or digital audio music player 1305, such as described above. The patient support system 1300 can include one or more of the features and components described above with respect to other embodiments.

**[0071]** FIG. 14 is another embodiment, similar to that of FIG. 11 and 12. However, in this example, a data connector or docking port 1420 extends from a hospital room headwall or other wall within the hospital room. This port 1420 then interfaces with the patient support 1400 via a corresponding data receptacle 1421 on the endboard of the bed, allowing for data transfer whenever the bed is hooked to the port 1420 on the wall. Accordingly, the endboard of the patient support system transfers data regarding the bed or equipment and devices controlled by or monitored by the bed, wired or wirelessly. Such data can then be transmitted to remote locations, such as computers or nurses stations, having health information systems and/or Electronic Medical Records, for collection, storage, billing, reporting, and/or analysis. The patient support system 1400 can include one or more of the features and components described above with respect to other embodiments.

**[0072]** FIG. 15 is a partial cross-section view of an illustrative embodiment of a siderail 20', such as that of FIG. 5, having an incorporated display 529 for a patient monitor or other medical equipment, according to principles of the present disclosure. This Figure illustrates the routing of conductors 160 for equipment display 529. Conductors 160 extend through central opening 162 in siderail 20', and through an opening 168 in display 529 and in the siderail 20'. Conductors 160 may provide power and other signals to pendant display 529 from display 529 may provide signals through conductors 160 to the main bed control system. Connectors, such as screws or bolts or snap fittings 531 can be used to hold the display 529 to the siderail 20'. In some alternatives, the siderail 20' is an endboard or other board or component of the bed. Also, in some embodiments, the display 529 is mounted flush with the sideboard 20' or otherwise integrated therein. Additionally, the wires 160 may connect to the display via an electrical connector between display 529 and sideboard 20', such that an opening 168 in siderail 20' and display 529 is not needed. Wires may comprise individual wires or bundled wires such as on a ribbon connector. Siderail 20' (and the other siderails described herein) can locate the edge of the bed, can assist the patient and caregiver while the patient is in the bed, can impede the patient from moving off the bed, and can be moved up and down (deployed and stowed) as needed during use.

**[0073]** FIG. 16 illustrates a control system for a patient support system. The system 1330 includes a controller 1332 which can be a networking microprocessor. Controller 1332 accesses memory 1334 and can comprise one or more microprocessors, controllers, or control boards. Memory 1334 can include an EEPROM, and EPROM, and a static RAM. Controller 1332 is coupled to a RS-485 transceiver 1336. Transceiver 1336 is coupled to first and second network connectors 1338 and 1340. System 1330 includes an internal power supply 1342 coupled to a power input. Illustratively, power supply 1342 supplies a +5V supply voltage to controller 1332

on line 1344. Power supply 1342 also supplies power to a medical equipment interface 1346, a display interface 1348, and a keyboard interface 1350. Medical equipment interface 1346 receives an input from medical equipment, such as the patient vital monitors, patient therapy devices, or patient treatment devices discussed herein. An output of interface 1346 is coupled to controller 1332 on line 1354. Controller supplies information to display interface 1348 on line 1356. An output from display interface 1348 is coupled to a suitable display 1358. Keyboard interface 1350 receives an input from a keyboard 1360. An output of keyboard interface 1350 is coupled to controller 1332 by line 1362.

**[0074]** System 1330 provides a unified apparatus for controlling and monitoring bed functions as well as for controlling and/or monitoring functions of the medical equipment. Medical equipment 1352 and keyboard 1360 provide input devices for inputting information into system 1330. It is understood that any type of input device can be used. Information from system 1330 can be sent to the hospital network through transceiver 1336 and communication module 1020 or to another remote location via accessory module 1016. An output device such as display 1358 is provided to display information to the user. The display 1359 can be a series of LEDs or a display panel, such as a LCD display. Memory 1334 contains code that translates raw medical equipment information and keyboard input information from keyboard 1360 into specific data or commands, either for local on-bed use or for hospital network off-bed use. For instance, the nurse can take patient vitals using the medical equipment or input various information into keyboard 1360 related to the patient. This input can be used to generate an internal chart of the medical history of the patient for use on the hospital bed. This chart data can be displayed on display 1358. In addition, this chart can be transmitted over the hospital network or transmitted to a remote location using a data link coupled to accessory port 1016.

**[0075]** Another use of system 1330 is for inputting a control sequence used to control a bed control module to perform a dedicated function on the bed. For instance, a caregiver can prescribe a certain surface therapy for pulmonary or other type of treatment of the patient on the bed. This treatment prescription can specify a period of time for percussion and vibration therapy or for rotational therapy of the patient on the bed. The prescription can include a specific period of time for the therapy with varying rates of rotation or a varying frequency of percussion and vibration. This specific control sequence is input into system 1330. System 1330 then automatically executes the prescribed control sequence by transmitting appropriate commands at appropriate times through transceiver 1336 to the network and to the selected bed control modules to control the selected modules in the prescribed control sequence.

**[0076]** Numbered clauses defining the inventions contemplated herein are as follows:

1. A hospital bed comprising  
a frame,  
a plurality of siderails coupled to the frame,  
a headboard coupled to the frame,  
a footboard coupled to the frame,  
a physiologic monitor sensing at least one physiologic parameter of a patient supported by the frame,  
and  
a plurality of graphical displays, a first graphical display of the plurality of graphical displays being included as part of a first siderail of the plurality of siderails and a second graphical display of the plurality of graphical displays being included as part of one of the headboard and the footboard, each of the first and second graphical displays being operable to display the physiologic parameter sensed by the physiologic monitor.

2. The hospital bed of clause 1, wherein the second graphical display is included as part of the headboard and faces away from the frame.

3. The hospital bed of clause 2, further comprising a third graphical display included as part of the headboard.

4. The hospital bed of clause 3, wherein the second graphical display displays data relating to a first physiologic parameter of the patient and the third graphical display displays data relating to a second physiologic parameter of the patient.

5. The hospital bed of clause 3, wherein the second and third graphical displays are located in spaced-apart, side-by-side relation.

6. The hospital bed of clause 1, wherein the second graphical display is included as part of the footboard and faces toward the frame.

7. The hospital bed of clause 6, further comprising a third graphical display included as part of the footboard.

8. The hospital bed of clause 7, wherein the second graphical display displays data relating to a first physiologic parameter of the patient and the third graphical display displays data relating to a second physiologic parameter of the patient.

9. The hospital bed of clause 7, wherein the second and third graphical displays are located in spaced-apart, side-by-side relation.

10. A hospital bed comprising  
a frame,  
a plurality of siderails coupled to the frame,  
a headboard coupled to the frame,  
a footboard coupled to the frame,  
a physiologic monitor sensing at least one physiologic parameter of a patient supported by the frame,  
a pneumatic therapy device operable to delivery therapy to the patient, and  
a plurality of graphical displays, a first graphical display of the plurality of graphical displays being included as part of a headboard and a second graphical display of the plurality of graphical displays being

included as part of the footboard, wherein one of first and second graphical displays shows information pertaining to one of the physiologic monitor and the pneumatic therapy device, and wherein the other of the first and second graphical displays shows information pertaining to the other of the physiologic monitor and the pneumatic therapy device.

11. The hospital bed of clause 10, wherein the first graphical display shows data pertaining to the physiologic monitor and the second graphical display shows information pertaining to the pneumatic therapy device.

12. The hospital bed of clause 10, wherein the pneumatic therapy device comprises a respiratory therapy garment worn by a patient for high frequency chest wall oscillation therapy.

13. The hospital bed of clause 10, wherein the pneumatic therapy device comprises a sequential compression therapy sleeve worn by a patient for prevention of deep vein thrombosis.

14. The hospital bed of clause 10, further comprising a third graphical display included as part of a first siderail of the plurality of siderails, the third graphical display showing information pertaining to at least one of the physiologic monitor and the pneumatic therapy device.

15. A hospital bed comprising  
a frame;

hospital bed electronics carried by the frame, the hospital bed electronics controlling each of the following: movement of portions of the frame to reposition a patient, operation of an IV pump, operation of a vital signs monitor, and operation of a therapy device;

at least one barrier coupled to the frame; and  
at least one graphical display that is included as part of the barrier and that displays information pertaining to operation of the IV pump, information pertaining to operation of the vital signs monitor, and information pertaining to operation of the therapy device.

16. The hospital bed of clause 15, further comprising user inputs carried by the barrier and usable to command the hospital bed electronics regarding control of the operation of the IV pump, the vital signs monitor, and the therapy device.

17. The hospital bed of clause 15, wherein the therapy device comprises one of a respiratory therapy garment worn by a patient for high frequency chest wall oscillation therapy and a sequential compression therapy sleeve worn by a patient for prevention of deep vein thrombosis.

18. The hospital bed of clause 15, wherein the hospital bed electronics communicates via wireless signals with at least one computer device that is spaced from the hospital bed.

19. The hospital bed of clause 15, wherein the hospital bed electronics includes a patient audio port to which a patient attaches a personal audio player.

20. The hospital bed of clause 15, wherein the hospital bed electronics is communicatively coupled via a hospital network to a medical records system and further comprising a keyboard coupled to the hospital bed electronics for entering patient vital signs information into a patient medical record via the hospital bed electronics.

21. A patient support system, comprising:  
 a deck configured to support a patient;  
 a base supporting the deck;  
 at least one sensor configured to monitor a vital sign of the patient;  
 and  
 a board positioned along an edge of the deck and supported by the base, wherein the board includes a user interface configured to provide an indication of the status of the vital sign.

22. A patient support system, comprising:  
 a deck configured to support a patient;  
 a base supporting the deck;  
 a patient sensor configured to monitor a vital sign of the patient;  
 a component sensor configured to monitor the status of a component on the patient support;  
 an electronic circuit configured to receive signals from the patient sensor and the component sensor;  
 a siderail board positioned adjacent a side edge of the deck;  
 an endboard positioned adjacent an end edge of the deck;  
 a user interface system supported by the endboard and/or siderail, wherein the user interface system is configured to receive signals from the electronic circuit to indicate the status of the patient vital sign and the component sensor.

23. A patient support system, comprising:  
 a deck configured to support a patient;  
 a base supporting the deck;  
 a power cord configured to provide electrical power to the patient support system;  
 a patient monitor supported by the base and configured to monitor a vital sign of the patient;  
 a component sensor supported by the base and configured to monitor the status of a component on the patient support;  
 a pump supported by the base and configured to deliver therapy and/or medication to the patient;  
 an actuator supported by the base and configured to move at least a portion of the deck relative to the base;  
 a user interface system supported by the base,

wherein the user interface system is configured to receive signals from the component sensor and the patient monitor and to allow control of the actuator and the pump; and  
 a power circuit configured to receive the electrical power from the cord and provide power to the actuator, the pump, the patient monitor, and the user interface system.

24. A patient support system, comprising:  
 a deck configured to support a patient;  
 a base supporting the deck;  
 a power cord configured to provide electrical power to the patient support system;  
 a patient monitor circuit supported by the base and configured to monitor a vital sign of the patient;  
 a component sensor supported by the base and configured to monitor the status of a component on the patient support;  
 a pump supported by the base and configured to deliver therapy and/or medication to the patient;  
 an actuator supported by the base and configured to move at least a portion of the deck relative to the base;  
 a user interface system supported by the base, wherein the user interface system is configured to receive signals from the component sensor and the patient monitor and to allow control of the actuator and the pump;  
 a microprocessor board supported by the base and configured to control operation of the pump and the actuator and to receive signals from the component sensor and the patient monitor circuit;  
 a communication circuit supported by the base and connected with the microprocessor board, wherein the communication board is configured to communicate signals indicating the status of the component sensor and at least one of the pump and patient monitor circuit to a remote location; and  
 a power circuit configured to receive the electrical power from the cord and provide power to the actuator, the pump, the patient monitor, the microprocessor board, the communication circuit, and the user interface system.

25. A patient support system, comprising:  
 a deck configured to support a patient;  
 a base supporting the deck;  
 an actuator configured to move the deck relative to the base;  
 a pump supported by the base;  
 a connector supported by the base and config-

ured to place the pump into fluid communication with an air mattress;  
 a connector supported by the base and configured to place the pump into fluid communication with at least one of a sequential compression therapy device, a chest wall oscillation device, and a medication pumping device;  
 a control system supported by the base and configured to control the actuator and the pump; and  
 a user interface system supported by the base and configured to modify the control of the control system to control the actuator and the pump, to thereby allow user control of the actuator, the mattress, and at least one of the sequential compression therapy device, the chest wall oscillation device, and the medication pumping device.

26. A patient support system comprising:

a deck configured to support a patient;  
 a base supporting the deck;  
 an actuator configured to move the deck relative to the base;  
 a board configured to locate an edge of the deck;  
 an audio connector provided on the board and configured to receive a plug from an audio device;  
 a speaker supported by the base;  
 an electronics system supported by the base and configured to control the actuator and to drive the speaker according to the signal from an audio device.

27. A patient support system comprising:

a deck configured to support a patient;  
 a base supporting the deck;  
 an actuator configured to move the deck relative to the base;  
 a board configured to locate an edge of the deck;  
 a telephone storage recess provided on the board and configured to receive a telephone; and  
 an electronics system supported by the base and configured to carry out one or more of the following: control the actuator, control the communication of signals to and from a telephone, and provide power to a telephone.

28. A patient support system, comprising:

a deck configured to support a patient;  
 a base supporting the deck;  
 an actuator configured to move the deck relative to the base;  
 at least one board configured along at least one edge of the deck and supported by the base, wherein the board includes at least one user in-

terface configured to control the actuator, wherein the user interface is further configured to control or monitor medical equipment; and wherein the patient support system comprises one or more of an obstacle detection system, a bed exit alarm system, a head of bed angle alarm system, a safety indicator indicating the bed is in a safe condition, a scale system, a powered transport system, and a patient turn assist system.

29. A patient support system, comprising:

a deck configured to support a patient;  
 a base supporting the deck;  
 an actuator configured to move the deck relative to the base;  
 an electronic control system supported by the base and provided at one location along the patient support system, wherein the electronic control system is configured to control the actuator and to receive signals from and/or provide signals to at least one of a consumer electronics device, a patient monitoring device connected to the patient, and a patient therapy device attached to the patient;  
 wherein the patient support system comprises one or more of an obstacle detection system, a bed exit alarm system, a head of bed angle alarm system, a safety indicator indicating the bed is in a safe condition, a scale system, a powered transport system, and a patient turn assist system.

[0077] The foregoing description of various embodiments and principles of the disclosure have been presented for the purposes of illustration and description. It is not intended to be exhaustive or to limit the disclosure to the precise forms disclosed. Many alternatives, modifications and variations will be apparent to those skilled in the art. Moreover, although multiple inventive aspects and principles have been presented, these need not be utilized in combination, and various combinations of inventive aspects and principles are possible in light of the various embodiments provided above. Accordingly, the above description is intended to embrace all possible alternatives, modifications, aspects, combinations, principles, and variations that have been discussed or suggested herein, as well as all others that fall within the principles, spirit and broad scope of the various possible inventions disclosed herein and defined by the claims.

Claims

1. A hospital bed comprising a frame; hospital bed electronics carried by the frame, the

- hospital bed electronics controlling each of the following: movement of portions of the frame to reposition a patient, operation of an IV pump, operation of a vital signs monitor, and operation of a therapy device;
- at least one barrier coupled to the frame; and
- at least one graphical display that is included as part of the barrier and that displays information pertaining to operation of the IV pump, information pertaining to operation of the vital signs monitor, and information pertaining to operation of the therapy device.
2. The hospital bed of claim 1, further comprising user inputs carried by the barrier and usable to command the hospital bed electronics regarding control of the operation of the IV pump, the vital signs monitor, and the therapy device. 15
  3. The hospital bed of either claim 1 or claim 2, wherein the therapy device is a pneumatic therapy device. 20
  4. The hospital bed of claim 3 wherein the therapy device comprises one of a respiratory therapy garment worn by a patient for high frequency chest wall oscillation therapy and a sequential compression therapy sleeve worn by a patient for prevention of deep vein thrombosis. 25
  5. The hospital bed of any preceding claim wherein the at least one barrier comprises a plurality of siderails coupled to the frame, a headboard coupled to the frame, and a footboard coupled to the frame, wherein the bed includes a physiologic monitor sensing at least one physiologic parameter of a patient supported by the frame, and wherein there is a plurality of graphical displays, a first graphical display of the plurality of graphical displays being included as part of a first siderail of the plurality of siderails and a second graphical display of the plurality of graphical displays being included as part of one of the headboard and the footboard, each of the first and second graphical displays being operable to display the physiologic parameter sensed by the physiologic monitor. 30  
35  
40
  6. The hospital bed of claim 5, wherein the second graphical display is included as part of the headboard and faces away from the frame. 45
  7. The hospital bed of claim 6, further comprising a third graphical display included as part of the headboard. 50
  8. The hospital bed of claim 5, wherein the second graphical display is included as part of the footboard and faces toward the frame. 55
  9. The hospital bed of claim 8, further comprising a third graphical display included as part of the footboard.
  10. The hospital bed of either claim 7 or claim 9, wherein the second graphical display displays data relating to a first physiologic parameter of the patient and the third graphical display displays data relating to a second physiologic parameter of the patient. 5
  11. The hospital bed of any one of claims 7, 9 and 10, wherein the second and third graphical displays are located in spaced-apart, side-by-side relation. 10
  12. The hospital bed of any preceding claim, wherein the hospital bed electronics communicates via wireless signals with at least one computer device that is spaced from the hospital bed. 15
  13. The hospital bed of any preceding claim, wherein the hospital bed electronics includes a patient audio port to which a patient attaches a personal audio player. 20
  14. The hospital bed of any preceding claim, wherein the hospital bed electronics is communicatively coupled via a hospital network to a medical records system and further comprising a keyboard coupled to the hospital bed electronics for entering patient vital signs information into a patient medical record via the hospital bed electronics. 25



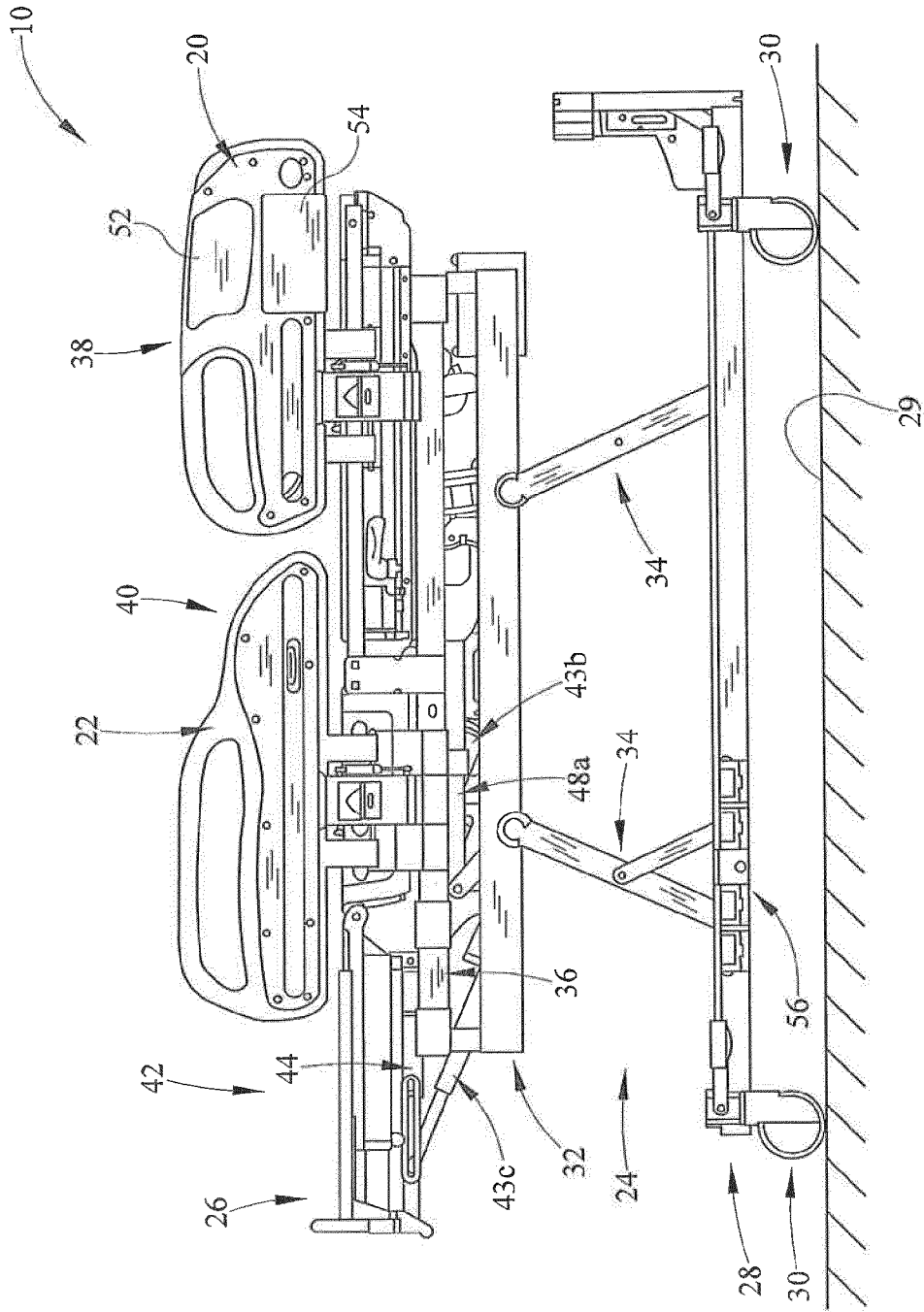

FIG. 2

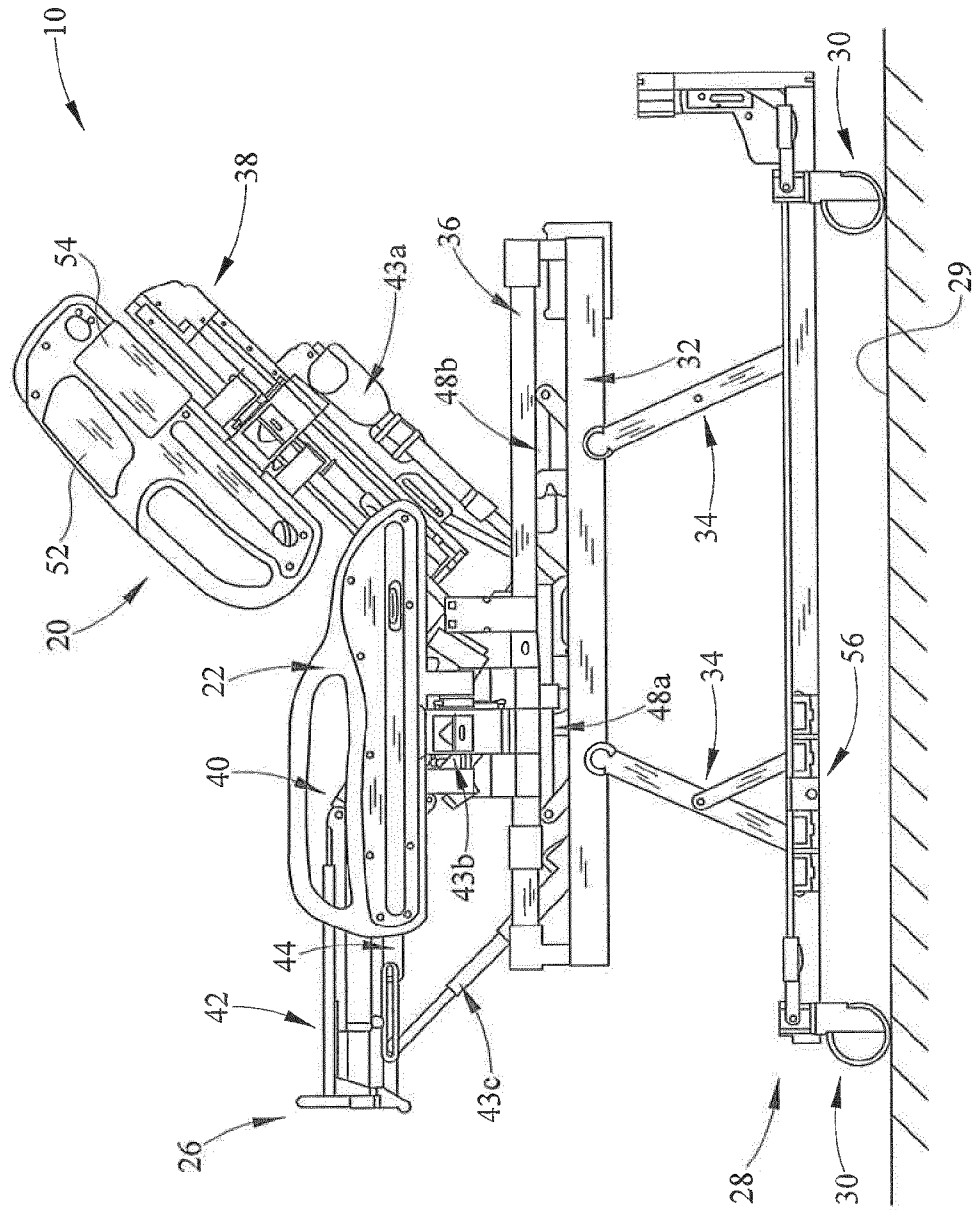

FIG. 3

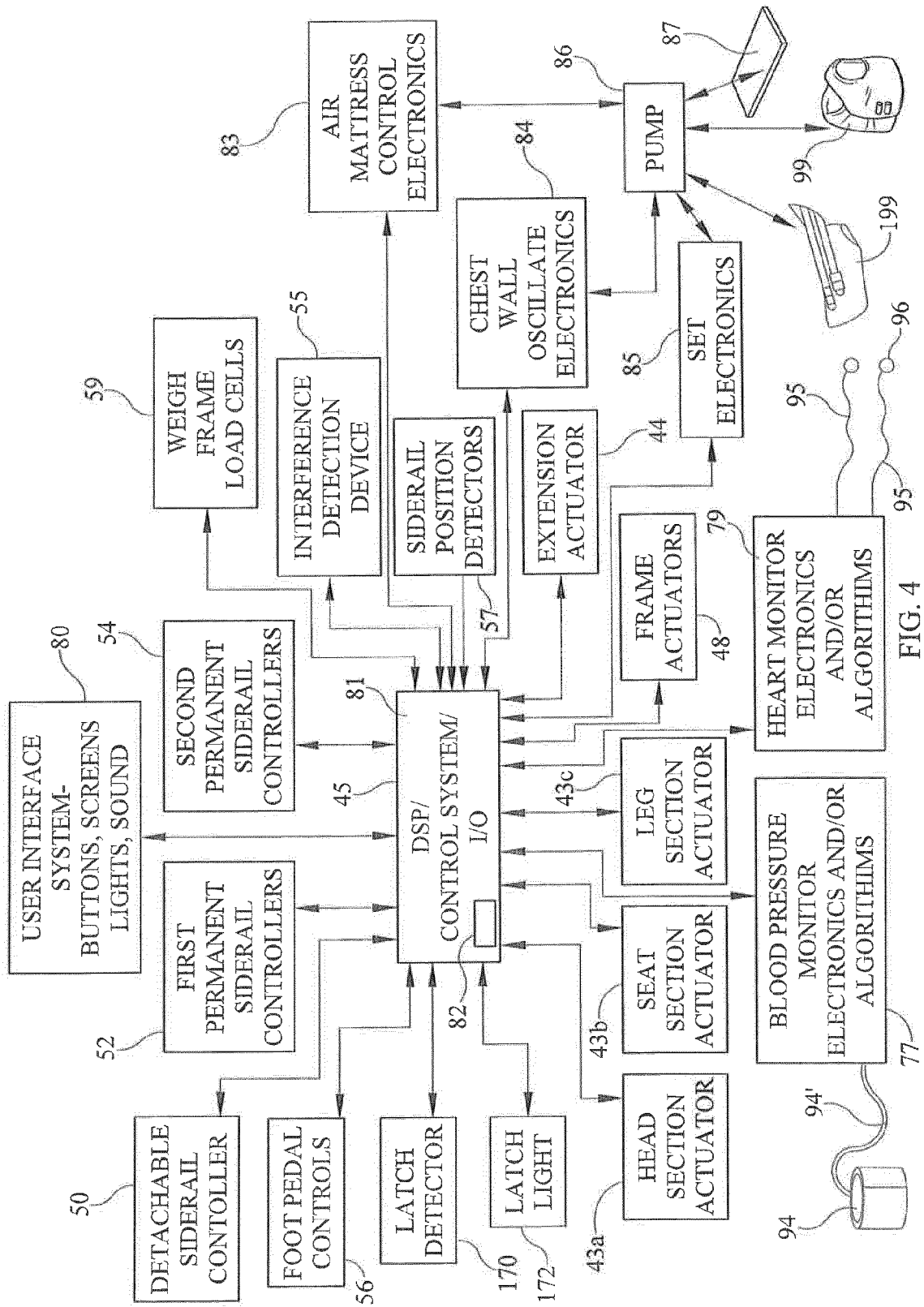

FIG. 4

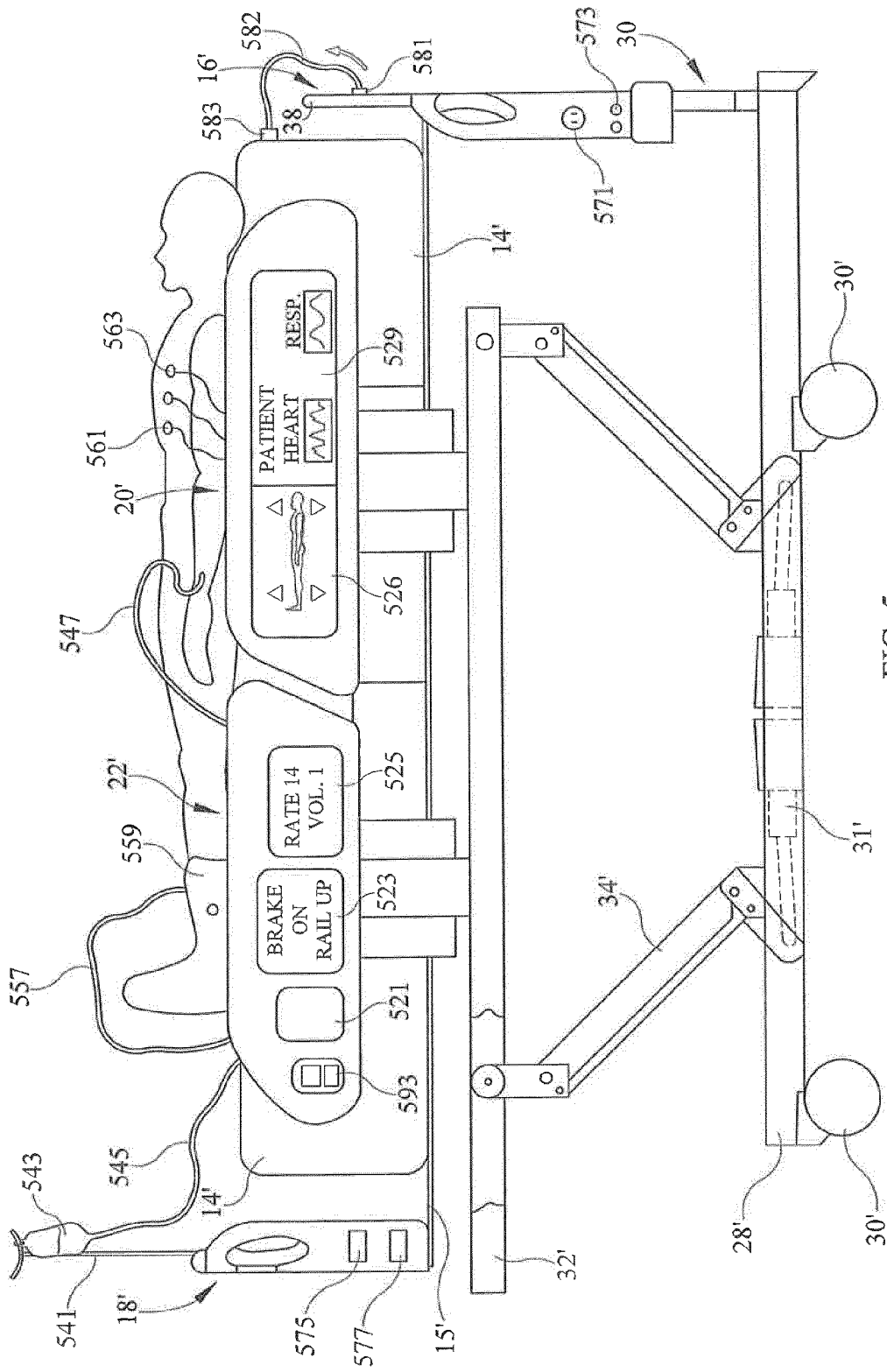

FIG. 5

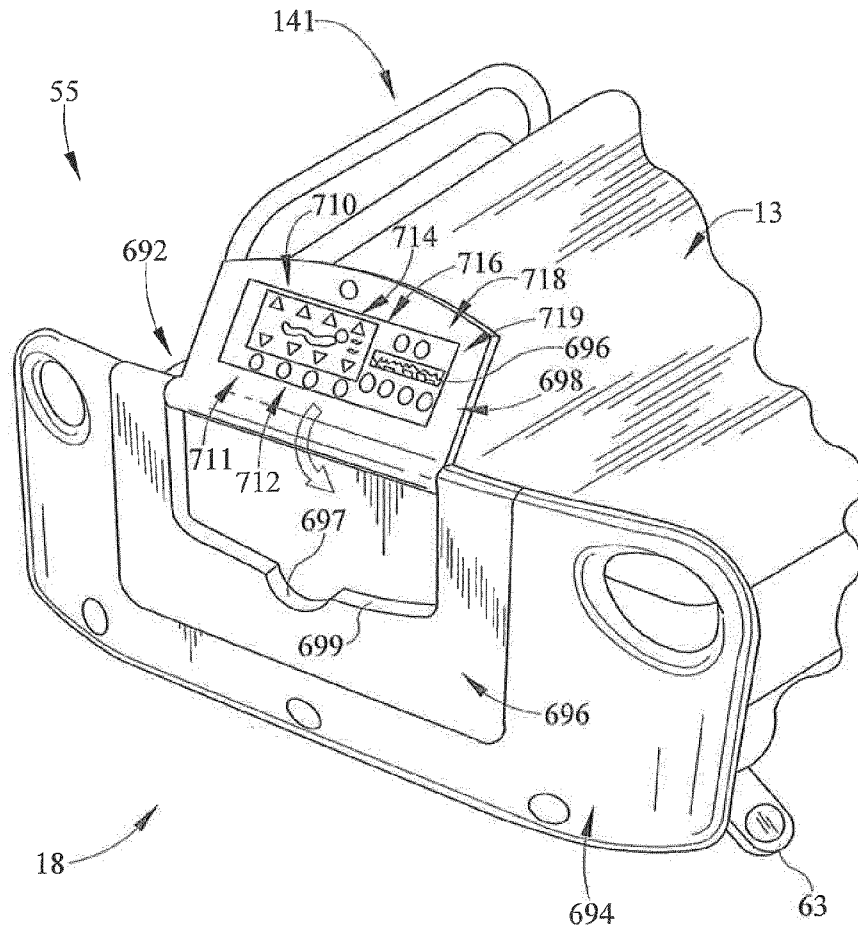

FIG. 6

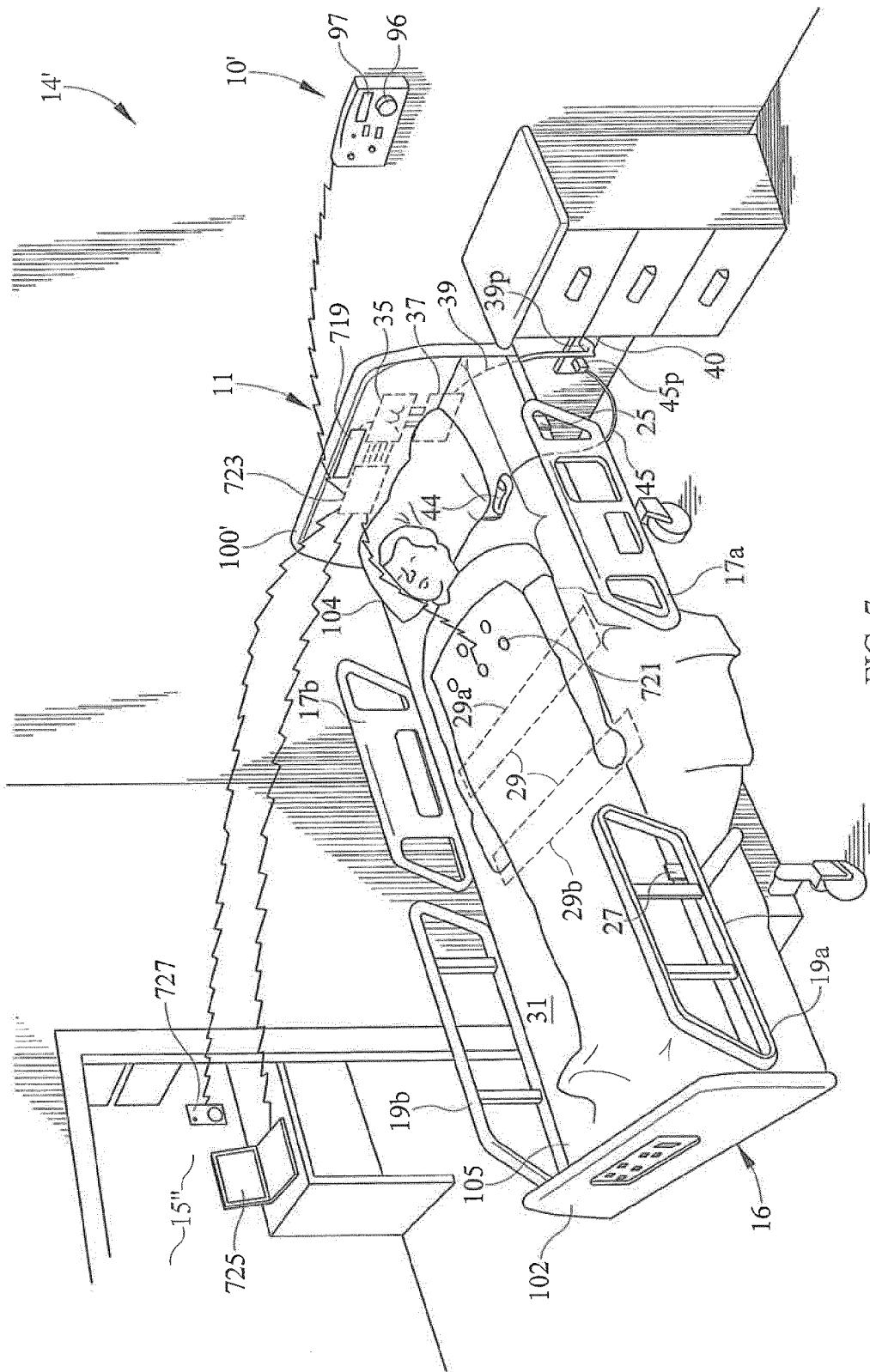

FIG. 7

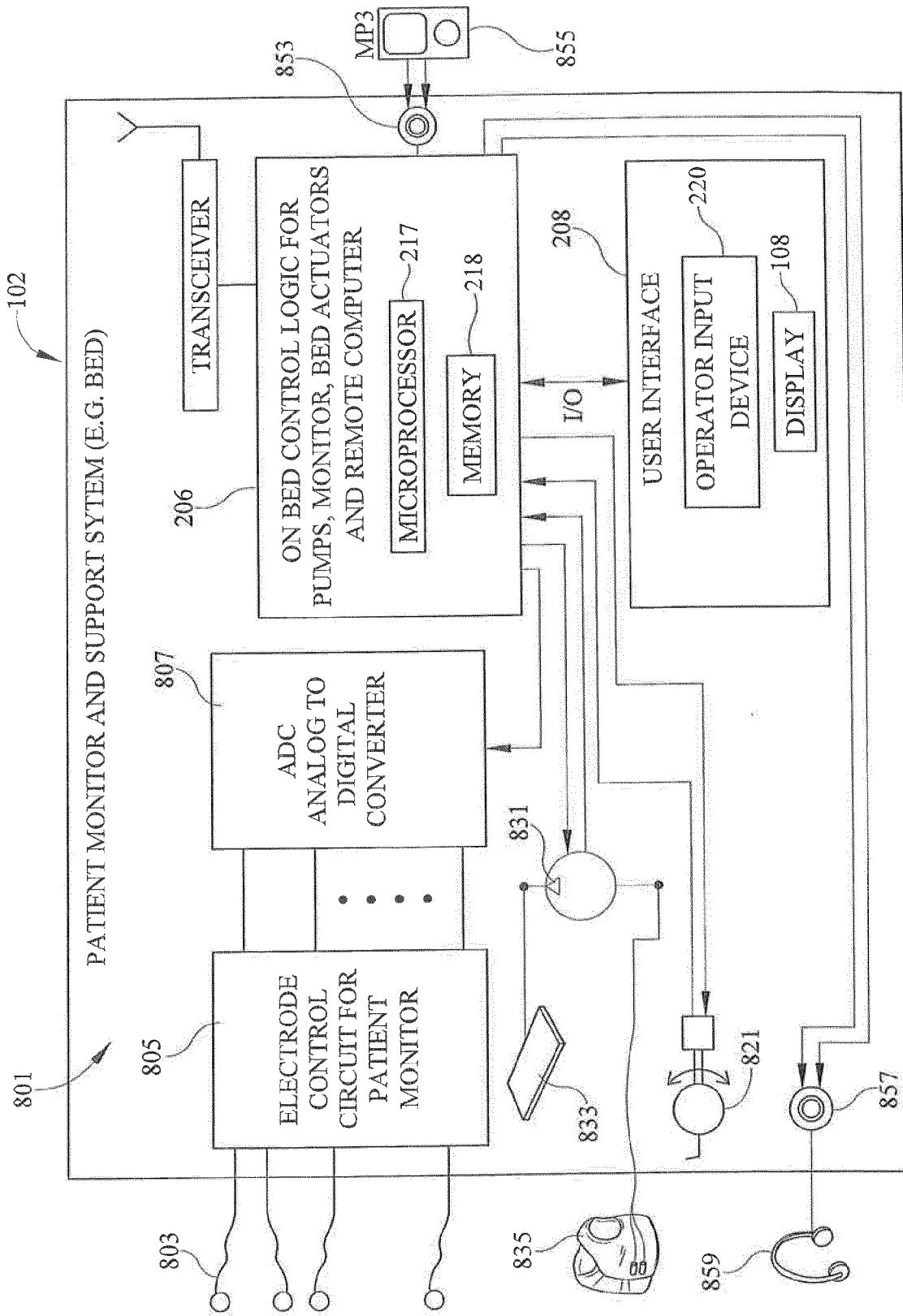
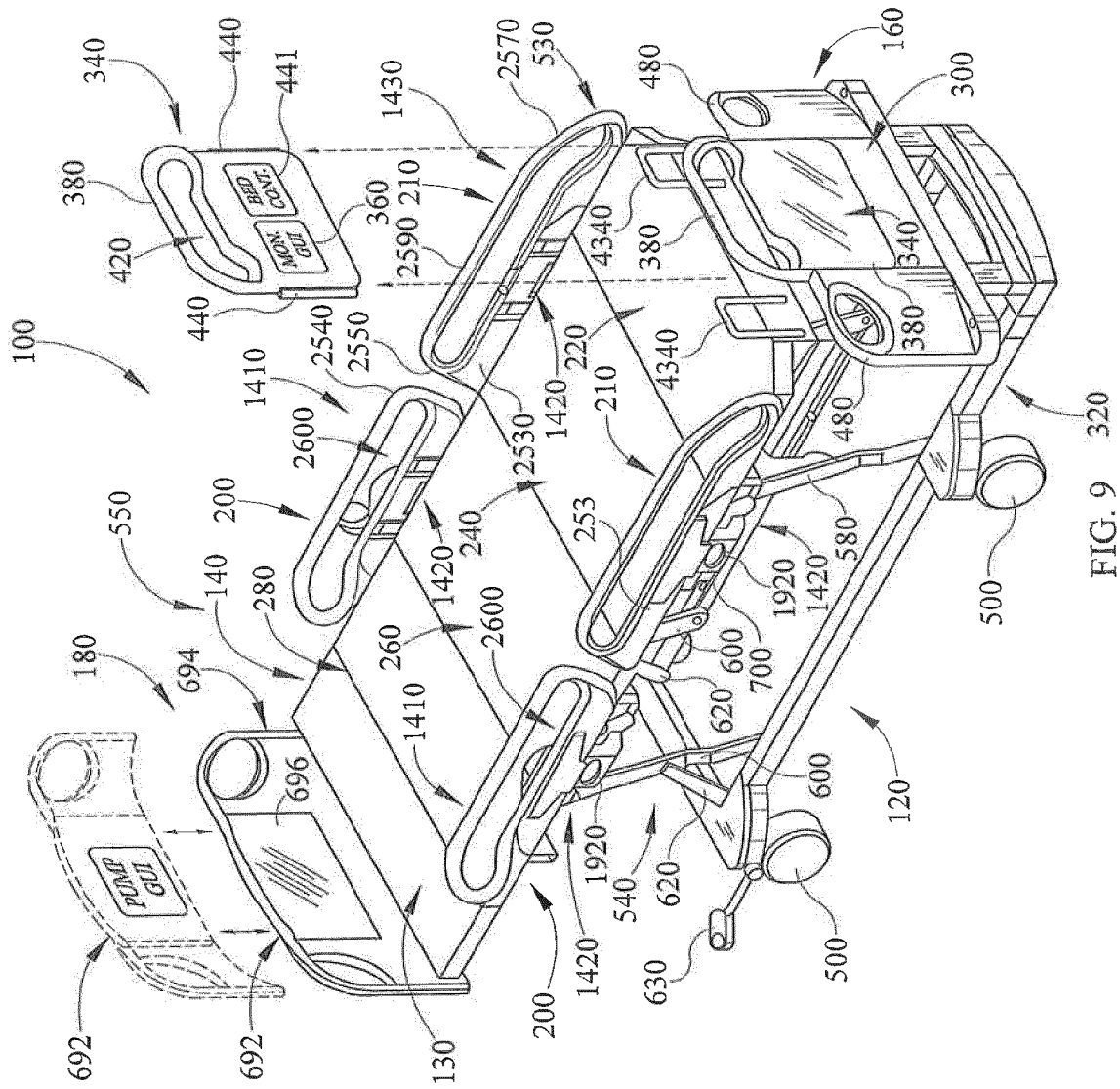

FIG. 8



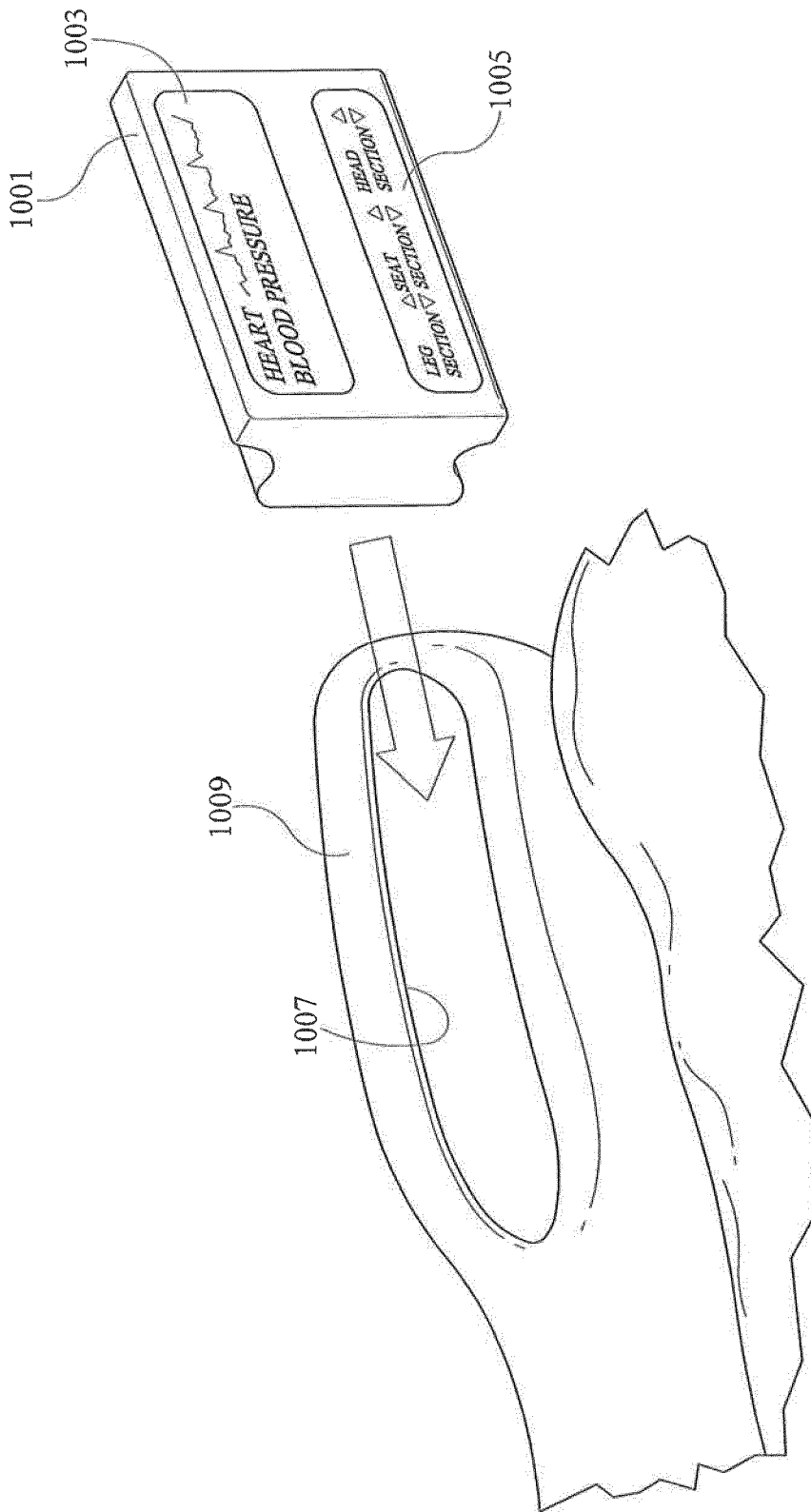

FIG. 10

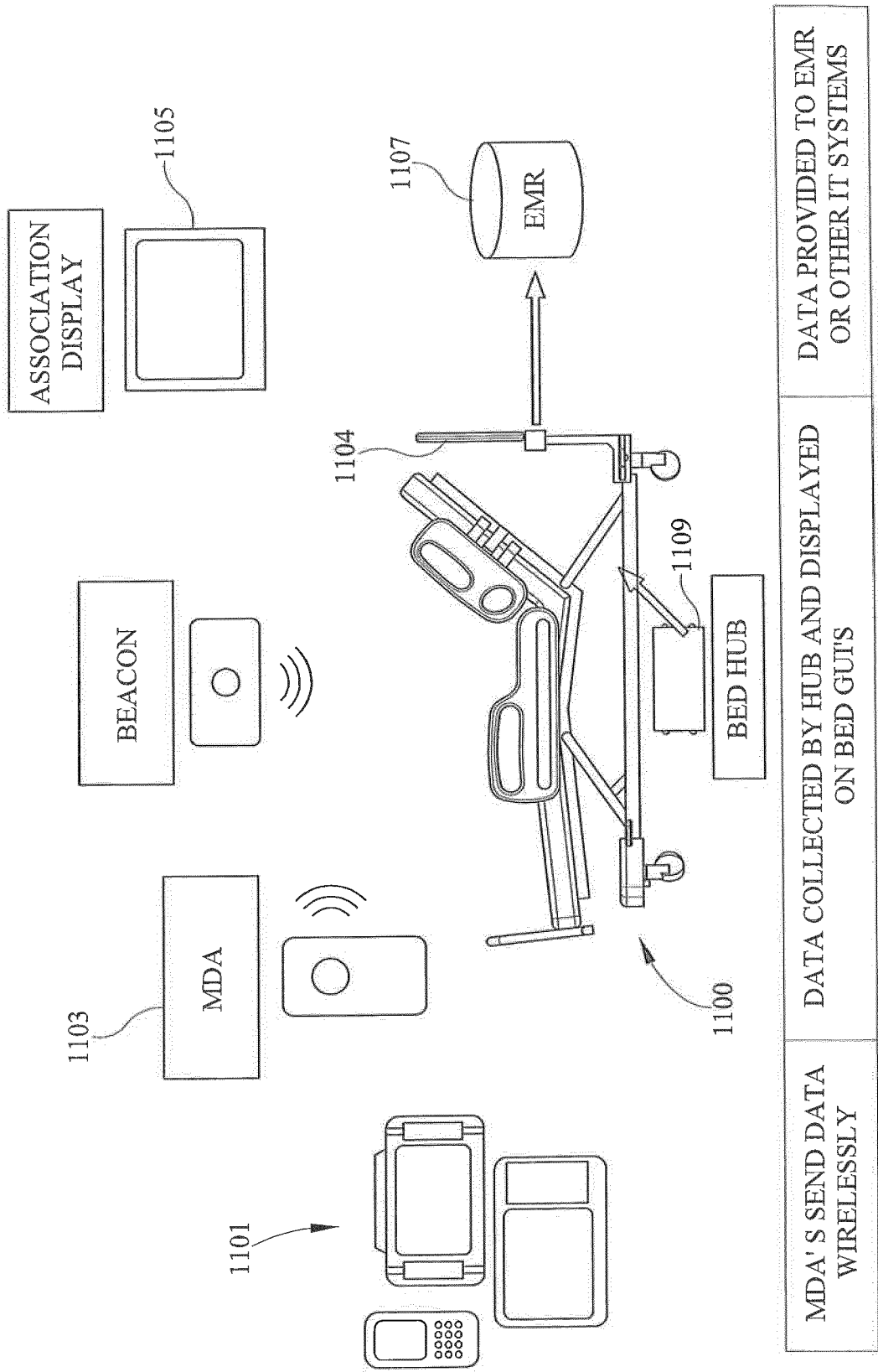

FIG. 11

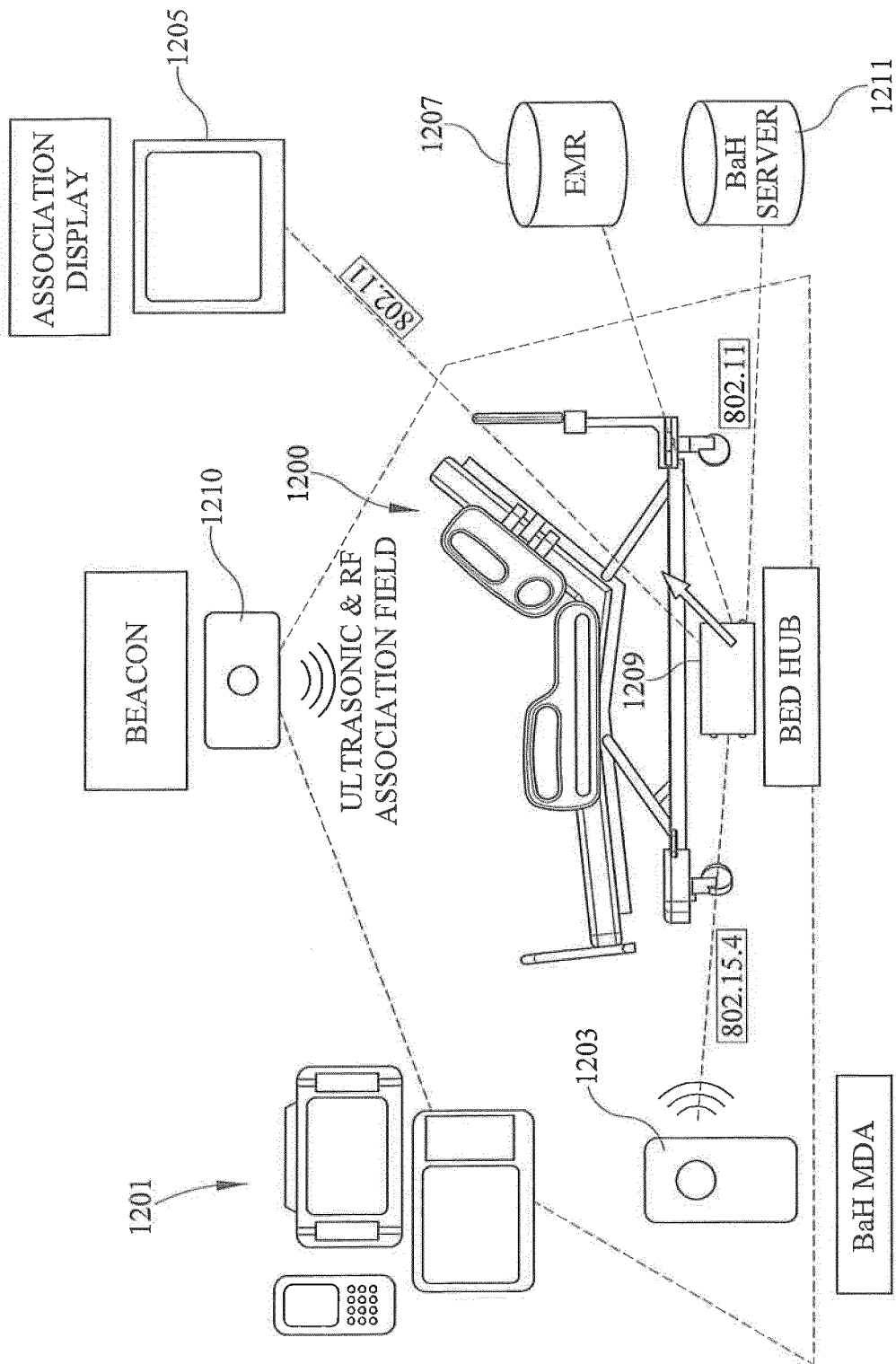

FIG. 12

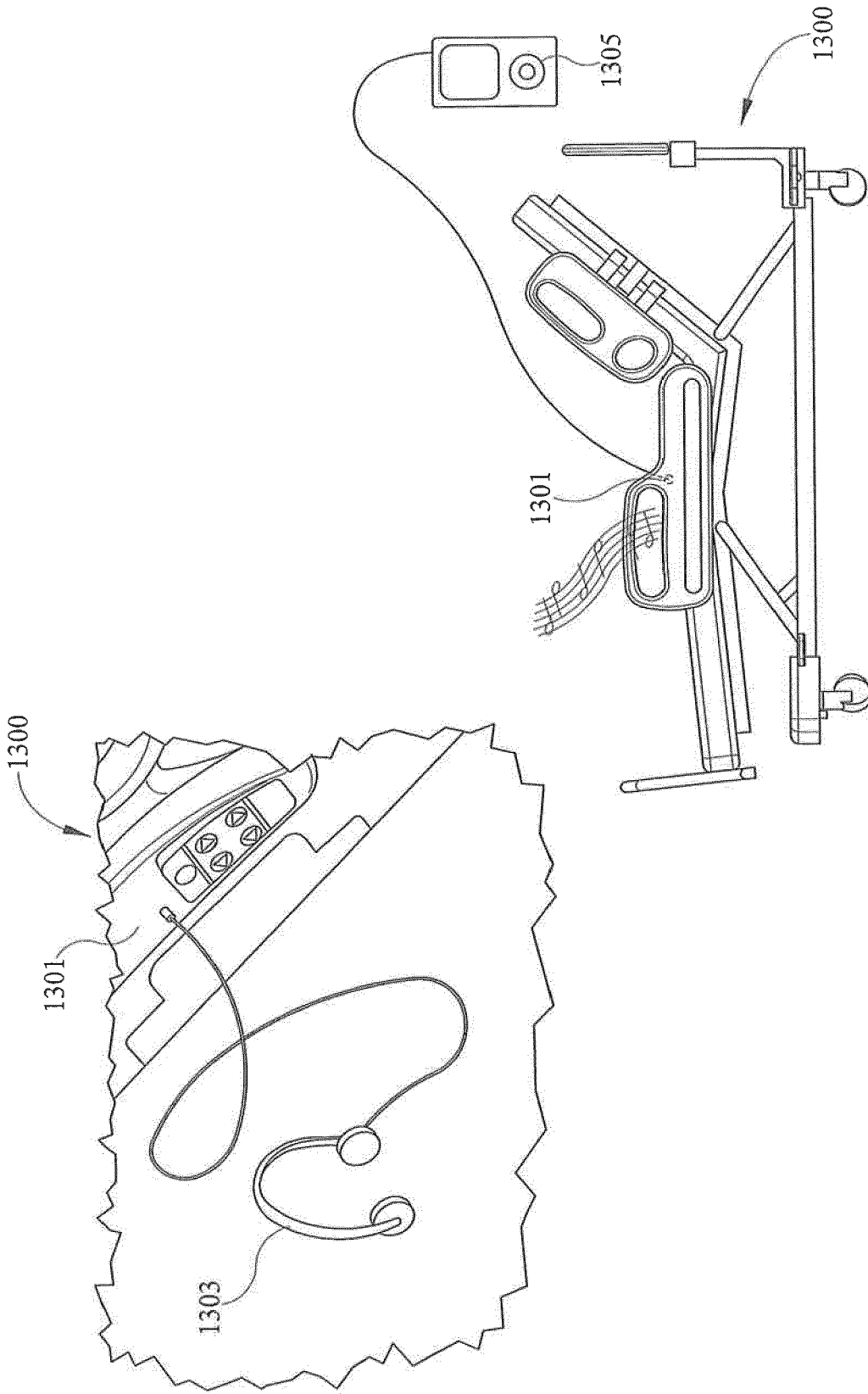

FIG. 13

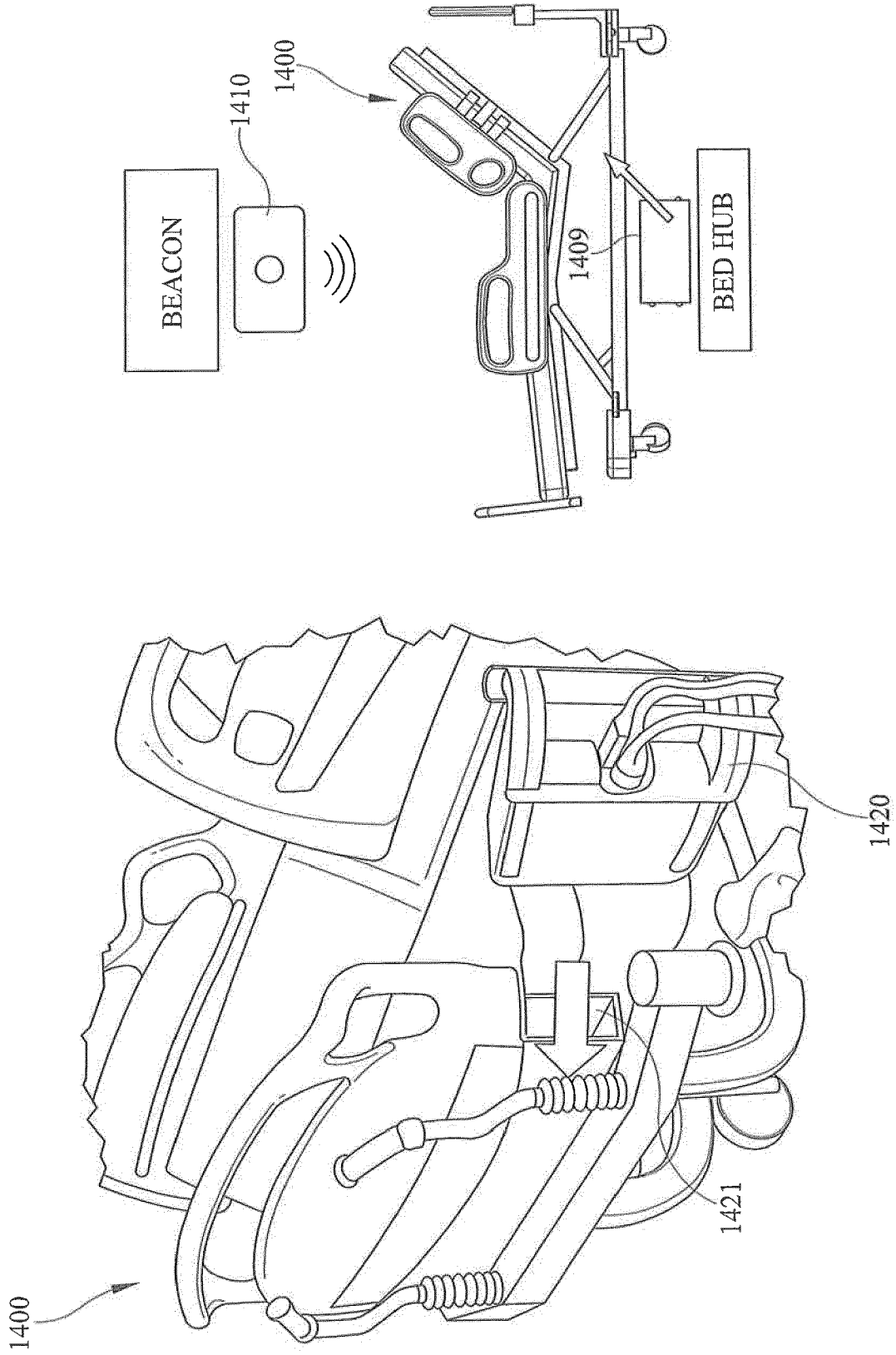

FIG. 14

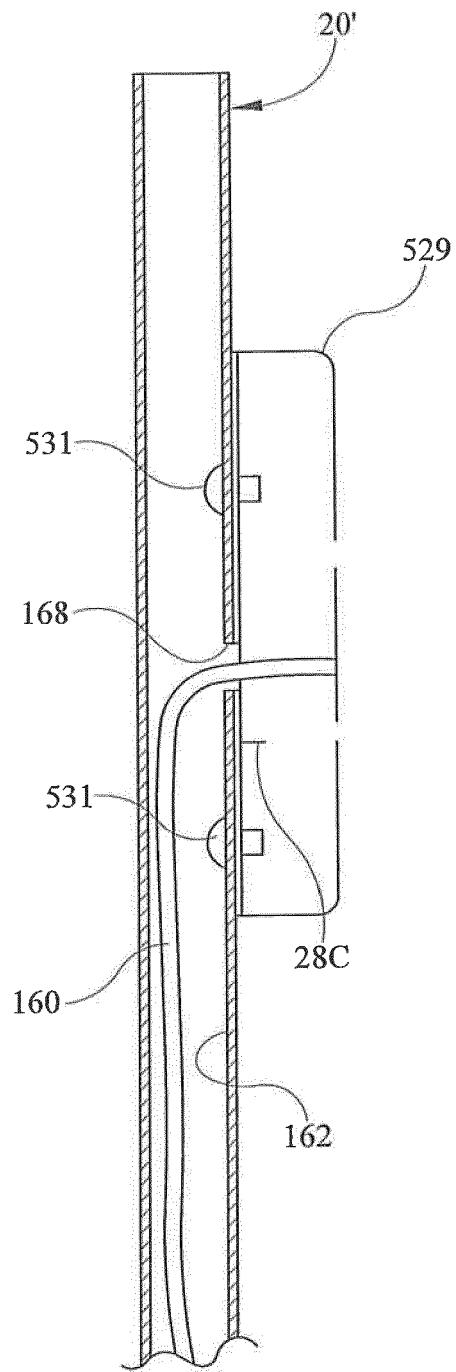

FIG. 15

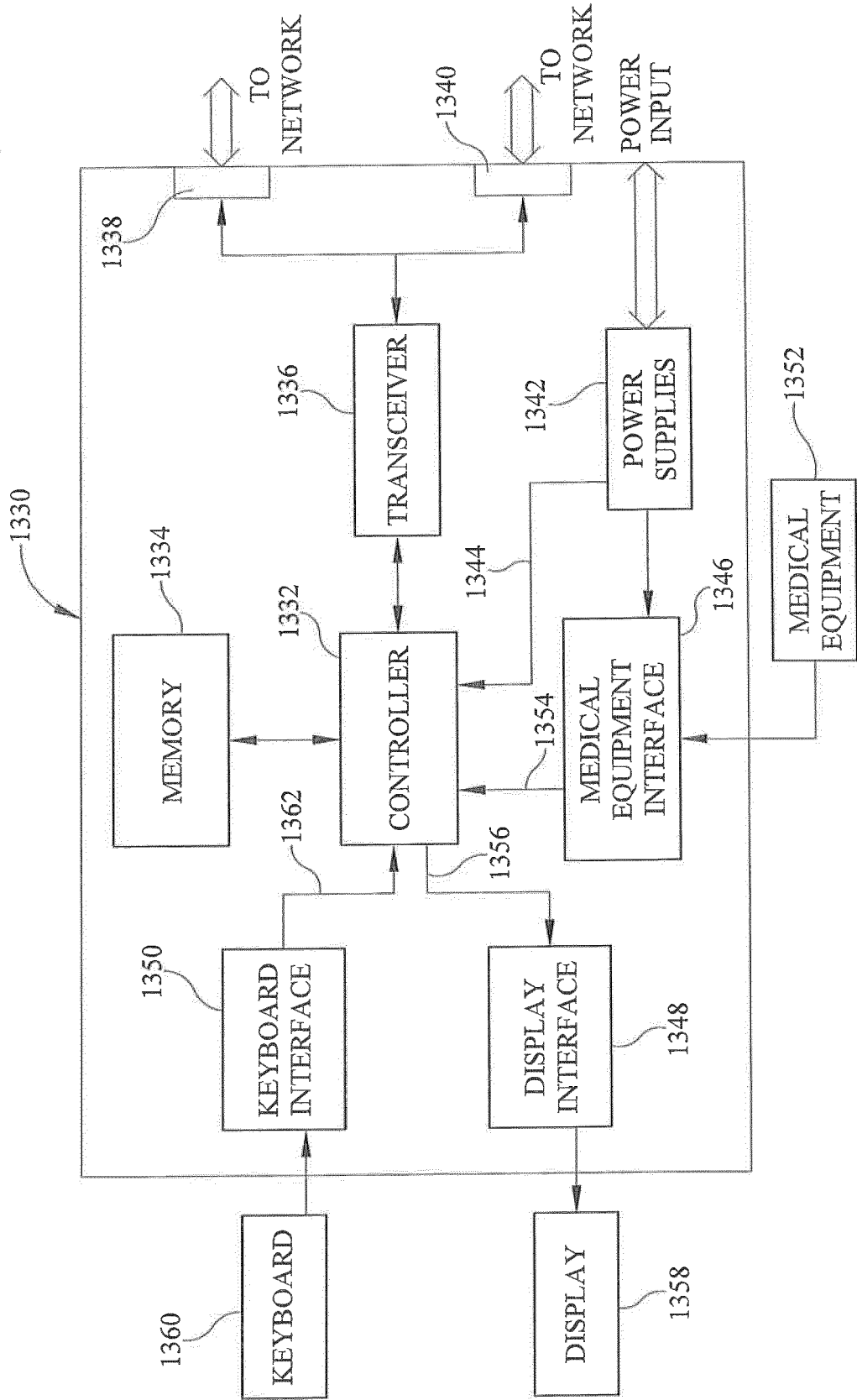

FIG. 16



EUROPEAN SEARCH REPORT

Application Number  
EP 13 17 9526

DOCUMENTS CONSIDERED TO BE RELEVANT			
Category	Citation of document with indication, where appropriate, of relevant passages	Relevant to claim	CLASSIFICATION OF THE APPLICATION (IPC)
X	US 2007/169268 A1 (LEMIRE GUY [CA] ET AL) 26 July 2007 (2007-07-26)	1,2,5,6,12,14	INV. A61G7/015
Y	* paragraphs [0053], [0058], [0323], [0352], [0360], [0383], [0419], [0423], [0425], [0471], [0472], [0526], [0536]; figures 1, 8A, 43A, 58, 59A-D, 68 *	7-11,13	A61G7/05  ADD. A61B5/00
X,D	US 2003/052787 A1 (ZERHUSEN ROBERT MARK [US] ET AL) 20 March 2003 (2003-03-20)	1,3,12,14	
Y	* paragraphs [0003], [0074], [0075], [0103], [0114], [0143], [0145] - [0147], [0217]; figures 30-34, 45, 88, 91-102, 148-150 *	4	
Y	US 2008/172789 A1 (ELLIOT DERICK [US] ET AL) 24 July 2008 (2008-07-24)	13	
	* paragraphs [0004] - [0007], [0010], [0012], [0014], [0022], [0023], [0025], [0031], [0033], [0042], [0045], [0074], [0075], [0080], [0081], [0083] - [0008]; figures 1, 2, 5, 11, 28, 50, 53, 54 *		TECHNICAL FIELDS SEARCHED (IPC) A61G
Y	US 2007/180616 A1 (NEWKIRK DAVID C [US] ET AL) 9 August 2007 (2007-08-09)	8	
	* paragraphs [0004] - [0006], [0009], [0010], [0058] - [0062], [0071], [0098], [0099], [0139]; figures 1, 17 *		
Y,D	US 2006/258964 A1 (BIONDO JOHN P [US] ET AL) 16 November 2006 (2006-11-16)	4	
	* abstract; figure 1 *		
Y	US 2002/044059 A1 (REEDER RYAN A [US] ET AL) 18 April 2002 (2002-04-18)	7,9-11	
	* abstract; figure 1 *		
The present search report has been drawn up for all claims			
Place of search The Hague		Date of completion of the search 8 October 2013	Examiner Sommer, Jean
CATEGORY OF CITED DOCUMENTS X : particularly relevant if taken alone Y : particularly relevant if combined with another document of the same category A : technological background O : non-written disclosure P : intermediate document		T : theory or principle underlying the invention E : earlier patent document, but published on, or after the filing date D : document cited in the application L : document cited for other reasons & : member of the same patent family, corresponding document	

2  
EPO FORM 1503 03.82 (P04C01)

**ANNEX TO THE EUROPEAN SEARCH REPORT  
ON EUROPEAN PATENT APPLICATION NO.**

EP 13 17 9526

This annex lists the patent family members relating to the patent documents cited in the above-mentioned European search report. The members are as contained in the European Patent Office EDP file on  
The European Patent Office is in no way liable for these particulars which are merely given for the purpose of information.

08-10-2013

Patent document cited in search report	Publication date	Patent family member(s)	Publication date
US 2007169268 A1	26-07-2007	US 2007157385 A1	12-07-2007
		US 2007163043 A1	19-07-2007
		US 2007169268 A1	26-07-2007
		US 2007174964 A1	02-08-2007
		US 2011162141 A1	07-07-2011
		US 2011231996 A1	29-09-2011
		US 2011277242 A1	17-11-2011
		WO 2007075701 A2	05-07-2007
		-----	-----
US 2003052787 A1	20-03-2003	AT 463779 T	15-04-2010
		AU 2002321885 A1	24-02-2003
		CA 2454243 A1	20-02-2003
		EP 1421458 A2	26-05-2004
		EP 2244200 A2	27-10-2010
		EP 2302541 A2	30-03-2011
		EP 2302542 A2	30-03-2011
		JP 2005523042 A	04-08-2005
		JP 2005527245 A	15-09-2005
		US 2003052787 A1	20-03-2003
		US 2007120689 A1	31-05-2007
		US 2010154124 A1	24-06-2010
		US 2011166891 A1	07-07-2011
		US 2012102434 A1	26-04-2012
		US 2013131870 A1	23-05-2013
WO 03014871 A2	20-02-2003		
-----	-----	-----	-----
US 2008172789 A1	24-07-2008	EP 2214616 A1	11-08-2010
		US 2008172789 A1	24-07-2008
		US 2011144548 A1	16-06-2011
		WO 2009065109 A1	22-05-2009
-----	-----	-----	-----
US 2007180616 A1	09-08-2007	EP 1983865 A2	29-10-2008
		EP 1983957 A2	29-10-2008
		EP 1983958 A2	29-10-2008
		EP 2556811 A1	13-02-2013
		US 2007180616 A1	09-08-2007
		US 2007180624 A1	09-08-2007
		US 2007181751 A1	09-08-2007
		US 2010263123 A1	21-10-2010
		WO 2007092526 A2	16-08-2007
		WO 2007092886 A2	16-08-2007
		WO 2007092922 A2	16-08-2007
-----	-----	-----	-----
US 2006258964 A1	16-11-2006	US 2006258964 A1	16-11-2006
		US 2010076356 A1	25-03-2010
		WO 2004091463 A2	28-10-2004

EPO FORM P0459

For more details about this annex : see Official Journal of the European Patent Office, No. 12/82

ANNEX TO THE EUROPEAN SEARCH REPORT  
ON EUROPEAN PATENT APPLICATION NO.

EP 13 17 9526

This annex lists the patent family members relating to the patent documents cited in the above-mentioned European search report. The members are as contained in the European Patent Office EDP file on  
The European Patent Office is in no way liable for these particulars which are merely given for the purpose of information.

08-10-2013

Patent document cited in search report	Publication date	Patent family member(s)	Publication date
US 2002044059 A1	18-04-2002	AU 6119801 A	20-11-2001
		BR 0110596 A	02-08-2005
		CA 2408230 A1	15-11-2001
		EP 1278456 A2	29-01-2003
		JP 4072343 B2	09-04-2008
		JP 2004514464 A	20-05-2004
		JP 2005199064 A	28-07-2005
		US 2002044059 A1	18-04-2002
		US 2009241807 A1	01-10-2009
		WO 0186575 A2	15-11-2001

**REFERENCES CITED IN THE DESCRIPTION**

*This list of references cited by the applicant is for the reader's convenience only. It does not form part of the European patent document. Even though great care has been taken in compiling the references, errors or omissions cannot be excluded and the EPO disclaims all liability in this regard.*

**Patent documents cited in the description**

- US 5664270 A [0003]
- US 5715548 A [0003]
- US 6493568 A [0003]
- US 6899103 A [0003]
- US 7038588 A [0003]
- US 7154397 A [0003]
- US 7343916 A [0003]
- US 7515059 A [0003]
- US 7641623 A [0003]
- US 20080126132 A [0003]
- US 20080005838 A [0003]
- US 20050190068 A [0003]
- US 6658680 B [0043]
- US 6611979 B [0043]

专利名称(译)	用于患者支持，监测和治疗的系统		
公开(公告)号	<a href="#">EP2664314A1</a>	公开(公告)日	2013-11-20
申请号	EP2013179526	申请日	2010-07-09
[标]申请(专利权)人(译)	希尔 - 罗姆服务股份有限公司		
申请(专利权)人(译)	HILL-ROM SERVICES , INC.		
当前申请(专利权)人(译)	HILL-ROM SERVICES , INC.		
[标]发明人	SODERBERG PETER H STANLEY TIMOTHY A O'KEEFE CHRISTOPHER R		
发明人	SODERBERG, PETER H. STANLEY, TIMOTHY A. O'KEEFE, CHRISTOPHER R.		
IPC分类号	A61G7/015 A61G7/05 A61B5/00		
CPC分类号	A61B5/7445 A61B5/00 A61B5/4839 A61B5/6891 A61B5/743 A61G7/015 A61G7/0506 A61G7/0507 A61G7/0514 A61G7/0524 A61G7/0527 A61G2203/72 A61H9/0078 A61H23/00 A61H23/04 A61H31 /008 A61H31/02 A61H2201/5041 A61H2201/5097 A61H2209/00 A61H2230/04 A61H2230/30 A61H2230/50 A61M5/172		
审查员(译)	SOMMER , JEAN		
优先权	61/224851 2009-07-10 US 61/225920 2009-07-15 US		
外部链接	<a href="#">Espacenet</a>		

摘要(译)

医院病床 ( 10 ) 包括框架 ( 12 ) ; 由框架 ( 12 ) 承载的医院病床电子设备 ( 45 ) , 医院病床电子设备 ( 45 ) 控制以下各项 : 框架 ( 10 ) 的部分的移动以重新定位患者 , IV 泵的操作 , 操作 a 生命体征监测和治疗装置的操作 ; 至少一个与框架 ( 10 ) 连接的屏障 ( 16, 18 ) ; 至少一个图形显示器 ( 91, 92, 97, 98 ) , 作为屏障 ( 16, 18 ) 的一部分包括在内 , 并显示与 IV 泵的操作有关的信息 , 与生命体征监视器的操作有关的信息 , 以及与治疗装置的操作有关的信息。

