



(11) **EP 2 127 610 A3**

(12) **EUROPEAN PATENT APPLICATION**

(88) Date of publication A3:
19.05.2010 Bulletin 2010/20

(51) Int Cl.:
A61B 19/02 (2006.01) **A61B 19/00 (2006.01)**
A61B 5/021 (2006.01)

(43) Date of publication A2:
02.12.2009 Bulletin 2009/49

(21) Application number: **09010613.9**

(22) Date of filing: **12.08.2005**

(84) Designated Contracting States:
DE FR GB IT

(30) Priority: **13.08.2004 US 601450 P**
04.03.2005 US 658626 P
17.05.2005 US 131015

(62) Document number(s) of the earlier application(s) in accordance with Art. 76 EPC:
05786449.8 / 1 786 350

(71) Applicant: **Welch Allyn, INC.**
Skaneateles Falls, NY 13153 (US)

(72) Inventors:
• **Wawro, Thaddeus J.**
NY 13021 Auburn (US)
• **Metz, Kristin A.**
NY 13031 Camillus (US)
• **Perkins, David G.**
NY 13159 Tully (US)
• **Linquest, Douglas J.**
OR 97068 West Linn (US)
• **Sonderberg, Peter H.**
NY 13152 Skaneateles (US)

(74) Representative: **Hauck Patent- und Rechtsanwälte**
Schwanthalerstrasse 106
80339 München (DE)

(54) **Mobile medical workstation**

(57) A medical workstation (20) is defined by a supporting structure (28) having at least one medical diagnostic instrument disposed (60) thereupon. A first display is further disposed (82) on a first side of the supporting structure and a second display (84) is disposed on a second side of the supporting structure in a manner substantially opposite from the first display. Each of the first and second displays are interconnected to the at least one medical diagnostic instrument to permit at least one of the displays in order to display diagnostic results and are tandemly or independently controllable.

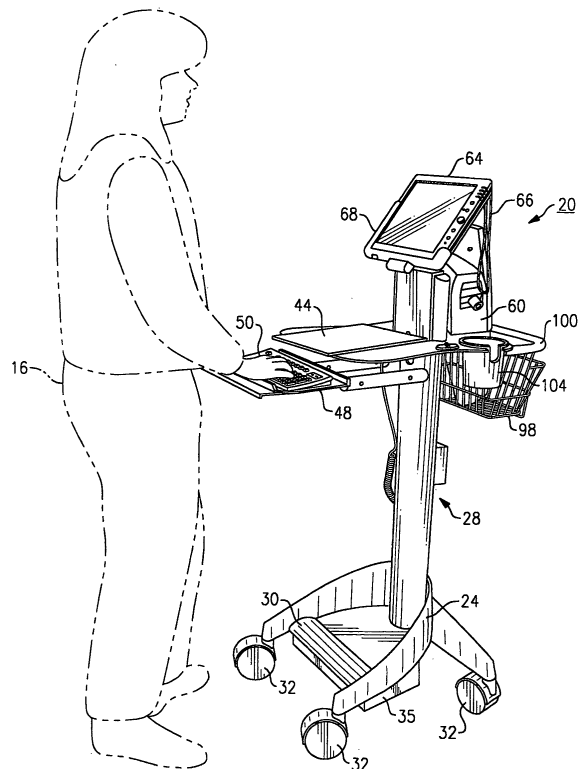

FIG.1

EP 2 127 610 A3



EUROPEAN SEARCH REPORT

Application Number
EP 09 01 0613

DOCUMENTS CONSIDERED TO BE RELEVANT			
Category	Citation of document with indication, where appropriate, of relevant passages	Relevant to claim	CLASSIFICATION OF THE APPLICATION (IPC)
X	WO 2004/017831 A (WELCH ALLYN INC [US]) 4 March 2004 (2004-03-04) * paragraphs [0025], [0097], [0150] * -----	1-3,6,7, 9-12	INV. A61B19/02 A61B19/00 A61B5/021
X	US 2002/106709 A1 (POTTS RUSSELL O [US] ET AL) 8 August 2002 (2002-08-08) * abstract * * paragraphs [0008], [0018], [0138] * -----	1,2,7-12	
X	WO 98/55021 A (SOUTHWEST RES INST [US]) 10 December 1998 (1998-12-10) * abstract * * page 40, last paragraph - page 41, paragraph 1 * * page 5, paragraph 2 * * page 35, paragraph 6 * -----	1,2,4,5, 9-12	
X	US 2003/181815 A1 (EBNER DENNIS M [US] ET AL) 25 September 2003 (2003-09-25) * abstract * -----	1,2,4,6, 9-12	
			TECHNICAL FIELDS SEARCHED (IPC)
			A61B
The present search report has been drawn up for all claims			
Place of search Berlin		Date of completion of the search 6 April 2010	Examiner Clevorn, Jens
CATEGORY OF CITED DOCUMENTS X : particularly relevant if taken alone Y : particularly relevant if combined with another document of the same category A : technological background O : non-written disclosure P : intermediate document		T : theory or principle underlying the invention E : earlier patent document, but published on, or after the filing date D : document cited in the application L : document cited for other reasons & : member of the same patent family, corresponding document	

5
EPO FORM 1503 03/82 (P04C01)

ANNEX TO THE EUROPEAN SEARCH REPORT
ON EUROPEAN PATENT APPLICATION NO.

EP 09 01 0613

This annex lists the patent family members relating to the patent documents cited in the above-mentioned European search report. The members are as contained in the European Patent Office EDP file on The European Patent Office is in no way liable for these particulars which are merely given for the purpose of information.

06-04-2010

Patent document cited in search report	Publication date	Patent family member(s)	Publication date
WO 2004017831 A	04-03-2004	NONE	
-----	-----	-----	-----
US 2002106709 A1	08-08-2002	US 2005119540 A1	02-06-2005
-----	-----	-----	-----
WO 9855021 A	10-12-1998	DE 69821931 D1	01-04-2004
		EP 0986324 A1	22-03-2000
		JP 3496940 B2	16-02-2004
		JP 2001506167 T	15-05-2001
		US 5931790 A	03-08-1999
-----	-----	-----	-----
US 2003181815 A1	25-09-2003	AU 2003220455 A1	13-10-2003
		EP 1487329 A2	22-12-2004
		WO 03082073 A2	09-10-2003
		US 2006155176 A1	13-07-2006
-----	-----	-----	-----

专利名称(译)	移动医疗工作站		
公开(公告)号	EP2127610A3	公开(公告)日	2010-05-19
申请号	EP2009010613	申请日	2005-08-12
[标]申请(专利权)人(译)	伟伦公司		
申请(专利权)人(译)	伟伦, INC.		
当前申请(专利权)人(译)	伟伦, INC.		
[标]发明人	WAWRO THADDEUS J METZ KRISTIN A PERKINS DAVID G LINQUEST DOUGLAS J SONDERBERG PETER H		
发明人	WAWRO, THADDEUS J. METZ, KRISTIN A. PERKINS, DAVID G. LINQUEST, DOUGLAS J. SONDERBERG, PETER H.		
IPC分类号	A61B19/02 A61B19/00 A61B5/021 A61B5/00 A61B5/02 A61B5/0402 A61B5/05 A61B5/117		
CPC分类号	A61B5/0002 A61B5/02 A61B5/0402 A61B5/1172 A61B5/14532 A61B5/1455 A61B5/412 A61B5/742 A61B5/743 A61B5/7435 A61B5/7475 A61B50/10 A61B50/13 A61B90/50 A61B2560/0437 A61B2560/0456		
代理机构(译)	HAUCK专利和律师		
优先权	11/131015 2005-05-17 US 60/601450 2004-08-13 US 60/658626 2005-03-04 US		
其他公开文献	EP2127610A2		
外部链接	Espacenet		

摘要(译)

医疗工作站 (20) 由支撑结构 (28) 限定, 该支撑结构 (28) 具有至少一个设置在其上的医疗诊断仪器 (60)。第一显示器进一步设置 (82) 在支撑结构的第一侧上, 第二显示器 (84) 以与第一显示器基本相对的方式设置在支撑结构的第二侧上。第一和第二显示器中的每一个与至少一个医疗诊断仪器互连, 以允许至少一个显示器显示诊断结果并且串联或独立可控。

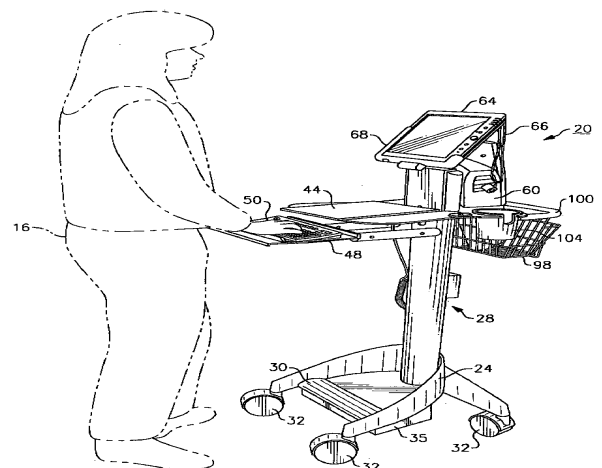

FIG. 1