



(12) **EUROPEAN PATENT APPLICATION**

(88) Date of publication A3:
21.11.2012 Bulletin 2012/47

(51) Int Cl.:
A61B 5/1455 (2006.01)

(43) Date of publication A2:
22.08.2012 Bulletin 2012/34

(21) Application number: **12165265.5**

(22) Date of filing: **19.06.2003**

(84) Designated Contracting States:
AT BE BG CH CY CZ DE DK EE ES FI FR GB GR HU IE IT LI LU MC NL PT RO SE SI SK TR

(30) Priority: **20.06.2002 US 176310**

(62) Document number(s) of the earlier application(s) in accordance with Art. 76 EPC:
03761126.6 / 1 513 443

(71) Applicant: **The University of Florida Gainesville, FL 32611 (US)**

(72) Inventors:
• **Melker, Richard**
Gainesville, FL Florida FL 32605-3247 (US)
• **Layon, Joseph**
Gainesville, FL Florida 32610-0254 (US)
• **Worley, George E.**
Garland, TX Texas 75044 (US)
• **Nappo, Robert**
Gainesville, FL 32608 (US)

(74) Representative: **Papa, Elisabetta et al**
Società Italiana Brevetti S.p.A
Piazza di Pietra, 39
00186 Roma (IT)

(54) **Perfusion monitor and system, including specifically configured oximeter probes and covers for oximeter probes**

(57) The present invention relates to pulse oximeter probes that are configured to be placed, respectively, across the septum or nares of the nose. These probes are fabricated to provide signals to estimate arterial oxygen saturation. The present invention also relates to a

combined nasal pulse oximeter probe/nasal cannula. In certain embodiments, an additional limitation of a control means to adjust the flow rate of such gas is provided, where such control is directed by the blood oxygen saturation data obtained from the pulse oximeter probe.

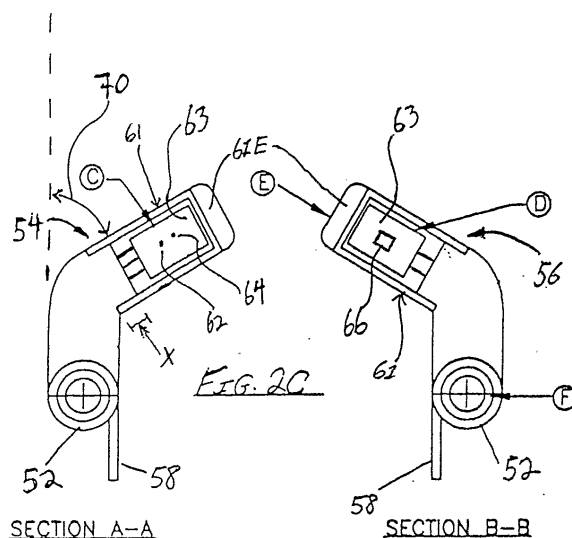

**PARTIAL EUROPEAN SEARCH REPORT**

Application Number

under Rule 62a and/or 63 of the European Patent Convention.
This report shall be considered, for the purposes of
subsequent proceedings, as the European search report

EP 12 16 5265

DOCUMENTS CONSIDERED TO BE RELEVANT			
Category	Citation of document with indication, where appropriate, of relevant passages	Relevant to claim	CLASSIFICATION OF THE APPLICATION (IPC)
X	US 4 830 014 A (GOODMAN DAVID E [US] ET AL) 16 May 1989 (1989-05-16) * column 1, line 11 - line 17 * * column 5, line 3 - line 29 * * column 8, line 49 - line 67; figures 2,3 * * column 1, line 25 - line 43 * * column 10, line 10 - line 17; figure 9 * -----	1	INV. A61B5/1455
X	US 5 335 659 A (POLOGE JONAS A [US]) 9 August 1994 (1994-08-09)	1-5,8, 11,14, 39,41 15,27,40	
Y	* column 1, line 5 - line 11 * * column 2, line 30 - line 68 * * column 4, line 3 - line 6; figure 3 * * column 3, line 54 - line 66 * * figures 1,2,5,6 * * column 3, line 22 - line 27 * * column 4, line 40 - column 5, line 5 * ----- -/--		
			TECHNICAL FIELDS SEARCHED (IPC)
			A61B
INCOMPLETE SEARCH			
<p>The Search Division considers that the present application, or one or more of its claims, does/do not comply with the EPC so that only a partial search (R.62a, 63) has been carried out.</p> <p>Claims searched completely :</p> <p>Claims searched incompletely :</p> <p>Claims not searched :</p> <p>Reason for the limitation of the search: see sheet C</p>			
Place of search		Date of completion of the search	Examiner
The Hague		12 October 2012	Ekstrand, Vilhelm
<p>CATEGORY OF CITED DOCUMENTS</p> <p>X : particularly relevant if taken alone Y : particularly relevant if combined with another document of the same category A : technological background O : non-written disclosure P : intermediate document</p> <p>T : theory or principle underlying the invention E : earlier patent document, but published on, or after the filing date D : document cited in the application L : document cited for other reasons & : member of the same patent family, corresponding document</p>			

 3
EPO FORM 1503 03.82 (P04E07)



PARTIAL EUROPEAN SEARCH REPORT

Application Number
EP 12 16 5265

DOCUMENTS CONSIDERED TO BE RELEVANT			CLASSIFICATION OF THE APPLICATION (IPC)
Category	Citation of document with indication, where appropriate, of relevant passages	Relevant to claim	
X	US 6 142 149 A (STEEN SCOT KENNETH [US]) 7 November 2000 (2000-11-07)	1,8-10, 16,17	
Y	* figure 4 * * column 3, line 44 - line 60; figure 1 * * column 2, line 35 - line 43 * -----	15,40	
X	US 6 371 114 B1 (SCHMIDT MATTHEW F [US] ET AL) 16 April 2002 (2002-04-16)	8-10,12, 34	
Y	* paragraph [0054] - paragraph [0058]; figure 1 *	13	TECHNICAL FIELDS SEARCHED (IPC)
A	* paragraph [0052] * * paragraph [0046] * * paragraph [0060] - paragraph [0062] * * paragraph [0126] * -----	1-5, 39-41	
X	US 6 334 065 B1 (AL-ALI AMMAR [US] ET AL) 25 December 2001 (2001-12-25)	1,8,9	
A	* column 18, line 7 - line 20 * * column 5, line 21 - line 26 * -----	18-27, 35-38	
A	US 6 213 955 B1 (KARAKASOGLU AHMET [US] ET AL) 10 April 2001 (2001-04-10)	1-5, 39-41	
	* figures 1-3 * -----		
A	US 4 457 756 A (KERN EUGENE B [US] ET AL) 3 July 1984 (1984-07-03)	1-5, 39-41	
	* column 1, line 34 - line 39 * * claim 5; figures 1-8 * -----		
X	US 4 685 464 A (GOLDBERGER DANIEL S [US] ET AL) 11 August 1987 (1987-08-11)	1,6,7	
	* column 1, line 5 - line 9 * * column 4, line 20 - line 34 * * column 6, line 45 - column 7, line 35; figure 3 * * column 7, line 66 - column 8, line 13 * ----- -/--		



PARTIAL EUROPEAN SEARCH REPORT

Application Number
EP 12 16 5265

DOCUMENTS CONSIDERED TO BE RELEVANT			CLASSIFICATION OF THE APPLICATION (IPC)
Category	Citation of document with indication, where appropriate, of relevant passages	Relevant to claim	
Y	US 6 190 327 B1 (ISAACSON PHILLIP O [US] ET AL) 20 February 2001 (2001-02-20)	13	
A	* column 3, line 5 - line 18 *	12,34	

A	W0 99/20332 A1 (CHRISTOPHER KENT L [US]) 29 April 1999 (1999-04-29)	12,13,34	
	* page 11, line 1 - line 20; figure 1 *		
	* page 7, line 1 - line 20 *		

A	US 5 046 491 A (DERRICK STEVEN J [US]) 10 September 1991 (1991-09-10)	12,13,34	
	* column 5, line 1 - line 20 *		
	* column 1, line 10 - line 13 *		

X	W0 01/78597 A1 (CHEETAH MEDICAL INC [US]; KEREN HANAN [IL]) 25 October 2001 (2001-10-25)	18,19	TECHNICAL FIELDS SEARCHED (IPC)
Y	* page 1, line 5 - line 17 *	20,27	
A	* page 9, line 4 - line 23; figure 5 *	21-26,	
	* page 3, line 15 - page 20 *	35-38	
	* page 12, line 20 *		

Y	W0 01/24845 A2 (MILLS ALEXANDER K [US]) 12 April 2001 (2001-04-12)	20	
A	* page 6, line 27 - line 31 *	18,19,	
	* page 16, line 12 - line 20 *	21-27,	
	* page 25, line 16 - line 21 *	35-38	
	* page 3, line 9 - line 13 *		
	* page 3, line 21 - line 26 *		

**INCOMPLETE SEARCH
SHEET C**

Application Number

EP 12 16 5265

Claim(s) completely searchable:
1-27, 34-41

Claim(s) not searched:
28-33

Reason for the limitation of the search (non-patentable invention(s)):

Claims 28 relate to diagnostic methods practised on the human or animal body and are therefore not allowed (Article 53(c)). This because claim 28 involves the following phases:

i) examination phase: claim 28, part c "measuring signals from said central source site pulse oximeter and said first peripheral site pulse oximeter"

ii) comparison phase: description page 38, l 14-17, the difference between the peripheral site and the central source site are compared to a standard value of about 5 percent points.

iii) finding of significant deviation: same passage, a difference greater than 5 percent points is a significant deviation.

iv) decision phase: claim 28, "to determine the presence or absence of impaired peripheral perfusion"

Further, all steps of a technical nature in phases i-iii are performed on the body. Thus, claims 28-33 fulfills all requirements of a diagnostic medical method within the meaning of Article 53(c) EPC.



Application Number

EP 12 16 5265

CLAIMS INCURRING FEES

The present European patent application comprised at the time of filing claims for which payment was due.

☐ Only part of the claims have been paid within the prescribed time limit. The present European search report has been drawn up for those claims for which no payment was due and for those claims for which claims fees have been paid, namely claim(s):

☐ No claims fees have been paid within the prescribed time limit. The present European search report has been drawn up for those claims for which no payment was due.

LACK OF UNITY OF INVENTION

The Search Division considers that the present European patent application does not comply with the requirements of unity of invention and relates to several inventions or groups of inventions, namely:

see sheet B

☒ All further search fees have been paid within the fixed time limit. The present European search report has been drawn up for all claims.

☐ As all searchable claims could be searched without effort justifying an additional fee, the Search Division did not invite payment of any additional fee.

☐ Only part of the further search fees have been paid within the fixed time limit. The present European search report has been drawn up for those parts of the European patent application which relate to the inventions in respect of which search fees have been paid, namely claims:

☐ None of the further search fees have been paid within the fixed time limit. The present European search report has been drawn up for those parts of the European patent application which relate to the invention first mentioned in the claims, namely claims:

☐ The present supplementary European search report has been drawn up for those parts of the European patent application which relate to the invention first mentioned in the claims (Rule 164 (1) EPC).



**LACK OF UNITY OF INVENTION
SHEET B**

Application Number
EP 12 16 5265

The Search Division considers that the present European patent application does not comply with the requirements of unity of invention and relates to several inventions or groups of inventions, namely:

1. claims: 4, 5, 39, 40(completely); 1-3, 41(partially)

Oximeter probe adapted for the nose having two extensions

2. claims: 6, 7(completely); 1-3, 41(partially)

Oximeter probe having hinging means

3. claims: 8-17(completely); 1-3, 41(partially)

Oximeter probe with supply of oxygen

4. claims: 18-27, 35-38

A perfusion resistance monitor system

5. claims: 34(completely); 1-3, 41(partially)

Oximeter adapted for the nose having an extra sensor

**ANNEX TO THE EUROPEAN SEARCH REPORT
ON EUROPEAN PATENT APPLICATION NO.**

EP 12 16 5265

This annex lists the patent family members relating to the patent documents cited in the above-mentioned European search report.
The members are as contained in the European Patent Office EDP file on
The European Patent Office is in no way liable for these particulars which are merely given for the purpose of information.

12-10-2012

Patent document cited in search report		Publication date	Patent family member(s)	Publication date
US 4830014	A	16-05-1989	NONE	
US 5335659	A	09-08-1994	NONE	
US 6142149	A	07-11-2000	AU 6272699 A US 6142149 A WO 0018460 A1	17-04-2000 07-11-2000 06-04-2000
US 6371114	B1	16-04-2002	US 6371114 B1 US 2002112726 A1 US 2003145852 A1 US 2004159323 A1 US 2006213519 A1	16-04-2002 22-08-2002 07-08-2003 19-08-2004 28-09-2006
US 6334065	B1	25-12-2001	AT 521277 T AU 4214199 A CA 2333062 A1 EP 1082050 A1 EP 2319398 A1 JP 2002516689 A US 6334065 B1 US 2002082488 A1 US 2004059209 A1 US 2005197551 A1 US 2006258923 A1 US 2006258924 A1 US 2006258925 A1 US 2006270920 A1 US 2006281983 A1 WO 9962399 A1	15-09-2011 20-12-1999 09-12-1999 14-03-2001 11-05-2011 11-06-2002 25-12-2001 27-06-2002 25-03-2004 08-09-2005 16-11-2006 16-11-2006 16-11-2006 30-11-2006 14-12-2006 09-12-1999
US 6213955	B1	10-04-2001	NONE	
US 4457756	A	03-07-1984	NONE	
US 4685464	A	11-08-1987	NONE	
US 6190327	B1	20-02-2001	NONE	
WO 9920332	A1	29-04-1999	AU 1085699 A CA 2305189 A1 DE 69831016 D1 DE 69831016 T2 EP 1056498 A1 US 5954050 A WO 9920332 A1	10-05-1999 29-04-1999 01-09-2005 01-06-2006 06-12-2000 21-09-1999 29-04-1999

EPO FORM P0459

For more details about this annex : see Official Journal of the European Patent Office, No. 12/82

**ANNEX TO THE EUROPEAN SEARCH REPORT
ON EUROPEAN PATENT APPLICATION NO.**

EP 12 16 5265

This annex lists the patent family members relating to the patent documents cited in the above-mentioned European search report.
The members are as contained in the European Patent Office EDP file on
The European Patent Office is in no way liable for these particulars which are merely given for the purpose of information.

12-10-2012

Patent document cited in search report	Publication date	Patent family member(s)	Publication date
US 5046491	A	10-09-1991	AT 166581 T 15-06-1998
		AU 643276 B2 11-11-1993	
		AU 7670791 A 21-10-1991	
		CA 2078447 A1 28-09-1991	
		DE 69129503 D1 02-07-1998	
		EP 0673265 A1 27-09-1995	
		JP H05507004 A 14-10-1993	
		US 5046491 A 10-09-1991	
		WO 9114469 A1 03-10-1991	
WO 0178597	A1	25-10-2001	AU 7551900 A 30-10-2001
		EP 1292221 A1 19-03-2003	
		US 6676608 B1 13-01-2004	
		WO 0178597 A1 25-10-2001	
WO 0124845	A2	12-04-2001	AU 766952 B2 30-10-2003
		AU 7997300 A 10-05-2001	
		CA 2388033 A1 12-04-2001	
		EP 1233697 A2 28-08-2002	
		JP 2003511101 A 25-03-2003	
		MX PA02003412 A 10-09-2004	
		NZ 518142 A 28-11-2003	
		US 6537225 B1 25-03-2003	
		US 2002188205 A1 12-12-2002	
		US 2004162493 A1 19-08-2004	
		WO 0124845 A2 12-04-2001	

专利名称(译)	灌注监测器和系统，包括专门配置的血氧计探头和血氧计探头的盖子		
公开(公告)号	EP2489306A3	公开(公告)日	2012-11-21
申请号	EP2012165265	申请日	2003-06-19
[标]申请(专利权)人(译)	佛罗里达大学		
申请(专利权)人(译)	佛罗里达大学		
当前申请(专利权)人(译)	佛罗里达大学		
[标]发明人	MELKER RICHARD LAYON JOSEPH WORLEY GEORGE E NAPPO ROBERT		
发明人	MELKER, RICHARD LAYON, JOSEPH WORLEY, GEORGE E. NAPPO, ROBERT		
IPC分类号	A61B5/1455 A61B5/145 A61B5/00 A61B5/083 A61B5/087 A61M16/00		
CPC分类号	A61B5/0816 A61B5/0836 A61B5/0873 A61B5/14551 A61B5/14552 A61B5/6819 A61B5/682 A61B5/6826 A61B5/6829 A61B2560/0276 A61B2562/247 A61M16/0051 A61M16/021 A61M16/0666 A61M16/0672 A61M16/085 A61M2202/0208 A61M2202/03 A61M2205/3561 A61M2205/3569 A61M2210/0618 A61M2210/0625 A61M2210/0662 A61M2230/06 A61M2230/205 A61M2230/30 A61M2230/42 A61M2230/432 A61M2230/005 A61M2202/0007 A61B5/0205 A61B5/02416 A61B5/02427 A61B5/0261 A61B5/0295 A61B5/036 A61B5/087 A61B5/4818 A61B5/4836 A61B5/7278 A61B5/7282 A61M16/0003 A61M16/0057 A61M16/08 A61M16/20		
审查员(译)	埃克斯特兰德，VILHELM		
优先权	10/176310 2002-06-20 US		
其他公开文献	EP2489306B1 EP2489306A2		
外部链接	Espacenet		

摘要(译)

本发明涉及配置成分别放置在鼻子的隔膜或鼻孔周围的脉搏血氧计探针。这些探针被制造成提供信号以估计动脉血氧饱和度。本发明还涉及一种组合的鼻部脉搏血氧计探头/鼻插管。在某些实施例中，提供了控制装置的附加限制以调节这种气体的流速，其中这种控制由从脉搏血氧计探针获得的血氧饱和度数据引导。

