



US 20050146657A1

(19) **United States**

(12) **Patent Application Publication**

Wen et al.

(10) **Pub. No.: US 2005/0146657 A1**

(43) **Pub. Date:**

**Jul. 7, 2005**

(54) **TRANSFLECTIVE LIQUID CRYSTAL DISPLAY**

**Related U.S. Application Data**

(76) Inventors: **Chi-Jain Wen**, Hsin-Chu City (TW);  
**Dai-Liang Ting**, Hsin-Chu City (TW);  
**Hsiao-Yi Lin**, Hsin-Chu City (TW);  
**Gwo-Long Lin**, Hsin-Chu City (TW);  
**I-Wei Wu**, Hsin-Chu City (TW)

(62) Division of application No. 10/250,018, filed on May 29, 2003.

**Publication Classification**

(51) **Int. Cl.<sup>7</sup>** ..... **G02F 1/1335**

(52) **U.S. Cl.** ..... **349/114**

Correspondence Address:  
**NORTH AMERICA INTERNATIONAL  
PATENT OFFICE (NAIPC)  
P.O. BOX 506  
MERRIFIELD, VA 22116 (US)**

(57) **ABSTRACT**

A transflective liquid crystal display (LCD) includes at least a transmission pixel region and at least a reflection pixel region positioned in a pixel region. The transmission region includes at least a transmissive electrode connected to a first switching element. The reflection pixel region includes at least a reflective electrode connected to a second switching element. The transmissive and the reflective electrodes are controlled respectively by independent switching elements.

(21) Appl. No.: **10/907,053**

(22) Filed: **Mar. 18, 2005**

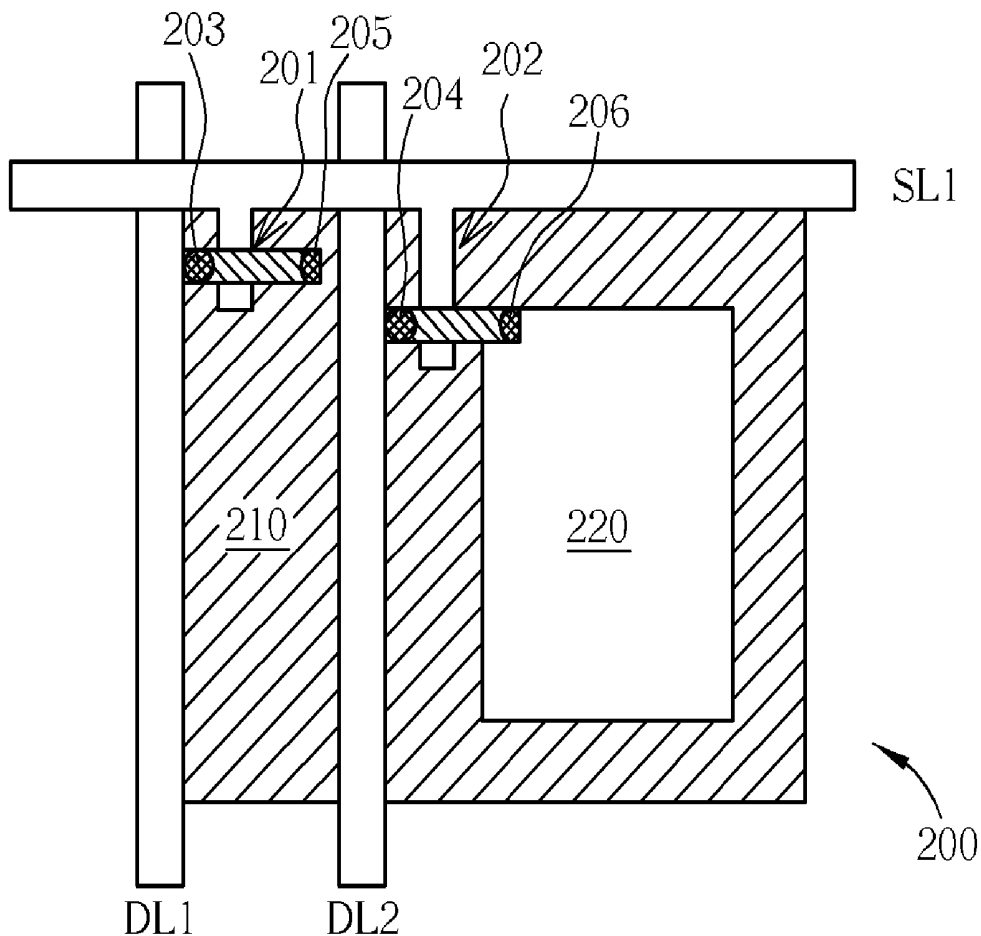

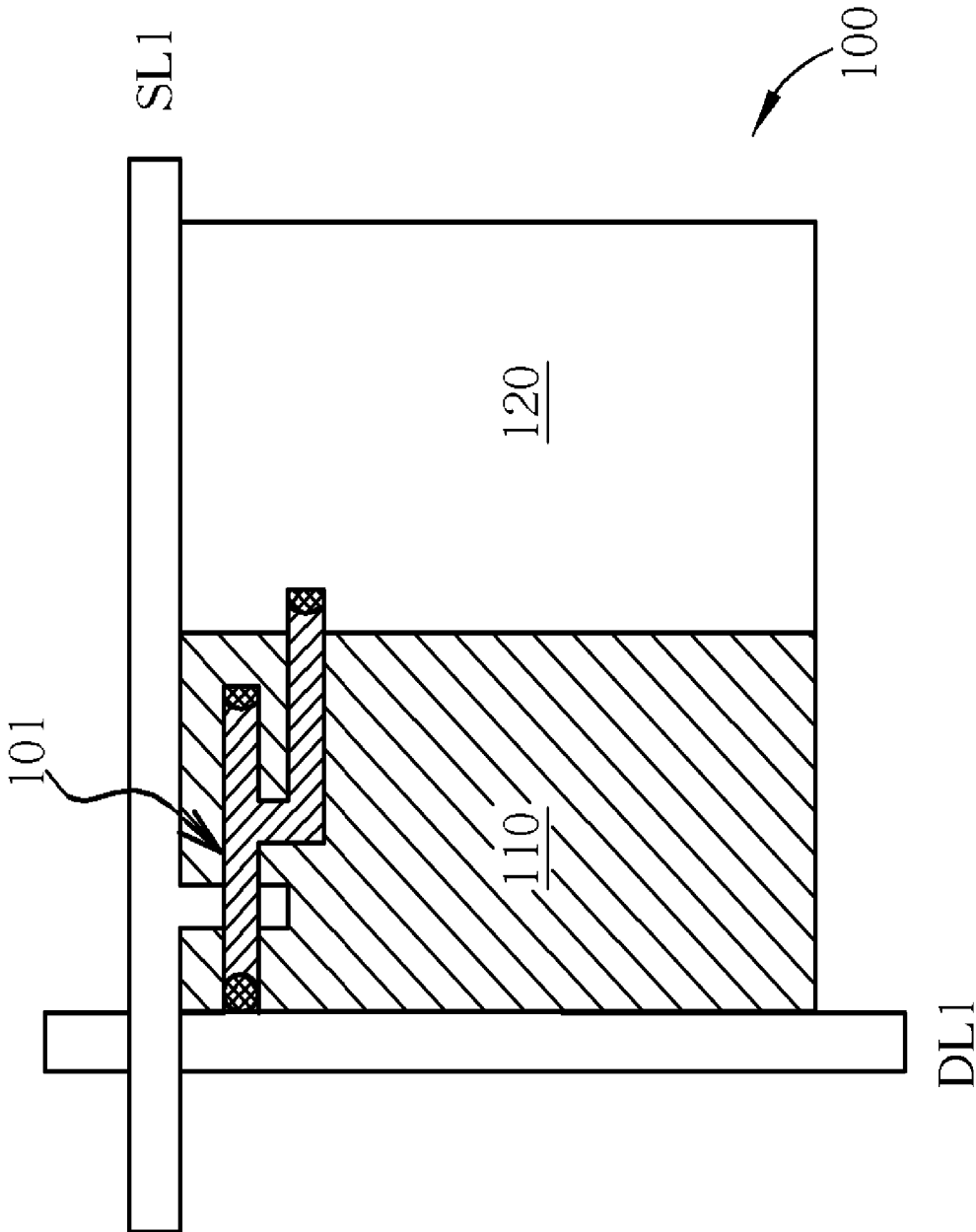

Fig. 1 Prior art

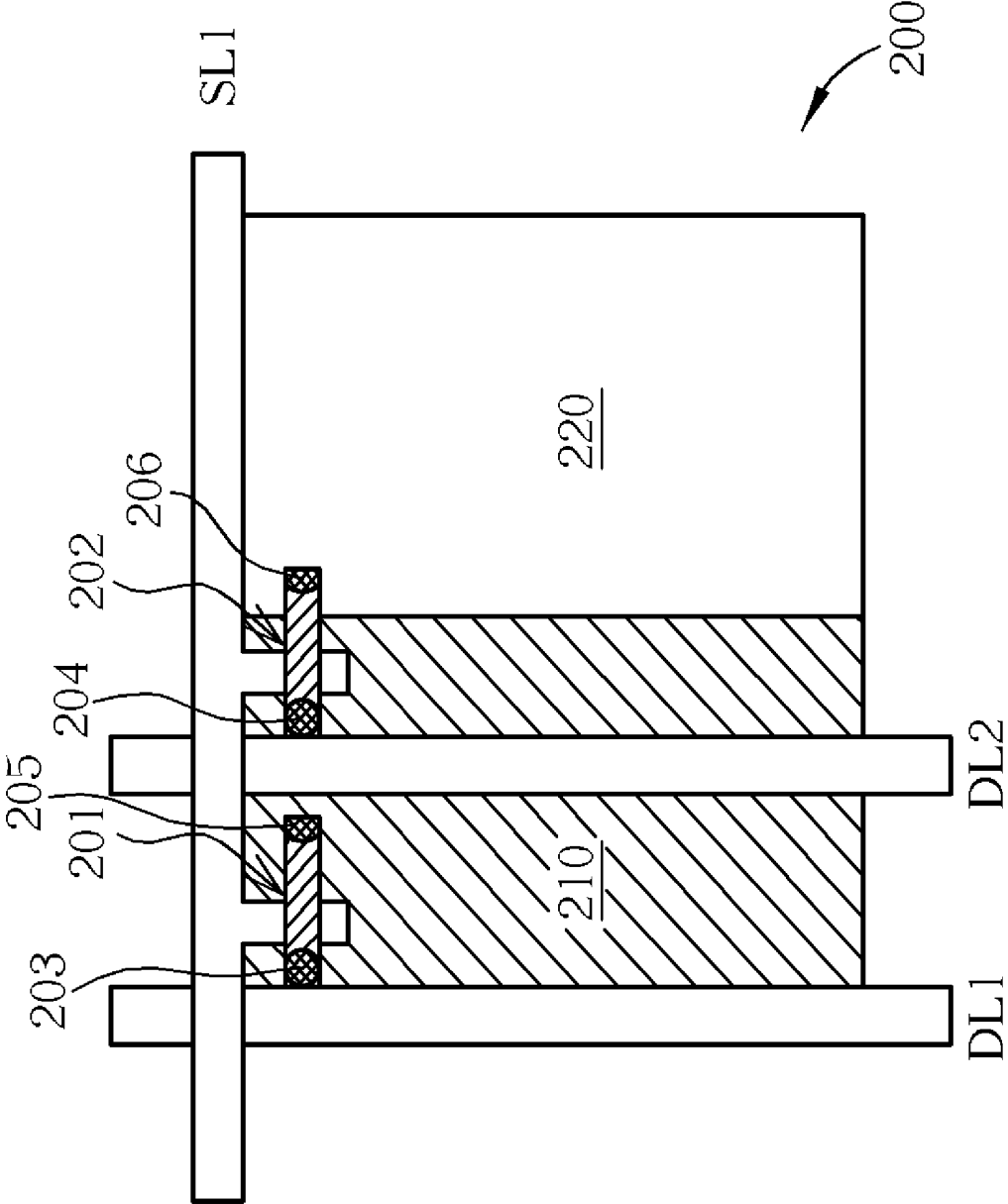

Fig. 2

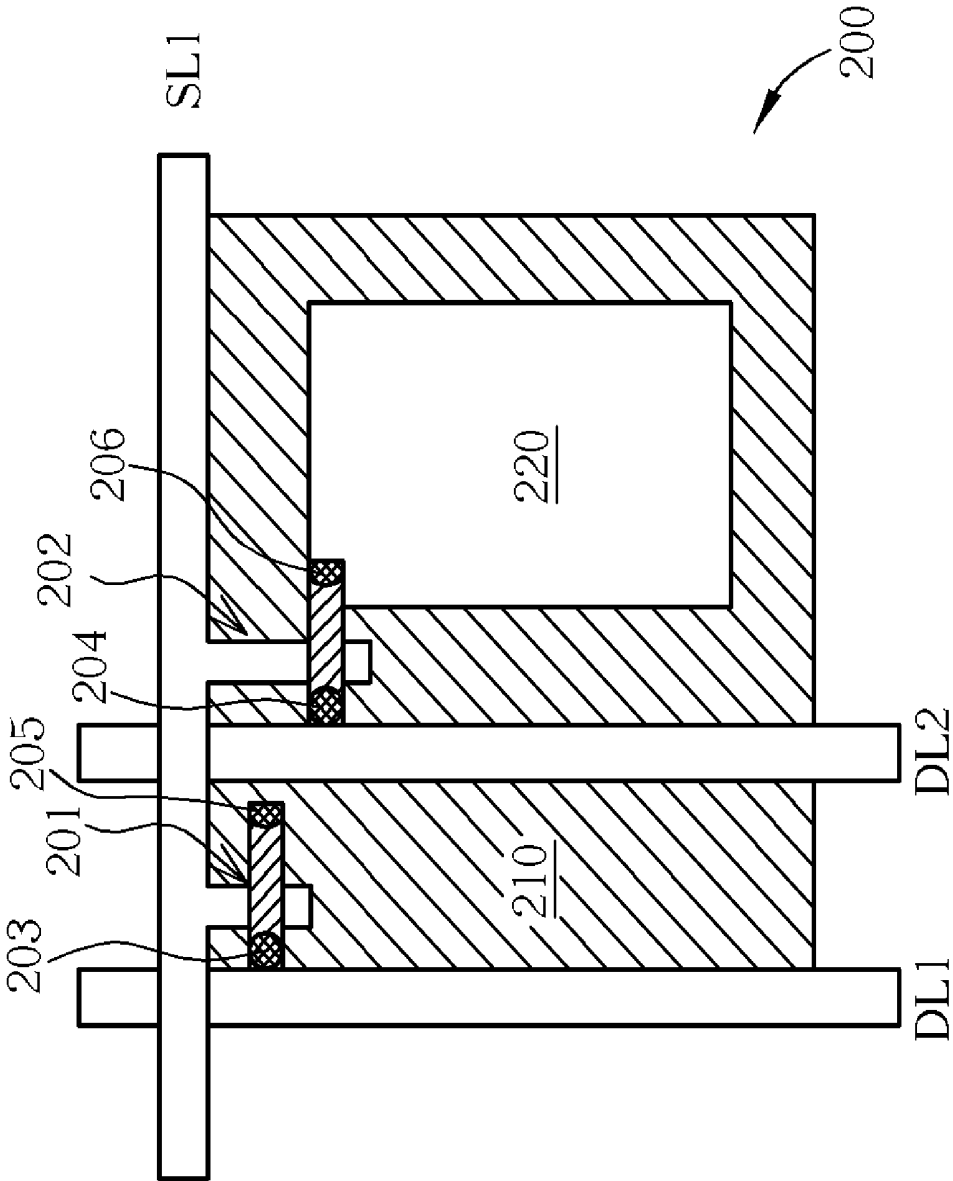

Fig. 3

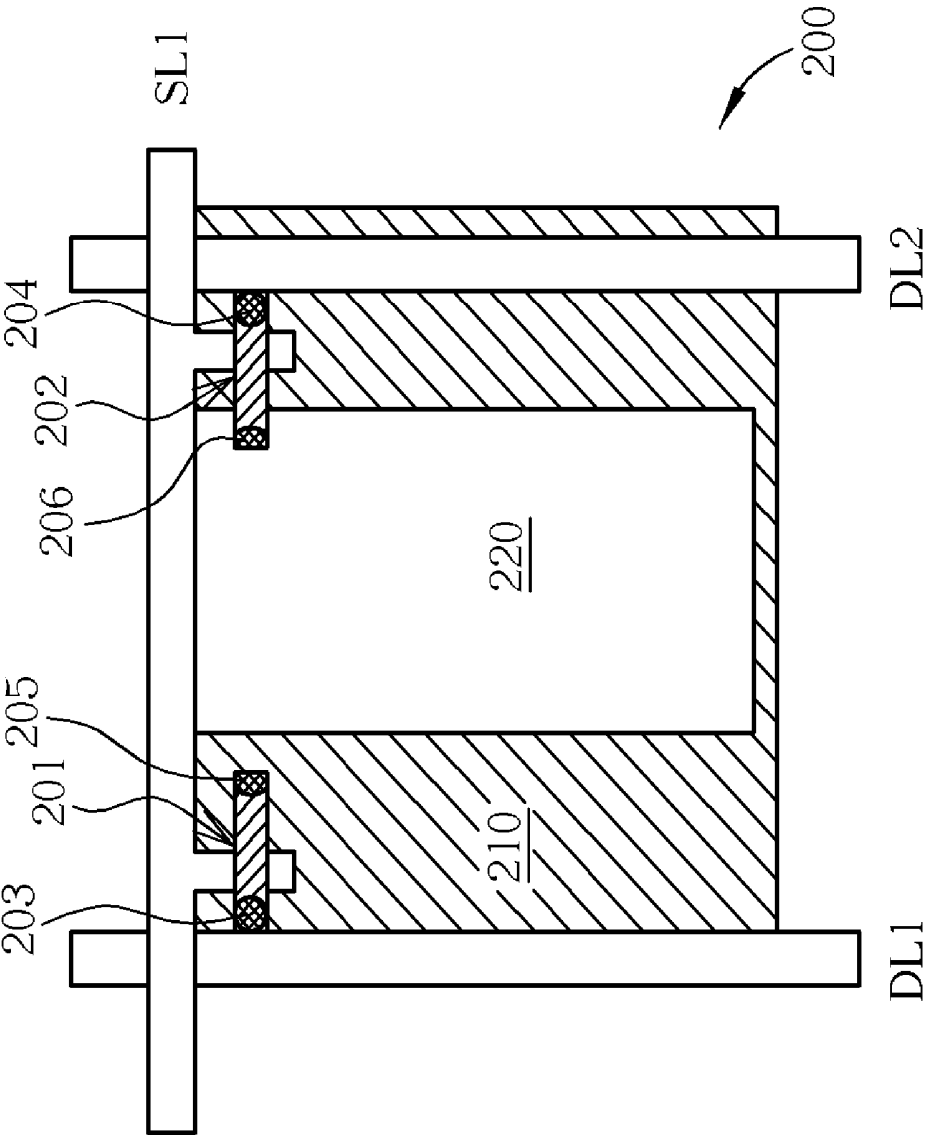

Fig. 4

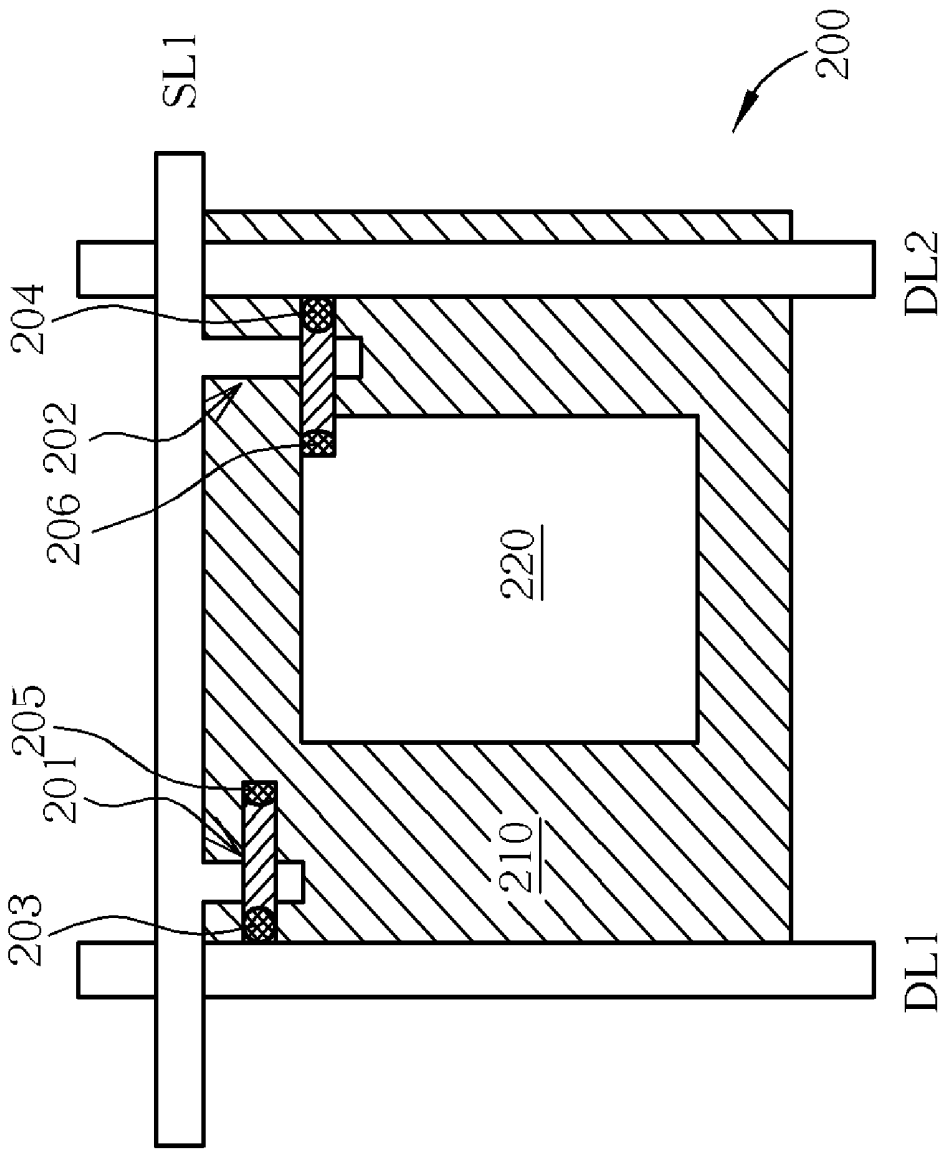

Fig. 5

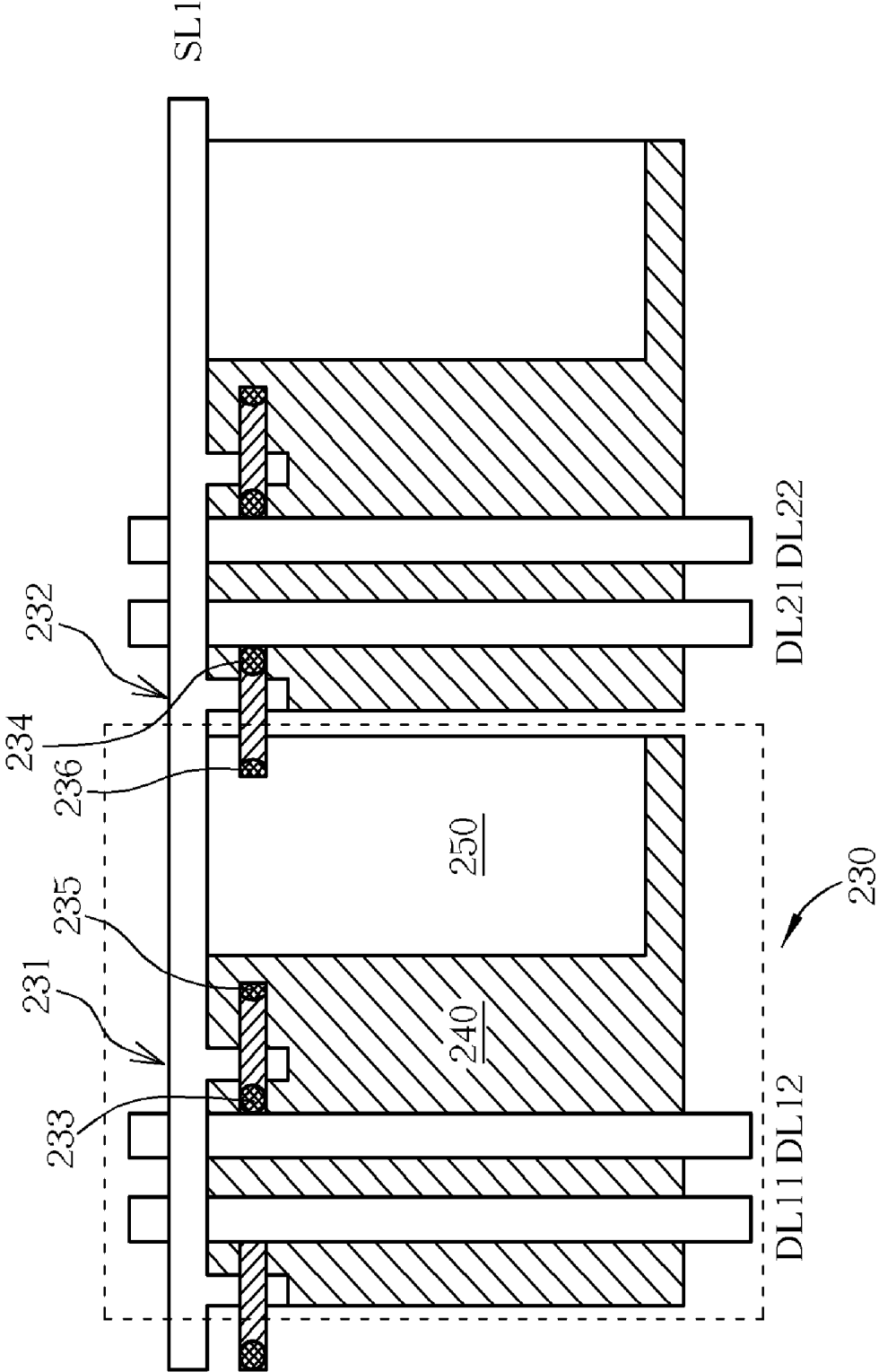

Fig. 6

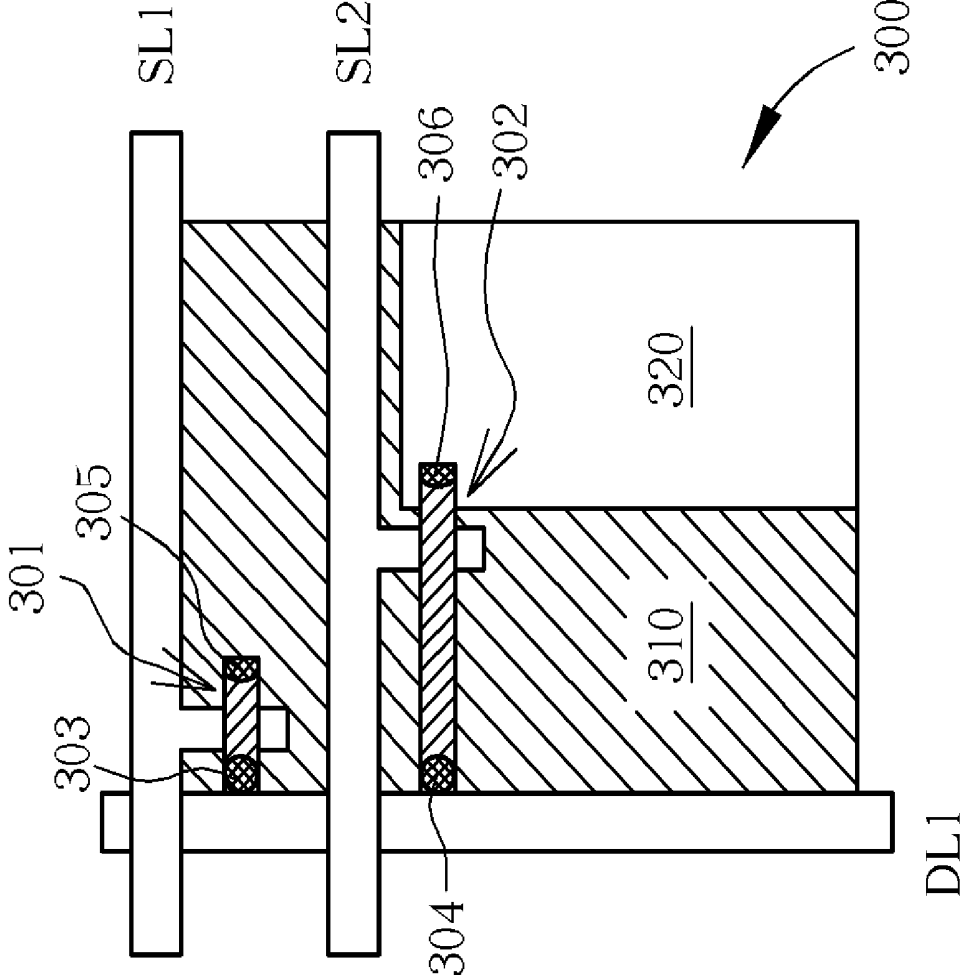

Fig. 7

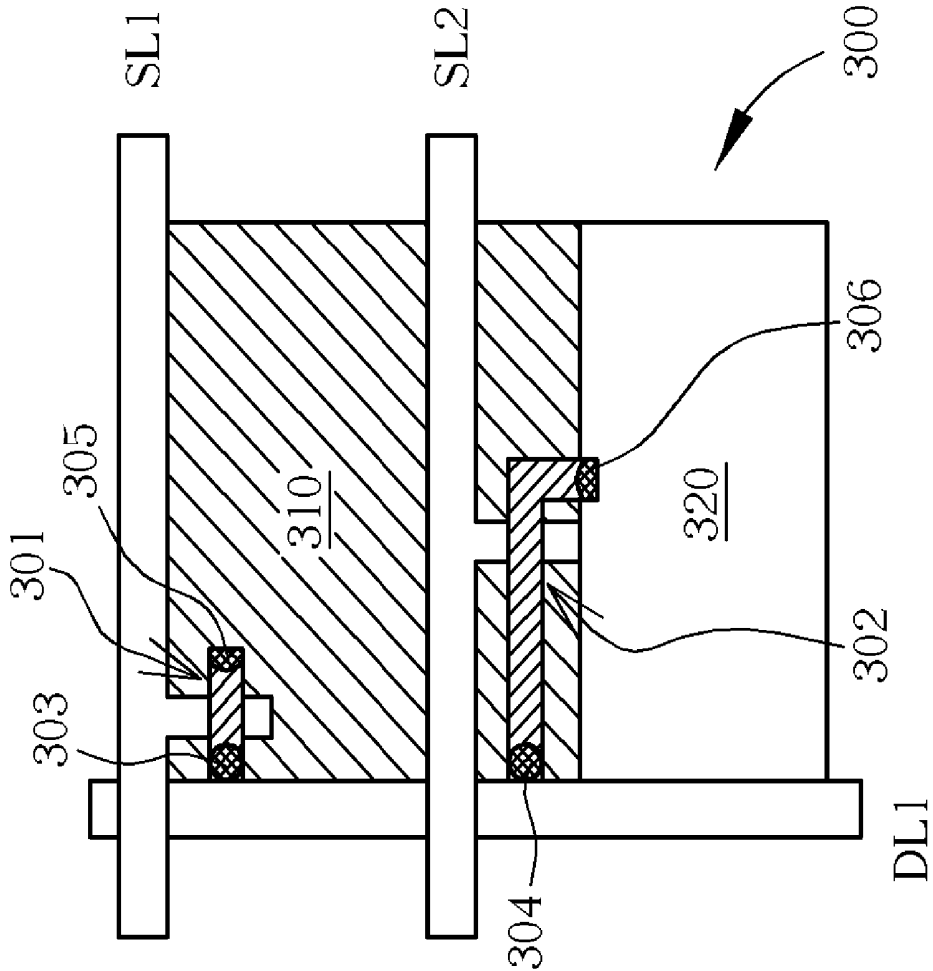

Fig. 8

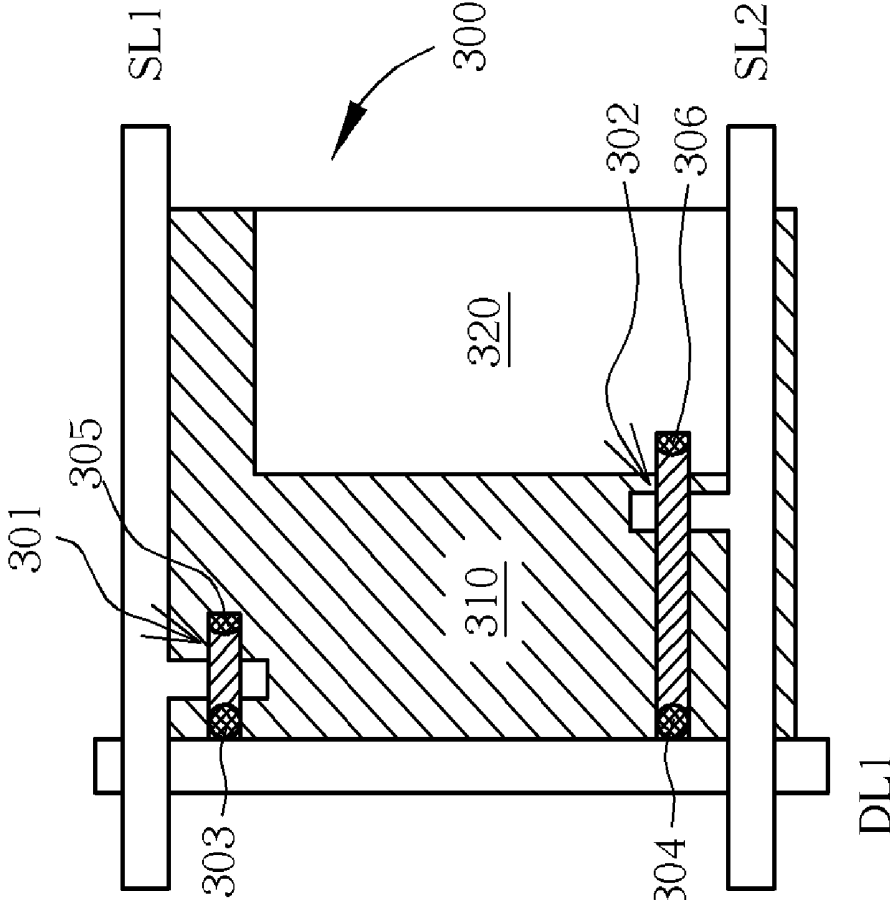

Fig. 9

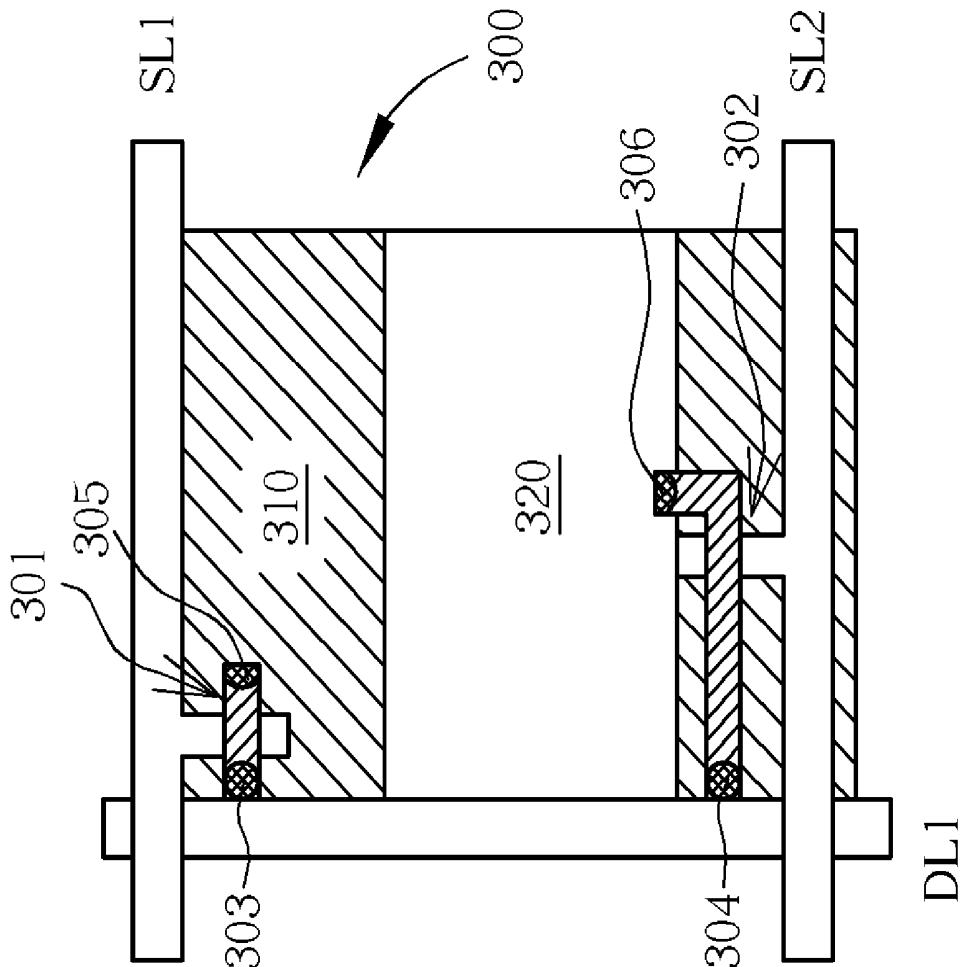

Fig. 10

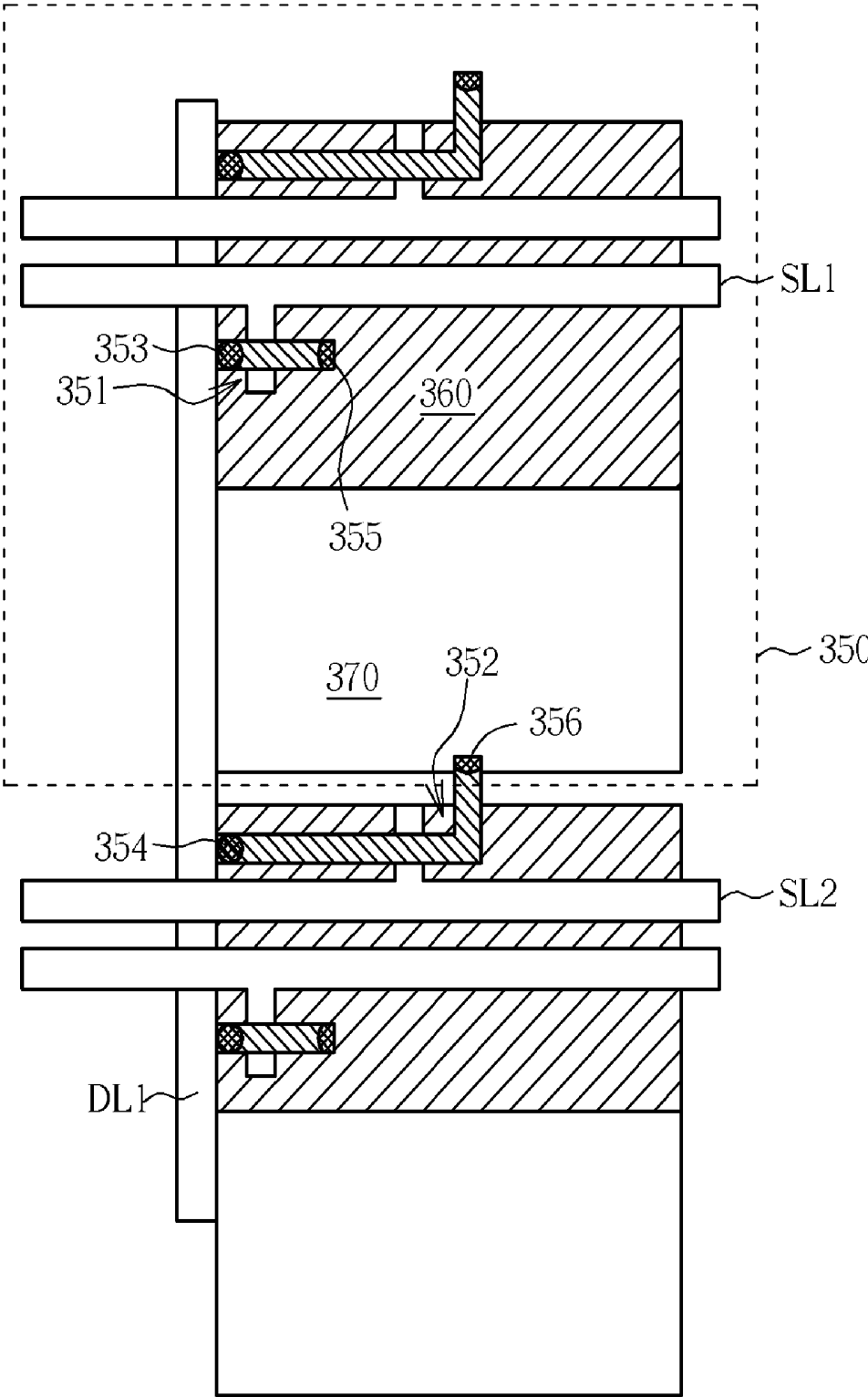

Fig. 11

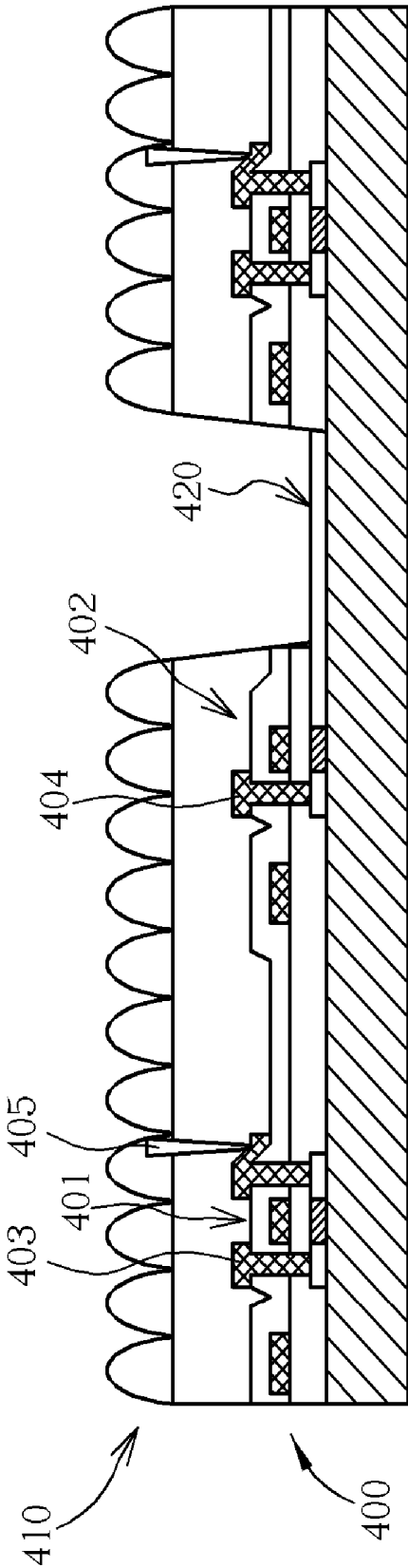

Fig. 12

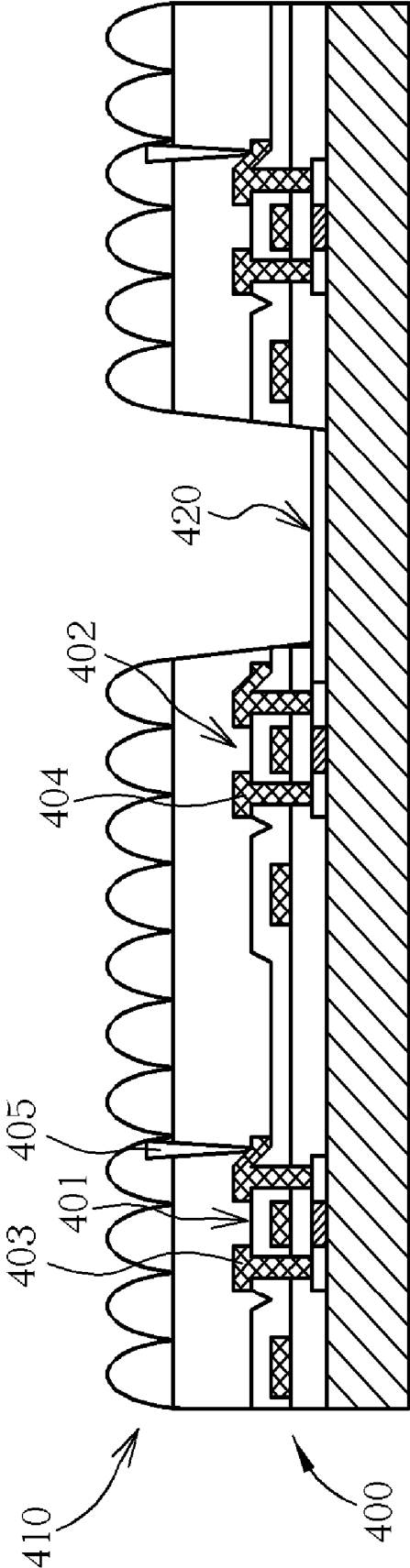

Fig. 13

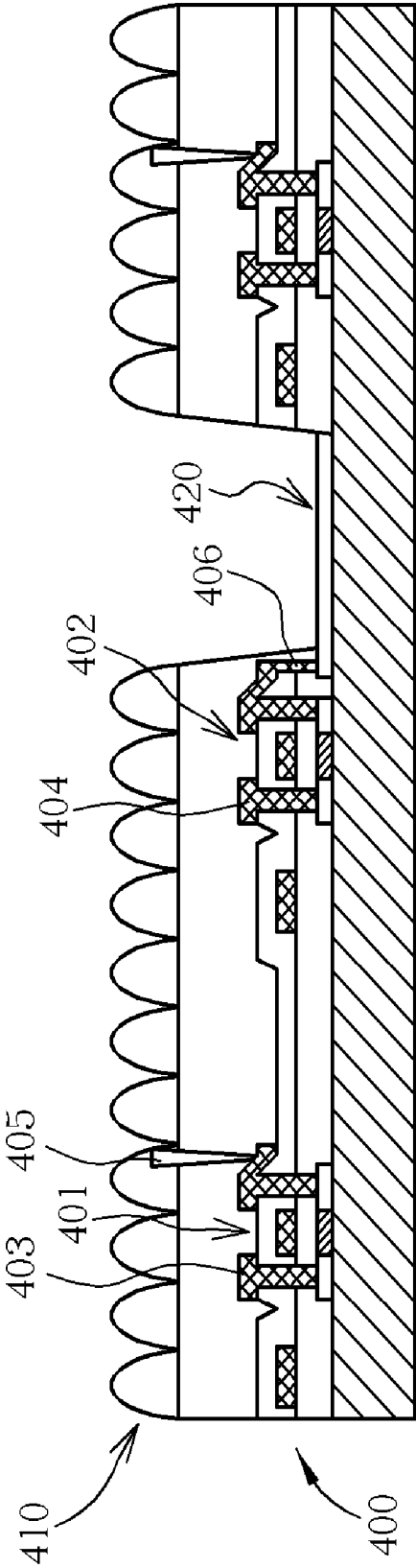

Fig. 14

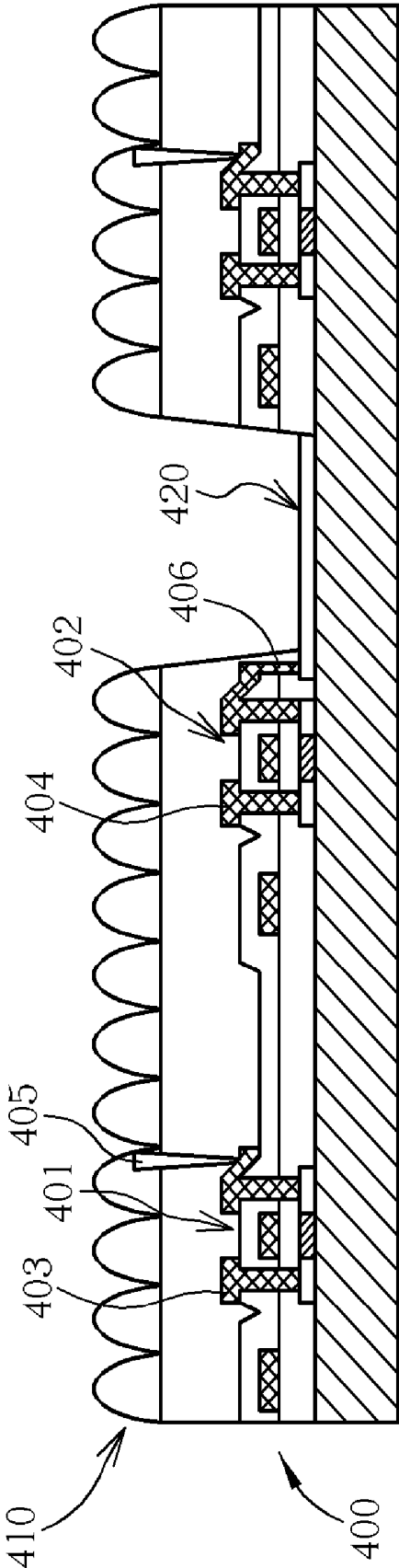

Fig. 15

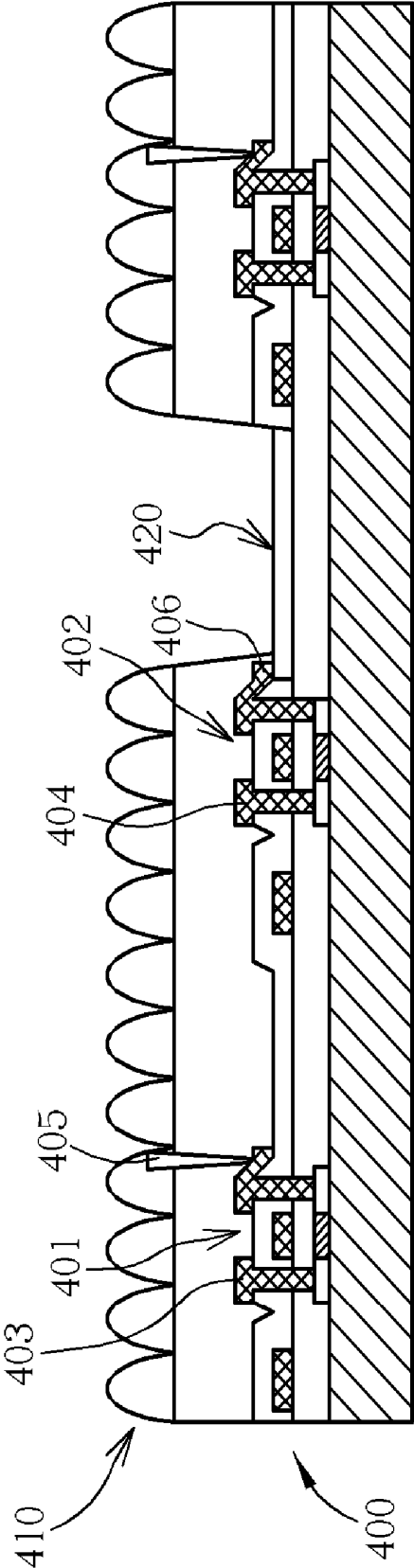

Fig. 16

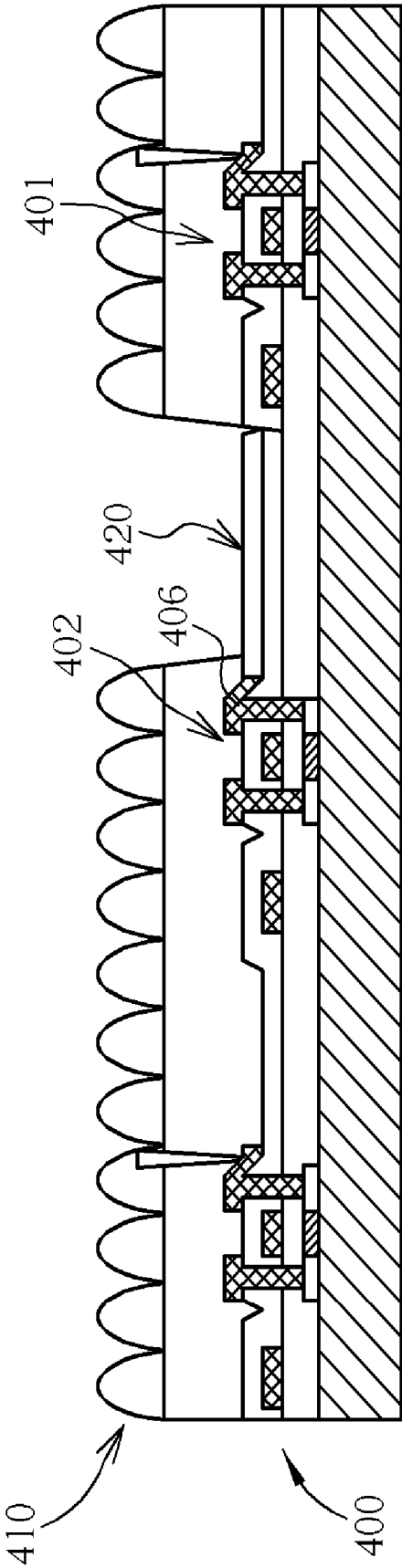

Fig. 17

## TRANSFLECTIVE LIQUID CRYSTAL DISPLAY

### CROSS REFERENCE TO RELATED APPLICATIONS

[0001] This application is a division of application Ser. No. 10/250,018 filed on May 29, 2003.

### BACKGROUND OF INVENTION

[0002] 1. Field of the Invention

[0003] The present invention relates to a liquid crystal display (LCD), and more particularly to a transfective LCD.

[0004] 2. Description of the Prior Art

[0005] LCDs have been popularly applied to various IT products such as notebooks, personal digital assistants (PDAs), and cellular phones. Since LCDs are passive luminous devices, an external light source is required. According to different types of external light sources, LCDs are generally classified into reflective LCDs, transmissive LCDs, and transfective LCDs. In a reflective LCD, an external light in front of the panel enters the panel, and is reflected by a reflective layer (such as an aluminum layer) so that users can see what the LCD displays on the screen. In a transmissive LCD, a back light module is installed behind the panel for radiating light, and the radiating light will pass through the panel so that users can see what the LCD displays on the screen. In a transfective LCD, an external light and a back light module are used simultaneously as light sources to illuminate the transfective LCD.

[0006] Please refer to FIG. 1. FIG. 1 is a schematic diagram of a pixel region 100 of a prior art transfective LCD, wherein the pixel region 100 is a red color, green color, or blue color pixel region. As shown in FIG. 1, the pixel region 100 comprises a reflection pixel region 110 and a transmission region 120, wherein the reflection pixel region 110 includes a reflective electrode (not shown), and the transmission pixel region 120 comprises a transmissive electrode (not shown). The transmissive electrode (not shown) and the reflective electrode of a pixel region are connected to a pixel driving circuit 101 controlled by a scan line SL1 and a data line DL1, and the luminance of the transmission pixel and the reflective pixel are controlled by the pixel driving circuit 101 simultaneously.

[0007] The transmission mode of the prior art transfective LCD uses an internal back light module, while the reflection mode uses an external light. However, in the prior art a pixel driving circuit is used to control both a transmission pixel region and a reflection pixel region in the same pixel region, so only the transmission region or the reflection region can be controlled to its best color display. Therefore the total color display of the transfective LCD is reduced.

### SUMMARY OF INVENTION

[0008] It is therefore a primary objective of the claimed invention to provide a transfective LCD using two independent switching elements to control the transmission pixel region and the reflection pixel region so that both the transmission mode and the reflection mode can achieve best color display with any light sources.

[0009] According to the claimed invention, the transfective LCD comprises a reflection region and a transmission

region installed in a pixel region. The reflection region includes a reflective electrode connected to a first switching element, and the transmission region comprises a transmissive electrode connected to a second switching element, wherein the first switching element and the second switching element respectively control the function of reflection mode and transmission mode.

[0010] It is an advantage of the claimed invention that the best color display of the transfective LCD can be achieved because the luminance of the reflection region and the transmission region are controlled separately by the first switching element and the second switching element.

[0011] These and other objectives of the present invention will no doubt become obvious to those of ordinary skill in the art after reading the following detailed description of the preferred embodiment that is illustrated in the various figures and drawings.

### BRIEF DESCRIPTION OF DRAWINGS

[0012] FIG. 1 is a schematic diagram of a pixel region of a prior art transfective LCD.

[0013] FIG. 2 to FIG. 5 are schematic diagrams of a pixel region of a transfective LCD along the radiation direction of a back light module in the first embodiment of the present invention.

[0014] FIG. 6 is a schematic diagram of a pixel region of a transfective LCD along the radiation direction of a back light module in the second embodiment of the present invention.

[0015] FIG. 7 to FIG. 10 are schematic diagrams of a pixel region of a transfective LCD along the radiation direction of a back light module in the third embodiment of the present invention.

[0016] FIG. 11 is a schematic diagram of a pixel region of a transfective LCD along the radiation direction of a back light module in the fourth embodiment of the present invention.

[0017] FIG. 12 to FIG. 17 are cross-section diagrams of a transfective LCD of the present invention.

### DETAILED DESCRIPTION

[0018] Please refer to FIG. 2. FIG. 2 is a schematic diagram of a pixel region 200 of a transfective LCD along the radiation direction of a back light module in the first embodiment of the present invention, wherein the pixel region 200 is a red color pixel region, a green color pixel region, or a blue color pixel region. As shown in FIG. 2, the pixel region 200 includes a reflection region 210 and a transmission region 220, the luminance of the reflection region 210 is controlled by a first switching element 201, and the luminance of the transmission region 220 is controlled by a second switching element 202. The switching elements 201 and 202 can be driving circuits sharing a scan line SL1, connect to data lines DL1 and DL2 by contact holes 203 and 204, and receive image data signals from data lines DL1 and DL2 respectively. Furthermore, the first switching element 201 is connected to a reflective electrode (not shown) by a contact hole 205 for controlling the luminance of the reflection region 210, and the second switching element 202 is connected to a transmissive elec-

trode (not shown) by a contact hole 206 for controlling the luminance of the transmission region 220. In this embodiment of the present invention, the data line DL1, DL2 and the switching element 201, 202 are located below the reflection region 210 for not affecting the aperture ratio. It is worth noticing that the relative location and ratio of the reflection pixel region and the transmission pixel region can be modified according to circuit designs as shown in FIG. 3, FIG. 4, and FIG. 5.

[0019] Please refer to FIG. 6. FIG. 6 is a schematic diagram of a pixel region 230 of a transfective LCD along the radiation direction of a back light module in the second embodiment of the present invention, wherein the pixel region 230 is a red color pixel region, a green color pixel region, or a blue color pixel region. As shown in FIG. 6, the pixel region 230 includes a reflection region 240 and a transmission region 250, the luminance of the reflection region 230 is controlled by a first switching element 231, and the luminance of the transmission region 250 is controlled by a second switching element 232. The switching elements 231 and 232 are driving circuits sharing a scan line SL1, connect to data lines DL12 and DL21 by contact holes 233 and 234, and receive image data signals from data lines DL12 and DL21 respectively. Furthermore, the first switching element 231 is connected to a reflective electrode (not shown) by a contact hole 235 for controlling the luminance of the reflection region 240, and the second switching element 232 is connected to a transmissive electrode (not shown) by a contact hole 236 for controlling the luminance of the transmission region 250. In this embodiment of the present invention, the data line DL12 and the first switching element 231 are located below the reflection region 240, while the data line DL21 and the second switching element 232 are located below a reflection pixel region of a neighboring pixel region for not affecting the aperture ratio.

[0020] Please refer to FIG. 7. FIG. 7 is a schematic diagram of a pixel region 300 of a transfective LCD along the radiation direction of a back light module in the third embodiment of the present invention, wherein the pixel region 300 is a red color pixel region, a green color pixel region, or a blue color pixel region. As shown in FIG. 7, the pixel region 300 includes a reflection region 310 and a transmission region 320, the luminance of the reflection region 310 is controlled by a first switching element 301, and the luminance of the transmission region 320 is controlled by a second switching element 302. The switching elements 301 and 302 are respectively connected to a data line DL1 by contact holes 303 and 304. Furthermore, the first switching element 301 is connected to a reflective electrode (not shown) by a contact hole 305, and the reflective electrode (not shown) receives a signal from the scan line SL1 to switch the reflection region 310. The second switching element 302 is connected to a transmissive electrode (not shown) by a contact hole 306, and the transmissive electrode (not shown) receives a signal from the scan line SL2 to switch the transmission region 320. In this embodiment of the present invention, the scan lines SL1, SL2 and the switching elements 301, 302 are located below the reflection region 310 for not affecting the aperture ratio. It is worth noticing that the relative location and ratio of the reflection pixel region and the transmission pixel region can be modified according to circuit designs as shown in FIG. 8, FIG. 9, and FIG. 10.

[0021] Please refer to FIG. 11. FIG. 11 is a schematic diagram of a pixel region 350 of a transfective LCD along the radiation direction of a back light module in the fourth embodiment of the present invention, wherein the pixel region 350 is a red color pixel region, a green color pixel region, or a blue color pixel region. As shown in FIG. 11, the pixel region 350 includes a reflection region 360 and a transmission region 370, the luminance of the reflection region 360 is controlled by a first switching element 351, and the luminance of the transmission region 370 is controlled by a second switching element 352. The switching elements 351 and 352 are respectively connected to a data line DL1 by contact holes 353 and 354. Furthermore, the first switching element 351 is connected to a reflective electrode (not shown) by a contact hole 355, and the reflective electrode (not shown) receives a signal from the scan line SL1 to switch the reflection region 360. The second switching element 352 is connected to a transmissive electrode (not shown) by a contact hole 356, and the transmissive electrode (not shown) receives a signal from the scan line SL2 to switch the transmission region 370. In this embodiment of the present invention, the scan lines SL1 and the first switching element 351 are located below the reflection region 360, while the scan line SL2 and the second switching element 352 are located below a reflection pixel region of a neighboring pixel region for not affecting the aperture ratio.

[0022] All embodiments of the present invention can be modified as follows. Please refer to FIG. 12 to FIG. 17. FIG. 12 to FIG. 17 are cross-section diagrams of a transfective LCD 400 of the present invention. As shown in FIG. 12 to FIG. 14, the transfective LCD 400 comprises a reflective electrode 410, a transmissive electrode 420, a first switching element 401, and a second switching element 402. The first switching element 401 is connected to a data line by a via hole 403 and is connected to the reflective electrode 410 by a via hole 405, and the second switching element 402 is connected to a data line by a via hole 404. The material of the transmissive electrode 420 can be doped or non-doped polysilicon, or doped or non-doped amorphous silicon. Furthermore, the transmissive electrode 420 can be connected directly to an active layer (source/drain) of the second switching element 402 as shown in FIG. 12 and FIG. 13, or the transmissive electrode 420 can be connected to the active layer of the second switching element 402 by the via hole 406 as shown in FIG. 14. Additionally, the transmissive electrode 420 can be an ITO or an IZO material, and is connected to the second switching element 402 by a via hole 406, wherein the location of the transmissive electrode 420 can be modified as shown in FIG. 15 to FIG. 17. As shown in FIG. 15, the transmissive electrode 420 is located on the bottom layer of the second switching element 402. As shown in FIG. 16, the transmissive electrode 420 and the scan line are located in the same layer. As shown in FIG. 17, the transmissive electrode 420 and the data line are located in the same layer.

[0023] Those skilled in the art will readily observe that numerous modifications and alterations of the device and method may be made while retaining the teachings of the invention. Accordingly, the above disclosure should be construed as limited only by the metes and bounds of the appended claims.

What is claimed is:

1. A transfective liquid crystal display (LCD) including at least a reflection region and a transmission region positioned in a pixel region of the transfective liquid crystal display, wherein the reflection region includes at least a reflective electrode connected to a first switching element, and the transmission region includes at least a transmissive electrode connected to a second switching element, the first switching element and the second switching element are connected to the same data line and are respectively connected to a first scan line and a second scan line that are not electrically connected to each other.

2. The transfective LCD of claim 1, wherein the pixel region is a red color pixel region.

3. The transfective LCD of claim 1, wherein the pixel region is a green color pixel region.

4. The transfective LCD of claim 1, wherein the pixel region is a blue color pixel region.

5. The transfective LCD of claim 1, wherein the first switching element is used to control a reflection mode of the transfective LCD, and the second switching element is used to control a transmission mode of the transfective LCD.

6. The transfective LCD of claim 5, wherein the reflection mode and the transmission mode are operated individually or cooperatively to achieve best display effect.

7. The transfective LCD of claim 1, wherein the second switching element is located under the reflective electrode to avoid affecting the aperture ratio of the transfective LCD.

8. The transfective LCD of claim 1, wherein the transmissive electrode is connected to an active layer of the second switching element.

9. The transfective LCD of claim 1, wherein the transmissive electrode is located in a bottom layer of the second switching element.

10. The transfective LCD of claim 1, wherein the transmissive electrode, the first scan line, and the second scan line are located in the same layer.

11. The transfective LCD of claim 1, wherein the transmissive electrode and the data line are located in the same layer.

\* \* \* \* \*

专利名称(译)	透反液晶显示器		
公开(公告)号	<a href="#">US20050146657A1</a>	公开(公告)日	2005-07-07
申请号	US10/907053	申请日	2005-03-18
[标]申请(专利权)人(译)	螭纹JAIN 婷戴良 林萧易 LIN GWO LONG 吴魏我		
申请(专利权)人(译)	文智JAIN 寿DAI-LIANG 林孝仪 LIN GWO-LONG 吴I-WEI		
当前申请(专利权)人(译)	群创光电		
[标]发明人	WEN CHI JAIN TING DAI LIANG LIN HSIAO YI LIN GWO LONG WU I WEI		
发明人	WEN, CHI-JAIN TING, DAI-LIANG LIN, HSIAO-YI LIN, GWO-LONG WU, I-WEI		
IPC分类号	G02F1/1335 G02F1/1362		
CPC分类号	G02F1/13624 G02F1/133555		
其他公开文献	US7002652		
外部链接	<a href="#">Espacenet</a> <a href="#">USPTO</a>		

摘要(译)

透反液晶显示器 ( LCD ) 至少包括透射像素区域和位于像素区域中的至少一个反射像素区域。透射区域至少包括连接到第一开关元件的透射电极。反射像素区域至少包括连接到第二开关元件的反射电极。透射和反射电极分别由独立的开关元件控制。

